

Submit 3 Copies To Appropriate District
Office
District I
1625 N. French Dr., Hobbs, NM 87240
District II
1301 W. Grand Avenue, Artesia, NM
88210
District III
1000 Rio Brazos Rd., Aztec, NM 87410
District IV
2040 South Pacheco, Santa Fe, NM 87505

State of New Mexico
Energy, Minerals and Natural Resources

OIL CONSERVATION DIVISION
2040 South Pacheco
Santa Fe, NM 87505

Form C-103
Revised March 25, 1999

SUNDRY NOTICES AND REPORTS ON WELLS (DO NOT USE THIS FORM FOR PROPOSALS TO DRILL OR TO DEEPEN OR PLUG BACK TO A DIFFERENT RESERVOIR. USE "APPLICATION FOR PERMIT" (FORM C-101) FOR SUCH PROPOSALS.)		WELL API NO. 30-025-35548
1. Type of Well: Oil Well <input checked="" type="checkbox"/> Gas Well <input type="checkbox"/> Other <input type="checkbox"/>		5. Indicate Type of Lease STATE <input checked="" type="checkbox"/> FEE <input type="checkbox"/>
2. Name of Operator Matador Operating Company		6. State Oil & Gas Lease No.
3. Address of Operator 8340 Meadow Road #150, Dallas, TX 75231		7. Lease Name or Unit Agreement Name: Shelley 35 State
4. Well Location Unit Letter <u>F</u> : <u>2130</u> feet from the <u>North</u> line and <u>1980</u> feet from the West <u> </u> line Section <u>35</u> Township <u>19S</u> Range <u>37E</u> NMPM Lea County		8. Well No. <u>2</u>
10. Elevation (Show whether DR, RKB, RT, GR, etc.) <u>3593' GR</u>		9. Pool name or Wildcat Wildcat (Abo)

11. Check Appropriate Box to Indicate Nature of Notice, Report or Other Data

NOTICE OF INTENTION TO:

PERFORM REMEDIAL WORK ☐ PLUG AND ABANDON ☐

TEMPORARILY ABANDON ☐ CHANGE PLANS ☒

PULL OR ALTER CASING ☐ MULTIPLE COMPLETION ☐

OTHER: ☐

SUBSEQUENT REPORT OF:

REMEDIAL WORK ☐ ALTERING CASING ☐

COMMENCE DRILLING OPNS. ☐ PLUG AND ABANDONMENT ☐

CASING TEST AND CEMENT JOB ☐

OTHER: ☐

12. Describe proposed or completed operations. (Clearly state all pertinent details, and give pertinent dates, including estimated date of starting any proposed work). SEE RULE 1103. For Multiple Completions: Attach wellbore diagram of proposed completion or recompilation.

Drill 12-1/4" hole to top of Anhydrite @ +/- 1350'. Run and cement 8-5/8" casing. Nipple up 11" 3M BOP assembly and test to 3000 psi. Drill 7-7/8" hole to 7800'. Evaluate to run 4-1/2" casing to 7800'.

Anticipated total depth 7800'. The primary target is Monument (Tubb) interval (80 acre spacing as per original permit). The secondary target is Wildcat (Abo) interval. The Abo completion is expected to be oil. If results indicate classification as gas well, Matador will comply with rules of Skaggs-Abo, Gas.

Note: Revising pool name and total depth.

I hereby certify that the information above is true and complete to the best of my knowledge and belief.

SIGNATURE Jim Kramer TITLE Sr. Drilling Engineer DATE 1/3/02

Type or print name Jim Kramer Telephone No. 214 987-7128
(This space for State use)

APPROVED BY _____

TITLE _____ DATE JAN 11 2002
Conditions of approval, if any:

DISTRICT I
P. O. Box 1980
Hobbs, NM 88241-1980

State of New Mexico
Energy, Minerals, and Natural Resources Department

Form C-102
Revised 02-10-94
Instructions on back

DISTRICT II
P. O. Drawer DD
Artesia, NM 88211-0719

OIL CONSERVATION DIVISION
P. O. Box 2088
Santa Fe, New Mexico 87504-2088

Submit to the Appropriate
District Office
State Lease - 4 copies
Fee Lease - 3 copies

DISTRICT III
1000 Rio Brazos Rd.
Aztec, NM 87410

☐ AMENDED REPORT

DISTRICT IV
P. O. Box 2088
Santa Fe, NM 87507-2088

WELL LOCATION AND ACREAGE DEDICATION PLAT

1 API Number 30-025-35548		2 Pool Code		3 Pool Name Wildcat (Abo)			
4 Property Code 27971		5 Property Name SHELLEY STATE 35				6 Well Number 2	
7 OGRID No. 014245		8 Operator Name MATADOR OPERATING COMPANY				9 Elevation 3593'	

10 SURFACE LOCATION

UL or lot no.	Section	Township	Range	Lot Ida	Feet from the	North/South line	Feet from the	East/West line	County
F	35	19 SOUTH	37 EAST, N.M.P.M.		2130'	NORTH	1980'	WEST	LEA

11 BOTTOM HOLE LOCATION IF DIFFERENT FROM SURFACE

UL or lot no.	Section	Township	Range	Lot Ida	Feet from the	North/South line	Feet from the	East/West line	County

12 Dedicated Acres 40	13 Joint or Infill	14 Consolidation Code	15 Order No.
--------------------------	--------------------	-----------------------	--------------

NO ALLOWABLE WELL BE ASSIGNED TO THIS COMPLETION UNTIL ALL INTERESTS HAVE BEEN CONSOLIDATED OR A NON-STANDARD UNIT HAS BEEN APPROVED BY THE DIVISION

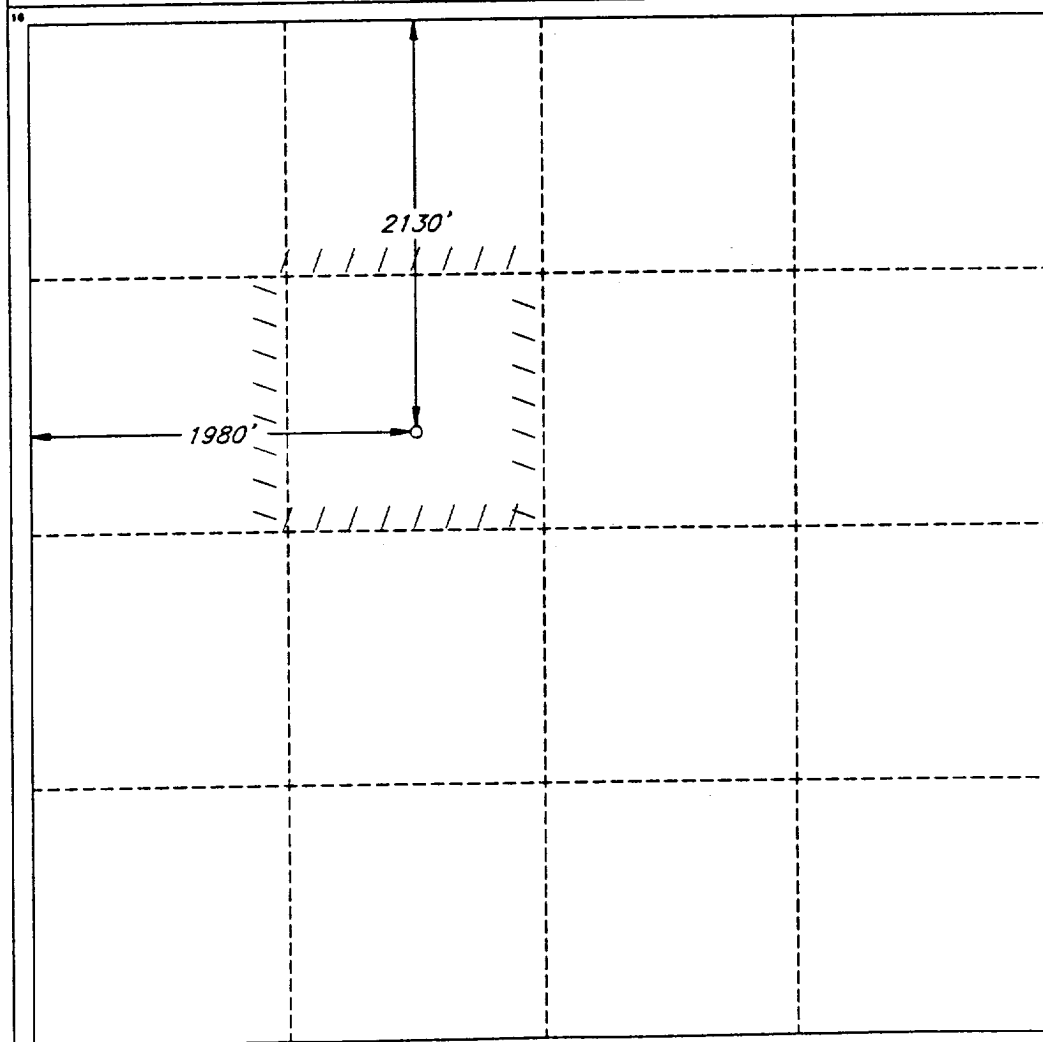

OPERATOR CERTIFICATION

I hereby certify that the information contained herein is true and complete to the best of my knowledge and belief.

Signature
Sharon Cook

Printed Name
Sharon Cook

Title
Regulatory Analyst

Date
1/4/02

SURVEYOR CERTIFICATION

I hereby certify that the well location shown on this plat was plotted from field notes of actual surveys made by me or under my supervision, and that the same is true and correct to the best of my belief.

Date of Survey
MAY 2, 2001

Signature and Seal of
Professional Surveyor

[Signature]
V. L. BEZNER / R.P.S. #7920

Certificate No.
V. L. BEZNER - R.P.S. #7920

JOB #76219 / 70 SW / J.C.P.