

Santa Fe, New Mexico

NOTICE OF INTENTION TO DRILL

Notice must be given to the Oil Conservation Commission or its proper agent and approval obtained before drilling begins. If changes in the proposed plan are considered advisable, a copy of this notice showing such changes will be returned to the sender. Submit this notice in triplicate. One copy will be returned following approval. See additional instructions in Rules and Regulations of the Commission.

Dallas 1, Texas

February 24, 1948

Place

Date

OIL CONSERVATION COMMISSION, Santa Fe, New Mexico,

Gentlemen:

You are hereby notified that it is our intention to commence the drilling of a well to be known as MAGNOLIA PETROLEUM COMPANY E.O. Carson Well No. 16 in NW NW

Company or Operator

Lease

of Sec 33, T 21S, R 37E, N. M., P. M., Ellenburger Pay, Lea County, Eunice Area

The well is 660 feet (N.) (S.) of the North line and 860 feet (E.) (W.) of the West line of of the NW 1/4

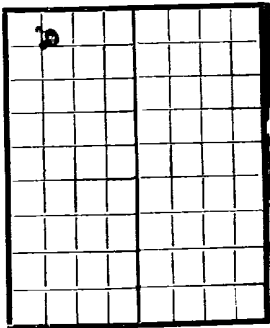

AREA 640 ACRES

LOCATE WELL CORRECTLY

(Give location from section or other legal subdivision lines. Cross out wrong directions.)

If state land the oil and gas lease is No. Assignment No.

If patented land the owner is E. O. Carson Merkel, Texas

Address

If government land the permittee is

Address

The lessee is Magnolia Petroleum Company

Address Box 727, Kermit, Texas

We propose to drill well with drilling equipment as follows: Rotary

The status of a bond for this well in conformance with Rule 39 of the General Rules and Regulations of the Commission is as follows: Financial Statement of Company filed with Commission and in First Judicial District of New Mexico

We propose to use the following strings of casing and to land or cement them as indicated:

Table with 7 columns: Size of Hole, Size of Casing, Weight Per Foot, New or Second Hand, Depth, Landed or Cemented, Sacks Cement. Rows include 17-1/4", 12-1/4", and 8-3/4" casing sizes with corresponding depths and cement requirements.

If changes in the above plan become advisable we will notify you before cementing or landing casing. We estimate that the first productive oil or gas sand should occur at a depth of about 8400 feet.

Additional information:

Approved, 19, except as follows:

Sincerely yours,

MAGNOLIA PETROLEUM COMPANY

Company or Operator

By [Signature]

Position Field Superintendent

Send communications regarding well to

Name M. Shaffer

Address Box 900 - Dallas 1, Texas

OIL CONSERVATION COMMISSION,

By [Signature]

Title

12/15/1916
(Ellenburger Pay)

Magnolia Petroleum Company

PRODUCING DEPARTMENT

Location made Feb. 24th, 1948

E. O. Carson Well No. 16

Lea District

Lease A-B NM. 612, acres 320 Sec. 33, T 21 S, R 37 E District Township

Lea County, New Mexico

Scale 1" = 500'

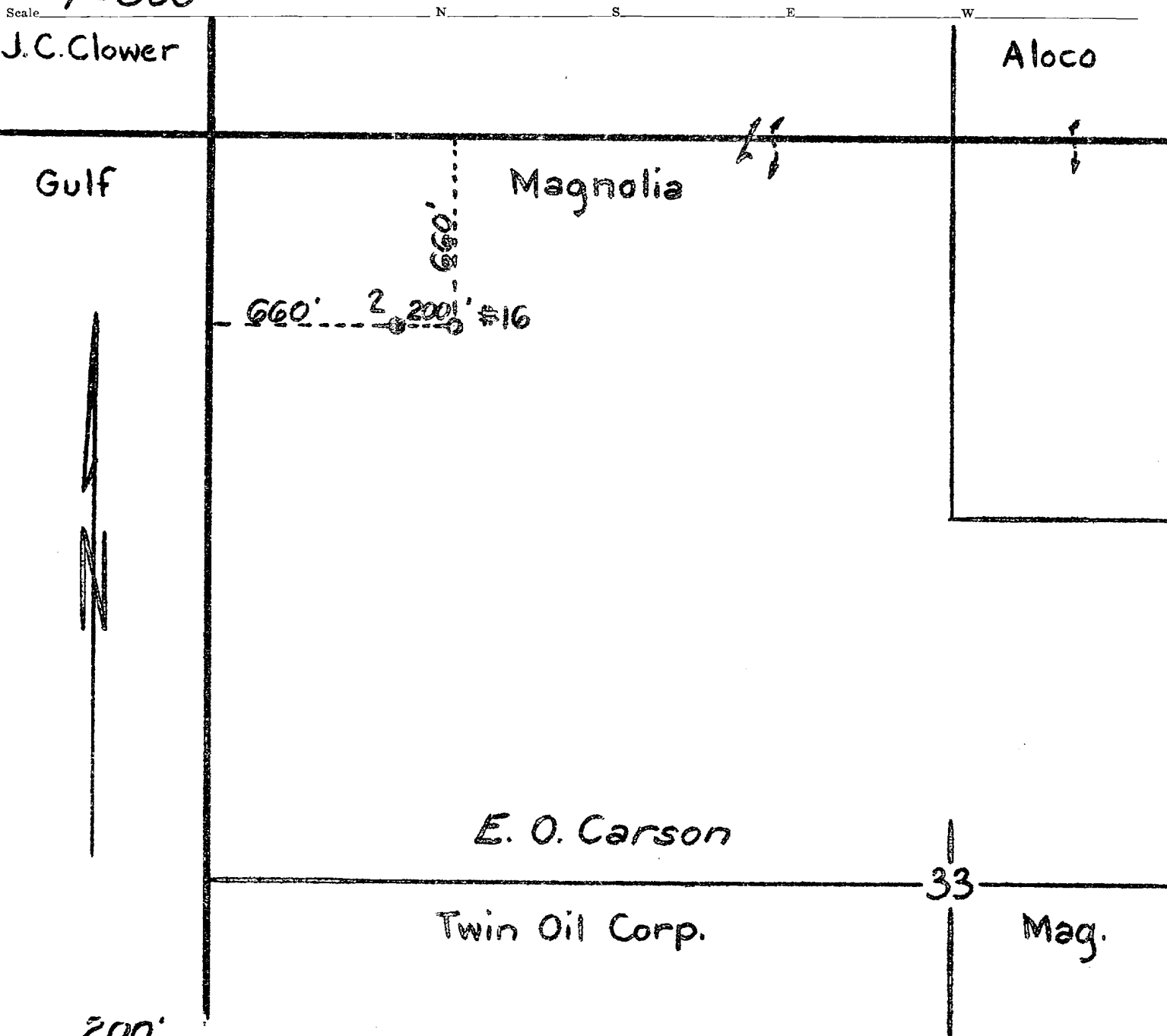

Reserve 200'

Special instructions

Location changed on account of

Date work is commenced _____ 194 _____ Supt. E. J. Strickman

Location approved by _____ Plat made by R. M. Brady

Magnolia Petroleum Company
PRODUCING DEPARTMENT

Location for Well No. _____

File No. _____