

NEW MEXICO OIL CONSERVATION COMMISSION

SANTA FE, NEW MEXICO

5-1-61

APPLICATION FOR MULTIPLE COMPLETION

Operator Continental Oil Company		County Lea		Date 12-10-76
Address Box 460, Hobbs, N. M. 88240		Lease Warren Unit		Well No. 42
Location or Well	Unit I	Section 27	Township 20-S	Range 38-E

1. Has the New Mexico Oil Conservation Commission heretofore authorized the multiple completion of a well in these same pools or in the same zones within one mile of the subject well? YES X NO _____

2. If answer is yes, identify one such instance: Order No. MC-2213; Operator, Lease, and Well No.: Continental Oil Company Warren Unit No. 37

3. The following facts are submitted:	Upper Zone	Intermediate Zone	Lower Zone
a. Name of Pool and Formation	Blinebry Oil & Gas		Warren Tubb
b. Top and Bottom of Pay Section (Perforations)	5900-6050'		6575-6675'
c. Type of production (Oil or Gas)	Oil		Oil
d. Method of Production (Flowing or Artificial Lift)			

4. The following are attached. (Please mark YES or NO)

- Yes a. Diagrammatic Sketch of the Multiple Completion, showing all casing strings, including diameters and setting depths, centralizers and /or turbolizers and location thereof, quantities used and top of cement, perforated intervals, tubing strings, including diameters and setting depth, location and type of packers and side door chokes, and such other information as may be pertinent.
- Yes b. Plat showing the location of all wells on applicant's lease, all offset wells on offset leases, and the names and addresses of operators of all leases offsetting applicant's lease.
- * c. Waivers consenting to such multiple completion from each offset operator, or in lieu thereof, evidence that said offset operators have been furnished copies of the application. *
- ** d. Electrical log of the well or other acceptable log with tops and bottoms of producing zones and intervals of perforation indicated thereon. (If such log is not available at the time application is filed, it shall be submitted as provided by Rule 112-A.)

5. List all offset operators to the lease on which this well is located together with their correct mailing address.

*Continental is the offset operator

**Will follow

6. Were all operators listed in Item 5 above notified and furnished a copy of this application? YES ** NO ____ . If answer is yes, give date of such notification _____ .

CERTIFICATE: I, the undersigned, state that I am the Administrative Supervisor of the Continental Oil (company), and that I am authorized by said company to make this report; and that this report was prepared under my supervision and direction and that the facts stated therein are true, correct and complete to the best of my knowledge.

NMOCC - Santa Fe (2)

NMOCC - Hobbs (2)

*File Should waivers from all offset operators not accompany an application for administrative approval, the New Mexico Oil Conservation Commission will hold the application for a period of twenty (20) days from date of receipt by the Commission's Santa Fe office. If, after said twenty-day period, no protest nor request for hearing is received by the Santa Fe office, the application will then be processed.

NOTE: If the proposed multiple completion will result in an unorthodox well location and/or a non-standard proration unit in either or both of the producing zones, then separate application for approval of the same should be filed simultaneously with this application.

Bill Renfro
Signature

RECEIVED

DEC 10 1976

OIL CONSERVATION & COMM
ADVISORY BOARD

WARREN UNIT, WELL No. 42
PROPOSED COMPLETION EQUIPMENT

9 5/8", 32.3#/ft @ 1524'
w / 675 SX, CIRC. TO SURFACE
14 - CENTRALIZERS (EVERY 3 JOINTS)

BLINEBRY PERFS
(EST. 5900' - 6050')

TUBS PERFS
(EST. 6575 - 6675')

T.D. - 7090'

SRB

12/10/76

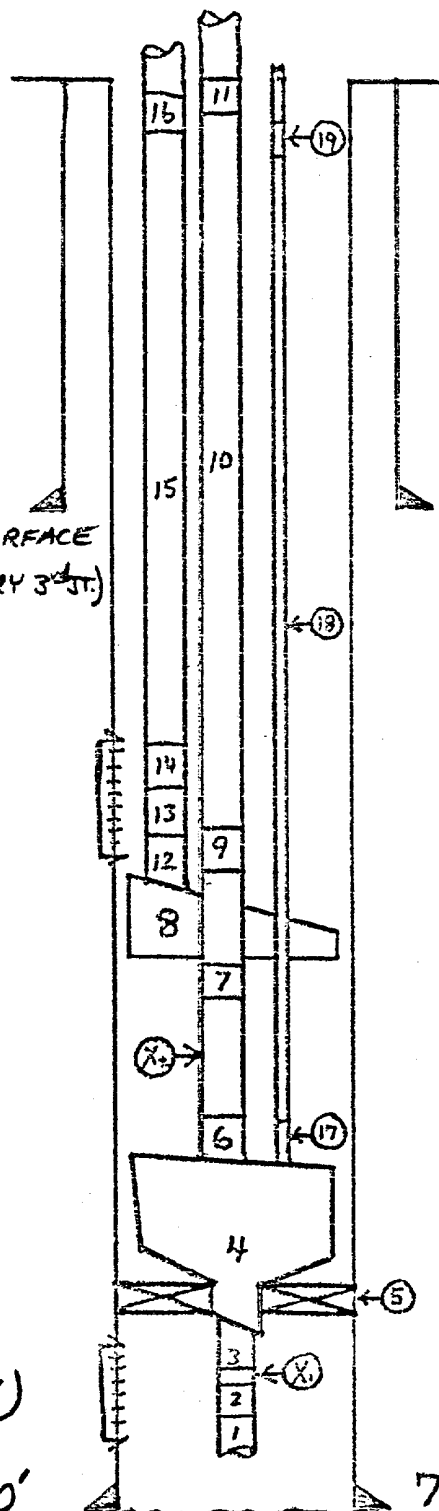

1. 1 JT. 2 3/8" BUTTRESS TBG. O.E.
2. TUBS S.N. - BUTTRESS
- X₁ 2 3/8" BUTTRESS TBG.
3. X-OVER 2 3/8" BUTT. X EUE 8rd
4. VENT HEAD ASSY.
5. PKR (OTIS "WB" PERM PKR)
6. X-OVER 2 3/8" BUTT. X EUE 8rd
- X₂ 2 3/8" BUTTRESS TBG.
7. X-OVER 2 3/8" BUTT. X EUE 8rd
- 8.* TRIPLE STRING ANCHOR
9. X-OVER 2 3/8" BUTT. X EUE 8rd
10. 2 3/8" BUTTRESS TBG.
11. X-OVER 2 3/8" BUTT. X EUE 8rd
12. J- LATCH ASSY.
13. X-OVER 2 3/8" BUTT. X EUE 8rd
14. BLINEBRY S.N. - BUTTRESS
15. 2 3/8" BUTTRESS TBG.
16. X-OVER 2 3/8" BUTT. X EUE 8rd
17. STINGER COLLET
18. 1 1/4" 10rd IIS TBG.
19. X-OVER 10rd IIS 1 1/4" X 10rd EUE

NOTE*: TO BE LOCATED BELOW
BOTTOM BLINEBRY PERFS.

7", 26 1/4#/ft K-55 CS. @ 7090'
w / 1675 SX - TOC = 1850'

8 - CENTRALIZERS (6000' - 6300')
8 - CENTRALIZERS (6500' - 6800')

RECEIVED

FEB 13 1976

OIL CONSERVATION COMM.
HOBBS, N. M.

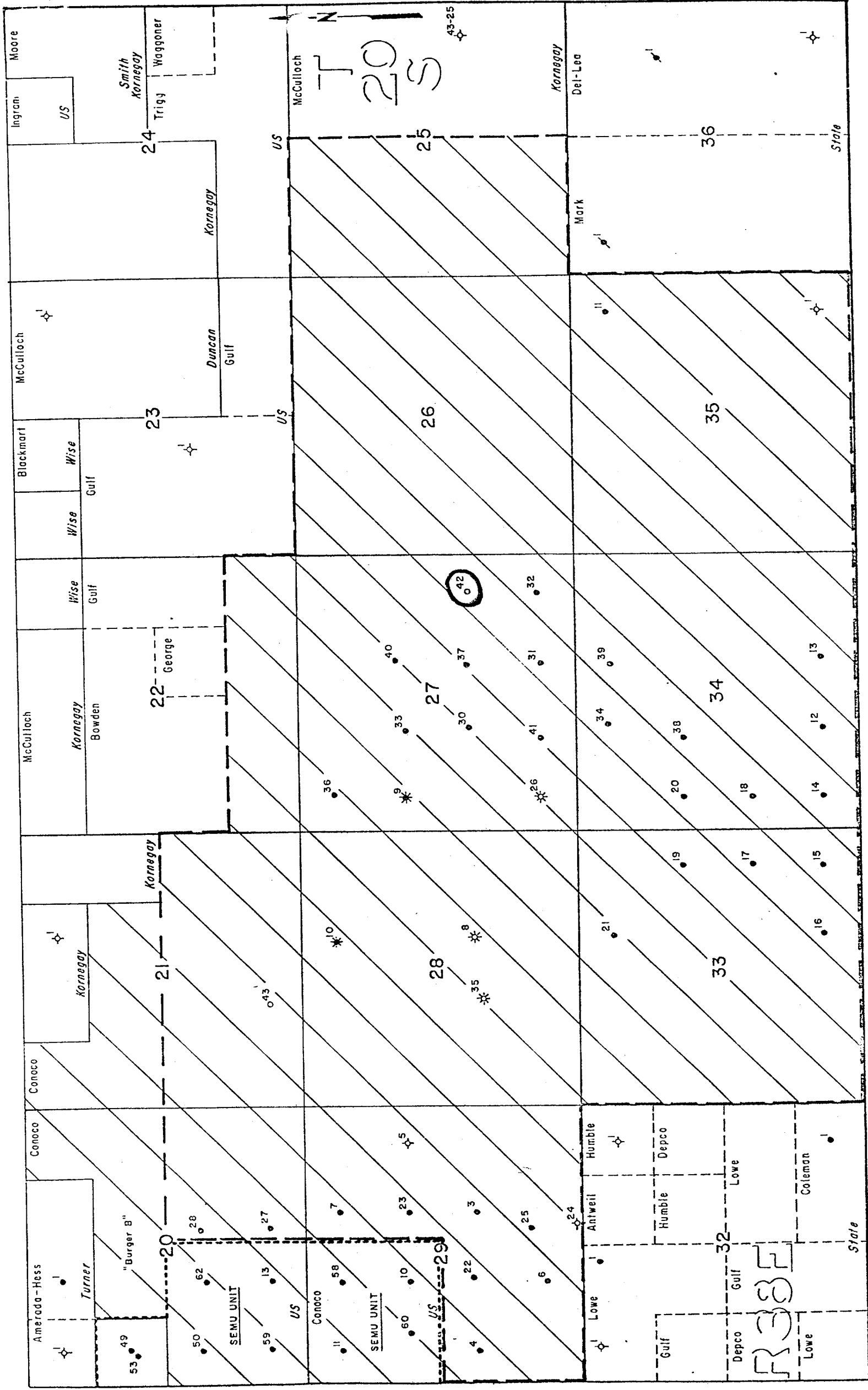

RECEIVED

DEC 13 1976

OIL CONSERVATION COMM.
HOBBS, N. M.