

# VICINITY MAP

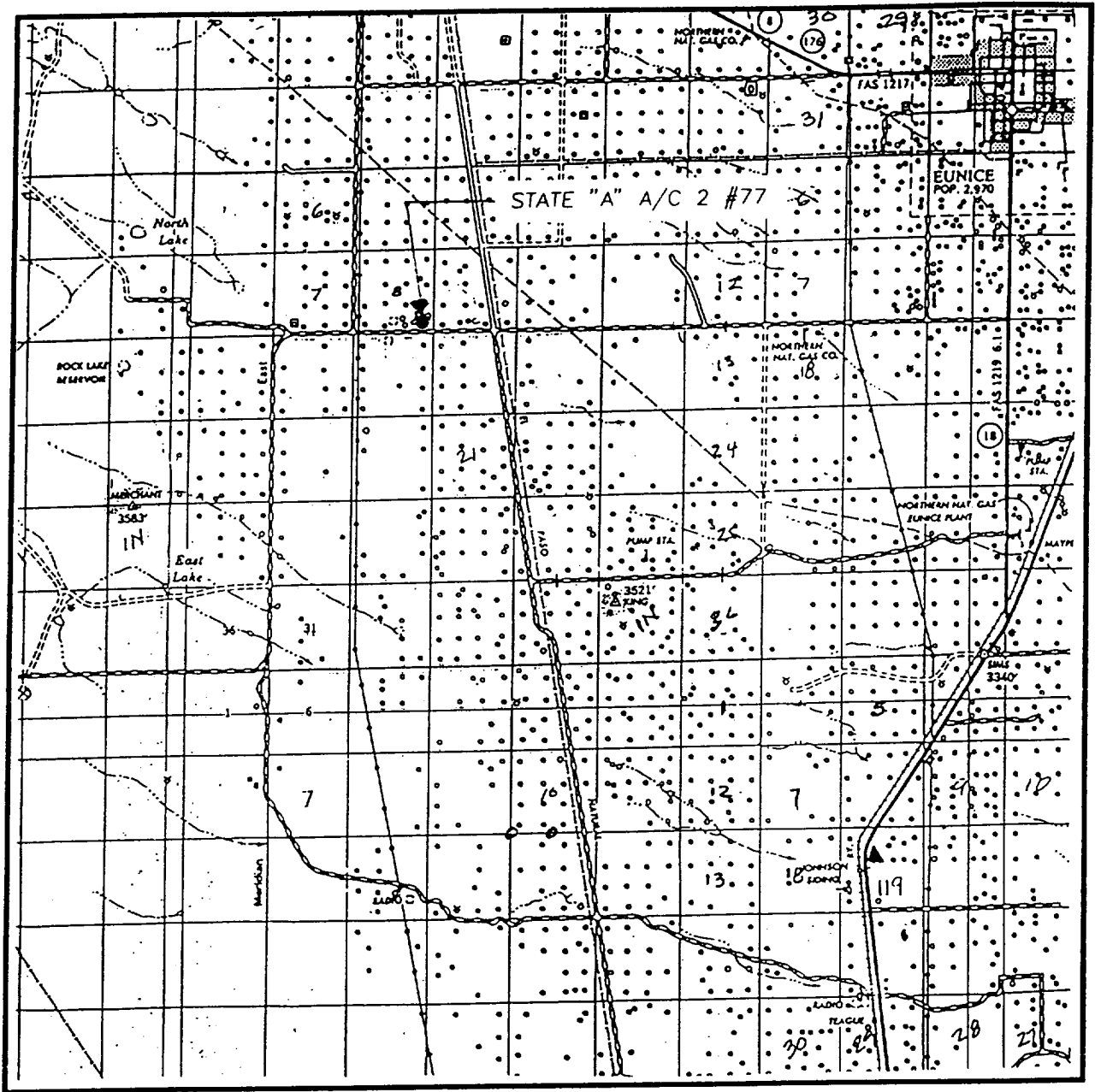

SCALE: 1" = 2 MILES

SEC. 8 TWP. 22-S RGE. 36-E

SURVEY N.M.P.M.

COUNTY LEA

DESCRIPTION 660' FSL & 560' FEL

ELEVATION 3582

OPERATOR RAPTOR RESOURCES, INC.

LEASE STATE "A" A/C 2

**JOHN WEST SURVEYING**  
**HOBBS, NEW MEXICO**  
**(505) 393-3117**

