

NEW MEXICO OIL CONSERVATION COMMISSION
WELL LOCATION AND ACREAGE DEDICATION PLAT

Form C-102
Supersedes C-128
Effective 1-1-65

All distances must be from the outer boundaries of the Section.

| | | | | | |
|---|--|---------------------------------------|--------------------------------|---------------------------------------|-----------------------|
| Operator GULF OIL CORPORATION | | Lease Arnott-Ramsay (NCT-C) | | | Well No. 11 |
| Unit Letter I | Section 21 | Township 21S | Range 37E | County Lea | |
| Actual Postage Location of Well: 1980 feet from the South line and 660 feet from the East line | | | | | |
| Ground Level Elev. 3595 | Producing Formation Grayburg | | Pool Eunice-Monument | Dedicated Acreage: 40 Acres | |

1. Outline the acreage dedicated to the subject well by colored pencil or hachure marks on the plat below.
2. If more than one lease is dedicated to the well, outline each and identify the ownership thereof (both as to working interest and royalty).
3. If more than one lease of different ownership is dedicated to the well, have the interests of all owners been consolidated by communitization, unitization, force-pooling, etc?

Yes No If answer is "yes," type of consolidation _____

If answer is "no," list the owners and tract descriptions which have actually been consolidated. (Use reverse side of this form if necessary.) _____

No allowable will be assigned to the well until all interests have been consolidated (by communitization, unitization, forced-pooling, or otherwise) or until a non-standard unit, eliminating such interests, has been approved by the Commission.

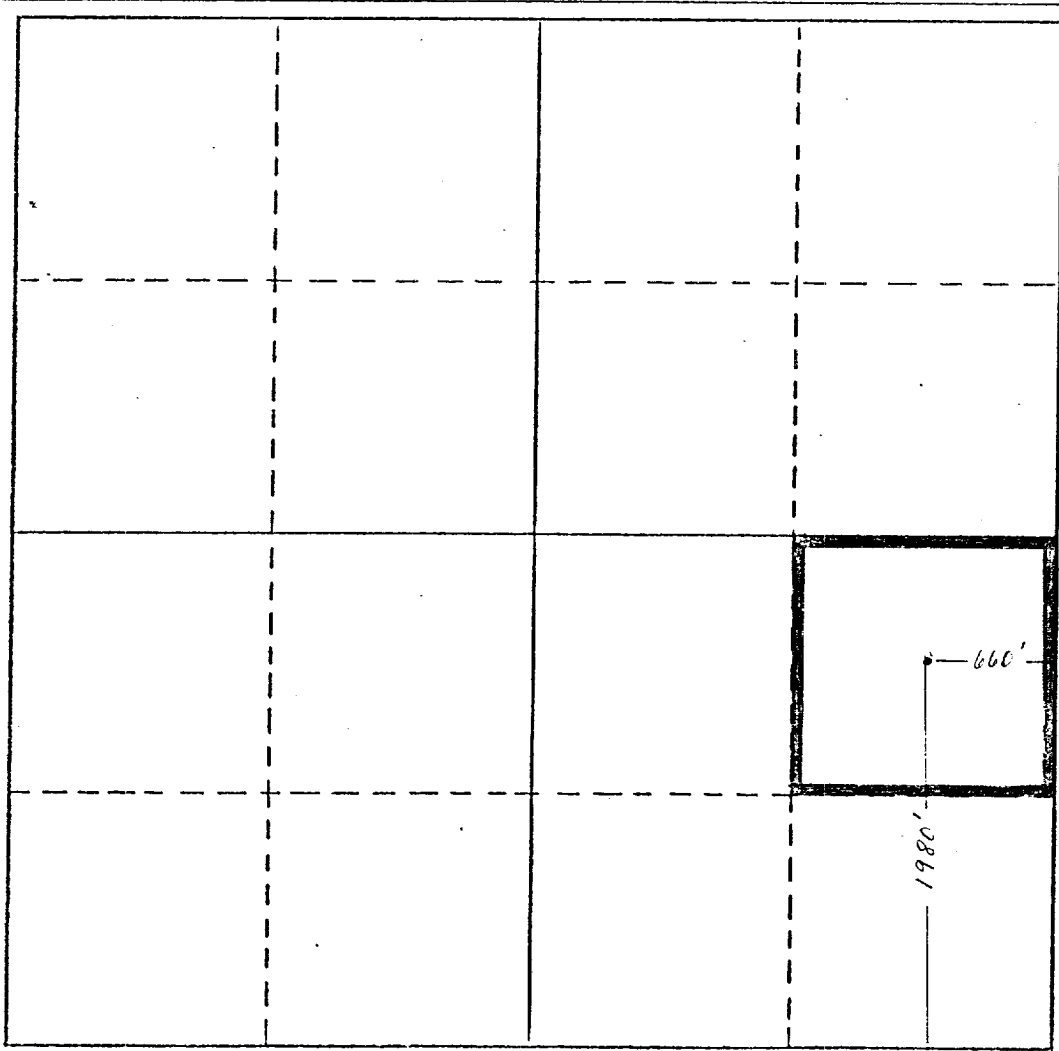

CERTIFICATION

I hereby certify that the information contained herein is true and complete to the best of my knowledge and belief.

N. P. Sikes, Jr.

Name
N. P. Sikes, Jr.

Position
Area Engineer

Company
Gulf Oil Corporation

Date
8-22-79

I hereby certify that the well location shown on this plat was plotted from field notes of actual surveys made by me or under my supervision, and that the same is true and correct to the best of my knowledge and belief.

Date Surveyed

Registered Professional Engineer and/or Land Surveyor

Certificate No.

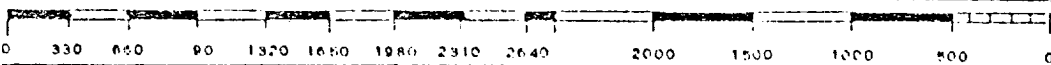

| | | |
|------------------------|--|--|
| NO. OF COPIES RECEIVED | | |
| DISTRIBUTION | | |
| SANTA FE | | |
| FILE | | |
| U.S.G.S. | | |
| LAND OFFICE | | |
| OPERATOR | | |

NEW MEXICO OIL CONSERVATION COMMISSION

Form C-103
Supersedes Old
C-102 and C-103
Effective 1-1-65

5a. Indicate Type of Lease
State Fee
5. State Oil & Gas Lease No.
B-229

SUNDRY NOTICES AND REPORTS ON WELLS
(DO NOT USE THIS FORM FOR PROPOSALS TO DRILL OR TO DEEPEN OR PLUG BACK TO A DIFFERENT RESERVOIR. USE "APPLICATION FOR PERMIT -" (FORM C-101) FOR SUCH PROPOSALS.)

1. OIL WELL GAS WELL OTHER
2. Name of Operator
Gulf Oil Corporation
3. Address of Operator
Box 670, Hobbs, New Mexico 88240
4. Location of Well
UNIT LETTER I 1980 FEET FROM THE South LINE AND 660 FEET FROM
THE East LINE, SECTION 21 TOWNSHIP 21-S RANGE 36-E NMPM.
7. Unit Agreement Name
8. Farm or Lease Name
Arnett-Ramsay (NCT-C)
9. Well No.
11
10. Field and Pool, or Wildcat
Eunice-Monument
15. Elevation (Show whether DF, RT, GR, etc.)
3595' GL
12. County
Lea

16. Check Appropriate Box To Indicate Nature of Notice, Report or Other Data

| | | | |
|--|---|---|---|
| NOTICE OF INTENTION TO: | | SUBSEQUENT REPORT OF: | |
| PERFORM REMEDIAL WORK <input type="checkbox"/> | PLUG AND ABANDON <input type="checkbox"/> | REMEDIAL WORK <input type="checkbox"/> | ALTERING CASING <input type="checkbox"/> |
| TEMPORARILY ABANDON <input type="checkbox"/> | CHANGE PLANS <input type="checkbox"/> | COMMENCE DRILLING OPNS. <input type="checkbox"/> | PLUG AND ABANDONMENT <input type="checkbox"/> |
| PULL OR ALTER CASING <input type="checkbox"/> | OTHER <input type="checkbox"/> | CASING TEST AND CEMENT JOB <input type="checkbox"/> | OTHER <input type="checkbox"/> |
| | | Acidized | |

17. Describe Proposed or Completed Operations (Clearly state all pertinent details, and give pertinent dates, including estimated date of starting any proposed work) SEE RULE 1103.
3870' PB.
Pulled rods and pump. Pumped 500 gallons of 15% NE acid down tubing over open hole interval 3790' to 3870'. Flushed with 12 barrels of oil. Ran rods and pump and returned well to production.

18. I hereby certify that the information above is true and complete to the best of my knowledge and belief.

SIGNED Glyn Stone TITLE Petroleum Engineer DATE January 31, 1972
APPROVED BY John W. Ramsey TITLE Geologist DATE FEB 1 1972
CONDITIONS OF APPROVAL, IF ANY: