

NEW MEXICO OIL CONSERVATION COMMISSION

Well Location and Acreage Dedication Plat

Section A.

Date 7-19-1957

Operator GULF OIL CORP. Lease WM A. RAMSAY (NET-A)
Well No. 30 Unit Letter G Section 34 Township 21-S Range 36-E NMPM
Located 1980 Feet From NORTH Line, 1980 Feet From EAST Line
County LEA G. L. Elevation _____ Dedicated Acreage _____ Acres
Name of Producing Formation _____ Pool _____

1. Is the Operator the only owner* in the dedicated acreage outlined on the plat below?
Yes No
2. If the answer to question one is "no," have the interests of all the owners been consolidated by communitization agreement or otherwise? Yes No . If answer is "yes," Type of Consolidation _____
3. If the answer to question two is "no," list all the owners and their respective interests below:

<u>Owner</u>	<u>Land Description</u>

Section B

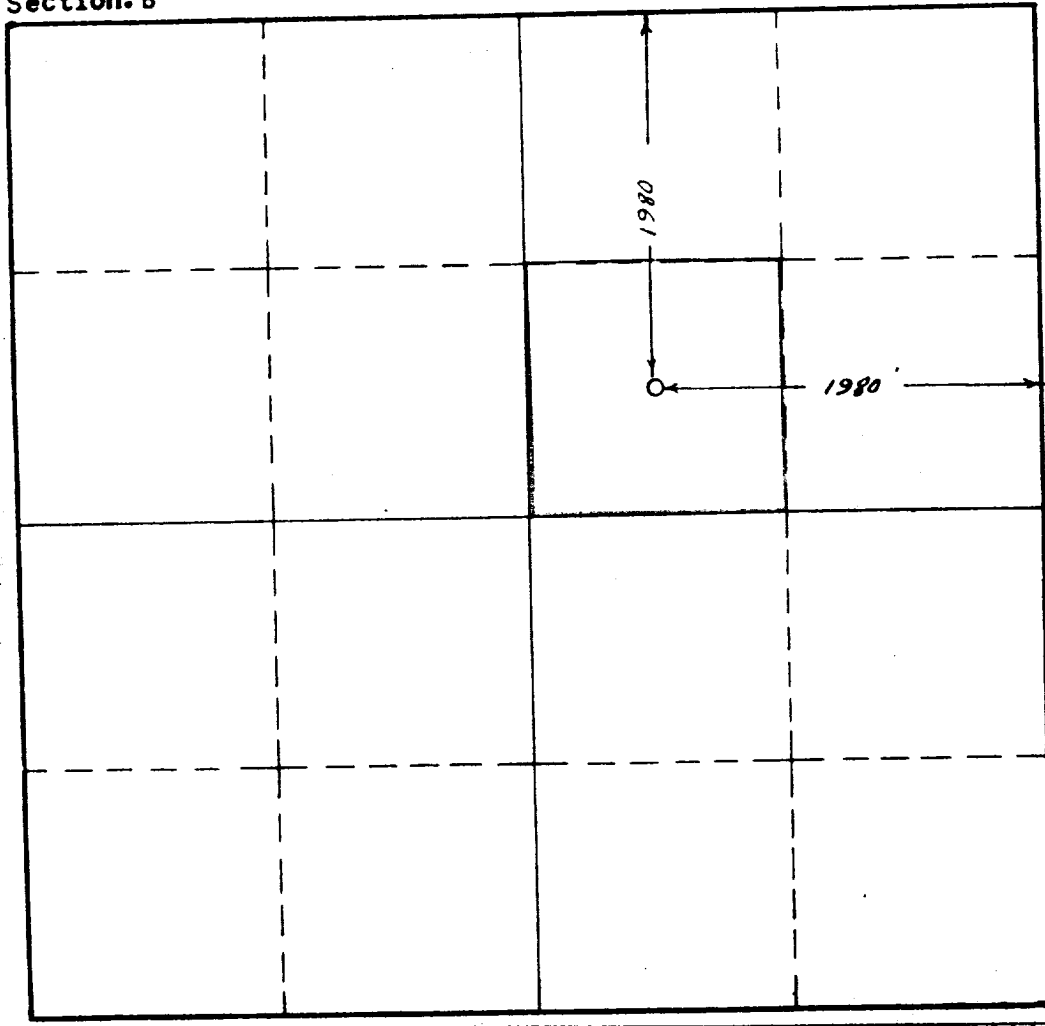

This is to certify that the information in Section A above is true and complete to the best of my knowledge and belief.

Gulf Oil Corporation
(Operator)

B. F. Taylor
(Representative)
Area Supt. of Prod.
Box 2167, Hobbs, New Mexico
Address

This is to certify that the well location shown on the plat in Section B was plotted from field notes of actual surveys made by me or under my supervision and that the same is true and correct to the best of my knowledge and belief.

Date Surveyed 7-19-1957

John A. West
Registered Professional
Engineer and/or Land Surveyor.

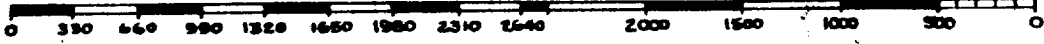

Certificate No. 676

(See instructions for completing this form on the reverse side)