

MEXICO OIL CONSERVATION COMMISSION
WELL LOCATION AND ACREAGE DEDICATION PLAT
 Plug Back

Form C-122
 Supersedes C-128
 Effective 1-1-65

All distances must be from the outer boundaries of the Section.

Operator Grace Petroleum Corporation			Lease Matkins		Well No. 2
Unit Letter 0	Section 15	Township 23-S	Range 36-E	County Lea	
Actual Postage Location of Well: 715 feet from the South line and 1923 feet from the East line					
Ground Level Elev. 3379	Producing Formation Seven Rivers		Pool Jalmat Yates, 7 R	Dedicated Acreage 40 Acres	

1. Outline the acreage dedicated to the subject well by colored pencil or hachure marks on the plat below.
2. If more than one lease is dedicated to the well, outline each and identify the ownership thereof (both as to working interest and royalty).
3. If more than one lease of different ownership is dedicated to the well, have the interests of all owners been consolidated by communitization, unitization, force-pooling, etc?

Yes No If answer is "yes," type of consolidation _____

If answer is "no," list the owners and tract descriptions which have actually been consolidated. (Use reverse side of this form if necessary.) _____
 No allowable will be assigned to the well until all interests have been consolidated (by communitization, unitization, forced-pooling, or otherwise) or until a non-standard unit, eliminating such interests, has been approved by the Commission.

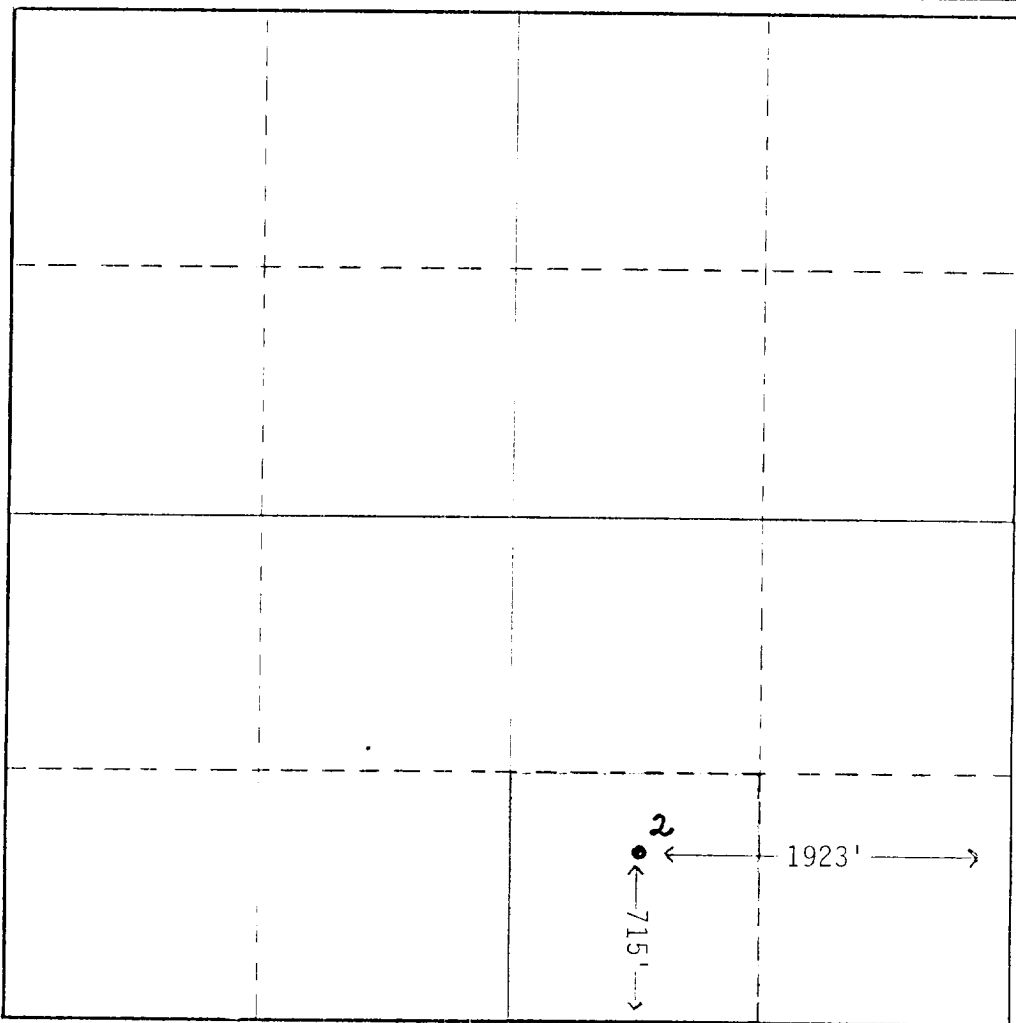

CERTIFICATION
<i>I hereby certify that the information contained herein is true and complete to the best of my knowledge and belief.</i>
<i>Douglas W. Rice</i> Name
Douglas W. Rice Position
Asst. Dist. Prod. Manager Company
Grace Petroleum Corp. Date
9-2-80
<i>I hereby certify that the well location shown on this plat was plotted from field notes of actual surveys made by me or under my supervision, and that the same is true and correct to the best of my knowledge and belief.</i>
Date Surveyed
Registered Professional Engineer and/or Land Surveyor
Certificate No.