

District I
 PO Box 1980, Hobbs, NM 88241-1980
 District II
 PO Drawer DD, Artesia, NM 88211-0719
 District III
 1000 Rio Brazos Rd. Aztec, NM 87410
 District IV
 PO Box 2088, Santa Fe, NM 87504-2088

State of New Mexico
 Energy, Minerals & Natural Resources Department

OIL CONSERVATION DIVISION
 PO Box 2088
 Santa Fe, NM 87504-2088

Form C-1
 Revised February 21, 19
 instructions on ba
 Submit to Appropriate District Offi
 State Lease - 4 Copi
 Fee Lease - 3 Copi
 AMENDED REPORT

WELL LOCATION AND ACREAGE DEDICATION PLAT

API Number 30-025-24170		2 Pool Code 79240		3 Pool Name Jalmat, Tnsl, Yts, 7-Rivers (Pro Gas)	
4 Property Code 24669		5 Property Name State 'A' A/C 1			6 Well Number 112
7 OGRID No. 162791		8 Operator Name Raptor Resources, Inc,			9 Elevation

10 Surface Location

UL or lot no.	Section	Township	Range	Lot Idn	Feet from the	North/South line	Feet from the	East/West line	County
J	21	23S	36E		2210	South	1650	East	Lea

11 Bottom Hole Location If Different From Surface

UL or lot no.	Section	Township	Range	Lot Idn	Feet from the	North/South line	Feet from the	East/West line	County

12 Dedicated Acres 440	13 Joint or Infil	14 Consolidation Code	15 Order No. NSP-1811(L)(SD)
---------------------------	-------------------	-----------------------	---------------------------------

NO ALLOWABLE WILL BE ASSIGNED TO THIS COMPLETION UNTIL ALL INTERESTS HAVE BEEN CONSOLIDATED OR A NON-STANDARD UNIT HAS BEEN APPROVED BY THE DIVISION

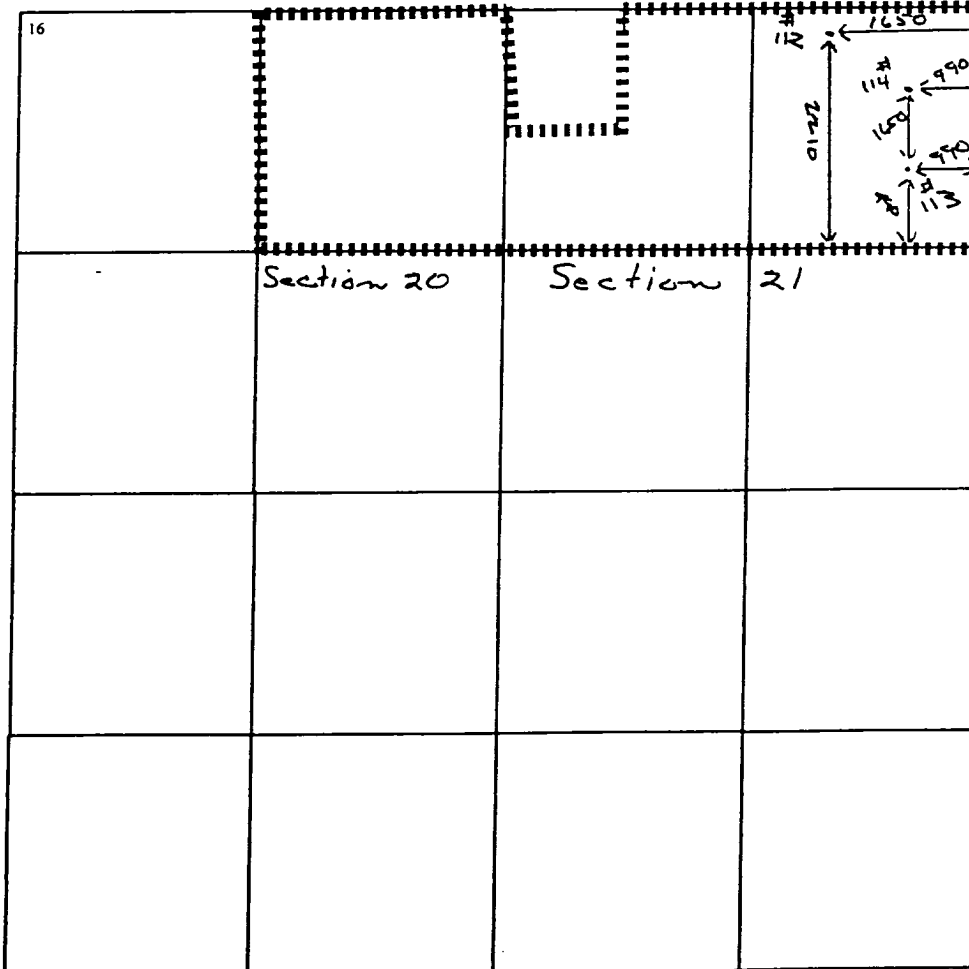

17 OPERATOR CERTIFICATION

I hereby certify that the information contained herein is true and complete to the best of my knowledge and belief

Bill R. Keathly
 Signature
 Bill R. Keathly
 Printed Name
 Regulatory Agent - Raptor
 Title
 12-1-99
 Date

18 SURVEYOR CERTIFICATION

I hereby certify that the well location shown on this plat was plotted from field notes of actual surveys made by me or under my supervision, and that the same is true and correct to the best of my belief.

Date of Survey
 Signature and Seal of Professional Surveyor:

Certificate Number