

District I
PO Box 1980, Hobbs, NM 88241-1980

District II
811 South First, Artesia, NM 88210

District III
1000 Rio Brazos Rd., Aztec, NM 87410

District IV
2040 South Pacheco, Santa Fe, NM 87505

State of New Mexico
Energy, Minerals & Natural Resources Department

Form C-101
Revised October 18, 1994
Instructions on back
Submit to Appropriate District Office
State Lease - 6 Copies
Fee Lease - 5 Copies

OIL CONSERVATION DIVISION
2040 South Pacheco
Santa Fe, NM 87505

AMENDED REPORT

APPLICATION FOR PERMIT TO DRILL, RE-ENTER, DEEPEN, PLUGBACK, OR ADD A ZONE

¹ Operator Name and Address John H. Hendrix Corporation P. O. Box 3040 Midland, TX 79702-3040		² OGRID Number 012024
		³ API Number 30 - 025 - 355 20
⁴ Property Code 25440	⁵ Property Name Paddock Unit	⁶ Well No. 37

⁷Surface Location

UL or lot no.	Section	Township	Range	Lot Idn	Feet from the	North/South line	Feet from the	East/West Line	County
M	3	22S	37E		380	South	530	West	Lea

⁸Proposed Bottom Hole Location If Different From Surface

UL or lot no.	Section	Township	Range	Lot Idn	Feet from the	North/South line	Feet from the	East/West Line	County
⁹ Proposed Pool 1 Paddock					¹⁰ Proposed Pool 2				

¹¹ Work Type Code N	¹² Well Type Code O	¹³ Cable/Rotary R	¹⁴ Lease Type Code P	¹⁵ Ground Level Elevation 3425
¹⁶ Multiple No	¹⁷ Proposed Depth 5350	¹⁸ Formation Paddock	¹⁹ Contractor -	²⁰ Spud Date

²¹Proposed Casing and Cement Program

Hole Size	Casing Size	Casing weight/foot	Setting Depth	Sacks of Cement	Estimated TOC
12-1/4"	8-5/8"	24#/ft.	1130	700 sx.	Surface
7-7/8"	5-1/2"	15.5#/ft.	5350	1100 sx.	Surface

²²Describe the proposed program. If this application is to DEEPEN or PLUG BACK give the data on the present productive zone and proposed new productive zone. Describe the blowout prevention program, if any. Use additional sheets if necessary.

1. Drill 12-1/4" hole and set 8-5/8" casing at 1130' and cement 8-5/8" to surface.
2. Drill 7-7/8" hole to approximately 5350', log, set 5-1/2" casing @ TD and circulate cement to surface.
3. Perf. selected Paddock perms. from log, acidize & frac.

Permit Expires 1 Year From Approval
Date Unless Drilling Underway

²³I hereby certify that the information given above is true and complete to the best of my knowledge and belief.

Signature: *Ronnie H. Westbrook*
 Printed name: Ronnie H. Westbrook
 Title: Vice President

OIL CONSERVATION DIVISION

Approved By: _____
 Title: _____
 Approval Date: _____ Expiration Date: _____

5
3
5

BMP

DISTRICT I
P.O. Box 1980, Hobbs, NM 88241-1980

State of New Mexico
Energy, Minerals and Natural Resources Department

Form C-102
Revised February 10, 1994
Submit to Appropriate District Office
State Lease - 4 Copies
Fee Lease - 3 Copies

DISTRICT II
P.O. Drawer DD, Artesia, NM 88211-0719

OIL CONSERVATION DIVISION

P.O. Box 2088

Santa Fe, New Mexico 87504-2088

DISTRICT III
1000 Rio Brazos Rd., Artec, NM 87410

DISTRICT IV
P.O. BOX 2088, SANTA FE, N.M. 87504-2088

WELL LOCATION AND ACREAGE DEDICATION PLAT

AMENDED REPORT

API Number 30-025-35520	Pool Code 49210	Pool Name Paddock
Property Code 25440	Property Name PADDOCK UNIT	
OGRID No. 012024	Operator Name JOHN H. HENDRIX CORP.	
		Well Number 37
		Elevation 3425'

Surface Location

UL or lot No.	Section	Township	Range	Lot Idn	Feet from the	North/South line	Feet from the	East/West line	County
M	3	22S	37 E		380	SOUTH	530	WEST	LEA

Bottom Hole Location If Different From Surface

UL or lot No.	Section	Township	Range	Lot Idn	Feet from the	North/South line	Feet from the	East/West line	County

Dedicated Acres 40	Joint or Infill	Consolidation Code	Order No.
------------------------------	-----------------	--------------------	-----------

NO ALLOWABLE WILL BE ASSIGNED TO THIS COMPLETION UNTIL ALL INTERESTS HAVE BEEN CONSOLIDATED OR A NON-STANDARD UNIT HAS BEEN APPROVED BY THE DIVISION

LOT 4	LOT 3	LOT 2	LOT 1
38.73 AC	38.74 AC	38.76 AC	38.77 AC

#37
530'
380'

OPERATOR CERTIFICATION

I hereby certify the the information contained herein is true and complete to the best of my knowledge and belief.

Ronnie H. Westbrook

Signature
Ronnie H. Westbrook
Printed Name
Vice President
Title
4/19/01
Date

SURVEYOR CERTIFICATION

I hereby certify that the well location shown on this plat was plotted from field notes of actual surveys made by me or under my supervision, and that the same is true and correct to the best of my belief.

MARCH 23, 2001

Date Surveyed
Signature & Seal of Professional Surveyor
Ronald S. Edson
Professional Surveyor
01-11-0392
Certificate No. **RONALD S. EDSON 3239**
GARY EDSON 12641

VICINITY MAP

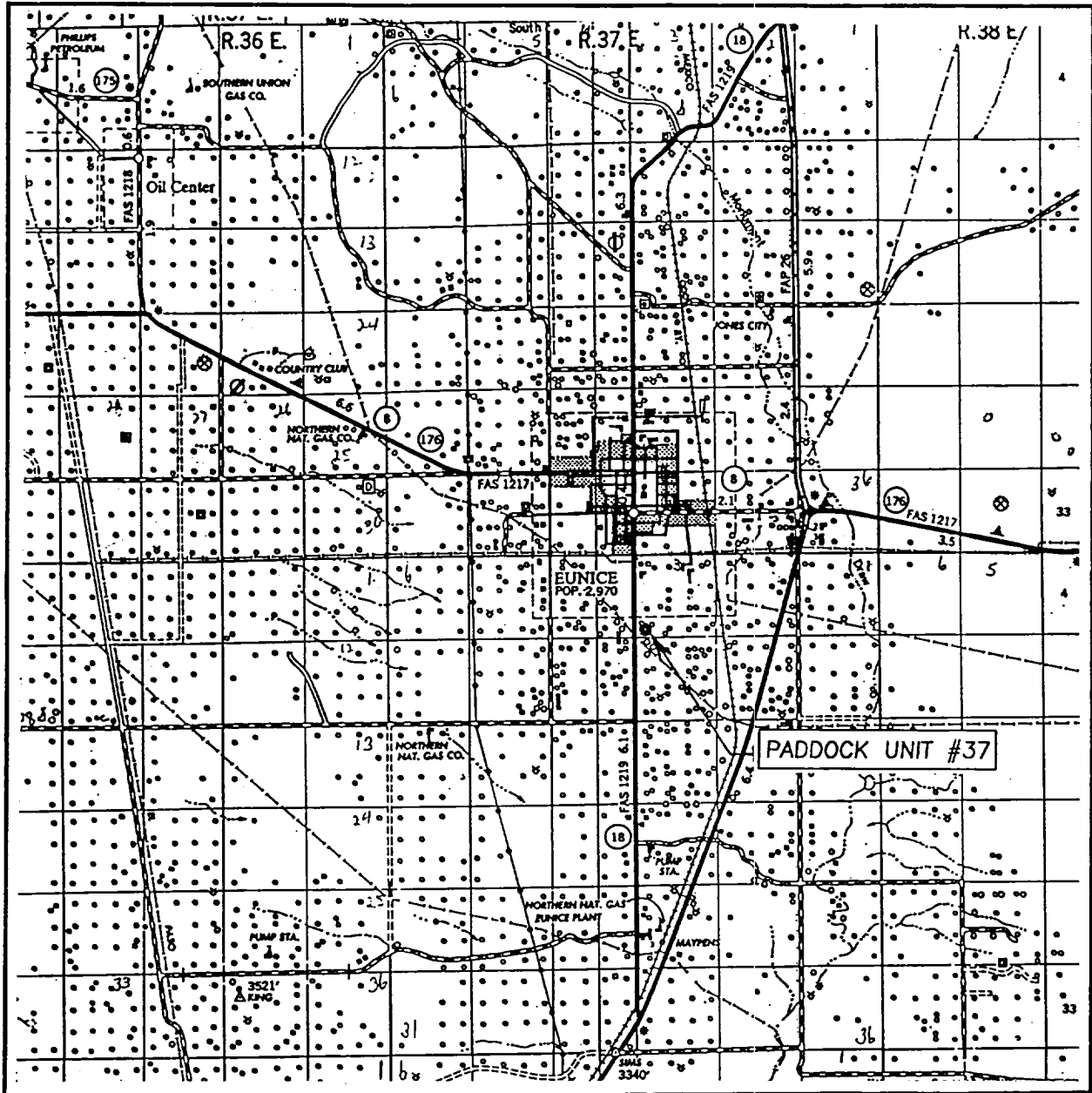

SCALE: 1" = 2 MILES

SEC. 3 TWP. 22-S RGE. 37-E
 SURVEY N.M.P.M.
 COUNTY LEA
 DESCRIPTION 380'FSL & 530'FWL
 ELEVATION 3425'
 OPERATOR JOHN H. HENDRIX CORP.
 LEASE PADDOCK UNIT

JOHN WEST SURVEYING
HOBBS, NEW MEXICO
(505) 393-3117

LOCATION VERIFICATION MAP

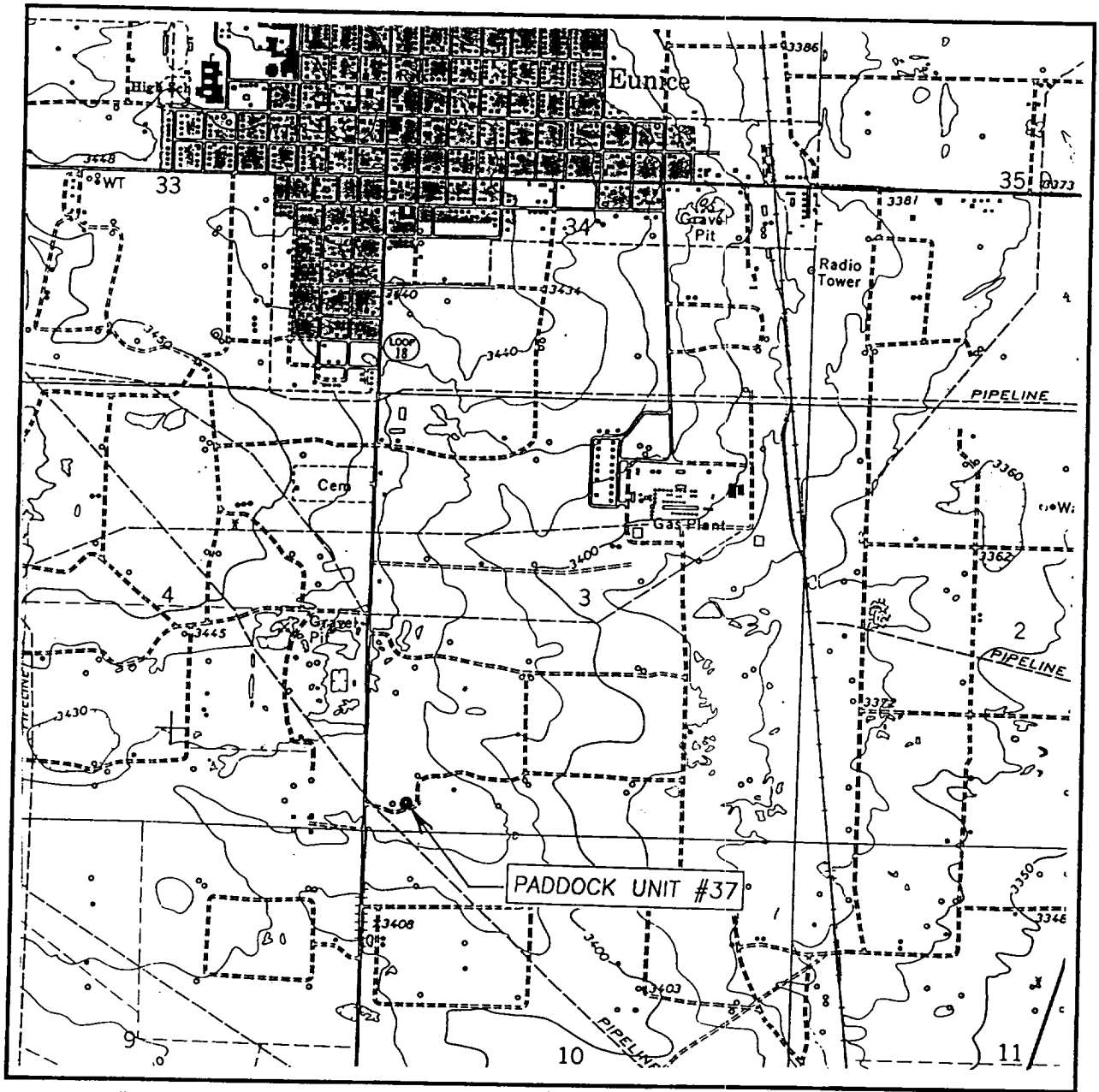

SCALE: 1" = 2000'

CONTOUR INTERVAL: 10'
EUNICE N.M.

SEC. 3 TWP. 22-S RGE. 37-E

SURVEY N.M.P.M.

COUNTY LEA

DESCRIPTION 380'FSL & 530'FWL

ELEVATION 3425'

OPERATOR JOHN H. HENDRIX CORP.

LEASE PADDOCK UNIT

U.S.G.S. TOPOGRAPHIC MAP

EUNICE N.M.

JOHN WEST SURVEYING
HOBBS, NEW MEXICO
(505) 393-3117

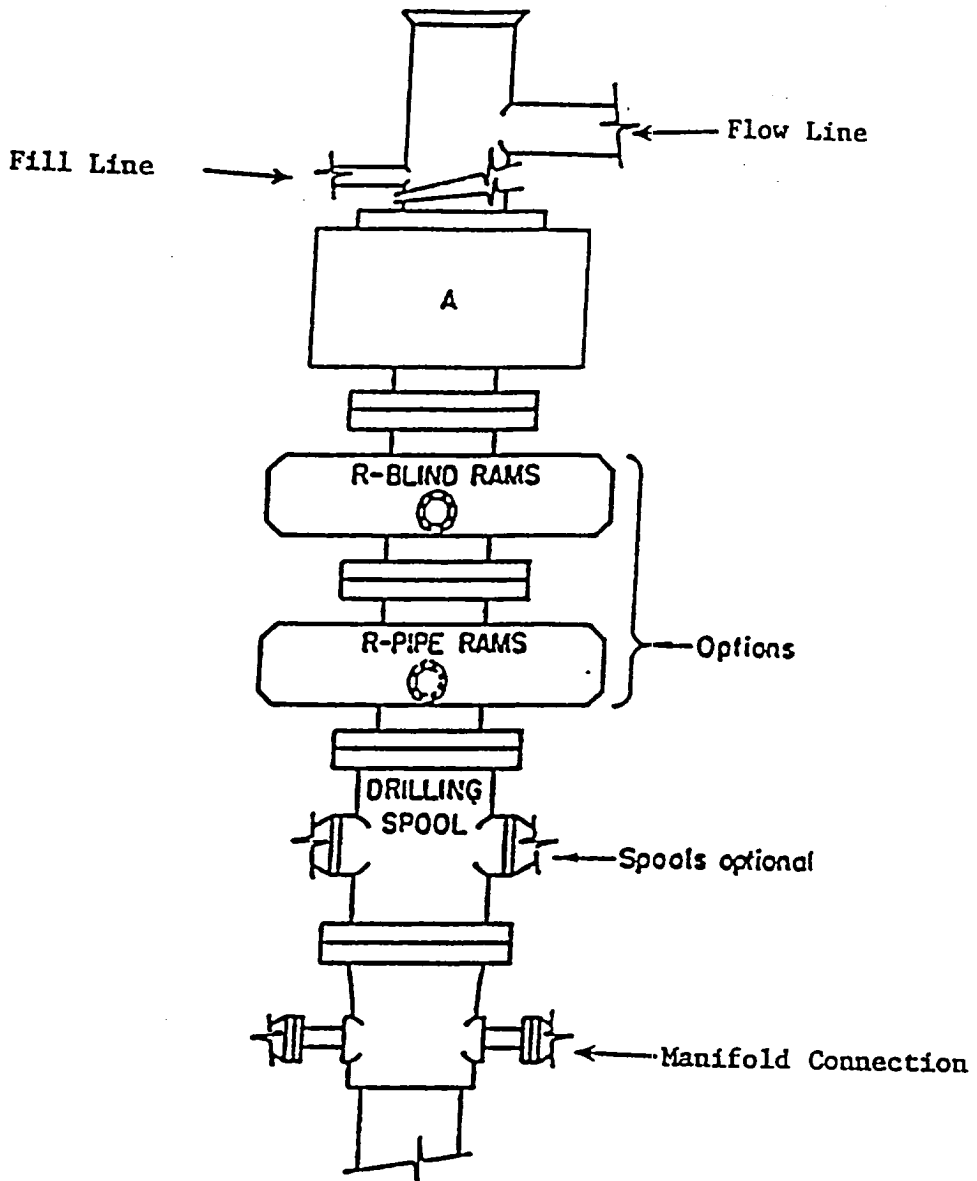

ARRANGEMENT SRRA

900 Series
3000 PSI WP

JOHN H. HENDRIX CORPORATION
 Sketch of BOP
 To Be Used On
 PADDOCK UNIT NO. 37
 380' FSL & 530' FWL
 Sec. 3, T22S - R37E
 Lea County, New Mexico

ABOVE DATE DOES NOT
INDICATE WHEN
CONFIDENTIAL LOGS
WILL BE RELEASED

ELF 11/2/01