

N MEXICO OIL CONSERVATION COMMISSION
WELL LOCATION AND ACREAGE DEDICATION PLAT

Form C-102
Supersedes C-128
Effective 1-1-65

All distances must be from the outer boundaries of the Section.

Operator BTA OIL PRODUCERS		Lease 8706 JV-P MADERA		Well No. I
Unit Letter "E"	Section 27	Township 24-S	Range 34-E	County LEA
Actual Footage Location of Well: 1980 feet from the NORTH line and 660 feet from the WEST line				
Ground Level Elev. 3468	Producing Formation MORROW	Pool PITCHFORK RANCH (MORROW)	Dedicated Acreage: 320 Acres	

1. Outline the acreage dedicated to the subject well by colored pencil or hachure marks on the plat below.
2. If more than one lease is dedicated to the well, outline each and identify the ownership thereof (both as to working interest and royalty). See reverse side
3. If more than one lease of different ownership is dedicated to the well, have the interests of all owners been consolidated by communitization, unitization, force-pooling, etc?

Yes No If answer is "yes," type of consolidation Communitization

If answer is "no," list the owners and tract descriptions which have actually been consolidated. (Use reverse side of this form if necessary.) _____

No allowable will be assigned to the well until all interests have been consolidated (by communitization, unitization, forced-pooling, or otherwise) or until a non-standard unit, eliminating such interests, has been approved by the Commission.

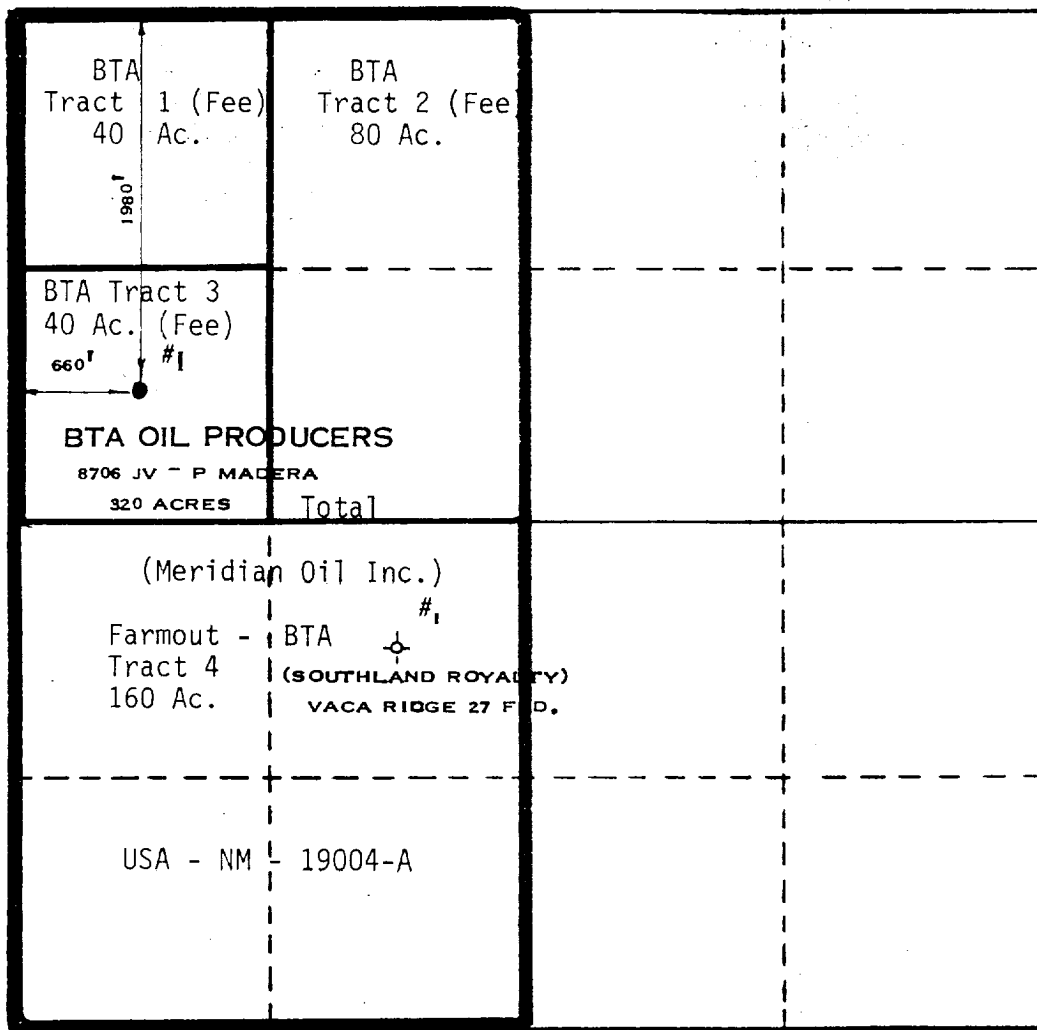

CERTIFICATION

I hereby certify that the information contained herein is true and complete to the best of my knowledge and belief.

Dorothy Houghton
Name

DOROTHY HOUGHTON

Position

Regulatory Supervisor

Company

BTA OIL PRODUCERS

Date

May 1, 1987

I hereby certify that the well location shown on this plat was plotted from field notes of actual surveys made by me or under my supervision, and that the same is true and correct to the best of my knowledge and belief.

Date Surveyed

MAY 1, 1987

Registered Professional Engineer
and/or Land Surveyor

Max A. Schumann
MAX A. SCHUMANN
1510

Certificate No.

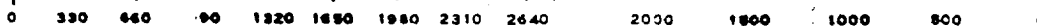

		<u>WORKING INTEREST</u>	<u>Royalty</u>
Tract 1	BTA Oil Producers	100%	14.5833
Tract 2	BTA Oil Producers	100%	25.0000
Tract 3	BTA Oil Producers	66.66%	25.0000
	Frazier & Ray	16.67%	18.7500
	Enron	16.67%	20.0000
Tract 4	Meridian Oil Inc.	100%	
	U.S.A.		12.5000

MAY 5 1987
 HOBBS OFFICE
 OGD

B T A O I L P R O D U C E R S

Field: Pitchfork Ranch (Morrow)

Lease: Madera, 8706 JV-P Well No. 1

Driller's Zero 1 ft Above Rotary Table

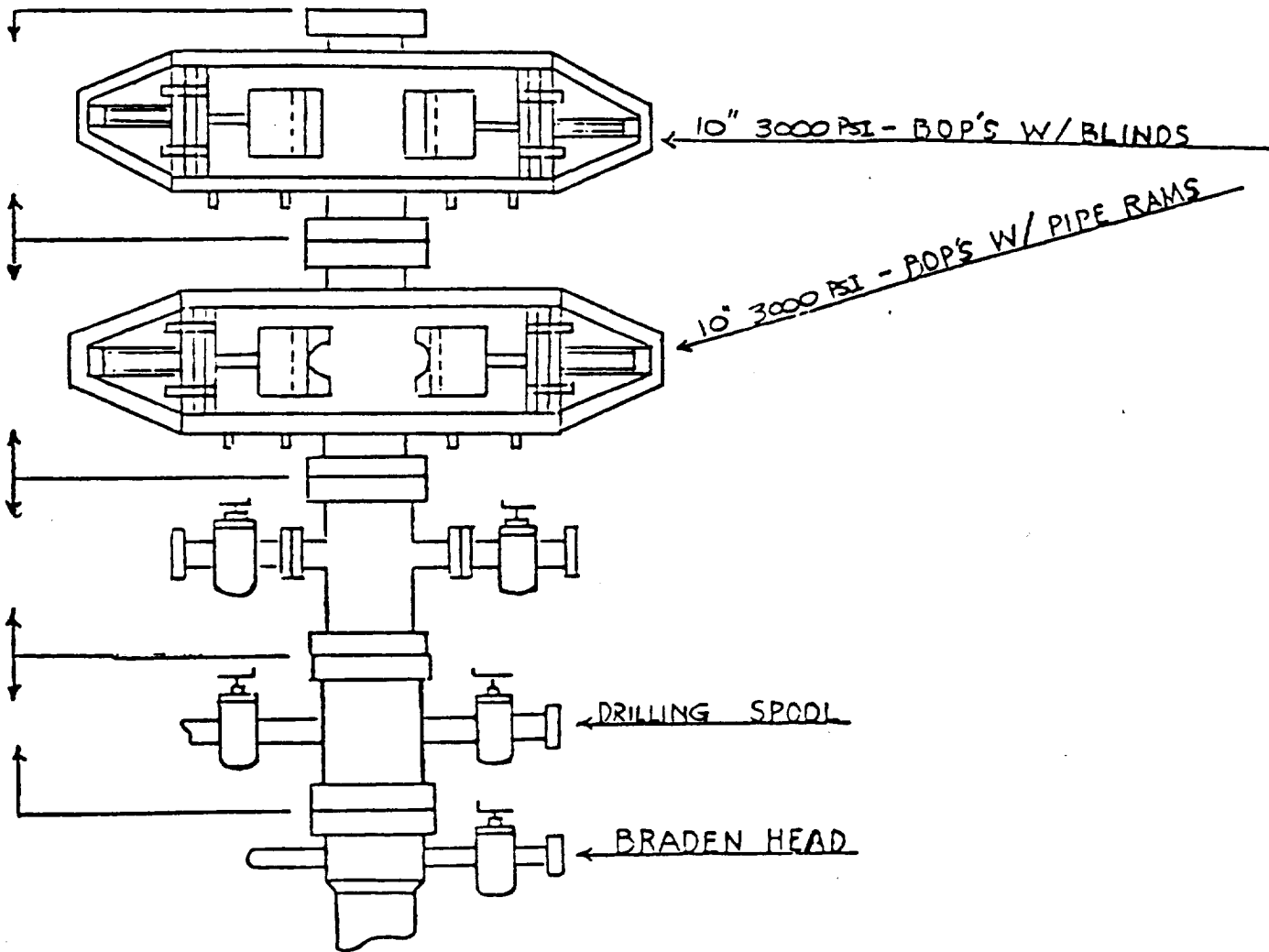

RECEIVED
MAY 5 1981
HOBBS OFFICE
OCCD

1944
MAY 15 1944
RECEIVED
U.S. AIR FORCE
HEADQUARTERS
WASHINGTON, D.C.

LE 1/8 P 225

ETP