

Submit to Appropriate  
 District Office  
 State - 4 copies  
 Fee License - 3 copies

State of New Mexico  
 Energy, Minerals and Natural Resources Department

Form C-102  
 Revised 1-1-80

**OIL CONSERVATION DIVISION**

**DISTRICT I**  
 P.O. Box 1880, Hobbs, NM 88240

P.O. Box 2088

Santa Fe, New Mexico 87504-2088

**DISTRICT II**  
 P.O. Drawer DD, Artesia, NM 88210

**DISTRICT III**  
 1000 E. Brasco Rd., Aztec, NM 87410

**WELL LOCATION AND ACREAGE DEDICATION PLAT**

All Distances must be from the outer boundaries of the section

Operator <b>SAMEDAN OIL CORP.</b>		Lease <b>SARAH "B"</b>		Well No. <b>2</b>	
Unit Letter <b>K</b>	Section <b>12</b>	Township <b>23 SOUTH</b>	Range <b>37 EAST</b>	County <b>NMPM LEA</b>	
Actual Footage Location of Well: <b>2310</b> feet from the <b>SOUTH</b> line and <b>1803</b> feet from the <b>WEST</b> line					
Ground Level Elev. <b>3302.0</b>	Producing Formation <b>Blinebry</b>		Pool <b>Cline</b>	Dedicated Acreage: <b>40</b> Acres	

- Outline the acreage dedicated to the subject well by colored pencil or hachure marks on the plat below.
- If more than one lease is dedicated to the well, outline each and identify the ownership thereof (both as to working interest and royalty).
- If more than one lease of different ownership is dedicated to the well, have the interest of all owners been consolidated by communitization, unitization, forced-pooling, etc.?
 

Yes     No    If answer is 'yes' type of consolidation \_\_\_\_\_

If answer is "no" list of owners and tract descriptions which have actually been consolidated. (Use reverse side of this form necessary.)

No allowable will be assigned to the well unit all interests have been consolidated (by communitization, unitization, forced-pooling, otherwise) or until a non-standard unit, eliminating such interest, has been approved by the Division.

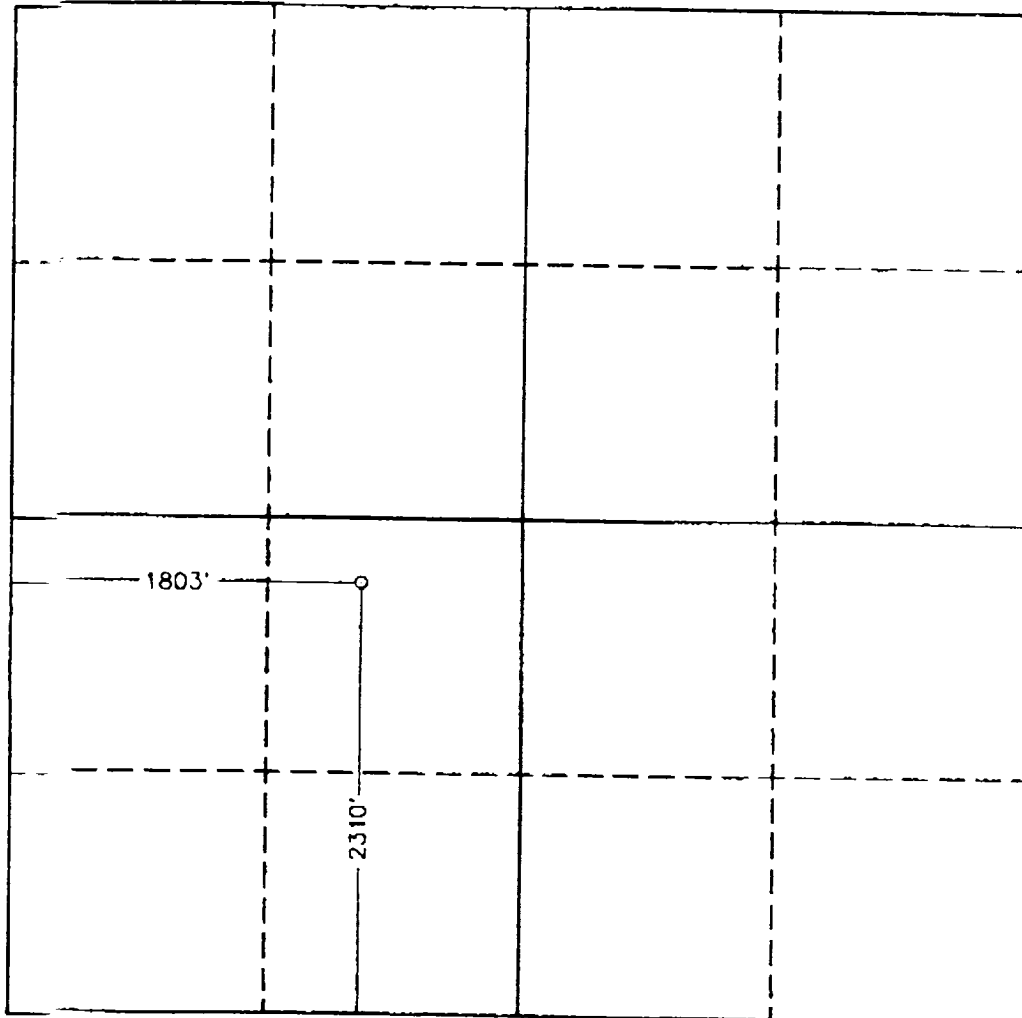

**OPERATOR CERTIFICATION**

I hereby certify the the information contained herein is true and complete to the best of my knowledge and belief.

*Judy Throneberry*  
 Signature  
 Judy Throneberry

Printed Name  
 Division Production Clerk

Position  
 Samedan Oil Corporation

Company

Date

**SURVEYOR CERTIFICATION**

I hereby certify that the well location shown on this plat was plotted from field notes of actual surveys made by me or under my supervision, and that the same is true and correct to the best of my knowledge and belief.

Date Surveyed  
 JUNE 6, 1993

Signature & Seal of  
 Professional Surveyor

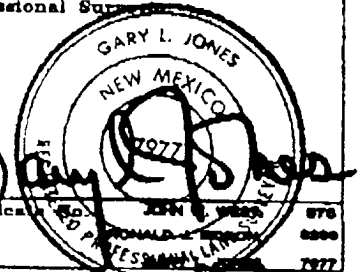

Certification No. **7977**    State of **NEW MEXICO**    No. **7977**  
 Gary L. Jones  
 PROFESSIONAL SURVEYOR