

Submit 3 Copies
to Appropriate
District Office

State of New Mexico
Energy, Minerals and Natural Resources Department

Form C-103
Revised 1-1-89

DISTRICT I
P.O. Box 1980, Hobbs, NM 88240

OIL CONSERVATION DIVISION
P.O. Box 2088
Santa Fe, New Mexico 87504-2088

DISTRICT II
P.O. Drawer DD, Artesia, NM 88210

DISTRICT III
1000 Rio Brazos Rd., Aztec, NM 87410

WELL API NO. 30-025-32373
5. Indicate Type of Lease STATE <input checked="" type="checkbox"/> FEE <input type="checkbox"/>
6. State Oil & Gas Lease No. B-9311
7. Lease Name or Unit Agreement Name WEST DOLLARHIDE DRINKARD UNIT
8. Well No. 145
9. Pool name or Wildcat DOLLARHIDE TUBB DRINKARD
10. Elevation (Show whether DF, RKB, RT, GR, etc.) GR-3172'

SUNDRY NOTICES AND REPORTS ON WELLS
(DO NOT USE THIS FORM FOR PROPOSALS TO DRILL OR TO DEEPEN OR PLUG BACK TO A
DIFFERENT RESERVOIR. USE "APPLICATION FOR PERMIT"
(FORM C-101) FOR SUCH PROPOSALS.)

1. Type of Well: OIL WELL <input checked="" type="checkbox"/> GAS WELL <input type="checkbox"/> OTHER <input type="checkbox"/>
2. Name of Operator TEXACO EXPLORATION AND PRODUCTION INC.
3. Address of Operator P. O. Box 3109 Midland, Texas 79702
4. Well Location Unit Letter <u>K</u> : <u>2589</u> Feet From The <u>SOUTH</u> Line and <u>2060</u> Feet From The <u>WEST</u> Line Section <u>32</u> Township <u>24-SOUTH</u> Range <u>38-EAST</u> NMPM LEA County
10. Elevation (Show whether DF, RKB, RT, GR, etc.) GR-3172'

11. Check Appropriate Box to Indicate Nature of Notice, Report, or Other Data

NOTICE OF INTENTION TO:	SUBSEQUENT REPORT OF:
PERFORM REMEDIAL WORK <input type="checkbox"/>	REMEDIAL WORK <input type="checkbox"/>
TEMPORARILY ABANDON <input type="checkbox"/>	ALTERING CASING <input type="checkbox"/>
PULL OR ALTER CASING <input type="checkbox"/>	COMMENCE DRILLING OPNS. <input type="checkbox"/>
OTHER: <u>MOVED LOCATION</u> <input checked="" type="checkbox"/>	PLUG AND ABANDONMENT <input type="checkbox"/>
	CASING TEST AND CEMENT JOB <input type="checkbox"/>
	OTHER: _____ <input type="checkbox"/>

12. Describe Proposed or Completed Operations (Clearly state all pertinent details, and give pertinent dates, including estimated date of starting any proposed work) SEE RULE 1103.

CHANGE OF LOCATION: OLD LOCATION - 2539' FSL & 2060' FWL
"NEW LOCATION - 2589' FSL & 2060' FWL
LOCATION WAS MOVED 50' NORTH BECAUSE OF A FLOWLINE. AN AMENDED LOCATION UNDER ORDER NO. NSL-3338 HAS BEEN REQUESTED IN SANTA FE. (COPY ATTACHED).
ATTACHED IS THE REVISED FORM C-102.

I hereby certify that the information above is true and complete to the best of my knowledge and belief.
SIGNATURE C.P. Basham /cwh TITLE DRILLING OPERATIONS MANAGER DATE 02-10-94
TYPE OR PRINT NAME C. P. BASHAM TELEPHONE NO. 915-6884620

Orig. Signed by
Paul Kautz
Geologist

APPROVED BY _____ TITLE _____ DATE _____
CONDITIONS OF APPROVAL, IF ANY:

FEB 10 1994

Submit to Appropriate
District Office
State Lease - 4 copies
Fee Lease - 3 copies

OIL CONSERVATION DIVISION
P.O. Box 2088
Santa Fe, New Mexico 87504-2088

DISTRICT I
P.O. Box 1900, Hobbs, NM 88240

DISTRICT II
P.O. Drawer DD, Artesia, NM 88210

DISTRICT III
1000 Rio Arriba Rd., Aztec, NM 87410

WELL LOCATION AND ACREAGE DEDICATION PLAT
All Distances must be from the outer boundaries of the section

Operator TEXACO EXPLORATION & PRODUCTION		Lease WEST DOLLARHIDE DRINKARD UNIT		Well No. 145
Unit Letter K	Section 32	Township 24 SOUTH	Range 38 EAST	County LEA
Actual Footage Location of Well: 2589 feet from the SOUTH line and 2060 feet from the WEST line				
Ground level Elev. 3172'		Producing Formation (ABO &) TUBB DRINKARD(DRINKARD)		Foot DOLLARHIDE TUBB DRINKARD
				Dedicated Acreage: 40 Acres

- Outline the acreage dedicated to the subject well by colored pencil or lockess marks on the plat below.
- If more than one lease is dedicated to the well, outline each and identify the ownership thereof (both as to working interest and royalty).
- If more than one lease of different ownership is dedicated to the well, have the interest of all owners been consolidated by communitization, unitization, force-pooling, etc.?
 Yes No If answer is "yes" type of consolidation UNITIZATION
 If answer is "no" list the owners and tract descriptions which have actually been consolidated. (Use reverse side of this form if necessary.)
 No allowable will be assigned to the well until all interests have been consolidated (by communitization, unitization, forced-pooling, or otherwise) or until a non-standard unit, eliminating such interest, has been approved by the Division.

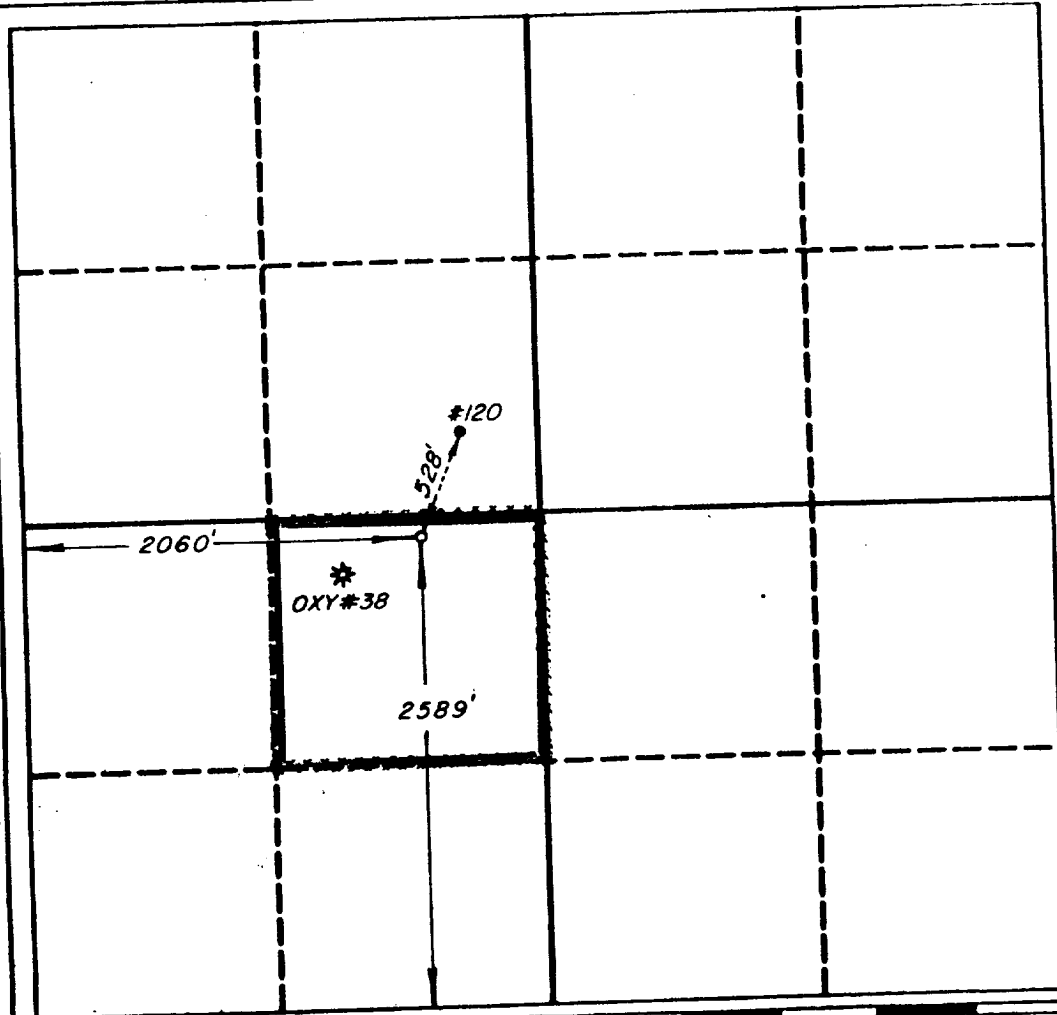

OPERATOR CERTIFICATION

I hereby certify that the information contained herein is true and complete to the best of my knowledge and belief.

Signature: *R.D. Mariott*
 Printed Name: **R. D. MARIOTT**
 Position: **DIVISION SURVEYOR**
 Company: **TEXACO E & P**
 Date: **FEBRUARY 8, 1994**

SURVEYOR CERTIFICATION

I hereby certify that the well location shown on this plat was plotted from field notes of actual surveys made by me or under my supervision, and that the same is true and correct to the best of my knowledge and belief.

Date Surveyed: **FEBRUARY 8, 1994**
 Signature & Seal of Professional Surveyor: *[Signature]*
 Certificate No.: **4882**



Texaco Exploration and Production Inc
Midland Producing Division

500 N Loraine
Midland TX 79701

P O Box 3109
Midland TX 79702

February 10, 1994

GOV - STATE AND LOCAL GOVERNMENTS

Unorthodox Locations
West Dollarhide Drinkard Unit
Well No. 145
Lea County, New Mexico

State of New Mexico
Energy and Minerals Department
Oil Conservation Division
P. O. Box 2088
Santa Fe, New Mexico 87501-2088

Attention: Mr. Michael E. Stogner

Gentlemen:

Texaco Exploration and Production Inc. respectfully submits, for administrative approval, an amended drilling location for the captioned well under Order No. NSL-3338.

Well No. 145 was moved 50' north because of a buried flowline.

Attached is Form C-102 showing the amended location for the well. Please note that there are no affected operators to this location.

Yours very truly,

C. P. Basham / cwh

C. P. Basham
Drilling Operations Manager

CWH:cwh

cc:NMOC, P. O. Box 1980, Hobbs, NM 88240