

NSL Initial Application

Received: 01/11/21

RECEIVED: 01/11/21	REVIEWER: LRL	TYPE: NSL	APP NO: pLEL2101173006
---------------------------	----------------------	------------------	-------------------------------

ABOVE THIS TABLE FOR OCD DIVISION USE ONLY

NEW MEXICO OIL CONSERVATION DIVISION
- Geological & Engineering Bureau -
1220 South St. Francis Drive, Santa Fe, NM 87505



ADMINISTRATIVE APPLICATION CHECKLIST

THIS CHECKLIST IS MANDATORY FOR ALL ADMINISTRATIVE APPLICATIONS FOR EXCEPTIONS TO DIVISION RULES AND REGULATIONS WHICH REQUIRE PROCESSING AT THE DIVISION LEVEL IN SANTA FE

Applicant: Spur Energy Partners LLC **OGRID Number:** 328947
Well Name: Morris Boyd 11H **API:** 30-015-
Pool: N. Seven Rivers; Glorieta-Yeso **Pool Code:** 97565

SUBMIT ACCURATE AND COMPLETE INFORMATION REQUIRED TO PROCESS THE TYPE OF APPLICATION INDICATED BELOW

- 1) **TYPE OF APPLICATION:** Check those which apply for [A]
- A. Location – Spacing Unit – Simultaneous Dedication
☒ NSL ☐ NSP (PROJECT AREA) ☐ NSP (PRORATION UNIT) ☐ SD
- B. Check one only for [I] or [II]
- [I] Commingling – Storage – Measurement
☐ DHC ☐ CTB ☐ PLC ☐ PC ☐ OLS ☐ OLM
- [II] Injection – Disposal – Pressure Increase – Enhanced Oil Recovery
☐ WFX ☐ PMX ☐ SWD ☐ IPI ☐ EOR ☐ PPR
- 2) **NOTIFICATION REQUIRED TO:** Check those which apply.
- A. ☒ Offset operators or lease holders
 B. ☐ Royalty, overriding royalty owners, revenue owners
 C. ☐ Application requires published notice
 D. ☒ Notification and/or concurrent approval by SLO
 E. ☐ Notification and/or concurrent approval by BLM
 F. ☐ Surface owner
 G. ☐ For all of the above, proof of notification or publication is attached, and/or,
 H. ☐ No notice required

FOR OCD ONLY

- ☐ Notice Complete
☐ Application Content Complete

- 3) **CERTIFICATION:** I hereby certify that the information submitted with this application for administrative approval is **accurate** and **complete** to the best of my knowledge. I also understand that **no action** will be taken on this application until the required information and notifications are submitted to the Division.

Note: Statement must be completed by an individual with managerial and/or supervisory capacity.

Sarah Chapman

Print or Type Name

Signature

Sarah Chapman

01/11/2021

Date

832-830-8613

Phone Number

schapman@spurepllc.com

e-mail Address



January 11, 2021

New Mexico Oil Conservation Division
1220 South St. Francis Dr.
Santa Fe, NM 87505

Attention: Leonard Lowe

RE: ***Application for Administrative Approval of Non- Standard Location
Morris Boyd 11H – N. Seven Rivers; Glorieta-Yeso (97565)
Surface Hole – 943' FSL 882' FEL Unit P Sec 23 T19S R25E
First Take Point – 100' FNL 1260' FEL Unit A Sec 26 T19S R25E
Last Take Point – 100' FSL 1260' FEL Unit P Sec 26 T19S R25E
Bottom Hole – 50' FSL 1260' FEL Unit P Sec 26 T19S R25E
Eddy County, New Mexico***

Dear Mr. Lowe:

Spur Energy Partners LLC respectfully requests administrative approval of a non-standard location on the Morris Boyd 11H, API Number 30-015-Pending, Property Code Pending. The 11H well is proposed to be completed in the N. Seven Rivers; Glorieta-Yeso pool, Pool Code 97565. The proposed wellbore is to be completed within 330' feet of the W/2 of the W/2 of Section 26. The proposed interval is projected as follows:

Surface Hole – 943' FSL 882' FEL Unit P Sec 23 T19S R25E
First Take Point – 100' FNL 1260' FEL Unit A Sec 26 T19S R25E
Last Take Point – 100' FSL 1260' FEL Unit P Sec 26 T19S R25E
Bottom Hole – 50' FSL 1260' FEL Unit P Sec 26 T19S R25E

The adjoining units which the unorthodox location encroaches are located in T19S R25E, Section 26, Units B, G, J and O.

Approval of the unorthodox completed interval will allow for efficient spacing of horizontal wells and thereby prevent waste.

To support this request, the following information has been submitted for your review:

1. Application Checklist
2. C-102 Plat for proposed well and an additional plat with offsetting affected units
3. List of affected parties in each of the units in the same pool located closer to the unorthodox well location that the minimum distance prescribed by rule or order, copies of the sign certified return copies will be furnished upon request
4. Statement from Spur landman certifying Spur is 100% Working Interest in Unit, B, G, J and O of Section 26

If you need any additional information, please call me at 832-930-8613.

Sincerely,

Sarah Chapman

Regulatory Director

Attachments
CC: Service List

District I
1625 N. French Dr., Hobbs, NM 88240
Phone: (575) 393-6161 Fax: (575) 393-0720
District II
811 S. First St., Artesia, NM 88210
Phone: (575) 748-1283 Fax: (575) 748-9720
District III
1000 Rio Brazos Road, Aztec, NM 87410
Phone: (505) 334-6178 Fax: (505) 334-6170
District IV
1220 S. St. Francis Dr., Santa Fe, NM 87505
Phone: (505) 476-3460 Fax: (505) 476-3462

State of New Mexico
Energy, Minerals & Natural Resources Department
OIL CONSERVATION DIVISION
1220 South St. Francis Dr.
Santa Fe, NM 87505

Form C-102
Revised August 1, 2011
Submit one copy to appropriate
District Office

☐ AMENDED REPORT

WELL LOCATION AND ACREAGE DEDICATION PLAT

¹ API Number 30-015-	² Pool Code 97565	³ Pool Name N. SEVEN RIVERS; GLORIETA-YESO
⁴ Property Code	⁵ Property Name MORRIS BOYD	⁶ Well Number 11H
⁷ OGRID NO. 328947	⁸ Operator Name SPUR ENERGY PARTNERS LLC.	⁹ Elevation 3421'

¹⁰ Surface Location

UL or lot no.	Section	Township	Range	Lot Idn	Feet from the	North/South line	Feet From the	East/West line	County
P	23	19S	25E		943	SOUTH	882	EAST	EDDY

¹¹ Bottom Hole Location If Different From Surface

UL or lot no.	Section	Township	Range	Lot Idn	Feet from the	North/South line	Feet from the	East/West line	County
P	26	19S	25E		50	SOUTH	1260	EAST	EDDY
¹² Dedicated Acres 160	¹³ Joint or Infill	¹⁴ Consolidation Code	¹⁵ Order No.						

No allowable will be assigned to this completion until all interest have been consolidated or a non-standard unit has been approved by the division.

	<p>GEODETIC DATA NAD 83 GRID - NM EAST</p> <p>SURFACE LOCATION (SL) N: 597165.7 - E: 505529.9 LAT: 32.6416031° N LONG: 104.4496634° W</p> <p>LAST TAKE POINT (LTP) 100' FSL SEC 26 1260' FEL SEC 26 N: 590959.4 - E: 505126.5 LAT: 32.6245424° N LONG: 104.4509518° W</p> <p>FIRST TAKE POINT (FTP) 100' FNL SEC 26 1260' FEL SEC 26 N: 596111.8 - E: 505134.3 LAT: 32.6387050° N LONG: 104.4509450° W</p> <p>BOTTOM HOLE (BH) N: 590909.4 - E: 505126.4 LAT: 32.6244050° N LONG: 104.4509519° W</p> <p>CORNER DATA NAD 83 GRID - NM EAST</p> <p>A: FOUND 1/2" REBAR N 590847.7 - E 501100.1</p> <p>B: FOUND 1/2" REBAR N 596091.2 - E 501054.3</p> <p>C: FOUND 60D NAIL N 601603.9 - E 501084.3</p> <p>D: FOUND SPIKE NAIL N 601581.4 - E 503829.7</p> <p>E: FOUND 1/2" REBAR N 601583.0 - E 506491.4</p> <p>F: FOUND 5/8" REBAR N 596249.0 - E 506393.5</p> <p>G: FOUND 1/2" REBAR W/YPC "PS 12641" N 593556.0 - E 506389.9</p> <p>H: FOUND 1/2" REBAR W/YPC "PS 12641" N 590863.1 - E 506386.0</p>	<p>¹⁷ OPERATOR CERTIFICATION I hereby certify that the information contained herein is true and complete to the best of my knowledge and belief, and that this organization either owns a working interest or unleased mineral interest in the land including the proposed bottom hole location or has a right to drill this well at this location pursuant to a contract with an owner of such a mineral or working interest, or to a voluntary pooling agreement or a compulsory pooling order heretofore entered by the division.</p> <p><i>Sarah Chapman</i> 01/11/2021 Signature Date SARAH CHAPMAN Printed Name SCHAPMAN@SPUREPLLC.COM E-mail Address</p> <p>¹⁸ SURVEYOR CERTIFICATION I hereby certify that the well location shown on this plat was plotted from field notes of actual surveys made by me or under my supervision, and that the same is true and correct to the best of my belief.</p> <p>11-30-20 Date of Survey Signature and Seal of Professional Surveyor 19680 Certificate Number</p>
--	---	---

Job No.: LS20110722

Intent ☒ As Drilled ☐

API # 30-015-		
Operator Name: SPUR ENERGY PARTNERS LLC	Property Name: MORRIS BOYD	Well Number 11H

Kick Off Point (KOP)

UL	Section	Township	Range	Lot	Feet	From N/S	Feet	From E/W	County
Latitude					Longitude				NAD

First Take Point (FTP)

UL A	Section 26	Township 19S	Range 25E	Lot	Feet 100	From N/S NORTH	Feet 1260	From E/W EAST	County EDDY
Latitude 32.6387050					Longitude -104.4509450				NAD NAD83

Last Take Point (LTP)

UL P	Section 26	Township 19S	Range 25E	Lot	Feet 100	From N/S SOUTH	Feet 1260	From E/W EAST	County EDDY
Latitude 32.6245424					Longitude -104.4509518				NAD NAD83

Is this well the defining well for the Horizontal Spacing Unit? ☐Is this well an infill well? ☐

If infill is yes please provide API if available, Operator Name and well number for Defining well for Horizontal Spacing Unit.

API #		
Operator Name:	Property Name:	Well Number

KZ 06/29/2018

Spur Energy Partners LLC
Morris Boyd 11H
Section 23 Township 19 South Range 25 East
Eddy County, New Mexico

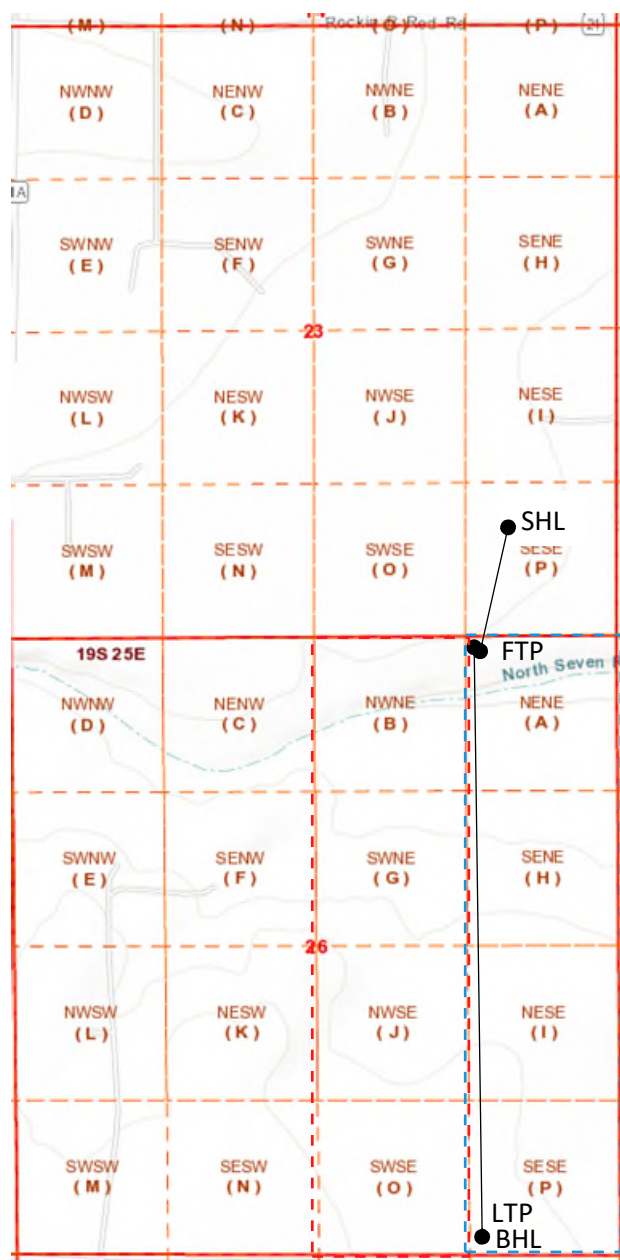

Red Outline – Affected Tracts

Blue Outline – Horizontal Spacing Unit

Application of Non-Standard Location - Service List
Spur Energy Partners LLC
Morris Boyd 11H

New Mexico Oil Conservation Division
811 S. First St.
Artesia, NM 88210
9414 8118 9876 5892 2493 64

New Mexico Oil Conservation Division
1220 South St. Francis Dr.
Santa Fe, NM 87505
Uploaded online

New Mexico State Land Office
310 Old Santa Fe Trail
Santa Fe. NM 87501
9414 8118 9876 5892 2494 18

T19S R25E
Section 26 - Units B, G, J and O
SEP Permain LLC is an affiliate of Spur Energy Partners LLC and is 100% Working Interest (letter from Spur Landman is attached)

SEP Permian LLC
9655 Katy Freeway, Suite 500
Houston, TX 77024

Copies of the application were mailed to the above individuals, companies and organizations on January 11, 2021



Spur Energy Partners LLC



January 5, 2021

**RE: Morris Boyd 11H
Section 26, T19S, R25E, Eddy County**

To Whom It May Concern:

SEP Permian LLC, an affiliate of Spur Energy Partners LLC, is the sole Working Interest Owner of Units B, G, J and O in Section 26, T19S, R25E, Eddy County, New Mexico as to depths from the top of the Yeso Formation to the base of the Yeso Formation.

Should you have any questions, please contact me at the email address below.

Regards,

A handwritten signature in blue ink that reads "Megan Peña".

Megan Peña
Sr. Landman
mpena@spurepllc.com

District I
1625 N. French Dr., Hobbs, NM 88240
Phone:(575) 393-6161 Fax:(575) 393-0720
District II
811 S. First St., Artesia, NM 88210
Phone:(575) 748-1283 Fax:(575) 748-9720
District III
1000 Rio Brazos Rd., Aztec, NM 87410
Phone:(505) 334-6178 Fax:(505) 334-6170
District IV
1220 S. St Francis Dr., Santa Fe, NM 87505
Phone:(505) 476-3470 Fax:(505) 476-3462

State of New Mexico
Energy, Minerals and Natural Resources
Oil Conservation Division
1220 S. St Francis Dr.
Santa Fe, NM 87505

CONDITIONS

Action 14408

CONDITIONS OF APPROVAL

Operator: SPUR ENERGY PARTNERS LLC Suite 500 Houston, TX77024	9655 Katy Freeway	OGRID: 328947	Action Number: 14408	Action Type: NSL
OCD Reviewer llowe	Condition None			