

DATE IN	SUSPENSE	ENGINEER	LOGGED IN	TYPE	APP NO.
---------	----------	----------	-----------	------	---------

ABOVE THIS LINE FOR DIVISION USE ONLY

NEW MEXICO OIL CONSERVATION DIVISION

- Engineering Bureau -

1220 South St. Francis Drive, Santa Fe, NM 87505



ADMINISTRATIVE APPLICATION CHECKLIST

THIS CHECKLIST IS MANDATORY FOR ALL ADMINISTRATIVE APPLICATIONS FOR EXCEPTIONS TO DIVISION RULES AND REGULATIONS
WHICH REQUIRE PROCESSING AT THE DIVISION LEVEL IN SANTA FE

Application Acronyms:

[NSL-Non-Standard Location] [NSP-Non-Standard Proration Unit] [SD-Simultaneous Dedication]
[DHC-Downhole Commingling] [CTB-Lease Commingling] [PLC-Pool/Lease Commingling]
[PC-Pool Commingling] [OLS - Off-Lease Storage] [OLM-Off-Lease Measurement]
[WFX-Waterflood Expansion] [PMX-Pressure Maintenance Expansion]
[SWD-Salt Water Disposal] [IPI-Injection Pressure Increase]
[EOR-Qualified Enhanced Oil Recovery Certification] [PPR-Positive Production Response]

[1] TYPE OF APPLICATION - Check Those Which Apply for [A]

[A] Location - Spacing Unit - Simultaneous Dedication
☐ NSL ☐ NSP ☐ SD

Check One Only for [B] or [C]

[B] Commingling - Storage - Measurement
☐ DHC ☒ CTB ☐ PLC ☐ PC ☒ OLS ☒ OLM

[C] Injection - Disposal - Pressure Increase - Enhanced Oil Recovery
☐ WFX ☐ PMX ☐ SWD ☐ IPI ☐ EOR ☐ PPR

[D] Other: Specify _____

[2] NOTIFICATION REQUIRED TO: - Check Those Which Apply, or Does Not Apply

[A] ☒ Working, Royalty or Overriding Royalty Interest Owners

[B] ☐ Offset Operators, Leaseholders or Surface Owner

[C] ☐ Application is One Which Requires Published Legal Notice

[D] ☒ Notification and/or Concurrent Approval by BLM or SLO
U.S. Bureau of Land Management - Commissioner of Public Lands, State Land Office

[E] ☐ For all of the above, Proof of Notification or Publication is Attached, and/or,

[F] ☐ Waivers are Attached

[3] SUBMIT ACCURATE AND COMPLETE INFORMATION REQUIRED TO PROCESS THE TYPE OF APPLICATION INDICATED ABOVE.

[4] CERTIFICATION: I hereby certify that the information submitted with this application for administrative approval is **accurate** and **complete** to the best of my knowledge. I also understand that **no action** will be taken on this application until the required information and notifications are submitted to the Division.

Note: Statement must be completed by an individual with managerial and/or supervisory capacity.

David Schellstede

Print or Type Name

Signature

Title

Date

david@fenergyus.com
e-mail Address

District I
1625 N. French Drive, Hobbs, NM 88240
District II
811 S. First St., Artesia, NM 88210
District III
1000 Rio Brazos Road, Aztec, NM 87410
District IV
1220 S. St Francis Dr, Santa Fe, NM
87505

State of New Mexico
Energy, Minerals and Natural Resources Department

Form C-107-B
Revised August 1, 2011

OIL CONSERVATION DIVISION

1220 S. St Francis Drive
Santa Fe, New Mexico 87505

Submit the original
application to the Santa Fe
office with one copy to the
appropriate District Office.

APPLICATION FOR SURFACE COMMINGLING (DIVERSE OWNERSHIP)

OPERATOR NAME: FAE II Operating, LLC

OPERATOR ADDRESS: 11757 Katy Fwy, Ste. 1000, Houston, TX 77079

APPLICATION TYPE:

☐ Pool Commingling ☐ Lease Commingling ☒ Pool and Lease Commingling ☐ Off-Lease Storage and Measurement (Only if not Surface Commingled)

LEASE TYPE: ☐ Fee ☐ State ☒ Federal

Is this an Amendment to existing Order? ☐ Yes ☒ No If "Yes", please include the appropriate Order No. _____
Have the Bureau of Land Management (BLM) and State Land office (SLO) been notified in writing of the proposed commingling
☒ Yes ☐ No

(A) POOL COMMINGLING Please attach sheets with the following information

(1) Pool Names and Codes	Gravities / BTU of Non-Commingled Production	Calculated Gravities / BTU of Commingled Production	\$/Mcf	Calculated Value of Commingled Production	Volumes MCF/Month
33820 JALMAT; TAN- YATES - 7 RVRS (OIL)	1.406	1.373	1.2	\$495/Month	724
79240 JALMAT; TAN- YATES - 7 RVRS (GAS)	1.133		1.2	\$990/Month	101

- (2) Are any wells producing at top allowables? ☐ Yes ☒ No
(3) Has all interest owners been notified by certified mail of the proposed commingling? ☒ Yes ☐ No.
(4) Measurement type: ☒ Metering ☐ Other (Specify)
(5) Will commingling decrease the value of production? ☐ Yes ☒ No If "yes", describe why commingling should be approved

(B) LEASE COMMINGLING Please attach sheets with the following information

- (1) Pool Name and Code.
(2) Is all production from same source of supply? ☐ Yes ☐ No
(3) Has all interest owners been notified by certified mail of the proposed commingling? ☐ Yes ☐ No
(4) Measurement type: ☐ Metering ☐ Other (Specify)

(C) POOL and LEASE COMMINGLING Please attach sheets with the following information

- (1) Complete Sections A and E.

(D) OFF-LEASE STORAGE and MEASUREMENT Please attached sheets with the following information

- (1) Is all production from same source of supply? ☒ Yes ☐ No
(2) Include proof of notice to all interest owners.

(E) ADDITIONAL INFORMATION (for all application types) Please attach sheets with the following information

- (1) A schematic diagram of facility, including legal location.
(2) A plat with lease boundaries showing all well and facility locations. Include lease numbers if Federal or State lands are involved.
(3) Lease Names, Lease and Well Numbers, and API Numbers.

I hereby certify that the information above is true and complete to the best of my knowledge and belief.

SIGNATURE: MBates TITLE: Engineering Tech DATE: 10/29/2020
TYPE OR PRINT NAME Marshall Bates TELEPHONE NO.: (713) 253-2885
E-MAIL ADDRESS: Marshall@FAEnergyus.com

faeIIoperating

October 24, 2020

VIA ONLINE FILING

Mr. Dean McClure
New Mexico Energy, Minerals and Natural Resources Department
1220 South St. Francis Drive
Santa Fe, New Mexico 87505

Re: Application of FAE II Operating, LLC for Administrative Approval to Surface Commingle, Store, and Sell Oil and Gas Production from the Jalmat Oil and Gas Pool for the Winningham #9 Well and the Sholes B 30 #3 Tank Battery located in Sec. 30, T-25S, R-37E, Lea County, New Mexico

Dear Mr. McClure:

FAE II Operating LLC, OGRID: 329326, requests administrative approval for surface commingling, off-lease storage, and off-lease marketing of oil and gas production from the Jalmat Oil and Gas Pool for its Sholes B 30 #3 and Winningham #9 wells located in Section 30 of Township 25S, Range 37E as shown on the map in Exhibit A. The two separate leases are also identified by outline and legend. Exhibit B offers further detail on the relevant leases and wells.

The attached battery diagrams, Exhibits C and D, are accurate schematics of the current facility and the proposed commingled facility, respectively. A new 3-phase flowline will be laid from the Winningham #9 well to the Sholes B 30 #3 Tank Battery and tie in to its own 3-phase separator. From there, the water and oil flow lines will tie into their own tanks for off-lease storage on the Sholes B 30 #3. However, a new gas flowline will also be laid from the Sholes B 30 #3 to the Winningham #9 well and tie in on the suction side of the compressor for gas commingling purposes. For oil measurement, individual allocation meters will be utilized at each well site for measurement of oil production stemming from the separators. For gas measurement, the Winningham #9 gas production will be measured by subtracting the metered Sholes B 30 #3 gas production from the total gas production measured by the sales meter at the Winningham #9.

After a review of internal records, the interest owners are not identical for the wells mentioned above. As such, we have notified all relevant parties of our intent to commingle gas production (see attached letter). The working, royalty, and overriding royalty interest owners as shown in Exhibit E have been notified of this application by certified mail. Copies of the certified mail receipts are attached as Exhibit F.

This proposed commingling of production is in the interest of conservation and will not result in reduced royalty or improper measurement of production. If there are further questions concerning this application, please feel free to contact the undersigned by email at kevin@faenergyus.com or by telephone at (832) 220-9188.

Very truly yours,



FAE II Operating, LLC

faeIoperating

Exhibit A – Lease Boundaries Map

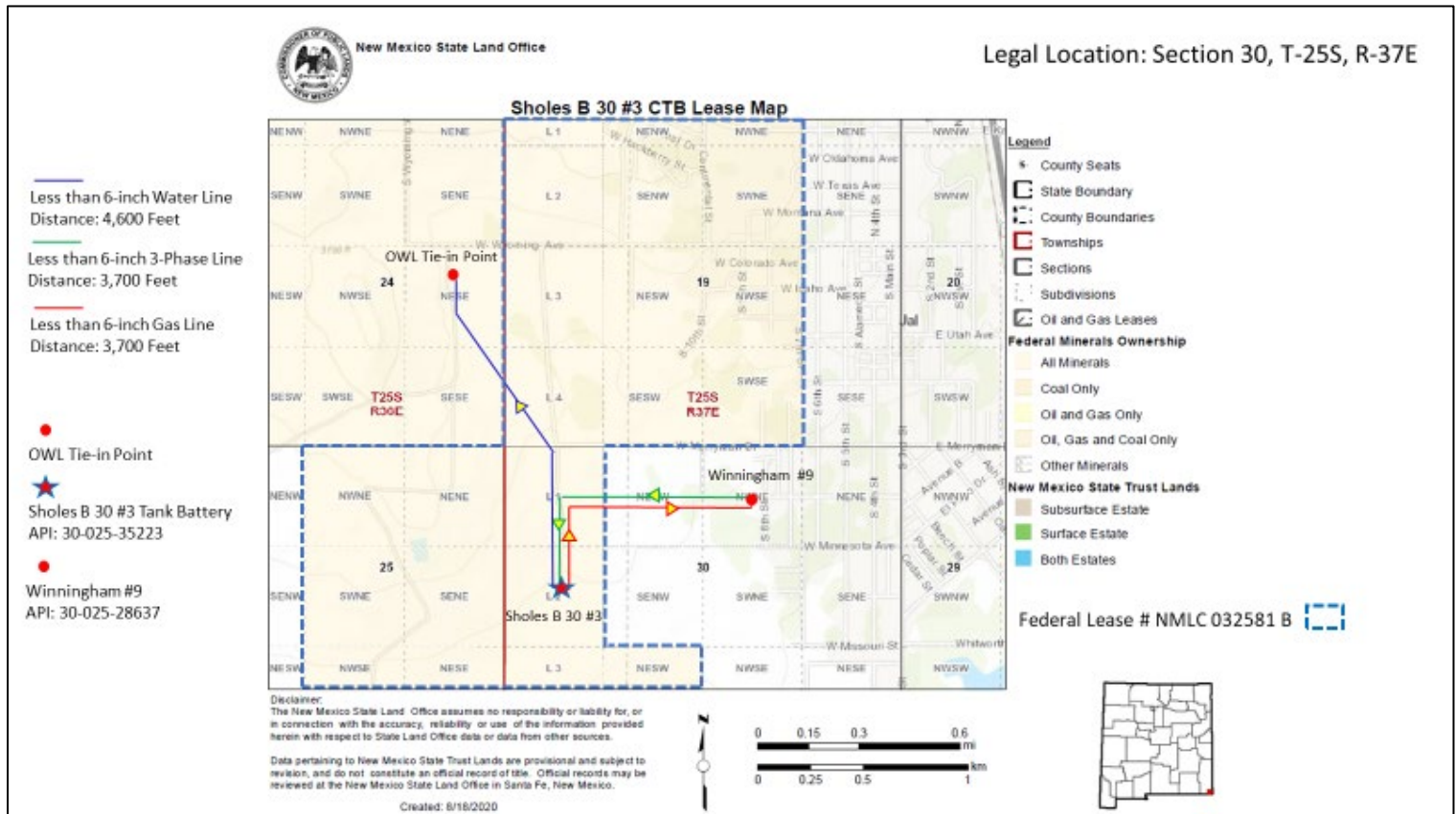
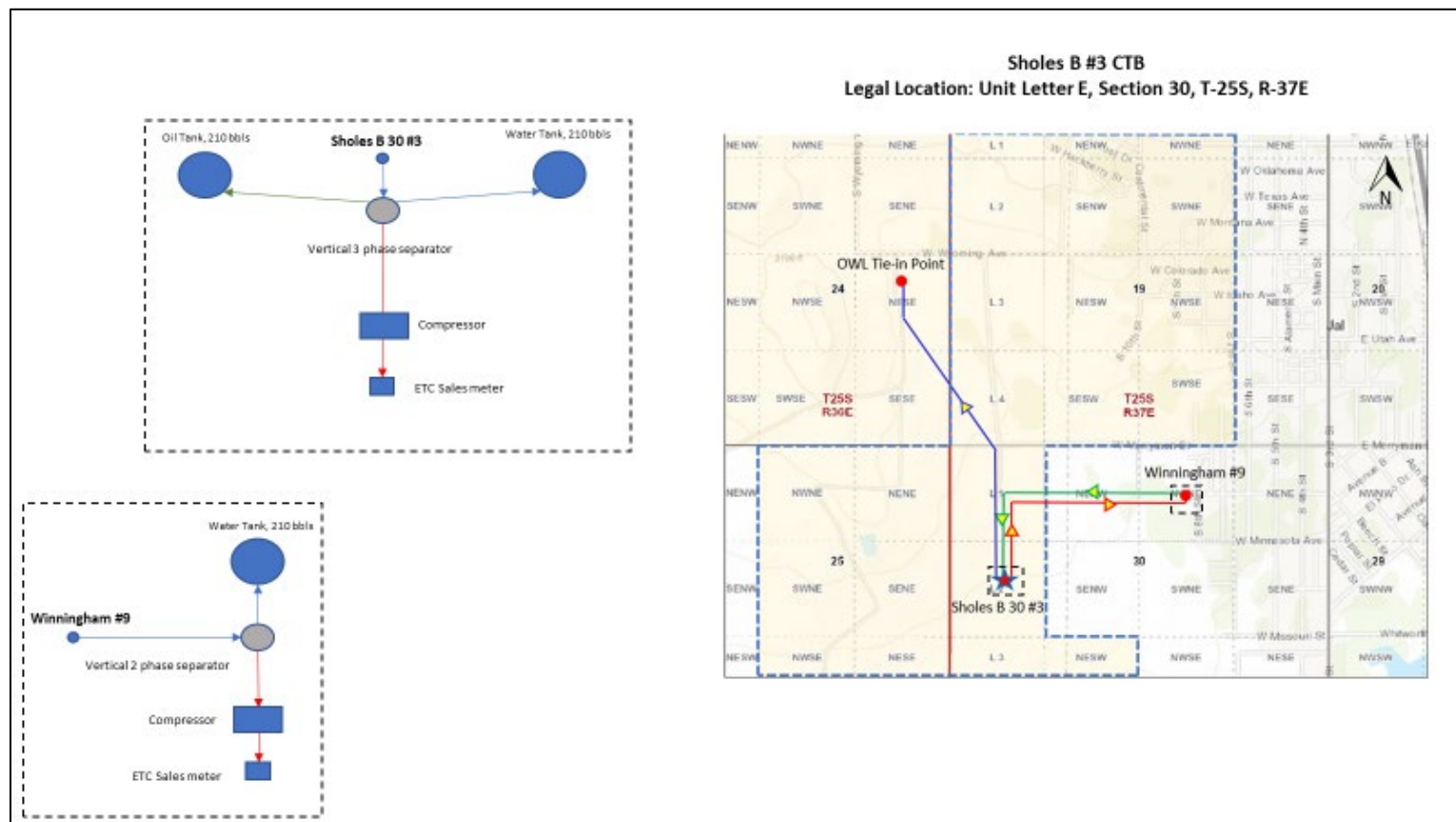

Exhibit B – Lease and Well Information

Well Name	Federal Lease or Property No.	API #	Pool ID
Sholes B 30 #3	NMLC 032581 B	30-025-35223	33820 JALMAT; TAN-YATES-7 RVRS (OIL)
Winningham #9	326422	30-025-28637	79240 JALMAT; TAN-YATES-7 RVRS (GAS)

faeIIoperating

Exhibit C – Current Facility Layout



faeIoperating

Exhibit D – Proposed Facility Layout

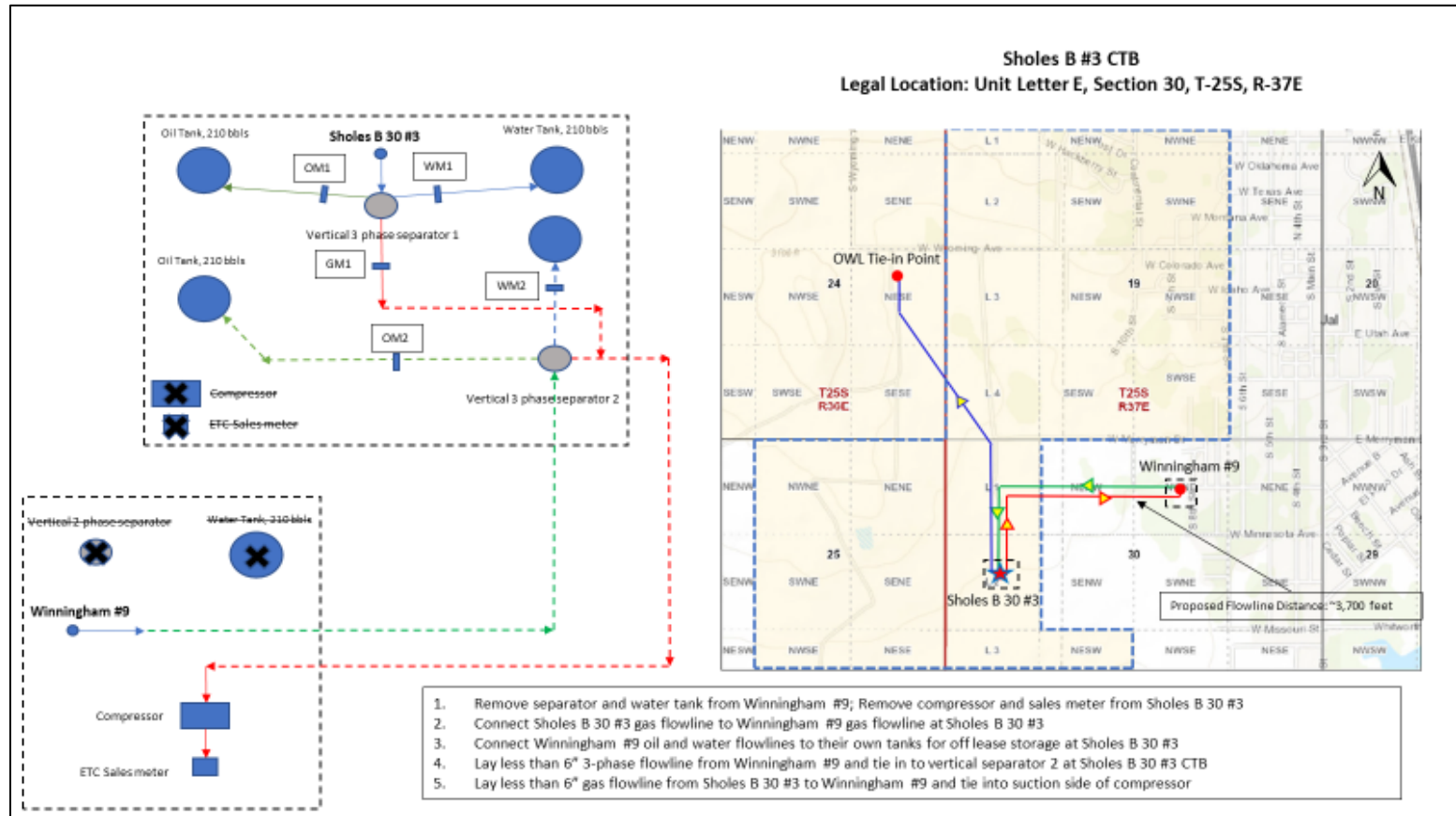

faeIIoperating

Exhibit E – Ownership Information

Well Name(s)	Ownership Type	Name	Address
Sholes B 30 #3, Winningham #9	Working	FAE II Operating LLC	11757 Katy Fwy Ste. 1000 Houston, TX 77079-1762
Winningham #9	Working	31 Group	PO Box 1706 Rockwall, TX 75087
Winningham #9	Royalty	James William Akin, Trustee	5350 Shawnee Road Ste. 101 B Alexandria, VA 22312
Winningham #9	Royalty	John G Akin Trust C/O Stephen M A Slough PLLC CPA	5350 Shawnee Road Ste. 101 B Alexandria, VA 22312
Winningham #9	Royalty	Ann D Allison	PO Box 64035 Lubbock, TX 79464
Winningham #9	Royalty	Carla Beren Trust	3713 Edgestone Drive Plano, TX 75093
Winningham #9	Royalty	Clear Fork Minerals LLC	309 W. 7 th St. Ste. 500 Ft. Worth, TX 76102
Winningham #9	Royalty	Davis A Coppedge	PO Box 1858 Pottsville, TX 75076
Winningham #9	Royalty	James T & Virginia L Coppedge	PO Box 43 Spencer, IN 47460
Winningham #9	Royalty	Corrigan Southern Land & Cattle Company, LLC	8117 Preston Road Ste. 610 Dallas, TX 75225
Winningham #9	Royalty	Sue Hess Edmonson	6511 Morningside Drive Houston, TX 77030-1919
Winningham #9	Royalty	Thomas Martin Ellison	PO Box 206 Volcano, CA 95689
Winningham #9	Royalty	Irene K Fardon Glaister Fardon Housefrog	Lanemilton-Under-Wychwood Chipping Norton, UK
Winningham #9	Royalty	Rachel B Fardon	Castro 11 Upper Rose Hill Dorking Surry, UK RH4 2EB
Winningham #9	Royalty	Mary Fountaine	1133 Oakhurst Drive Broomfield, CO 80020
Winningham #9	Royalty	Stanley Erb Hess	PO Box 1982 Coeur D'Alene, ID 83816-1908
Winningham #9	Royalty	Maura Smyrl Jennings	1810 S Breton Place Tucson, AZ 85748
Winningham #9	Royalty	Tate Byrne Jennings	3535 23 rd Street Boulder, CO 80304
Winningham #9	Royalty	Clarence W Johnson	HC 1 Box 46 Coalinga, CA 93210
Winningham #9	Royalty	Peter Francis Jones	15 Eastwind #9 Marina Del Rey, CA 90292
Winningham #9	Royalty	Wendelin E Jones Reneta A Dymesich, Conservator	17416 Wildrye Drive Austin, TX 78738
Winningham #9	Royalty	J Pat Corrigan Family Limited Partnership	7150 20 th St. Ste. E Vero Beach, FL 32966
Winningham #9	Royalty	Kenneth N Headley	1040 Levy Ogden, UT 84201-0010
Winningham #9	Royalty	Marilyn M Law Revocable Trust C/O BOKF NA Agent	PO Box 1588 Tulsa, OK 74101
Winningham #9	Royalty	W C Lawrence	PO Box 630 Santa Fe, NM 87509
Winningham #9	Royalty	Alvin Luskey.	113 N. Houston St. Fort Worth, TX 76164
Winningham #9	Royalty	David Luskey Estate Idelle Luskey, Indep. Executrix	6509 Valencia Grove Pass Ft. Worth, TX 76132
Winningham #9	Royalty	Luskey Living Trust Bernice Luskey, Trustee	95 Skidaway Island Park Road #311 Savannah, GA 31411
Winningham #9	Royalty	Mary J McWhorter Trust James R McWhorter, Trustee	PO Box 1087 Medford, OR 97520
Winningham #9	Overriding Royalty	Larry Bond	3501 French Park Drive, Suite G Edmond, OK 73034
Winningham #9	Overriding Royalty	Jimmie Eden Jr. Trust	P.O. Box 17 Stillwater, OK 74076
Winningham #9	Overriding Royalty	Legat LLC	6114 W. Canterbury Drive Stillwater, OK 74074

faeIoperating

Exhibit E (continued) – Ownership Information

Well Name	Ownership Type	Name	Address
Winningham #9	Royalty	Metropolitan Royalty Corp. C/O Mary Stuart Gephart	PO Box 975363 Dallas, TX 75397-5363
Winningham #9	Royalty	Mobil Producing TX & NM Inc. C/O XTO Energy Inc.	PO Box 731917 Dallas, TX 75373-1917
Winningham #9	Royalty	Michael Herd Moore	PO Box 2398 Frisco, TX 75034
Winningham #9	Royalty	Clifford Mordhorst	PO Box 4335 Tulsa, OK 74159
Winningham #9	Royalty	Derek Mordhorst	PO Box 4335 Tulsa, OK 74159
Winningham #9	Royalty	Jimmy D Morey Trust C/O JP Morgan Chase Bank NA Trustee	PO Box 99084 Fort Worth, TX 76199-0084
Winningham #9	Royalty	Lyeth Oil Irrevocable Trust C/O Kanaly Trust Company	PO Box 13639 Arlington, TX 76094
Winningham #9	Royalty	New Mexico Western Minerals	PO Box 1738 Roswell, NM 88202
Winningham #9	Royalty	Noble Royalties Access Fund VII LP	PO Box 660082 Dallas, TX 75266-0082
Winningham #9	Royalty	Noble Royalties Access Fund VIII LP	PO Box 660082 Dallas, TX 75266-0082
Winningham #9	Royalty	Noble Royalties Inc.	PO Box 660082 Dallas, TX 75266-0082
Winningham #9	Royalty	Onez Norman Rooney Test Trust James Michael Morey, Trustee C/O D Craig Story	PO Box 960031 Oklahoma City, OK 73196-0001
Winningham #9	Royalty	John W & Cynthia J Pride Rev. Trust	PO Box 701950 Tulsa, OK 74170-1950
Winningham #9	Royalty	Matthew L & Renee G Pride Rev. Trust	PO Box 701950 Tulsa, OK 74170-1950
Winningham #9	Royalty	Dan Mordhorst Rev. Trust Dan Mordhorst, Trustee	PO Box 4335 Tulsa, OK 74159-0335
Winningham #9	Royalty	Sappington Energy Interest Ltd.	PO Box 19160 Houston, TX 77224-9160
Winningham #9	Royalty	Shelley Luskey Trust	21185 Toll Gate Road Saratoga, CA 95070
Winningham #9	Royalty	Texas Presbyterian Foundation Farmers National CO Agent Oil & Gas Dept.	PO Box 3480 Omaha, NE 68103-0480
Winningham #9	Royalty	Trinity University C/O Frost National Bank	PO Box 27 San Antonio, TX 78291-0027
Winningham #9	Royalty	McWhorter Living Trust	6140 East Voltaire Ave. Scottsdale, AZ 85254
Winningham #9	Royalty	White Star Energy, Inc.	PO Box 51108 Midland, TX 79710
Winningham #9	Royalty	Andrea Colleen Wiggins	PO Box 5305 Austin, TX 78763-5305
Winningham #9	Royalty	Charles R Wiggins	PO Box 10862 Midland, TX 79702
Winningham #9	Royalty	Robert R Winningham	PO Box 1124 Allen, TX 75013
Winningham #9	Royalty	Windom Royalties, LLC	PO Box 660082 Dallas, TX 75266-0082
Winningham #9	Royalty	ZPZ Delaware I LLC	PO Box 840133 Dallas, TX 75284-0133
Winningham #9	Overriding Royalty	The McDaniel Company	12900 Preston Road, Suite 415 Dallas, TX 75231
Winningham #9	Overriding Royalty	Marjam Energy, LLC	10440 N. Central Express Way, Suite 1010 Dallas, TX 75231
Winningham #9	Overriding Royalty	Milagro Resources, LP	415 West Wall Avenue, Suite 1118 Midland, TX 79701
Winningham #9	Overriding Royalty	John F. Special	P.O. Box 369 Stillwater, OK 74076
Sholes B 30 #3	Royalty	Department of Interior	PO Box 5810 Denver, CO 80217-5810

faeIloperating

Exhibit F – Certified Mail Receipts

7020 0090 0000 6900 0061	U.S. Postal Service™ CERTIFIED MAIL® RECEIPT Domestic Mail Only For delivery information, visit our website at www.usps.com ®. Spencer, IN 47460 Certified Mail Fee \$3.55 Extra Services & Fees (check box, add fee if applicable) <input type="checkbox"/> Return Receipt (hardcopy) \$0.00 <input type="checkbox"/> Return Receipt (electronic) \$0.00 <input type="checkbox"/> Certified Mail Restricted Delivery \$0.00 <input type="checkbox"/> Adult Signature Required \$0.00 <input type="checkbox"/> Adult Signature Restricted Delivery \$0.00 Postage \$0.70 Total Postage and Fees \$7.10 Sent To James T. & Virginia L. Coppedge Street and Apt. No., or PO Box No. PO Box 43 City, State, ZIP+4® Spencer, IN 47460 PS Form 3800, April 2015 PSN 7530-02-000-9047 See Reverse for Instructions	0037 12 Postmark Here 11/02/2020
7020 0090 0000 6900 0153	U.S. Postal Service™ CERTIFIED MAIL® RECEIPT Domestic Mail Only For delivery information, visit our website at www.usps.com ®. Boulder, CO 80304 Certified Mail Fee \$3.55 Extra Services & Fees (check box, add fee if applicable) <input type="checkbox"/> Return Receipt (hardcopy) \$0.00 <input type="checkbox"/> Return Receipt (electronic) \$0.00 <input type="checkbox"/> Certified Mail Restricted Delivery \$0.00 <input type="checkbox"/> Adult Signature Required \$0.00 <input type="checkbox"/> Adult Signature Restricted Delivery \$0.00 Postage \$0.70 Total Postage and Fees \$7.10 Sent To Tate Byrne Jennings Street and Apt. No., or PO Box No. 3535 23rd St. City, State, ZIP+4® Boulder, CO 80304 PS Form 3800, April 2015 PSN 7530-02-000-9047 See Reverse for Instructions	0037 12 Postmark Here 11/02/2020
7020 0090 0000 6900 0076	U.S. Postal Service™ CERTIFIED MAIL® RECEIPT Domestic Mail Only For delivery information, visit our website at www.usps.com ®. Dallas, TX 75225 Certified Mail Fee \$3.55 Extra Services & Fees (check box, add fee if applicable) <input type="checkbox"/> Return Receipt (hardcopy) \$0.00 <input type="checkbox"/> Return Receipt (electronic) \$0.00 <input type="checkbox"/> Certified Mail Restricted Delivery \$0.00 <input type="checkbox"/> Adult Signature Required \$0.00 <input type="checkbox"/> Adult Signature Restricted Delivery \$0.00 Postage \$0.70 Total Postage and Fees \$7.10 Sent To Corrigan Southern Land & Cattle Co. LLC Street and Apt. No., or PO Box No. 8117 Preston Road Ste. 610 City, State, ZIP+4® Dallas, TX 75225 PS Form 3800, April 2015 PSN 7530-02-000-9047 See Reverse for Instructions	0037 12 Postmark Here 11/02/2020
7020 0090 0000 6900 0085	U.S. Postal Service™ CERTIFIED MAIL® RECEIPT Domestic Mail Only For delivery information, visit our website at www.usps.com ®. Houston, TX 77030 Certified Mail Fee \$3.55 Extra Services & Fees (check box, add fee if applicable) <input type="checkbox"/> Return Receipt (hardcopy) \$0.00 <input type="checkbox"/> Return Receipt (electronic) \$0.00 <input type="checkbox"/> Certified Mail Restricted Delivery \$0.00 <input type="checkbox"/> Adult Signature Required \$0.00 <input type="checkbox"/> Adult Signature Restricted Delivery \$0.00 Postage \$0.70 Total Postage and Fees \$7.10 Sent To Sue Hess Edmonson Street and Apt. No., or PO Box No. 6511 Morningside Dr. City, State, ZIP+4® Houston, TX 77030-1919 PS Form 3800, April 2015 PSN 7530-02-000-9047 See Reverse for Instructions	0037 12 Postmark Here 11/02/2020
7020 0090 0000 6900 1387	U.S. Postal Service™ CERTIFIED MAIL® RECEIPT Domestic Mail Only For delivery information, visit our website at www.usps.com ®. Lubbock, TX 79464 Certified Mail Fee \$3.55 Extra Services & Fees (check box, add fee if applicable) <input type="checkbox"/> Return Receipt (hardcopy) \$0.00 <input type="checkbox"/> Return Receipt (electronic) \$0.00 <input type="checkbox"/> Certified Mail Restricted Delivery \$0.00 <input type="checkbox"/> Adult Signature Required \$0.00 <input type="checkbox"/> Adult Signature Restricted Delivery \$0.00 Postage \$0.70 Total Postage and Fees \$7.10 Sent To Ann D. Allison Street and Apt. No., or PO Box No. PO Box 64035 City, State, ZIP+4® Lubbock, TX 79464 PS Form 3800, April 2015 PSN 7530-02-000-9047 See Reverse for Instructions	0037 12 Postmark Here 11/02/2020

faeIloperating

U.S. Postal Service™
CERTIFIED MAIL® RECEIPT
Domestic Mail Only

For delivery information, visit our website at www.usps.com®.

Plano, TX 75093

Certified Mail Fee \$3.55 0037 12

Extra Services & Fees (check box, add fee as indicated)

<input type="checkbox"/> Return Receipt (hardcopy)	\$0.00
<input type="checkbox"/> Return Receipt (electronic)	\$0.00
<input type="checkbox"/> Certified Mail Restricted Delivery	\$0.00
<input type="checkbox"/> Adult Signature Required	\$0.00
<input type="checkbox"/> Adult Signature Restricted Delivery	\$0.00

Postage \$0.70

Total Postage and Fees \$7.10

Postmark Here 11/02/2020

Sent To Carla Beren Trust
Street and Apt. No., or PO Box No.
3713 Edgestone Drive
City, State, ZIP+4®
Plano, TX 75093

PS Form 3800, April 2015 PSN 7530-02-000-9047 See Reverse for Instructions

U.S. Postal Service™
CERTIFIED MAIL® RECEIPT
Domestic Mail Only

For delivery information, visit our website at www.usps.com®.

Alexandria, VA 22312

Certified Mail Fee \$3.55 0037 12

Extra Services & Fees (check box, add fee as indicated)

<input type="checkbox"/> Return Receipt (hardcopy)	\$0.00
<input type="checkbox"/> Return Receipt (electronic)	\$0.00
<input type="checkbox"/> Certified Mail Restricted Delivery	\$0.00
<input type="checkbox"/> Adult Signature Required	\$0.00
<input type="checkbox"/> Adult Signature Restricted Delivery	\$0.00

Postage \$0.70

Total Postage and Fees \$7.10

Postmark Here 11/02/2020

Sent To James William Akin, Trustee
Street and Apt. No., or PO Box No.
5350 Shawnee Rd. Ste. 101 B
City, State, ZIP+4®
Alexandria, VA 22312

PS Form 3800, April 2015 PSN 7530-02-000-9047 See Reverse for Instructions

U.S. Postal Service™
CERTIFIED MAIL® RECEIPT
Domestic Mail Only

For delivery information, visit our website at www.usps.com®.

Fort Worth, TX 76102

Certified Mail Fee \$3.55 0037 12

Extra Services & Fees (check box, add fee as indicated)

<input type="checkbox"/> Return Receipt (hardcopy)	\$0.00
<input type="checkbox"/> Return Receipt (electronic)	\$0.00
<input type="checkbox"/> Certified Mail Restricted Delivery	\$0.00
<input type="checkbox"/> Adult Signature Required	\$0.00
<input type="checkbox"/> Adult Signature Restricted Delivery	\$0.00

Postage \$0.70

Total Postage and Fees \$7.10

Postmark Here 11/02/2020

Sent To Clear Fork Minerals, LLC
Street and Apt. No., or PO Box No.
309 W. 7th St. Ste. 500
City, State, ZIP+4®
Ft. Worth, TX 76102

PS Form 3800, April 2015 PSN 7530-02-000-9047 See Reverse for Instructions

U.S. Postal Service™
CERTIFIED MAIL® RECEIPT
Domestic Mail Only

For delivery information, visit our website at www.usps.com®.

Ordan, UT 84201

Certified Mail Fee \$3.55 0037 12

Extra Services & Fees (check box, add fee as indicated)

<input type="checkbox"/> Return Receipt (hardcopy)	\$0.00
<input type="checkbox"/> Return Receipt (electronic)	\$0.00
<input type="checkbox"/> Certified Mail Restricted Delivery	\$0.00
<input type="checkbox"/> Adult Signature Required	\$0.00
<input type="checkbox"/> Adult Signature Restricted Delivery	\$0.00

Postage \$0.70

Total Postage and Fees \$7.10

Postmark Here 11/02/2020

Sent To Kenneth N. Headley
Street and Apt. No., or PO Box No.
1040 Levy
City, State, ZIP+4®
Ordan, UTAH 84201-0010

PS Form 3800, April 2015 PSN 7530-02-000-9047 See Reverse for Instructions

U.S. Postal Service™
CERTIFIED MAIL® RECEIPT
Domestic Mail Only

For delivery information, visit our website at www.usps.com®.

Tulsa, OK 74101

Certified Mail Fee \$3.55 0037 12

Extra Services & Fees (check box, add fee as indicated)

<input type="checkbox"/> Return Receipt (hardcopy)	\$0.00
<input type="checkbox"/> Return Receipt (electronic)	\$0.00
<input type="checkbox"/> Certified Mail Restricted Delivery	\$0.00
<input type="checkbox"/> Adult Signature Required	\$0.00
<input type="checkbox"/> Adult Signature Restricted Delivery	\$0.00

Postage \$0.70

Total Postage and Fees \$7.10

Postmark Here 11/02/2020

Sent To Marilyn M. Law Trust
Street and Apt. No., or PO Box No.
PO Box 1588
City, State, ZIP+4®
Tulsa, OK 74101

PS Form 3800, April 2015 PSN 7530-02-000-9047 See Reverse for Instructions

U.S. Postal Service™
CERTIFIED MAIL® RECEIPT
Domestic Mail Only

For delivery information, visit our website at www.usps.com®.

Ashland, OR 97520

Certified Mail Fee \$3.55 0037 12

Extra Services & Fees (check box, add fee as indicated)

<input type="checkbox"/> Return Receipt (hardcopy)	\$0.00
<input type="checkbox"/> Return Receipt (electronic)	\$0.00
<input type="checkbox"/> Certified Mail Restricted Delivery	\$0.00
<input type="checkbox"/> Adult Signature Required	\$0.00
<input type="checkbox"/> Adult Signature Restricted Delivery	\$0.00

Postage \$0.70

Total Postage and Fees \$7.10

Postmark Here 11/02/2020

Sent To Mary J. McWhorter Trust
Street and Apt. No., or PO Box No.
PO Box 1087
City, State, ZIP+4®
Medford OR 97520

PS Form 3800, April 2015 PSN 7530-02-000-9047 See Reverse for Instructions

faeIloperating

7020 0090 0000 6900 0245

**U.S. Postal Service™
CERTIFIED MAIL® RECEIPT**
Domestic Mail Only

For delivery information, visit our website at www.usps.com®.

Fort Worth, TX 76132

Certified Mail Fee \$3.55

Extra Services & Fees (check box, add fee as appropriate)

☐ Return Receipt (hardcopy) \$2.85

☐ Return Receipt (electronic) \$0.00

☐ Certified Mail Restricted Delivery \$0.00

☐ Adult Signature Required \$0.00

☐ Adult Signature Restricted Delivery \$0.00

Postage \$0.70

Total Postage and Fees \$7.10

Postmark Here 11/02/2020

Sent To David Luskey Estate
Street and Apt. No., or PO Box No. 6509 Valencia Grove Pass
City, State, ZIP+4® Ft. Worth, TX 76132

PS Form 3800, April 2015 PSN 7530-02-000-9047 See Reverse for Instructions

7020 0090 0000 6900 0139

**U.S. Postal Service™
CERTIFIED MAIL® RECEIPT**
Domestic Mail Only

For delivery information, visit our website at www.usps.com®.

Coeur D'Alene, ID 83816

Certified Mail Fee \$3.55

Extra Services & Fees (check box, add fee as appropriate)

☐ Return Receipt (hardcopy) \$2.85

☐ Return Receipt (electronic) \$0.00

☐ Certified Mail Restricted Delivery \$0.00

☐ Adult Signature Required \$0.00

☐ Adult Signature Restricted Delivery \$0.00

Postage \$0.70

Total Postage and Fees \$7.10

Postmark Here 11/02/2020

Sent To Stanley Erb Hess
Street and Apt. No., or PO Box No. PO Box 1982
City, State, ZIP+4® Coeur D'Alene, ID 83816-1908

PS Form 3800, April 2015 PSN 7530-02-000-9047 See Reverse for Instructions

7020 0090 0000 6900 0160

**U.S. Postal Service™
CERTIFIED MAIL® RECEIPT**
Domestic Mail Only

For delivery information, visit our website at www.usps.com®.

Coalinga, CA 93210

Certified Mail Fee \$3.55

Extra Services & Fees (check box, add fee as appropriate)

☐ Return Receipt (hardcopy) \$2.85

☐ Return Receipt (electronic) \$0.00

☐ Certified Mail Restricted Delivery \$0.00

☐ Adult Signature Required \$0.00

☐ Adult Signature Restricted Delivery \$0.00

Postage \$0.70

Total Postage and Fees \$7.10

Postmark Here 11/02/2020

Sent To Clarence W Johnson
Street and Apt. No., or PO Box No. HC 1 Box 46
City, State, ZIP+4® Coalinga, CA 93210

PS Form 3800, April 2015 PSN 7530-02-000-9047 See Reverse for Instructions

7020 0090 0000 6900 0191

**U.S. Postal Service™
CERTIFIED MAIL® RECEIPT**
Domestic Mail Only

For delivery information, visit our website at www.usps.com®.

Vero Beach, FL 32966

Certified Mail Fee \$3.55

Extra Services & Fees (check box, add fee as appropriate)

☐ Return Receipt (hardcopy) \$2.85

☐ Return Receipt (electronic) \$0.00

☐ Certified Mail Restricted Delivery \$0.00

☐ Adult Signature Required \$0.00

☐ Adult Signature Restricted Delivery \$0.00

Postage \$0.70

Total Postage and Fees \$7.10

Postmark Here 11/02/2020

Sent To J Pat Corrigan Family Ltd. Partnership
Street and Apt. No., or PO Box No. 7150 20th St. Ste. E
City, State, ZIP+4® Vero Beach, FL 32966

PS Form 3800, April 2015 PSN 7530-02-000-9047 See Reverse for Instructions

7020 0090 0000 6900 0092

**U.S. Postal Service™
CERTIFIED MAIL® RECEIPT**
Domestic Mail Only

For delivery information, visit our website at www.usps.com®.

Volcano, CA 95689

Certified Mail Fee \$3.55

Extra Services & Fees (check box, add fee as appropriate)

☐ Return Receipt (hardcopy) \$2.85

☐ Return Receipt (electronic) \$0.00

☐ Certified Mail Restricted Delivery \$0.00

☐ Adult Signature Required \$0.00

☐ Adult Signature Restricted Delivery \$0.00

Postage \$0.70

Total Postage and Fees \$7.10

Postmark Here 11/02/2020

Sent To Thomas Martin Ellison
Street and Apt. No., or PO Box No. PO Box 206
City, State, ZIP+4® Volcano, CA 95689

PS Form 3800, April 2015 PSN 7530-02-000-9047 See Reverse for Instructions

7020 0090 0000 6900 0122

**U.S. Postal Service™
CERTIFIED MAIL® RECEIPT**
Domestic Mail Only

For delivery information, visit our website at www.usps.com®.

Broomfield, CO 80020

Certified Mail Fee \$3.55

Extra Services & Fees (check box, add fee as appropriate)

☐ Return Receipt (hardcopy) \$2.85

☐ Return Receipt (electronic) \$0.00

☐ Certified Mail Restricted Delivery \$0.00

☐ Adult Signature Required \$0.00

☐ Adult Signature Restricted Delivery \$0.00

Postage \$0.70

Total Postage and Fees \$7.10

Postmark Here 11/02/2020

Sent To Mary Fountaine
Street and Apt. No., or PO Box No. 1133 Dakhurst Drive
City, State, ZIP+4® Broomfield, CO 80020

PS Form 3800, April 2015 PSN 7530-02-000-9047 See Reverse for Instructions

faeIloperating

U.S. Postal Service™
CERTIFIED MAIL® RECEIPT
Domestic Mail Only

For delivery information, visit our website at www.usps.com®.

Austin, TX 78738

Certified Mail Fee \$3.55 0037 12

Extra Services & Fees (check box, add fee as appropriate):
☐ Return Receipt (hardcopy) \$0.00
☐ Return Receipt (electronic) \$0.00
☐ Certified Mail Restricted Delivery \$0.00
☐ Adult Signature Required \$0.00
☐ Adult Signature Restricted Delivery \$0.00

Postage \$0.70

Total Postage and Fees \$7.10

11/02/2020

Sent To: Wendelin E Jones
 Street and Apt. No., or PO Box No. 17th Wildlife Drive
 City, State, ZIP+4® Austin, TX 78738

PS Form 3800, April 2015 PSN 7530-02-000-9047 See Reverse for Instructions

U.S. Postal Service™
CERTIFIED MAIL® RECEIPT
Domestic Mail Only

For delivery information, visit our website at www.usps.com®.

Tulsa, OK 74170

Certified Mail Fee \$3.55 0037 12

Extra Services & Fees (check box, add fee as appropriate):
☐ Return Receipt (hardcopy) \$0.00
☐ Return Receipt (electronic) \$0.00
☐ Certified Mail Restricted Delivery \$0.00
☐ Adult Signature Required \$0.00
☐ Adult Signature Restricted Delivery \$2.00

Postage \$0.70

Total Postage and Fees \$7.10

11/02/2020

Sent To: John W. & Cynthia S. Pride Trust
 Street and Apt. No., or PO Box No. PO Box 701950
 City, State, ZIP+4® Tulsa, OK 74170-1950

PS Form 3800, April 2015 PSN 7530-02-000-9047 See Reverse for Instructions

U.S. Postal Service™
CERTIFIED MAIL® RECEIPT
Domestic Mail Only

For delivery information, visit our website at www.usps.com®.

Marina del Rey, CA 90292

Certified Mail Fee \$3.55 0037 12

Extra Services & Fees (check box, add fee as appropriate):
☐ Return Receipt (hardcopy) \$0.00
☐ Return Receipt (electronic) \$0.00
☐ Certified Mail Restricted Delivery \$0.00
☐ Adult Signature Required \$0.00
☐ Adult Signature Restricted Delivery \$0.00

Postage \$0.70

Total Postage and Fees \$7.10

11/02/2020

Sent To: Peter Francis Jones
 Street and Apt. No., or PO Box No. 15 Eastwind #9
 City, State, ZIP+4® Marina del Rey, CA 90292

PS Form 3800, April 2015 PSN 7530-02-000-9047 See Reverse for Instructions

U.S. Postal Service™
CERTIFIED MAIL® RECEIPT
Domestic Mail Only

For delivery information, visit our website at www.usps.com®.

Tulsa, OK 74159

Certified Mail Fee \$3.55 0037 12

Extra Services & Fees (check box, add fee as appropriate):
☐ Return Receipt (hardcopy) \$0.00
☐ Return Receipt (electronic) \$0.00
☐ Certified Mail Restricted Delivery \$0.00
☐ Adult Signature Required \$0.00
☐ Adult Signature Restricted Delivery \$0.00

Postage \$0.70

Total Postage and Fees \$7.10

11/02/2020

Sent To: Derek Nordhorst
 Street and Apt. No., or PO Box No. PO Box 4335
 City, State, ZIP+4® Tulsa, OK 74159

PS Form 3800, April 2015 PSN 7530-02-000-9047 See Reverse for Instructions

U.S. Postal Service™
CERTIFIED MAIL® RECEIPT
Domestic Mail Only

For delivery information, visit our website at www.usps.com®.

Dallas, TX 75266

Certified Mail Fee \$3.55 0037 12

Extra Services & Fees (check box, add fee as appropriate):
☐ Return Receipt (hardcopy) \$0.00
☐ Return Receipt (electronic) \$0.00
☐ Certified Mail Restricted Delivery \$0.00
☐ Adult Signature Required \$0.00
☐ Adult Signature Restricted Delivery \$0.00

Postage \$0.70

Total Postage and Fees \$7.10

11/02/2020

Sent To: Noble Royalties Access Fund VII LP
 Street and Apt. No., or PO Box No. PO Box 660082
 City, State, ZIP+4® Dallas, TX 75266-0082

PS Form 3800, April 2015 PSN 7530-02-000-9047 See Reverse for Instructions

U.S. Postal Service™
CERTIFIED MAIL® RECEIPT
Domestic Mail Only

For delivery information, visit our website at www.usps.com®.

Oklahoma City, OK 73196

Certified Mail Fee \$3.55 0037 12

Extra Services & Fees (check box, add fee as appropriate):
☐ Return Receipt (hardcopy) \$0.00
☐ Return Receipt (electronic) \$0.00
☐ Certified Mail Restricted Delivery \$0.00
☐ Adult Signature Required \$0.00
☐ Adult Signature Restricted Delivery \$0.00

Postage \$0.70

Total Postage and Fees \$7.10

11/02/2020

Sent To: One Z Norman Roney Trust
 Street and Apt. No., or PO Box No. PO Box 960031
 City, State, ZIP+4® Oklahoma City, OK 73196-0001

PS Form 3800, April 2015 PSN 7530-02-000-9047 See Reverse for Instructions

faeIloperating

7020 0640 0000 9346 8157	U.S. Postal Service™ CERTIFIED MAIL® RECEIPT Domestic Mail Only For delivery information, visit our website at www.usps.com ®. OFFICIAL USE Certified Mail Fee \$ Extra Services & Fees (check box, add fee as appropriate) <input type="checkbox"/> Return Receipt (hardcopy) \$ <input type="checkbox"/> Return Receipt (electronic) \$ <input type="checkbox"/> Certified Mail Restricted Delivery \$ <input type="checkbox"/> Adult Signature Required \$ <input type="checkbox"/> Adult Signature Restricted Delivery \$ Postage \$ Total Postage and Fees \$ Sent To Jimmie Eden Jr. Trust Street and Apt. No., or PO Box No. PO Box 17 City, State, ZIP+4® Stillwater, OK 74074 PS Form 3800, April 2015 PSN 7530-02-000-9047 See Reverse for Instructions
7020 0640 0000 9346 8171	U.S. Postal Service™ CERTIFIED MAIL® RECEIPT Domestic Mail Only For delivery information, visit our website at www.usps.com ®. OFFICIAL USE Certified Mail Fee \$ Extra Services & Fees (check box, add fee as appropriate) <input type="checkbox"/> Return Receipt (hardcopy) \$ <input type="checkbox"/> Return Receipt (electronic) \$ <input type="checkbox"/> Certified Mail Restricted Delivery \$ <input type="checkbox"/> Adult Signature Required \$ <input type="checkbox"/> Adult Signature Restricted Delivery \$ Postage \$ Total Postage and Fees \$ Sent To Dept. of Interior Street and Apt. No., or PO Box No. PO Box 5810 City, State, ZIP+4® Denver, CO 80214-5810 PS Form 3800, April 2015 PSN 7530-02-000-9047 See Reverse for Instructions
7020 0640 0000 9346 8294	U.S. Postal Service™ CERTIFIED MAIL® RECEIPT Domestic Mail Only For delivery information, visit our website at www.usps.com ®. OFFICIAL USE Certified Mail Fee \$ Extra Services & Fees (check box, add fee as appropriate) <input type="checkbox"/> Return Receipt (hardcopy) \$ <input type="checkbox"/> Return Receipt (electronic) \$ <input type="checkbox"/> Certified Mail Restricted Delivery \$ <input type="checkbox"/> Adult Signature Required \$ <input type="checkbox"/> Adult Signature Restricted Delivery \$ Postage \$ Total Postage and Fees \$ Sent To Luskey Living Trust c/o Bernice Luskey Street and Apt. No., or PO Box No. 95 Skidaway Island Park Road # 311 City, State, ZIP+4® Savannah, GA 31411 PS Form 3800, April 2015 PSN 7530-02-000-9047 See Reverse for Instructions
7020 0640 0000 9346 8164	U.S. Postal Service™ CERTIFIED MAIL® RECEIPT Domestic Mail Only For delivery information, visit our website at www.usps.com ®. OFFICIAL USE Certified Mail Fee \$ Extra Services & Fees (check box, add fee as appropriate) <input type="checkbox"/> Return Receipt (hardcopy) \$ <input type="checkbox"/> Return Receipt (electronic) \$ <input type="checkbox"/> Certified Mail Restricted Delivery \$ <input type="checkbox"/> Adult Signature Required \$ <input type="checkbox"/> Adult Signature Restricted Delivery \$ Postage \$ Total Postage and Fees \$ Sent To Leant LLC Street and Apt. No., or PO Box No. 6114 W. Canterbury Dr. City, State, ZIP+4® Stillwater, OK 74074 PS Form 3800, April 2015 PSN 7530-02-000-9047 See Reverse for Instructions
7020 0090 0000 6900 1341	U.S. Postal Service™ CERTIFIED MAIL® RECEIPT Domestic Mail Only For delivery information, visit our website at www.usps.com ®. OFFICIAL USE Certified Mail Fee \$ Extra Services & Fees (check box, add fee as appropriate) <input type="checkbox"/> Return Receipt (hardcopy) \$ <input type="checkbox"/> Return Receipt (electronic) \$ <input type="checkbox"/> Certified Mail Restricted Delivery \$ <input type="checkbox"/> Adult Signature Required \$ <input type="checkbox"/> Adult Signature Restricted Delivery \$ Postage \$ Total Postage and Fees \$ Sent To 31 Group Street and Apt. No., or PO Box No. PO Box 1706 City, State, ZIP+4® Rockwall, TX 75087 PS Form 3800, April 2015 PSN 7530-02-000-9047 See Reverse for Instructions
7020 0640 0000 9346 8072	U.S. Postal Service™ CERTIFIED MAIL® RECEIPT Domestic Mail Only For delivery information, visit our website at www.usps.com ®. OFFICIAL USE Certified Mail Fee \$ Extra Services & Fees (check box, add fee as appropriate) <input type="checkbox"/> Return Receipt (hardcopy) \$ <input type="checkbox"/> Return Receipt (electronic) \$ <input type="checkbox"/> Certified Mail Restricted Delivery \$ <input type="checkbox"/> Adult Signature Required \$ <input type="checkbox"/> Adult Signature Restricted Delivery \$ Postage \$ Total Postage and Fees \$ Sent To Robert R. Winningham Street and Apt. No., or PO Box No. PO Box 1124 City, State, ZIP+4® Allen, TX 75013 PS Form 3800, April 2015 PSN 7530-02-000-9047 See Reverse for Instructions

faeIloperating

7020 0640 0000 9346 8089	U.S. Postal Service™ CERTIFIED MAIL® RECEIPT Domestic Mail Only For delivery information, visit our website at www.usps.com ®. OFFICIAL USE Certified Mail Fee \$ Extra Services & Fees (check box, add fee as appropriate) <input type="checkbox"/> Return Receipt (hardcopy) \$ <input type="checkbox"/> Return Receipt (electronic) \$ <input type="checkbox"/> Certified Mail Restricted Delivery \$ <input type="checkbox"/> Adult Signature Required \$ <input type="checkbox"/> Adult Signature Restricted Delivery \$ Postage \$ Total Postage and Fees \$ Sent To <u>Windom Royalties, LLC</u> Street and Apt. No., or PO Box No. <u>PO Box 660082</u> City, State, ZIP+4® <u>Dallas, TX 75266-0082</u> PS Form 3800, April 2015 PSN 7530-02-000-9047 See Reverse for Instructions
7020 0640 0000 9346 7853	U.S. Postal Service™ CERTIFIED MAIL® RECEIPT Domestic Mail Only For delivery information, visit our website at www.usps.com ®. OFFICIAL USE Certified Mail Fee \$ Extra Services & Fees (check box, add fee as appropriate) <input type="checkbox"/> Return Receipt (hardcopy) \$ <input type="checkbox"/> Return Receipt (electronic) \$ <input type="checkbox"/> Certified Mail Restricted Delivery \$ <input type="checkbox"/> Adult Signature Required \$ <input type="checkbox"/> Adult Signature Restricted Delivery \$ Postage \$ Total Postage and Fees \$ Sent To <u>Metropolitan Royalty Corp.</u> Street and Apt. No., or PO Box No. <u>PO Box 975363</u> City, State, ZIP+4® <u>Dallas, TX 75397-9363</u> PS Form 3800, April 2015 PSN 7530-02-000-9047 See Reverse for Instructions
7020 0640 0000 9346 7877	U.S. Postal Service™ CERTIFIED MAIL® RECEIPT Domestic Mail Only For delivery information, visit our website at www.usps.com ®. OFFICIAL USE Certified Mail Fee \$ Extra Services & Fees (check box, add fee as appropriate) <input type="checkbox"/> Return Receipt (hardcopy) \$ <input type="checkbox"/> Return Receipt (electronic) \$ <input type="checkbox"/> Certified Mail Restricted Delivery \$ <input type="checkbox"/> Adult Signature Required \$ <input type="checkbox"/> Adult Signature Restricted Delivery \$ Postage \$ Total Postage and Fees \$ Sent To <u>Michael Herd Moore</u> Street and Apt. No., or PO Box No. <u>PO Box 2398</u> City, State, ZIP+4® <u>Frisco, TX 75034</u> PS Form 3800, April 2015 PSN 7530-02-000-9047 See Reverse for Instructions
7020 0640 0000 9346 8221	U.S. Postal Service™ CERTIFIED MAIL® RECEIPT Domestic Mail Only For delivery information, visit our website at www.usps.com ®. OFFICIAL USE Certified Mail Fee \$ Extra Services & Fees (check box, add fee as appropriate) <input type="checkbox"/> Return Receipt (hardcopy) \$ <input type="checkbox"/> Return Receipt (electronic) \$ <input type="checkbox"/> Certified Mail Restricted Delivery \$ <input type="checkbox"/> Adult Signature Required \$ <input type="checkbox"/> Adult Signature Restricted Delivery \$ Postage \$ Total Postage and Fees \$ Sent To <u>W C Lawrence</u> Street and Apt. No., or PO Box No. <u>PO Box 630</u> City, State, ZIP+4® <u>Santa Fe, NM 87509</u> PS Form 3800, April 2015 PSN 7530-02-000-9047 See Reverse for Instructions
7020 0640 0000 9346 7860	U.S. Postal Service™ CERTIFIED MAIL® RECEIPT Domestic Mail Only For delivery information, visit our website at www.usps.com ®. OFFICIAL USE Certified Mail Fee \$ Extra Services & Fees (check box, add fee as appropriate) <input type="checkbox"/> Return Receipt (hardcopy) \$ <input type="checkbox"/> Return Receipt (electronic) \$ <input type="checkbox"/> Certified Mail Restricted Delivery \$ <input type="checkbox"/> Adult Signature Required \$ <input type="checkbox"/> Adult Signature Restricted Delivery \$ Postage \$ Total Postage and Fees \$ Sent To <u>Mobil Producing TX & NM Inc.</u> Street and Apt. No., or PO Box No. <u>PO Box 731917</u> City, State, ZIP+4® <u>Dallas, TX 75373-1917</u> PS Form 3800, April 2015 PSN 7530-02-000-9047 See Reverse for Instructions
7020 0640 0000 9346 7884	U.S. Postal Service™ CERTIFIED MAIL® RECEIPT Domestic Mail Only For delivery information, visit our website at www.usps.com ®. OFFICIAL USE Certified Mail Fee \$ Extra Services & Fees (check box, add fee as appropriate) <input type="checkbox"/> Return Receipt (hardcopy) \$ <input type="checkbox"/> Return Receipt (electronic) \$ <input type="checkbox"/> Certified Mail Restricted Delivery \$ <input type="checkbox"/> Adult Signature Required \$ <input type="checkbox"/> Adult Signature Restricted Delivery \$ Postage \$ Total Postage and Fees \$ Sent To <u>Clifford Mordhorst</u> Street and Apt. No., or PO Box No. <u>PO Box 4335</u> City, State, ZIP+4® <u>Tulsa, OK 74159</u> PS Form 3800, April 2015 PSN 7530-02-000-9047 See Reverse for Instructions

faeIIoperating

7020 0640 0000 9346 8287	U.S. Postal Service™ CERTIFIED MAIL® RECEIPT Domestic Mail Only For delivery information, visit our website at www.usps.com ®. OFFICIAL USE Certified Mail Fee \$ Extra Services & Fees (check box, add fee as appropriate) <input type="checkbox"/> Return Receipt (hardcopy) \$ <input type="checkbox"/> Return Receipt (electronic) \$ <input type="checkbox"/> Certified Mail Restricted Delivery \$ <input type="checkbox"/> Adult Signature Required \$ <input type="checkbox"/> Adult Signature Restricted Delivery \$ Postage \$ Total Postage and Fees \$ Sent To Matthew L. & Renee G. Pride Trust Street and Apt. No., or PO Box No. PO Box 701950 City, State, ZIP+4® Tulsa, OK 74170-1950 PS Form 3800, April 2015 PSN 7530-02-000-9047 See Reverse for Instructions	7020 0640 0000 9346 7907
7020 0640 0000 9346 7914	U.S. Postal Service™ CERTIFIED MAIL® RECEIPT Domestic Mail Only For delivery information, visit our website at www.usps.com ®. OFFICIAL USE Certified Mail Fee \$ Extra Services & Fees (check box, add fee as appropriate) <input type="checkbox"/> Return Receipt (hardcopy) \$ <input type="checkbox"/> Return Receipt (electronic) \$ <input type="checkbox"/> Certified Mail Restricted Delivery \$ <input type="checkbox"/> Adult Signature Required \$ <input type="checkbox"/> Adult Signature Restricted Delivery \$ Postage \$ Total Postage and Fees \$ Sent To Wyeth Oil Trust Street and Apt. No., or PO Box No. PO Box 13639 City, State, ZIP+4® Arlington, TX 76094 PS Form 3800, April 2015 PSN 7530-02-000-9047 See Reverse for Instructions	7020 0640 0000 9346 7921
7020 0640 0000 9346 7945	U.S. Postal Service™ CERTIFIED MAIL® RECEIPT Domestic Mail Only For delivery information, visit our website at www.usps.com ®. OFFICIAL USE Certified Mail Fee \$ Extra Services & Fees (check box, add fee as appropriate) <input type="checkbox"/> Return Receipt (hardcopy) \$ <input type="checkbox"/> Return Receipt (electronic) \$ <input type="checkbox"/> Certified Mail Restricted Delivery \$ <input type="checkbox"/> Adult Signature Required \$ <input type="checkbox"/> Adult Signature Restricted Delivery \$ Postage \$ Total Postage and Fees \$ Sent To Noble Royalties Access Fund VIII LP Street and Apt. No., or PO Box No. PO Box 660082 City, State, ZIP+4® Dallas, TX 75266-0082 PS Form 3800, April 2015 PSN 7530-02-000-9047 See Reverse for Instructions	7020 0640 0000 9346 7952
	U.S. Postal Service™ CERTIFIED MAIL® RECEIPT Domestic Mail Only For delivery information, visit our website at www.usps.com ®. OFFICIAL USE Certified Mail Fee \$ Extra Services & Fees (check box, add fee as appropriate) <input type="checkbox"/> Return Receipt (hardcopy) \$ <input type="checkbox"/> Return Receipt (electronic) \$ <input type="checkbox"/> Certified Mail Restricted Delivery \$ <input type="checkbox"/> Adult Signature Required \$ <input type="checkbox"/> Adult Signature Restricted Delivery \$ Postage \$ Total Postage and Fees \$ Sent To Jimmy D Morey Trust Street and Apt. No., or PO Box No. PO Box 99034 City, State, ZIP+4® Ft. Worth, TX 76199-0034 PS Form 3800, April 2015 PSN 7530-02-000-9047 See Reverse for Instructions	
	U.S. Postal Service™ CERTIFIED MAIL® RECEIPT Domestic Mail Only For delivery information, visit our website at www.usps.com ®. OFFICIAL USE Certified Mail Fee \$ Extra Services & Fees (check box, add fee as appropriate) <input type="checkbox"/> Return Receipt (hardcopy) \$ <input type="checkbox"/> Return Receipt (electronic) \$ <input type="checkbox"/> Certified Mail Restricted Delivery \$ <input type="checkbox"/> Adult Signature Required \$ <input type="checkbox"/> Adult Signature Restricted Delivery \$ Postage \$ Total Postage and Fees \$ Sent To New Mexico Western Minerals Street and Apt. No., or PO Box No. PO Box 1738 City, State, ZIP+4® Roswell, NM 88202 PS Form 3800, April 2015 PSN 7530-02-000-9047 See Reverse for Instructions	
	U.S. Postal Service™ CERTIFIED MAIL® RECEIPT Domestic Mail Only For delivery information, visit our website at www.usps.com ®. OFFICIAL USE Certified Mail Fee \$ Extra Services & Fees (check box, add fee as appropriate) <input type="checkbox"/> Return Receipt (hardcopy) \$ <input type="checkbox"/> Return Receipt (electronic) \$ <input type="checkbox"/> Certified Mail Restricted Delivery \$ <input type="checkbox"/> Adult Signature Required \$ <input type="checkbox"/> Adult Signature Restricted Delivery \$ Postage \$ Total Postage and Fees \$ Sent To Noble Royalties Inc. Street and Apt. No., or PO Box No. PO Box 660082 City, State, ZIP+4® Dallas, TX 75266-0082 PS Form 3800, April 2015 PSN 7530-02-000-9047 See Reverse for Instructions	

faeIloperating

7020 0640 0000 9346 7983

**U.S. Postal Service™
CERTIFIED MAIL® RECEIPT**
Domestic Mail Only

For delivery information, visit our website at www.usps.com®.

OFFICIAL USE

Certified Mail Fee
\$

Extra Services & Fees (check box, add fee as appropriate)
☐ Return Receipt (hardcopy) \$
☐ Return Receipt (electronic) \$
☐ Certified Mail Restricted Delivery \$
☐ Adult Signature Required \$
☐ Adult Signature Restricted Delivery \$

Postage
\$

Total Postage and Fees
\$

Sent To
Dan Mordhorst Trust
PO Box 4335
Tulsa, OK 74159-0335

PS Form 3800, April 2015 PSN 7530-02-000-9047 See Reverse for Instructions

7020 0640 0000 9346 7990

**U.S. Postal Service™
CERTIFIED MAIL® RECEIPT**
Domestic Mail Only

For delivery information, visit our website at www.usps.com®.

OFFICIAL USE

Certified Mail Fee
\$

Extra Services & Fees (check box, add fee as appropriate)
☐ Return Receipt (hardcopy) \$
☐ Return Receipt (electronic) \$
☐ Certified Mail Restricted Delivery \$
☐ Adult Signature Required \$
☐ Adult Signature Restricted Delivery \$

Postage
\$

Total Postage and Fees
\$

Sent To
Sappington Energy Interest Ltd.
PO Box 19160
Houston, TX 77224-9160

PS Form 3800, April 2015 PSN 7530-02-000-9047 See Reverse for Instructions

7020 0090 0000 6900 0236

**U.S. Postal Service™
CERTIFIED MAIL® RECEIPT**
Domestic Mail Only

For delivery information, visit our website at www.usps.com®.

OFFICIAL USE

Certified Mail Fee
\$

Extra Services & Fees (check box, add fee as appropriate)
☐ Return Receipt (hardcopy) \$
☐ Return Receipt (electronic) \$
☐ Certified Mail Restricted Delivery \$
☐ Adult Signature Required \$
☐ Adult Signature Restricted Delivery \$

Postage
\$

Total Postage and Fees
\$

Sent To
Avin Luskey
113 N. Houston St.
Ft. Worth, TX 76164

PS Form 3800, April 2015 PSN 7530-02-000-9047 See Reverse for Instructions

7020 0640 0000 9346 8003

**U.S. Postal Service™
CERTIFIED MAIL® RECEIPT**
Domestic Mail Only

For delivery information, visit our website at www.usps.com®.

OFFICIAL USE

Certified Mail Fee
\$

Extra Services & Fees (check box, add fee as appropriate)
☐ Return Receipt (hardcopy) \$
☐ Return Receipt (electronic) \$
☐ Certified Mail Restricted Delivery \$
☐ Adult Signature Required \$
☐ Adult Signature Restricted Delivery \$

Postage
\$

Total Postage and Fees
\$

Sent To
Shelley Luskey Trust
21185 Toll Gate Road
Saratoa, CA 95070

PS Form 3800, April 2015 PSN 7530-02-000-9047 See Reverse for Instructions

7020 0640 0000 9346 8010

**U.S. Postal Service™
CERTIFIED MAIL® RECEIPT**
Domestic Mail Only

For delivery information, visit our website at www.usps.com®.

OFFICIAL USE

Certified Mail Fee
\$

Extra Services & Fees (check box, add fee as appropriate)
☐ Return Receipt (hardcopy) \$
☐ Return Receipt (electronic) \$
☐ Certified Mail Restricted Delivery \$
☐ Adult Signature Required \$
☐ Adult Signature Restricted Delivery \$

Postage
\$

Total Postage and Fees
\$

Sent To
Texas Presbyterian Foundation
PO Box 3480
Omaha, NE 68103-0480

PS Form 3800, April 2015 PSN 7530-02-000-9047 See Reverse for Instructions

7020 0640 0000 9346 8027

**U.S. Postal Service™
CERTIFIED MAIL® RECEIPT**
Domestic Mail Only

For delivery information, visit our website at www.usps.com®.

OFFICIAL USE

Certified Mail Fee
\$

Extra Services & Fees (check box, add fee as appropriate)
☐ Return Receipt (hardcopy) \$
☐ Return Receipt (electronic) \$
☐ Certified Mail Restricted Delivery \$
☐ Adult Signature Required \$
☐ Adult Signature Restricted Delivery \$

Postage
\$

Total Postage and Fees
\$

Sent To
Trinity University
700 Frost PO Box 27
San Antonio, TX 78291-0027

PS Form 3800, April 2015 PSN 7530-02-000-9047 See Reverse for Instructions

faeIloperating

7020 0640 0000 9346 8034

**U.S. Postal Service™
CERTIFIED MAIL® RECEIPT**
Domestic Mail Only

For delivery information, visit our website at www.usps.com®.

OFFICIAL USE

Certified Mail Fee
\$

Extra Services & Fees (check box, add fee as appropriate)
☐ Return Receipt (hardcopy) \$
☐ Return Receipt (electronic) \$
☐ Certified Mail Restricted Delivery \$
☐ Adult Signature Required \$
☐ Adult Signature Restricted Delivery \$

Postage
\$

Total Postage and Fees
\$

Sent To
 Street and Apt. No., or PO Box No.
 McWhorter Trust
 6140 East Voltair Ave.
 City, State, ZIP+4®
 Scottsdale, AZ 85254

PS Form 3800, April 2015 PSN 7530-02-000-9047 See Reverse for Instructions

7020 0640 0000 9346 804J

**U.S. Postal Service™
CERTIFIED MAIL® RECEIPT**
Domestic Mail Only

For delivery information, visit our website at www.usps.com®.

OFFICIAL USE

Certified Mail Fee
\$

Extra Services & Fees (check box, add fee as appropriate)
☐ Return Receipt (hardcopy) \$
☐ Return Receipt (electronic) \$
☐ Certified Mail Restricted Delivery \$
☐ Adult Signature Required \$
☐ Adult Signature Restricted Delivery \$

Postage
\$

Total Postage and Fees
\$

Sent To
 Street and Apt. No., or PO Box No.
 White Star Energy, Inc.
 PO Box 51108
 City, State, ZIP+4®
 Midland, TX 79710

PS Form 3800, April 2015 PSN 7530-02-000-9047 See Reverse for Instructions

7020 0090 0000 6900 1372

**U.S. Postal Service™
CERTIFIED MAIL® RECEIPT**
Domestic Mail Only

For delivery information, visit our website at www.usps.com®.

OFFICIAL USE

Certified Mail Fee
\$

Extra Services & Fees (check box, add fee as appropriate)
☐ Return Receipt (hardcopy) \$
☐ Return Receipt (electronic) \$
☐ Certified Mail Restricted Delivery \$
☐ Adult Signature Required \$
☐ Adult Signature Restricted Delivery \$

Postage
\$

Total Postage and Fees
\$

Sent To
 Street and Apt. No., or PO Box No.
 John G Akin Trust
 5350 Shawnee Rd. Ste. 101 B
 City, State, ZIP+4®
 Alexandria, VA 22312

PS Form 3800, April 2015 PSN 7530-02-000-9047 See Reverse for Instructions

7020 0090 0000 6900 0054

**U.S. Postal Service™
CERTIFIED MAIL® RECEIPT**
Domestic Mail Only

For delivery information, visit our website at www.usps.com®.

OFFICIAL USE

Certified Mail Fee
\$

Extra Services & Fees (check box, add fee as appropriate)
☐ Return Receipt (hardcopy) \$
☐ Return Receipt (electronic) \$
☐ Certified Mail Restricted Delivery \$
☐ Adult Signature Required \$
☐ Adult Signature Restricted Delivery \$

Postage
\$

Total Postage and Fees
\$

Sent To
 Street and Apt. No., or PO Box No.
 Davis A. Coppedge
 PO Box 1858
 City, State, ZIP+4®
 Pottsboro, TX 75076

PS Form 3800, April 2015 PSN 7530-02-000-9047 See Reverse for Instructions

7020 0640 0000 9346 8058

**U.S. Postal Service™
CERTIFIED MAIL® RECEIPT**
Domestic Mail Only

For delivery information, visit our website at www.usps.com®.

OFFICIAL USE

Certified Mail Fee
\$3.55

Extra Services & Fees (check box, add fee as appropriate)
☐ Return Receipt (hardcopy) \$2.25
☐ Return Receipt (electronic) \$0.00
☐ Certified Mail Restricted Delivery \$0.00
☐ Adult Signature Required \$0.00
☐ Adult Signature Restricted Delivery \$0.00

Postage
\$0.70

Total Postage and Fees
\$7.10

Sent To
 Street and Apt. No., or PO Box No.
 Andrea Colleen Wiggins
 PO Box 5305
 City, State, ZIP+4®
 Austin, TX 78763-5305

PS Form 3800, April 2015 PSN 7530-02-000-9047 See Reverse for Instructions

7020 0640 0000 9346 8065

**U.S. Postal Service™
CERTIFIED MAIL® RECEIPT**
Domestic Mail Only

For delivery information, visit our website at www.usps.com®.

OFFICIAL USE

Certified Mail Fee
\$

Extra Services & Fees (check box, add fee as appropriate)
☐ Return Receipt (hardcopy) \$
☐ Return Receipt (electronic) \$
☐ Certified Mail Restricted Delivery \$
☐ Adult Signature Required \$
☐ Adult Signature Restricted Delivery \$

Postage
\$

Total Postage and Fees
\$

Sent To
 Street and Apt. No., or PO Box No.
 Charles R Wiggins
 PO Box 10862
 City, State, ZIP+4®
 Midland, TX 79702

PS Form 3800, April 2015 PSN 7530-02-000-9047 See Reverse for Instructions

faeIloperating

7020 0640 0000 9346 8096	U.S. Postal Service™ CERTIFIED MAIL® RECEIPT Domestic Mail Only For delivery information, visit our website at www.usps.com ®. OFFICIAL USE Certified Mail Fee \$ Extra Services & Fees (check box, add fee as appropriate) <input type="checkbox"/> Return Receipt (hardcopy) \$ <input type="checkbox"/> Return Receipt (electronic) \$ <input type="checkbox"/> Certified Mail Restricted Delivery \$ <input type="checkbox"/> Adult Signature Required \$ <input type="checkbox"/> Adult Signature Restricted Delivery \$ Postage \$ Total Postage and Fees \$ Sent To ZPE Delaware, LLC Street and Apt. No., or PO Box No. PO Box 840133 City, State, ZIP+4® Dallas, TX 75284-0133 PS Form 3800, April 2015 PSN 7530-02-000-9047 See Reverse for Instructions
7020 0640 0000 9346 8102	U.S. Postal Service™ CERTIFIED MAIL® RECEIPT Domestic Mail Only For delivery information, visit our website at www.usps.com ®. OFFICIAL USE Certified Mail Fee \$ Extra Services & Fees (check box, add fee as appropriate) <input type="checkbox"/> Return Receipt (hardcopy) \$ <input type="checkbox"/> Return Receipt (electronic) \$ <input type="checkbox"/> Certified Mail Restricted Delivery \$ <input type="checkbox"/> Adult Signature Required \$ <input type="checkbox"/> Adult Signature Restricted Delivery \$ Postage \$ Total Postage and Fees \$ Sent To The McDaniel Company Street and Apt. No., or PO Box No. 12900 Preston Road, Ste. 415 City, State, ZIP+4® Dallas, TX 75231 PS Form 3800, April 2015 PSN 7530-02-000-9047 See Reverse for Instructions
7020 0640 0000 9346 8119	U.S. Postal Service™ CERTIFIED MAIL® RECEIPT Domestic Mail Only For delivery information, visit our website at www.usps.com ®. OFFICIAL USE Certified Mail Fee \$ Extra Services & Fees (check box, add fee as appropriate) <input type="checkbox"/> Return Receipt (hardcopy) \$ <input type="checkbox"/> Return Receipt (electronic) \$ <input type="checkbox"/> Certified Mail Restricted Delivery \$ <input type="checkbox"/> Adult Signature Required \$ <input type="checkbox"/> Adult Signature Restricted Delivery \$ Postage \$ Total Postage and Fees \$ Sent To Mariam Energy, LLC Street and Apt. No., or PO Box No. 10440 N. Central Expressway Ste. 1010 City, State, ZIP+4® Dallas, TX 75231 PS Form 3800, April 2015 PSN 7530-02-000-9047 See Reverse for Instructions
7020 0640 0000 9346 8126	U.S. Postal Service™ CERTIFIED MAIL® RECEIPT Domestic Mail Only For delivery information, visit our website at www.usps.com ®. OFFICIAL USE Certified Mail Fee \$ Extra Services & Fees (check box, add fee as appropriate) <input type="checkbox"/> Return Receipt (hardcopy) \$ <input type="checkbox"/> Return Receipt (electronic) \$ <input type="checkbox"/> Certified Mail Restricted Delivery \$ <input type="checkbox"/> Adult Signature Required \$ <input type="checkbox"/> Adult Signature Restricted Delivery \$ Postage \$ Total Postage and Fees \$ Sent To John F. Special Street and Apt. No., or PO Box No. P.O. Box 369 City, State, ZIP+4® Stillwater, OK 74076 PS Form 3800, April 2015 PSN 7530-02-000-9047 See Reverse for Instructions
7020 0640 0000 9346 8126	U.S. Postal Service™ CERTIFIED MAIL® RECEIPT Domestic Mail Only For delivery information, visit our website at www.usps.com ®. OFFICIAL USE Certified Mail Fee \$ Extra Services & Fees (check box, add fee as appropriate) <input type="checkbox"/> Return Receipt (hardcopy) \$ <input type="checkbox"/> Return Receipt (electronic) \$ <input type="checkbox"/> Certified Mail Restricted Delivery \$ <input type="checkbox"/> Adult Signature Required \$ <input type="checkbox"/> Adult Signature Restricted Delivery \$ Postage \$ Total Postage and Fees \$ Sent To Milagro Resources, LP Street and Apt. No., or PO Box No. 415 West Wall Avenue, Ste. 118 City, State, ZIP+4® Midland, TX 79701 PS Form 3800, April 2015 PSN 7530-02-000-9047 See Reverse for Instructions

Affidavit of Publication

STATE OF NEW MEXICO
COUNTY OF LEA

I, Daniel Russell, Publisher of the Hobbs News-Sun, a newspaper published at Hobbs, New Mexico, solemnly swear that the clipping attached hereto was published in the regular and entire issue of said newspaper, and not a supplement thereof for a period of 1 issue(s).

Beginning with the issue dated
December 11, 2020
and ending with the issue dated
December 11, 2020.



Publisher

Sworn and subscribed to before me this
11th day of December 2020.

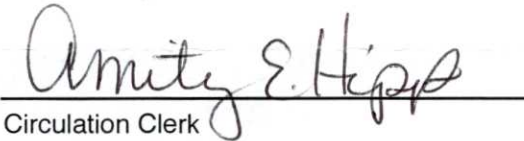

Circulation Clerk

My commission expires
October 29, 2022
(Seal)

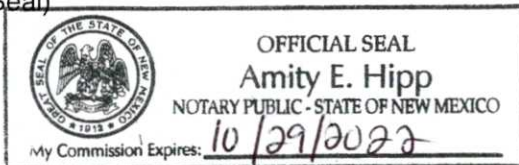

This newspaper is duly qualified to publish legal notices or advertisements within the meaning of Section 3, Chapter 167, Laws of 1937 and payment of fees for said



67115951

00249208

MARITZA SANTANA
FORTY ACRES ENERGY
11757 KATY FREEWAY SUITE 1000
HOUSTON, TX 77079

Well Name(s)	Ownership Type	Name	Address	Tracking #
Sholes B 30 #3, Winningham #9	Working	FAE II Operating LLC	11757 Katy Fwy Ste. 1000 Houston,TX 77079-1762	N/A
Winningham #9	Working	31 Group	PO Box 1706 Rockwall, TX 75087	7020 0090 0000 6900 1341
Winningham #9	Royalty	James William Akin, Trustee	5350 Shawnee Road Ste. 101 B Alexandria, VA 22312	7020 0090 0000 6900 1358
Winningham #9	Royalty	John G Akin Trust	5350 Shawnee Road Ste. 101 B Alexandria, VA 22312	7020 0090 0000 6900 1372
Winningham #9	Royalty	C/O Stephen M A Slough PLLC CPA Ann D Allison	PO Box 64035 Lubbock, TX 79464	7020 0090 0000 6900 1389
Winningham #9	Royalty	Carla Beren Trust	3713 Edgestone Drive Plano, TX 75093	7020 0090 0000 6900 0030
Winningham #9	Royalty	Clear Fork Minerals LLC	309 W. 7th St. Ste. 500 Ft. Worth, TX 76102	7020 0090 0000 6900 0047
Winningham #9	Royalty	Davis A Coppedge	PO Box 1858 Pottsboro, TX 75076	7020 0090 0000 0054
Winningham #9	Royalty	James T & Virginia L Coppedge	PO Box 43 Spencer, IN 47460	7020 0090 0000 6900 0061
Winningham #9	Royalty	Corrigan Southern Land & Cattle Company, LLC	8117 Preston Road Ste. 610 Dallas, TX 75225	7020 0090 0000 6900 0078
Winningham #9	Royalty	Sue Hess Edmonson	6511 Morningside Drive Houston, TX 77030-1919	7020 0090 0000 6900 0085
Winningham #9	Royalty	Thomas Martin Ellison	PO Box 206 Volcano, CA 95689	7020 0090 0000 6900 0092
Winningham #9	Royalty	Mary Fountaine	1133 Oakhurst Drive Broomfield, CO 80020	7020 0090 0000 6900 0122
Winningham #9	Royalty	Stanley Erb Hess	PO Box 1982 Coeur D'Alene, ID 83816-1908	7020 0090 0000 6900 0139
Winningham #9	Royalty	Maura Smyrl Jennings	1810 S Breton Place Tucson, AZ 85748	7020 0090 0000 6900 0146
Winningham #9	Royalty	Tate Byrne Jennings	3535 23rd Street Boulder, CO 80304	7020 0090 0000 6900 0153
Winningham #9	Royalty	Clarence W Johnson	HC 1 Box 46 Coalinga, CA 93210	7020 0090 0000 6900 0160
Winningham #9	Royalty	Peter Francis Jones	15 Eastwind #9 Marina Del Rey, CA 90292	7020 0090 0000 6900 0177
Winningham #9	Royalty	Wendelin E Jones	17416 Wildrye Drive Austin, TX 78738	7020 0090 0000 6900 0184
Winningham #9	Royalty	Reneta A Dymesich, Conservator J Pat Corrigan Family Limited Partnership	7150 20th St. Ste. E Vero Beach, FL 32966	7020 0090 0000 6900 0191
Winningham #9	Royalty	Kenneth N Headley	1040 Levy Ogden, UT 84201-0010	7020 0090 0000 6900 0207
Winningham #9	Royalty	Marilyn M Law Revocable Trust	PO Box 1588 Tulsa, OK 74101	7020 0090 0000 6900 0214
Winningham #9	Royalty	C/O BOKF NA Agent W C Lawrence	PO Box 630 Santa Fe, NM 87509	7020 0090 0000 6900 0221
Winningham #9	Royalty	Alvin Luskey.	113 N. Houston St. Fort Worth, TX 76164	7020 0090 0000 6900 0238
Winningham #9	Royalty	David Luskey Estate	6509 Valencia Grove Pass Ft. Worth, TX 76132	7020 0090 0000 6900 0245
Winningham #9	Royalty	Idelle Luskey, Indep. Executrix Luskey Living Trust	95 Skidaway Island Park Road #311 Savannah, GA 31411	7020 0640 0000 9346 8294
Winningham #9	Royalty	Bernice Luskey, Trustee Mary J McWhorter Trust	PO Box 1087 Medford, OR 97520	7020 0090 0000 6900 0269
Winningham #9	Overriding Royalty	James R McWhorter, Trustee Larry Bond	3501 French Park Drive, Suite G Edmond, OK 73034	7020 0640 0000 9346 8140
Winningham #9	Overriding Royalty	Jimmie Eden Jr. Trust	P.O. Box 17 Stillwater, OK 74076	7020 0640 0000 9346 8157
Winningham #9	Overriding Royalty	Legat LLC	6114 W. Canterbury Drive Stillwater, OK 74074	7020 0640 0000 9346 8164
Winningham #9	Royalty	Metropolitan Royalty Corp.	PO Box 975363 Dallas, TX 75397-5363	7020 0640 0000 9346 7853
Winningham #9	Royalty	C/O Mary Stuart Gephart Mobil Producing TX & NM Inc.	PO Box 731917 Dallas, TX 75373-1917	7020 0640 0000 9346 7860
Winningham #9	Royalty	C/O XTO Energy Inc. Michael Herd Moore	PO Box 2398 Frisco, TX 75034	7020 0640 0000 9346 7877
Winningham #9	Royalty	Clifford Mordhorst	PO Box 4335 Tulsa, OK 74159	7020 0640 0000 9346 7884
Winningham #9	Royalty	Derek Mordhorst	PO Box 4335 Tulsa, OK 74159	7020 0640 0000 9346 7891
Winningham #9	Royalty	Jimmy D Morey Trust	PO Box 99084	7020 0640 0000 9346 7907

Winningham #9	Royalty	C/O JP Morgan Chase Bank NA Trustee Lyeth Oil Irrevocable Trust	Fort Worth, TX 76199-0084 PO Box 13639	7020 0640 0000 9346 7914
Winningham #9	Royalty	C/O Kanaly Trust Company New Mexico Western Minerals	Arlington, TX 76094 PO Box 1738	7020 0640 0000 9346 7921
Winningham #9	Royalty	Noble Royalties Access Fund VII LP	Roswell, NM 88202 PO Box 660082	7020 0640 0000 9346 7938
Winningham #9	Royalty	Noble Royalties Access Fund VIII LP	Dallas, TX 75266-0082 PO Box 660082	7020 0640 0000 9346 7945
Winningham #9	Royalty	Noble Royalties Inc.	Dallas, TX 75266-0082 PO Box 660082	7020 0640 0000 9346 7952
Winningham #9	Royalty	Onez Norman Rooney Test Trust James Michael Morey, Trustee C/O D Craig Story	Dallas, TX 75266-0082 PO Box 960031	7020 0640 0000 9346 7969
Winningham #9	Royalty	John W & Cynthia J Pride Rev. Trust	Oklahoma City, OK 73196-0001 PO Box 701950	7020 0640 0000 9346 7976
Winningham #9	Royalty	Matthew L & Renee G Pride Rev. Trust	Tulsa, OK 74170-1950 PO Box 701950	7020 0640 0000 9346 8287
Winningham #9	Royalty	Dan Mordhorst Rev. Trust Dan Mordhorst, Trustee	Tulsa, OK 74170-1950 PO Box 4335	7020 0640 0000 9346 7983
Winningham #9	Royalty	Sappington Energy Interest Ltd.	Tulsa, OK 74159-0335 PO Box 19160	7020 0640 0000 9346 7990
Winningham #9	Royalty	Shelley Luskey Trust	Houston, TX 77224-9160 21185 Toll Gate Road	7020 0640 0000 9346 8003
Winningham #9	Royalty	Texas Presbyterian Foundation Farmers National CO Agent Oil & Gas Dept.	Saratoga, CA 95070 PO Box 3480	7020 0640 0000 9346 8010
Winningham #9	Royalty	Trinity University C/O Frost National Bank	Omaha, NE 68103-0480 PO Box 27	7020 0640 0000 9346 8027
Winningham #9	Royalty	McWhorter Living Trust	San Antonio, TX 78291-0027 6140 East Voltaire Ave.	7020 0640 0000 9346 8034
Winningham #9	Royalty	White Star Energy, Inc.	Scottsdale, AZ 85254 PO Box 51108	7020 0640 0000 9346 8041
Winningham #9	Royalty	Andrea Colleen Wiggins	Midland, TX 79710 PO Box 5305	7020 0640 0000 9346 8058
Winningham #9	Royalty	Charles R Wiggins	Austin, TX 78763-5305 PO Box 10862	7020 0640 0000 9346 8065
Winningham #9	Royalty	Robert R Winningham	Midland, TX 79702 PO Box 1124	7020 0640 0000 9346 8072
Winningham #9	Royalty	Windom Royalties, LLC	Allen, TX 75013 PO Box 660082	7020 0640 0000 9346 8089
Winningham #9	Royalty	ZPZ Delaware I LLC	Dallas, TX 75266-0082 PO Box 840133	7020 0640 0000 9346 8096
Winningham #9	Overriding Royalty	The McDaniel Company	Dallas, TX 75284-0133 12900 Preston Road, Suite 415	7020 0640 0000 9346 8102
Winningham #9	Overriding Royalty	Marjam Energy, LLC	Dallas, TX 75231 10440 N. Central Express Way, Suite 10	7020 0640 0000 9346 8119
Winningham #9	Overriding Royalty	Milagro Resources, LP	Dallas, TX 75231 415 West Wall Avenue, Suite 1118	7020 0640 0000 9346 8126
Winningham #9	Overriding Royalty	John F. Special	Midland, TX 79701 P.O. Box 369	7020 0640 0000 9346 8133
Sholes B 30 #3	Royalty	Department of Interior	Stillwater, OK 74076 PO Box 5810	7020 0640 0000 9346 8171
			Denver, CO 80217-5810	

SENDER: COMPLETE THIS SECTION	COMPLETE THIS SECTION ON DELIVERY
<ul style="list-style-type: none">■ Complete items 1, 2, and 3.■ Print your name and address on the reverse so that we can return the card to you.■ Attach this card to the back of the mailpiece, or on the front if space permits.	<p>A. Signature x R Duran <input type="checkbox"/> Agent <input checked="" type="checkbox"/> Addressee</p>
1. Article Addressed to: BLM - New Mexico State Office 301 Dinosaur Trail Santa Fe, NM 87508	B. Received by (Printed Name) Regina Duran
	C. Date of Delivery 6-14-21
	D. Is delivery address different from item 1? <input type="checkbox"/> Yes If YES, enter delivery address below: <input type="checkbox"/> No
2. Article Number (Transfer from service label) 7020 0640 0000 9346 5545	3. Service Type <input type="checkbox"/> Adult Signature <input type="checkbox"/> Adult Signature Restricted Delivery <input type="checkbox"/> Certified Mail® <input type="checkbox"/> Certified Mail Restricted Delivery <input type="checkbox"/> Collect on Delivery <input type="checkbox"/> Collect on Delivery Restricted Delivery <input type="checkbox"/> Registered Mail <input type="checkbox"/> Registered Mail Restricted Delivery (over \$500)
	<input type="checkbox"/> Priority Mail Express® <input type="checkbox"/> Registered Mail™ <input type="checkbox"/> Registered Mail Restricted Delivery <input type="checkbox"/> Signature Confirmation™ <input type="checkbox"/> Signature Confirmation Restricted Delivery

PS Form 3811, July 2020 PSN 7530-02-000-9053

Domestic Return Receipt

From: [Engineer, OCD, EMNRD](#)
To: [Marshall Bates](#)
Cc: [McClure, Dean, EMNRD](#); [Simmons, Kurt, EMNRD](#); [Bratcher, Mike, EMNRD](#); [Kautz, Paul, EMNRD](#); [Hawkins, James, EMNRD](#); [Powell, Brandon, EMNRD](#); [lisa@rwbyram.com](#); [Glover, James](#); [Paradis, Kyle O](#); [Walls, Christopher](#)
Subject: Approved Administrative Order PLC-714
Date: Friday, July 2, 2021 5:24:39 PM
Attachments: [PLC714 Order.pdf](#)

NMOCD has issued Administrative Order PLC-714 which authorizes FAE II Operating, LLC (329326) to surface commingle or off-lease measure, as applicable, the following wells:

Well API	Well Name	Location (NMPM)	Pool Code
30-025-35223	Sholes B 30 #3	E-30-25S-37E	33820
30-025-28637	Winningham #9	B-30-25S-37E	79240 37240

The administrative order is attached to this email and can also be found online at OCD Imaging.

Please review the content of the order to ensure you are familiar with the authorities granted and any conditions of approval. If you have any questions regarding this matter, please contact me.

Dean McClure
Petroleum Engineer, Oil Conservation Division
New Mexico Energy, Minerals and Natural Resources Department
(505) 469-8211

State of New Mexico
Energy, Minerals and Natural Resources Department

Notice

Order: **PLC-714**

Operator: **FAE II Operating, LLC (329326)**

Publication Date: **12/11/2020**

Date Sent: **On or Prior to 11/4/2020**

Noticed Persons

Date	Person	Certified Tracking Number	Status
11/4/2020	31 Group	7020 0090 0000 6900 1341	Delivered
11/6/2020	James William Akin, Trustee	7020 0090 0000 6900 1358	Alert
11/6/2020	John G Akin Trust	7020 0090 0000 6900 1372	Alert
11/9/2020	Ann D Allison	7020 0090 0000 6900 1389	Delivered
11/5/2020	Carla Beren Trust	7020 0090 0000 6900 0030	Delivered
11/16/2020	Clear Fork Minerals LLC	7020 0090 0000 6900 0047	Returned
11/24/2020	Davis A Coppedge	7020 0090 0000 6900 0054	Delivered
11/5/2020	James T & Virginia L Coppedge	7020 0090 0000 6900 0061	Delivered
11/13/2020	Corrigan Southern Land & Cattle Company, LLC	7020 0090 0000 6900 0078	Alert
11/16/2020	Sue Hess Edmonson	7020 0090 0000 6900 0085	Delivered
11/6/2020	Thomas Martin Ellison	7020 0090 0000 6900 0092	Delivered
11/7/2020	Mary Fountaine	7020 0090 0000 6900 0122	Delivered
11/6/2020	Stanley Erb Hess	7020 0090 0000 6900 0139	Delivered
11/5/2020	Maura Smyrl Jennings	7020 0090 0000 6900 0146	Delivered
11/12/2020	Tate Byrne Jennings	7020 0090 0000 6900 0153	Delivered
11/13/2020	Clarence W Johnson	7020 0090 0000 6900 0160	Delivered
12/2/2020	Peter Francis Jones	7020 0090 0000 6900 0177	In-Transit
11/5/2020	Wendelin E Jones	7020 0090 0000 6900 0184	Delivered
11/5/2020	J Pat Corrigan Family Limited Partnership	7020 0090 0000 6900 0191	Delivered
11/5/2020	Kenneth N Headley	7020 0090 0000 6900 0207	Delivered
11/9/2020	Marilyn M Law Revocable Trust	7020 0090 0000 6900 0214	Delivered
11/5/2020	W C Lawrence	7020 0090 0000 6900 0221	Delivered
11/4/2020	Alvin Luskey.	7020 0090 0000 6900 0238	Delivered
12/17/2020	David Luskey Estate	7020 0090 0000 6900 0245	Returned
11/10/2020	Luskey Living Trust	7020 0640 0000 9346 8294	Delivered
11/21/2020	Mary J McWhorter Trust	7020 0090 0000 6900 0269	Returned
12/10/2020	Larry Bond	7020 0640 0000 9346 8140	Returned
11/12/2020	Jimmie Eden Jr. Trust	7020 0640 0000 9346 8157	Delivered
11/5/2020	Legat LLC	7020 0640 0000 9346 8164	Delivered
11/4/2020	Metropolitan Royalty Corp.	7020 0640 0000 9346 7853	Delivered
11/4/2020	Mobil Producing TX & NM Inc.	7020 0640 0000 9346 7860	Delivered
3/1/2021	Michael Herd Moore	7020 0640 0000 9346 7877	Returned
11/5/2020	Clifford Mordhorst	7020 0640 0000 9346 7884	Delivered
11/5/2020	Derek Mordhorst	7020 0640 0000 9346 7891	Delivered
11/6/2020	Jimmy D Morey Trust	7020 0640 0000 9346 7907	Delivered
11/13/2020	Lyeth Oil Irrevocable Trust	7020 0640 0000 9346 7914	Delivered
11/12/2020	New Mexico Western Minerals	7020 0640 0000 9346 7921	Returned

11/4/2020	Noble Royalties Access Fund VII LP	7020 0640 0000 9346 7938	Delivered
11/5/2020	Noble Royalties Access Fund VIII LP	7020 0640 0000 9346 7945	Delivered
11/4/2020	Noble Royalties Inc.	7020 0640 0000 9346 7952	Delivered
11/5/2020	Onez Norman Rooney Test Trust	7020 0640 0000 9346 7969	Delivered
11/5/2020	John W & Cynthia J Pride Rev. Trust	7020 0640 0000 9346 7976	Delivered
11/5/2020	Matthew L & Renee G Pride Rev. Trust	7020 0640 0000 9346 8287	Delivered
11/5/2020	Dan Mordhorst Rev. Trust	7020 0640 0000 9346 7983	Delivered
11/3/2020	Sappington Energy Interest Ltd.	7020 0640 0000 9346 7990	Delivered
12/1/2020	Shelley Luskey Trust	7020 0640 0000 9346 8003	Delivered
11/6/2020	Texas Presbyterian Foundation	7020 0640 0000 9346 8010	Delivered
11/6/2020	Trinity University	7020 0640 0000 9346 8027	Delivered
11/5/2020	McWhorter Living Trust	7020 0640 0000 9346 8034	Delivered
11/9/2020	White Star Energy, Inc.	7020 0640 0000 9346 8041	Delivered
1/29/2021	Andrea Colleen Wiggins	7020 0640 0000 9346 8058	Delivered
11/9/2020	Charles R Wiggins	7020 0640 0000 9346 8065	Delivered
12/21/2020	Robert R Winningham	7020 0640 0000 9346 8072	Returned
11/4/2020	Windom Royalties, LLC	7020 0640 0000 9346 8089	Delivered
11/4/2020	ZPZ Delaware I LLC	7020 0640 0000 9346 8096	Delivered
11/4/2020	The McDaniel Company	7020 0640 0000 9346 8102	Delivered
11/5/2020	Marjam Energy, LLC	7020 0640 0000 9346 8119	Delivered
11/11/2020	Milagro Resources, LP	7020 0640 0000 9346 8126	In-Transit
11/6/2020	John F. Special	7020 0640 0000 9346 8133	Delivered
12/18/2020	Department of Interior	7020 0640 0000 9346 8171	Returned

**\STATE OF NEW MEXICO
ENERGY, MINERALS AND NATURAL RESOURCES DEPARTMENT
OIL CONSERVATION DIVISION**

**APPLICATION FOR SURFACE COMMINGLING
SUBMITTED BY FAE II OPERATING, LLC**

ORDER NO. PLC-714

ORDER

The Director of the New Mexico Oil Conservation Division (“OCD”), having considered the application and the recommendation of the OCD Engineering Bureau, issues the following Order.

FINDINGS OF FACT

1. FAE II Operating, LLC (“Applicant”) submitted a complete application to surface commingle the oil and gas production from the pools, leases, and wells identified in Exhibit A (“Application”).
2. Applicant proposed a method to allocate the oil and gas production to the pools, leases, and wells to be commingled.
3. To the extent that ownership is identical, Applicant submitted a certification by a licensed attorney or qualified petroleum landman that the ownership in the pools, leases, and wells to be commingled is identical as defined in 19.15.12.7(B) NMAC.
4. To the extent that ownership is diverse, Applicant provided notice of the Application to all persons owning an interest in the oil and gas production to be commingled, including the owners of royalty and overriding royalty interests, regardless of whether they have a right or option to take their interests in kind, and those persons either submitted a written waiver or did not file an objection to the Application.
5. Applicant provided notice of the Application to the Bureau of Land Management (“BLM”) or New Mexico State Land Office (“NMSLO”), as applicable.
6. Applicant certified the commingling of oil and gas production from the pools, leases, and wells will not in reasonable probability reduce the value of the oil and gas production to less than if it had remained segregated.

CONCLUSIONS OF LAW

7. OCD has jurisdiction to issue this Order pursuant to the Oil and Gas Act, NMSA 1978, §§ 70-2-6, 70-2-11, 70-2-12, 70-2-16, and 70-2-17, 19.15.12 NMAC, and 19.15.23 NMAC.
8. Applicant satisfied the notice requirements for the Application in accordance with 19.15.12.10(A)(2), (C)(4)(c), and (C)(4)(e) NMAC, as applicable.
9. Applicant satisfied the notice requirements for the Application in accordance with 19.15.23.9(A)(5) and (6) NMAC, as applicable.

10. Applicant's proposed method of allocation, as modified herein, complies with 19.15.12.10(B)(1) or (C)(1) NMAC, as applicable.
11. Commingling of oil and gas production from state, federal, or tribal leases shall not commence until approved by the BLM or NMSLO, as applicable, in accordance with 19.15.12.10(B)(3) and (C)(4)(h) NMAC.
12. By granting the Application with the conditions specified below, this Order prevents waste and protects correlative rights, public health, and the environment.

ORDER

1. Applicant is authorized to surface commingle oil and gas production from the pools, leases, and wells identified in Exhibit A.

Applicant is authorized to store and measure oil and gas production off-lease from the pools, leases, and wells identified in Exhibit A at a central tank battery described in Exhibit A.

2. This Order supersedes Order OLM-224.
3. The oil production for each well identified in Exhibit A shall be separated and metered prior to commingling.

Gas production for Sholes B 30 No. 3 (30-025-35223) shall be allocated using allocation meters.

The gas production allocated to Winningham No. 9 (30-025-28637) shall be equal to the total commingled gas production minus the gas production allocated to Sholes B 30 No. 3 (30-025-35223).

4. Applicant shall measure and market the commingled oil at a central tank battery described in Exhibit A in accordance with this Order and 19.15.18.15 NMAC or 19.15.23.8 NMAC.
5. Applicant shall measure and market the commingled gas at a central delivery point, central tank battery, or gas title transfer meter described in Exhibit A in accordance with this Order and 19.15.19.9 NMAC, provided however that if the gas is vented or flared, and regardless of the reason or authorization pursuant to 19.15.28.8(B) NMAC for such venting or flaring, Applicant shall measure or estimate the gas in accordance with 19.15.28.8(E) NMAC.
6. Applicant shall calibrate the meters used to measure or allocate oil and gas production in accordance with 19.15.12.10(C)(2) NMAC.
7. If the commingling of oil and gas production from any pool, lease, or well reduces the value of the commingled oil and gas production to less than if it had remained segregated, no later than sixty (60) days after the decrease in value has occurred Applicant shall submit a new surface commingling application to OCD to amend this Order to remove the pool, lease, or well whose oil and gas production caused the decrease in value. If Applicant fails to submit a new application, this Order shall terminate on the following day, and if OCD denies the application, this Order shall terminate on the date of such action.

8. Applicant shall not commence commingling oil or gas production from state, federal, or tribal leases until approved by the BLM or NMSLO, as applicable.
9. If OCD determines that Applicant has failed to comply with any provision of this Order, OCD may take any action authorized by the Oil and Gas Act or the New Mexico Administrative Code (NMAC).
10. OCD retains jurisdiction of this matter and reserves the right to modify or revoke this Order as it deems necessary.

**STATE OF NEW MEXICO
OIL CONSERVATION DIVISION**



**ADRIENNE SANDOVAL
DIRECTOR**

DATE: 7/02/2021

State of New Mexico
Energy, Minerals and Natural Resources Department

Exhibit A

Order: **PLC-714**

Operator: **FAE II Operating, LLC (329326)**

Central Tank Battery: **Sholes B 3 Central Tank Battery**

Central Tank Battery Location (NMPM): **Unit E, Section 30, Township 25 South, Range 37 East**

Gas Custody Transfer Meter Location (NMPM): **Unit B, Section 30, Township 25 South, Range 37 East**

Pools

Pool Name	Pool Code
JALMAT; TAN-YATES-7 RVRS (GAS)	79240
JALMAT; TAN-YATES-7 RVRS (OIL)	33820
LANGLIE MATTIX;7 RVRS-Q-GRAYBURG	37240

Leases as defined in 19.15.12.7(C) NMAC

Lease	Location (NMPM)	
Fee	E/2, E/2 NW/4	Sec 30-T25S-R37E
	E/2 SE/4	Sec 19-T25S-R37E
NMLC 0032581B	SW/4 NW/4	Sec 30-T25S-R37E

Wells

Well API	Well Name	Location (NMPM)	Pool Code	Train
30-025-35223	Sholes B 30 #3	E-30-25S-37E	33820	
30-025-28637	Winningham #9	B-30-25S-37E	79240	
			37240	

District I

1625 N. French Dr., Hobbs, NM 88240
Phone:(575) 393-6161 Fax:(575) 393-0720

District II

811 S. First St., Artesia, NM 88210
Phone:(575) 748-1283 Fax:(575) 748-9720

District III

1000 Rio Brazos Rd., Aztec, NM 87410
Phone:(505) 334-6178 Fax:(505) 334-6170

District IV

1220 S. St Francis Dr., Santa Fe, NM 87505
Phone:(505) 476-3470 Fax:(505) 476-3462

State of New Mexico
Energy, Minerals and Natural Resources
Oil Conservation Division
1220 S. St Francis Dr.
Santa Fe, NM 87505

CONDITIONS

Action 11080

CONDITIONS

Operator: FAE II Operating LLC 11757 Katy Freeway, Suite 1000 Houston, TX 77079	OGRID: 329326
	Action Number: 11080
	Action Type: [C-107] Surface Commingle or Off-Lease (C-107B)

CONDITIONS

Created By	Condition	Condition Date
dmcclure	Please review the content of the order to ensure you are familiar with the authorities granted and any conditions of approval. If you have any questions regarding this matter, please contact me.	7/2/2021