

RECEIVED:	REVIEWER:	TYPE:	APP NO: pLEL2228032057
-----------	-----------	-------	-------------------------------

ABOVE THIS TABLE FOR OCD DIVISION USE ONLY

NEW MEXICO OIL CONSERVATION DIVISION
 - Geological & Engineering Bureau -
 1220 South St. Francis Drive, Santa Fe, NM 87505



ADMINISTRATIVE APPLICATION CHECKLIST

THIS CHECKLIST IS MANDATORY FOR ALL ADMINISTRATIVE APPLICATIONS FOR EXCEPTIONS TO DIVISION RULES AND REGULATIONS WHICH REQUIRE PROCESSING AT THE DIVISION LEVEL IN SANTA FE

Applicant: OXY USA INC. (16696) **OGRID Number:** 16696
Well Name: TOP SPOT 12-13 FEDERAL COM 312H **API:** 30-015-47626
Pool: WC 22S31E13; WOLFCAMP **Pool Code:** 98351

SUBMIT ACCURATE AND COMPLETE INFORMATION REQUIRED TO PROCESS THE TYPE OF APPLICATION INDICATED BELOW

1) **TYPE OF APPLICATION:** Check those which apply for [A]

A. Location – Spacing Unit – Simultaneous Dedication

☒ NSL ☐ NSP (PROJECT AREA) ☐ NSP (PRORATION UNIT) ☐ SD

B. Check one only for [I] or [II]

[I] Commingling – Storage – Measurement

☐ DHC ☐ CTB ☐ PLC ☐ PC ☐ OLS ☐ OLM

[II] Injection – Disposal – Pressure Increase – Enhanced Oil Recovery

☐ WFX ☐ PMX ☐ SWD ☐ IPI ☐ EOR ☐ PPR

2) **NOTIFICATION REQUIRED TO:** Check those which apply.

- A. ☒ Offset operators or lease holders
 B. ☐ Royalty, overriding royalty owners, revenue owners
 C. ☐ Application requires published notice
 D. ☐ Notification and/or concurrent approval by SLO
 E. ☒ Notification and/or concurrent approval by BLM
 F. ☐ Surface owner
 G. ☒ For all of the above, proof of notification or publication is attached, and/or,
 H. ☐ No notice required

FOR OCD ONLY

- ☐ Notice Complete
☐ Application Content Complete

3) **CERTIFICATION:** I hereby certify that the information submitted with this application for administrative approval is **accurate** and **complete** to the best of my knowledge. I also understand that **no action** will be taken on this application until the required information and notifications are submitted to the Division.

Note: Statement must be completed by an individual with managerial and/or supervisory capacity.

RONI MATHEW

Print or Type Name

Roni Mathew

Signature

10/6/2022

Date

713-215-7827

Phone Number

RONI_MATHEW@OXY.COM

e-mail Address



OXY USA Inc

5 Greenway Plaza, Suite 110
Houston, TX 77046-0521

October 6, 2022

New Mexico Oil Conservation Division
1220 South St. Francis Dr.
Santa Fe, NM 87505

Attention: Leonard Lowe

Re: ***Application for Administrative Approval of Non-Standard Location
Top Spot 12-13 Federal Com 312H – WC 22S31E13; Wolfcamp
Surface – 310' FSL 1375' FEL Unit O, Sec 13 T22S R31E
First Take Point – 100' FSL 2580' FWL Unit N, Sec 13 T22S R31E
Last Take Point – 100' FNL 2580' FWL Unit C, Sec 12 T22S R31E
Bottom Hole – 20' FNL 2580' FWL Unit C, Sec 12 T22S R31E
Eddy County, New Mexico***

Dear Mr. Lowe:

OXY USA Inc. respectfully requests administrative approval of a non-standard location on the Top Spot Federal Com #312H well, API Number-30-015-47626, Property Code 329719. The #312H well is proposed to be completed in the WC 22S31E13; Wolfcamp pool. This will be a horizontal well in a pool with no special rules for setback, so the setback requirements under Rule 19.15.15.9 (A) and 19.15.16.15 (B) will apply. The proposed producing interval is projected as follows:

Surface – 310' FSL 1375' FEL Unit O, Sec 13 T22S R31E
First Take Point – 100' FSL 2580' FWL Unit N, Sec 13 T22S R31E
Last Take Point – 100' FNL 2580' FWL Unit C, Sec 12 T22S R31E
Bottom Hole – 20' FNL 2580' FWL Unit C, Sec 12 T22S R31E

The adjoining units which the completed interval, unorthodox location, encroaches are located to the West in T22S R31E:

Section 12 - Units B, G, J, and O
Section 13 - Units B, G, J, and O

Area noted above have multiple working interest owners (see attached notice list).

Approval of the unorthodox location will allow for efficient spacing of horizontal wells in the Wolfcamp formation and thereby prevent waste.

To support this request, the following information has been submitted for your review:

1. C-102 Plat for the proposed well.
2. List of affected offset parties in each adjoining spacing unit in the same pool or formation located closer to the unorthodox well location than the minimum distance prescribed by applicable rule or order, copies of the signed certified return receipts will be furnished upon request.
3. Statement from Oxy Development Area Engineer.

Sincerely,

Roni Mathew

Roni Mathew
Regulatory Advisor
Roni_mathew@oxy.com



OXY USA Inc

5 Greenway Plaza, Suite 110
Houston, TX 77046-0521

October 6, 2022

CERTIFIED MAIL – RETURN RECEIPT REQUESTED

Re: *Application for Administrative Approval of Non-Standard Location
Top Spot 12-13 Federal Com 312H – WC 22S31E13; Wolfcamp
Surface – 310' FSL 1375' FEL Unit O, Sec 13 T22S R31E
First Take Point – 100' FSL 2580' FWL Unit N, Sec 13 T22S R31E
Last Take Point – 100' FNL 2580' FWL Unit C, Sec 12 T22S R31E
Bottom Hole – 20' FNL 2580' FWL Unit C, Sec 12 T22S R31E
Eddy County, New Mexico*

To Whom it May Concern:

Enclosed is a copy of an application, filed with the New Mexico Oil Conservation Division by OXY USA Inc., requesting administrative approval for a non-standard location. As an affected party, notice is being provided to you pursuant to Rule 19.15.4.12(A)(2)(a), 19.15.15.9(A) and 19.15.16.15(B). The well is located as follows:

Surface – 310' FSL 1375' FEL Unit O, Sec 13 T22S R31E
First Take Point – 100' FSL 2580' FWL Unit N, Sec 13 T22S R31E
Last Take Point – 100' FNL 2580' FWL Unit C, Sec 12 T22S R31E
Bottom Hole – 20' FNL 2580' FWL Unit C, Sec 12 T22S R31E

If you object to the well's location, you must notify the Division in writing no later than 20 days from the date the application is received by the NMOCD (1220 South St. Francis Drive, Santa Fe, NM 87505; Attention: Leonard Lowe).

If you need any additional information, you can contact Courtney Carr at 713-599-4116 or myself at 713-215-7827.

Thank you,

A handwritten signature in blue ink, appearing to read "R. Mathew", is written over a horizontal line.

Roni Mathew
Regulatory Advisor
OXY USA Inc.

DISTRICT I
1625 N. FRENCH DR., HOBBS, NM 88240
Phone: (575) 393-6161 Fax: (575) 393-0720

DISTRICT II
811 S. FIRST ST., ARTESIA, NM 88210
Phone: (575) 746-1283 Fax: (575) 746-9720

DISTRICT III
1000 RIO BRAZOS RD., AZTEC, NM 87410
Phone: (505) 334-6178 Fax: (505) 334-6170

DISTRICT IV
1220 S. ST. FRANCIS DR., SANTA FE, NM 87505
Phone: (505) 476-3460 Fax: (505) 476-3462

State of New Mexico
Energy, Minerals & Natural Resources Department
OIL CONSERVATION DIVISION
1220 SOUTH ST. FRANCIS DR.
Santa Fe, New Mexico 87505

Form C-102
Revised August 1, 2011
Submit one copy to appropriate
District Office

☒ AMENDED REPORT

WELL LOCATION AND ACREAGE DEDICATION PLAT

API Number 30-015-47626	Pool Code 98351	Pool Name WC 22S31E13; WOLFCAMP
Property Code 329719	Property Name TOP SPOT 12_13 FEDERAL COM	
OGRID No. 16696	Operator Name OXY USA, INC.	Well Number 312H
		Elevation 3581.4'

Surface Location

UL or lot No.	Section	Township	Range	Lot Idn	Feet from the	North/South line	Feet from the	East/West line	County
0	13	22-S	31-E		310	SOUTH	1375	EAST	EDDY

Bottom Hole Location If Different From Surface

UL or lot No.	Section	Township	Range	Lot Idn	Feet from the	North/South line	Feet from the	East/West line	County
C	12	22-S	31-E		20	NORTH	2580	WEST	EDDY

Dedicated Acres	Joint or Infill	Consolidation Code	Order No.
640			

NO ALLOWABLE WILL BE ASSIGNED TO THIS COMPLETION UNTIL ALL INTERESTS HAVE BEEN CONSOLIDATED
OR A NON-STANDARD UNIT HAS BEEN APPROVED BY THE DIVISION

<p><u>PROPOSED BOTTOM HOLE LOCATION NAD 83</u> Y=514588.9 N X=726996.3 E LAT.=32.413236° N LONG.=103.731702° W</p> <p><u>LTP NAD 83</u> 100' FNL & 2580' FWL Y=514508.9 N X=726996.7 E LAT.=32.413016° N LONG.=103.731702° W</p> <table border="1" style="width: 100%; border-collapse: collapse;"> <tr><th colspan="2">POINT LEGEND NAD83</th></tr> <tr><td>1</td><td>Y=514601.2 N X=724416.2 E</td></tr> <tr><td>2</td><td>Y=511959.0 N X=724430.0 E</td></tr> <tr><td>3</td><td>Y=509318.0 N X=724444.6 E</td></tr> <tr><td>4</td><td>Y=506677.3 N X=724460.1 E</td></tr> <tr><td>5</td><td>Y=504028.2 N X=724471.7 E</td></tr> <tr><td>6</td><td>Y=504045.0 N X=727116.9 E</td></tr> <tr><td>7</td><td>Y=509326.6 N X=727087.2 E</td></tr> <tr><td>8</td><td>Y=514609.1 N X=727060.1 E</td></tr> </table> <p><u>FTP NAD 83</u> 100' FSL & 2580' FWL Y=504144.5 N X=727051.2 E LAT.=32.384527° N LONG.=103.731714° W</p> <p><u>KOP NAD 83</u> 50' FSL & 2580' FWL Y=504094.5 N X=727051.4 E LAT.=32.384389° N LONG.=103.731714° W</p> <p><u>SURFACE LOCATION NAD 83</u> Y=504360.6 N X=728381.3 E LAT.=32.385100° N LONG.=103.727402° W</p>	POINT LEGEND NAD83		1	Y=514601.2 N X=724416.2 E	2	Y=511959.0 N X=724430.0 E	3	Y=509318.0 N X=724444.6 E	4	Y=506677.3 N X=724460.1 E	5	Y=504028.2 N X=724471.7 E	6	Y=504045.0 N X=727116.9 E	7	Y=509326.6 N X=727087.2 E	8	Y=514609.1 N X=727060.1 E	<p>HORIZONTAL SPACING UNIT</p> <p>SECTION 12</p> <p>SECTION 13</p>	<p><u>PROPOSED BOTTOM HOLE LOCATION NAD 27</u> Y=514528.2 N X=685814.2 E LAT.=32.413113° N LONG.=103.731212° W</p> <p><u>LTP NAD 27</u> 100' FNL & 2580' FWL Y=514448.2 N X=685814.6 E LAT.=32.412893° N LONG.=103.731212° W</p> <table border="1" style="width: 100%; border-collapse: collapse;"> <tr><th colspan="2">POINT LEGEND NAD27</th></tr> <tr><td>1</td><td>Y=514540.6 N X=683234.1 E</td></tr> <tr><td>2</td><td>Y=511898.4 N X=683247.9 E</td></tr> <tr><td>3</td><td>Y=509257.4 N X=683262.4 E</td></tr> <tr><td>4</td><td>Y=506616.8 N X=683277.8 E</td></tr> <tr><td>5</td><td>Y=503967.8 N X=683289.3 E</td></tr> <tr><td>6</td><td>Y=503984.5 N X=685934.6 E</td></tr> <tr><td>7</td><td>Y=509266.1 N X=685905.0 E</td></tr> <tr><td>8</td><td>Y=514548.4 N X=685878.0 E</td></tr> </table> <p><u>FTP NAD 27</u> 100' FSL & 2580' FWL Y=504084.1 N X=685868.8 E LAT.=32.384404° N LONG.=103.731226° W</p> <p><u>KOP NAD 27</u> 50' FSL & 2580' FWL Y=504034.1 N X=685869.1 E LAT.=32.384267° N LONG.=103.731226° W</p> <p><u>SURFACE LOCATION NAD 27</u> Y=504300.1 N X=687198.9 E LAT.=32.384977° N LONG.=103.726913° W</p>	POINT LEGEND NAD27		1	Y=514540.6 N X=683234.1 E	2	Y=511898.4 N X=683247.9 E	3	Y=509257.4 N X=683262.4 E	4	Y=506616.8 N X=683277.8 E	5	Y=503967.8 N X=683289.3 E	6	Y=503984.5 N X=685934.6 E	7	Y=509266.1 N X=685905.0 E	8	Y=514548.4 N X=685878.0 E
POINT LEGEND NAD83																																						
1	Y=514601.2 N X=724416.2 E																																					
2	Y=511959.0 N X=724430.0 E																																					
3	Y=509318.0 N X=724444.6 E																																					
4	Y=506677.3 N X=724460.1 E																																					
5	Y=504028.2 N X=724471.7 E																																					
6	Y=504045.0 N X=727116.9 E																																					
7	Y=509326.6 N X=727087.2 E																																					
8	Y=514609.1 N X=727060.1 E																																					
POINT LEGEND NAD27																																						
1	Y=514540.6 N X=683234.1 E																																					
2	Y=511898.4 N X=683247.9 E																																					
3	Y=509257.4 N X=683262.4 E																																					
4	Y=506616.8 N X=683277.8 E																																					
5	Y=503967.8 N X=683289.3 E																																					
6	Y=503984.5 N X=685934.6 E																																					
7	Y=509266.1 N X=685905.0 E																																					
8	Y=514548.4 N X=685878.0 E																																					

OPERATOR CERTIFICATION

I hereby certify that the information herein is true and complete to the best of my knowledge and belief, and that this organization either owns a working interest or unleased mineral interest in the land including the proposed bottom hole location or has a right to drill this well at this location pursuant to a contract with an owner of such mineral or working interest, or to a voluntary pooling agreement or a compulsory pooling order heretofore entered by the division.

Roni Mathew 8/30/2022
Signature Date

Roni Mathew
Printed Name
roni_mathew@oxy.com
E-mail Address

SURVEYOR CERTIFICATION

I hereby certify that the well location shown on this plat was plotted from field notes of actual surveys made by me or under my supervision, and that the same is true and correct to the best of my belief.

SEPTEMBER 27, 2019

Date of Survey

Signature & Seal of Professional Surveyor



Chad Harcrow 8/17/22
Certificate No. CHAD HARCROW 17777
W.O. #22-826 DRAWN BY: WN

Intent ☒ As Drilled ☐

API # 30-015-47626		
Operator Name: OXY USA Inc.	Property Name: TOP SPOT 12-13 FEDERAL COM	Well Number 312H

Kick Off Point (KOP)

UL N	Section 13	Township 22S	Range 31E	Lot	Feet 50	From N/S FSL	Feet 2580	From E/W FWL	County EDDY
Latitude 32.384389					Longitude -103.731714				NAD NAD83

First Take Point (FTP)

UL N	Section 13	Township 22S	Range 31E	Lot	Feet 100	From N/S FSL	Feet 2580	From E/W FWL	County EDDY
Latitude 32.384527					Longitude -103.731714				NAD NAD83

Last Take Point (LTP)

UL C	Section 12	Township 22S	Range 31E	Lot	Feet 100	From N/S FNL	Feet 2580	From E/W FWL	County EDDY
Latitude 32.413016					Longitude -103.731702				NAD NAD83

Is this well the defining well for the Horizontal Spacing Unit? ☐ NIs this well an infill well? ☐ Y

If infill is yes please provide API if available, Operator Name and well number for Defining well for Horizontal Spacing Unit.

API # 30-015-47627		
Operator Name: OXY USA INC.	Property Name: TOP SPOT 12-13 FEDERAL COM	Well Number 311H

KZ 06/29/2018

OXY USA Inc.

Top Spot 12-13 Federal Com #312H

Section 13 Township 22 South,

Range 31 East, N.M.P.M.

Eddy County, New Mexico

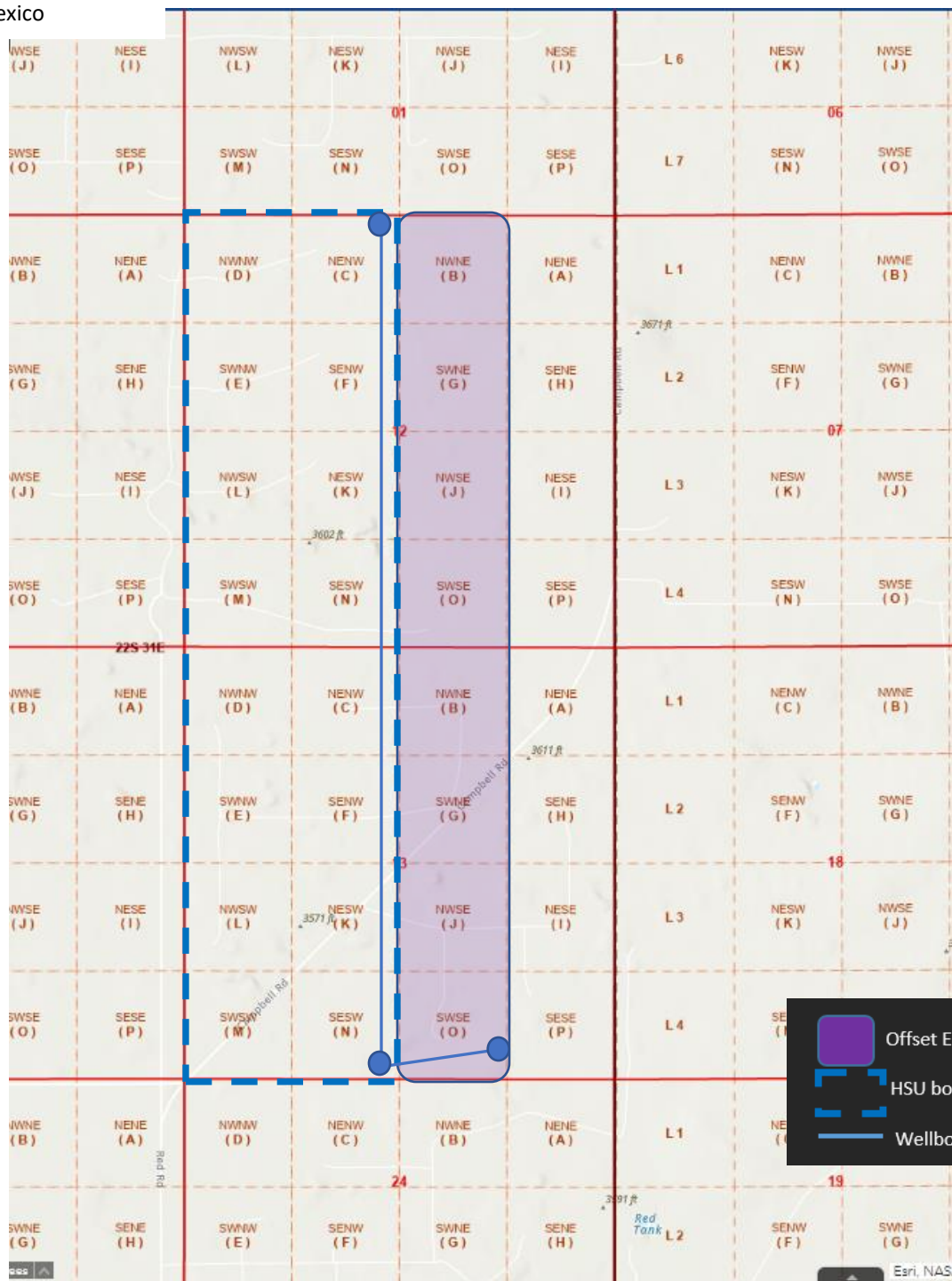



Occidental Oil and Gas Corporation
ATTN: Morgan Berber
5 Greenway Plaza, Suite 110
Houston, TX 77046
713-350-4818
Morgan_Berber@oxy.com

October 5, 2022

Mr. Leonard Lowe
New Mexico Oil Conservation Division
1220 South Francis Drive
Santa Fe, New Mexico 87505

RE: *Application for Nonstandard Location—Engineering Justification*
OXY USA Inc.
Top Spot 12-13 Federal Com 312H
T22S R31E, Sections 12 & 13 – West ½, Eddy County

Dear Mr. Lowe:

Oxy USA Inc. respectfully seeks approval for a non-standard location for the Top Spot 12-13 Federal Com 312H well to be drilled within 330' of the HSU boundary. It is Oxy's responsibility as a prudent operator to optimize the section's well spacing and minimize reserves left in the ground. Placing the well within the setback, allows for a horizontal well spacing of 7 wells per section, optimizing the recoverable reserves. Any reduction in well spacing will result in untapped reserves being left in the reservoir resulting in waste of a resource that will not be developed otherwise.

Sincerely,

A handwritten signature in black ink, appearing to be "M. Berber", with a long horizontal line extending to the right.

Morgan Berber
Reservoir Engineer

Application Non-Standard Location - Service List
OXY USA Inc.
Top Spot 12-13 Federal Com 312H

Online Submission

New Mexico Oil Conservation Division
 1220 South St. Francis Dr.
 Santa Fe, NM 87505

Certified Mail # 9407111898765817466587

Bureau of Land Management Carlsbad
 620 E. Greene Street
 Carlsbad, NM 88220-6292

Offset Tracts Section 12 (T22S-R31E) - Units B, G, J, O

Offset Tracts Section 13 (T22S-R31E) - Units B, G, J, O

Type	Affected Party	Location	Date Letter Sent	Mail Tracking #
Working Interest	Chisos, Ltd. 1331 Lamar Ste 1077 Houston, TX 77010	W2E2 Sec. 12 T22S-R31E	10/6/2022	_9407111898765817466723
Working Interest	Rockport Oil and Gas, LLC PO Box 19567 Houston, TX 77224-9567	W2E2 Sec. 12 T22S-R31E	10/6/2022	_9407111898765817466792
Working Interest	Long Trust PO Box 3096 Kilgore, TX 75663	W2E2 Sec. 12 T22S-R31E	10/6/2022	_9407111898765817466785
Working Interest	Charles Andrew Spradlin 2451 Walker St Grand Prairie, TX 75052	W2E2 Sec. 12 T22S-R31E	10/6/2022	_9407111898765817466730
Working Interest	XTO Holdings, LLC 22777 Springwoods Village Parkway Spring, TX 77389	W2NE4 Sec. 12 T22S-R31E	10/6/2022	_9407111898765817466778

Copies of this application were mailed to the individuals, companies and organizations
 on or before October 6, 2022

Roni Mathew

Roni Mathew, Regulatory Advisor
 OXY USA Inc.

District I
1625 N. French Dr., Hobbs, NM 88240
Phone:(575) 393-6161 Fax:(575) 393-0720
District II
811 S. First St., Artesia, NM 88210
Phone:(575) 748-1283 Fax:(575) 748-9720
District III
1000 Rio Brazos Rd., Aztec, NM 87410
Phone:(505) 334-6178 Fax:(505) 334-6170
District IV
1220 S. St Francis Dr., Santa Fe, NM 87505
Phone:(505) 476-3470 Fax:(505) 476-3462

State of New Mexico
Energy, Minerals and Natural Resources
Oil Conservation Division
1220 S. St Francis Dr.
Santa Fe, NM 87505

CONDITIONS

Action 149324

CONDITIONS

Operator: OXY USA INC P.O. Box 4294 Houston, TX 772104294	OGRID: 16696
	Action Number: 149324
	Action Type: [UF-NSL] Non-Standard Location (NSL)

CONDITIONS

Created By	Condition	Condition Date
llowe	NSL - 8455 is approved. The approved Order can be retrieved at the following OCD website link. https://ocdimage.emnrd.nm.gov/imaging/AEOrderCriteria.aspx	10/7/2022