

Submit Copy To Appropriate District Office  
 District I – (575) 393-6161  
 1625 N. French Dr., Hobbs, NM 88240  
 District II – (575) 748-1283  
 811 S. First St., Artesia, NM 88210  
 District III – (505) 334-6178  
 1000 Rio Brazos Rd., Aztec, NM 87410  
 District IV – (505) 476-3460  
 1220 S. St. Francis Dr., Santa Fe, NM 87505

State of New Mexico  
 Energy, Minerals and Natural Resources

OIL CONSERVATION DIVISION  
 1220 South St. Francis Dr.  
 Santa Fe, NM 87505

DHC-5265 Form C-103  
 Revised July 18, 2013

WELL API NO. 30-039-24146	
5. Indicate Type of Lease STATE <input type="checkbox"/> FEE <input type="checkbox"/>	
6. State Oil & Gas Lease No. NMSF078425	
7. Lease Name or Unit Agreement Name San Juan 29-7 Unit	
8. Well Number 139	
9. OGRID Number 372171	
10. Pool name or Wildcat Basin Dakota/Blanco Mesaverde	
SUNDRY NOTICES AND REPORTS ON WELLS (DO NOT USE THIS FORM FOR PROPOSALS TO DRILL OR TO DEEPEN OR PLUG BACK TO A DIFFERENT RESERVOIR. USE "APPLICATION FOR PERMIT" (FORM C-101) FOR SUCH PROPOSALS.) 1. Type of Well: Oil Well <input type="checkbox"/> Gas Well <input checked="" type="checkbox"/> Other <input type="checkbox"/> 2. Name of Operator Hilcorp Energy Company 3. Address of Operator 382 Road 3100, Aztec NM 87410 4. Well Location Unit Letter _J_: 1650 feet from the _South_ line and 1450 feet from the _East_ line Section 25 Township 29N Range 7W NMPM Rio Arriba County 11. Elevation (Show whether DR, RKB, RT, GR, etc.) 6720'	

12. Check Appropriate Box to Indicate Nature of Notice, Report or Other Data

NOTICE OF INTENTION TO:	SUBSEQUENT REPORT OF:
PERFORM REMEDIAL WORK <input type="checkbox"/>	REMEDIAL WORK <input type="checkbox"/>
TEMPORARILY ABANDON <input type="checkbox"/>	ALTERING CASING <input type="checkbox"/>
PULL OR ALTER CASING <input type="checkbox"/>	COMMENCE DRILLING OPNS. <input type="checkbox"/>
DOWNHOLE COMMINGLE <input checked="" type="checkbox"/>	P AND A <input type="checkbox"/>
CLOSED-LOOP SYSTEM <input type="checkbox"/>	CASING/CEMENT JOB <input type="checkbox"/>
OTHER: <input type="checkbox"/>	OTHER: <input type="checkbox"/>

13. Describe proposed or completed operations. (Clearly state all pertinent details, and give pertinent dates, including estimated date of starting any proposed work). SEE RULE 19.15.7.14 NMAC. For Multiple Completions: Attach wellbore diagram of proposed completion or recompletion.

It is intended to recomple the subject well in the Blanco Mesaverde (pool 72319) and downhole commingle the existing Basin Dakota (pool 71599) with the Mesaverde. The production will be commingled per Oil Conservation Division Order Number 11363. See attached allocation methodology. Commingling will not reduce the value of the production. The Bureau of Land Management has been notified in writing of this application.

Proposed perforations are: MV - 5226' - 6000'; DK - 7813' - 8003' These perforations are in TVD.

As referenced in Order # R- 10697 interest owners were not re-notified.

Spud Date:

Rig Release Date:

I hereby certify that the information above is true and complete to the best of my knowledge and belief.

SIGNATURE Kandis Roland TITLE Operations/Regulatory Technician Sr. DATE 12/6/2022

Type or print name Kandis Roland E-mail address: kroland@hilcorp.com PHONE: 713-757-5246  
**For State Use Only**

APPROVED BY: Dean R. Mollure TITLE Petroleum Engineer DATE 12/30/2022  
 Conditions of Approval (if any):

## CONDITIONS OF APPROVAL

If an alteration is made to the Well or a condition within the Well changes which may cause the allocation of production to the Pools as approved within this Permit to become inaccurate, then no later than sixty (60) days after that event, the Operator shall submit Form C-103 to the OCD Engineering Bureau describing the event and include a revised allocation plan. If OCD denies the revised allocation plan, this Permit shall terminate on the date of such action.

If the downhole commingling of the Pools reduces the value of the oil and gas production to less than if it had remained segregated, no later than sixty (60) days after the decrease in value has occurred the Operator shall submit a new downhole commingling application to OCD to amend this Permit to remove the pool that caused the decrease in value. If the Operator fails to submit a new application, this Permit shall terminate on the following day, and if OCD denies the application, this Permit shall terminate on the date of such action.

If a completed interval of the Well is altered from what is submitted within this application, then no later than sixty (60) days after the alteration, the Operator shall submit Form C-103 to the OCD Engineering Bureau detailing the alteration and completed interval.

The Operator shall calculate the oil and gas production average during the fourth year after the commencement of commingling, which shall be used to establish a fixed percentage of the total oil and gas production that shall be allocated to each of the Pools ("fixed percentage allocation plan"). No later than ninety (90) days after the fourth year, the Operator shall submit a Form C-103 to the OCD Engineering Bureau that includes the fixed percentage allocation plan and all data used to determine it. If the Operator fails to do so, this Permit shall terminate on the following day. If OCD denies the fixed percentage allocation plan, this Permit shall terminate on the date of such action. If OCD approves the percentage allocation plan with or without modifications, then the approved percentage allocation plan shall be used to determine oil and gas allocation starting on the date of such action until the Well is plugged and abandoned.

**State of New Mexico**  
**Energy, Minerals and Natural**  
**Resources**  
**Oil Conservation Division**  
**1220 S. St Francis Dr.**  
**Santa Fe, NM 87505**

**District I**

1025 N. French Dr., Hobbs, NM 88240  
 Phone:(575) 393-6161 Fax:(575) 393-0720

**District II**

811 S. First St., Artesia, NM 88210  
 Phone:(575) 748-1283 Fax:(575) 748-9720

**District III**

1000 Rio Brazos Rd., Aztec, NM 87410  
 Phone:(505) 334-6178 Fax:(505) 334-6170

**District IV**

1220 S. St Francis Dr., Santa Fe, NM 87505  
 Phone:(505) 476-3470 Fax:(505) 476-3462

**WELL LOCATION AND ACREAGE DEDICATION PLAT**

1. API Number 30-039-24146	2. Pool Code 72319	3. Pool Name BLANCO-MESAVERDE (PRORATED GAS)
4. Property Code 318713	5. Property Name SAN JUAN 29 7 UNIT	6. Well No. 139
7. OGRID No. 372171	8. Operator Name HILCORP ENERGY COMPANY	9. Elevation 6720

**10. Surface Location**

UL - Lot J	Section 25	Township 29N	Range 07W	Lot Idn	Feet From 1650	N/S Line S	Feet From 1450	E/W Line E	County RIO ARRIBA
---------------	---------------	-----------------	--------------	---------	-------------------	---------------	-------------------	---------------	-------------------------

**11. Bottom Hole Location If Different From Surface**

UL - Lot	Section	Township	Range	Lot Idn	Feet From	N/S Line	Feet From	E/W Line	County
12. Dedicated Acres 320.00 E/2	13. Joint or Infill			14. Consolidation Code			15. Order No.		

**NO ALLOWABLE WILL BE ASSIGNED TO THIS COMPLETION UNTIL ALL INTERESTS HAVE BEEN CONSOLIDATED OR A NON-STANDARD UNIT HAS BEEN APPROVED BY THE DIVISION**

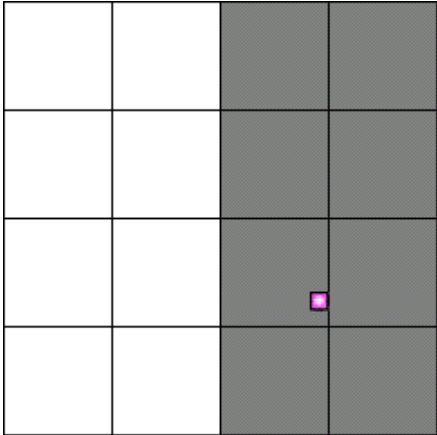
	<p style="text-align: center;"><b>OPERATOR CERTIFICATION</b></p> <p><i>I hereby certify that the information contained herein is true and complete to the best of my knowledge and belief, and that this organization either owns a working interest or unleased mineral interest in the land including the proposed bottom hole location(s) or has a right to drill this well at this location pursuant to a contract with an owner of such a mineral or working interest, or to a voluntary pooling agreement or a compulsory pooling order heretofore entered by the division.</i></p> <p>E-Signed By: Kandis Roland        Title: Regulatory Tech        Date: 8/31/2022</p> <hr/> <p style="text-align: center;"><b>SURVEYOR CERTIFICATION</b></p> <p><i>I hereby certify that the well location shown on this plat was plotted from field notes of actual surveys made by me or under my supervision, and that the same is true and correct to the best of my belief.</i></p> <p>Surveyed By: William E Mahnke        Date of Survey: 6/23/1987        Certificate Number: 8466</p>
--	---

**NEW MEXICO OIL CONSERVATION COMMISSION  
WELL LOCATION AND ACREAGE DEDICATION PLAT**

Form C-102  
Supersedes C-128  
Effective 1-1-65

All distances must be from the outer boundaries of the Section.

Operator <b>MERIDIAN OIL INC.</b> <b>EL PASO NATURAL GAS CO.</b>		Lease <b>SAN JUAN 29-7 UNIT (SF 878425)</b>		Well No. <b>139</b>
Unit Letter <b>J</b>	Section <b>25</b>	Township <b>29 N</b>	Range <b>7 W</b>	County <b>Rio Arriba</b>
Actual Footage Location of Well: <b>1650</b> feet from the <b>South</b> line and <b>1450</b> feet from the <b>East</b> line				
Ground Level Elev. <b>6720</b>	Producing Formation <b>Dakota</b>	Pool <b>Basin</b>	Dedicated Acreage <b>320</b> Acres	

1. Outline the acreage dedicated to the subject well by colored pencil or hatchure marks on the plat below.
2. If more than one lease is dedicated to the well, outline each and identify the ownership thereof (both as to working interest and royalty).
3. If more than one lease of different ownership is dedicated to the well, have the interests of all owners been consolidated by communitization, unitization, force-pooling, etc?

☒ Yes ☐ No If answer is "yes," type of consolidation Unitization

If answer is "no," list the owners and tract descriptions which have actually been consolidated. (Use reverse side of this form if necessary.) \_\_\_\_\_

No allowable will be assigned to the well until all interests have been consolidated (by communitization, unitization, forced-pooling, or otherwise) or until a non-standard unit, eliminating such interests, has been approved by the Commission.

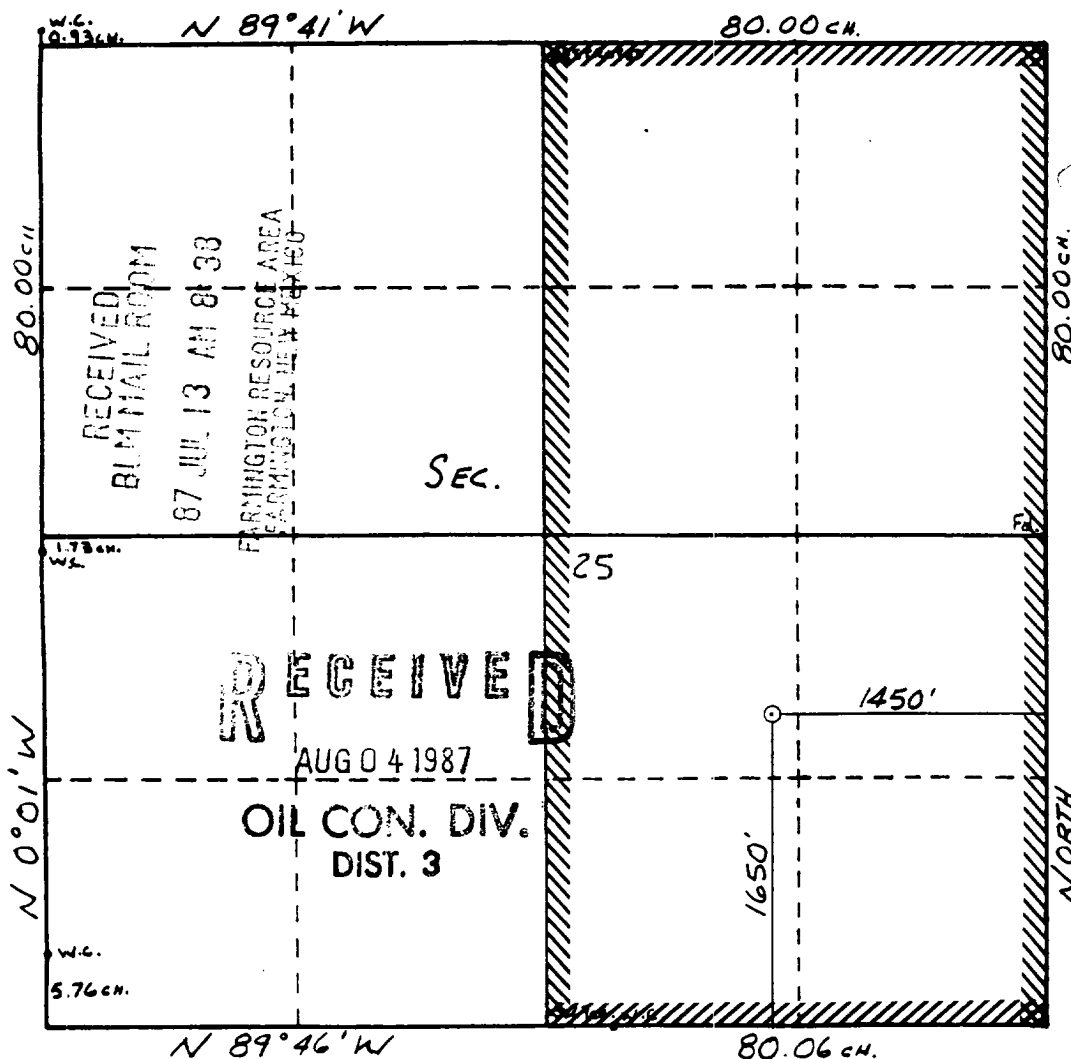

**CERTIFICATION**

I hereby certify that the information contained herein is true and complete to the best of my knowledge and belief.

Name Drilling Clerk  
Position El Paso Natural Gas  
Company \_\_\_\_\_

Date \_\_\_\_\_

I hereby certify that the well location shown on this plat was plotted from field notes of actual surveys made by me or under my supervision, and that the same is true and correct to the best of my knowledge and belief.

Date Surveyed 6-23-87  
Surveyed by WILLIAM E. MAHAFFE II  
Registered Professional Engineer and Land Surveyor  
#8466  
Certification No. 8466

## San Juan 29-7 Unit 139 Production Allocation Method - Subtraction

**Gas Allocation:**

Production for the downhole commingle will be allocated using the subtraction method in agreement with local agencies. The base formation is the Dakota and the added formation to be commingled is the Mesaverde. The subtraction method applies an average monthly production forecast to the base formation using historic production. All production from this well exceeding the forecast will be allocated to the new formation. After 3 years production will stabilize. A production average will be gathered during the 4<sup>th</sup> year and will be utilized to create a fixed percentage-based allocation.

Plot below shows the decline parameters for Dakota base production forecast.

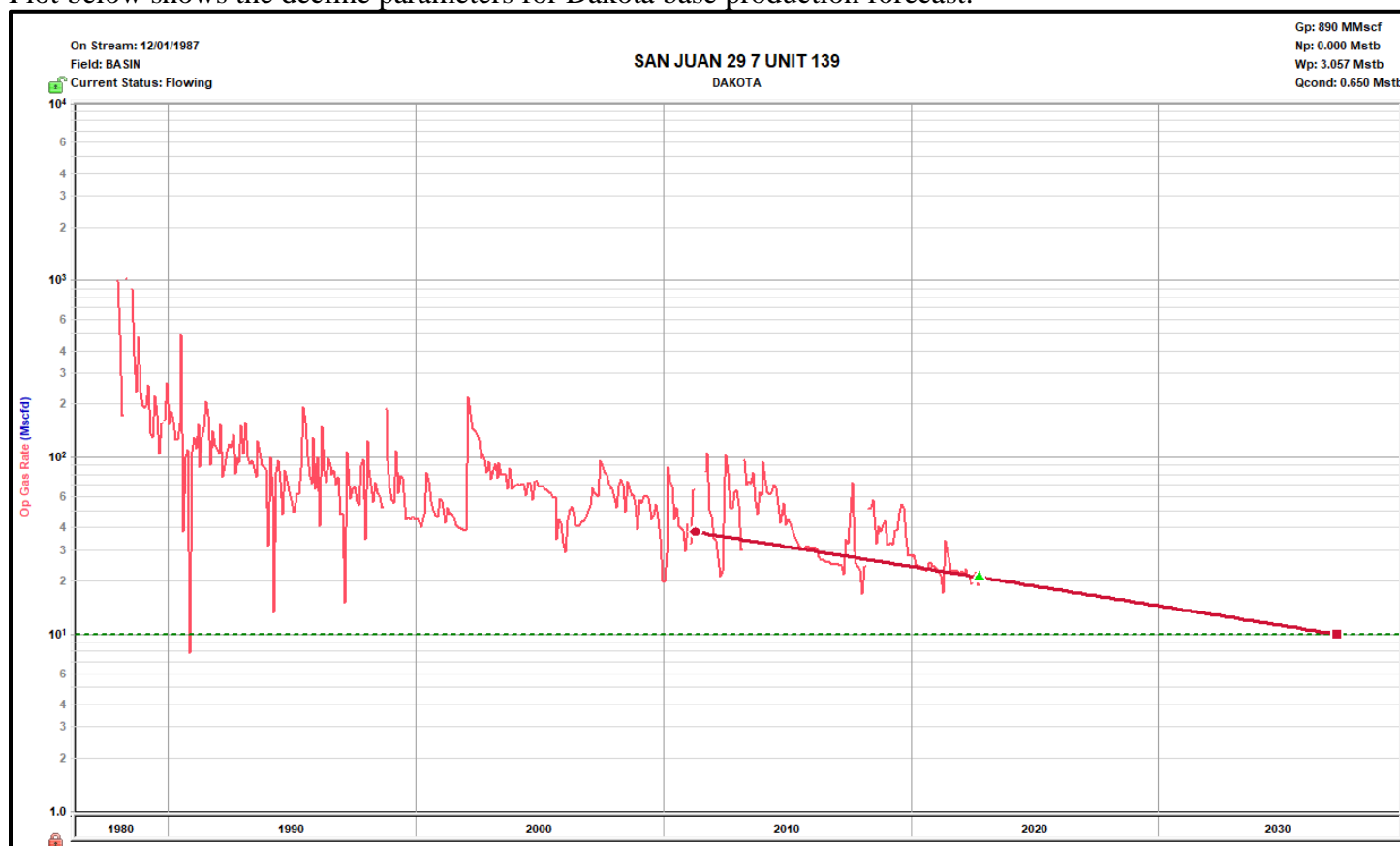
**Oil Allocation:**

Oil production will be allocated based on average formation yields from offset wells and will be a fixed rate for 4 years.

After 4 years oil will be reevaluated and adjust as needed based on average formation yields and new fixed gas allocation.

Formation	Yield (bbl/MM)	Remaining Reserves (MMcf)	% Oil Allocation
DK	0.72	78	2%
MV	4.11	750	98%

Dakota Oil Yield Map

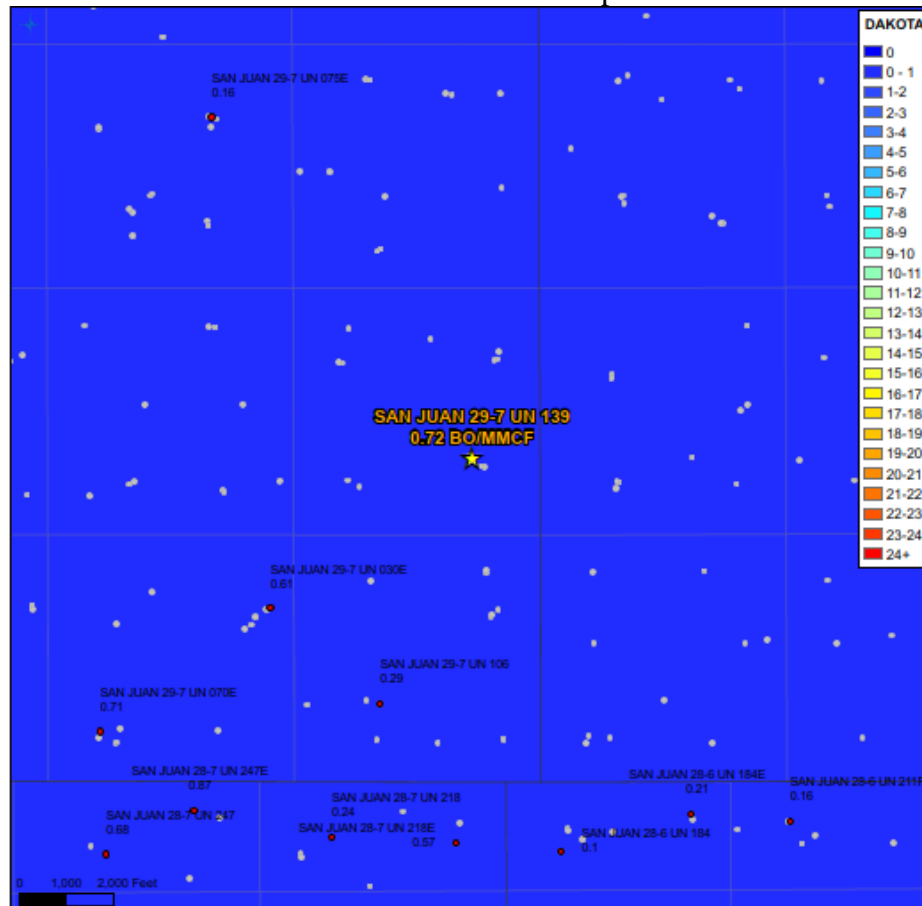

Mesaverde Oil Yield Map

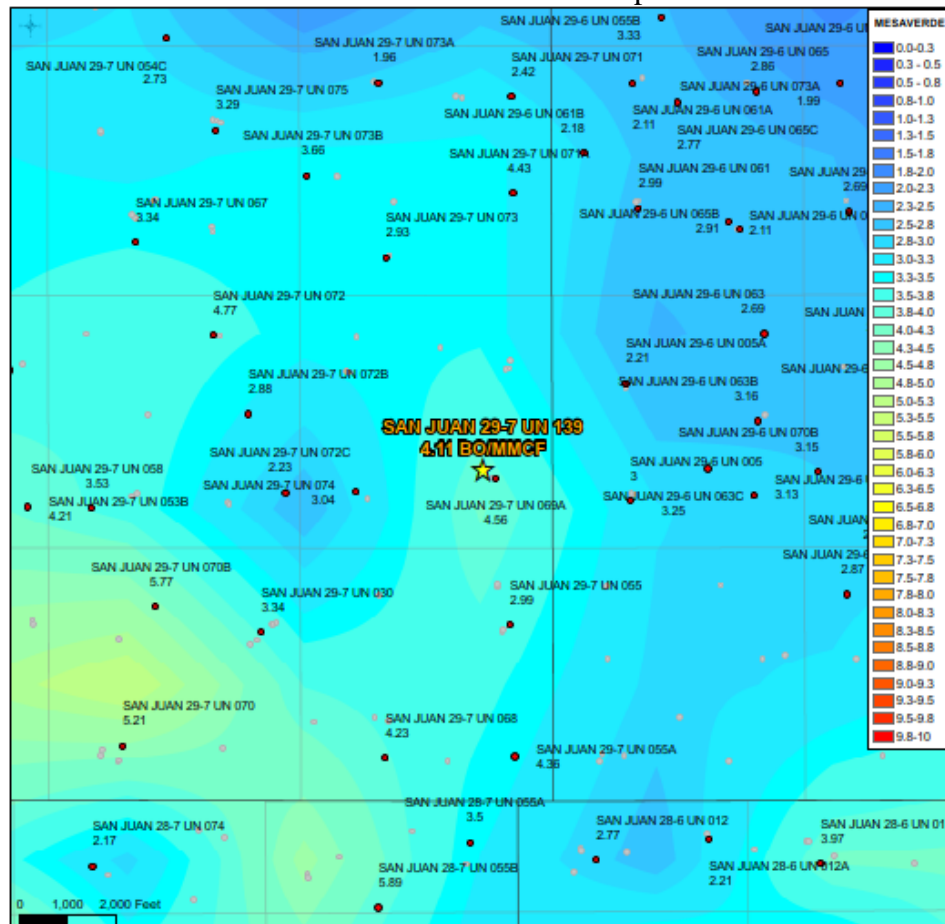

**District I**

1625 N. French Dr., Hobbs, NM 88240  
Phone:(575) 393-6161 Fax:(575) 393-0720

**District II**

811 S. First St., Artesia, NM 88210  
Phone:(575) 748-1283 Fax:(575) 748-9720

**District III**

1000 Rio Brazos Rd., Aztec, NM 87410  
Phone:(505) 334-6178 Fax:(505) 334-6170

**District IV**

1220 S. St Francis Dr., Santa Fe, NM 87505  
Phone:(505) 476-3470 Fax:(505) 476-3462

**State of New Mexico**  
**Energy, Minerals and Natural Resources**  
**Oil Conservation Division**  
**1220 S. St Francis Dr.**  
**Santa Fe, NM 87505**

CONDITIONS

Action 164252

**CONDITIONS**

Operator: HILCORP ENERGY COMPANY 1111 Travis Street Houston, TX 77002	OGRID: 372171
	Action Number: 164252
	Action Type: [C-107] Down Hole Commingle (C-107A)

**CONDITIONS**

Created By	Condition	Condition Date
dmcclure	If an alteration is made to the Well or a condition within the Well changes which may cause the allocation of production to the Pools as approved within this Permit to become inaccurate, then no later than sixty (60) days after that event, the Operator shall submit Form C-103 to the OCD Engineering Bureau describing the event and include a revised allocation plan. If OCD denies the revised allocation plan, this Permit shall terminate on the date of such action.	12/30/2022
dmcclure	If the downhole commingling of the Pools reduces the value of the oil and gas production to less than if it had remained segregated, no later than sixty (60) days after the decrease in value has occurred the Operator shall submit a new downhole commingling application to OCD to amend this Permit to remove the pool that caused the decrease in value. If the Operator fails to submit a new application, this Permit shall terminate on the following day, and if OCD denies the application, this Permit shall terminate on the date of such action.	12/30/2022
dmcclure	If a completed interval of the Well is altered from what is submitted within this application, then no later than sixty (60) days after the alteration, the Operator shall submit Form C-103 to the OCD Engineering Bureau detailing the alteration and completed interval.	12/30/2022
dmcclure	The Operator shall calculate the oil and gas production average during the fourth year after the commencement of commingling, which shall be used to establish a fixed percentage of the total oil and gas production that shall be allocated to each of the Pools ("fixed percentage allocation plan"). No later than ninety (90) days after the fourth year, the Operator shall submit a Form C-103 to the OCD Engineering Bureau that includes the fixed percentage allocation plan and all data used to determine it. If the Operator fails to do so, this Permit shall terminate on the following day. If OCD denies the fixed percentage allocation plan, this Permit shall terminate on the date of such action. If OCD approves the percentage allocation plan with or without modifications, then the approved percentage allocation plan shall be used to determine oil and gas allocation starting on the date of such action until the Well is plugged and abandoned.	12/30/2022