

ID NO. 170625

NSL - 8519

Revised March 23, 2017

RECEIVED:	REVIEWER:	TYPE:	APP NO: pLEL2236329454
-----------	-----------	-------	-------------------------------

ABOVE THIS TABLE FOR OCD DIVISION USE ONLY

NEW MEXICO OIL CONSERVATION DIVISION
 - Geological & Engineering Bureau -
 1220 South St. Francis Drive, Santa Fe, NM 87505

**ADMINISTRATIVE APPLICATION CHECKLIST**

THIS CHECKLIST IS MANDATORY FOR ALL ADMINISTRATIVE APPLICATIONS FOR EXCEPTIONS TO DIVISION RULES AND
 REGULATIONS WHICH REQUIRE PROCESSING AT THE DIVISION LEVEL IN SANTA FE

Applicant: OXY USA INC. (16696) **OGRID Number:** 16696
Well Name: HEADS CC 9 4 FEDERAL COM #37H **API:** 30-015-47194
Pool: PURPLE SAGE WOLFCAMP (GAS) **Pool Code:** 98220

**SUBMIT ACCURATE AND COMPLETE INFORMATION REQUIRED TO PROCESS THE TYPE OF APPLICATION
 INDICATED BELOW**

1) TYPE OF APPLICATION: Check those which apply for [A]

A. Location – Spacing Unit – Simultaneous Dedication

☒ NSL☐ NSP (PROJECT AREA)☐ NSP (PRORATION UNIT)☐ SD

B. Check one only for [I] or [II]

[I] Commingling – Storage – Measurement

☐ DHC☐ CTB☐ PLC☐ PC☐ OLS☐ OLM

[II] Injection – Disposal – Pressure Increase – Enhanced Oil Recovery

☐ WFX☐ PMX☐ SWD☐ IPI☐ EOR☐ PPR**2) NOTIFICATION REQUIRED TO:** Check those which apply.A. ☒ Offset operators or lease holdersB. ☐ Royalty, overriding royalty owners, revenue ownersC. ☐ Application requires published noticeD. ☒ Notification and/or concurrent approval by SLOE. ☒ Notification and/or concurrent approval by BLMF. ☒ Surface ownerG. ☐ For all of the above, proof of notification or publication is attached, and/or,H. ☐ No notice required**FOR OCD ONLY**☐ Notice Complete☐ Application
Content
Complete

3) CERTIFICATION: I hereby certify that the information submitted with this application for administrative approval is **accurate** and **complete** to the best of my knowledge. I also understand that **no action** will be taken on this application until the required information and notifications are submitted to the Division.

Note: Statement must be completed by an individual with managerial and/or supervisory capacity.

12/20/2022

Date

STEPHEN JANACEK

Print or Type Name

713-493-1986

Phone Number

Signature

STEPHEN_JANACEK@OXY.COM

e-mail Address

**OXY USA Inc****5 Greenway Plaza, Suite 110
Houston, TX 77046-0521**

December 20, 2022

New Mexico Oil Conservation Division
1220 South St. Francis Dr.
Santa Fe, NM 87505

Attention: Leonard Lowe

Re: ***Application for Administrative Approval of Non-Standard Location:
Heads CC 9 4 Federal Com #37H- Purple Sage Wolfcamp
Eddy County, New Mexico***

Dear Mr. Lowe:

OXY USA Inc. respectfully requests administrative approval of a non-standard location for the Heads CC 9 4 Federal Com #37H well, API Number 30-015-47194, Property Code 328290.

The gas well is proposed to be completed in the Purple Sage Wolfcamp pool, Pool Code 98220, which has special pool rules specifying the completed interval must be located 330 feet from the exterior boundary of the applicable spacing unit. The proposed completed interval is projected as follows:

Surface	792 FNL, 1654 FWL, C, SEC 16, T24S, R29E
First Take Point	100 FSL, 1700 FWL, N, SEC 9, T24S, R29E
Last Take Point	100 FNL, 1700 FWL, LOT 3, SEC 4, T24S, R29E
Bottom Hole	20 FNL, 1700 FWL, LOT 3, SEC 4, T24S, R29E

This well is developing gas resources. This unorthodox location has been requested because a longer completed interval will allow for efficient spacing of horizontal wells and thereby prevent waste.

The Horizontal Spacing Unit will be 1280-acres including all of section 9 and section 4, T24S R29E.

- To the North, the adjoining units which the unorthodox location encroaches are in T23S R29E, Section 33- Units I, J, K, L, M, N, O and P, and the Operator is Tap Rock Operating, LLC.
- To the South, the adjoining units which the unorthodox location encroaches are in T24S R29E, Section 16- Units A, B, C, D, E, F, G and H, which are 100% OXY USA INC working interest or OXY USA INC is the Lessee.

This well is an infill well. The defining well is Heads CC 9 4 Federal Com #312H (30-015-47340).

To support this request, the following documents are included for review:

1. NSL Request Cover Letter (this document)
2. Administrative Application Checklist
3. Form C-102
4. Supplemental Information
5. HSU and offset party map
6. List of affected persons
7. Tap Rock waiver documents
8. Statement from Oxy Reservoir Engineer

If you need any additional information, please call me at 713-493-1986.

Sincerely,

Stephen Janacek
Regulatory Engineer
Stephen_Janacek@oxy.com

DISTRICT I
1625 N. FRENCH DR., HOBBS, NM 88240
Phone: (575) 393-6161 Fax: (575) 393-0720

DISTRICT II
811 S. FIRST ST., ARTESIA, NM 88210
Phone: (575) 746-1283 Fax: (575) 746-9720

DISTRICT III
1000 RIO BRAZOS RD., AZTEC, NM 87410
Phone: (505) 334-6178 Fax: (505) 334-6170

DISTRICT IV
1220 S. ST. FRANCIS DR., SANTA FE, NM 87505
Phone: (505) 476-3460 Fax: (505) 476-3462

State of New Mexico
Energy, Minerals & Natural Resources Department
OIL CONSERVATION DIVISION
1220 SOUTH ST. FRANCIS DR.
Santa Fe, New Mexico 87505

Form C-102
Revised August 1, 2011
Submit one copy to appropriate
District Office

☒ AMENDED REPORT

WELL LOCATION AND ACREAGE DEDICATION PLAT

API Number 30-015-47194	Pool Code 98220	Pool Name PURPLE SAGE WOLFCAMP (GAS)
Property Code 328290	Property Name HEADS CC 9_4 FEDERAL COM	Well Number 37H
OGRID No. 16696	Operator Name OXY USA INC.	Elevation 2927.4'

Surface Location

UL or lot No.	Section	Township	Range	Lot Idn	Feet from the	North/South line	Feet from the	East/West line	County
C	16	24-S	29-E		792	NORTH	1654	WEST	EDDY

Bottom Hole Location If Different From Surface

UL or lot No.	Section	Township	Range	Lot Idn	Feet from the	North/South line	Feet from the	East/West line	County
3	4	24-S	29-E		20	NORTH	1700	WEST	EDDY

Dedicated Acres	Joint or Infill	Consolidation Code	Order No.
1280	Y		

NO ALLOWABLE WILL BE ASSIGNED TO THIS COMPLETION UNTIL ALL INTERESTS HAVE BEEN CONSOLIDATED
OR A NON-STANDARD UNIT HAS BEEN APPROVED BY THE DIVISION

<p><u>PROPOSED BOTTOM HOLE LOCATION NAD 83</u> Y=456297.3 N X=646670.0 E LAT.=32.253977° N LONG.=103.992596° W</p> <p><u>LTP NAD 83</u> 100' FNL & 1700' FWL Y=456217.3 N X=646670.3 E LAT.=32.253757° N LONG.=103.992596° W</p> <table border="1"> <thead> <tr> <th>POINT</th> <th>LEGEND</th> <th>NAD83</th> </tr> </thead> <tbody> <tr><td>1</td><td>Y=456311.0 N</td><td></td></tr> <tr><td>1</td><td>X=644969.9 E</td><td></td></tr> <tr><td>2</td><td>Y=453660.3 N</td><td></td></tr> <tr><td>2</td><td>X=644969.9 E</td><td></td></tr> <tr><td>3</td><td>Y=451006.8 N</td><td></td></tr> <tr><td>3</td><td>X=644997.4 E</td><td></td></tr> <tr><td>4</td><td>Y=448351.8 N</td><td></td></tr> <tr><td>4</td><td>X=645008.9 E</td><td></td></tr> <tr><td>5</td><td>Y=445695.4 N</td><td></td></tr> <tr><td>5</td><td>X=645021.1 E</td><td></td></tr> <tr><td>6</td><td>Y=456320.9 N</td><td></td></tr> <tr><td>6</td><td>X=647615.9 E</td><td></td></tr> <tr><td>7</td><td>Y=451020.7 N</td><td></td></tr> <tr><td>7</td><td>X=647641.0 E</td><td></td></tr> <tr><td>8</td><td>Y=445710.8 N</td><td></td></tr> <tr><td>8</td><td>X=647666.6 E</td><td></td></tr> <tr><td>9</td><td>Y=456330.3 N</td><td></td></tr> <tr><td>9</td><td>X=650262.8 E</td><td></td></tr> <tr><td>10</td><td>Y=453688.3 N</td><td></td></tr> <tr><td>10</td><td>X=650273.5 E</td><td></td></tr> <tr><td>11</td><td>Y=451034.0 N</td><td></td></tr> <tr><td>11</td><td>X=650284.7 E</td><td></td></tr> <tr><td>12</td><td>Y=448382.0 N</td><td></td></tr> <tr><td>12</td><td>X=650298.1 E</td><td></td></tr> <tr><td>13</td><td>Y=445726.2 N</td><td></td></tr> <tr><td>13</td><td>X=650312.0 E</td><td></td></tr> </tbody> </table> <p><u>FTP NAD 83</u> 100' FSL & 1700' FWL Y=445805.3 N X=646720.6 E LAT.=32.225136° N LONG.=103.992540° W</p> <p><u>KOP NAD 83</u> 50' FSL & 1700' FWL Y=445755.3 N X=646720.9 E LAT.=32.224998° N LONG.=103.992540° W</p> <p><u>SURFACE LOCATION NAD 83</u> Y=444913.1 N X=646681.4 E LAT.=32.222683° N LONG.=103.992676° W</p>	POINT	LEGEND	NAD83	1	Y=456311.0 N		1	X=644969.9 E		2	Y=453660.3 N		2	X=644969.9 E		3	Y=451006.8 N		3	X=644997.4 E		4	Y=448351.8 N		4	X=645008.9 E		5	Y=445695.4 N		5	X=645021.1 E		6	Y=456320.9 N		6	X=647615.9 E		7	Y=451020.7 N		7	X=647641.0 E		8	Y=445710.8 N		8	X=647666.6 E		9	Y=456330.3 N		9	X=650262.8 E		10	Y=453688.3 N		10	X=650273.5 E		11	Y=451034.0 N		11	X=650284.7 E		12	Y=448382.0 N		12	X=650298.1 E		13	Y=445726.2 N		13	X=650312.0 E			<p><u>PROPOSED BOTTOM HOLE LOCATION NAD 27</u> Y=456238.1 N X=605486.4 E LAT.=32.253855° N LONG.=103.992106° W</p> <p><u>LTP NAD 27</u> 100' FNL & 1700' FWL Y=456158.1 N X=605486.8 E LAT.=32.253635° N LONG.=103.992106° W</p> <table border="1"> <thead> <tr> <th>POINT</th> <th>LEGEND</th> <th>NAD27</th> </tr> </thead> <tbody> <tr><td>1</td><td>Y=456251.8 N</td><td></td></tr> <tr><td>1</td><td>X=603786.3 E</td><td></td></tr> <tr><td>2</td><td>Y=453601.2 N</td><td></td></tr> <tr><td>2</td><td>X=603800.0 E</td><td></td></tr> <tr><td>3</td><td>Y=450947.8 N</td><td></td></tr> <tr><td>3</td><td>X=603813.7 E</td><td></td></tr> <tr><td>4</td><td>Y=448292.8 N</td><td></td></tr> <tr><td>4</td><td>X=603825.1 E</td><td></td></tr> <tr><td>5</td><td>Y=445636.4 N</td><td></td></tr> <tr><td>5</td><td>X=603837.3 E</td><td></td></tr> <tr><td>6</td><td>Y=456261.7 N</td><td></td></tr> <tr><td>6</td><td>X=606432.3 E</td><td></td></tr> <tr><td>7</td><td>Y=450981.7 N</td><td></td></tr> <tr><td>7</td><td>X=606457.3 E</td><td></td></tr> <tr><td>8</td><td>Y=445651.8 N</td><td></td></tr> <tr><td>8</td><td>X=606482.7 E</td><td></td></tr> <tr><td>9</td><td>Y=456271.1 N</td><td></td></tr> <tr><td>9</td><td>X=609079.2 E</td><td></td></tr> <tr><td>10</td><td>Y=453629.2 N</td><td></td></tr> <tr><td>10</td><td>X=609089.8 E</td><td></td></tr> <tr><td>11</td><td>Y=450974.9 N</td><td></td></tr> <tr><td>11</td><td>X=609101.0 E</td><td></td></tr> <tr><td>12</td><td>Y=448323.3 N</td><td></td></tr> <tr><td>12</td><td>X=609114.4 E</td><td></td></tr> <tr><td>13</td><td>Y=445667.2 N</td><td></td></tr> <tr><td>13</td><td>X=609128.2 E</td><td></td></tr> </tbody> </table> <p><u>FTP NAD 27</u> 100' FSL & 1700' FWL Y=445746.3 N X=605536.8 E LAT.=32.225013° N LONG.=103.992051° W</p> <p><u>KOP NAD 27</u> 50' FSL & 1700' FWL Y=445696.3 N X=605537.0 E LAT.=32.224875° N LONG.=103.992051° W</p> <p><u>SURFACE LOCATION NAD 27</u> Y=444854.1 N X=605497.6 E LAT.=32.222561° N LONG.=103.992187° W</p>	POINT	LEGEND	NAD27	1	Y=456251.8 N		1	X=603786.3 E		2	Y=453601.2 N		2	X=603800.0 E		3	Y=450947.8 N		3	X=603813.7 E		4	Y=448292.8 N		4	X=603825.1 E		5	Y=445636.4 N		5	X=603837.3 E		6	Y=456261.7 N		6	X=606432.3 E		7	Y=450981.7 N		7	X=606457.3 E		8	Y=445651.8 N		8	X=606482.7 E		9	Y=456271.1 N		9	X=609079.2 E		10	Y=453629.2 N		10	X=609089.8 E		11	Y=450974.9 N		11	X=609101.0 E		12	Y=448323.3 N		12	X=609114.4 E		13	Y=445667.2 N		13	X=609128.2 E		<p>OPERATOR CERTIFICATION</p> <p>I hereby certify that the information herein is true and complete to the best of my knowledge and belief, and that this organization either owns a working interest or unleased mineral interest in the land including the proposed bottom hole location or has a right to drill this well at this location pursuant to a contract with an owner of such mineral or working interest, or to a voluntary pooling agreement or a compulsory pooling order heretofore entered by the division.</p> <p><u>Stephen Janacek</u> 12/08/2022 Signature Date</p> <p>STEPHEN JANACEK Printed Name</p> <p><u>STEPHEN_JANACEK@OXY.COM</u> E-mail Address</p> <p>SURVEYOR CERTIFICATION</p> <p>I hereby certify that the well location shown on this plat was plotted from field notes of actual surveys made by me or under my supervision, and that the same is true and correct to the best of my belief.</p> <p>OCTOBER 21, 2022 Date of Survey</p> <p>Signature & Seal of Professional Surveyor</p> <p> Chad L. Harcrow 11/3/22 Certificate No. CHAD HARCROW 17777 W.O. #22-1031 DRAWN BY: AH</p>
POINT	LEGEND	NAD83																																																																																																																																																																			
1	Y=456311.0 N																																																																																																																																																																				
1	X=644969.9 E																																																																																																																																																																				
2	Y=453660.3 N																																																																																																																																																																				
2	X=644969.9 E																																																																																																																																																																				
3	Y=451006.8 N																																																																																																																																																																				
3	X=644997.4 E																																																																																																																																																																				
4	Y=448351.8 N																																																																																																																																																																				
4	X=645008.9 E																																																																																																																																																																				
5	Y=445695.4 N																																																																																																																																																																				
5	X=645021.1 E																																																																																																																																																																				
6	Y=456320.9 N																																																																																																																																																																				
6	X=647615.9 E																																																																																																																																																																				
7	Y=451020.7 N																																																																																																																																																																				
7	X=647641.0 E																																																																																																																																																																				
8	Y=445710.8 N																																																																																																																																																																				
8	X=647666.6 E																																																																																																																																																																				
9	Y=456330.3 N																																																																																																																																																																				
9	X=650262.8 E																																																																																																																																																																				
10	Y=453688.3 N																																																																																																																																																																				
10	X=650273.5 E																																																																																																																																																																				
11	Y=451034.0 N																																																																																																																																																																				
11	X=650284.7 E																																																																																																																																																																				
12	Y=448382.0 N																																																																																																																																																																				
12	X=650298.1 E																																																																																																																																																																				
13	Y=445726.2 N																																																																																																																																																																				
13	X=650312.0 E																																																																																																																																																																				
POINT	LEGEND	NAD27																																																																																																																																																																			
1	Y=456251.8 N																																																																																																																																																																				
1	X=603786.3 E																																																																																																																																																																				
2	Y=453601.2 N																																																																																																																																																																				
2	X=603800.0 E																																																																																																																																																																				
3	Y=450947.8 N																																																																																																																																																																				
3	X=603813.7 E																																																																																																																																																																				
4	Y=448292.8 N																																																																																																																																																																				
4	X=603825.1 E																																																																																																																																																																				
5	Y=445636.4 N																																																																																																																																																																				
5	X=603837.3 E																																																																																																																																																																				
6	Y=456261.7 N																																																																																																																																																																				
6	X=606432.3 E																																																																																																																																																																				
7	Y=450981.7 N																																																																																																																																																																				
7	X=606457.3 E																																																																																																																																																																				
8	Y=445651.8 N																																																																																																																																																																				
8	X=606482.7 E																																																																																																																																																																				
9	Y=456271.1 N																																																																																																																																																																				
9	X=609079.2 E																																																																																																																																																																				
10	Y=453629.2 N																																																																																																																																																																				
10	X=609089.8 E																																																																																																																																																																				
11	Y=450974.9 N																																																																																																																																																																				
11	X=609101.0 E																																																																																																																																																																				
12	Y=448323.3 N																																																																																																																																																																				
12	X=609114.4 E																																																																																																																																																																				
13	Y=445667.2 N																																																																																																																																																																				
13	X=609128.2 E																																																																																																																																																																				

Intent ☒ As Drilled ☐

API # 30-015-47194		
Operator Name: OXY USA INC.	Property Name: HEADS CC 9_4 FEDERAL COM	Well Number 37H

Kick Off Point (KOP)

UL N	Section 9	Township 24S	Range 29E	Lot	Feet 50	From N/S SOUTH	Feet 1700	From E/W WEST	County EDDY
Latitude 32.224998					Longitude 103.992540			NAD NAD 83	

First Take Point (FTP)

UL N	Section 9	Township 24S	Range 29E	Lot	Feet 100	From N/S SOUTH	Feet 1700	From E/W WEST	County EDDY
Latitude 32.225136					Longitude 103.992540			NAD NAD 83	

Last Take Point (LTP)

UL	Section 4	Township 24S	Range 29E	Lot 3	Feet 100	From N/S NORTH	Feet 1700	From E/W WEST	County EDDY
Latitude 32.253757					Longitude 103.992596			NAD NAD 83	

Is this well the defining well for the Horizontal Spacing Unit? Is this well an infill well?

If infill is yes please provide API if available, Operator Name and well number for Defining well for Horizontal Spacing Unit.

API # 30-015-47340		
Operator Name: OXY USA INC.	Property Name: HEADS CC 9 4 FEDERAL COM	Well Number #312H

KZ 06/29/2018

HSU AND OFFSET PARTY MAP:
PURPLE SAGE WOLFCAMP POOL
OXY USA INC.
HEADS CC 9 4 FEDERAL COM #37H
30-015-47194



NSL HSU



OFFSET PARTY

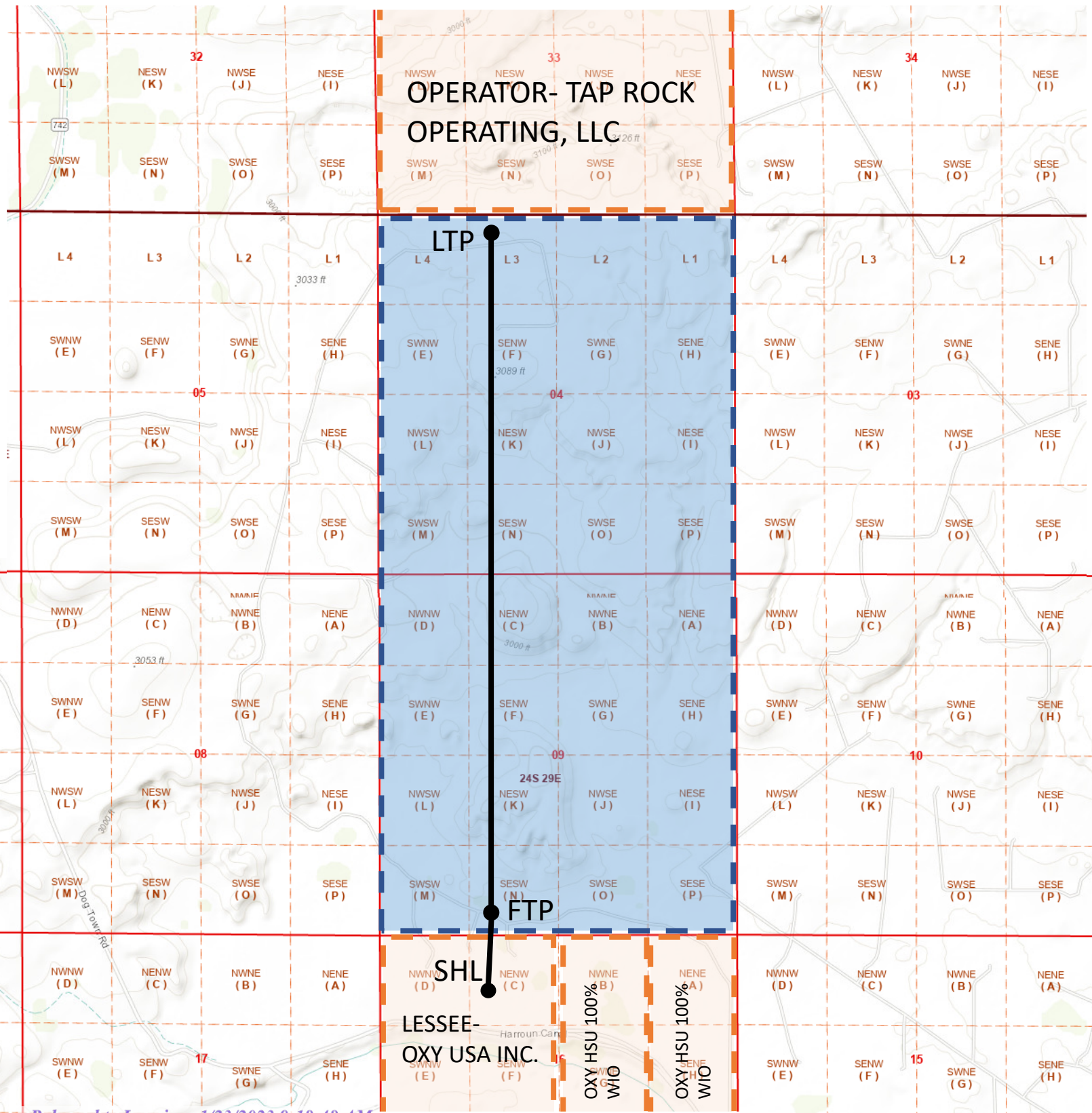

Affected Persons

Name	Street	City	State	Zip Code	Merged	USPS Tracking
Surface Owner						
OXY USA Inc.						
Working Interest Owners						
None- 100% OXY USA Inc.						
Lessees and Operators						
OXY USA Inc.						
Tap Rock Operating, LLC.	523 Park Point Drive	Golden	CO	80401	Tap Rock Operating, LLC. 523 Park Point Drive Golden, CO 80401	_9414811898765832546850
Fed Tracts						
Bureau of Land Management	620 E. Greene Street	Carlsbad	NM	88220-6292	Bureau of Land Management 620 E. Greene Street Carlsbad, NM 88220-6292	_9414811898765832546829
State Tracts						
State Land Office	PO Box 1148	Santa Fe	NM	87504	State Land Office PO Box 1148 Santa Fe, NM 87504	_9414811898765832546843



OXY USA Inc

5 Greenway Plaza, Suite 110
Houston, TX 77046-0521

December 28, 2022

CERTIFIED MAIL – RETURN RECEIPT REQUESTED

Re: ***Application for Administrative Approval of Non-Standard Location:
Heads CC 9 4 Federal Com #37H– Purple Sage Wolfcamp
Eddy County, New Mexico***

To Whom it May Concern:

Enclosed is a copy of an application, filed with the New Mexico Oil Conservation Division by OXY USA Inc., requesting administrative approval for a non-standard location.

As an Affected Person, notice is provided to you pursuant to Rule 19.15.4.12(A)(2)(a), 19.15.15.9(A) and 19.15.16.15(B). The well is located as follows:

Surface	792 FNL, 1654 FWL, C, SEC 16, T24S, R29E
First Take Point	100 FSL, 1700 FWL, N, SEC 9, T24S, R29E
Last Take Point	100 FNL, 1700 FWL, LOT 3, SEC 4, T24S, R29E
Bottom Hole	20 FNL, 1700 FWL, LOT 3, SEC 4, T24S, R29E

If you object to the well's location, you must notify the Division in writing no later than 20 days from the date the application is received by the NMOCD (1220 South St. Francis Drive, Santa Fe, NM 87505; Attention: Leonard Lowe).

If you need any additional information, you can contact Clayton Carroll at 713-366-5281 or myself at 713-493-1986.

Thank you,

A handwritten signature in black ink that reads "Stephen Janacek". The signature is written in a cursive, flowing style.

Stephen Janacek
Regulatory Engineer
OXY USA Inc.



OXY USA Inc

5 Greenway Plaza, Suite 110
Houston, TX 77046-0521

May 23, 2022

Re: ***Protest Waiver for NSLs:
Heads CC 9 4 Development– Purple Sage Wolfcamp
Eddy County, New Mexico***

To Whom it May Concern:

Per the email sent by Matt Phillips (mphillips@taprk.com) to Peter Van Liew (peter_vanliew@oxy.com) on 10/29/2021 at 1:10 PM, Tap Rock Operating, LLC. agreed to waive any right to protest NSLs for the Heads development in Section 4 and Section 9 T24S, R29E Eddy County, New Mexico. The email is attached.

If you need any additional information, you can contact Clayton Carroll at 713-366-5281 or myself at 713-493-1986.

Thank you,

A handwritten signature in black ink that reads "Stephen Janacek". The signature is written in a cursive, flowing style.

Stephen Janacek
Regulatory Engineer
OXY USA Inc.

Janacek, Stephen C

From: Matt Phillips <mphillips@taprk.com>
Sent: Friday, October 29, 2021 1:10 PM
To: Van Liew, Peter R
Subject: RE: [EXTERNAL] RE: Tap Rock Cypress 33 Wells - NSL Waiver

WARNING - This message is from an EXTERNAL SENDER - be CAUTIOUS, particularly with links and attachments.

Peter,

Thank you for the quick response. Tap Rock agrees to waive any right to protest NSLs on Heads. I will place a copy of these emails in the file to memorialize the terms on my end.

Thank you,
Matt

From: Van Liew, Peter R <Peter_VanLiew@oxy.com>
Sent: Friday, October 29, 2021 12:05 PM
To: Matt Phillips <mphillips@taprk.com>
Subject: [EXTERNAL] RE: Tap Rock Cypress 33 Wells - NSL Waiver

[EXTERNAL] This email originated from outside your organization. Do not trust links or attachments.

Matt,

Oxy is amenable to granting to waive any right to protest these NSLs so long as we receive a reciprocal waiver for our Heads development in Section 4. Feel free to confirm via email and let me know if you need anything else related to this request.

Sincerely,

Peter R. Van Liew, RPL
Senior Land Negotiator
Occidental Petroleum Corporation
5 Greenway Plaza, Suite 110
Houston, Texas 77046
713.985.6972 (o)
832.627.6880 (c)

CONFIDENTIALITY NOTICE

The information in this e-mail may be confidential and/or privileged. This e-mail is intended for review only by the individual or organization named above. If you are not the intended recipient, you are hereby notified that any review, dissemination or copying of this e-mail or the information contained herein and in its attachments, if any, is prohibited. If you have received this e-mail in error, please immediately notify the sender by return e-mail and delete this e-mail from your system.

From: Matt Phillips <mphillips@taprk.com>
Sent: Friday, October 29, 2021 12:00 PM
To: Van Liew, Peter R <Peter_VanLiew@oxy.com>
Subject: [EXTERNAL] Tap Rock Cypress 33 Wells - NSL Waiver

WARNING - This message is from an EXTERNAL SENDER - be CAUTIOUS, particularly with links and attachments.

Peter,

Pursuant to our conversation this morning, please allow this email to serve as notice that Tap Rock Operating, LLC intends to drill the following wells at non-standard locations (100' setbacks for FTP and LTP) encroaching on the SW/4 & W/2SE/4 Section 28, T23S, R29E and N/2 Section 4, T24S, R29E:

- E/2 Section 33 (Northern and Southern encroachment): Cypress 33 Fed Com #206H, #246H, #233H, #243H, #213H
- E/2 Section 33 (Southern encroachment): Cypress 33 Fed Com #208H, #214H, #234H, #244H
- W/2 Section 33 (Northern and Southern encroachment): Cypress 33 Fed Com #205H, #207H, #211H, #212H, #231H, #232H, #235H, #241H, #245H, #242H

We plan to spud the E/2 wells starting in December of 2021 and the W/2 wells in April of 2022. If OXY is amenable to granting Tap Rock waivers for the above, we are willing to grant same for any upcoming OXY Heads development and will confirm via email upon request.

Thank you,

Matthew C. Phillips
Land Manager
Direct: (720) 459-3724
Cell: (432) 553-3272
mphillips@taprk.com





Occidental Oil and Gas Corporation
ATTN: Pablo Cabal
5 Greenway Plaza, Suite 110
Houston, TX 77046
713-215-7433
Pablo_Cabal@oxy.com

December 27, 2022

Mr. Leonard Lowe
New Mexico Oil Conservation Division
1220 South Francis Drive
Santa Fe, New Mexico 87505

RE: *Application for Nonstandard Location—Engineer Justification Letter
Oxy USA Inc.
Heads CC 9-4 Federal Com # 34, 35, 37, 42, 43, 44, 52, and 311H
T24S R29E, Sections 4 & 9, Eddy County*

Dear Mr. Lowe:

Oxy USA Inc. respectfully seeks approval for a non-standard location, decreasing the first and last take point for the following wells:

- Heads CC 9-4 Federal Com #34H
- Heads CC 9-4 Federal Com #35H
- Heads CC 9-4 Federal Com #37H
- Heads CC 9-4 Federal Com #42H
- Heads CC 9-4 Federal Com #43H
- Heads CC 9-4 Federal Com #44H
- Heads CC 9-4 Federal Com #52H
- Heads CC 9-4 Federal Com #311H

These wells will be completed in the Purple Sage Wolfcamp Pool (Gas). The FTP and LTP offset distance will be reduced from 330 feet to 100 feet.

It is Oxy's responsibility as a prudent operator to maximize lateral length and minimize reserves left in the ground. Decreasing the first and last take point will increase this well's effective lateral length by 460 feet and increase the estimated ultimate recovery of the well by approximately 5%. Any increase in first or last take point would result in untapped reserves left in the reservoir, and waste of a resource that would otherwise go undeveloped.

Sincerely,

A handwritten signature in blue ink, appearing to read "P. Cabal", is placed over a light blue rectangular background.

Pablo Cabal
Reservoir Engineer

District I
1625 N. French Dr., Hobbs, NM 88240
Phone:(575) 393-6161 Fax:(575) 393-0720
District II
811 S. First St., Artesia, NM 88210
Phone:(575) 748-1283 Fax:(575) 748-9720
District III
1000 Rio Brazos Rd., Aztec, NM 87410
Phone:(505) 334-6178 Fax:(505) 334-6170
District IV
1220 S. St Francis Dr., Santa Fe, NM 87505
Phone:(505) 476-3470 Fax:(505) 476-3462

State of New Mexico
Energy, Minerals and Natural Resources
Oil Conservation Division
1220 S. St Francis Dr.
Santa Fe, NM 87505

CONDITIONS

Action 170625

CONDITIONS

Operator: OXY USA INC P.O. Box 4294 Houston, TX 772104294	OGRID: 16696
	Action Number: 170625
	Action Type: [UF-NSL] Non-Standard Location (NSL)

CONDITIONS

Created By	Condition	Condition Date
llowe	None	1/23/2023