

AE Order Number Banner

Application Number: pAYH2329349274

SWD-2576

Pilot Water Solutions SWD LLC [331374]



October 13, 2023

Oil Conservation Division
1220 South St. Francis Dr.
Santa Fe, New Mexico 87505

Subject: Pilot Water Solutions SWD LLC
Application for Authorization to Inject
Burrow SWD State #1

Mr. Fuge,

Pilot Water Solutions SWD LLC (Pilot) is applying for administrative approval of the attached Application for Authorization to Inject (Form C-108) for their proposed Burrow SWD State #1. The application is requesting authorization to dispose of saltwater from oil and gas production in the area via commercial disposal into the San Andres Formation in Lea County, NM.

Questions regarding this application or the included materials can be directed to Nate Alleman (Pilot Regulatory Advisor Contractor) via telephone at 918-237-0559 or via email at nate.alleman@aceadvisors.com.

Sincerely,

A handwritten signature in black ink that reads "Nathan Alleman".

Nate Alleman
Chief Regulatory Advisor
Ace Energy Advisors

Revised March 23, 2017

RECEIVED:	REVIEWER:	TYPE:	APP NO:
-----------	-----------	-------	---------

ABOVE THIS TABLE FOR OCD DIVISION USE ONLY

NEW MEXICO OIL CONSERVATION DIVISION
 - Geological & Engineering Bureau -
 1220 South St. Francis Drive, Santa Fe, NM 87505



ADMINISTRATIVE APPLICATION CHECKLIST

THIS CHECKLIST IS MANDATORY FOR ALL ADMINISTRATIVE APPLICATIONS FOR EXCEPTIONS TO DIVISION RULES AND REGULATIONS WHICH REQUIRE PROCESSING AT THE DIVISION LEVEL IN SANTA FE

Applicant: Pilot Water Solutions SWD LLC OGRID Number: 331374
 Well Name: Burrow State SWD #1 API: 30-025-
 Pool: SWD; San Andres Pool Code: 96121

SUBMIT ACCURATE AND COMPLETE INFORMATION REQUIRED TO PROCESS THE TYPE OF APPLICATION INDICATED BELOW

1) TYPE OF APPLICATION: Check those which apply for [A]

A. Location – Spacing Unit – Simultaneous Dedication

☐ NSL ☐ NSP (PROJECT AREA) ☐ NSP (PRORATION UNIT) ☐ SD

B. Check one only for [I] or [II]

[I] Commingling – Storage – Measurement

☐ DHC ☐ CTB ☐ PLC ☐ PC ☐ OLS ☐ OLM

[II] Injection – Disposal – Pressure Increase – Enhanced Oil Recovery

☐ WFX ☐ PMX ☒ SWD ☐ IPI ☐ EOR ☐ PPR

2) NOTIFICATION REQUIRED TO: Check those which apply.

- A. ☒ Offset operators or lease holders
 B. ☐ Royalty, overriding royalty owners, revenue owners
 C. ☒ Application requires published notice
 D. ☒ Notification and/or concurrent approval by SLO
 E. ☐ Notification and/or concurrent approval by BLM
 F. ☒ Surface owner
 G. ☒ For all of the above, proof of notification or publication is attached, and/or,
 H. ☐ No notice required

FOR OCD ONLY

- ☐ Notice Complete
☐ Application Content Complete

3) CERTIFICATION: I hereby certify that the information submitted with this application for administrative approval is accurate and complete to the best of my knowledge. I also understand that no action will be taken on this application until the required information and notifications are submitted to the Division.

Note: Statement must be completed by an individual with managerial and/or supervisory capacity.

David Grounds

Print or Type Name

David Grounds

Signature

10/13/2023

Date

713-307-8752

Phone Number

david.grounds@pilotwater.com

e-mail Address

STATE OF NEW MEXICO
ENERGY, MINERALS AND NATURAL
RESOURCES DEPARTMENT

Oil Conservation Division
1220 South St. Francis Dr.
Santa Fe, New Mexico 87505

FORM C-108
Revised June 10, 2003

APPLICATION FOR AUTHORIZATION TO INJECT

- I. PURPOSE: _____ Secondary Recovery _____ Pressure Maintenance _____ ☒ Disposal _____ Storage
Application qualifies for administrative approval? _____ ☒ Yes _____ No
- II. OPERATOR: Pilot Water Solutions SWD LLC
ADDRESS: 20 Greenway Plaza, Suite 200, Houston, TX 77046
CONTACT PARTY: David Grounds PHONE: 713-307-8752
- III. WELL DATA: Complete the data required on the reverse side of this form for each well proposed for injection.
Additional sheets may be attached if necessary.
- IV. Is this an expansion of an existing project? _____ Yes _____ ☒ No
If yes, give the Division order number authorizing the project: _____
- V. Attach a map that identifies all wells and leases within two miles of any proposed injection well with a one-half mile radius circle drawn around each proposed injection well. This circle identifies the well's area of review.
- VI. Attach a tabulation of data on all wells of public record within the area of review which penetrate the proposed injection zone. Such data shall include a description of each well's type, construction, date drilled, location, depth, record of completion, and a schematic of any plugged well illustrating all plugging detail.
- VII. Attach data on the proposed operation, including:
1. Proposed average and maximum daily rate and volume of fluids to be injected;
 2. Whether the system is open or closed;
 3. Proposed average and maximum injection pressure;
 4. Sources and an appropriate analysis of injection fluid and compatibility with the receiving formation if other than reinjected produced water; and,
 5. If injection is for disposal purposes into a zone not productive of oil or gas at or within one mile of the proposed well, attach a chemical analysis of the disposal zone formation water (may be measured or inferred from existing literature, studies, nearby wells, etc.).
- *VIII. Attach appropriate geologic data on the injection zone including appropriate lithologic detail, geologic name, thickness, and depth. Give the geologic name, and depth to bottom of all underground sources of drinking water (aquifers containing waters with total dissolved solids concentrations of 10,000 mg/l or less) overlying the proposed injection zone as well as any such sources known to be immediately underlying the injection interval.
- IX. Describe the proposed stimulation program, if any.
- *X. Attach appropriate logging and test data on the well. (If well logs have been filed with the Division, they need not be resubmitted).
- *XI. Attach a chemical analysis of fresh water from two or more fresh water wells (if available and producing) within one mile of any injection or disposal well showing location of wells and dates samples were taken.
- XII. Applicants for disposal wells must make an affirmative statement that they have examined available geologic and engineering data and find no evidence of open faults or any other hydrologic connection between the disposal zone and any underground sources of drinking water.
- XIII. Applicants must complete the "Proof of Notice" section on the reverse side of this form.
- XIV. Certification: I hereby certify that the information submitted with this application is true and correct to the best of my knowledge and belief.
- NAME: David Grounds TITLE: VP - Regulatory Compliance
SIGNATURE: David Grounds DATE: 10/13/2023
E-MAIL ADDRESS: david.grounds@pilotwater.com
- * If the information required under Sections VI, VIII, X, and XI above has been previously submitted, it need not be resubmitted. Please show the date and circumstances of the earlier submittal: _____

DISTRIBUTION: Original and one copy to Santa Fe with one copy to the appropriate District Office

III. Well Data

A. The following well data must be submitted for each injection well covered by this application. The data must be both in tabular and schematic form and shall include:

- (1) Lease name; Well No.; Location by Section, Township and Range; and footage location within the section.**

Operator: Pilot Water Solutions SWD LLC (OGRID# 331374)

Lease/Well Name & Number: Burrow SWD State #1

Legal Location: 458' FNL & 1,612' FWL- Unit C – Section 5 T19S R37E – Lea County

- (2) Each casing string used with its size, setting depth, sacks of cement used, hole size, top of cement, and how such top was determined.**

Casing String	Hole Size (in)	Casing Size (in)	Casing Depth (ft)	Sacks Cement (sx)	Top of Cement (ft)	Method Determined
Surface	17-1/2	13-3/8	1,487	2,330.7	0	Circulation
Production	12-1/4	9-5/8	5,629	1,680.3	0	Circulation

A wellbore diagram is included in **Attachment 1**.

- (3) A description of the tubing to be used including its size, lining material, and setting depth.**

5-1/2" fiberglass-coated tubing set at 4,330'

- (4) The name, model, and setting depth of the packer used or a description of any other seal system or assembly used.**

Weatherford AS1X Stainless 9-5/8" X 5-1/2" set at 4,330'.

B. The following must be submitted for each injection well covered by this application. All items must be addressed for the initial well. Responses for additional wells need be shown only when different. Information shown on schematics need not be repeated.

- (1) The name of the injection formation and, if applicable, the field or pool name.**

Injection Formation Name - San Andres

Pool Name - SWD; San Andres

Pool Code – 96121

- (2) The injection interval and whether it is perforated or open-hole.**

Cased-hole injection between 4,330' - 5'629'.

- (3) State if the well was drilled for injection or, if not, the original purpose of the well.**

New drill for injection

- (4) Give the depths of any other perforated intervals and detail on the sacks of cement or bridge plugs used to seal off such perforations.**

None

- (5) Give the depth to and the name of the next higher and next lower oil or gas zone in the area of the well, if any.**

- **Overlying**
 - Yates (2,751')
 - 7 Rivers (3,019')
 - Queen (3,475')
 - Grayburg (3,917')
- **Underlying** - No underlying oil and gas zones present.

Note: the proposed SWD is located on the Central Basin Platform. Therefore, the listed productive zones are limited to those productive zones occurring on the Central Basin Platform.

V. AOR Maps

Attach a map that identifies all wells and leases within two miles of any proposed injection well with a one-half mile radius circle drawn around each proposed injection well. This circle identifies the well's area of review.

The following maps are included in **Attachment 2**:

- ½-Mile AOR/Surface & Mineral Ownership Map
- ½-Mile Leaseholder Map
- 2-Mile Oil & Gas Well Map

VI. AOR List

Attach a tabulation of data on all wells of public record within the area of review which penetrate the proposed injection zone. Such data shall include a description of each well's type, construction, date drilled, location, depth, record of completion, and a schematic of any plugged well illustrating all plugging detail.

Details of the wells within the 0.5-mile AOR are included in **Attachment 2**. No wells within the 0.5-mile AOR penetrate the top of the proposed injection zone.

VII. Operational Information

Attach data on the proposed operation, including:

- (1) Proposed average and maximum daily rate and volume of fluids to be injected;**

Maximum: 25,000 bpd

Average: 15,000 bpd

- (2) Whether the system is open or closed;**

The system will be closed.

- (3) Proposed average and maximum injection pressure;**

Maximum: 866 psi (surface)

Average: approx. 500-600 psi (surface)

- (4) Sources and an appropriate analysis of injection fluid and compatibility with the receiving formation if other than reinjected produced water;**

It is anticipated that produced water from Wolfcamp and Bone Spring production wells in the area will be injected into the proposed SWD. Therefore, water analysis from these formations was obtained and is included in **Attachment 3**.

- (5) If injection is for disposal purposes into a zone not productive of oil or gas at or within one mile of the proposed well, attach a chemical analysis of the disposal zone formation water (may be measured or inferred from existing literature, studies, nearby wells, etc.).**

The proposed injection interval for this SWD is the San Andres formation, which is a non-productive zone known to be compatible with formation water from the Wolfcamp and Bone Spring formations. Water analyses of samples collected from the proposed injection formation in the area were obtained and are included in **Attachment 4**.

VIII. Geologic Description

Attach appropriate geologic data on the injection zone including appropriate lithologic detail, geologic name, thickness, and depth. Give the geologic name, and depth to bottom of all underground sources of drinking water (aquifers containing waters with total dissolved solids concentrations of 10,000 mg/l or less) overlying the proposed injection zone as well as any such sources known to be immediately underlying the injection interval.

The proposed injection interval is located in the San Andres formation between the depths of 4,330 and 5,629 feet. The San Andres formation consists of an interbedded carbonate sequence composed of limestone and dolomite. These cycles tend to be mappable within the San Andres and are differentiated by sections of either very high or very low porosity and permeability development. Upper and lower confinement will be provided by tight carbonate facies present within San Andres that occur above and below the porous injection interval. The upper confining interval occurs at the top of the San Andres formation, directly underlying the Grayburg formation, and ranges from 125' – 150' net thickness based on a review of nearby open-hole geophysical logs. The lower confining interval occurs at the bottom of the San Andres formation, directly overlying the Glorieta formation, and ranges from 150' - 200' net thickness based on a review of nearby open-hole geophysical logs.

The base of the lowermost Underground Source of Drinking Water (USDW), identified as the top of the first anhydrite, was determined to occur at the top of the Rustler formation at a depth of 1,462'. Water wells in the area are drilled to a depth of approximately 55' – 200'.

IX. Proposed Stimulation Program

Describe the proposed stimulation program, if any.

A minor acid job utilizing 15-20% hydrochloric acid may be used to cleanup the wellbore.

X. Logging and Test Data

Attach appropriate logging and test data on the well. (If well logs have been filed with the Division, they need not be resubmitted).

Logs will be run and submitted to the Division once the well is completed.

XI. Groundwater Wells

Attach a chemical analysis of fresh water from two or more fresh water wells (if available and producing) within one mile of any injection or disposal well showing location of wells and dates samples were taken.

Based on data obtained from the New Mexico Office of the State Engineer (OSE), a total of 21 groundwater wells (11 Active, 2 Pending, 4 Inactive, 1 Capped and 3 Plugged) are located within 1 mile of the proposed SWD location.

Multiple attempts have been made to contact the owners of the water wells that meet the sampling criteria and such contact efforts will be continued. Associated water sample analyses will be submitted to OCD upon completion.

Attachment 5 includes a table with details of the water wells within 1-mile and a water well map.

XII. No Hydrologic Connection Statement

Applicants for disposal wells must make an affirmative statement that they have examined available geologic and engineering data and find no evidence of open faults or any other hydrologic connection between the disposal zone and any underground sources of drinking water.

A geologic review conducted on offset wireline log data and published regional studies did not identify any faulting in the vicinity of the proposed locations that would allow for the hydraulic communication between the injection interval and overlying USDWs. The base of the lowermost Underground Source of Drinking Water (USDW), identified as the top of the first anhydrite, was determined to occur at the top of the Rustler formation at a depth of 1,462'.

XIII. Proof of Notice

Applicants must complete the "Proof of Notice" section on the reverse side of this form.

All applicants must furnish proof that a copy of the application has been furnished, by certified or registered mail, to the owner of the surface of the land on which the well is to be located and to each leasehold operator within one-half mile of the well location.

A copy of the application was mailed to the Affected Persons, including the OCD District Office, surface owner, leasehold operators within the AOR, and BLM/SLO if they own minerals within the AOR. **Attachment 6** includes a list of the Affected Persons receiving notice of the application and the associated certified mailing receipts (green sheets).

Where an application is subject to administrative approval, a proof of publication must be submitted. Such proof shall consist of a copy of the legal advertisement which was published in the county in which the well is located.

A Public Notice was published in the Hobbs NewsSun, a newspaper of general circulation in the area, and the associated affidavit is included in **Attachment 6**.

Attachment 1

District I
1625 N. French Dr., Hobbs, NM 88240
Phone: (575) 393-6161 Fax: (575) 393-0720
District II
811 S. First St., Artesia, NM 88210
Phone: (575) 748-1283 Fax: (575) 748-9720
District III
1000 Rio Brazos Road, Aztec, NM 87410
Phone: (505) 334-6178 Fax: (505) 334-6170
District IV
1220 S. St. Francis Dr., Santa Fe, NM 87505
Phone: (505) 476-3460 Fax: (505) 476-3462

State of New Mexico
Energy, Minerals & Natural Resources Department
OIL CONSERVATION DIVISION
1220 South St. Francis Dr.
Santa Fe, NM 87505

Form C-102
Revised August 1, 2011
Submit one copy to appropriate
District Office
☐ AMENDED REPORT

WELL LOCATION AND ACREAGE DEDICATION PLAT

¹ API Number	² Pool Code 96121	³ Pool Name SWD; San Andres
⁴ Property Code	⁵ Property Name BURROW SWD STATE	⁶ Well Number #1
⁷ OGRID No. 331374	⁸ Operator Name Pilot Water Solutions SWD LLC	⁹ Elevation 3713.75'

¹⁰ Surface Location

UL or lot no.	Section	Township	Range	Lot Idn	Feet from the	North/South line	Feet from the	East/West line	County
C	5	19 S	37 E		458	NORTH	1612	WEST	LEA

¹¹ Bottom Hole Location If Different From Surface

UL or lot no.	Section	Township	Range	Lot Idn	Feet from the	North/South line	Feet from the	East/West line	County

¹² Dedicated Acres	¹³ Joint or Infill	¹⁴ Consolidation Code	¹⁵ Order No.

No allowable will be assigned to this completion until all interests have been consolidated or a non-standard unit has been approved by the division.

¹⁶ 		¹⁷ OPERATOR CERTIFICATION I hereby certify that the information contained herein is true and complete to the best of my knowledge and belief, and that this organization either owns a working interest or unleased mineral interest in the land including the proposed bottom hole location or has a right to drill this well at this location pursuant to a contract with an owner of such a mineral or working interest, or to a voluntary pooling agreement or a compulsory pooling order heretofore entered by the division. Signature 08/22/2023 Date Nate Alleman Printed Name nate.alleman@aceadvisors.com E-mail Address	
GEODETIC DATA NAD 83 NM EAST BURROW SWD STATE 1 X: 866331.20' Y: 618404.79' LAT.: N 32.69558831 LONG.: W -103.2768978 1-Y=618852.49', X=864715.08' 2-Y=618886.35', X=869988.38' 3-Y=613512.79', X=870030.42' 4-Y=613473.44', X=864761.20'		¹⁸ SURVEYOR CERTIFICATION I hereby certify that the well location shown on this plat was plotted from field notes of actual surveys made by me or under my supervision, and that the same is true and correct to the best of my belief. Date of Survey 07/25/2023 Date Signature and Seal of Professional Surveyor: 	
⁴		³	

Pilot Water Solutions SWD LLC

Burrow SWD State #1 Wellbore Diagram

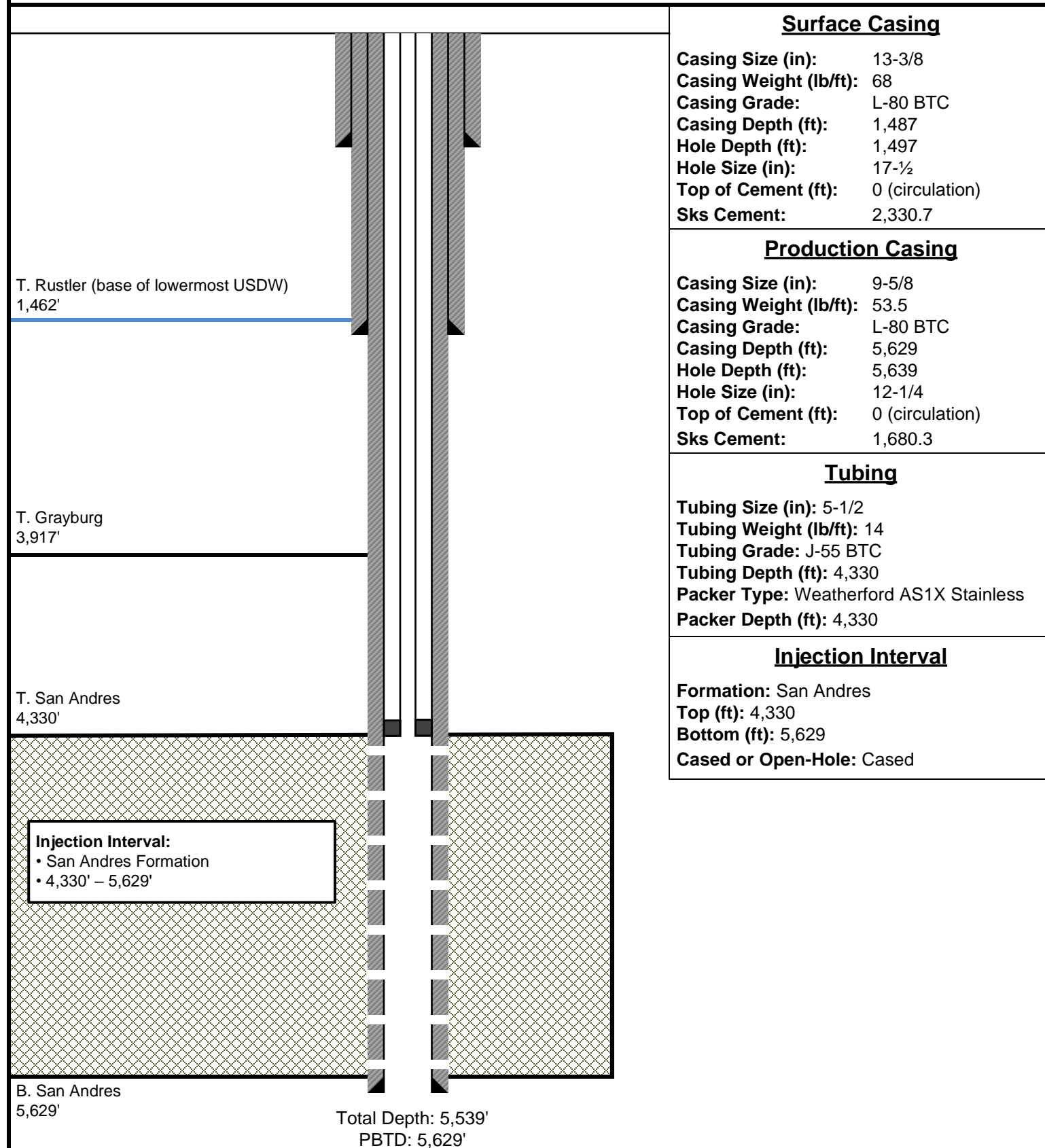

Note: Listed depths and cement volumes are approximates based on available information.

NOT TO SCALE

Attachment 2

Burrow SWD State Well No.1 - Area of Review - 2 Miles

(Attachment to NMOCD Form C-108 - Item V)

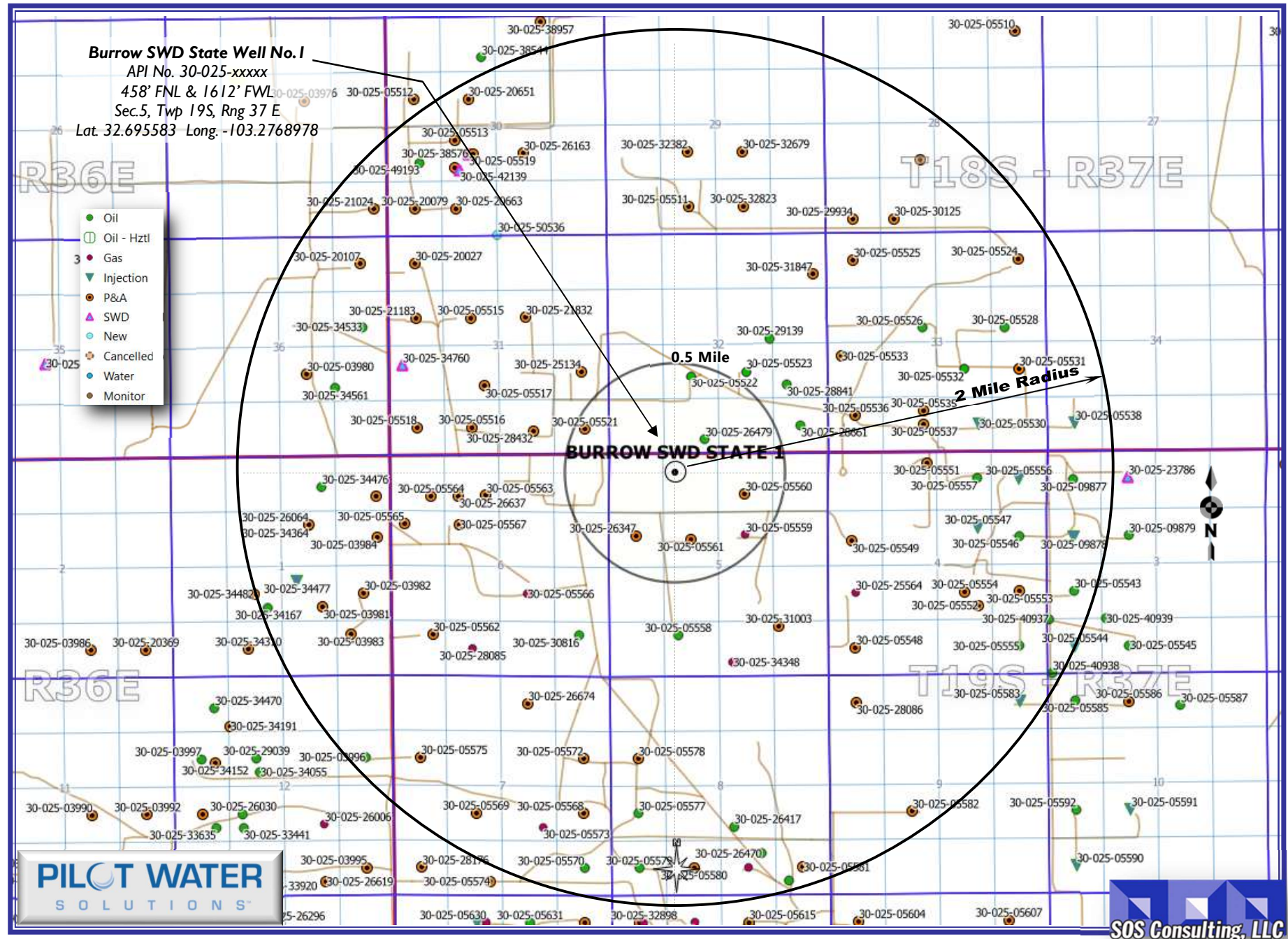

Burrow SWD State #1 – Surface & Minerals Ownership

(Attachment to NMOCD Form C-108, Application for Authority to Inject.)

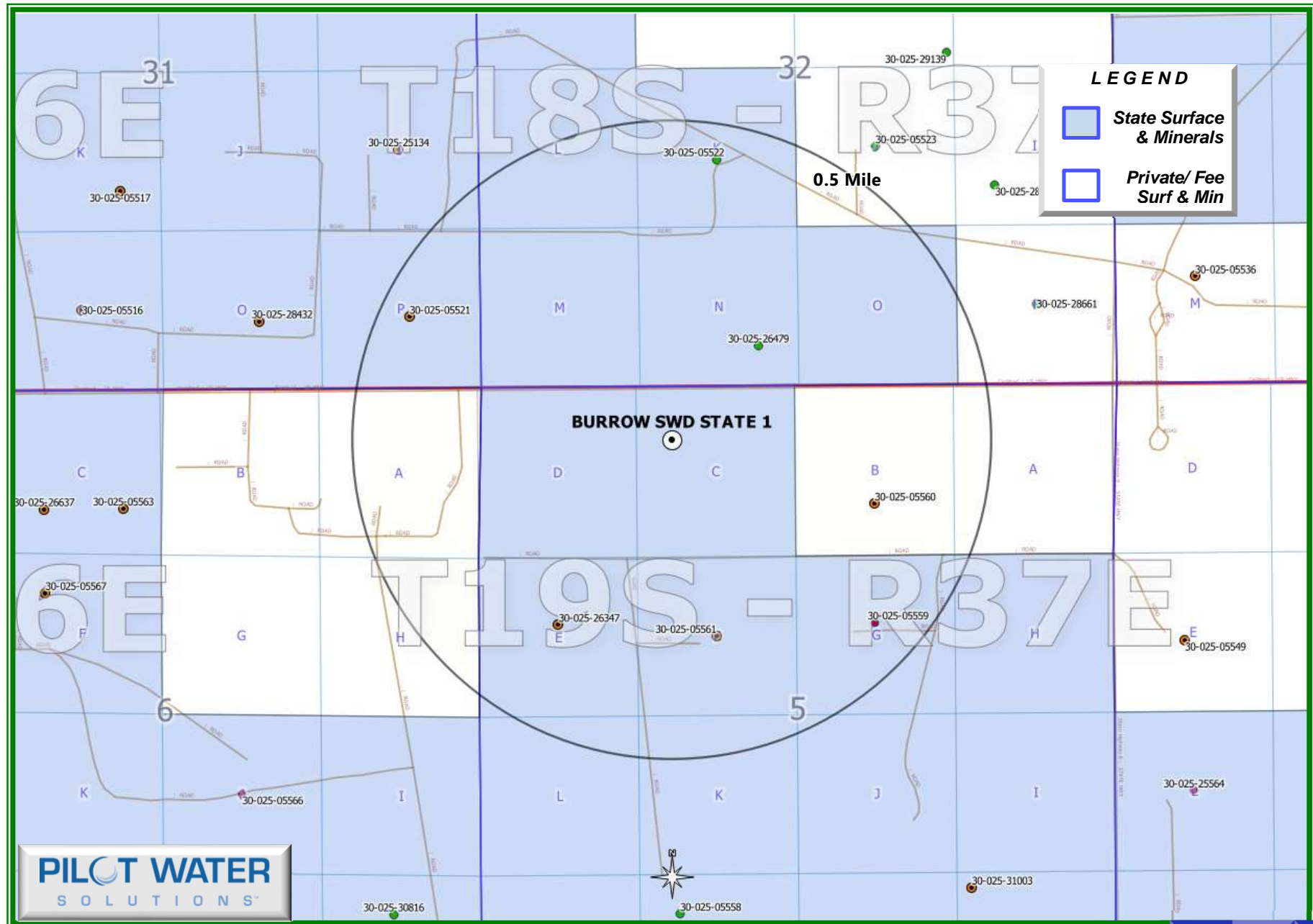

1/2-Mile AOR Tabulation for Burrow SWD State #1 (Top of Injection Interval: 4,330')

Well Name	API#	Well Type	Operator	Status	Spud Date	Location (Sec., Tn., Rng.)	Total Vertical Depth (feet)	Penetrate Inj. Zone?
PRE-ONGARD WELL #001	30-025-05521	G	PRE-ONGARD WELL OPERATOR	Plugged (site released)	1/20/1954	P-31-18S-37E	3,890	No
STATE AC #002	30-025-26347	G	LANEXCO INC	Plugged (site released)	11/20/1979	E-05-19S-37E	3,950	No
NEW MEXICO AK STATE #001	30-025-05522	O	Energy Acumen LLC	Active	9/4/1955	K-32-18S-37E	4,195	No
NEW MEXICO AK STATE #002	30-025-26479	O	Energy Acumen LLC	Active	10/9/1979	N-32-18S-37E	4,200	No
STATE AC #001	30-025-05561	G	LANEXCO INC	Plugged (site released)	1/31/1956	F-05-19S-37E	3,923	No
J R HOLT A #001	30-025-05559	G	MORGAN OPERATING, INC.	Active	7/17/1957	G-05-19S-37E	3,900	No
PRE-ONGARD WELL #001	30-025-05560	G	PRE-ONGARD WELL OPERATOR	Plugged (site released)	5/16/1957	B-05-19S-37E	3,999	No
Notes: No wells within the 1/2-mile AOR penetrate the injection interval.								

Burrow SWD State #1 – Leasehold Plat

(Attachment to NMOCD Form C-108, Application for Authority to Inject.)

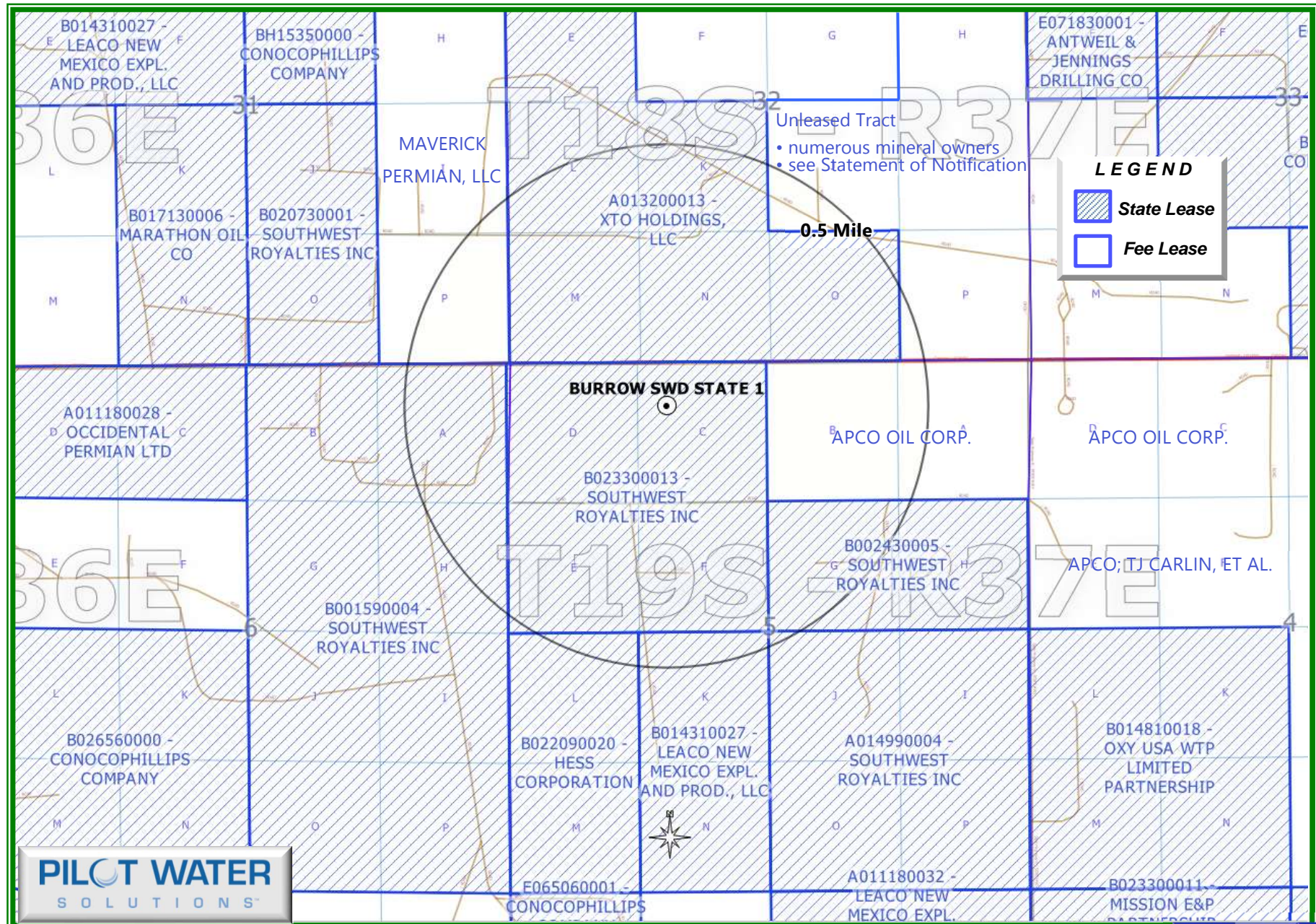

Attachment 3

Source Formation Water Analysis																							
Well Name	API	Latitude	Longitude	Section	Township	Range	Unit	Ftgns	Ftgew	County	State	Formation	Sampled	PH	TDS (Mg/L)	Sodium (Mg/L)	Calcium (MG/L)	Iron (MG/L)	Magnesium (MG/L)	Manganese (MG/L)	Chloride (MG/L)	Bicarbonate (MG/L)	Sulfate (MG/L)
STATE NPA #001	3002503156	32.6879654	-103.5031815	6	19S	35E	L	1980S	660W	LEA	NM	BONE SPRING	1960	7.7	25800.0						14100.0	830.0	1120.0
SHOOTING STAR STATE SWD #001	3002529805	32.7594261	-103.4270935	11	18S	35E	J	1650S	2310E	LEA	NM	BONE SPRING	2001	6.2			15600.0	2.5	981.9		148248.0	244.0	650.0
SINCLAIR STATE #002	3002503123	32.7386246	-103.4561005	21	18S	35E	A	660N	660E	LEA	NM	WOLFCAMP	1960	7.1	60950.0						33568.0	1087.0	3049.0
IRONHOUSE 19 STATE COM #001H	3002540676	32.7266121	-103.499527	19	18S	35E	N	200S	1800W	Lea	NM	BONE SPRING 2ND SAND	2014	6.4	182863.9	58171.0	4944.4	49.0	1892.6	1.4	113954.0	195.2	0.0
IRONHOUSE 19 STATE COM #004H	3002541245	32.7264938	-103.5014343	19	18S	35E	M	150S	1215W	Lea	NM	BONE SPRING 2ND SAND	2014	6.2	189029.2	64016.2	5319.3	38.8	2044.4	1.5	113566.0	158.6	0.0
IRONHOUSE 19 STATE COM #002H	3002541094	32.7271118	-103.4903336	19	18S	35E	P	410S	630E	Lea	NM	BONE SPRING 2ND SAND	2014	6.0	205332.0	72646.0	4828.0	39.0	2316.0	2.0	130450.0	488.0	1503.0
IRONHOUSE 20 STATE COM #001	3002540611	32.7265129	-103.4774857	20	18S	35E	O	200S	1980E	Lea	NM	BONE SPRING 2ND SAND	2014	6.1	186865.0	65638.0	4698.0	16.0	1700.0	1.0	116510.0	1098.0	1804.0
IRONHOUSE 20 STATE #002H	3002540748	32.7265129	-103.4731903	20	18S	35E	P	200S	660E	Lea	NM	BONE SPRING 2ND SAND	2014	6.6	196865.0	66738.0	4631.0	23.0	1790.0	1.0	116580.0	1298.0	1894.0
IRONHOUSE 19 STATE COM #003H	3002541050	32.7264977	-103.4941711	19	18S	35E	O	175S	1810E	Lea	NM	BONE SPRING 2ND SAND	2014	6.2	178457.0	56874.0	6125.0	22.0	1457.0	1.0	125412.0	845.0	849.0
HAMON STATE #001	3002503140	32.7175827	-103.4464035	27	18S	35E	K	2310S	2310W	LEA	NM	BONE SPRING			154510.0						96360.0	430.0	1210.0
LEA 403 STATE #001	3002503126	32.7386093	-103.4518051	22	18S	35E	D	660N	660W	LEA	NM	BONE SPRING	1958	6.7	255451.0						156699.0	327.0	779.0

Attachment 4

Injection Formation Water Analysis																		
Well Name	API	Latitude	Longitude	Section	Township	Range	Unit	Ftgns	Ftgew	County	State	Formation	Sampled	PH	TDS (Mg/L)	Chloride (MG/L)	Bicarbonate (MG/L)	Sulfate (MG/L)
B V CULP NCT A #008	3002505640	32.6467896	-103.2919235	19	19S	37E	F	2310N	2239W	LEA	NM	SAN ANDRES			10905	2350	1100	3700
B V CULP NCT A #008	3002505640	32.6467896	-103.2919235	19	19S	37E	F	2310N	2239W	LEA	NM	SAN ANDRES			26735	14500	1370	1020
B V CULP NCT A #008	3002505640	32.6467896	-103.2919235	19	19S	37E	F	2310N	2239W	LEA	NM	SAN ANDRES			40250	20800	1390	3100
B V CULP NCT A #008	3002505640	32.6467896	-103.2919235	19	19S	37E	F	2310N	2239W	LEA	NM	SAN ANDRES			71110	39800	810	3500
B V CULP NCT A #008	3002505640	32.6467896	-103.2919235	19	19S	37E	F	2310N	2239W	LEA	NM	SAN ANDRES			156218	95130	176	771
NORTH MONUMENT G/SA UNIT #001	3002505647	32.6512489	-103.2843475	19	19S	37E	A	660N	660E	Lea	NM	SAN ANDRES	1964	6.0		10200	592	1938
GOODWIN #002	3002520651	32.7204323	-103.2928467	30	18S	37E	F	1980N	1980W	LEA	NM	SAN ANDRES			80467	45060	1492	3315
GOODWIN #002	3002520651	32.7204323	-103.2928467	30	18S	37E	F	1980N	1980W	LEA	NM	SAN ANDRES			69848	39130	1225	3114
NORTH HOBBS UNIT #001	3002505449	32.7530632	-103.211138	13	18S	37E	D	660N	660W	LEA	NM	SAN ANDRES	1960	8.0	12100	4500	504	2300
NORTH HOBBS UNIT #001	3002505449	32.7530632	-103.211138	13	18S	37E	D	660N	660W	LEA	NM	SAN ANDRES			12100	4541	509	2321
BOBBI STATE WF UNIT #006	3002503978	32.7231979	-103.373436	29	18S	36E	B	990N	1650E	LEA	NM	SAN ANDRES			20882	11190	645	1232
STATE NG #001	3002522795	32.7349815	-103.3057404	24	18S	36E	G	1980N	1980E	LEA	NM	SAN ANDRES	1968	6.5	265665	157000	98	5400
STATE NG #001	3002522795	32.7349815	-103.3057404	24	18S	36E	G	1980N	1980E	LEA	NM	SAN ANDRES	1968	6.3	203913	122000	110	3000
GRAHAM STATE NCT F #003	3002512476	32.6149902	-103.3056641	36	19S	36E	J	1980S	1980E	LEA	NM	SAN ANDRES	1900	6.5		16406	611	
NORTHWEST EUMONT UNIT #156	3002504099	32.617733	-103.3518143	33	19S	36E	H	2310N	330E	Lea	NM	SAN ANDRES	1960	7.0		38119	405	4317
GRAHAM STATE NCT F #003	3002512476	32.6149902	-103.3056641	36	19S	36E	J	1980S	1980E	Lea	NM	SAN ANDRES	1964	6.5		16406	611	
GRAHAM STATE NCT F #003	3002512476	32.6149902	-103.3056641	36	19S	36E	J	1980S	1980E	LEA	NM	SAN ANDRES			26344			
E M E SWD #008	3002506017	32.5895042	-103.2725601	8	20S	37E	G	1980N	2310E	LEA	NM	SAN ANDRES	1964	8.5	65365	36905	560	1460
THEODORE ANDERSON #002	3002506139	32.5785942	-103.2758102	17	20S	37E	C	660N	1980W	Lea	NM	SAN ANDRES	1964	6.7		67245	564	489
E M E SWD #008	3002506017	32.5895042	-103.2725601	8	20S	37E	G	1980N	2310E	LEA	NM	SAN ANDRES			65361	36900	560	1460
EUNICE MONUMENT UNIT #031	3002506169	32.5531693	-103.2843781	19	20S	37E	P	660S	660E	LEA	NM	SAN ANDRES			91120	59850	0	722

Attachment 5

Burrow SWD State #1 - Water Well Map

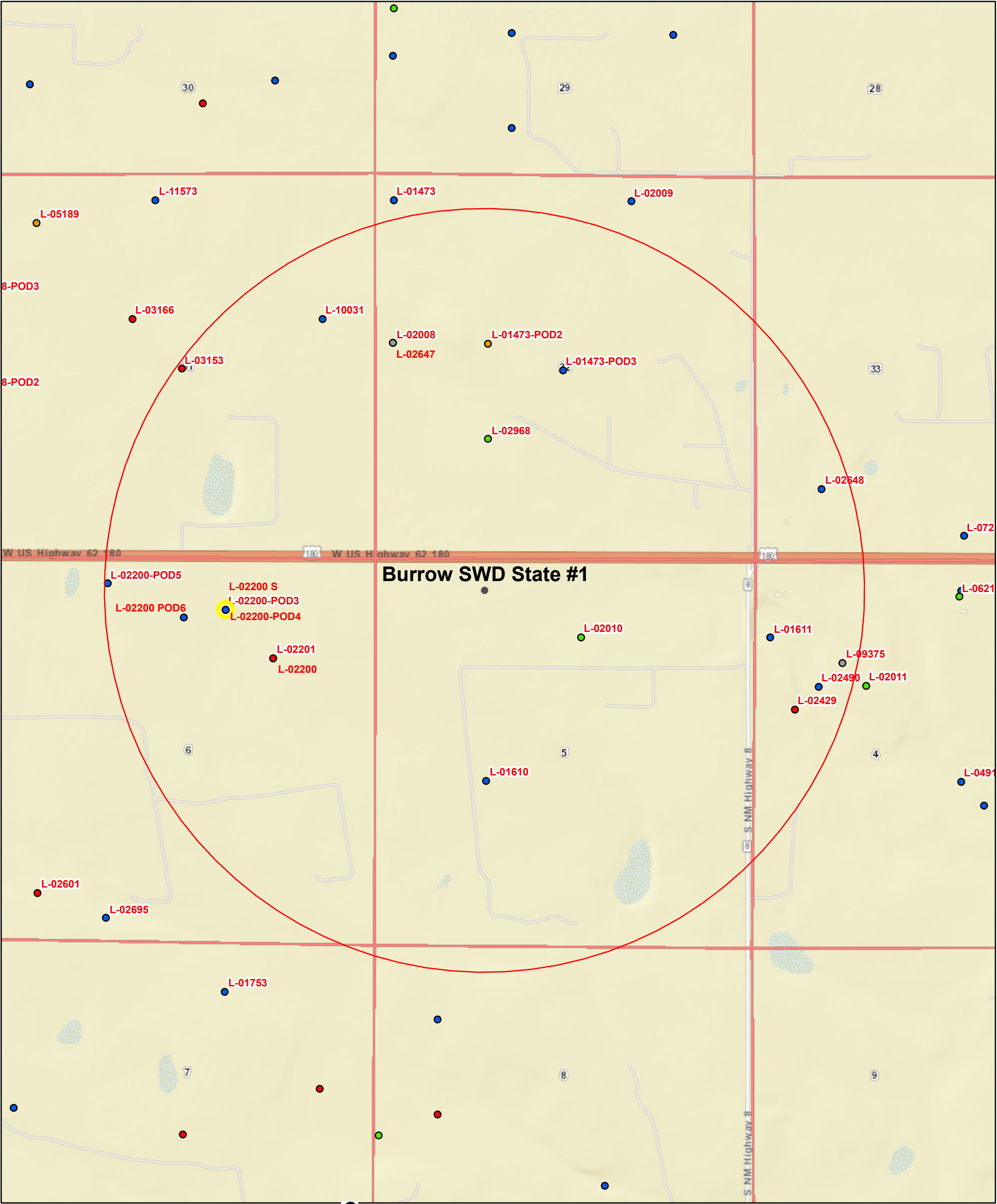

9/1/2023, 1:06:00 PM

GIS WATERS PODs

- Active
- Pending
- Capped
- Plugged
- Incomplete
- Sections

1:18,056

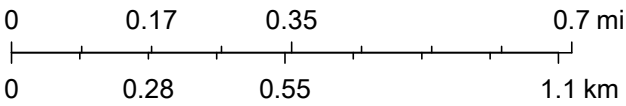

OSE SLO, Bureau of Land Management, Esri, HERE, Garmin, INCREMENT P, NGA, USGS

Water Well Sampling Table					
Water Well ID	OSE Status	Owner	Available Contact Information	Use	Notes
L 02200 POD4	Active	DCP MIDSTREAM L.P.	Dcp Midstream L.p. 10 Desta Dr Suite 400 W Midland, TX 79705	Industrial	Industrial use - not fresh water supply well
L 02200 POD6	Active	DCP MIDSTREAM L.P.	Dcp Midstream L.p. 10 Desta Dr Suite 400 W Midland, TX 79705	Industrial	Industrial use - not fresh water supply well
L 02200 POD5	Active	DCP MIDSTREAM L.P.	Dcp Midstream L.p. 10 Desta Dr Suite 400 W Midland, TX 79705	Industrial	Industrial use - not fresh water supply well
L 01611	Active	CARLIN	Bruce Alene Carlin Po Box 61 Hobbs, NM 88241	Irrigation	Unable to contact landowner after multiple attempts. Will continue attempting to contact and sample.
L 09375	Inactive	CARLIN	Bruce Alene Carlin Po Box 61 Hobbs, NM 88241	Irrigation	OSE Records ididcate water well is inactive.
L 02490	Active	LINAM	Virgil Linam Box 743 Hobbs, NM 88240	Livestock watering	Unable to contact landowner after multiple attempts. Will continue attempting to contact and sample.
L 02429	Plugged	LAMANCE DRILLING COMPANY	Lamance Drilling Company Box 2686 Midland, TX	Prospecting	O&G Prospecting - not fresh water supply well
L 02647	Active	LINAM	Virgil Linam Box 743 Hobbs, NM 88240	Livestock watering	Unable to contact landowner after multiple attempts. Will continue attempting to contact and sample.
L 02648	Active	LINAM	Virgil Linam Box 743 Hobbs, NM 88240	Domestic	Unable to contact landowner after multiple attempts. Will continue attempting to contact and sample.
L 03153	Plugged	OSCAR BOURG DRLG. CO.	Oscar Bourg Drlg. Co. C/o O.r. Musslewhite Hobbs, NM	Prospecting	O&G Prospecting - not fresh water supply well
L 02968	Pending	HUMBLE OIL & REFINING COMPANY	Humble Oil & Refining Company Box 1287 Roswell, NM	Prospecting	O&G Prospecting - not fresh water supply well
L 02010	Pending	LINAM	Virgil Linam Box 743 Hobbs, NM 88240	Irrigation	Unable to contact landowner after multiple attempts. Will continue attempting to contact and sample.
L 01610	Active	CARLIN	Bruce Alene Carlin Po Box 61 Hobbs, NM 88241	Irrigation	Unable to contact landowner after multiple attempts. Will continue attempting to contact and sample.
L 10031	Active	COOPER	Jimmy B. Cooper Box 36 Monument, NM 88265	Livestock watering	Unable to contact landowner after multiple attempts. Will continue attempting to contact and sample.
L 02008	Inactive	LINAM	Virgil Linam Box 743 Hobbs, NM 88240	Irrigation	OSE Records indicate water right was cancelled.
L 01473 POD2	Capped	LINAM	Virgil Linam Box 743 Hobbs, NM 88240	Irrigation	OSE Records indicate well is capped.
L 01473 POD3	Active	CARLIN	Bruce Alene Carlin Po Box 61 Hobbs, NM 88241	Irrigation	Unable to contact landowner after multiple attempts. Will continue attempting to contact and sample.
L 02200	Inactive	DCP MIDSTREAM L.P.	Dcp Midstream L.p. 10 Desta Dr Suite 400 W Midland, TX 79705	Industrial	Industrial use - not fresh water supply well
L 02201	Plugged	DCP MIDSTREAM L.P.	Dcp Midstream L.p. 10 Desta Dr Suite 400 W Midland, TX 79705	Industrial	Industrial use - not fresh water supply well
L 02200 S	Inactive	DCP MIDSTREAM L.P.	Dcp Midstream L.p. 10 Desta Dr Suite 400 W Midland, TX 79705	Industrial	Industrial use - not fresh water supply well
L 02200 POD3	Active	DCP MIDSTREAM L.P.	Dcp Midstream L.p. 10 Desta Dr Suite 400 W Midland, TX 79705	Industrial	Industrial use - not fresh water supply well
Notes:					

Attachment 6

Affidavit of Publication

STATE OF NEW MEXICO
COUNTY OF LEA

I, Daniel Russell, Publisher of the Hobbs News-Sun, a newspaper published at Hobbs, New Mexico, solemnly swear that the clipping attached hereto was published in the regular and entire issue of said newspaper, and not a supplement thereof for a period of 1 issue(s).

Beginning with the issue dated
August 24, 2023
and ending with the issue dated
August 24, 2023.

Publisher

Sworn and subscribed to before me this
24th day of August 2023.

Business Manager

My commission expires
January 29, 2027

(Seal)
STATE OF NEW MEXICO
NOTARY PUBLIC
GUSSIE RUTH BLACK
COMMISSION # 1087526
COMMISSION EXPIRES 01/29/2027

This newspaper is duly qualified to publish legal notices or advertisements within the meaning of Section 3, Chapter 167, Laws of 1937 and payment of fees for said publication has been made.

LEGAL NOTICE August 24, 2023

Pilot Water Solutions SWD LLC, 20 Greenway Plaza, Suite 200, Houston, TX 77046, is filing Form C-108 (Application for Authorization to Inject) with the New Mexico Oil Conservation Division seeking administrative approval for commercial saltwater injection into its Burrow SWD State #1. This will be a new well located 458' FNL & 1,612' FWL Section 5 Township 19S Range 37E in Lea County, New Mexico. The purpose of the well is to inject produced water from permitted oil and gas wells in the area for commercial disposal into the San Andres formation at depths of 4,330' - 5,629' at a maximum surface injection pressure of 866 psi and a maximum injection rate of 25,000 barrels of water per day.

Objections or requests for hearing must be filed with the New Mexico Oil Conservation Division within fifteen (15) days. Any objection or request for hearing should be mailed to the Oil Conservation Division, 1220 South St. Francis Dr., Santa Fe, New Mexico 87505. Additional information may be obtained by contacting the operator contact, David Grounds, at 713-307-8752.

#00281925

67117907

00281925

NATE ALLEMAN
ACE ENERGY ADVISORS
501 E. FRANK PHILLIPS BLVD.
SUITE 201
BARTLESVILLE, OK 74006

Statement of Affected Person Notification

A copy of the C-108 application has been provided to the following Affected Persons as notification of the subject Application for Authorization to Inject (C-108).

Entity Name	Entity Address	Mailing Date
Site Surface Owner		
STATE LAND OFFICE	P.O. Box 1148 Santa Fe, NM 87504	10/13/2023
Site Mineral Owner		
STATE LAND OFFICE	P.O. Box 1148 Santa Fe, NM 87504	10/13/2023
OCD District		
OCD - DISTRICT 1	1625 N. French Drive Hobbs, NM 88240	10/13/2023
Leaseholders		
SOUTHWEST ROYALTIES INC	200 N Loraine St Ste 400 Midland, TX 79701	10/13/2023
APCO OIL CORP	17 th Floor HNG Bldg. Houston, TX 77002	10/13/2023
XTO HOLDINGS LLC	Land Dept. Loc. 115 22777 Springwoods Village Pkwy. Spring, TX 773891425	10/13/2023
MORGAN OPERATING, INC.	P.O. Box 118 Hobbs, NM 88241	10/13/2023
ENERGY ACUMEN LLC	9900 Spectrum Drive Austin, TX 78717	10/13/2023
HESS CORPORATION	P.O. Box 840 Seminole, TX 79360	10/13/2023
LEACO NEW MEXICO EXPL. AND PROD., LLC	2121 Sage Road Suite 325 Houston, TX 77056	10/13/2023
MAVERICK PERMIAN LLC	1000 Main Street, Suite 2900 Houston, TX 77002	10/13/2023
Mineral Owners of Unleased Tract		
Mary E. Kowalczyk (Trustee)	9048 E. Pomegranate St. Tuscon, Arizona 85730	10/13/2023
Wells Fargo Bank (Trustee of the James Virgil Linam Trust)	c/o Bryan Frazier 201 Main Street, Suite 400 Fort Worth, Texas 76102	10/13/2023
George Linam Klein (Trustee)	P.O. Box 541382 Grand Prairie, Texas 75054	10/13/2023
The Allar Company	c/o John Chiles Graham P.O. Box 1567 Graham, Texas 76450	10/13/2023
Morse Energy Partners, LLC	c/o Brent J. Morse 410 17th Street, Suite 1150 Denver, Colorado 80202	10/13/2023
Janice L. Edgar	3208 West 186th Street Torrance, California 90504	10/13/2023
Michael Harrison Moore (Trustee)	P.O. Box 51570 Midland, Texas 79710	10/13/2023
Richard Lyons Moore (Trustee)	c/o Terry L. Farmer, RPL 16400 Dallas Parkway, Suite 400 Dallas, Texas 75248	10/13/2023
Estate of Elouise Mae Linam	11004 West Love Drive Odessa, TX 79764	10/13/2023
KAB Acquisition LLLP-IX, LP	c/o Kenneth A. Breitenbach 240 St. Paul Street, #503 Denver, Colorado 80206	10/13/2023

Statement of Affected Person Notification

Dios Del Mar Petroleum, Inc.	c/o Crystal H. Hathaway P.O. Box 621128 Littleton, Colorado 80162	10/13/2023
MDC Partners, LLC	c/o Joe Freeman 3415 South Clayton Boulevard Englewood, Colorado 80113	10/13/2023
Louis Ray Thorp (Self & Trustee)	401 East Stanolind Road Hobbs, New Mexico 88240	10/13/2023
JoAn Hollen	950 SW Bryson Street Dallas, OR 97338	10/13/2023
Estate of Dayton Ray Thorp	29200 Ferncrest Dr. Rainier, OR 97048	10/13/2023
Susan Oren Ritenour	687 SW Augustus Dr. Dallas, OR 97338	10/13/2023
Mary Jo Fay Thorp	950 SW Bryson Street Dallas, OR 97338	10/13/2023
Estate of Lonnie Gilbert Hill, Jr.	c/o Ben Louis Hill 2279 County Road 314 Seminole, Texas 79360	10/13/2023
B. Etolia Scantling (Trustee)	7304 Camellia Lane Stockton, California 95207	10/13/2023
Lance Allen Hutchison	4102 Avalon Lane Baytown, Texas 77521	10/13/2023
Clifford Cone	P.O. Drawer 64720 Lubbock, Texas 79464	10/13/2023
Tom R. Cone	P.O. Box 400 Southwest City, Missouri 64863	10/13/2023
Cathie Cone Auvenshine McCown	P.O. Box 658 Dripping Springs, Texas 78620	10/13/2023
Kenneth G. Cone	c/o Cathie McCown, AIF P.O. Box 658 Dripping Springs, Texas 78620	10/13/2023
Marilyn Cone (Trustee)	P.O. Box 1545 Lubbock, Texas 79408	10/13/2023
Estate of Donna Ruth Vandagriff Nichols	c/o Sidney Charles Nichols 3836 E 142nd St. N Skiatook, OK 74070+3795	10/13/2023
Tracy June Spivey	708 County Road 389 Gorman, Texas 76454	10/13/2023
Estate of Lula Elizabeth Dunnam Ward	c/o Judy Mae Crane, Representative 12600 Brickstone Ct. Oklahoma City, OK 73142	10/13/2023
Loretta D. Lowe	1200 Barton Creek Boulevard, Apt. 2 Austin, Texas 78735	10/13/2023
Triune, LLC	c/o Nathan Lowe, Manager 2313 Broadway Lubbock, Texas 79401	10/13/2023
Robert Thomas Hartley, LLC	P.O. Box 1024 Clovis, New Mexico 88102	10/13/2023
Teddy Lowe Hartley, LLC	918 Curran Drive Clovis, New Mexico 88101	10/13/2023
Kerry Allen Vandagriff	7000 Shalidar Drive Knoxville, Tennessee 37921	10/13/2023
Kristi Jill Vandagriff	619 Forest Shore Drive Miramar Beach, Florida 32550	10/13/2023
Estate of Frances Virginia Nelson Prather	c/o Dana Rex Prather 317 E. Orchard Lane Carlsbad, NM 88220	10/13/2023
Casey Thorp	P.O. Box 91 Oracle, Arizona 85623	10/13/2023

Statement of Affected Person Notification

Ronnie Dudley Thorp and Kathleen M. Thorp (Co-Trustees)	1180 East Avenida Ellena Casa Grande, Arizona 85122	10/13/2023
Vivian Lowe Anselmi	4904 97th Street Lubbock, Texas 79424	10/13/2023
Kaye Lowe Atcheson (Trustee)	P.O. Box 64595 Lubbock, Texas 79464	10/13/2023
Estate of Ronnie P. Lowe	c/o Victoria Hunter Lowe, Executrix P.O. Box 549 Tombstone, AZ 85638	10/13/2023
Karen Elaine Matthews	2131 Ridge Crest Drive Richardson, Texas 75080	10/13/2023
Kevin Carl Cooley	369 Highway 290 Meeteetse, Wyoming 82433	10/13/2023
Terry Jo Glenn	1703 Creekmere Drive Canyon, Texas 79015	10/13/2023
Marvin Andrew Lawson	18114 Briden Oak Court Spring, Texas 77379	10/13/2023
Allen Edward Neudauer	1051 Site Drive, Space 200 Brea, California 92821	10/13/2023
Jess "Jay" Dean Neudauer	15 Sherry Rancho Mirage, California 92270	10/13/2023
M. Dion Lowe	7801 Espanola Trail Austin, Texas 78737	10/13/2023
Debra Lowe Finn	P.O. Box 13715 Tuscon, Arizona 85732	10/13/2023
Mekusukey Oil Company, LLC	201 South Mekusukey Avenue Wewoka, Oklahoma 74884	10/13/2023
Estate of Ruth Beglau	c/o David F. Beglau 16319 Anthol Street Fontana, California 92335	10/13/2023
Sean Thomas Lowe	P.O. Box 893 Homer, Alaska 99603	10/13/2023
Adrian Michael Lowe	3648 Fore Circle Farmers Branch, Texas 75234	10/13/2023
Elva Bethene Dunnam Wilson	1894 Nova Lane Richland, Washington 99352	10/13/2023
Jerry Herman Dunnam	2016 Marina Point Court Frisco, Texas 75036	10/13/2023
Lola Janette Henington	10797 South Monaco Street Lone Tree, Colorado 80124	10/13/2023
Tammy L. Henderson	8021 North FM 620, Apt. 1022 Austin, Texas 78726	10/13/2023
Shana Lowe Conine	P.O. Box 5883 Granbury, Texas 76049	10/13/2023
Chad S. Conine	310 N. 40th Street Waco, Texas 76710	10/13/2023
Chaney Conine Cockrell	P.O. Box 5321 Granbury, Texas 76049	10/13/2023
Calley Conine Durant	2419 Rock Church Highway Tolar, Texas 76476	10/13/2023
Kelly Lowe Read	302 Country Club Lane Levelland, Texas 79336	10/13/2023
Haley Day Lowe Erdlen	7 Meadowood Road Bryn Mawr, Pennsylvania 19010	10/13/2023
Lauren Lowe Matthews	3613 Hamilton Ave. Fort Worth, TX 76107-1703	10/13/2023
Lowe Family, Ltd.	c/o Shana Lowe Conine, General Partner P.O. Box 5883 Granbury, Texas 76049	10/13/2023

Statement of Affected Person Notification

Clint Neudauer	34208 Island Drive Leesburg, Florida 34788	10/13/2023
LDL Lowe Family Partnership, Ltd.	c/o Loretta D. Lowe, President 1200 Barton Creek Boulevard, Apt. 2 Austin, Texas 78735	10/13/2023
Lowe Minerals and Land Family Partnership, Ltd.	c/o Nathan Lowe, Registered Agent 2313 Broadway Lubbock, Texas 79401	10/13/2023
Kay Colloway Newton	5004 Woodrow Road Lubbock, Texas 79424	10/13/2023
Lewanda Jean Crumpton Onstead	P.O. Box 4530 Ruidoso, New Mexico 88355	10/13/2023

Nathan Alleman
 Ace Energy Advisors
 501 Se Fph Blvd Ste 201
 BARTLESVILLE OK 74003-3931

stamps
\$4.980
 US POSTAGE
 FIRST-CLASS
 FROM 74003
 10/13/2023
 stamps
 endicia



Place label at top of the center of the envelope and fold at dotted line.

CERTIFIED MAIL®



9407 1118 9956 2035 0080 37

STATE LAND OFFICE
 Po Box 1148
 Santa Fe NM 87504-1148

Nathan Alleman
 Ace Energy Advisors
 501 Se Fph Blvd Ste 201
 BARTLESVILLE OK 74003-3931

stamps
\$4.980
 US POSTAGE
 FIRST-CLASS
 FROM 74003
 10/13/2023
 stamps
 endicia



Place label at top of the center of the envelope and fold at dotted line.

CERTIFIED MAIL®



9407 1118 9956 2035 0084 57

OCD - DISTRICT 1
 1625 N French Dr
 Hobbs NM 88240-9273

Nathan Alleman
 Ace Energy Advisors
 501 Se Fph Blvd Ste 201
 BARTLESVILLE OK 74003-3931

stamps
\$4.980
 US POSTAGE
 FIRST-CLASS
 FROM 74003
 10/13/2023
 stamps
 endicia



Place label at top of the center of the envelope and fold at dotted line.

CERTIFIED MAIL®



9407 1118 9956 2035 0084 40

SOUTHWEST ROYALTIES INC
 200 N Loraine St Ste 400
 Midland TX 79701-4735

Nathan Alleman
 Ace Energy Advisors
 501 Se Fph Blvd Ste 201
 BARTLESVILLE OK 74003-3931

stamps
\$4.980
 US POSTAGE
 FIRST-CLASS
 FROM 74003
 10/13/2023
 stamps
 endicia



Place label at top of the center of the envelope and fold at dotted line.

CERTIFIED MAIL®



9407 1118 9956 2035 0085 56

XTO HOLDINGS LLC
 Land Dept. Loc. 115
 22777 Springwoods Village Pkwy
 Spring TX 77389-1425

Nathan Alleman
Ace Energy Advisors
501 Se Fph Blvd Ste 201
BARTLESVILLE OK 74003-3931

stamps
\$4.980
US POSTAGE
FIRST-CLASS
FROM 74003
10/13/2023
stamps
endicia

062S0002203377

Place label at top of the center of the
envelope and fold at dotted line.

CERTIFIED MAIL®
CERTIFIED MAIL®



9407 1118 9956 2035 8349 19

MORGAN OPERATING, INC.
Po Box 118
Hobbs NM 88241-0118

Nathan Alleman
Ace Energy Advisors
501 Se Fph Blvd Ste 201
BARTLESVILLE OK 74003-3931

stamps
\$4.980
US POSTAGE
FIRST-CLASS
FROM 74003
10/13/2023
stamps
endicia

062S0002203377

Place label at top of the center of the
envelope and fold at dotted line.

CERTIFIED MAIL®
CERTIFIED MAIL®

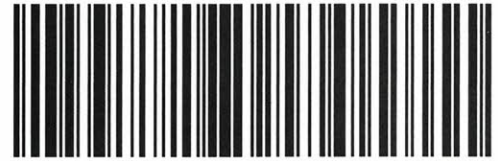

9407 1118 9956 2035 8349 40

ENERGY ACUMEN LLC
9900 Spectrum Dr
Austin TX 78717-4555

Nathan Alleman
Ace Energy Advisors
501 Se Fph Blvd Ste 201
BARTLESVILLE OK 74003-3931

stamps
\$4.980
US POSTAGE
FIRST-CLASS
FROM 74003
10/13/2023
stamps
endicia

062S0002203377

Place label at top of the center of the
envelope and fold at dotted line.

CERTIFIED MAIL®
CERTIFIED MAIL®

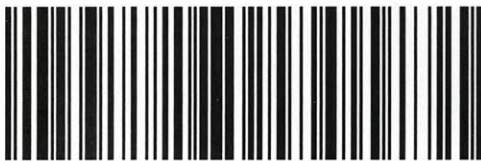

9407 1118 9956 2035 8349 33

HESS CORPORATION
Po Box 840
Seminole TX 79360-0840

Nathan Alleman
Ace Energy Advisors
501 Se Fph Blvd Ste 201
BARTLESVILLE OK 74003-3931

stamps
\$4.980
US POSTAGE
FIRST-CLASS
FROM 74003
10/13/2023
stamps
endicia

062S0002203377

Place label at top of the center of the
envelope and fold at dotted line.

CERTIFIED MAIL®
CERTIFIED MAIL®



9407 1118 9956 2035 8349 71

LEACO NEW MEXICO EXPL. AND PROD., LLC
2121 Sage Rd Ste 325
Houston TX 77056-4326

Nathan Alleman
Ace Energy Advisors
501 Se Fph Blvd Ste 201
BARTLESVILLE OK 74003-3931



Place label at top of the center of the
envelope and fold at dotted line.

CERTIFIED MAIL®
CERTIFIED MAIL®

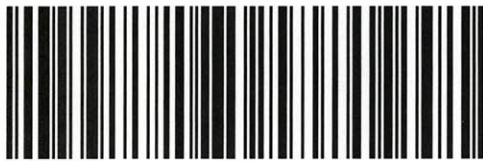

9407 1118 9956 2035 3859 54

APCO OIL CORP
Po Box 1841
Oklahoma City OK 73101-1841

Nathan Alleman
Ace Energy Advisors
501 Se Fph Blvd Ste 201
BARTLESVILLE OK 74003-3931



Place label at top of the center of the
envelope and fold at dotted line.

CERTIFIED MAIL®
CERTIFIED MAIL®

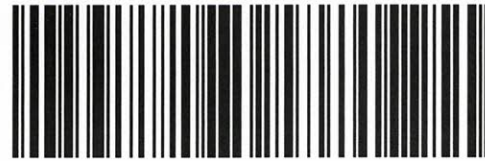

9407 1118 9956 2035 3859 23

MAVERICK PERMIAN LLC
1000 Main St Ste 2900
Houston TX 77002-6342

Nathan Alleman
Ace Energy Advisors
501 Se Fph Blvd Ste 201
BARTLESVILLE OK 74003-3931



Place label at top of the center of the
envelope and fold at dotted line.

CERTIFIED MAIL®
CERTIFIED MAIL®



9407 1118 9956 2035 3856 95

Mekusukey Oil Company, LLC
201 S Mekusukey Ave
Wewoka OK 74884

Nathan Alleman
Ace Energy Advisors
501 Se Fph Blvd Ste 201
BARTLESVILLE OK 74003-3931



Place label at top of the center of the
envelope and fold at dotted line.

CERTIFIED MAIL®
CERTIFIED MAIL®



9407 1118 9956 2035 3856 88

Estate of Ruth Beglau
c/o David F. Beglau
16319 Athol St
Fontana CA 92335-4533

Nathan Alleman
Ace Energy Advisors
501 Se Fph Blvd Ste 201
BARTLESVILLE OK 74003-3931

stamps
\$5.220
US POSTAGE
FIRST-CLASS
FROM 74003
10/13/2023
stamps
endicia



Place label at top of the center of the envelope and fold at dotted line.

CERTIFIED MAIL®



9407 1118 9956 2035 8706 96

Mary E. Kowalczyk (Trustee)
9048 E Pomegranate St
Tucson AZ 85730-5734

Nathan Alleman
Ace Energy Advisors
501 Se Fph Blvd Ste 201
BARTLESVILLE OK 74003-3931

stamps
\$5.220
US POSTAGE
FIRST-CLASS
FROM 74003
10/13/2023
stamps
endicia



Place label at top of the center of the envelope and fold at dotted line.

CERTIFIED MAIL®



9407 1118 9956 2035 8701 15

Wells Fargo Bank (Trustee)
c/o Bryan Frazier
201 Main St Ste 400
Fort Worth TX 76102-3116

Nathan Alleman
Ace Energy Advisors
501 Se Fph Blvd Ste 201
BARTLESVILLE OK 74003-3931

stamps
\$5.220
US POSTAGE
FIRST-CLASS
FROM 74003
10/13/2023
stamps
endicia



Place label at top of the center of the envelope and fold at dotted line.

CERTIFIED MAIL®



9407 1118 9956 2035 8701 39

George Linam Klein (Trustee)
Po Box 541382
Grand Prairie TX 75054-1382

Nathan Alleman
Ace Energy Advisors
501 Se Fph Blvd Ste 201
BARTLESVILLE OK 74003-3931

stamps
\$5.220
US POSTAGE
FIRST-CLASS
FROM 74003
10/13/2023
stamps
endicia



Place label at top of the center of the envelope and fold at dotted line.

CERTIFIED MAIL®



9407 1118 9956 2035 8703 20

The Allar Company
c/o John Chiles Graham
Po Box 1567
Graham TX 76450-7567

Nathan Alleman
 Ace Energy Advisors
 501 Se Fph Blvd Ste 201
 BARTLESVILLE OK 74003-3931

stamps
\$5.220
 US POSTAGE
 FIRST-CLASS
 FROM 74003
 10/13/2023
 stamps
 endicia



Place label at top of the center of the envelope and fold at dotted line.

CERTIFIED MAIL®



9407 1118 9956 2035 8993 45

Morse Energy Partners, LLC
 c/o Brent J. Morse
 410 17th St Ste 1150
 Denver CO 80202-4414

Nathan Alleman
 Ace Energy Advisors
 501 Se Fph Blvd Ste 201
 BARTLESVILLE OK 74003-3931

stamps
\$5.220
 US POSTAGE
 FIRST-CLASS
 FROM 74003
 10/13/2023
 stamps
 endicia



Place label at top of the center of the envelope and fold at dotted line.

CERTIFIED MAIL®



9407 1118 9956 2035 8993 83

Janice L. Edgar
 3208 W 186th St
 Torrance CA 90504-5036

Nathan Alleman
 Ace Energy Advisors
 501 Se Fph Blvd Ste 201
 BARTLESVILLE OK 74003-3931

stamps
\$5.220
 US POSTAGE
 FIRST-CLASS
 FROM 74003
 10/13/2023
 stamps
 endicia



Place label at top of the center of the envelope and fold at dotted line.

CERTIFIED MAIL®



9407 1118 9956 2035 8993 38

Michael Harrison Moore (Trustee)
 Po Box 51570
 Midland TX 79710-1570

Nathan Alleman
 Ace Energy Advisors
 501 Se Fph Blvd Ste 201
 BARTLESVILLE OK 74003-3931

stamps
\$5.220
 US POSTAGE
 FIRST-CLASS
 FROM 74003
 10/13/2023
 stamps
 endicia



Place label at top of the center of the envelope and fold at dotted line.

CERTIFIED MAIL®



9407 1118 9956 2035 8993 76

Richard Lyons Moore (Trustee)
 c/o Terry L. Farmer, RPL
 16400 Dallas Pkwy Ste 400
 Dallas TX 75248-2643

Nathan Alleman
Ace Energy Advisors
501 Se Fph Blvd Ste 201
BARTLESVILLE OK 74003-3931



Place label at top of the center of the envelope and fold at dotted line.

CERTIFIED MAIL®
CERTIFIED MAIL®

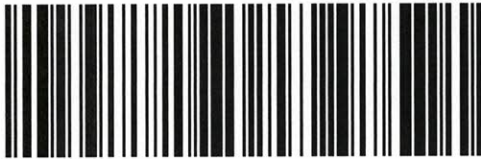

9407 1118 9956 2035 8907 93

Estate of Elouise Mae Linam
11004 W Love Dr
Odessa TX 79764-9094

Nathan Alleman
Ace Energy Advisors
501 Se Fph Blvd Ste 201
BARTLESVILLE OK 74003-3931



Place label at top of the center of the envelope and fold at dotted line.

CERTIFIED MAIL®
CERTIFIED MAIL®



9407 1118 9956 2035 8907 86

KAB Acquisition LLLP-IX, LP
c/o Kenneth A. Breitenbach
240 Saint Paul St Ste 503
Denver CO 80206-5128

Nathan Alleman
Ace Energy Advisors
501 Se Fph Blvd Ste 201
BARTLESVILLE OK 74003-3931



Place label at top of the center of the envelope and fold at dotted line.

CERTIFIED MAIL®
CERTIFIED MAIL®



9407 1118 9956 2035 8909 60

Dios Del Mar Petroleum, Inc.
c/o Crystal H. Hathaway
Po Box 621128
Littleton CO 80162-1128

Nathan Alleman
Ace Energy Advisors
501 Se Fph Blvd Ste 201
BARTLESVILLE OK 74003-3931



Place label at top of the center of the envelope and fold at dotted line.

CERTIFIED MAIL®
CERTIFIED MAIL®



9407 1118 9956 2035 8909 46

MDC Partners, LLC
c/o Joe Freeman
3415 S Clayton Blvd
Englewood CO 80113-7611

Nathan Alleman
Ace Energy Advisors
501 Se Fph Blvd Ste 201
BARTLESVILLE OK 74003-3931



Place label at top of the center of the
envelope and fold at dotted line.

CERTIFIED MAIL®

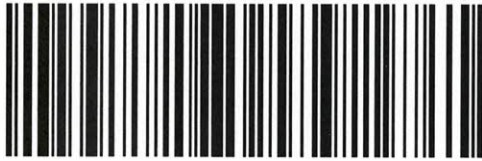

9407 1118 9956 2035 8602 39

Louis Ray Thorp (Self & Trustee)
401 E Stanolind Rd Apt A
Hobbs NM 88240-7758

Nathan Alleman
Ace Energy Advisors
501 Se Fph Blvd Ste 201
BARTLESVILLE OK 74003-3931



Place label at top of the center of the
envelope and fold at dotted line.

CERTIFIED MAIL®



9407 1118 9956 2035 8608 19

JoAn Hollen
950 Sw Bryson St
Dallas OR 97338-1357

Nathan Alleman
Ace Energy Advisors
501 Se Fph Blvd Ste 201
BARTLESVILLE OK 74003-3931



Place label at top of the center of the
envelope and fold at dotted line.

CERTIFIED MAIL®

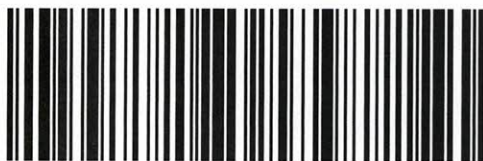

9407 1118 9956 2035 8608 02

Estate of Dayton Ray Thorp
29200 Ferncrest Dr
Rainier OR 97048-3108

Nathan Alleman
Ace Energy Advisors
501 Se Fph Blvd Ste 201
BARTLESVILLE OK 74003-3931



Place label at top of the center of the
envelope and fold at dotted line.

CERTIFIED MAIL®



9407 1118 9956 2035 8606 73

Susan Oren Ritenour
687 Sw Augustus Dr
Dallas OR 97338-1261

Nathan Alleman
Ace Energy Advisors
501 Se Fph Blvd Ste 201
BARTLESVILLE OK 74003-3931

stamps
\$5.220
US POSTAGE
FIRST-CLASS
FROM 74003
10/13/2023
stamps
endicia



Place label at top of the center of the envelope and fold at dotted line.

CERTIFIED MAIL®



9407 1118 9956 2035 8616 87

Mary Jo Fay Thorp
950 Sw Bryson St
Dallas OR 97338-1357

Nathan Alleman
Ace Energy Advisors
501 Se Fph Blvd Ste 201
BARTLESVILLE OK 74003-3931

stamps
\$5.220
US POSTAGE
FIRST-CLASS
FROM 74003
10/13/2023
stamps
endicia



Place label at top of the center of the envelope and fold at dotted line.

CERTIFIED MAIL®



9407 1118 9956 2035 8616 70

Estate of Lonnie Gilbert Hill, Jr.
c/o Ben Louis Hill
2279 County Road 314 Unit A
Seminole TX 79360-1826

Nathan Alleman
Ace Energy Advisors
501 Se Fph Blvd Ste 201
BARTLESVILLE OK 74003-3931

stamps
\$5.220
US POSTAGE
FIRST-CLASS
FROM 74003
10/13/2023
stamps
endicia



Place label at top of the center of the envelope and fold at dotted line.

CERTIFIED MAIL®



9407 1118 9956 2035 8611 51

B. Etolia Scantling (Trustee)
7304 Camellia Ln
Stockton CA 95207-1620

Nathan Alleman
Ace Energy Advisors
501 Se Fph Blvd Ste 201
BARTLESVILLE OK 74003-3931

stamps
\$5.220
US POSTAGE
FIRST-CLASS
FROM 74003
10/13/2023
stamps
endicia



Place label at top of the center of the envelope and fold at dotted line.

CERTIFIED MAIL®



9407 1118 9956 2035 8611 99

Lance Allen Hutchison
4102 Avalon Ln
Baytown TX 77521-2867

Nathan Alleman
Ace Energy Advisors
501 Se Fph Blvd Ste 201
BARTLESVILLE OK 74003-3931



Place label at top of the center of the
envelope and fold at dotted line.

CERTIFIED MAIL®

CERTIFIED MAIL®

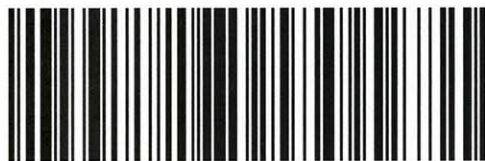

9407 1118 9956 2035 8849 69

Clifford Cone
Po Box 64720
Lubbock TX 79464-4720

Nathan Alleman
Ace Energy Advisors
501 Se Fph Blvd Ste 201
BARTLESVILLE OK 74003-3931



Place label at top of the center of the
envelope and fold at dotted line.

CERTIFIED MAIL®

CERTIFIED MAIL®



9407 1118 9956 2035 8849 90

Tom R. Cone
Po Box 400
South West Cy MO 64863-0400

Nathan Alleman
Ace Energy Advisors
501 Se Fph Blvd Ste 201
BARTLESVILLE OK 74003-3931



Place label at top of the center of the
envelope and fold at dotted line.

CERTIFIED MAIL®

CERTIFIED MAIL®



9407 1118 9956 2035 8849 76

Cathie Cone Auvenshine McCown
Po Box 658
Dripping Spgs TX 78620-0658

Nathan Alleman
Ace Energy Advisors
501 Se Fph Blvd Ste 201
BARTLESVILLE OK 74003-3931



Place label at top of the center of the
envelope and fold at dotted line.

CERTIFIED MAIL®

CERTIFIED MAIL®



9407 1118 9956 2035 8846 24

Kenneth G. Cone
c/o Cathie McCown, AIF
Po Box 658
Dripping Spgs TX 78620-0658

Nathan Alleman
Ace Energy Advisors
501 Se Fph Blvd Ste 201
BARTLESVILLE OK 74003-3931



Place label at top of the center of the
envelope and fold at dotted line.

CERTIFIED MAIL®
CERTIFIED MAIL®



9407 1118 9956 2035 8863 38

Marilyn Cone (Trustee)
Po Box 1545
Lubbock TX 79408-1545

Nathan Alleman
Ace Energy Advisors
501 Se Fph Blvd Ste 201
BARTLESVILLE OK 74003-3931



Place label at top of the center of the
envelope and fold at dotted line.

CERTIFIED MAIL®
CERTIFIED MAIL®



9407 1118 9956 2035 8863 76

Estate of Donna Ruth VandagriffNichols
c/o Sidney Charles Nichols
3836 E 142nd St N
Skiatook OK 74070-3795

Nathan Alleman
Ace Energy Advisors
501 Se Fph Blvd Ste 201
BARTLESVILLE OK 74003-3931



Place label at top of the center of the
envelope and fold at dotted line.

CERTIFIED MAIL®
CERTIFIED MAIL®



9407 1118 9956 2035 8860 55

Tracy June Spivey
708 County Road 389
Gorman TX 76454-1806

Nathan Alleman
Ace Energy Advisors
501 Se Fph Blvd Ste 201
BARTLESVILLE OK 74003-3931



Place label at top of the center of the
envelope and fold at dotted line.

CERTIFIED MAIL®
CERTIFIED MAIL®



9407 1118 9956 2035 8860 00

Estate of Lula Elizabeth Dunnam Ward
c/o Judy Mae Crane, Representative
12600 Brickstone Ct
Oklahoma City OK 73142-2229

Nathan Alleman
Ace Energy Advisors
501 Se Fph Blvd Ste 201
BARTLESVILLE OK 74003-3931



Place label at top of the center of the envelope and fold at dotted line.

CERTIFIED MAIL®
CERTIFIED MAIL®

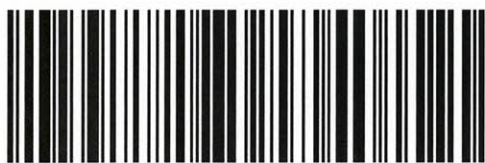

9407 1118 9956 2035 8062 37

Loretta D. Lowe
1200 Barton Creek Blvd Apt 2
Austin TX 78735-1608

Nathan Alleman
Ace Energy Advisors
501 Se Fph Blvd Ste 201
BARTLESVILLE OK 74003-3931



Place label at top of the center of the envelope and fold at dotted line.

CERTIFIED MAIL®
CERTIFIED MAIL®



9407 1118 9956 2035 8068 55

Triune, LLC
c/o Nathan Lowe, Manager
2313 Broadway
Lubbock TX 79401-2916

Nathan Alleman
Ace Energy Advisors
501 Se Fph Blvd Ste 201
BARTLESVILLE OK 74003-3931



Place label at top of the center of the envelope and fold at dotted line.

CERTIFIED MAIL®
CERTIFIED MAIL®

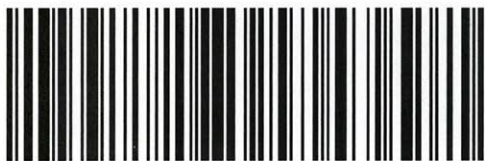

9407 1118 9956 2035 8068 93

Teddy Lowe Hartley, LLC
918 Curran Dr
Clovis NM 88101-9507

Nathan Alleman
Ace Energy Advisors
501 Se Fph Blvd Ste 201
BARTLESVILLE OK 74003-3931



Place label at top of the center of the envelope and fold at dotted line.

CERTIFIED MAIL®
CERTIFIED MAIL®



9407 1118 9956 2035 8068 79

Robert Thomas Hartley, LLC
Po Box 1024
Clovis NM 88102-1024

Nathan Alleman
Ace Energy Advisors
501 Se Fph Blvd Ste 201
BARTLESVILLE OK 74003-3931

stamps
\$5.220
US POSTAGE
FIRST-CLASS
FROM 74003
10/13/2023
stamps
endicia



Place label at top of the center of the envelope and fold at dotted line.

CERTIFIED MAIL®



9407 1118 9956 2035 3389 98

Kerry Allen Vandagriff
7000 Shalidar Dr
Knoxville TN 37921-1030

Nathan Alleman
Ace Energy Advisors
501 Se Fph Blvd Ste 201
BARTLESVILLE OK 74003-3931

stamps
\$5.220
US POSTAGE
FIRST-CLASS
FROM 74003
10/13/2023
stamps
endicia



Place label at top of the center of the envelope and fold at dotted line.

CERTIFIED MAIL®

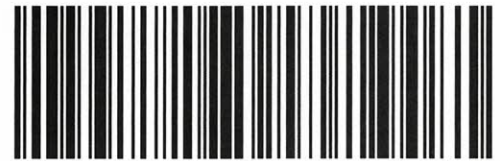

9407 1118 9956 2035 3389 81

Kristi Jill Vandagriff
619 Forest Shore Dr
Miramar Beach FL 32550-3958

Nathan Alleman
Ace Energy Advisors
501 Se Fph Blvd Ste 201
BARTLESVILLE OK 74003-3931

stamps
\$5.220
US POSTAGE
FIRST-CLASS
FROM 74003
10/13/2023
stamps
endicia



Place label at top of the center of the envelope and fold at dotted line.

CERTIFIED MAIL®



9407 1118 9956 2035 3389 36

Estate of Frances Virginia Nelson Prather
c/o Dana Rex Prather
317 E Orchard Ln
Carlsbad NM 88220-9697

Nathan Alleman
Ace Energy Advisors
501 Se Fph Blvd Ste 201
BARTLESVILLE OK 74003-3931

stamps
\$5.220
US POSTAGE
FIRST-CLASS
FROM 74003
10/13/2023
stamps
endicia



Place label at top of the center of the envelope and fold at dotted line.

CERTIFIED MAIL®



9407 1118 9956 2035 3386 53

Casey Thorp
Po Box 91
Oracle AZ 85623-0091

Nathan Alleman
Ace Energy Advisors
501 Se Fph Blvd Ste 201
BARTLESVILLE OK 74003-3931

stamps
\$5.220
US POSTAGE
FIRST-CLASS
FROM 74003
10/13/2023
stamps
endicia

062S0002203377

Place label at top of the center of the
envelope and fold at dotted line.

CERTIFIED MAIL®
CERTIFIED MAIL®

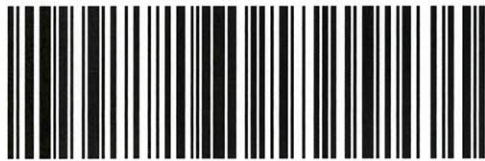

9407 1118 9956 2035 3184 19

Vivian Lowe Anselmi
4904 97th St
Lubbock TX 79424-4804

Nathan Alleman
Ace Energy Advisors
501 Se Fph Blvd Ste 201
BARTLESVILLE OK 74003-3931

stamps
\$5.220
US POSTAGE
FIRST-CLASS
FROM 74003
10/13/2023
stamps
endicia

062S0002203377

Place label at top of the center of the
envelope and fold at dotted line.

CERTIFIED MAIL®
CERTIFIED MAIL®



9407 1118 9956 2035 3184 64

Kaye Lowe Acheson (Trustee)
Po Box 64595
Lubbock TX 79464-4595

Nathan Alleman
Ace Energy Advisors
501 Se Fph Blvd Ste 201
BARTLESVILLE OK 74003-3931

stamps
\$5.220
US POSTAGE
FIRST-CLASS
FROM 74003
10/13/2023
stamps
endicia

062S0002203377

Place label at top of the center of the
envelope and fold at dotted line.

CERTIFIED MAIL®
CERTIFIED MAIL®



9407 1118 9956 2035 3184 26

Estate of Ronnie P. Lowe
c/o Victoria Hunter Lowe, Executrix
Po Box 549
Tombstone AZ 85638-0549

Nathan Alleman
Ace Energy Advisors
501 Se Fph Blvd Ste 201
BARTLESVILLE OK 74003-3931

stamps
\$5.220
US POSTAGE
FIRST-CLASS
FROM 74003
10/13/2023
stamps
endicia

062S0002203377

Place label at top of the center of the
envelope and fold at dotted line.

CERTIFIED MAIL®
CERTIFIED MAIL®



9407 1118 9956 2035 3184 88

Ronnie and Kathleen Thorp (Trustees)
1180 E Avenida Ellena
Casa Grande AZ 85122-1107

Nathan Alleman
 Ace Energy Advisors
 501 Se Fph Blvd Ste 201
 BARTLESVILLE OK 74003-3931

stamps
\$5.220
 US POSTAGE
 FIRST-CLASS
 FROM 74003
 10/13/2023
 stamps
 endicia



Place label at top of the center of the envelope and fold at dotted line.

CERTIFIED MAIL®



9407 1118 9956 2035 3113 73

Karen Elaine Matthews
 2131 Ridge Crest Dr
 Richardson TX 75080-2523

Nathan Alleman
 Ace Energy Advisors
 501 Se Fph Blvd Ste 201
 BARTLESVILLE OK 74003-3931

stamps
\$5.220
 US POSTAGE
 FIRST-CLASS
 FROM 74003
 10/13/2023
 stamps
 endicia



Place label at top of the center of the envelope and fold at dotted line.

CERTIFIED MAIL®



9407 1118 9956 2035 3110 69

Kevin Carl Cooley
 369 State Highway 290
 Meeteetse WY 82433-9728

Nathan Alleman
 Ace Energy Advisors
 501 Se Fph Blvd Ste 201
 BARTLESVILLE OK 74003-3931

stamps
\$5.220
 US POSTAGE
 FIRST-CLASS
 FROM 74003
 10/13/2023
 stamps
 endicia



Place label at top of the center of the envelope and fold at dotted line.

CERTIFIED MAIL®



9407 1118 9956 2035 3114 10

Terry Jo Glenn
 1703 Creekmere Dr
 Canyon TX 79015-5231

Nathan Alleman
 Ace Energy Advisors
 501 Se Fph Blvd Ste 201
 BARTLESVILLE OK 74003-3931

stamps
\$5.220
 US POSTAGE
 FIRST-CLASS
 FROM 74003
 10/13/2023
 stamps
 endicia



Place label at top of the center of the envelope and fold at dotted line.

CERTIFIED MAIL®



9407 1118 9956 2035 3114 27

Marvin Andrew Lawson
 18114 Briden Oak Ct
 Spring TX 77379-6162

Nathan Alleman
Ace Energy Advisors
501 Se Fph Blvd Ste 201
BARTLESVILLE OK 74003-3931



Place label at top of the center of the
envelope and fold at dotted line.

CERTIFIED MAIL®
CERTIFIED MAIL®



9407 1118 9956 2035 3449 37

Allen Edward Neudauer
1051 Site Dr Spc 200
Brea CA 92821-2143

Nathan Alleman
Ace Energy Advisors
501 Se Fph Blvd Ste 201
BARTLESVILLE OK 74003-3931



Place label at top of the center of the
envelope and fold at dotted line.

CERTIFIED MAIL®
CERTIFIED MAIL®



9407 1118 9956 2035 3446 23

Jess "Jay" Dean Neudauer
15 Sherry
Rancho Mirage CA 92270-5656

Nathan Alleman
Ace Energy Advisors
501 Se Fph Blvd Ste 201
BARTLESVILLE OK 74003-3931



Place label at top of the center of the
envelope and fold at dotted line.

CERTIFIED MAIL®
CERTIFIED MAIL®

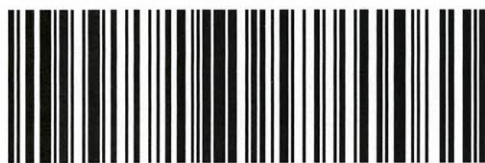

9407 1118 9956 2035 3446 85

M. Dion Lowe
7801 Espanola Trl
Austin TX 78737-2506

Nathan Alleman
Ace Energy Advisors
501 Se Fph Blvd Ste 201
BARTLESVILLE OK 74003-3931



Place label at top of the center of the
envelope and fold at dotted line.

CERTIFIED MAIL®
CERTIFIED MAIL®



9407 1118 9956 2035 3446 30

Debra Lowe Finn
Po Box 13715
Tucson AZ 85732-3715

Nathan Alleman
Ace Energy Advisors
501 Se Fph Blvd Ste 201
BARTLESVILLE OK 74003-3931

stamps
\$5.220
US POSTAGE
FIRST-CLASS
FROM 74003
10/13/2023
stamps
endicia



Place label at top of the center of the envelope and fold at dotted line.

CERTIFIED MAIL®

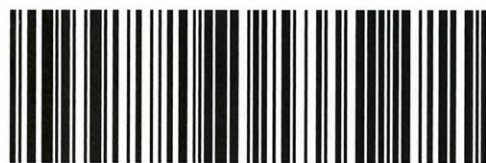

9407 1118 9956 2035 3748 42

Sean Thomas Lowe
Po Box 893
Homer AK 99603-0893

Nathan Alleman
Ace Energy Advisors
501 Se Fph Blvd Ste 201
BARTLESVILLE OK 74003-3931

stamps
\$5.220
US POSTAGE
FIRST-CLASS
FROM 74003
10/13/2023
stamps
endicia



Place label at top of the center of the envelope and fold at dotted line.

CERTIFIED MAIL®



9407 1118 9956 2035 3748 35

Adrian Michael Lowe
3648 Fore Cir
Farmers Brnch TX 75234-2451

Nathan Alleman
Ace Energy Advisors
501 Se Fph Blvd Ste 201
BARTLESVILLE OK 74003-3931

stamps
\$5.220
US POSTAGE
FIRST-CLASS
FROM 74003
10/13/2023
stamps
endicia



Place label at top of the center of the envelope and fold at dotted line.

CERTIFIED MAIL®



9407 1118 9956 2035 3748 73

Elva Bethene Dunnam Wilson
1894 Nova Ln
Richland WA 99352-8648

Nathan Alleman
Ace Energy Advisors
501 Se Fph Blvd Ste 201
BARTLESVILLE OK 74003-3931

stamps
\$5.220
US POSTAGE
FIRST-CLASS
FROM 74003
10/13/2023
stamps
endicia



Place label at top of the center of the envelope and fold at dotted line.

CERTIFIED MAIL®



9407 1118 9956 2035 3747 50

Jerry Herman Dunnam
2016 Marina Point Ct
Frisco TX 75036-1432

Nathan Alleman
Ace Energy Advisors
501 Se Fph Blvd Ste 201
BARTLESVILLE OK 74003-3931



Place label at top of the center of the
envelope and fold at dotted line.

CERTIFIED MAIL®
CERTIFIED MAIL®



9407 1118 9956 2035 3767 47

Lola Janette Henington
10797 S Monaco St
Lone Tree CO 80124-9564

Nathan Alleman
Ace Energy Advisors
501 Se Fph Blvd Ste 201
BARTLESVILLE OK 74003-3931



Place label at top of the center of the
envelope and fold at dotted line.

CERTIFIED MAIL®
CERTIFIED MAIL®

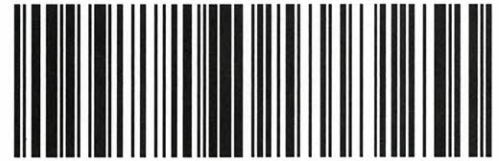

9407 1118 9956 2035 3767 30

Tammy L. Henderson
8021 N Fm 620 Rd Apt 1022
Austin TX 78726-4567

Nathan Alleman
Ace Energy Advisors
501 Se Fph Blvd Ste 201
BARTLESVILLE OK 74003-3931



Place label at top of the center of the
envelope and fold at dotted line.

CERTIFIED MAIL®
CERTIFIED MAIL®

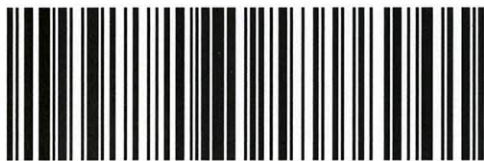

9407 1118 9956 2035 3769 21

Shana Lowe Conine
Po Box 5883
Granbury TX 76049-0883

Nathan Alleman
Ace Energy Advisors
501 Se Fph Blvd Ste 201
BARTLESVILLE OK 74003-3931



Place label at top of the center of the
envelope and fold at dotted line.

CERTIFIED MAIL®
CERTIFIED MAIL®



9407 1118 9956 2035 3769 83

Chad S. Conine
310 N 40th St
Waco TX 76710-7120

Nathan Alleman
Ace Energy Advisors
501 Se Fph Blvd Ste 201
BARTLESVILLE OK 74003-3931



Place label at top of the center of the envelope and fold at dotted line.

CERTIFIED MAIL®
CERTIFIED MAIL®



9407 1118 9956 2035 3942 53

Chaney Conine Cockrell
Po Box 5321
Granbury TX 76049-0321

Nathan Alleman
Ace Energy Advisors
501 Se Fph Blvd Ste 201
BARTLESVILLE OK 74003-3931



Place label at top of the center of the envelope and fold at dotted line.

CERTIFIED MAIL®
CERTIFIED MAIL®



9407 1118 9956 2035 3942 08

Calley Conine Durant
2419 Rock Church Hwy
Tolar TX 76476-6331

Nathan Alleman
Ace Energy Advisors
501 Se Fph Blvd Ste 201
BARTLESVILLE OK 74003-3931



Place label at top of the center of the envelope and fold at dotted line.

CERTIFIED MAIL®
CERTIFIED MAIL®



9407 1118 9956 2035 3942 39

Kelly Lowe Read
302 Country Club Ln
Levelland TX 79336-6622

Nathan Alleman
Ace Energy Advisors
501 Se Fph Blvd Ste 201
BARTLESVILLE OK 74003-3931



Place label at top of the center of the envelope and fold at dotted line.

CERTIFIED MAIL®
CERTIFIED MAIL®



9407 1118 9956 2035 3948 19

Haley Day Lowe Erdlen
7 Meadowood Rd
Bryn Mawr PA 19010-1022

Nathan Alleman
Ace Energy Advisors
501 Se Fph Blvd Ste 201
BARTLESVILLE OK 74003-3931

stamps
\$5.220
US POSTAGE
FIRST-CLASS
FROM 74003
10/13/2023
stamps
endicia



Place label at top of the center of the envelope and fold at dotted line.

CERTIFIED MAIL®



9407 1118 9956 2035 3982 75

Lauren Lowe Matthews
3613 Hamilton Ave
Fort Worth TX 76107-1703

Nathan Alleman
Ace Energy Advisors
501 Se Fph Blvd Ste 201
BARTLESVILLE OK 74003-3931

stamps
\$5.220
US POSTAGE
FIRST-CLASS
FROM 74003
10/13/2023
stamps
endicia



Place label at top of the center of the envelope and fold at dotted line.

CERTIFIED MAIL®

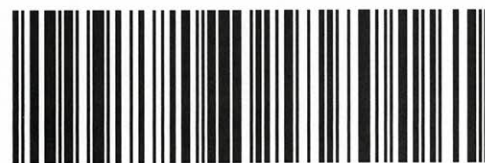

9407 1118 9956 2035 3988 17

Lowe Family, Ltd.
c/o Shana Lowe Conine, General Partner
Po Box 5883
Granbury TX 76049-0883

Nathan Alleman
Ace Energy Advisors
501 Se Fph Blvd Ste 201
BARTLESVILLE OK 74003-3931

stamps
\$5.220
US POSTAGE
FIRST-CLASS
FROM 74003
10/13/2023
stamps
endicia



Place label at top of the center of the envelope and fold at dotted line.

CERTIFIED MAIL®



9407 1118 9956 2035 3988 55

Clint Neudauer
34208 Island Dr
Leesburg FL 34788-4465

Nathan Alleman
Ace Energy Advisors
501 Se Fph Blvd Ste 201
BARTLESVILLE OK 74003-3931

stamps
\$5.220
US POSTAGE
FIRST-CLASS
FROM 74003
10/13/2023
stamps
endicia



Place label at top of the center of the envelope and fold at dotted line.

CERTIFIED MAIL®



9407 1118 9956 2035 3988 62

LDL Lowe Family Partnership, Ltd.
c/o Loretta D. Lowe, President
1200 Barton Creek Blvd Apt 2
Austin TX 78735-1608

Nathan Alleman
 Ace Energy Advisors
 501 Se Fph Blvd Ste 201
 BARTLESVILLE OK 74003-3931

stamps.com
\$5.220
 US POSTAGE
 FIRST-CLASS
 FROM 74003
 10/13/2023
 stamps
 endicia

Nathan Alleman
 Ace Energy Advisors
 501 Se Fph Blvd Ste 201
 BARTLESVILLE OK 74003-3931

stamps.com
\$5.220
 US POSTAGE
 FIRST-CLASS
 FROM 74003
 10/13/2023
 stamps
 endicia

Place label at top of the center of the envelope and fold at dotted line.

Place label at top of the center of the envelope and fold at dotted line.

CERTIFIED MAIL®
CERTIFIED MAIL®

CERTIFIED MAIL®
CERTIFIED MAIL®



9407 1118 9956 2035 3587 43



9407 1118 9956 2035 3589 27

Kay Colloway Newton
 5004 Woodrow Rd
 Lubbock TX 79424-6609

Lewanda Jean Crumpton Onstead
 Po Box 4530
 Ruidoso NM 88355-4530

Nathan Alleman
 Ace Energy Advisors
 501 Se Fph Blvd Ste 201
 BARTLESVILLE OK 74003-3931

stamps.com
\$5.220
 US POSTAGE
 FIRST-CLASS
 FROM 74003
 10/13/2023
 stamps
 endicia

Place label at top of the center of the envelope and fold at dotted line.

Place label at top of the center of the envelope and fold at dotted line.

CERTIFIED MAIL®
CERTIFIED MAIL®

CERTIFIED MAIL®
CERTIFIED MAIL®



9407 1118 9956 2035 3589 34

LoweMinerals&LandFamily Partnership
 Nathan Lowe
 2313 Broadway
 Lubbock TX 79401-2916

District I
1625 N. French Dr., Hobbs, NM 88240
Phone:(575) 393-6161 Fax:(575) 393-0720
District II
811 S. First St., Artesia, NM 88210
Phone:(575) 748-1283 Fax:(575) 748-9720
District III
1000 Rio Brazos Rd., Aztec, NM 87410
Phone:(505) 334-6178 Fax:(505) 334-6170
District IV
1220 S. St Francis Dr., Santa Fe, NM 87505
Phone:(505) 476-3470 Fax:(505) 476-3462

State of New Mexico
Energy, Minerals and Natural Resources
Oil Conservation Division
1220 S. St Francis Dr.
Santa Fe, NM 87505

CONDITIONS

Action 277797

CONDITIONS

Operator: Pilot Water Solutions SWD LLC 20 Greenway Plaza, Suite 200 Houston, TX 77046	OGRID: 331374
	Action Number: 277797
	Action Type: [IM-SD] Admin Order Support Doc (ENG) (IM-AAO)

CONDITIONS

Created By	Condition	Condition Date
anthony.harris	None	10/20/2023