

ID NO. 322425

NSL - 8738

Revised March 23, 2017

RECEIVED: 03/12/24	REVIEWER:	TYPE:	APP NO: pLEL2407234000
---------------------------	-----------	-------	-------------------------------

ABOVE THIS TABLE FOR OCD DIVISION USE ONLY

NEW MEXICO OIL CONSERVATION DIVISION
 - Geological & Engineering Bureau -
 1220 South St. Francis Drive, Santa Fe, NM 87505

**ADMINISTRATIVE APPLICATION CHECKLIST**

THIS CHECKLIST IS MANDATORY FOR ALL ADMINISTRATIVE APPLICATIONS FOR EXCEPTIONS TO DIVISION RULES AND
 REGULATIONS WHICH REQUIRE PROCESSING AT THE DIVISION LEVEL IN SANTA FE

Applicant: <u>EOG Resources Inc.</u>	OGRID Number: <u>7377</u>
Well Name: <u>Rattlesnake 28 Fed Com 214H</u>	API: <u>30-025-51966</u>
Pool: <u>Bradley; Bone Spring</u>	Pool Code: <u>7280</u>

**SUBMIT ACCURATE AND COMPLETE INFORMATION REQUIRED TO PROCESS THE TYPE OF APPLICATION
 INDICATED BELOW**

1) TYPE OF APPLICATION: Check those which apply for [A]

A. Location – Spacing Unit – Simultaneous Dedication

☒ NSL

 ☐ NSP (PROJECT AREA)

 ☐ NSP (PRORATION UNIT)

 ☐ SD

B. Check one only for [I] or [II]

[I] Commingling – Storage – Measurement

☐ DHC

☐ CTB

☐ PLC

☐ PC

☐ OLS

☐ OLM

[II] Injection – Disposal – Pressure Increase – Enhanced Oil Recovery

☐ WFX

☐ PMX

☐ SWD

☐ IPI

☐ EOR

☐ PPR
2) NOTIFICATION REQUIRED TO: Check those which apply.

- A. ☒ Offset operators or lease holders
 B. ☒ Royalty, overriding royalty owners, revenue owners
 C. ☐ Application requires published notice
 D. ☐ Notification and/or concurrent approval by SLO
 E. ☒ Notification and/or concurrent approval by BLM
 F. ☐ Surface owner
 G. ☒ For all of the above, proof of notification or publication is attached, and/or,
 H. ☐ No notice required

FOR OCD ONLY

- ☐ Notice Complete
☐ Application Content Complete

3) CERTIFICATION: I hereby certify that the information submitted with this application for administrative approval is **accurate** and **complete** to the best of my knowledge. I also understand that **no action** will be taken on this application until the required information and notifications are submitted to the Division.

Note: Statement must be completed by an individual with managerial and/or supervisory capacity.

Lisa Youngblood

Print or Type Name

03/12/2024

Date

432-247-6331

Phone Number

lisa_youngblood@eogresources.com

e-mail Address

Lisa Youngblood

Signature



Lisa Youngblood
Phone: (432) 247-6331
Email: lisa_youngblood@eogresources.com

March 12, 2024

VIA ONLINE FILING

Dylan Fuge, OCD Director
Oil Conservation Division
New Mexico Department of Energy, Minerals, and Natural Resources
1220 South St. Francis Drive
Santa Fe, New Mexico 87505

Re: Application of EOG Resources, Inc. for administrative approval of an unorthodox well location for its Rattlesnake 28 Fed Com 214H well dedicated to the W2 of Section 28 and N2 of the NW4 and Lots 3 and 4 of Section 33, Township 26 South, Range 33 East, NMPM, Lea County, New Mexico.

Dear Director Fuge,

EOG Resources, Inc. (OGRID No. 7377) seeks administrative approval of an unorthodox well location for its Rattlesnake 28 Fed Com 214H well (API No. 30-025-51966). The spacing unit dedicated to the well is comprised of the W2 of Section 28 and N2 of the NW4 and Lots 3 and 4 of Section 33, Township 26 South, Range 33 East, NMPM, Lea County, New Mexico and is within the Bradley; Bone Spring (7280). The horizontal spacing unit for the well is approximately 474.49 acres and does not include proximity tracts.

This well has not yet been drilled. It is proposed to be drilled as follows:

- The surface location is located 1016 feet from the North line, 2172 feet from the West line (Unit C) of Section 28,
- The bottom hole location is located 100 feet from the South line, 2360 feet from the West line (Lot 3) of Section 33,
- The first take point is located 100 feet from the North line, 2360 feet from the West line (Unit C) of Section 28,
- The last take point is located 100 feet from the South line, 2360 feet from the West line (Lot 3) of Section 33,

The acreage is governed by the Division's statewide rules. The proposed completed interval is unorthodox because it will be closer than 330 feet to the eastern boundary. It encroaches on the spacing units in the W2E2 of Section 28 and NWNE and Lot 2 of Section 33. Approval of the

unorthodox location will allow EOG to use its preferred well spacing plan for horizontal wells, which will prevent waste.

Exhibit A is the pending C-102 sundry that shows a change in the horizontal lateral, spacing unit, and well number change. This plat also shows the location of the proposed well, including the proposed unorthodox, completed interval. The proposed completed interval encroaches on the spacing unit/tracts to the east. The second page of Exhibit A is the approved original C-102 in the APD.

Exhibit B is a plat that shows the Rattlesnake 28 Fed Com 214H well in relation to the adjoining spacing units/tracts to the east.

Exhibit C is a certification from the landman indicating that he has reviewed the tracts affected by this request. Exhibit C includes a list of the affected parties and **Exhibit D** provides proof that a copy of this application, including exhibits, was mailed to each affected party. This notice advises affected parties that any objection must be filed in writing with the Division within 20 days from the date the Division receives the application.

Exhibit E is a statement from a petroleum engineer providing justification for the requested non-standard location.

Thank you for your attention to this matter.

Very truly yours,

A handwritten signature in black ink that reads "Lisa Youngblood". The signature is written in a cursive, flowing style.

Lisa Youngblood
Regulatory Specialist

DISTRICT I
1625 N. French Dr., Hobbs, NM 88240
Phone: (575) 393-6161 Fax: (575) 393-0720
DISTRICT II
811 S. First St., Artesia, NM 88210
Phone: (575) 748-1283 Fax: (575) 748-9720
DISTRICT III
1000 Rio Brazos Rd., Aztec, NM 87410
Phone: (505) 334-6178 Fax: (505) 334-6170
DISTRICT IV
1220 S. St. Francis Dr., Santa Fe, NM 87505
Phone: (505) 476-3460 Fax: (505) 476-3462

State of New Mexico
Energy, Minerals & Natural Resources Department
OIL CONSERVATION DIVISION
1220 South St. Francis Dr.
Santa Fe, New Mexico 87505

Form C-102
Revised August 1, 2011
Submit one copy to appropriate
District Office
☐ AMENDED REPORT

WELL LOCATION AND ACREAGE DEDICATION PLAT

API Number 30-025-51966		Pool Code 7280		Pool Name Bradley; Bone Spring					
Property Code 315317		Property Name RATTLESNAKE 28 FED COM						Well Number 214H	
OGRID No. 7377		Operator Name EOG RESOURCES, INC.						Elevation 3238'	
Surface Location									
UL or lot no. C	Section 28	Township 26-S	Range 33-E	Lot Idn -	Feet from the 1016'	North/South line NORTH	Feet from the 2172'	East/West line WEST	County LEA
Bottom Hole Location If Different From Surface									
UL or lot no. 3	Section 33	Township 26-S	Range 33-E	Lot Idn -	Feet from the 100'	North/South line SOUTH	Feet from the 2360'	East/West line WEST	County LEA
Dedicated Acres 474.49		Joint or Infill		Consolidated Code		Order No. NMNM106322048			

No allowable will be assigned to this completion until all interests have been consolidated or a non-standard unit has been approved by the division.

<p>SURFACE LOCATION (SHL)</p> <p>NEW MEXICO EAST NAD 1983 X=775210 Y=371448 LAT.: N 32.0189456 LONG.: W 103.5787319 NAD 1927 X=734022 Y=371391 LAT.: N 32.0188203 LONG.: W 103.5782660 1016' FNL 2172' FWL</p> <p>KICK OFF POINT (KOP)</p> <p>NEW MEXICO EAST NAD 1983 X=775391 Y=372414 LAT.: N 32.0215979 LONG.: W 103.5781270 NAD 1927 X=734203 Y=372357 LAT.: N 32.0214726 LONG.: W 103.5776609 50' FNL 2360' FWL</p> <p>UPPER MOST PERF. (UMP)</p> <p>NEW MEXICO EAST NAD 1983 X=775391 Y=372364 LAT.: N 32.0214604 LONG.: W 103.5781269 NAD 1927 X=734203 Y=372307 LAT.: N 32.0213352 LONG.: W 103.5776608 100' FNL 2360' FWL</p> <p>OPERATOR CERTIFICATION</p> <p>I hereby certify that the information contained herein is true and complete to the best of my knowledge and belief, and that this organization either owns a working interest or released mineral interest in the land including the proposed bottom hole location or has a right to drill this well at this location pursuant to a contract with an owner of such a mineral or working interest, or to voluntary pooling agreement or a compulsory pooling order heretofore entered by the division.</p> <p><i>Star L Harrell</i> 3/6/2024 Signature Date</p> <p>Star L Harrell Print Name</p> <p>star_harrell@eogresources.com E-mail Address</p>	<p>The diagram is a survey plat for a well location in Section 33, Township 26S, Range R33E. It shows a rectangular area divided into four lots (LOT 1, LOT 2, LOT 3, LOT 4) with acreages of 36.71, 36.92, 37.14, and 37.35 acres respectively. The well location is marked with a red dot and labeled 'KOP' (Kick Off Point). Other points marked include 'SHL' (Surface Location), 'UMP' (Upper Most Perf.), 'FPP1' (FED PERF. POINT), 'FPP2' (FED PERF. POINT), 'LMP/BHL' (Lower Most Perf./Bottom Hole Location). The diagram also shows the 'HZ SPACING UNIT' and 'USA' (United States) boundary. The well is located in the center of the section, with a 1016' FNL (Foot North Line) and 2172' FWL (Foot West Line) from the SHL. The well is also 50' FNL (Foot North Line) and 2360' FWL (Foot West Line) from the KOP. The well is 100' FNL (Foot North Line) and 2360' FWL (Foot West Line) from the UMP. The well is 2640' FSL (Foot South Line) and 2360' FWL (Foot West Line) from the FPP1. The well is 2640' FSL (Foot South Line) and 2360' FWL (Foot West Line) from the FPP2. The well is 100' FSL (Foot South Line) and 2360' FWL (Foot West Line) from the LMP/BHL. The diagram also shows the 'NEW MEXICO' and 'TEXAS' boundary. The well is located in the center of the section, with a 1016' FNL (Foot North Line) and 2172' FWL (Foot West Line) from the SHL. The well is also 50' FNL (Foot North Line) and 2360' FWL (Foot West Line) from the KOP. The well is 100' FNL (Foot North Line) and 2360' FWL (Foot West Line) from the UMP. The well is 2640' FSL (Foot South Line) and 2360' FWL (Foot West Line) from the FPP1. The well is 2640' FSL (Foot South Line) and 2360' FWL (Foot West Line) from the FPP2. The well is 100' FSL (Foot South Line) and 2360' FWL (Foot West Line) from the LMP/BHL.</p>	<p>FED PERF. POINT (FPP1)</p> <p>NEW MEXICO EAST NAD 1983 X=775410 Y=369826 LAT.: N 32.0144829 LONG.: W 103.5781230 NAD 1927 X=734222 Y=369769 LAT.: N 32.0143576 LONG.: W 103.5776573 2640' FSL 2360' FEL</p> <p>FED PERF. POINT (FPP2)</p> <p>NEW MEXICO EAST NAD 1983 X=775430 Y=367186 LAT.: N 32.0072269 LONG.: W 103.5781188 NAD 1927 X=734242 Y=367129 LAT.: N 32.0071016 LONG.: W 103.5776536 0' FNL 2360' FWL</p> <p>LOWER MOST PERF. (LMP) BOTTOM HOLE LOCATION (BHL)</p> <p>NEW MEXICO EAST NAD 1983 X=775448 Y=364747 LAT.: N 32.0005219 LONG.: W 103.5781150 NAD 1927 X=734260 Y=364690 LAT.: N 32.0003965 LONG.: W 103.5776502 100' FSL 2360' FWL</p> <p>SURVEYORS CERTIFICATION</p> <p>I hereby certify that the well location shown on this plat was plotted from field notes of actual surveys made by me or under my supervision, and that the same is true and correct to the best of my belief.</p> <p>02/23/2024 Date of Survey</p> <p>Signature and Seal of Professional Surveyor:</p> <p><i>Ramon Dominguez</i> Professional Surveyor 24508 3/1/2024 4:19:26 PM</p>
--	---	--

Exhibit A, page 1

District I
1625 N. French Dr., Hobbs, NM 88240
Phone: (575) 393-6161 Fax: (575) 393-0720

District II
811 S. First St., Artesia, NM 88210
Phone: (575) 748-1283 Fax: (575) 748-9720

District III
1000 Rio Brazos Road, Aztec, NM 87410
Phone: (505) 334-6178 Fax: (505) 334-6170

District IV
1220 S. St. Francis Dr., Santa Fe, NM 87505
Phone: (505) 476-3460 Fax: (505) 476-3462

State of New Mexico
Energy, Minerals & Natural Resources
Department
OIL CONSERVATION DIVISION
1220 South St. Francis Dr.
Santa Fe, NM 87505

FORM C-102

Revised August 1, 2011

Submit one copy to appropriate

District Office

☐ **AMENDED REPORT**

WELL LOCATION AND ACREAGE DEDICATION PLAT

¹ API Number 30-025-51966	² Pool Code 7280	³ Pool Name Bradley; Bone Spring
⁴ Property Code 315317	⁵ Property Name RATTLESNAKE 28 FED COM	
⁷ OGRID No. 7377	⁸ Operator Name EOG RESOURCES, INC.	⁶ Well Number 505H
		⁹ Elevation 3242'

¹⁰Surface Location

UL or lot no.	Section	Township	Range	Lot Idn	Feet from the	North/South line	Feet from the	East/West line	County
C	28	26-S	33-E	—	1016'	NORTH	2172'	WEST	LEA

¹¹Bottom Hole Location If Different From Surface

UL or lot no.	Section	Township	Range	Lot Idn	Feet from the	North/South line	Feet from the	East/West line	County
4	33	26-S	33-E	—	2447'	NORTH	1254'	WEST	LEA

¹² Dedicated Acres 237.13	¹³ Joint or Infill	¹⁴ Consolidation Code	¹⁵ Order No.
--	-------------------------------	----------------------------------	-------------------------

No allowable will be assigned to this completion until all interests have been consolidated or a non-standard unit has been approved by the division.

The survey map displays three well locations with their respective surface and bottom hole coordinates. The map includes a grid with section numbers 20, 21, 22, 28, 27, 29, 32, 33, and 34. A vertical hatched area labeled 'HZ SPACING UNIT' runs through sections 20, 29, 32, and 33.

UPPER MOST PERF. NEW MEXICO EAST NAD 1927

- X=773030.16 Y=372458.43
- X=774350.95 Y=372461.60
- LAT.: N 32.0213491 LONG.: W 103.5812293
- NAD 1983 X=774285 Y=372361
- LAT.: N 32.0214743 LONG.: W 103.5816954

FED PERF. POINT NEW MEXICO EAST NAD 1927

- X=733106 Y=371086
- LAT.: N 32.0179984 LONG.: W 103.5812278
- NAD 1983 X=774294 Y=371143
- LAT.: N 32.0181237 LONG.: W 103.5816938

FED PERF. POINT NEW MEXICO EAST NAD 1927

- X=733135 Y=367128
- LAT.: N 32.0071199 LONG.: W 103.5812231
- NAD 1983 X=774323 Y=367185
- LAT.: N 32.0072452 LONG.: W 103.5816884

SURFACE LOCATION NEW MEXICO EAST NAD 1927

- X=734022 Y=371391
- LAT.: N 32.0188203 LONG.: W 103.5782660
- NAD 1983 X=775210 Y=371448
- LAT.: N 32.0189456 LONG.: W 103.5787319

LOWER MOST PERF./BOTTOM HOLE LOCATION NEW MEXICO EAST NAD 1927

- X=733154 Y=364682
- LAT.: N 32.0003945 LONG.: W 103.5812178
- NAD 1983 X=774342 Y=364739
- LAT.: N 32.0005198 LONG.: W 103.5816827

Other Coordinates:

- X=773069.07 Y=367183.91
- X=773088.67 Y=364629.18
- X=774407.04 Y=364639.07

Measurements and Angles:

- AZ = 314.65°
- 1300.0'
- 100'
- 1254'
- 1329'
- 1016'
- 67'
- 852'
- 2172'
- 330'
- 179.57°
- 7623.1'
- 2447'
- 64'
- 100'
- 1254'
- 100'

Exhibit A, page 2

17 OPERATOR CERTIFICATION

I hereby certify that the information contained herein is true and complete to the best of my knowledge and belief, and that this organization either owns a working interest or unleased mineral interest in the land including the proposed bottom hole location or has a right to drill this well at this location pursuant to a contract with an owner of such a mineral or working interest, or to a voluntary pooling agreement or a compulsory pooling order heretofore entered by the division.

Lisa Trascher 9/21/2020

Signature

Date

Lisa Trascher

Printed Name

lisa_trascher@eogresources.com

E-mail Address

18 SURVEYOR CERTIFICATION

I hereby certify that the well location shown on this plat was plotted from field notes of actual surveys made by me or under my supervision, and that the same is true to the best of my belief.

01/21/2020

Date of Survey
Signature and Seal of Professional Surveyor

The seal is circular with a purple border. Inside the border, it reads "RAMON A. DOMINGUEZ" at the top, "NEW MEXICO" in the center, and "PROFESSIONAL SURVEYOR" at the bottom. The number "24508" is prominently displayed in the center.

Certificate Number

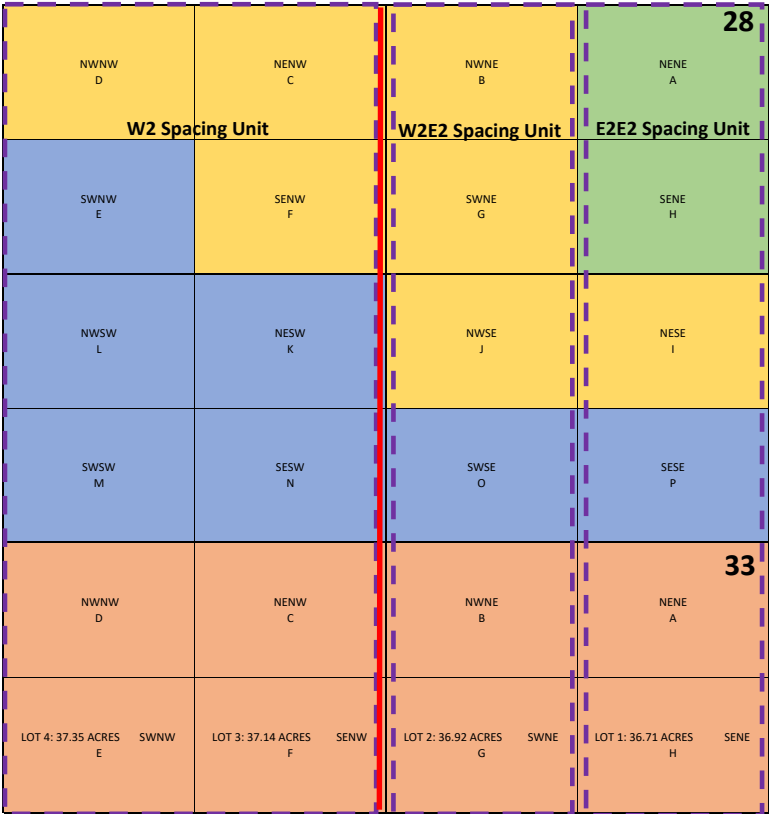

RATTLESNAKE 28 FED COM
All of Sec. 28 & N2N2 & Lots 1-4 of Sec. 33
T26S-R33E Lea County

Fee Leases

USA NMNM-121490

USA NMNM-084898

USA NMNM-02965-A

Bone Spring Units Spacing Units

Rattlesnake 28 Fed Com #214H: W2 Spacing Unit

Exhibit B



5509 Champions Dr., Midland, Texas 79706
Phone: (432) 686-3600 Fax: (432) 686-3773

March 11, 2024

Certification of Ownership

I have reviewed the ownership of the oil and gas leasehold in Sections 28 & 33, T26S-R33E, Lea County, New Mexico, for purposes of the unorthodox location for EOG Resources, Inc.'s Rattlesnake 28 Fed Com #214H Well in the W2 of Sections 28 & 33. The affected parties in the W2E2 are:

EOG Resources, Inc. 5509 Champions Drive Midland, Texas 79706
Chief Capital O&G II, LLC 8111 Westchester Drive, Ste 900 Dallas, TX 75225
Pontem Energy Partners I, LP 9001 Airport Freeway, Ste 825 North Richland Hills, TX 76180
Ellipsis Oil & Gas, Inc. 3500 Maple Ave, Ste 1080 Dallas, TX 75219
KMF Land, LLC 1401 Lawrence Street, Ste 1750 Denver, CO 80202
Bureau of Land Management 301 Dinosaur Trail Santa Fe, New Mexico 87508

EOG Resources, Inc.

A handwritten signature in black ink that reads "James Barwis".

James Barwis
Sr. Landman
March 11, 20214

Exhibit C

energy **opportunity** growth

NSL Application for Rattlesnake 28 Fed Com 214H, 510H, 512H
EOG Resources, Inc.
EXHIBIT A- Notice List

New Mexico Oil Conservation Division
Attn: Mr. Leonard Lowe
1220 South St. Francis Drive
Santa Fe, NM 87505
Via NMOCD Online

Bureau of Land Management
Attn: Jonathon Shepard
620 E. Green Street
Carlsbad, NM 88220
7021 2720 0000 6696 7753

EOG Resources
5509 Champions Dr
Midland TX, 79706

Ellipsis Oil & Gas Inc.
FKA Westlawn Fortuna Inc.
3500 Maple Ave, STE 1080
Dallas, TX 75219
7021 2720 0000 6696 7760

KMF Land LLC, DBA Sitio Permian LP
1401 Lawrence St
Suite 1750
Denver, CO 80202
7021 2720 0000 6696 7777

Cheif Capital O&G II LLC
Attn: Lacy Roberson
8111 Westchester Drive, STE 900
Dallas, TX 75225
7021 2720 0000 6696 7784

Pontem Energy Partners I LP
FKA Covenant Natural Resources
9001 Airport Freeway, STE 825
N Richland Hills, TX 76180-7795
7021 2720 0000 6696 7791

Exhibit D



Lisa Youngblood
Phone: (432) 247-6331
Email: lisa_youngblood@eogresources.com

March 12, 2024

VIA CERTIFIED MAIL

TO: AFFECTED PARTIES

Re: Application of EOG Resources, Inc. for administrative approval of an unorthodox well location for its Rattlesnake 28 Fed Com 214H well dedicated to the W2 of Section 28 and N2 of the NW4 and Lots 3 and 4 of Section 33, Township 26 South, Range 33 East, NMPM, Lea County, New Mexico.

Ladies and Gentlemen:

Enclosed is a copy of the above-referenced application which was filed with the New Mexico Oil Conservation Division on this date. Any objection to this application must be filed in writing within twenty days from this date with the applicant and the New Mexico Oil Conservation Division, 1220 South St. Francis Drive, Santa Fe, New Mexico, 87505. If no objection is received within this twenty-day period, this application may be approved administratively by the Division.

If you have any questions about this application, please contact the following:

James Barwis
EOG Resources, Inc.
(432) 425-1204
James_Barwis@eogresources.com

Very truly yours,

A handwritten signature in black ink that reads "Lisa Youngblood".

Lisa Youngblood
Regulatory Specialist



March 11, 2024

Re: EOG Resources, Inc. NSL Application
Rattlesnake 28 Fed Com #214H

To Whom it may concern:

A non-standard location is necessary to develop the Bone Spring resource in an economic fashion. The non-standard location also reflects the as-drilled location of the well. Based on analog Bone Spring wells along with geologic analysis, EOG believes placing the well at this location maintains optimal spacing to continue development of resources in the formation. Granting the exception will allow for more total production from the section and more efficient development of the asset therefore protecting correlative rights.

Sincerely

EOG Resources, Inc.

A handwritten signature in black ink, appearing to read "Price Hernandez", enclosed within a large, loopy oval shape.

Price Hernandez
Senior Reservoir Engineer

Exhibit E

District I
1625 N. French Dr., Hobbs, NM 88240
Phone:(575) 393-6161 Fax:(575) 393-0720
District II
811 S. First St., Artesia, NM 88210
Phone:(575) 748-1283 Fax:(575) 748-9720
District III
1000 Rio Brazos Rd., Aztec, NM 87410
Phone:(505) 334-6178 Fax:(505) 334-6170
District IV
1220 S. St Francis Dr., Santa Fe, NM 87505
Phone:(505) 476-3470 Fax:(505) 476-3462

State of New Mexico
Energy, Minerals and Natural Resources
Oil Conservation Division
1220 S. St Francis Dr.
Santa Fe, NM 87505

CONDITIONS

Action 322425

CONDITIONS

Operator: EOG RESOURCES INC 5509 Champions Drive Midland, TX 79706	OGRID: 7377
	Action Number: 322425
	Action Type: [UF-NSL] Non-Standard Location (NSL)

CONDITIONS

Created By	Condition	Condition Date
llowe	None	3/12/2024