

State of New Mexico
Energy, Minerals and Natural Resources Department

Michelle Lujan-Grisham
Governor

Melanie A. Kenderdine
Cabinet Secretary

Ben Shelton
Deputy Secretary

Erin Taylor
Deputy Secretary

Albert C.S. Chang
Division Director
Oil Conservation Division



Peyton Warren
pwarren@mewbourne.com

Administrative Order NSP – 2283

ADMINISTRATIVE NON-STANDARD HORIZONTAL SPACING UNIT

Mewbourne Oil Company [OGRID 14744]

High Sea 8 20 Federal Com Well No. 522H [30-025-54716]

High Sea 8 20 Federal Com Well No. 524H [30-025-PENDING]

High Sea 8 20 Federal Com Well No. 526H [30-025-PENDING]

High Sea 8 20 Federal Com Well No. 528H [30-025-PENDING]

HSU: Section 08, Section 17 and Section 20, T19S R36E, Lea County, New Mexico

Reference is made to your application received on April 17th, 2025.

You have requested approval of a non-standard horizontal spacing unit to be included in your proposed horizontal spacing unit, as follows:

Proposed Increased Horizontal Spacing Unit:

Description	Acres	Pool	Pool Code
Section 08	1920	Pearl; Bone Spring, East	49690
Section 17			
Section 20			

You have requested an exception pursuant to Rule 19.15.16.15(A)(3) NMAC, to approve a non-standard horizontal spacing unit consisting of the entire area described above as the horizontal spacing unit. The proposed horizontal spacing unit does not consist of a quarter - quarter section or equivalent in sections, as required by Rule 19.15.16.15(B)(1) NMAC.

NSP - 2283
Mewbourne Oil Company
Page 2 of 2

We understand that you are seeking this exception for an allowance to create a non-standard horizontal spacing unit, comprised of the Proposed Horizontal Spacing Unit referenced above within Lea County, New Mexico.

The Division understands you have given notice of this application to all operators or owners who are "affected persons," as defined in Paragraph (8) Subsection A of 19.15.2.7 NMAC, in all adjoining units which are to be being included.

You have requested this non-standard horizontal spacing unit in order to eliminate the need for separate facilities, the need for additional administrative approvals and to protect correlative rights within Bone Spring formation. Thereby, preventing waste underlying all of Section 08, all of Section 17, and all of Section 20, within the referenced Horizontal Spacing Unit.

Pursuant to the authority conferred by Division Rule 19.15.16.15(B)(5) NMAC, the above-described **non-standard horizontal spacing unit is hereby approved**. Further, the Applicant may add additional wells to the non-standard spacing unit, the well(s) must be in the same horizontal spacing unit and pool/formation. The new well's APD shall reference this NSP order number on Form C-102 with an adjacent letter stating this request.

General Provisions

The above approvals are subject to your being in compliance with all other applicable Division rules, including, but not limited to Division Rule 19.15.5.9 NMAC.

Jurisdiction of this case is retained for the entry of such further orders as the Division may deem necessary.



Albert C.S. Chang, PE
AC/lrl

Date: 7/3/2025

ID NO. 453008

NSP - 2283

Revised March 23, 2017

RECEIVED: 04/17/25	REVIEWER:	TYPE:	APP NO:
---------------------------	-----------	-------	---------

ABOVE THIS TABLE FOR OCD DIVISION USE ONLY

NEW MEXICO OIL CONSERVATION DIVISION
 - Geological & Engineering Bureau -
 1220 South St. Francis Drive, Santa Fe, NM 87505

**ADMINISTRATIVE APPLICATION CHECKLIST**

THIS CHECKLIST IS MANDATORY FOR ALL ADMINISTRATIVE APPLICATIONS FOR EXCEPTIONS TO DIVISION RULES AND
 REGULATIONS WHICH REQUIRE PROCESSING AT THE DIVISION LEVEL IN SANTA FE

Applicant: Mewbourne Oil Company**OGRID Number:** 14744**Well Name:** High Sea 8/20 Fed Com #522H, #524H, #526H & #528H**API:** Pending**Pool:** Pearl; Bone Spring, East**Pool Code:** 49690

**SUBMIT ACCURATE AND COMPLETE INFORMATION REQUIRED TO PROCESS THE TYPE OF APPLICATION
 INDICATED BELOW**

1) TYPE OF APPLICATION: Check those which apply for [A]

A. Location – Spacing Unit – Simultaneous Dedication

☐ NSL☐ NSP (PROJECT AREA)☒ NSP (PRORATION UNIT)☐ SD

B. Check one only for [I] or [II]

[I] Commingling – Storage – Measurement

☐ DHC☐ CTB☐ PLC☐ PC☐ OLS☐ OLM

[II] Injection – Disposal – Pressure Increase – Enhanced Oil Recovery

☐ WFX☐ PMX☐ SWD☐ IPI☐ EOR☐ PPR**2) NOTIFICATION REQUIRED TO:** Check those which apply.A. ☒ Offset operators or lease holdersB. ☐ Royalty, overriding royalty owners, revenue ownersC. ☐ Application requires published noticeD. ☒ Notification and/or concurrent approval by SLOE. ☒ Notification and/or concurrent approval by BLMF. ☐ Surface ownerG. ☒ For all of the above, proof of notification or publication is attached, and/or,H. ☐ No notice required**FOR OCD ONLY**☐ Notice Complete☐ Application
Content
Complete

- 3) CERTIFICATION:** I hereby certify that the information submitted with this application for administrative approval is **accurate** and **complete** to the best of my knowledge. I also understand that **no action** will be taken on this application until the required information and notifications are submitted to the Division.

Note: Statement must be completed by an individual with managerial and/or supervisory capacity.

Peyton Warren

Print or Type Name

4/4/2025

Date

(432) 682-3715

Phone Number

pwarren@mewbourne.com

e-mail Address

Peyton Warren
 Signature

MEWBOURNE OIL COMPANY

500 West Texas, Suite 1020
Midland, Texas 79701
Phone (432) 682-3715

April 4, 2025

Overnight Mail

New Mexico Oil Conservation Division
1220 S. St. Francis Drive
Santa Fe, New Mexico 87505
Attn: Mr. Leonard Lowe

Re: **Application for Non-Standard Proration Unit**
HIGH SEA 8/20 FED COM #522H – API # - pending
SHL: 225' FSL & 2440' FEL, Section 5, T19S, R36E
BHL: 100' FSL & 700' FWL, Section 20, T19S, R36E
FTP: 100' FNL & 700' FWL, Section 8, T19S, R36E
LTP: 100' FSL & 700' FWL, Section 20, T19S, R36E

HIGH SEA 8/20 FED COM #524H – API # - pending
SHL: 225' FSL & 2290' FEL, Section 5, T19S, R36E
BHL: 100' FSL & 2100' FWL, Section 20, T19S, R36E
FTP: 100' FNL & 2100' FWL, Section 8, T19S, R36E
LTP: 100' FSL & 2100' FWL, Section 20, T19S, R36E

HIGH SEA 8/20 FED COM #526H – API # - pending
SHL: 225' FSL & 2140' FEL, Section 5, T19S, R36E
BHL: 100' FSL & 1780' FEL, Section 20, T19S, R36E
FTP: 100' FNL & 1780' FEL, Section 8, T19S, R36E
LTP: 100' FSL & 1780' FEL, Section 20, T19S, R36E

HIGH SEA 8/20 FED COM #528H – API # - pending
SHL: 225' FSL & 1990' FEL, Section 5, T19S, R36E
BHL: 100' FSL & 380' FEL, Section 20, T19S, R36E
FTP: 100' FNL & 380' FEL, Section 8, T19S, R36E
LTP: 100' FSL & 380' FEL, Section 20, T19S, R36E
Lea County, New Mexico

Dear Mr. Lowe,

Pursuant to Division Rule 19.15.16.15(B)(5), Mewbourne Oil Company ("Mewbourne") respectfully requests administrative approval of a non-standard proration unit for its proposed High Sea 8/20 wells listed above. These wells will be drilled as horizontal oil wells in the Pearl; Bone Spring, East [49690] pool.

The High Sea 8/20 Fed Com #522H, High Sea 8/20 Fed Com #524H, High Sea 8/20 Fed Com #526H, and High Sea 8/20 Fed Com #528H wells will be dedicated to a 1920-acre proration unit comprising All of Sections 8, 17 and 20, T19S, R36E, Lea County, New Mexico

The affected offset acreage comprises SW4SW4 of Section 4, the W2W2 of Section 9, the W2W2 of Section 16, the W2W2 of Section 21, the NW4NW4 of Section 28, the N2N2 of Section 29, the NE4NE4 of Section 30, the E2E2 of Section 19, the E2E2 of Section 18, the E2E2 of Section 7, the SE4SE4 of Section 6, and the S2S2 of Section 5, all in T19S, R36E, Lea County, New Mexico. Consequently, notice of this application is being provided to all parties listed on the attached list of affected parties.

Mewbourne is seeking approval of this NSP to eliminate the need for separate production facilities and additional administrative approvals. Approval of the Non-Standard Proration Unit will reduce waste, limit our environmental footprint, and protect correlative rights with the horizontal spacing unit.

Notice by certified mail, return receipt requested, has been given to the affected parties listed in the notification list attached.

Thank you for your consideration of this application. Should you have any questions or need additional information regarding the above, please contact me at pwarren@mewbourne.com or (432) 682-3715.

Very truly yours,

MEWBOURNE OIL COMPANY



Peyton Warren
Landman

Enclosures

C-102 Submit Electronically Via OCD Permitting	State of New Mexico Energy, Minerals & Natural Resources Department OIL CONSERVATION DIVISION	Revised July 9, 2024	
		Submittal Type:	<input type="checkbox"/> Initial Submittal
			<input type="checkbox"/> Amended Report
		<input type="checkbox"/> As Drilled	

WELL LOCATION INFORMATION

API Number	Pool Code [49690]	Pool Name PEARL; BONE SPRING, EAST
Property Code	Property Name HIGH SEA 8/20 FED COM	Well Number 522H
OGRID No. 14744	Operator Name MEWBOURNE OIL COMPANY	Ground Level Elevation
Surface Owner: <input type="checkbox"/> State <input type="checkbox"/> Fee <input type="checkbox"/> Tribal <input type="checkbox"/> Federal		Mineral Owner: <input type="checkbox"/> State <input type="checkbox"/> Fee <input type="checkbox"/> Tribal <input type="checkbox"/> Federal

Surface Location

UL 0	Section 5	Township 19S	Range 36E	Lot	Ft. from N/S 225 FSL	Ft. from E/W 2440 FEL	Latitude	Longitude	County LEA
------	-----------	--------------	-----------	-----	----------------------	-----------------------	----------	-----------	------------

Bottom Hole Location

UL M	Section 20	Township 19S	Range 36E	Lot	Ft. from N/S 100 FSL	Ft. from E/W 700 FWL	Latitude	Longitude	County LEA
------	------------	--------------	-----------	-----	----------------------	----------------------	----------	-----------	------------

Dedicated Acres 1920	Infill or Defining Well Defining	Defining Well API	Overlapping Spacing Unit (Y/N)	Consolidation Code
Order Numbers.			Well setbacks are under Common Ownership: <input type="checkbox"/> Yes <input type="checkbox"/> No	

Kick Off Point (KOP)

UL	Section	Township	Range	Lot	Ft. from N/S	Ft. from E/W	Latitude	Longitude	County
----	---------	----------	-------	-----	--------------	--------------	----------	-----------	--------

First Take Point (FTP)

UL	Section 8	Township 19S	Range 36E	Lot	Ft. from N/S 100 FNL	Ft. from E/W 700 FWL	Latitude	Longitude	County Lea
----	-----------	--------------	-----------	-----	----------------------	----------------------	----------	-----------	------------

Last Take Point (LTP)

UL	Section 20	Township 19S	Range 36E	Lot	Ft. from N/S 100 FSL	Ft. from E/W 700 FWL	Latitude	Longitude	County Lea
----	------------	--------------	-----------	-----	----------------------	----------------------	----------	-----------	------------

Unitized Area or Area of Uniform Interest	Spacing Unit Type <input type="checkbox"/> Horizontal <input type="checkbox"/> Vertical	Ground Floor Elevation:
---	---	-------------------------

OPERATOR CERTIFICATIONS <i>I hereby certify that the information contained herein is true and complete to the best of my knowledge and belief, and, if the well is a vertical or directional well, that this organization either owns a working interest or unleased mineral interest in the land including the proposed bottom hole location or has a right to drill this well at this location pursuant to a contract with an owner of a working interest or unleased mineral interest, or to a voluntary pooling agreement or a compulsory pooling order heretofore entered by the division.</i> <i>If this well is a horizontal well, I further certify that this organization has received the consent of at least one lessee or owner of a working interest or unleased mineral interest in each tract (in the target pool or formation) in which any part of the well's completed interval will be located or obtained a compulsory pooling order from the division.</i>		SURVEYOR CERTIFICATIONS <i>I hereby certify that the well location shown on this plat was plotted from field notes of actual surveys made by me under my supervision, and that the same is true and correct to the best of my belief.</i>	
Signature _____ Date _____		Signature and Seal of Professional Surveyor _____	
Printed Name _____		Certificate Number _____	Date of Survey _____
Email Address _____			

ACREAGE DEDICATION PLATS

This grid represents a standard section. You may superimpose a non-standard section, or larger area, over this grid. Operators must outline the dedicated acreage in a red box, clearly show the well surface location and bottom hole location, if it is a directionally drilled, with the dimensions from the section lines in the cardinal directions. If this is a horizontal wellbore show on this plat the location of the First Take Point and Last Take Point, and the point within the Completed interval (other than the First Take Point or Last Take Point) that is closest to any outer boundary of the tract.

Surveyors shall use the latest United States government survey or dependent resurvey. Well locations will be in reference to the New Mexico Principal Meridian. If the land is not surveyed, contact the OCD Engineering Bureau. Independent subdivision surveys will not be acceptable.

HIGH SEA 8/20 FED COM #522H

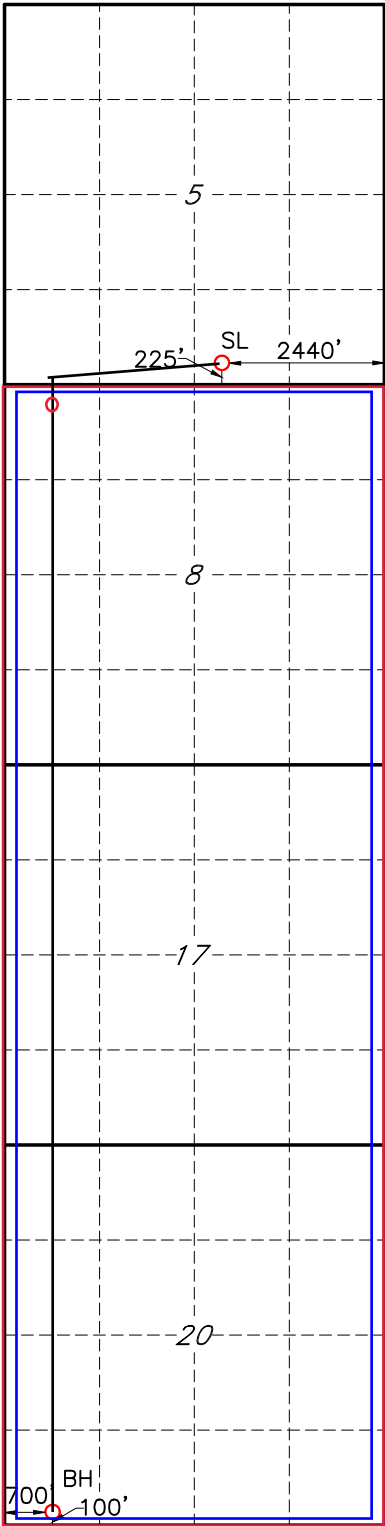

C-102 Submit Electronically Via OCD Permitting	State of New Mexico Energy, Minerals & Natural Resources Department OIL CONSERVATION DIVISION	Revised July 9, 2024	
		Submittal Type:	<input type="checkbox"/> Initial Submittal
			<input type="checkbox"/> Amended Report
		<input type="checkbox"/> As Drilled	

WELL LOCATION INFORMATION

API Number	Pool Code [49690]	Pool Name PEARL; BONE SPRING, EAST
Property Code	Property Name HIGH SEA 8/20 FED COM	Well Number 524H
OGRID No. 14744	Operator Name MEWBOURNE OIL COMPANY	Ground Level Elevation
Surface Owner: <input type="checkbox"/> State <input type="checkbox"/> Fee <input type="checkbox"/> Tribal <input type="checkbox"/> Federal		Mineral Owner: <input type="checkbox"/> State <input type="checkbox"/> Fee <input type="checkbox"/> Tribal <input type="checkbox"/> Federal

Surface Location

UL 0	Section 5	Township 19S	Range 36E	Lot	Ft. from N/S 225 FSL	Ft. from E/W 2290 FEL	Latitude	Longitude	County LEA
------	-----------	--------------	-----------	-----	----------------------	-----------------------	----------	-----------	------------

Bottom Hole Location

UL N	Section 20	Township 19S	Range 36E	Lot	Ft. from N/S 100 FSL	Ft. from E/W 2100 FWL	Latitude	Longitude	County LEA
------	------------	--------------	-----------	-----	----------------------	-----------------------	----------	-----------	------------

Dedicated Acres 1920	Infill or Defining Well Infill	Defining Well API	Overlapping Spacing Unit (Y/N)	Consolidation Code
Order Numbers.			Well setbacks are under Common Ownership: <input type="checkbox"/> Yes <input type="checkbox"/> No	

Kick Off Point (KOP)

UL	Section	Township	Range	Lot	Ft. from N/S	Ft. from E/W	Latitude	Longitude	County
----	---------	----------	-------	-----	--------------	--------------	----------	-----------	--------

First Take Point (FTP)

UL	Section 8	Township 19S	Range 36E	Lot	Ft. from N/S 100 FNL	Ft. from E/W 2100 FWL	Latitude	Longitude	County Lea
----	-----------	--------------	-----------	-----	----------------------	-----------------------	----------	-----------	------------

Last Take Point (LTP)

UL	Section 20	Township 19S	Range 36E	Lot	Ft. from N/S 100 FSL	Ft. from E/W 2100 FWL	Latitude	Longitude	County Lea
----	------------	--------------	-----------	-----	----------------------	-----------------------	----------	-----------	------------

Unitized Area or Area of Uniform Interest	Spacing Unit Type <input type="checkbox"/> Horizontal <input type="checkbox"/> Vertical	Ground Floor Elevation:
---	---	-------------------------

OPERATOR CERTIFICATIONS <i>I hereby certify that the information contained herein is true and complete to the best of my knowledge and belief, and, if the well is a vertical or directional well, that this organization either owns a working interest or unleased mineral interest in the land including the proposed bottom hole location or has a right to drill this well at this location pursuant to a contract with an owner of a working interest or unleased mineral interest, or to a voluntary pooling agreement or a compulsory pooling order heretofore entered by the division.</i> <i>If this well is a horizontal well, I further certify that this organization has received the consent of at least one lessee or owner of a working interest or unleased mineral interest in each tract (in the target pool or formation) in which any part of the well's completed interval will be located or obtained a compulsory pooling order from the division.</i>		SURVEYOR CERTIFICATIONS <i>I hereby certify that the well location shown on this plat was plotted from field notes of actual surveys made by me under my supervision, and that the same is true and correct to the best of my belief.</i>	
Signature _____ Date _____		Signature and Seal of Professional Surveyor _____	
Printed Name _____		Certificate Number _____	Date of Survey _____
Email Address _____			

ACREAGE DEDICATION PLATS

This grid represents a standard section. You may superimpose a non-standard section, or larger area, over this grid. Operators must outline the dedicated acreage in a red box, clearly show the well surface location and bottom hole location, if it is a directionally drilled, with the dimensions from the section lines in the cardinal directions. If this is a horizontal wellbore show on this plat the location of the First Take Point and Last Take Point, and the point within the Completed interval (other than the First Take Point or Last Take Point) that is closest to any outer boundary of the tract.

Surveyors shall use the latest United States government survey or dependent resurvey. Well locations will be in reference to the New Mexico Principal Meridian. If the land is not surveyed, contact the OCD Engineering Bureau. Independent subdivision surveys will not be acceptable.

HIGH SEA 8/20 FED COM #524H

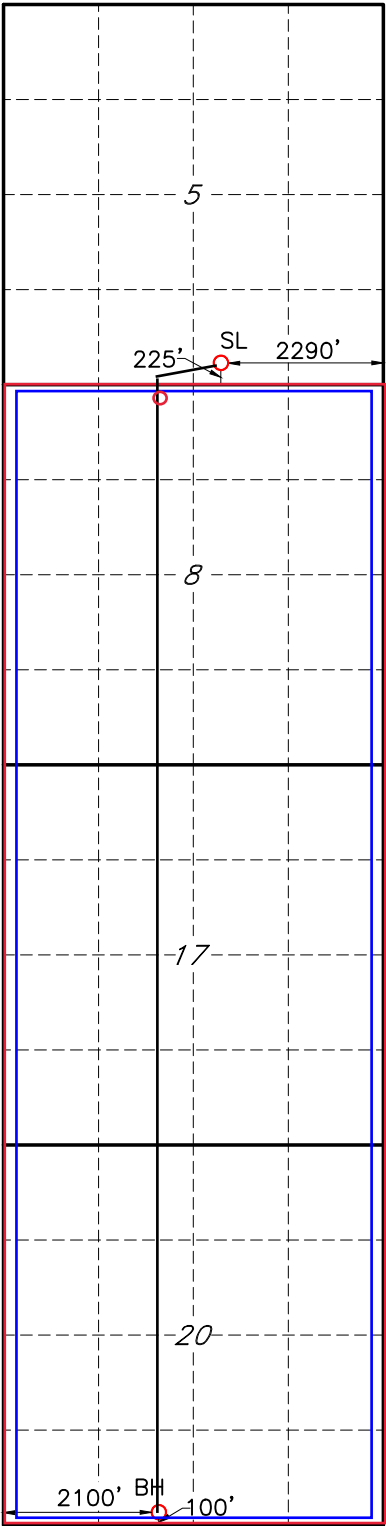

C-102 Submit Electronically Via OCD Permitting	State of New Mexico Energy, Minerals & Natural Resources Department OIL CONSERVATION DIVISION	Revised July 9, 2024	
		Submittal Type:	<input type="checkbox"/> Initial Submittal
			<input type="checkbox"/> Amended Report
		<input type="checkbox"/> As Drilled	

WELL LOCATION INFORMATION

API Number	Pool Code [49690]	Pool Name PEARL; BONE SPRING, EAST
Property Code	Property Name HIGH SEA 8/20 FED COM	Well Number 526H
OGRID No. 14744	Operator Name MEWBOURNE OIL COMPANY	Ground Level Elevation
Surface Owner: <input type="checkbox"/> State <input type="checkbox"/> Fee <input type="checkbox"/> Tribal <input type="checkbox"/> Federal		Mineral Owner: <input type="checkbox"/> State <input type="checkbox"/> Fee <input type="checkbox"/> Tribal <input type="checkbox"/> Federal

Surface Location

UL 0	Section 5	Township 19S	Range 36E	Lot	Ft. from N/S 225 FSL	Ft. from E/W 2140 FEL	Latitude	Longitude	County LEA
------	-----------	--------------	-----------	-----	----------------------	-----------------------	----------	-----------	------------

Bottom Hole Location

UL 0	Section 20	Township 19S	Range 36E	Lot	Ft. from N/S 100 FSL	Ft. from E/W 1780 FEL	Latitude	Longitude	County LEA
------	------------	--------------	-----------	-----	----------------------	-----------------------	----------	-----------	------------

Dedicated Acres 1920	Infill or Defining Well Infill	Defining Well API	Overlapping Spacing Unit (Y/N)	Consolidation Code
Order Numbers.			Well setbacks are under Common Ownership: <input type="checkbox"/> Yes <input type="checkbox"/> No	

Kick Off Point (KOP)

UL	Section	Township	Range	Lot	Ft. from N/S	Ft. from E/W	Latitude	Longitude	County
----	---------	----------	-------	-----	--------------	--------------	----------	-----------	--------

First Take Point (FTP)

UL	Section 8	Township 19S	Range 36E	Lot	Ft. from N/S 100 FNL	Ft. from E/W 1780 FEL	Latitude	Longitude	County Lea
----	-----------	--------------	-----------	-----	----------------------	-----------------------	----------	-----------	------------

Last Take Point (LTP)

UL	Section 20	Township 19S	Range 36E	Lot	Ft. from N/S 100 FSL	Ft. from E/W 1780 FEL	Latitude	Longitude	County Lea
----	------------	--------------	-----------	-----	----------------------	-----------------------	----------	-----------	------------

Unitized Area or Area of Uniform Interest	Spacing Unit Type <input type="checkbox"/> Horizontal <input type="checkbox"/> Vertical	Ground Floor Elevation:
---	---	-------------------------

OPERATOR CERTIFICATIONS <i>I hereby certify that the information contained herein is true and complete to the best of my knowledge and belief, and, if the well is a vertical or directional well, that this organization either owns a working interest or unleased mineral interest in the land including the proposed bottom hole location or has a right to drill this well at this location pursuant to a contract with an owner of a working interest or unleased mineral interest, or to a voluntary pooling agreement or a compulsory pooling order heretofore entered by the division.</i> <i>If this well is a horizontal well, I further certify that this organization has received the consent of at least one lessee or owner of a working interest or unleased mineral interest in each tract (in the target pool or formation) in which any part of the well's completed interval will be located or obtained a compulsory pooling order from the division.</i>		SURVEYOR CERTIFICATIONS <i>I hereby certify that the well location shown on this plat was plotted from field notes of actual surveys made by me under my supervision, and that the same is true and correct to the best of my belief.</i>	
Signature _____ Date _____		Signature and Seal of Professional Surveyor _____	
Printed Name _____		Certificate Number _____	Date of Survey _____
Email Address _____			

ACREAGE DEDICATION PLATS

This grid represents a standard section. You may superimpose a non-standard section, or larger area, over this grid. Operators must outline the dedicated acreage in a red box, clearly show the well surface location and bottom hole location, if it is a directionally drilled, with the dimensions from the section lines in the cardinal directions. If this is a horizontal wellbore show on this plat the location of the First Take Point and Last Take Point, and the point within the Completed interval (other than the First Take Point or Last Take Point) that is closest to any outer boundary of the tract.

Surveyors shall use the latest United States government survey or dependent resurvey. Well locations will be in reference to the New Mexico Principal Meridian. If the land is not surveyed, contact the OCD Engineering Bureau. Independent subdivision surveys will not be acceptable.

HIGH SEA 8/20 FED COM #526H

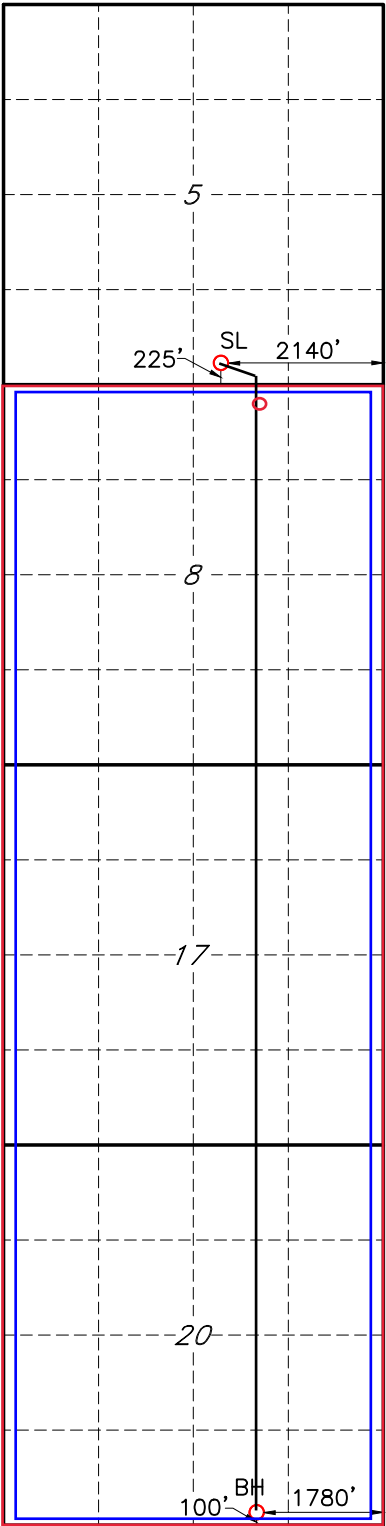

C-102 Submit Electronically Via OCD Permitting	State of New Mexico Energy, Minerals & Natural Resources Department OIL CONSERVATION DIVISION	Revised July 9, 2024	
		Submittal Type:	<input type="checkbox"/> Initial Submittal
			<input type="checkbox"/> Amended Report
		<input type="checkbox"/> As Drilled	

WELL LOCATION INFORMATION

API Number	Pool Code [49690]	Pool Name PEARL; BONE SPRING, EAST
Property Code	Property Name HIGH SEA 8/20 FED COM	Well Number 528H
OGRID No. 14744	Operator Name MEWBOURNE OIL COMPANY	Ground Level Elevation
Surface Owner: <input type="checkbox"/> State <input type="checkbox"/> Fee <input type="checkbox"/> Tribal <input type="checkbox"/> Federal		Mineral Owner: <input type="checkbox"/> State <input type="checkbox"/> Fee <input type="checkbox"/> Tribal <input type="checkbox"/> Federal

Surface Location

UL 0	Section 5	Township 19S	Range 36E	Lot	Ft. from N/S 225 FSL	Ft. from E/W 1990 FEL	Latitude	Longitude	County LEA
------	-----------	--------------	-----------	-----	----------------------	-----------------------	----------	-----------	------------

Bottom Hole Location

UL P	Section 20	Township 19S	Range 36E	Lot	Ft. from N/S 100 FSL	Ft. from E/W 380 FEL	Latitude	Longitude	County LEA
------	------------	--------------	-----------	-----	----------------------	----------------------	----------	-----------	------------

Dedicated Acres 1920	Infill or Defining Well Infill	Defining Well API	Overlapping Spacing Unit (Y/N)	Consolidation Code
Order Numbers.			Well setbacks are under Common Ownership: <input type="checkbox"/> Yes <input type="checkbox"/> No	

Kick Off Point (KOP)

UL	Section	Township	Range	Lot	Ft. from N/S	Ft. from E/W	Latitude	Longitude	County
----	---------	----------	-------	-----	--------------	--------------	----------	-----------	--------

First Take Point (FTP)

UL	Section 8	Township 19S	Range 36E	Lot	Ft. from N/S 100 FNL	Ft. from E/W 380 FEL	Latitude	Longitude	County Lea
----	-----------	--------------	-----------	-----	----------------------	----------------------	----------	-----------	------------

Last Take Point (LTP)

UL	Section 20	Township 19S	Range 36E	Lot	Ft. from N/S 100 FSL	Ft. from E/W 380 FEL	Latitude	Longitude	County Lea
----	------------	--------------	-----------	-----	----------------------	----------------------	----------	-----------	------------

Unitized Area or Area of Uniform Interest	Spacing Unit Type <input type="checkbox"/> Horizontal <input type="checkbox"/> Vertical	Ground Floor Elevation:
---	---	-------------------------

OPERATOR CERTIFICATIONS <i>I hereby certify that the information contained herein is true and complete to the best of my knowledge and belief, and, if the well is a vertical or directional well, that this organization either owns a working interest or unleased mineral interest in the land including the proposed bottom hole location or has a right to drill this well at this location pursuant to a contract with an owner of a working interest or unleased mineral interest, or to a voluntary pooling agreement or a compulsory pooling order heretofore entered by the division.</i> <i>If this well is a horizontal well, I further certify that this organization has received the consent of at least one lessee or owner of a working interest or unleased mineral interest in each tract (in the target pool or formation) in which any part of the well's completed interval will be located or obtained a compulsory pooling order from the division.</i>		SURVEYOR CERTIFICATIONS <i>I hereby certify that the well location shown on this plat was plotted from field notes of actual surveys made by me under my supervision, and that the same is true and correct to the best of my belief.</i>	
Signature _____ Date _____		Signature and Seal of Professional Surveyor _____	
Printed Name _____		Certificate Number _____	Date of Survey _____
Email Address _____			

Note: No allowable will be assigned to this completion until all interests have been consolidated or a non-standard unit has been approved by the division.

ACREAGE DEDICATION PLATS

This grid represents a standard section. You may superimpose a non-standard section, or larger area, over this grid. Operators must outline the dedicated acreage in a red box, clearly show the well surface location and bottom hole location, if it is a directionally drilled, with the dimensions from the section lines in the cardinal directions. If this is a horizontal wellbore show on this plat the location of the First Take Point and Last Take Point, and the point within the Completed interval (other than the First Take Point or Last Take Point) that is closest to any outer boundary of the tract.

Surveyors shall use the latest United States government survey or dependent resurvey. Well locations will be in reference to the New Mexico Principal Meridian. If the land is not surveyed, contact the OCD Engineering Bureau. Independent subdivision surveys will not be acceptable.

HIGH SEA 8/20 FED COM #528H

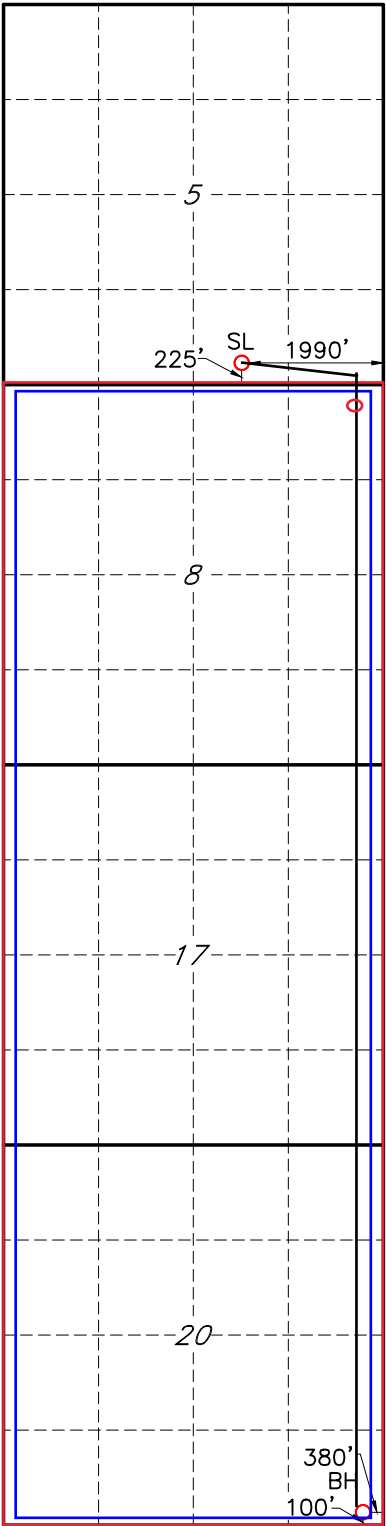

MEWBOURNE OIL COMPANY

500 West Texas, Suite 1020
Midland, Texas 79701
Phone (432) 682-3715

April 4, 2025

Certified Mail

Affected Parties

Re: **Application for Non-Standard Proration Unit**
HIGH SEA 8/20 FED COM #522H – API # - pending
SHL: 225' FSL & 2440' FEL, Section 5, T19S, R36E
BHL: 100' FSL & 700' FWL, Section 20, T19S, R36E
FTP: 100' FNL & 700' FWL, Section 8, T19S, R36E
LTP: 100' FSL & 700' FWL, Section 20, T19S, R36E

HIGH SEA 8/20 FED COM #524H – API # - pending
SHL: 225' FSL & 2290' FEL, Section 5, T19S, R36E
BHL: 100' FSL & 2100' FWL, Section 20, T19S, R36E
FTP: 100' FNL & 2100' FWL, Section 8, T19S, R36E
LTP: 100' FSL & 2100' FWL, Section 20, T19S, R36E

HIGH SEA 8/20 FED COM #526H – API # - pending
SHL: 225' FSL & 2140' FEL, Section 5, T19S, R36E
BHL: 100' FSL & 1780' FEL, Section 20, T19S, R36E
FTP: 100' FNL & 1780' FEL, Section 8, T19S, R36E
LTP: 100' FSL & 1780' FEL, Section 20, T19S, R36E

HIGH SEA 8/20 FED COM #528H – API # - pending
SHL: 225' FSL & 1990' FEL, Section 5, T19S, R36E
BHL: 100' FSL & 380' FEL, Section 20, T19S, R36E
FTP: 100' FNL & 380' FEL, Section 8, T19S, R36E
LTP: 100' FSL & 380' FEL, Section 20, T19S, R36E
Lea County, New Mexico

To Whom It May Concern:

Enclosed is a copy of Mewbourne Oil Company's (MOC) Application for Non-Standard Proration Unit for the above referenced High Sea 8/20 Fed Com #522H, High Sea 8/20 Fed Com #524H, High Sea 8/20 Fed Com #526H, and High Sea 8/20 Fed Com #528H wells covering All of Sections 8, 17 and 20, T19S, R36E, Lea County, New Mexico.

You are being sent a copy of this Application per OCD's requirements to notify the interest owners in the affected offset acreage. If you have any objection to this Application, notification should be given to the OCD within 20 days of the date of this letter. The Application has been filed with the OCD as of this date.

MOC is seeking approval of the non-standard proration unit to eliminate the need for separate production facilities and additional administrative approvals. Approval of the Non-Standard Proration Unit will reduce waste, limit our environmental footprint, and protect correlative rights with the horizontal spacing unit.

If you have any questions regarding this application, please contact me at pwarren@mewbourne.com or (432) 682-3715.

MEWBOURNE OIL COMPANY



Peyton Warren
Landman

Plat of Affected Tracts
High Sea NSP

T19S-R36E

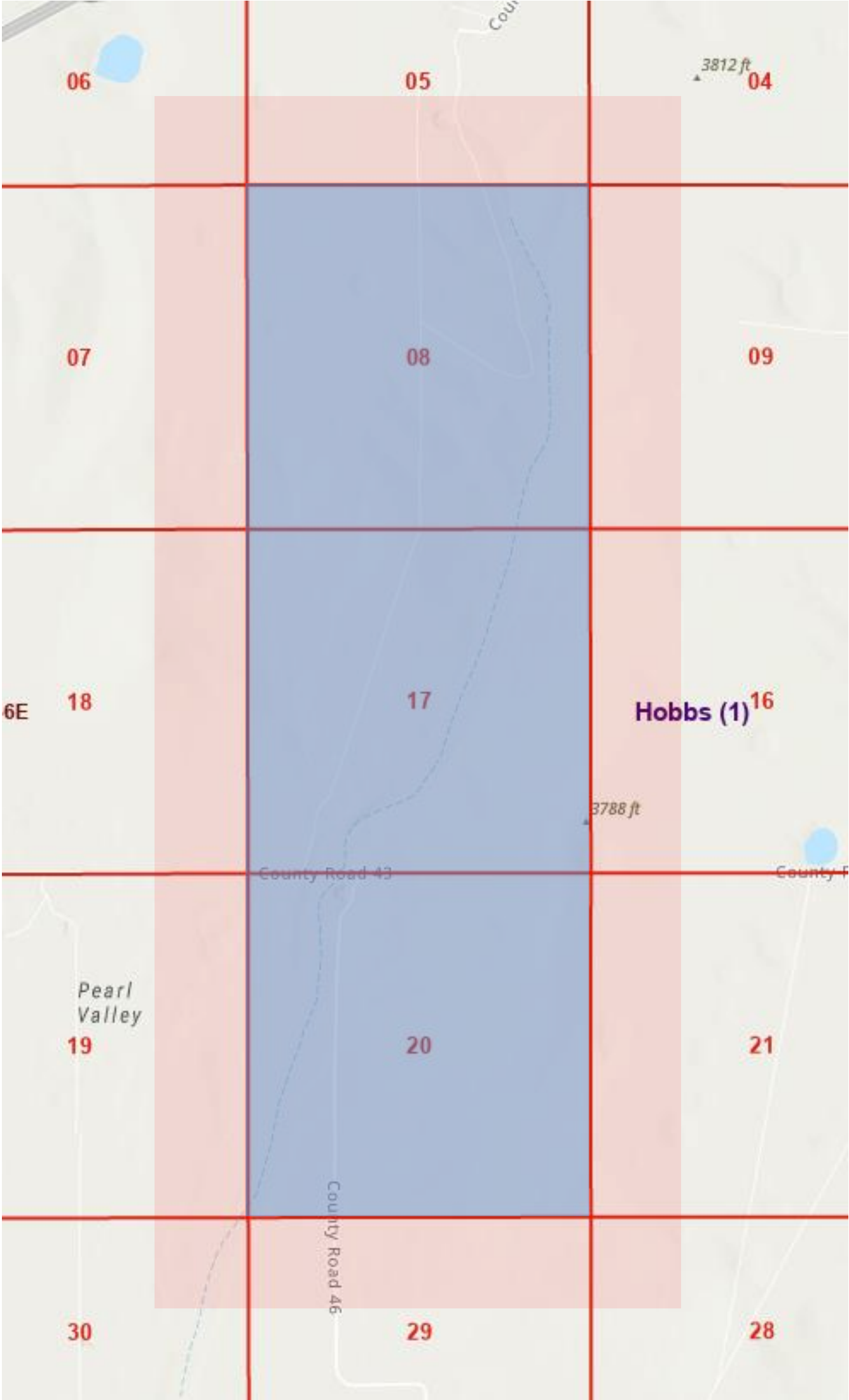

Proration Unit	Affected Tracts
----------------	-----------------

High Sea 8/20 Prospect - NSP Notice List					
OWNER NAME	ADDRESS	CITY	STATE	ZIP	TRACKING NUMBER
Rockwood Energy, LP	4450 Oak Park Lane, Suite 101897	Fort Worth	TX	76109	9414 8362 0855 1280 7605 82
OXY USA WTP LP	5 Greenway Plaza, Suite 110	Houston	TX	77046	9414 8362 0855 1280 7606 50
Chevron USA Inc.	1400 Smith Street, HOU 140/45130	Houston	TX	77002	9414 8362 0855 1280 7607 28
Coterra Energy Operating Co.	6001 Deauville Blvd., Suite 300N	Midland	TX	79706	9414 8362 0855 1280 7607 80
Texas Standard Oil LLC	3300 N. A Street, Building 1, Suite 105	Midland	TX	79705	9414 8362 0855 1280 7608 41
Marhsall & Winston, Inc.	PO Box 50880	Midland	TX	79710	9414 8362 0855 1280 7609 19
Copperhead Resources, LLC	PO Box 8355	Midland	TX	79708	9414 8362 0855 1280 7609 88
Jack P. Hooper GST Trust	5511 E. 89th Court	Tulsa	OK	74137	9414 8362 0855 1280 7610 53
Two States Oil Company	3625 CENTENARY AVE	DALLAS	TX	75225	9414 8362 0855 1280 7611 07
Holmes OG Legacy, LLC	PO BOX 849	PEORIA	AZ	85380	9414 8362 0855 1280 7612 20
SEO, LLC	120 W BAJA	HOBBS	NM	88240	9414 8362 0855 1280 7613 05
RSJD, LLC	118 CR 249F	SEMINOLE	TX	79360	9414 8362 0855 1280 7613 43
Grimes 710 LLC	PO BOX 2006	MIDLAND	TX	79702	9414 8362 0855 1280 7614 28
Matthews-Link Properties, Ltd.	2630 EXPOSITION BLVD, Suite G12C	AUSTIN	TX	78703	9414 8362 0855 1280 7614 97
James D. Russell	3333 E BAYAUD AVENUE, #214	DENVER	CO	80209	9414 8362 0855 1280 7615 41
Hunter Oil LLC	334 N MAXWELL CREEK RD	MURPHY	TX	75094	9414 8362 0855 1280 7616 19
Mary B. Hunter Marital Trust	9 OAKLAWN PARK	MIDLAND	TX	79705	9414 8362 0855 1280 7616 71
Trink Minerals LLC	4002 SOUTH SPRINGS LOOP	ROSWELL	NM	88203	9414 8362 0855 1280 7617 25
Karylila, LLC	3 SOUTHPOINTE DRIVE	SEARCY	AR	72143	9414 8362 0855 1280 7617 87
Ann Reese Minerals, LLC	3525 N WASHINGTON ROAD	FORT WAYNE	IN	46802	9414 8362 0855 1280 7618 48
Robert Stephen Heinsch (Deceased)	4415 87TH STREET	LUBBOCK	TX	79424	9414 8362 0855 1280 7619 54
Leslie M. Heinsch Revocable Trust	1309 DELTA AVENUE	CARLSBAD	NM	88220	9414 8362 0855 1280 7620 50
CC Heinsch Living Trust	1826 E FRIER DRIVE #2	PHOENIX	AZ	85020	9414 8362 0855 1280 7621 73
Rising Phoenix Opportunity Fund IV, LLC	4230 AVONDALE AVENUE	DALLAS	TX	75219	9414 8362 0855 1280 7622 65

Sante Fe Main Office
Phone: (505) 476-3441

General Information
Phone: (505) 629-6116

Online Phone Directory
<https://www.emnrd.nm.gov/ocd/contact-us>

State of New Mexico
Energy, Minerals and Natural Resources
Oil Conservation Division
1220 S. St Francis Dr.
Santa Fe, NM 87505

COMMENTS

Action 453008

COMMENTS

Operator: MEWBOURNE OIL CO P.O. Box 5270 Hobbs, NM 88241	OGRID: 14744
	Action Number: 453008
	Action Type: [UF-NSP] Non-Standard Proration (NSP)

COMMENTS

Created By	Comment	Comment Date
llowe	If this NSP order was approved with pending API wells. The owner of the NSP shall update the OCD when API number(s) are assigned to those pending APD well(s) by sending an e-mail to ocd.engineer@emnrd.nm.gov . TITLED: (Updating NSP-XXX with API number(s) and associated Well Name)	7/10/2025

Sante Fe Main Office
Phone: (505) 476-3441

General Information
Phone: (505) 629-6116

Online Phone Directory
<https://www.emnrd.nm.gov/ocd/contact-us>

State of New Mexico
Energy, Minerals and Natural Resources
Oil Conservation Division
1220 S. St Francis Dr.
Santa Fe, NM 87505

CONDITIONS

Action 453008

CONDITIONS

Operator: MEWBOURNE OIL CO P.O. Box 5270 Hobbs, NM 88241	OGRID: 14744
	Action Number: 453008
	Action Type: [UF-NSP] Non-Standard Proration (NSP)

CONDITIONS

Created By	Condition	Condition Date
llowe	None	4/18/2025