

Revised March 23, 2017

RECEIVED:	REVIEWER:	TYPE:	APP NO:
-----------	-----------	-------	---------

ABOVE THIS TABLE FOR OCD DIVISION USE ONLY

NEW MEXICO OIL CONSERVATION DIVISION
 - Geological & Engineering Bureau -
 1220 South St. Francis Drive, Santa Fe, NM 87505



ADMINISTRATIVE APPLICATION CHECKLIST

THIS CHECKLIST IS MANDATORY FOR ALL ADMINISTRATIVE APPLICATIONS FOR EXCEPTIONS TO DIVISION RULES AND REGULATIONS WHICH REQUIRE PROCESSING AT THE DIVISION LEVEL IN SANTA FE

Applicant: _____ OGRID Number: _____
 Well Name: _____ API: _____
 Pool: _____ Pool Code: _____

SUBMIT ACCURATE AND COMPLETE INFORMATION REQUIRED TO PROCESS THE TYPE OF APPLICATION INDICATED BELOW

1) **TYPE OF APPLICATION:** Check those which apply for [A]

A. Location – Spacing Unit – Simultaneous Dedication

☐ NSL ☐ NSP (PROJECT AREA) ☐ NSP (PRORATION UNIT) ☐ SD

B. Check one only for [I] or [II]

[I] Commingling – Storage – Measurement

☐ DHC ☐ CTB ☐ PLC ☐ PC ☐ OLS ☐ OLM

[II] Injection – Disposal – Pressure Increase – Enhanced Oil Recovery

☐ WFX ☐ PMX ☐ SWD ☐ IPI ☐ EOR ☐ PPR

2) **NOTIFICATION REQUIRED TO:** Check those which apply.

- A. ☐ Offset operators or lease holders
 B. ☐ Royalty, overriding royalty owners, revenue owners
 C. ☐ Application requires published notice
 D. ☐ Notification and/or concurrent approval by SLO
 E. ☐ Notification and/or concurrent approval by BLM
 F. ☐ Surface owner
 G. ☐ For all of the above, proof of notification or publication is attached, and/or,
 H. ☐ No notice required

FOR OCD ONLY

- ☐ Notice Complete
☐ Application Content Complete

3) **CERTIFICATION:** I hereby certify that the information submitted with this application for administrative approval is **accurate** and **complete** to the best of my knowledge. I also understand that **no action** will be taken on this application until the required information and notifications are submitted to the Division.

Note: Statement must be completed by an individual with managerial and/or supervisory capacity.

Print or Type Name

Sarah Chapman
 Signature

Date

Phone Number

e-mail Address

District I
1625 N. French Drive, Hobbs, NM 88240
District II
811 S. First St., Artesia, NM 88210
District III
1000 Rio Brazos Road, Aztec, NM 87410
District IV
1220 S. St Francis Dr, Santa Fe, NM
87505

State of New Mexico
Energy, Minerals and Natural Resources Department

Form C-107-B
Revised August 1, 2011

OIL CONSERVATION DIVISION
1220 S. St Francis Drive
Santa Fe, New Mexico 87505

Submit the original
application to the Santa Fe
office with one copy to the
appropriate District Office.

APPLICATION FOR SURFACE COMMINGLING (DIVERSE OWNERSHIP)

OPERATOR NAME: SPUR ENERGY PARTNERS LLC
OPERATOR ADDRESS: 9655 KATY FREEWAY, SUITE 500, HOUSTON, TX 77024
APPLICATION TYPE:

☐ Pool Commingling ☐ Lease Commingling ☐ Pool and Lease Commingling ☒ Off-Lease Storage and Measurement (Only if not Surface Commingled)

LEASE TYPE: ☐ Fee ☒ State ☒ Federal

Is this an Amendment to existing Order? ☐ Yes ☒ No If "Yes", please include the appropriate Order No. _____
Have the Bureau of Land Management (BLM) and State Land office (SLO) been notified in writing of the proposed commingling
☒ Yes ☐ No

(A) POOL COMMINGLING
Please attach sheets with the following information

(1) Pool Names and Codes	Gravities / BTU of Non-Commingled Production	Calculated Gravities / BTU of Commingled Production		Calculated Value of Commingled Production	Volumes

- (2) Are any wells producing at top allowables? ☐ Yes ☐ No
(3) Has all interest owners been notified by certified mail of the proposed commingling? ☐ Yes ☐ No.
(4) Measurement type: ☐ Metering ☐ Other (Specify)
(5) Will commingling decrease the value of production? ☐ Yes ☐ No If "yes", describe why commingling should be approved

(B) LEASE COMMINGLING
Please attach sheets with the following information

- (1) Pool Name and Code.
(2) Is all production from same source of supply? ☐ Yes ☐ No
(3) Has all interest owners been notified by certified mail of the proposed commingling? ☐ Yes ☐ No
(4) Measurement type: ☐ Metering ☐ Other (Specify)

(C) POOL and LEASE COMMINGLING
Please attach sheets with the following information

- (1) Complete Sections A and E.

(D) OFF-LEASE STORAGE and MEASUREMENT
Please attached sheets with the following information

- (1) Is all production from same source of supply? ☒ Yes ☐ No
(2) Include proof of notice to all interest owners.

(E) ADDITIONAL INFORMATION (for all application types)
Please attach sheets with the following information

- (1) A schematic diagram of facility, including legal location.
(2) A plat with lease boundaries showing all well and facility locations. Include lease numbers if Federal or State lands are involved.
(3) Lease Names, Lease and Well Numbers, and API Numbers.

I hereby certify that the information above is true and complete to the best of my knowledge and belief.

SIGNATURE: Sarah Chapman TITLE: REGULATORY DIRECTOR DATE: 05/20/2024
TYPE OR PRINT NAME SARAH CHAPMAN TELEPHONE NO.: 832-930-8613
E-MAIL ADDRESS: SCHAPMAN@SPURENERGY.COM

Office
 District I – (575) 393-6161
 1625 N. French Dr., Hobbs, NM 88240
 District II – (575) 748-1283
 811 S. First St., Artesia, NM 88210
 District III – (505) 334-6178
 1000 Rio Brazos Rd., Aztec, NM 87410
 District IV – (505) 476-3460
 1220 S. St. Francis Dr., Santa Fe, NM
 87505

State of New Mexico
 Energy, Minerals and Natural Resources

Form C-103
 Revised July 18, 2013

OIL CONSERVATION DIVISION
 1220 South St. Francis Dr.
 Santa Fe, NM 87505

SUNDRY NOTICES AND REPORTS ON WELLS (DO NOT USE THIS FORM FOR PROPOSALS TO DRILL OR TO DEEPEN OR PLUG BACK TO A DIFFERENT RESERVOIR. USE "APPLICATION FOR PERMIT" (FORM C-101) FOR SUCH PROPOSALS.)		WELL API NO. 30-015-49245
1. Type of Well: Oil Well <input checked="" type="checkbox"/> Gas Well <input type="checkbox"/> Other <input type="checkbox"/>		5. Indicate Type of Lease STATE <input type="checkbox"/> FEE <input type="checkbox"/>
2. Name of Operator SPUR ENERGY PARTNERS LLC		6. State Oil & Gas Lease No.
3. Address of Operator 9655 KATY FREEWAY, SUITE 500, HOUSTON, TX 77024		7. Lease Name or Unit Agreement Name WELCH B 28 FEDERAL
4. Well Location Unit Letter E : 1735 feet from the NORTH line and 809 feet from the WEST line Section 27 Township 17S Range 28E NMPM EDDY County		8. Well Number 10H
11. Elevation (Show whether DR, RKB, RT, GR, etc.) 3659' GR		9. OGRID Number 328947
		10. Pool name or Wildcat ARTESIA; GLORIETA-YESO (O)

12. Check Appropriate Box to Indicate Nature of Notice, Report or Other Data

NOTICE OF INTENTION TO:	SUBSEQUENT REPORT OF:
PERFORM REMEDIAL WORK <input type="checkbox"/>	REMEDIAL WORK <input type="checkbox"/>
TEMPORARILY ABANDON <input type="checkbox"/>	ALTERING CASING <input type="checkbox"/>
PULL OR ALTER CASING <input type="checkbox"/>	COMMENCE DRILLING OPNS. <input type="checkbox"/>
DOWNHOLE COMMINGLE <input type="checkbox"/>	P AND A <input type="checkbox"/>
CLOSED-LOOP SYSTEM <input type="checkbox"/>	CASING/CEMENT JOB <input type="checkbox"/>
OTHER: OFFLEASE MEASUREMENT <input checked="" type="checkbox"/>	OTHER: <input type="checkbox"/>

13. Describe proposed or completed operations. (Clearly state all pertinent details, and give pertinent dates, including estimated date of starting any proposed work). SEE RULE 19.15.7.14 NMAC. For Multiple Completions: Attach wellbore diagram of proposed completion or recompletion.

Spur Energy Partners LLC respectfully requests approval for Offlease Oil and Gas Measurement for the Welch B 28 Federal Lse# NMNM048344 as defined by 43 CFR 3173.22. It is proposed that the production facilities supporting three (3) remote wells associated with the Welch B 28 Federal Lse# NMNM048344 be co-located at the Welch A 28 State Facility on the Welch A 28 State Lse Prop# 329863 CA# NMNM133058. [SEE ATTACHED DETAILS]

WELCH B 28 FEDERAL 10H - 30-015-49245
 WELCH B 28 FEDERAL 50H - 30-015-49235
 WELCH B 28 FEDERAL 70H (PREVIOUSLY WELCH B 28 FEDERAL 90H) - 30-015-49237

Spud Date:

Rig Release Date:

I hereby certify that the information above is true and complete to the best of my knowledge and belief.

SIGNATURE Sarah Chapman TITLE REGULATORY DIRECTOR DATE 05/16/2024

Type or print name SARAH CHAPMAN E-mail address: SCHAPMAN@SPURENERGY.COM PHONE: 832-930-8613

For State Use Only

APPROVED BY: _____ TITLE _____ DATE _____

Conditions of Approval (if any):

Well Name	Well Number	US Well Number	Lease Number	Case Number	Operator
WELCH B 28	70H	3001549237	NMNM048344	NMNM048344	SPUR ENERGY
WELCH B 28	10H	3001549245	NMNM048344	NMNM048344	SPUR ENERGY
WELCH B 28	50H	3001549235	NMNM048344	NMNM048344	SPUR ENERGY

Notice of Intent

Sundry ID: 2789217

Type of Submission: Notice of Intent

Date Sundry Submitted: 05/08/2024

Date proposed operation will begin: 05/08/2024

Type of Action: Off-lease Measurement/Storage

Time Sundry Submitted: 05:04

Procedure Description: Spur Energy Partners, LLC respectfully requests approval for Offlease Oil and Gas Measurement for the Welch B 28 Federal Lse# NMNM048344 as defined by 43 CFR 3173.22. It is proposed that the production facilities supporting three (3) remote wells associated with the Welch B 28 Federal Lse# NMNM048344 be co-located at the Welch A 28 State Facility on the Welch A 28 State Lse Prop# 329863 CA# NMNM133058. [SEE ATTACHED DETAILS]

Surface Disturbance

Is any additional surface disturbance proposed?: No

NOI Attachments

Procedure Description

Offlease_Meas_Request_Welch_B_28_Fed_01_BLM_SUBMITTAL_20240508170331.pdf

Operator

I certify that the foregoing is true and correct. Title 18 U.S.C. Section 1001 and Title 43 U.S.C. Section 1212, make it a crime for any person knowingly and willfully to make to any department or agency of the United States any false, fictitious or fraudulent statements or representations as to any matter within its jurisdiction. Electronic submission of Sundry Notices through this system satisfies regulations requiring a

Operator Electronic Signature: DAVID HARSELL

Signed on: MAY 08, 2024 05:04 PM

Name: SPUR ENERGY PARTNERS LLC

Title: Principal Engineer

Street Address: 3706 KELLYS FALLS LANE

City: KATY**State:** TX

Phone: (713) 416-3651

Email address: DART.CONSULTING@YAHOO.COM

Field

Representative Name:

Street Address:

City:**State:****Zip:**

Phone:

Email address:

BLM Point of Contact

BLM POC Name: JONATHON W SHEPARD

BLM POC Title: Petroleum Engineer

BLM POC Phone: 5752345972

BLM POC Email Address: jshepard@blm.gov

Disposition: Approved

Disposition Date: 05/09/2024

Signature: Jonathon Shepard

Form 3160-5
(June 2019)

UNITED STATES
DEPARTMENT OF THE INTERIOR
BUREAU OF LAND MANAGEMENT

FORM APPROVED
OMB No. 1004-0137
Expires: October 31, 2021

SUNDRY NOTICES AND REPORTS ON WELLS
Do not use this form for proposals to drill or to re-enter an abandoned well. Use Form 3160-3 (APD) for such proposals.

5. Lease Serial No.	
6. If Indian, Allottee or Tribe Name	
7. If Unit of CA/Agreement, Name and/or No.	
8. Well Name and No.	
9. API Well No.	
10. Field and Pool or Exploratory Area	
11. Country or Parish, State	

12. CHECK THE APPROPRIATE BOX(ES) TO INDICATE NATURE OF NOTICE, REPORT OR OTHER DATA

TYPE OF SUBMISSION	TYPE OF ACTION				
<input type="checkbox"/> Notice of Intent	<input type="checkbox"/> Acidize	<input type="checkbox"/> Deepen	<input type="checkbox"/> Production (Start/Resume)	<input type="checkbox"/> Water Shut-Off	
<input type="checkbox"/> Subsequent Report	<input type="checkbox"/> Alter Casing	<input type="checkbox"/> Hydraulic Fracturing	<input type="checkbox"/> Reclamation	<input type="checkbox"/> Well Integrity	
<input type="checkbox"/> Final Abandonment Notice	<input type="checkbox"/> Casing Repair	<input type="checkbox"/> New Construction	<input type="checkbox"/> Recomplete	<input type="checkbox"/> Other	
	<input type="checkbox"/> Change Plans	<input type="checkbox"/> Plug and Abandon	<input type="checkbox"/> Temporarily Abandon		
	<input type="checkbox"/> Convert to Injection	<input type="checkbox"/> Plug Back	<input type="checkbox"/> Water Disposal		

13. Describe Proposed or Completed Operation: Clearly state all pertinent details, including estimated starting date of any proposed work and approximate duration thereof. If the proposal is to deepen directionally or recompleat horizontally, give subsurface locations and measured and true vertical depths of all pertinent markers and zones. Attach the Bond under which the work will be perfonned or provide the Bond No. on file with BLM/BIA. Required subsequent reports must be filed within 30 days following completion of the involved operations. If the operation results in a multiple completion or recompleat in a new interval, a Form 3160-4 must be filed once testing has been completed. Final Abandonment Notices must be filed only after all requirements, including reclamation, have been completed and the operator has detennined that the site is ready for final inspection.)

14. I hereby certify that the foregoing is true and correct. Name (Printed/Typed)	Title
Signature	Date

THE SPACE FOR FEDERAL OR STATE OFFICE USE

Approved by	Title	Date
Conditions of approval, if any, are attached. Approval of this notice does not warrant or certify that the applicant holds legal or equitable title to those rights in the subject lease which would entitle the applicant to conduct operations thereon.	Office	

Title 18 U.S.C Section 1001 and Title 43 U.S.C Section 1212, make it a crime for any person knowingly and willfully to make to any department or agency of the United States any false, fictitious or fraudulent statements or representations as to any matter within its jurisdiction.

(Instructions on page 2)

GENERAL INSTRUCTIONS

This form is designed for submitting proposals to perform certain well operations and reports of such operations when completed as indicated on Federal and Indian lands pursuant to applicable Federal law and regulations. Any necessary special instructions concerning the use of this form and the number of copies to be submitted, particularly with regard to local area or regional procedures and practices, are either shown below, will be issued by or may be obtained from the local Federal office.

SPECIFIC INSTRUCTIONS

Item 4 - Locations on Federal or Indian land should be described in accordance with Federal requirements. Consult the local Federal office for specific instructions.

Item 13: Proposals to abandon a well and subsequent reports of abandonment should include such special information as is required by the local Federal office. In addition, such proposals and reports should include reasons for the abandonment; data on any former or present productive zones or other zones with present significant fluid contents not sealed off by cement or otherwise; depths (top and bottom) and method of placement of cement plugs; mud or other material placed below, between and above plugs; amount, size, method of parting of any casing, liner or tubing pulled and the depth to the top of any tubing left in the hole; method of closing top of well and date well site conditioned for final inspection looking for approval of the abandonment. If the proposal will involve **hydraulic fracturing operations**, you must comply with 43 CFR 3162.3-3, including providing information about the protection of usable water. Operators should provide the best available information about all formations containing water and their depths. This information could include data and interpretation of resistivity logs run on nearby wells. Information may also be obtained from state or tribal regulatory agencies and from local BLM offices.

NOTICES

The privacy Act of 1974 and the regulation in 43 CFR 2.48(d) provide that you be furnished the following information in connection with information required by this application.

AUTHORITY: 30 U.S.C. 181 et seq., 351 et seq., 25 U.S.C. 396; 43 CFR 3160.

PRINCIPAL PURPOSE: The information is used to: (1) Evaluate, when appropriate, approve applications, and report completion of subsequent well operations, on a Federal or Indian lease; and (2) document for administrative use, information for the management, disposal and use of National Resource lands and resources, such as: (a) evaluating the equipment and procedures to be used during a proposed subsequent well operation and reviewing the completed well operations for compliance with the approved plan; (b) requesting and granting approval to perform those actions covered by 43 CFR 3162.3-2, 3162.3-3, and 3162.3-4; (c) reporting the beginning or resumption of production, as required by 43 CFR 3162.4-1(c) and (d) analyzing future applications to drill or modify operations in light of data obtained and methods used.

ROUTINE USES: Information from the record and/or the record will be transferred to appropriate Federal, State, local or foreign agencies, when relevant to civil, criminal or regulatory investigations or prosecutions in connection with congressional inquiries or to consumer reporting agencies to facilitate collection of debts owed the Government.

EFFECT OF NOT PROVIDING THE INFORMATION: Filing of this notice and report and disclosure of the information is mandatory for those subsequent well operations specified in 43 CFR 3162.3-2, 3162.3-3, 3162.3-4.

The Paperwork Reduction Act of 1995 requires us to inform you that:

The BLM collects this information to evaluate proposed and/or completed subsequent well operations on Federal or Indian oil and gas leases.

Response to this request is mandatory.

The BLM would like you to know that you do not have to respond to this or any other Federal agency-sponsored information collection unless it displays a currently valid OMB control number.

BURDEN HOURS STATEMENT: Public reporting burden for this form is estimated to average 8 hours per response, including the time for reviewing instructions, gathering and maintaining data, and completing and reviewing the form. Direct comments regarding the burden estimate or any other aspect of this form to U.S. Department of the Interior, Bureau of Land Management (1004-0137), Bureau Information Collection Clearance Officer (WO-630), 1849 C St., N.W., Mail Stop 401 LS, Washington, D.C. 20240

Additional Information

Batch Well Data

WELCH B 28 FEDERAL 10H, US Well Number: 3001549245, Case Number: NMNM048344, Lease Number: NMNM048344,
Operator:SPUR ENERGY PARTNERS LLC

WELCH B 28 FEDERAL 50H, US Well Number: 3001549235, Case Number: NMNM048344, Lease Number: NMNM048344,
Operator:SPUR ENERGY PARTNERS LLC

WELCH B 28 FEDERAL 70H, US Well Number: 3001549237, Case Number: NMNM048344, Lease Number: NMNM048344,
Operator:SPUR ENERGY PARTNERS LLC

APPLICATION FOR OFFLEASE OIL AND GAS MEASUREMENT AT A CO-LOCATED PRODUCTION FACILITY

Spur Energy Partners, LLC respectfully requests approval for Offlease Oil and Gas Measurement for the Welch B 28 Federal Lse# NMNM048344 as defined by 43 CFR 3173.22. It is proposed that the production facilities supporting three (3) remote wells associated with the Welch B 28 Federal Lse# NMNM048344 be co-located at the Welch A 28 State Facility on the Welch A 28 State Lse Prop# 329863 CA# NMNM133058.

Spur Energy's request for Offlease Oil and Gas Measurement for the Welch B 28 Federal Lse# NMNM048344 will involve co-locating the production equipment supporting the three (3) wells producing from a remote wellpad site over to the Welch A 28 State Facility. The Welch A 28 State Facility currently has three (3) active wells producing from the Welch A 28 State Lse Prop# 329863 CA# NMNM133058. The hydrocarbon production, sales, and measurement from the Welch B 28 Federal Lease wells will not be commingled and will be kept separate and distinct from the Welch A 28 State production. Both the OIL FMP and GAS FMP will distinctly only measure production from the Welch B 28 Federal Lse# NMNM048344. [\[43 CFR 3173.22\(b\)\]](#)

Table 1 – Lease and Well Info provides a list of the three (3) wells located on the remote wellpad associated with Federal Lse# NMNM048344. [\[43 CFR 3173.22\(a\)\]](#)

Table 1 – LEASE AND WELL INFO			
WELCH B 28 REMOTE WELLPAD			
FEDERAL LEASE# NMNM048344			
Well	API	Location	Pool
Welch B 28 Federal 10H	3001549245	SWNW-27-17S-28E	[96830] ARTESIA; GLORIETA-YESO(O)
Welch B 28 Federal 50H	3001549235	SWNW-27-17S-28E	[96830] ARTESIA; GLORIETA-YESO(O)
Welch B 28 Federal 70H	3001549237	SWNW-27-17S-28E	[96830] ARTESIA; GLORIETA-YESO(O)

Spur Energy believes accurate production accountability will be maintained as the hydrocarbon production, sales, and measurement from the Welch B 28 Federal Lease wells will not be commingled and will be kept separate and distinct from the Welch A 28 State production. Both the OIL FMP and GAS FMP will distinctly only measure production from the Welch B 28 Federal Lse# NMNM048344. [\[43 CFR 3173.22\(b\)\]](#)

As noted above, the offlease oil and gas measurement will occur through approved OIL and GAS FMPs. The oil sold through a dedicated oil Coriolis meter will be considered the OIL FMP sales point. The dedicated Coriolis oil sales meter will be operated, maintained, and calibrated by Spur Energy designated personnel per API guidelines and BLM FMP standards. After the oil is measured through the Coriolis OIL FMP, the oil will be commingled with the Welch A 28 State oil production, stored in onsite tanks, and sold through a LACT into a truck. The Welch B 28 Federal oil production and sales will be based solely on the Coriolis OIL FMP volume. The gas sold through a dedicated gas sales meter will be considered the GAS FMP sales point. The dedicated gas sales meter will be operated, maintained, and calibrated by Spur Energy designated personnel per API guidelines and BLM FMP standards. After the gas is measured through the GAS FMP, the gas will be commingled with the Welch A 28 State gas production and sold into the Durango gas pipeline system. The Welch B 28 Federal gas production and sales will be based solely on the GAS FMP volume. [\[43 CFR 3173.22\(b\)\]](#)

Spur Energy Partners, LLC believes it is in the public's best interest from an economic perspective to maximize the ultimate economic recovery from Federal Lse# NMNM048344 by allowing the oil and gas sales points from the three (3) remote wells to be co-located offlease to minimize the capital investment and enhance the economic development of additional wells and increased hydrocarbon production. Locating the Welch B 28 Federal production equipment at the Welch A 28 State Facility allows access to existing hydrocarbon sales points, electrical power, and shared produced water disposal infrastructure. The capital investment to install an additional production facility dedicated to these three (3) remote wells is in excess of \$2.0MM; whereas the use of the offlease facility requires only a \$0.5MM investment, thus enhancing the ultimate economic viability of this lease for future continued development and expanded production. [\[43 CFR 3173.22\(c\) and 3173.23\(b\)\]](#)

The attached Federal Lease Plat shows the boundaries of Welch B 28 Federal Lse# NMNM048344 and Welch A 28 State Lse Prop# 329863 CA# NMNM133058. The plat will also show the location of the Welch A 28 State Facility, the location and API# of the three (3) onsite wells, as well as the location and API# of the remote well pad for the three (3) remote Welch B 28 Federal wells. Offlease Oil and Gas Measurement is being requested for the hydrocarbons being sold from the three (3) wells producing from a remote wellpad site associated with the Welch B 28 Federal Lse# NMNM048344. [\[43 CFR 3173.23\(c\)\(1-2\)\]](#)

The Welch A 28 State Facility is located in the NWNW, SEC 27, T17S, R28E on State Lease Prop# 329863 CA# NMNM133058. The remote wellpad site containing the three (3) remote wells on the Welch B 28 Federal Lse# NMNM048344 is located in the SWNW, SEC 27, T17S, R28E. The surface location of the facility, the remote wellpad site, and the land associated with the flowlines from the wells to the facility are completely on State of New Mexico land managed by the New Mexico State Land Office. The BLM has an existing agreement with the State of New Mexico granting BLM personnel unrestricted access to the off-lease measurement facility and the surface on which it is located. [\[43 CFR 3173.23\(d\)\(e\)\(h\)\]](#)

The location of the Welch A 28 State Facility and the Welch B 28 Federal remote well pad is not located on a pipeline. No new surface disturbance is being proposed to lay the flowlines from the remote wellpad site to the facility. Spur Energy will obtain any additional required Federal ROW grants associated with these flowlines if required. [\[43 CFR 3173.23\(f\)\]](#)

The location of the Welch A 28 State Facility and the Welch B 28 Federal remote well pad is not on Indian land or associated with any BIA office. [\[43 CFR 3173.23\(g\)\]](#)

Spur Energy believes this request meets the requirements of CFR 3178.6(a) as no oil or gas will be added or removed from the production stream as it is moved from the remote wellpad site to the Welch A 28 State Facility. [\[43 CFR 3173.23\(i\)\]](#)

The request to perform Offlease Measurement includes the oil, gas, and water production from the three (3) remote wells from the Welch B 28 Federal Lse# NMNM048344 with oil and gas hydrocarbon production and sales being measured through the OIL FMP and GAS FMP located at the Welch A 28 State Facility. [\[43 CFR 3173.23\(j\)\]](#)

ATTACHMENTS

Federal Lease Plat

Shows the location of the Welch B 28 Federal Lse# NMNM048344, the remote well pad site containing three (3) wells and their associated flowlines, and the Welch A 28 State Facility with the boundaries of the Welch A 28 State CA# NMNM133058.

WELCH A and B FACILITY

Legal: NWNW, SEC 27, T17S, R28E
 Desc: 32.810980N -104.169414W
 Prop#: 329863 CA #: NMNM133058
 County: Eddy, New Mexico

Wells on Location:

Welch A 28 State 10H	API 3001547743
Welch A 28 State 20H	API 3001547741
Welch A 28 State 50H	API 3001547783

Co-Located Facilities on Location:

WELCH B 28 FED FACILITY

Legal: NWNW, SEC 28, T17S, R28E
Desc: 32.810980N -104.169414W
Lease #: NMNM048344

Remote Wells Accessing Location:

Welch B 28 Federal 10H API 3001549245
Welch B 28 Federal 50H API 3001549235
Welch B 28 Federal 70H API 3001549237

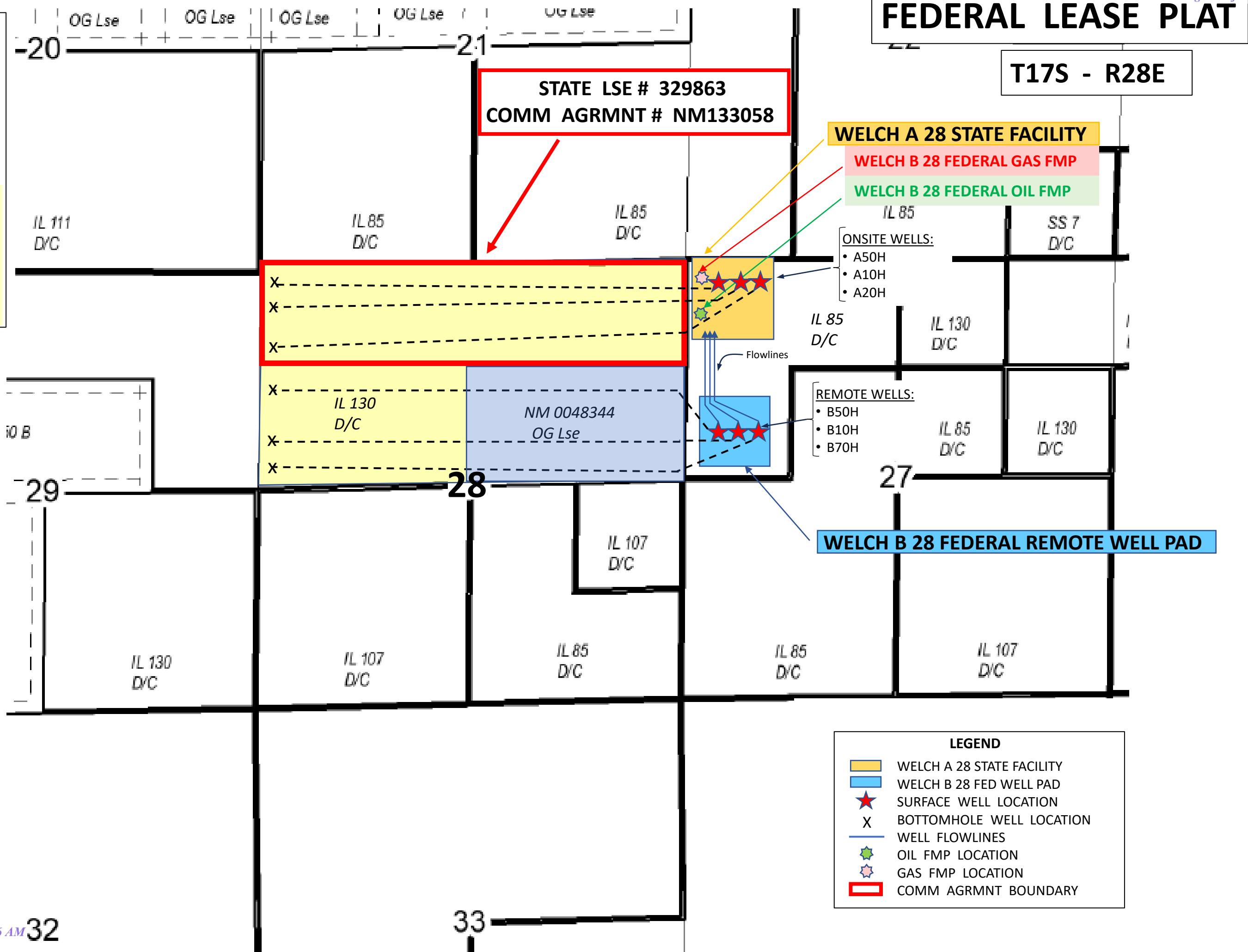

DART Consulting

DART.Consulting@yahoo.com
Spring, TX 713-416-3651

**COMMISSIONER**

Stephanie Garcia Richard

**State of New Mexico
Commissioner of Public Lands**310 OLD SANTA FE TRAIL
P.O. BOX 1148
SANTA FE, NEW MEXICO 87504-1148**COMMISSIONER'S OFFICE**

Phone (505) 827-5760

Fax (505) 827-5766

www.nmstatelands.org

Drew Oldis
Spur Energy Partners
9655 Katy FWY STE 500
Houston, TX 77024-1385November 30th, 2021Re: Communitization Agreement Approval
Welch A 28 State Com #050H
Vertical Extent: Artesia, Glorieta-Yeso
Township: 17 South, Range 28 East, NMPM
Section 28: N2N2
Eddy County, New Mexico

Dear Mr. Oldis,

The Commissioner of Public Lands has this date approved the Welch A 28 State Com #050H Communitization Agreement for the Artesia, Glorieta-Yeso formation effective 2-1-2021. Enclosed are three Certificates of Approval.

The agreement shall remain in effect for One Year, and as long thereafter as communitized substances are produced from the communitized area in paying quantities.

Approval of this agreement does not warrant or certify that the operator and/or other working interest owners hold legal or equitable title to the leases which are committed hereto, nor does the Commissioner's approval constitute adjudication of any federal or private interests, or warrant or certify that the information supplied by the operator regarding federal or private interests is accurate.

If we may be of further service, please contact Baylen Lamkin at (505) 827-6628.

Sincerely,

A handwritten signature in black ink that reads "Stephanie Garcia Richard/S".

Stephanie Garcia Richard
Commissioner of Public Lands

NEW MEXICO STATE LAND OFFICE**CERTIFICATE OF APPROVAL****COMMISSIONER OF PUBLIC LANDS, STATE OF NEW MEXICO**

**Spur Energy Partners LLC
Welch A 28 State Com #050H
Artesia, Glorieta-Yeso
Township: 17 South, Range: 28 East, NMPM
Section 28: N2N2**

Eddy County, New Mexico

There having been presented to the undersigned Commissioner of Public Lands of the State of New Mexico for examination, a Consolidation Agreement for the development and operation of acreage which is described within the referenced Agreement dated **February 1, 2021**, which has been executed, or is to be executed by parties owning and holding oil and gas leases and royalty interests in and under the property described, and upon examination of said Agreement, the Commissioner finds:

- (a) That such agreement will tend to promote the conservation of oil and gas and the better utilization of reservoir energy in said area.
- (b) That under the proposed agreement, the State of New Mexico will receive its fair share of the recoverable oil or gas in place under its lands in the area.
- (c) That each beneficiary Institution of the State of New Mexico will receive its fair and equitable share of the recoverable oil and gas under its lands within the area.
- (d) That such agreement is in other respects for the best interests of the State, with respect to state lands.

NOW, THEREFORE, by virtue of the authority conferred upon me under Sections 19-10-45, 19-10-46, 19-10-47, New Mexico Statutes Annotated, 1978 Compilation, I, the undersigned Commissioner of Public Lands of the State of New Mexico, for the purpose of more properly conserving the oil and gas resources of the State, do hereby consent to and approve the said Agreement, and any leases embracing lands of the State of New Mexico within the area shall be and the same are hereby amended to conform with the terms thereof, and shall remain in full force and effect according to the terms and conditions of said Agreement. This approval is subject to all of the provisions of the aforesaid statutes.

IN WITNESS WHEREOF, this Certificate of Approval is executed, with seal affixed, this 30th day of November, 2021.

Stephane Garcia Rickard/Sj
COMMISSIONER OF PUBLIC LANDS
of the State of New Mexico

**NM State Land Office
Oil, Gas, & Minerals Division**

**STATE/STATE OR
STATE/FEE**

Revised March 2017

COMMUNITIZATION AGREEMENT

ONLINE Version

KNOW ALL MEN BY THESE PRESENTS:

Well Name: **WELCH A 28 STATE COM 50H**

STATE OF NEW MEXICO)
SS)

API #: 30 - **01** - **47783**

COUNTY OF **EDDY**)

THAT THIS AGREEMENT [which is NOT to be used for carbon dioxide or helium] is entered into as of **February 1**, 20 **21**, by and between the parties subscribing, ratifying or consenting hereto, such parties hereinafter being referred to as "Parties hereto";

WHEREAS, the Commissioner of Public Lands of the State of New Mexico is authorized by the Legislature, as set forth in Sec. 19-10-53, New Mexico Statutes, Annotated, 1978, in the interest of conservation of oil & gas and the prevention of waste to consent to and approve the development or operation of State Trust Lands under agreements made by lessees of oil & gas leases thereon, jointly or severally with other oil & gas lessees of State Trust Lands, or oil and gas lessees or mineral owners of privately owned or fee lands, for the purpose of pooling or communitizing such lands to form a proration unit or portion thereof, or well-spacing unit, pursuant to any order, rule or regulation of the New Mexico Oil Conservation Division of the New Mexico Energy, Minerals and Natural Resources Department where such agreement provides for the allocation of the production of oil or gas from such pools or communitized areas on an acreage or other basis found by the Commissioner of Public Lands to be fair and equitable.

WHEREAS, the parties hereto, own working, royalty, or other leasehold interests or operating rights under the oil and gas leases and lands subject to this agreement, which leases are more particularly described in the schedule attached hereto, marked Exhibit "A" and made a part hereof, for all purposes; and

WHEREAS, said leases, insofar as they cover the **Artesia, Glorieta-Yeso** formation or pool as defined by the NMOCD, as further described on Exhibit "A" (hereinafter referred to as "said formation") in and under the land hereinafter described cannot be independently developed and operated in conformity with the well spacing program established for such formation in and under said lands; and

WHEREAS, the parties hereto desire to communitize and pool their respective interests in said leases subject to this agreement for the purpose of developing, operating and producing hydrocarbons in the said formation in and under the land hereinafter described subject to the terms hereof.

ONLINE version
March, 2017

State/State
State/Fee

2022 AUG 10 AM 8:14

1

NOW THEREFORE, in consideration of the premises and the mutual advantages to the parties hereto, it is mutually covenanted and agreed by and between the undersigned as follows:

1. The lands covered by this agreement (hereinafter referred to as the "communitized area") are described as follows:

Subdivisions **North Half of the North Half (N/2 of N/2)**

Of Sect(s) **28** Twnshp **17S** Rng **28E** NMPM **Eddy** County, NM

containing **160** acres, more or less. It is the judgment of the parties hereto that the communitization, pooling and consolidation of the aforesaid land into a single unit for the development and production of hydrocarbons from the said formation in and under said land is necessary and advisable in order to properly develop and produce the hydrocarbons in the said formation beneath the said land in accordance with the well spacing rules of the Oil Conservation Division of the New Mexico Energy, Minerals and Natural Resources Department, and in order to promote the conservation of the hydrocarbons in and that may be produced from said formation in and under said lands, and would be in the public interest;

AND, for the purposes aforesaid, the parties hereto do hereby communitize for proration or spacing purposes only the leases and/or depths described in Exhibit "A" hereto insofar as they cover hydrocarbons within and that may be produced from the said formation (hereinafter referred to as "communitized substances") beneath the above-described land, into a single communitization, for the development, production, operation and conservation of the hydrocarbons in said formation beneath said lands.

Attached hereto and made a part of this agreement for all purposes, is Exhibit A showing the acreage, depths communitized and ownership (Lessees of Record) of all leases within the communitized area.

2. The communitized area shall be developed and operated as an entirety with the understanding and agreement between the parties hereto that all communitized substances produced therefrom shall be allocated among the leases described in Exhibit "A" hereto in the proportion that the number of surface acres covered by each of such leases and included within the communitized area bears to the total number of acres contained in the communitized area.

3. Subject to Paragraph 4, the royalties payable on communitized substances allocated to the individual leases and the rentals provided for in said leases shall be determined and paid in the manner and on the basis prescribed in each of said leases. Except as provided for under the terms and provisions of the leases described in Exhibit "A" hereto or as herein provided to the contrary, the payment of rentals under the terms of said leases shall not be affected by this agreement; and except as herein modified and changed or heretofore amended, the oil and gas leases subject to this agreement shall remain in full force and effect as originally issued and amended.

ONLINE version

State/State

March, 2017

State/Fee

2021 AUG 10 AM 8:14

4. **Spur Energy Partners LLC** shall be the Operator of the said communitized area and all matters of operation shall be determined and performed by **Spur Energy Partners LLC**.

5. The State of New Mexico hereafter is entitled to the right to take in kind its share for the communitized substances allocated to such tract, and Operator shall make deliveries of such royalty share taken in kind in conformity with applicable contracts, laws, and regulations.

6. There shall be no obligation upon the parties hereto to offset any well or wells situated on the tracts of land comprising the communitized area, nor shall the Operator be required to measure separately the communitized substances by reason of the diverse ownership of the separate tracts of land comprising the said communitized area; provided, however, that the parties hereto shall not be released from their obligation to protect the communitized area from drainage of communitized substances by wells which may be drilled within offset distance (as that term is defined) of the communitized area.

7. The commencement, completion, and continued operation or production of a well or wells of communitized substances on the communitized area shall be considered as the commencement, completion, continued operation or production as to each of the leases described in Exhibit "A" hereto.

8. The production of communitized substances and disposal thereof shall be in conformity with the allocations, allotments, and quotas made or fixed by any duly authorized person or regulatory body under applicable Federal or State laws. This agreement shall be subject to all applicable Federal and State laws, executive orders, rules and regulations affecting the performance of the provisions hereof, and no party hereto shall suffer a forfeiture or be liable in damages for failure to comply with any of the provisions of this agreement if compliance is prevented by or if such failure results from compliance with any such laws, orders, rules and regulations.

9. This agreement shall be effective as of the date hereinabove written upon execution by the necessary parties, notwithstanding the date of execution, and upon approval by the Commissioner of Public Lands, shall remain in full force and effect for a period of one year from the date hereof and as long thereafter as communitized substances are produced from the communitized area in paying quantities; provided, that this agreement shall not expire if there is a well capable of producing gas in paying quantities located upon some part of the communitized area, if such a well is shut-in due to the inability of the Operator to obtain a pipeline connection or to market the gas therefrom, and if either: (a) a shut-in royalty has been timely and properly paid pursuant to the provisions of one of the State of New Mexico oil and gas leases covering lands subject to this agreement so as to prevent the expiration of such lease; or (b) each of the State of New Mexico oil and gas leases covering lands subject to this agreement is in its primary term (if a five-year lease), or in its primary or secondary term (if a ten-year lease), or is held by production from another well. Provided further, however, that prior to production in paying quantities from the communitized area, and upon fulfillment of all requirements of the Commissioner of Public Lands with respect to any dry hole or abandoned well drilled upon the communitized area, this agreement may be

ONLINE version
March, 2017

State/State
State/Fee

2021 AUG 40 AM 8:14

terminated at any time by mutual agreement of the parties hereto. This agreement shall not terminate upon cessation of production of communitized substances if, within sixty (60) days thereafter, reworking or drilling operations on the communitized area are commenced and are thereafter conducted with reasonable diligence. As to State Trust Lands, written notice of intention to commence such operations shall be filed with the Commissioner of Public Lands within thirty (30) days after the cessation of such production, and a report of the status of such operations shall be made by the Operator to the Commissioner every thirty (30) days, and the cessation of such operations for more than twenty (20) consecutive days shall be considered as an abandonment of such operations as to any lease from the State of New Mexico included in this agreement.

10. Operator will furnish the Oil Conservation Division of the New Mexico Energy, Minerals and Natural Resources Department, and the Commissioner of Public Lands of the State of New Mexico, with any and all reports, statements, notices and well logs and records which may be required under the laws and regulations of the State of New Mexico.

11. It is agreed between the parties hereto that the Commissioner of Public Lands, or his duly authorized representatives, shall have the right of supervision over all operations under the communitized area to the same extent and degree as provided in the oil and gas leases described in Exhibit "A" hereto and in the applicable oil and gas regulations of the State of New Mexico.

12. If any order of the Oil Conservation Division of the New Mexico Energy Minerals and Natural Resources Department, upon which this agreement is predicated or based is in anyway changed or modified, then in such event said agreement is likewise modified to conform thereto.

13. This agreement may be executed in any number of counterparts, no one of which needs to be executed by all parties, or may be ratified or consented to by separate instruments, in writing, specifically referring hereto, and shall be binding upon all parties who have executed such a counterpart, ratification or consent hereto with the same force and effect as if all parties had signed the same document.

14. This agreement shall be binding upon the parties hereto and shall extend to and be binding upon their respective heirs, executors, administrators, successors and assigns.

IN WITNESS WHEREOF, the parties hereto have executed this agreement as of the day and year first above written.

ONLINE version
March, 2017

State/State
State/Fee

4

2021 AUG 10 AM 8:16

OPERATOR: Spur Energy Partners LLC

BY: Nash Bell - VP Land

Name and Title of Authorized Agent

Signature of Authorized Agent

nc
TD

2021 AUG 10 AM 8:14

Acknowledgment in an Individual Capacity

State of _____)
County of _____)
SS)

This instrument was acknowledged before me on _____ Date

By _____

Name(s) of Person(s)

(Seal)

Signature of Notarial Officer

My commission expires: _____

Acknowledgment in an Representative Capacity

State of **Texas**)
County of **Harris**)
SS)

This instrument was acknowledged before me on July 30, 2021 Date

By Nash Bell

Name(s) of Person(s)

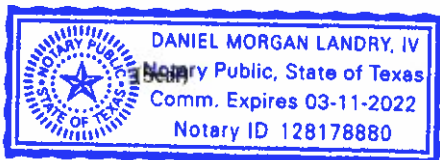

Signature of Notarial Officer

My commission expires: 03-11-2022

LEASE #: 1

LESSEE OF RECORD: Walter Granberry JR.

BY: WALTER GRANBERRY JR. OWNER

Name & Title of Authorized Agent

Walter Granberry Jr.
Signature of Authorized Agent

Acknowledgment in an Individual Capacity

State of Texas)
County of Lubbock)

This instrument was acknowledged before me on April 20th, 2021 Date

By Walter Granberry Jr.
Name(s) of Person(s)

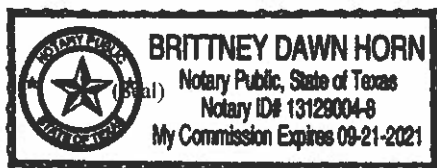

[Signature]
Signature of Notarial Officer

My commission expires: 9-21-2021

Acknowledgment in an Representative Capacity

State of)
County of)

This instrument was acknowledged before me on _____ Date

By _____
Name(s) of Person(s)

(Seal)

Signature of Notarial Officer

My commission expires: _____

2021 AUG 10 AM 8:15

7

2021 AUG 10 AM 8:14

8

2021 AUG 10 AM 8:14

Released to Imaging: 11/12/2025 11:26:46 AM

EXHIBIT AAttached to and made a part of that Communitization Agreement dated **02/01/2021**by and between **Spur Energy Partners LLC**, **Walter Granberry JR.**,**Chisos, LTD.**, and **Black Shale Minerals LLC**the Subdivisions **N/2 of N/2**,Sect **28**, Twnshp **17S**, Rnge **28E**, NMPM **Eddy** County, NMLimited in depth from 3500 ft to 5523 ft. (enter here what is granted in pooling order if applicable)OPERATOR of Communitized Area: **Spur Energy Partners LLC****DESCRIPTION OF LEASES COMMITTED:****TRACT NO. 1**Lessor: **State of New Mexico**Lessee of Record: **Walter Granberry JR.**Serial No. of Lease: **B0-1111-0009** Date of Lease: **08/10/1932**

Description of Lands Committed:

Subdivisions: **N/2 of NW/4 & NW/4 of NE/4**Sect **28** Twnshp **17S** Rng **28E** NMPM **Eddy** County NMNo. of Acres: **120****TRACT NO. 2**Lessor: **State of New Mexico**Lessee of Record: **Chisos, LTD.** and **Black Shale Minerals LLC**Serial No. of Lease: **B0-1111-⁸⁴0012** Date of Lease: **08/10/1932**

Description of Lands Committed:

Subdivisions: **NE/4 of NE/4**Sect **28** Twnshp **17S** Rng **28E** NMPM **Eddy** County NMNo. of Acres: **40**

ONLINE version

State/State

March, 2017

State/Fee

9

2021 AUG 10 AM 8:14

RECAPITULATION

Tract number	Number of Acres Committed	Percentage of Interest in Communitized Area
No. 1	120	75%
No. 2	40	25%
TOTAL	160	100%

2021 AUG 10 AM 8:14

ONLINE version
March, 2017

State/State
State/Fee

10

**DEPARTMENT OF THE INTERIOR
BUREAU OF LAND MANAGEMENT
CASE RECORDATION
(MASS) Serial Register Page**

Run Date/Time: 5/3/2023 9:12 AM

Page 1 Of 10

01 02-25-1920;041STAT0437;30USC226

Case Type 310781: O&G RENEWAL LEASE - PD

Commodity 459: OIL & GAS

Case Disposition: AUTHORIZED

Case File Juris:

Total Acres:
240.000

Serial Number

NMNM 0048344

				Serial Number: NMNM-- 0 048344		
Name & Address				Int Rel	% Interest	
XXXXXXXXXX	XXXXXXXXXX	XXXXXXXXXX	XX XXXXX-XXXX	OPERATING RIGHTS	0.000000000	
RSE PARTNERS I LP	3141 HOOD ST #350	DALLAS	TX 75219	OPERATING RIGHTS	0.000000000	
XXXXXXXXXX	XXXXXXXXXX	XXXXXXXXXX	XX XXXXX-XXXX	OPERATING RIGHTS	0.000000000	
EDGE PETROLEUM EXPL CO	1301 TRAVIS ST STE 2000	HOUSTON	TX 770027430	OPERATING RIGHTS	0.000000000	
NEARBURG EXPLORATION CO LLC	3300 N A ST # 120	MIDLAND	TX 797055421	OPERATING RIGHTS	0.000000000	
YATES ENERGY CORP	PO BOX 2323	ROSWELL	NM 882022323	OPERATING RIGHTS	0.000000000	
LONGFELLOW LH LLC	16803 DALLAS PKWY	ADDISON	TX 750015212	OPERATING RIGHTS	0.000000000	
SDX RESOURCES INC	507 N MARIENFELD	MIDLAND	TX 79705	OPERATING RIGHTS	0.000000000	
CONOCOPHILLIPS CO	600 N DAIRY ASHFORD	HOUSTON	TX 77079	OPERATING RIGHTS	0.000000000	
WPX ENERGY PERMIAN LLC	3500 ONE WILLIAMS CTR	TULSA	OK 741720135	OPERATING RIGHTS	0.000000000	
DOMINION OK TX EXPL & PROD INC	14000 QUAIL SPGS PKY #600	OKLAHOMA CITY	OK 73134	OPERATING RIGHTS	0.000000000	
CROSS BORDER RESOURCES INC	14282 GILLIS RD	FARMERS BRANCH	TX 752443715	LESSEE	0.000000000	
CROSS BORDER RESOURCES INC	14282 GILLIS RD	FARMERS BRANCH	TX 752443715	OPERATING RIGHTS	0.000000000	
ST DEVOTE LLC	919 MILAM ST STE 2475	HOUSTON	TX 770025338	OPERATING RIGHTS	0.000000000	
STATES LTD	PO BOX 911	BRECKENRIDGE	TX 764240911	LESSEE	0.000000000	
NOBLE ENERGY INC	1001 NOBLE ENERGY WAY	HOUSTON	TX 770701435	OPERATING RIGHTS	0.000000000	
APACHE CORPORATION	2000 POST OAK BLVD STE 100	HOUSTON	TX 770564400	OPERATING RIGHTS	0.000000000	
APACHE CORPORATION	2000 POST OAK BLVD STE 100	HOUSTON	TX 770564400	LESSEE	0.000000000	
SDX PROPERTIES INC	BOX 5061	MIDLAND	TX 797045061	OPERATING RIGHTS	0.000000000	
JALAPENO CORP	PO BOX 1608	ALBUQUERQUE	NM 87103	OPERATING RIGHTS	0.000000000	
801 LLC	105 S 4TH ST	ARTESIA	NM 882102177	OPERATING RIGHTS	0.000000000	
CHISOS LTD	1331 LAMAR ST STE 1077	HOUSTON	TX 770103135	LESSEE	0.000000000	
CHISOS LTD	1331 LAMAR ST STE 1077	HOUSTON	TX 770103135	OPERATING RIGHTS	0.000000000	
OVERTON ENE INVESTMENTS VI LLC	4265 SAN FELIPE ST STE 1040	HOUSTON	TX 770272929	OPERATING RIGHTS	0.000000000	
OXY USA WTP LP	6 DESTA DR #6000	MIDLAND	TX 797055505	OPERATING RIGHTS	0.000000000	
COG OPERATING LLC	600 W ILLINOIS AVE	MIDLAND	TX 797014882	OPERATING RIGHTS	0.000000000	
CONTANGO RESOURCES INC	717 TEXAS ST STE 2900	HOUSTON	TX 770022836	LESSEE	0.000000000	
GRIZZLY OPERATING LLC	5847 SAN FELIPE ST STE 3000	HOUSTON	TX 770573399	OPERATING RIGHTS	0.000000000	
ABO PETROLEUM LLC	PO BOX 900	ARTESIA	NM 882110900	OPERATING RIGHTS	0.000000000	

NO WARRANTY IS MADE BY BLM FOR USE OF THE DATA FOR PURPOSES NOT INTENDED BY BLM

**DEPARTMENT OF THE INTERIOR
BUREAU OF LAND MANAGEMENT
CASE RECORDATION
(MASS) Serial Register Page**

Run Date/Time: 5/3/2023 9:12 AM

Page 2 Of 10

						Serial Number: NMNM-- 0 048344	
Name & Address						Int Rel	% Interest
SEP PERMIAN LLC	9655 KATY FWY STE 500	HOUSTON	TX	770241338	OPERATING RIGHTS	0.000000000	
OCCIDENTAL PERMIAN LP	5 GREENWAY PLZ STE 110	HOUSTON	TX	770460521	OPERATING RIGHTS	0.000000000	

										Serial Number: NMNM-- 0 048344	
Mer	Twp	Rng	Sec	S	Type	Nr	Suff	Subdivision	District/ Field Office	County	Mgmt Agency
23	0170S	0280E	028	ALIQ				S2NE;	CARLSBAD FIELD OFFICE	EDDY	BUREAU OF LAND MGMT
23	0170S	0280E	029	ALIQ				SW;	CARLSBAD FIELD OFFICE	EDDY	BUREAU OF LAND MGMT

Relinquished/Withdrawn Lands							Serial Number: NMNM-- 0 048344			
23	0170S	0280E	721	FF	NE:SEGR		PECOS DISTRICT OFFICE	EDDY	BUREAU OF LAND MGMT	

						Serial Number: NMNM-- 0 048344	
Act Date	Act Code	Action Txt	Action Remarks			Pending Off	
04/11/1938	387	CASE ESTABLISHED					
04/12/1938	496	FUND CODE	05;145003				
04/12/1938	868	EFFECTIVE DATE					
07/15/1958	209	CASE CREATED BY SEGR	OUT OF NMLC046250B;				
12/04/1958	643	PRODUCTION DETERMINATION	/1/				
12/04/1958	650	HELD BY PROD - ACTUAL	/1/				
12/04/1958	658	MEMO OF 1ST PROD-ACTUAL	/1/#				
11/01/1961	242	LEASE RENEWED	THRU 10/31/71;				
03/16/1962	817	MERGER RECOGNIZED	GRARIDGE CORP/IBEX CO				
03/16/1962	940	NAME CHANGE RECOGNIZED	IBEX CO/GRARIDGE CORP				
04/29/1969	940	NAME CHANGE RECOGNIZED	HUSKY OIL CO/DE				
03/19/1971	940	NAME CHANGE RECOGNIZED	PAN AMER PETRO/AMOCO				
11/01/1971	242	LEASE RENEWED	THRU 10/31/81;				
03/01/1977	940	NAME CHANGE RECOGNIZED	HUSKY OIL DE/OIL				
08/10/1977	396	TRF OF INTEREST FILED	V WELCH EST/SHELTON				
10/24/1979	940	NAME CHANGE RECOGNIZED	CONTL OIL/CONOCO INC				
11/01/1981	242	LEASE RENEWED	THRU 10/31/91;				
09/10/1984	817	MERGER RECOGNIZED	HUSKY OIL/MARATHON				
09/06/1985	940	NAME CHANGE RECOGNIZED	AMER PETROFINA/FINA				
07/14/1986	140	ASGN FILED	PETRO CORP/PC LTD				
10/16/1986	139	ASGN APPROVED	EFF 08/01/86;				
10/28/1986	963	CASE MICROFILMED/SCANNED	CNUM 102,698	GLC			
08/26/1988	974	AUTOMATED RECORD VERIF	BTM/MIG				

NO WARRANTY IS MADE BY BLM FOR USE OF THE DATA FOR PURPOSES NOT INTENDED BY BLM

**DEPARTMENT OF THE INTERIOR
BUREAU OF LAND MANAGEMENT
CASE RECORDATION
(MASS) Serial Register Page**

Run Date/Time: 5/3/2023 9:12 AM

Page 3 Of 10

Serial Number: NMNM-- 0 048344

Act Date	Act Code	Action Txt	Action Remarks	Pending Off
05/15/1989	817	MERGER RECOGNIZED	DEPCO INC/DEKALB CORP	
05/15/1989	940	NAME CHANGE RECOGNIZED	DEKALB CORP/ENE CO	
11/06/1989	932	TRF OPER RGTS FILED	MARTHON OIL/AMCON RES	
12/19/1989	933	TRF OPER RGTS APPROVED	EFF 12/01/89;	
12/19/1989	974	AUTOMATED RECORD VERIF	TF/MT	
07/01/1991	314	RENEWAL APLN FILED		
08/14/1991	910	REPORT REQUESTED		
08/14/1991	974	AUTOMATED RECORD VERIF	TF/MT	
10/15/1991	932	TRF OPER RGTS FILED	INGRAM T/NEARBURG EXP	
11/01/1991	242	LEASE RENEWED	THRU 10/31/11;	
11/01/1991	530	RLTY RATE - 12 1/2%	/A/	
11/01/1991	868	EFFECTIVE DATE	LAST RENEWAL;	
11/15/1991	974	AUTOMATED RECORD VERIF	TF/MT	
12/17/1991	974	AUTOMATED RECORD VERIF	TF/MT	
04/13/1992	933	TRF OPER RGTS APPROVED	EFF 11/01/91;	
04/13/1992	974	AUTOMATED RECORD VERIF	TF/JS	
07/13/1992	974	AUTOMATED RECORD VERIF	AMR/JS	
10/21/1992	932	TRF OPER RGTS FILED	DEKALB/DREYFUS GAS	
11/09/1992	974	AUTOMATED RECORD VERIF	ANN/KRP	
12/07/1992	933	TRF OPER RGTS APPROVED	EFF 11/01/92;	
12/07/1992	974	AUTOMATED RECORD VERIF	TF/JS	
12/21/1992	932	TRF OPER RGTS FILED	CONOCO/PERRY	
01/21/1993	932	TRF OPER RGTS FILED	HEYCO/YATES ENE CORP	
02/19/1993	625	RLTY REDUCTION APPV	/1/	
07/06/1993	933	TRF OPER RGTS APPROVED	EFF 01/01/93;	
07/06/1993	974	AUTOMATED RECORD VERIF	ST/JCV	
07/28/1993	933	TRF OPER RGTS APPROVED	EFF 02/01/93;	
07/28/1993	974	AUTOMATED RECORD VERIF	TF/MV	
11/05/1993	974	AUTOMATED RECORD VERIF	LR	
08/15/1996	817	MERGER RECOGNIZED	DREYFUS/BOGERT	
08/15/1996	940	NAME CHANGE RECOGNIZED	BOGERT/DREYFUS	
10/23/1996	932	TRF OPER RGTS FILED	CONOCO/C WILLIAMS ENE	
10/31/1996	932	TRF OPER RGTS FILED	NEARBURG/NEARBURG	
12/13/1996	933	TRF OPER RGTS APPROVED	(1)EFF 11/01/96;	
12/13/1996	933	TRF OPER RGTS APPROVED	(2)EFF 11/01/96;	
12/13/1996	974	AUTOMATED RECORD VERIF	MV/MV	
12/30/1996	974	AUTOMATED RECORD VERIF	TF/TF	
02/18/1997	140	ASGN FILED	PC LTD/STATES INC	
03/07/1997	139	ASGN APPROVED	EFF 03/01/97;	

NO WARRANTY IS MADE BY BLM FOR USE OF THE DATA FOR PURPOSES NOT INTENDED BY BLM

**DEPARTMENT OF THE INTERIOR
BUREAU OF LAND MANAGEMENT
CASE RECORDATION
(MASS) Serial Register Page**

Run Date/Time: 5/3/2023 9:12 AM

Page 4 Of 10

Serial Number: NMNM-- 0 048344

Act Date	Act Code	Action Txt	Action Remarks	Pending Off
03/07/1997	974	AUTOMATED RECORD VERIF	JLV	
04/02/1997	932	TRF OPER RGTS FILED	AMOCO/ALTURA ENERGY	
04/17/1997	933	TRF OPER RGTS APPROVED	EFF 05/01/97;	
04/17/1997	974	AUTOMATED RECORD VERIF	JLV	
12/29/1998	932	TRF OPER RGTS FILED	ALTURA/RSE PARTNERS	
01/14/1999	933	TRF OPER RGTS APPROVED	EFF 01/01/99;	
01/14/1999	974	AUTOMATED RECORD VERIF	MV/MV	
01/22/1999	246	LEASE COMMITTED TO CA	NMNM103135;	
01/22/1999	658	MEMO OF 1ST PROD-ACTUAL	/2/NMNM103135;#1 PIB	
11/04/1999	643	PRODUCTION DETERMINATION	/2/	
04/03/2000	932	TRF OPER RGTS FILED	STATES/MARRS & SMITH	
05/30/2000	933	TRF OPER RGTS APPROVED	EFF 05/01/2000	
05/30/2000	974	AUTOMATED RECORD VERIF	ANN	
06/12/2000	940	NAME CHANGE RECOGNIZED	ALTURA/OCCIDENTALPER	
05/18/2001	932	TRF OPER RGTS FILED	PERRY, W WESLEY;1	
06/25/2001	932	TRF OPER RGTS FILED	NEARBURG, GRETCHEN;1	
07/05/2001	933	TRF OPER RGTS APPROVED	EFF 06/01/2001	
07/05/2001	974	AUTOMATED RECORD VERIF	ANN	
07/19/2001	933	TRF OPER RGTS APPROVED	EFF 07/01/01;	
07/19/2001	974	AUTOMATED RECORD VERIF	LR	
12/12/2001	817	MERGER RECOGNIZED	L DREYFUS/DOMINION	
01/13/2002	522	CA TERMINATED	SW-1063;	
04/15/2002	246	LEASE COMMITTED TO CA	NMNM107679;	
04/25/2002	940	NAME CHANGE RECOGNIZED	FINA/ATOFINA PETRO	
05/15/2002	658	MEMO OF 1ST PROD-ACTUAL	/3/NMNM107679;#1 SPRK	
07/05/2002	932	TRF OPER RGTS FILED	OPUBCO ENE/RICKS EXPL	
08/01/2002	643	PRODUCTION DETERMINATION	/3/	
09/05/2002	933	TRF OPER RGTS APPROVED	EFF 08/01/2002	
09/05/2002	974	AUTOMATED RECORD VERIF	ANN	
05/30/2003	940	NAME CHANGE RECOGNIZED	RICKS EXPL II/CONCHO	
08/05/2003	940	NAME CHANGE RECOGNIZED	STATES INC/LTD	
05/14/2004	932	TRF OPER RGTS FILED	MARRS&SMITH/SDX PROP	
06/22/2004	140	ASGN FILED	1	
06/22/2004	140	ASGN FILED	2	
07/13/2004	933	TRF OPER RGTS APPROVED	EFF 06/01/04;	
07/13/2004	974	AUTOMATED RECORD VERIF	MV	
08/02/2004	139	ASGN APPROVED	02EFF 07/01/04;	
08/02/2004	139	ASGN APPROVED	01EFF 07/01/04;	
08/02/2004	974	AUTOMATED RECORD VERIF	JLV	

NO WARRANTY IS MADE BY BLM FOR USE OF THE DATA FOR PURPOSES NOT INTENDED BY BLM

**DEPARTMENT OF THE INTERIOR
BUREAU OF LAND MANAGEMENT
CASE RECORDATION
(MASS) Serial Register Page**

Run Date/Time: 5/3/2023 9:12 AM

Page 5 Of 10

Serial Number: NMNM-- 0 048344

Act Date	Act Code	Action Txt	Action Remarks	Pending Off
10/15/2004	932	TRF OPER RGTS FILED	M K WADE/SDX PROP	
10/15/2004	932	TRF OPER RGTS FILED	KEN WADE/SDX PROP	
10/29/2004	140	ASGN FILED	PURE ENE/EDGE PETRO	
11/02/2004	817	MERGER RECOGNIZED	CONCHO/CHESAPEAKE	
04/15/2005	899	TRF OF ORR FILED	1	
09/15/2005	933	TRF OPER RGTS APPROVED	02EFF 11/01/04;	
09/15/2005	933	TRF OPER RGTS APPROVED	01EFF 11/01/04;	
09/15/2005	974	AUTOMATED RECORD VERIF	MV	
09/28/2005	104	ADDTL INFO RQSTD	10/29/04 RT ASGN;	
09/28/2005	974	AUTOMATED RECORD VERIF	MV	
02/01/2006	630	RLTY REDUCTION LIFTED		
11/06/2006	140	ASGN FILED	PURE ENER/EDGE PETR;1	
11/06/2006	932	TRF OPER RGTS FILED	NEARBURG/SDX PROPE;1	
12/15/2006	139	ASGN APPROVED	EFF 12/01/06;	
12/15/2006	933	TRF OPER RGTS APPROVED	EFF 12/01/06;	
12/15/2006	974	AUTOMATED RECORD VERIF	MV	
01/04/2007	932	TRF OPER RGTS FILED	DOMINION/LOBOS ENE;1	
02/05/2007	932	TRF OPER RGTS FILED	SDX PROPE/LIME ROCK;1	
03/21/2007	933	TRF OPER RGTS APPROVED	EFF 03/01/07;	
04/25/2007	974	AUTOMATED RECORD VERIF	ANN	
05/07/2007	933	TRF OPER RGTS APPROVED	EFF 02/01/07;	
05/07/2007	974	AUTOMATED RECORD VERIF	ANN	
05/09/2007	933	TRF OPER RGTS APPROVED	EFF 02/01/07;	
02/05/2008	932	TRF OPER RGTS FILED	OXY USA/CONOCOPHILL;1	
02/11/2008	140	ASGN FILED	CHISOS/EDGE PETRO E;1	
02/11/2008	932	TRF OPER RGTS FILED	CHISOS/EDGE PETRO E;1	
02/25/2008	932	TRF OPER RGTS FILED	OXY USA W/CONOCOPHI;1	
04/08/2008	933	TRF OPER RGTS APPROVED	EFF 03/01/08;	
04/08/2008	974	AUTOMATED RECORD VERIF	LR	
04/14/2008	139	ASGN APPROVED	EFF 03/01/08;	
04/15/2008	933	TRF OPER RGTS APPROVED	EFF 03/01/08;	
04/15/2008	974	AUTOMATED RECORD VERIF	SSP	
04/15/2008	974	AUTOMATED RECORD VERIF	RAYO	
06/09/2008	140	ASGN FILED	PURE ENER/PURE GAS;1	
06/09/2008	932	TRF OPER RGTS FILED	CHISOS/PURE GAS PAR;1	
06/11/2008	817	MERGER RECOGNIZED	CHESA LLC/CHESA LP	
06/11/2008	817	MERGER RECOGNIZED	CHESA EXP LP/CHESA O	
06/11/2008	940	NAME CHANGE RECOGNIZED	CHESA ORC/CHESA EXP L	
06/16/2008	932	TRF OPER RGTS FILED	SELL ETAL/LIME ROCK;1	

NO WARRANTY IS MADE BY BLM FOR USE OF THE DATA FOR PURPOSES NOT INTENDED BY BLM

**DEPARTMENT OF THE INTERIOR
BUREAU OF LAND MANAGEMENT
CASE RECORDATION
(MASS) Serial Register Page**

Run Date/Time: 5/3/2023 9:12 AM

Page 6 Of 10

Serial Number: NMNM-- 0 048344

Act Date	Act Code	Action Txt	Action Remarks	Pending Off
06/16/2008	932	TRF OPER RGTS FILED	SELL ETAL/LIME ROCK;2	
06/16/2008	932	TRF OPER RGTS FILED	SELL ETAL/LIME ROCK;3	
07/16/2008	933	TRF OPER RGTS APPROVED	EFF 03/01/08;	
07/16/2008	974	AUTOMATED RECORD VERIF	RAYO/RAYO	
07/25/2008	139	ASGN APPROVED	EFF 07/01/08;	
07/25/2008	933	TRF OPER RGTS APPROVED	EFF 07/01/08;	
07/25/2008	974	AUTOMATED RECORD VERIF	ANN	
07/30/2008	140	ASGN FILED	PURE GAS/LIME ROCK;1	
07/30/2008	932	TRF OPER RGTS FILED	PURE GAS/LIME ROCK;1	
08/04/2008	933	TRF OPER RGTS APPROVED	03 EFF 07/01/08;	
08/04/2008	933	TRF OPER RGTS APPROVED	02 EFF 07/01/08;	
08/04/2008	933	TRF OPER RGTS APPROVED	01 EFF 07/01/08;	
08/04/2008	974	AUTOMATED RECORD VERIF	LR	
08/22/2008	817	MERGER RECOGNIZED	CHES PERM/EXPL LP	
08/22/2008	817	MERGER RECOGNIZED		
09/10/2008	139	ASGN APPROVED	EFF 08/01/08;	
09/10/2008	933	TRF OPER RGTS APPROVED	EFF 08/01/08;	
09/10/2008	974	AUTOMATED RECORD VERIF	ANN	
02/27/2009	932	TRF OPER RGTS FILED	CIBOLA ENE/JALAPENO;1	
05/08/2009	933	TRF OPER RGTS APPROVED	EFF 03/01/09;	
05/08/2009	974	AUTOMATED RECORD VERIF	MV	
09/29/2009	932	TRF OPER RGTS FILED	CHISOS/LIME ROCK RE;1	
12/11/2009	933	TRF OPER RGTS APPROVED	EFF 10/01/09;	
12/11/2009	974	AUTOMATED RECORD VERIF	RAYO/RAYO	
01/08/2010	932	TRF OPER RGTS FILED	SDX PROPE/SELL ETAL;1	
02/01/2010	817	MERGER RECOGNIZED	LOBOS ENE/KHODY LAND	
04/29/2010	932	TRF OPER RGTS FILED	CHESAPEAK/THREE RIV;1	
06/09/2010	933	TRF OPER RGTS APPROVED	EFF 05/01/10;	
06/09/2010	974	AUTOMATED RECORD VERIF	ANN	
06/25/2010	932	TRF OPER RGTS FILED	CHISOS/LIME ROCK RE;1	
09/08/2010	269	ASGN DENIED	CHISOS/LIME ROCK RE;1	
09/08/2010	974	AUTOMATED RECORD VERIF	RAYO/RAYO	
02/23/2011	140	ASGN FILED	EDGE PETROLE/APACHE;1	
04/05/2011	139	ASGN APPROVED	EFF 03/01/2011;	
04/05/2011	974	AUTOMATED RECORD VERIF	JS	
09/06/2011	932	TRF OPER RGTS FILED	THREE RIV/SALIENT Z;1	
09/21/2011	932	TRF OPER RGTS FILED	SALIENT Z/OVERTON E;1	
10/20/2011	932	TRF OPER RGTS FILED	POOL JOHN/LIME ROCK;1	
10/21/2011	933	TRF OPER RGTS APPROVED	1 EFF 10/01/11;	

NO WARRANTY IS MADE BY BLM FOR USE OF THE DATA FOR PURPOSES NOT INTENDED BY BLM

**DEPARTMENT OF THE INTERIOR
BUREAU OF LAND MANAGEMENT
CASE RECORDATION
(MASS) Serial Register Page**

Run Date/Time: 5/3/2023 9:12 AM

Page 7 Of 10

Serial Number: NMNM-- 0 048344

Act Date	Act Code	Action Txt	Action Remarks	Pending Off
10/21/2011	933	TRF OPER RGTS APPROVED	2 EFF 10/01/11;	
10/21/2011	974	AUTOMATED RECORD VERIF	RAYO	
12/01/2011	933	TRF OPER RGTS APPROVED	EFF 11/01/11;	
12/01/2011	974	AUTOMATED RECORD VERIF	LBO	
12/06/2011	932	TRF OPER RGTS FILED	EDGE PETROLE/APACHE;1	
12/08/2011	140	ASGN FILED	LIME ROCK/LRE OPERA;1	
12/08/2011	932	TRF OPER RGTS FILED	LIME ROCK/LRE OPERA;1	
02/24/2012	139	ASGN APPROVED	EFF 01/01/12;	
02/24/2012	974	AUTOMATED RECORD VERIF	LBO	
03/05/2012	933	TRF OPER RGTS APPROVED	EFF 01/01/12;	
03/05/2012	974	AUTOMATED RECORD VERIF	LBO	
03/08/2012	933	TRF OPER RGTS APPROVED	EFF 01/01/12;	
03/08/2012	974	AUTOMATED RECORD VERIF	LBO	
07/23/2012	817	MERGER RECOGNIZED	DORAL ACQ/DORAL ENE	
07/23/2012	817	MERGER RECOGNIZED	PURE/DORAL ACQ	
07/23/2012	817	MERGER RECOGNIZED	DORAL ENE/CROSS	
08/14/2012	932	TRF OPER RGTS FILED	THREE RIV/COG OPERA;1	
03/01/2013	933	TRF OPER RGTS APPROVED	EFF 09/01/12;	
03/01/2013	974	AUTOMATED RECORD VERIF	BTM	
04/25/2013	700	LEASE SEGREGATED	INTO NMNM 131678;	
05/08/2013	817	MERGER RECOGNIZED	COG EXC PROP/COG OPER	
05/13/2013	932	TRF OPER RGTS FILED	CHISOS/LRE OPERATIN;1	
09/20/2013	933	TRF OPER RGTS APPROVED	EFF 06/01/13;	
09/20/2013	974	AUTOMATED RECORD VERIF	DME	
12/11/2013	974	AUTOMATED RECORD VERIF	JA;	
02/07/2014	974	AUTOMATED RECORD VERIF	ANN	
09/15/2014	932	TRF OPER RGTS FILED	YATES ENER/JALAPENO;1	
10/29/2014	104	ADDTL INFO RQSTD	SIGNATURE/YATES;	
10/29/2014	974	AUTOMATED RECORD VERIF	JA	
11/25/2014	103	ADDTL INFO RECD		
11/25/2014	933	TRF OPER RGTS APPROVED	EFF 10/01/14;	
11/25/2014	974	AUTOMATED RECORD VERIF	JA	
02/05/2016	932	TRF OPER RGTS FILED	YATES PET/COG OPERA;1	
03/08/2016	066	BANKRUPTCY FILED	CROSS BORDER RESOURCE	
03/08/2016	817	MERGER RECOGNIZED	EFF 10/05/15;/B/	
03/08/2016	974	AUTOMATED RECORD VERIF	EMR	
03/15/2016	933	TRF OPER RGTS APPROVED	EFF 03/01/16;	
03/15/2016	974	AUTOMATED RECORD VERIF	MJD	
12/01/2016	817	MERGER RECOGNIZED	KHODY/RKI EXP & PROD;	

NO WARRANTY IS MADE BY BLM FOR USE OF THE DATA FOR PURPOSES NOT INTENDED BY BLM

**DEPARTMENT OF THE INTERIOR
BUREAU OF LAND MANAGEMENT
CASE RECORDATION
(MASS) Serial Register Page**

Run Date/Time: 5/3/2023 9:12 AM

Page 8 Of 10

Serial Number: NMNM-- 0 048344

Act Date	Act Code	Action Txt	Action Remarks	Pending Off
07/17/2017	932	TRF OPER RGTS FILED	NBL PERMI/LONGFELLO;1	
08/24/2017	817	MERGER RECOGNIZED	EFF 04/24/17;/C/	
08/24/2017	974	AUTOMATED RECORD VERIF	EMR	
09/12/2017	140	ASGN FILED	SALIENT Z/ST DEVOTE;1	
09/12/2017	140	ASGN FILED	OVERTON E/ST DEVOTE;1	
09/12/2017	932	TRF OPER RGTS FILED	SALIENT Z/ST DEVOTE;1	
09/12/2017	932	TRF OPER RGTS FILED	OVERTON E/ST DEVOTE;1	
10/12/2017	933	TRF OPER RGTS APPROVED	EFF 8/1/17;	
10/12/2017	974	AUTOMATED RECORD VERIF	KM	
12/18/2017	140	ASGN FILED	SALIENT Z/801 LLC &;1	
12/18/2017	932	TRF OPER RGTS FILED	SALIENT Z/801 LLC &;1	
12/28/2017	933	TRF OPER RGTS APPROVED	EFF 10/01/17;	
12/28/2017	974	AUTOMATED RECORD VERIF	EMR	
12/29/2017	933	TRF OPER RGTS APPROVED	EFF 10/01/17;	
01/17/2018	269	ASGN DENIED	NO R/T INTEREST;1	
01/17/2018	269	ASGN DENIED	NO R/T INTEREST;2	
01/17/2018	974	AUTOMATED RECORD VERIF	EMR	
02/22/2018	269	ASGN DENIED	NO INTEREST	
02/22/2018	974	AUTOMATED RECORD VERIF	HLJ	
02/23/2018	933	TRF OPER RGTS APPROVED	EFF 01/01/18;	
02/23/2018	974	AUTOMATED RECORD VERIF	HLJ	
04/02/2018	940	NAME CHANGE RECOGNIZED	RKI EXP/WPX ENERGY	
05/09/2019	932	TRF OPER RGTS FILED	EOG RESOU/ST DEVOTE;1	
05/16/2019	932	TRF OPER RGTS FILED	CARDINAL/ST DEVOTE;1	
07/01/2019	932	TRF OPER RGTS FILED	ST DEVOTE/SEP PERMI;1	
07/10/2019	940	NAME CHANGE RECOGNIZED	VANGUARD/GRIZZLY;	
08/08/2019	933	TRF OPER RGTS APPROVED	EFF 06/01/19;	
08/08/2019	974	AUTOMATED RECORD VERIF	AMV	
08/09/2019	933	TRF OPER RGTS APPROVED	EFF 06/01/19;	
08/09/2019	974	AUTOMATED RECORD VERIF	AMV	
09/26/2019	933	TRF OPER RGTS APPROVED	EFF 08/01/19;	
09/26/2019	974	AUTOMATED RECORD VERIF	JY	
12/30/2019	817	MERGER RECOGNIZED	EFF 08/01/18;/D/	
02/27/2020	932	TRF OPER RGTS FILED	COG OPERA/SEP PERMI;1	
05/19/2020	933	TRF OPER RGTS APPROVED	EFF 03/01/20;	
05/19/2020	974	AUTOMATED RECORD VERIF	KB	
07/06/2020	932	TRF OPER RGTS FILED	CONOCOPHI/SEP PERMI;1	
11/04/2020	933	TRF OPER RGTS APPROVED	EFF 08/01/20;	
11/04/2020	974	AUTOMATED RECORD VERIF	KB	

NO WARRANTY IS MADE BY BLM FOR USE OF THE DATA FOR PURPOSES NOT INTENDED BY BLM

**DEPARTMENT OF THE INTERIOR
BUREAU OF LAND MANAGEMENT
CASE RECORDATION
(MASS) Serial Register Page**

Run Date/Time: 5/3/2023 9:12 AM

Page 9 Of 10

Serial Number: NMNM-- 0 048344

Act Date	Act Code	Action Txt	Action Remarks	Pending Off
12/04/2020	932	TRF OPER RGTS FILED	MCCOMBS E/LONGFELLO;1	
03/18/2021	140	ASGN FILED	GRIZZLY O/CONTANGO;1	
04/15/2021	932	TRF OPER RGTS FILED	GRIZZLY O/CONTANGO;1	
04/15/2021	932	TRF OPER RGTS FILED	GRIZZLY O/CONTANGO;2	
05/03/2021	932	TRF OPER RGTS FILED	ABO EMPIR/ABO PETRO;1	
06/17/2021	957	TRF OPER RGTS DENIED	NO OR INT	
06/17/2021	974	AUTOMATED RECORD VERIF	JY	
08/09/2021	139	ASGN APPROVED	EFF 04/01/21;	
08/09/2021	974	AUTOMATED RECORD VERIF	AR	
01/28/2022	933	TRF OPER RGTS APPROVED	EFF 06/01/21;	
01/28/2022	974	AUTOMATED RECORD VERIF	EH	
02/03/2022	899	TRF OF ORR FILED	1	

Line Number	Remark Text	Serial Number: NMNM-- 0 048344
0002	CURRENT RECORD TITLE HOLDERS:	
0003	T. 17 S, R. 28 E:	
0004	SEC. 28: S2NE;	
0005	CHISOS LTD.	21.875
0006	APACHE CORPORATION	43.745
0007	STATES LTD.	12.500
0008	CROSS BORDER RES INC	21.880
0009	T. 17 S, R. 28 E:	
0010	SEC. 29: SW	
0011	CHISOS LTD	21.875
0012	APACHE CORPORATION	43.745
0013	STATES LTD.	12.500
0014	CONTANGO RESOURCES INC.	21.880
0015	/A/AC 534 RLTY RATE SLIDING SCH D EFF 4/12/1938	
0016	THRU 10/31/1991.	
0017	BONDED TRANSFEREES/LESSEES/OPERATORS:	
0018	05/08/2009 - JALAPENO CORP - NM2259 - S/W	
0019	04/05/2011 - APACHE CORP - CO1463 - N/W	
0020	03/01/2013 - COG OPERATING LLC NMB000740 225K/CFO	
0021	09/20/2013 - LRE OPTG LLC NMB000817 IND	
0022	11/25/2014 - JALAPENO CORP NMB000378 S/W	
0023	03/15/16 - TRANSFEREE BONDED COG OPER NMB000740	
0024	/B/LRE OPERATING LLC INTO LRR ENERGY LP	
0025	LRR ENERGY LP INTO VANGUARD OPERATING LLC.	
0026	/C/ 08/24/2017 - CLAYTON WILLIAMS ENERGY INC INTO	

NO WARRANTY IS MADE BY BLM FOR USE OF THE DATA FOR PURPOSES NOT INTENDED BY BLM

DEPARTMENT OF THE INTERIOR
BUREAU OF LAND MANAGEMENT
CASE RECORDATION
(MASS) Serial Register Page

Run Date/Time: 5/3/2023 9:12 AM

Page 10 Of 10

Line Number	Remark Text	Serial Number: NMNM-- 0 048344
0027	NBL PERMIAN LLC.	
0028	LONGFELLOW - NMB001490 S/W	
0029	12/28/2017 - APACHE CORP - CO1463 - N/W;	
0030	02/23/2018 - TRANSFEREE 801 LLC BOND NMB000616 - SW	
0031	08/08/2019 - VANGUARD OPERATING LLC NMB000817 - IND	
0032	/D/ 12/30/2019 - NBL PERMIAN INTO NOBLE ENERGY INC	
0033	05/19/2020 - SEP PERMIAN NMB001783 S/W	
0034	08/09/2021 - CONTANGO BOND NM001832, NW	
0035	01/28/2022 - ABO PETROLEUM, LLC NMB001923 SW	

NO WARRANTY IS MADE BY BLM FOR USE OF THE DATA FOR PURPOSES NOT INTENDED BY BLM

Facility Monthly Allocation

Facility Name/Yr/Mo/Completion Name	API	Quorum ID	OpTm (hr)	Oil Prod (bbl)	Gas Prod (MCF)	Water Prod (bbl)
WELCH A 28 10.20.50 CTB				40,708.92	130,826.85	104,494.00
2023				21,752.50	63,728.56	54,020.00
10				5,958.75	17,667.56	11,853.00
WELCH A 28 STATE 10H	3001547743	14033	720.00	2,589.61	8,715.58	6,804.81
WELCH A 28 STATE 20H	3001547741	14034	723.00	1,722.02	6,416.30	2,865.61
WELCH A 28 STATE 50H	3001547783	14035	720.00	1,647.12	2,535.68	2,182.58
11				8,402.44	21,282.84	21,688.00
WELCH A 28 STATE 10H	3001547743	14033	711.50	4,244.59	10,784.77	13,773.41
WELCH A 28 STATE 20H	3001547741	14034	711.50	2,121.41	6,822.78	4,243.07
WELCH A 28 STATE 50H	3001547783	14035	711.50	2,036.43	3,675.29	3,671.52
12				7,391.31	24,778.16	20,479.00
WELCH A 28 STATE 10H	3001547743	14033	744.00	3,462.21	13,079.82	12,172.34
WELCH A 28 STATE 20H	3001547741	14034	744.00	2,003.15	8,245.20	4,340.06
WELCH A 28 STATE 50H	3001547783	14035	732.00	1,925.96	3,453.14	3,966.60
2024				18,956.41	67,098.29	50,474.00
1				6,821.99	23,948.89	19,851.00
WELCH A 28 STATE 10H	3001547743	14033	734.00	3,490.20	13,293.63	12,736.81
WELCH A 28 STATE 20H	3001547741	14034	732.00	1,585.56	7,344.43	3,708.48
WELCH A 28 STATE 50H	3001547783	14035	744.00	1,746.23	3,310.84	3,405.71
2				6,673.27	22,785.31	18,048.00
WELCH A 28 STATE 10H	3001547743	14033	686.00	3,310.44	12,694.33	11,333.43
WELCH A 28 STATE 20H	3001547741	14034	674.00	1,638.17	7,102.14	3,439.73
WELCH A 28 STATE 50H	3001547783	14035	686.00	1,724.67	2,988.84	3,274.85
3				5,461.15	20,364.09	12,575.00
WELCH A 28 STATE 10H	3001547743	14033	612.00	2,341.99	10,066.15	6,374.33
WELCH A 28 STATE 20H	3001547741	14034	708.00	1,533.03	7,153.70	3,050.85
WELCH A 28 STATE 50H	3001547783	14035	732.00	1,586.12	3,144.24	3,149.82



Certificate of Analysis

Number: 6030-22040342-001A

Artesia Laboratory

200 E Main St.

Artesia, NM 88210

Phone 575-746-3481

Jerry Mathews
 Spur Energy
 1012 Marquez Place, Suite 106b
 Santa Fe, NM 87505

Apr. 25, 2022

Station Name: Welch A 28 St 20H
 Station Number: 79410129
 Station Location: Spur
 Sample Point: Meter Run
 Type of Sample: Spot-Cylinder
 Heat Trace Used: N/A
 Sampling Method: Fill and Purge
 Sampling Company: SPL
 Analyzed: 04/25/2022 10:42:25 by ERG

Sampled By: Nathan Payne
 Sample Of: Gas Spot
 Sample Date: 04/20/2022
 Sample Conditions: 71 psig, @ 100 °F Ambient: 91 °F
 Effective Date: 04/20/2022
 Method: GPA-2261M
 Cylinder No: 5030-00518
 Instrument: 6030_GC6 (Inficon GC-3000 Micro)
 Last Inst. Cal.: 04/25/2022 0:00 AM

Analytical Data

Components	Un-normalized Mol %	Mol. %	Wt. %	GPM at 14.73 psia		
Hydrogen Sulfide	0.000	0.30000	0.453		GPM TOTAL C2+	6.765
Nitrogen	1.825	1.83531	2.278		GPM TOTAL C3+	3.337
Methane	72.822	73.24522	52.073		GPM TOTAL iC5+	0.795
Carbon Dioxide	1.091	1.09735	2.140			
Ethane	12.694	12.76753	17.012	3.428		
Propane	6.059	6.09394	11.908	1.685		
Iso-butane	0.771	0.77508	1.996	0.255		
n-Butane	1.891	1.90220	4.899	0.602		
Iso-pentane	0.493	0.49617	1.586	0.182		
n-Pentane	0.518	0.52142	1.667	0.190		
Hexanes Plus	0.960	0.96578	3.988	0.423		
	99.124	100.00000	100.000	6.765		

Calculated Physical Properties

Relative Density Real Gas	Total	C6+
	0.7821	3.2176
Calculated Molecular Weight	22.57	93.19
Compressibility Factor	0.9959	

GPA 2172 Calculation:

Calculated Gross BTU per ft³ @ 14.73 psia & 60°F

Real Gas Dry BTU	1307	5141
Water Sat. Gas Base BTU	1285	5052
Ideal, Gross HV - Dry at 14.73 psia	1301.5	5141.1
Ideal, Gross HV - Wet	1278.8	5051.6

Comments: H₂S Field Content 0.3 %
 Mcf/day 480

Hydrocarbon Laboratory Manager

Quality Assurance: The above analyses are performed in accordance with ASTM, UOP, GPA guidelines for quality assurance, unless otherwise stated.

District I
1625 N. French Dr., Hobbs, NM 88240
Phone: (575) 393-6161 Fax: (575) 393-0720
District II
811 S. First St., Artesia, NM 88210
Phone: (575) 748-1283 Fax: (575) 748-9720
District III
1000 Rio Brazos Road, Aztec, NM 87410
Phone: (505) 334-6178 Fax: (505) 334-6170
District IV
1220 S. St. Francis Dr., Santa Fe, NM 87505
Phone: (505) 476-3460 Fax: (505) 476-3462

State of New Mexico
Energy, Minerals & Natural Resources Department
OIL CONSERVATION DIVISION
1220 South St. Francis Dr.
Santa Fe, NM 87505

Form C-102
Revised August 1, 2011
Submit one copy to appropriate
District Office

☒ AMENDED REPORT
AS-DRILLED

WELL LOCATION AND ACREAGE DEDICATION PLAT

¹ API Number 30-015-47743		² Pool Code 96830		³ Pool Name ARTESIA, GLORIETA-YESO (O)	
⁴ Property Code 329863		⁵ Property Name WELCH A 28 STATE			⁶ Well Number 10H
⁷ OGRID NO. 328947		⁸ Operator Name SPUR ENERGY PARTNERS LLC.			⁹ Elevation 3654'

¹⁰ Surface Location

UL or lot no. D	Section 27	Township 17S	Range 28E	Lot Idn	Feet from the 655	North/South line NORTH	Feet From the 910	East/West line WEST	County EDDY
---------------------------	----------------------	------------------------	---------------------	---------	-----------------------------	----------------------------------	-----------------------------	-------------------------------	-----------------------

¹¹ Bottom Hole Location If Different From Surface

UL or lot no. D	Section 28	Township 17S	Range 28E	Lot Idn	Feet from the 343	North/South line NORTH	Feet from the 51	East/West line WEST	County EDDY
¹² Dedicated Acres 160		¹³ Joint or Infill		¹⁴ Consolidation Code		¹⁵ Order No.			

No allowable will be assigned to this completion until all interest have been consolidated or a non-standard unit has been approved by the division.

¹⁶ <u>GEODETIC DATA</u> NAD 83 GRID — NM EAST <u>SURFACE LOCATION (SL)</u> N: 658806.0 — E: 591698.3 LAT: 32.8109796° N LONG: 104.1694138° W <u>FIRST TAKE POINT (FTP)</u> 292' FNL & 103' FEL — SEC 28 N: 659162.7 — E: 590688.7 LAT: 32.8119642° N LONG: 104.1726981° W MD = 4146' — TVD = 3762.3' <u>LAST TAKE POINT (LTP)</u> 343' FNL & 147' FWL — SEC 28 N: 658959.2 — E: 585746.0 LAT: 32.8114245° N LONG: 104.1887873° W MD = 9097' — TVD = 3646.2'		<u>BOTTOM HOLE (BH)</u> N: 658956.4 — E: 585650.0 LAT: 32.8114171° N LONG: 104.1890996° W MD = 9193' — TVD = 3645.0' <u>CORNER DATA</u> NAD 83 GRID — NM EAST A: FOUND BRASS CAP "1941" N: 654104.0 — E: 585547.5 B: FOUND BRASS CAP "1941" N: 656702.1 — E: 585573.1 C: FOUND BRASS CAP "1941" N: 659297.8 — E: 585602.6 D: FOUND BRASS CAP "1941" N: 659377.1 — E: 588198.9 E: FOUND BRASS CAP "1941" N: 659457.7 — E: 590794.9 F: FOUND BRASS CAP "1941" N: 659466.8 — E: 593406.4 G: FOUND BRASS CAP "1941" N: 659475.1 — E: 596017.9 H: FOUND BRASS CAP "1941" N: 656886.5 — E: 595997.7 I: FOUND BRASS CAP "1941" N: 654298.0 — E: 595977.3 J: FOUND BRASS CAP "1941" N: 654266.7 — E: 593360.1 K: FOUND BRASS CAP "1941" N: 654235.0 — E: 590741.9 L: FOUND BRASS CAP "1941" N: 654169.8 — E: 588139.7 M: FOUND BRASS CAP "1941" N: 656846.0 — E: 590769.0		¹⁷ OPERATOR CERTIFICATION I hereby certify that the information contained herein is true and complete to the best of my knowledge and belief, and that this organization either owns a working interest or unleased mineral interest in the land including the proposed bottom hole location or has a right to drill this well at this location pursuant to a contract with an owner of such a mineral or working interest, or to a voluntary pooling agreement or a compulsory pooling order heretofore entered by the division. <u>Sarah Chapman</u> 4/13/2021 Signature Date SARAH CHAPMAN Printed Name SCHAPMAN@SPUREPLLC.COM E-mail Address	
		¹⁸ SURVEYOR CERTIFICATION I hereby certify that the well location shown on this plat was plotted from field notes of actual surveys made by me or under my supervision, and that the same is true and correct to the best of my belief. 01/29/2021 Date of Survey Signature and Seal of Professional Surveyor 19680 Certificate Number LS20100587AD			

District I
1625 N. French Dr., Hobbs, NM 88240
Phone: (575) 393-6161 Fax: (575) 393-0720
District II
811 S. First St., Artesia, NM 88210
Phone: (575) 748-1283 Fax: (575) 748-9720
District III
1000 Rio Brazos Road, Aztec, NM 87410
Phone: (505) 334-6178 Fax: (505) 334-6170
District IV
1220 S. St. Francis Dr., Santa Fe, NM 87505
Phone: (505) 476-3460 Fax: (505) 476-3462

State of New Mexico
Energy, Minerals & Natural Resources Department
OIL CONSERVATION DIVISION
1220 South St. Francis Dr.
Santa Fe, NM 87505

Form C-102
Revised August 1, 2011
Submit one copy to appropriate
District Office

☒ AMENDED REPORT
AS-DRILLED

WELL LOCATION AND ACREAGE DEDICATION PLAT

¹ API Number 30-015-47741		² Pool Code 96830		³ Pool Name ARTESIA, GLORIETA-YESO (O)	
⁴ Property Code 330996		⁵ Property Name WELCH A 28 STATE			⁶ Well Number 20H
⁷ OGRID NO. 328947		⁸ Operator Name SPUR ENERGY PARTNERS LLC.			⁹ Elevation 3654'

¹⁰ Surface Location

UL or lot no. D	Section 27	Township 17S	Range 28E	Lot Idn	Feet from the 655	North/South line NORTH	Feet From the 930	East/West line WEST	County EDDY
---------------------------	----------------------	------------------------	---------------------	---------	-----------------------------	----------------------------------	-----------------------------	-------------------------------	-----------------------

¹¹ Bottom Hole Location If Different From Surface

UL or lot no. D	Section 28	Township 17S	Range 28E	Lot Idn	Feet from the 1085	North/South line NORTH	Feet from the 51	East/West line WEST	County EDDY
¹² Dedicated Acres 160		¹³ Joint or Infill		¹⁴ Consolidation Code		¹⁵ Order No.			

No allowable will be assigned to this completion until all interest have been consolidated or a non-standard unit has been approved by the division.

¹⁶ GEODETIC DATA NAD 83 GRID — NM EAST SURFACE LOCATION (SL) N: 658806.1 — E: 591718.3 LAT: 32.8109797° N LONG: 104.1693487° W FIRST TAKE POINT (FTP) 1070' FNL & 102' FEL — SEC 28 N: 658384.9 — E: 590682.0 LAT: 32.8098263° N LONG: 104.1727240° W MD = 4289' — TVD = 3787.2' LAST TAKE POINT (LTP) 1090' FNL & 141' FWL — SEC 28 N: 658212.4 — E: 585731.0 LAT: 32.8093718° N LONG: 104.1888395° W MD = 9247' — TVD = 3739.8'		BOTTOM HOLE (BH) N: 658214.6 — E: 585641.1 LAT: 32.8093783° N LONG: 104.1891319° W MD = 9337' — TVD = 3735.0' CORNER DATA NAD 83 GRID — NM EAST A: FOUND BRASS CAP "1941" N: 654104.0 — E: 585547.5 B: FOUND BRASS CAP "1941" N: 656702.1 — E: 585573.1 C: FOUND BRASS CAP "1941" N: 659297.8 — E: 585602.6 D: FOUND BRASS CAP "1941" N: 659377.1 — E: 588198.9 E: FOUND BRASS CAP "1941" N: 659457.7 — E: 590794.9 F: FOUND BRASS CAP "1941" N: 659466.8 — E: 593406.4 G: FOUND BRASS CAP "1941" N: 659475.1 — E: 596017.9 H: FOUND BRASS CAP "1941" N: 656886.5 — E: 595997.7 I: FOUND BRASS CAP "1941" N: 654298.0 — E: 595977.3 J: FOUND BRASS CAP "1941" N: 654266.7 — E: 593360.1 K: FOUND BRASS CAP "1941" N: 654235.0 — E: 590741.9 L: FOUND BRASS CAP "1941" N: 654169.8 — E: 588139.7 M: FOUND BRASS CAP "1941" N: 656846.0 — E: 590769.0	
		¹⁷ OPERATOR CERTIFICATION I hereby certify that the information contained herein is true and complete to the best of my knowledge and belief, and that this organization either owns a working interest or unleased mineral interest in the land including the proposed bottom hole location or has a right to drill this well at this location pursuant to a contract with an owner of such a mineral or working interest, or to a voluntary pooling agreement or a compulsory pooling order heretofore entered by the division. Signature <u>Sarah Chapman</u> Date <u>4/13/2021</u> SARAH CHAPMAN Printed Name SCHAPMAN@SPUREPLLC.COM E-mail Address	
		¹⁸ SURVEYOR CERTIFICATION I hereby certify that the well location shown on this plat was plotted from field notes of actual surveys made by me or under my supervision, and that the same is true and correct to the best of my belief. Date of Survey <u>02/07/2021</u> Signature and Seal of Professional Surveyor <u>Robert M. Howett</u> 19680 Certificate Number	

LS20100586AD

District I
1625 N. French Dr., Hobbs, NM 88240
Phone: (575) 393-6161 Fax: (575) 393-0720
District II
811 S. First St., Artesia, NM 88210
Phone: (575) 748-1283 Fax: (575) 748-9720
District III
1000 Rio Brazos Road, Aztec, NM 87410
Phone: (505) 334-6178 Fax: (505) 334-6170
District IV
1220 S. St. Francis Dr., Santa Fe, NM 87505
Phone: (505) 476-3460 Fax: (505) 476-3462

State of New Mexico
Energy, Minerals & Natural Resources Department
OIL CONSERVATION DIVISION
1220 South St. Francis Dr.
Santa Fe, NM 87505

Form C-102
Revised August 1, 2011
Submit one copy to appropriate
District Office

☒ AMENDED REPORT
AS-DRILLED

WELL LOCATION AND ACREAGE DEDICATION PLAT

¹ API Number 30-015-47783		² Pool Code 96830	³ Pool Name ARTESIA; GLORIETA-YESO (O)
⁴ Property Code 330996	⁵ Property Name WELCH A 28 STATE		⁶ Well Number 50H
⁷ GRID NO. 328947	⁸ Operator Name SPUR ENERGY PARTNERS LLC.		⁹ Elevation 3654'

¹⁰ Surface Location

UL or lot no. D	Section 27	Township 17S	Range 28E	Lot Idn	Feet from the 655	North/South line NORTH	Feet From the 890	East/West line WEST	County EDDY
---------------------------	----------------------	------------------------	---------------------	---------	-----------------------------	----------------------------------	-----------------------------	-------------------------------	-----------------------

¹¹ Bottom Hole Location If Different From Surface

UL or lot no. D	Section 28	Township 17S	Range 28E	Lot Idn	Feet from the 442	North/South line NORTH	Feet from the 52	East/West line WEST	County EDDY
---------------------------	----------------------	------------------------	---------------------	---------	-----------------------------	----------------------------------	----------------------------	-------------------------------	-----------------------

¹² Dedicated Acres 160	¹³ Joint or Infill	¹⁴ Consolidation Code	¹⁵ Order No.
---	-------------------------------	----------------------------------	-------------------------

No allowable will be assigned to this completion until all interest have been consolidated or a non-standard unit has been approved by the division.

<p>¹⁶ GEODETIC DATA NAD 83 GRID - NM EAST</p> <p>SURFACE LOCATION (SL) N: 658805.9 - E: 591678.3 LAT: 32.8109795° N LONG: 104.1694788° W</p> <p>FIRST TAKE POINT (FTP) 437' FNL & 104' FEL - SEC 28 N: 659018.0 - E: 590656.2 LAT: 32.8115666° N LONG: 104.1727072° W MD = 4562' - TVD = 4139.8'</p> <p>LAST TAKE POINT (LTP) 444' FNL & 150' FWL - SEC 28 N: 658858.0 - E: 585747.6 LAT: 32.8111465° N LONG: 104.1887825° W MD = 9509' - TVD = 4116.3'</p> <p>BOTTOM HOLE (BH) N: 658857.6 - E: 585649.7 LAT: 32.811456° N LONG: 104.1891012° W MD = 9607' - TVD = 4112.3'</p> <p>CORNER DATA NAD 83 GRID - NM EAST</p> <p>A: FOUND BRASS CAP "1941" N: 654104.0 - E: 585547.5</p> <p>B: FOUND BRASS CAP "1941" N: 656702.1 - E: 585573.1</p> <p>C: FOUND BRASS CAP "1941" N: 659297.8 - E: 585602.6</p> <p>D: FOUND BRASS CAP "1941" N: 659377.1 - E: 588198.9</p> <p>E: FOUND BRASS CAP "1941" N: 659457.7 - E: 590794.9</p> <p>F: FOUND BRASS CAP "1941" N: 659466.8 - E: 593406.4</p> <p>G: FOUND BRASS CAP "1941" N: 659475.1 - E: 596017.9</p> <p>H: FOUND BRASS CAP "1941" N: 656886.5 - E: 595997.7</p> <p>I: FOUND BRASS CAP "1941" N: 654298.0 - E: 595977.3</p> <p>J: FOUND BRASS CAP "1941" N: 654266.7 - E: 593360.1</p> <p>K: FOUND BRASS CAP "1941" N: 654235.0 - E: 590741.9</p> <p>L: FOUND BRASS CAP "1941" N: 654169.8 - E: 588139.7</p> <p>M: FOUND BRASS CAP "1941" N: 656846.0 - E: 590769.0</p>	<p>¹⁷ OPERATOR CERTIFICATION I hereby certify that the information contained herein is true and complete to the best of my knowledge and belief, and that this organization either owns a working interest or unleased mineral interest in the land including the proposed bottom hole location or has a right to drill this well at this location pursuant to a contract with an owner of such a mineral or working interest, or to a voluntary pooling agreement or a compulsory pooling order heretofore entered by the division.</p> <p><i>Sarah Chapman</i> 4/13/2021 Signature Date SARAH CHAPMAN Printed Name SCHAPMAN@SPUREPLLC.COM E-mail Address</p> <p>¹⁸ SURVEYOR CERTIFICATION I hereby certify that the well location shown on this plat was plotted from field notes of actual surveys made by me or under my supervision, and that the same is true and correct to the best of my belief.</p> <p>01/22/2021 Date of Survey Signature and Seal of Professional Surveyor 19680 Certificate Number LS20100588AD</p>
--	--

District I
1625 N. French Dr., Hobbs, NM 88240
Phone: (575) 393-6161 Fax: (575) 393-0720
District II
811 S. First St., Artesia, NM 88210
Phone: (575) 748-1283 Fax: (575) 748-9720
District III
1000 Rio Brazos Road, Aztec, NM 87410
Phone: (505) 334-6178 Fax: (505) 334-6170
District IV
1220 S. St. Francis Dr., Santa Fe, NM 87505
Phone: (505) 476-3460 Fax: (505) 476-3462

State of New Mexico
Energy, Minerals & Natural Resources Department
OIL CONSERVATION DIVISION
1220 South St. Francis Dr.
Santa Fe, NM 87505

Form C-102
Revised August 1, 2011
Submit one copy to appropriate
District Office

☐ AMENDED REPORT

WELL LOCATION AND ACREAGE DEDICATION PLAT

¹ API Number 30-015-	² Pool Code 96830	³ Pool Name Artesia; Glorieta-Yeso (O)
⁴ Property Code	⁵ Property Name WELCH B 28 FED	⁶ Well Number 10H
⁷ OGRID NO. 328947	⁸ Operator Name SPUR ENERGY PARTNERS LLC.	⁹ Elevation 3659'

¹⁰ Surface Location

UL or lot no.	Section	Township	Range	Lot Idn	Feet from the	North/South line	Feet From the	East/West line	County
E	27	17S	28E		1735	NORTH	809	WEST	EDDY

¹¹ Bottom Hole Location If Different From Surface

UL or lot no.	Section	Township	Range	Lot Idn	Feet from the	North/South line	Feet from the	East/West line	County
E	28	17S	28E		2455	NORTH	50	WEST	EDDY
¹² Dedicated Acres 160	¹³ Joint or Infill	¹⁴ Consolidation Code	¹⁵ Order No.						

No allowable will be assigned to this completion until all interest have been consolidated or a non-standard unit has been approved by the division.

<p>¹⁶</p> <p><u>GEODETIC DATA</u> NAD 83 GRID — NM EAST</p> <p><u>SURFACE LOCATION (SL)</u> N: 657726.2 — E: 591586.6 LAT: 32.8080119° N LONG: 104.1697828° W</p> <p><u>FIRST TAKE POINT (FTP)</u> 2455' FNL & 100' FEL — SEC 28 N: 657000.4 — E: 590670.7 LAT: 32.8060209° N LONG: 104.1727676° W</p> <p><u>LAST TAKE POINT (LTP)</u> 2455' FNL & 100' FWL — SEC 28 N: 656846.6 — E: 585674.6 LAT: 32.8056180° N LONG: 104.1890290° W</p> <p><u>BOTTOM HOLE (BH)</u> N: 656845.1 — E: 585624.6 LAT: 32.8056140° N LONG: 104.1891916° W</p> <p><u>CORNER DATA</u> NAD 83 GRID — NM EAST</p> <p>A: FOUND BRASS CAP "1941" N: 654104.0 — E: 585547.5</p> <p>B: FOUND BRASS CAP "1941" N: 656702.1 — E: 585573.1</p> <p>C: FOUND BRASS CAP "1941" N: 659297.8 — E: 585602.6</p> <p>D: FOUND BRASS CAP "1941" N: 659377.1 — E: 588198.9</p> <p>E: FOUND BRASS CAP "1941" N: 659457.7 — E: 590794.9</p> <p>F: FOUND BRASS CAP "1941" N: 659466.8 — E: 593406.4</p> <p>G: FOUND BRASS CAP "1941" N: 659475.1 — E: 596017.9</p> <p>H: FOUND BRASS CAP "1941" N: 656886.5 — E: 595997.7</p> <p>I: FOUND BRASS CAP "1941" N: 654298.0 — E: 595977.3</p> <p>J: FOUND BRASS CAP "1941" N: 654266.7 — E: 593360.1</p> <p>K: FOUND BRASS CAP "1941" N: 654235.0 — E: 590741.9</p> <p>L: FOUND BRASS CAP "1941" N: 654169.8 — E: 588139.7</p> <p>M: FOUND BRASS CAP "1941" N: 656846.0 — E: 590769.0</p>	<p>¹⁷ OPERATOR CERTIFICATION</p> <p><i>I hereby certify that the information contained herein is true and complete to the best of my knowledge and belief, and that this organization either owns a working interest or unleased mineral interest in the land including the proposed bottom hole location or has a right to drill this well at this location pursuant to a contract with an owner of such a mineral or working interest, or to a voluntary pooling agreement or a compulsory pooling order heretofore entered by the division.</i></p> <p><i>Sarah Chapman</i> 12/3/2020 Signature Date</p> <p>Sarah Chapman Printed Name</p> <p>schapman@spurepllc.com E-mail Address</p> <p>¹⁸ SURVEYOR CERTIFICATION</p> <p><i>I hereby certify that the well location shown on this plat was plotted from field notes of actual surveys made by me or under my supervision, and that the same is true and correct to the best of my belief.</i></p> <p>10-31-2020 Date of Survey</p> <p>Signature and Seal of Professional Surveyor</p> <p>19680 Certificate Number</p> <p>LS20100590</p>
---	---

District I
1625 N. French Dr., Hobbs, NM 88240
Phone: (575) 393-6161 Fax: (575) 393-0720
District II
811 S. First St., Artesia, NM 88210
Phone: (575) 748-1283 Fax: (575) 748-9720
District III
1000 Rio Brazos Road, Aztec, NM 87410
Phone: (505) 334-6178 Fax: (505) 334-6170
District IV
1220 S. St. Francis Dr., Santa Fe, NM 87505
Phone: (505) 476-3460 Fax: (505) 476-3462

State of New Mexico
Energy, Minerals & Natural Resources Department
OIL CONSERVATION DIVISION
1220 South St. Francis Dr.
Santa Fe, NM 87505

Form C-102
Revised August 1, 2011
Submit one copy to appropriate
District Office

☐ AMENDED REPORT

WELL LOCATION AND ACREAGE DEDICATION PLAT

¹ API Number 30-015-		² Pool Code 96830	³ Pool Name Artesia; Glorieta-Yeso (O)
⁴ Property Code	⁵ Property Name WELCH B 28 FED		⁶ Well Number 50H
⁷ OGRID NO. 328947	⁸ Operator Name SPUR ENERGY PARTNERS LLC.		⁹ Elevation 3660'

¹⁰ Surface Location

UL or lot no.	Section	Township	Range	Lot Idn	Feet from the	North/South line	Feet From the	East/West line	County
E	27	17S	28E		1756	NORTH	775	WEST	EDDY

¹¹ Bottom Hole Location If Different From Surface

UL or lot no.	Section	Township	Range	Lot Idn	Feet from the	North/South line	Feet from the	East/West line	County
E	28	17S	28E		2305	NORTH	50	WEST	EDDY
¹² Dedicated Acres 160	¹³ Joint or Infill	¹⁴ Consolidation Code	¹⁵ Order No.						

No allowable will be assigned to this completion until all interest have been consolidated or a non-standard unit has been approved by the division.

<p>¹⁶</p> <p><u>GEODETIC DATA</u> NAD 83 GRID — NM EAST</p> <p><u>SURFACE LOCATION (SL)</u> N: 657705.2 — E: 591552.5 LAT: 32.8079545° N LONG: 104.1698939° W</p> <p><u>FIRST TAKE POINT (FTP)</u> 2305' FNL & 100' FEL — SEC 28 N: 657150.3 — E: 590672.2 LAT: 32.8064331° N LONG: 104.1727620° W</p> <p><u>LAST TAKE POINT (LTP)</u> 2305' FNL & 100' FWL — SEC 28 N: 656996.6 — E: 585676.3 LAT: 32.8060302° N LONG: 104.1890228° W</p> <p><u>BOTTOM HOLE (BH)</u> N: 656995.0 — E: 585626.3 LAT: 32.8060262° N LONG: 104.1891854° W</p> <p><u>CORNER DATA</u> NAD 83 GRID — NM EAST</p> <p>A: FOUND BRASS CAP "1941" N: 654104.0 — E: 585547.5</p> <p>B: FOUND BRASS CAP "1941" N: 656702.1 — E: 585573.1</p> <p>C: FOUND BRASS CAP "1941" N: 659297.8 — E: 585602.6</p> <p>D: FOUND BRASS CAP "1941" N: 659377.1 — E: 588198.9</p> <p>E: FOUND BRASS CAP "1941" N: 659457.7 — E: 590794.9</p> <p>F: FOUND BRASS CAP "1941" N: 659466.8 — E: 593406.4</p> <p>G: FOUND BRASS CAP "1941" N: 659475.1 — E: 596017.9</p> <p>H: FOUND BRASS CAP "1941" N: 656886.5 — E: 595997.7</p> <p>I: FOUND BRASS CAP "1941" N: 654298.0 — E: 595977.3</p> <p>J: FOUND BRASS CAP "1941" N: 654266.7 — E: 593360.1</p> <p>K: FOUND BRASS CAP "1941" N: 654235.0 — E: 590741.9</p> <p>L: FOUND BRASS CAP "1941" N: 654169.8 — E: 588139.7</p> <p>M: FOUND BRASS CAP "1941" N: 656846.0 — E: 590769.0</p>	<p>¹⁷ OPERATOR CERTIFICATION</p> <p>I hereby certify that the information contained herein is true and complete to the best of my knowledge and belief, and that this organization either owns a working interest or unleased mineral interest in the land including the proposed bottom hole location or has a right to drill this well at this location pursuant to a contract with an owner of such a mineral or working interest, or to a voluntary pooling agreement or a compulsory pooling order heretofore entered by the division.</p> <p><i>Sarah Chapman</i> 12/3/2020 Signature Date</p> <p>Sarah Chapman Printed Name</p> <p>schapman@spurepllc.com E-mail Address</p> <p>¹⁸ SURVEYOR CERTIFICATION</p> <p>I hereby certify that the well location shown on this plat was plotted from field notes of actual surveys made by me or under my supervision, and that the same is true and correct to the best of my belief.</p> <p>10-28-2020 Date of Survey</p> <p>Signature and Seal of Professional Surveyor</p> <p>19680 Certificate Number</p> <p>LS20100592</p>
---	---

District I
1625 N. French Dr., Hobbs, NM 88240
Phone: (575) 393-6161 Fax: (575) 393-0720
District II
811 S. First St., Artesia, NM 88210
Phone: (575) 748-1283 Fax: (575) 748-9720
District III
1000 Rio Brazos Road, Aztec, NM 87410
Phone: (505) 334-6178 Fax: (505) 334-6170
District IV
1220 S. St. Francis Dr., Santa Fe, NM 87505
Phone: (505) 476-3460 Fax: (505) 476-3462

State of New Mexico
Energy, Minerals & Natural Resources Department
OIL CONSERVATION DIVISION
1220 South St. Francis Dr.
Santa Fe, NM 87505

Form C-102
Revised August 1, 2011
Submit one copy to appropriate
District Office

☒ AMENDED REPORT

WELL LOCATION AND ACREAGE DEDICATION PLAT

¹ API Number 30-015-49237	² Pool Code 96830	³ Pool Name ARTESIA; GLORIETA-YESO (O)
⁴ Property Code 332213	⁵ Property Name WELCH B 28 FED	⁶ Well Number 70H
⁷ OGRID NO. 328947	⁸ Operator Name SPUR ENERGY PARTNERS LLC.	⁹ Elevation 3659'

¹⁰ Surface Location

UL or lot no.	Section	Township	Range	Lot Idn	Feet from the	North/South line	Feet From the	East/West line	County
E	27	17S	28E		1725	NORTH	826	WEST	EDDY

¹¹ Bottom Hole Location If Different From Surface

UL or lot no.	Section	Township	Range	Lot Idn	Feet from the	North/South line	Feet from the	East/West line	County
E	28	17S	28E		1505	NORTH	50	WEST	EDDY
¹² Dedicated Acres 160	¹³ Joint or Infill	¹⁴ Consolidation Code	¹⁵ Order No.						

No allowable will be assigned to this completion until all interest have been consolidated or a non-standard unit has been approved by the division.

<p>¹⁶</p> <p><u>GEODETIC DATA</u> NAD 83 GRID — NM EAST</p> <p><u>SURFACE LOCATION (SL)</u> N: 657736.6 — E: 591603.6 LAT: 32.8080405° N LONG: 104.1697274° W</p> <p><u>FIRST TAKE POINT (FTP)</u> 1505' FNL & 100' FEL — SEC 28 N: 657950.1 — E: 590680.1 LAT: 32.8086313° N LONG: 104.1727322° W</p> <p><u>LAST TAKE POINT (LTP)</u> 1505' FNL & 100' FWL — SEC 28 N: 657796.3 — E: 585685.4 LAT: 32.8082283° N LONG: 104.1889896° W</p> <p><u>BOTTOM HOLE (BH)</u> N: 657794.8 — E: 585635.5 LAT: 32.8082243° N LONG: 104.1891522° W</p> <p><u>CORNER DATA</u> NAD 83 GRID — NM EAST</p> <p>A: FOUND BRASS CAP "1941" N: 654104.0 — E: 585547.5</p> <p>B: FOUND BRASS CAP "1941" N: 656702.1 — E: 585573.1</p> <p>C: FOUND BRASS CAP "1941" N: 659297.8 — E: 585602.6</p> <p>D: FOUND BRASS CAP "1941" N: 659377.1 — E: 588198.9</p> <p>E: FOUND BRASS CAP "1941" N: 659457.7 — E: 590794.9</p> <p>F: FOUND BRASS CAP "1941" N: 659466.8 — E: 593406.4</p> <p>G: FOUND BRASS CAP "1941" N: 659475.1 — E: 596017.9</p> <p>H: FOUND BRASS CAP "1941" N: 656886.5 — E: 595997.7</p> <p>I: FOUND BRASS CAP "1941" N: 654298.0 — E: 595977.3</p> <p>J: FOUND BRASS CAP "1941" N: 654266.7 — E: 593360.1</p> <p>K: FOUND BRASS CAP "1941" N: 654235.0 — E: 590741.9</p> <p>L: FOUND BRASS CAP "1941" N: 654169.8 — E: 588139.7</p> <p>M: FOUND BRASS CAP "1941" N: 656846.0 — E: 590769.0</p>	<p>¹⁷ OPERATOR CERTIFICATION</p> <p>I hereby certify that the information contained herein is true and complete to the best of my knowledge and belief, and that this organization either owns a working interest or unleased mineral interest in the land including the proposed bottom hole location or has a right to drill this well at this location pursuant to a contract with an owner of such a mineral or working interest, or to a voluntary pooling agreement or a compulsory pooling order heretofore entered by the division.</p> <p><i>Sarah Chapman</i> 02/01/2024 Signature Date</p> <p>SARAH CHAPMAN Printed Name</p> <p>SCHAPMAN@SPUREENERGY.COM E-mail Address</p> <p>¹⁸ SURVEYOR CERTIFICATION</p> <p>I hereby certify that the well location shown on this plat was plotted from field notes of actual surveys made by me or under my supervision, and that the same is true and correct to the best of my belief.</p> <p>10-28-2020 Date of Survey</p> <p>Signature and Seal of Professional Surveyor</p> <p>19680 Certificate Number</p> <p>LS20100589</p>
---	---

Service List						
<u>Entities</u>	<u>Attn</u>	<u>Address</u>	<u>City</u>	<u>State</u>	<u>Zip</u>	<u>Tracking</u>
SEP Permian LLC		9655 Katy Freeway, Ste 500	Houston	Texas	77024	N/A
SEP Permian Holding Corp.		9655 Katy Freeway, Ste 500	Houston	Texas	77024	N/A
OXY USA WTP Limited Partnership	Alissa Payne	5 Greenway Plaza, Ste 110	Houston	Texas	77046	9407 1118 9876 5462 5317 53
WPX Energy Permian, LLC	Tanner Tepe	3500 One Williams Center, MD 35	Tulsa	Oklahoma	74172	9407 1118 9876 5462 5317 22
Marathon Oil Company	Janine Salgado	5555 San Felipe Street	Houston	Texas	77056-2723	9407 1118 9876 5462 5317 08
Marathon Oil Permian LLC	Janine Salgado	5555 San Felipe Street	Houston	Texas	77056-2723	9407 1118 9876 5462 5317 91
MRC Delaware Resources, LLC		5400 LBJ Freeway, Ste 1500	Dallas	Texas	75240	9407 1118 9876 5462 5317 46
Sharbro Energy, LLC	Elizabeth Baker	P.O. Box 840	Artesia	New Mexico	88211-0840	9407 1118 9876 5462 5317 84
Longfellow LH, LLC	Ryan Culpepper	16803 Dallas Parkway	Addison	Texas	75001	9407 1118 9876 5462 5317 39
Black Oak Energy, LLC	Saxby Stradinger	701 NW 5th Street	Oklahoma City	Oklahoma	73102	9407 1118 9876 5462 5317 77
TYL Oil and Gas	LaDonna S. Mourné	21380 W. Sunrise Lane	Buckeye	Arizona	85396	9407 1118 9876 5462 5319 51
Jalapeno Corporation	Kathryn J. Reese	P.O. Box 1608	Albuquerque	New Mexico	87103-1608	9407 1118 9876 5462 5319 68
United States of America		620 E. Greene St.	Carslbad	New Mexico	88220	9407 1118 9876 5462 5319 20
New Mexico State Land Office		P.O. Box 1148	Santa Fe	New Mexico	87504	9407 1118 9876 5462 5319 06

Tracking Number:
9407111898765462531920

 Copy  Add to Informed Delivery

Latest Update

Your item has been delivered to an agent for final delivery in CARLSBAD, NM 88220 on May 24, 2024 at 12:15 pm.

Get More Out of USPS Tracking:

 USPS Tracking Plus®

 **Delivered to Agent**
Delivered to Agent for Final Delivery
CARLSBAD, NM 88220
May 24, 2024, 12:15 pm

[See All Tracking History](#)

[What Do USPS Tracking Statuses Mean?](#)

Text & Email Updates



USPS Tracking Plus®



Product Information



See Less 

Tracking Number:

Remove

9407111898765462531906

 Copy  Add to Informed Delivery

Latest Update

Your item was picked up at a postal facility at 11:07 am on May 24, 2024 in SANTA FE, NM 87501.

Get More Out of USPS Tracking:

 USPS Tracking Plus®

 **Delivered**
Delivered, Individual Picked Up at Postal Facility
SANTA FE, NM 87501
May 24, 2024, 11:07 am

[See All Tracking History](#)

[What Do USPS Tracking Statuses Mean?](#)

See More 

**STATE OF NEW MEXICO
ENERGY, MINERALS AND NATURAL RESOURCES DEPARTMENT
OIL CONSERVATION DIVISION**

**APPLICATION FOR OFF-LEASE MEASUREMENT
SUBMITTED BY SPUR ENERGY PARTNERS, LLC**

ORDER NO. OLM-306

ORDER

The Director of the New Mexico Oil Conservation Division ("OCD"), having considered the application and the recommendation of the Engineering Bureau, issues the following Order.

FINDINGS OF FACT

1. Spur Energy Partners, LLC ("Applicant") submitted a complete application to off-lease measure the oil and gas production ("Application") from the wells, pool, and lease identified in Exhibit A.
2. Applicant provided notice of the Application to all persons owning a working interest in the oil and gas production to be off-lease measured in accordance with 19.15.23.9(A)(5) NMAC, and those persons either submitted a written waiver or did not file an objection to the Application.
3. Applicant provided notice of the Application to the Bureau of Land Management or New Mexico State Land Office, as applicable.

CONCLUSIONS OF LAW

4. OCD has jurisdiction to issue this Order pursuant to the Oil and Gas Act, NMSA 1978, §§ 70-2-6, 70-2-11, 70-2-12, and 19.15.23 NMAC.
5. Applicant satisfied the notice requirements for the Application in accordance with 19.15.23.9(A)(5) NMAC.
6. By granting the Application with the conditions specified below, this Order prevents waste and protects correlative rights, public health, and the environment.

ORDER

1. Applicant is authorized to store and measure oil and gas production off-lease from the pools, leases, and wells identified in Exhibit A at a central tank battery described in Exhibit A.
2. The oil and gas production from the wells identified in Exhibit A shall be physically separated from the oil and gas production from other wells and no commingling of production from different leases or pools shall occur in accordance with 19.15.23.9(A)(3) NMAC and 19.15.23.9(A)(4) NMAC, except as otherwise provided in order(s) issued by OCD.

3. Applicant shall measure and market the commingled oil at a central tank battery described in Exhibit A in accordance with this Order and 19.15.18.15 NMAC or 19.15.23.8 NMAC.
4. Applicant shall measure and market the commingled gas at a central delivery point, central tank battery, or gas title transfer meter described in Exhibit A in accordance with this Order and 19.15.19.9 NMAC, provided however that if the gas is vented or flared, and regardless of the reason or authorization pursuant to 19.15.28.8(B) NMAC for such venting or flaring, Applicant shall measure or estimate the gas in accordance with 19.15.28.8(E) NMAC.
5. Applicant shall calibrate the meters used to measure or allocate oil and gas production in accordance with 19.15.12.10(C)(2) NMAC.
6. OCD retains jurisdiction of this matter and reserves the right to modify or revoke this Order as it deems necessary.

**STATE OF NEW MEXICO
OIL CONSERVATION DIVISION**



**ALBERT C.S. CHANG
DIRECTOR**

DATE: 11/10/2025

State of New Mexico
Energy, Minerals and Natural Resources Department

Exhibit A

Order: OLM-306
Operator: Spur Energy Partners, LLC (328947)
Central Tank Battery: Welch A 28 State Facility
Central Tank Battery Location: UL E, Section 27, Township 17 South, Range 28 East
Gas Title Transfer Meter Location:

Pools

Pool Name	Pool Code
ARTESIA; GLORIETA-YESO (O)	96830

Leases as defined in 19.15.12.7(C) NMAC

Lease	UL or Q/Q	S-T-R
CA Artesia; Glorietta-Yeso NMNM 106381361	S2N2	28-17S-28E
CA Artesia; Glorietta-Yeso SLO 204971 PUN 1405384	S2N2	28-17S-28E

Wells

Well API	Well Name	UL or Q/Q	S-T-R	Pool
30-015-49245	WELCH B 28 FEDERAL #010H	S2N2	28-17S-28E	96830
30-015-49235	WELCH B 28 FEDERAL #050H	S2N2	28-17S-28E	96830
30-015-49237	WELCH B 28 FEDERAL #070H	S2N2	28-17S-28E	96830

Sante Fe Main Office
Phone: (505) 476-3441

General Information
Phone: (505) 629-6116

Online Phone Directory
<https://www.emnrd.nm.gov/oed/contact-us>

State of New Mexico
Energy, Minerals and Natural Resources
Oil Conservation Division
1220 S. St Francis Dr.
Santa Fe, NM 87505

CONDITIONS

Action 345715

CONDITIONS

Operator: Spur Energy Partners LLC 9655 Katy Freeway Houston, TX 77024	OGRID: 328947
	Action Number: 345715
	Action Type: [C-107] Surface Commingle or Off-Lease (C-107B)

CONDITIONS

Created By	Condition	Condition Date
sarah.clelland	Please review the content of the order to ensure you are familiar with the authorities granted and any conditions of approval. If you have any questions regarding this matter, please email us at OCD.Engineer@emnrd.nm.gov .	11/12/2025