



300 N. MARIENFELD STREET, SUITE 1000
MIDLAND, TX 79701

OFFICE 432.695.4222
FAX 432.695.4063

October 23, 2023

Mr. Dean McClure
1220 S. St. Francis Dr.
Santa Fe, New Mexico 87505

RE: Application of Permian Resources Operating, LLC to authorize surface commingling at the Woody 22 Federal Com Central Tank Battery located in the NE/4SW/4 of Section 22, Township 20 South, Range 35 East, NMPM, Lea County, New Mexico.

Mr. McClure,

Pursuant to Division Rule 19.15.12.10, Permian Resources Operating, LLC. respectfully requests administrative approval to Surface Commingle at a Common Central Tank Battery.

API	WELL NAME	WELL #	LOCATION
30-025-51394	WOODY 22 FEDERAL COM	501H	K-22-20S-35E
30-025-51395	WOODY 22 FEDERAL COM	502H	K-22-20S-35E
30-025-51396	WOODY 22 FEDERAL COM	503H	I-22-20S-35E
30-025-51397	WOODY 22 FEDERAL COM	504H	I-22-20S-35E
30-025-51398	WOODY 22 FEDERAL COM	505H	I-22-20S-35E

Each well is metered individually. This action will prevent waste, promote conservation and protect correlative rights. The Woody 22 Fed Com battery is located in Unit Letter K, Sec 22, T-20S, R-35E.

These wells are operated by Permian Resources Operating, LLC. with the diverse ownership. There are three federal leases and three proposed COM agreements involved. Pursuant Division Rule 19.15.12.10, the interest owners that are to be notified are listed on the attached notice list and are being sent a copy of this application by certified mail, return receipt.

Also Attached:

- NMOCD Form C-107B
- NMOCD Administrative Application Checklist
- Summary Detail
- Lease plat shows boundaries, Federal Lease #'s, facility, wellhead and path of production
- Facility Diagram
- NMOCD form C-102 well plats for each well
- A copy of notice letter to interest owners and Notice List

For future addition of wells, leases, and pools to this commingling operation, notice shall be given to the interest owners in the wells, leases or pools to be added, in accordance with the Division Rule 19.15.12.10 C (4)(g) NMAC.

Sincerely,

Kanicia Schlichting
Regulatory Specialist
432-400-0185

Revised March 23, 2017

RECEIVED:	REVIEWER:	TYPE:	APP NO:
-----------	-----------	-------	---------

ABOVE THIS TABLE FOR OCD DIVISION USE ONLY

NEW MEXICO OIL CONSERVATION DIVISION
 - Geological & Engineering Bureau -
 1220 South St. Francis Drive, Santa Fe, NM 87505



ADMINISTRATIVE APPLICATION CHECKLIST

THIS CHECKLIST IS MANDATORY FOR ALL ADMINISTRATIVE APPLICATIONS FOR EXCEPTIONS TO DIVISION RULES AND REGULATIONS WHICH REQUIRE PROCESSING AT THE DIVISION LEVEL IN SANTA FE

Applicant: _____ OGRID Number: _____
 Well Name: _____ API: _____
 Pool: _____ Pool Code: _____

SUBMIT ACCURATE AND COMPLETE INFORMATION REQUIRED TO PROCESS THE TYPE OF APPLICATION INDICATED BELOW

1) **TYPE OF APPLICATION:** Check those which apply for [A]

A. Location – Spacing Unit – Simultaneous Dedication

☐ NSL ☐ NSP (PROJECT AREA) ☐ NSP (PRORATION UNIT) ☐ SD

B. Check one only for [I] or [II]

[I] Commingling – Storage – Measurement

☐ DHC ☐ CTB ☐ PLC ☐ PC ☐ OLS ☐ OLM

[II] Injection – Disposal – Pressure Increase – Enhanced Oil Recovery

☐ WFX ☐ PMX ☐ SWD ☐ IPI ☐ EOR ☐ PPR

2) **NOTIFICATION REQUIRED TO:** Check those which apply.

- A. ☐ Offset operators or lease holders
 B. ☐ Royalty, overriding royalty owners, revenue owners
 C. ☐ Application requires published notice
 D. ☐ Notification and/or concurrent approval by SLO
 E. ☐ Notification and/or concurrent approval by BLM
 F. ☐ Surface owner
 G. ☐ For all of the above, proof of notification or publication is attached, and/or,
 H. ☐ No notice required

FOR OCD ONLY

- ☐ Notice Complete
☐ Application Content Complete

- 3) **CERTIFICATION:** I hereby certify that the information submitted with this application for administrative approval is **accurate** and **complete** to the best of my knowledge. I also understand that **no action** will be taken on this application until the required information and notifications are submitted to the Division.

Note: Statement must be completed by an individual with managerial and/or supervisory capacity.

 Print or Type Name

 Date

 Phone Number

 Signature

 e-mail Address

District I
1625 N. French Drive, Hobbs, NM 88240
District II
811 S. First St., Artesia, NM 88210
District III
1000 Rio Brazos Road, Aztec, NM 87410
District IV
1220 S. St Francis Dr, Santa Fe, NM
87505

State of New Mexico
Energy, Minerals and Natural Resources Department

Form C-107-B
Revised August 1, 2011

OIL CONSERVATION DIVISION

1220 S. St Francis Drive
Santa Fe, New Mexico 87505

Submit the original
application to the Santa Fe
office with one copy to the
appropriate District Office.

APPLICATION FOR SURFACE COMMINGLING (DIVERSE OWNERSHIP)

OPERATOR NAME: Permian Resources Operating, LLC
OPERATOR ADDRESS: 300 N Marienfeld, Suite 1000, Midland, TX 79701
APPLICATION TYPE:

☐ Pool Commingling ☒ Lease Commingling ☐ Pool and Lease Commingling ☐ Off-Lease Storage and Measurement (Only if not Surface Commingled)

LEASE TYPE: ☐ Fee ☐ State ☒ Federal

Is this an Amendment to existing Order? ☐ Yes ☒ No If "Yes", please include the appropriate Order No. _____
Have the Bureau of Land Management (BLM) and State Land office (SLO) been notified in writing of the proposed commingling
☒ Yes ☐ No

(A) POOL COMMINGLING

Please attach sheets with the following information

(1) Pool Names and Codes	Gravities / BTU of Non-Commingled Production	Calculated Gravities / BTU of Commingled Production		Calculated Value of Commingled Production	Volumes

- (2) Are any wells producing at top allowables? ☐ Yes ☐ No
(3) Has all interest owners been notified by certified mail of the proposed commingling? ☐ Yes ☐ No.
(4) Measurement type: ☐ Metering ☐ Other (Specify)
(5) Will commingling decrease the value of production? ☐ Yes ☐ No If "yes", describe why commingling should be approved

(B) LEASE COMMINGLING

Please attach sheets with the following information

- (1) Pool Name and Code. Featherstone; Bone Spring 24250
(2) Is all production from same source of supply? ☒ Yes ☐ No
(3) Has all interest owners been notified by certified mail of the proposed commingling? ☒ Yes ☐ No
(4) Measurement type: ☒ Metering ☐ Other (Specify)

(C) POOL and LEASE COMMINGLING

Please attach sheets with the following information

- (1) Complete Sections A and E.

(D) OFF-LEASE STORAGE and MEASUREMENT

Please attached sheets with the following information

- (1) Is all production from same source of supply? ☐ Yes ☐ No
(2) Include proof of notice to all interest owners.

(E) ADDITIONAL INFORMATION (for all application types)

Please attach sheets with the following information

- (1) A schematic diagram of facility, including legal location.
(2) A plat with lease boundaries showing all well and facility locations. Include lease numbers if Federal or State lands are involved.
(3) Lease Names, Lease and Well Numbers, and API Numbers.

I hereby certify that the information above is true and complete to the best of my knowledge and belief.

SIGNATURE: K. Schlichting TITLE: Regulatory Specialist DATE: 10/23/23
TYPE OR PRINT NAME Kanicia Schlichting TELEPHONE NO.: 432-400-0185
E-MAIL ADDRESS: kanicia.schlichting@permianres.com

APPLICATION FOR SURFACE COMMINGLING INTO A CENTRAL TANK BATTERY

Permian Resources Operating, LLC respectfully requests approval to lease commingle oil & gas from the following wells:

	API	WELL NAME	WELL #	LOCATION	POOL CODE/NAME	STATUS
1	30-025-51394	WOODY 22 FEDERAL COM	501H	K-22-20S-35E	[24250] FEATHERSTONE; BONE SPRING	PRODUCING
2	30-025-51395	WOODY 22 FEDERAL COM	502H	K-22-20S-35E	[24250] FEATHERSTONE; BONE SPRING	PRODUCING
3	30-025-51396	WOODY 22 FEDERAL COM	503H	I-22-20S-35E	[24250] FEATHERSTONE; BONE SPRING	PRODUCING
4	30-025-51397	WOODY 22 FEDERAL COM	504H	I-22-20S-35E	[24250] FEATHERSTONE; BONE SPRING	PRODUCING
5	30-025-51398	WOODY 22 FEDERAL COM	505H	I-22-20S-35E	[24250] FEATHERSTONE; BONE SPRING	PRODUCING

GENERAL INFORMATION:**Spacing Unit for Woody 22 Federal Com #501H and Woody 22 Federal Com #502H:**

W/2 Section 15, T20S-R35E

NW/4 Section 22, T20S-R35E

Total of 480.00 acres, all in Lea County, NM

	Lease Type	Lease Number	Type of Production	Royalty	Description	% of Comm	Acres in Comm
1	Federal	NMNM-025369	Oil and Gas	12.50%	720.56 acres, including E/2NE/4, NW/4NE/4, & NW/4 Section 15, T20S-R35E, Lea County, NM	33.333333%	160.00
2	Federal	NMNM-132075	Oil and Gas	12.50%	320 acres, being S/2 Section 15, T20S-R35E, Lea County, NM	33.333333%	160.00
3	Federal	NMNM-016835	Oil and Gas	12.50%	840.32 acres, including NE/4NE/4 & NW/4NW/4 Section 22, T20S-R35E, Lea County, NM	8.333333%	40.00
4	Federal	NMNM-141011	Oil and Gas	12.50%	120 acres, being SW/4NW/4 & W/2SW/4 Section 22, T20S-R35E, Lea County, NM	8.333333%	40.00
5	Fee	N/A	Oil and Gas	Various	80 acres, being E/2NW/4 Section 22, T20S-R35E, Lea County, NM	16.666667%	80.00
		Total				100.000000%	480.00

***The Communitization Agreement for the Woody 22 Federal Com #501H and 502H has been submitted to the BLM for approval. Both wells will be subject to the same federal Communitization Agreement.**

Spacing Unit for the Woody 22 Federal Com 503H, Woody 22 Federal Com 504H, and Woody 22 Federal Com 505H:

E/2 Section 15, T20S-R35E

NE/4 Section 22, T20S-R35E

Total of 480.00 acres, all in Lea County, NM

	Lease Type	Lease Number	Type of Production	Royalty	Description	% of Comm	Acres in Comm
1	Federal	NMNM-025369	Oil and Gas	12.50%	720.56 acres, including E/2NE/4, NW/4NE/4, & NW/4 Section 15, T20S-R35E, Lea County, NM	25.000000%	120.00
2	Federal	NMNM-141010	Oil and Gas	12.50%	40 acres, being SW/4NE/4 Section 15, T20S-R35E, Lea County, NM	8.333333%	40.00
3	Federal	NMNM--132075	Oil and Gas	12.50%	320 acres, being S/2 Section 15, T20S-R35E, Lea County, NM	33.333333%	160.00
4	Federal	NMNM-016835	Oil and Gas	12.50%	840.32 acres, including NE/4NE/4 & NW/4NW/4 Section 22, T20S-R35E, Lea County, NM	8.333333%	40.00
5	Fee	N/A	Oil and Gas	Various	80 acres, being W/2NE/4 Section 22, T20S-R35E, Lea County, NM	16.666667%	80.00
6	Fee	N/A	Oil and Gas	Various	40 acres, being the SE/4NE/4 Section 22, T20S-R35E, Lea County, NM	8.333333%	40.00
		Total				100.000000%	480.00

***The Communitization Agreement for the Woody 22 Federal Com 503H, Woody 22 Federal Com 504H, and Woody 22 Federal Com 505H has been submitted to the BLM for approval. All three wells will be subject to the same federal Communitization Agreement.**

- This commingle application is NOT considered a commingle with the BLM because we will be using the meters at each well as FMPs for allocation and royalty purposes. The metered production for each well will be used to allocate production at this facility.
- The central tank battery to service the subject wells is located off-lease, in the NE/4SW/4 of Section 22, T20S-R35E, Lea County, New Mexico. The facility was reviewed and approved in the APDs for the Woody 22 Federal Com 501H, 502H, 503H, 504H, and 505H. Storing and measuring from this off-lease facility reduces the amount of trucking or pipelines since it is next to the drill pad. So, although it is off-lease, it reduces our environmental impact by producing closer to the drill pad. Please see the attached map for reference.
- There is no new surface disturbance included as part of the proposed CAA.
- Notices to all owners have been mailed out. Some owners are unlocatable, so notification has also been published.
- Enclosed herewith is 1) a map that displays the leases and the location of the subject wells, 2) a map that displays the location of the proposed CTB, (3) a Site Facility diagram, and (4) the C-102 plat for each of the wells.

- All leases, unit PAs, or CAs in the proposed CAA are capable of production in paying quantities.
- The approval of this commingling application will not negatively affect the royalty revenue of the federal government due to the allocation methodology described in the application. The approval of this application will also provide for reduced surface disturbance in this development area.
- All non-FMP gas meters will meet API Standard 14.3/AGA Report No 3 and all non-FMP oil meters will meet API/MPMS Chapter 5.6
- Pursuant to Statewide rule 19.15.12.10(C)(4)(g) PERMIAN RESOURCES OPERATING, LLC requests the option to include additional pools or leases within the defined parameters set forth in the Order for future additions.

District I
1625 N. French Dr., Hobbs, NM 88240
Phone: (575) 393-6161 Fax: (575) 393-0720

District II
811 S. First St., Artesia, NM 88210
Phone: (575) 748-1283 Fax: (575) 748-9720

District III
1000 Rio Brazos Road, Aztec, NM 87410
Phone: (505) 334-6178 Fax: (505) 334-6170

District IV
1220 S. St. Francis Dr., Santa Fe, NM 87505
Phone: (505) 476-3460 Fax: (505) 476-3462

State of New Mexico
Energy, Minerals & Natural Resources Department
OIL CONSERVATION DIVISION
1220 South St. Francis Dr.
Santa Fe, NM 87505

Form C-102
Revised August 1, 2011
Submit one copy to appropriate
District Office

☐ AMENDED REPORT

WELL LOCATION AND ACREAGE DEDICATION PLAT

¹ API Number 30-025-51394	² Pool Code 24250	³ Pool Name Featherstone: Bone Spring	
⁴ Property Code 333928	⁵ Property Name WOODY 22 FED COM		⁶ Well Number 501H
⁷ OGRID No. 37265	⁸ Operator Name PERMIAN RESOURCES OPERATING, LLC		⁹ Elevation 3695.2¹

¹⁰Surface Location

UL or lot no. K	Section 22	Township 20S	Range 35E	Lot Idn	Feet from the 2124	North/South line SOUTH	Feet from the 1540	East/West line WEST	County LEA
--------------------	---------------	-----------------	--------------	---------	-----------------------	---------------------------	-----------------------	------------------------	---------------

¹¹ Bottom Hole Location If Different From Surface

UL or lot no. C	Section 15	Township 20S	Range 35E	Lot Idn	Feet from the 109	North/South line NORTH	Feet from the 1359	East/West line WEST	County LEA
¹² Dedicated Acres 480		¹³ Joint or Infill		¹⁴ Consolidation Code		¹⁵ Order No.			

No allowable will be assigned to this completion until all interests have been consolidated or a non-standard unit has been approved by the division.

16

NAD 83 (SURFACE HOLE LOCATION)	
LATITUDE = 32°33'26.09" (32.557247°)	
LONGITUDE = -103°26'55.42" (-103.448729°)	
NAD 27 (SURFACE HOLE LOCATION)	
LATITUDE = 32°33'25.64" (32.557123°)	
LONGITUDE = -103°26'53.68" (-103.448243°)	
STATE PLANE NAD 83 (N.M. EAST)	
N: 567589.29' E: 813887.55'	
STATE PLANE NAD 27 (N.M. EAST)	
N: 567526.90' E: 772705.84'	

NAD 83 (AS-COMPLETED KOP)	
LATITUDE = 32°33'26.20" (32.557277°)	
LONGITUDE = -103°26'57.21" (-103.449226°)	
NAD 27 (AS-COMPLETED KOP)	
LATITUDE = 32°33'25.75" (32.557153°)	
LONGITUDE = -103°26'55.47" (-103.448740°)	
STATE PLANE NAD 83 (N.M. EAST)	
N: 567599.07' E: 813734.32'	
STATE PLANE NAD 27 (N.M. EAST)	
N: 567536.68' E: 772552.62'	

NAD 83 (AS-COMPLETED FTP)	
LATITUDE = 32°33'32.46" (32.559017°)	
LONGITUDE = -103°26'57.55" (-103.449318°)	
NAD 27 (AS-COMPLETED FTP)	
LATITUDE = 32°33'32.02" (32.558893°)	
LONGITUDE = -103°26'55.80" (-103.448833°)	
STATE PLANE NAD 83 (N.M. EAST)	
N: 568231.79' E: 813700.54'	
STATE PLANE NAD 27 (N.M. EAST)	
N: 568169.39' E: 772518.86'	

NAD 83 (LPP #1)	
LATITUDE = 32°33'57.39" (32.565942°)	
LONGITUDE = -103°26'57.39" (-103.449275°)	
NAD 27 (LPP #1)	
LATITUDE = 32°33'56.95" (32.565818°)	
LONGITUDE = -103°26'55.64" (-103.448789°)	
STATE PLANE NAD 83 (N.M. EAST)	
N: 570751.36' E: 813692.98'	
STATE PLANE NAD 27 (N.M. EAST)	
N: 570688.89' E: 772511.39'	

NAD 83 (LPP #2)	
LATITUDE = 32°34'23.56" (32.573210°)	
LONGITUDE = -103°26'57.40" (-103.449277°)	
NAD 27 (LPP #2)	
LATITUDE = 32°34'23.11" (32.573086°)	
LONGITUDE = -103°26'55.65" (-103.448791°)	
STATE PLANE NAD 83 (N.M. EAST)	
N: 573395.69' E: 813670.43'	
STATE PLANE NAD 27 (N.M. EAST)	
N: 573333.15' E: 772488.92'	

NAD 83 (AS-COMPLETED LTP)	
LATITUDE = 32°34'48.08" (32.580022°)	
LONGITUDE = -103°26'57.54" (-103.449318°)	
NAD 27 (AS-COMPLETED LTP)	
LATITUDE = 32°34'47.63" (32.579898°)	
LONGITUDE = -103°26'55.79" (-103.448831°)	
STATE PLANE NAD 83 (N.M. EAST)	
N: 575873.91' E: 813637.26'	
STATE PLANE NAD 27 (N.M. EAST)	
N: 575811.29' E: 772455.83'	

NAD 83 (AS-COMPLETED BHL)	
LATITUDE = 32°34'48.62" (32.580173°)	
LONGITUDE = -103°26'57.56" (-103.449322°)	
NAD 27 (AS-COMPLETED BHL)	
LATITUDE = 32°34'48.18" (32.580049°)	
LONGITUDE = -103°26'55.81" (-103.448836°)	
STATE PLANE NAD 83 (N.M. EAST)	
N: 575928.80' E: 813635.33'	
STATE PLANE NAD 27 (N.M. EAST)	
N: 575866.19' E: 772453.90'	

NOTE:

- Distances referenced on plat to section lines are perpendicular.
- Basis of Bearing is a Transverse Mercator Projection with a Central Meridian of W103°53'00" (NAD 83)
- As-Completed well head has not been field verified.
- Well bore data provided by Permian Resources Operating, LLC.

The main survey plat shows sections 15 and 22. A proposed well bore is shown running north-south through section 22. Key points include:
Section Line: 1/16 Section Line.
Proposed Well Bore: Indicated by a green line.
AS-COMPLETED KOP: 10' NORTH OF WELL, 153' WEST OF WELL, M.D. 9,681', Inclination 1.7'.
AS-COMPLETED BHL: 8,342' NORTH OF WELL, 217' WEST OF WELL, M.D. 18,330', Inclination 92.8'.
AS-COMPLETED LTP: 8,287' NORTH OF WELL, 215' WEST OF WELL, M.D. 18,275', Inclination 92.8'.
Leases: NMNM 016835, NMNM 141010, NMNM 132075, NMNM 025369, FEE.
Dimensions: Various distances are noted along the well bore and section lines, such as 1359', 1360', 1364', 109', 164', 1358', 1540', 2124', 2135', 2520', 589'46'55"W - 5296.19' (Meas.), 589'53'46"W 2653.33' (Meas.), 589'48'19"E 5302.65' (Meas.), 589'45'32"W 2653.44', 500'11'58"W - 5284.87' (Meas.), 500'11'15"E 2644.45' (Meas.), 500'11'08"E 2641.62' (Meas.), 500'14'28"W 2641.24' (Meas.), 500'14'49"W 2645.69' (Meas.), 500'15'23"W - 5288.25' (Meas.).

Detail "A"
No Scale

Detail "B"
No Scale

APPROXIMATE WELL BORE DISTANCE FROM FTP TO LTP	
LEASE	DISTANCE
FEE	2,521.06'
NMNM 132075	2,645.27'
NMNM 025369	2,479.70'
TOTAL	7,646.03'

LINE TABLE		
LINE	DIRECTION	LENGTH
L1	S89°45'32"W	2653.44'

LEGEND:

- = SURFACE HOLE LOCATION
- ◆ = AS-COMPLETED KICK OFF POINT/TAKE POINT
- ☆ = LEASE PENETRATION POINT
- = AS-COMPLETED BOTTOM HOLE LOCATION
- ▲ = SECTION CORNER LOCATED
- = AS-COMPLETED WELLBORE
- - - = LEASE LINE

SCALE
DRAWN BY: D.M.C. 09-19-23

18 OPERATOR CERTIFICATION
I hereby certify that the information contained herein is true and complete to the best of my knowledge and belief, and that this organization either owns a working interest or unleased mineral interest in the land including the proposed bottom hole location or has a right to drill this well at this location pursuant to a contract with an owner of such a mineral or working interest, or to a voluntary pooling agreement or a compulsory pooling order heretofore entered by the division.
Kanicia Schlichting
Signature Date
Kanicia Schlichting
Printed Name
kanicia.schlichting@permianres.com
E-mail Address

18 SURVEYOR CERTIFICATION
I hereby certify that the well location shown on this plat was plotted from field notes of actual surveys made by me or under my supervision, and that the same is true and correct to the best of my belief.
April

Form C-102
Revised August 1, 2011
Submit one copy to appropriate
District Office

☐ AMENDED REPORT

SCALE
DRAWN BY: D.M.C. 09-19-23

District I
1625 N. French Dr., Hobbs, NM 88240
Phone: (575) 393-6161 Fax: (575) 393-0720

District II
811 S. First St., Artesia, NM 88210
Phone: (575) 748-1283 Fax: (575) 748-9720

District III
1000 Rio Brazos Road, Aztec, NM 87410
Phone: (505) 334-6178 Fax: (505) 334-6170

District IV
1220 S. St. Francis Dr., Santa Fe, NM 87505
Phone: (505) 476-3460 Fax: (505) 476-3462

State of New Mexico
Energy, Minerals & Natural Resources Department
OIL CONSERVATION DIVISION
1220 South St. Francis Dr.
Santa Fe, NM 87505

Form C-102
Revised August 1, 2011
Submit one copy to appropriate
District Office

☐ AMENDED REPORT

WELL LOCATION AND ACREAGE DEDICATION PLAT

¹ API Number 30-025-51396	² Pool Code 24250	³ Pool Name Featherstone; Bone Spring
⁴ Property Code 333928	⁵ Property Name WOODY 22 FED COM	⁶ Well Number 503H
⁷ OGRID No. 372165	⁸ Operator Name PERMIAN RESOURCES OPERATING, LLC	⁹ Elevation 3688.8'

¹⁰ Surface Location

UL or lot no.	Section	Township	Range	Lot 1dn	Feet from the	North/South line	Feet from the	East/West line	County
I	22	20S	35E		2142	SOUTH	1289	EAST	LEA

¹¹ Bottom Hole Location If Different From Surface

UL or lot no. B	Section 15	Township 20S	Range 35E	Lot Idn	Feet from the 89	North/South line NORTH	Feet from the 2130	East/West line EAST	County LEA
¹² Dedicated Acres 480		¹³ Joint or Infill		¹⁴ Consolidation Code		¹⁵ Order No.			

No allowable will be assigned to this completion until all interests have been consolidated or a non-standard unit has been approved by the division.

16

NAD 83 (SURFACE HOLE LOCATION)
LATITUDE = 32°33'26.26" (32.557296°)
LONGITUDE = -103°26'26.57" (-103.440714°)
NAD 27 (SURFACE HOLE LOCATION)
LATITUDE = 32°33'25.82" (32.557172°)
LONGITUDE = -103°26'24.82" (-103.440229°)
STATE PLANE NAD 83 (N.M. EAST)
N: 567627.76' E: 816356.95'
STATE PLANE NAD 27 (N.M. EAST)
N: 567565.39' E: 775175.18'

NAD 83 (AS-COMPLETED KOP)
LATITUDE = 32°33'27.72" (32.557699°)
LONGITUDE = -103°26'36.69" (-103.443525°)
NAD 27 (AS-COMPLETED KOP)
LATITUDE = 32°33'27.27" (32.557575°)
LONGITUDE = -103°26'34.95" (-103.443040°)
STATE PLANE NAD 83 (N.M. EAST)
N: 567767.20' E: 815489.35'
STATE PLANE NAD 27 (N.M. EAST)
N: 567704.81' E: 774307.61'

NAD 83 (AS-COMPLETED FTP)
LATITUDE = 32°33'32.50" (32.559028°)
LONGITUDE = -103°26'36.16" (-103.443379°)
NAD 27 (AS-COMPLETED FTP)
LATITUDE = 32°33'32.06" (32.558904°)
LONGITUDE = -103°26'34.42" (-103.442894°)
STATE PLANE NAD 83 (N.M. EAST)
N: 568251.10' E: 815530.48'
STATE PLANE NAD 27 (N.M. EAST)
N: 568188.71' E: 774348.76'

NAD 83 (AS-COMPLETED LPP #1)
LATITUDE = 32°33'57.38" (32.565938°)
LONGITUDE = -103°26'36.66" (-103.443518°)
NAD 27 (AS-COMPLETED LPP #1)
LATITUDE = 32°33'56.93" (32.565815°)
LONGITUDE = -103°26'34.92" (-103.443032°)
STATE PLANE NAD 83 (N.M. EAST)
N: 570764.89' E: 815466.70'
STATE PLANE NAD 27 (N.M. EAST)
N: 570702.43' E: 774285.06'

NAD 83 (AS-COMPLETED LPP #2)
LATITUDE = 32°34'23.53" (32.573204°)
LONGITUDE = -103°26'36.46" (-103.443461°)
NAD 27 (AS-COMPLETED LPP #2)
LATITUDE = 32°34'23.09" (32.573080°)
LONGITUDE = -103°26'34.71" (-103.442975°)
STATE PLANE NAD 83 (N.M. EAST)
N: 573408.26' E: 815462.15'
STATE PLANE NAD 27 (N.M. EAST)
N: 573345.73' E: 774280.59'

NAD 83 (AS-COMPLETED LPP #3)
LATITUDE = 32°34'36.61" (32.576837°)
LONGITUDE = -103°26'36.37" (-103.443435°)
NAD 27 (AS-COMPLETED LPP #3)
LATITUDE = 32°34'36.17" (32.576714°)
LONGITUDE = -103°26'34.62" (-103.442949°)
STATE PLANE NAD 83 (N.M. EAST)
N: 574730.32' E: 815458.97'
STATE PLANE NAD 27 (N.M. EAST)
N: 574667.75' E: 774277.46'

NAD 83 (AS-COMPLETED LTP)
LATITUDE = 32°34'48.26" (32.580073°)
LONGITUDE = -103°26'36.31" (-103.443419°)
NAD 27 (AS-COMPLETED LTP)
LATITUDE = 32°34'47.82" (32.579949°)
LONGITUDE = -103°26'34.56" (-103.442933°)
STATE PLANE NAD 83 (N.M. EAST)
N: 575907.61' E: 815454.19'
STATE PLANE NAD 27 (N.M. EAST)
N: 575845.02' E: 774272.72'

NAD 83 (AS-COMPLETED BHL)
LATITUDE = 32°34'48.81" (32.580226°)
LONGITUDE = -103°26'36.32" (-103.443422°)
NAD 27 (AS-COMPLETED BHL)
LATITUDE = 32°34'48.37" (32.580103°)
LONGITUDE = -103°26'34.57" (-103.442936°)
STATE PLANE NAD 83 (N.M. EAST)
N: 575963.39' E: 815452.60'
STATE PLANE NAD 27 (N.M. EAST)
N: 575900.80' E: 774271.13'

Map details include:
 - Section lines: S89°45'32"W 2653.44' (Meas.), N0014°28"W 2641.24' (Meas.), N0014°49"W 2645.69' (Meas.), N0015°23"W - 5288.25' (Meas.), N0015°08"W 2641.62' (Meas.), N0011°15"W 2644.45' (Meas.), N0011°58"W - 5284.87' (Meas.), S89°46'55"W - 5296.19' (Meas.).
 - Points: LPP #1 (0' FSL, 2156' FEL), LPP #2 (2645' FNL, 2644' FSL, 2140' FEL), LPP #3 (1322' FNL, 2133' FEL).
 - AS-COMPLETED KOP: 143' NORTH OF WELL, 867' WEST OF WELL, M.D. 9.810', Inclination 0.7.
 - AS-COMPLETED FTP: 627' NORTH OF WELL, 824' WEST OF WELL, M.D. 10.573', Inclination 87.1.
 - AS-COMPLETED BHL: 8,341' NORTH OF WELL, 869' WEST OF WELL, M.D. 18,292', Inclination 94.9.
 - AS-COMPLETED LTP: 8,285' NORTH OF WELL, 868' WEST OF WELL, M.D. 18,236', Inclination 94.9.
 - Proposed Well Bore: Indicated by a green line.
 - Lease Lines: Indicated by red lines.
 - Distances: 2130', 2129', 2156', 2142', 2289', 2111', 1289', 2515', 5302.65' (Meas.), 589°48'19"W 5302.65' (Meas.).

NOTE:

- Distances referenced on plat to section lines are perpendicular.
- Basis of Bearing is a Transverse Mercator Projection with a Central Meridian of W103°53'00" (NAD 83)
- As-Completed well head has not been field verified.
- Well bore data provided by Permian Resources Operating, LLC.

Detail "A" details include:
 - Section Line: S89°45'32"W 2653.44' (Meas.).
 - AS-COMPLETED BHL: 8,341' NORTH OF WELL, 869' WEST OF WELL, M.D. 18,292', Inclination 94.9.
 - AS-COMPLETED LTP: 8,285' NORTH OF WELL, 868' WEST OF WELL, M.D. 18,236', Inclination 94.9.
 - Proposed Well Bore: Indicated by a green line.
 - Distances: 145', 89', 2130', 2129'.

LINE TABLE

District I
1625 N. French Dr., Hobbs, NM 88240
Phone: (575) 393-6161 Fax: (575) 393-0720

District II
811 S. First St., Artesia, NM 88210
Phone: (575) 748-1283 Fax: (575) 748-9720

District III
1000 Rio Brazos Road, Aztec, NM 87410
Phone: (505) 334-6178 Fax: (505) 334-6170

District IV
1220 S. St. Francis Dr., Santa Fe, NM 87505
Phone: (505) 476-3460 Fax: (505) 476-3462

State of New Mexico
Energy, Minerals & Natural Resources Department
OIL CONSERVATION DIVISION
1220 South St. Francis Dr.
Santa Fe, NM 87505

Form C-102
Revised August 1, 2011
Submit one copy to appropriate
District Office

☐ AMENDED REPORT

WELL LOCATION AND ACREAGE DEDICATION PLAT

¹ API Number 30-025-51397		² Pool Code 24250		³ Pool Name Featherstone: Bone Spring	
⁴ Property Code 333928		⁵ Property Name WOODY 22 FED COM			
⁷ OGRID No. 372165		⁸ Operator Name PERMIAN RESOURCES OPERATING, LLC			⁶ Well Number 504H
					⁹ Elevation 3688.7'

¹⁰Surface Location

UL or lot no.	Section	Township	Range	Lot Idn	Feet from the	North/South line	Feet from the	East/West line	County
I	22	20S	35E		2142	SOUTH	1254	EAST	LEA

¹¹ Bottom Hole Location If Different From Surface

UL or lot no. A	Section 15	Township 20S	Range 35E	Lot Idn	Feet from the 100	North/South line NORTH	Feet from the 1258	East/West line EAST	County LEA
¹² Dedicated Acres 480	¹³ Joint or Infill		¹⁴ Consolidation Code		¹⁵ Order No.				

No allowable will be assigned to this completion until all interests have been consolidated or a non-standard unit has been approved by the division.

OPERATOR CERTIFICATION

I hereby certify that the information contained herein is true and complete to the best of my knowledge and belief, and that this organization either owns a working interest or unleased mineral interest in the land including the proposed bottom hole location or has a right to drill this well at this location pursuant to a contract with an owner of such a mineral or working interest, or to a voluntary pooling agreement or a compulsory pooling order heretofore entered by the division.

	10/9/23
Signature _____	Date _____

Kanicia Schlichting
Printed Name
kancia.schlichting@permianres.com
E-mail Address

SURVEYOR CERTIFICATION

I hereby certify that the well location shown on this plat was plotted from field notes of actual surveys made by me or under my supervision, and that the same is true and correct to the best of my belief.

November 20, 2020

Date of Survey
Signature and Seal of Professional Surveyor:

Certificate Number:

NAD 83 (SURFACE HOLE LOCATION)
LATITUDE = 32°33'26.26" (32.557296°)
LONGITUDE = -103°26'26.16" (-103.440600°)
NAD 27 (SURFACE HOLE LOCATION)
LATITUDE = 32°33'25.82" (32.557172°)
LONGITUDE = -103°26'24.41" (-103.440115°)
STATE PLANE NAD 83 (N.M. EAST)
N: 567628.05' E: 816391.94'
STATE PLANE NAD 27 (N.M. EAST)
N: 567565.68' E: 775210.18'
NAD 83 (AS-COMPLETED KOP)
LATITUDE = 32°33'27.49" (32.557637°)
LONGITUDE = -103°26'25.67" (-103.440463°)
NAD 27 (AS-COMPLETED KOP)
LATITUDE = 32°33'27.05" (32.557514°)
LONGITUDE = -103°26'23.92" (-103.439978°)
STATE PLANE NAD 83 (N.M. EAST)
N: 567752.72' E: 816433.12'
STATE PLANE NAD 27 (N.M. EAST)
N: 567690.35' E: 775251.36'
NAD 83 (AS-COMPLETED FTP)
LATITUDE = 32°33'32.50" (32.559028°)
LONGITUDE = -103°26'25.45" (-103.440403°)
NAD 27 (AS-COMPLETED FTP)
LATITUDE = 32°33'32.06" (32.558905°)
LONGITUDE = -103°26'23.71" (-103.439918°)
STATE PLANE NAD 83 (N.M. EAST)
N: 568258.94' E: 816447.36'
STATE PLANE NAD 27 (N.M. EAST)
N: 568196.55' E: 775265.61'
NAD 83 (AS-COMPLETED LPP #1)
LATITUDE = 32°33'44.29" (32.562303°)
LONGITUDE = -103°26'25.82" (-103.440506°)
NAD 27 (AS-COMPLETED LPP #1)
LATITUDE = 32°33'43.85" (32.562179°)
LONGITUDE = -103°26'24.08" (-103.440021°)
STATE PLANE NAD 83 (N.M. EAST)
N: 569450.03' E: 816405.61'
STATE PLANE NAD 27 (N.M. EAST)
N: 569387.61' E: 775223.90'
NAD 83 (AS-COMPLETED LPP #2)
LATITUDE = 32°33'57.37" (32.565936°)
LONGITUDE = -103°26'25.86" (-103.440517°)
NAD 27 (AS-COMPLETED LPP #2)
LATITUDE = 32°33'56.93" (32.565813°)
LONGITUDE = -103°26'24.11" (-103.440032°)
STATE PLANE NAD 83 (N.M. EAST)
N: 570771.94' E: 816391.14'
STATE PLANE NAD 27 (N.M. EAST)
N: 570709.48' E: 775209.47'
NAD 83 (AS-COMPLETED LPP #3)
LATITUDE = 32°34'23.52" (32.573200°)
LONGITUDE = -103°26'25.94" (-103.440539°)
NAD 27 (AS-COMPLETED LPP #3)
LATITUDE = 32°34'23.83" (32.573077°)
LONGITUDE = -103°26'24.19" (-103.440053°)
STATE PLANE NAD 83 (N.M. EAST)
N: 573414.57' E: 816362.27'
STATE PLANE NAD 27 (N.M. EAST)
N: 573352.05' E: 775180.70'
NAD 83 (AS-COMPLETED LTP)
LATITUDE = 32°34'48.16" (32.580044°)
LONGITUDE = -103°26'26.11" (-103.440586°)
NAD 27 (AS-COMPLETED LTP)
LATITUDE = 32°34'47.71" (32.579920°)
LONGITUDE = -103°26'24.36" (-103.440100°)
STATE PLANE NAD 83 (N.M. EAST)
N: 575904.21' E: 816326.78'
STATE PLANE NAD 27 (N.M. EAST)
N: 575841.63' E: 775145.29'
NAD 83 (AS-COMPLETED BHL)
LATITUDE = 32°34'48.68" (32.580189°)
LONGITUDE = -103°26'26.13" (-103.440590°)
NAD 27 (AS-COMPLETED BHL)
LATITUDE = 32°34'48.24" (32.580066°)
LONGITUDE = -103°26'24.38" (-103.440105°)
STATE PLANE NAD 83 (N.M. EAST)
N: 575957.24' E: 816325.05'
STATE PLANE NAD 27 (N.M. EAST)
N: 575894.66' E: 775143.56'

• Distances referenced on plat to section lines are perpendicular.
• Basis of Bearing is a Transverse Mercator Projection with a Central Meridian of W103°53'00" (NAD 83)
• As-Completed well head has not been field verified.
• Well bore data provided by Permian Resources Operating, LLC.

LINE TABLE		
LINE	DIRECTION	LENGTH
L1	S89°53'46"W	2653.33'

APPROXIMATE WELL BORE DISTANCE FROM FTP TO LTP	
LEASE	DISTANCE
FEE	1,192.11'
NMNM 016835	1,322.22'
NMNM 132075	2,643.52'
NMNM 025369	2,490.75'
TOTAL	7,648.60'

- = SURFACE HOLE LOCATION
- ◆ = AS-COMPLETED KICK OFF POINT/TAKE POINT
- ☆ = LEASE PENETRATION POINT
- = AS

State of New Mexico
Energy, Minerals & Natural Resources Department
OIL CONSERVATION DIVISION
1220 South St. Francis Dr.
Santa Fe, NM 87505

Form C-102
Revised August 1, 2011
Submit one copy to appropriate
District Office

☐ AMENDED REPORT

¹ API Number 30-025-51398	² Pool Code 24250	³ Pool Name Featherstone; Bone Spring
⁴ Property Code 333928	⁵ Property Name WOODY 22 FED COM	⁶ Well Number 505H
⁷ OGRID No. 372165	⁸ Operator Name PERMIAN RESOURCES OPERATING, LLC	⁹ Elevation 3688.3'

UL or lot no.	Section	Township	Range	Lot Idn	Feet from the	North/South line	Feet from the	East/West line	County
I	22	20S	35E		2142	SOUTH	1219	EAST	LEA

UL or lot no. A	Section 15	Township 20S	Range 35E	Lot Idn	Feet from the 98	North/South line NORTH	Feet from the 372	East/West line EAST	County LEA
¹² Dedicated Acres 480		¹³ Joint or Infill		¹⁴ Consolidation Code		¹⁵ Order No.			

No allowable will be assigned to this completion until all interests have been consolidated or a non-standard unit has been approved by the division.

Released to Imaging: 1/12/2026 10:36:24 AM

Well Name	API Number	BLM Lease/CA
Woody 22 Fed Com 501H	30-025-51394	NMNM141011
Woody 22 Fed Com 502H	30-025-51395	NMNM141011
Woody 22 Fed Com 503H	30-025-21396	NMNM132075
Woody 22 Fed Com 504H	30-025-51397	NMNM132075
Woody 22 Fed Com 505H	30-025-51398	NMNM132075

Valve Position During Production		
Valve	Line Use	Position
1-3	Oil Fill	Open
4-6	Oil Sales	Closed
7-9	Water Fill	Open
10-12	Water Transfer	Closed

Valve Position During Sales		
Valve	Line Use	Position
1-3	Oil Fill	Closed
4-6	Oil Sales	Open
7-9	Water Fill	Closed
10-12	Water Transfer	Open

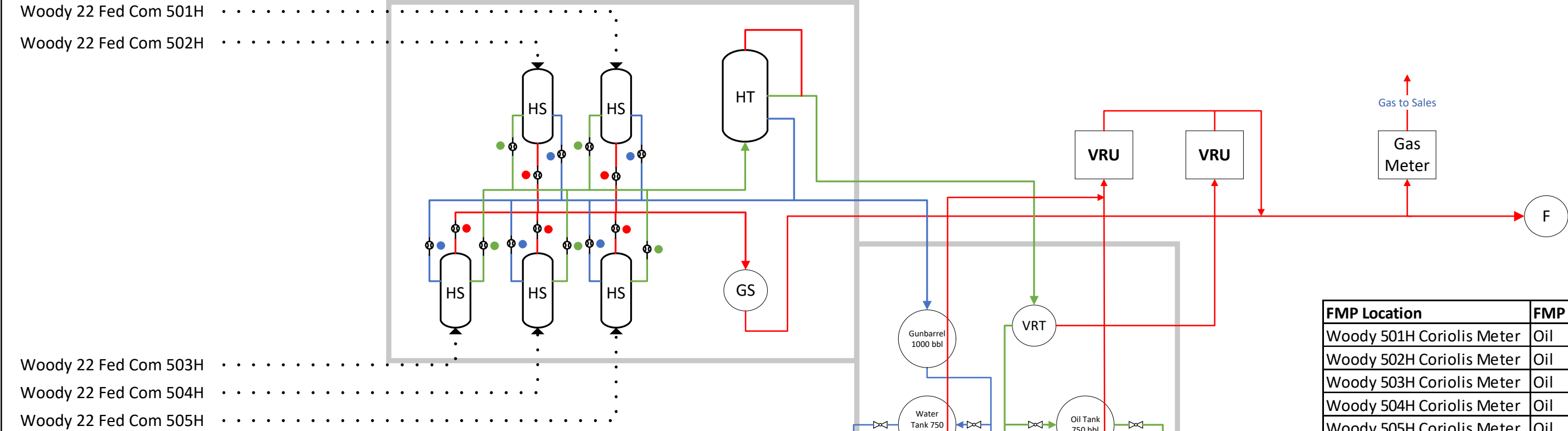

Beneficial Use Equipment	Burn Rate (MCFD)	Calculation Method
Heater Treater	48	Manufacturer

LEGEND

- Containment
- Below-ground Piping
- Produced Water Piping
- Crude Oil Piping
- Gas Piping
- Produced Water FMP
- Crude Oil FMP
- Gas FMP

- GS** Gas Scrubber
- F** Flare
- T** H2S Treatment
- VRU** Vapor Recovery Unit
- HT** Heater Treater
- HS** Horizontal Separator
- X** Pump
- Valve

FMP Location	FMP Product	Serial Number
Woody 501H Coriolis Meter	Oil	V7087616000
Woody 502H Coriolis Meter	Oil	V7087716000
Woody 503H Coriolis Meter	Oil	V7087516000
Woody 504H Coriolis Meter	Oil	V7086C16000
Woody 505H Coriolis Meter	Oil	V7087816000
Woody 501H Mag Meter	Water	V50CE516000
Woody 502H Mag Meter	Water	V50ECF16000
Woody 503H Mag Meter	Water	V50ED016000
Woody 504H Mag Meter	Water	V50ECE16000
Woody 505H Mag Meter	Water	V609CD16000
Woody 501H Total Flow	Gas	T230599654
Woody 502H Total Flow	Gas	T230599648
Woody 503H Total Flow	Gas	T230599651
Woody 504H Total Flow	Gas	T231105838
Woody 505H Total Flow	Gas	T231105880

6/13/2023

SITE FACILITY DIAGRAM

PERMIAN RESOURCES CORPORATION

Woody 22 CTB 1

LAT/LONG: 32°33'23.41"N/ 103°26'49.01"W

Section 22, T20S, R35E

Lea County, NM

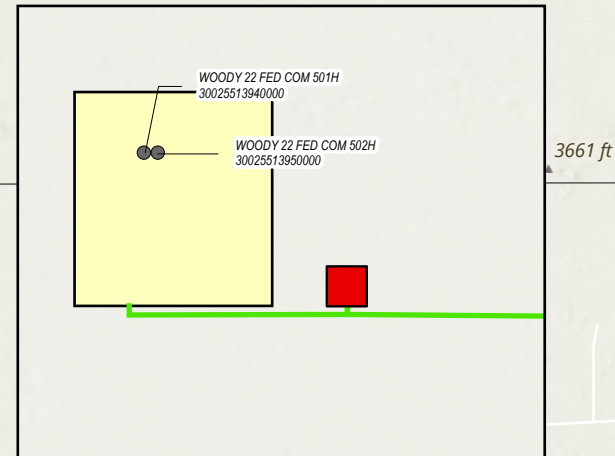
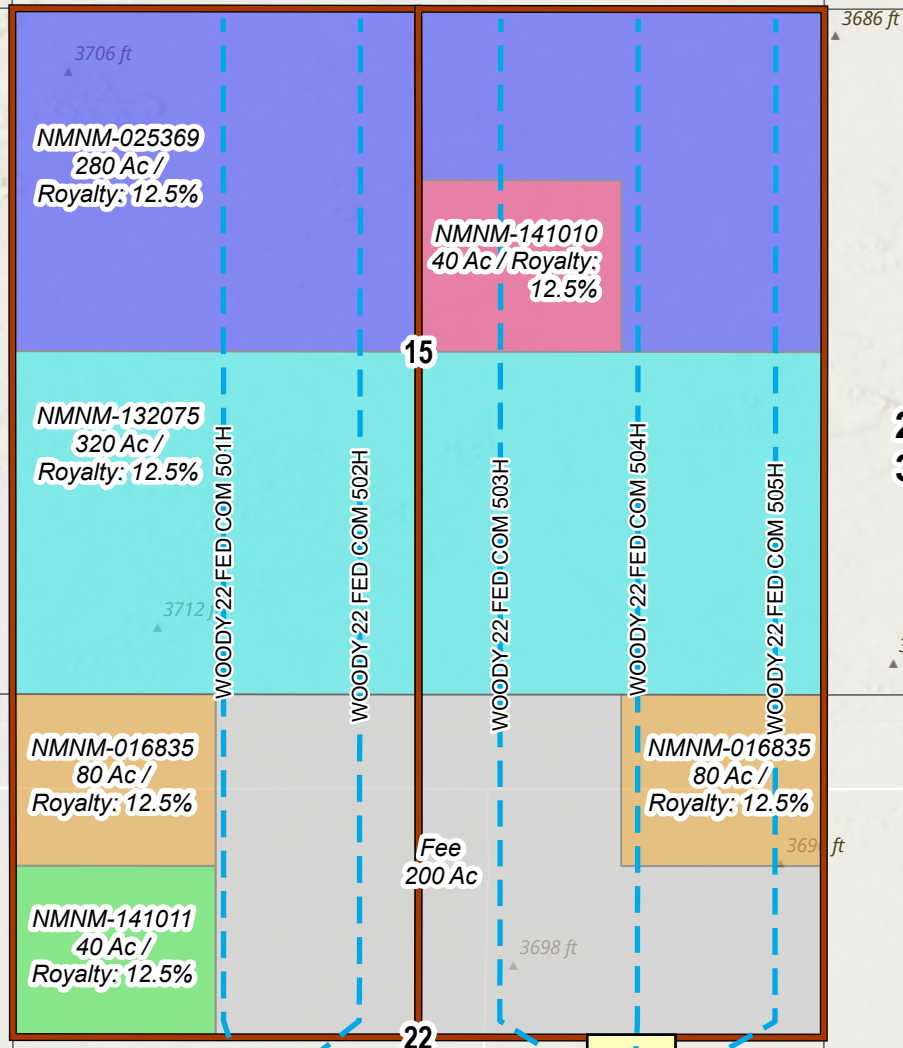

- Legend**
- Central Tank Battery
 - Flowlines
 - Facility / Pads
 - Wellbores
 - SHL
 - Communitized Areas Raider
- Leases**
- Fee
 - NMNM-141011
 - NMNM-016835
 - NMNM-025369
 - NMNM-132075
 - NMNM-141010



0 375 750 1,500 Feet

Spatial Reference
Name: GCS North American 1983
GCS: GCS North American 1983
Datum: North American 1983
Map Units: Degree

This map and its contents are not a legal surveyed document. It is meant for the use of Permian Resources and its employees and cannot be shared without expressed written authorization.

PERMIAN
RESOURCES



Woody Fed Commingling Agreement

Delaware, Lea County, New Mexico

Created Date: 09/06/2023 Revised Date: 10/12/2023

Author: K. Schlichting Drafter: T. Douglass

Path: X:\GIS\Coal\Project\Agreement\Commingling\Project\Commingling\Map.aprx



300 N. MARIENFELD STREET, SUITE 1000
MIDLAND, TX 79701

OFFICE 432.695.4222
FAX 432.695.4063

CERTIFIED MAIL
RETURN RECEIPT REQUESTED

Date: October 24, 2023

Re: Application of Permian Resources Operating, LLC to authorize surface commingling at the Woody 22 Federal Com Central Tank Battery located in the NE/4SW/4 of Section 22, Township 20 South, Range 35 East, NMPM, Lea County, New Mexico.

Dear Sir/Madam:

Enclosed please find a copy of the above-referenced application to commingle production at the Woody 22 Federal Com Central Tank Battery located in Lea County, New Mexico, filed this date with the New Mexico Oil Conservation Division (NMOCD) and the New Mexico State Land Office.

API	WELL NAME	WELL #	LOCATION
30-025-51394	WOODY 22 FEDERAL COM	501H	K-22-20S-35E
30-025-51395	WOODY 22 FEDERAL COM	502H	K-22-20S-35E
30-025-51396	WOODY 22 FEDERAL COM	503H	I-22-20S-35E
30-025-51397	WOODY 22 FEDERAL COM	504H	I-22-20S-35E
30-025-51398	WOODY 22 FEDERAL COM	505H	I-22-20S-35E

Any objection to this application must be filed in writing within twenty (20) days from this date at the Division's Santa Fe Office located at 1220 South St. Francis Drive, Santa Fe, New Mexico, 87505. If no objection is received within this twenty-day period, this application may be approved administratively by the Division.

Pursuant to Statewide Rule 19.15.12.10(C)(4)(g) Permian Resources Operating, LLC requests the option to include additional pools or leases within the defined parameters set forth in the order for future additions.

For questions regarding this application, please contact me at (432) 400-0185 or kanicia.schlichting@permianres.com.

Sincerely,

A handwritten signature in blue ink, appearing to read "K. Schlichting".

Kanicia Schlichting
Regulatory Specialist

Woody 22 Federal Com Notice List

Mailer Name & Address:
Permian Resources Operating, LLC
Kanicia Schlichting
300 N. Marienfeld Street, Suite 1000
Midland, TX 79701

FIRM BOOK REPORT

ARTICLE NUMBER	Address (Name, Street, City, State, & ZIP Code)	POSTAGE	Certified Fee	Return Receipt Electronic	Restricted Delivery	Total Postage & Fees
9407111898765499977944	Bureau of Land Management - NMSO, 301 Dinosaur Trail, Santa Fe, NM 87508	\$1.830	\$4.350			\$6.180
9407111898765499977937	BMD Exploration, LLC, 510 Vincent St., Houston, TX 77009	\$1.830	\$4.350			\$6.180
9407111898765499977975	BMD Exploration, LLC, PO Box 30127, Houston, TX 77249	\$1.830	\$4.350			\$6.180
9407111898765499977616	Copperhead Resources, LLC, PO Box 8355, Midland, TX 79708	\$1.830	\$4.350			\$6.180
9407111898765499977654	David Daniel Sell, 14181 County Road C, Booker, TX 79005	\$1.830	\$4.350			\$6.180
9407111898765499977661	David Daniel Sell, PO Box 129, Booker, TX 79005	\$1.830	\$4.350			\$6.180
9407111898765499977623	David Daniel Sell, Route 2, Box 210, Booker, TX 79005	\$1.830	\$4.350			\$6.180
9407111898765499977609	Drew Scott, PO Box 9143, Midland, TX 79708	\$1.830	\$4.350			\$6.180
9407111898765499977685	Drew Scott, 5616 Drexel Ct, Midland, TX 79707	\$1.830	\$4.350			\$6.180
9407111898765499977630	Attn Cecil Dale Watkins, 1216 N County Rd 1130, Midland, TX 79706	\$1.830	\$4.350			\$6.180
9407111898765499977678	Attn Randy Watkins, 336 County road 1643, Chico, TX 76431	\$1.830	\$4.350			\$6.180
9407111898765499977111	Attn Sandra Ferguson, 336 County Road 1643, Chico, TX 76431	\$1.830	\$4.350			\$6.180
9407111898765499977166	JB & PDIII Partners, LLC, PO Box 1811, Midland, TX 79702	\$1.830	\$4.350			\$6.180
9407111898765499977104	Kerry John Sell, 4787 N Golf Course Dr, Blaine, WA 98230	\$1.830	\$4.350			\$6.180
9407111898765499977197	Kerry John Sell, 19409 56th Ave West, Apt No. 11, Lynnwood, WA 98036	\$1.830	\$4.350			\$6.180
9407111898765499977142	Kettle Investment I LLC, PO Box 51138, Midland, TX 79710	\$1.830	\$4.350			\$6.180
9407111898765499977135	Marshall & Winston, Inc., PO Box 50880, Midland, TX 79710	\$1.830	\$4.350			\$6.180
9407111898765499977173	Matthew Bart Sell, 14329 Brown Rd, Denham Springs, LA 70726	\$1.830	\$4.350			\$6.180
9407111898765499977364	Matthew Bart Sell, Route 2, Box 19A, Perryton, TX 79070	\$1.830	\$4.350			\$6.180
9407111898765499977326	Paul Davis, Ltd., PO Box 871, Midland, TX 79702	\$1.830	\$4.350			\$6.180
9407111898765499977302	RKR Family Holdings, LLC, 415 W Wall St, Ste 105, Midland, TX 79701	\$1.830	\$4.350			\$6.180
9407111898765499977395	RKR Family Holdings, LLC, 2601 Airport Fwy, Ste 200, Fort Worth, TX 76111	\$1.830	\$4.350			\$6.180
9407111898765499977388	Thomas Duane Sell, 13291 E 137th St. S, Broken Arrow, OK 74011	\$1.830	\$4.350			\$6.180
9407111898765499977333	Thomas Duane Sell, Route 2, Box 19A, Perryton, TX 79070	\$1.830	\$4.350			\$6.180
9407111898765499977371	David Henry Watkins, 214 Cross Timbers Ct, Weatherford, TX 76085	\$1.830	\$4.350			\$6.180
9407111898765499977012	David Henry Watkins, 141 Cross Timbers Ct, Weatherford, TX 76085	\$1.830	\$4.350			\$6.180
9407111898765499977050	DCS Minerals, LLC, 2203 Stanolind Ave, Midland, TX 79705	\$1.830	\$4.350			\$6.180
9407111898765499977067	Dorothy Ann Watkins, 1211 Lauren Ln, Stillwater, OK 74075	\$1.830	\$4.350			\$6.180
9407111898765499977029	E3 Land & Minerals, LLC, 327 North Roberts St, Gilmer, TX 75644	\$1.830	\$4.350			\$6.180
9407111898765499977005	E3 Land & Minerals, LLC, 22238 State Highway 154, Diana, TX 75640	\$1.830	\$4.350			\$6.180

Mailer Name & Address:
Permian Resources Operating, LLC
Kanicia Schlichting
300 N. Marienfeld Street, Suite 1000
Midland, TX 79701

FIRM BOOK REPORT

ARTICLE NUMBER	Address (Name, Street, City, State, & ZIP Code)	POSTAGE	Certified Fee	Return Receipt Electronic	Restricted Delivery	Total Postage & Fees
9407111898765499977098	Estate of Edna Imogene Freeman Watkins, 148 Cross Timbers Court, Weatherford, TX 76085	\$1.830	\$4.350			\$6.180
9407111898765499977043	Estate of Edna Imogene Freeman Watkins, 141 Cross Timbers Ct, Weatherford, TX 76085	\$1.830	\$4.350			\$6.180
9407111898765499977081	Estate of Edna Imogene Freeman Watkins, 2322 Aldford Dr., Austin, TX 78745	\$1.830	\$4.350			\$6.180
9407111898765499977036	Estate of Henry Grant Watkins, 7419 Universal Dr., Houston, TX 77072	\$1.830	\$4.350			\$6.180
9407111898765499977074	Estate of Lala Watkins Ridge, 4927 Keenland Dr, Midland, TX 79707	\$1.830	\$4.350			\$6.180
9407111898765499977418	Estate of Ruth L. Lankford, 14507 County Rd 546, Nevada, TX 75173	\$1.830	\$4.350			\$6.180
9407111898765499977456	Estate of Ruth L. Lankford, 4712 Banner Ct, El Paso, TX 79903	\$1.830	\$4.350			\$6.180
9407111898765499977463	Henry Douglas Harrell, 2827 Carson Dr, Katy, TX 77493	\$1.830	\$4.350			\$6.180
9407111898765499977425	John H. Baldwin, 3621 Bonham, Odessa, TX 79761	\$1.830	\$4.350			\$6.180
9407111898765499977401	Estate of John Kevin Watkins, 148 Cross Timbers Court, Weatherford, TX 76085	\$1.830	\$4.350			\$6.180
9407111898765499977494	Estate of John Kevin Watkins, 190 Sandy Creek Trl, Weatherford, TX 76085	\$1.830	\$4.350			\$6.180
9407111898765499977449	Estate of John Kevin Watkins, 122 Crossfire Ct, Weatherford, TX 76088	\$1.830	\$4.350			\$6.180
9407111898765499977432	Joseph Marshall Watkins, 2322 Aldford Dr., Austin, TX 78745	\$1.830	\$4.350			\$6.180
9407111898765499977470	Kastleford Land Company, PO Box 51540, Midland, TX 79701	\$1.830	\$4.350			\$6.180
9407111898765499977517	Kathryn Watkins Louis, 3603 Gaston, Midland, TX 70703	\$1.830	\$4.350			\$6.180
9407111898765499977555	Kathryn Watkins Louis, 550 Roselea Dr, Buchanan Dam, TX 78609	\$1.830	\$4.350			\$6.180
9407111898765499977562	Mary Ann David Shands, 1741 Flaming Oak Dr, New Braunfels, TX 78132	\$1.830	\$4.350			\$6.180
9407111898765499977524	Mary Kathryn Watkins, 8915 Trone Circle, Apt D, Austin, TX 78758	\$1.830	\$4.350			\$6.180
9407111898765499977593	Rosemary Watkins Craig, 4705 Erie, Midland, TX 79703	\$1.830	\$4.350			\$6.180
9407111898765499977586	Estate of Rosemary Watkins Craig, 15105 Briar Rd, Morris, TX 74445	\$1.830	\$4.350			\$6.180
9407111898765499977531	Stephen Morris Watkins, 1617 Third Ave., Picayune, MS 34966	\$1.830	\$4.350			\$6.180
9407111898765499977579	Susan Lianne Watkins, 148 Cross Timbers Ct, Weatherford, TX 76085	\$1.830	\$4.350			\$6.180
9407111898765499976213	Ventura Oil & Gas, LLC, 308 N. Colorado, Ste 200, Midland, TX 79701	\$1.830	\$4.350			\$6.180
9407111898765499976251	William Michael Watkins, 8300 Beaver Brook Ln, Austin, TX 78748	\$1.830	\$4.350			\$6.180
9407111898765499976268	Claude Forest Wynn, PO Box 6832, Houston, TX 77265	\$1.830	\$4.350			\$6.180
9407111898765499976220	Claude Forest Wynn, 1 Courtland PL, Houston, TX 77006	\$1.830	\$4.350			\$6.180
9407111898765499976206	Forest Jacob Wynn, 6255 Longmont Dr, Houston, TX 77057	\$1.830	\$4.350			\$6.180
9407111898765499976299	Forest Jacob Wynn, 4925 Greenville Ave., Dallas, TX 75206	\$1.830	\$4.350			\$6.180
9407111898765499976282	Jane B. Ramsland Oil & Gas Partnership, Ltd., PO Box 10689, Midland, TX 79702	\$1.830	\$4.350			\$6.180
9407111898765499976275	Jane B. Ramsland Oil & Gas Partnership, Ltd., 1004 N Big Spring St, Ste 121, Midland, TX 79701	\$1.830	\$4.350			\$6.180

Mailer Name & Address:
Permian Resources Operating, LLC
Kanicia Schlichting
300 N. Marienfeld Street, Suite 1000
Midland, TX 79701

FIRM BOOK REPORT

ARTICLE NUMBER	Address (Name, Street, City, State, & ZIP Code)	POSTAGE	Certified Fee	Return Receipt Electronic	Restricted Delivery	Total Postage & Fees
9407111898765499976817	Jane B. Ramsland Oil & Gas Partnership, Ltd., PO Box 10505, Midland, TX 79702	\$1.830	\$4.350			\$6.180
9407111898765499976855	co ASWB Royalty Endowment, LLC, 901 Main St, Ste 600, Dallas, TX 75202	\$1.830	\$4.350			\$6.180
9407111898765499976824	co ASWB Royalty Endowment, LLC, 8150 N. Central Expressway, Ste 1400, Dallas, TX 75206	\$1.830	\$4.350			\$6.180
9407111898765499976800	Estate of Russell J. Ramsland, Sr., 1004 N. Big Spring, Ste 600, Midland, TX 79701	\$1.830	\$4.350			\$6.180
9407111898765499976848	Estate of Russell J. Ramsland, Sr., 6339 Desco Dr, Dallad, TX 75225	\$1.830	\$4.350			\$6.180
9407111898765499976879	Taylor Mays Wynn, 2211 Stoney Brook Dr., Houston, TX 77063	\$1.830	\$4.350			\$6.180
9407111898765499976763	The Barnes Family Partnership, 500 W. Wall St, Ste 304, Midland, TX 79701	\$1.830	\$4.350			\$6.180
9407111898765499976701	The Barnes Family Partnership, PO Box 552, Midland, TX 79702	\$1.830	\$4.350			\$6.180
9407111898765499976749	co Wells Fargo Bank, N.A., as Agent, PO Box 40909, Austin, TX 78704	\$1.830	\$4.350			\$6.180
9407111898765499976732	Alpha-Omega Fund, LP, 7419 Mason Dells Dr., Dallas, TX 75230	\$1.830	\$4.350			\$6.180
9407111898765499976770	Andrea C. Wiggins, PO Box 50331, Midland, TX 79710	\$1.830	\$4.350			\$6.180
9407111898765499976916	Andrea C. Wiggins, 4104 Tablerock Dr, Austin, TX 79731	\$1.830	\$4.350			\$6.180
9407111898765499976954	Andy M. Quinn, Jr. & Nancy B. Quinn, 2414 Albans Road, Houston, TX 77005	\$1.830	\$4.350			\$6.180
9407111898765499976961	Apache Corporation, 303 Veterans Airpark Ln, Ste. 1000, Midland, TX 79705	\$1.830	\$4.350			\$6.180
9407111898765499976923	Apache Corporation, 2000 Post Oak Blvd, Ste. 100, Houston, TX 77056	\$1.830	\$4.350			\$6.180
9407111898765499976909	Banner III Holdings, LLC, 3851 N. Versailles Ave., Dallas, TX 75209	\$1.830	\$4.350			\$6.180
9407111898765499976992	Trustee of the Carolyn A. Streich Trust, 9156 E. Andora Hills, Scottsdale, AZ 85262	\$1.830	\$4.350			\$6.180
9407111898765499976985	Charles R. Wiggins, 1513 Douglas Ave., Midland, TX 79701	\$1.830	\$4.350			\$6.180
9407111898765499976930	Charles R. Wiggins, PO Box 10862, Midland, TX 79702	\$1.830	\$4.350			\$6.180
9407111898765499976978	Charles R. Wiggins, 400 W. Texas, Ste. 1228, Midland, TX 79701	\$1.830	\$4.350			\$6.180
9407111898765499976619	Comeups, LLC, 1121 4th St. NW, Ste. 1A, Albuquerque, NM 87102	\$1.830	\$4.350			\$6.180
9407111898765499976657	Five States Energy Company, LLC, 4925 Greenville Ave., Ste. 1220, Dallas, TX 75206	\$1.830	\$4.350			\$6.180
9407111898765499976664	Five States Energy Company, LLC, 1220 One Energy SQ 4925 Greenville Ave., Dallas, TX 75206	\$1.830	\$4.350			\$6.180
9407111898765499976626	HED Enterprises, L.P., 1528 Slocum St., Dallas, TX 75207	\$1.830	\$4.350			\$6.180
9407111898765499976640	Trustee of Howard Smith Jr Louise Smith Neuhaus, 1001 Fannin St., Ste. 700, Houston, TX 77002	\$1.830	\$4.350			\$6.180
9407111898765499976688	Jack C. Vaughn, Jr., 5325 Waneta Dr., Dallas, TX 75209	\$1.830	\$4.350			\$6.180
9407111898765499976633	Trustee of John R Sears Jr ua of Elma A Sears, 3100 Monticello Ave., Ste. 830, Dallas, TX 75205	\$1.830	\$4.350			\$6.180
9407111898765499976671	KWF Enterprises, LP, 1528 Slocum St., Dallad, TX 75207	\$1.830	\$4.350			\$6.180
9407111898765499976114	Trust of Margaret Seay Oglesby Allison Trust, 10601 Inwood Rd, Dallas, TX 75229	\$1.830	\$4.350			\$6.180
9407111898765499976152	MonkeyBear, LLC, 22 Cheltenham Way, Dallas, TX 75230	\$1.830	\$4.350			\$6.180

Mailer Name & Address:
Permian Resources Operating, LLC
Kanicia Schlichting
300 N. Marienfeld Street, Suite 1000
Midland, TX 79701

FIRM BOOK REPORT

ARTICLE NUMBER	Address (Name, Street, City, State, & ZIP Code)	POSTAGE	Certified Fee	Return Receipt Electronic	Restricted Delivery	Total Postage & Fees
9407111898765499976121	Morris E. Schertz, PO Box 2588, Roswell, NM 88202	\$1.830	\$4.350			\$6.180
9407111898765499976107	Morris E. Schertz, 1407 S Sunset Ave, Roswell, NM 88203	\$1.830	\$4.350			\$6.180
9407111898765499976190	Petrasilva Partners, LP, 6255 Velasco Avenue, Dallas, TX 75214	\$1.830	\$4.350			\$6.180
9407111898765499976183	Revolution Energy Holding Company, LLC, 914 N Broway Avenue, Suite 302, Oklahoma City, OK 73103	\$1.830	\$4.350			\$6.180
9407111898765499976138	Richard H. & Sigrid M. Coats, 3006 Racquet Club Dr., Midland, TX 79705	\$1.830	\$4.350			\$6.180
9407111898765499976176	Richard H. & Sigrid M. Coats, PO Box 2412, Midland, TX 79701	\$1.830	\$4.350			\$6.180
9407111898765499976312	Galley NM Assets, LLC, 4143 Maple Avenue, Floor 5, Dallas, TX 75219	\$1.830	\$4.350			\$6.180
9407111898765499976350	Tim Goudeau, 2102 N I St., Midland, TX 79705	\$1.830	\$4.350			\$6.180
9407111898765499976367	Trust for Edward K Neuhaus, 10906 Little Lisa Ln, Houston, TX 77024	\$1.830	\$4.350			\$6.180
9407111898765499976329	Trust for Laurence B Neuhaus, 4874 Post Oak Timber Dr., Houston, TX 77056	\$1.830	\$4.350			\$6.180
9407111898765499976398	VEB Holdings LLC, 6103 Tyne St., Unit B, Houston, TX 77007	\$1.830	\$4.350			\$6.180
9407111898765499976343	Trustees of WO III Kay F Neuhaus Trust, 479 Camino Don Miguel, Santa Fe, NM 87505	\$1.830	\$4.350			\$6.180
9407111898765499976336	Weathered Rock, L.L.C., 4525 Arcady Avenue, Dallas, TX 75205	\$1.830	\$4.350			\$6.180
9407111898765499976374	BEXP II Alpha, LLC, 5914 W. Courtyard Dr., Ste. 340, Austin, TX 78730	\$1.830	\$4.350			\$6.180
9407111898765499976015	BEXP II Alpha Omega, LLC, 5914 W. Courtyard Dr., Ste. 340, Austin, TX 78730	\$1.830	\$4.350			\$6.180
9407111898765499976053	Incline Permian II, LLC, 4645 N. Central Expressway, Ste. 100, Dallas, TX 75205	\$1.830	\$4.350			\$6.180
9407111898765499976060	Occidental Permian Ltd., 5 Greenway Plaza, Ste. 110, Houston, TX 77046	\$1.830	\$4.350			\$6.180
9407111898765499976008	SITL Energy, LLC, 308 N. Colorado, Ste. 200, Midland, TX 79701	\$1.830	\$4.350			\$6.180
9407111898765499976091	XTO Holdings, LLC, 22777 Springwoods Village Pkway, Spring, TX 77389	\$1.830	\$4.350			\$6.180
9407111898765499976046	Devon Energy Production Company, LP, 333 W. Sheridan Ave., Oklahoma City, OK 73102	\$1.830	\$4.350			\$6.180
9407111898765499976084	Crown Oil Partners VII, LLC, PO Box 50820, Midland, TX 79710	\$1.830	\$4.350			\$6.180
9407111898765499976039	Mavros Oil Company, LLC, PO Box 50820, Midland, TX 79710	\$1.830	\$4.350			\$6.180
9407111898765499976077	Crump Energy Investments IV, LLC, PO Box 50820, Midland, TX 79710	\$1.830	\$4.350			\$6.180

Legal Notice

Permian Resources Operating, LLC is applying to surface commingle two wells to a central tank battery in Lea County, New Mexico. The central tank battery will be located at the Woody 22 Federal Com CTB in the NE/4SW/4. The five wells, details and locations are the following:

Woody 22 Federal Com 501H located in the southwest quarter of section 22, T20S, R35E, Unit K, 2124 FSL & 1540 FWL.

Woody 22 Federal Com 502H located in the southwest quarter of section 22, T20S, R35E, Unit K, 2124 FSL & 1573 FWL.

Woody 22 Federal Com 503H located in the southeast quarter of section 22, T20S, R35E, Unit I, 2142 FSL & 1289 FEL.

Woody 22 Federal Com 504H located in the southeast quarter of section 22, T20S, R35E, Unit I, 2142 FSL & 1254 FEL.

Woody 22 Federal Com 505H located in the southeast quarter of section 22, T20S, R35E, Unit I, 2142 FSL & 1219 FEL.

Interested parties must file objections or requests for hearing with the New Mexico Oil Conservation Division, 1220 South Saint Francis Dr., Santa Fe, NM 87505, within 20 days. Additional information can be obtained by contacting Kanicia Schlichting, Permian Resources Operating, LLC, 300 N. Marienfeld St., Suite 1000, Midland, TX 79701. Phone number is 432-400-0185.

*Certified Copy will be emailed to the OCD once received.

Federal Communitization Agreement

Contract No. _____

THIS AGREEMENT entered into as of the 1st day of March, 2023, by and between the parties subscribing, ratifying, or consenting hereto, such parties being hereinafter referred to as "parties hereto."

WITNESSETH:

WHEREAS, the Act of February 25, 1920 (41 Stat. 437), as amended and supplemented, authorizes communitization or drilling agreements communitizing or pooling a Federal oil and gas lease, or any portion thereof, with other lands, whether or not owned by the United States, when separate tracts under such Federal lease cannot be independently developed and operated in conformity with an established well-spacing program for the field or area and such communitization or pooling is determined to be in the public interest; and

WHEREAS, the parties hereto own working, royalty or other leasehold interests, or operating rights under the oil and gas leases and lands subject to this agreement which cannot be independently developed and operated in conformity with the well-spacing program established for the field or area in which said lands are located; and

WHEREAS, the parties hereto desire to communitize and pool their respective mineral interests in lands subject to this agreement for the purpose of developing and producing communitized substances in accordance with the terms and conditions of this agreement:

NOW, THEREFORE, in consideration of the premises and the mutual advantages to the parties hereto, it is mutually covenanted and agreed by and between the parties hereto as follows:

1. The lands covered by this agreement (hereinafter referred to as "communitized area") are described as follows:

Township 20 South, Range 35 East:

Section 15: W/2

Lea County, New Mexico

Township 20 South, Range 35 East:

Section 22: NW/4

Lea County, New Mexico

Containing **480.00** acres, and this agreement shall include only the Bone Spring formation underlying said lands and the associated gaseous hydrocarbons hereafter referred to as "communitized substances," producible from such formation.

2. Attached hereto, and made a part of this agreement for all purposes is Exhibit "A", a plat designating the communitized area and, Exhibit "B", designating the operator of the communitized area and showing the acreage, percentage and ownership of oil and gas interests in all lands within the communitized area, and the authorization, if any, for communitizing or pooling any patented or fee lands within the communitized area.
3. The Operator of the communitized area shall be Permian Resources Operating, LLC, whose address is 300 N. Marienfeld Street, Suite 1000, Midland, Texas 79701. All matters of operations shall be governed by the operator under and pursuant to the terms and provisions of this agreement. A successor operator may be designated by the owners of the working interest in the communitized area and four (4) executed copies of a designation of successor operator shall be filed with the Authorized Officer.
4. Operator shall furnish the Secretary of the Interior, or his authorized representative, with a log and history of any well drilled on the communitized area, monthly reports of operations, statements of oil and gas sales and royalties and such other reports as are deemed necessary to compute monthly the royalty due the United States, as specified in the applicable oil and gas operating regulations.
5. The communitized area shall be developed and operated as an entirety, with the understanding and agreement between the parties hereto that all communitized substances produced there from shall be allocated among the leaseholds comprising said area in the proportion that the acreage interest of each leasehold bears to the entire acreage interest committed to this agreement.

If the communitized area approved in this Agreement contains unleased Federal lands, the value of $1/8^{\text{th}}$ or $12 \frac{1}{2}$ percent for the Federal lands, of the production that would be allocated to such Federal lands, described above, if such lands were leased, committed and entitled to participation, shall be payable as compensatory royalties to the Federal government. The remaining $7/8^{\text{th}}$ should be placed into an escrow account set up by the operator. Parties to the Agreement holding working interest in committed leases within the applicable communitized area are responsible for such royalty payments on the volume of the production reallocated from the unleased Federal lands to their communitized tracts as set forth in Exhibit "B" attached hereto. The value of such production subject to the payment of said royalties shall be determined pursuant to the method set forth in 30 CFR Part 1206 for the unleased Federal lands. Payment of compensatory royalties on the production reallocated from the unleased Federal lands to the committed tracts within the communitized area shall fulfill the Federal royalty obligation for such production. Payment of compensatory royalties, as provided herein, shall accrue

from the date the committed tracts in the communitized area that includes unleased Federal land receive a production allocation, and shall be due and payable by the last day of the calendar month next following the calendar month of actual production. Payment due under this provision shall end when the Federal tract is leased or when production of communitized substances ceases within the communitized area and the Communitization Agreement is terminated, whichever occurs first.

Any party acquiring a Federal lease of the unleased Federal lands included in the communitized area established hereunder, will be subject to this Agreement as of the effective date of the Federal leases to said party (ies). Upon issuance of the Federal lease and payment of its proportionate cost of the well, including drilling, completing and equipping the well, the acquiring party (ies) shall own the working interest described in the Tract, as described on Exhibit "B", and shall have the rights and obligations of said working interest as to the effective date of the Federal Lease.

6. The royalties payable on communitized substances allocated to the individual leases comprising the communitized area and the rentals provided for in said leases shall be determined and paid on the basis prescribed in each of the individual leases. Payments of rentals under the terms of leases subject to this agreement shall not be affected by this agreement except as provided for under the terms and provisions of said leases or as may herein be otherwise provided. Except as herein modified and changed, the oil and gas leases subject to this agreement shall remain in full force and effect as originally made and issued. It is agreed that for any Federal lease bearing a sliding- or step-scale rate of royalty, such rate shall be determined separately as to production from each communitization agreement to which such lease may be committed, and separately as to any noncommunitized lease production, provided, however, as to leases where the rate of royalty for gas is based on total lease production per day, such rate shall be determined by the sum of all communitized production allocated to such a lease plus any noncommunitized lease production.
7. There shall be no obligation on the lessees to offset any well or wells completed in the same formation as covered by this agreement on separate component tracts into which the communitized area is now or may hereafter be divided, nor shall any lessee be required to measure separately communitized substances by reason of the diverse ownership thereof, but the lessees hereto shall not be released from their obligation to protect said communitized area from drainage of communitized substances by a well or wells which may be drilled offsetting said area.
8. The commencement, completion, continued operation, or production of a well or wells for communitized substances on the communitized area shall be construed and considered as the commencement, completion, continued operation, or production on each and all of the lands within and comprising said communitized

area, and operations or production pursuant to this agreement shall be deemed to be operations or production as to each lease committed hereto.

9. Production of communitized substances and disposal thereof shall be in conformity with allocation, allotments, and quotas made or fixed by any duly authorized person or regulatory body under applicable Federal or State statutes. This agreement shall be subject to all applicable Federal and State laws or executive orders, rules and regulations, and no party hereto shall suffer a forfeiture or be liable in damages for failure to comply with any of the provisions of this agreement if such compliance is prevented by, or if such failure results from, compliance with any such laws, orders, rules or regulations.
10. The date of this agreement is March 1, 2023, and it shall become effective as of this date or from the onset of production of communitized substances, whichever is earlier upon execution by the necessary parties, notwithstanding the date of execution, and upon approval by the Secretary of the Interior or by his duly authorized representative, and shall remain in force and effect for a period of 2 years and for as long as communitized substances are, or can be, produced from the communitized area in paying quantities: Provided, that prior to production in paying quantities from the communitized area and upon fulfillment of all requirements of the Secretary of the Interior, or his duly authorized representative, with respect to any dry hole or abandoned well, this agreement may be terminated at any time by mutual agreement of the parties hereto. This agreement shall not terminate upon cessation of production if, within 60 days thereafter, reworking or drilling operations on the communitized area are commenced and are thereafter conducted with reasonable diligence during the period of nonproduction. The 2-year term of this agreement will not in itself serve to extend the term of any Federal lease which would otherwise expire during said period.
11. The covenants herein shall be construed to be covenants running with the land with respect to the communitized interests of the parties hereto and their successors in interests until this agreement terminates and any grant, transfer, or conveyance of any such land or interest subject hereto, whether voluntary or not, shall be and hereby is conditioned upon the assumption of all obligations hereunder by the grantee, transferee, or other successor in interest, and as to Federal land shall be subject to approval by the Secretary of the Interior, or his duly authorized representative.
12. It is agreed between the parties hereto that the Secretary of the Interior, or his duly authorized representative, shall have the right of supervision over all Fee and State mineral operations within the communitized area to the extent necessary to monitor production and measurement, and assure that no avoidable loss of hydrocarbons occur in which the United States has an interest pursuant to applicable oil and gas regulations of the Department of the Interior relating to such production and measurement.

13. This agreement shall be binding upon the parties hereto and shall extend to and be binding upon their respective heirs, executors, administrators, successors, and assigns.
14. This agreement may be executed in any number of counterparts, no one of which needs to be executed by all parties, or may be ratified or consented to by separate instrument, in writing, specifically referring hereto, and shall be binding upon all parties who have executed such a counterpart, ratification or consent hereto with the same force and effect as if all parties had signed the same document.
15. Nondiscrimination. In connection with the performance of work under this agreement, the operator agrees to comply with all the provisions of Section 202(1) to (7) inclusive, of Executive Order 11246 (30F.R. 12319), as amended, which are hereby incorporated by reference in this agreement.

IN WITNESS WHEREOF, the parties hereto have executed this agreement as of the day and year first above written and have set opposite their respective names the date of execution.

PERMIAN RESOURCES OPERATING, LLC
(Operator)

Date: 6/29/2023

By: 
Patrick Godwin, Vice President of Land

in RM

ACKNOWLEDGEMENT

STATE OF TEXAS)
) ss.
COUNTY OF MIDLAND)

On this 29th day of June 2023, before me, a Notary Public for the State of Texas, personally appeared Patrick Godwin, known to me to be the Vice President of Land of Permian Resources Operating, LLC, the corporation that executed the foregoing instrument and acknowledged to me such corporation executed the same.

(SEAL)

Notary Public



5-29-2026

My commission expires

PERMIAN RESOURCES OPERATING, LLC
(Working Interest Owner/Lessee of Record)

By:

[Signature]

Patrick Godwin – Vice President of Land

rw

Date: *6/29/2023*

ACKNOWLEDGEMENT

STATE OF TEXAS

)
) ss.
)

COUNTY OF MIDLAND

On this *29th* day of *June* 2023, before me, a Notary Public for the State of Texas, personally appeared Patrick Godwin, known to me to be the Vice President of Land of Permian Resources Operating, LLC, the corporation that executed the foregoing instrument and acknowledged to me such corporation executed the same.

(SEAL)



[Signature]
Notary Public

My commission expires *5-29-2026*

XTO HOLDINGS, LLC

(Lessee of Record/Working Interest Owner)

Date: 6-2-23By:  Name: ANGIE REPKATitle: COMMERCIAL & LAND MANAGER
AGENT & ATTORNEY - IN - FACT**ACKNOWLEDGEMENT**

(Representative Capacity)

STATE OF Texas)
) ss.
COUNTY OF Harris)

On this 2nd day of June, 2023 before me, a Notary Public for the State of Texas, personally appeared ANGIE REPKA - COMMERCIAL & LAND MANAGER known to me to be the AGENT & ATTORNEY - IN - FACT of XTO Holdings, LLC, the corporation that executed the foregoing instrument and acknowledged to me such corporation executed the same.

(SEAL)

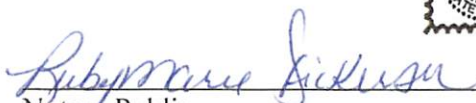
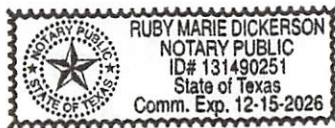
Notary Public12-15-2026
My commission expires**ACKNOWLEDGEMENT**

(Individual capacity)

STATE OF _____)
COUNTY OF _____)

On this ____ day of _____, 20____, before me, a Notary Public for the State of _____, personally appeared _____.

(SEAL)

Notary Public_____
My commission expires

**OCCIDENTAL PERMIAN LIMITED
PARTNERSHIP**

(Working Interest Owner/Lessee of Record)

Date: 6-20-2023By: Name: James LaningTitle: Attorney-in-Fact**ACKNOWLEDGEMENT**

(Representative Capacity)

STATE OF TEXAS)
) ss.
COUNTY OF HARRIS)On this 20th day of June, 2023, before me, a Notary Public for
the State of Texas, personally appeared James Laning
known to me to be the Attorney-in-Fact
of OCCIDENTAL PERMIAN LIMITED PARTNERSHIP, the corporation that executed the
foregoing instrument and acknowledged to me such corporation executed the same.

(SEAL)

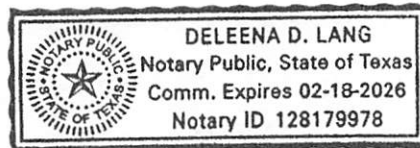
Notary Public

My commission expires _____

ACKNOWLEDGEMENT

(Individual capacity)

STATE OF _____)
COUNTY OF _____)On this _____ day of _____, 20____, before me, a Notary Public
for the State of _____, personally appeared _____.

(SEAL)

Notary Public_____
My commission expires

BEXP II Alpha, LLC
(Working Interest Owner/Lessee of Record)

Date: 4/10/23

By: [Signature]

Name: Keith P. Lilie

Title: CEO

ACKNOWLEDGEMENT

(Representative Capacity)

STATE OF Texas)

COUNTY OF Travis) ss.

On this 10th day of April, 2023 before me, a Notary Public for the State of Texas, personally appeared Keith P. Lilie known to me to be the CEO of BEXP II Alpha, LLC, the corporation that executed the foregoing instrument and acknowledged to me such corporation executed the same.

(SEAL)

[Signature: Nancy Panter]
Notary Public

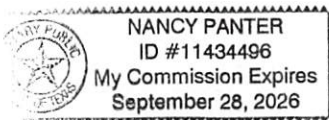

9/28/26
My commission expires

ACKNOWLEDGEMENT

(Individual capacity)

STATE OF _____)

COUNTY OF _____)

On this _____ day of _____, 20____, before me, a Notary Public for the State of _____, personally appeared _____.

(SEAL)

Notary Public

My commission expires

BEXP II OMEGA, LLC

(Working Interest Owner/Lessee of Record)

Date: 4/10/23By: [Signature]Name: Keith P. L. LieTitle: CEO**ACKNOWLEDGEMENT**

(Representative Capacity)

STATE OF Texas)
COUNTY OF Travis) ss.On this 10th day of April, 2023, before me, a Notary Public for the State of Texas, personally appeared Keith P. L. Lie known to me to be the CEO of BEXP II Omega, LLC, the corporation that executed the foregoing instrument and acknowledged to me such corporation executed the same.

(SEAL)

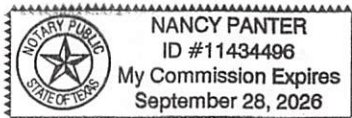
Notary Public [Signature]9/28/26
My commission expires**ACKNOWLEDGEMENT**

(Individual capacity)

STATE OF _____)
COUNTY OF _____)

On this ____ day of _____, 20____, before me, a Notary Public for the State of _____, personally appeared _____.

(SEAL)

Notary Public _____

My commission expires _____

INCLINE PERMIAN II, LLC
(Working Interest Owner/Lessee of Record)

Date: April 18, 2023

By: [Signature]

Name: Lee Johnston

Title: SVP Permian Basin

ACKNOWLEDGEMENT

(Representative Capacity)

STATE OF Texas)
) ss.
COUNTY OF Tarrant)

On this 18 day of April, 2023, before me, a Notary Public for the State of Texas, personally appeared Lee Johnston known to me to be the SVP Permian Basin of Incline Permian II, LLC, the corporation that executed the foregoing instrument and acknowledged to me such corporation executed the same.

(SEAL)

Ross Harvey
Notary Public

1-13-2026
My commission expires

ACKNOWLEDGEMENT

(Individual capacity)

STATE OF _____)
COUNTY OF _____)

On this ____ day of _____, 20____, before me, a Notary Public for the State of _____, personally appeared _____.

(SEAL)

Notary Public

My commission expires

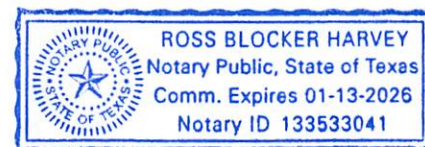

KASTLEFORD LAND, LLC

(Lessee of Record/Working Interest Owner)

Date: 5/1/23By: Name: BEN WILLIAMSTitle: MANAGER**ACKNOWLEDGEMENT**

(Representative Capacity)

STATE OF TEXAS)
) ss.
COUNTY OF MIDLAND)On this 1st day of MAY, 2023, before me, a Notary Public for the State of TEXAS, personally appeared BEN WILLIAMS known to me to be the MANAGER of KASTLEFORD LAND CO. LLC, the corporation that executed the foregoing instrument and acknowledged to me such corporation executed the same.

(SEAL)

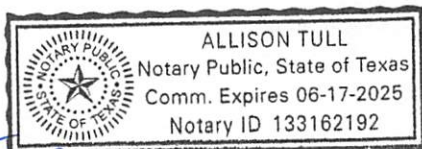
Notary Public06-17-2025
My commission expires**ACKNOWLEDGEMENT**

(Individual capacity)

STATE OF _____)
COUNTY OF _____)

On this ____ day of _____, 20____, before me, a Notary Public for the State of _____, personally appeared _____.

(SEAL)

Notary Public_____
My commission expires

SITL ENERGY, LLC

(Working Interest Owner/Lessee of Record)

Date: 4/11/23By: [Signature]Name: JOHN W. BURNS IITitle: PRESIDENT**ACKNOWLEDGEMENT**

(Representative Capacity)

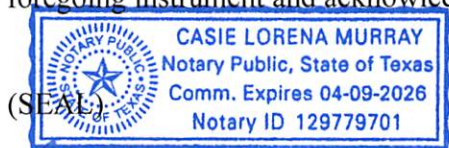
STATE OF Texas)
COUNTY OF Midland) ss.On this 11th day of April, 2023, before me, a Notary Public for the State of Texas, personally appeared John W. Burns II known to me to be the president of SITL Energy LLC, the corporation that executed the foregoing instrument and acknowledged to me such corporation executed the same.[Signature]
Notary Public04-09-2026
My commission expires**ACKNOWLEDGEMENT**

(Individual capacity)

STATE OF _____)
COUNTY OF _____)

On this ____ day of _____, 20____, before me, a Notary Public for the State of _____, personally appeared _____.

(SEAL)

Notary Public_____
My commission expires

EXHIBIT "A"

Plat of communitized area covering **480.00** acres in the W/2 of Section 15, T20S-R35E and the NW/4 of Section 22, T20S-R35E, Lea County, New Mexico, as written in Section 1 above.

Well Name/No.

Woody 22 Fed Com 501H

Woody 22 Fed Com 502H

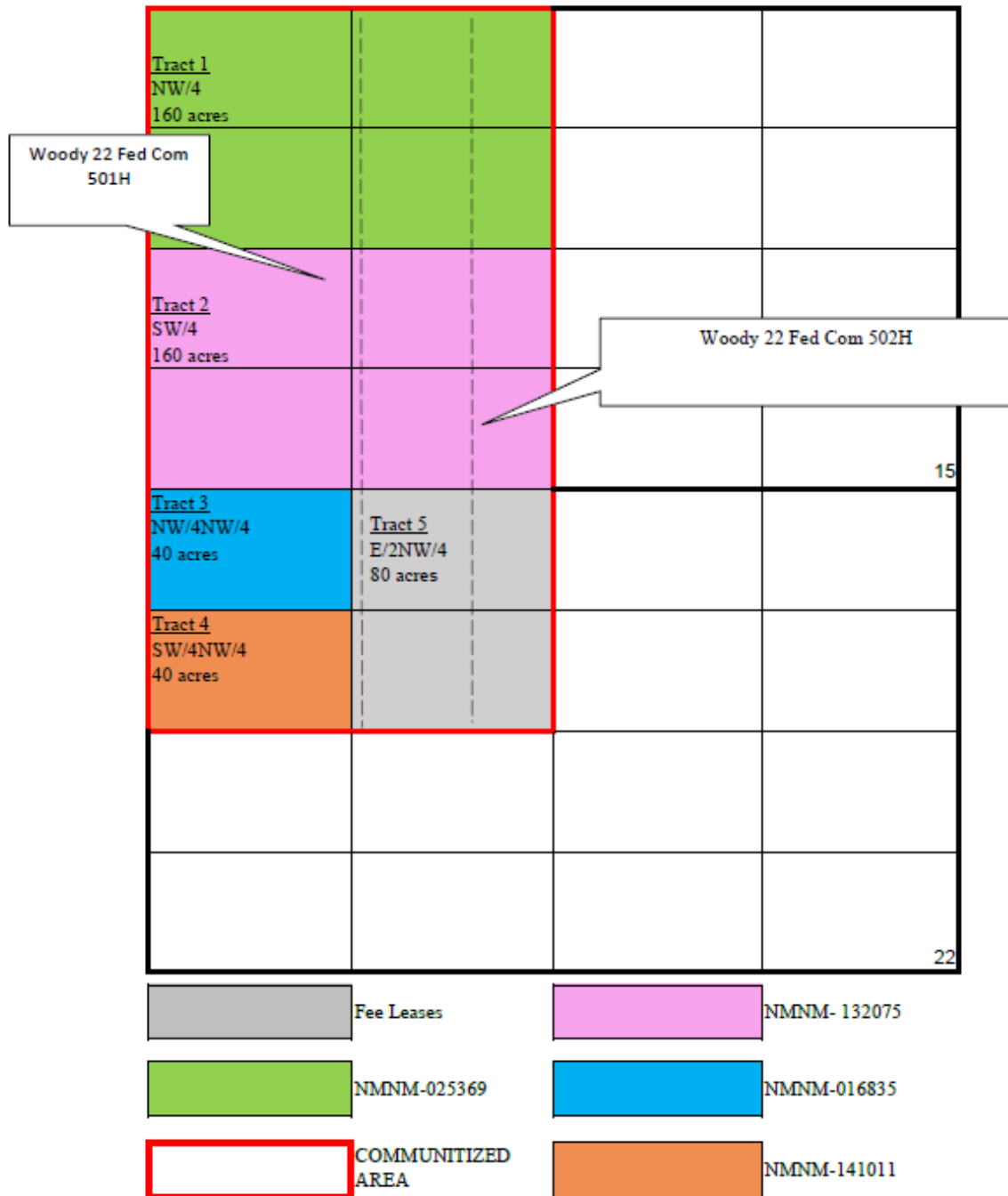

EXHIBIT "B"

To Communitization Agreement Dated March 1, 2023 embracing the following described land in the W/2 of Section 15, T20S-R35E and the NW/4 of Section 22, T20S-R35E, Lea County, New Mexico, as written in Section 1 above.

Operator of Communitized Area:

PERMIAN RESOURCES OPERATING, LLC**DESCRIPTION OF LEASES COMMITTED****TRACT NO. 1**

Lease Serial Number:	NMNM025369
Lease Date:	June 1, 1975
Lease Term:	10 years
Lessor:	United States of America
Original Lessee:	Weldon S. Abbott
Current Lessee of Record:	XTO Holdings, LLC
Description of Land Committed:	NW/4 of Section 15, T20S-R35E, Lea County, New Mexico
Number of Acres:	160.00 acres
Royalty Rate:	12.5%
Name and Percent ORRI Owners:	Andrea C. Wiggins – 0.00925000, Charles R. Wiggins – 0.00925000, Galley NM Assets, LLC – 0.00650000, Richard H. Coats and Sigrid M. Coats – 0.02000000, Tim Goudeau – 0.00500000, Five States Energy Company, LLC – 0.07500000
Name of Working Interest Owners:	Permian Resources Operating, LLC – 1.00000000

TRACT NO. 2

Lease Serial Number:	NMNM132075
Lease Date:	June 1, 2014
Lease Term:	10 years
Lessor:	United States of America
Original Lessee:	Apache Corporation
Current Lessee of Record:	Permian Resources Operating, LLC
Description of Land Committed:	SW/4 of Section 15, T20S-R35E, Lea County, New Mexico
Number of Acres:	160.00 acres
Royalty Rate:	12.5%
Name and Percent ORRI Owners:	Apache Corporation – 0.07500000
Name of Working Interest Owners:	Permian Resources Operating, LLC – 1.00000000

TRACT NO. 3

Lease Serial Number: NMNM016835
Lease Date: June 1, 1973
Lease Term: 10 years
Original Lessee: W. Oscar Neuhaus and Ben N. Neuhaus
Current Lessee of Record: XTO Holdings, LLC
Description of Land Committed: NW/4NW/4 of Section 22, T20S-R35E, Lea County, New Mexico
Number of Acres: 40.00 acres
Royalty Rate: 12.5%
Name and Percent ORRI Owners: Trustee of the W. Oscar Neuhaus Residuary Trust for Edward K. Neuhaus – 0.00500000, Trustee of the W. Oscar Neuhaus Residuary Trust for Laurance B. Neuhaus – 0.00500000, W. O. Neuhaus III & Kay F. Neuhaus as Co-Trustees of the W. O. III & Kay F. Neuhaus Rev. Trust – 0.00500000, Houston Trust Company, in its capacity as Trustee of the Howard F. Smith Jr. Trust F/B/O Louise Smith Neuhaus – 0.01500000
Name of Working Interest Owners: XTO Holdings, LLC – 1.0000000

TRACT NO. 4

Lease Serial Number: NMNM141011
Lease Date: January 1, 2021
Lease Term: 10 years
Original Lessee: KEW Drilling
Current Lessee of Record: Incline Permian II, LLC (RT Assignment from KEW to Incline is currently awaiting approval from the BLM)
Description of Land Committed: SW/4NW/4 of Section 22, T20S-R35E, Lea County, New Mexico
Number of Acres: 40.00 acres
Royalty Rate: 12.5%
Name and Percent ORRI Owners: Alpha-Omega Fund, LP – 0.00701114, Andy M. Quinn, Jr. & Nancy B. Quinn – 0.01026221, Banner III Holdings LLC – 0.01325992, Carolyn A. Streich Trust – 0.01282777, Comeups, LLC – 0.00513111, HED Enterprises, L.P. – 0.00052598, Jack C. Vaughn, Jr. – 0.00513111, John R. Sears, Jr. Trust u/a of Elma A. Sears – 0.00513111, KWF Enterprises, LP – 0.00052598, Margaret Seay Oglesby Allison Trust – 0.00513111,

MonkeyBear, LLC – 0.00513111, Petrasilva Partners, LP – 0.00128274, Revolution Energy Holding Company, LLC – 0.00769666, VEB Holdings, LLC – 0.00256556, Weathered Rock, LLC – 0.00338649

Name of Working Interest Owners: BEXP II Alpha, LLC – 0.10659575, BEXP II Omega, LLC – 0.14340425, Incline Permian II, LLC – 0.5000000, Kastleford Land Company, LLC – 0.02500000, SITL Energy, LLC – 0.22500000

TRACT NO. 5

Lease Type: Fee Leases
Description of Lands Committed: Insofar as leases cover the E/2NW/4 of Section 22, T20S-R35E, Lea County, New Mexico
Number of Acres: 80.00 acres
Lessee of Record: Occidental Permian Ltd.
Name of Working Interest Owners: Occidental Permian Ltd. – 1.00000000
Pooling Provision: Leases contain provisions authorizing pooling

End of Exhibit “B”

RECAPITULATION

<u>Tract No.</u>	<u>No. of Acres Committed</u>	<u>Percentage of Interest in Communitized Area</u>
1	160.00	33.333333%
2	160.00	33.333333%
3	40.00	08.333333 %
4	40.00	08.333333%
5	80.00	16.666667%
Total	480.00	100.000000%

Federal Communitization Agreement

Contract No. _____

THIS AGREEMENT entered into as of the 1st day of March, 2023, by and between the parties subscribing, ratifying, or consenting hereto, such parties being hereinafter referred to as "parties hereto."

WITNESSETH:

WHEREAS, the Act of February 25, 1920 (41 Stat. 437), as amended and supplemented, authorizes communitization or drilling agreements communitizing or pooling a Federal oil and gas lease, or any portion thereof, with other lands, whether or not owned by the United States, when separate tracts under such Federal lease cannot be independently developed and operated in conformity with an established well-spacing program for the field or area and such communitization or pooling is determined to be in the public interest; and

WHEREAS, the parties hereto own working, royalty or other leasehold interests, or operating rights under the oil and gas leases and lands subject to this agreement which cannot be independently developed and operated in conformity with the well-spacing program established for the field or area in which said lands are located; and

WHEREAS, the parties hereto desire to communitize and pool their respective mineral interests in lands subject to this agreement for the purpose of developing and producing communitized substances in accordance with the terms and conditions of this agreement:

NOW, THEREFORE, in consideration of the premises and the mutual advantages to the parties hereto, it is mutually covenanted and agreed by and between the parties hereto as follows:

1. The lands covered by this agreement (hereinafter referred to as "communitized area") are described as follows:

Township 20 South, Range 35 East:

Section 15: E/2

Lea County, New Mexico

Township 20 South, Range 35 East:

Section 22: NE/4

Lea County, New Mexico

Containing **480.00** acres, and this agreement shall include only the Bone Spring formation underlying said lands and the associated gaseous hydrocarbons hereafter referred to as "communitized substances," producible from such formation.

2. Attached hereto, and made a part of this agreement for all purposes is Exhibit "A", a plat designating the communitized area and, Exhibit "B", designating the operator of the communitized area and showing the acreage, percentage and ownership of oil and gas interests in all lands within the communitized area, and the authorization, if any, for communitizing or pooling any patented or fee lands within the communitized area.
3. The Operator of the communitized area shall be Permian Resources Operating, LLC, whose address is 300 N. Marienfeld Street, Suite 1000, Midland, Texas 79701. All matters of operations shall be governed by the operator under and pursuant to the terms and provisions of this agreement. A successor operator may be designated by the owners of the working interest in the communitized area and four (4) executed copies of a designation of successor operator shall be filed with the Authorized Officer.
4. Operator shall furnish the Secretary of the Interior, or his authorized representative, with a log and history of any well drilled on the communitized area, monthly reports of operations, statements of oil and gas sales and royalties and such other reports as are deemed necessary to compute monthly the royalty due the United States, as specified in the applicable oil and gas operating regulations.
5. The communitized area shall be developed and operated as an entirety, with the understanding and agreement between the parties hereto that all communitized substances produced there from shall be allocated among the leaseholds comprising said area in the proportion that the acreage interest of each leasehold bears to the entire acreage interest committed to this agreement.

If the communitized area approved in this Agreement contains unleased Federal lands, the value of $1/8^{\text{th}}$ or $12 \frac{1}{2}$ percent for the Federal lands, of the production that would be allocated to such Federal lands, described above, if such lands were leased, committed and entitled to participation, shall be payable as compensatory royalties to the Federal government. The remaining $7/8^{\text{th}}$ should be placed into an escrow account set up by the operator. Parties to the Agreement holding working interest in committed leases within the applicable communitized area are responsible for such royalty payments on the volume of the production reallocated from the unleased Federal lands to their communitized tracts as set forth in Exhibit "B" attached hereto. The value of such production subject to the payment of said royalties shall be determined pursuant to the method set forth in 30 CFR Part 1206 for the unleased Federal lands. Payment of compensatory royalties on the production reallocated from the unleased Federal lands to the committed tracts within the communitized area shall fulfill the Federal royalty obligation for such production. Payment of compensatory royalties, as provided herein, shall accrue

from the date the committed tracts in the communitized area that includes unleased Federal land receive a production allocation, and shall be due and payable by the last day of the calendar month next following the calendar month of actual production. Payment due under this provision shall end when the Federal tract is leased or when production of communitized substances ceases within the communitized area and the Communitization Agreement is terminated, whichever occurs first.

Any party acquiring a Federal lease of the unleased Federal lands included in the communitized area established hereunder, will be subject to this Agreement as of the effective date of the Federal leases to said party (ies). Upon issuance of the Federal lease and payment of its proportionate cost of the well, including drilling, completing and equipping the well, the acquiring party (ies) shall own the working interest described in the Tract, as described on Exhibit "B", and shall have the rights and obligations of said working interest as to the effective date of the Federal Lease.

6. The royalties payable on communitized substances allocated to the individual leases comprising the communitized area and the rentals provided for in said leases shall be determined and paid on the basis prescribed in each of the individual leases. Payments of rentals under the terms of leases subject to this agreement shall not be affected by this agreement except as provided for under the terms and provisions of said leases or as may herein be otherwise provided. Except as herein modified and changed, the oil and gas leases subject to this agreement shall remain in full force and effect as originally made and issued. It is agreed that for any Federal lease bearing a sliding- or step-scale rate of royalty, such rate shall be determined separately as to production from each communitization agreement to which such lease may be committed, and separately as to any noncommunitized lease production, provided, however, as to leases where the rate of royalty for gas is based on total lease production per day, such rate shall be determined by the sum of all communitized production allocated to such a lease plus any noncommunitized lease production.
7. There shall be no obligation on the lessees to offset any well or wells completed in the same formation as covered by this agreement on separate component tracts into which the communitized area is now or may hereafter be divided, nor shall any lessee be required to measure separately communitized substances by reason of the diverse ownership thereof, but the lessees hereto shall not be released from their obligation to protect said communitized area from drainage of communitized substances by a well or wells which may be drilled offsetting said area.
8. The commencement, completion, continued operation, or production of a well or wells for communitized substances on the communitized area shall be construed and considered as the commencement, completion, continued operation, or production on each and all of the lands within and comprising said communitized

area, and operations or production pursuant to this agreement shall be deemed to be operations or production as to each lease committed hereto.

9. Production of communitized substances and disposal thereof shall be in conformity with allocation, allotments, and quotas made or fixed by any duly authorized person or regulatory body under applicable Federal or State statutes. This agreement shall be subject to all applicable Federal and State laws or executive orders, rules and regulations, and no party hereto shall suffer a forfeiture or be liable in damages for failure to comply with any of the provisions of this agreement if such compliance is prevented by, or if such failure results from, compliance with any such laws, orders, rules or regulations.
10. The date of this agreement is March 1, 2023, and it shall become effective as of this date or from the onset of production of communitized substances, whichever is earlier upon execution by the necessary parties, notwithstanding the date of execution, and upon approval by the Secretary of the Interior or by his duly authorized representative, and shall remain in force and effect for a period of 2 years and for as long as communitized substances are, or can be, produced from the communitized area in paying quantities: Provided, that prior to production in paying quantities from the communitized area and upon fulfillment of all requirements of the Secretary of the Interior, or his duly authorized representative, with respect to any dry hole or abandoned well, this agreement may be terminated at any time by mutual agreement of the parties hereto. This agreement shall not terminate upon cessation of production if, within 60 days thereafter, reworking or drilling operations on the communitized area are commenced and are thereafter conducted with reasonable diligence during the period of nonproduction. The 2-year term of this agreement will not in itself serve to extend the term of any Federal lease which would otherwise expire during said period.
11. The covenants herein shall be construed to be covenants running with the land with respect to the communitized interests of the parties hereto and their successors in interests until this agreement terminates and any grant, transfer, or conveyance of any such land or interest subject hereto, whether voluntary or not, shall be and hereby is conditioned upon the assumption of all obligations hereunder by the grantee, transferee, or other successor in interest, and as to Federal land shall be subject to approval by the Secretary of the Interior, or his duly authorized representative.
12. It is agreed between the parties hereto that the Secretary of the Interior, or his duly authorized representative, shall have the right of supervision over all Fee and State mineral operations within the communitized area to the extent necessary to monitor production and measurement, and assure that no avoidable loss of hydrocarbons occur in which the United States has an interest pursuant to applicable oil and gas regulations of the Department of the Interior relating to such production and measurement.

- IN WITNESS WHEREOF, the parties hereto have executed this agreement as of the day and year first above written and have set opposite their respective names the date of execution.

Date: 7/17/2023

By:

Patrick Godwin, Vice President of Land

STATE OF TEXAS)
) ss.
COUNTY OF MIDLAND)

On this 17th day of July 2023, before me, a Notary Public for the State of Texas, personally appeared Patrick Godwin, known to me to be the Vice President of Land of Permian Resources Operating, LLC, the corporation that executed the foregoing instrument and acknowledged to me such corporation executed the same.

(SEAL)

Notary Public

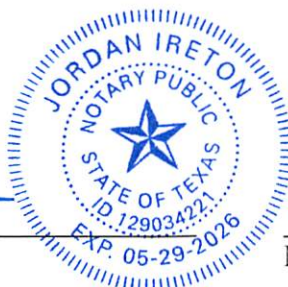

My commission expires _____

Date: 7/17/2023

By: 
Patrick Godwin – Vice President of Land

 $\uparrow \sim$

STATE OF TEXAS)
) ss.
COUNTY OF MIDLAND)

On this 17th day of July, 2023, before me, a Notary Public for the State of Texas, personally appeared Patrick Godwin, known to me to be the Vice President of Land of Permian Resources Operating, LLC, the corporation that executed the foregoing instrument and acknowledged to me such corporation executed the same.

(SEAL)

Notary Public

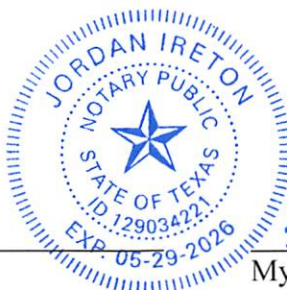

My commission expires

XTO HOLDINGS, LLC

(Lessee of Record/Working Interest Owner)

Date: 6-2-23By:  Name: ANGIE REPKA - COMMERCIAL 3 LAND MANAGERTitle: AGENT 3 ATTORNEY - IN-FACT**ACKNOWLEDGEMENT**

(Representative Capacity)

STATE OF TEXAS)
) ss.
COUNTY OF Harris)

On this 2nd day of JUNE, 2023, before me, a Notary Public for the State of Texas, personally appeared ANGIE REPKA - COMMERCIAL 3 LAND MANAGER known to me to be the AGENT 3 ATTORNEY - IN-FACT of XTO Holdings, LLC, the corporation that executed the foregoing instrument and acknowledged to me such corporation executed the same.

(SEAL)

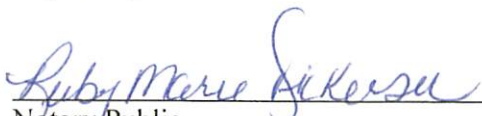
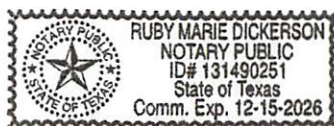
Notary Public12-15-2026
My commission expires**ACKNOWLEDGEMENT**

(Individual capacity)

STATE OF _____)
COUNTY OF _____)

On this ____ day of _____, 20____, before me, a Notary Public for the State of _____, personally appeared _____.

(SEAL)

Notary Public_____
My commission expires

KASTLEFORD LAND, LLC

(Lessee of Record/Working Interest Owner)

Date: 5/1/23By: [Signature]Name: BEN WILLIAMSTitle: MANAGER**ACKNOWLEDGEMENT**

(Representative Capacity)

STATE OF TEXAS)
) ss.
COUNTY OF MIDLAND)On this 1st day of MAY, 2023, before me, a Notary Public for the State of TEXAS, personally appeared BEN WILLIAMS known to me to be the MANAGER of KASTLEFORD LAND CO. LLC, the corporation that executed the foregoing instrument and acknowledged to me such corporation executed the same.

(SEAL)

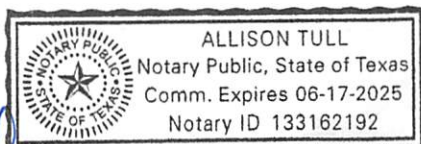
[Signature]
Notary Public06-17-2025
My commission expires**ACKNOWLEDGEMENT**

(Individual capacity)

STATE OF _____)
COUNTY OF _____)

On this ____ day of _____, 20____, before me, a Notary Public for the State of _____, personally appeared _____.

(SEAL)

Notary Public_____
My commission expires

DEVON ENERGY PRODUCTION CO., LP
(Working Interest Owner/Lessee of Record)

Date: 6-7-2023

By: [Signature]

Name: David M. Korell **DB**

Title: Land Manager

ACKNOWLEDGEMENT

(Representative Capacity)

STATE OF OKLAHOMA)
) ss.
COUNTY OF OKLAHOMA)

On this 7th day of June, 2023, before me, a Notary Public for the State of Oklahoma, personally appeared David M. Korell known to me to be the Land Manager of Devon Energy Production Company, L.P., the corporation that executed the foregoing instrument and acknowledged to me such corporation executed the same.

(SEAL)



Cynthia Sheldon
Notary Public

11-25-2025
My commission expires

ACKNOWLEDGEMENT

(Individual capacity)

STATE OF _____)
COUNTY OF _____)

On this _____ day of _____, 20____, before me, a Notary Public for the State of _____, personally appeared _____.

(SEAL)

Notary Public

My commission expires

EXHIBIT "A"

Plat of communitized area covering **480.00** acres in the E/2 of Section 15, T20S-R35E and the NE/4 of Section 22, T20S-R35E, Lea County, New Mexico, as written in Section 1 above.

Well Name/No.

Woody 22 Fed Com 503H

Woody 22 Fed Com 504H

Woody 22 Fed Com 505H

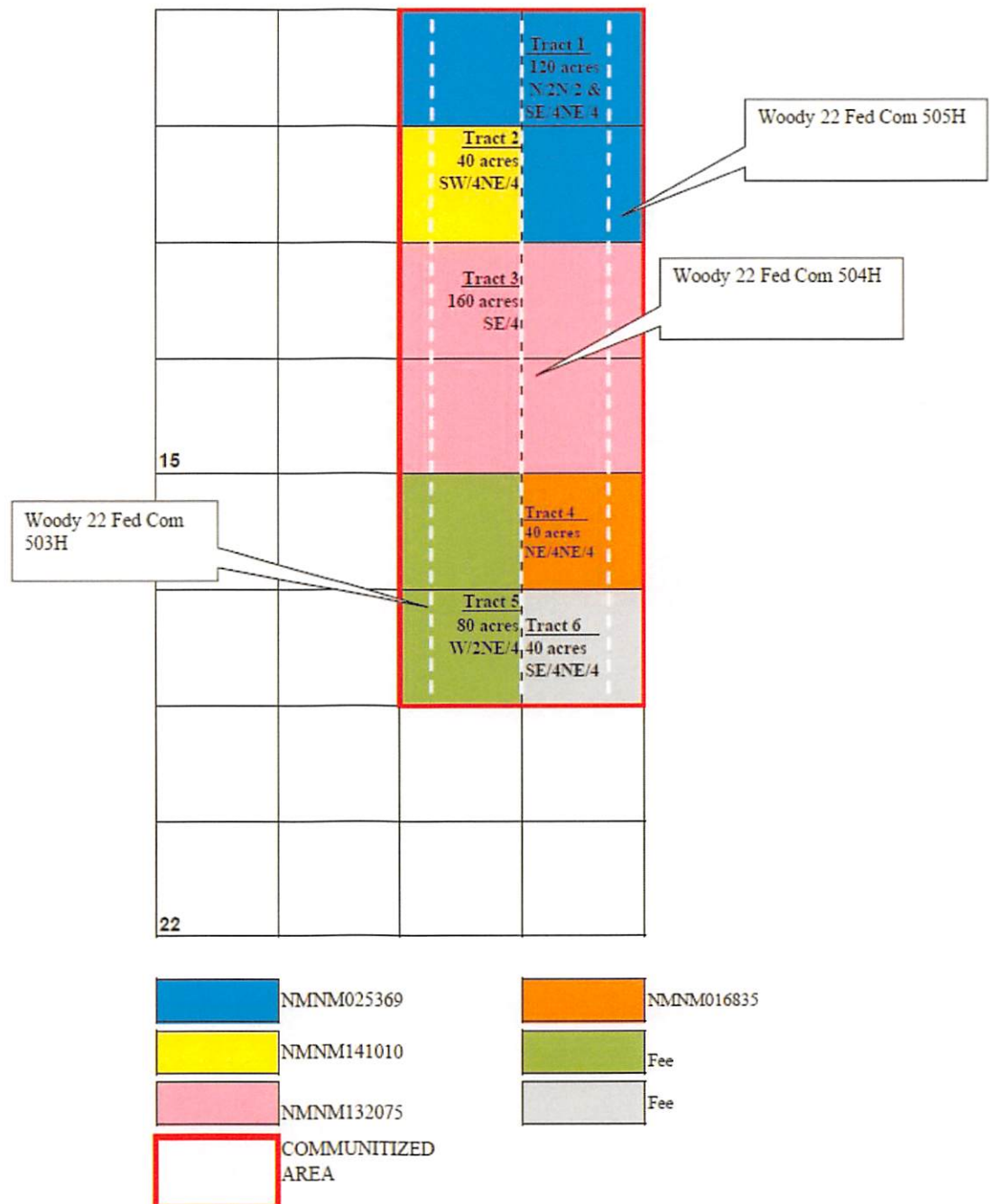

EXHIBIT "B"

To Communitization Agreement Dated March 1, 2023 embracing the following described land in the E/2 of Section 15, T20S-R35E and the NE/4 of Section 22, T20S-R35E, Lea County, New Mexico, as written in Section 1 above.

Operator of Communitized Area:

PERMIAN RESOURCES OPERATING, LLC

DESCRIPTION OF LEASES COMMITTED

TRACT NO. 1

Lease Serial Number:	NMNM025369
Lease Date:	June 1, 1975
Lease Term:	10 years
Lessor:	United States of America
Original Lessee:	Weldon S. Abbott
Current Lessee of Record:	XTO Holdings, LLC
Description of Land Committed:	N/2NE/4 & SE/4NE/4 of Section 15, T20S-R35E, Lea County, NM
Number of Acres:	120.00 acres
Royalty Rate:	12.5%
Name and Percent ORRI Owners:	Andrea C. Wiggins – 0.00925000, Charles R. Wiggins – 0.00925000, Galley NM Assets, LLC – 0.00650000, Richard H. Coats and Sigrid M. Coats – 0.02000000, Tim Goudeau – 0.00500000, Five States Energy Company, LLC – 0.07500000
Name of Working Interest Owners:	Permian Resources Operating, LLC – 1.00000000

TRACT NO. 2

Lease Serial Number:	NMNM141010
Lease Date:	January 1, 2021
Lease Term:	10 years
Lessor:	United States of America
Original Lessee:	Kastleford Land Co., LLC
Current Lessee of Record:	Kastleford Land Co., LLC
Description of Land Committed:	SW/4NE/4 of Section 15, T20S-R35E, Lea County, NM
Number of Acres:	40.00 acres
Royalty Rate:	12.5%
Name and Percent ORRI Owners:	N/A
Name of Working Interest Owners:	Kastleford Land Co., LLC – 1.00000000

TRACT NO. 3

Lease Serial Number: NMNM132075
Lease Date: June 1, 2014
Lease Term: 10 years
Lessor: United States of America
Original Lessee: Apache Corporation
Current Lessee of Record: Permian Resources Operating, LLC
Description of Land Committed: SE/4 of Section 15, T20S-R35E, Lea County, New Mexico
Number of Acres: 160.00 acres
Royalty Rate: 12.5%
Name and Percent ORRI Owners: Apache Corporation – 0.07500000
Name of Working Interest Owners: Permian Resources Operating, LLC – 1.00000000

TRACT NO. 4

Lease Serial Number: NMNM016835
Lease Date: June 1, 1973
Lease Term: 10 years
Original Lessee: W. Oscar Neuhaus and Ben N. Neuhaus
Current Lessee of Record: XTO Holdings, LLC
Description of Land Committed: NE/4NE/4 of Section 22, T20S-R35E, Lea County, New Mexico
Number of Acres: 40.00 acres
Royalty Rate: 12.5%
Name and Percent ORRI Owners: Trustee of the W. Oscar Neuhaus Residuary Trust for Edward K. Neuhaus – 0.00500000, Trustee of the W. Oscar Neuhaus Residuary Trust for Laurance B. Neuhaus – 0.00500000, W. O. Neuhaus III & Kay F. Neuhaus as Co-Trustees of the W. O. III & Kay F. Neuhaus Rev. Trust – 0.00500000, Houston Trust Company, in its capacity as Trustee of the Howard F. Smith Jr. Trust F/B/O Louise Smith Neuhaus – 0.01500000
Name of Working Interest Owners: Devon Energy Production Co., LP – 0.50000000, XTO Holdings, LLC – 0.50000000

Exhibit "B" cont. 'd on next page

TRACT NO. 5

Lease Type:	Fee Leases
Description of Lands Committed:	Insofar as leases cover the W/2NE/4 of Section 22, T20S-R35E, Lea County, New Mexico
Number of Acres:	80.00 acres
Lessee of Record:	Devon Energy Production Co., LP
Name of Working Interest Owners:	Devon Energy Production Co., LP – 1.00000000
Pooling Provision:	Leases contain provisions authorizing pooling

TRACT NO. 6

Lease Type:	Fee Leases
Description of Lands Committed:	Insofar as leases cover the SE/4NE/4 of Section 22, T20S-R35E, Lea County, New Mexico
Number of Acres:	40.00 acres
Lessee of Record:	Devon Energy Production Co., LP
Name of Working Interest Owners:	Devon Energy Production Co., LP. – 1.00000000
Pooling Provision:	Leases contain provisions authorizing pooling

End of Exhibit “B”

RECAPITULATION

<u>Tract No.</u>	<u>No. of Acres Committed</u>	<u>Percentage of Interest in Communitized Area</u>
1	120.00	25.000000%
2	40.00	08.333333%
3	160.00	33.333333%
4	40.00	08.333333%
5	80.00	16.666667%
6	40.00	08.333333%
Total	480.00	100.000000%

**STATE OF NEW MEXICO
ENERGY, MINERALS AND NATURAL RESOURCES DEPARTMENT
OIL CONSERVATION DIVISION**

APPLICATION FOR SURFACE COMMINGLING

**SUBMITTED BY PERMIAN RESOURCES OPERATING,
LLC**

ORDER NO. CTB-1184

ORDER

The Director of the New Mexico Oil Conservation Division (“OCD”), having considered the application and the recommendation of the OCD Engineering Bureau, issues the following Order.

FINDINGS OF FACT

1. Permian Resources Operating, LLC (“Applicant”) submitted a complete application to surface commingle the oil and gas production from the pools and leases described in Exhibit A (“Application”).
2. Applicant included a complete list of the wells currently dedicated to each pool and lease.
3. Applicant proposed a method to allocate the oil and gas production to the pools, leases, and wells to be commingled.
4. Applicant in the notice for the Application stated that it sought authorization to prospectively include additional pools and leases in accordance with 19.15.12.10(C)(4)(g) NMAC.
5. Applicant stated that it sought authorization to surface commingle and off-lease measure, as applicable, oil and gas production from wells which have not yet been approved to be drilled, but will produce from a pool and lease as described in Exhibit A.
6. Applicant provided notice of the Application to all persons owning an interest in the oil and gas production to be commingled, including the owners of royalty and overriding royalty interests, regardless of whether they have a right or option to take their interests in kind, and those persons either submitted a written waiver or did not file an objection to the Application.
7. Applicant provided notice of the Application to the Bureau of Land Management (“BLM”) or New Mexico State Land Office (“NMSLO”), as applicable.

CONCLUSIONS OF LAW

8. OCD has jurisdiction to issue this Order pursuant to the Oil and Gas Act, NMSA 1978, §§ 70-2-6, 70-2-11, 70-2-12, 70-2-16, and 70-2-17, 19.15.12. NMAC, and 19.15.23. NMAC.
9. Applicant satisfied the notice requirements for the Application in accordance with 19.15.12.10(A)(2) NMAC, 19.15.12.10(C)(4)(c) NMAC, and 19.15.12.10(C)(4)(e) NMAC, as applicable.

10. Applicant satisfied the notice requirements for the Application in accordance with 19.15.23.9(A)(5) NMAC and 19.15.23.9(A)(6) NMAC, as applicable.
11. Applicant's proposed method of allocation, as modified herein, complies with 19.15.12.10(B)(1) NMAC or 19.15.12.10(C)(1) NMAC, as applicable.
12. Commingling of oil and gas production from state, federal, or tribal leases shall not commence until approved by the BLM or NMSLO, as applicable, in accordance with 19.15.12.10(B)(3) NMAC and 19.15.12.10(C)(4)(h) NMAC.
13. Applicant satisfied the notice requirements for the subsequent addition of pools, leases, and wells in the notice for the Application, in accordance with 19.15.12.10(C)(4)(g) NMAC. Subsequent additions of pools, leases, and wells within Applicant's defined parameters, as modified herein, will not, in reasonable probability, reduce the commingled production's value or otherwise adversely affect the interest owners in the production to be added.
14. By granting the Application with the conditions specified below, this Order prevents waste and protects correlative rights, public health, and the environment.

ORDER

1. Applicant is authorized to surface commingle oil and gas production from the pools and leases as described in Exhibit A.

Applicant is authorized to surface commingle oil and gas production from the wells included in Exhibit A provided that they produce from a pool and lease described in Exhibit A.

Applicant is authorized to store and measure oil and gas production off-lease, as applicable, from the pools and leases as described in Exhibit A at a central tank battery or gas title transfer meter described in Exhibit A.

Applicant is authorized to surface commingle oil and gas production from wells not included in Exhibit A but that produce from a pool and lease as described in Exhibit A.

Applicant is authorized to store and measure oil and gas production off-lease, as applicable, from wells not included in Exhibit A but that produce from a pool and lease as described in Exhibit A at a central tank battery or gas title transfer meter described in Exhibit A.

2. The allocation of oil and gas production to wells not included in Exhibit A but that produce from a pool and lease as described in Exhibit A shall be determined in the same manner as to wells identified in Exhibit A that produce from that pool and lease, provided that if more than one allocation method is being used or if there are no wells identified in Exhibit A that produce from the pool and lease, then allocation of oil and gas production to each well not included in Exhibit A shall be determined by OCD prior to commingling production from it with the production from another well.

3. The oil and gas production for each well identified in Exhibit A shall be separated and metered prior to commingling it with production from another well.
4. If Applicant recovers oil or gas production from produced water prior to Applicant injecting it or transferring custody of it, then that production shall be allocated to each well in the proportion that it contributed to the total produced water.
5. If Applicant recovers gas production using a vapor recovery unit (VRU), then that gas production shall be allocated to each well in the proportion that it contributed to the total oil production.
6. Applicant shall measure and market the commingled oil at a central tank battery described in Exhibit A in accordance with this Order and 19.15.18.15 NMAC or 19.15.23.8 NMAC.
7. Applicant shall measure and market the commingled gas at a well pad, central delivery point, central tank battery, or gas title transfer meter described in Exhibit A in accordance with this Order and 19.15.19.9 NMAC, provided however that if the gas is vented or flared, and regardless of the reason or authorization pursuant to 19.15.28.8(B) NMAC for such venting or flaring, Applicant shall measure or estimate the gas in accordance with 19.15.28.8(E) NMAC.
8. Applicant shall calibrate the meters used to measure or allocate oil and gas production in accordance with 19.15.12.10(C)(2) NMAC.
9. Applicant shall install and utilize vessels that are appropriately designed to ensure sufficient separation of the fluids and to accurately measure oil and gas production.
10. If the commingling of oil and gas production from any pool, lease, or well reduces the value of the commingled oil and gas production to less than if it had remained segregated, no later than sixty (60) days after the decrease in value has occurred Applicant shall submit a new surface commingling application to OCD to amend this Order to remove the pool, lease, or well whose oil and gas production caused the decrease in value. If Applicant fails to submit a new application, this Order shall terminate on the following day, and if OCD denies the application, this Order shall terminate on the date of such action.
11. Applicant may submit an application to amend this Order to add pools, leases, and subsequently drilled wells with spacing units adjacent to or within the tracts commingled by this Order by submitting a Form C-107-B in accordance with 19.15.12.10(C)(4)(g) NMAC, provided the pools, leases, and subsequently drilled wells are within the identified parameters included in the Application.
12. If a well is not included in Exhibit A but produces from a pool and lease as described in Exhibit A, then Applicant shall submit Forms C-102 and C-103 to the OCD Engineering Bureau after the well has been approved to be drilled and prior to off-lease measuring or commingling oil or gas production from it with the production from another well. The Form

C-103 shall reference this Order and identify the well, proposed method to determine the allocation of oil and gas production to it, and the location(s) that commingling of its production will occur.

13. Applicant shall not commence commingling oil or gas production from state, federal, or tribal leases until approved by the BLM or NMSLO, as applicable.
14. If OCD determines that Applicant has failed to comply with any provision of this Order, OCD may take any action authorized by the Oil and Gas Act or the New Mexico Administrative Code (NMAC).
15. OCD retains jurisdiction of this matter and reserves the right to modify or revoke this Order as it deems necessary.

**STATE OF NEW MEXICO
OIL CONSERVATION DIVISION**



**ALBERT C. S. CHANG
DIRECTOR**

DATE: 1/9/2026

State of New Mexico
Energy, Minerals and Natural Resources Department

Exhibit A

Order: **CTB-1184**

Operator: **Permian Resources Operating, LLC (372165)**

Central Tank Battery: **Woody 22 Federal Com Central Tank Battery**

Central Tank Battery Location: **UL K, Section 22, Township 20 South, Range 35 East**

Gas Title Transfer Meter Location:

Pools

Pool Name	Pool Code
FEATHERSTONE;BONE SPRING	24250

Leases as defined in 19.15.12.7(C) NMAC

Lease	UL or Q/Q	S-T-R
CA Bone Spring NMNM 106306836	W2	15-20S-35E
	NW4	22-20S-35E
CA Bone Spring NMNM 106313547	E2	15-20S-35E
	NE4	22-20S-35E

Wells

Well API	Well Name	UL or Q/Q	S-T-R	Pool
30-025-51394	WOODY 22 FEDERAL COM #501H	W2	15-20S-35E	24250
		NW4	22-20S-35E	
30-025-51395	WOODY 22 FEDERAL COM #502H	W2	15-20S-35E	24250
		NW4	22-20S-35E	
30-025-51396	WOODY 22 FEDERAL COM #503H	W2E2	15-20S-35E	24250
		W2NE	22-20S-35E	
30-025-51397	WOODY 22 FEDERAL COM #504H	E2	15-20S-35E	24250
		NE4	22-20S-35E	
30-025-51398	WOODY 22 FEDERAL COM #505H	E2E2	15-20S-35E	24250
		E2NE	22-20S-35E	

Sante Fe Main Office
Phone: (505) 476-3441

General Information
Phone: (505) 629-6116

Online Phone Directory
<https://www.emnrd.nm.gov/ocd/contact-us>

State of New Mexico
Energy, Minerals and Natural Resources
Oil Conservation Division
1220 S. St Francis Dr.
Santa Fe, NM 87505

CONDITIONS

Action 278578

CONDITIONS

Operator: Permian Resources Operating, LLC 300 N. Marienfeld St Ste 1000 Midland, TX 79701	OGRID: 372165
	Action Number: 278578
	Action Type: [C-107] Surface Commingle or Off-Lease (C-107B)

CONDITIONS

Created By	Condition	Condition Date
sarah.clelland	Please review the content of the order to ensure you are familiar with the authorities granted and any conditions of approval. If you have any questions regarding this matter, please email us at OCD.Engineer@emnrd.nm.gov .	1/12/2026