

**CASE NO. 22648**

**APPLICATION OF MEWBOURNE OIL COMPANY FOR COMPULSORY POOLING  
EDDY COUNTY, NEW MEXICO**

**MEWBOURNE OIL COMPANY'S EXHIBIT LIST**

1. Application and Proposed Notice
2. Landman's Affidavit
3. Geologist's Affidavit
4. Affidavit of Mailing
5. Publication Affidavit
6. Pooling Checklist

**BEFORE THE NEW MEXICO OIL CONSERVATION DIVISION****APPLICATION OF MEWBOURNE OIL COMPANY  
FOR COMPULSORY POOLING, EDDY COUNTY,  
NEW MEXICO.**Case No. 22648**APPLICATION**

Mewbourne Oil Company applies for an order pooling all uncommitted mineral interest owners in the Bone Spring formation underlying a horizontal spacing unit comprised of the S $\frac{1}{2}$ SE $\frac{1}{4}$  of Section 28 and the S $\frac{1}{2}$ S $\frac{1}{2}$  of Section 27, Township 20 South, Range 27 East, N.M.P.M., Eddy County, New Mexico, and in support thereof, states:

1. Applicant is an interest owner in the S $\frac{1}{2}$ SE $\frac{1}{4}$  of Section 28 and the S $\frac{1}{2}$ S $\frac{1}{2}$  of Section 27, and has the right to drill a well thereon.
2. Applicant proposes to drill the Nina 28/27 B3OP Fed. Com. Well No. 1H to a depth sufficient to test the Bone Spring formation, and to dedicate the S $\frac{1}{2}$ SE $\frac{1}{4}$  of Section 28 and the S $\frac{1}{2}$ S $\frac{1}{2}$  of Section 27 to the well. The well is a horizontal well, with a first take point in the SW $\frac{1}{4}$ SE $\frac{1}{4}$  of Section 28 and a last take point in the SE $\frac{1}{4}$ SE $\frac{1}{4}$  of Section 27.
3. Applicant has in good faith sought to obtain the voluntary joinder of all other mineral interest owners in the S $\frac{1}{2}$ SE $\frac{1}{4}$  of Section 28 and the S $\frac{1}{2}$ S $\frac{1}{2}$  of Section 27 for the purposes set forth herein.
4. Although applicant attempted to obtain voluntary agreements from all mineral interest owners to participate in the drilling of the well or to otherwise commit their interests to the well, certain interest owners have failed or refused to join in dedicating their interests. Therefore, applicant seeks an order pooling all mineral interest owners in the Bone Spring

EXHIBIT **1**

formation underlying S $\frac{1}{2}$ SE $\frac{1}{4}$  of Section 28 and the S $\frac{1}{2}$ S $\frac{1}{2}$  of Section 27, pursuant to NMSA 1978 §70-2-17.

5. The pooling of all mineral interest owners in the Bone Spring formation underlying the S $\frac{1}{2}$ SE $\frac{1}{4}$  of Section 28 and the S $\frac{1}{2}$ S $\frac{1}{2}$  of Section 27 will prevent the drilling of unnecessary wells, prevent waste, and protect correlative rights.

**WHEREFORE**, applicant requests that, after notice and hearing, the Division enter its order:

- A. Pooling all mineral interest owners in the Bone Spring formation underlying the S $\frac{1}{2}$ SE $\frac{1}{4}$  of Section 28 and the S $\frac{1}{2}$ S $\frac{1}{2}$  of Section 27;
- B. Designating applicant as operator of the well;
- C. Considering the cost of drilling, completing, and equipping the well, and allocating the cost among the well's working interest owners;
- D. Approving actual operating charges and costs charged for supervision, together with a provision adjusting the rates pursuant to the COPAS accounting procedure; and
- E. Setting a 200% charge for the risk involved in drilling, completing, and equipping the well in the event a working interest owner elects not to participate in the well.

Respectfully submitted,

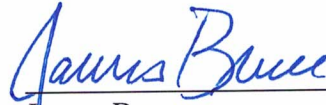

James Bruce  
Post Office Box 1056  
Santa Fe, New Mexico 87504  
(505) 982-2043

Attorney for Mewbourne Oil Company

***Application of Mewbourne Oil Company for compulsory pooling, Eddy County, New Mexico.***

Mewbourne Oil Company seeks an order pooling all uncommitted mineral interest owners in the Bone Spring formation underlying a horizontal spacing unit comprised of the S/2SE/4 of Section 28 and the S/2S/2 of Section 27, Township 20 South, Range 27 East, NMPM. The unit will be dedicated to the Nina 28/27 B3OP Fed. Com. Well No. 1H, a horizontal well with a first take point in the SW/4SE/4 of Section 28 and a last take point in the SE/4SE/4 of Section 27. Also to be considered will be the cost of drilling, completing, and equipping the well and the allocation of the cost thereof, as well as actual operating costs and charges for supervision, designation of applicant as operator of the well, and a 200% charge for the risk involved in drilling, completing, and equipping the well. The unit is located approximately 9 miles southeast of Lakewood, New Mexico.

STATE OF NEW MEXICO  
ENERGY, MINERALS AND NATURAL RESOURCES DEPARTMENT  
OIL CONSERVATION DIVISION

**IN THE MATTER OF THE HEARING CALLED  
BY THE OIL CONSERVATION DIVISION FOR  
THE PURPOSE OF CONSIDERING:**

**APPLICATION OF MEWBOURNE OIL COMPANY  
FOR COMPULSORY POOLING, EDDY COUNTY,  
NEW MEXICO.**

**Case No. 22648**

**SELF-AFFIRMED STATEMENT OF BRAXTON BLANDFORD**

Braxton Blandford deposes and states:

1. I am a landman for Mewbourne Oil Company ("Mewbourne"), and have personal knowledge of the matters stated herein. My educational and work experience is as follows:

I graduated from Texas Tech University in May 2021 from the Energy Commerce program in the Rawls College of Business. I started working full time for Mewbourne Oil Company June 21, 2021, following my internship in the Summer of 2020.

2. Pursuant to Division Rules, the following information is submitted in support of the compulsory pooling application filed herein:

3. The purpose of this application is to force pool working interest owners into the Bone Spring horizontal spacing unit described below, and in wells to be drilled in the unit.

4. No opposition is expected because the interest owners being pooled have been contacted regarding the proposed wells, but have failed or refused to voluntarily commit their interests to the well.

5. A plat outlining the units being pooled is submitted as Attachment A. Mewbourne seeks orders pooling all mineral interests in the Bone Spring formation underlying a horizontal spacing unit comprised of the S/2 SE/4 of Section 28 and the S/2 S/2 of Section 27, Township 20 South, Range 27 East, NMPM. The unit will be dedicated to the Nina 28/27 B3OP Fed Com. Well No. 1H, with a first take point in the SW/4 SE/4 of Section 28 and a last take point in the SE/4 SE/4 of Section 27. There is no depth severance in the Bone Spring formation.

A form C-102 for the well is also submitted as part of Attachment A.

EXHIBIT

2

6. The parties being pooled, and their interests, are set forth in Attachment B. Attachment C is a summary of communications and a sample copy of the proposal letters sent to the uncommitted working interest owners.

7. Some interest owners may be unlocatable. In order to locate the interest owners Mewbourne examined the records of Eddy County, State Land Office records, and the Bureau of Land Management records. In addition, we conducted internet searches using Drilling Info, Accurint, and generic name searches on Google.

Mewbourne has made a good faith effort to locate and obtain the voluntary joinder of the working interest owners in the proposed well.

8. Mewbourne has the right to pool the overriding royalty owners in the well unit.

9. Attachment D contains the Authorization for Expenditure for the proposed well. The estimated costs of the wells set forth therein are fair and reasonable, and comparable to the costs of other wells of similar depth and length drilled in this area of Eddy County.

10. Mewbourne requests overhead and administrative rates of \$8000/month for a drilling well and \$800/month for a producing well. These rates are fair, and comparable to the rates charged by other operators for wells of this type in this portion of Eddy County. They are also the rates set forth in the Joint Operating Agreement for the well unit. Mewbourne requests that these rates be adjusted periodically as provided in the COPAS Accounting Procedure.

11. Mewbourne requests that the maximum cost plus 200% risk charge be assessed against non-consenting working interest owners.

12. Mewbourne requests that it be designated operator of the well.

13. The attachments to this affidavit were prepared by me, or compiled from company business records.

14. The granting of this application is in the interests of conservation and the prevention of waste.

I understand that this Self-Affirmed Statement will be used as written testimony in this case. I affirm that my testimony in paragraphs 1 through 14 above is true and correct and is made under penalty of perjury under the laws of the State of New Mexico. My testimony is made as of the date handwritten next to my signature below.

Date: 4/6/2022

Braxton Blandford  
Braxton Blandford

Nina 28-27 B3OP FED COM #1H



ATTACHMENT



District I  
1625 N. French Dr., Hobbs, NM 88240  
Phone: (575) 393-6161 Fax: (575) 393-0720  
District II  
811 S. First St., Artesia, NM 88210  
Phone: (575) 748-1283 Fax: (575) 748-9720  
District III  
1000 Rio Brazos Road, Aztec, NM 87410  
Phone: (505) 334-6178 Fax: (505) 334-6170  
District IV  
1220 S. St. Francis Dr., Santa Fe, NM 87505  
Phone: (505) 476-3460 Fax: (505) 476-3462

State of New Mexico  
Energy, Minerals & Natural Resources Department  
OIL CONSERVATION DIVISION  
1220 South St. Francis Dr.  
Santa Fe, NM 87505

Form C-102  
Revised August 1, 2011  
Submit one copy to appropriate  
District Office

☐ AMENDED REPORT

WELL LOCATION AND ACREAGE DEDICATION PLAT

<sup>1</sup> API Number	<sup>2</sup> Pool Code	<sup>3</sup> Pool Name
<sup>4</sup> Property Code	<sup>5</sup> Property Name <b>NINA 28/27 B30P FED COM</b>	
<sup>7</sup> OGRID NO.	<sup>8</sup> Operator Name <b>MEWBOURNE OIL COMPANY</b>	<sup>6</sup> Well Number <b>1H</b>
		<sup>9</sup> Elevation <b>3209'</b>

<sup>10</sup> Surface Location

UL or lot no.	Section	Township	Range	Lot Idn	Feet from the	North/South line	Feet From the	East/West line	County
<b>N</b>	<b>28</b>	<b>20S</b>	<b>27E</b>		<b>1000</b>	<b>SOUTH</b>	<b>2540</b>	<b>WEST</b>	<b>EDDY</b>

<sup>11</sup> Bottom Hole Location If Different From Surface

UL or lot no.	Section	Township	Range	Lot Idn	Feet from the	North/South line	Feet from the	East/West line	County
<b>P</b>	<b>27</b>	<b>20S</b>	<b>27E</b>		<b>440</b>	<b>SOUTH</b>	<b>100</b>	<b>EAST</b>	<b>EDDY</b>

<sup>12</sup> Dedicated Acres	<sup>13</sup> Joint or Infill	<sup>14</sup> Consolidation Code	<sup>15</sup> Order No.

No allowable will be assigned to this completion until all interest have been consolidated or a non-standard unit has been approved by the division.

<p><sup>16</sup></p> <p><u>CORNER DATA</u> NAD 83 GRID - NM EAST</p> <p><u>GEODETIC DATA</u> NAD 83 GRID - NM EAST N: 560186.1 - E: 555712.4 LAT: 32.5400007° N LONG: 104.2866855° W</p> <p><u>SURFACE LOCATION</u> N: 559585.8 - E: 563668.2 LAT: 32.5383384° N LONG: 104.2608695° W</p> <p><u>BOTTOM HOLE</u> N: 559585.8 - E: 563668.2 LAT: 32.5383384° N LONG: 104.2608695° W</p> <p><u>FOUND BRASS CAP "1934"</u> A: N 559216.9 - E 553169.5 B: N 561871.2 - E 553179.3 C: CALCULATED CORNER N 564525.5 - E 553189.8 D: FOUND BRASS CAP "1942" N 564496.2 - E 555846.6 E: FOUND BRASS CAP "1942" N 564470.0 - E 558504.7 F: FOUND BRASS CAP "1942" N 564416.2 - E 561154.1</p> <p><u>FOUND BRASS CAP "1942"</u> G: N 564411.2 - E 563796.1 H: N 561778.2 - E 563779.6 I: N 559145.3 - E 563765.8 J: N 559161.8 - E 561127.5 K: N 559153.2 - E 558477.3 L: N 561826.2 - E 558488.9</p> <p><u>Diagram Description:</u> A plat map showing sections 27 and 28 of Township 20S, Range 27E, Eddy County, NM. The plat shows a well location (B.H.) at the intersection of a 1000' line from the surface location and a 440' line from the bottom hole location. The well is located in Section 28, 1000' from the surface location and 440' from the bottom hole location. The diagram includes corner data, geodetic data, surface location, and bottom hole location. The well is located in Section 28, 1000' from the surface location and 440' from the bottom hole location. The diagram includes corner data, geodetic data, surface location, and bottom hole location.</p>	<p><sup>17</sup> <b>OPERATOR CERTIFICATION</b> I hereby certify that the information contained herein is true and complete to the best of my knowledge and belief, and that this organization either owns a working interest or unleased mineral interest in the land including the proposed bottom hole location or has a right to drill this well at this location pursuant to a contract with an owner of such a mineral or working interest, or to a voluntary pooling agreement or a compulsory pooling order heretofore entered by the division.</p> <p>Signature _____ Date _____</p> <p>Printed Name _____</p> <p>E-mail Address _____</p> <p><sup>18</sup> <b>SURVEYOR CERTIFICATION</b> I hereby certify that the well location shown on this plat was plotted from field notes of actual surveys made by me or under my supervision, and that the same is true and correct to the best of my belief.</p> <p><b>04/05/2022</b> Date of Survey</p> <p>Signature and Seal of Professional Surveyor _____</p> <p><b>19680</b> Certificate Number</p> <p><b>Job No.: LS22040399</b></p>
---	---

Section Plat Nina 28/27 B3OP Fed Com #1H All of Section 27 & E/2 of Section 28 T20S-R27E, Eddy County, New Mexico		
Section 28	Section 27	
Tract 1	Tract 2	

**Tract 1: S/2 SE/4 of Section 28-Fed Lease NMIC-0072015C**

Mewbourne Oil Company  
Tascosa Energy Partners LLC  
Canyon Draw Resources LLC  
Sabinal Energy Operating LLC

**Tract 2: S/2 S/2 of Section 27-State Lease VO-2394-0002**

Mewbourne Oil Company  
Bail Oil & Gas LLC  
Baine Biggie  
Jalapeño Corporation  
Scott Lane & Dana Jan Buckles  
Wade P Carrigan  
Chevron USA Inc  
JTD Resources

Hutchings Oil Company  
The James K Lusk and Martha L Lusk Trust  
SSB Production LC  
Highland Texas Energy  
Samuel Max Mordka Trust

**RECAPITULATION FOR NINA 28/27 B3OP FED COM #1H**

Tract Number	Number of Acres Committed	Percentage of Interest in Communitized Area
1	80	33.33333%
2	160	66.66667%
<b>TOTAL</b>	<b>240</b>	<b>100.000000%</b>

ATTACHMENT

**B**

TRACT OWNERSHIP		
<u>S/2 SE/4 of Section 28 &amp; S/2 S/2 of Section 27</u>		
<u>Bone Spring Formation:</u>		
Owner		<u>% of Leasehold Interest</u>
Mewbourne Oil Company, et al.		94.591467%
*Sabinal Energy Operating, LLC		1.075200%
1780 Hughes Landing Boulevard, Suite 1200		
The Woodlands, TX 77380		
*Bane Bigbie		1.333333%
PO Box 998		
Ardmore, OK 73402-0998		
*JTD Resources		0.333333%
PO Box 3422		
Midland, TX 79702		
*The James K Lusk and Martha L Lusk Trust		0.666667%
PO Box 1310		
Wilsonville, Oregon 97070		
*SSB Production LC		2.000000%
PO Box 998		
Ardmore, OK 73402		
<b>TOTAL</b>		<b>100.000000%</b>
<b>Total Interest Being Pooled:</b>	<b>5.408533%</b>	
<u>OWNERSHIP BY TRACT</u>		
<u>S/2 SE/4 of Section 28</u>		
Owner		<u>% of Leasehold Interest</u>
Mewbourne Oil Company, et al		96.774400%
Sabinal Energy Operating, LLC		3.225600%
<b>TOTAL</b>		<b>100.000000%</b>
<u>S/2 S/2 of Section 27</u>		
Owner		<u>% of Leasehold Interest</u>
Mewbourne Oil Company, et al		93.500000%
Bane Bigbie		2.000000%
JTD Resources		0.500000%
The James K Lusk and Martha L Lusk Trust		1.000000%
SSB Production LC		3.000000%
<b>TOTAL</b>		<b>100.000000%</b>

Summary of Communications

Nina 28/27 B3OP Fed Com #1H

Pinta 28/29 B3NM Fed Com #1H

T20S-R27E, Eddy County, NM

OXY USA WTP LP

10/26/2021: Phone correspondence with the above listed party regarding the Well Proposal and Working interest unit.

11/11/2021: Phone correspondence with the above listed party regarding the Well Proposal and Working interest unit.

11/17/2021: Phone correspondence with the above listed party regarding the Well Proposal and Working interest unit.

COG Operating, LLC

10/26/2021: Phone correspondence with the above listed party regarding the Well Proposal and Working interest unit.

11/3/2021: Email correspondence with the above listed party regarding the Well Proposal and Working interest unit. Called and left a voicemail.

11/10/2021: Called the above listed party and left a voicemail.

11/16/2021: Phone correspondence with the above listed party regarding the Well Proposal and Working interest unit.

12/3/2021: Email correspondence with the above listed party regarding the Well Proposal and Working interest unit.

12/16/2021: Phone correspondence with the above listed party regarding the Well Proposal and Working interest unit.

12/22/2021: Phone correspondence with the above listed party regarding the Well Proposal and Working interest unit.

1/11/2022: Phone correspondence with the above listed party regarding the Well Proposal and Working interest unit.

SSB Production, LC

10/21/2021: Phone correspondence with the above listed party regarding the Well Proposal and Working interest unit.

11/2/2021: Phone correspondence with the above listed party regarding the Well Proposal and Working interest unit.

ATTACHMENT



12/16/2021: Email correspondence with the above listed party regarding the Well Proposal and Working interest unit.

1/17/2022: Email correspondence with the above listed party regarding the Well Proposal and Working interest unit.

**Bane Bigbie**

10/21/2021: Phone correspondence with the above listed party regarding the Well Proposal and Working interest unit.

11/2/2021: Phone correspondence with the above listed party regarding the Well Proposal and Working interest unit.

12/16/2021: Email correspondence with the above listed party regarding the Well Proposal and Working interest unit.

1/17/2022: Email correspondence with the above listed party regarding the Well Proposal and Working interest unit.

**The James K Lusk and Martha L Lusk Trust**

12/11/2021: Mailed Working Interest Unit, Well Proposal and Joint operating Agreement to the above listed party. Proof of delivery is attached.

Failed to find a good point of contact.

**JTD Resources**

12/6/2021: Phone correspondence with the above listed party regarding the Well Proposal and Working interest unit.

1/7/2022: Phone correspondence with the above listed party regarding the Well Proposal and Working interest unit.

1/11/2022: Phone correspondence with the above listed party regarding the Well Proposal and Working interest unit.

2/3/2022: Called above listed party and left a voicemail.

**Sabinal Energy Operating, LLC**

11/18/2021: Email correspondence with the above listed party regarding the Well Proposal and Working interest unit.

12/2/2021: Phone correspondence with the above listed party regarding the Well Proposal and Working interest unit.

12/16/2021: Phone correspondence with the above listed party regarding the Well Proposal and Working interest unit.

1/12/2022: Email correspondence with the above listed party regarding the Well Proposal and Working interest unit.

3/2/2022: Phone correspondence with the above listed party regarding the Well Proposal and Working interest unit.

**NimTex Energy, LLC**

1/26/2022: Phone correspondence with the above listed party regarding the Working interest unit.

1/28/2022: Email correspondence with the above listed party regarding the Working interest unit.

**Carol Mae Davis**

1/5/2022: Mailed Working Interest Unit, Well Proposal and Joint operating Agreement to the above listed party. Proof of delivery is attached.

2/25/2022: Phone correspondence with the above listed party regarding the Well Proposal and Working interest unit.

**Marie Cleveland George**

1/5/2022: Mailed Working Interest Unit, Well Proposal and Joint operating Agreement to the above listed party. Proof of delivery is attached.

1/25/2022: Email correspondence with the above listed party regarding the Well Proposal and Working interest unit.

1/27/2022: Phone correspondence with the above listed party regarding the Well Proposal and Working interest unit.

**Edna Laura Criswell Blankenship**

1/5/2022: Mailed Working Interest Unit, Well Proposal and Joint operating Agreement to the above listed party. Proof of delivery is attached.

1/18/2022: Email correspondence with the above listed party regarding the Well Proposal and Working interest unit.

3/3/2022: Phone/Email correspondence with the above listed party regarding the Well Proposal and Working interest unit.

**Mary Josephine Criswell Lee**

1/5/2022: Mailed Working Interest Unit, Well Proposal and Joint operating Agreement to the above listed party. Proof of delivery is attached.

1/5/2022: Email correspondence with the above listed party regarding the working interest unit. Proposal is attached

**John Claude Criswell**

1/5/2022: Mailed Working Interest Unit, Well Proposal and Joint operating Agreement to the above listed party. Proof of delivery is attached.

1/5/2022: Email correspondence with the above listed party regarding the working interest unit.  
Proposal is attached

**Jesse Harold Criswell**

11/9/2021: Email correspondence with the above listed party regarding the working interest unit.  
Proposal is attached

12/1/2021: Phone correspondence with the above listed party regarding the working interest unit.

1/10/2022: Email correspondence with the above listed party regarding the working interest unit.  
Proposal is attached

**The Heirs or Devisees of John C Moore**

1/5/2022: Mailed Working Interest Unit, Well Proposal and Joint operating Agreement to the above listed party. Proof of delivery is attached.

Failed to find a good point of contact

**Bobbie S Davis**

1/5/2022: Mailed Working Interest Unit, Well Proposal and Joint operating Agreement to the above listed party. Proof of delivery is attached.

Failed to find a good point of contact

**Velma Walters Moore**

1/5/2022: Mailed Working Interest Unit, Well Proposal and Joint operating Agreement to the above listed party. Proof of delivery is attached.

1/31/2022: Phone correspondence with the above listed party regarding the Well Proposal and Working interest unit.

**Billie Beth Moore**

1/5/2022: Mailed Working Interest Unit, Well Proposal and Joint operating Agreement to the above listed party. Proof of delivery is attached.

1/31/2022: Phone correspondence with the above listed party regarding the Well Proposal and Working interest unit.

**Scott Martin Carter**

1/5/2022: Mailed Working Interest Unit, Well Proposal and Joint operating Agreement to the above listed party. Proof of delivery is attached.

Failed to find a good point of contact

**Mary Christi Carter Daniels**

1/5/2022: Mailed Working Interest Unit, Well Proposal and Joint operating Agreement to the above listed party. Proof of delivery is attached.

Failed to find a good point of contact

**Carl Mack Carter**

1/5/2022: Mailed Working Interest Unit, Well Proposal and Joint operating Agreement to the above listed party. Proof of delivery is attached.

Failed to find a good point of contact

**Hettie Patton Davis**

1/5/2022: Mailed Working Interest Unit, Well Proposal and Joint operating Agreement to the above listed party. Proof of delivery is attached.

Failed to find a good point of contact

**Shirley Carole Hoyt Sheats**

1/5/2022: Mailed Working Interest Unit, Well Proposal and Joint operating Agreement to the above listed party. Proof of delivery is attached.

Failed to find a good point of contact

**Kathryn Sheats Johnson**

1/5/2022: Mailed Working Interest Unit, Well Proposal and Joint operating Agreement to the above listed party. Proof of delivery is attached.

1/6/2022: Email correspondence with the above listed party regarding the Well Proposal and Working interest unit.

1/10/2022: Phone correspondence with the above listed party regarding the Well Proposal and Working interest unit.

1/18/2022: Phone correspondence with the above listed party regarding the Well Proposal and Working interest unit.

2/25/2022: Email correspondence with the above listed party regarding the Well Proposal and Working interest unit.

**Lena Mae Ellis**

1/5/2022: Mailed Working Interest Unit, Well Proposal and Joint operating Agreement to the above listed party. Proof of delivery is attached.

1/19/2022: Phone correspondence with the above listed party regarding the Well Proposal and Working interest unit.

## MEWBOURNE OIL COMPANY

FASKEN CENTER  
500 WEST TEXAS, SUITE 1020  
MIDLAND, TX 79701

TELEPHONE (432) 682-3715  
FACSIMILE (432) 685-4170

October 8, 2021

Certified Mail

Sabinal Energy Operating, LLC  
1780 Hughes Landing Boulevard, Suite 1200  
The Woodlands, TX 77380

Re: Nina 28/27 B3OP Fed Com #1H and Pinta 28/29 B3NM Fed Com #1H  
440' FSL & 2540' FEL (Section 27) 1970' FSL & 2540' FWL (Section 28)  
1000' FSL & 2540' FWL (Section 28) 440' FSL & 100' FWL (Section 29)

Ladies and Gentlemen:

Mewbourne Oil Company ("Mewbourne"), as Operator, proposes to form a 1920.0 acre Working Interest Unit ("WIU") covering all of the captioned Sections 27, 28, and 29 for oil and gas production. The targeted interval for the initial test is the Bone Spring formation. Our records indicate that you own a portion of the operating rights in the WIU, and your working interest is reflected on the enclosed AFE.

In addition, Mewbourne as Operator hereby proposes to drill the captioned Nina 28/27 B3OP Fed Com #1H well at the above referenced surface location (SL) to the referenced bottom hole location (BHL). The proposed well will be drilled to an approximate true vertical depth (TVD) of 8,177 feet subsurface to evaluate the Third Bone Spring Sand Formation. The proposed well will have a measured depth (MD) of approximately 15,878 feet. The S/2SE/4 of Section 28 and the S/2S/2 of Section 27 will be dedicated to the well as the proration unit.

Finally, Mewbourne as Operator hereby proposes to drill the captioned Pinta 28/29 B3NM Fed Com #1H well at the above referenced surface location (SL) to the referenced bottom hole location (BHL). The proposed well will be drilled to an approximate true vertical depth (TVD) of 8,170 feet subsurface to evaluate the Third Bone Spring Sand Formation. The proposed well will have a measured depth (MD) of approximately 15,662 feet. The S/2SW/4 of Section 28 and the S/2S/2 of Section 29 will be dedicated to the well as the proration unit.

Regarding the above, enclosed for your further handling is our Operating Agreement dated October 1, 2021, along with an extra set of signature pages and our AFEs dated September 30, 2019, for the captioned proposed wells. Please sign and return said AFEs and extra set of signature pages at your earliest convenience if you elect to participate in the captioned wells and WIU and return to me within thirty (30) days.

If you have any questions regarding the above, please email me at [bblandford@mewbourne.com](mailto:bblandford@mewbourne.com) or call me at (432) 682-3715.

Sincerely,

**MEWBOURNE OIL COMPANY**

Braxton Blandford  
Landman



October 14, 2021

Dear Simple Certified:

The following is in response to your request for proof of delivery on your item with the tracking number:  
**9402 8368 9784 6455 1257 41.**



**Item Details**

<b>Status:</b>	Delivered, Front Desk/Reception/Mail Room
<b>Status Date / Time:</b>	October 14, 2021, 11:28 am
<b>Location:</b>	SPRING, TX 77380
<b>Postal Product:</b>	Priority Mail®
<b>Extra Services:</b>	Certified Mail™ Return Receipt Electronic Up to \$100 insurance included
<b>Recipient Name:</b>	LAND MANAGER

**Shipment Details**

<b>Weight:</b>	1.0oz
----------------	-------

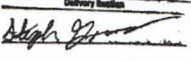
**Recipient Signature**

Signature of Recipient:	
Address of Recipient:	

Note: Scanned image may reflect a different destination address due to Intended Recipient's delivery instructions on file.

Thank you for selecting the United States Postal Service® for your mailing needs. If you require additional assistance, please contact your local Post Office™ or a Postal representative at 1-800-222-1811.

Sincerely,  
United States Postal Service®  
475 L'Enfant Plaza SW  
Washington, D.C. 20260-0004

LAND MANAGER  
SABINAL ENERGY OPERATING, LLC  
1780 HUGHES LANDING BLVD, SUITE 1200  
THE WOODLANDS, TX 77380  
Reference #: NINA/PINTA

## MEWBORNE OIL COMPANY

## AUTHORIZATION FOR EXPENDITURE

Well Name: <b>NINA 28/27 B3OP FED COM #1H</b>		Prospect: _____	
Location: <b>SL: 1000 FSL &amp; 2540 FWL (28) ; BHL: 440 FSL &amp; 100 FEL (27)</b>		County: <b>Eddy</b>	ST: <b>NM</b>
Sec. <b>28</b>	Blk: _____	Survey: _____	TWP: <b>20S</b> RNG: <b>27E</b> Prop. TVD: <b>8177</b> TMD: <b>15878</b>

INTANGIBLE COSTS 0180		CODE	TCP	CODE	CC
Regulatory Permits & Surveys		0180-0100	\$20,000	0180-0200	
Location / Road / Site / Preparation		0180-0105	\$75,000	0180-0205	\$35,000
Location / Restoration		0180-0106	\$200,000	0180-0206	\$75,000
Daywork / Turnkey / Footage Drilling	22 days drilg / 3 days comp @ \$19500/d	0180-0110	\$460,000	0180-0210	\$62,500
Fuel	1700 gal/day @ \$3/gal	0180-0114	\$119,800	0180-0214	\$264,000
Mud, Chemical & Additives		0180-0120	\$100,000	0180-0220	
Horizontal Drillout Services				0180-0222	\$200,000
Cementing		0180-0125	\$60,000	0180-0225	\$35,000
Logging & Wireline Services		0180-0130	\$2,300	0180-0230	\$363,000
Casing / Tubing / Snubbing Service		0180-0134	\$25,000	0180-0234	\$15,000
Mud Logging		0180-0137	\$30,000		
Stimulation	38 Stg 14.5 MM gal / 14.5 MM lb			0180-0241	\$1,250,000
Stimulation Rentals & Other				0180-0242	\$150,000
Water & Other		0180-0145	\$40,000	0180-0245	\$295,000
Bits		0180-0148	\$100,000	0180-0248	\$5,000
Inspection & Repair Services		0180-0150	\$50,000	0180-0250	\$5,000
Misc. Air & Pumping Services		0180-0154		0180-0254	\$10,000
Testing & Flowback Services		0180-0158	\$12,000	0180-0258	\$24,000
Completion / Workover Rig				0180-0260	\$10,500
Rig Mobilization		0180-0164	\$150,000		
Transportation		0180-0165	\$30,000	0180-0265	\$15,000
Welding Services		0180-0168	\$4,000	0180-0268	\$15,000
Contract Services & Supervision		0180-0170	\$102,700	0180-0270	\$58,100
Directional Services	Includes Vertical Control	0180-0175	\$278,700		
Equipment Rental		0180-0180	\$173,600	0180-0280	\$12,500
Well / Lease Legal		0180-0184	\$5,000	0180-0284	
Well / Lease Insurance		0180-0185	\$4,800	0180-0285	
Intangible Supplies		0180-0188	\$7,000	0180-0288	\$1,000
Damages		0180-0190	\$10,000	0180-0290	\$10,000
ROW & Easements		0180-0192		0180-0292	\$5,000
Pipeline Interconnect				0180-0293	
Company Supervision		0180-0195	\$132,000	0180-0295	\$40,000
Overhead Fixed Rate		0180-0196	\$10,000	0180-0296	\$20,000
Well Abandonment		0180-0198		0180-0298	
Contingencies	10% (TCP) 10% (CC)	0180-0199	\$220,190	0180-0299	\$297,560
<b>TOTAL</b>			<b>\$2,422,090</b>		<b>\$3,273,160</b>

TANGIBLE COSTS 0181		CODE	TCP	CODE	CC
Casing (19.1" - 30")		0181-0793			
Casing (10.1" - 19.0")	350' - 13 3/8" 54.5# J-55 ST&C @ \$48/ft	0181-0794	\$17,900		
Casing (8.1" - 10.0")	2000' - 9 5/8" 36# J-55 LT&C @ \$38/ft	0181-0795	\$81,200		
Casing (6.1" - 8.0")	8400' - 7" 29# HCP-110 LT&C @ \$28.5/ft	0181-0796	\$255,700		
Casing (4.1" - 6.0")	8000' - 4 1/2" 13.5# P-110 BPN @ \$15.5/ft			0181-0797	\$132,400
Tubing	8000' - 2 7/8" 6.5# L-80 Tbg @ \$13/ft			0181-0798	\$111,100
Drilling Head		0181-0860	\$35,000		
Tubing Head & Upper Section				0181-0870	\$30,000
Horizontal Completion Tools	Completion Liner Hanger			0181-0871	\$50,000
Sucker Rods				0181-0875	
Subsurface Equipment				0181-0880	\$25,000
Artificial Lift Systems	ESP			0181-0884	\$100,000
Pumping Unit				0181-0885	
Surface Pumps & Prime Movers	1/2 VRU/SWD TP			0181-0886	\$55,000
Tanks - Oil	1/2 of 6 - 750 bbl			0181-0890	\$60,000
Tanks - Water	1/2 of 5 - 750 bbl coated			0181-0891	\$50,000
Separation / Treating Equipment	1/2 GB/VRT/Flare			0181-0895	\$150,000
Heater Treaters, Line Heaters	8"x20"x75# HT			0181-0897	\$25,000
Metering Equipment				0181-0898	\$15,000
Line Pipe & Valves - Gathering	1/2 3.5 mile water			0181-0900	\$90,000
Fittings / Valves & Accessories				0181-0906	\$160,000
Cathodic Protection	Automation			0181-0908	\$15,000
Electrical Installation				0181-0909	\$93,750
Equipment Installation				0181-0910	\$93,750
Pipeline Construction	1/2 3.5 mile water			0181-0920	\$125,000
<b>TOTAL</b>			<b>\$389,800</b>		<b>\$1,381,000</b>
<b>SUBTOTAL</b>			<b>\$2,811,890</b>		<b>\$4,654,160</b>

<b>TOTAL WELL COST</b>		<b>\$7,466,050</b>
------------------------	--	--------------------

Extra Expense Insurance	
<input type="checkbox"/>	I elect to be covered by Operator's Extra Expense Insurance and pay my proportionate share of the premium. Operator has secured Extra Expense Insurance covering costs of well control, clean up and redrilling as estimated in Line Item 0180-0185.
<input type="checkbox"/>	I elect to purchase my own well control insurance policy.
If neither box is checked above, non-operating working interest owner elects to be covered by Operator's well control insurance.	
Prepared by: <b>G. Edington</b>	Date: <b>9/30/2021</b>
Company Approval: _____	Date: _____
Joint Owner Interest: _____ Amount: _____	Signature: _____
Joint Owner Name: _____	

ATTACHMENT

**STATE OF NEW MEXICO  
ENERGY, MINERALS AND NATURAL RESOURCES DEPARTMENT  
OIL CONSERVATION DIVISION**

**APPLICATIONs OF MEWBOURNE OIL COMPANY  
FOR COMPULSORY POOLING, EDDY COUNTY,  
NEW MEXICO.**

**Case Nos. 22648 & 22672**

**SELF-AFFIRMED STATEMENT OF CHARLES CROSBY**

COUNTY OF MIDLAND                    )  
  ) ss.  
STATE OF TEXAS                        )

Charles Crosby deposes and states:

1. I am over the age of 18, and have personal knowledge of the matters stated herein.
2. I am a geologist for Mewbourne Oil Company ("Mewbourne"), and I am familiar with the geological matters involved in these cases. I have been qualified by the Division as an expert petroleum geologist.
3. The following geological plats are attached hereto:
  - (a) Attachment A is a structure map on the base of the Third Bone Spring Sand. It shows that structure dips gently to the southeast. It also shows Bone Spring wells in the area, and a line of cross-section.
  - (b) Attachment B is a cross section showing the Third Bone Spring Sand, the target zones for the proposed well. The well logs on the cross-section give a representative sample of the Third Bone Spring Sand in this area. The sand is continuous and uniformly thick across the well unit.
4. I conclude from the maps that:
  - (a) The horizontal spacing units are justified from a geologic standpoint.
  - (b) The target zone is continuous and of relatively uniform thickness across the well units.
  - (c) Each quarter-quarter section in the well units will contribute more or less equally to production.

EXHIBIT

3

(d) There is no faulting or other geologic impediment in the area which will affect the drilling of the subject wells.

5. Attachment C contains information from other Third Bone Spring Sand wells drilled in this area. There is a preference for laydown wells.

6. Attachment D contains Survey Calculation Reports for the proposed wells. The producing intervals of the wells will be orthodox.

I understand that this Self-Affirmed Statement will be used as written testimony in these cases. I affirm that my testimony in paragraphs 1 through 6 above is true and correct and is made under penalty of perjury under the laws of the State of New Mexico. My testimony is made as of the date handwritten next to my signature below.

Date: July 5, 2022

/s/ Charles Crosby  
Charles Crosby

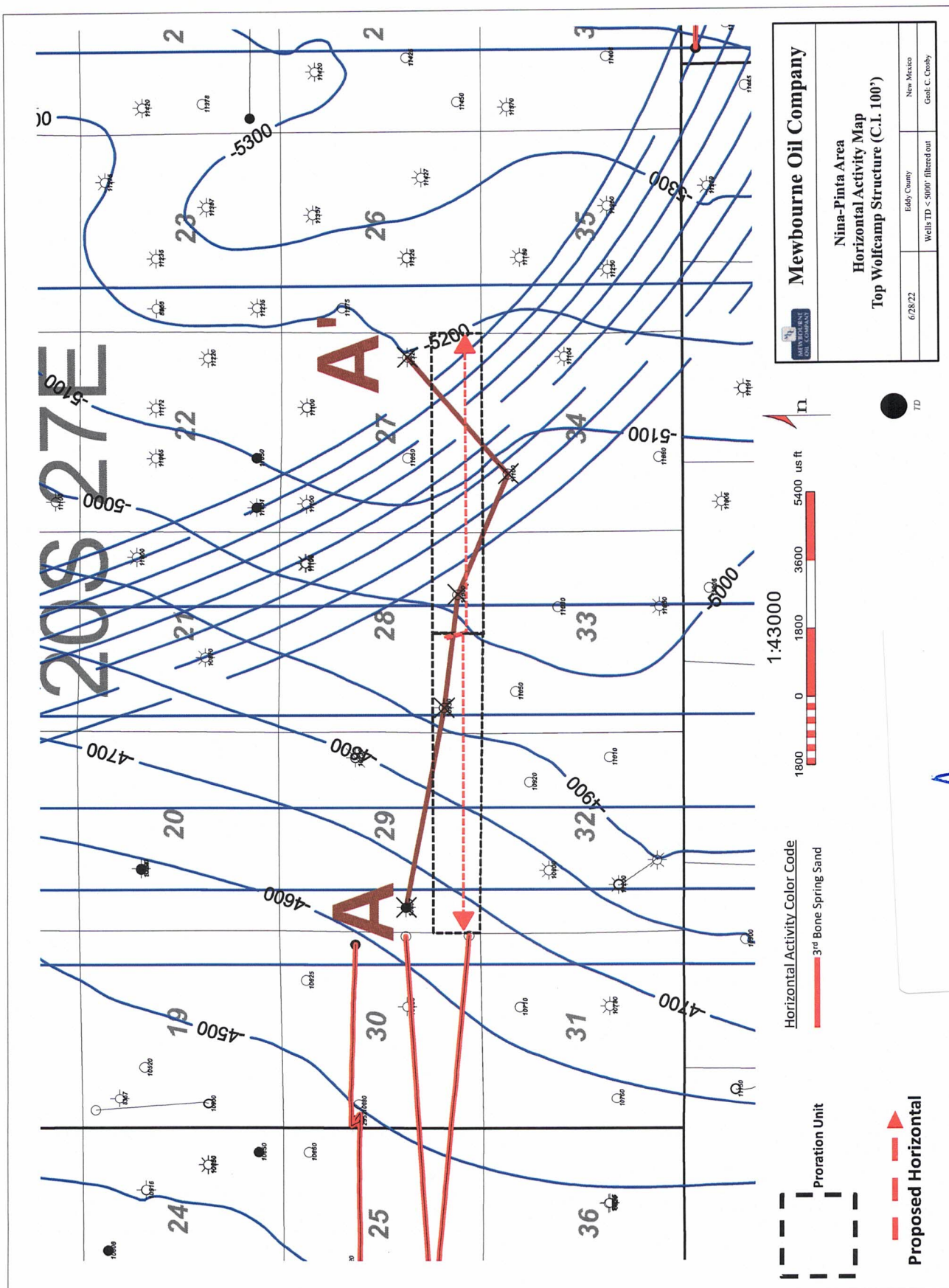

ATTACHMENT A



ATTACHMENT

Nina/Pinta 3rd BSPG SD Horizontal Production Table

Well Name	Operator	API	Location	Completion Date	Cum Oil (Mbo)	Cum Gas (Bcf)	Cum Water (Mbw)	NS/EW	Production Zone
Roscoe 6 B3AD Federal Com 1H	Mewbourne	30015431680000	6A/21S/27E	6/3/2017	233.5	0.50	619.4	EW	3rd Bone Spring Sand
Catalina 30 EH State 1H	Tascosa	30015476410000	30E/20S/27E	3/29/2021	149.3	0.62	136.5	EW	3rd Bone Spring Sand
Catalina 25 HE State 1H	Tascosa	30015487360000	30E/20S/27E	2/15/2022	76.4	0.31	102.1	EW	3rd Bone Spring Sand
Catalina 25/30 State Com 2H	Tascosa	30015491120000	25L/20S/26E		Pending			EW	3rd Bone Spring Sand
Catalina 25/30 State Com 3H	Tascosa	30015491250000	25M/20S/26E		Pending			EW	3rd Bone Spring Sand

ATTACHMENT

C

## Mewbourne Oil Company

SURVEY CALCULATION REPORT  
Minimum Curvature CalculationsOperator: Mewbourne Oil Company  
Lease Name: Nina 28/27 B3OP Fed Com 1H  
KOP 7605.04SL: 1000 FSL & 2540 FWL; Sec 28/20S/27E  
PBHL: 440 FSL & 100 FEL; Sec 27/20S/27ETarget KBTVD: 8,178 Feet 8178.00  
Target Angle: 88.47 Degrees 88.47  
Section Plane: 94.08 Degrees  
Declination Corrected to True North: 6.63 Degrees  
Bit to Survey Offset: 44 Feet

Survey No.	Measured Depth-ft	Drift (Deg.)	Azimuth (Deg.)	Course Length	TVD (Feet)	Vertical Section	+N/-S (Feet)	+E/-W (Feet)	Closure Distance	Closure Direction	BUR	DLS	KBTVD	+Above -Below Target	DRIFT (RADIANS)	AZIMUTH (RADIANS)
T/I	7605.04	0.00	94.08	N/A	7605.0	0.0	0.0	0.0	0.0	0.0	N/A	N/A	7605.0	573.0	1E-12	1.64 #VALUE!
1	7693.51	8.85	94.08	88.471	7693.2	6.8	-0.5	6.8	6.8	94.1	10.0	10.0	7693.0	485.0	0.1544113	1.64 0.1544113
2	7781.98	17.69	94.08	88.471	7779.2	27.1	-1.9	27.0	27.1	94.1	10.0	10.0	7778.5	399.5	0.3088226	1.64 0.1544113
3	7870.46	26.54	94.08	88.471	7861.1	60.4	-4.3	60.2	60.4	94.1	10.0	10.0	7859.5	318.5	0.4632339	1.64 0.1544113
4	7958.93	35.39	94.08	88.471	7936.9	105.9	-7.5	105.6	105.9	94.1	10.0	10.0	7934.0	244.0	0.6176453	1.64 0.1544113
5	8047.40	44.24	94.08	88.471	8004.7	162.4	-11.6	162.0	162.4	94.1	10.0	10.0	8000.4	177.6	0.7720566	1.64 0.1544113
6	8135.87	53.08	94.08	88.471	8063.1	228.8	-16.3	228.2	228.8	94.1	10.0	10.0	8057.0	121.0	0.9264679	1.64 0.1544113
7	8224.34	61.93	94.08	88.471	8110.6	303.4	-21.6	302.6	303.4	94.1	10.0	10.0	8102.5	75.5	1.0808792	1.64 0.1544113
8	8312.81	70.78	94.08	88.471	8146.1	384.3	-27.4	383.3	384.3	94.1	10.0	10.0	8135.8	42.2	1.2352905	1.64 0.1544113
9	8401.28	79.62	94.08	88.471	8168.6	469.8	-33.4	468.6	469.8	94.1	10.0	10.0	8156.1	21.9	1.3897018	1.64 0.1544113
10	8489.75	88.47	94.08	88.471	8177.8	557.7	-39.7	556.3	557.7	94.1	10.0	10.0	8162.9	15.1	1.5441131	1.64 0.1544113
11	8500.00	88.47	94.08	10.246	8178.1	567.9	-40.4	566.5	567.9	94.1	0.0	0.0	8162.9	15.1	1.5441131	1.64 1E-10
12	8600.00	88.47	94.08	100	8180.7	667.9	-47.5	666.2	667.9	94.1	0.0	0.0	8162.9	15.1	1.5441131	1.64 1E-10
13	8700.00	88.47	94.08	100	8183.4	767.8	-54.6	765.9	767.8	94.1	0.0	0.0	8162.9	15.1	1.5441131	1.64 1E-10
14	8800.00	88.47	94.08	100	8186.1	867.8	-61.8	865.6	867.8	94.1	0.0	0.0	8162.9	15.1	1.5441131	1.64 1E-10
15	8900.00	88.47	94.08	100	8188.7	967.8	-68.9	965.3	967.8	94.1	0.0	0.0	8162.9	15.1	1.5441131	1.64 1E-10
16	9000.00	88.47	94.08	100	8191.4	1067.7	-76.0	1065.0	1067.7	94.1	0.0	0.0	8162.9	15.1	1.5441131	1.64 1E-10
17	9100.00	88.47	94.08	100	8194.1	1167.7	-83.1	1164.7	1167.7	94.1	0.0	0.0	8162.9	15.1	1.5441131	1.64 1E-10
18	9200.00	88.47	94.08	100	8196.7	1267.7	-90.2	1264.4	1267.7	94.1	0.0	0.0	8162.9	15.1	1.5441131	1.64 1E-10
19	9300.00	88.47	94.08	100	8199.4	1367.6	-97.3	1364.2	1367.6	94.1	0.0	0.0	8162.9	15.1	1.5441131	1.64 1E-10
20	9400.00	88.47	94.08	100	8202.1	1467.6	-104.5	1463.9	1467.6	94.1	0.0	0.0	8162.9	15.1	1.5441131	1.64 1E-10
21	9500.00	88.47	94.08	100	8204.7	1567.6	-111.6	1563.6	1567.6	94.1	0.0	0.0	8162.9	15.1	1.5441131	1.64 1E-10
22	9600.00	88.47	94.08	100	8207.4	1667.5	-118.7	1663.3	1667.5	94.1	0.0	0.0	8162.9	15.1	1.5441131	1.64 1E-10
23	9700.00	88.47	94.08	100	8210.1	1767.5	-125.8	1763.0	1767.5	94.1	0.0	0.0	8162.9	15.1	1.5441131	1.64 1E-10
24	9800.00	88.47	94.08	100	8212.8	1867.5	-132.9	1862.7	1867.5	94.1	0.0	0.0	8162.9	15.1	1.5441131	1.64 1E-10
25	9900.00	88.47	94.08	100	8215.4	1967.4	-140.0	1962.4	1967.4	94.1	0.0	0.0	8162.9	15.1	1.5441131	1.64 1E-10
26	10000.00	88.47	94.08	100	8218.1	2067.4	-147.1	2062.1	2067.4	94.1	0.0	0.0	8162.9	15.1	1.5441131	1.64 1E-10
27	10100.00	88.47	94.08	100	8220.8	2167.3	-154.3	2161.8	2167.3	94.1	0.0	0.0	8162.9	15.1	1.5441131	1.64 1E-10
28	10200.00	88.47	94.08	100	8223.4	2267.3	-161.4	2261.6	2267.3	94.1	0.0	0.0	8162.9	15.1	1.5441131	1.64 1E-10
29	10300.00	88.47	94.08	100	8226.1	2367.3	-168.5	2361.3	2367.3	94.1	0.0	0.0	8162.9	15.1	1.5441131	1.64 1E-10
30	10400.00	88.47	94.08	100	8228.8	2467.2	-175.6	2461.0	2467.2	94.1	0.0	0.0	8162.9	15.1	1.5441131	1.64 1E-10
31	10500.00	88.47	94.08	100	8231.4	2567.2	-182.7	2560.7	2567.2	94.1	0.0	0.0	8162.9	15.1	1.5441131	1.64 1E-10
32	10600.00	88.47	94.08	100	8234.1	2667.2	-189.8	2660.4	2667.2	94.1	0.0	0.0	8162.9	15.1	1.5441131	1.64 1E-10
33	10700.00	88.47	94.08	100	8236.8	2767.1	-196.9	2760.1	2767.1	94.1	0.0	0.0	8162.9	15.1	1.5441131	1.64 1E-10
34	10800.00	88.47	94.08	100	8239.4	2867.1	-204.1	2859.8	2867.1	94.1	0.0	0.0	8162.9	15.1	1.5441131	1.64 1E-10
35	10900.00	88.47	94.08	100	8242.1	2967.1	-211.2	2959.5	2967.1	94.1	0.0	0.0	8162.9	15.1	1.5441131	1.64 1E-10
36	11000.00	88.47	94.08	100	8244.8	3067.0	-218.3	3059.2	3067.0	94.1	0.0	0.0	8162.9	15.1	1.5441131	1.64 1E-10
37	11100.00	88.47	94.08	100	8247.4	3167.0	-225.4	3159.0	3167.0	94.1	0.0	0.0	8162.9	15.1	1.5441131	1.64 1E-10
38	11200.00	88.47	94.08	100	8250.1	3267.0	-232.5	3258.7	3267.0	94.1	0.0	0.0	8162.9	15.1	1.5441131	1.64 1E-10
39	11300.00	88.47	94.08	100	8252.8	3366.9	-239.6	3358.4	3366.9	94.1	0.0	0.0	8162.9	15.1	1.5441131	1.64 1E-10
40	11400.00	88.47	94.08	100	8255.4	3466.9	-246.7	3458.1	3466.9	94.1	0.0	0.0	8162.9	15.1	1.5441131	1.64 1E-10
41	11500.00	88.47	94.08	100	8258.1	3566.8	-253.9	3557.8	3566.8	94.1	0.0	0.0	8162.9	15.1	1.5441131	1.64 1E-10
42	11600.00	88.47	94.08	100	8260.8	3666.8	-261.0	3657.5	3666.8	94.1	0.0	0.0	8162.9	15.1	1.5441131	1.64 1E-10
43	11700.00	88.47	94.08	100	8263.4	3766.8	-268.1	3757.2	3766.8	94.1	0.0	0.0	8162.9	15.1	1.5441131	1.64 1E-10
44	11800.00	88.47	94.08	100	8266.1	3866.7	-275.2	3856.9	3866.7	94.1	0.0	0.0	8162.9	15.1	1.5441131	1.64 1E-10
45	11900.00	88.47	94.08	100	8268.8	3966.7	-282.3	3956.6	3966.7	94.1	0.0	0.0	8162.9	15.1	1.5441131	1.64 1E-10
46	12000.00	88.47	94.08	100	8271.4	4066.7	-289.4	4056.4	4066.7	94.1	0.0	0.0	8162.9	15.1	1.5441131	1.64 1E-10
47	12100.00	88.47	94.08	100	8274.1	4166.6	-296.5	4156.1	4166.6	94.1	0.0	0.0	8162.9	15.1	1.5441131	1.64 1E-10
48	12200.00	88.47	94.08	100	8276.8	4266.6	-303.7	4255.8	4266.6	94.1	0.0	0.0	8162.9	15.1	1.5441131	1.64 1E-10
49	12300.00	88.47	94.08	100	8279.5	4366.6	-310.8	4355.5	4366.6	94.1	0.0	0.0	8162.9	15.1	1.5441131	1.64 1E-10
50	12400.00	88.47	94.08	100	8282.1	4466.5	-317.9	4455.2	4466.5	94.1	0.0	0.0	8162.9	15.1	1.5441131	1.64 1E-10
51	12500.00	88.47	94.08	100	8284.8	4566.5	-325.0	4554.9	4566.5	94.1	0.0	0.0	8162.9	15.1	1.5441131	1.64 1E-10
52	12600.00	88.47	94.08	100	8287.5	4666.5	-332.1	4654.6	4666.5	94.1	0.0	0.0	8162.9	15.1	1.5441131	1.64 1E-10
53	12700.00	88.47	94.08	100	8290.1	4766.4	-339.2	4754.3	4766.4	94.1	0.0	0.0	8162.9	15.1	1.5441131	1.64 1E-10
54	12800.00	88.47	94.08	100	8292.8	4866.4	-346.3	4854.0	4866.4	94.1	0.0	0.0	8162.9	15.1	1.5441131	1.64 1E-10

ATTACHMENT

55	12900.00	88.47	94.08	100	8295.5	4966.3	-353.5	4953.8	4966.3	94.1	0.0	0.0	8162.9	15.1	1.5441131	1.64	1E-10
56	13000.00	88.47	94.08	100	8298.1	5066.3	-360.6	5053.5	5066.3	94.1	0.0	0.0	8162.9	15.1	1.5441131	1.64	1E-10

57	13100.00	88.47	94.08	100	8300.8	5166.3	-367.7	5153.2	5166.3	94.1	0.0	0.0	8162.9	15.1	1.5441131	1.64	1E-10
58	13200.00	88.47	94.08	100	8303.5	5266.2	-374.8	5252.9	5266.2	94.1	0.0	0.0	8162.9	15.1	1.5441131	1.64	1E-10
59	13300.00	88.47	94.08	100	8306.1	5366.2	-381.9	5352.6	5366.2	94.1	0.0	0.0	8162.9	15.1	1.5441131	1.64	1E-10
60	13400.00	88.47	94.08	100	8308.8	5466.2	-389.0	5452.3	5466.2	94.1	0.0	0.0	8162.9	15.1	1.5441131	1.64	1E-10
61	13500.00	88.47	94.08	100	8311.5	5566.1	-396.2	5552.0	5566.1	94.1	0.0	0.0	8162.9	15.1	1.5441131	1.64	1E-10
62	13600.00	88.47	94.08	100	8314.1	5666.1	-403.3	5651.7	5666.1	94.1	0.0	0.0	8162.9	15.1	1.5441131	1.64	1E-10
63	13700.00	88.47	94.08	100	8316.8	5766.1	-410.4	5751.4	5766.1	94.1	0.0	0.0	8162.9	15.1	1.5441131	1.64	1E-10
64	13800.00	88.47	94.08	100	8319.5	5866.0	-417.5	5851.2	5866.0	94.1	0.0	0.0	8162.9	15.1	1.5441131	1.64	1E-10
65	13900.00	88.47	94.08	100	8322.1	5966.0	-424.6	5950.9	5966.0	94.1	0.0	0.0	8162.9	15.1	1.5441131	1.64	1E-10
66	14000.00	88.47	94.08	100	8324.8	6066.0	-431.7	6050.6	6066.0	94.1	0.0	0.0	8162.9	15.1	1.5441131	1.64	1E-10
67	14100.00	88.47	94.08	100	8327.5	6165.9	-438.8	6150.3	6165.9	94.1	0.0	0.0	8162.9	15.1	1.5441131	1.64	1E-10
68	14200.00	88.47	94.08	100	8330.1	6265.9	-446.0	6250.0	6265.9	94.1	0.0	0.0	8162.9	15.1	1.5441131	1.64	1E-10
69	14300.00	88.47	94.08	100	8332.8	6365.8	-453.1	6349.7	6365.8	94.1	0.0	0.0	8162.9	15.1	1.5441131	1.64	1E-10
70	14400.00	88.47	94.08	100	8335.5	6465.8	-460.2	6449.4	6465.8	94.1	0.0	0.0	8162.9	15.1	1.5441131	1.64	1E-10
71	14500.00	88.47	94.08	100	8338.1	6565.8	-467.3	6549.1	6565.8	94.1	0.0	0.0	8162.9	15.1	1.5441131	1.64	1E-10
72	14600.00	88.47	94.08	100	8340.8	6665.7	-474.4	6648.8	6665.7	94.1	0.0	0.0	8162.9	15.1	1.5441131	1.64	1E-10
73	14700.00	88.47	94.08	100	8343.5	6765.7	-481.5	6748.5	6765.7	94.1	0.0	0.0	8162.9	15.1	1.5441131	1.64	1E-10
74	14800.00	88.47	94.08	100	8346.2	6865.7	-488.6	6848.3	6865.7	94.1	0.0	0.0	8162.9	15.1	1.5441131	1.64	1E-10
75	14900.00	88.47	94.08	100	8348.8	6965.6	-495.8	6948.0	6965.6	94.1	0.0	0.0	8162.9	15.1	1.5441131	1.64	1E-10
76	15000.00	88.47	94.08	100	8351.5	7065.6	-502.9	7047.7	7065.6	94.1	0.0	0.0	8162.9	15.1	1.5441131	1.64	1E-10
77	15100.00	88.47	94.08	100	8354.2	7165.6	-510.0	7147.4	7165.6	94.1	0.0	0.0	8162.9	15.1	1.5441131	1.64	1E-10
78	15200.00	88.47	94.08	100	8356.8	7265.5	-517.1	7247.1	7265.5	94.1	0.0	0.0	8162.9	15.1	1.5441131	1.64	1E-10
79	15300.00	88.47	94.08	100	8359.5	7365.5	-524.2	7346.8	7365.5	94.1	0.0	0.0	8162.9	15.1	1.5441131	1.64	1E-10
80	15400.00	88.47	94.08	100	8362.2	7465.5	-531.3	7446.5	7465.5	94.1	0.0	0.0	8162.9	15.1	1.5441131	1.64	1E-10
81	15500.00	88.47	94.08	100	8364.8	7565.4	-538.4	7546.2	7565.4	94.1	0.0	0.0	8162.9	15.1	1.5441131	1.64	1E-10
82	15600.00	88.47	94.08	100	8367.5	7665.4	-545.6	7645.9	7665.4	94.1	0.0	0.0	8162.9	15.1	1.5441131	1.64	1E-10
83	15700.00	88.47	94.08	100	8370.2	7765.4	-552.7	7745.7	7765.4	94.1	0.0	0.0	8162.9	15.1	1.5441131	1.64	1E-10
84	15800.00	88.47	94.08	100	8372.8	7865.3	-559.8	7845.4	7865.3	94.1	0.0	0.0	8162.9	15.1	1.5441131	1.64	1E-10
85	15886.21	88.47	94.08	86.214	8375.1	7951.5	-565.9	7931.3	7951.5	94.1	0.0	0.0	8162.9	15.1	1.5441131	1.64	1E-10
86	15886.21	88.47	94.08	0	8375.1	7951.5	-565.9	7931.3	7951.5	94.1	#DIV/0!	#DIV/0!	8162.9	15.1	1.5441131	1.64	1E-10

## Mewbourne Oil Company

SURVEY CALCULATION REPORT  
Minimum Curvature Calculations

Operator: Mewbourne Oil Company  
 Lease Name: Pinta 28/29 B3NM Fed Com 1H  
 KOP 7598.04  
 SL: 970 FSL & 2540 FWL; Sec 28/20S/27E  
 PBHL: 440 FSL & 100 FEL; Sec 29/20S/27E

Target KBTVD: 8,171 Feet 8171.00  
 Target Angle: 92.45 Degrees 92.45  
 Section Plane: 266.64 Degrees  
 Declination Corrected to True North: 6.63 Degrees  
 Bit to Survey Offset: 44 Feet

Survey No.	Measured Depth-ft	Drift (Deg.)	Azimuth (Deg.)	Course Length	TVD (Feet)	Vertical Section	+N/-S (Feet)	+E/-W (Feet)	Closure Distance	Closure Direction	BUR	DLS	KBTVD	+Above		
														-Below Target	DRIFT (RADIANS)	AZIMUTH (RADIAN)
T/I	7598.04	0.00	266.64	N/A	7598.0	0.0	0.0	0.0	0.0	0.0	N/A	N/A	7598.0	573.0	1E-12	4.65 #VALUE!
1	7690.50	9.25	266.64	92.453	7690.1	7.4	-0.4	-7.4	266.6	10.0	10.0	10.0	7690.4	480.6	0.161361	4.65 0.1613609
2	7782.95	18.49	266.64	92.453	7779.8	29.6	-1.7	-29.5	266.6	10.0	10.0	10.0	7781.0	390.0	0.322722	4.65 0.1613609
3	7875.40	27.74	266.64	92.453	7864.7	65.8	-3.9	-65.7	266.6	10.0	10.0	10.0	7867.5	303.5	0.484083	4.65 0.1613609
4	7967.85	36.98	266.64	92.453	7942.7	115.3	-6.7	-115.1	266.6	10.0	10.0	10.0	7947.6	223.4	0.645444	4.65 0.1613609
5	8060.31	46.23	266.64	92.453	8011.8	176.6	-10.3	-176.3	266.6	10.0	10.0	10.0	8019.3	151.7	0.806805	4.65 0.1613609
6	8152.76	55.47	266.64	92.453	8070.1	248.2	-14.5	-247.8	266.6	10.0	10.0	10.0	8080.7	90.3	0.968166	4.65 0.1613609
7	8245.21	64.72	266.64	92.453	8116.1	328.3	-19.2	-327.7	266.6	10.0	10.0	10.0	8130.2	40.8	1.129527	4.65 0.1613609
8	8337.67	73.96	266.64	92.453	8148.7	414.7	-24.3	-414.0	266.6	10.0	10.0	10.0	8166.5	4.5	1.290887	4.65 0.1613609
9	8430.12	83.21	266.64	92.453	8167.0	505.2	-29.6	-504.3	266.6	10.0	10.0	10.0	8188.6	-17.6	1.452248	4.65 0.1613609
10	8522.57	92.45	266.64	92.453	8170.5	597.5	-35.0	-596.5	266.6	10.0	10.0	10.0	8196.1	-25.1	1.613609	4.65 0.1613609
11	8600.00	92.45	266.64	77.428	8167.2	674.8	-39.5	-673.7	266.6	0.0	0.0	0.0	8196.1	-25.1	1.613609	4.65 1E-10
12	8700.00	92.45	266.64	100	8162.9	774.7	-45.4	-773.4	266.6	0.0	0.0	0.0	8196.1	-25.1	1.613609	4.65 1E-10
13	8800.00	92.45	266.64	100	8158.6	874.7	-51.2	-873.2	266.6	0.0	0.0	0.0	8196.1	-25.1	1.613609	4.65 1E-10
14	8900.00	92.45	266.64	100	8154.3	974.6	-57.0	-972.9	266.6	0.0	0.0	0.0	8196.1	-25.1	1.613609	4.65 1E-10
15	9000.00	92.45	266.64	100	8150.0	1074.5	-62.9	-1072.6	266.6	0.0	0.0	0.0	8196.1	-25.1	1.613609	4.65 1E-10
16	9100.00	92.45	266.64	100	8145.8	1174.4	-68.7	-1172.4	266.6	0.0	0.0	0.0	8196.1	-25.1	1.613609	4.65 1E-10
17	9200.00	92.45	266.64	100	8141.5	1274.3	-74.6	-1272.1	266.6	0.0	0.0	0.0	8196.1	-25.1	1.613609	4.65 1E-10
18	9300.00	92.45	266.64	100	8137.2	1374.2	-80.4	-1371.8	266.6	0.0	0.0	0.0	8196.1	-25.1	1.613609	4.65 1E-10
19	9400.00	92.45	266.64	100	8132.9	1474.1	-86.3	-1471.6	266.6	0.0	0.0	0.0	8196.1	-25.1	1.613609	4.65 1E-10
20	9500.00	92.45	266.64	100	8128.6	1574.0	-92.1	-1571.3	266.6	0.0	0.0	0.0	8196.1	-25.1	1.613609	4.65 1E-10
21	9600.00	92.45	266.64	100	8124.4	1673.9	-98.0	-1671.1	266.6	0.0	0.0	0.0	8196.1	-25.1	1.613609	4.65 1E-10
22	9700.00	92.45	266.64	100	8120.1	1773.8	-103.8	-1770.8	266.6	0.0	0.0	0.0	8196.1	-25.1	1.613609	4.65 1E-10
23	9800.00	92.45	266.64	100	8115.8	1873.7	-109.7	-1870.5	266.6	0.0	0.0	0.0	8196.1	-25.1	1.613609	4.65 1E-10
24	9900.00	92.45	266.64	100	8111.5	1973.6	-115.5	-1970.3	266.6	0.0	0.0	0.0	8196.1	-25.1	1.613609	4.65 1E-10
25	10000.00	92.45	266.64	100	8107.2	2073.6	-121.4	-2070.0	266.6	0.0	0.0	0.0	8196.1	-25.1	1.613609	4.65 1E-10
26	10100.00	92.45	266.64	100	8103.0	2173.5	-127.2	-2169.7	266.6	0.0	0.0	0.0	8196.1	-25.1	1.613609	4.65 1E-10
27	10200.00	92.45	266.64	100	8098.7	2273.4	-133.1	-2269.5	266.6	0.0	0.0	0.0	8196.1	-25.1	1.613609	4.65 1E-10
28	10300.00	92.45	266.64	100	8094.4	2373.3	-138.9	-2369.2	266.6	0.0	0.0	0.0	8196.1	-25.1	1.613609	4.65 1E-10
29	10400.00	92.45	266.64	100	8090.1	2473.2	-144.8	-2468.9	266.6	0.0	0.0	0.0	8196.1	-25.1	1.613609	4.65 1E-10
30	10500.00	92.45	266.64	100	8085.8	2573.1	-150.6	-2568.7	266.6	0.0	0.0	0.0	8196.1	-25.1	1.613609	4.65 1E-10
31	10600.00	92.45	266.64	100	8081.6	2673.0	-156.5	-2668.4	266.6	0.0	0.0	0.0	8196.1	-25.1	1.613609	4.65 1E-10
32	10700.00	92.45	266.64	100	8077.3	2772.9	-162.3	-2768.2	266.6	0.0	0.0	0.0	8196.1	-25.1	1.613609	4.65 1E-10
33	10800.00	92.45	266.64	100	8073.0	2872.8	-168.2	-2867.9	266.6	0.0	0.0	0.0	8196.1	-25.1	1.613609	4.65 1E-10
34	10900.00	92.45	266.64	100	8068.7	2972.7	-174.0	-2967.6	266.6	0.0	0.0	0.0	8196.1	-25.1	1.613609	4.65 1E-10
35	11000.00	92.45	266.64	100	8064.4	3072.6	-179.9	-3067.4	266.6	0.0	0.0	0.0	8196.1	-25.1	1.613609	4.65 1E-10
36	11100.00	92.45	266.64	100	8060.2	3172.5	-185.7	-3167.1	266.6	0.0	0.0	0.0	8196.1	-25.1	1.613609	4.65 1E-10
37	11200.00	92.45	266.64	100	8055.9	3272.5	-191.6	-3266.8	266.6	0.0	0.0	0.0	8196.1	-25.1	1.613609	4.65 1E-10
38	11300.00	92.45	266.64	100	8051.6	3372.4	-197.4	-3366.6	266.6	0.0	0.0	0.0	8196.1	-25.1	1.613609	4.65 1E-10
39	11400.00	92.45	266.64	100	8047.3	3472.3	-203.3	-3466.3	266.6	0.0	0.0	0.0	8196.1	-25.1	1.613609	4.65 1E-10
40	11500.00	92.45	266.64	100	8043.0	3572.2	-209.1	-3566.1	266.6	0.0	0.0	0.0	8196.1	-25.1	1.613609	4.65 1E-10
41	11600.00	92.45	266.64	100	8038.8	3672.1	-215.0	-3665.8	266.6	0.0	0.0	0.0	8196.1	-25.1	1.613609	4.65 1E-10
42	11700.00	92.45	266.64	100	8034.5	3772.0	-220.8	-3765.5	266.6	0.0	0.0	0.0	8196.1	-25.1	1.613609	4.65 1E-10
43	11800.00	92.45	266.64	100	8030.2	3871.9	-226.7	-3865.3	266.6	0.0	0.0	0.0	8196.1	-25.1	1.613609	4.65 1E-10
44	11900.00	92.45	266.64	100	8025.9	3971.8	-232.5	-3965.0	266.6	0.0	0.0	0.0	8196.1	-25.1	1.613609	4.65 1E-10
45	12000.00	92.45	266.64	100	8021.6	4071.7	-238.4	-4064.7	266.6	0.0	0.0	0.0	8196.1	-25.1	1.613609	4.65 1E-10
46	12100.00	92.45	266.64	100	8017.4	4171.6	-244.2	-4164.5	266.6	0.0	0.0	0.0	8196.1	-25.1	1.613609	4.65 1E-10
47	12200.00	92.45	266.64	100	8013.1	4271.5	-250.0	-4264.2	266.6	0.0	0.0	0.0	8196.1	-25.1	1.613609	4.65 1E-10
48	12300.00	92.45	266.64	100	8008.8	4371.4	-255.9	-4364.0	266.6	0.0	0.0	0.0	8196.1	-25.1	1.613609	4.65 1E-10
49	12400.00	92.45	266.64	100	8004.5	4471.4	-261.7	-4463.7	266.6	0.0	0.0	0.0	8196.1	-25.1	1.613609	4.65 1E-10
50	12500.00	92.45	266.64	100	8000.2	4571.3	-267.6	-4563.4	266.6	0.0	0.0	0.0	8196.1	-25.1	1.613609	4.65 1E-10
51	12600.00	92.45	266.64	100	7996.0	4671.2	-273.4	-4663.2	266.6	0.0	0.0	0.0	8196.1	-25.1	1.613609	4.65 1E-10
52	12700.00	92.45	266.64	100	7991.7	4771.1	-279.3	-4762.9	266.6	0.0	0.0	0.0	8196.1	-25.1	1.613609	4.65 1E-10
53	12800.00	92.45	266.64	100	7987.4	4871.0	-285.1	-4862.6	266.6	0.0	0.0	0.0	8196.1	-25.1	1.613609	4.65 1E-10
54	12900.00	92.45	266.64	100	7983.1	4970.9	-291.0	-4962.4	266.6	0.0	0.0	0.0	8196.1	-25.1	1.613609	4.65 1E-10

55	13000.00	92.45	266.64	100	7978.8	5070.8	-296.8	-5062.1	5070.8	266.6	0.0	0.0	8196.1	-25.1	1.613609	4.65	1E-10
56	13100.00	92.45	266.64	100	7974.6	5170.7	-302.7	-5161.8	5170.7	266.6	0.0	0.0	8196.1	-25.1	1.613609	4.65	1E-10
57	13200.00	92.45	266.64	100	7970.3	5270.6	-308.5	-5261.6	5270.6	266.6	0.0	0.0	8196.1	-25.1	1.613609	4.65	1E-10
58	13300.00	92.45	266.64	100	7966.0	5370.5	-314.4	-5361.3	5370.5	266.6	0.0	0.0	8196.1	-25.1	1.613609	4.65	1E-10
59	13400.00	92.45	266.64	100	7961.7	5470.4	-320.2	-5461.1	5470.4	266.6	0.0	0.0	8196.1	-25.1	1.613609	4.65	1E-10
60	13500.00	92.45	266.64	100	7957.4	5570.3	-326.1	-5560.8	5570.3	266.6	0.0	0.0	8196.1	-25.1	1.613609	4.65	1E-10
61	13600.00	92.45	266.64	100	7953.2	5670.3	-331.9	-5660.5	5670.3	266.6	0.0	0.0	8196.1	-25.1	1.613609	4.65	1E-10
62	13700.00	92.45	266.64	100	7948.9	5770.2	-337.8	-5760.3	5770.2	266.6	0.0	0.0	8196.1	-25.1	1.613609	4.65	1E-10
63	13800.00	92.45	266.64	100	7944.6	5870.1	-343.6	-5860.0	5870.1	266.6	0.0	0.0	8196.1	-25.1	1.613609	4.65	1E-10
64	13900.00	92.45	266.64	100	7940.3	5970.0	-349.5	-5959.7	5970.0	266.6	0.0	0.0	8196.1	-25.1	1.613609	4.65	1E-10
65	14000.00	92.45	266.64	100	7936.0	6069.9	-355.3	-6059.5	6069.9	266.6	0.0	0.0	8196.1	-25.1	1.613609	4.65	1E-10
66	14100.00	92.45	266.64	100	7931.8	6169.8	-361.2	-6159.2	6169.8	266.6	0.0	0.0	8196.1	-25.1	1.613609	4.65	1E-10
67	14200.00	92.45	266.64	100	7927.5	6269.7	-367.0	-6259.0	6269.7	266.6	0.0	0.0	8196.1	-25.1	1.613609	4.65	1E-10
68	14300.00	92.45	266.64	100	7923.2	6369.6	-372.9	-6358.7	6369.6	266.6	0.0	0.0	8196.1	-25.1	1.613609	4.65	1E-10
69	14400.00	92.45	266.64	100	7918.9	6469.5	-378.7	-6458.4	6469.5	266.6	0.0	0.0	8196.1	-25.1	1.613609	4.65	1E-10
70	14500.00	92.45	266.64	100	7914.6	6569.4	-384.6	-6558.2	6569.4	266.6	0.0	0.0	8196.1	-25.1	1.613609	4.65	1E-10
71	14600.00	92.45	266.64	100	7910.4	6669.3	-390.4	-6657.9	6669.3	266.6	0.0	0.0	8196.1	-25.1	1.613609	4.65	1E-10
72	14700.00	92.45	266.64	100	7906.1	6769.2	-396.3	-6757.6	6769.2	266.6	0.0	0.0	8196.1	-25.1	1.613609	4.65	1E-10
73	14800.00	92.45	266.64	100	7901.8	6869.2	-402.1	-6857.4	6869.2	266.6	0.0	0.0	8196.1	-25.1	1.613609	4.65	1E-10
74	14900.00	92.45	266.64	100	7897.5	6969.1	-408.0	-6957.1	6969.1	266.6	0.0	0.0	8196.1	-25.1	1.613609	4.65	1E-10
75	15000.00	92.45	266.64	100	7893.2	7069.0	-413.8	-7056.9	7069.0	266.6	0.0	0.0	8196.1	-25.1	1.613609	4.65	1E-10
76	15100.00	92.45	266.64	100	7889.0	7168.9	-419.7	-7156.6	7168.9	266.6	0.0	0.0	8196.1	-25.1	1.613609	4.65	1E-10
77	15200.00	92.45	266.64	100	7884.7	7268.8	-425.5	-7256.3	7268.8	266.6	0.0	0.0	8196.1	-25.1	1.613609	4.65	1E-10
78	15300.00	92.45	266.64	100	7880.4	7368.7	-431.3	-7356.1	7368.7	266.6	0.0	0.0	8196.1	-25.1	1.613609	4.65	1E-10
79	15400.00	92.45	266.64	100	7876.1	7468.6	-437.2	-7455.8	7468.6	266.6	0.0	0.0	8196.1	-25.1	1.613609	4.65	1E-10
80	15500.00	92.45	266.64	100	7871.8	7568.5	-443.0	-7555.5	7568.5	266.6	0.0	0.0	8196.1	-25.1	1.613609	4.65	1E-10
81	15600.00	92.45	266.64	100	7867.6	7668.4	-448.9	-7655.3	7668.4	266.6	0.0	0.0	8196.1	-25.1	1.613609	4.65	1E-10
82	15687.73	92.45	266.64	87.733	7863.8	7756.1	-454.0	-7742.8	7756.1	266.6	0.0	0.0	8196.1	-25.1	1.613609	4.65	1E-10

**STATE OF NEW MEXICO  
ENERGY, MINERALS AND NATURAL RESOURCES DEPARTMENT  
OIL CONSERVATION DIVISION**

**APPLICATION OF MEWBOURNE OIL  
COMPANY FOR COMPULSORY POOLING,  
EDDY COUNTY, NEW MEXICO.**

**Case No. 22648**

**SELF-AFFIRMED STATEMENT OF NOTICE**

COUNTY OF SANTA FE     )  
  ) ss.  
STATE OF NEW MEXICO    )

James Bruce deposes and states:

1. I am over the age of 18, and have personal knowledge of the matters stated herein.
2. I am an attorney for Mewbourne Oil Company.
3. Mewbourne Oil Company has conducted a good faith, diligent effort to find the names and correct addresses of the interest owners entitled to receive notice of the application filed herein.
4. Notice of the application was provided to the interest owners, at their last known addresses, by certified mail. Copies of the notice letter and certified return receipts are attached hereto as Attachment A.
5. Applicant has complied with the notice provisions of Division Rules.
6. I understand that this Self-Affirmed Statement will be used as written testimony in this case. I affirm that my testimony in paragraphs 1 through 5 above is true and correct and is made under penalty of perjury under the laws of the State of New Mexico. My testimony is made as of the date handwritten next to my signature below.

Date:

7/5/22

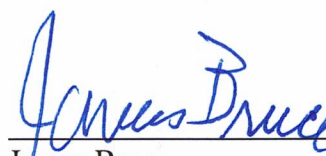
  
James Bruce

EXHIBIT

4

**JAMES BRUCE**  
ATTORNEY AT LAW

POST OFFICE BOX 1056  
SANTA FE, NEW MEXICO 87504

369 MONTEZUMA, NO. 213  
SANTA FE, NEW MEXICO 87501

(505) 982-2043 (Phone)  
(505) 660-6612 (Cell)  
(505) 982-2151 (Fax)

[jamesbruc@aol.com](mailto:jamesbruc@aol.com)

June 16, 2022

CERTIFIED MAIL - RETURN RECEIPT REQUESTED

Ladies and gentlemen:

Enclosed is a copy of an application for compulsory pooling (Case No. 22648), filed with the New Mexico Oil Conservation Division by Mewbourne Oil Company, seeking to pool all uncommitted mineral interest owners in the Bone Spring formation underlying a horizontal spacing unit comprised of the S/2SE/4 of Section 28 and the S/2S/2 of Section 27, Township 20 South, Range 27 East, NMPM. The unit will be dedicated to the Nina 28/27 B3OP Fed. Com. Well No. 1H.

This matter is scheduled for hearing at 8:15 a.m. on Thursday, July 7, 2022. During the COVID-19 Public Health Emergency, state buildings are closed to the public and the hearing will be conducted remotely. To determine the location of the hearing or to participate in an electronic hearing, go to [emnrd.state.nm.us/OCD/hearings](http://emnrd.state.nm.us/OCD/hearings) or see the instructions posted on the Division's website, <http://emnrd.state.nm.us/OCD/announcements.html>. You are not required to attend this hearing, but as an owner of an interest who may be affected by the application, you may appear and present testimony. Failure to appear at that time and become a party of record will preclude you from contesting this matter at a later date. A party appearing in a Division case is required by Division Rules to file a Pre-Hearing Statement no later than five business days before the hearing date. This statement may be filed online with the Division at [ocd.hearings@state.nm.us](mailto:ocd.hearings@state.nm.us), and should include: The name of the party and his or her attorney; a concise statement of the case; the name(s) of the witness(es) the party will call to testify at the hearing; the approximate time the party will need to present his or her case; and identification of any procedural matters that need to be resolved prior to the hearing. The Pre-Hearing Statement must also be provided to the undersigned.

Very truly yours,

  
James Bruce

Attorney for Mewbourne Oil Company

ATTACHMENT

A

EXHIBIT A

Canyon Draw Resources, LLC  
3333 Lee Parkway, Suite 750  
Dallas, Texas 75219  
Attn: Erin Devlin

Sabinal Energy Operating LC  
1780 Hughes Landing Boulevard, Suite 1200  
The Woodlands, TX 77380  
Attn: Nicole Reeves

SSB Production LC  
PO Box 998  
Ardmore, OK 73402  
Attn: Bane Bigbie

Bane Bigbie  
PO Box 998  
Ardmore, OK 73402-0998

The James K Lusk and Martha L Lusk Trust  
PO Box 1310  
Wilsonville, Oregon 97070

JTD Resources  
PO Box 3422  
Midland, TX 79702  
Attn: Dan Leonard

Branko, Inc  
13 Deslauriers Circle  
St. Albert, Alberta Canada T8N-5y6  
Attn: Branko Jankovic

Permian Basin Investment Corporation  
648 Petroleum Bldg.  
Roswell, NM 88201  
Attn: Land Department

**U.S. Postal Service™  
CERTIFIED MAIL® RECEIPT**  
Domestic Mail Only

For delivery information, visit our website at [www.usps.com](http://www.usps.com)®.

**OFFICIAL USE**

Certified Mail Fee \$  
Extra Services & Fees (check box, add fee as appropriate)  
☐ Return Receipt (hardcopy) \$  
☐ Return Receipt (electronic) \$  
☐ Certified Mail Restricted Delivery \$  
☐ Adult Signature Required \$  
☐ Adult Signature Restricted Delivery \$  
 Postage \$  
**Total Postage and Fees** \$  
 Sabinal Energy Operating LC  
 1780 Hughes Landing Boulevard, Suite 1200  
 The Woodlands, TX 77380  
 Attn: Nicole Reeves  
 Street and Apt. No., or P.O. Box  
 City, State, ZIP+4®  
 PS Form 3800, April 2015 PSN 7530-02-000-9047 See Reverse for Instructions

Postmark Here

**SENDER: COMPLETE THIS SECTION**

1. Complete items 1, 2, and 3.  
 Print your name and address on the reverse so that we can return the card to you.  
 Attach this card to the back of the mailpiece, or on the front if space permits.

1. Article Addressed to:

Canyon Draw Resources, LLC  
 3333 Lee Parkway, Suite 750  
 Dallas, Texas 75219  
 Attn: Erin Devlin

2. Article Addressed to:

7021 0350 0001 3337 6304 restricted Delivery

PS Form 3811, July 2020 PSN 7530-02-000-9053

**COMPLETE THIS SECTION ON DELIVERY**

A. Signature ☒ Agent ☐ Addressee  
 B. Received by (Printed Name) C. Date of Delivery  
 D. Is delivery address different from item 1? ☐ Yes ☐ No  
 If YES, enter delivery address below:

3. Service Type  
☐ Adult Signature  
☐ Adult Signature Restricted Delivery  
☒ Certified Mail®  
☐ Certified Mail Restricted Delivery  
☐ Signature Confirmation™  
☐ Signature Confirmation Restricted Delivery  
☐ Collect on Delivery  
☐ Collect on Delivery Restricted Delivery

Domestic Return Receipt

**U.S. Postal Service™  
CERTIFIED MAIL® RECEIPT**  
Domestic Mail Only

For delivery information, visit our website at [www.usps.com](http://www.usps.com)®.

**OFFICIAL USE**

Certified Mail Fee \$  
Extra Services & Fees (check box, add fee as appropriate)  
☐ Return Receipt (hardcopy) \$  
☐ Return Receipt (electronic) \$  
☐ Certified Mail Restricted Delivery \$  
☐ Adult Signature Required \$  
☐ Adult Signature Restricted Delivery \$  
 Postage \$  
**Total Postage and Fees** \$  
 Canyon Draw Resources, LLC  
 3333 Lee Parkway, Suite 750  
 Dallas, Texas 75219  
 Attn: Erin Devlin  
 Street and Apt. No., or P.O. Box  
 City, State, ZIP+4®  
 PS Form 3800, April 2015 PSN 7530-02-000-9047 See Reverse for Instructions

Postmark Here

**SENDER: COMPLETE THIS SECTION**

1. Complete items 1, 2, and 3.  
 Print your name and address on the reverse so that we can return the card to you.  
 Attach this card to the back of the mailpiece, or on the front if space permits.

1. Article Addressed to:

Sabinal Energy Operating LC  
 1780 Hughes Landing Boulevard, Suite 1200  
 The Woodlands, TX 77380  
 Attn: Nicole Reeves

2. Article Addressed to:

7021 0350 0001 3337 6298 restricted Delivery

PS Form 3811, July 2020 PSN 7530-02-000-9053

**COMPLETE THIS SECTION ON DELIVERY**

A. Signature ☒ Agent ☐ Addressee  
 B. Received by (Printed Name) C. Date of Delivery  
 D. Is delivery address different from item 1? ☐ Yes ☐ No  
 If YES, enter delivery address below:

3. Service Type  
☐ Adult Signature  
☐ Adult Signature Restricted Delivery  
☒ Certified Mail®  
☐ Certified Mail Restricted Delivery  
☐ Collect on Delivery  
☐ Collect on Delivery Restricted Delivery  
☐ Insured Mail  
☐ Priority Mail Express®  
☐ Registered Mail™  
☐ Registered Mail Restricted Delivery  
☐ Signature Confirmation™  
☐ Signature Confirmation Restricted Delivery

Domestic Return Receipt

**SENDER: COMPLETE THIS SECTION**

■ Complete items 1, 2, and 3.  
 ■ Print your name and address on the reverse so that we can return the card to you.  
 ■ Attach this card to the back of the mailpiece, or on the front if space permits.

1. Article Addressed to:

SSB Production LC  
 PO Box 998  
 Ardmore, OK 73402  
 Attn: Bane Bigbie

9590 9402 6746 1074 4017 50

2. Article Number (Transfer from service label)  
 7021 0350 0001 3337 6281

PS Form 3811, July 2020 PSN 7530-02-000-9053

**COMPLETE THIS SECTION ON DELIVERY**

A. Signature [Signature] ☐ Agent ☐ Addressee

B. Received by (Printed Name) Bane Bigbie C. Date of Delivery JUN 27 2022

D. Is delivery address different from item 1? ☐ Yes ☒ No

If YES, enter delivery address below:

3. Service Type

☐ Adult Signature Restricted Delivery  
☒ Certified Mail®  
☐ Collect on Delivery  
☐ Insured Mail  
☐ Registered Mail™  
☐ Registered Mail Restricted Delivery  
☐ Signature Confirmation™  
☐ Signature Confirmation Restricted Delivery  
☐ Priority Mail Express®

Domestic Return Receipt MI - NM

**U.S. Postal Service™  
 CERTIFIED MAIL RECEIPT**  
 Domestic Mail Only

For delivery information, visit our website at [www.usps.com](http://www.usps.com).

**OFFICIAL USE**

Certified Mail Fee \$  
 Extra Services & Fees (check box, add fee as appropriate)  
☐ Return Receipt (hardcopy) \$  
☐ Return Receipt (electronic) \$  
☐ Certified Mail Restricted Delivery \$  
☐ Adult Signature Required \$  
☐ Adult Signature Restricted Delivery \$  
 Postage \$  
 Total Postage and Fees \$

Sent To SSB Production LC  
 PO Box 998  
 Ardmore, OK 73402  
 Street and Apt. No., or  
 City, State, ZIP+4®

PS Form 3800, April 2015 PSN 7530-02-000-9047 See Reverse for Instructions

7021 0350 0001 3337 6243

U.S. Postal Service<sup>TM</sup>  
**CERTIFIED MAIL<sup>®</sup> RECEIPT**  
Domestic Mail Only

For delivery information, visit our website at [www.usps.com](http://www.usps.com).

**OFFICIAL USE**

Certified Mail Fee  
\$

Extra Services & Fees (check box, add fee as appropriate)

<input type="checkbox"/> Return Receipt (hardcopy)	\$
<input type="checkbox"/> Return Receipt (electronic)	\$
<input type="checkbox"/> Certified Mail Restricted Delivery	\$
<input type="checkbox"/> Adult Signature Required	\$
<input type="checkbox"/> Adult Signature Restricted Delivery	\$

Postage  
\$

**Total Postage and Fees**  
\$

Sent To  
Permian Basin Investment Corporation  
648 Petroleum Bldg.  
Roswell, NM 88201  
Attn: Land Department

Street and Apt. No., c  
City, State, ZIP+4<sup>®</sup>

Postmark Here

PS Form 3800, April 2015 PSN 7530-02-000-9047 See Reverse for Instructions

7021 0350 0001 3337 6250

U.S. Postal Service<sup>TM</sup>  
**CERTIFIED MAIL<sup>®</sup> RECEIPT**  
Domestic Mail Only

For delivery information, visit our website at [www.usps.com](http://www.usps.com).

**OFFICIAL USE**

Certified Mail Fee  
\$

Extra Services & Fees (check box, add fee as appropriate)

<input type="checkbox"/> Return Receipt (hardcopy)	\$
<input type="checkbox"/> Return Receipt (electronic)	\$
<input type="checkbox"/> Certified Mail Restricted Delivery	\$
<input type="checkbox"/> Adult Signature Required	\$
<input type="checkbox"/> Adult Signature Restricted Delivery	\$

Postage  
\$

**Total Postage and Fees**  
\$

Sent To  
JTD Resources  
PO Box 3422  
Midland, TX 79702  
Attn: Dan Leonard

Street and Apt. No., c  
City, State, ZIP+4<sup>®</sup>

Postmark Here

PS Form 3800, April 2015 PSN 7530-02-000-9047 See Reverse for Instructions

7021 0350 0001 3337 6274

U.S. Postal Service<sup>TM</sup>  
**CERTIFIED MAIL<sup>®</sup> RECEIPT**  
Domestic Mail Only

For delivery information, visit our website at [www.usps.com](http://www.usps.com).

**OFFICIAL USE**

Certified Mail Fee  
\$

Extra Services & Fees (check box, add fee as appropriate)

<input type="checkbox"/> Return Receipt (hardcopy)	\$
<input type="checkbox"/> Return Receipt (electronic)	\$
<input type="checkbox"/> Certified Mail Restricted Delivery	\$
<input type="checkbox"/> Adult Signature Required	\$
<input type="checkbox"/> Adult Signature Restricted Delivery	\$

Postage  
\$

**Total Postage and Fees**  
\$

Sent To  
Bane Bigbie  
PO Box 998  
Ardmore, OK 73402-0998

Street and Apt. No., or PO Box No.  
City, State, ZIP+4<sup>®</sup>

Postmark Here

PS Form 3800, April 2015 PSN 7530-02-000-9047 See Reverse for Instructions

7021 0350 0001 3337 6267

U.S. Postal Service<sup>TM</sup>  
**CERTIFIED MAIL<sup>®</sup> RECEIPT**  
Domestic Mail Only

For delivery information, visit our website at [www.usps.com](http://www.usps.com).

**OFFICIAL USE**

Certified Mail Fee  
\$

Extra Services & Fees (check box, add fee as appropriate)

<input type="checkbox"/> Return Receipt (hardcopy)	\$
<input type="checkbox"/> Return Receipt (electronic)	\$
<input type="checkbox"/> Certified Mail Restricted Delivery	\$
<input type="checkbox"/> Adult Signature Required	\$
<input type="checkbox"/> Adult Signature Restricted Delivery	\$

Postage  
\$

**Total Postage and Fees**  
\$

Sent To  
The James K Lusk and Martha L Lusk Trust  
PO Box 1310  
Wilsonville, Oregon 97070

Street and Apt. No., or  
City, State, ZIP+4<sup>®</sup>

Postmark Here

PS Form 3800, April 2015 PSN 7530-02-000-9047 See Reverse for Instructions

# Carlsbad Current Argus.

PART OF THE USA TODAY NETWORK

## Affidavit of Publication

Ad # 0005263243

This is not an invoice

**JAMES BRUCE ATTORNEY AT LAW**  
POBOX 1056

**SANTA FE, NM 87504**

I, a legal clerk of the **Carlsbad Current Argus**, a newspaper published daily at the City of Carlsbad, in said county of Eddy, state of New Mexico and of general paid circulation in said county; that the same is a duly qualified newspaper under the laws of the State wherein legal notices and advertisements may be published; that the printed notice attached hereto was published in the regular and entire edition of said newspaper and not in supplement thereof in editions dated as follows:

05/20/2022



Legal Clerk

Subscribed and sworn before me this May 20, 2022:

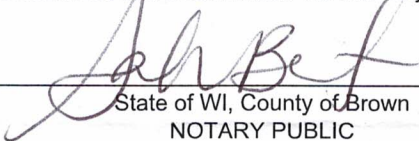

State of WI, County of Brown  
NOTARY PUBLIC



My commission expires

SARAH BERTELSEN  
Notary Public  
State of Wisconsin

### NOTICE

To: Canyon Draw Resources LLC, Sabinal Energy Operating LC, SSB Production LC, Bane Bigbie, The James K. Lusk and Martha L. Lusk Trust, JTD Resources, Branko, Inc., and Permian Basin Investment Corporation, or your heirs, devisees, successors, or assigns: Mewbourne Oil Company has filed an application with the New Mexico Oil Conservation Division seeking an order pooling all uncommitted mineral interest owners in the Bone Spring formation in a horizontal spacing unit comprised of the S/2SE/4 of Section 28 and the S/2S/2 of Section 27, Township 20 South, Range 27 East, NMPM. The unit will be dedicated to the Nina 28/27 B3OP Fed. Com. Well No. 1H. Also to be considered will be the cost of drilling, completing, and equipping the well and the allocation of the cost thereof, as well as actual operating costs and charges for supervision, designation of applicant as operator of the well, and a 200% charge for the risk involved in drilling, completing, and equipping the well. This matter is scheduled for hearing at 8:15 a.m. on Thursday, June 2, 2022. During the COVID-19 Public Health Emergency, state buildings are closed to the public and the hearing will be conducted remotely. To determine the location of the hearing or to participate in an electronic hearing, go to [emnrd.state.nm.us/OCD/hearings](http://emnrd.state.nm.us/OCD/hearings) or see the instructions posted on the Division's website, <http://emnrd.state.nm.us/OCD/announcements.html>. You are not required to attend this hearing, but as an owner of an interest that may be affected by this application, you may appear and present testimony. A party appearing in a Division case is required by Division Rules to file a Pre-Hearing Statement no later than Thursday, May 26, 2022. This statement may be filed online with the Division at [ocd.hearings@state.nm.us](mailto:ocd.hearings@state.nm.us). Failure to appear at that time and become a party of record will preclude you from contesting this matter at a later date. The attorney for applicant is James Bruce, P.O. Box 1056, Santa Fe, New Mexico 87504, [jamesbruc@aol.com](mailto:jamesbruc@aol.com). The unit is located approximately 9 miles southeast of Lakewood, New Mexico.

#5263243, Current Argus, May 20, 2022

Ad # 0005263243  
PO #: MOC-News-Nina 28-27  
# of Affidavits 1

This is not an invoice

EXHIBIT

5

**COMPULSORY POOLING APPLICATION CHECKLIST****ALL INFORMATION IN THE APPLICATION MUST BE SUPPORTED BY SIGNED AFFIDAVITS**

<b>Case:</b>	<b>22648</b>
<b>Date:</b>	<b>July 5, 2022</b>
Applicant	Mewbourne Oil Company
Designated Operator & OGRID (affiliation if applicable)	Mewbourne Oil Company/OGRID No.14744
Applicant's Counsel:	James Bruce
Case Title:	Application of Mewbourne Oil Company for Compulsory Pooling, Eddy County, New Mexico
Entries of Appearance/Intervenors:	
Well Family	Nina Bone Spring well
<b>Formation/Pool</b>	
Formation Name(s) or Vertical Extent:	Bone Spring Formation
Primary Product (Oil or Gas):	Oil
Pooling this vertical extent:	Entire Bone Spring formation
Pool Name and Pool Code:	
Well Location Setback Rules:	Statewide rules and current horizontal well rules
Spacing Unit Size:	Quarter-quarter sections/40 acres
<b>Spacing Unit</b>	
Type (Horizontal/Vertical)	Horizontal
Size (Acres)	240 acres
Building Blocks:	
Orientation:	West - East
Description: TRS/County	S/2S/2 §27 and S/2SE/4 §28-20S-27E, NMPM, Eddy County
Standard Horizontal Well Spacing Unit (Y/N), If No, describe	Yes
<b>Other Situations</b>	
Depth Severance: Y/N. If yes, description	No
Proximity Tracts: If yes, description	No
Proximity Defining Well: if yes, description	
Applicant's Ownership in Each Tract	Exhibit 2-A
<b>Well(s)</b>	
Name & API (if assigned), surface and bottom hole location, footages, completion target, orientation, completion status (standard or non-standard)	Nina 28/27 B3OP Fed. Com. Well No. 1H API No. 30-015-Pending SHL: 1000 FSL & 2540 FWL §28 BHL: 440 FSL & 100 FEL §27 FTP: 440 FSL & 2540 FEL §28 LTP: 440 FSL & 100 FEL §27 Third Bone Spring/TVD 8177 feet/MD 15878 feet

EXHIBIT

6

Horizontal Well First and Last Take Points	See above
Completion Target (Formation, TVD and MD)	See above
<b>AFE Capex and Operating Costs</b>	
Drilling Supervision/Month \$	\$8000
Production Supervision/Month \$	\$800
Justification for Supervision Costs	Exhibit 2, page 2
Requested Risk Cha648	Cost + 200%/Exhibit 2, page 2
<b>Notice of Hearing</b>	
Proposed Notice of Hearing	Exhibit 1
Proof of Mailed Notice of Hearing (20 days before hearing)	Exhibit 4
Proof of Published Notice of Hearing (10 days before hearing)	Exhibit 5
<b>Ownership Determination</b>	
Land Ownership Schematic of the Spacing Unit	Exhibit 2-B
Tract List (including lease numbers and owners)	Exhibit 2-B
Pooled Parties (including ownership type)	Exhibit 2-B
Unlocatable Parties to be Pooled	
Ownership Depth Severance (including percentage above & below)	None
<b>Joinder</b>	
Sample Copy of Proposal Letter	Exhibit 2-C
List of Interest Owners ( <i>i.e.</i> Exhibit A of JOA)	Exhibit 2-B
Chronology of Contact with Non-Joined Working Interests	Exhibit 2-C
Overhead Rates In Proposal Letter	
Cost Estimate to Drill and Complete	Exhibit 2-C
Cost Estimate to Equip Well	Exhibit 2-C
Cost Estimate for Production Facilities	Exhibit 2-C
<b>Geology</b>	
Summary (including special considerations)	Exhibit 3
Spacing Unit Schematic	Exhibits 2-A and 3-A
Gunbarrel/Lateral Trajectory Schematic	Exhibit 3-C
Well Orientation (with rationale)	Laydown/Exhibit 3
Target Formation	Bone Spring
HSU Cross Section	Exhibit 3-C
Depth Severance Discussion	Not Applicable
<b>Forms, Figures and Tables</b>	
C-102	Exhibit 2-A
Tracts	Exhibit 2-B
Summary of Interests, Unit Recapitulation (Tracts)	Exhibit 2-B

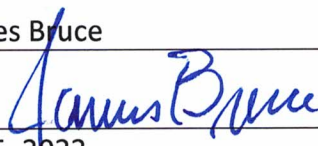
General Location Map (including basin)	Exhibits 2-A and 3-A
Well Bore Location Map	Exhibits 2-A and 3-A
Structure Contour Map - Subsea Depth	Exhibit 3-A
Cross Section Location Map (including wells)	Exhibits 3-B and 3-C
Cross Section (including Landing Zone)	Exhibit 3-C
<b>Additional Information</b>	
<b>CERTIFICATION: I hereby certify that the information provided in this checklist is complete and accurate.</b>	
<b>Printed Name</b> (Attorney or Party Representative):	James Bruce
<b>Signed Name</b> (Attorney or Party Representative):	
<b>Date:</b>	July 5, 2022