

**CASE NO. 24037**

**APPLICATION OF MEWBOURNE OIL COMPANY  
FOR COMPULSORY POOLING, EDDY COUNTY, NEW MEXICO**

**EXHIBITS**

1. Pooling Checklist
2. Landman's Affidavit
  - 2-A: C-102
  - 2-B: Tract Maps and Ownership Lists
  - 2-C: Summary of Contacts and Proposal Letter
  - 2-D: AFE
3. Geologist's Affidavit
  - 3-A: Structure Map
  - 3-B: Cross-Section
  - 3-C: Horizontal Drilling Plan
  - 3-D: Locator Map
4. Affidavit of Mailing
  - 4-A: Notice Letter
5. Certified Notice Spreadsheet
6. Publication Affidavit
7. Application and Proposed Notice



<b>COMPULSORY POOLING APPLICATION CHECKLIST</b>	
<b>ALL INFORMATION IN THE APPLICATION MUST BE SUPPORTED BY SIGNED AFFIDAVITS</b>	
<b>Case: 24037</b>	<b>APPLICANT'S RESPONSE</b>
<b>Date: December 7, 2023</b>	
Applicant	<b>Mewbourne Oil Company</b>
Designated Operator & OGRID (affiliation if applicable)	<b>Mewbourne Oil Company/OGRID 14744</b>
Applicant's Counsel:	James Bruce
Case Title:	Application of Mewbourne Oil Company for Compulsory Pooling, Eddy County, New Mexico
Entries of Appearance/Intervenors:	
Well Family	Foreigner Bone Spring wells
<b>Formation/Pool</b>	
Formation Name(s) or Vertical Extent:	Bone Spring
Primary Product (Oil or Gas):	Oil
Pooling this vertical extent:	Entire Bone Spring formation
Pool Name and Pool Code:	Culebra Bluff; Bone Spring, South/Pool Code 15011
Well Location Setback Rules:	Statewide Rules for horizontal wells – 330' and 100' setbacks
<b>Spacing Unit</b>	
Type (Horizontal/Vertical)	Horizontal
Size (Acres)	320 acres
Building Blocks:	40 acres
Orientation:	North-South
Description: TRS/County	E/2E/2 §33, Township 23 South, Range 28 East, and Lot 1, SE/4NE/4, and E/2SE/4 (the E/2E/2) §4, Township 24 South, Range 28 East, NMPM, Eddy County
Standard Horizontal Well Spacing Unit (Y/N), If No, describe <u>and is approval of non-standard unit requested in this application?</u>	Yes 
<b>Other Situations</b>	
Depth Severance: Y/N. If yes, description	N
Proximity Tracts: If yes, description	N

Proximity Defining Well: if yes, description	
Applicant's Ownership in Each Tract	Exhibit 2-B
<b>Well(s)</b>	
Name & API (if assigned), surface and bottom hole location, footages, completion target, orientation, completion status (standard or non-standard)	Add wells as needed
Well #1	Foreigner 33/4 Fed. Com. Well No. 528H API No. 30-015-Pending SHL: 215 FSL & 570 FEL §28-23S-28E BHL: 100 FSL & 660 FEL §4 FTP: 100 FNL & 660 FEL §33 LTP: 100 FSL & 660 FEL §4 Second Bone Spring/TVD 8100 feet/MD 19500 feet
Well #2	
Horizontal Well First and Last Take Points	See above
Completion Target (Formation, TVD and MD)	See above
<b>AFE Capex and Operating Costs</b>	
Drilling Supervision/Month \$	\$8000
Production Supervision/Month \$	\$800
Justification for Supervision Costs	Exhibit 2, page 2
Requested Risk Charge	Cost plus 200%
<b>Notice of Hearing</b>	
Proposed Notice of Hearing	Exhibit 1
Proof of Mailed Notice of Hearing (20 days before hearing)	Exhibit 4
Proof of Published Notice of Hearing (10 days before hearing)	Exhibit 6
<b>Ownership Determination</b>	
Land Ownership Schematic of the Spacing Unit	Exhibit 2-B
Tract List (including lease numbers and owners)	Exhibit 2-B
If approval of Non-Standard Spacing Unit is requested, Tract List (including lease numbers	



and owners) of Tracts subject to notice requirements.	
Pooled Parties (including ownership type)	Exhibit 2-B; Working Interest Owners
Unlocatable Parties to be Pooled	Yes
Ownership Depth Severance (including percentage above & below)	No Depth Severance
<b>Joinder</b>	
Sample Copy of Proposal Letter	Exhibit 2-C
List of Interest Owners (i.e. Exhibit A of JOA)	Exhibit 2-B
Chronology of Contact with Non-Joined Working Interests	Exhibit 2-C
Overhead Rates In Proposal Letter	
Cost Estimate to Drill and Complete	Exhibit 2-D
Cost Estimate to Equip Well	Exhibit 2-D
Cost Estimate for Production Facilities	Exhibit 2-D
<b>Geology</b>	
Summary (including special considerations)	Exhibit 3
Spacing Unit Schematic	Exhibits 2-A and 3-A
Gunbarrel/Lateral Trajectory Schematic	Exhibit 3-B
Well Orientation (with rationale)	West-East; Exhibits 3 and 3-A
Target Formation	Second Bone Spring Sand
HSU Cross Section	Exhibit 3-B
Depth Severance Discussion	N/A
<b>Forms, Figures and Tables</b>	
C-102	Exhibit 2-A
Tracts	Exhibit 2-B
Summary of Interests, Unit Recapitulation (Tracts)	Exhibits 2-B
General Location Map (including basin)	Exhibit 3-D
Well Bore Location Map	Exhibit 2-A
Structure Contour Map - Subsea Depth	Exhibit 3-A



Cross Section Location Map (including wells)	Exhibit 3-B
Cross Section (including Landing Zone)	Exhibit 3-C
<b>Additional Information</b>	
Special Provisions/Stipulations	
<b>CERTIFICATION: I hereby certify that the information provided in this checklist is complete and accurate.</b>	
<b>Printed Name</b> (Attorney or Party Representative):	James Bruce
<b>Signed Name</b> (Attorney or Party Representative):	
<b>Date:</b>	December 5, 2023



**STATE OF NEW MEXICO  
ENERGY, MINERALS AND NATURAL RESOURCES DEPARTMENT  
OIL CONSERVATION DIVISION**

**IN THE MATTER OF THE HEARING CALLED  
BY THE OIL CONSERVATION DIVISION FOR  
THE PURPOSE OF CONSIDERING:**

**APPLICATION OF MEWBOURNE OIL COMPANY  
FOR COMPULSORY POOLING, EDDY COUNTY,  
NEW MEXICO.**

**Case No. 24037**

**VERIFIED STATEMENT OF MITCH ROBB**

Mitch Robb, being duly sworn upon his oath, deposes and states:

1. I am a landman for Mewbourne Oil Company ("Mewbourne"), and have personal knowledge of the matters stated herein. I have been qualified by the Division as an expert petroleum landman.
2. Pursuant to NMAC 19.15.4.12.A(1), the following information is submitted in support of the compulsory pooling application filed herein:
  - (a) The purpose of this application is to force pool working interest owners into the Bone Spring horizontal spacing unit described below, and in wells to be drilled in the unit.
  - (b) No opposition is expected because the interest owners being pooled have been contacted regarding the proposed well, but have failed or refused to voluntarily commit their interests to the well. Some interest owners may be unlocatable.
  - (c) A plat outlining the unit being pooled is attached hereto as Attachment A. Mewbourne seeks an order pooling all mineral interests in the Bone Spring formation underlying the E/2E/2 of Section 33, Township 23 South, Range 28 East, NMPM and Lot 1 (NE/4NE/4), SE/4NE/4, and E/2SE/4 (E/2E/2) of Section 4, Township 24 South, Range 28 East, NMPM. The unit will be dedicated to:
    - (i) the Foreigner 33/4 Fed Com #528H, a horizontal well with a first take point in the NE/4 NE/4 of 33 and a final take point in the SE/4 SE/4 of Section 4;
  - (d) The parties being pooled and their interests are set forth in Attachment B. Their current and correct addresses, or last known addresses, are also set forth.

EXHIBIT 2



- (e) In order to locate the interest owners Mewbourne examined the county records, performed internet searches, checked telephone records, made calls to family members, and searched Accurint and Whitepages.
- (f) Attachment C contains a summary of contacts or attempted contacts with the interest owners, together with copies of the proposal letters sent to the interest owners.
- (g) Mewbourne has made a good faith effort to obtain the voluntary joinder of the working interest owners in the proposed well, or to locate the owners.
- (h) Mewbourne has the right to pool the overriding royalty owners in the well unit.
- (i) Attachment D contains the Authorizations for Expenditure for the proposed wells. The estimated costs of the wells set forth therein are fair and reasonable, and comparable to the costs of other wells of similar depth and length drilled in this area of Eddy County.
- (j) Mewbourne requests overhead and administrative rates of \$8000/month for a drilling well and \$800/month for a producing well. These rates are fair, and comparable to the rates charged by other operators for wells of this type in this portion of Eddy County. They are also the rates set forth in the Joint Operating Agreement for the well unit. Mewbourne requests that these rates be adjusted periodically as provided in the COPAS Accounting Procedure.
- (k) Mewbourne requests that the maximum cost plus 200% risk charge be assessed against non-consenting working interest owners.
- (l) Mewbourne requests that it be designated operator of the wells.
- (m) The attachments to this affidavit were prepared by me, or compiled from Company business records.
- (n) The granting of this application is in the interests of conservation and the prevention of waste.



VERIFICATION

STATE OF TEXAS                    )  
  ) ss.  
COUNTY OF MIDLAND            )

Mitch Robb, being duly sworn upon his oath, deposes and states that: He is a landman for Mewbourne Oil Company; he is authorized to make this verification on its behalf; he has read the foregoing statement, and knows the contents thereof; and the same is true and correct to the best of his knowledge, information, and belief.

  
\_\_\_\_\_  
Mitch Robb



District I  
1625 N. French Dr., Hobbs, NM 88240  
Phone: (575) 393-6161 Fax: (575) 393-0720  
District II  
811 S. First St., Artesia, NM 88210  
Phone: (575) 748-1283 Fax: (575) 748-9720  
District III  
1000 Rio Brazos Road, Aztec, NM 87410  
Phone: (505) 334-6178 Fax: (505) 334-6170  
District IV  
1220 S. St. Francis Dr., Santa Fe, NM 87505  
Phone: (505) 476-3460 Fax: (505) 476-3462

State of New Mexico  
Energy, Minerals & Natural Resources Department  
OIL CONSERVATION DIVISION  
1220 South St. Francis Dr.  
Santa Fe, NM 87505

Form C-102  
Revised August 1, 2011  
Submit one copy to appropriate  
District Office

☐ AMENDED REPORT

WELL LOCATION AND ACREAGE DEDICATION PLAT

<sup>1</sup> API Number		<sup>2</sup> Pool Code 15011		<sup>3</sup> Pool Name CULEBRA BLUFF; BONE SPRING, SOUTH					
<sup>4</sup> Property Code		<sup>5</sup> Property Name FOREIGNER 33/4 FED COM						<sup>6</sup> Well Number 528H	
<sup>7</sup> OGRID NO. 14744		<sup>8</sup> Operator Name MEWBOURNE OIL COMPANY						<sup>9</sup> Elevation 3061'	
<sup>10</sup> Surface Location									
UL or lot no. P	Section 28	Township 23S	Range 28E	Lot Idn	Feet from the 215	North/South line SOUTH	Feet From the 570	East/West line EAST	County EDDY
<sup>11</sup> Bottom Hole Location If Different From Surface									
UL or lot no. P	Section 4	Township 24S	Range 28E	Lot Idn	Feet from the 100	North/South line SOUTH	Feet from the 660	East/West line EAST	County EDDY
<sup>12</sup> Dedicated Acres 320		<sup>13</sup> Joint or Infill		<sup>14</sup> Consolidation Code		<sup>15</sup> Order No.			

No allowable will be assigned to this completion until all interest have been consolidated or a non-standard unit has been approved by the division.

<sup>16</sup> <u>GEODETIC DATA</u> NAD 83 GRID - NM EAST  <u>SURFACE LOCATION</u> N: 461837.0 - E: 617948.2  LAT: 32.2694214° N LONG: 104.0854652° W  <u>CORNER DATA</u> NAD 83 GRID - NM EAST A: FOUND 1/2" REBAR W/CAP "ILLEGIBLE" N: 451046.4 - E: 613167.1 B: FOUND 1/2" REBAR W/CAP "ILLEGIBLE" N: 453669.6 - E: 613160.5 C: FOUND 1/2" REBAR W/CAP "ILLEGIBLE" N: 456301.5 - E: 613156.1 D: FOUND COTTON SPINDLE N: 458943.1 - E: 613163.6 E: FOUND COTTON SPINDLE N: 461584.9 - E: 613170.7 F: FOUND 1/2" REBAR N: 464230.5 - E: 613156.6 G: FOUND 1/2" REBAR N: 466881.6 - E: 613142.8 H: FOUND COTTON SPINDLE N: 466898.7 - E: 615806.4 I: FOUND COTTON SPINDLE N: 466918.0 - E: 618471.2 J: FOUND 1/2" REBAR N: 461626.4 - E: 618520.2 K: FOUND 1/2" REBAR N: 458970.7 - E: 618484.3 L: FOUND BRASS CAP "1942" N: 456318.1 - E: 618448.9 M: FOUND BRASS CAP "1942" N: 453708.1 - E: 618414.1 N: FOUND 1/2" REBAR N: 451093.4 - E: 618379.9 O: FOUND BRASS CAP "1942" N: 451069.0 - E: 615773.5 P: FOUND BRASS CAP "1912" N: 456311.6 - E: 615802.4			<sup>17</sup> <b>OPERATOR CERTIFICATION</b> I hereby certify that the information contained herein is true and complete to the best of my knowledge and belief, and that this organization either owns a working interest or unleased mineral interest in the land including the proposed bottom hole location or has a right to drill this well at this location pursuant to a contract with an owner of such a mineral or working interest, or to a voluntary pooling agreement or a compulsory pooling order heretofore entered by the division. Signature: <i>Bennett Hall</i> Date: 8/25/2023 Printed Name: Bennett Hall E-mail Address: bhall@mewbourne.com <sup>18</sup> <b>SURVEYOR CERTIFICATION</b> I hereby certify that the well location shown on this plat was plotted from field notes of actual surveys made by me or under my supervision, and that the same is true and correct to the best of my belief. Date of Survey: 12/15/2022 Signature and Seal of Professional Surveyor: <i>Robert M. Howett</i> 19680 Certificate Number
--	--	--	--

EXHIBIT 2-A

JOB No: LS22121351

**Section Plat**

Foreigner 33/4 Fed Com #528H

E/2E/2 of Section 33-T23S-R28E & and Lot 1 (NE/4NE/4), SE/4NE/4,  
and E/2SE/4 (E/2E/2) of Section 4-T24S-R28E  
Eddy County, NM

**Section 33**

	Tract 1
	Tract 2
	Tract 3
	Tract 2

EXHIBIT 2.B

**Section 4****Tract 1: E2NE4 of Section 33 - Fee Leases**

MRC Permian Company  
MRC Permian LKE Company, LLC

**Tract 2: E2SE4 of Section 33 & SENE and E2SE of Section 4 - Fee Leases**

Mewbourne Oil Company, et al.  
MRC Permian Company  
Justin Nine and wife, Sara Nine

**Tract 3: Lot 1 (NENE) of Section 4 - NMNM 129728**

Mewbourne Oil Company, et al.  
MRC Permian Company  
Justin Nine and wife, Sara Nine



**RECAPITULATION FOR**  
Foreigner 33/4 Fed Com #528H

Tract Number	Number of Acres Committeed	Percentage of Interst in Communitized Area
1	80	25.011724%
2	200	62.529311%
3	39.85	12.458965%
<b>TOTAL</b>	<b>319.85</b>	<b>100.000000%</b>

**T23S-R28E, Eddy County, NM**  
**Section 33**

	Tract 1
	Tract 2
	Tract 3
	Tract 2

**Section 4**  
**T24S-R28E, Eddy County, NM**

**TRACT OWNERSHIP**

Foreigner 33/4 Fed Com #528H

E/2E/2 of Section 33-T23S-R28E &amp; and Lot 1 (NE/4NE/4), SE/4NE/4, and

E/2SE/4 (E/2E/2) of Section 4-T24S-R28E

Eddy County, NM

**E/2E/2 of Section 33 & and Lot 1 (NE/4NE/4), SE/4NE/4, and E/2SE/4 (E/2E/2) of Section 4****Bone Spring Formation:**

Owner	% of Leasehold Interest
Mewbourne Oil Company, et al.	43.571787%
*MRC Permian Company	55.933612%
*Justin Nine and wife, Sara Nine	0.103793%
*MRC Permian LKE Company, LLC	0.390808%
<b>TOTAL</b>	<b>100.000000%</b>

**Total Interest Being Pooled: 56.428213%**

---

**OWNERSHIP BY TRACT****E2NE of Section 33**

Owner	% of Leasehold Interest
MRC Permian Company	98.437500%
MRC Permian LKE Company, LLC	1.562500%
<b>TOTAL</b>	<b>100.000000%</b>

**E2SE4 of Section 33 & SENE and E2SE of Section 4**

Owner	% of Leasehold Interest
Mewbourne Oil Company, et al.	58.104800%
MRC Permian Company	41.756788%
Justin Nine and wife, Sara Nine	0.138412%
<b>TOTAL</b>	<b>58.104800%</b>

**Lot 1 (NENE) of Section 4**

Owner	% of Leasehold Interest
Mewbourne Oil Company, et al.	58.104800%
MRC Permian Company	41.756788%
Justin Nine and wife, Sara Nine	0.138412%
<b>TOTAL</b>	<b>100.000000%</b>



**Summary of Communications**  
**Foreigner 33/4 Fed Com #528H**  
**E/2E/2 of Section 33-T23S-R28E & and Lot 1 (NE/4NE/4), SE/4NE/4, and**  
**E/2SE/4 (E/2E/2) of Section 4-T24S-R28E**  
**Eddy County, NM**

**MRC Permian Company**

**MRC Permian LKE Company, LLC:**

**February 2022 to Present:** Trade discussions with above listed party

**10/05/2023:** Mailed Well Proposal, Revised Exhibit "A" & replacement page to Joint Operating Agreement and Communitization Agreement to the above listed party.

**10/30/2023:** Correspondence with above referenced party regarding proposals.

**11/06/2023:** Correspondence with above referenced party regarding proposals.

**11/28/2023:** Followed up with above referenced party regarding proposals.

**Justin Nine and wife, Sara Nine:**

**10/05/2023:** Mailed Well Proposal, Revised Exhibit "A" & replacement page to Joint Operating Agreement to the above listed party.

**11/16/2023:** Emailed Well Proposal, Revised Exhibit "A" & replacement page to Joint Operating Agreement to the above listed party.

**11/28/2023:** Followed up with above referenced party regarding proposals.

**Assigns of Joe H. Beeman:**

**10/05/2023:** Mailed Well Proposal to the above listed party.

**Ongoing:** Quiet title suit determining heirship

EXHIBIT 2 · C

**MEWBOURNE OIL COMPANY**

FASKEN CENTER  
500 WEST TEXAS, SUITE 1020  
MIDLAND, TX 79701

TELEPHONE (432) 682-3715

October 4, 2023

Via Certified Mail

Working Interest Owner

Re: Foreigner 33/4 Fed Com #528H  
215' FSL & 570' FEL (SL) (Section 28)  
100' FSL & 660' FEL (BHL) (Section 4)

Foreigner 33/4 Fed Com #525H  
215' FSL & 590' FEL (SL) (Section 28)  
100' FSL & 2000' FEL (BHL) (Section 4)

Section 33, T23S, R28E &  
Section 4, T24S, R28E  
Eddy County, New Mexico

Ladies and Gentlemen:

Under the terms of the governing Operating Agreement, dated December 1, 2015 ("JOA"), Mewbourne Oil Company ("Mewbourne") as Operator hereby proposes to drill the captioned Foreigner 33/4 Fed Com #528H at the above referenced surface locations (SL) to the referenced bottom hole locations (BHL). The proposed well will be drilled to an approximate true vertical depth (TVD) of 8,100 feet subsurface to evaluate the Bone Spring Formation. The proposed well will have a measured depth (MD) of approximately 19,500 feet. The E/2E/2 of the captioned Section 33 and the E/2E/2 of the captioned Section 4 will be dedicated to the well as the proration unit.

In addition, Mewbourne as Operator hereby proposes to drill the captioned Foreigner 33/4 Fed Com #525H at the above referenced surface locations (SL) to the referenced bottom hole locations (BHL). The proposed well will be drilled to an approximate true vertical depth (TVD) of 8,100 feet subsurface to evaluate the Bone Spring Formation. The proposed well will have a measured depth (MD) of approximately 19,500 feet. The W/2E/2 of the captioned Section 33 and the W/2E/2 of the captioned Section 4 will be dedicated to the well as the proration unit.

Regarding the above, enclosed for your further handling are our AFEs dated June 28, 2023 for the captioned proposed wells, a replacement Exhibit "A" and page 18 to the JOA. In the event your firm elects to participate in the proposed well, please execute the enclosed AFEs, initial the replacement Exhibit "A" to the JOA and return to me within thirty (30) days.

Should you have any questions regarding the above, please email me at [mrobb@mewbourne.com](mailto:mrobb@mewbourne.com) or call me at (432) 682-3715.

Sincerely,

**MEWBOURNE OIL COMPANY**

Mitch Robb  
Landman



## NEW BOURNE OIL COMPANY

## AUTHORIZATION FOR EXPENDITURE

<b>Well Name:</b> FOREIGNER 33/4 FED COM #528H (B2AP)		<b>Prospect:</b> FOREIGNER	
<b>Location:</b> SL: 215 FSL & 570 FEL (28); BHL: 100 FSL & 660 FEL (4)		<b>County:</b> Eddy <b>ST:</b> NM	
<b>Sec.</b> 28	<b>Blk:</b>	<b>Survey:</b>	<b>TWP:</b> 23S <b>RNG:</b> 28E <b>Prop. TVD:</b> 8100 <b>TMD:</b> 19500

INTANGIBLE COSTS 0180		CODE	TCP	CODE	CC
Regulatory Permits & Surveys		0180-0100	\$20,000	0180-0200	
Location / Road / Site / Preparation		0180-0105	\$50,000	0180-0205	\$35,000
Location / Restoration		0180-0106	\$200,000	0180-0206	\$50,000
Daywork / Turnkey / Footage Drilling 17 days drlg / 3 days comp @ \$28000/d		0180-0110	\$508,400	0180-0210	\$89,700
Fuel 1700 gal/day @ \$3.9/gal		0180-0114	\$120,400	0180-0214	\$241,000
Alternate Fuels		0180-0115		0180-0215	\$63,000
Mud, Chemical & Additives		0180-0120	\$35,000	0180-0220	
Mud - Specialized		0180-0121	\$250,000	0180-0221	
Horizontal Drillout Services				0180-0222	\$200,000
Stimulation Toe Preparation				0180-0223	\$40,000
Cementing		0180-0125	\$115,000	0180-0225	\$55,000
Logging & Wireline Services		0180-0130	\$34,000	0180-0230	\$377,000
Casing / Tubing / Snubbing Services		0180-0134	\$35,000	0180-0234	\$17,000
Mud Logging		0180-0137	\$15,000		
Stimulation 51 Stg 20.2 MM gal / 25.3 MM lb				0180-0241	\$3,033,000
Stimulation Rentals & Other				0180-0242	\$232,000
Water & Other 100% PW f/ MOC @ \$0.25/bbl		0180-0145	\$35,000	0180-0245	\$128,000
Bits		0180-0148	\$64,100	0180-0248	
Inspection & Repair Services		0180-0150	\$50,000	0180-0250	\$5,000
Misc. Air & Pumping Services		0180-0154		0180-0254	\$10,000
Testing & Flowback Services		0180-0158	\$12,000	0180-0258	\$20,000
Completion / Workover Rig				0180-0260	\$10,500
Rig Mobilization		0180-0164	\$150,000		
Transportation		0180-0165	\$30,000	0180-0265	\$60,000
Welding, Construction & Maint. Services		0180-0168	\$4,000	0180-0268	\$16,500
Contract Services & Supervision		0180-0170	\$114,000	0180-0270	\$70,000
Directional Services Includes Vertical Control		0180-0175	\$350,000		
Equipment Rental		0180-0180	\$125,300	0180-0280	\$42,000
Well / Lease Legal		0180-0184	\$5,000	0180-0284	
Well / Lease Insurance		0180-0185	\$5,100	0180-0285	
Intangible Supplies		0180-0188	\$7,000	0180-0288	\$1,000
Damages		0180-0190	\$10,000	0180-0290	\$10,000
Pipeline Interconnect, ROW Easements		0180-0192		0180-0292	\$5,000
Company Supervision		0180-0195	\$72,000	0180-0295	\$36,000
Overhead Fixed Rate		0180-0196	\$10,000	0180-0296	\$20,000
Contingencies 5% (TCP) 5% (CC)		0180-0199	\$121,300	0180-0299	\$243,300
<b>TOTAL</b>			<b>\$2,547,600</b>		<b>\$5,110,000</b>

TANGIBLE COSTS 0181		CODE	TCP	CODE	CC
Casing (19.1" - 30")		0181-0793			
Casing (10.1" - 19.0") 550' - 13 3/8" 54.5# J-55 ST&C @ \$58.21/ft		0181-0794	\$34,200		
Casing (8.1" - 10.0") 2550' - 9 5/8" 40# HCL80 LT&C @ \$56.93/ft		0181-0795	\$155,000		
Casing (6.1" - 8.0") 8100' - 7" 29# HPP110 BT&C @ \$51.82/ft		0181-0796	\$448,300		
Casing (4.1" - 6.0") 11600' - 4 1/2" 13.5# HCP-110 CDC-HTQ @ \$29.55/ft				0181-0797	\$366,100
Tubing 7850' - 3 1/2" 9.2# L-80 IPC Tbg @ \$23.11/ft				0181-0798	\$193,700
Drilling Head		0181-0860	\$50,000		
Tubing Head & Upper Section				0181-0870	\$30,000
Horizontal Completion Tools Completion Liner Hanger				0181-0871	\$75,000
Subsurface Equip. & Artificial Lift				0181-0880	\$25,000
Service Pumps (1/2) TP/CP/Circ pump				0181-0886	\$16,000
Storage Tanks (1/2) 4 OT/3 WT/GB				0181-0890	\$142,000
Emissions Control Equipment (1/2) 2 VRT/VRU/Flare/3 KO/AIR				0181-0892	\$138,000
Separation / Treating Equipment (1/2) 2 H Sep/V Sep/VHT/HHT				0181-0895	\$86,000
Automation Metering Equipment				0181-0898	\$88,000
Oil/Gas Pipeline-Pipe/Valves&Misc Gas Line & GL Injection				0181-0900	\$41,000
Water Pipeline-Pipe/Valves & Misc				0181-0901	\$5,000
On-site Valves/Fittings/Lines&Misc				0181-0906	\$200,000
Wellhead Flowlines - Construction				0181-0907	\$36,000
Cathodic Protection				0181-0908	
Electrical Installation				0181-0909	\$236,000
Equipment Installation				0181-0910	\$150,000
Oil/Gas Pipeline - Construction				0181-0920	\$31,000
Water Pipeline - Construction				0181-0921	\$4,000
<b>TOTAL</b>			<b>\$687,500</b>		<b>\$1,862,800</b>
<b>SUBTOTAL</b>			<b>\$3,235,100</b>		<b>\$6,972,800</b>
<b>TOTAL WELL COST</b>			<b>\$10,207,900</b>		

☐ I elect to be covered by Operator's Extra Expense Insurance and pay my proportionate share of the premium.  
Operator has secured Extra Expense Insurance covering costs of well control, clean up and redrilling as estimated in Line Item 0180-0185.

☐ I elect to purchase my own well control insurance policy.  
If neither box is checked above, non-operating working interest owner elects to be covered by Operator's well control insurance.

Joint owner agrees that item 0180-0245 will be provided by operator, if available, at the specified rate. Operator reserves the right to adjust the rate due to a change in market conditions.

Prepared by: Ryan McDaniel Date: 6/27/2023

Company Approval: m. whitte Date: 6/28/2023

Joint Owner Interest: \_\_\_\_\_ Amount: \_\_\_\_\_

Joint Owner Name: \_\_\_\_\_ Signature: \_\_\_\_\_

EXHIBIT 2-D



**STATE OF NEW MEXICO  
ENERGY, MINERALS AND NATURAL RESOURCES DEPARTMENT  
OIL CONSERVATION DIVISION**

**APPLICATIONS OF MEWBOURNE OIL COMPANY  
FOR A COMPULSORY POOLING, EDDY COUNTY,  
NEW MEXICO.**

**Case Nos. 24036 & 24037**

**SELF AFFIRMED STATEMENT OF TYLER HILL**

COUNTY OF MIDLAND                    )  
  ) ss.  
STATE OF TEXAS                         )

Tyler Hill deposes and states:

1. I am over the age of 18, and have personal knowledge of the matters stated herein.
2. I am a geologist for Mewbourne Oil Company ("Mewbourne"), and I am familiar with the geological matters involved in this case. I have been qualified by the Division as an expert petroleum geologist.
3. The following geological plats are attached hereto:
  - (a) Exhibit 3-A is a structure map of the 2<sup>nd</sup> BS formation, mapped on the top of the correlative 2<sup>nd</sup> BS 'C' Sd marker. It shows that structure dips to the east, and that the planned wellbores would drill along strike. It also shows a line of cross-section, A-A'.
  - (b) Exhibit 3-B is a north-south cross section. The well logs on the cross-section give a representative sample of the 2<sup>nd</sup> BS Sd formation in this area. The target zone for the wells is the Lower 2<sup>nd</sup> BS Sand, and that zone is continuous across the well unit.
4. I conclude from the maps that:
  - (a) The horizontal spacing unit is justified from a geologic standpoint.
  - (b) Each quarter-quarter section in the units will contribute more or less equally to production from each well.
  - (c) There is no faulting or other geologic impediment on the area which will affect the drilling of the subject wells.
5. Exhibit 3-C is a regional map that shows the Foreigner drilling units in relation to nearby cities, and its location in Eddy County, NM.

EXHIBIT 3



6. Exhibit 3-D contains the Directional Drilling plans for the wells: the Foreigner 33/4 Fed Com #525H and Foreigner 33/4 Fed Com #525H. The producing intervals of the proposed wells will be orthodox. The pool and pool code is Culebra Bluff; Bone Spring South (15011).

7. Referring to Exhibit 3-A, there are both standup and laydown well units in this area, although most of them are standup. Mewbourne's analysis shows that standup wells are a proper way to develop the reservoir.

I understand that this Self-Affirmed Statement will be used as written testimony in these cases. I affirm that my testimony in paragraphs 1 through above is true and correct and is made under penalty of perjury under the laws of the State of New Mexico. My testimony is made as of the date handwritten next to my signature below.

11/29/23  
Date

Tyler Hill  
Tyler Hill

2<sup>nd</sup> BS Sd

*Foreigner 33/4 Fed Com #525*  
*Foreigner 33/4 Fed Com #528*  
*Structure top 2<sup>nd</sup> BS Sd (C.I. 50')*

**Date:**  
28 November, 2023

Scale: 1.0"=2800'



## A









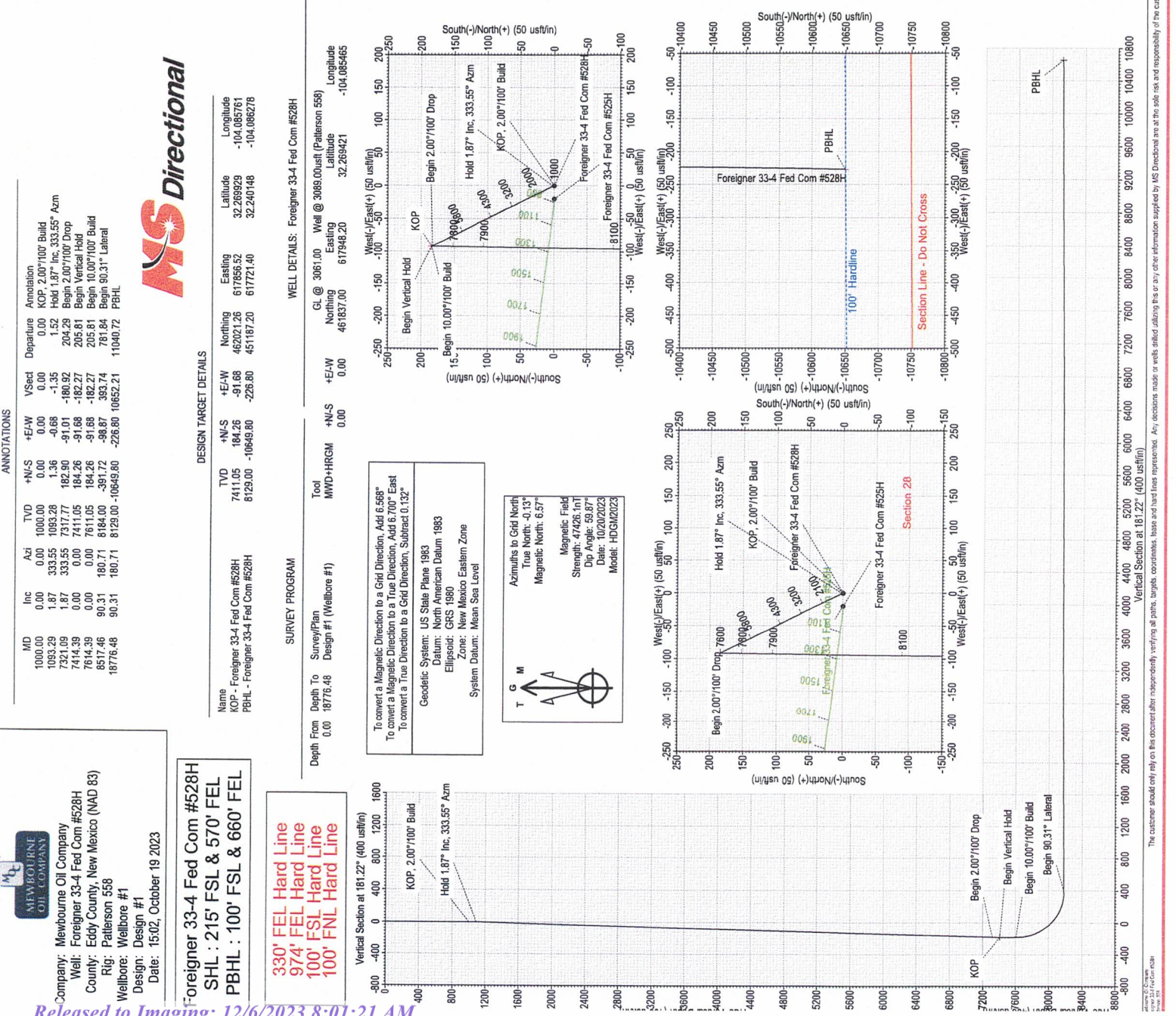



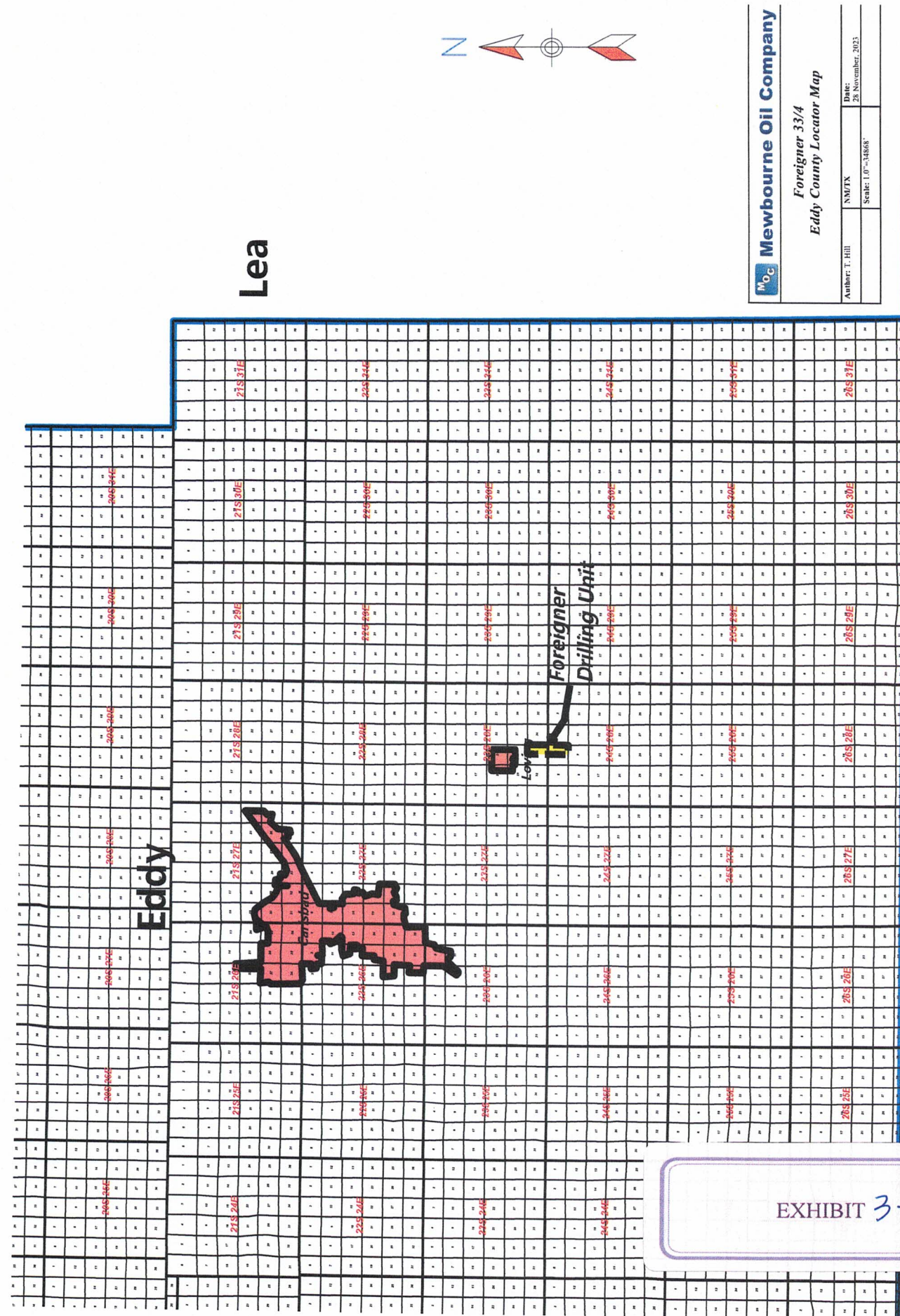



**STATE OF NEW MEXICO  
ENERGY, MINERALS AND NATURAL RESOURCES DEPARTMENT  
OIL CONSERVATION DIVISION**

**APPLICATIONS OF MEWBOURNE OIL COMPANY  
FOR COMPULSORY POOLING, EDDY COUNTY,  
NEW MEXICO.**

**Case Nos. 24036 & 24037**

**SELF-AFFIRMED STATEMENT OF NOTICE**

COUNTY OF SANTA FE     )  
  ) ss.  
STATE OF NEW MEXICO    )

James Bruce deposes and states:

1. I am over the age of 18, and have personal knowledge of the matters stated herein.
2. I am an attorney for Mewbourne Oil Company.
3. Mewbourne Oil Company has conducted a good faith, diligent effort to find the names and correct addresses of the interest owners entitled to receive notice of the application filed herein.
4. Notice of the application was provided to the interest owners, at their last known addresses, by certified mail. Copies of the notice letter and certified return receipts are attached hereto as Exhibit 2-A.
5. Applicant has complied with the notice provisions of Division Rules.

I understand that this Self-Affirmed Statement will be used as written testimony in this case. I affirm that my testimony in paragraphs 1 through 5 above is true and correct and is made under penalty of perjury under the laws of the State of New Mexico. My testimony is made as of the date handwritten next to my signature below.

Date:

12/5/23

James Bruce  
James Bruce

EXHIBIT

4

**JAMES BRUCE**  
ATTORNEY AT LAW

POST OFFICE BOX 1056  
SANTA FE, NEW MEXICO 87504

369 MONTEZUMA, NO. 213  
SANTA FE, NEW MEXICO 87501

(505) 982-2043 (Phone)  
(505) 660-6612 (Cell)  
(505) 982-2151 (Fax)

[jamesbruc@aol.com](mailto:jamesbruc@aol.com)

November 16, 2023

CERTIFIED MAIL - RETURN RECEIPT REQUESTED

To: Persons on Exhibit A

Ladies and gentlemen:

Enclosed are copies of two applications, filed with the New Mexico Oil Conservation Division by Mewbourne Oil Company, requesting the following relief:

(a) Case No. 24036: Mewbourne Oil Company seeks an order pooling all uncommitted mineral interest owners in the Bone Spring formation underlying a horizontal spacing unit comprised of the W/2E/2 of Section 33, Township 23 South, Range 28 East, N.M.P.M., and Lot 2, SW/4NE/4, and W/2SE/4 (the W/2E/2) of Section 4, Township 24 South, Range 28 East, N.M.P.M., Eddy County, New Mexico. The unit will be dedicated to the Foreigner 33/4 Fed. Com. Well No. 525H, with a first take point in the NW/4NE/4 of Section 33 and a last take point in the SW/4SE/4 of Section 4. Also to be considered will be the cost of drilling, completing, testing, and equipping the well and the allocation of the cost thereof, as well as actual operating costs and charges for supervision, designation of applicant as operator of the well, and a 200% charge for the risk involved in drilling, completing, testing and equipping the well.

(b) Case No. 24037: Mewbourne Oil Company seeks an order pooling all uncommitted mineral interest owners in the Bone Spring formation underlying a horizontal spacing unit comprised of the E/2E/2 of Section 33, Township 23 South, Range 28 East, N.M.P.M., and Lot 1, SE/4NE/4, and E/2SE/4 (the E/2E/2) of Section 4, Township 24 South, Range 28 East, N.M.P.M., Eddy County, New Mexico. The unit will be dedicated to the Foreigner 33/4 Fed. Com. Well No. 528H, with a first take point in the NE/4NE/4 of Section 33 and a last take point in the SE/4SE/4 of Section 4. Also to be considered will be the cost of drilling, completing, testing, and equipping the well and the allocation of the cost thereof, as well as actual operating costs and charges for supervision, designation of applicant as operator of the well, and a 200% charge for the risk involved in drilling, completing, testing and equipping the well.

EXHIBIT

A.A



These matters are scheduled for hearing at 8:15 a.m. on Thursday, December 7, 2023. During the current circumstances, state buildings are closed to the public and the hearing will be conducted remotely. To view the hearing docket and to determine how to participate in an electronic hearing, go to <https://www.emnrd.nm.gov/ocd/hearing-info/>, or contact Marlene Salvidrez at [Marlene.Salvidrez@emnrd.nm.gov](mailto:Marlene.Salvidrez@emnrd.nm.gov). You are not required to attend this hearing, but as an owner of an interest who may be affected by the applications, you may appear and present testimony. Failure to appear at that time and become a party of record will preclude you from contesting these matters at a later date. A party appearing in a Division case is required by Division Rules to file a Pre-Hearing Statement no later than five business days before the hearing date. This statement may be filed online with the Division at [ocd.hearings@emnrd.nm.gov](mailto:ocd.hearings@emnrd.nm.gov), and should include: The name of the party and his or her attorney; a concise statement of the case; the name(s) of the witness(es) the party will call to testify at the hearing; the approximate time the party will need to present his or her case; and identification of any procedural matters that need to be resolved prior to the hearing. The Pre-Hearing Statement must also be provided to the undersigned.

Very truly yours,



James Bruce

Attorney for Mewbourne Oil Company

EXHIBIT A

MRC Permian Company  
One Lincoln Center  
5400 LBJ Freeway, Suite 1500  
Dallas, Texas 75240

COG Production LLC  
One Concho Center  
600 W. Illinois Ave.  
Midland, TX 79701  
Attn: Brian Trejo Rojo

OXY USA WTP Limited Partnership  
5 Greenway Plaza, Suite 110  
Houston, TX 77046  
Attn: Hannah Eastwood

Justin Nine and Sara Nine  
1900 Larkspur Dr.  
Golden, CO 80401

Heirs and Assigns of Joe Beeman  
1933 San Mateo NE  
Albuquerque, NM 87110



**SENDER: COMPLETE THIS SECTION**

■ Complete items 1, 2, and 3.  
 ■ Print your name and address on the reverse so that we can return the card to you.  
 ■ Attach this card to the back of the mailpiece, or on the front if space permits.

1. Article Addressed to:

MRC Permian Company  
 One Lincoln Center  
 5400 LBJ Freeway, Suite 1500  
 Dallas, Texas 75240

2. A 7020 0090 0000 0863 3596 (over \$500)

PS Form 3811, July 2020 PSN 7530-02-000-9053

**COMPLETE THIS SECTION ON DELIVERY**

A. Signature ☒ Agent ☐ Addressee

B. Received by (Printed Name) OWN 2023 Date of Delivery 11/20/23

D. Is delivery address different from item 1? ☐ Yes ☐ No  
 If YES, enter delivery address below:

3. Service Type  
☐ Adult Signature  
☐ Adult Signature Restricted Delivery  
☒ Certified Mail®  
☐ Certified Mail Restricted Delivery  
☐ Collect on Delivery  
☐ Priority Mail Express®  
☐ Registered Mail™  
☐ Registered Mail Restricted Delivery  
☐ Signature Confirmation™  
☐ Signature Confirmation Restricted Delivery

Domestic Return Receipt

**U.S. Postal Service™**  
**CERTIFIED MAIL® RECEIPT**  
 Domestic Mail Only

For delivery information, visit our website at [www.usps.com](http://www.usps.com)

**OFFICIAL USE**

Certified Mail Fee \$  
 Extra Services & Fees (check box, add fee as appropriate)  
☐ Return Receipt (hardcopy) \$  
☐ Return Receipt (electronic) \$  
☐ Certified Mail Restricted Delivery \$  
☐ Adult Signature Required \$  
☐ Adult Signature Restricted Delivery \$

Postage \$  
 Total Postage and F 5400 LBJ Freeway, Suite 1500  
 Dallas, Texas 75240

Sent To  
 Street and Apt. No., or PO Box No.  
 City, State, ZIP+4®

PS Form 3800, April 2015 PSN 7530-02-000-9047 See Reverse for Instructions

**SENDER: COMPLETE THIS SECTION**

■ Complete items 1, 2, and 3.  
 ■ Print your name and address on the reverse so that we can return the card to you.  
 ■ Attach this card to the back of the mailpiece, or on the front if space permits.

1. Article Addressed to:

OXY USA WTP Limited Partnership  
 5 Greenway Plaza, Suite 110  
 Houston, TX 77046  
 Attn: Hannah Eastwood

2. Article Number (Transfer from reverse) 7020 0090 0000 0863 3572 (over \$500)

PS Form 3811, July 2020 PSN 7530-02-000-9053

**COMPLETE THIS SECTION ON DELIVERY**

A. Signature ☒ Agent ☐ Addressee

B. Received by (Printed Name) OWN 2023 C. Date of Delivery 11/20/23

D. Is delivery address different from item 1? ☐ Yes ☒ No  
 If YES, enter delivery address below:

3. Service Type  
☐ Adult Signature  
☐ Adult Signature Restricted Delivery  
☒ Certified Mail®  
☐ Certified Mail Restricted Delivery  
☐ Collect on Delivery  
☐ Priority Mail Express®  
☐ Registered Mail™  
☐ Registered Mail Restricted Delivery  
☐ Signature Confirmation™  
☐ Signature Confirmation Restricted Delivery

Domestic Return Receipt

**U.S. Postal Service™**  
**CERTIFIED MAIL® RECEIPT**  
 Domestic Mail Only

For delivery information, visit our website at [www.usps.com](http://www.usps.com)

**OFFICIAL USE**

Certified Mail Fee \$  
 Extra Services & Fees (check box, add fee as appropriate)  
☐ Return Receipt (hardcopy) \$  
☐ Return Receipt (electronic) \$  
☐ Certified Mail Restricted Delivery \$  
☐ Adult Signature Required \$  
☐ Adult Signature Restricted Delivery \$

Postage \$  
 Total Postage and F 5 Greenway Plaza, Suite 110  
 Houston, TX 77046  
 Attn: Hannah Eastwood

Sent To  
 Street and Apt. No., or PO Box No.  
 City, State, ZIP+4®

PS Form 3800, April 2015 PSN 7530-02-000-9047 See Reverse for Instructions



SENDER: COMPLETE THIS SECTION		COMPLETE THIS SECTION ON DELIVERY	
<p>■ Complete items 1, 2, and 3.</p> <p>■ Print your name and address on the reverse so that we can return the card to you.</p> <p>■ Attach this card to the back of the mailpiece, or on the front if space permits.</p>		<p>A. Signature <u>[Signature]</u> <input type="checkbox"/> Agent <input type="checkbox"/> Addressee</p>	
<p>1. Article Addressed to:</p> <p>COG Production LLC One Concho Center 600 W. Illinois Ave. Midland, TX 79701 Attn: Brian Trejo Rojo</p>		<p>B. Received by (Printed Name) <u>Wm Villano</u> C. Date of Delivery <u>11-21</u></p>	
<p>2. Article Number <u>7020 0090 0000 0863 3589</u> (over \$500) <u>M-F</u></p>		<p>D. Is delivery address different from item 1? <input type="checkbox"/> Yes <input type="checkbox"/> No If YES, enter delivery address below:</p>	
<p>3. Service Type</p> <p><input type="checkbox"/> Adult Signature <input type="checkbox"/> Priority Mail Express®  <input type="checkbox"/> Adult Signature Restricted Delivery <input type="checkbox"/> Registered Mail™  <input checked="" type="checkbox"/> Certified Mail® <input type="checkbox"/> Registered Mail Restricted Delivery  <input type="checkbox"/> Certified Mail Restricted Delivery <input type="checkbox"/> Signature Confirmation™  <input type="checkbox"/> Collect on Delivery <input type="checkbox"/> Signature Confirmation Restricted Delivery</p>		<p>Domestic Return Receipt</p>	

U.S. Postal Service™ CERTIFIED MAIL® RECEIPT Domestic Mail Only	
For delivery information, visit our website at <a href="http://www.usps.com">www.usps.com</a> ®.	
<b>OFFICIAL USE</b>	
Certified Mail Fee \$	Postmark Here
Extra Services & Fees (check box, add fee as appropriate)	
<input type="checkbox"/> Return Receipt (hardcopy) \$	
<input type="checkbox"/> Return Receipt (electronic) \$	
<input type="checkbox"/> Certified Mail Restricted Delivery \$	
<input type="checkbox"/> Adult Signature Required \$	
<input type="checkbox"/> Adult Signature Restricted Delivery \$	
Postage \$	
Total Postage and Fees \$	
Sent To	COG Production LLC
Street and Apt. No., or P.O.	One Concho Center
City, State, ZIP+4®	600 W. Illinois Ave. Midland, TX 79701 Attn: Brian Trejo Rojo
PS Form 3800, April 2015 PSN 7530-02-000-9047 See Reverse for Instructions	



7020 0090 0000 0863 3558

U.S. Postal Service™ CERTIFIED MAIL® RECEIPT Domestic Mail Only	
For delivery information, visit our website at <a href="http://www.usps.com">www.usps.com</a> ®.	
OFFICIAL USE	
Certified Mail Fee \$	Postmark Here
Extra Services & Fees (check box, add fee as appropriate)	
<input type="checkbox"/> Return Receipt (hardcopy) \$	
<input type="checkbox"/> Return Receipt (electronic) \$	
<input type="checkbox"/> Certified Mail Restricted Delivery \$	
<input type="checkbox"/> Adult Signature Required \$	
<input type="checkbox"/> Adult Signature Restricted Delivery \$	
Postage \$	
Total Postage \$	
Sent To	Heirs and Assigns of Joe Beeman
	1933 San Mateo NE
Street and Apt.	Albuquerque, NM 87110
City, State, ZIP+4®	
PS Form 3800, April 2015 PSN 7530-02-000-9047 See Reverse for Instructions	

7020 0090 0000 0863 3565

U.S. Postal Service™ CERTIFIED MAIL® RECEIPT Domestic Mail Only	
For delivery information, visit our website at <a href="http://www.usps.com">www.usps.com</a> ®.	
OFFICIAL USE	
Certified Mail Fee \$	Postmark Here
Extra Services & Fees (check box, add fee as appropriate)	
<input type="checkbox"/> Return Receipt (hardcopy) \$	
<input type="checkbox"/> Return Receipt (electronic) \$	
<input type="checkbox"/> Certified Mail Restricted Delivery \$	
<input type="checkbox"/> Adult Signature Required \$	
<input type="checkbox"/> Adult Signature Restricted Delivery \$	
Postage \$	
Total Postage and Fees \$	
Sent To	Justin Nine and Sara Nine
	1900 Larkspur Dr.
Street and Apt. No.,	Golden, CO 80401
City, State, ZIP+4®	
PS Form 3800, April 2015 PSN 7530-02-000-9047 See Reverse for Instructions	

## CASE NOS. 24036 &amp; 24037

STATUS OF CERTIFIED NOTICE

<u>INTEREST OWNER</u>	<u>MAILING DATE</u>	<u>RECEIPT DATE</u>	<u>CARD RETURNED</u>
MRC Permian Company	11/16/23	11/20/23	Yes
Concho Production LLC	11/16/23	11/21/23	Yes
OXY USA WTP Limited Partnership	11/16/23	11/20/23	Yes
Justin and Sarah Nine	11/16/23	Not returned	No
Heirs or Assigns of Joe Beeman	11/16/23	Not returned	No

EXHIBIT 5



# Carlsbad Current Argus.

PART OF THE USA TODAY NETWORK

## Affidavit of Publication

Ad # 0005860619

This is not an invoice

**JAMES BRUCE ATTORNEY AT LAW**  
POBOX 1056

**SANTA FE, NM 87504**

I, a legal clerk of the **Carlsbad Current Argus**, a newspaper published daily at the City of Carlsbad, in said county of Eddy, state of New Mexico and of general paid circulation in said county; that the same is a duly qualified newspaper under the laws of the State wherein legal notices and advertisements may be published; that the printed notice attached hereto was published in the regular and entire edition of said newspaper and not in supplement thereof in editions dated as follows:

11/22/2023



Legal Clerk

Subscribed and sworn before me this November 22, 2023:

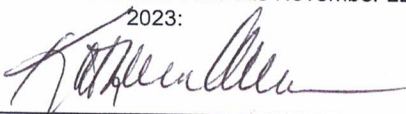

State of WI, County of Brown  
NOTARY PUBLIC

My commission expires

**KATHLEEN ALLEN**  
Notary Public  
State of Wisconsin

Ad # 0005860619  
PO #: 0005860619  
# of Affidavits 1

This is not an invoice

## NOTICE

To: MRC Permian Company, COG Production LLC, OXY USA WTP Limited Partnership, Justin Nine, Sara Nine, and Joe Beeman, or your heirs, devisees, successors, or assigns: Mewbourne Oil Company ("Mewbourne") has filed two applications with the New Mexico Oil Conservation Division requesting the following:

Case No. 24036: Mewbourne Oil Company seeks an order pooling all uncommitted mineral interest owners in the Bone Spring formation underlying a horizontal spacing unit comprised of the W/2E/2 of Section 33, Township 23 South, Range 28 East, N.M.P.M., and Lot 2, SW/4NE/4, and W/2SE/4 (the W/2E/2) of Section 4, Township 24 South, Range 28 East, N.M.P.M., Eddy County, New Mexico. The unit will be dedicated to the Foreigner 33/4 Fed. Com. Well No. 525H, with a first take point in the NW/4NE/4 of Section 33 and a last take point in the SW/4SE/4 of Section 4; and

Case No. 24037: Mewbourne Oil Company seeks an order pooling all uncommitted mineral interest owners in the Bone Spring formation underlying a horizontal spacing unit comprised of the E/2E/2 of Section 33, Township 23 South, Range 28 East, N.M.P.M., and Lot 1, SE/4NE/4, and E/2SE/4 (the E/2E/2) of Section 4, Township 24 South, Range 28 East, N.M.P.M., Eddy County, New Mexico. The unit will be dedicated to the Foreigner 33/4 Fed. Com. Well No. 528H, with a first take point in the NE/4NE/4 of Section 33 and a last take point in the SE/4SE/4 of Section 4.

Also to be considered will be the cost of drilling, completing, equipping, and testing the wells and the allocation of the cost thereof, as well as actual operating costs and charges for supervision, designation of applicant as operator of the wells, and a 200% charge for the risk involved in drilling, completing, equipping, and testing the wells. The matters are scheduled for hearing at 8:15 a.m. on Thursday, December 7, 2023. During the current circumstances, state buildings are closed to the public and the hearing will be conducted remotely. To view the hearing docket and to determine how to participate in an electronic hearing, go to <https://www.emnrd.nm.gov/ocd/hearing-info/>, or contact Marlene Salvidrez at [Marlene.Salvidrez@emnrd.nm.gov](mailto:Marlene.Salvidrez@emnrd.nm.gov). You are not required to attend this hearing, but as an owner of an interest who may be affected by the applications, you may appear and present testimony. Failure to appear at that time and become a party of record will preclude you from contesting these matters at a later date. A party appearing in a Division case is required by Division Rules to file a Pre-Hearing Statement no later than five business days before the hearing date. This statement may be filed online with the Division at [ocd.hearings@emnrd.nm.gov](mailto:ocd.hearings@emnrd.nm.gov), and should include: The name of the party and his or her attorney; a concise statement of the case; the name(s) of the witness(es) the party will call to testify at the hearing; the approximate time the party will need to present his or her case; and identification of any procedural matters that need to be resolved prior to the hearing. The attorney for applicant is James Bruce, P.O. Box 1056, Santa Fe, New Mexico 87504, (505) 982-2043, [jamesbruc@aol.com](mailto:jamesbruc@aol.com). The units are located approximately 2 miles northwest of Malaga, New Mexico. #0005860619, Current Argus, November 22, 2023

EXHIBIT 6

**BEFORE THE NEW MEXICO OIL CONSERVATION DIVISION****APPLICATION OF MEWBOURNE OIL COMPANY  
FOR COMPULSORY POOLING, EDDY COUNTY,  
NEW MEXICO.**Case No. 24037**APPLICATION**

Mewbourne Oil Company applies for an order pooling all uncommitted mineral interest owners in the Bone Spring formation underlying a horizontal spacing unit comprised of the E/2E/2 of Section 33, Township 23 South, Range 28 East, N.M.P.M., and Lot 1, SE/4NE/4, and E/2SE/4 (the E/2E/2) of Section 4, Township 24 South, Range 28 East, N.M.P.M., Eddy County, New Mexico, and in support thereof, states:

1. Applicant is an interest owner in the E/2E/2 of Section 33 and the E/2E/2 of Section (containing 319.85 acres), and has the right to drill a well thereon.

2. Applicant proposes to drill its Foreigner 33/4 Fed. Com. Well No. 528H to a depth sufficient to test the Bone Spring formation, with a first take point in the NE/4NE/4 of Section 33 and a last take point in the SE/4SE/4 of Section 4.

3. Applicant has in good faith sought to obtain the voluntary joinder of all other mineral interest owners in the E/2E/2 of Section 33 and the E/2E/2 of Section 4 for the purposes set forth herein.

4. Although applicant attempted to obtain voluntary agreements from all mineral interest owners to participate in the drilling of the well or to otherwise commit their interests to the well, certain interest owners have failed or refused to join in dedicating their interests. Therefore, applicant seeks an order pooling all uncommitted mineral interest owners in the Bone

EXHIBIT

7



Spring formation underlying the W/2E/2 of Section 33 and the W/2E/2 of Section 4, pursuant to NMSA 1978 §70-2-17.

5. The pooling of all uncommitted mineral interest owners in the Bone Spring formation underlying the E/2E/2 of Section 33 and the E/2E/2 of Section 4 will prevent the drilling of unnecessary wells, prevent waste, and protect correlative rights.

**WHEREFORE**, applicant requests that, after notice and hearing, the Division enter its order:

- A. Pooling all uncommitted mineral interest owners in the Bone Spring formation (Culebra Bluff; Bone Spring, South Pool/Pool Code 15011) underlying the E/2E/2 of Section 33 and the E/2E/2 of Section 4;
- B. Designating applicant as operator of the well;
- C. Considering the cost of drilling, completing, testing, and equipping the well, and allocating the cost among the well's working interest owners;
- D. Approving actual operating charges and costs charged for supervision, together with a provision adjusting the rates pursuant to the COPAS accounting procedure; and
- E. Setting a 200% charge for the risk involved in drilling, completing, testing and equipping the well in the event a working interest owner elects not to participate in the well.

Respectfully submitted,

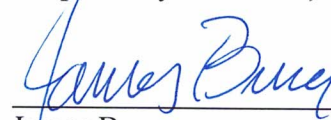

James Bruce  
Post Office Box 1056  
Santa Fe, New Mexico 87504  
(505) 982-2043

Attorney for Mewbourne Oil Company

***Application of Mewbourne Oil Company for compulsory pooling, Eddy County, New Mexico.***

Mewbourne Oil Company seeks an order pooling all uncommitted mineral interest owners in the Bone Spring formation underlying a horizontal spacing unit comprised of the E/2E/2 of Section 33, Township 23 South, Range 28 East, N.M.P.M., and Lot 1, SE/4NE/4, and E/2SE/4 (the E/2E/2) of Section 4, Township 24 South, Range 28 East, N.M.P.M., Eddy County, New Mexico. The unit will be dedicated to the Foreigner 33/4 Fed. Com. Well No. 528H, with a first take point in the NE/4NE/4 of Section 33 and a last take point in the SE/4SE/4 of Section 4. Also to be considered will be the cost of drilling, completing, testing, and equipping the well and the allocation of the cost thereof, as well as actual operating costs and charges for supervision, designation of applicant as operator of the well, and a 200% charge for the risk involved in drilling, completing, testing and equipping the well. The unit is located approximately 2 miles northwest of Malaga, New Mexico.