

**STATE OF NEW MEXICO
DEPARTMENT OF ENERGY, MINERALS AND NATURAL RESOURCES
OIL CONSERVATION DIVISION**

**APPLICATION OF PERMIAN RESOURCES
OPERATING, LLC FOR COMPULSORY
POOLING, EDDY COUNTY, NEW MEXICO.**

CASE NO. 25064

NOTICE OF AMENDED EXHIBITS

Permian Resources Operating, LLC is providing the attached amended exhibit packet,
which includes a revised Compulsory Pooling Checklist.

Respectfully submitted,

HINKLE SHANOR LLP

/s/ Dana S. Hardy

Dana S. Hardy

Jaclyn M. McLean

P.O. Box 2068

Santa Fe, NM 87504-2068

Phone: (505) 982-4554

Facsimile: (505) 982-8623

dhardy@hinklelawfirm.com

jmclean@hinklelawfirm.com

Counsel for Permian Resources Operating, LLC

**STATE OF NEW MEXICO
DEPARTMENT OF ENERGY, MINERALS AND NATURAL RESOURCES
OIL CONSERVATION DIVISION**

**APPLICATION OF PERMIAN RESOURCES
OPERATING, LLC FOR COMPULSORY
POOLING, EDDY COUNTY, NEW MEXICO.**

Case No. 25064

Exhibit Index

Compulsory Pooling Checklist

Exhibit A Self-Affirmed Statement of Ryan Curry

- | | |
|-----|--|
| A-1 | Application & Proposed Notice of Hearing |
| A-2 | C-102 |
| A-3 | Plat of Tracts, Tract Ownership, Applicable Lease Numbers, Unit Recapitulation, Pooled Parties |
| A-4 | Sample Well Proposal Letter and AFE |
| A-5 | Chronology of Contact |

Exhibit B Self-Affirmed Statement of Christopher Cantin

- | | |
|-----|-----------------------------|
| B-1 | Regional Locator Map |
| B-2 | Cross-Section Location Map |
| B-3 | Subsea Structure Map |
| B-4 | Stratigraphic Cross-Section |

Exhibit C Self-Affirmed Statement of Dana S. Hardy

- | | |
|-----|--|
| C-1 | Sample of Notice Letter Sent December 16, 2024 |
| C-2 | Chart of Notice to All Interested Parties |
| C-3 | Copies of Certified Mail Receipts and Returns |
| C-4 | Affidavit of Publication for December 19, 2024 |

COMPULSORY POOLING APPLICATION CHECKLIST	
ALL INFORMATION IN THE APPLICATION MUST BE SUPPORTED BY SIGNED AFFIDAVITS	
Case: 25064	APPLICANT'S RESPONSE
Date: February 13, 2025	
Applicant	Permian Resources Operating, LLC
Designated Operator & OGRID (affiliation if applicable)	Permian Resources Operating, LLC (OGRID No. 372165)
Applicant's Counsel:	Hinkle Shanor LLP
Case Title:	Application of Permian Resources Operating, LLC for Compulsory Pooling, Eddy County, New Mexico.
Entries of Appearance/Intervenors:	EOG Resources, Inc.
Well Family	Taipan
Formation/Pool	
Formation Name(s) or Vertical Extent:	Wolfcamp
Primary Product (Oil or Gas):	Gas
Pooling this vertical extent:	Wolfcamp
Pool Name and Pool Code:	Burton Flat, Wolfcamp, North (Gas) Pool (Code 73520)
Well Location Setback Rules:	Statewide
Spacing Unit	
Type (Horizontal/Vertical)	Horizontal
Size (Acres)	320 acres
Building Blocks:	quarter sections
Orientation:	West to East
Description: TRS/County	N/2 N/2 of Sections 21 and 22, Township 20 South, Range 28 East, Eddy County
Standard Horizontal Well Spacing Unit (Y/N), If No, describe and is approval of non-standard unit requested in this application?	No. Permian Resources will submit an administrative application for the non-standard spacing unit.
Other Situations	
Depth Severance: Y/N. If yes, description	No.
Proximity Tracts: If yes, description	No.
Proximity Defining Well: if yes, description	N/A
Applicant's Ownership in Each Tract	Exhibit A-3
Well(s)	
Name & API (if assigned), surface and bottom hole location, footages, completion target, orientation, completion status (standard or non-standard)	Add wells as needed
Well #1	Taipan 21 Fed Com 201H (API # pending) SHL: 1,507' FNL & 180' FEL (Unit H), Section 20, T20S-R28E BHL: 330' FNL & 10' FEL (Unit A), Section 22, T20S-R28E Completion Target: Wolfcamp (Approx. 8,899' TVD)
AFE Capex and Operating Costs	
Drilling Supervision/Month \$	\$10,000
Production Supervision/Month \$	\$1,000
Justification for Supervision Costs	Exhibit A-4
Requested Risk Charge	200%
Notice of Hearing	
Proposed Notice of Hearing	Exhibit A-1
Proof of Mailed Notice of Hearing (20 days before hearing)	Exhibits C-1, C-2, C-3
Proof of Published Notice of Hearing (10 days before hearing)	Exhibit C-4
Ownership Determination	
Land Ownership Schematic of the Spacing Unit	Exhibit A-3
Tract List (including lease numbers and owners)	Exhibit A-3
If approval of Non-Standard Spacing Unit is requested, Tract List (including lease numbers and owners) of Tracts subject to notice requirements.	N/A

Pooled Parties (including ownership type)	Exhibit A-3
Unlocatable Parties to be Pooled	N/A
Ownership Depth Severance (including percentage above & below)	N/A
Joinder	
Sample Copy of Proposal Letter	Exhibit A-4
List of Interest Owners (ie Exhibit A of JOA)	Exhibit A-3
Chronology of Contact with Non-Joined Working Interests	Exhibit A-5
Overhead Rates In Proposal Letter	Exhibit A-4
Cost Estimate to Drill and Complete	Exhibit A-4
Cost Estimate to Equip Well	Exhibit A-4
Cost Estimate for Production Facilities	Exhibit A-4
Geology	
Summary (including special considerations)	Exhibit B
Spacing Unit Schematic	Exhibit B-1
Gunbarrel/Lateral Trajectory Schematic	N/A
Well Orientation (with rationale)	Exhibit B
Target Formation	Exhibit B
HSU Cross Section	Exhibit B-2
Depth Severance Discussion	N/A
Forms, Figures and Tables	
C-102	Exhibit A-2
Tracts	Exhibit A-3
Summary of Interests, Unit Recapitulation (Tracts)	Exhibit A-3
General Location Map (including basin)	Exhibit B-1
Well Bore Location Map	Exhibit B-2
Structure Contour Map - Subsea Depth	Exhibit B-3
Cross Section Location Map (including wells)	Exhibit B-2
Cross Section (including Landing Zone)	Exhibit B-4
Additional Information	
Special Provisions/Stipulations	N/A
CERTIFICATION: I hereby certify that the information provided in this checklist is complete and accurate.	
Printed Name (Attorney or Party Representative):	Dana S. Hardy
Signed Name (Attorney or Party Representative):	/s/ Dana S. Hardy
Date:	2/11/2025

**STATE OF NEW MEXICO
DEPARTMENT OF ENERGY, MINERALS AND NATURAL RESOURCES
OIL CONSERVATION DIVISION**

**APPLICATION OF PERMIAN RESOURCES
OPERATING, LLC FOR COMPULSORY
POOLING, EDDY COUNTY, NEW MEXICO.**

CASE NO. 25064

**SELF-AFFIRMED STATEMENT
OF RYAN CURRY**

1. I am a Senior Landman with Permian Resources Operating, LLC ("Permian Resources"). I am over 18 years of age, have personal knowledge of the matters addressed herein, and am competent to provide this Self-Affirmed Statement. I have previously testified before the New Mexico Oil Conservation Division ("Division") and my credentials as an expert in petroleum land matters were accepted and made a matter of record.

2. Copies of Permian Resources' application and proposed hearing notice are attached as **Exhibit A-1**.

3. None of the parties proposed to be pooled in this case indicated opposition to this matter proceeding by affidavit; therefore I do not expect any opposition at hearing.

4. Permian Resources seeks an order pooling all uncommitted interests in the Wolfcamp formation underlying a 320-acre, more or less, standard horizontal spacing unit comprised of the N/2 N/2 of Sections 21 and 22, Township 20 South, Range 28 East, Eddy County, New Mexico ("Unit").

5. The Unit will be dedicated to the **Taipan 21 Fed Com 201H** well ("Well"), which will be drilled from a surface hole location in the SE/4 NE/4 (Unit H) of Section 20 to a bottom hole location in the NE/4 NE/4 (Unit A) of Section 22.

6. The completed interval of the Well will be orthodox.

7. **Exhibit A-2** contains the C-102 for the Well.

Permian Resources Operating, LLC
Case No. 25064
Exhibit A

8. **Exhibit A-3** contains a plat identifying ownership by tract in the Unit. This exhibit also includes any applicable lease numbers, a unit recapitulation, and the interests Permian Resources seeks to pool highlighted in yellow.

9. Permian Resources has conducted a diligent search of all county public records, including phone directories and computer databases, as well as internet searches, to locate the interest owners it seeks to pool.

10. **Exhibit A-4** contains a sample well proposal letter and AFE sent to working interest owners for the Well. The estimated costs reflected on the AFE are fair and reasonable and comparable to the cost of other wells of similar depth and length drilled in the subject formation in the area.

11. In my opinion, Permian Resources made a good-faith effort to reach voluntary joinder of uncommitted interests in the Well as indicated by the chronology of contact described in **Exhibit A-5**.

12. Permian Resources requests overhead and administrative rates of \$10,000 per month while the Well is being drilled and \$1,000 per month while the Well is producing. These rates are fair and are comparable to the rates charged by Permian Resources and other operators in the vicinity.

13. The attached exhibits were either prepared by me or under my supervision or were compiled from company business records.

14. In my opinion, the granting of Permian Resources' application would serve the interests of conservation, the protection of correlative rights, and the prevention of waste.

15. I understand this Self-Affirmed Statement will be used as written testimony in this case. I affirm that my testimony above is true and correct and is made under penalty of perjury

under the laws of the State of New Mexico. My testimony is made as of the date next to my electronic signature below.



RYAN CURRY

1/28/25
Date

**STATE OF NEW MEXICO
DEPARTMENT OF ENERGY, MINERALS AND NATURAL RESOURCES
OIL CONSERVATION DIVISION**

**APPLICATION OF PERMIAN RESOURCES
OPERATING, LLC FOR COMPULSORY
POOLING, EDDY COUNTY, NEW MEXICO.**

CASE NO. 25064

APPLICATION

Pursuant to NMSA § 70-2-17, Permian Resources Operating, LLC (“Applicant”) (OGRID No. 372165) applies for an order pooling all uncommitted interests in the Wolfcamp formation underlying a 320-acre, more or less, standard horizontal spacing unit comprised of the N/2 N/2 of Sections 21 and 22, Township 20 South, Range 28 East, Eddy County, New Mexico (“Unit”). In support of its application, Applicant states the following.

1. Applicant is a working interest owner in the Unit and has the right to drill wells thereon.
2. The Unit will be dedicated to the **Taipan 21 Fed Com 201H** well (“Well”), which will be drilled from a surface hole location in the SE/4 NE/4 (Unit H) of Section 20 to a bottom hole location in the NE/4 NE/4 (Unit A) of Section 22.
3. The completed interval of the Well will be orthodox.
4. Applicant has undertaken diligent, good faith efforts to obtain voluntary agreements from all interest owners to participate in the drilling of the Well but has been unable to obtain voluntary agreements from all interest owners.
5. The pooling of uncommitted interests will avoid the drilling of unnecessary wells, prevent waste, and protect correlative rights.

**Permian Resources Operating, LLC
Case No. 25064
Exhibit A-1**

6. In order to allow Applicant to obtain its just and fair share of the oil and gas underlying the subject lands, all uncommitted interests in the Unit should be pooled and Applicant should be designated the operator of the Well and the Unit.

WHEREFORE, Applicant requests that this application be set for hearing before an Examiner of the Oil Conservation Division on January 9, 2025, and, after notice and hearing as required by law, the Division enter an order:

- A. Pooling all uncommitted interests in the Unit;
- B. Approving the Well in the Unit;
- C. Designating Permian Resources Operating, LLC as operator of the Unit and the Well to be drilled thereon;
- D. Authorizing Permian Resources Operating, LLC to recover its costs of drilling, equipping, and completing the Well;
- E. Approving the actual operating charges and costs of supervision while drilling and after completion, together with a provision adjusting the rates pursuant to the COPAS accounting procedures; and
- F. Imposing a 200% charge for the risk assumed by Permian Resources Operating, LLC in drilling and completing the Well against any working interest owner who does not voluntarily participate in the drilling of the Well.

Respectfully submitted,

HINKLE SHANOR LLP

/s/ Dana S. Hardy

Dana S. Hardy

Jaclyn M. McLean

Dylan M. Villescas

P.O. Box 2068
Santa Fe, NM 87504-2068
Phone: (505) 982-4554
dhardy@hinklelawfirm.com
jmclean@hinklelawfirm.com
dvillecas@hinklelawfirm.com
*Counsel for Permian Resources Operating,
LLC*

Application of Permian Resources Operating, LLC for Compulsory Pooling, Eddy County, New Mexico. Permian Resources Operating, LLC (“Applicant”) (OGRID No. 372165) applies for an order pooling all uncommitted interests in the Wolfcamp formation underlying a 320-acre, more or less, standard horizontal spacing unit comprised of the N/2 N/2 of Sections 21 and 22, Township 20 South, Range 28 East, Eddy County, New Mexico (“Unit”). The Unit will be dedicated to the **Taipan 21 Fed Com 201H** well (“Well”), which will be drilled from a surface hole location in the SE/4 NE/4 (Unit H) of Section 20 to a bottom hole location in the NE/4 NE/4 (Unit A) of Section 22. The completed interval of the Well will be orthodox. Also to be considered will be the cost of drilling and completing the Well and the allocation of the costs, the designation of Applicant as operator of the Well, and a 200% charge for the risk involved in drilling and completing the Well. The Well is located approximately 10 miles northeast of Carlsbad, New Mexico.

<u>C-102</u> Submit Electronically Via OCD Permitting	State of New Mexico Energy, Minerals & Natural Resources Department OIL CONSERVATION DIVISION	Exhibit A-2 Revised July 9, 2024	
		Submittal Type:	<input type="checkbox"/> Initial Submittal
			<input checked="" type="checkbox"/> Amended Report
		<input type="checkbox"/> As Drilled	

WELL LOCATION INFORMATION

API Number	Pool Code 73520	Pool Name Burton Flat, Wolfcamp, North (Gas)
Property Code	Property Name TAIPAN 21 FED COM	Well Number 201H
OGRID No. 372165	Operator Name PERMIAN RESOURCES OPERATING, LLC	Ground Level Elevation 3235.47'
Surface Owner: <input type="checkbox"/> State <input checked="" type="checkbox"/> Fee <input type="checkbox"/> Tribal <input type="checkbox"/> Federal		Mineral Owner: <input checked="" type="checkbox"/> State <input type="checkbox"/> Fee <input type="checkbox"/> Tribal <input checked="" type="checkbox"/> Federal

Surface Location

UL	Section	Township	Range	Lot	Ft. from N/S	Ft. from E/W	Latitude	Longitude	County
H	20	20-S	28-E		1507' N	180' E	32.56215	-104.19203	EDDY

Bottom Hole Location

UL	Section	Township	Range	Lot	Ft. from N/S	Ft. from E/W	Latitude	Longitude	County
A	22	20-S	28-E		330' N	10' E	32.56550	-104.15690	EDDY

Dedicated Acres 320	Infill or Defining Well Defining	Defining Well API TBD	Overlapping Spacing Unit (Y/N) N	Consolidation Code TBD
Order Numbers. TBD			Well setbacks are under Common Ownership: <input checked="" type="checkbox"/> Yes <input type="checkbox"/> No	

Kick Off Point (KOP)

UL	Section	Township	Range	Lot	Ft. from N/S	Ft. from E/W	Latitude	Longitude	County
H	20	20-S	28-E		1507' N	180' E	32.56215	-104.19203	EDDY

First Take Point (FTP)

UL	Section	Township	Range	Lot	Ft. from N/S	Ft. from E/W	Latitude	Longitude	County
D	21	20-S	28-E		330' N	100' W	32.56538	-104.19112	EDDY

Last Take Point (LTP)

UL	Section	Township	Range	Lot	Ft. from N/S	Ft. from E/W	Latitude	Longitude	County
A	22	20-S	28-E		330' N	100' E	32.56550	-104.15719	EDDY

Unitized Area or Area of Uniform Interest	Spacing Unit Type <input checked="" type="checkbox"/> Horizontal <input type="checkbox"/> Vertical	Ground Floor Elevation:
---	--	-------------------------

OPERATOR CERTIFICATIONS <i>I hereby certify that the information contained herein is true and complete to the best of my knowledge and belief, and, if the well is a vertical or directional well, that this organization either owns a working interest or unleased mineral interest in the land including the proposed bottom hole location or has a right to drill this well at this location pursuant to a contract with an owner of a working interest or unleased mineral interest, or to a voluntary pooling agreement or a compulsory pooling order heretofore entered by the division.</i> <i>If this well is a horizontal well, I further certify that this organization has received the consent of at least one lessee or owner of a working interest or unleased mineral interest in each tract (in the target pool or formation) in which any part of the well's completed interval will be located or obtained a compulsory pooling order from the division.</i>		SURVEYOR CERTIFICATIONS <i>I hereby certify that the well location shown on this plat was plotted from field notes of actual surveys made by me or under my supervision, and that the same is true and correct to the best of my beliefs.</i> PRELIMINARY THIS DOCUMENT SHALL NOT BE RECORDED FOR ANY PURPOSE AND SHALL NOT BE USED OR VIEWED OR RELIED UPON AS A FINAL SURVEY DOCUMENT.	
Signature  Date 12/5/24		Signature and Seal of Professional Surveyor	
Printed Name Cassie Evans		Certificate Number	Date of Survey
Email Address Cassie.Evans@permianres.com			

Note: No allowable will be assigned to this completion until all interests have been consolidated or a non-standard unit has been approved by the division.

ACREAGE DEDICATION PLATS

This grid represents a standard section. You may superimpose a non-standard section, or larger area, over this grid. Operators must outline the dedicated acreage in a red box, clearly show the well surface location and bottom hole location, if it is directionally drilled, with the dimensions from the section lines in the cardinal directions. If this is a horizontal wellbore show on this plat the location of the First Take Point and Last Take Point, and the point within the Completed interval (other than the First Take Point or Last Take Point) that is closest to any outer boundary of the tract.

Surveyors shall use the latest United States government survey or dependent resurvey. Well locations will be in reference to the New Mexico Principal Meridian. If the land is not surveyed, contact the OCD Engineering Bureau. Independent subdivision surveys will not be acceptable.

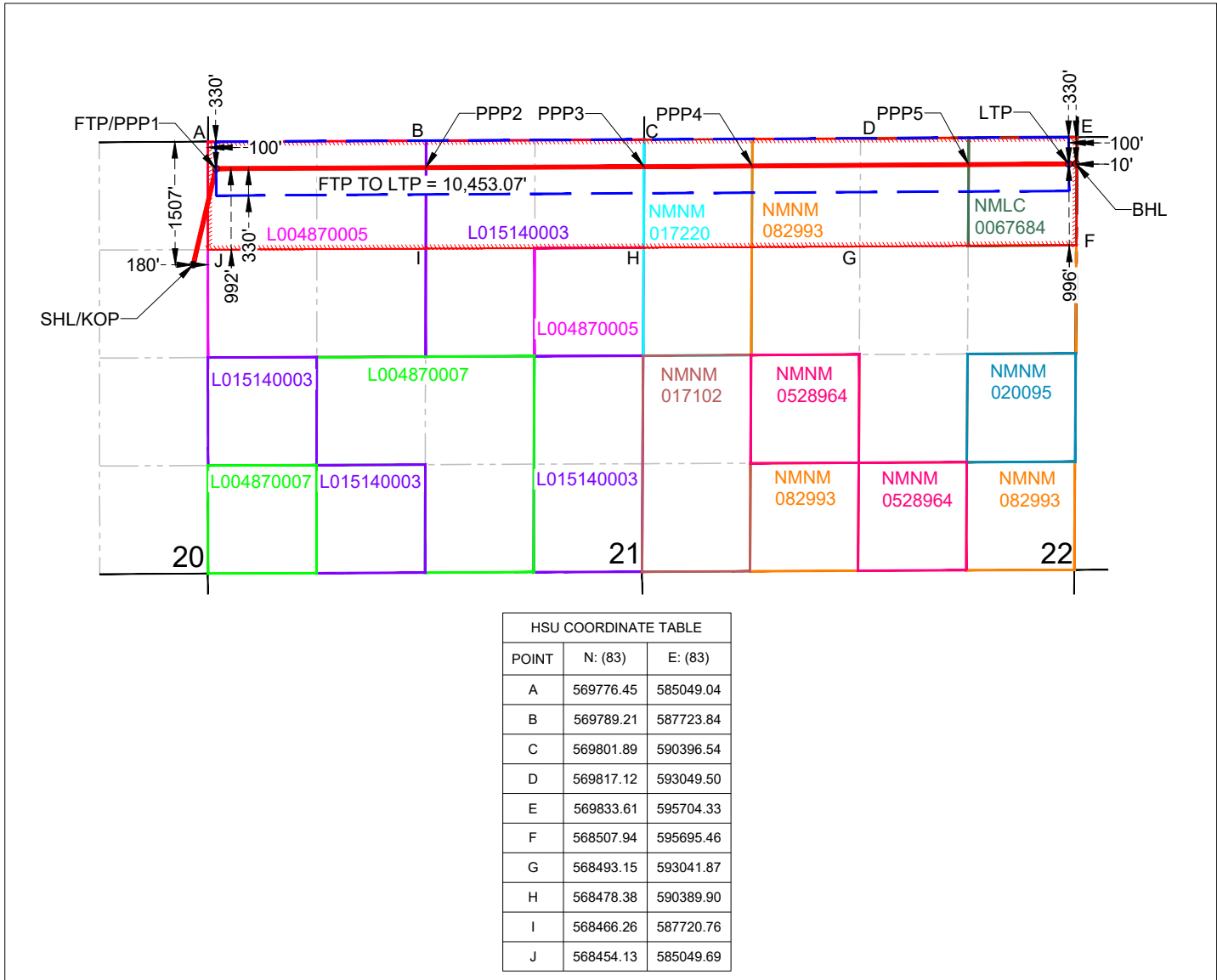

SURFACE HOLE LOCATION (SHL)
KICK OFF POINT (KOP)
NEW MEXICO EAST - NAD 83
X=584869.81 LAT.= 32.56215° N
Y=568268.31 LONG.= 104.19203° W
NEW MEXICO EAST - NAD 27
X=543689.49 LAT.= 32.56203° N
Y=568207.09 LONG.= 104.19153° W
1507' FNL, 180' FEL - SECTION 20

PENETRATION POINT 2 (PPP2)
NEW MEXICO EAST - NAD 83
X=587723.07 LAT.= 32.56541° N
Y=569459.17 LONG.= 104.18277° W
NEW MEXICO EAST - NAD 27
X=546542.75 LAT.= 32.56529° N
Y=569397.89 LONG.= 104.18226° W
330' FNL, 2672' FEL - SECTION 21
330' FNL, 0' FEL - LEASE

PENETRATION POINT 4 (PPP4)
NEW MEXICO EAST - NAD 83
X=591721.27 LAT.= 32.56545° N
Y=569479.79 LONG.= 104.16979° W
NEW MEXICO EAST - NAD 27
X=550540.94 LAT.= 32.56533° N
Y=569418.49 LONG.= 104.16928° W
330' FNL, 1326' FWL - SECTION 22
330' FNL, 0' FWL - LEASE

LAST TAKE POINT (LTP)
NEW MEXICO EAST - NAD 83
X=595602.12 LAT.= 32.56550° N
Y=569502.97 LONG.= 104.15719° W
NEW MEXICO EAST - NAD 27
X=554421.77 LAT.= 32.56538° N
Y=569441.62 LONG.= 104.15668° W
330' FNL, 100' FEL - SECTION 22
330' FNL, 100' FEL - LEASE

FIRST TAKE POINT (FTP)
PENETRATION POINT 1 (PPP1)
NEW MEXICO EAST - NAD 83
X=585149.20 LAT.= 32.56538° N
Y=569446.93 LONG.= 104.19112° W
NEW MEXICO EAST - NAD 27
X=543968.89 LAT.= 32.56527° N
Y=569385.67 LONG.= 104.19061° W
330' FNL, 100' FWL - SECTION 21
330' FNL, 100' FWL - LEASE

PENETRATION POINT 3 (PPP3)
NEW MEXICO EAST - NAD 83
X=590394.89 LAT.= 32.56543° N
Y=569471.88 LONG.= 104.17409° W
NEW MEXICO EAST - NAD 27
X=549214.56 LAT.= 32.56532° N
Y=569410.58 LONG.= 104.17359° W
330' FNL, 0' FEL - SECTION 21
330' FNL, 0' FEL - LEASE

PENETRATION POINT 5 (PPP5)
NEW MEXICO EAST - NAD 83
X=594374.83 LAT.= 32.56548° N
Y=569495.64 LONG.= 104.16117° W
NEW MEXICO EAST - NAD 27
X=553194.49 LAT.= 32.56536° N
Y=569434.31 LONG.= 104.16067° W
330' FNL, 1327' FEL - SECTION 22
330' FNL, 0' FEL - LEASE

BOTTOM HOLE LOCATION (BHL)
NEW MEXICO EAST - NAD 83
X=595692.12 LAT.= 32.56550° N
Y=569503.52 LONG.= 104.15690° W
NEW MEXICO EAST - NAD 27
X=554511.78 LAT.= 32.56538° N
Y=569442.18 LONG.= 104.15639° W
330' FNL, 10' FEL - SECTION 22
330' FNL, 10' FEL - LEASE

**Permian Resources Operating, LLC
Taipan 21 Fed Com 201H**

Township 20 South – Range 28 East, N.M.P.M.

Section 21: N/2N/2

Section 22: N/2N/2

Eddy County, New Mexico

Limited in Depth to the Wolcamp Formation

320.00 Acres, more or less

Section 21, T20S-R28E

Section 22, T20S-R28E

Tract 1: NMSLO L0-0487-0005
Tract 2: NMSLO L0-1514
Tract 3: BLM NMNM-017220
Tract 4: BLM NMNM-082993
Tract 5: BLM NMLC-0067684

**Permian Resources Operating, LLC
Case No. 25064
Exhibit A-3**

Tract 1: Section 21: N/2NW/4 (Containing 80.00 acres, more or less)

Permian Resources Operating LLC	37.776824%
EOG Resources, Inc.	50.000000%
QRE Operating, LLC	6.276824%
Karen Benbow McRae	1.931331%
Morris Allen Williams	0.515021%
Claremont Corporation	3.500000%
EOG Resources, Inc.	Record Title
Total	100.000000%

Tract 2: Section 21: N/2NE/4 (Containing 80.00 acres more or less)

Permian Resources Operating LLC	37.776824%
Magnum Hunter Production Inc.	50.000000%
Claremont Corporation	3.500000%
QRE Operating, LLC	6.276824%
Karen Benbow McRae	1.931331%
Morris Allen Williams	0.515021%
Magnum Hunter Production Inc.	Record Title
Total	100.000000%

Tract 3: Section 22: NW/4NW/4 (Containing 40.00 acres more or less)

Permian Resources Operating LLC	96.289392%
Davoil, Inc.	1.158065%
BEXP II GW Alpha, LLC	0.896208%
BEXP II Omega Misc., LLC	1.205677%
Sabinal Energy Operating, LLC	0.450658%
Total	100.000000%

Tract 4: Section 22: NE/4NW/4, NW/4NE/4 (Containing 80.00 acres more or less)

Permian Resources Operating LLC	96.289392%
Davoil, Inc.	1.158065%
BEXP II GW Alpha, LLC	0.896208%
BEXP II Omega Misc., LLC	1.205677%
Sabinal Energy Operating, LLC	0.450658%
Total	100.000000%

Tract 5: Section 22: NE/4NE/4 (Containing 40.00 acres more or less)

Permian Resources Operating LLC	96.289392%
Davoil, Inc.	1.158065%
BEXP II GW Alpha, LLC	0.896208%
BEXP II Omega Misc., LLC	1.205677%
Sabinal Energy Operating, LLC	0.450658%
Total	100.000000%

Unit Working Interest

Permian Resources Operating LLC	67.033108%
EOG Resources, Inc.	12.500000%
Magnum Hunter Production Inc.	12.500000%
QRE Operating, LLC	3.138412%
Claremont Corporation	1.750000%
BEXP II GW Alpha, LLC	0.448104%
BEXP II Omega Misc., LLC	0.602838%
Karen Benbow McRae	0.965665%
Davoil, Inc.	0.579033%
Morris Allen Williams	0.257511%
Sabinal Energy Operating, LLC	0.225329%
EOG Resources, Inc.	Record Title
Magnum Hunter Production Inc.	Record Title
Total	100.000000%
Total Committed to Unit	67.033108%
Total Seeking to Pool	32.966892%
Parties Seeking to Pool	

*Parties to be pooled are highlighted in yellow.



300 N. MARIENFELD STREET, SUITE 1000
MIDLAND, TX 79701

OFFICE 432.695.4222
FAX 432.695.4063

October 22, 2024

Via Certified Mail

CLAREMONT CORPORATION
PO BOX 3226
TULSA, OK 74101

RE: Well Proposals – Taipan 21 Fed Com Wells
All of Sections 21, & 22, T20S-R28E
Eddy County, New Mexico

To Whom It May Concern:

Permian Resources Operating, LLC (“Permian”), as operator, hereby proposes the drilling and completion of the following eight (8) wells, the Taipan 21 Fed Com Wells at the following approximate locations within Township 20 South, Range 28 East, Eddy Co., NM:

1. Taipan 21 Fed Com 131H

SHL: 1,538’ FNL & 180’ FEL or a legal location in Unit Letter H of Section 20
BHL: 990’ FNL & 50’ FEL of Section 22
FTP: 990’ FNL & 100’ FWL of Section 21
LTP: 990’ FNL & 100’ FEL of Section 22
TVD: Approximately 8,549’
TMD: Approximately 18,834’
Proration Unit: N/2N/2 of Sections 21 & 22, T20S-R28E
Targeted Interval: 3rd Bone Spring
Total Cost: See attached AFE

2. Taipan 21 Fed Com 132H

SHL: 1,598’ FNL & 180’ FEL or a legal location in Unit Letter H of Section 20
BHL: 2310’ FNL & 50’ FEL of Section 22
FTP: 2310’ FNL & 100’ FWL of Section 21
LTP: 2310’ FNL & 100’ FEL of Section 22
TVD: Approximately 8,549’
TMD: Approximately 18,834’
Proration Unit: S/2N/2 of Sections 21 & 22, T20S-R28E
Targeted Interval: 3rd Bone Spring
Total Cost: See attached AFE

3. Taipan 21 Fed Com 133H

SHL: 1,438’ FSL & 266’ FEL or a legal location in Unit Letter I of Section 20
BHL: 1650’ FSL & 50’ FEL of Section 22
FTP: 1650’ FSL & 100’ FWL of Section 21
LTP: 1650’ FSL & 100’ FEL of Section 22
TVD: Approximately 8,543’
TMD: Approximately 18,828’
Proration Unit: N/2S/2 of Sections 21 & 22, T20S-R28E
Targeted Interval: 3rd Bone Spring
Total Cost: See attached AFE

Permian Resources Operating, LLC
Case No. 25064
Exhibit A-4



300 N. MARIENFELD STREET, SUITE 1000
MIDLAND, TX 79701

OFFICE 432.695.4222
FAX 432.695.4063

4. Taipan 21 Fed Com 134H

SHL: 1,438' FSL & 326' FEL or a legal location in Unit Letter I of Section 20
BHL: 330' FSL & 50' FEL of Section 22
FTP: 330' FSL & 100' FWL of Section 21
LTP: 330' FSL & 100' FEL of Section 22
TVD: Approximately 8,563'
TMD: Approximately 18,848'
Proration Unit: S/2S/2 of Sections 21 & 22, T20S-R28E
Targeted Interval: 3rd Bone Spring
Total Cost: See attached AFE

5. Taipan 21 Fed Com 201H

SHL: 1,508' FNL & 180' FEL or a legal location in Unit Letter H of Section 20
BHL: 330' FNL & 50' FEL of Section 22
FTP: 330' FNL & 100' FWL of Section 21
LTP: 330' FNL & 100' FEL of Section 22
TVD: Approximately 8,899'
TMD: Approximately 19,184'
Proration Unit: N/2N/2 of Sections 21 & 22, T20S-R28E
Targeted Interval: Wolfcamp
Total Cost: See attached AFE

6. Taipan 21 Fed Com 202H

SHL: 1,568' FNL & 180' FEL or a legal location in Unit Letter H of Section 20
BHL: 1650' FNL & 50' FEL of Section 22
FTP: 1650' FNL & 100' FWL of Section 21
LTP: 1650' FNL & 100' FEL of Section 22
TVD: Approximately 8,899'
TMD: Approximately 19,184'
Proration Unit: S/2N/2 of Sections 21 & 22, T20S-R28E
Targeted Interval: Wolfcamp
Total Cost: See attached AFE

7. Taipan 21 Fed Com 203H

SHL: 1,438' FSL & 356' FEL or a legal location in Unit Letter I of Section 20
BHL: 2310' FSL & 50' FEL of Section 22
FTP: 2310' FSL & 100' FWL of Section 21
LTP: 2310' FSL & 100' FEL of Section 22
TVD: Approximately 8,903'
TMD: Approximately 19,188'
Proration Unit: N/2S/2 of Sections 21 & 22, T20S-R28E
Targeted Interval: Wolfcamp
Total Cost: See attached AFE

8. Taipan 21 Fed Com 204H

SHL: 1,438' FSL & 296' FEL or a legal location in Unit Letter I of Section 20
BHL: 990' FSL & 50' FEL of Section 22

PERMIAN
RESOURCES300 N. MARIENFELD STREET, SUITE 1000
MIDLAND, TX 79701OFFICE 432.695.4222
FAX 432.695.4063

FTP: 990' FSL & 100' FWL of Section 21

LTP: 990' FSL & 100' FEL of Section 22

TVD: Approximately 8,913'

TMD: Approximately 19,198'

Proration Unit: S/2S/2 of Sections 21 & 22, T20S-R28E

Targeted Interval: Wolfcamp

Total Cost: See attached AFE

The locations, TVDs, and targets are approximate and subject to change dependent on surface or subsurface issues encountered. These surface hole locations fall within an approved potash drill island and are subject to change based on BLM approval. Permian is proposing to drill these wells under the modified terms of the 1989 AAPL Operating Agreement and a form of said Operating Agreement is available upon request. The Operating Agreement has the following general provisions:

- 100%/300%/300% non-consent provisions
- \$10,000/\$1,000 drilling and producing rates
- Permian Resources Operating, LLC named as Operator

Please indicate your election to participate in the drilling and completion of the proposed wells on the enclosed ballot. Please sign and return one copy of this letter, signed copies of the proposed AFEs, a signed copy of the enclosed insurance declaration, and your geologic well requirements.

Due to

In the interest of time, should we not reach an agreement within thirty (30) days of the date of your receipt of this letter, Permian will apply to the New Mexico Oil Conservation Division for compulsory pooling of your interest into spacing units for the proposed wells. If you do not wish to participate, Permian would be interested in acquiring your interest in the subject lands which is subject to further mutually agreeable negotiation.

Please return elections by mail and/or email to the attention of Erin Lloyd, Erin.Lloyd@permianres.com

Thank you for your time and consideration, if you have any questions at all, please don't hesitate to contact me at, Ryan.Curry@permianres.com.

Respectfully,



Ryan Curry | Senior Landman

O 432.400.0209 | ryan.curry@permianres.com

300 N. Marienfeld Street, Suite 1000 | Midland, TX 79701

Enclosures

ELECTIONS ON PAGE TO FOLLOW



300 N. MARIENFELD STREET, SUITE 1000
MIDLAND, TX 79701

OFFICE 432.695.4222
FAX 432.695.4063

Taipan 21 Fed Com Elections:

Well Elections: <i>(Please indicate your responses in the spaces below)</i>		
Well(s)	Elect to Participate	Elect to <u>NOT</u> Participate
Taipan 21 Fed Com 131H		
Taipan 21 Fed Com 132H		
Taipan 21 Fed Com 133H		
Taipan 21 Fed Com 134H		
Taipan 21 Fed Com 201H		
Taipan 21 Fed Com 202H		
Taipan 21 Fed Com 203H		
Taipan 21 Fed Com 204H		

Company Name (If Applicable):

By: _____

Printed Name: _____

Date: _____



300 N. MARIENFELD STREET, SUITE 1000
MIDLAND, TX 79701

OFFICE 432.695.4222
FAX 432.695.4063

Participate / Rejection Declaration

Please return this page to Permian Resources Operating, LLC ("Permian") by the date specified in the letter, signed indicating your election to either participate in or reject this insurance program. If you reject the insurance coverage arranged by Permian, then, to the extent that Permian has an obligation to secure any such insurance on your behalf under any applicable agreements or otherwise, Permian will be relieved of such obligation, and Permian will assume that you maintain appropriate levels of insurance and will provide a current Certificate of Insurance upon request. If you fail to make an election within 30 days from receipt of this notice, you will be deemed a participant in the program as detailed on the attached and billed for your percentage participation as such.

- ☐ I hereby elect to participate in the insurance coverage arranged by Permian Resources Operating, LLC and understand that I will be charged for such participation.
- ☐ I hereby elect to reject the insurance coverage arranged by Permian Resources Operating, LLC.

Company Name (If Applicable):

By: _____

Printed Name: _____

Date: _____

AFE Number:		Description:	SHL LEGAL
AFE Name:	TAIPAN 21 FED COM 201H	AFE TYPE:	Drill and Complete
Well Operator:	PERMIAN RESOURCES OPERATING, LLC		
Operator AFE #:			

<u>Account</u>	<u>Description</u>	<u>Gross Est. (\$)</u>
Flowback Intangible		
8040.2000	IFC - TRUCKING/VACUUM/TRANSP	\$20,000.00
8040.4000	IFC - CHEMICALS	\$15,000.00
8040.3430	IFC - SURFACE PUMP RENTAL	\$20,000.00
8040.1899	IFC - FRAC WATER RECOVERY	\$226,200.00
8040.2900	IFC - WELL TESTING / FLOWBACK	\$125,000.00
8040.1100	IFC - ROADS LOCATIONS / PITS	\$5,000.00
8040.3500	IFC - WELLSITE SUPERVISION	\$10,000.00
8040.3420	IFC - TANK RENTALS	\$20,000.00
	Sub-total	\$441,200.00
Artificial Lift Tangible		
8065.2400	TAL - COMPRESSOR INSTALL & STARTUP	\$70,000.00
8065.1100	TAL - TUBING	\$125,000.00
8065.2000	TAL - WELLHEAD EQUIPMENT	\$60,000.00
8065.3100	TAL - MEASUREMENT EQUIPMENT	\$30,000.00
8065.3200	TAL - COMM, TELEMETRY & AUTOMA	\$10,000.00
8065.1320	TAL - GAS LIFT EQUIPMENT/INSTALL	\$30,000.00
8065.2300	TAL - GAS LIFT INJECTION LINE & INSTALL	\$80,000.00
8065.2500	TAL - VALVES/CONNECTIONS/FTGS	\$15,000.00
	Sub-total	\$420,000.00
Completion Intangible		
8025.3100	ICC - WELLHEAD/FRACTURE REPAIR	\$40,000.00
8025.3600	ICC - SUPERVISION/ENGINEERING	\$5,000.00
8025.1400	ICC - WIRELINE OPEN/CASED HOLE	\$40,000.00
8025.2000	ICC - TRUCKING	\$14,375.00
8025.2500	ICC - WELL STIMULATION/FRACTUR	\$2,487,131.00
8025.3400	ICC - RENTAL EQUIPMENT	\$202,410.00
8025.2300	ICC - COMPLETION FLUIDS	\$10,000.00
8025.2600	ICC - CONTRACT LABOR/ROUSTABOUT	\$15,000.00
8025.3000	ICC - WATER HANDLING	\$199,134.00
8025.1500	ICC - FUEL / POWER	\$647,517.00
8025.3800	ICC - OVERHEAD	\$10,000.00
8025.1800	ICC - WATER DISPOSAL/VACUUM TRUCK	\$18,113.00
8025.2200	ICC - ELECTRIC LOGGING / PERFORATING	\$398,624.00
8025.3500	ICC - WELLSITE SUPERVISION	\$56,700.00
8025.3700	ICC - SAFETY / ENVIRONMENTAL	\$15,000.00
8025.3050	ICC - SOURCE WATER	\$368,398.00
8025.1600	ICC - COILED TUBING	\$226,602.00
8025.1100	ICC - ROAD, LOCATIONS, PITS	\$10,500.00
	Sub-total	\$4,764,504.00
Drilling Intangible		

Cost Estimate

Printed Date: Apr 17, 2024

<u>Account</u>	<u>Description</u>	<u>Gross Est. (\$)</u>
8015.1900	IDC - DIRECTNL DRILL & SURVEY	\$248,760.47
8015.3200	IDC - CONTRACT LABOR/ROUSTABOUT	\$27,000.00
8015.3500	IDC - TRUCKING/VACUUM/ TRANSP	\$23,250.00
8015.3800	IDC - WELLHEAD PREPARE/REPAIR	\$12,500.00
8015.2300	IDC - FUEL / POWER	\$165,305.08
8015.3100	IDC - CASING CREW & TOOLS	\$47,500.00
8015.3000	IDC - CEMENT SERV/FLOAT EQUIP	\$143,200.00
8015.2600	IDC - MUD LOGGING	\$35,000.00
8015.4100	IDC - RENTAL EQUIPMENT	\$85,250.00
8015.1000	IDC - PERMITS,LICENSES,ETC	\$15,000.00
8015.4300	IDC - WELLSITE SUPERVISION	\$89,900.00
8015.2500	IDC - MUD/CHEMICALS/ACIDIZING	\$186,604.40
8015.2350	IDC - FUEL/MUD	\$73,570.31
8015.3400	IDC - MATERIALS & SUPPLIES	\$5,000.00
8015.5000	IDC - WELL CONTROL INSURANCE	\$8,525.00
8015.1700	IDC - DAYWORK CONTRACT	\$597,815.63
8015.1400	IDC - ROAD, LOCATIONS, PITS	\$95,625.00
8015.1200	IDC - LEGAL, TITLE SERVICES	\$13,000.00
8015.1600	IDC - RIG MOB / STANDBY RATE	\$36,300.00
8015.1310	IDC - PERMANENT EASEMENT	\$12,000.00
8015.3700	IDC - DISPOSAL	\$153,384.00
8015.2400	IDC - RIG WATER	\$19,375.00
8015.1100	IDC - STAKING & SURVEYING	\$15,000.00
8015.4600	IDC - SAFETY / ENVIRONMENTAL	\$20,150.00
8015.4200	IDC - MANCAMP	\$40,300.00
8015.1300	IDC - SURFACE DAMAGE / ROW	\$35,000.00
8015.5200	IDC - CONTINGENCY	\$116,725.85
8015.1500	IDC - RIG MOB / TRUCKING	\$127,500.00
8015.2150	IDC - DRILL BIT	\$98,000.00
8015.2000	IDC - CONDUCTOR HOLE & SERVICE	\$47,812.50
8015.2700	IDC - INSPECTION, TESTING & REPAIR	\$37,000.00
8015.2200	IDC - BITS, TOOLS, STABILIZERS	\$53,346.00
8015.3600	IDC - SOLIDS CONTROL/ CLOSED LOOP SYSTEM	\$60,934.38
Sub-total		\$2,745,633.62
Facilities		
8035.2500	FAC - CONSULTING SERVICES	\$714.00
8035.3000	FAC - HEATER TREATER/SEPARATOR	\$110,000.00
8035.1500	FAC - MATERIALS & SUPPLIES	\$2,143.00
8035.2100	FAC - INSPECTION & TESTING	\$714.00
8035.2400	FAC - SUPERVISION	\$8,571.00
8035.1600	FAC - TRANSPORTATION TRUCKING	\$4,286.00
8035.3700	FAC - AUTOMATION MATERIAL	\$10,714.00
8035.4500	FAC - CONTINGENCY	\$7,884.00
8035.2200	FAC - CONTRACT LABOR / ROUSTAB	\$21,429.00
8035.3200	FAC - VALVES FITTINGS & PIPE	\$57,143.00
8035.3600	FAC - ELECTRICAL	\$10,714.00

Cost Estimate

Printed Date: Apr 17, 2024

<u>Account</u>	<u>Description</u>	<u>Gross Est. (\$)</u>
8035.1700	FAC - RENTAL EQUIPMENT	\$7,143.00
8035.3100	FAC - DEHYDRATOR EQUIPMENT	\$12,857.00
8035.3400	FAC - METER & LACT	\$14,500.00
8035.4400	FAC - COMPANY LABOR	\$1,429.00
8035.1900	FAC - WATER DISPOSAL / SWD	\$429.00
	Sub-total	\$270,670.00
Artificial Lift Intangible		
8060.2600	IAL - CONTRACT LABOR/ROUSTABOUT	\$15,000.00
8060.1200	IAL - WORKOVER RIG	\$17,000.00
8060.2010	IAL - KILL TRUCK	\$5,000.00
8060.3420	IAL - REVERSE UNIT RENTAL	\$5,000.00
8060.1400	IAL - WIRELINE OPEN/CASED HOLE	\$10,000.00
8060.3500	IAL - WELLSITE SUPERVISION	\$5,000.00
8060.3400	IAL - RENTAL EQUIPMENT	\$5,000.00
8060.1900	IAL - INSPECTION & TESTING	\$3,000.00
8060.3410	IAL - LAYDOWN MACHINE	\$5,000.00
8060.2000	IAL - TRUCKING/VACUUM/TRANSP	\$5,000.00
8060.2300	IAL - COMPLETION FLUIDS	\$5,000.00
	Sub-total	\$80,000.00
Pipeline		
8036.2800	PLN - FLOWLINE MATERIAL	\$147,840.00
8036.2200	PLN - CONTRACT LABOR	\$125,664.00
8036.1310	PLN - PERMANENT EASEMENT	\$13,440.00
8036.3200	PLN - VALVES FITTINGS & PIPE	\$15,000.00
	Sub-total	\$301,944.00
Drilling Tangible		
8020.1100	TDC - CASING - SURFACE	\$20,302.25
8020.1500	TDC - WELLHEAD EQUIPMENT	\$63,750.00
8020.1400	TDC - CASING - PRODUCTION	\$454,891.41
8020.1200	TDC - CASING - INTERMEDIATE - 1	\$102,905.25
	Sub-total	\$641,848.91
Completion Tangible		
8030.2000	TCC - WELLHEAD EQUIPMENT	\$47,250.00
	Sub-total	\$47,250.00
Grand Total		\$9,713,050.53

Company Name (If Applicable):

By: _____

Printed Name: _____

Date: _____



300 N. MARIENFELD STREET, SUITE 1000
MIDLAND, TX 79701

OFFICE 432.695.4222
FAX 432.695.4063

Taipan – Chronology of Communication

October 22, 2024 – Proposals sent to all parties.

October 28, 2024 – Email correspondence with Bursake, LLC regarding working interest.

October 29, 2024 - Email correspondence with Sabinal Energy, LLC regarding working interest and request for JOA.

October 31, 2024 - Email correspondence with Karen Benbow Mcrae regarding proposal.

October 31, 2024 – Email correspondence with Claremont Corporation regarding working interest.

November 8, 2024 – Email correspondence with EOG Resources, Inc. regarding proposal.

November 8, 2024 – Phone conversation with Morris Williams regarding proposal.

November 8, 2024 – Phone conversation with William Bennet of McAnSo & Bursake regarding interest in the Unit.

November 8, 2024 – Phone conversation with Frank Medrano, on behalf of Karen Benbow McRae, regarding interest in the Unit.

November 11, 2024- Email correspondence with Claremont Corporation regarding working interest.

November 12, 2024 – Email correspondence with Claremont Corporation regarding working interest.

November 12, 2024 – Phone conversation with Claremont Corporation regarding working interest.

November 14, 2024 – Email correspondence with Sabinal Energy, LLC regarding JOA.

November 14, 2024 - Email correspondence with Karen Benbow Mcrae regarding working interest and JOA.

November 14, 2024 – Email correspondence with Claremont Corporation regarding working interest and JOA.

November 14, 2024 – Email correspondence with EOG Resources, Inc. regarding proposal.

November 15, 2024 – Email correspondence with Davoil discussing upcoming development plans inclusive of subject project.

November 18, 2024 – Email correspondence with Sabinal Energy, LLC regarding JOA.

November 19, 2024 - Email correspondence with Claremont Corporation regarding proposal.



300 N. MARIENFELD STREET, SUITE 1000
MIDLAND, TX 79701

OFFICE 432.695.4222
FAX 432.695.4063

November 21, 2024 - Email correspondence with Claremont Corporation regarding proposal and received elections.

November 22, 2024 - Email correspondence with Claremont Corporation regarding proposal.

December 5, 2024 – Email correspondence with Magnum Hunter Production regarding proposal.

December 11, 2025 – Email correspondence with BEXP regarding the project.

December 17, 2025 – Email correspondence with Sabinal regarding their interest in the project.

December 19, 2025 – Email correspondence with Karen Benbow Mcrae regarding potential acquisition

December 26, 2024 – Email correspondence with Hurt Properties.

January 7, 2025 – Email correspondence with Pat Gray on behalf of Magnum Hunter discussing voluntary joinder.

January 22, 2025 – Email correspondence with Karen Benbow Mcrae regarding potential acquisition

January 23, 2025 – Email correspondence with Karen Benbow Mcrae regarding potential acquisition

STATE OF NEW MEXICO
DEPARTMENT OF ENERGY, MINERALS AND NATURAL RESOURCES
OIL CONSERVATION DIVISION

APPLICATIONS OF PERMIAN RESOURCES
OPERATING, LLC FOR COMPULSORY
POOLING, EDDY COUNTY, NEW MEXICO.

CASE NOS. 25064, 25065
25066, 25067

**SELF-AFFIRMED STATEMENT
OF CHRISTOPHER CANTIN**

1. I am a geologist with Permian Resources Operating, LLC ("Permian Resources"). I am over 18 years of age, have personal knowledge of the matters addressed herein, and am competent to provide this Self-Affirmed Statement. I have previously testified before the New Mexico Oil Conservation Division ("Division") and my credentials as an expert in petroleum geology were accepted and made a matter of record.

2. I am familiar with the geological matters that pertain to the above-referenced cases.

3. **Exhibit B-1** is a regional locator map that identifies the Taipan project area, in proximity to the Capitan Reef within the Delaware Basin, for the Wolfcamp horizontal spacing units that are the subject of these applications.

4. **Exhibit B-2** is a cross section location map for the proposed horizontal spacing units within the Wolfcamp formation. The approximate wellbore paths for the proposed **Taipan 21 Fed Com 201H, Taipan 21 Fed Com 202H, Taipan 21 Fed Com 203H, and Taipan 21 Fed Com 204H** wells ("Wells") are represented by dashed purple lines. Existing producing wells in the targeted interval are represented by solid purple lines. This map identifies the cross-section running from A-A' with the cross-section wells name and a black line in proximity to the proposed Wells.

Permian Resources Operating, LLC
Case No. 25064
Exhibit B

5. **Exhibit B-3** is a Subsea Structure map of the Wolfcamp formation in TVD subsea with a contour interval of 100 ft. The map identifies the approximate wellbore paths for the proposed Wells with a purple dashed line. It also identifies the location of the cross-section running from A-A' in proximity to the proposed Wells. The data points are indicated by red triangles. The map demonstrates the formation is gently dipping to the southeast in this area. I do not observe any faulting, pinch-outs, or geologic impediments to developing the targeted intervals with horizontal wells.

6. **Exhibit B-4** identifies two wells penetrating the targeted interval, which I used to construct a stratigraphic cross-section from A to A'. It contains gamma ray, resistivity, and porosity logs. The cross section is oriented from west to east and is flattened on top of the Wolfcamp formation. The proposed landing zone for the Wells is labeled on the exhibit. The approximate well-paths for the proposed Wells are indicated by a dashed purple line to be drilled from west to east across the units. This cross-section demonstrates the target interval is continuous across the Unit.

7. In my opinion, a lay down orientation for the Wells is appropriate to properly develop the subject acreage because of consistent rock properties throughout the Unit and is the preferred fracture orientation in this portion of the trend.

8. Based on my geologic study of the area, the targeted interval underlying the Unit is suitable for development by horizontal wells and the tracts comprising the Unit will contribute more or less equally to the production of the Wells.

9. In my opinion, the granting of Permian Resources' application will serve the interests of conservation, the protection of correlative rights, and the prevention of waste.

10. The exhibits attached hereto were either preferred by me or under my supervision or were compiled from company business records.

11. I understand this Self-Affirmed Statement will be used as written testimony in this case. I affirm my testimony above is true and correct and is made under penalty of perjury under the laws of the State of New Mexico. My testimony is made as of the date identified next to my signature below.

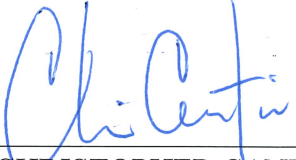
CHRISTOPHER CANTIN

02/06/2025
Date

Regional Locator Map
Taipan 21 Fed Com

Exhibit B-1

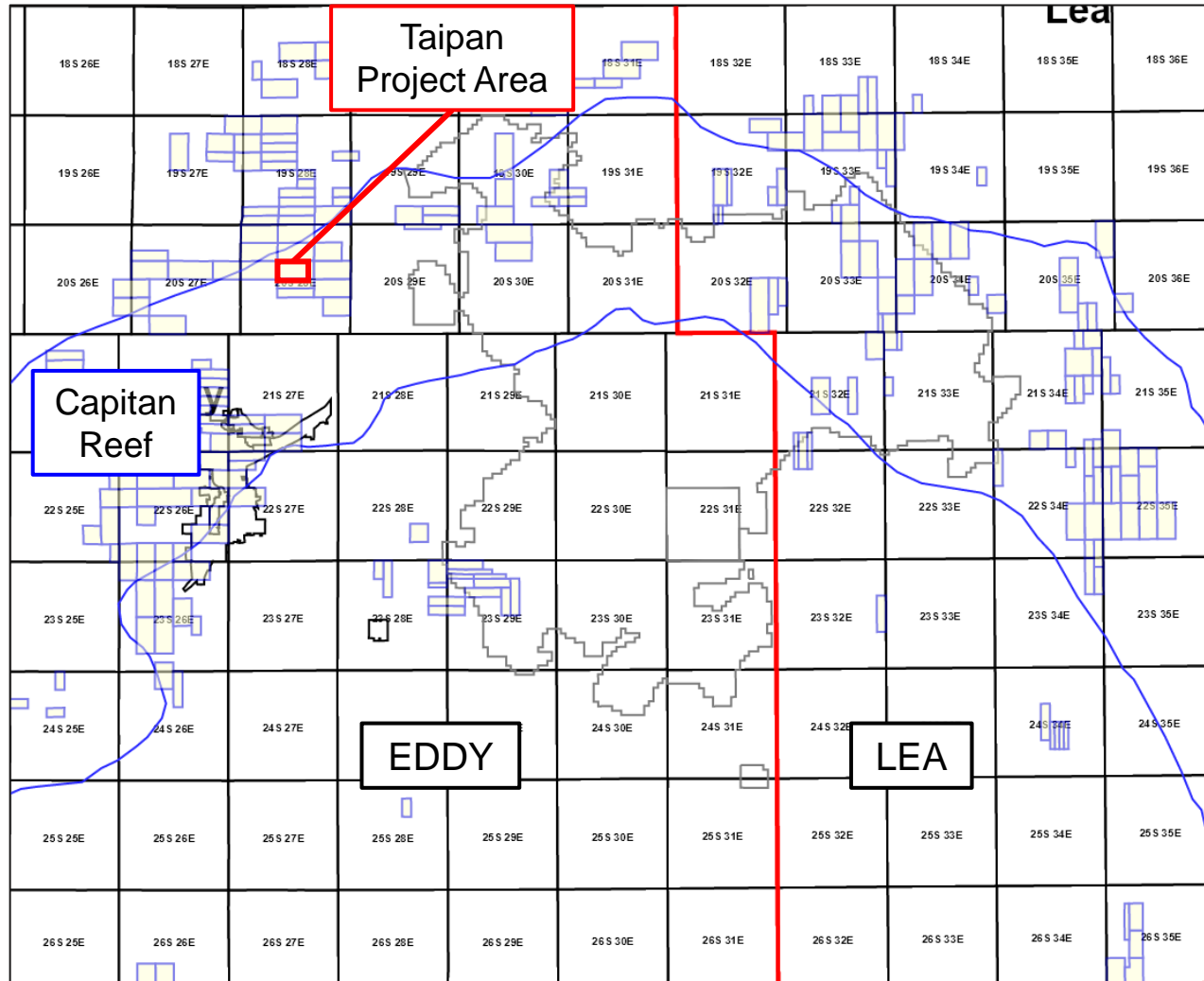
Permian
Resources

Cross-Section Locator Map

Taipan 21 Fed Com Wolfcamp

Permian Resources Operating, LLC
Case No. 25064
Exhibit B-2

Exhibit B-2

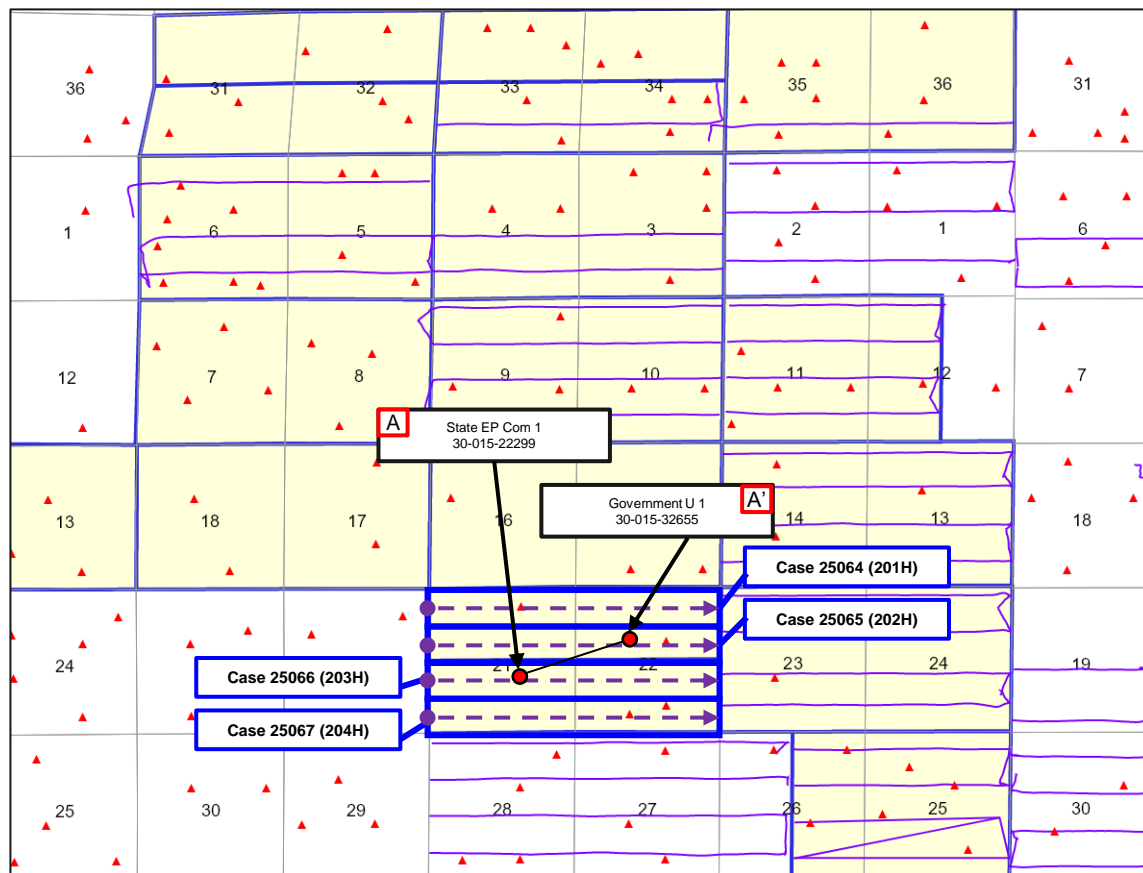

Control Point



Proposed Wells

WFMP
SHL BHL

Producing Wells

WFMP
BHL SHL

Permian
Resources



Wolfcamp – Structure Map

Taipan 21 Fed Com

Permian Resources Operating, LLC
Case No. 25064
Exhibit B-3

Exhibit B-3

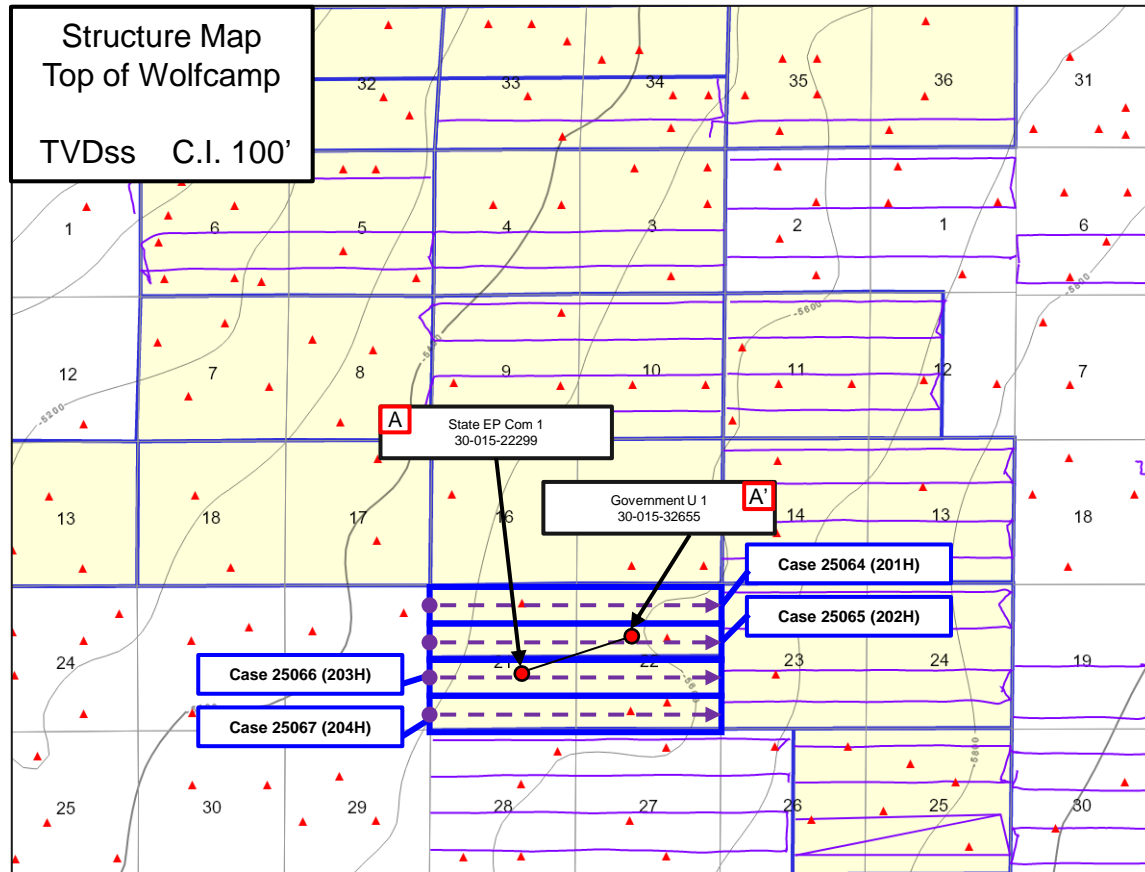

Permian
Resources



Stratigraphic Cross-Section A-A'

Taipan 21 Fed Com Wolfcamp

Permian Resources Operating, LLC
Case No. 25064
Exhibit B-4

Exhibit B-4

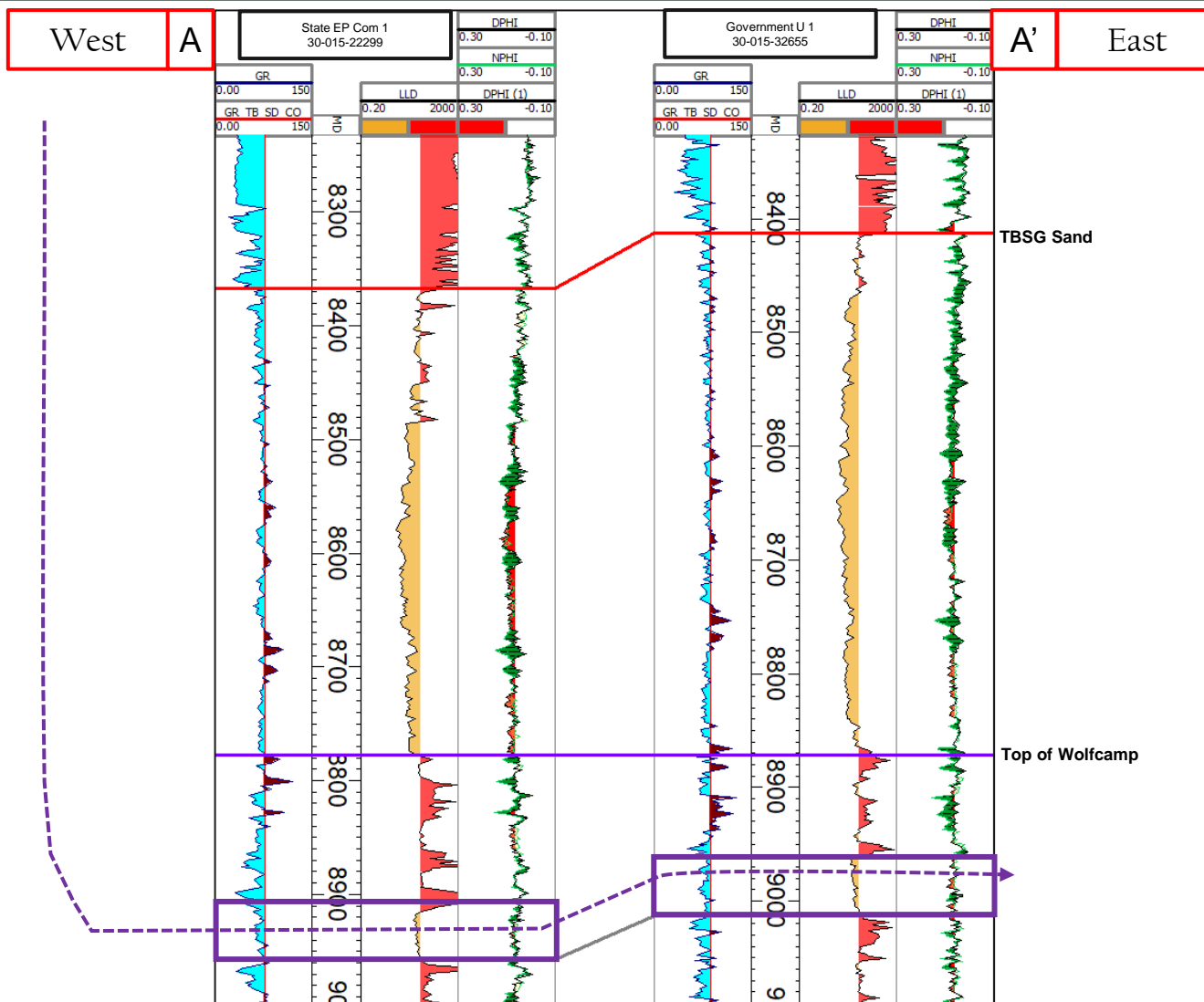

Target Interval

WFMP Target

**STATE OF NEW MEXICO
DEPARTMENT OF ENERGY, MINERALS AND NATURAL RESOURCES
OIL CONSERVATION DIVISION**

**APPLICATION OF PERMIAN RESOURCES
OPERATING, LLC FOR COMPULSORY
POOLING, EDDY COUNTY, NEW MEXICO.**

CASE NO. 25064

**SELF-AFFIRMED STATEMENT
OF DANA S. HARDY**

1. I am attorney in fact and authorized representative of Permian Resources Operating, LLC the Applicant herein.
2. I am familiar with the Notice Letter attached as **Exhibit C-1**, and caused the Notice Letter, along with the Application in this case, to be sent to the parties set out in the chart attached as **Exhibit C-2**.
3. **Exhibit C-2** also provides the date each Notice Letter was sent and the date each return was received.
4. Copies of the certified mail green cards and white slips are attached as **Exhibit C-3** as supporting documentation for proof of mailing and the information provided on **Exhibit C-2**.
5. On December 19, 2024, I caused a notice to be published in the Carlsbad Current Argus. An Affidavit of Publication from the Legal Clerk of the Carlsbad Current Argus along with a copy of the notice publication, is attached as **Exhibit C-4**.
6. I understand this Self-Affirmed Statement will be used as written testimony in the subject case. I affirm that my testimony above is true and correct and is made under penalty of perjury under the laws of the State of New Mexico. My testimony is made as of the date handwritten next to my signature below.

/s/ Dana S. Hardy
Dana S. Hardy

January 21, 2025
Date

**Permian Resources Operating, LLC
Case No. 25064
Exhibit C**



hinklelawfirm.com

HINKLE SHANOR LLP

ATTORNEYS AT LAW

P.O. BOX 2068

SANTA FE, NEW MEXICO 87504

505-982-4554 (FAX) 505-982-8623

WRITER:
Dana S. Hardy, Partner
dhardy@hinklelawfirm.com

December 16, 2024

VIA CERTIFIED MAIL
RETURN RECEIPT REQUESTED

TO ALL PARTIES ENTITLED TO NOTICE

**Re: Case Nos. 25060, 25061, 25062, 25063, 25064, 25065, 25066 & 25067 –
Applications of Permian Resources Operating, LLC for Compulsory Pooling,
Eddy County, New Mexico.**

To whom it may concern:

This letter is to advise you that the enclosed applications were filed with the New Mexico Oil Conservation Division. The hearing will be conducted on **February 13, 2025**, beginning at 9:00 a.m.

The hearing will be conducted in a hybrid fashion, both virtually and in-person at the Energy, Minerals, Natural Resources Department, Wendell Chino Building, Pecos Hall, 1220 South St. Francis Drive, 1st Floor, Santa Fe, NM 87505. To participate virtually, see the instructions posted on the OCD Hearings website: <https://www.emnrd.nm.gov/oed/hearing-info/>. You are not required to attend this hearing, but as an owner of an interest that may be affected by this application, you may appear and present testimony. Failure to appear at that time and become a party of record will preclude you from challenging the matter at a later date.

Pursuant to Division Rule 19.15.4.13.B, a party who intends to present evidence at the hearing shall file a pre-hearing statement and serve copies on other parties, or the attorneys of parties who are represented by counsel, at least four business days in advance of a scheduled hearing, but in no event later than 5:00 p.m. Mountain Time, on the Thursday preceding the scheduled hearing date. The statement must be submitted through the OCD E-Permitting system (<https://wwwapps.emnrd.nm.gov/oed/oedpermitting/>) or via e-mail to oed.hearings@emnrd.nm.gov and should include: the names of the parties and their attorneys, a concise statement of the case, the names of all witnesses the party will call to testify at the hearing, the approximate time the party will need to present its case, and identification of any procedural matters that are to be resolved prior to the hearing.

If you have any questions about this application, please contact Ryan Curry, Senior Landman at Permian Resources Operating, LLC, via e-mail at ryan.curry@permianres.com

Sincerely,

/s/ Dana S. Hardy

Dana S. Hardy

Permian Resources Operating, LLC**Case No. 25064****Exhibit C-1**

PO BOX 10
ROSWELL, NEW MEXICO 88202
(575) 622-6510
FAX (575) 623-9332

7601 JEFFERSON ST NE - SUITE 180
ALBUQUERQUE, NEW MEXICO 87109
505-858-8320
(FAX) 505-858-8321

PO BOX 2068
SANTA FE, NEW MEXICO 87504
(505) 982-4554
FAX (505) 982-8623

**STATE OF NEW MEXICO
DEPARTMENT OF ENERGY, MINERALS AND NATURAL RESOURCES
OIL CONSERVATION DIVISION**

**APPLICATION OF PERMIAN RESOURCES
OPERATING, LLC FOR COMPULSORY
POOLING, EDDY COUNTY, NEW MEXICO.**

**CASE NOS. 25060, 25061,
25062, 25063, 25064, 25065,
25066, & 25067.**

NOTICE LETTER CHART

PARTY	NOTICE LETTER SENT	RETURN RECEIVED
BEXP II GW Alpha, LLC 5914 W. Courtyard Dr. Ste. 200 Austin, TX 78730	12-16-2024 9589071052702305986949	1-2-2025
BEXP II GW WI Omega, LLC 5914 W. Courtyard Dr. Ste. 200 Austin, TX 78730	12-16-2024 9589071052702305986956	1-6-2025
BEXP II Omega MISC., LLC 5914 W. Courtyard Dr. Ste. 200 Austin, TX 78730	12-16-2024 9589071052702305986963	1-2-2025
Bursake, LLC PO Box 51407 Midland, TX 79710-0324	12-16-2024 9589071052702305986970	1-2-2025
Claremont Corporation PO Box 3226 Tulsa, OK 74101	12-16-2024 9589071052702305986987	1-2-2025
Davoil, Inc. PO Box 122269 Fort Worth, TX 76121-2269	12-16-2024 9589071052702305986994	1-2-2025
E. Cecile Martin PO Box 246 Marble Falls, TX 78654	12-16-2024 9589071052702305987007	1-3-2025 Return to Sender.
EOG Resources, Inc. 5509 Champions Dr. Midland, TX 79706	12-16-2024 9589071052702305987021	1-2-2025
Freddie Jean Wheeler 1117 S Tripp Ave Odessa, TX 79760	12-16-2024 9589071052702305987038	1-2-2025
Gilmore Resources, Inc. PO Box 577 Kimball, Nebraska 69145	12-16-2024 9589071052702305987045	1-2-2025
Great Western Drilling Ltd. PO Box 1659 Midland, TX 79702	12-16-2024 9589071052702305987052	1-6-2025
Hurt Properties, LP PO Box 1967 Abingdon, VA 24212-0000	12-16-2024 9589071052702305987069	Delivered 12-23-2025

**Permian Resources Operating, LLC
Case No. 25064
Exhibit C-2**

**STATE OF NEW MEXICO
DEPARTMENT OF ENERGY, MINERALS AND NATURAL RESOURCES
OIL CONSERVATION DIVISION**

**APPLICATION OF PERMIAN RESOURCES
OPERATING, LLC FOR COMPULSORY
POOLING, EDDY COUNTY, NEW MEXICO.**

**CASE NOS. 25060, 25061,
25062, 25063, 25064, 25065,
25066, & 25067.**

NOTICE LETTER CHART

James R. Hurt PO Box 72 Odessa, TX 79760	12-16-2024 9589071052702305987076	1-2-2025
Karen Benbow McRae PO Box 56429 Houston, TX 77256-6429	12-16-2024 9589071052702305987083	1-6-2025
Katherin Anne Gilmore Shannon and Laurence Davis Gilmore, Co- Trustees of The Katherine E. Gilmore Bypass Trust dated May 9, 2017. 505 N. Big Spring Ste. 303 Midland, TX 79701	12-16-2024 9589071052702305987106	1-2-2025
Magnum Hunter Production Inc. PO Box 972875 Dallas, TX 75397	12-16-2024 9589071052702305987113	1-2-2025
McAnSo, LLC PO Box 50530 Austin, TX 78763	12-16-2024 9589071052702305987120	Delivered 12-20-2024
Morris Allen Williams PO Box 2302 Payson, AZ 85547	12-16-2024 9589071052702305987137	1-2-2025
QRE Operating, LLC 1209 Orange St. Wilmington Newcastle, Wilmington, DE 19801	12-16-2024 9589071052702305987144	1-3-2025 Return to Sender.
Sabinal Energy Operating, LLC 1780 Hughes Landing Blvd. Ste 1200 The Woodlands, TX 77380	12-16-2024 9589071052702305987151	1-13-2025

U.S. Postal Service™
CERTIFIED MAIL® RECEIPT
 Domestic Mail Only

For delivery information, visit our website at www.usps.com

OFFICIAL USE

Certified Mail Fee
 \$ _____

Extra Services & Fees (check box, add fee as appropriate)

☐ Return Receipt (hardcopy) \$ _____

☐ Return Receipt (electronic) \$ _____

☐ Certified Mail Restricted Delivery \$ _____

☐ Adult Signature Required \$ _____

☐ Adult Signature Restricted Delivery \$ _____

Postage
 \$ _____

Total Postage and Fees
 \$ _____

Sent To
 Street a: BEXP II GW Alpha, LLC
 5914 W. Courtyard Dr. Ste. 200
 City, St: Austin, TX 78730
 25060-67 PRO - Taipan

PS Form 3800, January 2023 PSN 7530-02-000-3047 See Reverse for Instructions

SENDER: COMPLETE THIS SECTION

- Complete items 1, 2, and 3.
- Print your name and address on the reverse so that we can return the card to you.
- Attach this card to the back of the mailpiece, or on the front if space permits.

1. Article Addressed to:

BEXP II GW Alpha, LLC
 5914 W. Courtyard Dr. Ste.
 200
 Austin, TX 78730
 25060-67 PRO - Taipan

2. Article Number (Transfer from service label)

9589 0710 5270 2305 9869 49

PS Form 3811, July 2020 PSN 7530-02-000-9053

COMPLETE THIS SECTION ON DELIVERY

A. Signature
 X *[Signature]*

B. Received by (Printed Name)
 G. Acosta

C. Date of Delivery
 12-19-24

D. Is delivery address different from item 1? ☐ Yes
 If YES, enter delivery address below: ☐ No

3. Service Type

☐ Adult Signature

☐ Adult Signature Restricted Delivery

☐ Certified Mail®

☐ Certified Mail Restricted Delivery

☐ Collect on Delivery

☐ Collect on Delivery Restricted Delivery

☐ Priority Mail Express®

☐ Registered Mail™

☐ Registered Mail Restricted Delivery

☐ Signature Confirmation™

☐ Signature Confirmation Restricted Delivery

19 DEC 2024 PM 3:16

RECEIVED

JAN 3 2025

Domestic Return Receipt

Permian Resources Operating, LLC
 Case No. 25064
 Exhibit C-3

U.S. Postal Service™
CERTIFIED MAIL® RECEIPT
 Domestic Mail Only

For delivery information, visit our website at www.usps.com

OFFICIAL USE

9589 0710 5270 2305 9869 63

Certified Mail Fee	
\$	
Extra Services & Fees (check box, add fee as appropriate)	
<input type="checkbox"/> Return Receipt (hardcopy)	\$
<input type="checkbox"/> Return Receipt (electronic)	\$
<input type="checkbox"/> Certified Mail Restricted Delivery	\$
<input type="checkbox"/> Adult Signature Required	\$
<input type="checkbox"/> Adult Signature Restricted Delivery	\$
Postage	
\$	
Total Postage and Fees	
\$	
Sent To	
Street	BEXP II Omega MISC., LLC 5914 W. Courtyard Dr. Ste. 200 Austin, TX 78730
City, St	Austin, TX 78730
25060-67 PRO - Taiwan	

PS Form 3800, January 2023 PSN 7530-02-000-9047 See Reverse for Instructions

SENDER: COMPLETE THIS SECTION	COMPLETE THIS SECTION ON DELIVERY
<ul style="list-style-type: none"> Complete items 1, 2, and 3. Print your name and address on the reverse so that we can return the card to you. Attach this card to the back of the mailpiece, or on the front if space permits. 	<p>A. Signature </p> <p style="text-align: right;"><input type="checkbox"/> Agent <input type="checkbox"/> Addressee</p>
<p>1. Article Addressed to:</p> <p style="text-align: center;">BEXP II Omega MISC., LLC 5914 W. Courtyard Dr. Ste. 200 Austin, TX 78730</p> <p style="text-align: right;">25060-67 PRO - Taiwan</p>	<p>B. Received by (Printed Name) </p> <p>C. Date of Delivery </p>
<p>2. Article Number (Transfer from service label) 9589 0710 5270 2305 9869 63</p>	<p>D. Is delivery address different from item 1? <input type="checkbox"/> Yes If YES, enter delivery address below: <input type="checkbox"/> No</p> <p style="text-align: center; font-size: 2em; opacity: 0.5;">RECEIVED</p> <p style="text-align: center;">JAN 2 2025</p>
<p>3. Service Type</p> <p><input type="checkbox"/> Adult Signature </p> <p><input type="checkbox"/> Adult Signature Restricted Delivery</p> <p><input type="checkbox"/> Certified Mail®</p> <p><input type="checkbox"/> Certified Mail Restricted Delivery</p> <p><input type="checkbox"/> Collect on Delivery</p> <p><input type="checkbox"/> Collect on Delivery Restricted Delivery</p>	<p><input type="checkbox"/> Priority Mail Express®</p> <p><input type="checkbox"/> Registered Mail™</p> <p><input type="checkbox"/> Registered Mail Restricted Delivery</p> <p><input type="checkbox"/> Signature Confirmation™</p> <p><input type="checkbox"/> Signature Confirmation Restricted Delivery</p>

PS Form 3811, July 2020 PSN 7530-02-000-9053 Domestic Return Receipt

U.S. Postal Service™
CERTIFIED MAIL® RECEIPT
 Domestic Mail Only

For delivery information, visit our website at www.usps.com®.

OFFICIAL USE

Certified Mail Fee
 \$

Extra Services & Fees (check box, add fee as appropriate)

<input type="checkbox"/> Return Receipt (hardcopy)	\$
<input type="checkbox"/> Return Receipt (electronic)	\$
<input type="checkbox"/> Certified Mail Restricted Delivery	\$
<input type="checkbox"/> Adult Signature Required	\$
<input type="checkbox"/> Adult Signature Restricted Delivery	\$

Postage
 \$

Total Postage and Fees
 \$

Sent To

Street BEXP II GW WI Omega, LLC
 5914 W. Courtyard Dr. Ste. 200
 City Austin, TX 78730

25060-67 PRO - Taipan

PS Form 3800, January 2023 PSN 7530-02-000-9047 See Reverse for Instructions

Postmark
 DEB 5 2024

SENDER: COMPLETE THIS SECTION

- Complete items 1, 2, and 3.
- Print your name and address on the reverse so that we can return the card to you.
- Attach this card to the back of the mailpiece, or on the front if space permits.

1. Article Addressed to:

BEXP II GW WI Omega, LLC
 5914 W. Courtyard Dr. Ste.
 200
 Austin, TX 78730

25060-67 PRO - Taipan

2. Article Number (Transfer from service label)

9590 9402 9190 4225 2369 19

9589 0710 5270 2305 9869 56

PS Form 3811, July 2020 PSN 7530-02-000-9053

COMPLETE THIS SECTION ON DELIVERY

A. Signature  ☐ Agent
☒ Addressee

B. Received by (Printed Name) E. Acosta

C. Date of Delivery 12-20-24

D. Is delivery address different from item 1? ☐ Yes
 If YES, enter delivery address below: ☐ No

RECEIVED

3. Service Type

<input type="checkbox"/> Adult Signature	<input type="checkbox"/> Priority Mail Express®
<input type="checkbox"/> Adult Signature Restricted Delivery	<input type="checkbox"/> Registered Mail™
<input type="checkbox"/> Certified Mail®	<input type="checkbox"/> Registered Mail Restricted Delivery
<input type="checkbox"/> Certified Mail Restricted Delivery	<input type="checkbox"/> Signature Confirmation™
<input type="checkbox"/> Collect on Delivery	<input type="checkbox"/> Signature Confirmation Restricted Delivery
<input type="checkbox"/> Collect on Delivery Restricted Delivery	
<input type="checkbox"/> Insured Mail	
<input type="checkbox"/> Insured Mail Restricted Delivery	

Domestic Return Receipt

U.S. Postal Service™
CERTIFIED MAIL® RECEIPT
Domestic Mail Only

For delivery information, visit our website at www.usps.com™.

OFFICIAL USE

Certified Mail Fee
\$ _____

Extra Services & Fees (check box, add fee as appropriate)

<input type="checkbox"/> Return Receipt (hardcopy)	\$ _____
<input type="checkbox"/> Return Receipt (electronic)	\$ _____
<input type="checkbox"/> Certified Mail Restricted Delivery	\$ _____
<input type="checkbox"/> Adult Signature Required	\$ _____
<input type="checkbox"/> Adult Signature Restricted Delivery	\$ _____

Postage
\$ _____

Total Postage and Fees
\$ _____

Sent To _____

Street Bursake, LLC
PO Box 51407
City Midland, TX 79710-0324
25060-67 PRO - Taipan

PS Form 3800, January 2023 PSN 7530-02-000-9047 See Reverse for Instructions

SENDER: COMPLETE THIS SECTION	COMPLETE THIS SECTION ON DELIVERY
<p>■ Complete items 1, 2, and 3.</p> <p>■ Print your name and address on the reverse so that we can return the card to you.</p> <p>■ Attach this card to the back of the mailpiece, or on the front if space permits.</p> <p>1. Article Addressed to:</p> <p style="text-align: center;">Bursake, LLC PO Box 51407 Midland, TX 79710-0324</p> <p style="text-align: right;">25060-67 PRO - Taipan</p> <div style="text-align: center;">  9590 9402 9190 4225 2368 96 </div> <p>2. Article Number (Transfer from service label) 9589 0710 5270 2305 9869 70</p>	<p>A. Signature  <input type="checkbox"/> Agent <input checked="" type="checkbox"/> Addressee</p> <p>B. Received by (Printed Name) <u>Anderson Bursake</u></p> <p>C. Date of Delivery <u>12/26/2024</u></p> <p>D. Is delivery address different from item 1? <input type="checkbox"/> Yes If YES, enter delivery address below <input checked="" type="checkbox"/> No</p> <div style="text-align: center; border: 2px solid black; padding: 10px; margin: 10px 0;"> RECEIVED JAN 2 2025 </div> <p>3. Service Type <input type="checkbox"/> Adult Signature <input type="checkbox"/> Adult Signature Restricted Delivery <input type="checkbox"/> Certified Mail® <input type="checkbox"/> Certified Mail Restricted Delivery <input type="checkbox"/> Collect on Delivery <input type="checkbox"/> Collect on Delivery Restricted Delivery <input type="checkbox"/> Mail <input type="checkbox"/> Mail Restricted Delivery Priority Mail Express® Registered Mail™ Registered Mail Restricted Delivery Signature Confirmation™ Signature Confirmation Restricted Delivery </p>

PS Form 3811, July 2020 PSN 7530-02-000-9053 Domestic Return Receipt

U.S. Postal Service™
CERTIFIED MAIL® RECEIPT
Domestic Mail Only

For delivery information, visit our website at www.usps.com

OFFICIAL USE

Certified Mail Fee
\$

Extra Services & Fees (check box, add fee as appropriate)

<input type="checkbox"/> Return Receipt (hardcopy)	\$
<input type="checkbox"/> Return Receipt (electronic)	\$
<input type="checkbox"/> Certified Mail Restricted Delivery	\$
<input type="checkbox"/> Adult Signature Required	\$
<input type="checkbox"/> Adult Signature Restricted Delivery	\$

Postage
\$

Total Postage and Fees
\$

Sent To

Street: Claremont Corporation
PO Box 3226
City, St: Tulsa, OK 74101 25060-67 PRO - Taipan

DEC 16 2024
Postmark
Here

PS Form 3800, January 2023 PSN 7530-02-000-9047 See Reverse for Instructions

SENDER: COMPLETE THIS SECTION	COMPLETE THIS SECTION ON DELIVERY												
<p>■ Complete items 1, 2, and 3.</p> <p>■ Print your name and address on the reverse so that we can return the card to you.</p> <p>■ Attach this card to the back of the mailpiece, or on the front if space permits.</p> <p>1. Article Addressed to:</p> <p style="text-align: center;">Claremont Corporation PO Box 3226 Tulsa, OK 74101</p> <p style="text-align: right; font-size: 0.8em;">25060-67 PRO - Taipan</p> <div style="text-align: center;">  9590 9402 9190 4225 2368 89 </div> <p>2. Article Number (Transfer from service label) 9589 0710 5270 2305 9869 87</p>	<p>A. Signature X Wynell Miller</p> <p>B. Received by (Printed Name) Wynell Miller</p> <p>C. Date of Delivery JAN 2 2025</p> <p>D. Is delivery address different from item 1? <input type="checkbox"/> Yes If YES, enter delivery address below: <input type="checkbox"/> No</p> <p>3. Service Type</p> <table border="0" style="width: 100%;"> <tr> <td><input type="checkbox"/> Adult Signature</td> <td><input type="checkbox"/> Priority Mail Express®</td> </tr> <tr> <td><input type="checkbox"/> Adult Signature Restricted Delivery</td> <td><input type="checkbox"/> Registered Mail™</td> </tr> <tr> <td><input type="checkbox"/> Certified Mail®</td> <td><input type="checkbox"/> Registered Mail Restricted Delivery</td> </tr> <tr> <td><input type="checkbox"/> Certified Mail Restricted Delivery</td> <td><input type="checkbox"/> Signature Confirmation™</td> </tr> <tr> <td><input type="checkbox"/> Collect on Delivery</td> <td><input type="checkbox"/> Signature Confirmation Restricted Delivery</td> </tr> <tr> <td><input type="checkbox"/> Collect on Delivery Restricted Delivery</td> <td></td> </tr> </table>	<input type="checkbox"/> Adult Signature	<input type="checkbox"/> Priority Mail Express®	<input type="checkbox"/> Adult Signature Restricted Delivery	<input type="checkbox"/> Registered Mail™	<input type="checkbox"/> Certified Mail®	<input type="checkbox"/> Registered Mail Restricted Delivery	<input type="checkbox"/> Certified Mail Restricted Delivery	<input type="checkbox"/> Signature Confirmation™	<input type="checkbox"/> Collect on Delivery	<input type="checkbox"/> Signature Confirmation Restricted Delivery	<input type="checkbox"/> Collect on Delivery Restricted Delivery	
<input type="checkbox"/> Adult Signature	<input type="checkbox"/> Priority Mail Express®												
<input type="checkbox"/> Adult Signature Restricted Delivery	<input type="checkbox"/> Registered Mail™												
<input type="checkbox"/> Certified Mail®	<input type="checkbox"/> Registered Mail Restricted Delivery												
<input type="checkbox"/> Certified Mail Restricted Delivery	<input type="checkbox"/> Signature Confirmation™												
<input type="checkbox"/> Collect on Delivery	<input type="checkbox"/> Signature Confirmation Restricted Delivery												
<input type="checkbox"/> Collect on Delivery Restricted Delivery													

RECEIVED

JAN 2 2025

PS Form 3811, July 2020 PSN 7530-02-000-9053 Domestic Return Receipt

U.S. Postal Service™
CERTIFIED MAIL® RECEIPT
Domestic Mail Only

For delivery information, visit our website at www.usps.com

OFFICIAL USE

Certified Mail Fee \$

Extra Services & Fees (check box, add fee as appropriate)

☐ Return Receipt (hardcopy) \$

☐ Return Receipt (electronic) \$

☐ Certified Mail Restricted Delivery \$

☐ Adult Signature Required \$

☐ Adult Signature Restricted Delivery \$

Postage \$

Total Postage and Fees \$

Sent To

Street Davoil, Inc.
PO Box 122269
City Fort Worth, TX 76121-2269
25060-67 PRO - Taipan

PS Form 3800, January 2023 PSN 7530-02-000-9047 See Reverse for Instructions

SENDER: COMPLETE THIS SECTION	COMPLETE THIS SECTION ON DELIVERY
<p>■ Complete items 1, 2, and 3.</p> <p>■ Print your name and address on the reverse so that we can return the card to you.</p> <p>■ Attach this card to the back of the mailpiece, or on the front if space permits.</p> <p>1. Article Addressed to:</p> <p style="text-align: center;">Davoil, Inc. PO Box 122269 Fort Worth, TX 76121-2269 25060-67 PRO - Taipan</p> <div style="text-align: center;">  9590 9402 9190 4225 2368 72 </div> <p>2. Article Number (Transfer from service label)</p> <p style="text-align: center; font-size: 1.2em;">9589 0710 5270 2305 9869 94</p>	<p>A. Signature <input checked="" type="checkbox"/> Agent <input checked="" type="checkbox"/> Addressee</p> <p>B. Received by (Printed Name) V. Collingwood</p> <p>C. Date of Delivery 1/2-20</p> <p>D. Is delivery address different from item 1? <input type="checkbox"/> Yes If YES, enter delivery address below: <input checked="" type="checkbox"/> No</p> <p style="text-align: center; font-size: 1.5em; color: green;">RECEIVED</p> <p style="text-align: center;">JAN 2 2025</p> <p>3. Service Type</p> <div style="display: flex; justify-content: space-between;"> <div> <input type="checkbox"/> Adult Signature <input type="checkbox"/> Adult Signature Restricted Delivery <input type="checkbox"/> Certified Mail® <input type="checkbox"/> Certified Mail Restricted Delivery <input type="checkbox"/> Collect on Delivery <input type="checkbox"/> Collect on Delivery Restricted Delivery </div> <div> <input checked="" type="checkbox"/> Priority Mail Express® <input type="checkbox"/> Registered Mail™ <input type="checkbox"/> Registered Mail Restricted Delivery <input type="checkbox"/> Signature Confirmation™ <input type="checkbox"/> Signature Confirmation Restricted Delivery </div> </div> <p>4. Mail Restricted Delivery <input type="checkbox"/></p>

PS Form 3811, July 2020 PSN 7530-02-000-9053 Domestic Return Receipt

U.S. Postal Service™
CERTIFIED MAIL® RECEIPT
 Domestic Mail Only

For delivery information, visit our website at www.usps.com®.

OFFICIAL USE

Certified Mail Fee \$ _____ Extra Services & Fees (check box, add fee as appropriate) <input type="checkbox"/> Return Receipt (hardcopy) \$ _____ <input type="checkbox"/> Return Receipt (electronic) \$ _____ <input type="checkbox"/> Certified Mail Restricted Delivery \$ _____ <input type="checkbox"/> Adult Signature Required \$ _____ <input type="checkbox"/> Adult Signature Restricted Delivery \$ _____ Postage \$ _____ Total Postage and Fees \$ _____ Sent To Street: EOG Resources, Inc. 5509 Champions Dr. City, St: Midland, TX 79706 25060-67 PRO - Taipan	
--	--

PS Form 3800, January 2023 PSN 7530-02-000-9047 See Reverse for Instructions

SENDER: COMPLETE THIS SECTION	COMPLETE THIS SECTION ON DELIVERY																
<ul style="list-style-type: none"> ■ Complete items 1, 2, and 3. ■ Print your name and address on the reverse so that we can return the card to you. ■ Attach this card to the back of the mailpiece, or on the front if space permits. <p>1. Article Addressed to:</p> <p style="margin-left: 40px;">EOG Resources, Inc. 5509 Champions Dr. Midland, TX 79706 25060-67 PRO - Taipan</p> <div style="text-align: center;">  9590 9402 9190 4225 2368 58 </div> <p>2. Article Number (Transfer from service label)</p> <p style="font-size: 1.2em; font-weight: bold;">9589 0710 5270 2305 9870 21</p>	<p>A. Signature <input checked="" type="checkbox"/> Agent <input type="checkbox"/> Addressee</p> <p>B. Received by (Printed Name) <i>S. Smith</i> C. Date of Delivery <i>12/19</i></p> <p>D. Is delivery address different from item 1? <input type="checkbox"/> Yes If YES, enter delivery address below: <input type="checkbox"/> No</p> <p style="text-align: center; font-size: 1.5em; color: blue;">RECEIVED</p> <p style="text-align: center; font-size: 1.2em;">JAN 2 2025</p> <p>3. Service Type</p> <table style="width: 100%;"> <tr> <td><input type="checkbox"/> Adult Signature</td> <td><input type="checkbox"/> Priority Mail Express®</td> </tr> <tr> <td><input type="checkbox"/> Adult Signature Restricted Delivery</td> <td><input type="checkbox"/> Registered Mail™</td> </tr> <tr> <td><input type="checkbox"/> Certified Mail®</td> <td><input type="checkbox"/> Registered Mail Restricted Delivery</td> </tr> <tr> <td><input type="checkbox"/> Certified Mail Restricted Delivery</td> <td><input type="checkbox"/> Signature Confirmation™</td> </tr> <tr> <td><input type="checkbox"/> Collect on Delivery</td> <td><input type="checkbox"/> Signature Confirmation Restricted Delivery</td> </tr> <tr> <td><input type="checkbox"/> Collect on Delivery Restricted Delivery</td> <td></td> </tr> <tr> <td><input type="checkbox"/> Insured Mail</td> <td></td> </tr> <tr> <td><input type="checkbox"/> Mail Restricted Delivery</td> <td></td> </tr> </table>	<input type="checkbox"/> Adult Signature	<input type="checkbox"/> Priority Mail Express®	<input type="checkbox"/> Adult Signature Restricted Delivery	<input type="checkbox"/> Registered Mail™	<input type="checkbox"/> Certified Mail®	<input type="checkbox"/> Registered Mail Restricted Delivery	<input type="checkbox"/> Certified Mail Restricted Delivery	<input type="checkbox"/> Signature Confirmation™	<input type="checkbox"/> Collect on Delivery	<input type="checkbox"/> Signature Confirmation Restricted Delivery	<input type="checkbox"/> Collect on Delivery Restricted Delivery		<input type="checkbox"/> Insured Mail		<input type="checkbox"/> Mail Restricted Delivery	
<input type="checkbox"/> Adult Signature	<input type="checkbox"/> Priority Mail Express®																
<input type="checkbox"/> Adult Signature Restricted Delivery	<input type="checkbox"/> Registered Mail™																
<input type="checkbox"/> Certified Mail®	<input type="checkbox"/> Registered Mail Restricted Delivery																
<input type="checkbox"/> Certified Mail Restricted Delivery	<input type="checkbox"/> Signature Confirmation™																
<input type="checkbox"/> Collect on Delivery	<input type="checkbox"/> Signature Confirmation Restricted Delivery																
<input type="checkbox"/> Collect on Delivery Restricted Delivery																	
<input type="checkbox"/> Insured Mail																	
<input type="checkbox"/> Mail Restricted Delivery																	

PS Form 3811, July 2020 PSN 7530-02-000-9053 Domestic Return Receipt

U.S. Postal Service™
CERTIFIED MAIL® RECEIPT
Domestic Mail Only

For delivery information, visit our website at www.usps.com.

OFFICIAL USE

<p>Certified Mail Fee \$</p> <p>Extra Services & Fees (check box, add fee as appropriate)</p> <p><input type="checkbox"/> Return Receipt (hardcopy) \$</p> <p><input type="checkbox"/> Return Receipt (electronic) \$</p> <p><input type="checkbox"/> Certified Mail Restricted Delivery \$</p> <p><input type="checkbox"/> Adult Signature Required \$</p> <p><input type="checkbox"/> Adult Signature Restricted Delivery \$</p> <p>Postage \$</p> <p>Total Postage and Fees \$</p> <p>Sent To</p> <p>Street Freddie Jean Wheeler 1117 S Tripp Ave City, State Odessa, TX 79760 25060-67 PRO - Taipan</p>	
---	--

PS Form 3800, January 2023 PSN 7530-02-000-9047 See Reverse for Instructions

SENDER: COMPLETE THIS SECTION	COMPLETE THIS SECTION ON DELIVERY
<ul style="list-style-type: none"> Complete items 1, 2, and 3. Print your name and address on the reverse so that we can return the card to you. Attach this card to the back of the mailpiece, or on the front if space permits. <p>1. Article Addressed to:</p> <p>Freddie Jean Wheeler 1117 S Tripp Ave Odessa, TX 79760 25060-67 PRO - Taipan</p> <div style="text-align: center;">  9590 9402 9190 4225 2368 41 </div> <p>2. Article Number (Transfer from service label)</p> <p>9589 0710 5270 2305 9870 38</p>	<p>A. Signature</p> <p><input checked="" type="checkbox"/> <i>Tanya McGehee</i> <input type="checkbox"/> Agent <input type="checkbox"/> Addressee</p> <p>B. Received by (Printed Name) <i>Tanya McGehee</i> C. Date of Delivery</p> <p>D. Is delivery address different from item 1? <input type="checkbox"/> Yes If YES, enter delivery address below: <input type="checkbox"/> No</p> <div style="text-align: center; font-size: 2em; font-weight: bold;">RECEIVED</div> <p style="text-align: center;">JAN 2 2025</p> <p>3. Service Type</p> <p><input type="checkbox"/> Adult Signature <input type="checkbox"/> Priority Mail Express®</p> <p><input type="checkbox"/> Adult Signature Restricted Delivery <input type="checkbox"/> Registered Mail™</p> <p><input type="checkbox"/> Certified Mail® <input type="checkbox"/> Registered Mail Restricted Delivery</p> <p><input type="checkbox"/> Certified Mail Restricted Delivery <input type="checkbox"/> Signature Confirmation™</p> <p><input type="checkbox"/> Collect on Delivery <input type="checkbox"/> Signature Confirmation Restricted Delivery</p> <p><input type="checkbox"/> Collect on Delivery Restricted Delivery <input type="checkbox"/> Mail</p> <p><input type="checkbox"/> Mail Restricted Delivery (over \$500)</p>

PS Form 3811, July 2020 PSN 7530-02-000-9053 Domestic Return Receipt

9589 0710 5270 2305 9870 45

U.S. Postal Service™
CERTIFIED MAIL® RECEIPT
 Domestic Mail Only

For delivery information, visit our website at www.usps.com.

OFFICIAL USE

Certified Mail Fee \$
 Extra Services & Fees (check box, add fee as appropriate)
☐ Return Receipt (hardcopy) \$
☐ Return Receipt (electronic) \$
☐ Certified Mail Restricted Delivery \$
☐ Adult Signature Required \$
☐ Adult Signature Restricted Delivery \$
 Postage \$
 Total Postage and Fees \$
 Sent To
 Street Gilmore Resources, Inc.
 PO Box 577
 City, Kimball, Nebraska 69145
 25060-67 PRO - Taiwan

Postmark
 DEC 19 2024

PS Form 3800, January 2023 PSN 7530-02-000-0047 See Reverse for Instructions

SENDER: COMPLETE THIS SECTION

- Complete items 1, 2, and 3.
- Print your name and address on the reverse so that we can return the card to you.
- Attach this card to the back of the mailpiece, or on the front if space permits.

1. Article Addressed to:

Gilmore Resources, Inc.
 PO Box 577
 Kimball, Nebraska 69145
 25060-67 PRO - Taiwan

9590 9402 9190 4225 2368 34

2. Article Number (Transfer from service label)
 9589 0710 5270 2305 9870 45

PS Form 3811, July 2020 PSN 7530-02-000-9053

COMPLETE THIS SECTION ON DELIVERY

A. Signature
 X *Sam* ☐ Agent ☐ Addressee

B. Received by (Printed Name)
Sandra Ann

C. Date of Delivery
 12-27-24

D. Is delivery address different from item 1? ☐ Yes
 If YES, enter delivery address below: ☐ No

3. Service Type
☐ Adult Signature ☐ Priority Mail Express®
☐ Adult Signature Restricted Delivery ☐ Registered Mail™
☐ Certified Mail® ☐ Registered Mail Restricted Delivery
☐ Certified Mail Restricted Delivery ☐ Signature Confirmation™
☐ Collect on Delivery ☐ Signature Confirmation Restricted Delivery
☐ Collect on Delivery Restricted Delivery

RECEIVED
 JAN 2 2025

Domestic Return Receipt



U.S. Postal Service™
CERTIFIED MAIL® RECEIPT
Domestic Mail Only

For delivery information, visit our website at www.usps.com™.

OFFICIAL USE

Certified Mail Fee \$ _____	
Extra Services & Fees (check box, add fee as appropriate)	
<input type="checkbox"/> Return Receipt (hardcopy) \$ _____	
<input type="checkbox"/> Return Receipt (electronic) \$ _____	
<input type="checkbox"/> Certified Mail Restricted Delivery \$ _____	
<input type="checkbox"/> Adult Signature Required \$ _____	
<input type="checkbox"/> Adult Signature Restricted Delivery \$ _____	
Postage \$ _____	
Total Postage and Fees \$ _____	
Sent to Great Western Drilling Ltd. PO Box 1659 Midland, TX 79702 25060-67 PRO - Taipan	

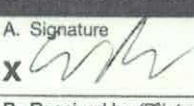
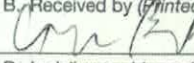
PS Form 3800, January 2023 PSN 7530-02-000-9047 See Reverse for Instructions

SENDER: COMPLETE THIS SECTION	COMPLETE THIS SECTION ON DELIVERY												
<ul style="list-style-type: none"> ■ Complete items 1, 2, and 3. ■ Print your name and address on the reverse so that we can return the card to you. ■ Attach this card to the back of the mailpiece, or on the front if space permits. 	<p>A. Signature <input checked="" type="checkbox"/>  <input type="checkbox"/> Agent <input type="checkbox"/> Addressee</p> <p>B. Received by (Printed Name)  </p> <p>C. Date of Delivery  </p> <p>D. Is delivery address different from item 1? <input type="checkbox"/> Yes If YES, enter delivery address below: <input type="checkbox"/> No</p>												
<p>1. Article Addressed to:</p> <p style="text-align: center;">Great Western Drilling Ltd. PO Box 1659 Midland, TX 79702 25060-67 PRO - Taipan</p> <p style="text-align: center;">  9590 9402 9190 4225 2368 27 </p>	<p style="text-align: center; font-size: 1.5em; color: red;">RECEIVED DEC 31 2024 JAN 6 2025</p>												
<p>2. Article Number (Transfer from service label) 9589 0710 5270 2305 9870 52 </p>	<p>3. Service Type</p> <table style="width: 100%;"> <tr> <td><input type="checkbox"/> Adult Signature</td> <td><input type="checkbox"/> Priority Mail Express®</td> </tr> <tr> <td><input type="checkbox"/> Adult Signature Restricted Delivery</td> <td><input type="checkbox"/> Registered Mail™</td> </tr> <tr> <td><input type="checkbox"/> Certified Mail®</td> <td><input type="checkbox"/> Registered Mail Restricted Delivery</td> </tr> <tr> <td><input type="checkbox"/> Certified Mail Restricted Delivery</td> <td><input type="checkbox"/> Signature Confirmation™</td> </tr> <tr> <td><input type="checkbox"/> Collect on Delivery</td> <td><input type="checkbox"/> Signature Confirmation Restricted Delivery</td> </tr> <tr> <td><input type="checkbox"/> Collect on Delivery Restricted Delivery</td> <td></td> </tr> </table> <p>Mail Restricted Delivery (0)</p>	<input type="checkbox"/> Adult Signature	<input type="checkbox"/> Priority Mail Express®	<input type="checkbox"/> Adult Signature Restricted Delivery	<input type="checkbox"/> Registered Mail™	<input type="checkbox"/> Certified Mail®	<input type="checkbox"/> Registered Mail Restricted Delivery	<input type="checkbox"/> Certified Mail Restricted Delivery	<input type="checkbox"/> Signature Confirmation™	<input type="checkbox"/> Collect on Delivery	<input type="checkbox"/> Signature Confirmation Restricted Delivery	<input type="checkbox"/> Collect on Delivery Restricted Delivery	
<input type="checkbox"/> Adult Signature	<input type="checkbox"/> Priority Mail Express®												
<input type="checkbox"/> Adult Signature Restricted Delivery	<input type="checkbox"/> Registered Mail™												
<input type="checkbox"/> Certified Mail®	<input type="checkbox"/> Registered Mail Restricted Delivery												
<input type="checkbox"/> Certified Mail Restricted Delivery	<input type="checkbox"/> Signature Confirmation™												
<input type="checkbox"/> Collect on Delivery	<input type="checkbox"/> Signature Confirmation Restricted Delivery												
<input type="checkbox"/> Collect on Delivery Restricted Delivery													
PS Form 3811, July 2020 PSN 7530-02-000-9053													

Domestic Return Receipt

9589 0710 5270 2305 9870 76

U.S. Postal Service™
CERTIFIED MAIL® RECEIPT
 Domestic Mail Only

For delivery information, visit our website at www.usps.com™.

OFFICIAL USE

Certified Mail Fee
 \$ _____

Extra Services & Fees (check box, add fee as appropriate)

<input type="checkbox"/> Return Receipt (hardcopy)	\$ _____
<input type="checkbox"/> Return Receipt (electronic)	\$ _____
<input type="checkbox"/> Certified Mail Restricted Delivery	\$ _____
<input type="checkbox"/> Adult Signature Required	\$ _____
<input type="checkbox"/> Adult Signature Restricted Delivery	\$ _____

Postage
 \$ _____

Total Postage and Fees
 \$ _____

Sent To
 Street or PO Box James R. Hurt
 PO Box 72
 City, State Odessa, TX 79760 25060-67 PRO - Taipan

PS Form 3800, January 2023 PSN 7530-02-000-9047 See Reverse for Instructions

SENDER: COMPLETE THIS SECTION

- Complete items 1, 2, and 3.
- Print your name and address on the reverse so that we can return the card to you.
- Attach this card to the back of the mailpiece, or on the front if space permits.

1. Article Addressed to:

James R. Hurt
 PO Box 72
 Odessa, TX 79760

25060-67 PRO - Taipan

9590 9402 9190 4225 2368 03

2. Article Number (Transfer from service label)
 9589 0710 5270 2305 9870 76

PS Form 3811, July 2020 PSN 7530-02-000-9053

COMPLETE THIS SECTION ON DELIVERY

A. Signature
 X *Mary Blain* ☐ Agent ☐ Addressee

B. Received by (Printed Name)
 MARY BLAIN

C. Date of Delivery
 12/19/24

D. Is delivery address different from item 1? ☐ Yes
 If YES, enter delivery address below: ☐ No

RECEIVED
 JAN 19 2025
 9589 0710 5270 2305 9870 76

3. Service Type

<input type="checkbox"/> Adult Signature	<input type="checkbox"/> Priority Mail Express®
<input type="checkbox"/> Adult Signature Restricted Delivery	<input type="checkbox"/> Registered Mail™
<input type="checkbox"/> Certified Mail®	<input type="checkbox"/> Registered Mail Restricted Delivery
<input type="checkbox"/> Certified Mail Restricted Delivery	<input type="checkbox"/> Signature Confirmation™
<input type="checkbox"/> Collect on Delivery	<input type="checkbox"/> Signature Confirmation Restricted Delivery
<input type="checkbox"/> Collect on Delivery Restricted Delivery	

Mail Restricted Delivery (over \$500)

9589 0710 5270 2305 9870 83

U.S. Postal Service™
CERTIFIED MAIL® RECEIPT
 Domestic Mail Only
For delivery information, visit our website at www.usps.com®.

OFFICIAL USE

Certified Mail Fee	\$
Extra Services & Fees (check box, add fee as appropriate)	
<input type="checkbox"/> Return Receipt (hardcopy)	\$
<input type="checkbox"/> Return Receipt (electronic)	\$
<input type="checkbox"/> Certified Mail Restricted Delivery	\$
<input type="checkbox"/> Adult Signature Required	\$
<input type="checkbox"/> Adult Signature Restricted Delivery	\$

Postage	\$
Total Postage and Fees	\$

Sent To	
Street a	Karen Benbow McRae
	PO Box 56429
City, St	Houston, TX 77256-6429
	25060-67 PRO - Taipan

PS Form 3800, January 2023 PSN 7530-02-000-9047 See Reverse for Instructions

DEC 2024
Postmark Here**SENDER: COMPLETE THIS SECTION**

- Complete items 1, 2, and 3.
- Print your name and address on the reverse so that we can return the card to you.
- Attach this card to the back of the mailpiece, or on the front if space permits.

1. Article Addressed to:

Karen Benbow McRae
 PO Box 56429
 Houston, TX 77256-6429

25060-67 PRO - Taipan



9590 9402 9190 4225 2367 97

2. Article Number (Transfer from service label)

9589 0710 5270 2305 9870 83

PS Form 3811, July 2020 PSN 7530-02-000-9053

COMPLETE THIS SECTION ON DELIVERY

A. Signature

X

☐ Agent☒ Addressee

B. Received by (Printed Name)

C. Date of Delivery

 D. Is delivery address different from item 1? ☐ Yes
 If YES, enter delivery address below: ☐ No
RECEIVED

JAN 6 2025

3. Service Type	Hinkle Shano	<input type="checkbox"/> Priority Mail Express®
<input type="checkbox"/> Adult Signature	Santa Fe NM 87501	<input type="checkbox"/> Registered Mail™
<input type="checkbox"/> Adult Signature Restricted Delivery		<input type="checkbox"/> Registered Mail Restricted Delivery
<input type="checkbox"/> Certified Mail®		<input type="checkbox"/> Signature Confirmation™
<input type="checkbox"/> Certified Mail Restricted Delivery		<input type="checkbox"/> Signature Confirmation Restricted Delivery
<input type="checkbox"/> Collect on Delivery		
<input type="checkbox"/> Collect on Delivery Restricted Delivery		
<input type="checkbox"/> Mail Restricted Delivery		

Domestic Return Receipt

U.S. Postal Service™
CERTIFIED MAIL® RECEIPT
Domestic Mail Only

For delivery information, visit our website at www.usps.com™.

OFFICIAL USE

Certified Mail Fee
\$ _____

Extra Services & Fees (check box, add fee as appropriate)

<input type="checkbox"/> Return Receipt (hardcopy)	\$ _____
<input type="checkbox"/> Return Receipt (electronic)	\$ _____
<input type="checkbox"/> Certified Mail Restricted Delivery	\$ _____
<input type="checkbox"/> Adult Signature Required	\$ _____
<input type="checkbox"/> Adult Signature Restricted Delivery	\$ _____

Postage
\$ _____

Total Postage and Fees
\$ _____

Sent To: Katherin Anne Gilmore Shannon and Laurence Davis Gilmore, Co-Trustees of The Katherine E. Gilmore Bypass Trust dated May 9, 2017.
505 N. Big Spring Ste. 303
Midland, TX 79701

City, St. _____

25060-67 PRO - Taiwan

PS Form 3800, January 2023 PSN 7530-02-000-9047 See Reverse for Instructions

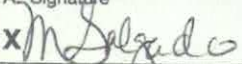
SENDER: COMPLETE THIS SECTION	COMPLETE THIS SECTION ON DELIVERY												
<p>■ Complete items 1, 2, and 3.</p> <p>■ Print your name and address on the reverse so that we can return the card to you.</p> <p>■ Attach this card to the back of the mailpiece, or on the front if space permits.</p> <p>1. Article Addressed to:</p> <p>Katherin Anne Gilmore Shannon and Laurence Davis Gilmore, Co-Trustees of The Katherine E. Gilmore Bypass Trust dated May 9, 2017. 505 N. Big Spring Ste. 303 Midland, TX 79701</p> <p style="text-align: right;">25060-67 PRO - Taiwan</p> <div style="text-align: center;">  9590 9402 9190 4225 2367 80 </div> <p>2. Article Number (Transfer from service label)</p> <p style="font-size: 1.2em;">9589 0710 5270 2305 9871 06</p>	<p>A. Signature  <input type="checkbox"/> Agent <input type="checkbox"/> Addressee</p> <p>B. Received by (Printed Name) Maggie Salgado</p> <p>C. Date of Delivery 12/23/24</p> <p>D. Is delivery address different from item 1? <input type="checkbox"/> Yes If YES, enter delivery address below: <input type="checkbox"/> No</p> <div style="text-align: center; font-size: 1.5em; font-weight: bold;">RECEIVED</div> <p style="text-align: center;">JAN 2 2025</p> <p>3. Service Type</p> <table border="0" style="width: 100%;"> <tr> <td><input type="checkbox"/> Adult Signature</td> <td><input type="checkbox"/> Priority Mail Express®</td> </tr> <tr> <td><input type="checkbox"/> Adult Signature Restricted Delivery</td> <td><input type="checkbox"/> Registered Mail™</td> </tr> <tr> <td><input type="checkbox"/> Certified Mail®</td> <td><input type="checkbox"/> Registered Mail Restricted Delivery</td> </tr> <tr> <td><input type="checkbox"/> Certified Mail Restricted Delivery</td> <td><input type="checkbox"/> Signature Confirmation™</td> </tr> <tr> <td><input type="checkbox"/> Collect on Delivery</td> <td><input type="checkbox"/> Signature Confirmation Restricted Delivery</td> </tr> <tr> <td><input type="checkbox"/> Collect on Delivery Restricted Delivery</td> <td></td> </tr> </table> <p style="text-align: right;">Hinkie Shannon LP State Fe NM Buss</p> <p>Mail Mail Restricted Delivery (0)</p>	<input type="checkbox"/> Adult Signature	<input type="checkbox"/> Priority Mail Express®	<input type="checkbox"/> Adult Signature Restricted Delivery	<input type="checkbox"/> Registered Mail™	<input type="checkbox"/> Certified Mail®	<input type="checkbox"/> Registered Mail Restricted Delivery	<input type="checkbox"/> Certified Mail Restricted Delivery	<input type="checkbox"/> Signature Confirmation™	<input type="checkbox"/> Collect on Delivery	<input type="checkbox"/> Signature Confirmation Restricted Delivery	<input type="checkbox"/> Collect on Delivery Restricted Delivery	
<input type="checkbox"/> Adult Signature	<input type="checkbox"/> Priority Mail Express®												
<input type="checkbox"/> Adult Signature Restricted Delivery	<input type="checkbox"/> Registered Mail™												
<input type="checkbox"/> Certified Mail®	<input type="checkbox"/> Registered Mail Restricted Delivery												
<input type="checkbox"/> Certified Mail Restricted Delivery	<input type="checkbox"/> Signature Confirmation™												
<input type="checkbox"/> Collect on Delivery	<input type="checkbox"/> Signature Confirmation Restricted Delivery												
<input type="checkbox"/> Collect on Delivery Restricted Delivery													

PS Form 3811, July 2020 PSN 7530-02-000-9053 Domestic Return Receipt

9589 0710 5270 2305 9871 13

U.S. Postal Service™ CERTIFIED MAIL® RECEIPT Domestic Mail Only	
For delivery information, visit our website at www.usps.com	
OFFICIAL USE	
Certified Mail Fee	
Extra Services & Fees (check box, add fee as appropriate)	
<input type="checkbox"/> Return Receipt (hardcopy)	\$
<input type="checkbox"/> Return Receipt (electronic)	\$
<input type="checkbox"/> Certified Mail Restricted Delivery	\$
<input type="checkbox"/> Adult Signature Required	\$
<input type="checkbox"/> Adult Signature Restricted Delivery	\$
Postage	
Total Postage and Fees	
Sent to	
Street	Magnum Hunter Production Inc.
City	PO Box 972875
	Dallas, TX 75397
	25060-67 PRO - Taipan
PS Form 3800, January 2023 PSN 7530-02-000-9047 See Reverse for Instructions	



SENDER: COMPLETE THIS SECTION	COMPLETE THIS SECTION ON DELIVERY
<ul style="list-style-type: none"> Complete items 1, 2, and 3. Print your name and address on the reverse so that we can return the card to you. Attach this card to the back of the mailpiece, or on the front if space permits. 	<p>A. Signature DEC 19 2024 X Gabriel Asamoah <input type="checkbox"/> Agent <input type="checkbox"/> Addressee</p> <p>B. Received by (Printed Name) C. Date of Delivery</p> <p>D. Is delivery address different from item 1? <input type="checkbox"/> Yes If YES, enter delivery address below: <input type="checkbox"/> No</p> <p>RECEIVED JAN 2 2025</p>
<p>1. Article Addressed to:</p> <p>Magnum Hunter Production Inc. PO Box 972875 Dallas, TX 75397</p> <p>25060-67 PRO - Taipan</p> <p>9590 9402 9190 4225 2367 73</p>	<p>3. Service Type</p> <p><input type="checkbox"/> Adult Signature <input type="checkbox"/> Adult Signature Restricted Delivery <input type="checkbox"/> Certified Mail® <input type="checkbox"/> Certified Mail Restricted Delivery <input type="checkbox"/> Collect on Delivery <input type="checkbox"/> Collect on Delivery Restricted Delivery <input type="checkbox"/> Insured Mail</p> <p><input type="checkbox"/> Priority Mail Express® <input type="checkbox"/> Registered Mail™ <input type="checkbox"/> Registered Mail Restricted Delivery <input type="checkbox"/> Signature Confirmation™ <input type="checkbox"/> Signature Confirmation Restricted Delivery</p> <p>Hinkle Shano Santa Fe NM 87201-9725</p>
<p>2. Article Number (Transfer from service label)</p> <p>9589 0710 5270 2305 9871 13</p>	<p>Mail Restricted Delivery</p>
<p>PS Form 3811, July 2020 PSN 7530-02-000-9053</p> <p>Domestic Return Receipt</p>	

9589 0710 5270 2305 9871 37

U.S. Postal Service™
CERTIFIED MAIL® RECEIPT
 Domestic Mail Only

For delivery information, visit our website at www.usps.com™.

OFFICIAL USE

Certified Mail Fee
 \$

Extra Services & Fees (check box, add fee as appropriate)

☐ Return Receipt (hardcopy) \$

☐ Return Receipt (electronic) \$

☐ Certified Mail Restricted Delivery \$

☐ Adult Signature Required \$

☐ Adult Signature Restricted Delivery \$

Postage
 \$

Total Postage and Fees
 \$

Sent To

Street: Morris Allen Williams
 PO Box 2302
 City: Payson, AZ 85547

25060-67 PRO - Taiwan

PS Form 3800, January 2023 PSN 7530-02-000-9047 See Reverse for Instructions

DEC 16 2024

SENDER: COMPLETE THIS SECTION

- Complete items 1, 2, and 3.
- Print your name and address on the reverse so that we can return the card to you.
- Attach this card to the back of the mailpiece, or on the front if space permits.

1. Article Addressed to:

Morris Allen Williams
 PO Box 2302
 Payson, AZ 85547

25060-67 PRO - Taiwan

9590 9402 9190 4225 2367 59

2. Article Number (Transfer from service label)
 9589 0710 5270 2305 9871 37

COMPLETE THIS SECTION ON DELIVERY

A. Signature
 X  ☐ Agent
☐ Addressee

B. Received by (Printed Name)
 Morris Williams

C. Date of Delivery
 JAN 2 2025

D. Is delivery address different from item 1? ☐ Yes
 If YES, enter delivery address below ☐ No

RECEIVED

3. Service Type
☐ Adult Signature
☐ Adult Signature Restricted Delivery
☐ Certified Mail®
☐ Certified Mail Restricted Delivery
☐ Collect on Delivery
☐ Collect on Delivery Restricted Delivery

☐ Priority Mail Express®
☐ Registered Mail™
☐ Registered Mail Restricted Delivery
☐ Signature Confirmation™
☐ Signature Confirmation Restricted Delivery

Mail
 Mail Restricted Delivery
 00

PS Form 3811, July 2020 PSN 7530-02-000-9053 Domestic Return Receipt

U.S. Postal Service™
CERTIFIED MAIL® RECEIPT
 Domestic Mail Only

For delivery information, visit our website at www.usps.com™.

OFFICIAL USE

Certified Mail Fee \$ _____ Extra Services & Fees (check box, add fee as appropriate) ✓ <input type="checkbox"/> Return Receipt (hardcopy) \$ _____ <input type="checkbox"/> Return Receipt (electronic) \$ _____ <input type="checkbox"/> Certified Mail Restricted Delivery \$ _____ <input type="checkbox"/> Adult Signature Required \$ _____ <input type="checkbox"/> Adult Signature Restricted Delivery \$ _____ Postage \$ _____ Total Postage and Fees \$ _____ Sent To Street Sabinal Energy Operating, LLC 1780 Hughes Landing Blvd Ste 1200 City, S The Woodlands, TX 77380 25060-67 PRO - Taiwan	
---	--

PS Form 3800, January 2023 PSN 7530-02-000-9047 See Reverse for Instructions

SENDER: COMPLETE THIS SECTION	COMPLETE THIS SECTION ON DELIVERY														
<ul style="list-style-type: none"> ■ Complete items 1, 2, and 3. ■ Print your name and address on the reverse so that we can return the card to you. ■ Attach this card to the back of the mailpiece, or on the front if space permits. <p>1. Article Addressed to:</p> <p style="text-align: center;">Sabinal Energy Operating, LLC 1780 Hughes Landing Blvd. ' 200 Woodlands, TX 77380 25060-67 PRO - Taiwan</p>  <p style="text-align: center;">9590 9402 9190 4225 2367 35</p> <p>2. Article Number (Transfer from service label) 9589 0710 5270 2305 9871 51</p>	<p>A. Signature  <input type="checkbox"/> Agent <input checked="" type="checkbox"/> Addressee</p> <p>B. Received by (Printed Name) C. Date of Delivery Jennifer Palma 12/23</p> <p>D. Is delivery address different from item 1? <input type="checkbox"/> Yes If YES, enter delivery address below: <input type="checkbox"/> No</p> <p style="text-align: center; font-size: 2em; color: lightblue;">RECEIVED JAN 13 2025</p> <p>3. Service Type</p> <table style="width: 100%;"> <tr> <td><input type="checkbox"/> Adult Signature</td> <td><input type="checkbox"/> Priority Mail Express®</td> </tr> <tr> <td><input type="checkbox"/> Adult Signature Restricted Delivery</td> <td><input type="checkbox"/> Registered Mail™</td> </tr> <tr> <td><input type="checkbox"/> Certified Mail®</td> <td><input type="checkbox"/> Registered Mail Restricted Delivery</td> </tr> <tr> <td><input type="checkbox"/> Certified Mail Restricted Delivery</td> <td><input type="checkbox"/> Signature Confirmation™</td> </tr> <tr> <td><input type="checkbox"/> Collect on Delivery</td> <td><input type="checkbox"/> Signature Confirmation Restricted Delivery</td> </tr> <tr> <td><input type="checkbox"/> Collect on Delivery Restricted Delivery</td> <td></td> </tr> <tr> <td><input type="checkbox"/> Insured Mail</td> <td></td> </tr> </table> <p>Mail Restricted Delivery (00)</p>	<input type="checkbox"/> Adult Signature	<input type="checkbox"/> Priority Mail Express®	<input type="checkbox"/> Adult Signature Restricted Delivery	<input type="checkbox"/> Registered Mail™	<input type="checkbox"/> Certified Mail®	<input type="checkbox"/> Registered Mail Restricted Delivery	<input type="checkbox"/> Certified Mail Restricted Delivery	<input type="checkbox"/> Signature Confirmation™	<input type="checkbox"/> Collect on Delivery	<input type="checkbox"/> Signature Confirmation Restricted Delivery	<input type="checkbox"/> Collect on Delivery Restricted Delivery		<input type="checkbox"/> Insured Mail	
<input type="checkbox"/> Adult Signature	<input type="checkbox"/> Priority Mail Express®														
<input type="checkbox"/> Adult Signature Restricted Delivery	<input type="checkbox"/> Registered Mail™														
<input type="checkbox"/> Certified Mail®	<input type="checkbox"/> Registered Mail Restricted Delivery														
<input type="checkbox"/> Certified Mail Restricted Delivery	<input type="checkbox"/> Signature Confirmation™														
<input type="checkbox"/> Collect on Delivery	<input type="checkbox"/> Signature Confirmation Restricted Delivery														
<input type="checkbox"/> Collect on Delivery Restricted Delivery															
<input type="checkbox"/> Insured Mail															

PS Form 3811, July 2020 PSN 7530-02-000-9053 Domestic Return Receipt

20 0286 5052 0250 0720 6856

U.S. Postal Service
CERTIFIED MAIL® RECEIPT

Domestic Mail Only

For delivery information, visit our website at www.usps.com

OFFICIAL USE

Certified Mail Fee

Extra Services & Fees (check box, add fee as appropriate)
☐ Return Receipt (hardcopy) \$
☐ Return Receipt (electronic) \$
☐ Certified Mail Restricted Delivery \$
☐ Adult Signature Required \$
☐ Adult Signature Restricted Delivery \$

Postage

Total Postage and Fees

Sent To

Street E. Cecile Martin
PO Box 246
City Marble Falls, TX 78654

29060-67 PRO - Taipei

PS Form 3800, January 2023 PSN 7530-02-000-9047

See Reverse for Instructions



9589 0710 5270 2305 9870 07



FROM



HINKLE SHANOR LLP

ATTORNEYS AT LAW

PO BOX 2068 • 218 MONTEZUMA
SANTA FE, NEW MEXICO 87504

TO

E. Cecile Martin
PO Box 246
Marble Falls, TX 78654

-K-T-S- 786545097-1N

12/28/24

RETURN TO SENDER
VACANT
UNABLE TO FORWARD
RETURN TO SENDER

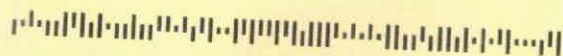

FIRST CLASS



US POSTAGE
ZIP 87501
02 7H
0006057409
DEC 16 2024
\$ 011.54

vac

LN 12/19

RECEIVED

JAN 3 2025

Hinkle Shanor LLP
Santa Fe NM 87504

9589 0710 5270 2305 9871 44

U.S. Postal Service™
CERTIFIED MAIL® RECEIPT
 Domestic Mail Only

For delivery information, visit our website at www.usps.com™.

OFFICIAL USE

Certified Mail Fee \$
 Extra Services & Fees (check box, add fee as appropriate)
☐ Return Receipt (hardcopy) \$
☐ Return Receipt (electronic) \$
☐ Certified Mail Restricted Delivery \$
☐ Adult Signature Required \$
☐ Adult Signature Restricted Delivery \$
 Postage \$
 Total Postage and Fees \$
 Sent to
 Street QRE Operating, LLC
 1209 Orange St. Wilmington Newcastle,
 City, Wilmington, DE 19801
 25060-67 PRO - Taiwan

DEC 16 2024
 Postmark Here

PS Form 3800, January 2023 PSN 7530-02-000-9047 See Reverse for Instructions

SENDER: COMPLETE THIS SECTION	COMPLETE THIS SECTION ON DELIVERY
<ul style="list-style-type: none"> Complete items 1, 2, and 3. Print your name and address on the reverse so that we can return the card to you. Attach this card to the back of the mailpiece, or on the front if space permits. 	<p>A. Signature X DEC 24 2024 <input type="checkbox"/> Agent <input type="checkbox"/> Addressee</p> <p>B. Received by (Printed Name) CT CORPORATION</p> <p>C. Date of Delivery</p> <p>D. Is delivery address different from item 1? <input type="checkbox"/> Yes If YES, enter delivery address below: <input type="checkbox"/> No</p>
<p>1. Article Addressed to:</p> <p>QRE Operating, LLC 1209 Orange St. Wilmington Newcastle, Wilmington, DE 19801 25060-67 PRO - Taiwan</p> <p>9590 9402 9190 4225 2367 42</p>	<p>RECEIVED JAN 3 2025</p>
<p>2. Article Number (Transfer from service label) 9589 0710 5270 2305 9871 44</p>	<p>3. Service Type First-Class Mail® <input type="checkbox"/> Adult Signature <input type="checkbox"/> Priority Mail Express® <input type="checkbox"/> Adult Signature Restricted Delivery <input type="checkbox"/> Registered Mail™ <input type="checkbox"/> Certified Mail® <input type="checkbox"/> Registered Mail Restricted Delivery <input type="checkbox"/> Certified Mail Restricted Delivery <input type="checkbox"/> Signature Confirmation™ <input type="checkbox"/> Collect on Delivery <input type="checkbox"/> Signature Confirmation Restricted Delivery <input type="checkbox"/> Collect on Delivery Restricted Delivery <input type="checkbox"/> Signature Confirmation Restricted Delivery</p>
<p>PS Form 3811, July 2020 PSN 7530-02-000-9053 Domestic Return Receipt</p>	

Wolters Kluwer

CT Corporation
 Rejection Team
 1999 Bryan Street
 Suite 900
 Dallas, TX 75201



quadrant
 FIRST-CLASS MAIL
 AUTO - IMI
 \$000.59
 15/06/2024 7P (P90)
 0491M32206320

US POSTAGE

JAN 3 2025



CT Corporation
Rejection Team
1999 Bryan Street
Suite 900
Dallas, TX 75201



quodient

FIRST-CLASS MAIL
AUTO - IMI

\$000.59²

12062024 ZIP 56305
043M32208326

US POSTAGE

JAN 8 2025

8056193

CT CORP-REJECT ENVL 105/20213

026 KAR3AAB 87504



9589 0710 5270 2305 9870 69

U.S. Postal ServiceTM
CERTIFIED MAIL[®] RECEIPT
Domestic Mail Only

For delivery information, visit our website at www.usps.com[®].

OFFICIAL USE

Certified Mail Fee

\$

Extra Services & Fees (check box, add fee as appropriate)

☐ Return Receipt (hardcopy)

\$

☐ Return Receipt (electronic)

\$

☐ Certified Mail Restricted Delivery

\$

☐ Adult Signature Required

\$

☐ Adult Signature Restricted Delivery

\$

Postage

\$

Total Postage and Fees

\$

Sent To

Street

City, S

Hurt Properties, LP

PO Box 1967

Abingdon, VA 24212-0000

25060-67 PRO - Taiwan

Postmark

DEC 15 2024

Here

PS Form 3800, January 2023 PSN 7530-02-000-9047 See Reverse for Instructions

ALERT: WINTER STORMS IN THE SOUTHERN, SOUTHEAST, AND NORTHEAST AND WILDFIRE...

USPS Tracking[®]

FAQs >

Tracking Number:

Remove X

9589071052702305987069

Copy Add to Informed Delivery (<https://informedelivery.usps.com/>)

Latest Update

Your item was picked up at the post office at 1:46 pm on December 23, 2024 in ABINGDON, VA 24210.

Get More Out of USPS Tracking:

USPS Tracking Plus[®]

Feedback

Delivered

Delivered, Individual Picked Up at Post Office

ABINGDON, VA 24210
December 23, 2024, 1:46 pm

Available for Pickup

ABINGDON
300 W MAIN ST
ABINGDON VA 24210-9998
M-F 0900-1700; SAT 1000-1200
December 21, 2024, 4:35 am

Arrived at Post Office

ABINGDON, VA 24210
December 21, 2024, 4:35 am

Arrived at USPS Regional Facility

KNOXVILLE TN DISTRIBUTION CENTER
December 20, 2024, 3:28 pm

In Transit to Next Facility

9589 0710 5270 2305 9871 20

U.S. Postal Service™ CERTIFIED MAIL® RECEIPT Domestic Mail Only	
For delivery information, visit our website at www.usps.com ®.	
OFFICIAL USE	
Certified Mail Fee	
\$	
Extra Services & Fees (check box, add fee as appropriate)	
<input type="checkbox"/> Return Receipt (hardcopy)	\$
<input type="checkbox"/> Return Receipt (electronic)	\$
<input type="checkbox"/> Certified Mail Restricted Delivery	\$
<input type="checkbox"/> Adult Signature Required	\$
<input type="checkbox"/> Adult Signature Restricted Delivery	\$
Postage	
\$	
Total Postage and Fees	
\$	
Sent To	
Street	McAnSo, LLC
	PO Box 50530
City	Austin, TX 78763
	25060-67 PRO - Taiwan
PS Form 3800, January 2023 PSN 7530-02-000-9047 See Reverse for Instructions	

Postmark Here DEC 1 2024

ALERT: WINTER STORMS IN THE SOUTHERN, SOUTHEAST, AND NORTHEAST AND WILDFIRE...

USPS Tracking[®]

FAQs >

Tracking Number:

Remove X

9589071052702305987120

Copy Add to Informed Delivery (<https://informedelivery.usps.com/>)

Latest Update

Your item has been delivered and is available at a PO Box at 8:03 am on December 20, 2024 in AUSTIN, TX 78703.

Get More Out of USPS Tracking:

USPS Tracking Plus[®]

Feedback

Delivered

Delivered, PO Box

AUSTIN, TX 78703
December 20, 2024, 8:03 am

Arrived at Post Office

AUSTIN, TX 78703
December 20, 2024, 7:56 am

In Transit to Next Facility

December 19, 2024

Arrived at USPS Regional Facility

AUSTIN TX DISTRIBUTION CENTER
December 18, 2024, 11:21 am

Departed USPS Facility

ALBUQUERQUE, NM 87101
December 17, 2024, 8:29 am

AFFIDAVIT OF PUBLICATION

CARLSBAD CURRENT-ARGUS
PO BOX 507
HUTCHINSON, KS 67504-0507

STATE OF NEW MEXICO }
COUNTY OF EDDY }

SS

Account Number: 94
Ad Number: 26190
Description: Permian Taipan 25060-25067
Ad Cost: \$217.80

Sherry Groves, being first duly sworn, says:

That she is the Agent of the the Carlsbad Current-Argus, a Weekly newspaper of general circulation, printed and published in Carlsbad, Eddy County, New Mexico; that the publication, a copy of which is attached hereto, was published in said newspaper on the following dates:

December 19, 2024

That said newspaper was regularly issued and circulated on those dates.
SIGNED:



Agent

Subscribed to and sworn to me this 19th day of December 2024.

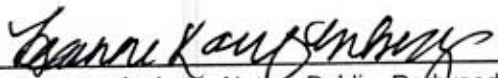

Leanne Kaufenberg, Notary Public, Redwood County
Minnesota

CARA DOUGLAS
HINKLE SHANOR, LLP
PO BOX 2068
Santa Fe, NM 87504
cdouglas@hinklelawfirm.com

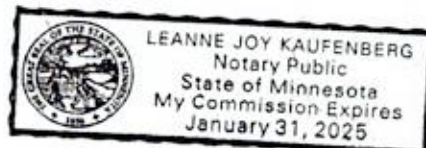

Permian Resources Operating, LLC
Case No. 25064
Exhibit C-4

PUBLIC NOTICE

This is to notify all interested parties, including BEXP II GW Alpha, LLC; BEXP II GW WI Omega, LLC; BEXP II Omega MISC., LLC; Bursake, LLC; Claremont Corporation; Davoil, Inc.; E. Cecile Martin; EOG Resources; Freddie Jean Wheeler; Gilmore Resources, Inc.; Great Western Drilling Ltd.; Hurt Properties, LP; James R. Hurt; Karen Benbow McRae; Katherine Anne Gilmore Shannon and Laurence Davis Gilmore, Co-Trustees of The Katherine E. Gilmore Bypass Trust dated May 9, 2017; Magnum Hunter Production Inc.; McAnSo, LLC; Morris Allen Williams; QRE Operating, LLC; Sabinal Energy Operating, LLC; and their successors and assigns, that the New Mexico Oil Conservation Division will conduct a hearing on the applications submitted by Permian Resources Operating, LLC (Case Nos. 25060, 25061, 25062, 25063, 25064, 25065, 25066 & 25067). The hearing will be conducted on January 9, 2025, in a hybrid fashion, both virtually and in-person at the Energy, Minerals, Natural Resources Department, Wendell Chino Building, Pecos Hall, 1220 South St. Francis Drive, 1st Floor, Santa Fe, NM 87505. To participate virtually, see the instructions posted on the OCD Hearings website: <https://www.emnrd.nm.gov/oed/hearing-info/>. In **Case No. 25060**, Permian Resources Operating, LLC ("Applicant") applies for an order pooling all uncommitted interests in the Bone Spring formation underlying a 320-acre, more or less, standard horizontal spacing unit comprised of the N/2 N/2 of Sections 21 and 22, Township 20 South, Range 28 East, Eddy County, New Mexico. The Unit will be dedicated to the **Taipan 21 Fed Com 131H** well, which will be drilled from a surface hole location in the SE/4 NE/4 (Unit H) of Section 20 to a bottom hole location in the NE/4 NE/4 (Unit A) of Section 22. In **Case No. 25061**, Applicant applies for an order pooling all uncommitted interests in the Bone Spring formation underlying a 320-acre, more or less, standard horizontal spacing unit comprised of the S/2 N/2 of Sections 21 and 22, Township 20 South, Range 28 East, Eddy County, New Mexico. The Unit will be dedicated to the **Taipan 21 Fed Com 132H** well, which will be drilled from a surface hole location in the SE/4 NE/4 (Unit H) of Section 20 to a bottom hole location in the SE/4 NE/4 (Unit H) of Section 22. In **Case No. 25062**, Applicant applies for an order pooling all uncommitted interests in the Bone Spring formation underlying a 320-acre, more or less, standard horizontal spacing unit comprised of the N/2 S/2 of Sections 21 and 22, Township 20 South, Range 28 East, Eddy County, New Mexico. The Unit will be dedicated to the **Taipan 21 Fed Com 133H** well, which will be drilled from a surface hole location in the NE/4 SE/4 (Unit I) of Section 20 to a bottom hole location in the NE/4 SE/4 (Unit I) of Section 22. In **Case No. 25063**, Applicant applies for an order pooling all uncommitted interests in the Bone Spring formation underlying a 320-acre, more or less, standard horizontal spacing unit comprised of the S/2 S/2 of Sections 21 and 22, Township 20 South, Range 28 East, Eddy County, New Mexico. The Unit will be dedicated to the **Taipan 21 Fed Com 134H** well, which will be drilled from a surface hole location in the NE/4 SE/4 (Unit I) of Section 20 to a bottom hole location in the SE/4 SE/4 (Unit P) of Section 22. In **Case No. 25064**, Applicant applies for an order pooling all uncommitted interests in the Wolfcamp formation underlying a 320-acre, more or less, standard horizontal spacing unit comprised of the N/2 N/2 of Sections 21 and 22, Township 20 South, Range 28 East, Eddy County, New Mexico. The Unit will be dedicated to the **Taipan 21 Fed Com 201H** well, which will be drilled from a surface hole location in the SE/4 NE/4 (Unit H) of Section 20 to a bottom hole location in the NE/4 NE/4 (Unit A) of Section 22. In **Case No. 25065**, Applicant applies for an order pooling all uncommitted interests in the Wolfcamp formation underlying a 320-acre, more or less, standard horizontal spacing unit comprised of the S/2 N/2 of Sections 21 and 22, Township 20 South, Range 28 East, Eddy County, New Mexico. The Unit will be dedicated to the **Taipan 21 Fed Com 202H** well, which will be drilled from a surface hole location in the SE/4 NE/4 (Unit H) of Section 20 to a bottom hole location in the SE/4 NE/4 (Unit H) of Section 22. In **Case No. 25066**, Applicant applies for an order pooling all uncommitted interests in the Wolfcamp formation underlying a 320-acre, more or less, standard horizontal spacing unit comprised of the N/2 S/2 of Sections 21 and 22, Township 20 South, Range 28 East, Eddy County, New Mexico. The Unit will be dedicated to the **Taipan 21 Fed Com 203H** well, which will be drilled from a surface hole location in the NE/4 SE/4 (Unit I) of Section 20 to a bottom hole location in the NE/4 SE/4 (Unit I) of Section 22. In **Case No. 25067**, Applicant applies for an order pooling all uncommitted interests in the Wolfcamp formation underlying a 320-acre, more or less, standard horizontal spacing unit comprised of the S/2 S/2 of Sections 21 and 22, Township 20 South, Range 28 East, Eddy County, New Mexico. The Unit will be dedicated to the **Taipan 21 Fed Com 204H** well, which will be drilled from a surface hole location in the NE/4 SE/4 (Unit I) of Section 20 to a bottom hole location in the SE/4 SE/4 (Unit P) of Section 22. The completed intervals of the Wells will be orthodox. Also to be

considered will be the cost of drilling and completing the Wells and the allocation of the costs, the designation of Applicant as operator of the Wells, and a 200% charge for the risk involved in drilling and completing the Wells. The Wells are located approximately 10 miles northeast of Carlsbad, New Mexico.

Published in the Carlsbad Current-Argus December 19, 2024.
#26190