

**STATE OF NEW MEXICO
ENERGY, MINERALS, AND NATURAL RESOURCES DEPARTMENT
OIL CONSERVATION DIVISION**

**APPLICATION OF TAP ROCK OPERATING,
LLC FOR APPROVAL TO COMPULSORY
POOL ADDITIONAL INTEREST OWNERS
UNDER ORDER R-23945, EDDY COUNTY, NEW
MEXICO**

CASE NO. 25710

NOTICE OF REVISED EXHIBITS

Tap Rock Operating, LLC ("Tap Rock"), applicant in the above referenced case, provides notice that it is filing the attached revised exhibits for acceptance into the record.

- **Tap Rock Revised Exhibit C** is a revised self-affirmed statement from Erica Shewmaker discussing the changes made to Tap Rock Exhibits C-3 through C-6.
- **Tap Rock Revised Exhibit C-3** is an updated pooling exhibit which includes a new Tract 7 and the new uncommitted and unleased mineral interest owner.
- **Tap Rock Revised Exhibit C-4** is an updated interest calculation for the Wolfcamp spacing unit from Original Case No. 25317, which reflects the inclusion of the new Tract 7 and new uncommitted and unleased mineral interest owner.
- **Tap Rock Revised Exhibit C-5** contains a copy of the well proposal letters sent in August of 2025 to the additional uncommitted and unleased mineral interest owner.
- **Tap Rock Revised Exhibit C-6** sets forth a chronology of contact with the new uncommitted and unleased owner Tap Rock seeks to pool under this amendment.

Respectfully submitted,

BEATTY & WOZNIAK, P.C.

By: 
Miguel A. Suazo
James P. Parrot
Jacob L. Everhart
Ryan McKee
Beatty & Wozniak, P.C.
500 Don Gaspar Ave.,
Santa Fe, NM 87505
(505) 946-2090
Fax: 800-886-6566
msuazo@bwenergylaw.com
jparrot@bwenergylaw.com
jeverhart@bwenergylaw.com
rmckee@bwenergylaw.com

**BEFORE THE OIL CONSERVATION DIVISION
EXAMINER HEARING DECEMBER 4, 2025**

Case No. 25710

Beer 30 – Order R-23945 Amendment

Eddy County, New Mexico



**STATE OF NEW MEXICO
ENERGY, MINERALS, AND NATURAL RESOURCES DEPARTMENT
OIL CONSERVATION DIVISION**

**APPLICATION OF TAP ROCK OPERATING, LLC
FOR APPROVAL TO COMPULSORY POOL
ADDITIONAL INTEREST OWNERS UNDER ORDER
R-23945, EDDY COUNTY, NEW MEXICO**

CASE NO. 25710

**HEARING PACKAGE
TABLE OF CONTENTS**

Tap Rock Exhibit A:	Application to Pool Additional Parties
Tap Rock Exhibit B:	Original Pooling Order
Tap Rock Exhibit C:	Self-Affirmed Statement of Erica Shewmaker, Landman
• Tap Rock Exhibit C-1:	Updated Plats of Tracts, Tract Ownership, Lease Numbers
• Tap Rock Exhibit C-2:	Updated Interest Calculations for Wolfcamp Spacing Unit
• Tap Rock Exhibit C-3:	Sample Well Proposal Letter & AFEs
• Tap Rock Exhibit C-4:	Detailed Summary of Chronology of Contact
Tap Rock Exhibit D:	Notice Affidavit
• Tap Rock Exhibit D-1:	Sample Notice Letter to All Interested Parties
• Tap Rock Exhibit D-2:	Chart of Notice to All Interested Parties
• Tap Rock Exhibit D-3:	Copies of Certified Mail Receipts and Returns
• Tap Rock Exhibit D-4:	Affidavit of Publication for October 30, 2025

**STATE OF NEW MEXICO
ENERGY, MINERALS, AND NATURAL RESOURCES DEPARTMENT
OIL CONSERVATION DIVISION**

**APPLICATION OF TAP ROCK
OPERATING, LLC FOR APPROVAL TO
COMPULSORY POOL ADDITIONAL
INTEREST OWNERS UNDER ORDER R-
23945, EDDY COUNTY, NEW MEXICO**

CASE NO. _____

APPLICATION

Tap Rock Operating, LLC, OGRID No. 372043 ("Tap Rock" or "Applicant"), through its undersigned attorneys, hereby files this Application with the Oil Conservation Division ("Division") for an order pooling additional uncommitted mineral interest owners under Division Order R-23945. In support of this application, Tap Rock states the following:

1. Order No. R-23945 pooled uncommitted mineral interest owners in the Purple-Sage; Wolfcamp formation [Pool Code: 98220] ("Wolfcamp Formation") underlying a standard horizontal spacing unit comprised of all of Sections 3 and 4, Township 25 South, Range 25 East, N.M.P.M., Eddy County, New Mexico (the "Unit").

2. The following wells (the "Wells") are dedicated to the Unit:

- a. **Beer 30 Fed Com 202H** (API No. 30-015-57254), **Beer 30 Fed Com 204H** (API No. 30-015-57256), **Beer 30 Fed Com 211H** (API No. 30-015-57255), and **Beer 30 Fed Com 213H** (API No. 30-015-57257).

3. Order No. R-23945 designated Tap Rock as the operator of the Unit and the Wells.

4. Tap Rock has determined that there are additional uncommitted and unleased mineral interest owners in the Unit who were not pooled by Order No. R-23945. The New Mexico Department of Transportation (NMDOT) owns a small, unleased mineral interest in the Unit.

Therefore, NMDOT, as a non-participant interest owner, is specifically provided notice herein as it relates to its unleased and uncommitted minerals in the Unit.¹

5. Tap Rock has made good-faith efforts to obtain voluntary agreements and joinder from all interest owners in the Wolfcamp formation underlying the proposed spacing Unit, but has been unable to secure agreement from all parties to participate in the drilling of the Wells or otherwise commit their interests. Therefore, Tap Rock seeks an order pooling all uncommitted mineral interest owners in the Wolfcamp formation underlying the Unit, pursuant to NMSA 1978 Sec. 70-2-17.

1. The pooling of all interests in the Wolfcamp formation within the proposed unit will avoid the drilling of unnecessary wells, prevent waste, and protect correlative rights.

WHEREFORE, Tap Rock requests this Application be set for hearing on **November 13, 2025**, or as soon as practicable thereafter, before an Examiner of the Oil Conservation Division, and after notice and hearing as required by law, the Division enter an order:

- A. Pooling all uncommitted mineral interest owners in the Wolfcamp formation underlying the Unit under Order R-23945;
- B. Authorizing Tap Rock to recover its costs of drilling, completing, and equipping the Wells, and allocating the cost thereof among the working interest owners;
- C. Approving the actual operating charges and costs of supervision while drilling and after completion, together with a provision adjusting the rates pursuant to the COPAS accounting procedures; and

¹ EMNRD OCD Case No. 13347 (Apr. 7, 2005) (Approving a pooling order application when applicant provided testimony that NMDOT routinely remains unresponsive or takes a non-participative role in compulsory pooling applications where it owns unleased and/or uncommitted mineral interests and when notice was properly provided to NMDOT); *see also* EMNRD OCD Case No. 13916 (May 10, 2007).

D. Imposing a 200% charge for the risk assumed by Tap Rock in drilling and completing the Wells against any working interest owner who does not voluntarily participate in the drilling of the Wells.

Respectfully submitted,

BEATTY & WOZNIAK, P.C.

By: 

Miguel A. Suazo

James P. Parrot

Jacob L. Everhart

Ryan McKee

500 Don Gaspar Ave.,

Santa Fe, NM 87505

(505) 946-2090

msuazo@bwenergylaw.com

jparrot@bwenergylaw.com

jeverhart@bwenergylaw.com

rmckee@bwenergylaw.com

Attorneys for Tap Rock Operating LLC

Application of Tap Rock Operating, LLC for approval to compulsory pool additional interest owners under Order R-23945, Eddy County, New Mexico. Tap Rock in the above-styled cause seeks an order from the Division pooling additional mineral interest owners under Order No. R-23945. The order pooled uncommitted mineral interest owners in the Wolfcamp formation underlying a standard horizontal spacing unit comprised of all of Sections 3 and 4 Township 25 South, Range 25 East, N.M.P.M., Eddy County, New Mexico. Tap Rock has determined that that are additional uncommitted and unleased mineral interest owners in the Unit who were not pooled by Order No. R-23945, including the New Mexico Department of Transportation. Tap Rock is the designated operator under the pooling order. Order R-23945 dedicated the Unit to the proposed initial wells including: **Beer 30 Fed Com 202H** (API No. 30-015-57254), **Beer 30 Fed Com 204H** (API No. 30-015-57256), **Beer 30 Fed Com 211H** (API No. 30-015-57255), and **Beer 30 Fed Com 213H** (API No. 30-015-57257). The wells and lands are located approximately 1 mile southeast of Whites City, New Mexico.

**STATE OF NEW MEXICO
ENERGY, MINERALS AND NATURAL RESOURCES DEPARTMENT
OIL CONSERVATION DIVISION**

**IN THE MATTER OF APPLICATION FOR
COMPULSORY POOLING SUBMITTED BY
TAP ROCK OPERATING, LLC**

**CASE NO. 25317
ORDER NO. R-23945**

ORDER

The Director of the New Mexico Oil Conservation Division (“OCD”), having heard this matter through a Hearing Examiner on May 8, 2025, and after considering the testimony, evidence, and recommendation of the Hearing and Technical Examiners, issues the following Order.

FINDINGS OF FACT

1. Tap Rock Operating, LLC (“Operator”) submitted an application (“Application”) to compulsory pool the uncommitted oil and gas interests within the spacing unit (“Unit”) described in Exhibit A. Operator seeks to be designated the operator of the Unit.
2. Operator will dedicate the well(s) described in Exhibit A (“Well(s)”) to the Unit.
3. Operator proposes the supervision and risk charges for the Well(s) described in Exhibit A.
4. Operator identified the owners of uncommitted interests in oil and gas minerals in the Unit and provided evidence that notice was given.
5. The Application was heard by the Hearing Examiner on the date specified above, during which Operator presented evidence through affidavits in support of the Application. No other party presented evidence at the hearing.

CONCLUSIONS OF LAW

6. OCD has jurisdiction to issue this Order pursuant to NMSA 1978, Section 70-2-17.
7. Operator is the owner of an oil and gas working interest within the Unit.
8. Operator satisfied the notice requirements for the Application and the hearing as required by 19.15.4.12 NMAC.
9. OCD satisfied the notice requirements for the hearing as required by 19.15.4.9 NMAC.
10. Operator has the right to drill the Well(s) to a common source of supply at the depth(s) and location(s) in the Unit described in Exhibit A.

11. The Unit contains separately owned uncommitted interests in oil and gas minerals.
12. Some of the owners of the uncommitted interests have not agreed to commit their interests to the Unit.
13. The pooling of uncommitted interests in the Unit will prevent waste and protect correlative rights, including the drilling of unnecessary wells.
14. This Order affords to the owner of an uncommitted interest the opportunity to produce his just and equitable share of the oil or gas in the pool.

ORDER

15. The uncommitted interests in the Unit are pooled as set forth in Exhibit A.
16. The Unit shall be dedicated to the Well(s) set forth in Exhibit A.
17. Operator is designated as operator of the Unit and the Well(s).
18. If the location of a well will be unorthodox under the spacing rules in effect at the time of completion, Operator shall obtain the OCD's approval for a non-standard location in accordance with 19.15.16.15(C) NMAC.
19. If the Unit is a non-standard horizontal spacing unit which has not been approved under this Order, Operator shall obtain the OCD's approval for a non-standard horizontal spacing unit in accordance with 19.15.16.15(B)(5) NMAC.
20. The Operator shall commence drilling the Well(s) within one year after the date of this Order, and complete each Well no later than one (1) year after the commencement of drilling the Well.
21. This Order shall terminate automatically if the Operator fails to comply with the preceding paragraph unless the Operator requests an extension by notifying the OCD and all parties that required notice of the original compulsory pooling application in accordance with 19.15.4.12.B and 19.15.4.12.C NMAC. Upon no objection after twenty (20) days the extension is automatically granted up to one year. If a protest is received the extension is not granted and the Operator must set the case for a hearing.
22. Operator may propose reasonable deviations from the development plan via notice to the OCD and all parties that required notice of the original compulsory pooling application in accordance with 19.15.4.12.B and 19.15.4.12.C NMAC. Upon no objection after twenty (20) days the deviation is automatically granted. If a protest is received the deviation is not granted and the Operator must set the case for a hearing.

CASE NO. 25317
ORDER NO. R-23945

Page 2 of 8

23. The infill well requirements in 19.15.13.9 NMAC through 19.15.13.12 NMAC shall be applicable.
24. Operator shall submit each owner of an uncommitted working interest in the pool ("Pooled Working Interest") an itemized schedule of estimated costs to drill, complete, and equip the well ("Estimated Well Costs").
25. No later than thirty (30) days after Operator submits the Estimated Well Costs, the owner of a Pooled Working Interest shall elect whether to pay its share of the Estimated Well Costs or its share of the actual costs to drill, complete and equip the well ("Actual Well Costs") out of production from the well. An owner of a Pooled Working Interest who elects to pay its share of the Estimated Well Costs shall render payment to Operator no later than thirty (30) days after the expiration of the election period, and shall be liable for operating costs, but not risk charges, for the well. An owner of a Pooled Working Interest who fails to pay its share of the Estimated Well Costs or who elects to pay its share of the Actual Well Costs out of production from the well shall be considered to be a "Non-Consenting Pooled Working Interest."
26. No later than one hundred eighty (180) days after Operator submits a Form C-105 for a well, Operator shall submit to each owner of a Pooled Working Interest an itemized schedule of the Actual Well Costs. The Actual Well Costs shall be considered to be the Reasonable Well Costs unless an owner of a Pooled Working Interest files a written objection no later than forty-five (45) days after receipt of the schedule. If an owner of a Pooled Working Interest files a timely written objection, OCD shall determine the Reasonable Well Costs after public notice and hearing.
27. No later than sixty (60) days after the expiration of the period to file a written objection to the Actual Well Costs or OCD's order determining the Reasonable Well Costs, whichever is later, each owner of a Pooled Working Interest who paid its share of the Estimated Well Costs shall pay to Operator its share of the Reasonable Well Costs that exceed the Estimated Well Costs, or Operator shall pay to each owner of a Pooled Working Interest who paid its share of the Estimated Well Costs its share of the Estimated Well Costs that exceed the Reasonable Well Costs.
28. The reasonable charges for supervision to drill and produce a well ("Supervision Charges") shall not exceed the rates specified in Exhibit A, provided however that the rates shall be adjusted annually pursuant to the COPAS form entitled "Accounting Procedure-Joint Operations."
29. No later than within ninety (90) days after Operator submits a Form C-105 for a well, Operator shall submit to each owner of a Pooled Working Interest an itemized schedule of the reasonable charges for operating and maintaining the well ("Operating Charges"), provided however that Operating Charges shall not include the Reasonable Well Costs or Supervision Charges. The Operating Charges shall

CASE NO. 25317
ORDER NO. R-23945

Page 3 of 8

be considered final unless an owner of a Pooled Working Interest files a written objection no later than forty-five (45) days after receipt of the schedule. If an owner of a Pooled Working Interest files a timely written objection, OCD shall determine the Operating Charges after public notice and hearing.

30. Operator may withhold the following costs and charges from the share of production due to each owner of a Pooled Working Interest who paid its share of the Estimated Well Costs: (a) the proportionate share of the Supervision Charges; and (b) the proportionate share of the Operating Charges.
31. Operator may withhold the following costs and charges from the share of production due to each owner of a Non-Consenting Pooled Working Interest: (a) the proportionate share of the Reasonable Well Costs; (b) the proportionate share of the Supervision and Operating Charges; and (c) the percentage of the Reasonable Well Costs specified as the charge for risk described in Exhibit A.
32. Operator shall distribute a proportionate share of the costs and charges withheld pursuant to the preceding paragraph to each Pooled Working Interest that paid its share of the Estimated Well Costs.
33. Each year on the anniversary of this Order, and no later than ninety (90) days after each payout, Operator shall provide to each owner of a Non-Consenting Pooled Working Interest a schedule of the revenue attributable to a well and the Supervision and Operating Costs charged against that revenue.
34. Any cost or charge that is paid out of production shall be withheld only from the share due to an owner of a Pooled Working Interest. No cost or charge shall be withheld from the share due to an owner of a royalty interests. For the purpose of this Order, an unleased mineral interest shall consist of a seven-eighths (7/8) working interest and a one-eighth (1/8) royalty interest.
35. Except as provided above, Operator shall hold the revenue attributable to a well that is not disbursed for any reason for the account of the person(s) entitled to the revenue as provided in the Oil and Gas Proceeds Payment Act, NMSA 1978, Sections 70-10-1 *et seq.*, and relinquish such revenue as provided in the Uniform Unclaimed Property Act, NMSA 1978, Sections 7-8A-1 *et seq.*
36. The Unit shall terminate if (a) the owners of all Pooled Working Interests reach a voluntary agreement; or (b) the well(s) drilled on the Unit are plugged and abandoned in accordance with the applicable rules. Operator shall inform OCD no later than thirty (30) days after such occurrence.
37. OCD retains jurisdiction of this matter for the entry of such orders as may be deemed necessary.

STATE OF NEW MEXICO
OIL CONSERVATION DIVISION



ALBERT CHANG
DIRECTOR
AC/jag

Date: 8/16/2025

CASE NO. 25317
ORDER NO. R-23945

Page **5** of **8**

Exhibit A

Received by OCD: 5/1/2025 4:56:52 PM

Page 3 of 54

COMPULSORY POOLING APPLICATION CHECKLIST	
ALL INFORMATION IN THE APPLICATION MUST BE SUPPORTED BY SIGNED AFFIDAVITS	
Case: 25317	APPLICANT'S RESPONSE
Date	
Applicant	Tap Rock Operating, LLC
Designated Operator & OGRID (affiliation if applicable)	372043
Applicant's Counsel:	Miguel Suazo, Beatty & Wozniak, P.C.
Case Title:	Application of Tap Rock Operating, LLC for Approval of Standard Horizontal Spacing Unit And Compulsory Pooling, Eddy County, New Mexico
Entries of Appearance/Intervenors:	EOG Resources, Inc.
Well Family	Beer 30 Fed Com
Formation/Pool	
Formation Name(s) or Vertical Extent:	Wolfcamp
Primary Product (Oil or Gas):	Gas
Pooling this vertical extent:	The top of the Wolfcamp formation to the base of the Wolfcamp formation
Pool Name and Pool Code:	Purple Sage; Wolfcamp (98220)
Well Location Setback Rules:	Order No. R-14262
Spacing Unit	
Type (Horizontal/Vertical)	Horizontal
Size (Acres)	1,283.04-acres, more or less
Building Blocks:	320.00-acres
Orientation:	East-West
Description: TRS/County	All of Sections 3 and 4, T-25-S, R-25-E, Eddy County, NM
Standard Horizontal Well Spacing Unit (Y/N), If No, describe and is approval of non-standard unit requested in this application?	Yes
Other Situations	
Depth Severance: Y/N. If yes, description	No
Proximity Tracts: If yes, description	No
Proximity Defining Well: if yes, description	Yes, Beer 30 Fed Com #213H
Applicant's Ownership in Each Tract	Exhibits C-3 and C-4
Well(s)	
Name & API (if assigned), surface and bottom hole location, footages, completion target, orientation, completion status (standard or non-standard)	Add wells as needed

Released to Imaging: 5/1/2025 4:57:44 PM

Case No. 25317
Tap Rock Operating, LLC- Exhibit ACASE NO. 25317
ORDER NO. R-23945

Page 6 of 8

Released to Imaging: 11/26/2025 1:08:38 PM

Case No. 25710
Tap Rock Operating, LLC - Exhibit B

Received by OCD: 5/1/2025 4:56:52 PM

Page 4 of 54

Well #1	Beer 30 Fed Com #202H (API No. Pending) SHL: NE/4 NE/4 (Lot 1) of Section 3, Township 25 South, Range 25 East, N.M.P.M. BHL: SW/4 NW/4 (Unit E) of Section 4, Township 25 South, Range 25 East, N.M.P.M. Completion Target: Purple Sage; Wolfcamp Gas Pool Well Orientation: East-West Completion Location: Standard
Well #2	Beer 30 Fed Com #204H (API No. Pending) SHL: NE/4 SE/4 (Unit I) of Section 3, Township 25 South, Range 25 East, N.M.P.M. BHL: SW/4 SW/4 (Unit M) of Section 4, Township 25 South, Range 25 East, N.M.P.M. Completion Target: Purple Sage; Wolfcamp Gas Pool Well Orientation: East-West Completion Location: Standard
Well #3	Beer 30 Fed Com #211H (API No. Pending) SHL: NE/4 NE/4 (Lot 1) of Section 3, Township 25 South, Range 25 East, N.M.P.M. BHL: NW/4 NW/4 (Lot 4) of Section 4, Township 25 South, Range 25 East, N.M.P.M. Completion Target: Purple Sage; Wolfcamp Gas Pool Well Orientation: East-West Completion Location: Standard
Well #4	Beer 30 Fed Com #213H (API No. Pending) SHL: NE/4 SE/4 (Unit I) of Section 3, Township 25 South, Range 25 East, N.M.P.M. BHL: NW/4 SW/4 (Unit L) of Section 4, Township 25 South, Range 25 East, N.M.P.M. Completion Target: Purple Sage; Wolfcamp Gas Pool Well Orientation: East-West Completion Location: Standard
Horizontal Well First and Last Take Points	Exhibit C-2
Completion Target (Formation, TVD and MD)	Exhibits C-5 and D-3
AFE Capex and Operating Costs	
Drilling Supervision/Month \$	Exhibit C \$8000
Production Supervision/Month \$	Exhibit C \$800
Justification for Supervision Costs	Exhibit C-5
Requested Risk Charge	200%
Released to Imaging: 5/1/2025 4:57:44 PM	Case No. 25317 Tap Rock Operating, LLC- Exhibit A

CASE NO. 25317
ORDER NO. R-23945

Page 7 of 8

Received by OCD: 5/1/2025 4:56:52 PM

Page 5 of 54

Proposed Notice of Hearing	Exhibits B and E-1
Proof of Mailed Notice of Hearing (20 days before hearing)	Exhibit E-3
Proof of Published Notice of Hearing (10 days before hearing)	Exhibit E-4
Ownership Determination	
Land Ownership Schematic of the Spacing Unit	Exhibits C-3 and C-4
Tract List (including lease numbers and owners)	Exhibits C-3 and C-4
If approval of Non-Standard Spacing Unit is requested, Tract List (including lease numbers and owners) of Tracts subject to notice requirements.	N/A
Pooled Parties (including ownership type)	Exhibit C-4
Unlocatable Parties to be Pooled	N/A
Ownership Depth Severance (including percentage above & below)	N/A
Joinder	
Sample Copy of Proposal Letter	Exhibit C-5
List of Interest Owners (ie Exhibit A of JOA)	Exhibits C-3 and C-4
Chronology of Contact with Non-Joined Working Interests	Exhibit C-6
Overhead Rates In Proposal Letter	Exhibit C-5
Cost Estimate to Drill and Complete	Exhibit C-5
Cost Estimate to Equip Well	Exhibit C-5
Cost Estimate for Production Facilities	Exhibit C-5
Geology	
Summary (including special considerations)	Exhibit D
Spacing Unit Schematic	Exhibit D-1
Gunbarrel/Lateral Trajectory Schematic	Exhibit D-4
Well Orientation (with rationale)	Exhibits D and D-2
Target Formation	Exhibits D-3 and D-4
HSU Cross Section	Exhibits D-3 and D-4
Depth Severance Discussion	N/A
Forms, Figures and Tables	
C-102	Exhibit C-2
Tracts	Exhibits C-3 and C-4
Summary of Interests, Unit Recapitulation (Tracts)	Exhibits C-3 and C-4
General Location Map (including basin)	Exhibit C-1
Well Bore Location Map	Exhibits C-1 and D-1
Structure Contour Map - Subsea Depth	Exhibit D-2
Cross Section Location Map (including wells)	Exhibits D-3 and D-4
Cross Section (including Landing Zone)	Exhibits D-3 and D-4
Additional Information	
Special Provisions/Stipulations	N/A
CERTIFICATION: I hereby certify that the information provided in this checklist is complete and accurate.	
Printed Name (Attorney or Party Representative):	Miguel Suazo
Signed Name (Attorney or Party Representative):	
Date:	5/1/2025

Case No. 25317

Tap Rock Operating, LLC- Exhibit A

CASE NO. 25317
ORDER NO. R-23945

Page 8 of 8

Page 16 of 42

**STATE OF NEW MEXICO
ENERGY, MINERALS, AND NATURAL RESOURCES DEPARTMENT
OIL CONSERVATION DIVISION**

**APPLICATION OF TAP ROCK OPERATING
LLC FOR APPROVAL TO COMPULSORY
POOL ADDITIONAL INTEREST OWNERS
UNDER ORDER NO. R-23945, EDDY COUNTY,
NEW MEXICO**

CASE NO. 25710

SELF-AFFIRMED STATEMENT OF ERICA SHEWMAKER

Erica Shewmaker, being first duly sworn upon oath, deposes and states as follows:

1. My name is Erica Shewmaker, and I am employed by Tap Rock Operating, LLC (“Tap Rock”) as Senior Landman.
2. I have previously testified before the New Mexico Oil Conservation Division (“Division”), and my qualifications as an expert in petroleum land matters were accepted and made a matter of record. I have several years of experience in petroleum land matters, and I have worked directly or in a supervisory role with the properties that are the subject of this matter.
3. I am familiar with the application filed by Tap Rock in the above-referenced case and the status of the subject lands.
4. None of the uncommitted parties in this case have indicated opposition to proceeding by self-affirmed statement, and therefore I do not expect any opposition at the hearing.
5. Under Case No. 25710, Tap Rock seeks to amend Division Order No. R-23945 (the “Order”), entered on August 16, 2025, in Case No. 25317 created a standard 1,283.04 acre, more or less, horizontal well spacing unit composed of All of Sections 3 and 4, Township 25 South, Range 25 East, Eddy County, New Mexico (the “Unit”), and designated Tap Rock Operating, LLC as operator of the unit. Order No. R-23945 further pooled the uncommitted interests in the

Wolfcamp formation (Purple-Sage Wolfcamp Pool Code: 98220) in the Unit and dedicated the Unit to the proposed initial **Beer 30 Fed Com #202H** (API No. 30-15-57254), **Beer 30 Fed Com #204H** (API No. 30-15-57256), **Beer 30 Fed Com #211H** (API No. 30-05-57255), **Beer 30 Fed Com #213H** (API No. 30-15-57257).

6. It has been determined that there was an additional uncommitted and unleased mineral interest owner, the New Mexico Department of Transportation (“NMDOT”), in the Unit who was not pooled by Order No. R-23945.

7. The granting of this Application is in the best interests of conservation, the prevention of waste, and the protection of correlative rights, and will avoid the drilling of unnecessary wells.

8. **Tap Rock Exhibit C-3** is an updated copy of the plat identifying ownership by tract, which includes a new Tract 7 and the new uncommitted and unleased mineral interest owner in the Unit exhibit (originally C-3 from original Case No. 25317).

9. **Tap Rock Exhibit C-4** is an updated interest calculation for the Wolfcamp spacing unit from Original Case No. 25317, setting forth the ownership and working interest percentages (as noted as Previously Pooled or Voluntary Joinder), and the additional party, whose entry is highlighted in yellow and noted to Compulsory Pool.

10. **Tap Rock Exhibit C-5** contains a copy of the well proposal letter sent in August of 2025 to the additional uncommitted and unleased mineral interest owner, which included AFEs for each well.

11. **Tap Rock Exhibit C-6** sets forth a chronology of contact with the uncommitted and unleased owner Tap Rock seeks to pool under this amendment. Tap Rock has made a good faith effort to obtain voluntary joinder of the interest owner in the wells.

12. I hereby swear that to the best of my knowledge and belief, all of the matters set forth herein and in the exhibits are true, correct, and accurate.

[Remainder of page left intentionally blank]

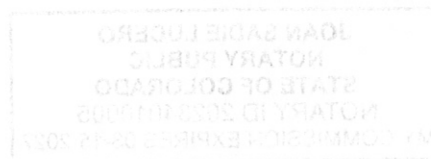

FURTHER AFFIANT SAYETH NOT.

Dated this 25 day of November, 2025.

Erica Shewmaker

Erica Shewmaker
Tap Rock Operating, LLC

STATE OF COLORADO)
) ss.
COUNTY OF)

The foregoing instrument was subscribed and sworn to before me this 25th day of November, 2025, by Erica Shewmaker, Senior Landman for Tap Rock Operating, LLC.

Witness my hand and official seal.

My commission expires: 03/15/2027

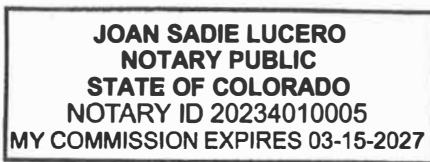

Joan Sadie Lucero

Exhibit C-3 Plat of Tracts, Tract Ownership, Applicable Lease Numbers

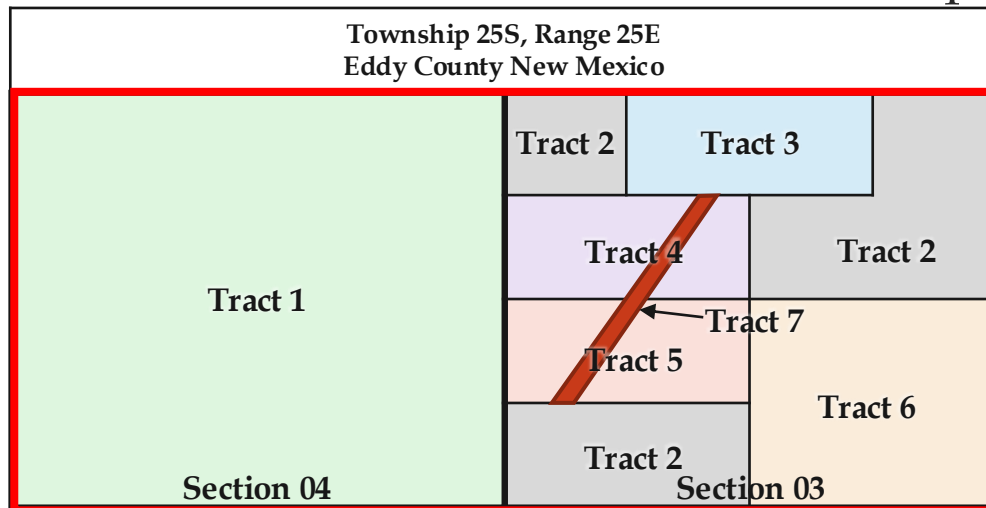

Tract No.	Lease Type	Lease No.
1 & 2	FED	BLM Lease 062171
3 & 6	FED	BLM Lease 116017
4	FEE	
5	FEE	
7	FEE	

 Beer 30 Fed Com Unit

Tract 1 – Sec 4 All	Tract WI %
Balog Family Trust dated 8/15/2002	0.290579
COG Operating LLC	38.764819
Concho Oil & Gas LLC	2.040254
EOG Resources Inc	21.054059
JKM Energy LLC	0.598906
OXY Y-1 Company	5.267463
Powderhorn Nominee Corp	8.000000
Sydhan, LP	2.000000
Tap Rock Resources III, LLC	16.983920
Vision Energy Inc	5.000000
Total	100.000000

Tract 2 – Sec 3 NWNW, NENE, S2NE, S2SW	Tract WI %
Balog Family Trust dated 8/15/2002	0.290579
Big Three Energy Group LLC	.076850
COG Operating LLC	38.764819
Concho Oil & Gas LLC	2.040254
EOG Resources Inc	21.054059
Featherstone Development Corporation	0.153701
JKM Energy LLC	0.598906
OXY Y-1 Company	5.267463
Parrot Head Properties LLC	0.153701
Powderhorn Nominee Corp	8.000000
Prospector LLC	0.768504
Sydhan LP	2.000000
Tap Rock Resources III LLC	15.831164
Vision Energy Inc	5.000000
Total	100.000000

Tract 3 – Sec 3 NWNE, NENW	Tract WI %
Tap Rock Resources III, LLC	11.538763
COG Operating LLC	49.086500
Concho Oil & Gas LLC	2.583500
EOG Resources Inc	26.660000
OXY Y-1 Company	6.670000
Featherstone Development Corporation	0.461498
Parrot Head Properties LLC	0.461498
Prospector LLC	2.307492
Big Three Energy Group LLC	0.230749
Total	100.000000

Tract 4 – Sec 3 S2NW + 1 Ac in N2SW	Tract WI %
Cimarex Energy Co, a subsidiary of Coterra Energy Operating Co.	30.560613
Tap Rock Resources III LLC	69.439387
Total	100.000000

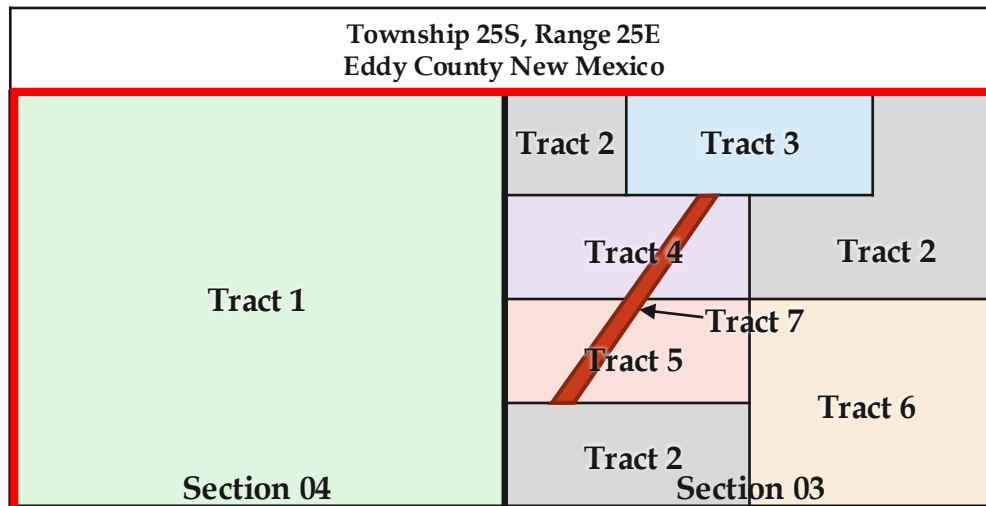

Tract No.	Lease Type	Lease No.
1 & 2	FED	BLM Lease 062171
3 & 6	FED	BLM Lease 116017
4	FEE	
5	FEE	
7	FEE	

 Beer 30 Fed Com Unit

Tract 5 – Sec 3 N2SW	Tract WI %
Berdan Living Trust	1.041667
Fandango, LLC	2.083333
Estate of Betty Cole Drake	4.166667
Estate of Frances Jane Owen	2.083333
Estate of Robert E Humphus	4.166667
Karen Dianne Farrell	6.250000
Powderhorn Asset Co	8.333333
Tap Rock Resources III LLC	71.875000
Total	100.000000

Tract 6 – Sec 3 SE4	Tract WI %
Tap Rock Resources III, LLC	11.538763
COG Operating LLC	49.086500
Concho Oil & Gas LLC	2.583500
EOG Resources Inc	26.660000
OXY Y-1 Company	6.670000
Featherstone Development Corporation	0.461498
Parrot Head Properties LLC	0.461498
Prospector LLC	2.307492
Big Three Energy Group LLC	0.230749
Total	100.000000

Tract 7 – Sec 3 Various Metes & Bounds	Tract WI %
New Mexico Department of Transportation	100.000000
Total	100.000000

Received by OCD: 11/26/2025 12:35:47 PM

Exhibit C-4 Working Interest in Beer 30 Unit

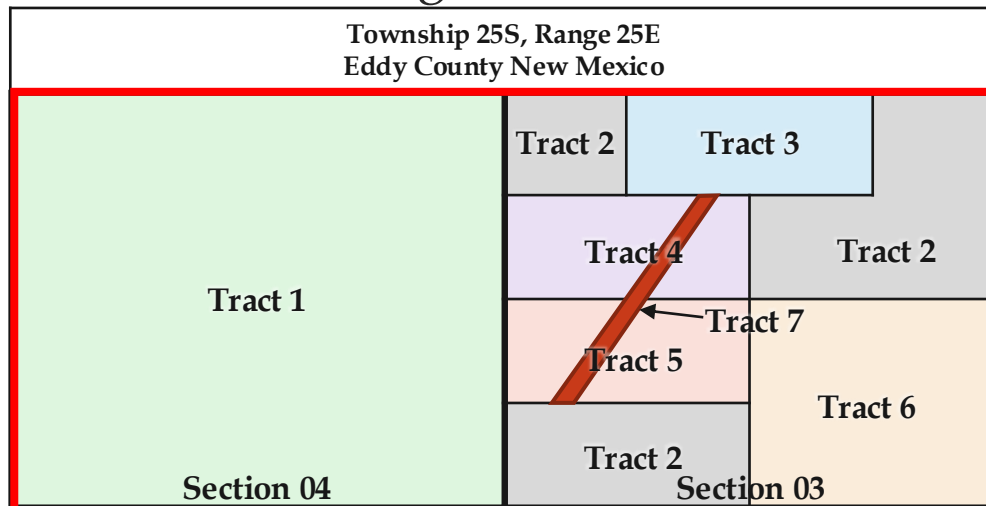

Beer 30 Fed Com Unit

Working Interest Owner	DSU Working Interest %	Net Acres	Tract No.	Status	Type of Interest
Tap Rock Resources III, LLC	22.283127	285.901433	1, 2, 3, 4, 5, 6	Operator	Working Interest
COG Operating LLC	35.865772	460.172198	1, 2, 3, 6	Voluntary Joinder	Working Interest
Concho Oil & Gas LLC	1.887672	24.219589	1, 2, 3, 6	Voluntary Joinder	Working Interest
Cimarex Energy Co, a subsidiary of Coterra Energy Operating Co.	1.895747	24.323192	4	Voluntary Joinder	Working Interest
Fandango, LLC	0.125989	1.616493	5	Voluntary Joinder	Working Interest
EOG Resources Inc	19.479520	249.930037	1, 2, 3, 6	Previously Pooled	Working Interest
Powderhorn Nominee Corp	5.502556	70.600000	1, 2	Previously Pooled	Working Interest
OXY Y-1 Company	4.873533	62.529383	1, 2, 3, 6	Previously Pooled	Working Interest
Vision Energy Inc	3.439098	44.125000	1, 2	Previously Pooled	Working Interest
Sydhan LP	1.375639	17.650000	1, 2	Previously Pooled	Working Interest

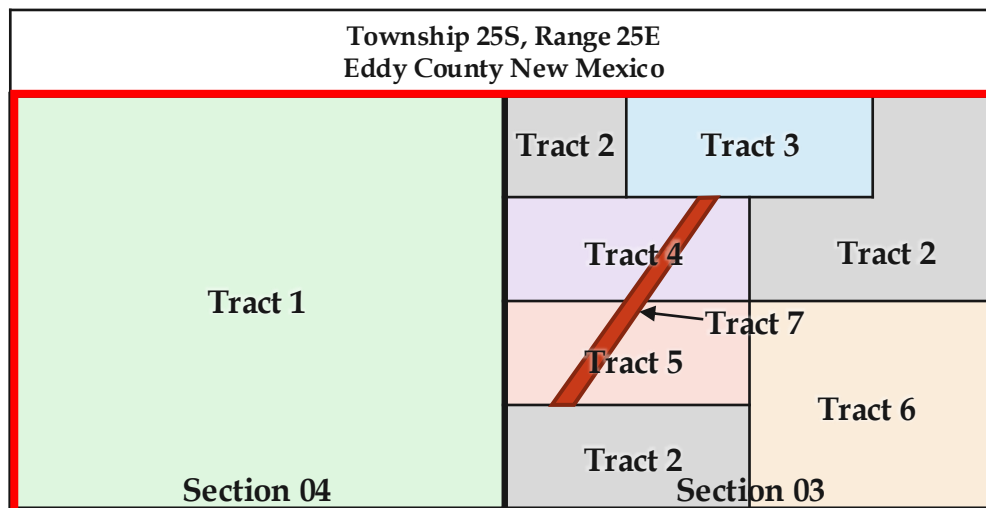

Beer 30 Fed Com Unit

WI Owner	WI	Net Acres	Tract No	Status	Type of Interest
Prospector LLC	0.576677	7.399001	2, 3, 6	Previously Pooled	Working Interest
Powderhorn Asset Co	0.503957	6.465975	5	Previously Pooled	Working Interest
JKM Energy LLC	0.411939	5.285345	1, 2	Previously Pooled	Working Interest
Karen Dianne Farrell	0.377968	4.849481	5	Previously Pooled	Working Interest
Estate of Betty Drake Cole	0.251979	3.232988	5	Previously Pooled	Working Interest
Estate of Robert Humphus	0.251979	3.232988	5	Previously Pooled	Working Interest
State of New Mexico, ex rel., New Mexico Department of Transportation	0.219658	2.818300	7	Compulsory Pool	Working Interest
Balog Family Trust dated 8/15/2002	0.199866	2.564359	1, 2	Previously Pooled	Working Interest
Estate of Frances Jane Owen	0.125989	1.616494	5	Previously Pooled	Working Interest
Featherstone Development Corporation	0.115335	1.479800	2, 3, 6	Previously Pooled	Working Interest
Parrot Head Properties LLC	0.115335	1.479800	2, 3, 6	Previously Pooled	Working Interest
Berdan Living Trust	0.062995	0.808247	5	Previously Pooled	Working Interest
Big Three Energy Group LLC	0.057668	0.739900	2, 3, 6	Previously Pooled	Working Interest
Total	100.000000	1283.040003			

TAP ROCK OPERATING, LLC

1700 LINCOLN STREET, SUITE 4700 - DENVER, COLORADO 80203



August 26, 2025

Via Certified Mail

NEW MEXICO DEPARTMENT OF TRANSPORTATION

1120 Cerrillos Road

Santa Fe, NM 87505

Re: Well Proposals**- BEER 30 FEDERAL COM #202H****- BEER 30 FEDERAL COM #204H****- BEER 30 FEDERAL COM #211H****- BEER 30 FEDERAL COM #213H****Township 25 South, Range 25 East Section 3: All & Section 4: All****Eddy County, New Mexico**

To Whom It May Concern:

Tap Rock Operating, LLC ("Tap Rock"), as Operator, hereby proposes to drill and complete the following wells (the "Wells") at the following approximate locations:

Well Name	Surface Hole Location (SHL)	Bottom Hole Location (BHL)	Formation	True Vertical Depth	Measured Depth
BEER 30 FEDERAL COM #202H	NE/4NE/4 of Section 3	5' FWL of Section 4 & 1,650' FNL of Section 4	Wolfcamp A	8,450'	18,650'
BEER 30 FEDERAL COM #204H	NE/4SE/4 of Section 3	5' FWL of Section 4 & 990' FSL of Section 4	Wolfcamp A	8,450'	18,650'
BEER 30 FEDERAL COM #211H	NE/4NE/4 of Section 3	5' FWL of Section 4 & 334' FNL of Section 4	Wolfcamp A	8,450'	18,650'
BEER 30 FEDERAL COM #213H	NE/4SE/4 of Section 3	5' FWL of Section 4 & 2,360' FSL of Section 4	Wolfcamp A	8,450'	18,650'

The proposed locations and drilling plans described above are subject to change depending on surface or subsurface issues that may be encountered.

An itemized schedule of the total estimated cost to drill and complete each of the Wells is provided in the enclosed AFEs. Tap Rock also estimates an additional \$1,283,000.00 per well for a central tank battery. Your election to participate in the drilling and completion of the Wells will also be considered an election to participate in the construction of the production facility. Tap Rock is proposing to drill the Wells under the modified terms of the enclosed AAPL Form 610-1989 Operating Agreement.

TAP ROCK OPERATING, LLC

1700 LINCOLN STREET, SUITE 4700 - DENVER, COLORADO 80203



Please indicate your election to participate by signing a copy of this letter and AFEs and return to me via Email or mail within thirty (30) days. If you do not wish to participate in the operation, Tap Rock would like to offer the following terms, subject to approval of Tap Rock's board and verification of title:

- For leased working interest parties, a three-year Term Assignment, \$500 per net acre bonus consideration.
- For unleased mineral owners, a three-year primary term lease with a royalty equal to the difference between existing burdens and 20%, \$500 per net acre bonus consideration.

Additionally, Tap Rock is open to discuss possible trades or other deal structures related to your interest in the proposed Wells. If an agreement cannot be reached within thirty (30) days of your receipt of this letter, Tap Rock will apply to the New Mexico Oil Conservation Division for compulsory pooling of your interest into a spacing unit for the proposed Wells to allow Tap Rock to move forward with planning and drilling the Wells.

Thank you for your time and consideration. If you have any questions regarding the above, please feel free to contact me at 720-459-3724 or by email at mphilips@taprk.com.

Sincerely,

TAP ROCK OPERATING, LLC

A handwritten signature in blue ink, appearing to read "Matthew C. Phillips".

Matthew C. Phillips

Land Manager

NEW MEXICO DEPARTMENT OF TRANSPORTATION hereby elects to:

_____ participate in the drilling, completion and equipping of the BEER 30 FEDERAL COM #202H

_____ non-consent the BEER 30 FEDERAL COM #202H

_____ participate in the drilling, completion and equipping of the BEER 30 FEDERAL COM #204H

_____ non-consent the BEER 30 FEDERAL COM #204H

_____ participate in the drilling, completion and equipping of the BEER 30 FEDERAL COM #211H

_____ non-consent the BEER 30 FEDERAL COM #211H

_____ participate in the drilling, completion and equipping of the BEER 30 FEDERAL COM #213H

_____ non-consent the BEER 30 FEDERAL COM #213H

By: _____

Name: _____

Title: _____

Date: _____

TAP ROCK OPERATING, LLC

1700 LINCOLN STREET, SUITE 4700 - DENVER, COLORADO 80203



August 26, 2025

Via Certified Mail

NEW MEXICO DEPARTMENT OF TRANSPORTATION
PO BOX 1149
SANTA FE, NM 87504-1149

Re: Well Proposals**- BEER 30 FEDERAL COM #202H****- BEER 30 FEDERAL COM #204H****- BEER 30 FEDERAL COM #211H****- BEER 30 FEDERAL COM #213H**

Township 25 South, Range 25 East Section 3: All & Section 4: All
Eddy County, New Mexico

To Whom It May Concern:

Tap Rock Operating, LLC ("Tap Rock"), as Operator, hereby proposes to drill and complete the following wells (the "Wells") at the following approximate locations:

Well Name	Surface Hole Location (SHL)	Bottom Hole Location (BHL)	Formation	True Vertical Depth	Measured Depth
BEER 30 FEDERAL COM #202H	NE/4NE/4 of Section 3	5' FWL of Section 4 & 1,650' FNL of Section 4	Wolfcamp A	8,450'	18,650'
BEER 30 FEDERAL COM #204H	NE/4SE/4 of Section 3	5' FWL of Section 4 & 990' FSL of Section 4	Wolfcamp A	8,450'	18,650'
BEER 30 FEDERAL COM #211H	NE/4NE/4 of Section 3	5' FWL of Section 4 & 334' FNL of Section 4	Wolfcamp A	8,450'	18,650'
BEER 30 FEDERAL COM #213H	NE/4SE/4 of Section 3	5' FWL of Section 4 & 2,360' FSL of Section 4	Wolfcamp A	8,450'	18,650'

The proposed locations and drilling plans described above are subject to change depending on surface or subsurface issues that may be encountered.

An itemized schedule of the total estimated cost to drill and complete each of the Wells is provided in the enclosed AFEs. Tap Rock also estimates an additional \$1,283,000.00 per well for a central tank battery. Your election to participate in the drilling and completion of the Wells will also be considered an election to participate in the construction of the production facility. Tap Rock is proposing to drill the Wells under the modified terms of the enclosed AAPL Form 610-1989 Operating Agreement.

TAP ROCK OPERATING, LLC

1700 LINCOLN STREET, SUITE 4700 - DENVER, COLORADO 80203



Please indicate your election to participate by signing a copy of this letter and AFEs and return to me via Email or mail within thirty (30) days. If you do not wish to participate in the operation, Tap Rock would like to offer the following terms, subject to approval of Tap Rock's board and verification of title:

- For leased working interest parties, a three-year Term Assignment, \$500 per net acre bonus consideration.
- For unleased mineral owners, a three-year primary term lease with a royalty equal to the difference between existing burdens and 20%, \$500 per net acre bonus consideration.

Additionally, Tap Rock is open to discuss possible trades or other deal structures related to your interest in the proposed Wells. If an agreement cannot be reached within thirty (30) days of your receipt of this letter, Tap Rock will apply to the New Mexico Oil Conservation Division for compulsory pooling of your interest into a spacing unit for the proposed Wells to allow Tap Rock to move forward with planning and drilling the Wells.

Thank you for your time and consideration. If you have any questions regarding the above, please feel free to contact me at 720-459-3724 or by email at mphilips@taprk.com.

Sincerely,

TAP ROCK OPERATING, LLC

A handwritten signature in blue ink, appearing to read "Matthew C. Phillips".

Matthew C. Phillips

Land Manager

NEW MEXICO DEPARTMENT OF TRANSPORTATION hereby elects to:

_____ participate in the drilling, completion and equipping of the BEER 30 FEDERAL COM #202H

_____ non-consent the BEER 30 FEDERAL COM #202H

_____ participate in the drilling, completion and equipping of the BEER 30 FEDERAL COM #204H

_____ non-consent the BEER 30 FEDERAL COM #204H

_____ participate in the drilling, completion and equipping of the BEER 30 FEDERAL COM #211H

_____ non-consent the BEER 30 FEDERAL COM #211H

_____ participate in the drilling, completion and equipping of the BEER 30 FEDERAL COM #213H

_____ non-consent the BEER 30 FEDERAL COM #213H

By: _____

Name: _____

Title: _____

Date: _____

TAP ROCK OPERATING, LLC

1700 Lincoln St Ste 4700 Denver CO 80203

Authorization For Expenditure

Name:	Beer 30 Fed Com #202H	Date:	January 28, 2025
AFE #:	0	MD/TVD:	18650 / 8450
County:	Eddy	Lateral Length:	9750
State:	NM	Geologic Target:	Wolfcamp A

Well Description: Drill, complete, and produce a horizontal Wolfcamp A well with a 9750 foot lateral.

INTANGIBLE DRILLING COSTS				INTANGIBLE COMPLETION COSTS				INTANGIBLE PRODUCTION COSTS			
COST CODES		DESCRIPTION	AMOUNT	COST CODES		DESCRIPTION	AMOUNT	COST CODES		DESCRIPTION	AMOUNT
1	1	Land - Legal	40,000	2	1	Land - Legal		3	1	Land - Legal	
1	2	Land - Regulatory	14,000	2	2	Land - Regulatory		3	2	Land - Regulatory	
1	3	Land - Surface Damages	50,000	2	3	Land - Surface Damages		3	3	Land - Surface Damages	
1	4	Land - Survey	10,000	2	4	Land - Survey		3	4	Land - Survey	
1	5	Location/Pit Construction	59,000	2	5	Location/Pit Construction		3	5	Location/Pit Construction	5,000
1	6	Remedial Dirtwork	0	2	6	Remedial Dirtwork		3	6	Remedial Dirtwork	
1	7	Reserve/Frac Pit Closing	0	2	7	Reserve/Frac Pit Closing		3	7	Reserve/Frac Pit Closing	
1	8	Drilling - Contractor	534,378	2	8	Drilling - Contractor		3	8	Drilling - Contractor	
1	9	Mob/Rig Up - Contractor/Trucking	50,000	2	9	Mob/Rig Up - Contractor/Trucking		3	9	Mob/Rig Up - Contractor/Trucking	
1	10	Cementing Services	141,000	2	10	Cementing Services		3	10	Cementing Services	
1	11	Cementing Equipment	30,000	2	11	Cementing Equipment		3	11	Cementing Equipment	
1	12	Bits/Drill Out Assemblies	63,500	2	12	Bits/Drill Out Assemblies	65,261	3	12	Bits/Drill Out Assemblies	
1	13	Fluid Circulation Equipment/Services	60,196	2	13	Fluid Circulation Equipment/Services		3	13	Fluid Circulation Equipment/Services	
1	14	Fluids/Chemicals	102,577	2	14	Fluids/Chemicals	43,482	3	14	Fluids/Chemicals	
1	15	WBM Cuttings/Wastewater Disposal	74,600	2	15	WBM Cuttings/Wastewater Disposal		3	15	WBM Cuttings/Wastewater Disposal	
1	16	OBM Cuttings/Chemical Disposal	0	2	16	OBM Cuttings/Chemical Disposal		3	16	OBM Cuttings/Chemical Disposal	
1	17	Fuel/Power	56,520	2	17	Fuel/Power	479,385	3	17	Fuel/Power	
1	18	Water	35,768	2	18	Water	602,610	3	18	Water	
1	19	Directional Drilling	188,401	2	19	Directional Drilling		3	19	Directional Drilling	
1	20	Mud Logging	23,113	2	20	Mud Logging		3	20	Mud Logging	
1	21	Open/Cased/Production Hole Logs	0	2	21	Open/Cased/Production Hole Logs	8,692	3	21	Open/Cased/Production Hole Logs	
1	22	Coring	0	2	22	Coring		3	22	Coring	
1	23	Geologic Supervision	0	2	23	Geologic Supervision		3	23	Geologic Supervision	
1	24	Engineering Supervision	0	2	24	Engineering Supervision		3	24	Engineering Supervision	
1	25	Consultant Supervision	96,096	2	25	Consultant Supervision	80,560	3	25	Consultant Supervision	23,500
1	26	Freight/Transportation	9,000	2	26	Freight/Transportation	2,000	3	26	Freight/Transportation	10,000
1	27	Labor	98,500	2	27	Labor	2,532	3	27	Labor	12,917
1	28	Supplies - Surface	2,500	2	28	Supplies - Surface	2,000	3	28	Supplies - Surface	
1	29	Supplies - Living Quarters	1,000	2	29	Supplies - Living Quarters	2,000	3	29	Supplies - Living Quarters	
1	30	Rentals - Surface	53,103	2	30	Rentals - Surface	14,763	3	30	Rentals - Surface	23,667
1	31	Rentals - Living Quarters	34,076	2	31	Rentals - Living Quarters	15,630	3	31	Rentals - Living Quarters	
1	32	Rentals - Downhole	2,000	2	32	Rentals - Downhole	0	3	32	Rentals - Downhole	
1	33	Rentals - Pipe & Handling Tools	58,404	2	33	Rentals - Pipe & Handling Tools	0	3	33	Rentals - Pipe & Handling Tools	
1	34	Rentals - Frac Stack		2	34	Rentals - Frac Stack	84,307	3	34	Rentals - Frac Stack	0
1	35	Rentals - Frac Tanks	5,652	2	35	Rentals - Frac Tanks	29,562	3	35	Rentals - Frac Tanks	900
1	36	Coil Tubing Unit/Workover Rig		2	36	Coil Tubing Unit/Workover Rig	132,744	3	36	Coil Tubing Unit/Workover Rig	26,500
1	37	Wireline/Slickline/Perforating		2	37	Wireline/Slickline/Perforating	261,608	3	37	Wireline/Slickline/Perforating	12,000
1	38	Temporary Packers/Plugs		2	38	Temporary Packers/Plugs	48,045	3	38	Temporary Packers/Plugs	
1	39	High Pressure Pump Truck		2	39	High Pressure Pump Truck	53,795	3	39	High Pressure Pump Truck	
1	40	Stimulation		2	40	Stimulation	1,760,226	3	40	Stimulation	
1	41	Rentals - Pressure Control		2	41	Rentals - Pressure Control		3	41	Rentals - Pressure Control	
1	42	Flowback Services		2	42	Flowback Services	54,103	3	42	Flowback Services	67,167
1	43	Water Transfer Services		2	43	Water Transfer Services	55,650	3	43	Water Transfer Services	
1	44	Flowback Water Trucking & Disposal		2	44	Flowback Water Trucking & Disposal	9,446	3	44	Flowback Water Trucking & Disposal	65,000
1	45	Permanent Equipment Installation		2	45	Permanent Equipment Installation		3	45	Permanent Equipment Installation	
1	46	Pipeline Tapping Services		2	46	Pipeline Tapping Services		3	46	Pipeline Tapping Services	
1	47	Plugging & Abandonment	0	2	47	Plugging & Abandonment		3	47	Plugging & Abandonment	
1	53	Overhead	0	2	53	Overhead	13,715	3	53	Overhead	0
1	54	Insurance	20,000	2	54	Insurance		3	54	Insurance	
1	55	Contingency	382,677	2	55	Contingency	441,301	3	55	Contingency	46,930
TOTAL INTANGIBLE DRILLING COSTS:			\$2,296,060	TOTAL INTANGIBLE COMPLETION COSTS:			\$4,263,416	TOTAL INTANGIBLE PRODUCTION COSTS:			\$293,580

TANGIBLE DRILLING COSTS				TANGIBLE COMPLETION COSTS				TANGIBLE PRODUCTION COSTS			
COST CODES		DESCRIPTION	AMOUNT	COST CODES		DESCRIPTION	AMOUNT	COST CODES		DESCRIPTION	AMOUNT
4	60	Conductor Casing	30,000	5	60	Conductor Casing		6	60	Conductor Casing	
4	61	Surface Casing	15,652	5	61	Surface Casing		6	61	Surface Casing	
4	62	1st Intermediate Casing	46,620	5	62	1st Intermediate Casing		6	62	1st Intermediate Casing	
4	63	2nd Intermediate Casing	0	5	63	2nd Intermediate Casing		6	63	2nd Intermediate Casing	
4	64	Production Casing	454,128	5	64	Production Casing	0	6	64	Production Casing	
4	65	Tubing		5	65	Tubing		6	65	Tubing	51,783
4	66	Wellhead	78,000	5	66	Wellhead	0	6	66	Wellhead	29,610
4	67	Permanent Packers/Hangers/Plugs		5	67	Permanent Packers/Hangers/Plugs		6	67	Permanent Packers/Hangers/Plugs	0
4	68	Tanks		5	68	Tanks		6	68	Tanks	
4	69	Production Vessels		5	69	Production Vessels		6	69	Production Vessels	311,225
4	70	Compressors		5	70	Compressors		6	70	Compressors	
4	71	Surface Flowlines		5	71	Surface Flowlines		6	71	Surface Flowlines	358,700
4	72	Gathering Lines		5	72	Gathering Lines		6	72	Gathering Lines	0
4	73	Valves & Controllers		5	73	Valves & Controllers		6	73	Valves & Controllers	0
4	74	Artificial Lift Equipment		5	74	Artificial Lift Equipment		6	74	Artificial Lift Equipment	79,000
4	75	Instrumentation & Measurement		5	75	Instrumentation & Measurement		6	75	Instrumentation & Measurement	
4	76	Electrical Grounding/Safety Equipment		5	76	Electrical Grounding/Safety Equipment		6	76	Electrical Grounding/Safety Equipment	
4	77	Permanent Equipment Installation		5	77	Permanent Equipment Installation		6	77	Permanent Equipment Installation	6,250
4	80	Other - Surface		5	80	Other - Surface		6	80	Other - Surface	
4	81	Other - Downhole	15,000	5	81	Other - Downhole		6	81	Other - Downhole	
TOTAL TANGIBLE DRILLING COSTS:			\$639,400	TOTAL TANGIBLE COMPLETION COSTS:			\$0	TOTAL TANGIBLE PRODUCTION COSTS:			\$836,568
TOTAL DRILLING COSTS:			\$2,935,460	TOTAL COMPLETION COSTS:			\$4,263,416	TOTAL PRODUCTION COSTS:			\$1,130,148

TOTAL WELL COST: \$8,329,023

TAP ROCK RESOURCES COMPANY APPROVAL:				NON OPERATING PARTNER APPROVAL:			
CEO _____ VP - EXPLORATION _____				COMPANY NAME: _____			
CFO _____ VP - OPERATIONS _____				SIGNED BY: _____ TITLE: _____			
VP - LAND & LEGAL _____ SENIOR GEOLOGIST _____				WORKING INTEREST (%): _____ DATE: _____			
				TAX ID: _____ APPROVAL: _____			

AFE is an estimate only. By signing this AFE, you agree to pay your proportionate share of the actual costs.

TAP ROCK OPERATING, LLC

1700 Lincoln St Ste 4700 Denver CO 80203

Authorization For Expenditure

Name:	Beer 30 Fed Com #204H	Date:	January 28, 2025
AFE #:	0	MD/TVD:	18650 / 8450
County:	Eddy	Lateral Length:	9750
State:	NM	Geologic Target:	Wolfcamp A

Well Description: Drill, complete, and produce a horizontal Wolfcamp A well with a 9750 foot lateral.

INTANGIBLE DRILLING COSTS				INTANGIBLE COMPLETION COSTS				INTANGIBLE PRODUCTION COSTS			
COST CODES		DESCRIPTION	AMOUNT	COST CODES		DESCRIPTION	AMOUNT	COST CODES		DESCRIPTION	AMOUNT
1	1	Land - Legal	40,000	2	1	Land - Legal		3	1	Land - Legal	
1	2	Land - Regulatory	14,000	2	2	Land - Regulatory		3	2	Land - Regulatory	
1	3	Land - Surface Damages	50,000	2	3	Land - Surface Damages		3	3	Land - Surface Damages	
1	4	Land - Survey	10,000	2	4	Land - Survey		3	4	Land - Survey	
1	5	Location/Pit Construction	59,000	2	5	Location/Pit Construction		3	5	Location/Pit Construction	5,000
1	6	Remedial Dirtwork	0	2	6	Remedial Dirtwork		3	6	Remedial Dirtwork	
1	7	Reserve/Frac Pit Closing	0	2	7	Reserve/Frac Pit Closing		3	7	Reserve/Frac Pit Closing	
1	8	Drilling - Contractor	534,378	2	8	Drilling - Contractor		3	8	Drilling - Contractor	
1	9	Mob/Rig Up - Contractor/Trucking	50,000	2	9	Mob/Rig Up - Contractor/Trucking		3	9	Mob/Rig Up - Contractor/Trucking	
1	10	Cementing Services	141,000	2	10	Cementing Services		3	10	Cementing Services	
1	11	Cementing Equipment	30,000	2	11	Cementing Equipment		3	11	Cementing Equipment	
1	12	Bits/Drill Out Assemblies	63,500	2	12	Bits/Drill Out Assemblies	65,261	3	12	Bits/Drill Out Assemblies	
1	13	Fluid Circulation Equipment/Services	60,196	2	13	Fluid Circulation Equipment/Services		3	13	Fluid Circulation Equipment/Services	
1	14	Fluids/Chemicals	102,577	2	14	Fluids/Chemicals	43,482	3	14	Fluids/Chemicals	
1	15	WBM Cuttings/Wastewater Disposal	74,600	2	15	WBM Cuttings/Wastewater Disposal		3	15	WBM Cuttings/Wastewater Disposal	
1	16	OBM Cuttings/Chemical Disposal	0	2	16	OBM Cuttings/Chemical Disposal		3	16	OBM Cuttings/Chemical Disposal	
1	17	Fuel/Power	56,520	2	17	Fuel/Power	479,385	3	17	Fuel/Power	
1	18	Water	35,768	2	18	Water	602,610	3	18	Water	
1	19	Directional Drilling	188,401	2	19	Directional Drilling		3	19	Directional Drilling	
1	20	Mud Logging	23,113	2	20	Mud Logging		3	20	Mud Logging	
1	21	Open/Cased/Production Hole Logs	0	2	21	Open/Cased/Production Hole Logs	8,692	3	21	Open/Cased/Production Hole Logs	
1	22	Coring	0	2	22	Coring		3	22	Coring	
1	23	Geologic Supervision	0	2	23	Geologic Supervision		3	23	Geologic Supervision	
1	24	Engineering Supervision	0	2	24	Engineering Supervision		3	24	Engineering Supervision	
1	25	Consultant Supervision	96,096	2	25	Consultant Supervision	80,560	3	25	Consultant Supervision	23,500
1	26	Freight/Transportation	9,000	2	26	Freight/Transportation	2,000	3	26	Freight/Transportation	10,000
1	27	Labor	98,500	2	27	Labor	2,532	3	27	Labor	12,917
1	28	Supplies - Surface	2,500	2	28	Supplies - Surface	2,000	3	28	Supplies - Surface	
1	29	Supplies - Living Quarters	1,000	2	29	Supplies - Living Quarters	2,000	3	29	Supplies - Living Quarters	
1	30	Rentals - Surface	53,103	2	30	Rentals - Surface	14,763	3	30	Rentals - Surface	23,667
1	31	Rentals - Living Quarters	34,076	2	31	Rentals - Living Quarters	15,630	3	31	Rentals - Living Quarters	
1	32	Rentals - Downhole	2,000	2	32	Rentals - Downhole	0	3	32	Rentals - Downhole	
1	33	Rentals - Pipe & Handling Tools	58,404	2	33	Rentals - Pipe & Handling Tools	0	3	33	Rentals - Pipe & Handling Tools	
1	34	Rentals - Frac Stack		2	34	Rentals - Frac Stack	84,307	3	34	Rentals - Frac Stack	0
1	35	Rentals - Frac Tanks	5,652	2	35	Rentals - Frac Tanks	29,562	3	35	Rentals - Frac Tanks	900
1	36	Coil Tubing Unit/Workover Rig		2	36	Coil Tubing Unit/Workover Rig	132,744	3	36	Coil Tubing Unit/Workover Rig	26,500
1	37	Wireline/Slickline/Perforating		2	37	Wireline/Slickline/Perforating	261,608	3	37	Wireline/Slickline/Perforating	12,000
1	38	Temporary Packers/Plugs		2	38	Temporary Packers/Plugs	48,045	3	38	Temporary Packers/Plugs	
1	39	High Pressure Pump Truck		2	39	High Pressure Pump Truck	53,795	3	39	High Pressure Pump Truck	
1	40	Stimulation		2	40	Stimulation	1,760,226	3	40	Stimulation	
1	41	Rentals - Pressure Control		2	41	Rentals - Pressure Control		3	41	Rentals - Pressure Control	
1	42	Flowback Services		2	42	Flowback Services	54,103	3	42	Flowback Services	67,167
1	43	Water Transfer Services		2	43	Water Transfer Services	55,650	3	43	Water Transfer Services	
1	44	Flowback Water Trucking & Disposal		2	44	Flowback Water Trucking & Disposal	9,446	3	44	Flowback Water Trucking & Disposal	65,000
1	45	Permanent Equipment Installation		2	45	Permanent Equipment Installation		3	45	Permanent Equipment Installation	
1	46	Pipeline Tapping Services		2	46	Pipeline Tapping Services		3	46	Pipeline Tapping Services	
1	47	Plugging & Abandonment	0	2	47	Plugging & Abandonment		3	47	Plugging & Abandonment	
1	53	Overhead	0	2	53	Overhead	13,715	3	53	Overhead	0
1	54	Insurance	20,000	2	54	Insurance		3	54	Insurance	
1	55	Contingency	382,677	2	55	Contingency	441,301	3	55	Contingency	46,930
TOTAL INTANGIBLE DRILLING COSTS:			\$2,296,060	TOTAL INTANGIBLE COMPLETION COSTS:			\$4,263,416	TOTAL INTANGIBLE PRODUCTION COSTS:			\$293,580

TANGIBLE DRILLING COSTS				TANGIBLE COMPLETION COSTS				TANGIBLE PRODUCTION COSTS			
COST CODES		DESCRIPTION	AMOUNT	COST CODES		DESCRIPTION	AMOUNT	COST CODES		DESCRIPTION	AMOUNT
4	60	Conductor Casing	30,000	5	60	Conductor Casing		6	60	Conductor Casing	
4	61	Surface Casing	15,652	5	61	Surface Casing		6	61	Surface Casing	
4	62	1st Intermediate Casing	46,620	5	62	1st Intermediate Casing		6	62	1st Intermediate Casing	
4	63	2nd Intermediate Casing	0	5	63	2nd Intermediate Casing		6	63	2nd Intermediate Casing	
4	64	Production Casing	454,128	5	64	Production Casing	0	6	64	Production Casing	
4	65	Tubing		5	65	Tubing		6	65	Tubing	51,783
4	66	Wellhead	78,000	5	66	Wellhead	0	6	66	Wellhead	29,610
4	67	Permanent Packers/Hangers/Plugs		5	67	Permanent Packers/Hangers/Plugs		6	67	Permanent Packers/Hangers/Plugs	0
4	68	Tanks		5	68	Tanks		6	68	Tanks	
4	69	Production Vessels		5	69	Production Vessels		6	69	Production Vessels	311,225
4	70	Compressors		5	70	Compressors		6	70	Compressors	
4	71	Surface Flowlines		5	71	Surface Flowlines		6	71	Surface Flowlines	358,700
4	72	Gathering Lines		5	72	Gathering Lines		6	72	Gathering Lines	0
4	73	Valves & Controllers		5	73	Valves & Controllers		6	73	Valves & Controllers	0
4	74	Artificial Lift Equipment		5	74	Artificial Lift Equipment		6	74	Artificial Lift Equipment	79,000
4	75	Instrumentation & Measurement		5	75	Instrumentation & Measurement		6	75	Instrumentation & Measurement	
4	76	Electrical Grounding/Safety Equipment		5	76	Electrical Grounding/Safety Equipment		6	76	Electrical Grounding/Safety Equipment	
4	77	Permanent Equipment Installation		5	77	Permanent Equipment Installation		6	77	Permanent Equipment Installation	6,250
4	80	Other - Surface		5	80	Other - Surface		6	80	Other - Surface	
4	81	Other - Downhole	15,000	5	81	Other - Downhole		6	81	Other - Downhole	
TOTAL TANGIBLE DRILLING COSTS:			\$639,400	TOTAL TANGIBLE COMPLETION COSTS:			\$0	TOTAL TANGIBLE PRODUCTION COSTS:			\$836,568
TOTAL DRILLING COSTS:			\$2,935,460	TOTAL COMPLETION COSTS:			\$4,263,416	TOTAL PRODUCTION COSTS:			\$1,130,148

TOTAL WELL COST: \$8,329,023

TAP ROCK RESOURCES COMPANY APPROVAL:				NON OPERATING PARTNER APPROVAL:			
CEO _____ VP - EXPLORATION _____				COMPANY NAME: _____			
CFO _____ VP - OPERATIONS _____				SIGNED BY: _____ TITLE: _____			
VP - LAND & LEGAL _____ SENIOR GEOLOGIST _____				WORKING INTEREST (%): _____ DATE: _____			
				TAX ID: _____ APPROVAL: _____			

AFE is an estimate only. By signing this AFE, you agree to pay your proportionate share of the actual costs.

TAP ROCK OPERATING, LLC
1700 Lincoln St Ste 4700 Denver CO 80203
Authorization For Expenditure

Name:	Beer 30 Fed Com #211H	Date:	January 28, 2025
AFE #:	0	MD/TVD:	18650 / 8450
County:	Eddy	Lateral Length:	9750
State:	NM	Geologic Target:	Wolfcamp A

Well Description: Drill, complete, and produce a horizontal Wolfcamp A well with a 9750 foot lateral.

INTANGIBLE DRILLING COSTS				INTANGIBLE COMPLETION COSTS				INTANGIBLE PRODUCTION COSTS			
COST CODES		DESCRIPTION	AMOUNT	COST CODES		DESCRIPTION	AMOUNT	COST CODES		DESCRIPTION	AMOUNT
1	1	Land - Legal	40,000	2	1	Land - Legal		3	1	Land - Legal	
1	2	Land - Regulatory	14,000	2	2	Land - Regulatory		3	2	Land - Regulatory	
1	3	Land - Surface Damages	50,000	2	3	Land - Surface Damages		3	3	Land - Surface Damages	
1	4	Land - Survey	10,000	2	4	Land - Survey		3	4	Land - Survey	
1	5	Location/Pit Construction	59,000	2	5	Location/Pit Construction		3	5	Location/Pit Construction	5,000
1	6	Remedial Dirtwork	0	2	6	Remedial Dirtwork		3	6	Remedial Dirtwork	
1	7	Reserve/Frac Pit Closing	0	2	7	Reserve/Frac Pit Closing		3	7	Reserve/Frac Pit Closing	
1	8	Drilling - Contractor	534,378	2	8	Drilling - Contractor		3	8	Drilling - Contractor	
1	9	Mob/Rig Up - Contractor/Trucking	50,000	2	9	Mob/Rig Up - Contractor/Trucking		3	9	Mob/Rig Up - Contractor/Trucking	
1	10	Cementing Services	141,000	2	10	Cementing Services		3	10	Cementing Services	
1	11	Cementing Equipment	30,000	2	11	Cementing Equipment		3	11	Cementing Equipment	
1	12	Bits/Drill Out Assemblies	63,500	2	12	Bits/Drill Out Assemblies	65,261	3	12	Bits/Drill Out Assemblies	
1	13	Fluid Circulation Equipment/Services	60,196	2	13	Fluid Circulation Equipment/Services		3	13	Fluid Circulation Equipment/Services	
1	14	Fluids/Chemicals	102,577	2	14	Fluids/Chemicals	43,482	3	14	Fluids/Chemicals	
1	15	WBM Cuttings/Wastewater Disposal	74,600	2	15	WBM Cuttings/Wastewater Disposal		3	15	WBM Cuttings/Wastewater Disposal	
1	16	OBM Cuttings/Chemical Disposal	0	2	16	OBM Cuttings/Chemical Disposal		3	16	OBM Cuttings/Chemical Disposal	
1	17	Fuel/Power	56,520	2	17	Fuel/Power	479,385	3	17	Fuel/Power	
1	18	Water	35,768	2	18	Water	602,610	3	18	Water	
1	19	Directional Drilling	188,401	2	19	Directional Drilling		3	19	Directional Drilling	
1	20	Mud Logging	23,113	2	20	Mud Logging		3	20	Mud Logging	
1	21	Open/Cased/Production Hole Logs	0	2	21	Open/Cased/Production Hole Logs	8,692	3	21	Open/Cased/Production Hole Logs	
1	22	Coring	0	2	22	Coring		3	22	Coring	
1	23	Geologic Supervision	0	2	23	Geologic Supervision		3	23	Geologic Supervision	
1	24	Engineering Supervision	0	2	24	Engineering Supervision		3	24	Engineering Supervision	
1	25	Consultant Supervision	96,096	2	25	Consultant Supervision	80,560	3	25	Consultant Supervision	23,500
1	26	Freight/Transportation	9,000	2	26	Freight/Transportation	2,000	3	26	Freight/Transportation	10,000
1	27	Labor	98,500	2	27	Labor	2,532	3	27	Labor	12,917
1	28	Supplies - Surface	2,500	2	28	Supplies - Surface	2,000	3	28	Supplies - Surface	
1	29	Supplies - Living Quarters	1,000	2	29	Supplies - Living Quarters	2,000	3	29	Supplies - Living Quarters	
1	30	Rentals - Surface	53,103	2	30	Rentals - Surface	14,763	3	30	Rentals - Surface	23,667
1	31	Rentals - Living Quarters	34,076	2	31	Rentals - Living Quarters	15,630	3	31	Rentals - Living Quarters	
1	32	Rentals - Downhole	2,000	2	32	Rentals - Downhole	0	3	32	Rentals - Downhole	
1	33	Rentals - Pipe & Handling Tools	58,404	2	33	Rentals - Pipe & Handling Tools	0	3	33	Rentals - Pipe & Handling Tools	
1	34	Rentals - Frac Stack		2	34	Rentals - Frac Stack	84,307	3	34	Rentals - Frac Stack	0
1	35	Rentals - Frac Tanks	5,652	2	35	Rentals - Frac Tanks	29,562	3	35	Rentals - Frac Tanks	900
1	36	Coil Tubing Unit/Workover Rig		2	36	Coil Tubing Unit/Workover Rig	132,744	3	36	Coil Tubing Unit/Workover Rig	26,500
1	37	Wireline/Slickline/Perforating		2	37	Wireline/Slickline/Perforating	261,608	3	37	Wireline/Slickline/Perforating	12,000
1	38	Temporary Packers/Plugs		2	38	Temporary Packers/Plugs	48,045	3	38	Temporary Packers/Plugs	
1	39	High Pressure Pump Truck		2	39	High Pressure Pump Truck	53,795	3	39	High Pressure Pump Truck	
1	40	Stimulation		2	40	Stimulation	1,760,226	3	40	Stimulation	
1	41	Rentals - Pressure Control		2	41	Rentals - Pressure Control		3	41	Rentals - Pressure Control	
1	42	Flowback Services		2	42	Flowback Services	54,103	3	42	Flowback Services	67,167
1	43	Water Transfer Services		2	43	Water Transfer Services	55,650	3	43	Water Transfer Services	
1	44	Flowback Water Trucking & Disposal		2	44	Flowback Water Trucking & Disposal	9,446	3	44	Flowback Water Trucking & Disposal	65,000
1	45	Permanent Equipment Installation		2	45	Permanent Equipment Installation		3	45	Permanent Equipment Installation	
1	46	Pipeline Tapping Services		2	46	Pipeline Tapping Services		3	46	Pipeline Tapping Services	
1	47	Plugging & Abandonment	0	2	47	Plugging & Abandonment		3	47	Plugging & Abandonment	
1	53	Overhead	0	2	53	Overhead	13,715	3	53	Overhead	0
1	54	Insurance	20,000	2	54	Insurance		3	54	Insurance	
1	55	Contingency	382,677	2	55	Contingency	441,301	3	55	Contingency	46,930
TOTAL INTANGIBLE DRILLING COSTS:			\$2,296,060	TOTAL INTANGIBLE COMPLETION COSTS:			\$4,263,416	TOTAL INTANGIBLE PRODUCTION COSTS:			\$293,580

TANGIBLE DRILLING COSTS				TANGIBLE COMPLETION COSTS				TANGIBLE PRODUCTION COSTS			
COST CODES		DESCRIPTION	AMOUNT	COST CODES		DESCRIPTION	AMOUNT	COST CODES		DESCRIPTION	AMOUNT
4	60	Conductor Casing	30,000	5	60	Conductor Casing		6	60	Conductor Casing	
4	61	Surface Casing	15,652	5	61	Surface Casing		6	61	Surface Casing	
4	62	1st Intermediate Casing	46,620	5	62	1st Intermediate Casing		6	62	1st Intermediate Casing	
4	63	2nd Intermediate Casing	0	5	63	2nd Intermediate Casing		6	63	2nd Intermediate Casing	
4	64	Production Casing	454,128	5	64	Production Casing	0	6	64	Production Casing	
4	65	Tubing		5	65	Tubing		6	65	Tubing	51,783
4	66	Wellhead	78,000	5	66	Wellhead	0	6	66	Wellhead	29,610
4	67	Permanent Packers/Hangers/Plugs		5	67	Permanent Packers/Hangers/Plugs		6	67	Permanent Packers/Hangers/Plugs	0
4	68	Tanks		5	68	Tanks		6	68	Tanks	
4	69	Production Vessels		5	69	Production Vessels		6	69	Production Vessels	311,225
4	70	Compressors		5	70	Compressors		6	70	Compressors	
4	71	Surface Flowlines		5	71	Surface Flowlines		6	71	Surface Flowlines	358,700
4	72	Gathering Lines		5	72	Gathering Lines		6	72	Gathering Lines	0
4	73	Valves & Controllers		5	73	Valves & Controllers		6	73	Valves & Controllers	0
4	74	Artificial Lift Equipment		5	74	Artificial Lift Equipment		6	74	Artificial Lift Equipment	79,000
4	75	Instrumentation & Measurement		5	75	Instrumentation & Measurement		6	75	Instrumentation & Measurement	
4	76	Electrical Grounding/Safety Equipment		5	76	Electrical Grounding/Safety Equipment		6	76	Electrical Grounding/Safety Equipment	
4	77	Permanent Equipment Installation		5	77	Permanent Equipment Installation		6	77	Permanent Equipment Installation	6,250
4	80	Other - Surface		5	80	Other - Surface		6	80	Other - Surface	
4	81	Other - Downhole	15,000	5	81	Other - Downhole		6	81	Other - Downhole	
TOTAL TANGIBLE DRILLING COSTS:			\$639,400	TOTAL TANGIBLE COMPLETION COSTS:			\$0	TOTAL TANGIBLE PRODUCTION COSTS:			\$836,568
TOTAL DRILLING COSTS:			\$2,935,460	TOTAL COMPLETION COSTS:			\$4,263,416	TOTAL PRODUCTION COSTS:			\$1,130,148

TOTAL WELL COST: \$8,329,023

TAP ROCK RESOURCES COMPANY APPROVAL:				NON OPERATING PARTNER APPROVAL:			
CEO _____ VP - EXPLORATION _____				COMPANY NAME: _____			
CFO _____ VP - OPERATIONS _____				SIGNED BY: _____ TITLE: _____			
VP - LAND & LEGAL _____ SENIOR GEOLOGIST _____				WORKING INTEREST (%): _____ DATE: _____			
				TAX ID: _____ APPROVAL: _____			

AFE is an estimate only. By signing this AFE, you agree to pay your proportionate share of the actual costs.

TAP ROCK OPERATING, LLC
1700 Lincoln St Ste 4700 Denver CO 80203
Authorization For Expenditure

Name:	Beer 30 Fed Com #213H	Date:	January 28, 2025
AFE #:	0	MD/TVD:	18650 / 8450
County:	Eddy	Lateral Length:	9750
State:	NM	Geologic Target:	Wolfcamp A

Well Description: Drill, complete, and produce a horizontal Wolfcamp A well with a 9750 foot lateral.

INTANGIBLE DRILLING COSTS				INTANGIBLE COMPLETION COSTS				INTANGIBLE PRODUCTION COSTS			
COST CODES		DESCRIPTION	AMOUNT	COST CODES		DESCRIPTION	AMOUNT	COST CODES		DESCRIPTION	AMOUNT
1	1	Land - Legal	40,000	2	1	Land - Legal		3	1	Land - Legal	
1	2	Land - Regulatory	14,000	2	2	Land - Regulatory		3	2	Land - Regulatory	
1	3	Land - Surface Damages	50,000	2	3	Land - Surface Damages		3	3	Land - Surface Damages	
1	4	Land - Survey	10,000	2	4	Land - Survey		3	4	Land - Survey	
1	5	Location/Pit Construction	59,000	2	5	Location/Pit Construction		3	5	Location/Pit Construction	5,000
1	6	Remedial Dirtwork	0	2	6	Remedial Dirtwork		3	6	Remedial Dirtwork	
1	7	Reserve/Frac Pit Closing	0	2	7	Reserve/Frac Pit Closing		3	7	Reserve/Frac Pit Closing	
1	8	Drilling - Contractor	534,378	2	8	Drilling - Contractor		3	8	Drilling - Contractor	
1	9	Mob/Rig Up - Contractor/Trucking	50,000	2	9	Mob/Rig Up - Contractor/Trucking		3	9	Mob/Rig Up - Contractor/Trucking	
1	10	Cementing Services	141,000	2	10	Cementing Services		3	10	Cementing Services	
1	11	Cementing Equipment	30,000	2	11	Cementing Equipment		3	11	Cementing Equipment	
1	12	Bits/Drill Out Assemblies	63,500	2	12	Bits/Drill Out Assemblies	65,261	3	12	Bits/Drill Out Assemblies	
1	13	Fluid Circulation Equipment/Services	60,196	2	13	Fluid Circulation Equipment/Services		3	13	Fluid Circulation Equipment/Services	
1	14	Fluids/Chemicals	102,577	2	14	Fluids/Chemicals	43,482	3	14	Fluids/Chemicals	
1	15	WBM Cuttings/Wastewater Disposal	74,600	2	15	WBM Cuttings/Wastewater Disposal		3	15	WBM Cuttings/Wastewater Disposal	
1	16	OBM Cuttings/Chemical Disposal	0	2	16	OBM Cuttings/Chemical Disposal		3	16	OBM Cuttings/Chemical Disposal	
1	17	Fuel/Power	56,520	2	17	Fuel/Power	479,385	3	17	Fuel/Power	
1	18	Water	35,768	2	18	Water	602,610	3	18	Water	
1	19	Directional Drilling	188,401	2	19	Directional Drilling		3	19	Directional Drilling	
1	20	Mud Logging	23,113	2	20	Mud Logging		3	20	Mud Logging	
1	21	Open/Cased/Production Hole Logs	0	2	21	Open/Cased/Production Hole Logs	8,692	3	21	Open/Cased/Production Hole Logs	
1	22	Coring	0	2	22	Coring		3	22	Coring	
1	23	Geologic Supervision	0	2	23	Geologic Supervision		3	23	Geologic Supervision	
1	24	Engineering Supervision	0	2	24	Engineering Supervision		3	24	Engineering Supervision	
1	25	Consultant Supervision	96,096	2	25	Consultant Supervision	80,560	3	25	Consultant Supervision	23,500
1	26	Freight/Transportation	9,000	2	26	Freight/Transportation	2,000	3	26	Freight/Transportation	10,000
1	27	Labor	98,500	2	27	Labor	2,532	3	27	Labor	12,917
1	28	Supplies - Surface	2,500	2	28	Supplies - Surface	2,000	3	28	Supplies - Surface	
1	29	Supplies - Living Quarters	1,000	2	29	Supplies - Living Quarters	2,000	3	29	Supplies - Living Quarters	
1	30	Rentals - Surface	53,103	2	30	Rentals - Surface	14,763	3	30	Rentals - Surface	23,667
1	31	Rentals - Living Quarters	34,076	2	31	Rentals - Living Quarters	15,630	3	31	Rentals - Living Quarters	
1	32	Rentals - Downhole	2,000	2	32	Rentals - Downhole	0	3	32	Rentals - Downhole	
1	33	Rentals - Pipe & Handling Tools	58,404	2	33	Rentals - Pipe & Handling Tools	0	3	33	Rentals - Pipe & Handling Tools	
1	34	Rentals - Frac Stack		2	34	Rentals - Frac Stack	84,307	3	34	Rentals - Frac Stack	0
1	35	Rentals - Frac Tanks	5,652	2	35	Rentals - Frac Tanks	29,562	3	35	Rentals - Frac Tanks	900
1	36	Coil Tubing Unit/Workover Rig		2	36	Coil Tubing Unit/Workover Rig	132,744	3	36	Coil Tubing Unit/Workover Rig	26,500
1	37	Wireline/Slickline/Perforating		2	37	Wireline/Slickline/Perforating	261,608	3	37	Wireline/Slickline/Perforating	12,000
1	38	Temporary Packers/Plugs		2	38	Temporary Packers/Plugs	48,045	3	38	Temporary Packers/Plugs	
1	39	High Pressure Pump Truck		2	39	High Pressure Pump Truck	53,795	3	39	High Pressure Pump Truck	
1	40	Stimulation		2	40	Stimulation	1,760,226	3	40	Stimulation	
1	41	Rentals - Pressure Control		2	41	Rentals - Pressure Control		3	41	Rentals - Pressure Control	
1	42	Flowback Services		2	42	Flowback Services	54,103	3	42	Flowback Services	67,167
1	43	Water Transfer Services		2	43	Water Transfer Services	55,650	3	43	Water Transfer Services	
1	44	Flowback Water Trucking & Disposal		2	44	Flowback Water Trucking & Disposal	9,446	3	44	Flowback Water Trucking & Disposal	65,000
1	45	Permanent Equipment Installation		2	45	Permanent Equipment Installation		3	45	Permanent Equipment Installation	
1	46	Pipeline Tapping Services		2	46	Pipeline Tapping Services		3	46	Pipeline Tapping Services	
1	47	Plugging & Abandonment	0	2	47	Plugging & Abandonment		3	47	Plugging & Abandonment	
1	53	Overhead	0	2	53	Overhead	13,715	3	53	Overhead	0
1	54	Insurance	20,000	2	54	Insurance		3	54	Insurance	
1	55	Contingency	382,677	2	55	Contingency	441,301	3	55	Contingency	46,930
TOTAL INTANGIBLE DRILLING COSTS:			\$2,296,060	TOTAL INTANGIBLE COMPLETION COSTS:			\$4,263,416	TOTAL INTANGIBLE PRODUCTION COSTS:			\$293,580

TANGIBLE DRILLING COSTS				TANGIBLE COMPLETION COSTS				TANGIBLE PRODUCTION COSTS			
COST CODES		DESCRIPTION	AMOUNT	COST CODES		DESCRIPTION	AMOUNT	COST CODES		DESCRIPTION	AMOUNT
4	60	Conductor Casing	30,000	5	60	Conductor Casing		6	60	Conductor Casing	
4	61	Surface Casing	15,652	5	61	Surface Casing		6	61	Surface Casing	
4	62	1st Intermediate Casing	46,620	5	62	1st Intermediate Casing		6	62	1st Intermediate Casing	
4	63	2nd Intermediate Casing	0	5	63	2nd Intermediate Casing		6	63	2nd Intermediate Casing	
4	64	Production Casing	454,128	5	64	Production Casing	0	6	64	Production Casing	
4	65	Tubing		5	65	Tubing		6	65	Tubing	51,783
4	66	Wellhead	78,000	5	66	Wellhead	0	6	66	Wellhead	29,610
4	67	Permanent Packers/Hangers/Plugs		5	67	Permanent Packers/Hangers/Plugs		6	67	Permanent Packers/Hangers/Plugs	0
4	68	Tanks		5	68	Tanks		6	68	Tanks	
4	69	Production Vessels		5	69	Production Vessels		6	69	Production Vessels	311,225
4	70	Compressors		5	70	Compressors		6	70	Compressors	
4	71	Surface Flowlines		5	71	Surface Flowlines		6	71	Surface Flowlines	358,700
4	72	Gathering Lines		5	72	Gathering Lines		6	72	Gathering Lines	0
4	73	Valves & Controllers		5	73	Valves & Controllers		6	73	Valves & Controllers	0
4	74	Artificial Lift Equipment		5	74	Artificial Lift Equipment		6	74	Artificial Lift Equipment	79,000
4	75	Instrumentation & Measurement		5	75	Instrumentation & Measurement		6	75	Instrumentation & Measurement	
4	76	Electrical Grounding/Safety Equipment		5	76	Electrical Grounding/Safety Equipment		6	76	Electrical Grounding/Safety Equipment	
4	77	Permanent Equipment Installation		5	77	Permanent Equipment Installation		6	77	Permanent Equipment Installation	6,250
4	80	Other - Surface		5	80	Other - Surface		6	80	Other - Surface	
4	81	Other - Downhole	15,000	5	81	Other - Downhole		6	81	Other - Downhole	
TOTAL TANGIBLE DRILLING COSTS:			\$639,400	TOTAL TANGIBLE COMPLETION COSTS:			\$0	TOTAL TANGIBLE PRODUCTION COSTS:			\$836,568
TOTAL DRILLING COSTS:			\$2,935,460	TOTAL COMPLETION COSTS:			\$4,263,416	TOTAL PRODUCTION COSTS:			\$1,130,148

TOTAL WELL COST: \$8,329,023

TAP ROCK RESOURCES COMPANY APPROVAL:				NON OPERATING PARTNER APPROVAL:			
CEO _____ VP - EXPLORATION _____				COMPANY NAME: _____			
CFO _____ VP - OPERATIONS _____				SIGNED BY: _____ TITLE: _____			
VP - LAND & LEGAL _____ SENIOR GEOLOGIST _____				WORKING INTEREST (%): _____ DATE: _____			
				TAX ID: _____ APPROVAL: _____			

AFE is an estimate only. By signing this AFE, you agree to pay your proportionate share of the actual costs.

Chronology of Contact

Party	Address	Proposal, AFE, and JOA Certified Mail Sent Date	Tracking Information	Proposal, AFE, and JOA Certified Mail Received Date	Correspondence
State of New Mexico, ex rel., New Mexico Department of Transportation	PO Box 1149 Santa Fe, NM 87504	8/26/2025	USPS - '9589071052703172141790	8/29/2025	8/26/2025 - Mailed well proposals, AFEs, and proposed Operating Agreement 8/27/2025 - Tap Rock title brokers reach out to Ricky Mot, chief of NMDOT to discuss mineral ownership of this parcel. Follow up 2X trying to explain their ownership (and requesting confirmation from their end). No meaningful response. 9/29/2025 - Tap Rock Emailed NMDOT contacts (4 Emails we could find online and from peers). Summarized their acreage position, gave development timing, offered to lease and explained pooling process as alternative. 10/1/2025 - NMDOT responds stating they have no interest in leasing or otherwise participating in the drilling of these wells (or any wells, for that matter).
State of New Mexico, ex rel., New Mexico Department of Transportation	1120 Cerillos Road Santa Fe, NM 87505	8/26/2025	FedEx - '883875175374	8/27/2025	""

**STATE OF NEW MEXICO
ENERGY, MINERALS, AND NATURAL RESOURCES DEPARTMENT
OIL CONSERVATION DIVISION**

**APPLICATION OF TAP ROCK OPERATING,
LLC FOR APPROVAL TO COMPULSORY
POOL ADDITIONAL INTEREST OWNERS
UNDER ORDER R-23945, EDDY COUNTY,
NEW MEXICO**

CASE NO. 25710

AFFIDAVIT

STATE OF COLORADO)
) ss.
CITY AND COUNTY OF DENVER)

Rachael Ketchledge, legal assistant and authorized representative of Tap Rock Operating, LLC ("Tap Rock"), the Applicant herein, being first duly sworn, upon oath, states that the above-referenced Application has been provided under Notice Letters dated October 9, 2025, which the Applicant mailed via U.S. Postal Service Certified Mail. Notice was delivered to the interested parties on or about October 22, 2025, as shown on certified mail receipts attached as Exhibit D-3.

Applicant also published notice of the Application in the Carlsbad Current-Argus on October 30, 2025. Proof of receipts is shown on Exhibit D-4.



Rachael Ketchledge

SUBSCRIBED AND SWORN to before me on October 30, 2025, by Rachael Ketchledge.

My commission expires:

SHANA JO PREISLER
NOTARY PUBLIC
STATE OF COLORADO
NOTARY ID 19924009418
MY COMMISSION EXPIRES MARCH 5, 2027



NOTARY PUBLIC

BEATTY & WOZNIAK, P.C.

ATTORNEYS AT LAW
500 DON GASPAR AVENUE
SANTA FE, NEW MEXICO 87505
TELEPHONE 505-983-8545
FACSIMILE 800-886-6566
www.bwenergylaw.com

COLORADO
NEW MEXICO
WYOMING

MIGUEL SUAZO

505-946-2090
MSUAZO@BWENERGYLAW.COM

October 22, 2025

VIA CERTIFIED MAIL
RETURN RECEIPT REQUESTED

TO: ALL INTEREST OWNERS SUBJECT TO SPACING AND POOLING PROCEEDINGS

Re: Application of Tap Rock Operating, LLC for Approval to Compulsory Pool
Additional Interest Owners Under Order R-23945, Eddy County, New Mexico
(Case No. 25710).

Dear Interest Owners:

This letter is to advise you that Tap Rock Operating, LLC ("Tap Rock") has filed the enclosed application, Case No. 25710, with the New Mexico Oil Conservation Division for Approval to Compulsory Pool Additional Interest Owners Under Order R-23945, Eddy County, New Mexico.

In Case No. 25710, Tap Rock seeks an Order from the Division to allow the compulsory pooling of additional uncommitted mineral interest owners under Order No. R-23945, issued in case number 25317. The Unit is a 1,283.04-acre standard horizontal well spacing unit comprised of all of Sections 3 and 4, Township 25 South, Range 25 East, N.M.P.M., Eddy County, New Mexico.

A hearing has been requested before a Division Examiner on November 13, 2025, and the status of the hearing can be monitored through the Division's website. Division hearings will commence at 9:00 a.m. Mountain Standard Time, and will be conducted in a hybrid fashion, both in-person at the Energy, Minerals, Natural Resources Department, Wendell Chino Building, Pecos Hall, 1220 South St. Francis Drive, 1st Floor, Santa Fe, NM 87505 and via the Microsoft Teams virtual meeting platform. To view the hearing docket and to determine how to participate in the electronic hearing, visit the Division's website at: <https://www.emnrd.nm.gov/oed/hearing-info/> or call (505) 476-3441.

You are being notified as an interest owner and are not required to attend this hearing, but as an owner of an interest that may be affected by this application, you may appear and present testimony. Failure to appear at that time and become a party of record will preclude you from contesting the matter at a later date.

Parties appearing in cases who intend to present evidence are required by Division Rule 19.15.4.13.B NMAC to file a Prehearing Statement at least four business days in advance of a scheduled hearing, but in no event later than 5 p.m. mountain time on the Thursday

BEATTY & WOZNIAK, P.C.

October 22, 2025
Case No. 25710
Page 2

preceding the scheduled hearing date. This statement must be submitted through the OCD E-Permitting system (<https://wwwapps.emnrd.nm.gov/ocd/ocdpermitting/>) or via e-mail to ocd.hearings@emnrd.nm.gov should include: the names of the parties and their attorneys; a concise statement of the case; the names of all witnesses the party will call to testify at the hearing; the approximate time the party will need to present its case; and identification of any procedural matters that are to be resolved prior to the hearing. The statement must also be provided to the attorney for the applicant, Miguel Suazo at msuazo@bwenergylaw.com.

If you have any questions about this matter, please contact Erica Shewmaker at eshewmaker@taprk.com.

Sincerely,

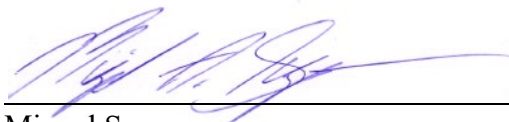

Miguel Suazo

Attorney for Tap Rock Operating, LLC

Case No. 25710 Certified Mailing Status

MAIL DATE	OWNER	ADDRESS	TYPE_INT	MAIL CLASS	TRACKING NUMBER
October 22, 2025	Balog Family Trust dated 8/15/2002	25812 South Dartford Drive Sun Lakes, Arizona 85248	WI	Certified w/ Return Receipt (Signature)	9589 0710 5270 2981 1355 18
October 22, 2025	Berdan Living Trust UTA dated November 2 2018	3639 Encanto Dr. Fort Worth, TX 76109	Unleased	Certified w/ Return Receipt (Signature)	9589 0710 5270 2981 1355 25
October 22, 2025	Big Three Energy Group LLC	P.O. Box 429 Roswell, NM 88202	WI	Certified w/ Return Receipt (Signature)	9589 0710 5270 0916 2418 39
October 22, 2025	Denise Price	415 Del Rio # 56 Carlsbad, NM 88220	Unleased	Certified w/ Return Receipt (Signature)	9589 0710 5270 0916 2418 46
October 22, 2025	EOG Resources Inc	5509 Champions Dr. Midland, TX 79702	WI	Certified w/ Return Receipt (Signature)	9589 0710 5270 2981 1353 58
October 22, 2025	Estate of Betty Cole Drake	415 N. McKinley St. Ste. 270C Little Rock AR 72205	Unleased	Certified w/ Return Receipt (Signature)	9589 0710 5270 2981 1353 65
October 22, 2025	Estate of Frances Jane Owen	5341 N 68th Pl Scottsdale, AZ 85253	Unleased	Certified w/ Return Receipt (Signature)	9589 0710 5270 2981 1353 72
October 22, 2025	Estate of Robert E Humphus	304 Soper Rd Carlsbad, NM 88220	Unleased	Certified w/ Return Receipt (Signature)	9589 0710 5270 2981 1353 89
October 22, 2025	Fandango, LLC	P.O. Box 2606 Amarillo, TX 79105	WI	Certified w/ Return Receipt (Signature)	9589 0710 5270 2981 1353 96
October 22, 2025	Feathersone Development Corporation	P.O. Box 429 Roswell, NM 88202	WI	Certified w/ Return Receipt (Signature)	9589 0710 5270 2981 1354 02
October 22, 2025	JKM Energy LLC	26 E. Compass Road Artesia, NM 88210	WI	Certified w/ Return Receipt (Signature)	9589 0710 5270 2981 1354 19
October 22, 2025	Karen Dianne Farrell	914 Fountain Dr. Carlsbad, NM 88220	Unleased	Certified w/ Return Receipt (Signature)	9589 0710 5270 2981 1354 26
October 22, 2025	Magnum Hunter Production Company Inc	6001 N. Deauville Blvd., Ste. 300N Midland, TX 79706	WI	Certified w/ Return Receipt (Signature)	9589 0710 5270 0916 2417 30
October 22, 2025	OXY Y-1 Company	5 Greenway Plaza, Ste 110 Houston, Texas 77045	WI	Certified w/ Return Receipt (Signature)	9589 0710 5270 0916 2417 47
October 22, 2025	Parrot Head Properties LLC	P.O. Box 429 Roswell, NM 88202	WI	Certified w/ Return Receipt (Signature)	9589 0710 5270 0916 2417 54
October 22, 2025	Powderhorn Asset Co, LLC	600 N Marienfield St. Suite 1000 Midland, TX 79705	WI	Certified w/ Return Receipt (Signature)	9589 0710 5270 0916 2417 61
October 22, 2025	Powderhorn Nominee Corp	600 N Marienfield St. Suite 1000 Midland, TX 79705	WI	Certified w/ Return Receipt (Signature)	9589 0710 5270 0916 2417 78
October 22, 2025	Prospector LLC	P.O. Box 429 Roswell, NM 88202	WI	Certified w/ Return Receipt (Signature)	9589 0710 5270 0916 2417 85
October 22, 2025	Sydhon LP	P.O. Box 92349 Austin, TX 78709	WI	Certified w/ Return Receipt (Signature)	9589 0710 5270 0916 2417 92
October 22, 2025	Vision Energy Inc	PO BOX 2459 Carlsbad, NM 88221	WI	Certified w/ Return Receipt (Signature)	9589 0710 5270 0916 2418 08
October 22, 2025	COG Operating LLC	One Concho Center 600 West Illinois Avenue Midland, TX 79701	WI	Certified w/ Return Receipt (Signature)	9589 0710 5270 0916 2418 22
October 22, 2025	Concho Oil & Gas LLC	600 W. Illinois Avenue Midland, TX 79701	WI	Certified w/ Return Receipt (Signature)	9589 0710 5270 1506 7189 08
October 22, 2025	Bureau of Land Management Carlsbad Field Office	620 East Green Street Carlsbad, NM 88220-6292	MINERAL OWNER/ROYALTY	Certified w/ Return Receipt (Signature)	9589 0710 5270 0916 2418 15

October 22, 2025	New Mexico Department of Transportation	1120 Cerillos Road Santa Fe, NM 87505	Unleased	Certified w/ Return Receipt (Signature)	9589 0710 5270 1506 7188 85
October 22, 2025	New Mexico Department of Transportation	PO Box 1149 Santa Fe, NM 87504-1149	Unleased	Certified w/ Return Receipt (Signature)	9589 0710 5270 1506 7188 92

SENDER: COMPLETE THIS SECTION

Complete items 1, 2, and 3.

Print your name and address on the reverse so that we can return the card to you.

Attach this card to the back of the mailpiece, or on the front if space permits.

1. Article Addressed to:

1814.2A

New Mexico Department of Transportation
1120 Cerrillos Road
Santa Fe, NM 87505

P.O. Box 1149

9590 9402 8763 3310 3017 26

9589 0710 5270 1506 7188 85

PS Form 3811, July 2020 PSN 7530-02-000-9053

COMPLETE THIS SECTION ON DELIVERY

A. Signature

X *[Signature]*

B. Received by (Printed Name)

C. Date of Delivery

D. Is delivery address different from item 1? ☐ Yes
If YES, enter delivery address below: ☐ No

RECEIVED
NM DEPT OF TRANSPORTATION
OCT 27 2025

3. Service Type

☐ Adult Signature ☐ Priority Mail Express®
☐ Adult Signature Restricted Delivery ☐ Registered Mail™
☐ Certified Mail® ☐ Registered Mail Restricted Delivery
☐ Certified Mail Restricted Delivery ☐ Signature Confirmation™
☐ Collect on Delivery ☐ Signature Confirmation Restricted Delivery
☐ Collect on Delivery Restricted Delivery ☐ Restricted Delivery

Mail Restricted Delivery (over \$500)

SENDER: COMPLETE THIS SECTION

Complete items 1, 2, and 3.

Print your name and address on the reverse so that we can return the card to you.

Attach this card to the back of the mailpiece, or on the front if space permits.

1. Article Addressed to:

1814.2A

New Mexico Department of Transportation
PO Box 1149
Santa Fe, NM 87504-1149

9590 9402 8763 3310 3017 19

9589 0710 5270 1506 7188 92

PS Form 3811, July 2020 PSN 7530-02-000-9053

COMPLETE THIS SECTION ON DELIVERY

A. Signature

X *[Signature]*

B. Received by (Printed Name)

C. Date of Delivery

D. Is delivery address different from item 1? ☐ Yes
If YES, enter delivery address below: ☐ No

RECEIVED
OFFICE OF GENERAL COUNSEL
ROOM 121
OCT 24 2025

3. Service Type

☐ Adult Signature ☐ Priority Mail Express®
☐ Adult Signature Restricted Delivery ☐ Registered Mail™
☐ Certified Mail® ☐ Registered Mail Restricted Delivery
☐ Certified Mail Restricted Delivery ☐ Signature Confirmation™
☐ Collect on Delivery ☐ Signature Confirmation Restricted Delivery
☐ Collect on Delivery Restricted Delivery ☐ Restricted Delivery

Mail Restricted Delivery (over \$500)

SENDER: COMPLETE THIS SECTION

Complete items 1, 2, and 3.

Print your name and address on the reverse so that we can return the card to you.

Attach this card to the back of the mailpiece, or on the front if space permits.

1. Article Addressed to:

1814.2A

Berdan Living Trust UTA dated November 2 2018
3639 Encanto Dr.
Fort Worth, TX 76109

9590 9402 8916 4064 1463 28

9589 0710 5270 2981 1355 25

PS Form 3811, July 2020 PSN 7530-02-000-9053

COMPLETE THIS SECTION ON DELIVERY

A. Signature

X *[Signature]*

B. Received by (Printed Name)

C. Date of Delivery

D. Is delivery address different from item 1? ☐ Yes
If YES, enter delivery address below: ☐ No

3. Service Type

☐ Adult Signature ☐ Priority Mail Express®
☐ Adult Signature Restricted Delivery ☐ Registered Mail™
☐ Certified Mail® ☐ Registered Mail Restricted Delivery
☐ Certified Mail Restricted Delivery ☐ Signature Confirmation™
☐ Collect on Delivery ☐ Signature Confirmation Restricted Delivery
☐ Collect on Delivery Restricted Delivery ☐ Restricted Delivery

Mail Restricted Delivery (over \$500)

SENDER: COMPLETE THIS SECTION

Complete items 1, 2, and 3.

Print your name and address on the reverse so that we can return the card to you.

Attach this card to the back of the mailpiece, or on the front if space permits.

1. Article Addressed to:

1814.2A

Big Three Energy Group LLC
P.O. Box 429
Roswell, NM 88202

9590 9402 8916 4064 1465 02

9589 0710 5270 0916 2418 39

PS Form 3811, July 2020 PSN 7530-02-000-9053

COMPLETE THIS SECTION ON DELIVERY

A. Signature

X *[Signature]*

B. Received by (Printed Name)

C. Date of Delivery

D. Is delivery address different from item 1? ☐ Yes
If YES, enter delivery address below: ☐ No

RECEIVED
USPS
ROSSELL
OCT 27 2025

3. Service Type

☐ Adult Signature ☐ Priority Mail Express®
☐ Adult Signature Restricted Delivery ☐ Registered Mail™
☐ Certified Mail® ☐ Registered Mail Restricted Delivery
☐ Certified Mail Restricted Delivery ☐ Signature Confirmation™
☐ Collect on Delivery ☐ Signature Confirmation Restricted Delivery
☐ Collect on Delivery Restricted Delivery ☐ Restricted Delivery

Mail Restricted Delivery (over \$500)

SENDER: COMPLETE THIS SECTION

Complete items 1, 2, and 3.

Print your name and address on the reverse so that we can return the card to you.

Attach this card to the back of the mailpiece, or on the front if space permits.

1. Article Addressed to:

1814.2A

Magnum Hunter Production Company Inc
6001 N. Deauville Blvd.
Ste. 300N
Midland, TX 79706

9590 9402 8916 4064 1466 18

9589 0710 5270 0916 2417 30

PS Form 3811, July 2020 PSN 7530-02-000-9053

COMPLETE THIS SECTION ON DELIVERY

A. Signature

X *[Signature]*

B. Received by (Printed Name)

C. Date of Delivery

D. Is delivery address different from item 1? ☐ Yes
If YES, enter delivery address below: ☐ No

3. Service Type

☐ Adult Signature ☐ Priority Mail Express®
☐ Adult Signature Restricted Delivery ☐ Registered Mail™
☐ Certified Mail® ☐ Registered Mail Restricted Delivery
☐ Certified Mail Restricted Delivery ☐ Signature Confirmation™
☐ Collect on Delivery ☐ Signature Confirmation Restricted Delivery
☐ Collect on Delivery Restricted Delivery ☐ Restricted Delivery

Mail Restricted Delivery (over \$500)

SENDER: COMPLETE THIS SECTION

Complete items 1, 2, and 3.

Print your name and address on the reverse so that we can return the card to you.

Attach this card to the back of the mailpiece, or on the front if space permits.

1. Article Addressed to:

1814.2A

JKM Energy LLC
26 E. Compass Road
Artesia, NM 88210

9590 9402 8916 4064 1464 34

9589 0710 5270 2981 1354 19

PS Form 3811, July 2020 PSN 7530-02-000-9053

COMPLETE THIS SECTION ON DELIVERY

A. Signature

X *[Signature]*

B. Received by (Printed Name)

C. Date of Delivery

D. Is delivery address different from item 1? ☐ Yes
If YES, enter delivery address below: ☐ No

3. Service Type

☐ Adult Signature ☐ Priority Mail Express®
☐ Adult Signature Restricted Delivery ☐ Registered Mail™
☐ Certified Mail® ☐ Registered Mail Restricted Delivery
☐ Certified Mail Restricted Delivery ☐ Signature Confirmation™
☐ Collect on Delivery ☐ Signature Confirmation Restricted Delivery
☐ Collect on Delivery Restricted Delivery ☐ Restricted Delivery

Mail Restricted Delivery (over \$500)

SENDER: COMPLETE THIS SECTION

■ Complete items 1, 2, and 3.
■ Print your name and address on the reverse so that we can return the card to you.
■ Attach this card to the back of the mailpiece, or on the front if space permits.

1. Article Addressed to:

1814.2A

FeathersonDevelopment Corporation
P.O. Box 429
Roswell, NM 88202

9590 9402 8916 4064 1464 27

9589 0710 5270 2981 1354 02

COMPLETE THIS SECTION ON DELIVERY

A. Signature
☒ Agent
☐ Addressee

B. Received by (Printed Name)
C. Date of Delivery

D. Is delivery address different from item 1? ☐ Yes
If YES, enter delivery address below: ☐ No

3. Service Type
☐ Adult Signature
☐ Adult Signature Restricted Delivery
☐ Certified Mail®
☐ Certified Mail Restricted Delivery
☐ Collect on Delivery
☐ Collect on Delivery Restricted Delivery
☐ Registered Mail™
☐ Registered Mail Restricted Delivery
☐ Signature Confirmation™
☐ Signature Confirmation Restricted Delivery

PS Form 3811, July 2020 PSN 7530-02-000-9053 Domestic Return Receipt

SENDER: COMPLETE THIS SECTION

■ Complete items 1, 2, and 3.
■ Print your name and address on the reverse so that we can return the card to you.
■ Attach this card to the back of the mailpiece, or on the front if space permits.

1. Article Addressed to:

1814.2A

EOG Resources Inc
5509 Champions Dr.
Midland, TX 79702

9590 9402 8916 4064 1464 96

9589 0710 5270 2981 1353 58

COMPLETE THIS SECTION ON DELIVERY

A. Signature
☒ Agent
☐ Addressee

B. Received by (Printed Name)
C. Date of Delivery

D. Is delivery address different from item 1? ☐ Yes
If YES, enter delivery address below: ☐ No

3. Service Type
☐ Adult Signature
☐ Adult Signature Restricted Delivery
☐ Certified Mail®
☐ Certified Mail Restricted Delivery
☐ Collect on Delivery
☐ Collect on Delivery Restricted Delivery
☐ Registered Mail™
☐ Registered Mail Restricted Delivery
☐ Signature Confirmation™
☐ Signature Confirmation Restricted Delivery

PS Form 3811, July 2020 PSN 7530-02-000-9053 Domestic Return Receipt

SENDER: COMPLETE THIS SECTION

■ Complete items 1, 2, and 3.
■ Print your name and address on the reverse so that we can return the card to you.
■ Attach this card to the back of the mailpiece, or on the front if space permits.

1. Article Addressed to:

1814.2A

Prospector LLC
P.O. Box 429
Roswell, NM 88202

9590 9402 8916 4064 1465 64

9589 0710 5270 0916 2417 85

COMPLETE THIS SECTION ON DELIVERY

A. Signature
☒ Agent
☐ Addressee

B. Received by (Printed Name)
C. Date of Delivery

D. Is delivery address different from item 1? ☐ Yes
If YES, enter delivery address below: ☐ No

3. Service Type
☐ Adult Signature
☐ Adult Signature Restricted Delivery
☐ Certified Mail®
☐ Certified Mail Restricted Delivery
☐ Collect on Delivery
☐ Collect on Delivery Restricted Delivery
☐ Priority Mail Express®
☐ Registered Mail™
☐ Registered Mail Restricted Delivery
☐ Signature Confirmation™
☐ Signature Confirmation Restricted Delivery

PS Form 3811, July 2020 PSN 7530-02-000-9053 Domestic Return Receipt

SENDER: COMPLETE THIS SECTION

■ Complete items 1, 2, and 3.
■ Print your name and address on the reverse so that we can return the card to you.
■ Attach this card to the back of the mailpiece, or on the front if space permits.

1. Article Addressed to:

1814.2A

Parrot Head Properties LLC
P.O. Box 429
Roswell, NM 88202

9590 9402 8916 4064 1465 95

9589 0710 5270 0916 2417 54

COMPLETE THIS SECTION ON DELIVERY

A. Signature
☒ Agent
☐ Addressee

B. Received by (Printed Name)
C. Date of Delivery

D. Is delivery address different from item 1? ☐ Yes
If YES, enter delivery address below: ☐ No

3. Service Type
☐ Adult Signature
☐ Adult Signature Restricted Delivery
☐ Certified Mail®
☐ Certified Mail Restricted Delivery
☐ Collect on Delivery
☐ Collect on Delivery Restricted Delivery
☐ Priority Mail Express®
☐ Registered Mail™
☐ Registered Mail Restricted Delivery
☐ Signature Confirmation™
☐ Signature Confirmation Restricted Delivery

PS Form 3811, July 2020 PSN 7530-02-000-9053 Domestic Return Receipt

SENDER: COMPLETE THIS SECTION

■ Complete items 1, 2, and 3.
■ Print your name and address on the reverse so that we can return the card to you.
■ Attach this card to the back of the mailpiece, or on the front if space permits.

1. Article Addressed to:

1814.2A

Fandango, LLC
P.O. Box 2606
Amarillo, TX 79105

9590 9402 8916 4064 1464 58

9589 0710 5270 2981 1353 96

COMPLETE THIS SECTION ON DELIVERY

A. Signature
☒ Agent
☐ Addressee

B. Received by (Printed Name)
C. Date of Delivery

D. Is delivery address different from item 1? ☐ Yes
If YES, enter delivery address below: ☐ No

3. Service Type
☐ Adult Signature
☐ Adult Signature Restricted Delivery
☐ Certified Mail®
☐ Certified Mail Restricted Delivery
☐ Collect on Delivery
☐ Collect on Delivery Restricted Delivery
☐ Priority Mail Express®
☐ Registered Mail™
☐ Registered Mail Restricted Delivery
☐ Signature Confirmation™
☐ Signature Confirmation Restricted Delivery

PS Form 3811, July 2020 PSN 7530-02-000-9053 Domestic Return Receipt

SENDER: COMPLETE THIS SECTION

■ Complete items 1, 2, and 3.
■ Print your name and address on the reverse so that we can return the card to you.
■ Attach this card to the back of the mailpiece, or on the front if space permits.

1. Article Addressed to:

1814.2A

Estate of Frances Jane Owen
5341 N 68th Pl
Scottsdale, AZ 85253

9590 9402 8916 4064 1464 72

9589 0710 5270 2981 1353 72

COMPLETE THIS SECTION ON DELIVERY

A. Signature
☒ Agent
☐ Addressee

B. Received by (Printed Name)
C. Date of Delivery

D. Is delivery address different from item 1? ☐ Yes
If YES, enter delivery address below: ☐ No

3. Service Type
☐ Adult Signature
☐ Adult Signature Restricted Delivery
☐ Certified Mail®
☐ Certified Mail Restricted Delivery
☐ Collect on Delivery
☐ Collect on Delivery Restricted Delivery
☐ Priority Mail Express®
☐ Registered Mail™
☐ Registered Mail Restricted Delivery
☐ Signature Confirmation™
☐ Signature Confirmation Restricted Delivery

PS Form 3811, July 2020 PSN 7530-02-000-9053 Domestic Return Receipt

SENDER: COMPLETE THIS SECTION

Complete items 1, 2, and 3.

Print your name and address on the reverse so that we can return the card to you.

Attach this card to the back of the mailpiece, or on the front if space permits.

1. Article Addressed to:

1814.2A

Vision Energy Inc
PO BOX 2459
Carlsbad, NM 88221

9590 9402 8916 4064 1465 40

9589 0710 5270 0916 2418 08

COMPLETE THIS SECTION ON DELIVERY

A. Signature
X *Amber Dominguez* ☐ Agent ☐ Addressee

B. Received by (Printed Name) C. Date of Delivery
Amber Dominguez

D. Is delivery address different from item 1? ☐ Yes
If YES, enter delivery address below: ☐ No

3. Service Type ☐ Priority Mail Express®
☐ Adult Signature ☐ Registered Mail™
☐ Adult Signature Restricted Delivery ☐ Registered Mail Restricted Delivery
☐ Certified Mail® ☐ Signature Confirmation™
☐ Certified Mail Restricted Delivery ☐ Signature Confirmation Restricted Delivery
☐ Collect on Delivery
☐ Collect on Delivery Restricted Delivery

U.S. POSTAL SERVICE
NOV - 3 2025

SENDER: COMPLETE THIS SECTION

Complete items 1, 2, and 3.

Print your name and address on the reverse so that we can return the card to you.

Attach this card to the back of the mailpiece, or on the front if space permits.

1. Article Addressed to:

1814.2A

Bureau of Land Management
Carlsbad Field Office
620 East Green Street
Carlsbad, NM 88220-6292

9590 9402 8916 4064 1465 33

9589 0710 5270 0916 2418 15

COMPLETE THIS SECTION ON DELIVERY

A. Signature
X *[Signature]* ☐ Agent ☐ Addressee

B. Received by (Printed Name) C. Date of Delivery
[Signature] 11/26/2025

D. Is delivery address different from item 1? ☐ Yes
If YES, enter delivery address below: ☐ No

3. Service Type ☐ Priority Mail Express®
☐ Adult Signature ☐ Registered Mail™
☐ Adult Signature Restricted Delivery ☐ Registered Mail Restricted Delivery
☐ Certified Mail® ☐ Signature Confirmation™
☐ Certified Mail Restricted Delivery ☐ Signature Confirmation Restricted Delivery
☐ Collect on Delivery
☐ Collect on Delivery Restricted Delivery

PS Form 3811, July 2020 PSN 7530-02-000-9053 Domestic Return Receipt

PS Form 3811, July 2020 PSN 7530-02-000-9053 Domestic Return Receipt

SENDER: COMPLETE THIS SECTION

Complete items 1, 2, and 3.

Print your name and address on the reverse so that we can return the card to you.

Attach this card to the back of the mailpiece, or on the front if space permits.

1. Article Addressed to:

1814.2A

Karen Dianne Farrell
914 Fountain Dr.
Carlsbad, NM 88220

9590 9402 8916 4064 1464 41

9589 0710 5270 2981 1354 26

COMPLETE THIS SECTION ON DELIVERY

A. Signature
X *Deborah Janway* ☐ Agent ☐ Addressee

B. Received by (Printed Name) C. Date of Delivery
Deborah Janway

D. Is delivery address different from item 1? ☐ Yes
If YES, enter delivery address below: ☐ No

3. Service Type ☐ Priority Mail Express®
☐ Adult Signature ☐ Registered Mail™
☐ Adult Signature Restricted Delivery ☐ Registered Mail Restricted Delivery
☐ Certified Mail® ☐ Signature Confirmation™
☐ Certified Mail Restricted Delivery ☐ Signature Confirmation Restricted Delivery
☐ Collect on Delivery
☐ Collect on Delivery Restricted Delivery

SENDER: COMPLETE THIS SECTION

Complete items 1, 2, and 3.

Print your name and address on the reverse so that we can return the card to you.

Attach this card to the back of the mailpiece, or on the front if space permits.

1. Article Addressed to:

1814.2A

OXY Y-1 Company
5 Greenway Plaza, Ste 110
Houston, Texas 77045

9590 9402 8916 4064 1466 01

9589 0710 5270 0916 2417 47

COMPLETE THIS SECTION ON DELIVERY

A. Signature
X *[Signature]* ☒ Agent ☐ Addressee

B. Received by (Printed Name) C. Date of Delivery
[Signature] 11/1/25

D. Is delivery address different from item 1? ☐ Yes
If YES, enter delivery address below: ☐ No

3. Service Type ☐ Priority Mail Express®
☐ Adult Signature ☐ Registered Mail™
☐ Adult Signature Restricted Delivery ☐ Registered Mail Restricted Delivery
☐ Certified Mail® ☐ Signature Confirmation™
☐ Certified Mail Restricted Delivery ☐ Signature Confirmation Restricted Delivery
☐ Collect on Delivery
☐ Collect on Delivery Restricted Delivery

PS Form 3811, July 2020 PSN 7530-02-000-9053 Domestic Return Receipt

PS Form 3811, July 2020 PSN 7530-02-000-9053 Domestic Return Receipt

SENDER: COMPLETE THIS SECTION

Complete items 1, 2, and 3.

Print your name and address on the reverse so that we can return the card to you.

Attach this card to the back of the mailpiece, or on the front if space permits.

1. Article Addressed to:

1814.2A

Concho Oil & Gas LLC
600 W. Illinois Avenue
Midland, TX 79701

9590 9402 8763 3310 3017 02

9589 0710 5270 1506 7189 08

COMPLETE THIS SECTION ON DELIVERY

A. Signature
X *[Signature]* ☐ Agent ☐ Addressee

B. Received by (Printed Name) C. Date of Delivery
Javier Salas 10/28/25

D. Is delivery address different from item 1? ☐ Yes
If YES, enter delivery address below: ☐ No

3. Service Type ☐ Priority Mail Express®
☐ Adult Signature ☐ Registered Mail™
☐ Adult Signature Restricted Delivery ☐ Registered Mail Restricted Delivery
☐ Certified Mail® ☐ Signature Confirmation™
☐ Certified Mail Restricted Delivery ☐ Signature Confirmation Restricted Delivery
☐ Collect on Delivery
☐ Collect on Delivery Restricted Delivery

SENDER: COMPLETE THIS SECTION

Complete items 1, 2, and 3.

Print your name and address on the reverse so that we can return the card to you.

Attach this card to the back of the mailpiece, or on the front if space permits.

1. Article Addressed to:

1814.2A

Balog Family Trust dated 8/15/2002
25812 South Dartford Drive
Sun Lakes, Arizona 85248

9590 9402 8916 4064 1463 35

9589 0710 5270 2981 1355 18

COMPLETE THIS SECTION ON DELIVERY

A. Signature
X *[Signature]* ☐ Agent ☐ Addressee

B. Received by (Printed Name) C. Date of Delivery
[Signature] 10-25

D. Is delivery address different from item 1? ☐ Yes
If YES, enter delivery address below: ☐ No

3. Service Type ☐ Priority Mail Express®
☐ Adult Signature ☐ Registered Mail™
☐ Adult Signature Restricted Delivery ☐ Registered Mail Restricted Delivery
☐ Certified Mail® ☐ Signature Confirmation™
☐ Certified Mail Restricted Delivery ☐ Signature Confirmation Restricted Delivery
☐ Collect on Delivery
☐ Collect on Delivery Restricted Delivery

PS Form 3811, July 2020 PSN 7530-02-000-9053 Domestic Return Receipt

PS Form 3811, July 2020 PSN 7530-02-000-9053 Domestic Return Receipt

Released Under Imaging: 11/26/2025 12:35:47 PM

U.S. Postal ServiceTM
CERTIFIED MAIL[®] RECEIPT
Domestic Mail Only

For delivery information, visit our website at www.usps.com.

OFFICIAL USE

Certified Mail Fee	
Extra Services & Fees (check box, add fee as appropriate)	
<input type="checkbox"/> Return Receipt (hardcopy) \$	
<input type="checkbox"/> Return Receipt (electronic) \$	
<input type="checkbox"/> Certified Mail Restricted Delivery \$	
<input type="checkbox"/> Adult Signature Required \$	
<input type="checkbox"/> Adult Signature Restricted Delivery \$	

Postage 1814.2A

Total \$

Sent To Powderhorn Nominee Corp
600 N Marienfield St.
Suite 1000
Midland, TX 79705

PS Form 3800, January 2023 PSN 7530-02-000-9047 See Reverse for Instructions

U.S. Postal ServiceTM
CERTIFIED MAIL[®] RECEIPT
Domestic Mail Only

For delivery information, visit our website at www.usps.com.

OFFICIAL USE

Certified Mail Fee	
Extra Services & Fees (check box, add fee as appropriate)	
<input type="checkbox"/> Return Receipt (hardcopy) \$	
<input type="checkbox"/> Return Receipt (electronic) \$	
<input type="checkbox"/> Certified Mail Restricted Delivery \$	
<input type="checkbox"/> Adult Signature Required \$	
<input type="checkbox"/> Adult Signature Restricted Delivery \$	

Postage 1814.2A

Total \$

Sent To Powderhorn Asset Co, LLC
600 N Marienfield St.
Suite 1000
Midland, TX 79705

PS Form 3800, January 2023 PSN 7530-02-000-9047 See Reverse for Instructions

U.S. Postal ServiceTM
CERTIFIED MAIL[®] RECEIPT
Domestic Mail Only

For delivery information, visit our website at www.usps.com.

OFFICIAL USE

Certified Mail Fee	
Extra Services & Fees (check box, add fee as appropriate)	
<input type="checkbox"/> Return Receipt (hardcopy) \$	
<input type="checkbox"/> Return Receipt (electronic) \$	
<input type="checkbox"/> Certified Mail Restricted Delivery \$	
<input type="checkbox"/> Adult Signature Required \$	
<input type="checkbox"/> Adult Signature Restricted Delivery \$	

Postage 1814.2A

Total \$

Sent To Estate of Robert E Humphus
304 Soper Rd
Carlsbad, NM 88220

PS Form 3800, January 2023 PSN 7530-02-000-9047 See Reverse for Instructions

94 9142 9160 0225 0120 6956

U.S. Postal ServiceTM
CERTIFIED MAIL[®] RECEIPT
Domestic Mail Only

For delivery information, visit our website at www.usps.com.

OFFICIAL USE

Certified Mail Fee	
Extra Services & Fees (check box, add fee as appropriate)	
<input type="checkbox"/> Return Receipt (hardcopy) \$	
<input type="checkbox"/> Return Receipt (electronic) \$	
<input type="checkbox"/> Certified Mail Restricted Delivery \$	
<input type="checkbox"/> Adult Signature Required \$	
<input type="checkbox"/> Adult Signature Restricted Delivery \$	

Postage 1814.2A

Total \$

Sent To Denise Price
415 Del Rio # 56
Carlsbad, NM 88220

PS Form 3800, January 2023 PSN 7530-02-000-9047 See Reverse for Instructions

U.S. Postal ServiceTM
CERTIFIED MAIL[®] RECEIPT
Domestic Mail Only

For delivery information, visit our website at www.usps.com.

OFFICIAL USE

Certified Mail Fee	
Extra Services & Fees (check box, add fee as appropriate)	
<input type="checkbox"/> Return Receipt (hardcopy) \$	
<input type="checkbox"/> Return Receipt (electronic) \$	
<input type="checkbox"/> Certified Mail Restricted Delivery \$	
<input type="checkbox"/> Adult Signature Required \$	
<input type="checkbox"/> Adult Signature Restricted Delivery \$	

Postage 1814.2A

Total \$

Sent To COG Operating LLC
One Concho Center
600 West Illinois Avenue
Midland, TX 79701

PS Form 3800, January 2023 PSN 7530-02-000-9047 See Reverse for Instructions

U.S. Postal ServiceTM
CERTIFIED MAIL[®] RECEIPT
Domestic Mail Only

For delivery information, visit our website at www.usps.com.

OFFICIAL USE

Certified Mail Fee	
Extra Services & Fees (check box, add fee as appropriate)	
<input type="checkbox"/> Return Receipt (hardcopy) \$	
<input type="checkbox"/> Return Receipt (electronic) \$	
<input type="checkbox"/> Certified Mail Restricted Delivery \$	
<input type="checkbox"/> Adult Signature Required \$	
<input type="checkbox"/> Adult Signature Restricted Delivery \$	

Postage 1814.2A

Total \$

Sent To Sydhan LP
P.O. Box 92349
Austin, TX 78709

PS Form 3800, January 2023 PSN 7530-02-000-9047 See Reverse for Instructions

U.S. Postal ServiceTM
CERTIFIED MAIL[®] RECEIPT
Domestic Mail Only

For delivery information, visit our website at www.usps.com.

OFFICIAL USE

Certified Mail Fee	
Extra Services & Fees (check box, add fee as appropriate)	
<input type="checkbox"/> Return Receipt (hardcopy) \$	
<input type="checkbox"/> Return Receipt (electronic) \$	
<input type="checkbox"/> Certified Mail Restricted Delivery \$	
<input type="checkbox"/> Adult Signature Required \$	
<input type="checkbox"/> Adult Signature Restricted Delivery \$	

Postage 1814.2A

Total \$

Sent To Estate of Betty Cole Drake
415 N. McKinley St. Ste. 270C
Little Rock AR 72205

PS Form 3800, January 2023 PSN 7530-02-000-9047 See Reverse for Instructions

Received by OCD: 11/26/2025 12:35:47 PM

Affidavit of Publication**Copy of Publication:**No. 69320

State of New Mexico

Publisher

County of Eddy:

Adrian Hedden

being duly sworn, says that he is the

Publisher

of the Carlsbad Current Argus, a weekly newspaper of

general circulation, published in English at Carlsbad,

said county and state, and that the hereto attached

Legal Ad

was published in a regular and entire issue of the said

Carlsbad Current Argus, a weekly newspaper duly qualified

for that purpose within the meaning of Chapter 167 of

the 1937 Session Laws of the state of New Mexico for

1 Consecutive weeks/day on the same

day as follows:

First Publication October 30, 2025

Second Publication _____

Third Publication _____

Fourth Publication _____

Fifth Publication _____

Sixth Publication _____

Seventh Publication _____

Eighth Publication _____

Subscribed and sworn before me this

30th day of October 2025

LATISHA ROMINE
 Notary Public, State of New Mexico
 Commission No. 1076338
 My Commission Expires
 05-12-2027



Latisha Romine

Notary Public, Eddy County, New Mexico

LEGAL NOTICE
OCTOBER 30, 2025

STATE OF NEW MEXICO
 ENERGY, MINERALS, AND NATURAL RESOURCES
 DEPARTMENT OIL CONSERVATION DIVISION, SANTA
 FE, NEW MEXICO

The State of New Mexico, Energy, Minerals, and Natural Resources Department, Oil Conservation Division (Division) hereby gives notice that the Division will hold public hearings before a hearing examiner on the following case.

The hearing will be conducted on **Thursday, November 13, 2025, beginning at 9:00 A.M. MST** in a hybrid fashion, both in-person at the Energy, Minerals, Natural Resources Department, Wendell Chino Building, Pecos Hall, 1220 South St. Francis Drive, 1st Floor, Santa Fe, NM 87505 and via the Microsoft Teams meeting platform. To view the hearing docket and to determine how to participate in the electronic hearing, visit the Divisions website at: <http://www.emnrd.state.nm.us/OCD/hearing-info/> or contact Sheila Apodaca at Sheila.Apodaca@emnrd.nm.gov. Documents filed in the case may also be viewed at <https://ocdimage.emnrd.nm.gov/imaging/CaseFileView.aspx?CaseNo=25710>. If you are an individual with a disability who needs a reader, amplifier, qualified sign language interpreter, or other form of auxiliary aid or service to attend or participate in the hearing, contact Sheila Apodaca or the New Mexico Relay Network at 1-800-659-1779, no later than November 6, 2025.

STATE OF NEW MEXICO TO:

All named parties and persons
 having any right, title, interest
 or claim in the following case
 and notice to the public.

(NOTE: All land descriptions herein refer to the New Mexico Principal Meridian whether or not so stated.)

TO: All interested parties, including: Balog Family Trust dated 8/15/2002; Berdan Living Trust UTA dated November 2 2018; Big; Three Energy Group LLC; Denise Price; EOG Resources Inc; Estate of Betty Cole Drake; Estate of Frances Jane Owen; Estate of Robert E Humphus; Fandango, LLC; Feathersone Development Corporation; JKM Energy LLC; Karen Dianne Farrell ; Magnum Hunter Production Company Inc; OXY Y-1 Company; Parrot Head Properties LLC; Powderhorn Asset Co, LLC ; Powderhorn Nominee Corp; Prospector LLC; Sydhan LP; Vision Energy Inc; Bureau of Land Management; COG Operating LLC; Concho Oil & Gas LLC; New Mexico Department of Transportation.

CASE NO. 25710: Application of Tap Rock Operating, LLC for Approval to Compulsory Pool Additional Interest Owners Under Order R-23945, Eddy County, New Mexico. Applicant in the above-styled cause seeks an order from the Division pooling additional uncommitted mineral interest owners under Order No. R-23945. The order pooled uncommitted mineral interest owners in the Wolfcamp formation underlying a standard horizontal spacing unit comprised of all of Sections 3 and 4 Township 25 South, Range 25 East, N.M.P.M., Eddy County, New Mexico (the Unit). Tap Rock has determined that that are additional uncommitted and unleased mineral interest owners in the Unit who were not pooled by Order No. R-23945, including the New Mexico Department of Transportation. Tap Rock is the designated operator under the pooling order. Order R-23945 dedicated the Unit to the proposed initial wells including: Beer 30 Fed Com 202H (API No. 30-015-57254), Beer 30 Fed Com 204H (API No. 30-015-57256), Beer 30 Fed Com 211H (API No. 30-015-57255), and Beer 30 Fed Com 213H (API No. 30-015-57257). The wells and lands are located approximately 1 mile southeast of Whites City, New Mexico.

69320-Published in Carlsbad Current Argus Oct. 30, 2025.

Case No. 25710

Tap Rock Operating, LLC - Exhibit D-4