

CASE 5616: ATLANTIC RICHFIELD
CO. FOR AN UNORTHODOX GAS WELL
LOCATION & SIMULTANEOUS DEDICATIO
LEA COUNTY, NEW MEXICO

CASE NO.

5616

APPLICATION,
TRANSCRIPTS,
SMALL EXHIBITS,

ETC.

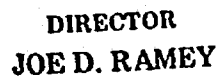

STATE OF NEW MEXICO
P.O. BOX 2088 - SANTA FE
87501

**LAND COMMISSIONER
PHIL R. LUCERO**



STATE GEOLOGIST
EMERY C. ARNOLD

Re: CASE NO. 5616
ORDER NO. R-5160

Mr. Clarence Hinkle
Hinkle, Bondurant, Cox
& Eaton
Attorneys at Law
Post Office Box 10
Roswell, New Mexico 88201

Applicant:

Atlantic Richfield Company

Dear Sir:

Enclosed herewith are two copies of the above-referenced Commission order recently entered in the subject case.

Yours very truly,

JOE D. RAMEY
Director

JDR/fd

Copy of order also sent to:

Hobbs OCC **x**

Artesia OCC.

Aztec OCC.

Other.

BEFORE THE OIL CONSERVATION COMMISSION
OF THE STATE OF NEW MEXICO

IN THE MATTER OF THE HEARING
CALLED BY THE OIL CONSERVATION
COMMISSION OF NEW MEXICO FOR
THE PURPOSE OF CONSIDERING:

CASE NO. 5616
Order No. R-5160

APPLICATION OF ATLANTIC RICHFIELD
COMPANY FOR AN UNORTHODOX GAS WELL
LOCATION AND SIMULTANEOUS DEDICATION,
LEA COUNTY, NEW MEXICO.

ORDER OF THE COMMISSION

BY THE COMMISSION:

This cause came on for hearing at 9 a.m. on January 20, 1976, at Santa Fe, New Mexico, before Examiner Daniel S. Nutter.

NOW, on this 3rd day of February, 1976, the Commission, a quorum being present, having considered the testimony, the record, and the recommendations of the Examiner, and being fully advised in the premises,

FINDS:

(1) That due public notice having been given as required by law, the Commission has jurisdiction of this cause and the subject matter thereof.

(2) That the applicant, Atlantic Richfield Company, seeks authority to simultaneously dedicate a previously approved 320-acre non-standard gas proration unit comprising the W/2 of Section 29, Township 24 South, Range 37 East, Jalmat Gas Pool, Lea County, New Mexico, to its W. H. Harrison "D" WN Com Well No. 1, located in Unit L of said Section 29 and its W. H. Harrison "A" WN Well No. 2, at an unorthodox location 660 feet from the North and West lines of said Section 29.

(3) That the W/2 of said Section 29 is to be dedicated to the well.

(4) That no offset operator objected to the proposed unorthodox location.

(5) That approval of the subject application will afford the applicant the opportunity to produce its just and equitable share of the gas in the subject pool, will prevent the economic loss caused by the drilling of unnecessary wells, avoid the augmentation of risk arising from the drilling of an excessive number of wells, and will otherwise prevent waste and protect correlative rights.

-2-

Case No. 5616
Order No. R-5160

(6) That Administrative Order NSP-748, which originally approved the subject 320-acre non-standard proration unit to be dedicated to the W. H. Harrison "D" WN Com Well No. 1 only should be superseded.

IT IS THEREFORE ORDERED:

(1) That Atlantic Richfield Company is hereby authorized to simultaneously dedicate a previously approved 320-acre non-standard gas proration unit comprising the W/2 of Section 29, Township 24 South, Range 37 East, Jalmat Gas Pool, Lea County, New Mexico, to its W. H. Harrison "D" WN Com Well No. 1, located in Unit L of said Section 29 and its W. H. Harrison "A" WN Well No. 2, at an unorthodox location 660 feet from the North and West lines of said Section 29.

(2) That the W/2 of said Section 29 shall be dedicated to the above-described well.

(3) That Administrative Order NSP-748 is hereby superseded.

(4) That jurisdiction of this cause is retained for the entry of such further orders as the Commission may deem necessary.

DONE at Santa Fe, New Mexico, on the day and year herein-above designated.

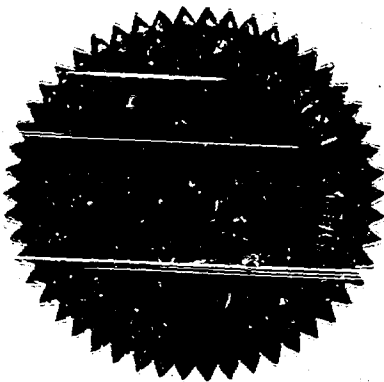

S E A L

STATE OF NEW MEXICO
OIL CONSERVATION COMMISSION

Phil R. Lucero
PHIL R. LUCERO, Chairman

Emery C. Arnold
EMERY C. ARNOLD, Member

Joe D. Ramey
JOE D. RAMEY, Member & Secretary

jr/

sid morrish reporting service
General Court Reporting Service
825 Calle Mejia, No. 122, Santa Fe, New Mexico 87501
Phone (505) 982-9212

Page 1

BEFORE THE
NEW MEXICO OIL CONSERVATION COMMISSION
Santa Fe, New Mexico
January 20, 1976

EXAMINER HEARING

IN THE MATTER OF:

Application of Atlantic Richfield
Company for an unorthodox gas well
location and simultaneous dedication,
Lea County, New Mexico.

CASE
5616

BEFORE: Daniel S. Nutter, Examiner

TRANSCRIPT OF HEARING

A P P E A R A N C E S

For the New Mexico Oil
Conservation Commission:

William F. Carr, Esq.
Legal Counsel for the Commission
State Land Office Building
Santa Fe, New Mexico

For the Applicant:

Clarence Hinkle, Esq.
HINKLE, BONDURANT, COX & EATON
Attorneys at Law
Hinkle Building
Roswell, New Mexico

sid morrish reporting service
General Court Reporting Service
825 Calle Mejia, No. 122, Santa Fe, New Mexico 87501
Phone (505) 982-9212

Page 2

I N D E X

Page

WILLIAM T. PORTER

Direct Examination by Mr. Hinkle	3
Cross Examination by Mr. Nutter	6

EXHIBIT INDEX

Page

Atlantic Richfield Exhibit No. One, Plat	6
Atlantic Richfield Exhibit No. Two, Plat	6

sid morish reporting service
General Court Reporting Service
825 Calle Mejia, No. 122, Santa Fe, New Mexico 87501
Phone (505) 982-9212

1 MR. NUTTER: We will call Case 5616.

2 MR. CARR: Case 5616, application of Atlantic
3 Richfield Company for an unorthodox gas well location,
4 Eddy County, New Mexico.

5 MR. HINKLE: Clarence Hinkle, Hinkle, Bondurant,
6 Cox and Eaton appearing on behalf of Atlantic Richfield. We
7 have one witness and two exhibits.

8 (THEREUPON, the witness was duly sworn.)

9 WILLIAM T. PORTER

10 called as a witness, having been first duly sworn, was
11 examined and testified as follows:

12 DIRECT EXAMINATION

13 BY MR. HINKLE:

14 Q State your name, your residence and by whom you are
15 employed?

16 A William T. Porter, I work for Atlantic Richfield
17 Company in Midland, Texas.

18 Q What is your position with Atlantic Richfield?

19 A I'm a Senior Operations Engineer.

20 Q Have you previously testified before the Commission?

21 A Yes, I have.

22 Q And qualified as a petroleum engineer?

23 A Yes.

24
25

1 Q And your qualifications are a matter of record?

2 A Yes.

3 Q Have you made a study of this particular area that
4 is involved in this application?

5 A Yes, I have.

6 MR. HINKLE: Are his qualifications sufficient?

7 MR. NUTTER: Yes, they are.

8 Q (Mr. Hinkle continuing.) What is Atlantic Richfield
9 seeking to accomplish by this application?

10 A We are requesting approval for an unorthodox gas
11 well location and are seeking authority to simultaneously
12 dedicate a previously approved three-hundred-and-twenty-acre
13 nonstandard gas proration unit to our William H. Harrison D
14 Com Well No. 1, and to the newly completed William H. Harrison
15 A Well No. 2 at an unorthodox location of six hundred and
16 sixty feet from the north and west line of Section 29.

17 Q Have you prepared or has there been prepared under
18 your direction, exhibits for introduction in this case?

19 A Yes, I have.

20 Q They are the ones marked Exhibits One and Two?

21 A Yes.

22 Q Refer to Exhibit One and explain what this is and
23 what it shows?

24 A Exhibit One is a nine-section plat showing the
25 unorthodox three-hundred-and-twenty acre unit located in the

1 west half of Section 29. All of the active Jalmat gas
2 producers are colored in green.

3 Q The arrow points to the unorthodox location of the
4 well?

5 A Yes.

6 Q What is the status of that well?

7 A It is currently shut in. It was completed on
8 December 24th, 1975 for one thousand MCF a day.

9 Q Where was it previously completed?

10 A In the Langlie-Mattix pool.

11 Q And the other well in the west half of 29, what
12 is the status of that well?

13 A It is presently producing as a marginal unit,
14 a three-twenty marginal unit, approximately eight hundred
15 MCF a day.

16 Q Now, refer to Exhibit Two and explain that?

17 A Exhibit Two is a well location and acreage dedication
18 plat, Form C-102, which was submitted previously in an attempt
19 for administrative approval, which was turned down.

20 Q Were all of the offset owners given notice of the
21 application?

22 A Yes, they were.

23 Q Have you had any protests?

24 A No, we have not.

25 Q You desire to make the allowable or produce either

sid morrish reporting service

General Court Reporting Service
825 Calle Mejia, No. 122, Santa Fe, New Mexico 87501
Phone (505) 982-9212

1 well in order to make the allowable?

2 A. Yes, sir. They are attempting to have a non-
3 marginal unit presently pushing that marginal unit because we
4 are under produced.

5 Q. In your opinion, would the approval of this applica-
6 tion be in the interests of conservation and the prevention
7 of waste and the protection of correlative rights?

8 A. Yes, sir.

9 Q. Do you have any other comments with respect to
10 these exhibits?

11 A. No, we don't.

12 MR. HINKLE: I would like to offer Exhibits One
13 and Two.

14 MR. NUTTER: Atlantic's Exhibits One and Two
15 will be admitted.

16 (THEREUPON, Atlantic Richfield's Exhibits
17 One and Two were admitted into evidence.)

18 CROSS EXAMINATION

19
20 BY MR. NUTTER:

21 Q. Mr. Porter, the three-hundred-and-twenty-acre unit
22 is presently in existence and dedicated to the Well No. 1, is
23 that correct?

24 A. Yes, sir.

25 Q. And what is the status of that unit, it is classified

sid morrish reporting service
General Court Reporting Service
825 Calle Mejia, No. 122, Santa Fe, New Mexico 87501
Phone (505) 982-9212

1 as marginal?

2 A. It is marginal.

3 Q. So there is no underage or overage status to be
4 assigned to the compositely dedicated unit, then?

5 A. That is correct.

6 Q. Is the No. 2 well a good enough well to make this
7 unit a non-marginal unit now?

8 A. Yes, sir.

9 Q. And will the No. 1 well continue to be produced?

10 A. Yes, sir.

11 Q. So you will have both wells dedicated to the unit?

12 A. Yes, sir.

13 MR. NUTTER: Are there any further questions of
14 the witness? He may be excused.

15 (THEREUPON, the witness was excused.)

16 MR. NUTTER: Do you have anything further, Mr. Hinkle?

17 MR. HINKLE: That's all.

18 MR. NUTTER: Does anyone have anything they wish
19 to offer in Case 5616? We will take the case under advisement.

20

21

22

23

24

25

REPORTER'S CERTIFICATE

I, SIDNEY F. MORRISH, a Certified Shorthand Reporter,
do hereby certify that the foregoing and attached Transcript
of Hearing before the New Mexico Oil Conservation Commission
was reported by me, and the same is a true and correct record
of the said proceedings to the best of my knowledge, skill and
ability.

Sidney F. Morrish, C.S.R.

sid morrish reporting service
General Court Reporting Service
825 Calle Mejia, No. 122, Santa Fe, New Mexico 87501
Phone (505) 982-9212

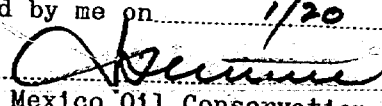
I do hereby certify that the foregoing is
a complete record of the proceedings in
the Examiner hearing of Case No. 5616,
heard by me on 1/20, 19 76.
, Examiner
New Mexico Oil Conservation Commission

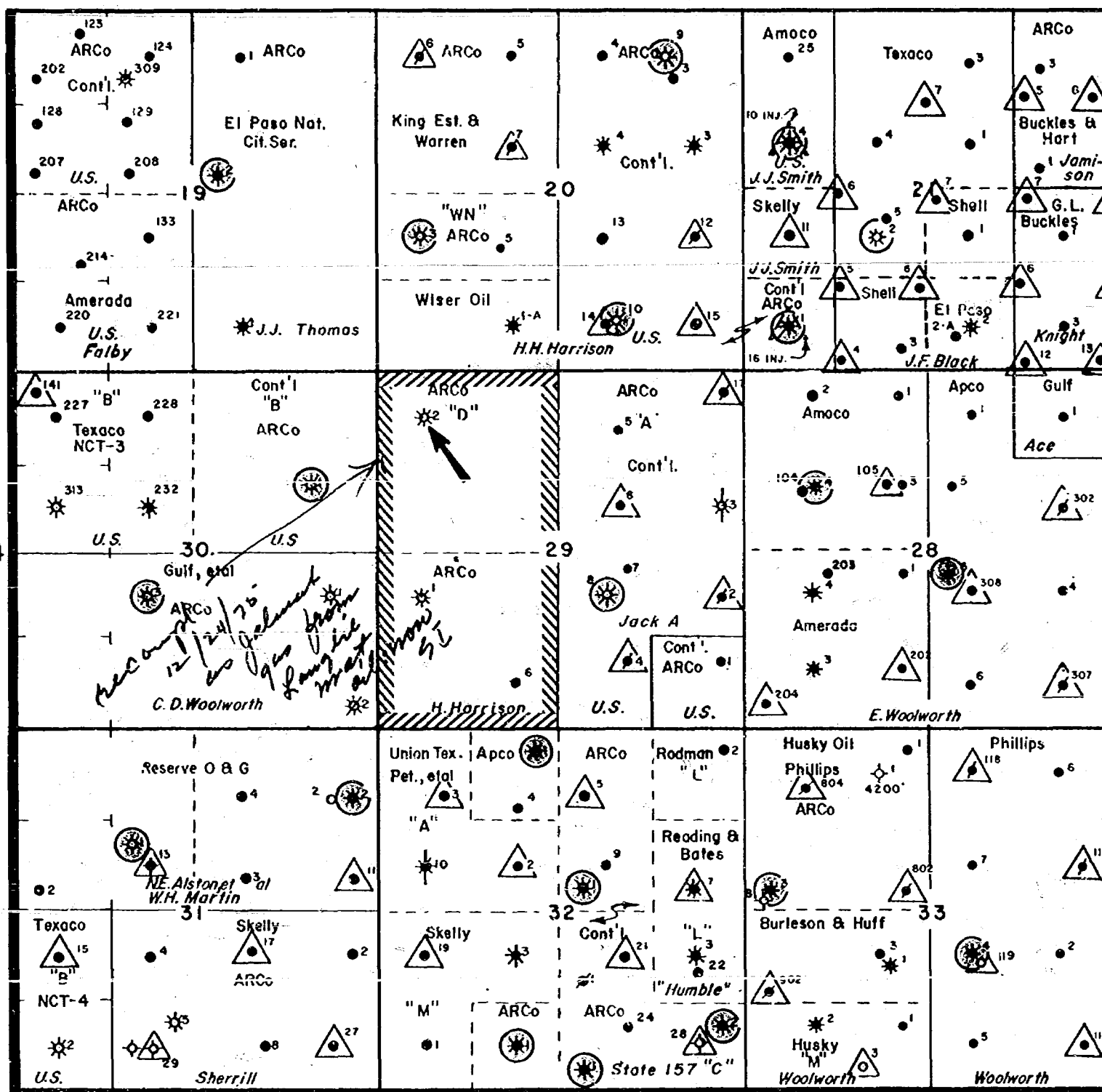

BEFORE EXAMINER NUTTER

CR. CONSERVATION COMMISSION

EXHIBIT NO. 1

CASE NO. 5611

320 AC. A.R.Co. GAS UNIT



ACTIVE JALMAT GAS PRODUCER (OCT. 75)

R 37 E

Atlantic Richfield Company
North American Producing Division
Permian District Midland, Texas

JALMAT GAS UNIT
HARRISON LEASE
LEA COUNTY, NEW MEXICO

SCALE 1"=2000'

By: W.T. PORTER	Drawn By: dL Date 1-76
Date: 1-76	Revised By: MSS Date 1-76
Dept: WEST AREA ENGR.	Eng No:

NEW MEXICO OIL CONSERVATION COMMISSION
WELL LOCATION AND ACREAGE DEDICATION PLAT

Form C-102
Supersedes C-128
Effective 1-1-65

All distances must be from the outer boundaries of the Section.

Operator Atlantic Richfield Company		Lease William H. Harrison A WN		Well No. 2
Unit Letter D	Section 29	Township 24 South	Range 37 East	County Lea
Actual Footage Location of Well: 660 feet from the North line and 660 feet from the West line		Dedicated Acreage: 320 Acres		
Ground Level Elev. 3290'	Producing Formation Seven Rivers		Pool Jalmat Gas	

1. Outline the acreage dedicated to the subject well by colored pencil or hachure marks on the plat below.
2. If more than one lease is dedicated to the well, outline each and identify the ownership thereof (both as to working interest and royalty).
3. If more than one lease of different ownership is dedicated to the well, have the interests of all owners been consolidated by communitization, unitization, force-pooling, etc?

☒ Yes ☐ No If answer is "yes," type of consolidation Communitization

If answer is "no," list the owners and tract descriptions which have actually been consolidated. (Use reverse side of this form if necessary.)

No allowable will be assigned to the well until all interests have been consolidated (by communitization, unitization, forced-pooling, or otherwise) or until a non-standard unit, eliminating such interests, has been approved by the Commission.

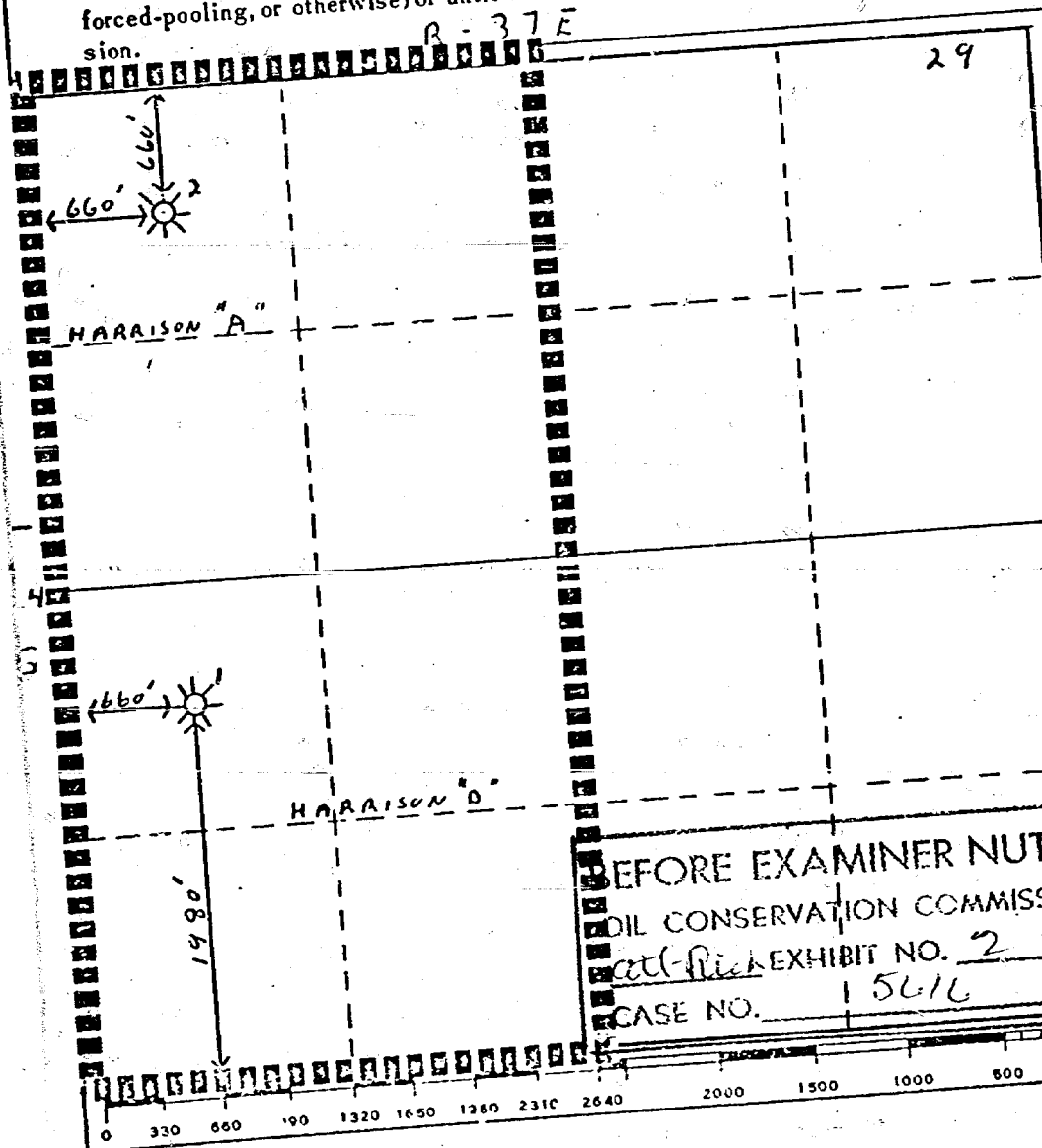

CERTIFICATION

I hereby certify that the information contained herein is true and complete to the best of my knowledge and belief.

Name Richard S. Prentice
Richard S. Prentice
Position
Operations Engineer
Company
Atlantic Richfield Company
Date
December 18, 1975

I hereby certify that the well location shown on this plat was plotted from field notes of actual surveys made by me or under my supervision, and that the same is true and correct to the best of my knowledge and belief.

BEFORE EXAMINER NUTTER
OIL CONSERVATION COMMISSION
EXHIBIT NO. 2
CASE NO. 15616

Date Surveyed
Registered Professional Engineer
and/or Land Surveyor
Certificate No.

Dockets Nos. 5-76 and 6-76 are tentatively set for hearing on February 4 and February 18, 1976. Applications for hearing must be filed at least 22 days in advance of hearing date.

DOCKET: EXAMINER HEARING - TUESDAY - JANUARY 20, 1976

9 A.M. - OIL CONSERVATION COMMISSION CONFERENCE ROOM,
STATE LAND OFFICE BUILDING, SANTA FE, NEW MEXICO

The following cases will be heard before Daniel S. Nutter, Examiner, or Richard L. Stamets, Alternate Examiner:

- CASE 5614: Application of Amerada Hess Corporation for downhole commingling, Rio Arriba County, New Mexico. Applicant, in the above-styled cause, seeks approval to commingle Basin-Dakota gas production and oil produced from an undesignated Gallup pool in the wellbore of its Apache "A" Well No. 7, located in Unit J of Section 26, Township 25 North, Range 5 West, Rio Arriba County, New Mexico.
- CASE 5615: Application of Yates Petroleum Corporation for an unorthodox gas well location, Eddy County, New Mexico. Applicant, in the above-styled cause, seeks approval for the unorthodox location of its Morely EW Well No. 1, located 660 feet from the South and East lines of Section 27, Township 17 South, Range 25 East, Eddy County, New Mexico, the S/2 of said Section 27 to be dedicated to the well.
- CASE 5616: Application of Atlantic Richfield Company for an unorthodox gas well location and simultaneous dedication, Lea County, New Mexico. Applicant, in the above-styled cause, seeks authority to simultaneously dedicate a previously approved 320-acre non-standard gas proration unit comprising the W/2 of Section 29, Township 24 South, Range 37 East, Jalmat Gas Pool, Lea County, New Mexico, to its W. H. Harrison "D" WN Com Well No. 1, located in Unit L of said Section 29 and its W. H. Harrison "A" WN Well No. 2, at an unorthodox location 660 feet from the North and West lines of said Section 29.
- CASE 5617: Application of Robinson Resource Development Company, Inc. for an unorthodox gas well location, Eddy County, New Mexico. Applicant, in the above-styled cause, seeks approval for the unorthodox location of a Morrow test well to be drilled 1530 feet from the North line and 330 feet from the East line of Section 18, Township 21 South, Range 25 East, Eddy County, New Mexico, the N/2 of said Section 18 to be dedicated to the well.
- CASE 5618: Application of Mesa Petroleum Co. for a triple completion, San Juan County, New Mexico. Applicant, in the above-styled cause, seeks approval of the triple completion (conventional) of its Primo Well No. 1A, located in Unit D of Section 6, Township 31 North, Range 10 West, San Juan County, New Mexico, to produce gas from the Pictured Cliffs, Chacra and Mesaverde formations.
- CASE 5117: (Reopened)
- In the matter of Case 5117 being reopened pursuant to the provisions of Order No. R-4691, which order established temporary special pool rules for the North Dagger Draw-Upper Pennsylvanian Pool, Eddy County, New Mexico. All interested parties may appear and show cause why said pool should not be developed on less than 320-acre spacing and why the special depth bracket allowable should remain in effect.
- CASE 5619: Application of Agua, Inc. for an extension of time, Order No. R-4495-A, Lea County, New Mexico. Applicant, in the above-styled cause, seeks a 90-day extension of the February 7, 1976, deadline to cease the disposal of produced salt water through perforations from 4,230 feet to 4,320 feet in its SKD Well No. C-2, located in Unit C of Section 2, Township 22 South, Range 37 East, Lea County, New Mexico.
- CASE 5603: (Continued from January 7, 1976 Examiner Hearing)
- Application of Burleson and Huff for compulsory pooling, a non-standard gas proration unit, and an unorthodox location, Lea County, New Mexico. Applicant, in the above-styled cause, seeks an order pooling all mineral interests in the Jalmat Gas Pool underlying the NW/4 of Section 35, Township 25 South, Range 37 East, Lea County, New Mexico, to form a non-standard 160-acre proration unit; applicant further seeks the pooling of all mineral interests in the Langlie-Mattix Pool underlying each of the following tracts in said Section 35 to form three standard 40-acre proration units: the NE/4 NW/4, to be dedicated to applicant's Dabbs Well No. 1, located 330 feet from the North line and 2310 feet from the West line of said Section 35; the SE/4 NW/4, to be dedicated to applicant's Dabbs Well No. 3, located 1980 feet from the North and West lines of said Section 35; and the SW/4 NW/4, to be dedicated to a well to be drilled on said tract at a standard Langlie-Mattix Pool location. In the event re-entry into either the Dabbs Well No. 1 or No. 3 is unsuccessful, applicant proposes to drill a replacement well at a standard location on its tract. Applicant further proposes to dedicate the 160-acre Jalmat proration unit to one of the three above-described wells, and in the event it should be the Dabbs Well No. 1, applicant seeks approval for the unorthodox Jalmat location for said well. Also to be considered will be the cost of re-entering, drilling, and completing said wells and the allocation of such costs as well as actual operating costs and charges for supervision. Also to be considered will be the designation of the applicant as operator of the wells and a charge for the risk involved in re-entering, drilling, and completing said well.
- CASE 5604: (Continued from January 7, 1976 Examiner Hearing)
- Application of Burleson & Huff for a waterflood project, Lea County, New Mexico. Applicant, in the above-styled cause, seeks authority to institute a waterflood project in the Querecho Plains-Queen Pool by the injection of water into the Queen formation through its Anadarko Federal Well No. 6 to be drilled at an unorthodox location in the approximate center of the SW/4 of Section 27, Township 18 South, Range 32 East, Lea County, New Mexico. Applicant further seeks an administrative procedure for approval of additional wells at standard and non-standard locations within the project area.

Dockets Nos. 5-76 and 6-76 are tentatively set for hearing on February 4 and February 18, 1976. Applications for hearing must be filed at least 22 days in advance of hearing date.

DOCKET: COMMISSION HEARING - WEDNESDAY - JANUARY 21, 1976

9 A.M. - OIL CONSERVATION COMMISSION - MORGAN HALL
STATE LAND OFFICE BUILDING, SANTA FE, NEW MEXICO

CASE 5592: (De Novo)

Application of Agua, Inc. for salt water disposal, Lea County, New Mexico. Applicant, in the above-styled cause, seeks authority to dispose of produced water by injection into the San Andres formation through the open-hole interval from approximately 4000 to 5000 feet in its Blinbry-Drinkard SKD System Well No. A-22 located 817 feet from the North line and 965 feet from the East line of Section 22, Township 22 South, Range 37 East, Lea County, New Mexico.

Upon application of Agua, Inc., this case will be heard De Novo pursuant to the provisions of Rule 1220.

CASE 5571: (De Novo)

Application of Robert G. Cox for amendment of Order No. R-4561, Eddy County, New Mexico. Applicant, in the above-styled cause, seeks amendment of Order No. R-4561, which order permitted the directional drilling of applicant's Federal "EA" Well No. 1, located 330 feet from the North and West lines of Section 12, Township 18 South, Range 27 East, Empire-Abe Pool, Eddy County, New Mexico, in such a manner as to be bottomed within 100 feet of the surface location. Applicant seeks the amendment of said order to permit bottoming of the subject well approximately 58 feet from the North line and 8 feet from the West line of said Section 12 and to permit verification of said downhole location by single-shot directional surveys made concurrently with the drilling of said well.

Upon application of Robert G. Cox, this case will be heard De Novo pursuant to the provisions of Rule 1220.

NOTE: Case No. 5592, above, will be dismissed at the request of applicant.

Memo

From
WM. F. CARR
ATTORNEY

To

can't grant administratively
because its 640 location
is unorthodox in a 320 acre
unit

hearing on Jan 20
de novo Jan 21

will treat letter of 12/18/75
as application

✓ w/ Hinkle re: dates
and subpoenas (cox)

Oil Conservation Commission - Santa Fe, New Mexico

Atlantic Richfield Company

North American Producing Division
Permian District
Post Office Box 1610
Midland, Texas 79701
Telephone 915 682 8631

December 18, 1975

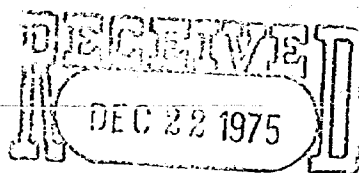

OIL CONSERVATION COMM.
Santa Fe

Mr. Joe D. Ramey
New Mexico Oil Conservation Commission
P. O. Box 2088
Santa Fe, New Mexico

Re: William H. Harrison "A" WN No. 2
Simultaneous Dedication of Acreage
Jalmat Gas Pool
Lea County, New Mexico
West/2 Sec. 29, T-24S, R-37E

Dear Mr. Ramey:

Atlantic Richfield Company requests administrative approval to simultaneously dedicate the West/2 of Section 29, Township 24 South, Range 37 East, to the W. H. Harrison "A" WN No. 2 and the W. H. Harrison "D" WN Com No. 1 wells for Jalmat gas production. We have abandoned the Langlie Mattix zone in the Harrison "A" No. 2 well and have recompleted in the Jalmat gas zone. The Harrison "D" No. 1 is currently a marginal Jalmat gas producer in a 320-acre non-standard Jalmat Gas Proration Unit composed of the acreage described above. The existing proration unit was established by the New Mexico Oil Conservation Commission per Administrative Order NSP 748, dated April 21, 1966. This application qualifies for administrative approval under New Mexico Oil Conservation Commission Statewide Rule No. 104-D II, and your consideration and approval is requested.

The well is located at an orthodox Langlie Mattix location and qualifies for administrative approval of location which has been applied for under a separate application. Approval of this application is in the interest of conservation, will protect correlative rights, prevent economic waste, and allow more complete recovery of Jalmat gas reserves. Your prompt consideration and approval is requested as a successful re-completion has been performed, and the well has flowed 800 MCFD. Attached is a map showing offset operators, a well location and dedication map, and a list of offset operators. In addition, offset operators have been notified of and provided with this application as required by Statewide Rule No. 104.

Very truly yours,

J. L. Tweed
J. L. Tweed

RSP/agp

DOCKET MAILED

Date 1/12/76

Case 5616

Hearing
1/21



Case 5616

Offset Operators
W. H. Harrison Lease
W/2 Sec. 29, T-24S, R-37E
Lea County, New Mexico

APCO Oil Company
P. O. Box 1027
Odessa, Texas 79760

Cities Service Oil Company
P. O. Box 1919
Midland, Texas 79701

Conoco
P. O. Box 1460
Hobbs, New Mexico

Gulf Energy & Minerals Company - US
P. O. Box 1150
Midland, Texas 79701

Reserve Oil & Gas
201 First Savings Bldg.
Midland, Texas 79701

Union Texas Petroleum
1300 Wilco Bldg.
Midland, Texas 79701

Wiser Oil Company
P. O. Box 2467
Hobbs, New Mexico

Case 5616

NEW MEXICO OIL CONSERVATION COMMISSION
WELL LOCATION AND ACREAGE DEDICATION PLAT

Form C-102
Supersedes C-128
Effective 1-1-65

All distances must be from the outer boundaries of the Section.

Operator Atlantic Richfield Company			Lease William H. Harrison A WN		Well No. 2
Unit Letter D	Section 29	Township 24 South	Range 37 East	County Lea	
Actual Footage Location of Well: 660 feet from the North line and 660 feet from the West line					
Ground Level Elev. 3290'	Producing Formation Seven Rivers	Pool Jalmat Gas	Dedicated Acreage: 320 Acres		

1. Outline the acreage dedicated to the subject well by colored pencil or hachure marks on the plat below.
2. If more than one lease is dedicated to the well, outline each and identify the ownership thereof (both as to working interest and royalty).
3. If more than one lease of different ownership is dedicated to the well, have the interests of all owners been consolidated by communitization, unitization, force-pooling, etc?

☒ Yes ☐ No, If answer is "yes," type of consolidation Communitization

If answer is "no," list the owners and tract descriptions which have actually been consolidated. (Use reverse side of this form if necessary.)

No allowable will be assigned to the well until all interests have been consolidated (by communitization, unitization, forced-pooling, or otherwise) or until a non-standard unit, eliminating such interests, has been approved by the Commission.

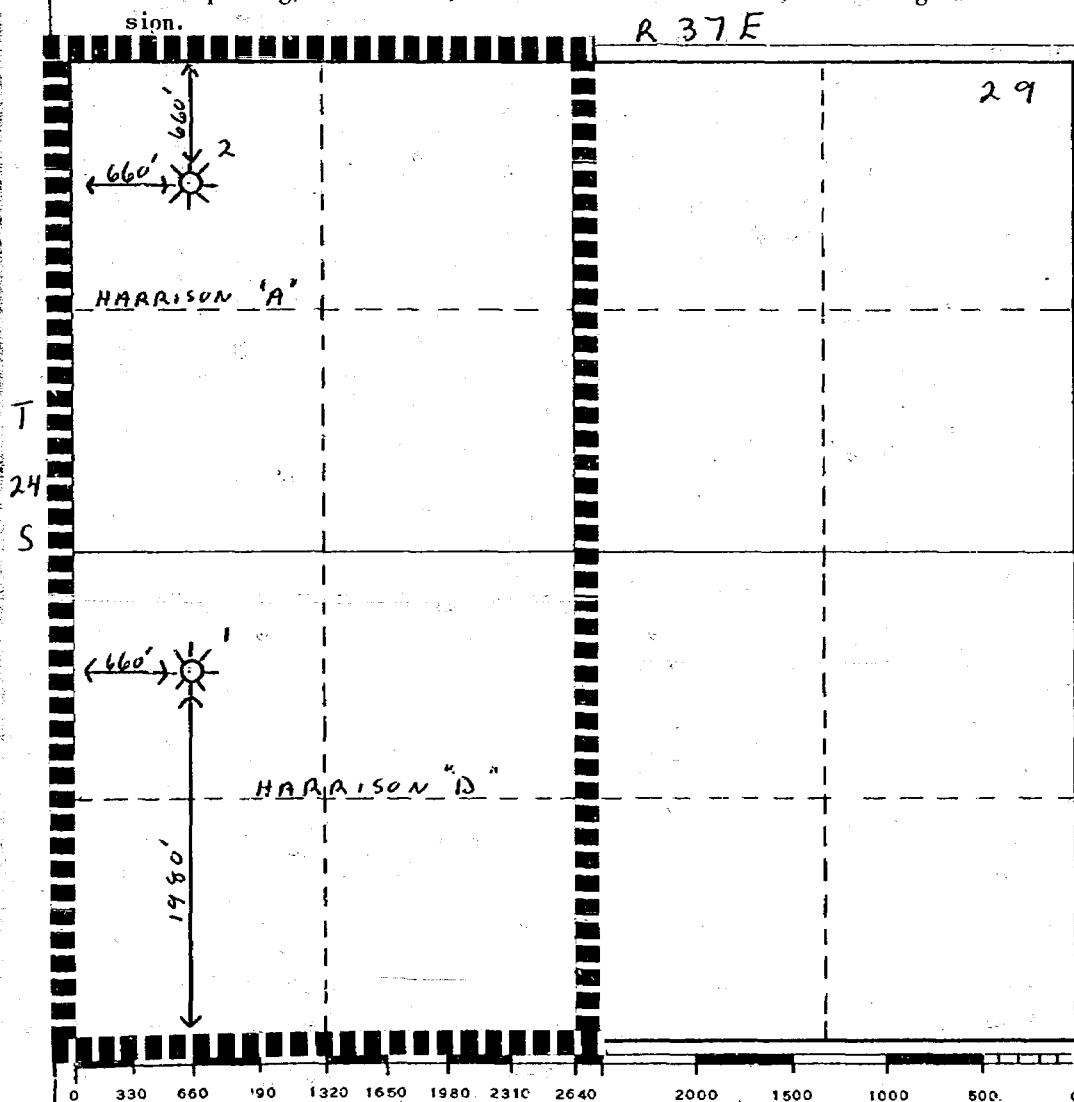

CERTIFICATION

I hereby certify that the information contained herein is true and complete to the best of my knowledge and belief.

Name Richard S. Prentice
Richard S. Prentice
Position
Operations Engineer
Company
Atlantic Richfield Company
Date
December 18, 1975

I hereby certify that the well location shown on this plat was plotted from field notes of actual surveys made by me or under my supervision, and that the same is true and correct to the best of my knowledge and belief.

Date Surveyed

Registered Professional Engineer
and/or Land Surveyor

Certificate No.

Case 5616

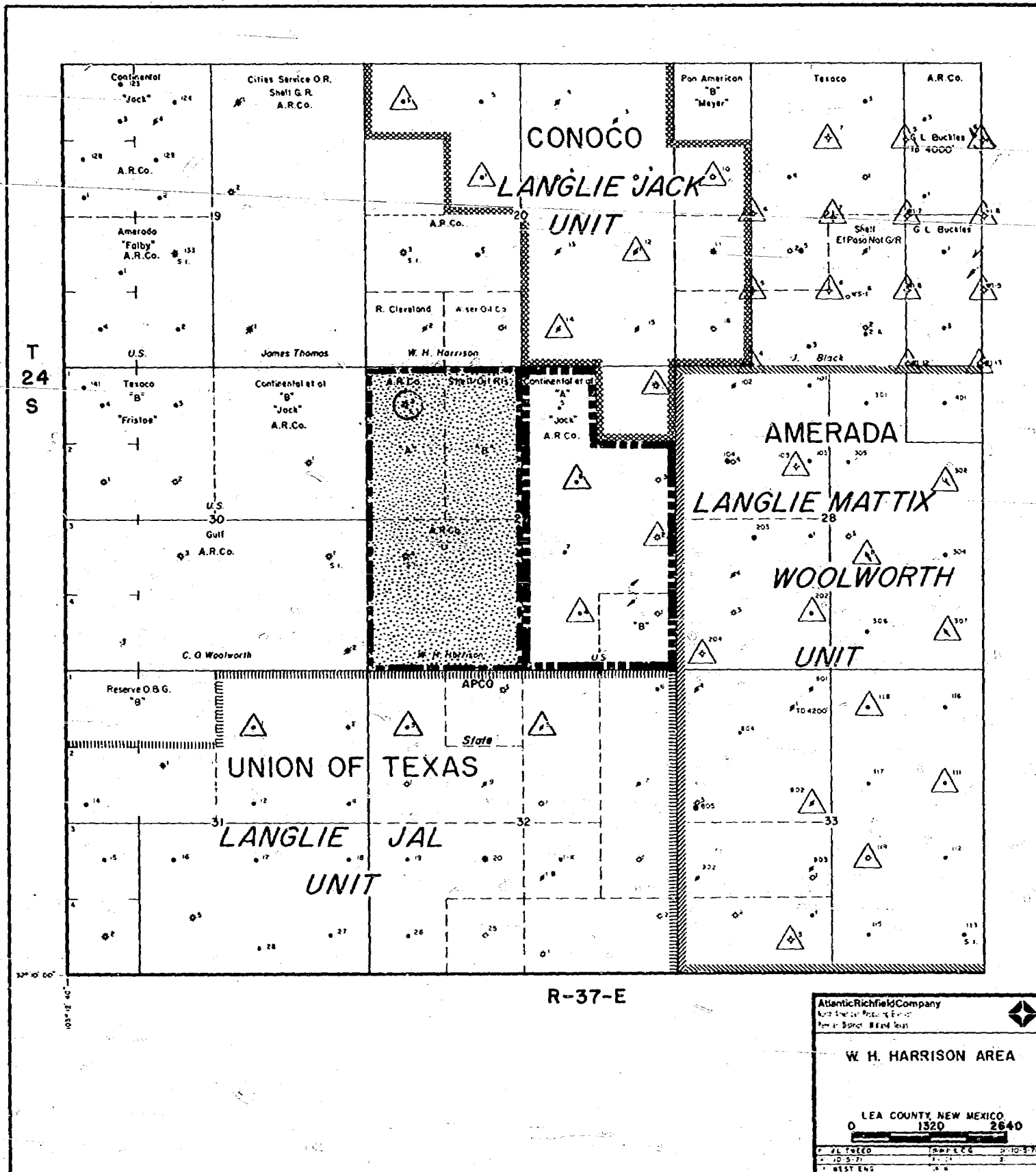

Richfield Company

North American Producing Division
Permian District
Post Office Box 1610
Midland, Texas 79701
Telephone 915 682 8631

Case 5616



December 18, 1975

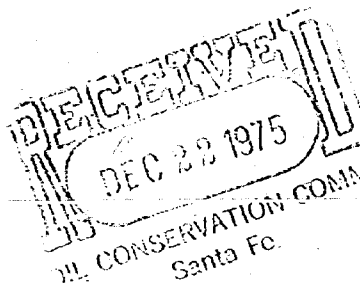

Mr. Joe D. Ramey
New Mexico Oil Conservation Commission
P. O. Box 2088
Santa Fe, New Mexico

Re: William H. Harrison "A" WN No. 2
Simultaneous Dedication of Acreage
Jalmat Gas Pool
Lea County, New Mexico
West/2 Sec. 29, T-24S, R-37E

Dear Mr. Ramey:

Atlantic Richfield Company requests administrative approval to simultaneously dedicate the West/2 of Section 29, Township 24 South, Range 37 East, to the W. H. Harrison "A" WN No. 2 and the W. H. Harrison "D" WN Com No. 1 wells for Jalmat gas production. We have abandoned the Langlie Mattix zone in the Harrison "A" No. 2 well and have recompleted in the Jalmat gas zone. The Harrison "D" No. 1 is currently a marginal Jalmat gas producer in a 320-acre non-standard Jalmat Gas Proration Unit composed of the acreage described above. The existing proration unit was established by the New Mexico Oil Conservation Commission per Administrative Order NSP 748, dated April 21, 1966. This application qualifies for administrative approval under New Mexico Oil Conservation Commission Statewide Rule No. 104-D II, and your consideration and approval is requested.

The well is located at an orthodox Langlie Mattix location and qualifies for administrative approval of location which has been applied for under a separate application. Approval of this application is in the interest of conservation, will protect correlative rights, prevent economic waste, and allow more complete recovery of Jalmat gas reserves. Your prompt consideration and approval is requested as a successful re-completion has been performed, and the well has flowed 800 MCFD.

Attached is a map showing offset operators, a well location and dedication map, and a list of offset operators. In addition, offset operators have been notified of and provided with this application as required by Statewide Rule No. 104.

Very truly yours,

J. L. Tweed
J. L. Tweed

RSP/agp

Case 5616

Offset Operators
W. H. Harrison Lease
W/2 Sec. 29, T-24S, R-37E
Lea County, New Mexico

APCO Oil Company
P. O. Box 1027
Odessa, Texas 79760

Cities Service Oil Company
P. O. Box 1919
Midland, Texas 79701

Conoco
P. O. Box 460
Hobbs, New Mexico

Gulf Energy & Minerals Company - US
P. O. Box 1150
Midland, Texas 79701

Reserve Oil & Gas
201 First Savings Bldg.
Midland, Texas 79701

Union Texas Petroleum
1300 Wilco Bldg.
Midland, Texas 79701

Wiser Oil Company
P. O. Box 2467
Hobbs, New Mexico

Form C-102
Supersedes C-128
Effective 1-1-65

NEW MEXICO OIL CONSERVATION COMMISSION
WELL LOCATION AND ACREAGE DEDICATION PLAT

All distances must be from the outer boundaries of the Section.

Operator Atlantic Richfield Company		Lease William H. Harrison A WN		Well No. 2
Unit Letter D	Section 29	Township 24 South	Range 37 East	County Lea
Actual Footage Location of Well: 660 feet from the North line and 660 feet from the West line				
Ground Level Elev. 3290'	Producing Formation Seven Rivers	Pool Jalmat Gas	Dedicated Acreage: 320 Acres	

Mark the subject well by colored pencil or hachure marks on the plat below.

- 660
Ground Level Elev: _____ Producing Formation
3290' **Seven Rivers** **Jalmat Gas**
1. Outline the acreage dedicated to the subject well by colored pencil or hachure marks on the plat below.
2. If more than one lease is dedicated to the well, outline each and identify the ownership thereof (both as to working interest and royalty).
3. If more than one lease of different ownership is dedicated to the well, have the interests of all owners been consolidated by communitization, unitization, force-pooling, etc?
- Consolidation Communitization

☒ Yes ☐ No If answer is "yes," type of consolidation Communitization

If answer is "no," list the owners and tract descriptions which have actually been consolidated. (Use reverse side of this form if necessary.) _____

_____ assigned to the well until all interests have been consolidated (by communitization, unitization, or force-pooling). _____

_____ representing such interests, has been approved by the Commission.

If answer is "no," list the owners and this form if necessary.)
No allowable will be assigned to the well until all interests have been consolidated (by communitization, unitization, forced-pooling, or otherwise) or until a non-standard unit, eliminating such interests, has been approved by the Commission.

R 37 E

CERTIFICATION

No allowable will be assigned to the well until all interests have been consolidated (by communitization, unitization, forced-pooling, or otherwise) or until a non-standard unit, eliminating such interests, has been approved by the Commission.

R 37 E

CERTIFICATION

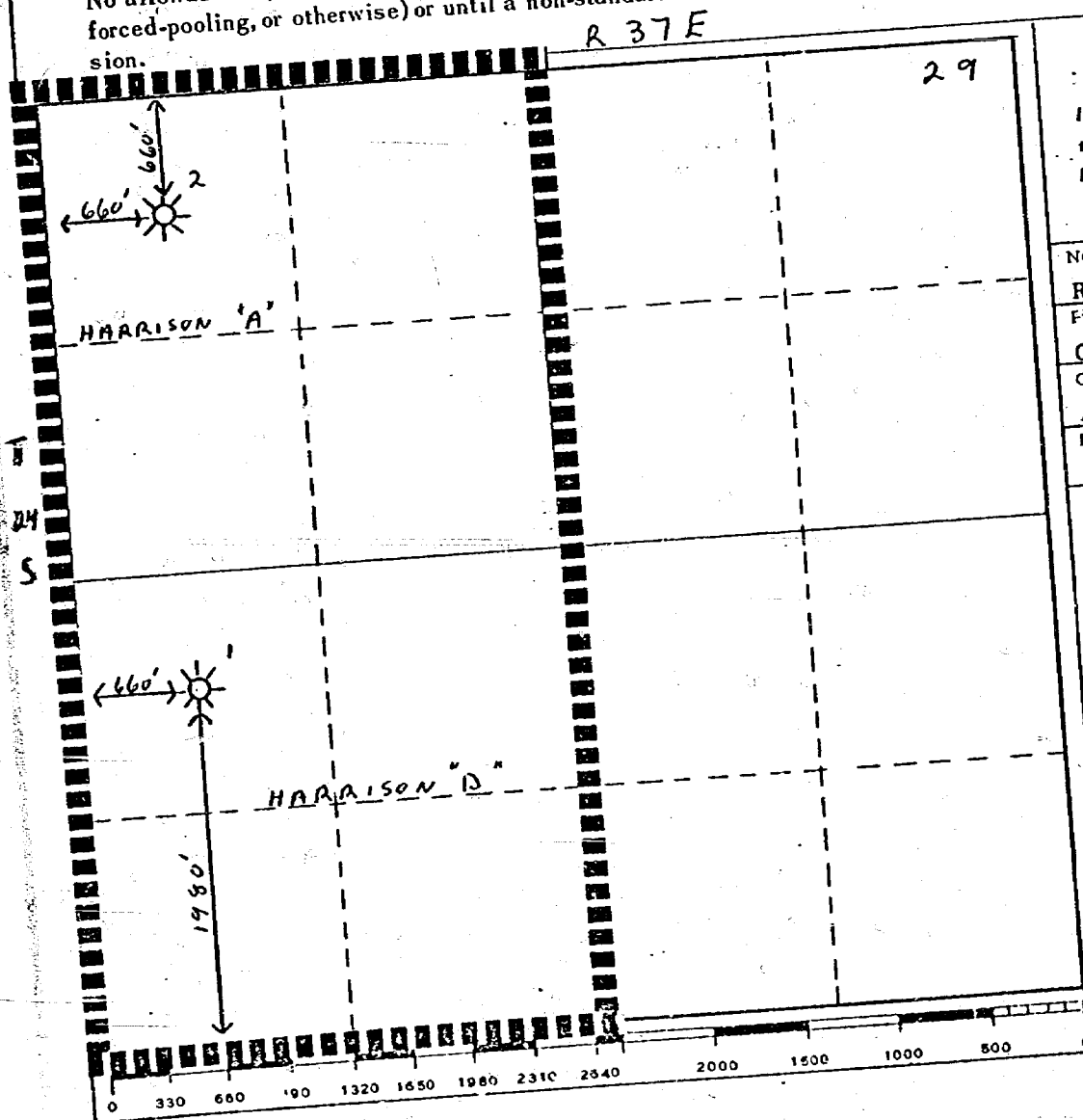

CERTIFICATION

I hereby certify that the information contained herein is true and complete to the best of my knowledge and belief.

Name: Richard S. Prentice
Richard S. Prentice

Position

Position Operations Engineer

Company

Company
Atlantic Richfield Company.

Date _____

Date December 18, 1975

I hereby certify that the well location shown on this plot was plotted from field notes of actual surveys made by me or under my supervision, and that the same is true and correct to the best of my knowledge and belief.

Date Surveyed _____

Registered Professional Engineer
and/or Land Surveyor

Certificate No.

Case 5816

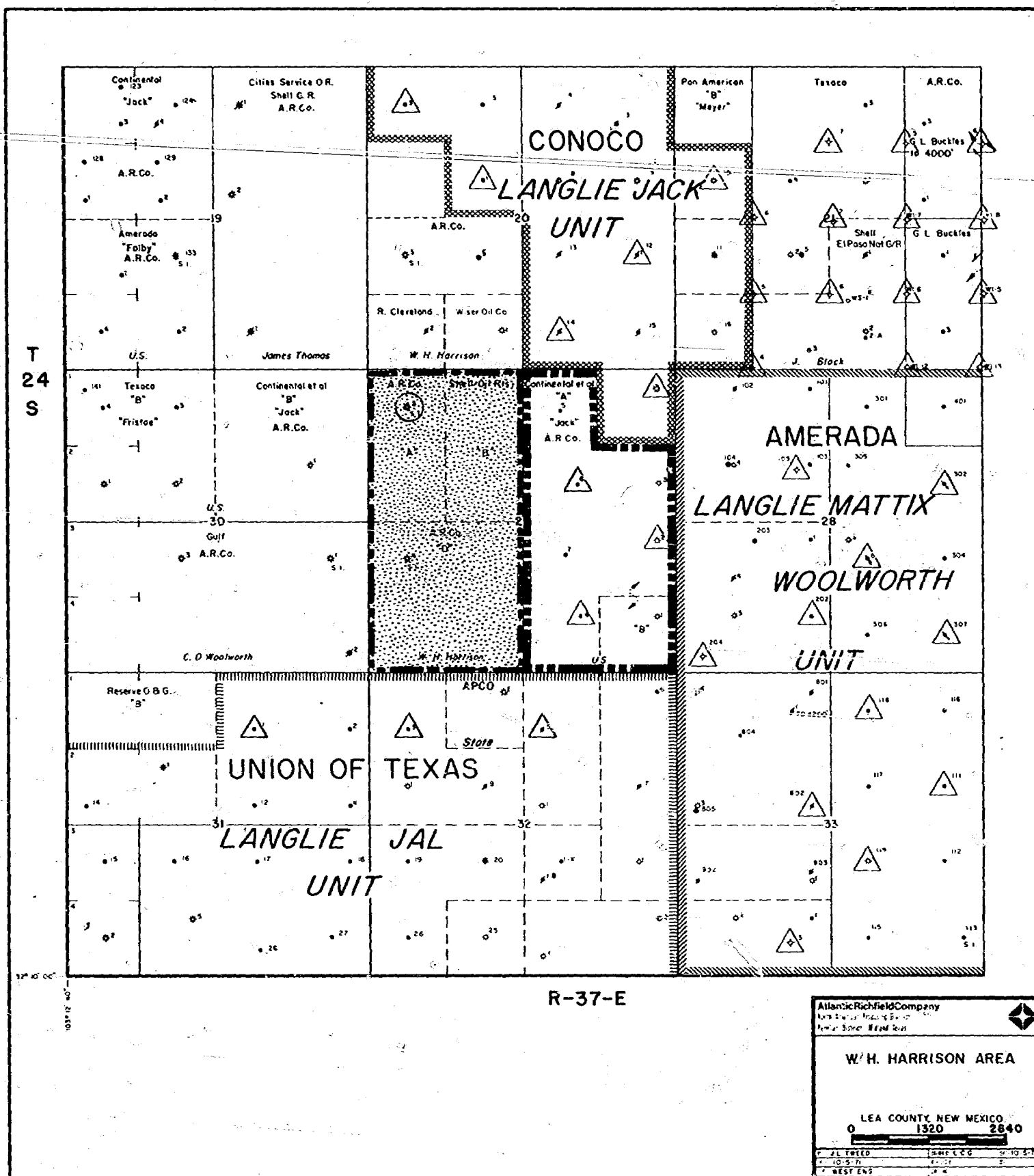

Atlantic Richfield Company

North American Producing Division
Permian District
Post Office Box 1610
Midland, Texas 79701
Telephone 915 682 8631

Case 5616

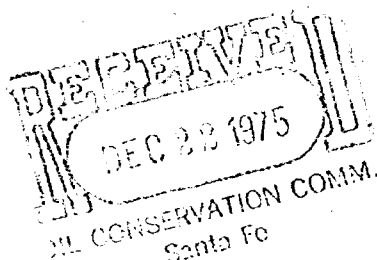

December 18, 1975

Mr. Joe D. Ramey
New Mexico Oil Conservation Commission
P. O. Box 2088
Santa Fe, New Mexico

Re: William H. Harrison "A" WN No. 2
Simultaneous Dedication of Acreage
Jalmat Gas Pool
Lea County, New Mexico
West/2 Sec. 29, T-24S, R-37E

Dear Mr. Ramey:

Atlantic Richfield Company requests administrative approval to simultaneously dedicate the West/2 of Section 29, Township 24 South, Range 37 East, to the W. H. Harrison "A" WN No. 2 and the W. H. Harrison "D" WN Com No. 1 wells for Jalmat gas production. We have abandoned the Langlie Mattix zone in the Harrison "A" No. 2 well and have recompleted in the Jalmat gas zone. The Harrison "D" No. 1 is currently a marginal Jalmat gas producer in a 320-acre non-standard Jalmat Gas Proration Unit composed of the acreage described above. The existing proration unit was established by the New Mexico Oil Conservation Commission per Administrative Order NSP 748, dated April 21, 1966. This application qualifies for administrative approval under New Mexico Oil Conservation Commission Statewide Rule No. 104-D II, and your consideration and approval is requested.

The well is located at an orthodox Langlie Mattix location and qualifies for administrative approval of location which has been applied for under a separate application. Approval of this application is in the interest of conservation, will protect correlative rights, prevent economic waste, and allow more complete recovery of Jalmat gas reserves. Your prompt consideration and approval is requested as a successful re-completion has been performed, and the well has flowed 800 MCFD.

Attached is a map showing offset operators, a well location and dedication map, and a list of offset operators. In addition, offset operators have been notified of and provided with this application as required by Statewide Rule No. 104.

Very truly yours,

J. L. Tweed
J. L. Tweed

RSP/agp

Case 5616

Offset Operators
W. H. Harrison Lease
W/2 Sec. 29, T-24S, R-37E
Lea County, New Mexico

APCO Oil Company
P. O. Box 1027
Odessa, Texas 79760

Cities Service Oil Company
P. O. Box 1919
Midland, Texas 79701

Conoco
P. O. Box 460
Hobbs, New Mexico

Gulf Energy & Minerals Company - US
P. O. Box 1150
Midland, Texas 79701

Reserve Oil & Gas
201 First Savings Bldg.
Midland, Texas 79701

Union Texas Petroleum
1300 Wilco Bldg.
Midland, Texas 79701

Wiser Oil Company
P. O. Box 2467
Hobbs, New Mexico

Case 5616

**NEW MEXICO OIL CONSERVATION COMMISSION
WELL LOCATION AND ACREAGE DEDICATION PLAT**

Form C-102
Supersedes C-128
Effective 1-1-65

All distances must be from the outer boundaries of the Section.

Operator Atlantic Richfield Company			Lease William H. Harrison A WN		Well No. 2
Unit Letter D	Section 29	Township 24 South	Range 37 East	County Lea	
Actual Footage Location of Well: 660 feet from the North line and 660 feet from the West line					
Ground Level Elev. 3290'	Producing Formation Seven Rivers	Pool Jalmat Gas	Dedicated Acreage: 320 Acres		

1. Outline the acreage dedicated to the subject well by colored pencil or hatchure marks on the plat below.
2. If more than one lease is dedicated to the well, outline each and identify the ownership thereof (both as to working interest and royalty).
3. If more than one lease of different ownership is dedicated to the well, have the interests of all owners been consolidated by communitization, unitization, force-pooling, etc?

☒ Yes ☐ No If answer is "yes," type of consolidation Communitization

If answer is "no," list the owners and tract descriptions which have actually been consolidated. (Use reverse side of this form if necessary.)

No allowable will be assigned to the well until all interests have been consolidated (by communitization, unitization, forced-pooling, or otherwise) or until a non-standard unit, eliminating such interests, has been approved by the Commis-

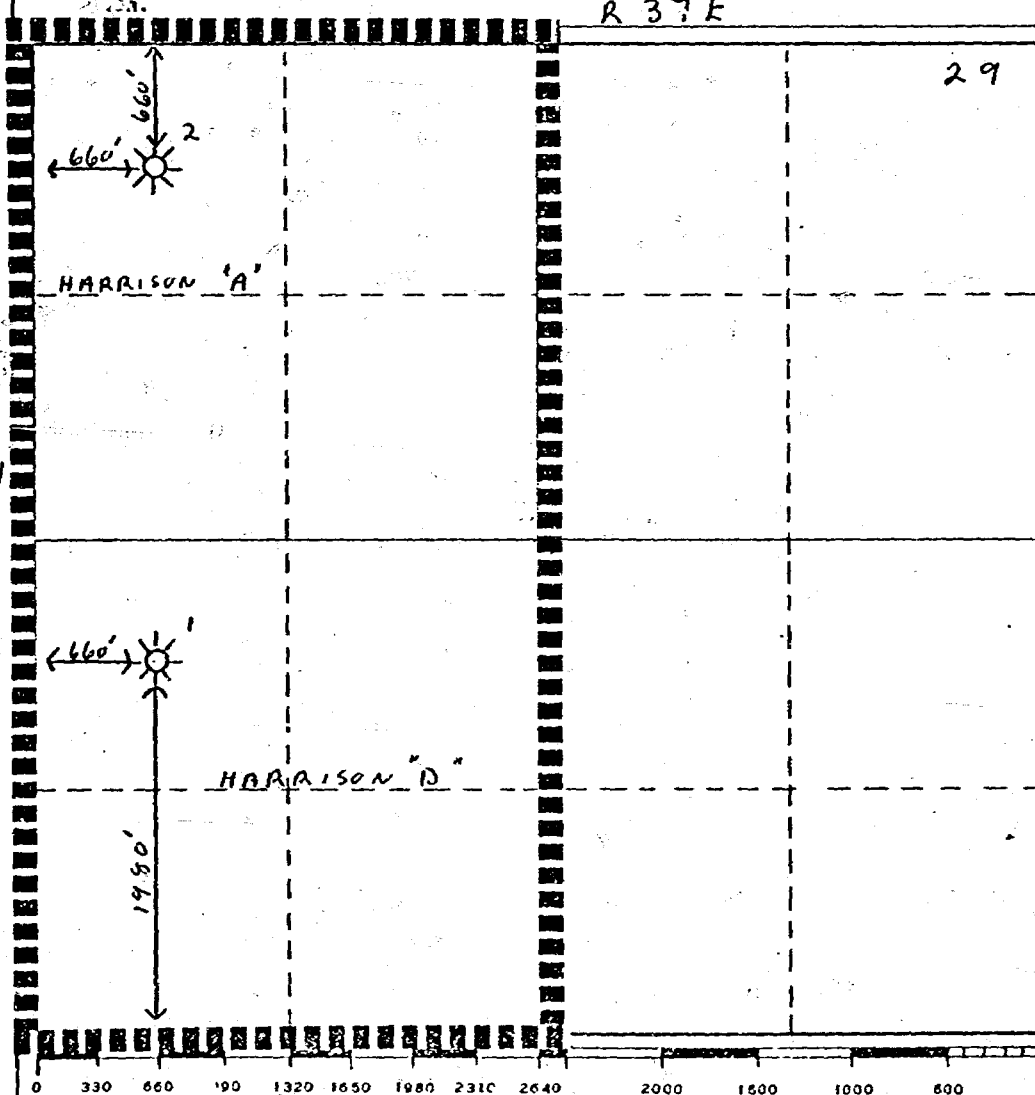

CERTIFICATION

I hereby certify that the information contained herein is true and complete to the best of my knowledge and belief.

Name Richard S. Prentice
Richard S. Prentice

Position
Operations Engineer

Company
Atlantic Richfield Company

Date
December 18, 1975

I hereby certify that the well location shown on this plat was plotted from field notes of actual surveys made by me or under my supervision, and that the same is true and correct to the best of my knowledge and belief.

Date Surveyed

Registered Professional Engineer
and/or Land Surveyor

Certificate No.

Case 5616

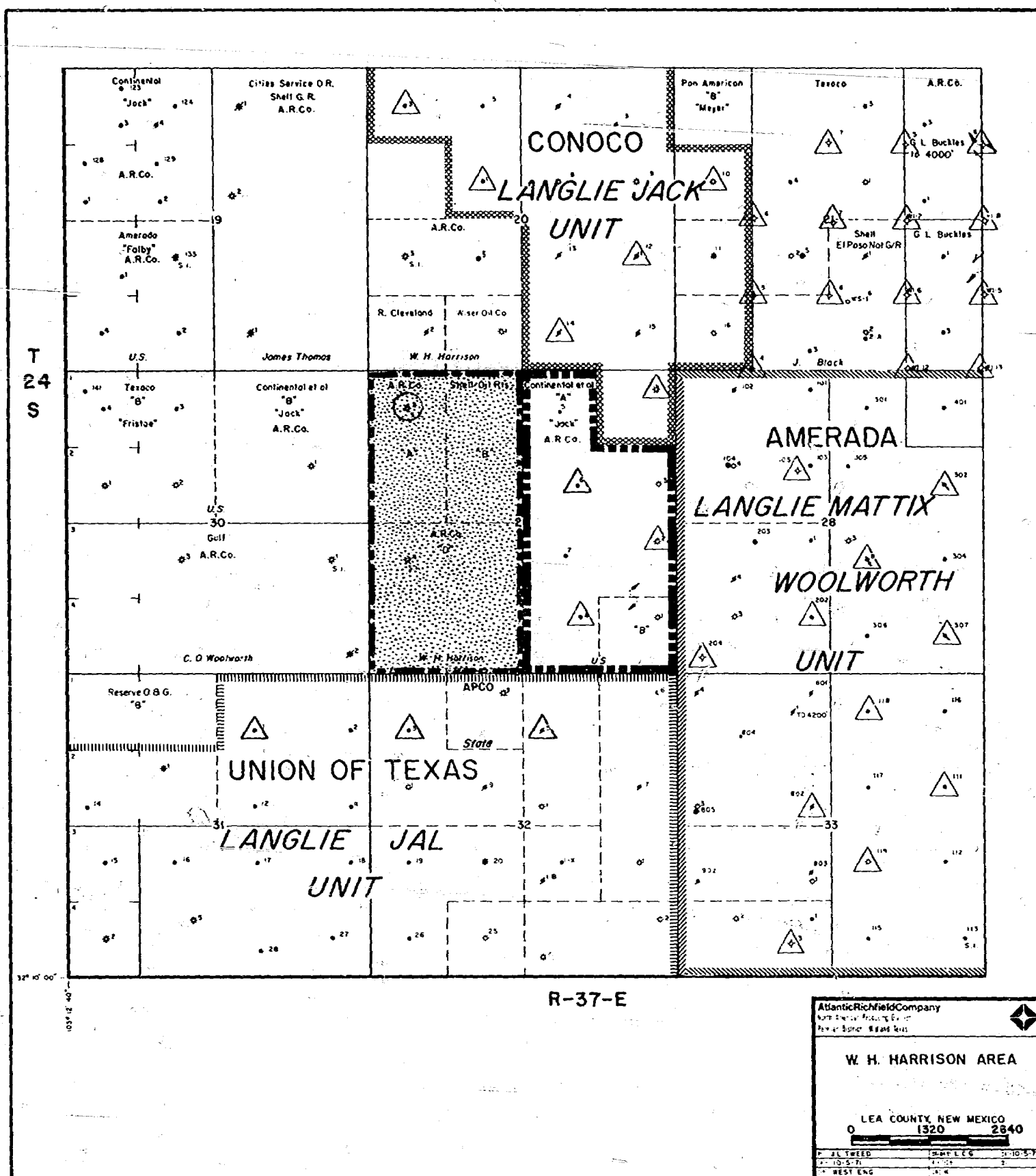

Atlantic Richfield Company

North American Producing Division
Permian District
Post Office Box 1610
Midland Texas 79701
Telephone 915 682 8631

Case 5616



December 18, 1975

Mr. Joe D. Ramey
New Mexico Oil Conservation Commission
P. O. Box 2088
Santa Fe, New Mexico



Re: William H. Harrison "A" WN No. 2
Unorthodox Location
Jalmat Gas Pool
Lea County, New Mexico
660' FNL & 660' FWL
Section 29, T-24S, R-37E

Dear Mr. Ramey:

Atlantic Richfield Company requests administrative approval of an unorthodox location for the William H. Harrison "A" WN No. 2 well which has recently been plugged and abandoned in the Langlie Mattix and recompleted in the Jalmat Gas Pool. The well was originally completed open hole in the Langlie Mattix in February 1937, at an orthodox location, 660' FNL and 660' FWL, Section 29, T-24S, R-37E. The well location complies with New Mexico Oil Conservation Commission Statewide Rule 104-F and qualifies for administrative approval.

The well is located within an approved 320-acre non-standard Jalmat Gas Proration Unit and simultaneous dedication of acreage is being applied for in another application. However, approval of this request for unorthodox location is in the interest of conservation, will protect correlative rights, and will allow for more complete recovery of Jalmat gas reserves. Your prompt consideration and approval would be appreciated as a recompletion has been successful and the well has flowed 800 MCFD.

Attached are a map showing offset operators, a well location, and acreage dedication plat, and a list of offset operators. In addition, offset operators have been notified of and provided with this application as required by Statewide Rule No. 104.

Very truly yours,

J. L. Tweed
J. L. Tweed

RSP/agp

Case 5616

Offset Operators
W. H. Harrison Lease
W/2 Sec. 29, T-24S, R-37E
Lea County, New Mexico

APCO Oil Company
P. O. Box 1027
Odessa, Texas 79760

Cities Service Oil Company
P. O. Box 1919
Midland, Texas 79701

Conoco
P. O. Box 460
Hobbs, New Mexico 79701

Gulf Energy & Minerals Company - US
P. O. Box 1150
Midland, Texas 79701

Reserve Oil & Gas
201 First Savings Bldg.
Midland, Texas 79701

Union Texas Petroleum
1300 Wilco Bldg.
Midland, Texas 79701

Wiser Oil Company
P. O. Box 2467
Hobbs, New Mexico

Case 5616

NEW MEXICO OIL CONSERVATION COMMISSION
WELL LOCATION AND ACREAGE DEDICATION PLAT

Form C-102
Supersedes C-128
Effective 1-1-65

All distances must be from the outer boundaries of the Section.

Operator Atlantic Richfield Company			Lease William H. Harrison A WN		Well No. 2
Unit Letter D	Section 29	Township 24 South	Range 37 East	County Lea	
Actual Footage Location of Well:					
660 feet from the North line and		660 feet from the West line			
Ground Level Elev. 3290'	Producing Formation Seven Rivers	Pool Jalmat Gas	Dedicated Acreage: 320 Acres		

- Outline the acreage dedicated to the subject well by colored pencil or hachure marks on the plat below.
- If more than one lease is dedicated to the well, outline each and identify the ownership thereof (both as to working interest and royalty).
- If more than one lease of different ownership is dedicated to the well, have the interests of all owners been consolidated by communitization, unitization, force-pooling, etc?

☒ Yes ☐ No If answer is "yes," type of consolidation Communitization

If answer is "no," list the owners and tract descriptions which have actually been consolidated. (Use reverse side of this form if necessary.)

No allowable will be assigned to the well until all interests have been consolidated (by communitization, unitization, forced-pooling, or otherwise) or until a non-standard unit, eliminating such interests, has been approved by the Commission.

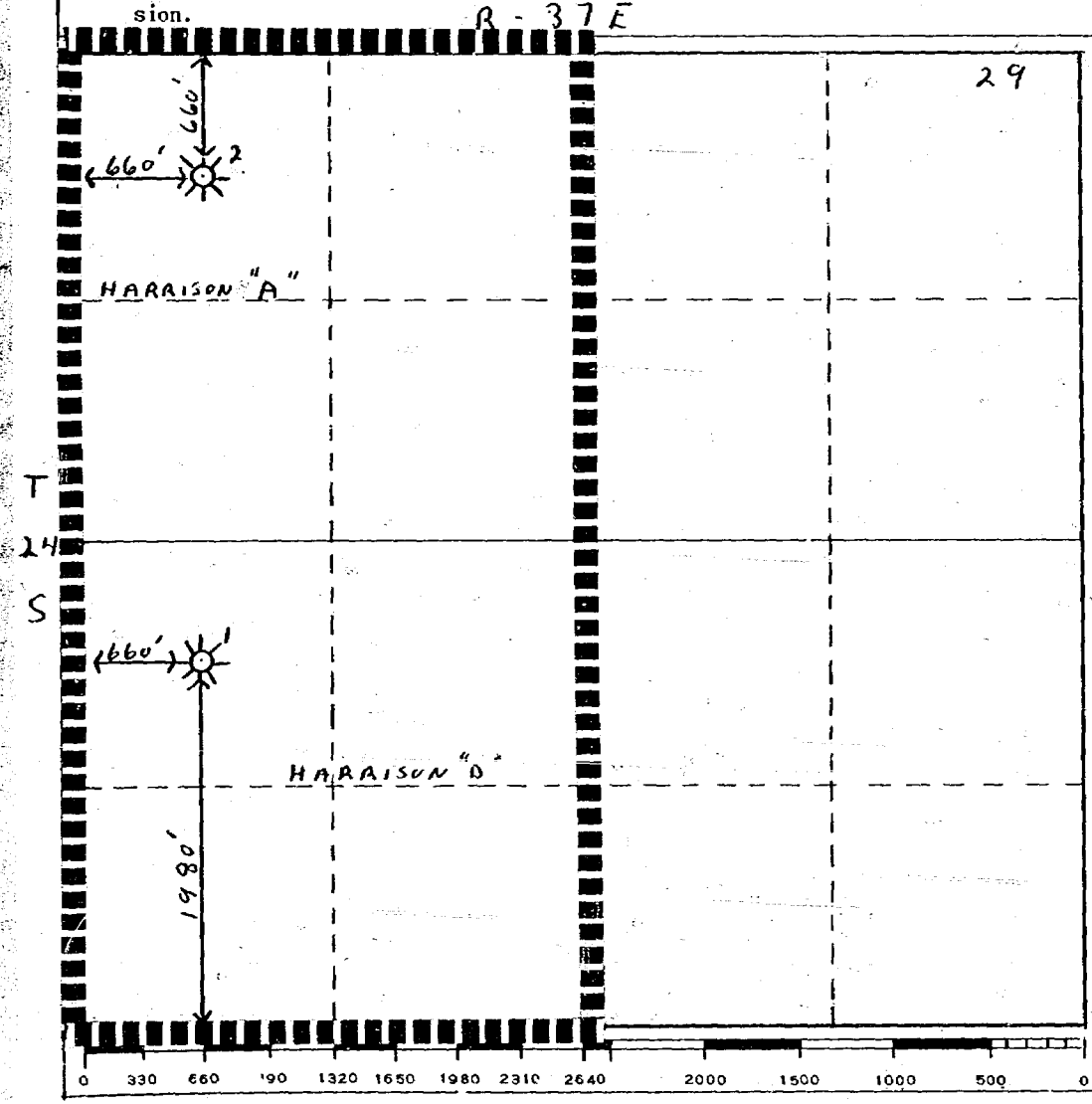

CERTIFICATION	
I hereby certify that the information contained herein is true and complete to the best of my knowledge and belief.	
Name	<u>Richard S. Prentice</u>
Position	<u>Operations Engineer</u>
Company	<u>Atlantic Richfield Company</u>
Date	<u>December 18, 1975</u>
I hereby certify that the well location shown on this plat was plotted from field notes of actual surveys made by me or under my supervision, and that the same is true and correct to the best of my knowledge and belief.	
Date Surveyed	
Registered Professional Engineer and/or Land Surveyor	
Certificate No.	

The map displays the following units and fields:

- CONOCO LANGLEIE JACK UNIT**
- AMERADA LANGLEIE MATTIX WOOLWORTH UNIT**
- UNION OF TEXAS LANGLEIE JAL UNIT**

Other labeled areas include:

- Continental "Jack" A.R.Co.
- Cities Service O.R. Shell G.R. A.R.Co.
- Pon American "B" "Meyer"
- Texaco
- A.R.Co.
- Shell El Paso Nat G/R
- G. L. Buckles
- R. Cleveland
- W. H. Harrison
- James Thomas
- Amerada "Faiby" A.R.Co.
- U.S.
- Texaco "B"
- "Fristoe" A.R.Co.
- U.S.
- Gulf
- A.R.Co.
- C. O. Woolworth
- Reserve O.B.G. "B"
- APCO
- State

The map includes a scale bar (0 to 10 miles) and a north arrow. The title "W. H. HARRISON AREA" is prominently displayed at the bottom.

Atlantic Richfield Company
 1000 West 10th Street, Suite 1000
 Denver, Colorado 80202-1500

W. H. HARRISON AREA

LEA COUNTY, NEW MEXICO
1320 2640

P	JL THREE	THREE	10-5-7
X	10-5-7	THREE	1
X	WEST ENG	THREE	1

Atlantic Richfield Company

North American Producing Division
Permian District
Post Office Box 1610
Midland, Texas 79701
Telephone 915 682 8631

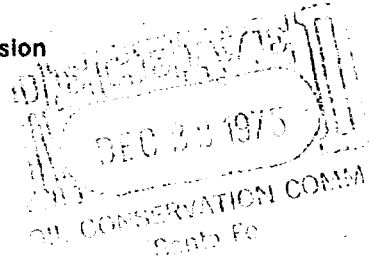

Case 5616



December 18, 1975

Mr. Joe D. Ramey
New Mexico Oil Conservation Commission
P. O. Box 2088
Santa Fe, New Mexico

Re: William H. Harrison "A" WN No. 2
Unorthodox Location
Jalmat Gas Pool
Lea County, New Mexico
660' FNL & 660' FWL
Section 29, T-24S, R-37E

Dear Mr. Ramey:

Atlantic Richfield Company requests administrative approval of an unorthodox location for the William H. Harrison "A" WN No. 2 well which has recently been plugged and abandoned in the Langlie Mattix and recompleted in the Jalmat Gas Pool. The well was originally completed open hole in the Langlie Mattix in February 1937, at an orthodox location, 660' FNL and 660' FWL, Section 29, T-24S, R-37E. The well location complies with New Mexico Oil Conservation Commission Statewide Rule 104-F and qualifies for administrative approval.

The well is located within an approved 320-acre non-standard Jalmat Gas Proration Unit and simultaneous dedication of acreage is being applied for in another application. However, approval of this request for unorthodox location is in the interest of conservation, will protect correlative rights, and will allow for more complete recovery of Jalmat gas reserves. Your prompt consideration and approval would be appreciated as a recompletion has been successful and the well has flowed 800 MCFD.

Attached are a map showing offset operators, a well location, and acreage dedication plat, and a list of offset operators. In addition, offset operators have been notified of and provided with this application as required by Statewide Rule No. 104.

Very truly yours,

J. L. Tweed
J. L. Tweed

RSP/agp

Offset Operators
W. H. Harrison Lease
W/2 Sec. 29, T-24S, R-37E
Lea County, New Mexico

APCO Oil Company
P. O. Box 1027
Odessa, Texas 79760

Cities Service Oil Company
P. O. Box 1919
Midland, Texas 79701

Conoco
P. O. Box 460
Hobbs, New Mexico

Gulf Energy & Minerals Company - US
P. O. Box 1150
Midland, Texas 79701

Reserve Oil & Gas
201 First Savings Bldg.
Midland, Texas 79701

Union Texas Petroleum
1300 Wilco Bldg.
Midland, Texas 79701

Wiser Oil Company
P. O. Box 2467
Hobbs, New Mexico

NEW MEXICO OIL CONSERVATION COMMISSION
WELL LOCATION AND ACREAGE DEDICATION PLAT

Form C-102
Supersedes C-128
Effective 1-1-65

All distances must be from the outer boundaries of the Section.

Operator Atlantic Richfield Company		Lease William H. Harrison A WN		Well No. 2
Unit Letter D	Section 29	Township 24 South	Range 37 East	County Lea
Actual Footage Location of Well:				
660 feet from the North line and		660 feet from the West line		
Ground Level Elev: 3290'	Producing Formation Seven Rivers	Pool Jalmat Gas	Dedicated Acreage: 320 Acres	

1. Outline the acreage dedicated to the subject well by colored pencil or hachure marks on the plat below.
2. If more than one lease is dedicated to the well, outline each and identify the ownership thereof (both as to working interest and royalty).
3. If more than one lease of different ownership is dedicated to the well, have the interests of all owners been consolidated by communitization, unitization, force-pooling, etc?

☒ Yes ☐ No If answer is "yes," type of consolidation Communitization

If answer is "no," list the owners and tract descriptions which have actually been consolidated. (Use reverse side of this form if necessary.)

No allowable will be assigned to the well until all interests have been consolidated (by communitization, unitization, forced-pooling, or otherwise) or until a non-standard unit, eliminating such interests, has been approved by the Commission.

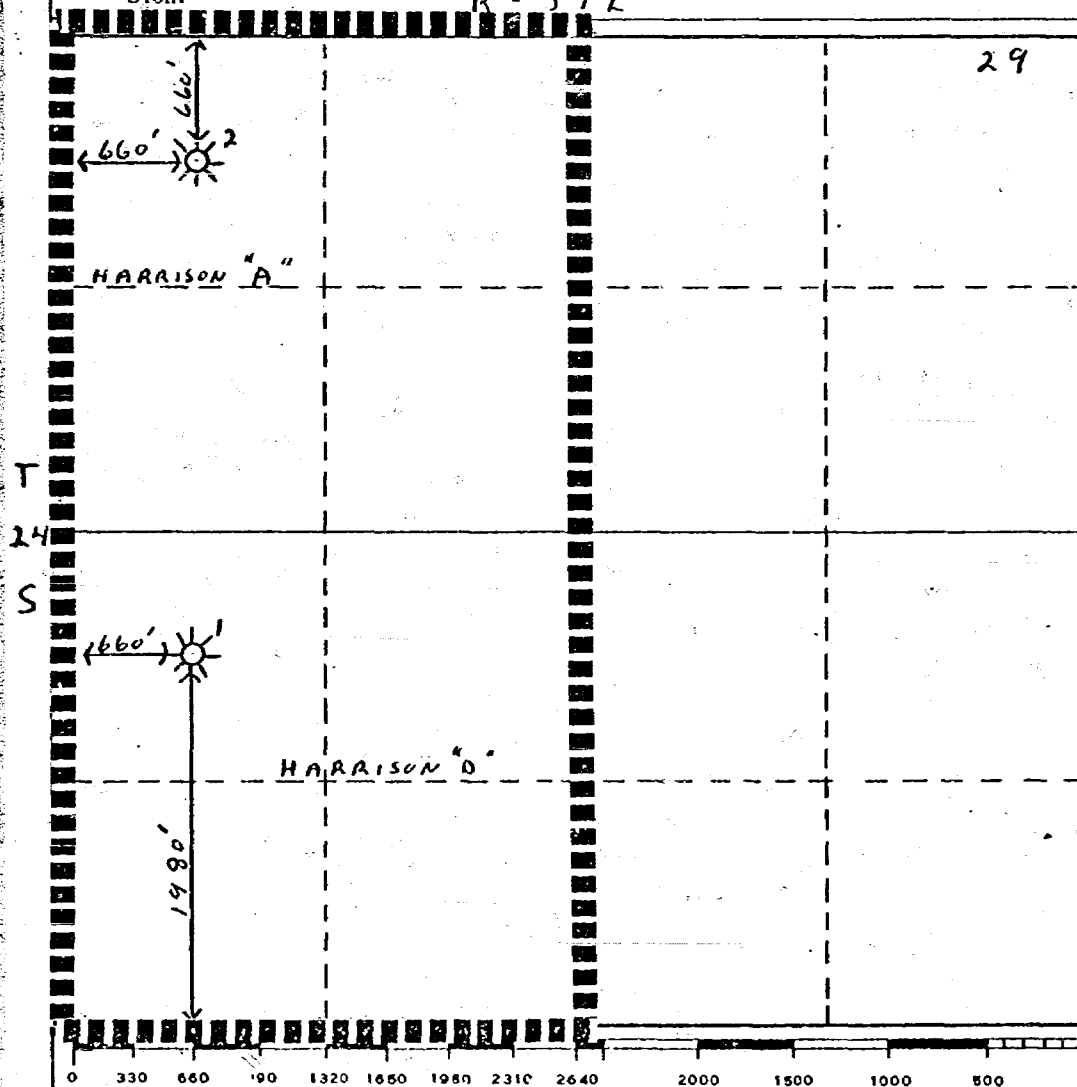

CERTIFICATION

I hereby certify that the information contained herein is true and complete to the best of my knowledge and belief.

Name Richard S. Prentice

Richard S. Prentice

Position

Operations Engineer

Company

Atlantic Richfield Company

Date

December 18, 1975

I hereby certify that the well location shown on this plat was plotted from field notes of actual surveys made by me or under my supervision, and that the same is true and correct to the best of my knowledge and belief.

Date Surveyed

Registered Professional Engineer and/or Land Surveyor

Certificate No.

Case 5616

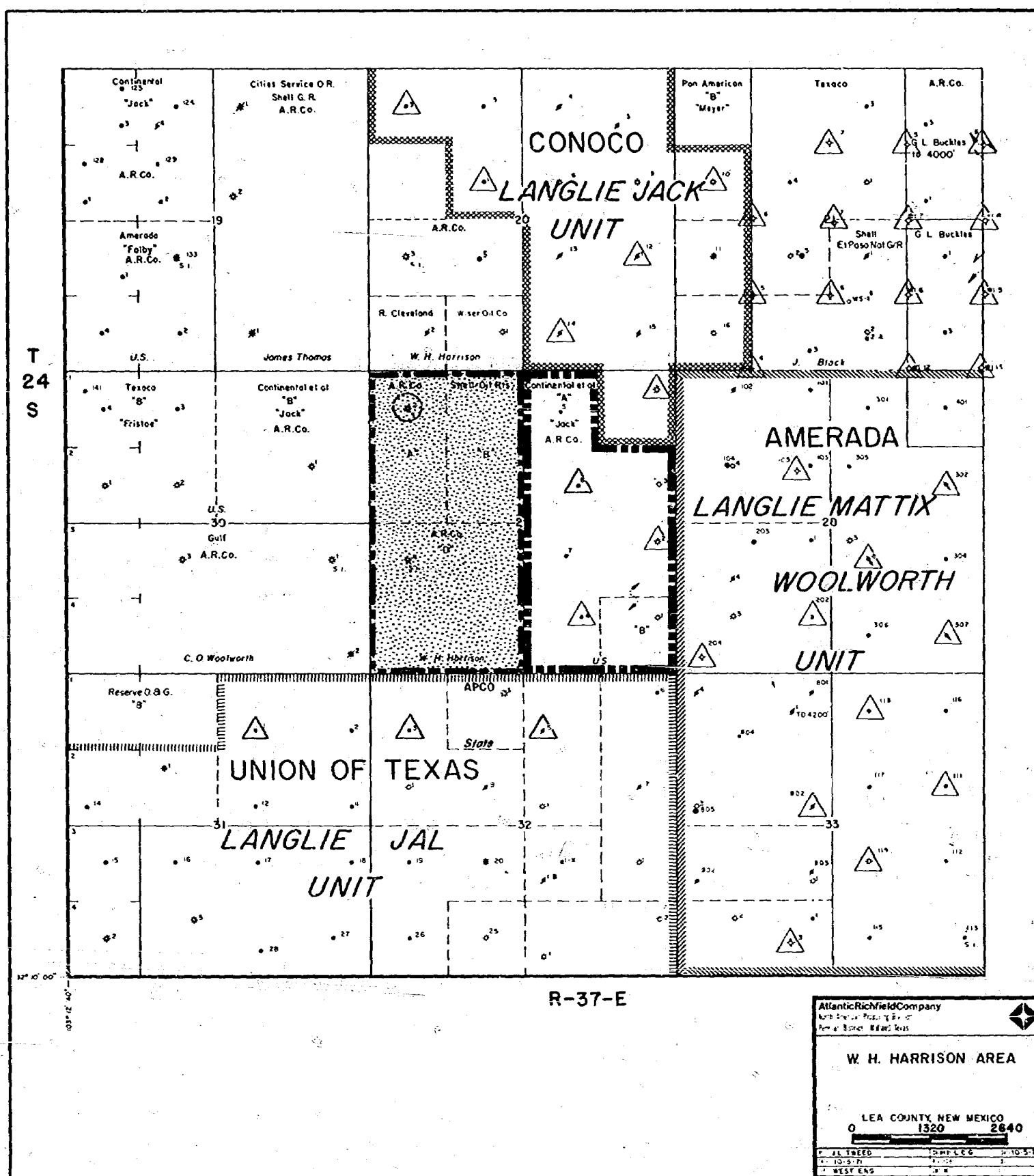

Atlantic Richfield Company

North American Producing Division
Permian District
Post Office Box 1610
Midland, Texas 79701
Telephone 915 682 8631

Case 5616

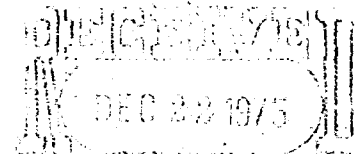

OIL CONSERVATION COMM.

December 18, 1975

Mr. Joe D. Ramey
New Mexico Oil Conservation Commission Santa Fe
P. O. Box 2088
Santa Fe, New Mexico

Re: William H. Harrison "A" WN No. 2
Unorthodox Location
Jalmat Gas Pool
Lea County, New Mexico
660' FNL & 660' FWL
Section 29, T-24S, R-37E

Dear Mr. Ramey:

Atlantic Richfield Company requests administrative approval of an unorthodox location for the William H. Harrison "A" WN No. 2 well which has recently been plugged and abandoned in the Langlie Mattix and recompleted in the Jalmat Gas Pool. The well was originally completed open hole in the Langlie Mattix in February 1937, at an orthodox location, 660' FNL and 660' FWL, Section 29, T-24S, R-37E. The well location complies with New Mexico Oil Conservation Commission Statewide Rule 104-F and qualifies for administrative approval.

The well is located within an approved 320-acre non-standard Jalmat Gas Proration Unit and simultaneous dedication of acreage is being applied for in another application. However, approval of this request for unorthodox location is in the interest of conservation, will protect correlative rights, and will allow for more complete recovery of Jalmat gas reserves. Your prompt consideration and approval would be appreciated as a recompletion has been successful and the well has flowed 800 MCFD.

Attached are a map showing offset operators, a well location, and acreage dedication plat, and a list of offset operators. In addition, offset operators have been notified of and provided with this application as required by Statewide Rule No. 104.

Very truly yours,

J. L. Tweed
J. L. Tweed

RSP/agp

Offset Operators
W. H. Harrison Lease
W/2 Sec. 29, T-24S, R-37E
Lea County, New Mexico

APCO Oil Company
P. O. Box 1027
Odessa, Texas 79760

Cities Service Oil Company
P. O. Box 1919
Midland, Texas 79701

Conoco
P. O. Box 460
Hobbs, New Mexico

Gulf Energy & Minerals Company - US
P. O. Box 1150
Midland, Texas 79701

Reserve Oil & Gas
201 First Savings Bldg.
Midland, Texas 79701

Union Texas Petroleum
1300 Wilco Bldg.
Midland, Texas 79701

Wiser Oil Company
P. O. Box 2467
Hobbs, New Mexico

NEW MEXICO OIL CONSERVATION COMMISSION
WELL LOCATION AND ACREAGE DEDICATION PLAT

All distances must be from the outer boundaries of the Section.

Operator Atlantic Richfield Company		Lease William H. Harrison A WN		Well No. 2
Unit Letter D	Section 29	Township 24 South	Range 37 East	County Lea
Actual Footage Location of Well: 660 feet from the		line and Pool 660 feet from the West		
Ground Level Elev. 3290'		Producing Formation Seven Rivers		
		Dedicated Acreage: 320 Acres		

1. Outline the acreage dedicated to the subject well by colored pencil or hachure marks on the plat below.
2. If more than one lease is dedicated to the well, outline each and identify the ownership thereof (both as to working interest and royalty).
3. If more than one lease of different ownership is dedicated to the well, have the interests of all owners been consolidated by communitization, unitization, force-pooling, etc?
☒ Yes ☐ No If answer is "yes," type of consolidation Communitization

If answer is "no," list the owners and tract descriptions which have actually been consolidated. (Use reverse side of this form if necessary.)
No allowable will be assigned to the well until all interests have been consolidated (by communitization, unitization, forced-pooling, or otherwise) or until a non-standard unit, eliminating such interests, has been approved by the Commission.

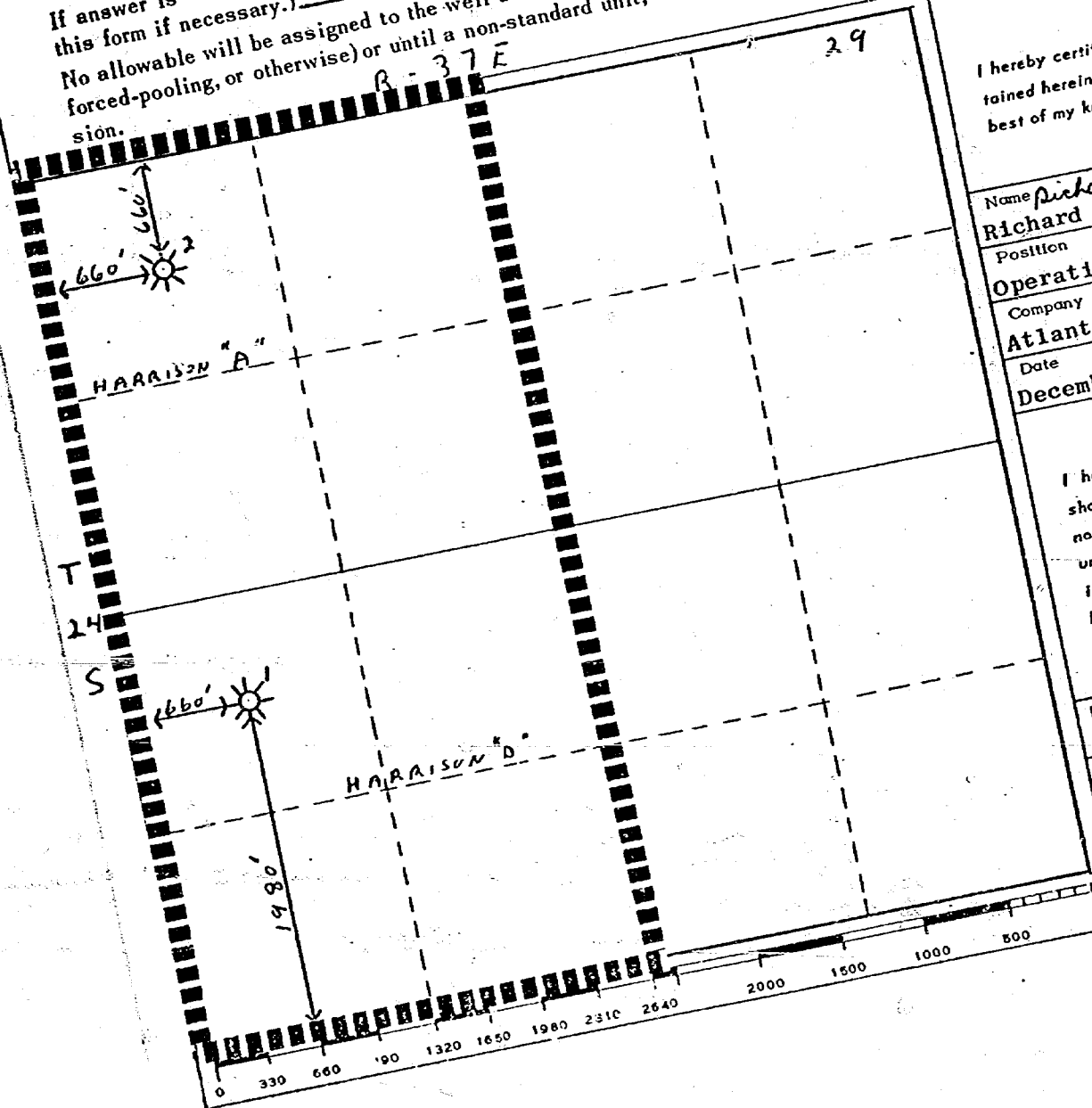

CERTIFICATION

I hereby certify that the information contained herein is true and complete to the best of my knowledge and belief.

Name Richard S. Prentice
Position Operations Engineer
Company Atlantic Richfield Company
Date December 18, 1975

I hereby certify that the well location shown on this plat was plotted from field notes of actual surveys made by me or under my supervision, and that the same is true and correct to the best of my knowledge and belief.

Date Surveyed
Registered Professional Engineer and/or Land Surveyor

Certificate No.

Case 5616

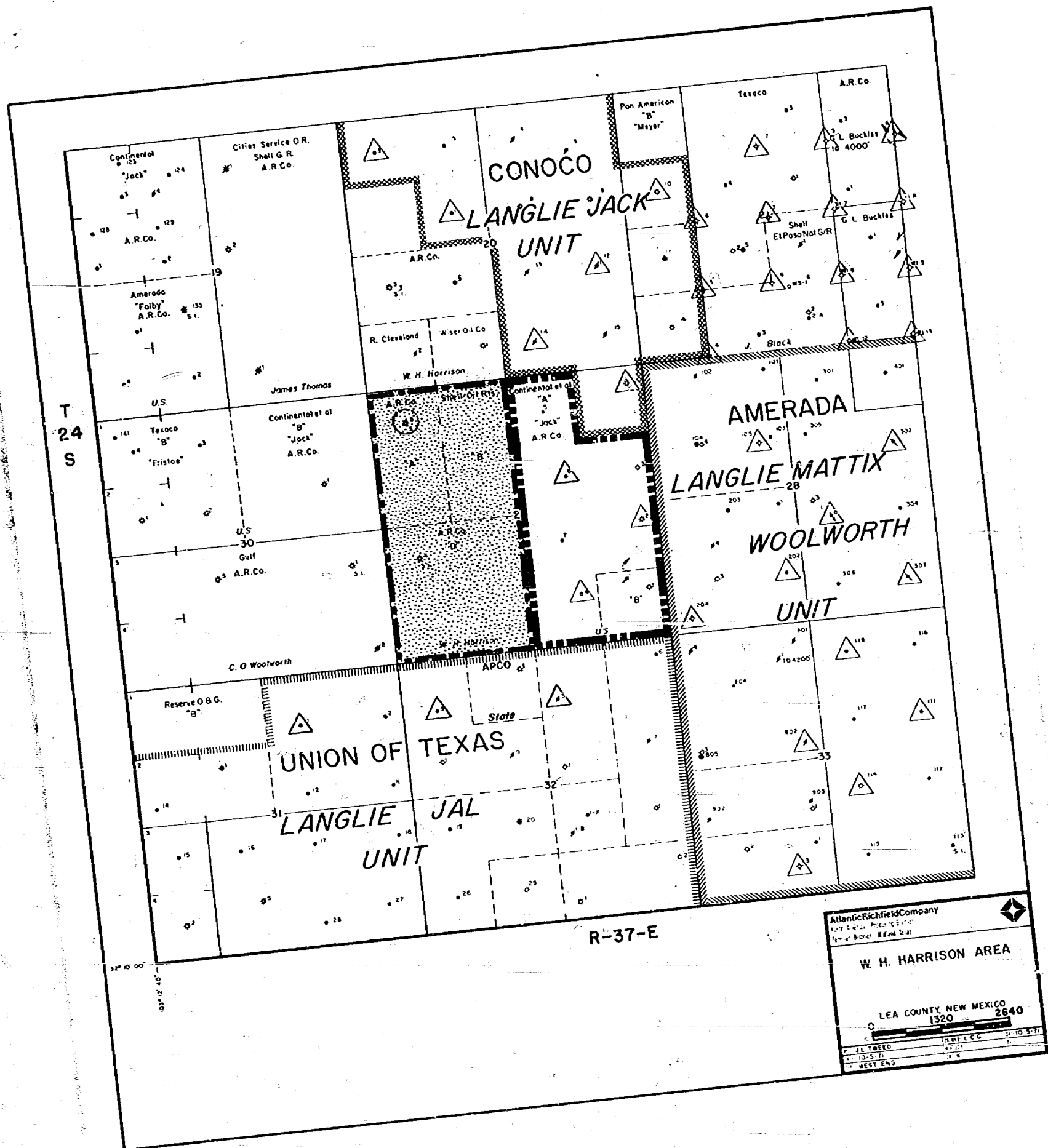

DRAFT

jr

BEFORE THE OIL CONSERVATION COMMISSION
OF THE STATE OF NEW MEXICO

IN THE MATTER OF THE HEARING
CALLED BY THE OIL CONSERVATION
COMMISSION OF NEW MEXICO FOR
THE PURPOSE OF CONSIDERING:

CASE NO. 5616

Order No. R- 5160

APPLICATION OF ATLANTIC RICHFIELD
COMPANY FOR AN UNORTHODOX GAS WELL
LOCATION AND SIMULTANEOUS DEDICATION,
LEA COUNTY, NEW MEXICO.

ORDER OF THE COMMISSION

BY THE COMMISSION:

This cause came on for hearing at 9 a.m. on January 20,
19 76, at Santa Fe, New Mexico, before Examiner Daniel S. Nutter.

NOW, on this February day of January, 19 76, the Commission,
a quorum being present, having considered the testimony, the record,
and the recommendations of the Examiner, and being fully advised
in the premises,

FINDS:

(1) That due public notice having been given as required by
law, the Commission has jurisdiction of this cause and the subject
matter thereof.

(2) That the applicant, Atlantic Richfield Company, seeks
authority to simultaneously dedicate a previously approved 320-acre
non-standard gas proration unit comprising the W/2 of Section 29,
Township 24 South, Range 37 East, Jalmat Gas Pool, Lea County, New
Mexico, to its W. H. Harrison "D" WN Com Well No. 1, located in
Unit L of said Section 29 and its W. H. Harrison "A" WN Well No. 2,
at an unorthodox location 660 feet from the North and West lines
of said Section 29.

-2-

Case No. 5616

Order No. R-

(3) That the W/2 of said Section 29 is to be dedicated to the wells.

~~(4) That a well at said unorthodox location will better enable applicant to produce the gas underlying the proration unit.~~

(4) That no offset operator objected to the proposed unorthodox location.

(5) That approval of the subject application will afford the applicant the opportunity to produce its just and equitable share of the gas in the subject pool, will prevent the economic loss caused by the drilling of unnecessary wells, avoid the augmentation of risk arising from the drilling of an excessive number of wells, and will otherwise prevent waste and protect correlative rights.

IT IS THEREFORE ORDERED:

(1) That Atlantic Richfield Company is hereby authorized to simultaneously dedicate a previously approved 320-acre non-standard gas proration unit (comprising the W/2 of Section 29, Township 24 South, Range 37 East, Jalmat Gas Pool, Lea County, New Mexico, to its W. H. Harrison "D" WN Com Well No. 1, located in Unit L of said Section 29 and its W. H. Harrison "A" WN Well No. 2, at an unorthodox location 660 feet from the North and West lines of said Section 29.

(2) That the W/2 of said Section 29 shall be dedicated to the above-described well.

(3) That jurisdiction of this cause is retained for the entry of such further orders as the Commission may deem necessary.

DONE at Santa Fe, New Mexico, on the day and year hereinabove designated.

(3) That Administrative Order NSP-748 is hereby superseded.

(4) That Administrative Order NSP-749, which originally approved the subject 320-acre non-standard