

CASE 5856: AMOCO PRODUCTION COMPANY
FOR AN UNORTHODOX GAS WELL LOCATION,
SAN JUAN COUNTY, NEW MEXICO

CASE NO.

5856

APPLICATION,
TRANSCRIPTS,
SMALL EXHIBITS,
ETC.



OIL CONSERVATION COMMISSION

STATE OF NEW MEXICO
P. O. BOX 2088 - SANTA FE
87501



DIRECTOR
JOE D. RAMEY

LAND COMMISSIONER
PHIL R. LUCERO
March 16, 1977

STATE GEOLOGIST
EMERY C. ARNOLD

Mr. Gordon Ryan
Amoco Production Company
3101 Security Life Building
Denver, Colorado 80202

Re: CASE NO. 5856
ORDER NO. R-5385

Applicant:

Amoco Production Company

Dear Sir:

Enclosed herewith are two copies of the above-referenced Commission order recently entered in the subject case.

Yours very truly,

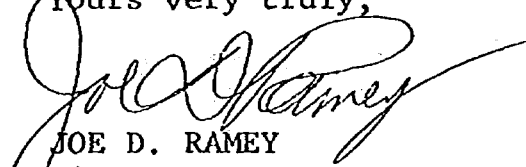
JOE D. RAMEY
Director

JDR/fd

Copy of order also sent to:

Hobbs OCC	<u>x</u>
Artesia OCC	<u>x</u>
Aztec OCC	<u>x</u>

Other _____

BEFORE THE OIL CONSERVATION COMMISSION
OF THE STATE OF NEW MEXICO

IN THE MATTER OF THE HEARING
CALLED BY THE OIL CONSERVATION
COMMISSION OF NEW MEXICO FOR
THE PURPOSE OF CONSIDERING:

CASE NO. 5856
Order No. R-5385

APPLICATION OF AMOCO PRODUCTION COMPANY
FOR AN UNORTHODOX GAS WELL LOCATION,
SAN JUAN COUNTY, NEW MEXICO.

ORDER OF THE COMMISSION

BY THE COMMISSION:

This cause came on for hearing at 9 a.m. on February 16, 1977, at Santa Fe, New Mexico, before Examiner Richard L. Stamets.

NOW, on this 15th day of March, 1977, the Commission, a quorum being present, having considered the testimony, the record, and the recommendations of the Examiner, and being fully advised in the premises,

FINDS:

(1) That due public notice having been given as required by law, the Commission has jurisdiction of this cause and the subject matter thereof.

(2) That the applicant, Amoco Production Company, seeks approval of an unorthodox gas well location for its Elliott Gas Com "F" Well No. 1A drilled at a point 1244 feet from the South line and 820 feet from the East line of Section 33, Township 30 North, Range 9 West, NMPM, to test the Mesaverde formation, Blanco Mesaverde Pool, San Juan County, New Mexico.

(3) That the E/2 of said Section 33 is dedicated to the well.

(4) That said unorthodox location resulted from an error in surveying.

(5) That no offset operator objected to the proposed unorthodox location.

-2-

Case No. 5856
Order No. R-5385

(6) That approval of the subject application will afford the applicant the opportunity to produce its just and equitable share of the gas in the subject pool, will prevent the economic loss caused by the drilling of unnecessary wells, avoid the augmentation of risk arising from the drilling of an excessive number of wells, and will otherwise prevent waste and protect correlative rights.

IT IS THEREFORE ORDERED:

(1) That an unorthodox gas well location for the Mesaverde formation is hereby approved for the Amoco Production Company Elliott Gas Com "F" Well No. 1A drilled at a point 1244 feet from the South line and 820 feet from the East line of Section 33, Township 30 North, Range 9 West, NMPM, Blanco Mesaverde Pool, San Juan County, New Mexico.

(2) That the E/2 of said Section 33 shall be dedicated to the above-described well.

(3) That jurisdiction of this cause is retained for the entry of such further orders as the Commission may deem necessary.

DONE at Santa Fe, New Mexico, on the day and year hereinabove designated.

STATE OF NEW MEXICO
OIL CONSERVATION COMMISSION

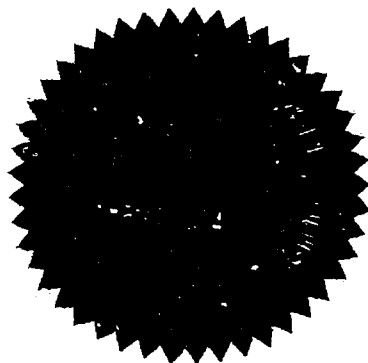

PHIL R. LUCERO, Chairman

Emery C. Arnold
EMERY C. ARNOLD, Member

Joe D. Ramey
JOE D. RAMEY, Member & Secretary

S E A L

dr/

Blanco

GATHERING SYSTEM

Line Amoco Prod. Co. ~ Elliot Gas Com. F No. 1A

From 0+00 = 16+46.4 On Well Tie To Amoco ~ Elliot Gas

Unit "N" No. 1 (BTE-26-1)

County San Juan

State New Mexico

Section 33

Township 30-N

Range 9-W

Dwg No. BTE-51-1

WO No.

RW No. 76046

Date 12-2-76

Scale 1" = 100'

Surveyed 11-24-76

N

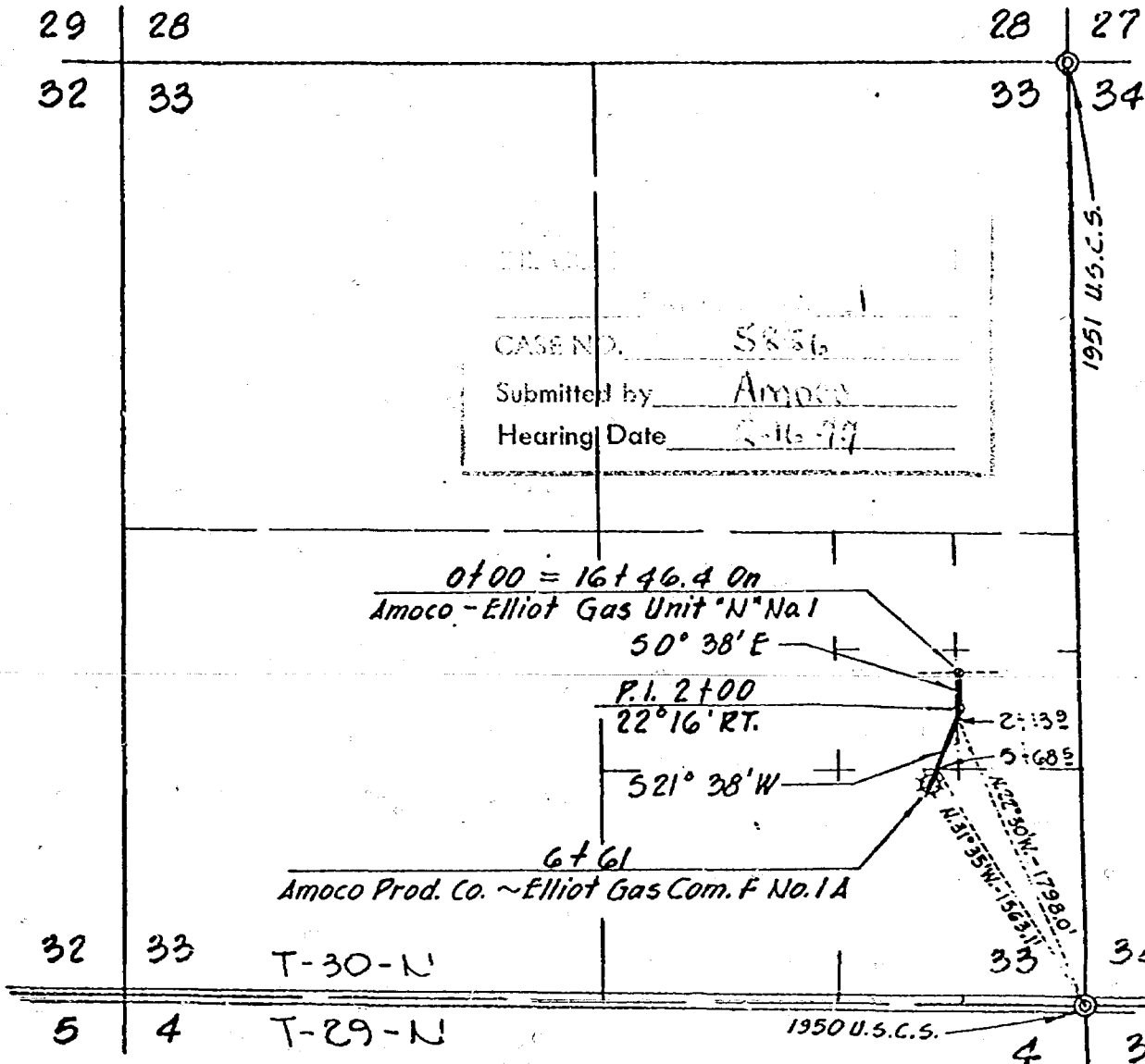

Dwn By *[Signature]*
Ckd By *[Signature]*

Constr. Commenced: _____
Constr. Completed: _____

Appl. Dwg. _____
Date _____

Pipe Size 4 1/2" O.D.

PRINT RECORD		PIPE DATA		METER STA. NO. (M.V.)	
6	R/W 12-1-76				
1	EX. N. 12-13-76				
10	R/W				
9	R.C.				
1	R.W.C.				
SUBDIVISION		OWNER	LESSEE	RODS	
SE 1/4 NE 1/4	SEC. 33	FRED L. LAWSON, et al.	Heirs of John Lynn	12.964	
SW 1/4 NE 1/4	SEC. 33	J.W. WILKINSON, et al.	LAWSON	21.491	
SE 1/4	SEC. 33	GENEVIVE JAQUEZ		5.606	

BART This is EPN's PLAT OF PIPELINE RIGHTAWAY
The red line is the line necessary to connect
The Elliott Gasline F(R) #1A into the sales line
[Signature]

R9W

AMOCO 50%
ELLIOTT G. C. "G"

AMOCO 99%
ELLIOTT G. C. "F"

AMOCO 100%
ELLIOTT G. C. "E"

LEGEND

- AUTHORIZED BUT NOT DRILLED
- ☼ DRILLED BUT NOT ON LINE
- ☼ PRODUCING WELL

— UNIT OUTLINE

T
30
N

AMOCO 100%
LIKINS G. C. "A"

BEFORE EXAMINER STATES
OF CONSERVATION COMMISSION

EXHIBIT NO. 2

CASE NO. 5856

Submitted by Ameco

Hearing Date 2-16-77

AMOCO 100%
JAQUEZ G. C. "B"

AMOCO 100%
GUTIERREZ G. C.

AMOCO 95%
LOBATO G. C. "A"

AMOCO 100%
CHAVEZ G. C. "A"

T
29
N

BLANCO MESAVERDE
SAN JUAN CO., NEW MEXICO
SCALE. 4"=1 MI.

☼ 1A

☼ 1

☼ 1A

☼ 1

☼ 1

☼ 1

☼ 1

☼ 1A

☼ 1A

☼ 1

○ 1A

☼ 1

☼ 1

☼ 1

○ 1A

○ 1A

33

34

4

820'

1244'

Dockets Nos. 8-77 and 9-77 are tentatively set for hearing on March 9 and March 23, 1977. Applications for hearing must be filed at least 22 days in advance of hearing date.

DOCKET: EXAMINER HEARING - FRIDAY - FEBRUARY 11, 1977

9 A.M. - OIL CONSERVATION COMMISSION CONFERENCE ROOM,
STATE LAND OFFICE BUILDING, SANTA FE, NEW MEXICO

The following case will be heard before Richard L. Stamets, Examiner, or Daniel S. Nutter, Alternate Examiner:

CASE 5872: In the matter of the hearing called by the Oil Conservation Commission on its own motion to consider the suspension of Rules 15(A) and 15(B) of the General Rules for Prorated Gas Pools as promulgated by Order No. R-1670, as amended, to permit overproduced wells to continue to produce gas during the present severe weather conditions without danger of being shut in for overproduction.

DOCKET: EXAMINER HEARING - WEDNESDAY - FEBRUARY 16, 1977

9 A.M. - OIL CONSERVATION COMMISSION CONFERENCE ROOM,
STATE LAND OFFICE BUILDING, SANTA FE, NEW MEXICO

The following cases will be heard before Richard L. Stamets, Examiner, or Daniel S. Nutter, Alternate Examiner:

- ALLOWABLE:
- (1) Consideration of the allowable production of gas for March, 1977, from seventeen prorated pools in Lea, Eddy, Chaves, and Roosevelt Counties, New Mexico.
 - (2) Consideration of the allowable production of gas for March, 1977, from four prorated pools in San Juan, Rio Arriba, and Sandoval Counties, New Mexico.
 - (3) Consideration of purchaser's nominations for the one-year period beginning April 1, 1977, for both of the above areas.

CASE 5856: Application of Amoco Production Company for an unorthodox gas well location, San Juan County, New Mexico. Applicant, in the above-styled cause, seeks approval for the unorthodox location of its Elliott Gas Com "F" 1-R Well No. 1A to be drilled 1244 feet from the South line and 820 feet from the East line of Section 33, Township 30 North, Range 9 West, Blanco Mesaverde Pool, San Juan County, New Mexico.

CASE 5857: Application of Union Oil Company of California for directional drilling, Lea County, New Mexico. Applicant, in the above-styled cause, seeks authority to re-enter its Pipeline Deep Unit Federal Well No. 3, the surface location of which is 1980 feet from the North and East lines of Section 7, Township 19 South, Range 34 East, Lea County, New Mexico, and to directionally drill said well in a southerly or easterly direction and complete it in the Morrow formation at a point no closer than 330 feet to the outer boundary of the proration unit, the E/2 of said Section 7.

CASE 5858: Application of Union Oil Company of California for 320-acre spacing, Lea County, New Mexico. Applicant, in the above-styled cause, seeks the adoption of 320-acre spacing and proration units for the North Quail Ridge-Morrow Gas Pool, Lea County, New Mexico. In the absence of objection, the Commission will adopt such 320-acre spacing.

CASE 5859: (This case will be continued and readvertised.)

Application of Caulkins Oil Company for downhole commingling, Rio Arriba County, New Mexico. Applicant, in the above-styled cause, seeks authority to commingle Basin-Dakota and Blanco-Mesaverde production in the wellbore of its Breech D Well No. 307 located in Unit M of Section 13, Township 26 North, Range 7 West, Rio Arriba County, New Mexico.

CASE 5860: Application of Rice Engineering & Operating, Inc. for salt water disposal, Lea County, New Mexico. Applicant, in the above-styled cause, seeks authority to dispose of produced salt water into the San Andres formation through the open hole interval from 4176 feet to 5500 feet of its Hobbs SWD Well No. P-16, located in Unit P of Section 16, Township 19 South, Range 38 East, Hobbs Field, Lea County, New Mexico.

ATWOOD, MALONE, MANN & COOTER
LAWYERS

JEFF D. ATWOOD [1883-1980]
ROSS L. MALONE [1910-1974]

P. O. DRAWER 700
SECURITY NATIONAL BANK BUILDING
ROSWELL, NEW MEXICO 88201
[505] 622-6221

February 2, 1977

CHARLES F. MALONE
RUSSELL D. MANN
PAUL A. COOTER
BOB F. TURNER
ROBERT A. JOHNSON
JOHN W. BASSETT
ROBERT E. SABIN
RUFUS E. THOMPSON
RALPH D. SHAMAS

Director
Oil Conservation Commission
State Land Office Building
Santa Fe, New Mexico 87501

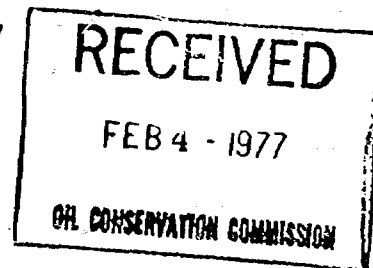

Re: Examiner hearing February 16, 1977

Dear Mr. Ramey:

Please file our enclosed Entry of Appearance
in behalf of Amoco Production Company in case no. 5856
for the February 16 Examiner hearing.

Thank you and with regards, I am,

Very truly yours,

A handwritten signature in dark ink, appearing to read "Charles F. Malone". The signature is fluid and cursive, with a long horizontal stroke at the end.

Charles F. Malone

CFM:1
Enc.

cc: Gordon Ryan, Esquire
Amoco Production Company
3101 Security Life Building
Denver, Colorado 80202
w/enc.

RECEIVED
FEB 4 9 13 AM '77
STATE LAND OFFICE
SANTA FE, N. M.

RECEIVED

FEB 4 - 1977

OIL CONSERVATION COMMISSION

BEFORE THE OIL CONSERVATION COMMISSION

STATE OF NEW MEXICO

IN THE MATTER OF THE APPLICATION)
OF AMOCO PRODUCTION COMPANY FOR)
UNORTHODOX LOCATION, NO. 1A ELLIOT)
GAS COM "F" 1-R WELL, BLANCO-MESA)
VERDE POOL, SAN JUAN COUNTY, NEW)
MEXICO.)

Case No. 5856

ENTRY OF APPEARANCE

The undersigned Atwood, Malone, Mann & Cooter, P.A.,
of Roswell, New Mexico, hereby enter their appearance herein
for the Applicant, Amoco Production Company, with Gordon Ryan,
Esquire of Denver, Colorado.

ATWOOD, MALONE, MANN & COOTER, P.A.

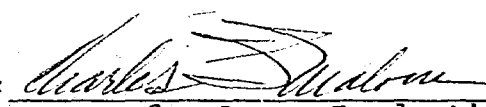
BY: 
Attorneys for Amoco Production
Company
Post Office Drawer 700
Roswell, New Mexico 88201

RECEIVED

FEB 4 9 13 AM '77

STATE LAND OFFICE
SANTA FE, N. M.



Amoco Production Company

Security Life Building
Denver, Colorado 80202

Case 5856

January 18, 1977

Joe D. Ramey (3)
New Mexico Energy Resources Board
c/o New Mexico Oil Conservation Commission
P. O. Box 2088
Santa Fe, New Mexico 87501

File: VDP-81-986.511

Dear Mr. Ramey:

Unorthodox Gas Well Location
Elliott Gas Com "F" 1-R Well #1A
Blanco Mesaverde Pool
San Juan County, New Mexico

Standard drilling locations in the Blanco Mesaverde Pool must be 130 feet from the interior edge and 790 feet from the exterior edge of each quarter quarter section.

Referring to the attached plat, Amoco, for its Elliott Gas Com "F" 1-R #1A well, in Unit P, Section 33-T30N-R9W, had received approval of a legal location staked 860 feet FEL and 1450 feet FSL of Section 33. We were drilling the well enroute to the Mesaverde, when El Paso Natural Gas, in the course of surveying a pipeline R-O-W, called to our attention that our well was not drilling at the location reported as the staked location. Immediately we had the location that was drilling resurveyed by another outside firm. El Paso was correct because the resurvey shows the well was drilling at a location 820 feet FEL and 1244 feet FSL of Section 33. The distance of 1244 feet FSL is closer than 130 feet to the interior edge of the well's quarter quarter section.

So we may produce this well from the Mesaverde when it becomes completed, we hereby request administrative approval for an unorthodox gas well location for this well in the Blanco Mesaverde Pool. The unorthodox move is only towards Amoco

*Ref for
Hearing
not eligible
for admin
approval*

Joe D. Ramey
January 18, 1977
Page 2

leaseholdings in Section 34. No notice to any other party
is necessary in this instance.

Yours very truly,

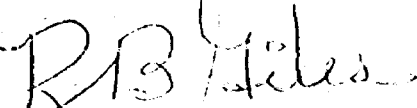

R. B. Giles

RBG:bp

Enclosure

cc: P. T. McGrath
U.S.G.S.
Box 959
Farmington, New Mexico 87401

A. L. Kendrick
Supervisor, District 3
New Mexico Oil Conservation Commission
1000 Rio Brazos Road
Aztec, New Mexico 87110

NEW MEXICO OIL CONSERVATION COMMISSION
WELL LOCATION AND ACREAGE DEDICATION PLAT

Form C-102
Supersedes C-128
Effective 1-1-65

All distances must be from the outer boundaries of the Section.

Operator Amoco Production Company			Lease Elliott Gas Com "F" 1-R		Well No. 1A
Unit Letter P	Section 33	Township 30N	Range 9W	County San Juan	
Actual Footage Location of Well: 1244 feet from the South line and 820 feet from the East line					
Ground Level Elev. 5681 Gr	Producing Formation Mesa Verde		Pool Blanco Mesaverde		Dedicated Acreage: 320 Acres

1. Outline the acreage dedicated to the subject well by colored pencil or hatchure marks on the plat below.
2. If more than one lease is dedicated to the well, outline each and identify the ownership thereof (both as to working interest and royalty).
3. If more than one lease of different ownership is dedicated to the well, have the interests of all owners been consolidated by communitization, unitization, force-pooling, etc?

☐ Yes ☐ No If answer is "yes," type of consolidation _____

If answer is "no," list the owners and tract descriptions which have actually been consolidated. (Use reverse side of this form if necessary.) _____

No allowable will be assigned to the well until all interests have been consolidated (by communitization, unitization, forced-pooling, or otherwise) or until a non-standard unit, eliminating such interests, has been approved by the Commission.

<p>This plat is of an existing well staked by others and reported: 1450' FSL and 860' FEL</p> <p style="text-align: center;">#1-R</p>	<p style="text-align: center;">Sec</p> <p style="text-align: center;">33</p>		<p style="text-align: right;">820'</p> <p style="text-align: right;">1244'</p>
<p style="text-align: center;">0 330 660 '90 1320 1650 1980 2310 2640 2000 1500 1000 500 0</p>			

CERTIFICATION

I hereby certify that the information contained herein is true and complete to the best of my knowledge and belief.

Name H. D. Montgomery

Position Area Engineer

Company AMOCO PRODUCTION COMPANY

Date January 11, 1977

I hereby certify that the well location shown on this plat was plotted from field notes of actual surveys made by me or under my supervision, and that the same is true and correct to the best of my knowledge and belief.

Date Surveyed January 6, 1977

Registered Professional Engineer and/or Land Surveyor
Fred B. Kerr Jr.

Certificate No. 3950

R9W

AMOCO 50%
ELLIOTT G. C. "G"

AMOCO 99%
ELLIOTT G. C. "F"

AMOCO 100%
ELLIOTT G. C. "E"

LEGEND

○ AUTHORIZED BUT
NOT DRILLED

☼ DRILLED BUT NOT
ON LINE

☼ PRODUCING WELL

— UNIT OUTLINE

☼ 1A

☼ 1

☼ 1A

☼ 1

33

24

T
30
N

AMOCO 100%
LIKINS G. C. "A"

☼ 1A

☼ 1

820'
1244'

☼ 1

AMOCO 100%
JAQUEZ G. C. "B"

AMOCO 100%
GUTIERREZ G. C.

AMOCO 95%
LOBATO G. C. "A"

AMOCO 100%
CHAVEZ G. C. "A"

☼ 1A

☼ 1

○ 1A

☼ 1

4

T
29
N

☼ 1

☼ 1

○ 1A

⊕ 1A

BLANCO MESAVERDE
SAN JUAN CO., NEW MEXICO
SCALE: 4"=1 MI.



Amoco Production Company

Security Life Building
Denver, Colorado 80202

January 18, 1977

Joe D. Ramey (3)
New Mexico Energy Resources Board
c/o New Mexico Oil Conservation Commission
P. O. Box 2088
Santa Fe, New Mexico 87501

File: VDP-81-986.S11

Dear Mr. Ramey:

Unorthodox Gas Well Location
Elliott Gas Com "F" 1-R Well #1A
Blanco Mesaverde Pool
San Juan County, New Mexico

Standard drilling locations in the Blanco Mesaverde Pool must be 130 feet from the interior edge and 790 feet from the exterior edge of each quarter quarter section.

Referring to the attached plat, Amoco, for its Elliott Gas Com "F" 1-R #1A well, in Unit P, Section 33-T30N-R9W had received approval of a legal location staked 860 feet FEL and 1450 feet FSL of Section 33. We were drilling the well enroute to the Mesaverde, when El Paso Natural Gas, in the course of surveying a pipeline R-O-W, called to our attention that our well was not drilling at the location reported as the staked location. Immediately we had the location that was drilling resurveyed by another outside firm. El Paso was correct because the resurvey shows the well was drilling at a location 820 feet FEL and 1244 feet FSL of Section 33. The distance of 1244 feet FSL is closer than 130 feet to the interior edge of the well's quarter quarter section.

So we may produce this well from the Mesaverde when it becomes completed, we hereby request administrative approval for an unorthodox gas well location for this well in the Blanco Mesaverde Pool. The unorthodox move is only towards Amoco

Joe D. Ramey
January 18, 1977
Page 2

JAN 19 1977

leaseholdings in Section 34. No notice to any other party
is necessary in this instance.

Yours very truly,

R. H. Giles

R. H. Giles

REG:bp

Enclosure

cc: P. T. McGrath
U.S.G.S.
Box 959
Farmington, New Mexico 87401

A. L. Kendrick
Supervisor, District 3
New Mexico Oil Conservation Commission
1000 Rio Brazos Road
Aztec, New Mexico 87410

NEW MEXICO OIL CONSERVATION COMMISSION
WELL LOCATION AND ACREAGE DEDICATION PLAT

Form C-102
Supersedes C-128
Effective 1-1-65

All distances must be from the outer boundaries of the Section.

Operator Amoco Production Company		Lease Elliott Gas Com "F" 1-R		Well No. 1A
Unit Letter P	Section 33	Township 30N	Range 9W	County San Juan
Actual Footage Location of Well: 1244 feet from the South line and 820 feet from the East line				
Ground Level Elev. 5681 Or	Producing Formation Mesa Verde	Pool Blanco Mesaverde	Dedicated Acreage: 320 Acres	

1. Outline the acreage dedicated to the subject well by colored pencil or hachure marks on the plat below.
2. If more than one lease is dedicated to the well, outline each and identify the ownership thereof (both as to working interest and royalty).
3. If more than one lease of different ownership is dedicated to the well, have the interests of all owners been consolidated by communitization, unitization, force-pooling, etc?

☐ Yes ☐ No If answer is "yes," type of consolidation _____

If answer is "no," list the owners and tract descriptions which have actually been consolidated. (Use reverse side of this form if necessary.) _____

No allowable will be assigned to the well until all interests have been consolidated (by communitization, unitization, forced-pooling, or otherwise) or until a non-standard unit, eliminating such interests, has been approved by the Commission.

This plat is of an existing well staked by others and reported: 1150'FSL and 860'FEL			
		#1-R	
Sec		33	
		820'	
		1244'	

0 330 660 990 1320 1650 1980 2310 2640 2970 3300 3630 3960 4290 4620 4950 5280 5610 5940 6270 6600

CERTIFICATION

I hereby certify that the information contained herein is true and complete to the best of my knowledge and belief.

Name

H. D. Montgomery

Position

Area Engineer

Company

AMOCO PRODUCTION COMPANY

Date

January 11, 1977

I hereby certify that the well location shown on this plat was plotted from field notes of actual surveys made by me or under my supervision, and that the same is true and correct to the best of my knowledge and belief.

Date Surveyed

January 6, 1977

Registered Professional Engineer and/or Land Surveyor

Fred B. Kerr Jr.

Certificate No.

3950

R9W

AMOCO 50%
ELLIOTT G. C. "G"

AMOCO 99%
ELLIOTT G. C. "F"

AMOCO 100%
ELLIOTT G. C. "E"

LEGEND

○ AUTHORIZED BUT
NOT DRILLED

☼ DRILLED BUT NOT
ON LINE

☼ PRODUCING WELL

— UNIT OUTLINE

T
30
N

AMOCO 100%
LIKINS G. C. "A"

AMOCO 100%
JAQUEZ G. C. "B"

AMOCO 100%
GUTIERREZ G. C.

AMOCO 95%
LOBATO G. C. "A"

AMOCO 100%
CHAVEZ G. C. "A"

T
29
N

BLANCO MESAVERDE
SAN JUAN CO., NEW MEXICO
SCALE: 4"=1 MI.

☼ 1

☼ 1

☼ 1A

☼ 1A

33

24

820'
1244'

☼ 1A

☼ 1

☼ 1

☼ 1

☼ 1A

○ 1A

☼ 1

4

3

☼ 1

☼ 1

○ 1A

○ 1A

Shawing

OIL CONSERVATION COMMISSION
Albuquerque DISTRICTOIL CONSERVATION COMMISSION
BOX 2088
SANTA FE, NEW MEXICO

J. E. Kapteina

DATE Jan 21, 1977RE: Proposed MC _____
Proposed DHC _____
Proposed NSL ☒ _____
Proposed SWD _____
Proposed WFX _____
Proposed PMX _____

Gentlemen:

I have examined the application dated Jan 18, 1977
for the Amoco Prod. Co. Elliott Gas Com F #1A P. 33-20N.9W
Operator Lease and Well No. Unit, S-T-R

and my recommendations are as follows:

The first surveyor set his flag about
200 feet from the desired location through
error.Approve

Yours very truly,

AR Kendrick



Amoco Production Company

Security Life Building
Denver, Colorado 80202

January 18, 1977

Joe D. Ramey (3)
New Mexico Energy Resources Board
c/o New Mexico Oil Conservation Commission
P. O. Box 2088
Santa Fe, New Mexico 87501

File: VDP-81-986.511

Dear Mr. Ramey:

Unorthodox Gas Well Location
Elliott Gas Com "F" 1-R Well #1A
Blanco Mesaverde Pool
San Juan County, New Mexico



Standard drilling locations in the Blanco Mesaverde Pool must be 130 feet from the interior edge and 790 feet from the exterior edge of each quarter quarter section.

Referring to the attached plat, Amoco, for its Elliott Gas Com "F" 1-R #1A well, in Unit P, Section 33-T30N-R9W had received approval of a legal location staked 860 feet FEL and 1450 feet FSL of Section 33. We were drilling the well enroute to the Mesaverde, when El Paso Natural Gas, in the course of surveying a pipeline R-O-W, called to our attention that our well was not drilling at the location reported as the staked location. Immediately we had the location that was drilling resurveyed by another outside firm. El Paso was correct because the resurvey shows the well was drilling at a location 820 feet FEL and 1244 feet FSL of Section 33. The distance of 1244 feet FSL is closer than 130 feet to the interior edge of the well's quarter quarter section.

So we may produce this well from the Mesaverde when it becomes completed, we hereby request administrative approval for an unorthodox gas well location for this well in the Blanco Mesaverde Pool. The unorthodox move is only towards Amoco

Joe D. Nancy
January 18, 1977
Page 2

leaseholdings in Section 34. No notice to any other party
is necessary in this instance.

Yours very truly,

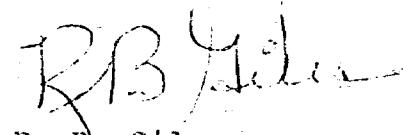

R. D. Giles

RBG:bp

Enclosure

cc: P. T. McGrath
U.S.G.S.
Box 959
Farmington, New Mexico 87401

A. L. Kendrick
Supervisor, District 3
New Mexico Oil Conservation Commission
1000 Rio Brazos Road
Aztec, New Mexico 87110

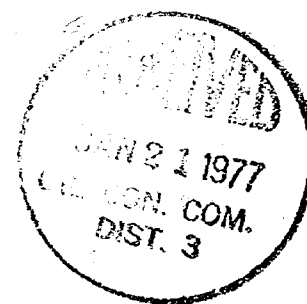

NEW MEXICO OIL CONSERVATION COMMISSION
WELL LOCATION AND ACREAGE DEDICATION PLAT

Form C-102
Supersedes C-128
Effective 1-1-65

All distances must be from the outer boundaries of the Section.

Operator Amoco Production Company			Lease Elliott Gas Com "F" 1-R		Well No. 1A
Unit Letter P	Section 33	Township 30N	Range 9W	County San Juan	
Actual Footage Location of Well: 1244 feet from the South line and 820 feet from the East line					
Ground Level Elev. 5681 Gr	Producing Formation Mesa Verde		Pool Blanco Mesaverde		Dedicated Acreage: 320 Acres

1. Outline the acreage dedicated to the subject well by colored pencil or hatchure marks on the plat below.
2. If more than one lease is dedicated to the well, outline each and identify the ownership thereof (both as to working interest and royalty).
3. If more than one lease of different ownership is dedicated to the well, have the interests of all owners been consolidated by communitization, unitization, force-pooling, etc?

☐ Yes ☐ No If answer is "yes," type of consolidation _____

If answer is "no," list the owners and tract descriptions which have actually been consolidated. (Use reverse side of this form if necessary.) _____

No allowable will be assigned to the well until all interests have been consolidated (by communitization, unitization, forced-pooling, or otherwise) or until a non-standard unit, eliminating such interests, has been approved by the Commission.

This plat is of an existing well staked by others and reported: 1450' FSL and 860' FEL		#1-R
Sec	33	
		820'



CERTIFICATION

I hereby certify that the information contained herein is true and complete to the best of my knowledge and belief.

H. D. Montgomery
Name
H. D. Montgomery

Position
Area Engineer

Company
AMOCO PRODUCTION COMPANY

Date
January 11, 1977

I hereby certify that the well location shown on this plat was plotted from field notes of actual surveys made by me or under my supervision, and that the same is true and correct to the best of my knowledge and belief.

Date Surveyed
January 6, 1977

Registered Professional Engineer and/or Land Surveyor
Fred B. Kerr Jr.

Certificate No.
3050

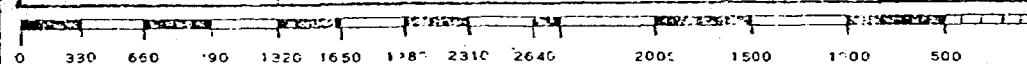

R9W

AMOCO 50%
ELLIOTT G. C. "G"

AMOCO 99%
ELLIOTT G. C. "F"

AMOCO 100%
ELLIOTT G. C. "E"

LEGEND

- AUTHORIZED BUT NOT DRILLED
- ☼ DRILLED BUT NOT ON LINE
- ☼ PRODUCING WELL
- UNIT OUTLINE

T
30
N

AMOCO 100%
LIKINS G. C. "A"

AMOCO 100%
JAQUEZ G. C. "B"

AMOCO 100%
GUTIERREZ G. C.

AMOCO 95%
LOBATO G. C. "A"

AMOCO 100%
CHAVEZ G. C. "A"

T
29
N

BLANCO MESAVERDE
SAN JUAN CO., NEW MEXICO
SCALE. 4"=1 MI.

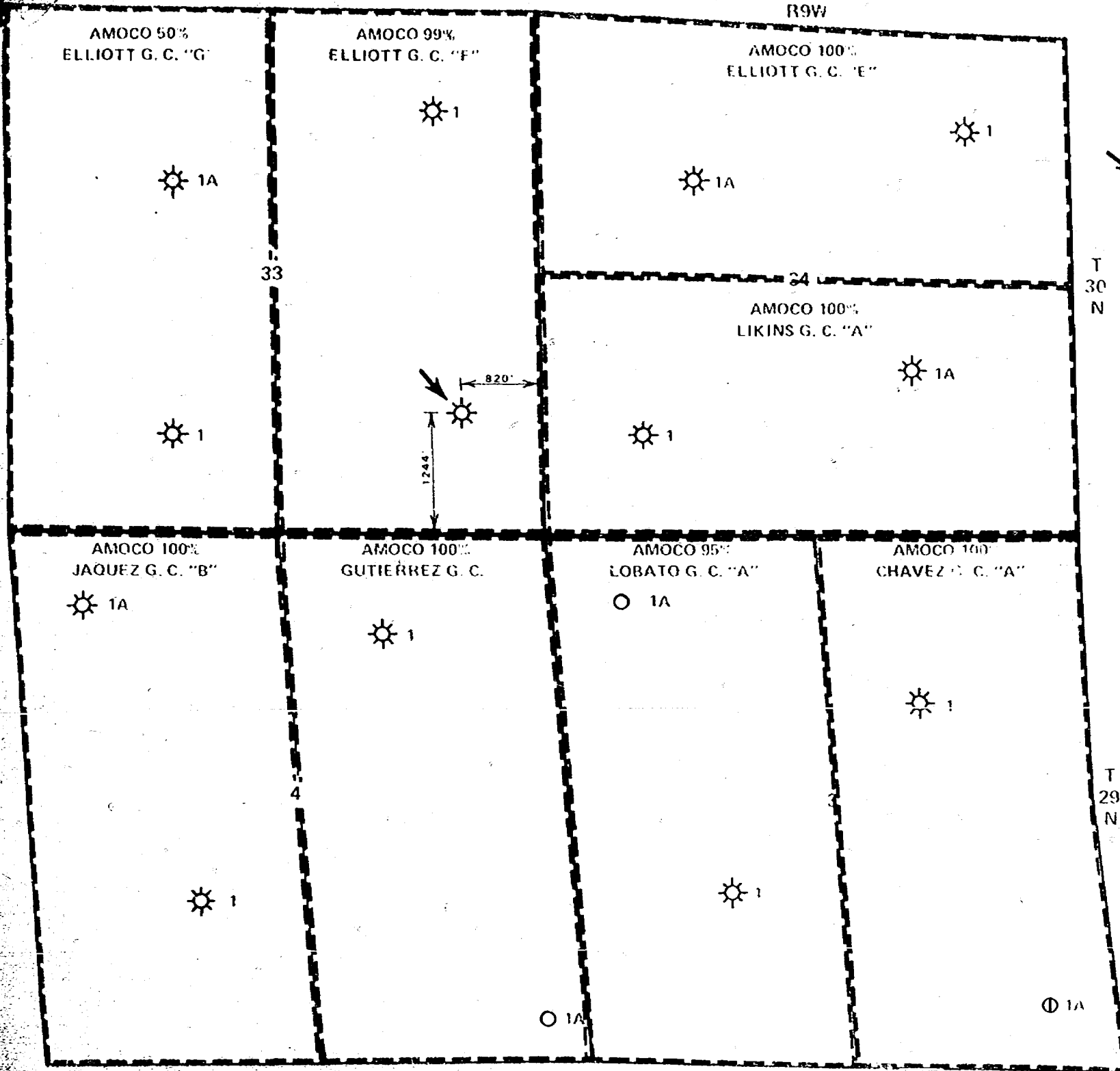

RLS
ROUGH

dr/

BEFORE THE OIL CONSERVATION COMMISSION
OF THE STATE OF NEW MEXICO

IN THE MATTER OF THE HEARING
CALLED BY THE OIL CONSERVATION
COMMISSION OF NEW MEXICO FOR
THE PURPOSE OF CONSIDERING:

CASE NO. 5856

Order No. R- 5385

APPLICATION OF AMOCO PRODUCTION COMPANY
FOR AN UNORTHODOX GAS WELL LOCATION,
SAN JUAN COUNTY, NEW MEXICO.

ORDER OF THE COMMISSION

BY THE COMMISSION:

This cause came on for hearing at 9 a.m. on February 16, 1977, at Santa Fe, New Mexico, before Examiner Richard L. Stamets.

NOW, on this day of February, 1977, the Commission, a quorum being present, having considered the testimony, the record, and the recommendations of the Examiner, and being fully advised in the premises,

FINDS:

(1) That due public notice having been given as required by law, the Commission has jurisdiction of this cause and the subject matter thereof.

(2) That the applicant, Amoco Production Company, seeks for its Elliott Gas Com "F" Well No. 1A to be drilled approval of an unorthodox gas well location/ 1244 feet from the South line and 820 feet from the East line of Section 33, Township 30 North, Range 9 West, NMPM, to test the Mesaverde formation, Blanco Mesaverde Pool, San Juan County, New Mexico.

(3) That the E/2 of said Section 33 is to be dedicated to the well.

(4) That ~~a well at~~ said unorthodox location ^{resulted from an} will better enable ~~applicant to produce the gas underlying the proration unit.~~ _{error in surveying.}

(5) That no offset operator objected to the proposed unorthodox location.

-2-

Case No. _____
Order No. R- _____

(6) That approval of the subject application will afford the applicant the opportunity to produce its just and equitable share of the gas in the subject pool, will prevent the economic loss caused by the drilling of unnecessary wells, avoid the augmentation of risk arising from the drilling of an excessive number of wells, and will otherwise prevent waste and protect correlative rights.

IT IS THEREFORE ORDERED:

(1) That an unorthodox gas well location for the Mesaverde
~~(the Amoco Production Company)~~ applicant's Elliott Gas Com "F" Well No. 1A ~~is~~ drilled
formation is hereby approved for ~~approval to be located~~ at a point 1244
feet from the South line and 820 feet from the East
line of Section 33, Township 30 North, Range 9 West
NMPM, Blanco Mesaverde Pool, San Juan County,
New Mexico.

(2) That the E/2 of said Section 33 shall be dedicated to
the above-described well.

(3) That jurisdiction of this cause is retained for the entry of such
further orders as the Commission may deem necessary.

DONE at Santa Fe, New Mexico, on the day and year hereinabove designated.