

SAFETY 20000 Duplication of GULF Air
of its J.F. JENSEN
J.F. JENSEN, JR. A. JENSEN D.

100

2555

dition, Transcript,
all Exhibits, Etc.

BEFORE THE OIL CONSERVATION COMMISSION
OF THE STATE OF NEW MEXICO

IN THE MATTER OF THE HEARING
CALLED BY THE OIL CONSERVATION
COMMISSION OF NEW MEXICO FOR
THE PURPOSE OF CONSIDERING:

CASE No. 2555
Order No. R-2273

APPLICATION OF GULF OIL CORPORATION
FOR APPROVAL OF A DUAL COMPLETION,
LEA COUNTY, NEW MEXICO.

ORDER OF THE COMMISSION

BY THE COMMISSION:

This cause came on for hearing at 9 o'clock a.m. on May 18, 1962, at Santa Fe, New Mexico, before Daniel S. Nutter, Examiner duly appointed by the Oil Conservation Commission of New Mexico, hereinafter referred to as the "Commission," in accordance with Rule 1214 of the Commission Rules and Regulations.

NOW, on this 21st day of June, 1962, the Commission, a quorum being present, having considered the application, the evidence adduced, and the recommendations of the Examiner, Daniel S. Nutter, and being fully advised in the premises,

FINDS:

(1) That due public notice having been given as required by law, the Commission has jurisdiction of this cause and the subject matter thereof.

(2) That the applicant, Gulf Oil Corporation, seeks permission to complete its J. F. Janda (NCT-F) Well No. 6, located in Unit D of Section 4, Township 22 South, Range 36 East, HEMP, Lea County, New Mexico, as a dual completion (conventional) in the Jalmat Gas Pool and in the South Eunice Oil Pool with the production of oil from the Jalmat Gas Pool to be through a string of 1 1/4-inch tubing and the production of oil from the South Eunice Oil Pool to be through a parallel string of 2 3/8-inch tubing.

(3) That the mechanics of the proposed dual completion are feasible and in accord with good conservation practices.

(4) That approval of the subject application will neither cause waste nor impair correlative rights.

IT IS THEREFORE ORDERED:

(1) That the applicant, Gulf Oil Corporation, is hereby authorized to complete its J. F. Janda (NCT-F) Well No. 6, located

-2-
CASE No. 2555
Order No. R-2273

in Unit D of Section 4, Township 22 South, Range 36 East, 22E24N, Lea County, New Mexico, as a dual completion (conventional) in such a manner as to permit the production of oil from the Joliet Gas Pool through a string of 1 1/4-inch tubing and the production of oil from the South Eunice Oil Pool through a parallel string of 2 3/8-inch tubing.

PROVIDED HOWEVER, That the applicant shall complete, operate, and produce said well in accordance with the provisions of Rule 112-A of the Commission Rules and Regulations.

PROVIDED FURTHER, That the applicant shall take packer-leakage tests upon completion and annually thereafter during the Gas-Oil Ratio Test Period for the South Eunice Oil Pool.

(2) That jurisdiction of this cause is retained for the entry of such further orders as the Commission may deem necessary.

DONE at Santa Fe, New Mexico, on the day and year hereinabove designated.

STATE OF NEW MEXICO
OIL CONSERVATION COMMISSION



EDWIN L. MECHEM, Chairman



E. S. WALKER, Member

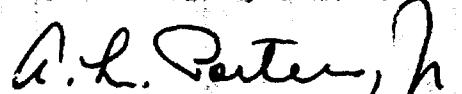

A. L. PORTER, JR., Member & Secretary



esr/

GOVERNOR
EDWIN L. MECHEM
CHAIRMAN

State of New Mexico
Oil Conservation Commission

LAND COMMISSIONER
E. S. JOHNNY WALKER
MEMBER



STATE GEOLOGIST
A. L. PORTER, JR.
SECRETARY - DIRECTOR

P. O. BOX 871
SANTA FE

June 21, 1962

Mr. Bill Kastler
Gulf Oil Corporation
Box 669
Roswell, New Mexico

Re: Case No. 2555
Order No. R-2273
Applicant:
Gulf Oil Corporation

Dear Sir:

Enclosed herewith are two copies of the above-referenced Commission order recently entered in the subject case.

Very truly yours,

A. L. Porter, Jr.

A. L. PORTER, JR.
Secretary-Director

ir/

Carbon copy of order also sent to:

Hobbs OCC x

Artesia OCC

Astec OCC

OTHER

OIL CONSERVATION COMMISSION
SANTA FE, NEW MEXICO

Date 6/14/62

CASE 2555

Hearing Date 9am 5/10/62

My recommendations for an order in the above numbered cases are as follows:

Enter an order approving Gulf's proposed dual completion of its J. F. Gauda Well No 6, located in Unit D of Sec 4, Twp 22 S, Rge 36 E, in such a manner as to permit the production of oil from the Gauda Gas Pool and the from the South Eunice Oil Pool through parallel strings of $1\frac{1}{4}$ inch and $2\frac{3}{8}$ inch tubing, respectively. ^{on completion and} Packer leakage tests, annually during GOR test period for the S. Eunice

Santhorne
Staff Member

No. 14-62

DOCKET: EXAMINER HEARING - THURSDAY - MAY 10, 1962

OIL CONSERVATION COMMISSION - 9 A.M. - MORGAN HALL, STATE LAND OFFICE
BUILDING, SANTA FE, NEW MEXICO

The following cases will be heard before Daniel S. Nutter, Examiner, or
Elvis A. Utz, as alternate examiner:

- CASE 2547: Application of Pan American Petroleum Corporation for a triple completion, Eddy County, New Mexico. Applicant, in the above-styled cause, seeks an order authorizing the triple completion (conventional) of its Greenwood Unit Well No. 7, located in Unit H, Section 12, Township 19 South, Range 31 East, Eddy County, New Mexico, in such a manner as to permit the production of oil from undesignated Strawn, Wolfcamp, and Bone Spring pools through parallel strings of tubing.
- CASE 2548: Application of Pan American Petroleum Corporation for an exception to Order No. R-660, Caprock-Queen Pool, Chaves County, New Mexico. Applicant, in the above-styled cause, seeks an exception to the Special Rules and Regulations of the Caprock-Queen Pool, Order No. R-660, for the assignment of a gas allowable equivalent to the total reservoir voidage of a top allowable oil well producing at the limiting GOR of 2000: 1 for its State "AK" Well No. 1 located in Unit N, Section 19, Township 15 South, Range 31 East, Chaves County, New Mexico.
- CASE 2549: Application of Cities Service Petroleum Company for a dual completion, Lea County, New Mexico. Applicant, in the above-styled cause, seeks permission to complete its Hodges B Well No. 4, located in Unit M of Section 1, Township 25 South, Range 37 East, Lea County, New Mexico, as a dual completion (conventional) in the North Justis Tubb-Drinkard Pool and Devonian formation adjacent to the North Justis-Devonian Pool with the production of oil from each zone to be through parallel strings of 2 3/8-inch tubing.
- CASE 2550: Application of Texaco Inc., for a quadruple completion, Lea County, New Mexico. Applicant, in the above-styled cause, seeks permission to complete its G. L. Erwin "B" NCT-2 Well No. 4, located in Unit O of Section 35, Township 24 South, Range 37 East, Lea County, New Mexico, as a quadruple completion (tubingless) in the North Justis-Fusselman, North Justis-Devonian, North Justis Tubb-Drinkard and North Justis-

Blinebry Pools, with the production of oil from all zones to be through parallel strings of small diameter casing cemented in a common well bore.

CASE 2551:

Application of Texaco Inc., for a triple completion, Lea County, New Mexico. Applicant, in the above-styled cause, seeks permission to complete its G. L. Erwin "A" Well No. 1, located in Unit N of Section 35, Township 24 South, Range 37 East, Lea County, New Mexico, as a triple completion (tubingless) in the North Justis-Devonian, North Justis-Tubb Drinkard and North Justis-Blinebry Pools with the production of oil from all zones to be through parallel strings of small diameter casing cemented in a common well bore.

CASE 2552:

Application of Texaco Inc., for a quadruple completion, Lea County, New Mexico. Applicant, in the above-styled cause, seeks an amendment to Order R-2109 to permit the quadruple completion (tubingless) of its G. L. Erwin "B" NCT-2 Well No. 2, located in Unit J of Section 35, Township 24 South, Range 37 East, Lea County, New Mexico, in the North Justis-Blinebry Pool, North Justis Tubb-Drinkard Pool, an undesignated Paddock pool and an undesignated Devonian pool with the production of oil from all four zones to be through parallel strings of 2 3/8-inch casing cemented in a common well bore.

CASE 2553:

Application of Texaco Inc. for a triple completion, Lea County, New Mexico. Applicant, in the above-styled cause, seeks an amendment to Order R-2181 to permit the triple completion (conventional) of its C. H. Weir "B" Well No. 5, located in Unit G of Section 11, Township 20 South, Range 37 East, Lea County, New Mexico, in the Skaggs-Glorieta and Skaggs-Drinkard Oil Pools and in an undesignated Blinebry Oil pool with the production of oil from the Glorieta and Drinkard zones to be through parallel strings of 2 1/16-inch tubing and the production of oil from the Blinebry zone to be through a dual zone flow tube and a string of 1-inch tubing.

CASE 2554:

Application of T. F. Hodge for an order creating a new pool and establishing temporary rules, Lea County, New Mexico. Applicant, in the above-styled cause, seeks an order creating a new pool for Pennsylvanian production; the discovery well for said pool is the Humble-State Well No. 1, located in

-3-

Docket No. 14-62

Unit N of Section 26, Township 10 South, Range 33 East, Lea County, New Mexico, completed in the Bough "C" zone of the Pennsylvanian formation with perforations from 9667 feet to 9671 feet. Applicant further seeks establishment of special rules and regulations governing said pool, including 80-acre proration units.

CASE 2555:

Application of Gulf Oil Corporation for a dual completion, Lea County, New Mexico. Applicant, in the above-styled cause, seeks permission to complete its J. F. Janda (NCT-F) Well No. 6, located in Unit D of Section 4, Township 22 South, Range 36 East, Lea County, New Mexico, as a dual completion (conventional) in the Jalmat Gas Pool and South Eunice Pool with the production of oil from the Jalmat Gas Pool to be through a string of 1 1/4-inch tubing and the production of oil from the South Eunice Pool to be through a parallel string of 2 3/8-inch tubing.

CASE 2556:

Application of Gulf Oil Corporation for an unorthodox oil well location and a dual completion, Lea County, New Mexico. Applicant, in the above-styled cause, seeks permission to complete its Lillie Well No. 3, located 2310 feet from the North line and 330 feet from the West line of Section 23, Township 24 South, Range 37 East, Lea County, New Mexico, as a dual completion (conventional) in the Fowler-Fusselman and Fowler-Ellenburger Pools with the production oil from both zones to be through a parallel strings of tubing. Said well is at an unorthodox location under the Fowler-Ellenburger Pool Rules.

CASE 2557:

Application of Gulf Oil Corporation for a unit agreement and a secondary recovery project, Lea County, New Mexico. Applicant, in the above-styled cause, seeks approval of the West Dollarhide Devonian Unit Agreement embracing 765.25 acres, more or less, of Federal and State lands in Townships 24 and 25 South, Range 38 East, Lea County, New Mexico. Applicant further seeks permission to institute a secondary recovery project in the proposed West Dollarhide Devonian Unit Area by injection of water into the Devonian formation into certain wells located in said unit.

John Hoover

Baker Model C

w/ unloader sea

@ 3441 on 2 3/8"

w/ tubing in tension
of 12,000# in 5 1/2" cap

jumping below p/c
hollow rods in 2 3/8" tby

upper zone perf
penetration down 3395 - 3446'
1880 PD + 700 BHP pressure 748 37°

lower zone perf
10-20 BPD 3187 - 3266 BHP pressure 365
+ 10 BW PD 3000 350

12" x 1 1/4"
1' stroke

pressure diff
will not change

Temperature
about 95°



BAKER OIL TOOLS, INC.

ADDRESS: POST OFFICE BOX 2274 TERMINAL ANNEX

W. S. ALTHOUSE, JR.
Vice President and
Mgr. of Research and Engineering

LOS ANGELES 54, CALIF.

May 29, 1962

CABLE ADDRESS "BACASO"
MAIN OFFICE AND FACTORY:
7400 E. SLAYSON AVENUE

Mr. Daniel S. Nutter
Oil Conservation Commission
State of New Mexico
P.O. Box 871
Santa Fe, New Mexico

Subject: Model "C" Full Bore Retrievable Cementer used as a
Production Packer

Ref: Your letter dated May 22

Dear Mr. Nutter:

In your letter of May 22 you state that the New Mexico Oil Conservation Commission has been asked to approve a dual completion in a well using our Model "C" Full Bore Retrievable Cementer. You ask if we would recommend this tool for use under these conditions.

Our Model "C" Full Bore Retrievable Cementer, as you are no doubt aware, was designed primarily for testing, fracturing, and squeezing work. Normally it is not used as a Production Packer although in some instances it has been used successfully. In order for us to answer your question satisfactorily I believe it will be necessary for you to outline in a little greater detail the use to which the tool will be put. In other words, we would like to know the type of hookup, and the operations which may take place at the time of completion or subsequently. We would also like to have some idea as to whether the oil zones will change pressure appreciably during the life of the well changing the differential pressure from one side to the other of the Packer. It would also be helpful if you could give us some idea as to the probable temperature and zonal pressures.

As soon as we receive this information, we will attempt to give you a recommendation as to whether we feel the Model "C" Full Bore Retrievable Cementer will be an adequate tool to do the job.

Yours truly,

W. S. Althouse
W. S. Althouse

WSA:m

*John Hoover
advised
that Self checked w/
Baker and Baker's Houston
office approved the
use of this cementing
Packer as a
Production Packer
in these zones.*

OIL CONSERVATION COMMISSION

P. O. BOX 871

SANTA FE, NEW MEXICO

May 22, 1962

Baker Oil Tools, Inc.
P. O. Box 2274
Terminal Annex, Zone 54
Los Angeles, California

Gentlemen:

The New Mexico Oil Conservation Commission has recently been asked to approve the dual completion of a well in which your Model "C" Full-Bore Retrievable Cementer, Product No. 410-01, would be used to obtain separation of the zones.

While we do recognize this tool as being highly satisfactory in the performance of work for which it was designed, testing, fracturing, squeezing, etc.; we have not previously encountered a case where it would be permanently installed as a production packer.

Is this a common use for the Model "C", and if so, under what type of conditions is it so recommended?

Your early answer will be appreciated.

Very truly yours,

DANIEL S. NUTTER
Chief Engineer

DSN/og

C
O
P
Y

BEFORE THE
OIL CONSERVATION COMMISSION
Santa Fe, New Mexico
May 10, 1962

EXAMINER HEARING

IN THE MATTER OF:

Application of Gulf Oil Corporation for
a dual completion, Lea County, New Mexico.
Applicant, in the above-styled cause,
seeks permission to complete its J. F.
Janda (NCT-F) Well No. 6, located in Unit
D of Section 4, Township 22 South, Range
36 East, Lea County, New Mexico, as a
dual completion (conventional) in the
Jalmat Gas Pool and South Eunice Pool
with the production of oil from the Jalmat
Gas Pool to be through a string of
1 1/4-inch tubing and the production of
oil from the South Eunice Pool to be
through a parallel string of 2 3/8-inch
tubing.

Case 2555

BEFORE: Daniel S. Nutter, Examiner.

TRANSCRIPT OF HEARING

MR. NUTTER: We will call Case 2555.

MR. MORRIS: Application of Gulf Oil Corporation for a
dual completion, Lea County, New Mexico.

MR. KASTLER: My name is Bill Kastler. I am an attorney
from Roswell, New Mexico, appearing on behalf of Gulf Oil
Corporation. Our principal witness in this case is Mr. John

DEARNLEY-MEIER REPORTING SERVICE, Inc.

ALBUQUERQUE, N. M.
PHONE 243-6691

FARMINGTON, N. M.
PHONE 325-1182



H. Hoover.

(Whereupon, Gulf's Exhibits Nos. 1, 2 and 3 were marked for identification.)

(Witness sworn.)

JOHN H. HOOVER

called as a witness, having been first duly sworn, testified as follows:

DIRECT EXAMINATION

BY MR. KASTLER:

Q Will you please for our record state your name, and employment position?

A John Hoover, petroleum engineer, Gulf Oil Corporation, Roswell, New Mexico.

Q Have you previously appeared before the New Mexico Oil Conservation Commission and qualified as an expert petroleum engineer and given testimony?

A Yes, sir, I have.

MR. KASTLER: Are the witness's qualifications satisfactory?

MR. NUTTER: Yes, sir. Would you please proceed?

Q (By Mr. Kastler) Are you familiar with Gulf's application in Case 2555?

A Yes, I am.

DEARNLEY-MEIER REPORTING SERVICE, Inc.

FARMINGTON, N. M.
PHONE 325-1182

ALBUQUERQUE, N. M.
PHONE 243-6691



DEARNLEY-MEIER REPORTING SERVICE, Inc.

FARMINGTON, N. M.
PHONE 325-1162

ALBUQUERQUE, N. M.
PHONE 243-6691

Q Please outline what Gulf is seeking.

A We are seeking approval of an oil-oil dual completion for our J. F. Janda (NCT-F) No. 6.

Q Have there been other dual completions in this same pool which would normally allow administrative approval?

A Yes, sir, there have. However, in the installation that we would propose we would use tubing with less than 1.670 inch inside diameter. Therefore, this hearing is required.

Q Would you state one instance of a previous dual completion in the same two zones?

A Yes, sir, our J. F. Janda (NCT-F) Well No. 3. It was approved by Order R-1161 in Case 1411, dated April, 1958.

Q Mr. Hoover, I call your attention to a plat marked Exhibit 1. Would you refer to this plat and explain what is shown on that that's pertinent to this case?

A Yes, sir. This is a lease plat showing our J. F. Janda (NCT-F) lease outlined in red and described as all of Section 4, Township 22 South, Range 36 East, Lea County, New Mexico. We also show the pertinent well, being the Janda F Well No. 6 circled in red. It's located 660 feet from the north and west lines of this section.

Q Is that a state, federal or fee lease?

A It's a state lease.



Q Have you prepared, or caused to be prepared, a log for introduction here as Exhibit No. 2?

A Yes, sir.

Q What does it show?

A On this log we have shown the top of the Yates, we have marked the top of the Yates 3200 feet; we show the perforations in the lower section of the Yates, being in the interval 3395 to 3416, show the top of the Seven Rivers marked at 3416, the top of the Queen at 3785, and we show the perforations in the South Eunice Oil Pool at 3787 to 3866. These perforations in the lower Yates are within the vertical limits of the Jalmat Pool, and the perforations in the Queen are in the vertical limits of the South Eunice Oil Pool.

Q I now call your attention to Exhibit No. 3, Referring to this exhibit, would you please testify as to what is shown hereon and what its bearing on this case might be?

A Yes, sir. This is a proposed mechanical installation for this dual completion, and this well was originally drilled and completed in August of 1956. It was completed in the South Eunice Oil Pool. We have 8-5/8" casing set at 249'. Cement was circulated, we have 5 1/2" casing set at 3890, and cemented with 1250 sacks, and the top of the cement is at 525' by temperature survey.

DEARNLEY-MEIER REPORTING SERVICE, Inc.

FARMINGTON, N. M.
PHONE 325-1182

ALBUQUERQUE, N. M.
PHONE 243-6691



DEARNLEY-MEIER REPORTING SERVICE, Inc.

FARMINGTON, N. M.
PHONE 325-1182

ALBUQUERQUE, N. M.
PHONE 243-6691

The well was completed at a total depth of 3890', plugged back to 3887. The installation that we propose to use here is using a string of 1 $\frac{1}{4}$ " tubing for producing the Jalmat oil and a string of 2-3/8" tubing for producing the South Eunice oil. The reason that we need to use this small tubing is due to the fact that we have 5 $\frac{1}{2}$ " casing in the well. Normally you could get two strings of two inch Hydril, but in our particular installation I would like to explain the 2-3/8" tubing, we will set a Baker Model "C", cemented packer, at approximately 3460'. We will have a perforated tubing sub just below the packer which will serve as a gas vent for pumping out below the packer. We intend to pump the South Eunice oil up through the 2-3/8" tubing and the oil will be pumped up through hollow rods.

For the rod string we will use 3/4" Kobe tubing. It is necessary that we use the 2-3/8" tubing so that we will have clearance for the collars on the 3/4" Kobe tubing. The 2-3/8" OD has a drift diameter of 1.901. The 3/4" Kobe tubing coupling has a 1.660. Therefore, to use 2-3/8" tubing, which is necessary for this pump installation, it is necessary that we use the inch and a quarter.

We estimate that we will have a pumping well in the South Eunice, and we estimate it ten to twenty barrels per day, ten water, pumping 35 degree gravity at 60 degrees, and it will be



sour crude. The Jalmat, we anticipate a penalized flowing well of 18 barrels, no water, with a gas-oil ratio of approximately 18,700. The gravity of this crude will be 37 degrees at 60 degrees. The bottom hole pressure in the South Eunice, which was taken on our Janda F No. 3 the latter part of '61, was 365 pounds.

Although we do not have a bottom hole pressure in the Jalmat zone, based on offset Jalmat wells we anticipate a bottom hole pressure in the neighborhood of 740 pounds. Therefore, we are showing that we have no or very small differential of very light duty for a packer.

I believe that explains Exhibit No. 3.

Q Is that the primary use for using Baker Model "C" Full-Bore retrievable packer?

A The reason we want to use that is for two reasons. First, it's a very dependable packer. We have used it hundreds of times in remedial work, and we know what it can do and its capabilities.

The second reason for using it is that it is easily retrievable, and we anticipate in this particular area we have a pilot water flood to the northeast of our lease in the Eumont oil or the Queen formation. We anticipate that that water flood will be expanded, and if and when it is, we believe that we will probably have to go back in the wells to rework the Queen.

DEARNLEY-MEIER REPORTING SERVICE, Inc.

ALBUQUERQUE, N. M.
PHONE 243-6691

FARMINGTON, N. M.
PHONE 325-1182



DEARNLEY-MEIER REPORTING SERVICE, Inc.

FARMINGTON, N. M.
TW 7NE 325-1182

ALBUQUERQUE, N. M.
PHONE 243-6691

Therefore, in setting a Baker Model "D" packer it would be necessary to drill out, where in this one we will be able to retrieve it. Those are the two main reasons for using it.

Q Have offset operators been notified of this application?

A Yes, sir, they have.

Q If granted, would this application cause any waste?

A No, sir.

Q Would it, in your opinion, protect correlative rights?

A Yes, sir, it would.

Q Were Exhibits 1, 2 and 3 prepared by you or under your direction or supervision?

A Yes, sir.

MR. KASTLER: This concludes our direct testimony.

MR. NUTTER: Are there any questions of Mr. Hoover?

CROSS EXAMINATION

BY MR. NUTTER:

Q With the installation of this inch and a quarter pipe to the Jalmat, are you going to be able to artificially lift it in the event that you have to?

A No, we will not be able to. What we would plan to do is to flow the Jalmat as long as it will flow and then evaluate which zone should be temporarily abandoned to deplete the other zone, and at that time that would have to be decided.



DEARNLEY-MEIER REPORTING SERVICE, Inc.

FARMINGTON, N. M.
PHONE 325-1182

ALBUQUERQUE, N. M.
PHONE 243-6691

Q First of all, has it been perforated in the Jalmat yet?

A The No. 6?

Q This well.

A Yes, sir, it has.

Q Now, you said that you anticipated or estimated that you would have a flowing well with 18 barrels of oil. Is this an actual test that you have run?

A Yes, it is. It was a flow test through 2-3/8" tubing. We had a test of 30 barrels of oil, no water, through a 24/64 choke, 500 MCF gas volume with a gas-oil ratio of 18,700, a tubing pressure of 110 pounds. I might add also that on the dual completion on our Janda F No. 3, it also has the inch and a quarter tubing flowing the Jalmat oil.

Q Now, this retrievable cementer packer, how is that packer set, Mr. Hoover?

A It is set in tension. The packer is run on the tubing string, and by rotating you release the slips which grab the casing wall. You pull the packer in tension to set it. It is left in tension.

Q How is it released?

A It is released by taking weight of the tubing, and it has a built in unloader sub with a packer which will equalize the pressures when pulling it, when releasing it.

Q Well, now, will the action of the rod pump or the



sucker rods in the tubing have any tendency to release this packer?

A No, sir. I believe it would be the other way, that the strain would be up on the pump which would tend, in other words, pumping up would tend to even hold it tighter. I do not believe that the --

Q Because tension holds it set?

A Tension holds it set.

Q How about when the pumps come down, the rods come down?

A Well, the tubing is left in tension, which would offset any force there.

Q I presume from your testimony that this gas comes up the annulus outside the hollow sucker rods, then?

A Yes.

Q Where is that pilot flood at the present time?

A It's in Section 34 to the northeast.

Q Is this acreage dedicated to any gas, this 40-acre lot No. 4 dedicated to any gas in the acreage in the Jalmat Pool?

A No, sir, it is not.

MR. NUTTER: Any further questions of Mr. Hoover? He may be excused.

(Witness excused.)

MR. KASTLER: I would like to ask that Exhibits 1, 2

DEARNLEY-MEIER REPORTING SERVICE, Inc.

FARMINGTON, N. M.
PHONE 325-1182

ALBUQUERQUE, N. M.
PHONE 243-6691



and 3 be admitted in evidence.

MR. NUTTER: Gulf's Exhibits 1 through 3 will be admitted in evidence. Do you have anything further, Mr. Kastler?

MR. KASTLER: Nothing in this case.

MR. NUTTER: Does anyone have anything they wish to offer in Case 2555? We will take the case under advisement and recess the hearing until 1:30.

STATE OF NEW MEXICO)
) ss
COUNTY OF BERNALILLO)

I, ADA DEARNLEY, Court Reporter, do hereby certify that the foregoing and attached transcript of proceedings before the New Mexico Oil Conservation Commission at Santa Fe, New Mexico, is a true and correct record to the best of my knowledge, skill and ability.

WITNESS WHEREOF I have affixed my hand and notarial seal this 1st day of June, 1962.

Ada Dearnley
Notary Public-Court Reporter

My commission expires:

June 19, 1963.

DEARNLEY-MEIER REPORTING SERVICE, Inc.

FARMINGTON, N. M.
PHONE 325-1182

ALBUQUERQUE, N. M.
PHONE 243-6691



Gulf Oil Corporation

ROSWELL PRODUCTION DISTRICT

1962 APR 17 AM 8:15

P. O. Drawer 1938
Roswell, New Mexico

W. A. Shellshear
DISTRICT MANAGER
F. O. Mortlock
DISTRICT EXPLORATION
MANAGER
M. J. Taylor
DISTRICT PRODUCTION
MANAGER
H. C. Vivian
DISTRICT SERVICES MANAGER

April 13, 1962

Oil Conservation Commission
State of New Mexico
Post Office Box 871
Santa Fe, New Mexico

Re: Application of Gulf Oil Corporation
for Approval of a Dual Completion
in the Jalmat Oil and South Eunice
Oil Pools, Lea County, New Mexico

Gentlemen:

Gulf Oil Corporation herewith submits application for approval of a dual completion for the J. F. Janda (NCT-F) Well No. 6, located 660 feet from the north and west lines of Section 4, Township 22 South, Range 36 East, Lea County, New Mexico. It is proposed to complete this well in the Jalmat Oil and South Eunice Oil Pools and to produce each zone through parallel strings of 2-3/8 inch O.D. and 1.66 inch O.D. tubing installed in 5-1/2 inch O.D. casing.

Attached is completed form Application for Multiple Completion, lease plat and diagrammatic sketch of the proposed multiple completion.

It is requested that this matter be set for Examiner Hearing at the first hearing scheduled for May, 1962.

Respectfully submitted,

GULF OIL CORPORATION

W. A. Shellshear

W. A. Shellshear

JHK:ers
Attachments

cc: New Mexico Oil Conservation Commission
Post Office Box 2045
Hobbs, New Mexico

Sinclair Oil & Gas Company
Post Office Box 1470
Midland, Texas

Texas Pacific Coal and Oil Company
Post Office Box 4067
Midland, Texas



Western Natural Gas Company
823 Midland Tower Building
Midland, Texas

NEW MEXICO OIL CONSERVATION COMMISSION

SANTA FE, NEW MEXICO

APPLICATION FOR MULTIPLE COMPLETION

5-1-61
OFFICE OCC
APR 13 1962
AM 8:15

Operator GULF OIL CORPORATION		County LEA	Date APRIL 13, 1962
Address POST OFFICE BOX 1936 MUSKIELL, NEW MEXICO		Lease J. F. JANDA (NUT-7)	Well No. 6
Location of Well B	Unit A	Section 12 E	Range 34 E

1. Has the New Mexico Oil Conservation Commission heretofore authorized the multiple completion of a well in these same pools or in the same zones within one mile of the subject well? YES ☒ NO ☐

2. If answer is yes, identify one such instance: Order No. **8-1161**; Operator, Lease, and Well No.:

Gulf Oil Corporation J. F. Janda (NUT-7) Well No. 3

3. The following facts are submitted:	Upper Zone	Intermediate Zone	Lower Zone
a. Name of Pool and Formation	Jalnet		South Union
b. Top and Bottom of Pay Section (Perforations)	3395' - 3416'		3787' - 3806'
c. Type of production (Oil or Gas)	Oil		Oil
d. Method of Production (Flowing or Artificial Lift)	Flow		Pump

4. The following are attached. (Please mark YES or NO)

- ☒ a. Diagrammatic Sketch of the Multiple Completion, showing all casing strings, including diameters and setting depths, centralizers and/or turbolizers and location thereof, quantities used and top of cement, perforated intervals, tubing strings, including diameters and setting depth, location and type of packers and side door chokes, and such other information as may be pertinent.
- ☒ b. Plat showing the location of all wells on applicant's lease, all offset wells on offset leases, and the names and addresses of operators of all leases offsetting applicant's lease.
- ☒ c. Waivers consenting to such multiple completion from each offset operator, or in lieu thereof, evidence that said offset operators have been furnished copies of the application.*
- ☒ d. Electrical log of the well or other acceptable log with tops and bottoms of producing zones and intervals of perforation indicated thereon. (If such log is not available at the time application is filed, it shall be submitted as provided by Rule 112-A.)

5. List all offset operators to the lease on which this well is located together with their correct mailing address.

SUNLAMP OIL & GAS COMPANY	Post Office Box 1470	Midland, Texas
TEXAS PACIFIC COAL AND OIL COMPANY	Post Office Box 4867	Midland, Texas
WESTERN NATURAL GAS COMPANY	621 Midland Tower Building	Midland, Texas

6. Were all operators listed in Item 5 above notified and furnished a copy of this application? YES ☒ NO ☐ . If answer is yes, give date of such notification **April 13, 1962**

CERTIFICATE: I, the undersigned, state that I am the **District Manager** of the **GULF OIL CORPORATION** (company), and that I am authorized by said company to make this report; and that this report was prepared under my supervision and direction and that the facts stated therein are true, correct and complete to the best of my knowledge.

W. A. Shellshear
W. A. Shellshear Signature

* Should waivers from all offset operators not accompany an application for administrative approval, the New Mexico Oil Conservation Commission will hold the application for a period of twenty (20) days from date of receipt by the Commission's Santa Fe office. If, after said twenty-day period, no protest nor request for hearing is received by the Santa Fe office, the application will then be processed.

NOTE: If the proposed multiple completion will result in an unorthodox well location and/or a non-standard perforation unit in either or both of the producing zones, then separate application for approval of the same should be filed simultaneously with this application.

J. F. JANDA (NCT-F) NO. 6
 SCHEMATIC DIAGRAM OF PROPOSED DUAL COMPLETION
 JALMAT OIL - SOUTH EUNICE OIL

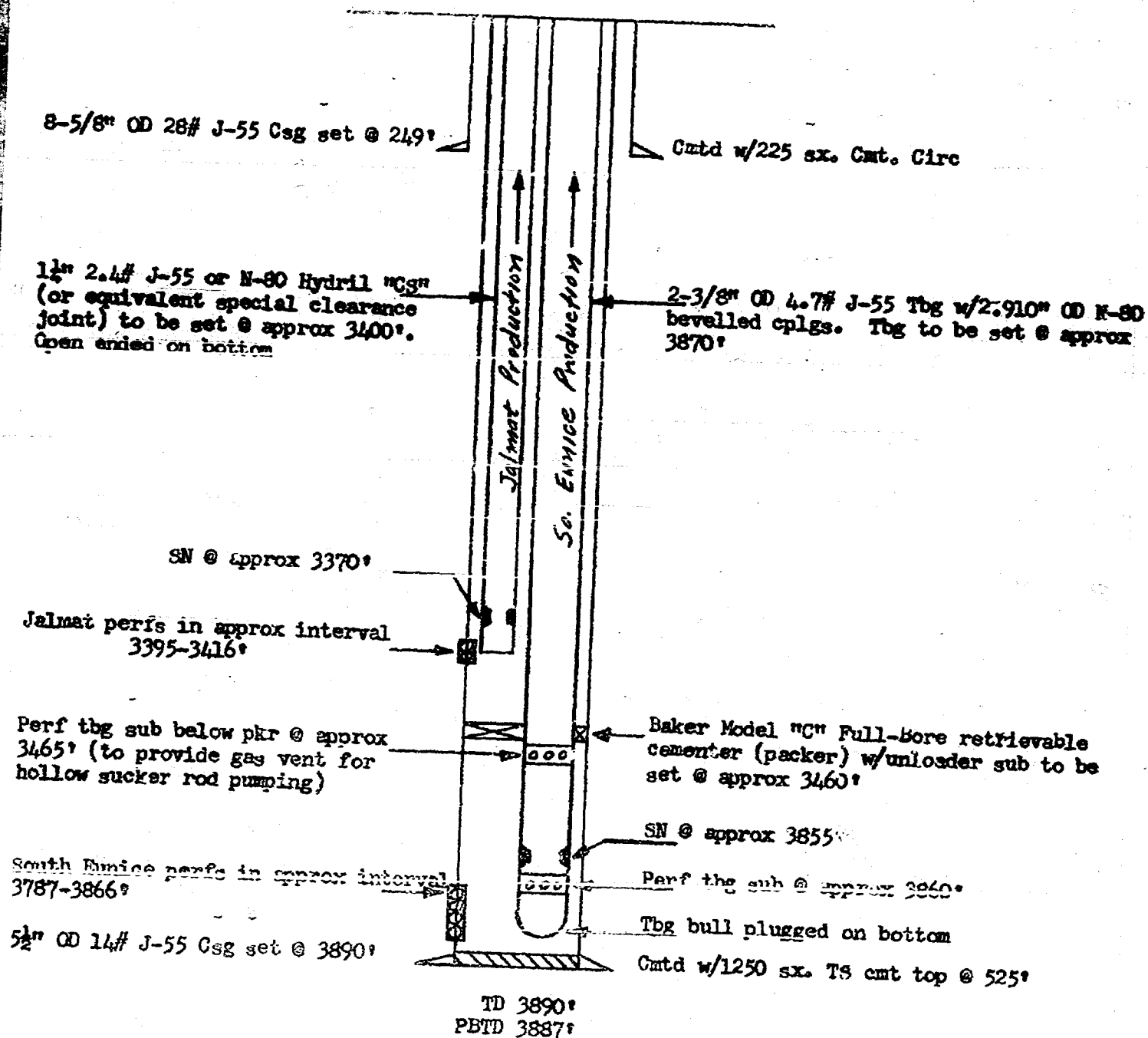

CRK: 4-12-62

Case 2555

MAIL ROOM
APR 24 1962

OIL CONSERVATION COMMISSION

BOX 2045

HOBBS, NEW MEXICO

DATE April 20, 1962

OIL CONSERVATION COMMISSION
BOX 871
SANTA FE, NEW MEXICO

Re: Proposed NSP _____

Proposed NSL _____

Proposed NFC _____

Proposed DC X

Gentlemen:

I have examined the application dated 4/17/62
for the Gulf Oil Corp. J. F. Janda NCT-f #6 4-22-36
Operator Lease and Well No. S-I-R

and my recommendations are as follows:

O.K.---E.F.E.

Geologically O.K.---J.W.R.

Yours very truly,

OIL CONSERVATION COMMISSION

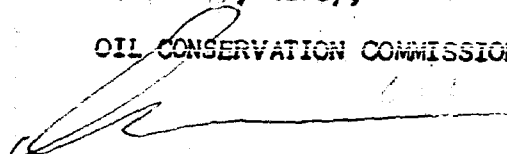

3-11

99
8

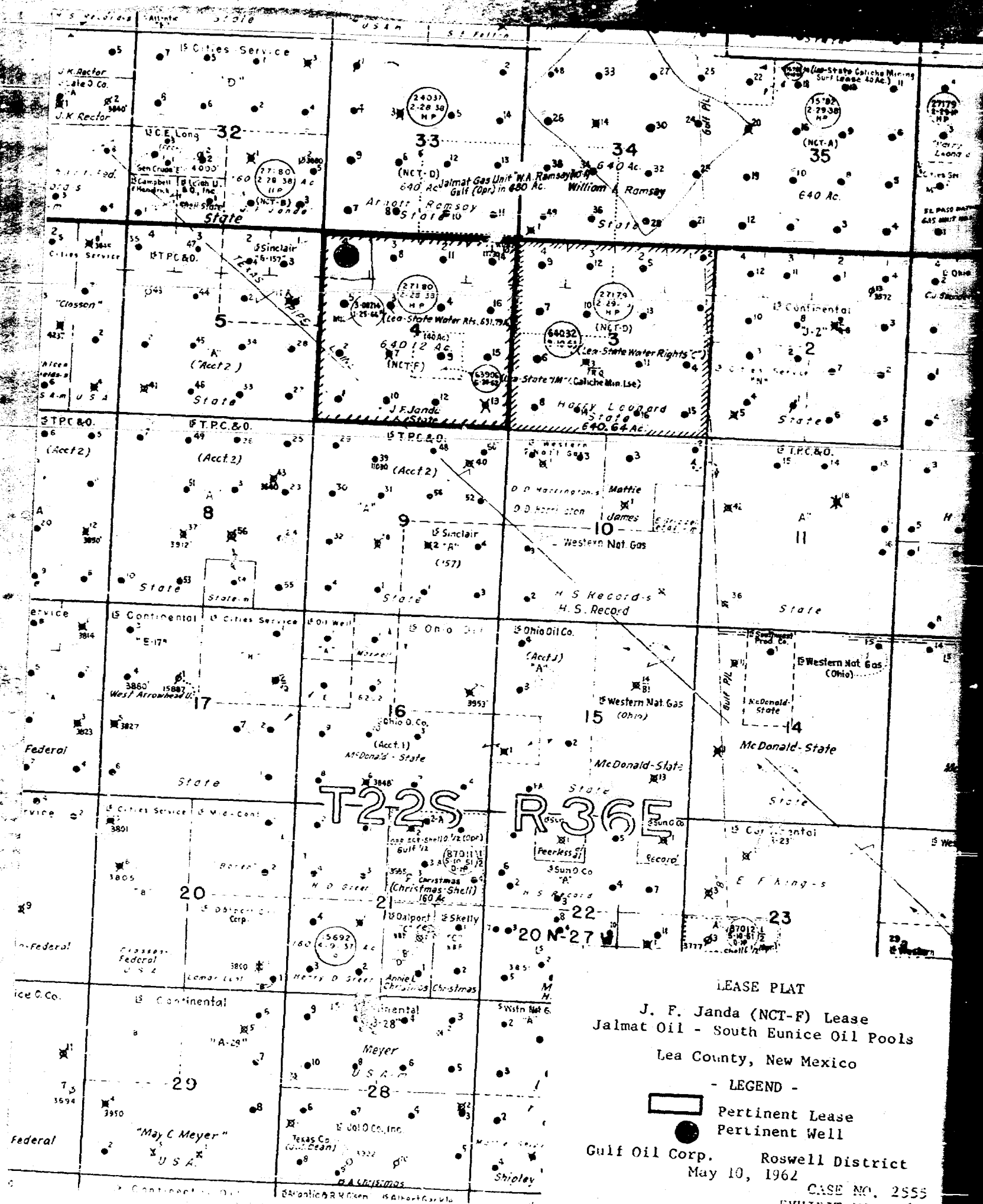

8-5/8" OD 28# J-55 Csg. set @ 249'

Cmtd w/225 sx. Cmt. Circ.

1 1/2" 2.4# J-55 or N-80 Hydril "CS"
(or equivalent special clearance
joint) to be set @ approx. 3400'.
Open ended on bottom.

2-3/8" OD 4.7# J-55 Tbg. w/2.910" OD N-80
bevelled cplgs. Tbg. to be set @ approx.
3870'.

SN @ approx. 3375'

Jalmat perfs. in approx. interval
3395-3416'

Perf. tbg. sub below pkr. @ approx.
3465' (to provide gas vent for
hollow sucker rod pumping)

South Eunice perfs. in approx. interval
3787-3866'

5 1/2" OD 14# J-55 Csg. set @ 3890'

Baker Model "C" Full-Bore retrievable
cementer (Packer) w/unloader sub to be
set @ approx. 3460'

SN @ approx. 3855'

Perf. tbg. sub @ approx. 3860

Tbg. bull plugged on bottom

Cmtd. 3/1250 sx. TS cmt. top @ 525'

TD 3890'
PBD 3887'

PROPOSED MECHANICAL INSTALLATION
DUAL COMPLETION
J. F. JANDA (NCT-F) NO. 6
JALMAT - SOUTH EUNICE OIL POOLS
LEA COUNTY, NEW MEXICO
GULF OIL CORPORATION
MAY 10, 1962

CASE NO. 2555
EXHIBIT NO. 3