

Case 344 Application of J. G. L. L.
Request for a dual completion of his
EYE WELD NO. 9-1.

14210.

2565

dition, Transcript,
all Exhibits, Etc.

BEFORE THE OIL CONSERVATION COMMISSION
OF THE STATE OF NEW MEXICO

IN THE MATTER OF THE HEARING
CALLED BY THE OIL CONSERVATION
COMMISSION OF NEW MEXICO FOR
THE PURPOSE OF CONSIDERING:

CASE No. 2565
Order No. N-2250

APPLICATION OF J. GLENN TURNER
FOR APPROVAL OF A DUAL COMPLETION
AND AN UNORTHODOX GAS WELL LOCA-
TION, SAN JUAN COUNTY, NEW MEXICO.

ORDER OF THE COMMISSION

BY THE COMMISSION:

This cause came on for hearing at 9 o'clock a.m. on May 23, 1962, at Santa Fe, New Mexico, before Elvis A. Utz, Examiner duly appointed by the Oil Conservation Commission of New Mexico, hereinafter referred to as the "Commission," in accordance with Rule 1214 of the Commission Rules and Regulations.

NOW, on this 4th day of June, 1962, the Commission, a quorum being present, having considered the application, the evidence adduced, and the recommendations of the Examiner, Elvis A. Utz, and being fully advised in the premises,

FINDS:

(1) That due public notice having been given as required by law, the Commission has jurisdiction of this cause and the subject matter thereof.

(2) That the applicant, J. Glenn Turner, seeks approval of an unorthodox location for his Nye Well No. 9-1 at a point 1810 feet from the North line and 900 feet from the West line of Section 9, Township 29 North, Range 10 West, N.M.P.M., San Juan County, New Mexico, this location being off-pattern for the Blanco-Mesaverde Gas Pool.

(3) That inasmuch as the subject well was originally projected to the Dakota formation only and is located at a standard Dakota location, and inasmuch as approval of the unorthodox location will neither cause waste nor impair correlative rights, it should be approved.

(4) That the applicant seeks permission to complete the subject well as a dual completion (conventional) in such a manner as to produce gas from the Blanco-Mesaverde and Basin-Dakota Gas Pools through parallel strings of 1 1/2-inch and 2 1/16-inch tubing, respectively.

-2-

CASE No. 2565
Order No. R-2250

(5) That inasmuch as the proposed dual completion is feasible and in accord with good conservation practices, it should be approved.

IT IS THEREFORE ORDERED:

(1) That J. Glenn Turner is hereby authorized to locate his Nye Well No. 9-1 at an unorthodox location 1810 feet from the North line and 900 feet from the West line of Section 9, Township 29 North, Range 10 West, NMPM, San Juan County, New Mexico.

(2) That the dual completion of the subject well in such a manner as to produce gas from the Blanco-Mesaverde and Basin-Dakota Gas Pools through parallel strings of tubing is hereby authorized.

PROVIDED HOWEVER, That the applicant shall complete, operate and produce said well in accordance with the provisions of Rule 112-A.

PROVIDED FURTHER, That zone segregation tests shall be taken upon completion and annually thereafter during the Deliverability Test Period for the Blanco-Mesaverde Gas Pool.

(3) That jurisdiction of this cause is retained for the entry of such further orders as the Commission may deem necessary.

DONE at Santa Fe, New Mexico, on the day and year hereinabove designated.

STATE OF NEW MEXICO
OIL CONSERVATION COMMISSION

E. J. McChen

EDWIN L. MECHEN, Chairman

E. S. Walker

E. S. WALKER, Member

A. L. Porter, Jr.

A. L. PORTER, Jr., Member & Secretary

esr/

Case 2565
Hear. 5-23-62
Rec. 5-23-62

1. Grant J. Glen Turner's request for a Dual Completion in the Bakken and Merced Suspoils.
2. Grant a N.W.V. for this well in the Merced formation. The well should be in the NE/4 and is in the NW/4. This well was drilled as a std. Dakota location and unfortunately encountered a commercial pay in the Merced. Well is not expected by and other N.W. wells and chances are it will not be since the N.W. is not too good.
3. Well location is J. Glen Turner -
Trce #9-1, E-9-28N-10W. (900' x 1810' x lines.)

Thos. H. H.

J. GLENN TURNER
W. D. WHITE
FELIX ATWOOD
JULIAN M. MEER
EDWARD A. FRANCIS
JAMES B. FRANCIS
TREVOR REES-JONES
LEO J. HOFFMAN
THOS. R. HARTNETT
JOHN L. MAUER
H. L. HITCHINS, JR.
WILLIAM L. MEINERNEY
WILLIAM G. WEBB
LEWIS CHANDLER
SNOWDEN M. LEFTWICH, JR.
WILLIAM C. HERNDON, JR.
B. THOMAS MELROY
C. SIDNEY MCCLAIN
JOSEPH P. DONAHUE
LANCASTER SMITH
DEAN CARLTON
ROBERT L. DONALSON
RICHARD A. FRELING
RAY PEARCE
JAMES J. HARTNETT
PAUL E. AVE
JAMES L. TRUITT
WILLIAM D. WHITE, JR.
ROBERT C. MCGUIRE

TURNER, WHITE, ATWOOD, MEER AND FRANCIS

ATTORNEYS AND COUNSELORS AT LAW

1900 MERCANTILE DALLAS BUILDING

DALLAS 1, TEXAS

May 1, 1962

1962 MAY 2 AM 8:20
MAIN OFFICE CCC

Case 2565

Oil Conservation Commission of
the State of New Mexico
Post Office Box 871
Santa Fe, New Mexico

Gentlemen:

Please find enclosed herewith original and two copies of Application for hearing before the New Mexico Oil Conservation Commission by J. Glenn Turner for an order authorizing a gas-gas dual completion in the Blanco-Mesaverde Gas Pool and the Basin Dakota Gas Pool and for an unorthodox gas well location, together with two copies of Welx Induction-Electric Log on the Nye Number 9-1 Dakota Formation gas well. Please advise when said matter will be scheduled for hearing.

Yours very truly,

TURNER, WHITE, ATWOOD, MEER
and FRANCIS

By *William G. Webb*
William G. Webb

WGW:mch
Enclosures

CC: Mr. Oliver Seth
Mr. Albert S. Johnson
Mr. C. Beeson Neal

*For Mr. Webb
5/10/62*

No. 16-62

DOCKET: EXAMINER HEARING - WEDNESDAY - MAY 23, 1962

9 A.M. - OIL CONSERVATION COMMISSION CONFERENCE ROOM,
STATE LAND OFFICE BUILDING, SANTA FE, NEW MEXICO

The following cases will be heard before Elvis A. Utz, Examiner, or Daniel S. Nutter, as alternate examiner.

CASE 2537: (Reopened)

Application of J. C. Williamson for a dual completion, Lea County, New Mexico. Applicant, in the above-styled cause, seeks permission to complete its Westates-Federal Well No. 8 located in Unit E of Section 1, Township 25 South, Range 37 East, Lea County, New Mexico, as a dual completion (conventional) in the North Justis-McKee Pool and an undesignated Montoya pool with the production of oil from both zones to be through parallel strings of tubing.

CASE 2564:

Application of Tidewater Oil Company for a triple completion, Lea County, New Mexico. Applicant, in the above-styled cause, seeks approval of the triple completion (conventional) of its A. B. Coates "C" Well No. 18, located in Unit I, Section 24, Township 25 South, Range 37 East, Lea County, New Mexico, in such a manner as to produce oil from the Justis-Blinbry, Justis Tubb-Drinkard and Justis Ellenburger Pools through parallel strings of 2 3/8-inch tubing.

CASE 2565:

Application of J. Glenn Turner for a dual completion and an unorthodox location, San Juan County, New Mexico. Applicant, in the above-styled cause, seeks an order authorizing the dual completion (conventional) of his Nye Well No. 9-1 at an unorthodox location 1810 feet from the North line and 900 feet from the West line of Section 9, Township 29 North, Range 10 West, San Juan County, New Mexico, in such a manner as to produce gas from the Blanco Mesaverde Gas Pool and the Basin Dakota Gas pool through parallel strings of 1 1/2-inch and 2 1/16-inch tubing.

CASE 2566:

Application of Newmont Oil Company for an amendment to Orders No. R-1110, R-1110-A and R-111-B, Eddy County, New Mexico. Applicant, in the above-styled cause, seeks an order amending Orders No. R-1110, R-1110-A and R-1110-B to define the proper limits of its Square Lake Pool Waterflood Project, Eddy County, New Mexico, to establish rules for expansion of the flood within the defined area, and to provide for capacity allowables for said area.

Docket No. 16-62

CASE 2567:

Application of Redfern & Herd, Inc., for a force-pooling order, San Juan County, New Mexico. Applicant, in the above-styled cause, seeks an order force-pooling all mineral interests in the Basin-Dakota Gas Pool underlying the S/2 Section 11, Township 29 North, Range 13 West, San Juan County, New Mexico, to be dedicated to a well to be drilled in the SE/4 SE/4 of said Section 11.

CASE 2568:

Application of Redfern & Herd, Inc., for a force-pooling order, San Juan County, New Mexico. Applicant, in the above-styled cause, seeks an order force-pooling all mineral interests in the Basin-Dakota Gas Pool underlying the E/2 Section 15, Township 29 North, Range 13 West, San Juan County, New Mexico, to be dedicated to a well to be drilled in the SE/4 NE/4 of said Section 15.

CASE 2569:

Application of Texaco Inc., for a quintuple completion, Lea County, New Mexico. Applicant, in the above-styled cause, seeks an order approving the quintuple completion (tubingless) of its G. L. Erwin "B" NCT-2 Well No. 3, located in Unit I, Section 35, Township 24 South, Range 37 East, Lea County, New Mexico, in such a manner as to produce oil from the Waddell, McKee, Fusselman, Devonian, and Drinkard zones, North Justis Field, through parallel strings of 2 7/8 and 2 3/8 inch casing cemented in a common well bore.

16-62

**SUPPLEMENTAL DOCKET: EXAMINER HEARING - WEDNESDAY MAY 23, 1962
9 A.M. CONFERENCE ROOM, STATE LAND OFFICE BUILDING, SANTA FE, N. M.**

The following case will be heard before Elvis A. Utz, Examiner, or Daniel S. Nutter Alternate Examiner.

CASE 2570:

Application of Cities Service Petroleum Corporation for a dual completion, Lea County, New Mexico. Applicant, in the above-styled cause, seeks permission to complete its State "AD" Well No. 2, located 3300 feet from the North line and 660 feet from the East line of Section 22, Township 10 South, Range 32 East, Lea County, New Mexico, as an oil-oil dual completion in the San Andres and Pennsylvanian formations in the Mescalero field with the production of oil to be through strings of 2-inch and 1½ or 1¼-inch tubing utilizing a crossover assembly.

BEFORE THE OIL CONSERVATION COMMISSION
OF THE STATE OF NEW MEXICO

IN THE MATTER OF THE APPLICATION
OF J. GLENN TURNER FOR AN ORDER
AUTHORIZING A GAS-GAS DUAL
COMPLETION IN THE BLANCO-MESAVERDE
GAS POOL AND THE BASIN DAKOTA GAS
POOL AND FOR AN UNORTHODOX GAS
WELL LOCATION

CASE NUMBER 2565

TO THE HONORABLE OIL CONSERVATION COMMISSION OF THE
STATE OF NEW MEXICO:

Comes now J. GLENN TURNER, as Operator, and respectfully requests an order authorizing a gas-gas dual completion in the Blanco-Mesaverde Gas Pool and in the Basin Dakota Gas Pool and for an unorthodox location for a well drilled through the Mesaverde Formation and to the Dakota Formation at a location nine hundred feet (900') from the West line and one thousand, eight hundred ten feet (1,810') from the North line of Section 9, Township 29 North, Range 10 West, N.M.P.M., San Juan County, New Mexico, and, for cause, would show as follows:

I

Applicant would show that the well heretofore drilled at the aforesaid location on that certain gas proration unit covering the N/2 of Section 9, Township 29 North, Range 10 West, San Juan County, New Mexico, covering a total of 320 acres, more or less, has been drilled to the base of the Dakota Formation, and that same has been completed in such a manner as to permit the production of gas from the Blanco-Mesaverde Gas Pool and the Basin Dakota Gas Pool through parallel strings of one and one-half inch (1-1/2") and two and one-sixteenths inch (2-1/16") tubing. Attached hereto as Exhibit "B" is a

schematic drawing of the manner of dually completing said well in such formations, which procedure is in accordance with sound conservation practices and will properly protect each such zone.

II

Applicant would further show that said well was initially projected to the Dakota Formation and that the location thereof was not an unorthodox location for wells to be completed in the Basin Dakota Gas Pool. In order to prevent economic waste and, in so doing, to permit the owners of the oil and gas lease covering the N/2 of Section 9, Township 29 North, Range 10 West, to recover their fair and equitable proportion of the natural gas which may underlie said acreage in the Mesaverde Formation, it was advisable to dually complete the same in the Mesaverde and Dakota Formations, but which completion in the Mesaverde Formation resulted in an unorthodox location for the Blanco-Mesaverde Gas Pool.

III

Attached hereto as Exhibit "A" is a Plat of the subject spacing unit which likewise illustrates the offsetting leases thereto.

IV

Applicant would respectfully show that the approval of the subject application will neither cause waste nor impair correlative rights.

Premises considered, the said J. Glenn Turner, as operator of said spacing unit, respectfully requests an order authorizing a gas-gas dual completion in the Blanco-Mesaverde Gas Pool and the Basin Dakota Gas Pool at the location of said well as specified herein and for an unorthodox gas location as aforesaid.

Respectfully submitted,

J. GLENN TURNER

By



William G. Webb

EXHIBIT "A"

R-10-W

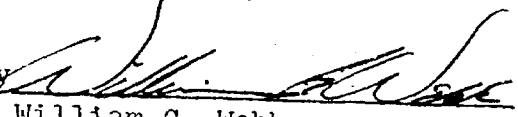
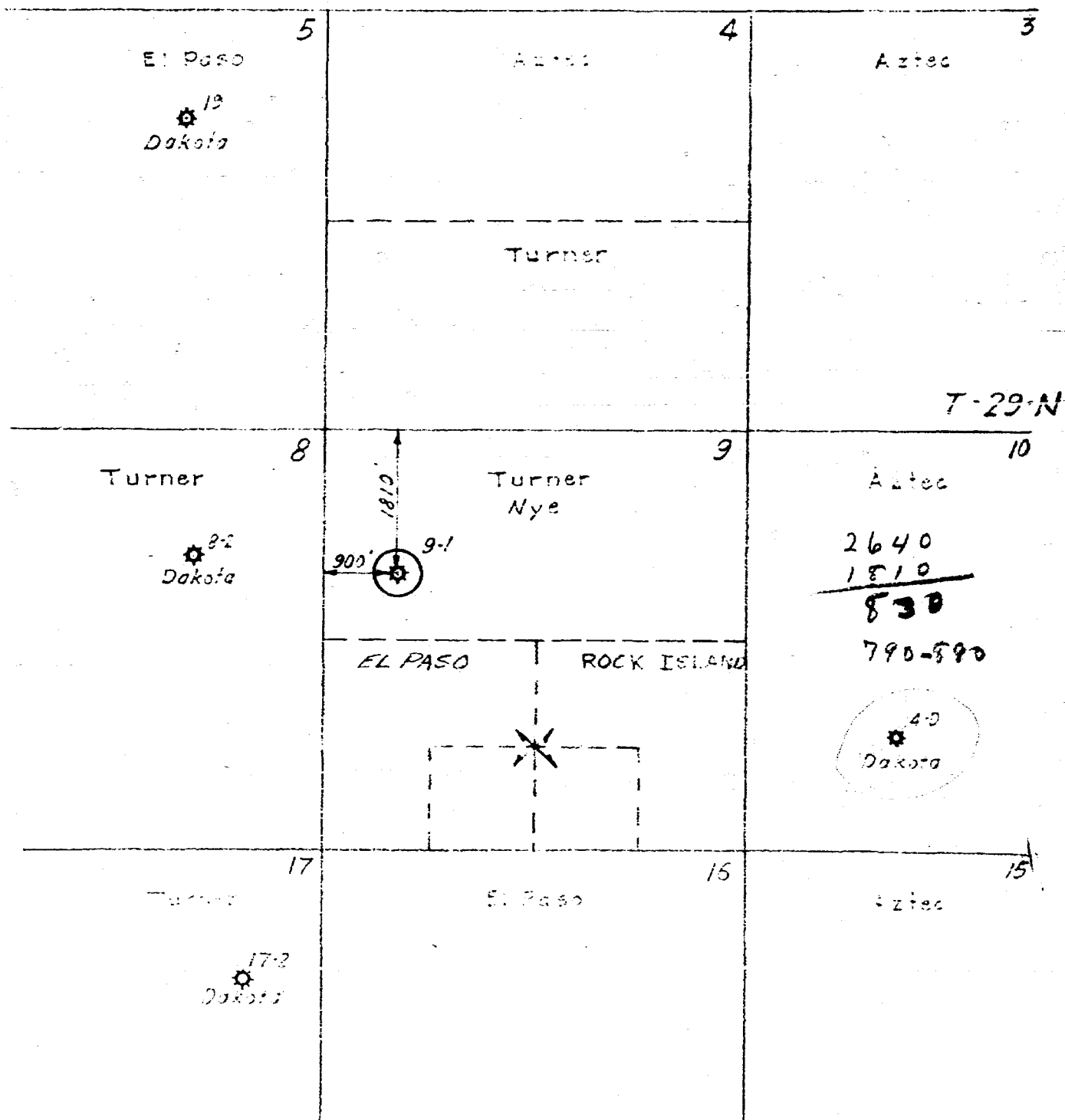

Scale: 3"=1 Mile

Chas J 565

EXHIBIT "E"

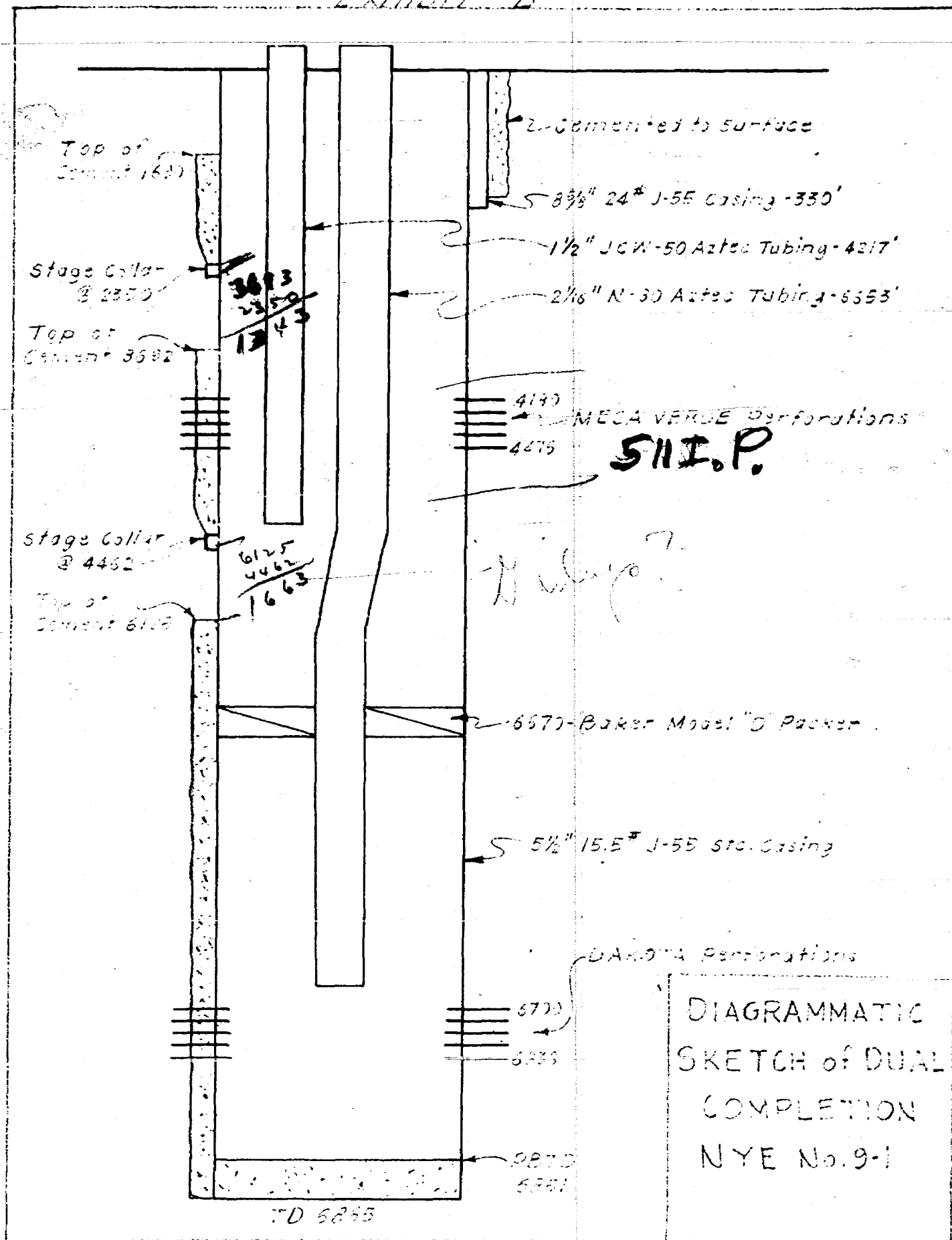

GOVERNOR
EDWIN L. MECHEM
CHAIRMAN

State of New Mexico
Oil Conservation Commission

LAND COMMISSIONER
E. S. JOHNNY WALKER
MEMBER



P. O. BOX 871
SANTA FE

STATE GEOLOGIST
A. L. PORTER, JR.
SECRETARY - DIRECTOR

June 4, 1962

Mr. William R. Federici
Seth, Montgomery, Federici & Andrews
Attorneys at Law
Box 828
Santa Fe, New Mexico

Re: Case No. 2563
Order No. A-2250
Applicant:
J. GLENN TURNER

Dear Sir:

Enclosed herewith are two copies of the above-referenced
Commission order recently entered in the subject case.

Very truly yours,

A handwritten signature in cursive script that reads "A. L. Porter, Jr.".

A. L. PORTER, Jr.
Secretary-Director

ir/

Carbon copy of order also sent to:

Hobbs OCC x

Artesia OCC

Aztec OCC x

OTHER

BEFORE THE
OIL CONSERVATION COMMISSION
Santa Fe, New Mexico
May 23, 1962

EXAMINER HEARING

IN THE MATTER OF:

Application of J. Glenn Turner for a dual completion and an unorthodox location, San Juan County, New Mexico. Applicant, in the above-styled cause, seeks an order authorizing the dual completion (conventional) of his Nye Well No. 9-1 at an unorthodox location 1810 feet from the North line and 900 feet from the West line of Section 9, Township 29 North, Range 10 West, San Juan County, New Mexico, in such a manner as to produce gas from the Blanco Mesaverde Gas Pool and the Basin Dakota Gas Pool through parallel strings of 1 1/2-inch and 2 1/16-inch tubing.

CASE 2565

BEFORE: Elvis A. Utz, Examiner

TRANSCRIPT OF PROCEEDINGS

MR. UTZ: We will take up Case 2565.

MR. MORRIS: Application of J. Glenn Turner for a dual completion and an unorthodox location, San Juan County, New Mexico.

MR. FEDERICI: William Federici of Seth, Montgomery, Federici and Andrews, for the applicant. I have one witness, Frank Barnes.

(Witness sworn.)

(Whereupon, Applicant's Exhibits A and B marked for identification.)

DEARNLEY-MEIER REPORTING SERVICE, Inc.

FARMINGTON, N. M.
PHONE 325-1182

ALBUQUERQUE, N. M.
PHONE 243-6691



FRANK C. BARNES

called as a witness, having been first duly sworn on oath, testified as follows:

DIRECT EXAMINATION

BY MR. FEDERICI:

Q Would you state your name and occupation?

A Frank C. Barnes.

Q Have you testified before the Commission at other times?

A Yes, I have. I'm a Consulting Geologist and I have testified before the Commission on numerous previous occasions.

Q And you are acting in the capacity of consultant in this case?

A For J. Glenn Turner and Associates, correct.

MR. FEDERICI: Are the qualifications of the witness acceptable?

MR. UTZ: Yes, sir. His qualifications have previously been accepted.

Q (By Mr. Federici) You have some exhibits there. I believe they're marked Exhibit A and B. Would you state what those exhibits are?

A Exhibit A is an acreage or township plat which shows the location of the well in question, the Turner Nye No. 9-1, which is located in the Northwest Quarter of Section 9, Township 29 North, Range 10 West. Exhibit B is a schematic diagram which shows the dual completion method that was used in completing the

DEARNLEY-MEIER REPORTING SERVICE, Inc.

FARMINGTON, N. M.
PHONE 325-1182

ALBUQUERQUE, N. M.
PHONE 243-6691



Turner Nye No. 9-1.

MR. FEDERICI: With the Examiner's permission, we would like to go to Exhibit B first.

MR. UTZ: Do we have copies of those exhibits, or did you submit copies with the application, or what?

A I believe copies were submitted with the application. I will turn these in. I have made some changes on Exhibit A. I have added to it and I think it would be of interest to the Commission to have the additions, so I will turn in my copy of Exhibit A at the conclusion of the testimony.

Q (By Mr. Federici) Would you explain Exhibit B?

A Exhibit B is more or less self-explanatory. It shows the dual completion method that was used in completing this particular well. It has no unusual features. It's a standard type dual completion that's used generally throughout the San Juan Basin and in this particular area in which the well is completed; from the upper zone through 1 1/2-inch tubing and from the lower zone through 2 1/16-inch tubing with a packer set to separate the two zones. I don't believe that the exhibit here is controversial or that it actually enters into the case. There isn't anything about it that is different than any other well or any other method used, other than the fact that it's producing from a formation that is not normally producing in the immediate vicinity of this well. If the Commission has any questions on Exhibit B, I'll be glad to answer them. Otherwise, I'll go on to Exhibit A.

DEARNLEY-MEIER REPORTING SERVICE, Inc.

FARMINGTON, N. M.
PHONE 325-1182

ALBUQUERQUE, N. M.
PHONE 243-6691



MR. UTZ: Go ahead to Exhibit A. We'll pick up the questions on both exhibits.

Q (By Mr. Federici) Before we go to Exhibit A, let me ask you about three questions here.

A Okay.

Q In your opinion, will this type of completion give complete separation of the producing formations?

A Yes.

Q Is this type of installation adequate to protect the different zones where only one zone is being produced at one time?

A Yes, it is.

Q In your opinion, would this type of completion be in the interest of conservation?

A Yes, sir, it would.

Q Would it protect correlative rights?

A Yes, I believe it would.

Q Would it prevent waste?

A It certainly would.

Q Now if you'll take Exhibit A and explain that to the Examiner.

A Exhibit A is a plat that shows the location of the well and I have added to my exhibit all of the surrounding wells which were not on the original exhibit when it was turned in. We have a rather unique and peculiar situation here. We have three pools involved in this. First of all, we have the Aztec-Pictured Cliffs

DEARNLEY-MEIER REPORTING SERVICE, Inc.

FARMINGTON, N. M.
PHONE 325-1182

ALBUQUERQUE, N. M.
PHONE 243-6691



DEARNLEY-MEIER REPORTING SERVICE, Inc.

FARMINGTON, N. M.
PHONE 325-1182

ALBUQUERQUE, N. M.
PHONE 243-0591

Pool, in which you have wells located on 160-acre spacing, four wells to a section, producing from the Pictured Cliffs sandstone at an average depth of between 2,000. 2100 feet, that surrounds the area of this well. In addition to that, you have to the north of this well, approximately one-half to three-quarters of a mile is the southern boundary of the Blanco Mesaverde Pool, which produces from the Mesaverde formation at a depth that runs around 4,000, 4500 feet. This well is not actually in the Blanco Mesaverde Pool. It's just outside the pool boundary, but it is within the legal jurisdiction of that pool under the Oil Commission regulations.

Then you have a third zone producing in the same area, and it is actually the zone in which this well was completed and the zone in which the completion was projected when the well was first spudded in, and that's the Dakota sandstone which produces from a depth of around 6,000 plus feet.

Now there are no Mesaverde wells in the immediate vicinity of the Turner Nye 9-1. There are no Mesaverde offsets; however, it is offset by Dakota wells and it is offset by Pictured Cliff wells. The general sand condition in the area has not been entirely favorable to drilling Mesaverde wells. It hasn't been considered economically feasible to drill Mesaverde wells in this immediate vicinity.

In the course of drilling the Turner Nye Well, due to sample electric logs and other geological data, the operator



concluded that there was an opportunity here that could be exploited in developing an additional shallower zone, to which he had the lease rights, namely, the Mesaverde formation. So they went ahead and dually completed the well mainly as a test. It made approximately half a million cubic feet of gas from the well, which obviously is not a great well by anyone's standards.

If the operator is permitted to go ahead with the dual completion, there may be other dual completions with this operator and other operators, but it is doubtful that with that magnitude any of them would drill Mesaverde wells on their own.

It's a perfect location to the Dakota sandstone within the pool boundaries of the Basin Dakota Pool, but as far as the Mesaverde formation goes, the normal spacing pattern is one well in the Northeast quadrant of the section and one well in the Southeast quadrant of the section; and this well is in opposition to that and that is what makes it an unorthodox location. The operator asks that the Commission allow him to go ahead with his production from this well, on the grounds that the Mesaverde production is too small to warrant drilling a Mesaverde well under any circumstances conceivable now or in the immediate or long-term future.

Q Approximately what would it cost to drill a well to the Mesaverde formation?

A It would cost somewhere between, oh, possibly \$50,000 under present completion practices, and with a well that small it

DEARNLEY-MEIER REPORTING SERVICE, Inc.

FARMINGTON, N. M.
PHONE 325-1182

ALBUQUERQUE, N. M.
PHONE 243-6691



DEARNLEY-MEIER REPORTING SERVICE, Inc.

FARMINGTON, N. M.
PHONE 325-1182

ALBUQUERQUE, N. M.
PHONE 243-6691

just simply would never pay out, you just couldn't do it. You have proration in the Mesaverde formation. In addition to that, the general gas production in the area and the take by the pipeline companies is not as good as it could be right now. Your marketing situation is not conducive to marginal drilling at the present time.

Q Do Exhibits A and B accurately reflect what is shown on them?

A Yes, sir, they do, except that I have added all the wells that offset the Section 9 and the Turner Nye Well on my copy of Exhibit A. I will turn this in to the Commission.

Q Those are shown in red?

A Correct. I have shown them all in red and marked "PC" for Pictured Cliff wells, and "D" for Dakota wells, and no Mesaverde wells immediately offsetting this one.

MR. FEDERICI: We offer Exhibits A and B in evidence.

MR. UTZ: Without objection, Exhibits A and B will be entered into the record of this case.

Q (By Mr. Federici) Is there anything further you wish to take up?

A No.

MR. FEDERICI: I have nothing further.

CROSS EXAMINATION

BY MR. UTZ:

Q What is the nearest Mesaverde well, what is its location?



DEARNLEY-MEIER REPORTING SERVICE, Inc.

FARMINGTON, N. M.
PHONE 325-1182

ALBUQUERQUE, N. M.
PHONE 243-6691

A I don't know the exact location of it. The nearest well is at least a mile or mile and a half away inside the boundaries of the Blanco Mesaverde Pool, and it's located north, north and northwest of this well, but I don't know the exact location. I only tried to plot the wells that were within a mile or mile and a half that would constitute any kind of a direct offset to the well.

Q You don't know whether it's a standard location or not?

A As far as I know, the locations, the nearest Mesaverde locations are standard locations.

Q Do you know why Mr. Turner decided to drill this well in this particular location? Now this was a Dakota single completion that was projected?

A That is correct. It was not intended as a Mesaverde well. There was no intention at all in the beginning to complete it, it was just something that developed during the drilling of this well.

Q Did he drill this well on this location to get as close as he could to known production?

A I believe that had something to do with it. The sands in this area in the Mesaverde and the Dakota sandstone leave a good deal to be desired from the operator's point of view. The area is also close to Kutz Canyon. You have a certain number of rather localized terrain problems due to gullying in the area and small mesas, and extremely rough terrain. The area is flat, but in local



areas you do have some trouble getting the location exactly where the law requires it.

Q In logging this well, he determined that there was a good possibility for the Mesaverde to be productive, and therefore decided to try to dual it?

A Yes, sir, it was done as an experiment without any great hope of success when they started, and obviously a half million cubic feet well from that depth is nothing to become overjoyed about. I think that this well will have a bearing on future Mesaverde development; if the operators can go ahead and exploit favorable sand conditions when they occur in a Mesaverde well, there probably will be additional Mesaverde dual wells in this area. If they have to drill wells on their own, I don't think the area will be developed, as it is too costly.

Q Referring to Exhibit B, the top of the cement on the 5 1/2-inch casing is 6125, the stage collar on the same string is at 4462, which leaves 1663 feet of open hole in that immediate area. Do you know what formations are behind that pipe there?

A The cement in this well was put up, calculated to come up to a depth to protect the Pictured Cliffs sandstone between the Pictured Cliff and the Mesaverde. All of the potential producing horizons in the area are protected. Now there is one sand, the Farmington sandstone or its equivalent sometimes produces in the area, and this is not cemented off in this particular well. However, there was nothing in the Farmington or that zone to

DEARNLEY-MEIER REPORTING SERVICE, Inc.

FARMINGTON, N. M.
PHONE 325-1182

ALBUQUERQUE, N. M.
PHONE 243-6691



DEARNLEY-MEIER REPORTING SERVICE, Inc.

FARMINGTON, N. M.
PHONE 325-1182

ALBUQUERQUE, N. M.
PHONE 243-6691

indicate any production in this well. The sand was fairly tight and there's nothing to indicate that it isn't fully protected by the mud that was left in the annulus between the casing and the hole.

Q Do you know whether or not there was any Gallup between the Mesaverde and the Dakota in this area?

A The Gallup sandstone does exist in this area, but there again there was nothing to indicate that the Gallup sandstone would be worth testing or dually completing in this particular well.

Q Do you know what the depth of the Pictured Cliff was, or in the offsetting wells?

A In the offset wells, the Pictured Cliff in this area runs approximately 2,000 to 2100 feet, and it would be the same in the Turner Nye Well. It would be somewhere between two --

Q It would be between 1690 and 2350, then?

A Yes, it would be protected by the cement.

MR. UTZ: Are there other questions of the witness? The witness may be excused.

(Witness excused.)

MR. UTZ: Are there any statements in this case? The case will be taken under advisement and the hearing is adjourned.

* * * * *



STATE OF NEW MEXICO)
) ss
COUNTY OF BERNALILLO)

I, ADA DEARNLEY, Notary Public in and for the County of Bernalillo, State of New Mexico, do hereby certify that the foregoing and attached Transcript of Proceedings was reported by me in stenotype and that the same was reduced to typewritten transcript under my personal supervision and contains a true and correct record of said proceedings, to the best of my knowledge, skill and ability.

DATED this 9th day of June, 1962, in the City of Albuquerque, County of Bernalillo, State of New Mexico.

Ada Dearnley
NOTARY PUBLIC

My Commission Expires:

June 19, 1963.

I do hereby certify that the foregoing is a complete record of the proceedings in the Examiner hearing of Case No. 2565 heard by me on *May 23* 19*62*.
James C. Self Examiner
New Mexico Oil Conservation Commission

DEARNLEY-MEIER REPORTING SERVICE, Inc.

FARMINGTON, N. M.
PHONE 325-1182

ALBUQUERQUE, N. M.
PHONE 243-6691



BEFORE EXAMINER UTZ
OIL CONSERVATION COMMISSION
April EXHIBIT NO. A
CASE NO. 2565

EXHIBIT A

R-10-W

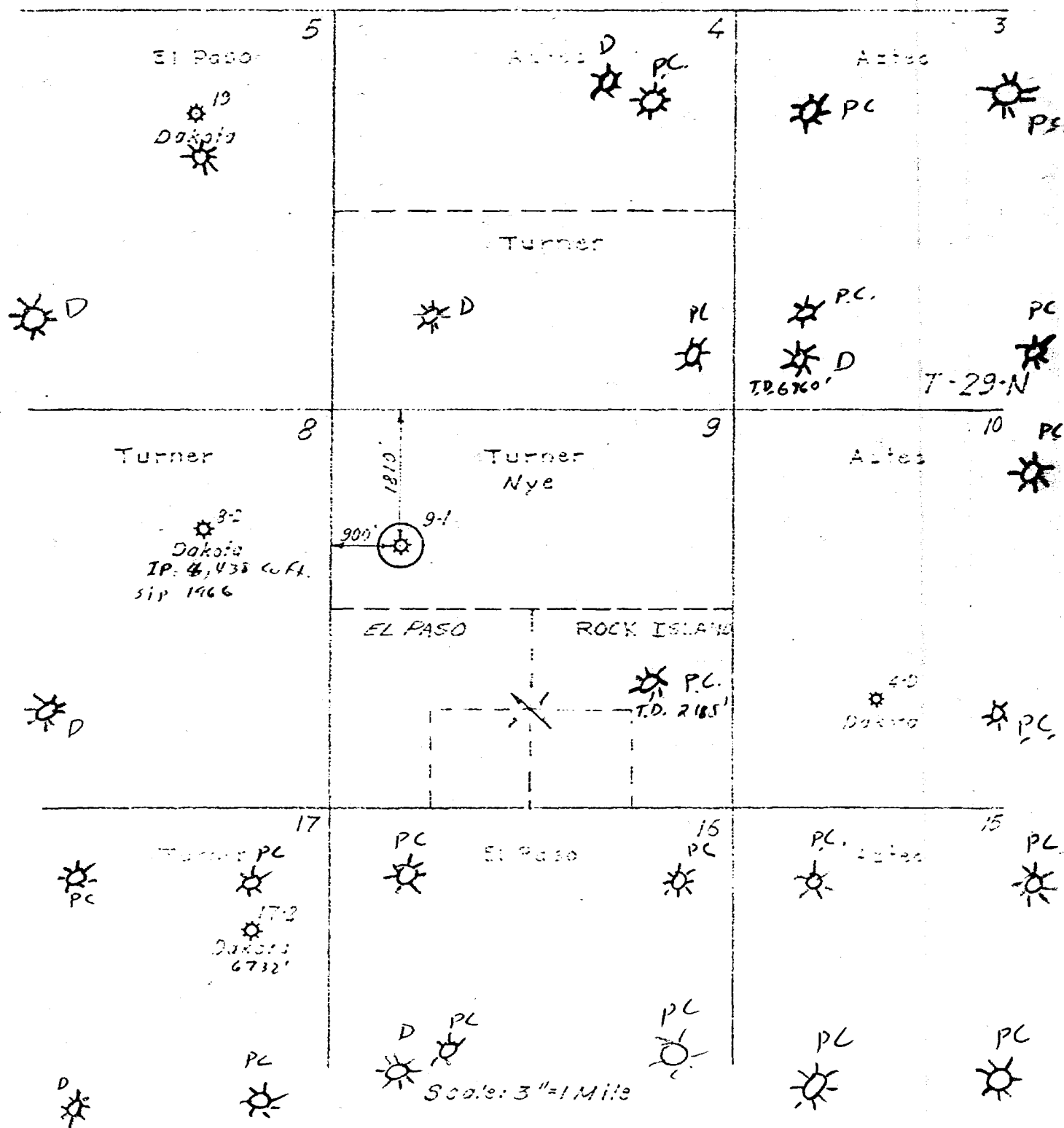

EXHIBIT "B"

