

CASE 6873: HARVEY E. YATES COMPANY FOR  
AN UNORTHODOX GAS WELL LOCATION, EDDY  
COUNTY, NEW MEXICO

CASE NO.

6873

---

APPLICATION,  
TRANSCRIPTS,  
SMALL EXHIBITS,

ETC.



**BRUCE KING**  
**GOVERNOR**

LARRY KEHOE  
SECRETARY

STATE OF NEW MEXICO  
ENERGY AND MINERALS DEPARTMENT  
OIL CONSERVATION DIVISION

**May 14, 1980**

POST OFFICE BOX 2088  
STATE LAND OFFICE BUILDING  
SANTA FE, NEW MEXICO 87501  
(505) 827-2434

Mr. Robert Strand, Attorney  
Harvey E. Yates Company  
P. O. Box 1933  
Roswell, New Mexico 88201

Re: CASE NO. 6873  
ORDER NO. R-6341

**Applicant:**

**Harvey E. Yates Company**

Dear Sir:

Enclosed herewith are two copies of the above-referenced Division order recently entered in the subject case.

Yours very truly,

JOE D. RAMEY  
Director

JDR/fd

Copy of order also sent to:

|             |          |
|-------------|----------|
| Hobbs OCD   | <u>x</u> |
| Artesia OCD | <u>x</u> |
| Aztec OCD   |          |

**Other**

STATE OF NEW MEXICO  
ENERGY AND MINERALS DEPARTMENT  
OIL CONSERVATION DIVISION

IN THE MATTER OF THE HEARING  
CALLED BY THE OIL CONSERVATION  
DIVISION FOR THE PURPOSE OF  
CONSIDERING:

CASE NO. 6873  
Order No. R-6341

APPLICATION OF HARVEY E. YATES COMPANY  
FOR AN UNORTHODOX GAS WELL LOCATION,  
EDDY COUNTY, NEW MEXICO.

ORDER OF THE DIVISION

BY THE DIVISION:

This cause came on for hearing at 9 a.m. on April 23, 1980,  
at Santa Fe, New Mexico, before Examiner Richard L. Stamets.

NOW, on this 13th day of May, 1980, the Division Director,  
having considered the testimony, the record, and the recommenda-  
tions of the Examiner, and being fully advised in the premises,

FINDS:

- (1) That due public notice having been given as required  
by law, the Division has jurisdiction of this cause and the  
subject matter thereof.
- (2) That the applicant, Harvey E. Yates Company, seeks  
approval of an unorthodox gas well location for its North  
Travis 12 Deep Well No. 1 to be drilled 660 feet from the South  
line and 1650 feet from the East line of Section 12, Township  
18 South, Range 28 East, NMPM, to test the Wolfcamp and Pennsyl-  
vanian formations, Travis Field, Eddy County, New Mexico.
- (3) That as a gas well in the Wolfcamp or Lower Pennsyl-  
vanian formation, the S/2 of said Section 12 is to be dedicated  
to the well.
- (4) That said North Travis 12 Deep Well No. 1 is to be  
drilled as a development well at a standard oil well location  
in the Travis-Upper Pennsylvanian Pool.
- (5) That approval of the application will permit the appli-  
cant to produce any gas zones encountered in the Wolfcamp or  
other Pennsylvanian zones without the drilling of a second  
(unnecessary) well.

-2-

Case No. 6873  
Order No. R-6341

(6) That no offset operator objected to the proposed unorthodox location.

(7) That approval of the subject application will afford the applicant the opportunity to produce its just and equitable share of the gas in the subject pool, will prevent the economic loss caused by the drilling of unnecessary wells, avoid the augmentation of risk arising from the drilling of an excessive number of wells, and will otherwise prevent waste and protect correlative rights.

**IT IS THEREFORE ORDERED:**

(1) That an unorthodox gas well location for the Wolfcamp and Pennsylvanian formations is hereby approved for the Harvey S. Yates Company North Travis 12 Deep Well No. 1 to be drilled at a point 660 feet from the South line and 1650 feet from the East line of Section 12, Township 18 South, Range 28 East, MNPM, Travis Field, Eddy County, New Mexico.

(2) That as a gas well in the Wolfcamp or Lower Pennsylvanian formation, the S/2 of said Section 12 shall be dedicated to the above-described well.

(3) That jurisdiction of this cause is retained for the entry of such further orders as the Division may deem necessary.

DONE at Santa Fe, New Mexico, on the day and year hereinabove designated.

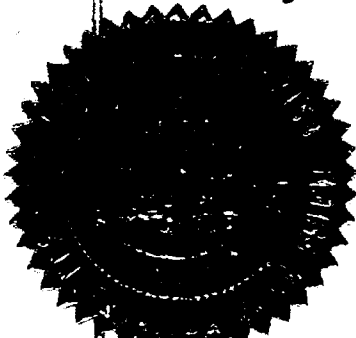

SEAL

STATE OF NEW MEXICO  
OIL CONSERVATION DIVISION

*Joe D. Ramey*  
JOE D. RAMEY  
Director

14/

STATE OF NEW MEXICO  
ENERGY AND MINERALS DEPARTMENT  
OIL CONSERVATION DIVISION  
STATE LAND OFFICE BLDG.  
SANTA FE, NEW MEXICO  
23 April 1980

EXAMINER HEARING

IN THE MATTER OF:

Application of Harvey E. Yates Com-  
pany for an unorthodox gas well loca-  
tion, Eddy County, New Mexico.

CASE  
6873

BEFORE: Richard L. Stamets

TRANSCRIPT OF HEARING

A P P E A R A N C E S

For the Oil Conservation  
Division:

Ernest L. Padilla, Esq.  
Legal Counsel to the Division  
State Land Office Bldg.  
Santa Fe, New Mexico 87501

For the Applicant:

Robert Strand, Esq.  
Roswell, New Mexico

SALLY W. BOYD, C.S.R.

Rt. 1 Box 193-B  
Santa Fe, New Mexico 87501  
Phone (505) 455-7409

I N D E X

1

2

3

RANDOLPH C. SMITH

4

Direct Examination by Mr. Strand

4

5

Cross Examination by Mr. Stamets

8

6

7

8

9

10

E X H I B I T S

11

12

Applicant Exhibit One, Isopach

5

13

Applicant Exhibit Two, Isopach

5

14

Applicant Exhibit Three, Structure Map

6

15

Applicant Exhibit Four, Cross Section

6

16

17

18

19

20

21

22

23

24

25

SALLY W. BOYD, C.S.R.

Rt. 1 Box 193-B  
Santa Fe, New Mexico 87501  
Phone (505) 435-7409

1 MP. STAMETS: We'll call next Case 6873.

2 MR. PADILLA: Application of Harvey E.

3 Yates Company for an unorthodox gas well location, Eddy  
4 County, New Mexico.

5 MR. STRAND: Mr. Examiner, Robert H.  
6 Strand, Attorney, from Roswell, New Mexico, appearing for the  
7 applicant, Harvey E. Yates Company. I have one witness to  
8 be sworn.

9  
10 (Witness sworn.)

11  
12 RANDOLPH C. SMITH  
13 being called as a witness and having been duly sworn upon his  
14 oath, testified as follows, to-wit:

15  
16 DIRECT EXAMINATION

17 BY MR. STRAND:

18 Mr. Examiner, for the record, the appli-  
19 cation in this case referred to the name of the well as the  
20 Travis Deep Well No. 5. Subsequent to filing the application  
21 the USGS requested that that name be changed and the name  
22 of the well will be the North Travis 12 Deep No. 1.

23 MR. STAMETS: The North Travis 12 Deep--

24 MR. STRAND: Deep No. 1.

25 MR. STAMETS: Okay.

SALLY W. BOYD, C.S.R.

El. 1 Box 191-B

Santa Fe, New Mexico 87501

Phone (505) 435-7409

1 Q State your name, please?

2 A My name is Randolph C. Smith.

3 Q Mr. Smith, what is your occupation and

4 your address?

5 A I'm an exploration geologist for Harvey

6 E. Yates Company in Midland, Texas.

7 Q Mr. Smith, have you testified before the

8 Commission in the past?

9 A Yes, I have.

10 Q Are your qualifications a matter of record?

11 A Yes, they are.

12 MR. STRAND: Mr. Examiner, are Mr. Smith's

13 qualifications acceptable?

14 MR. STAMETS: They are.

15 Q Mr. Smith, would you state the purpose

16 of the application in Case Number 6873?

17 A The purpose of Case 6873 is for Harvey

18 E. Yates Company to drill an unorthodox location in the Mor-

19 row in Eddy County, New Mexico, in Section 12, 18 South, 28

20 East.

21 Q What is the exact location of the well,

22 Mr. Smith?

23 A The exact location is 1650 from the east

24 line and 660 from the south line of Section 12, 18, 28.

25 Q Mr. Smith, what acreage will be dedicated

SALLY W. BOYD, C.S.R.

Rt. 1 Box 193-B  
Santa Fe, New Mexico 87501  
Phone (505) 455-7409

1 to that well as to the Morrow?

2 A 320 acres or the south half of Section 12  
3 of 18, 28.

4 Q Mr. Smith, with regard to the well that  
5 the applicant proposes to drill at this location, does it  
6 have other objective formations other than the Morrow forma-  
7 tion?

8 A Yes, it does. It is primarily a Canyon  
9 prospect.

10 Q But it is correct that the well will be  
11 drilled to the Morrow formation?

12 A That is true.

13 Q Mr. Smith, have you prepared certain ex-  
14 hibits relating to the application in this case?

15 A Yes, I have.

16 Q Referring to Exhibit Number One, will  
17 you please explain that exhibit?

18 A Yes. Exhibit Number One is a Canyon  
19 Bank Isopach gross time. You can see the location of the  
20 well in Section 12 of 18, 28, which is highlighted with a  
21 red arrow there. This is, like I said before, the gross  
22 lime Canyon Isopach map.

23 Q Mr. Smith, referring to Exhibit Number  
24 Two, will you explain that exhibit and its relationship to  
25 the application and to Exhibit One?

SALLY W. BOYD, C.S.R.

Rt. 1 Box 193-B

Santa Fe, New Mexico 87501

Phone (505) 455-7409

1 A Exhibit Number Two is a Canyon Isopach  
2 of the net pay of this carbonate reservoir. Once again you  
3 see the well location indicated with a red arrow and a spotted  
4 location.

5 Q Mr. Smith, under the Travis Upper Penn  
6 Pool rules relating to this Canyon well, is that an orthodox  
7 location for that particular formation?

8 A Yes, it is.

9 Q Mr. Smith, referring to Exhibit Number  
10 Three, will you please explain that?

11 A Exhibit Number Three is a structural map  
12 of the Morrow on top of the Morrow formation in this Travis  
13 Deep area.

14 Q And referring to Exhibit Number Four,  
15 please explain that.

16 A Exhibit Number Four is a north/south  
17 stratigraphic cross section hung on the top of the Lower  
18 Morrow, showing the relationship between the two wells,  
19 Harvey E. Yates Travis Deep No. 3, in Section 14, 18, 28,  
20 and Amoco Empire South Deep No. 2 in Section 12, of  
21 18, 28.

22 This cross section just simply shows the  
23 relationship of the Canyon reservoir, which is colored in  
24 blue, with perforations in red, in the HEYCO well and its  
25 near absence in the Amoco well to the north; the presence of

SALLY W. BOYD, C.S.R.

Rt. 1 Box 193-B  
Santa Fe, New Mexico 87501  
Phone (505) 435-7409

1 the Lower Morrow Sands in the HEYCO well and their absence  
2 to the north in the Amoco well.

3 The Lower Morrow Sands, the productive  
4 sands, are colored in yellow there.

5 Q Mr. Smith, in summarizing your testimony  
6 relating to these exhibits, would it be correct to say that  
7 the location chosen is a primary location for the Canyon  
8 formation and that this application was required due to the  
9 fact it will be deepened to the Morrow?

10 A Yes, it is. The reason for the two  
11 Canyon maps is that this is primarily a Pennsylvanian Canyon  
12 prospect. We would like to have drilled the well in the  
13 orthodox location of 1980 from the east, 660 from the south,  
14 but there is presently a shallow San Andres well there, so  
15 we felt that we needed to move to the west -- excuse me, to  
16 the east, to obtain the best Canyon reservoir. We did not  
17 want to move to the north. You can look at these two maps,  
18 you can see that we're losing the reservoir, the gross pay,  
19 as well as -- excuse me, the net pay, as well as the gross  
20 reservoir itself to the north and to the west. That's why  
21 we requested to move the location to the east 300 feet.

22 Q Mr. Smith, could you tell me the status  
23 of the land status of the two offset locations to the south  
24 and to the east of your proposed location?

25 A The land status is subject to the same

SALLY W. BOYD, C.S.R.

Rt. 1 Box 193-B  
Santa Fe, New Mexico 87501  
Phone (505) 455-7409

SALLY W. BOYD, C.S.R.

Rt. 1 Box 193-B  
Santa Fe, New Mexico 87501  
Phone (305) 455-7409

1 operating agreement which Harvey E. Yates is the operator.

2 Q Mr. Smith, is it your opinion that appro-  
3 val of this application will allow the applicant to produce  
4 its just and equitable share of gas, prevent drilling of  
5 excess wells, reduce risk, protect correlative rights, and  
6 otherwise promote conservation and prevent waste?

7 A Yes, it is.

8 MR. STRAND: I have nothing further, Mr.  
9 Examiner.

10

11

CROSS EXAMINATION

12

BY MR. STAMETS:

13

Q I presume the reason for the location is  
14 that this is primarily a Canyon test.

15

A That's correct.

16

Q And you don't want to waste drilling to  
17 that point in order to have to drill another well to the  
18 Morrow?

19

A That's correct.

20

Q Does Harvey E. Yates have the gas rights  
21 in the other Wolfcamp and Pennsylvanian formations in this  
22 area?

23

A Yes, we do. Yes.

24

MR. STRAND: Mr. Smith, were Exhibits  
25 One through Four prepared by you or under your supervision?

1 A Yes, they were.

2 MR. STRAND: Mr. Examiner, I move the  
3 admission of Exhibits One through Four.

4 MR. STAMETS: These exhibits will be  
5 admitted.

6 Are there any other questions of the  
7 witness? He may be excused.

8 Anything further in this case?

9 The case will be taken under advisement.

10  
11 (Hearing concluded.)  
12  
13  
14  
15  
16  
17  
18  
19  
20  
21  
22  
23  
24  
25

SALLY W. BOYD, C.S.R.

Rt. 1 Box 193-B  
Santa Fe, New Mexico 87501  
Phone (505) 455-7409

REPORTER'S CERTIFICATE

I, SALLY W. BOYD, C.S.R., DO HEREBY CERTIFY that the foregoing Transcript of Hearing before the Oil Conservation Division was reported by me; that the said transcript is a full, true, and correct record of the hearing, prepared by me to the best of my ability.

Sally W. Boyd C.S.R.

I do hereby certify that the foregoing is a complete record of the proceedings in the Examiner hearing of Case No. 6873, heard by me on 4-23 19-80.

Richard L. Shank, Examiner  
Oil Conservation Division

SALLY W. BOYD, C.S.R.

El. 1 Box 150-B

Santa Fe, New Mexico 87501

Phone (505) 455-7499

STATE OF NEW MEXICO  
ENERGY AND MINERALS DEPARTMENT  
OIL CONSERVATION DIVISION  
STATE LAND OFFICE BLDG.  
SANTA FE, NEW MEXICO  
23 April 1980

EXAMINER HEARING

IN THE MATTER OF:

Application of Harvey E. Yates Com-  
pany for an unorthodox gas well loca-  
tion, Eddy County, New Mexico.

CASE  
6873

BEFORE: Richard L. Stamets

TRANSCRIPT OF HEARING

A P P E A R A N C E S

For the Oil Conservation  
Division:

Ernest L. Padilla, Esq.  
Legal Counsel to the Division  
State Land Office Bldg.  
Santa Fe, New Mexico 87501

For the Applicant:

Robert Strand, Esq.  
Roswell, New Mexico

SALLY W. BOYD, C.S.R.  
Rt. 1 Box 195-B  
Santa Fe, New Mexico 87501  
Phone (505) 435-7409

## I N D E X

1  
2  
3 RANDOLPH C. SMITH4  
5 Direct Examination by Mr. Strand6  
7 Cross Examination by Mr. Stamets  
8

## E X H I B I T S

9  
10  
11  
12 Applicant Exhibit One, Isopach 5

13 Applicant Exhibit Two, Isopach 5

14 Applicant Exhibit Three, Structure Map 6

15 Applicant Exhibit Four, Cross Section 6  
16  
17  
18  
19  
20  
21  
22  
23  
24  
25

SALLY W. BOYD, C.S.R.

Rt. 1 Box 193-B  
Santa Fe, New Mexico 87501  
Phone (505) 455-7409

1 MR. STAMETS: We'll call next Case 6873.

2 MR. PADILLA: Application of Harvey E.  
3 Yates Company for an unorthodox gas well location, Eddy  
4 County, New Mexico.

5 MR. STRAND: Mr. Examiner, Robert H.  
6 Strand, Attorney, from Roswell, New Mexico, appearing for the  
7 applicant, Harvey E. Yates Company. I have one witness to  
8 be sworn.

9  
10 (Witness sworn.)

11  
12 RANDOLPH C. SMITH  
13 being called as a witness and having been duly sworn upon his  
14 oath, testified as follows, to-wit:

15  
16  
17 DIRECT EXAMINATION

18 BY MR. STRAND:

19 Mr. Examiner, for the record, the appli-  
20 cation in this case referred to the name of the well as the  
21 Travis Deep Well No. 5. Subsequent to filing the application  
22 the USGS requested that that name be changed and the name  
23 of the well will be the North Travis 12 Deep No. 1.

24 MR. STAMETS: The North Travis 12 Deep--

25 MR. STRAND: Deep No. 1.

MR. STAMETS: Okay.

SALLY W. BOYD, C.S.R.

Rt. 1 Box 150-B  
Santa Fe, New Mexico 87501  
Phone (505) 435-7409

SALLY W. BOYD, C.S.R.

Rt. 1 Box 193-B  
Santa Fe, New Mexico 87501  
Phone (505) 435-7409

Page 4

1 Q State your name, please?

2 A My name is Randolph C. Smith.

3 Q Mr. Smith, what is your occupation and  
4 your address?

5 A I'm an exploration geologist for Harvey  
6 E. Yates Company in Midland, Texas.

7 Q Mr. Smith, have you testified before the  
8 Commission in the past?

9 A Yes, I have.

10 Q Are your qualifications a matter of record?

11 A Yes, they are.

12 MR. STRAND: Mr. Examiner, are Mr. Smith's  
13 qualifications acceptable?

14 MR. STAMETS: They are.

15 Q Mr. Smith, would you state the purpose  
16 of the application in Case Number 6873?

17 A The purpose of Case 6873 is for Harvey  
18 E. Yates Company to drill an unorthodox location in the Mor-  
19 row in Eddy County, New Mexico, in Section 12, 18 South, 28  
20 East.

21 Q What is the exact location of the well,  
22 Mr. Smith?

23 A The exact location is 1650 from the east  
24 line and 660 from the south line of Section 12, 18, 28.

25 Q Mr. Smith, what acreage will be dedicated

SALLY W. BOYD, C.S.R.

Rt. 1 Box 193-B  
Santa Fe, New Mexico 87501  
Phone (505) 455-7409

1 to that well as to the Morrow?

2 A 320 acres or the south half of Section 12  
3 of 18, 28.

4 Q Mr. Smith, with regard to the well that  
5 the applicant proposes to drill at this location, does it  
6 have other objective formations other than the Morrow forma-  
7 tion?

8 A Yes, it does. It is primarily a Canyon  
9 prospect.

10 Q But it is correct that the well will be  
11 drilled to the Morrow formation?

12 A That is true.

13 Q Mr. Smith, have you prepared certain ex-  
14 hibits relating to the application in this case?

15 A Yes, I have.

16 Q Referring to Exhibit Number One, will  
17 you please explain that exhibit?

18 A Yes. Exhibit Number One is a Canyon  
19 bank Isopach gross lime. You can see the location of the  
20 well in Section 12 or 18, 28, which is highlighted with a  
21 red arrow there. This is, like I said before, the gross  
22 lime Canyon Isopach map.

23 Q Mr. Smith, referring to Exhibit Number  
24 Two, will you explain that exhibit and its relationship to  
25 the application and to Exhibit One?

1 A Exhibit Number Two is a Canyon Isopach  
2 of the net pay of this carbonate reservoir. Once again you  
3 see the well location indicated with a red arrow and a spotted  
4 location.

5 Q Mr. Smith, under the Travis Upper Penn  
6 Pool rules relating to this Canyon well, is that an orthodox  
7 location for that particular formation?

8 A Yes, it is.

9 Q Mr. Smith, referring to Exhibit Number  
10 Three, will you please explain that?

11 A Exhibit Number Three is a structural map  
12 of the Morrow on top of the Morrow formation in this Travis  
13 Deep area.

14 Q And referring to Exhibit Number Four,  
15 please explain that.

16 A Exhibit Number Four is a north/south  
17 stratigraphic cross section hung on the top of the Lower  
18 Morrow, showing the relationship between the two wells,  
19 Harvey E. Yates Travis Deep No. 3, in Section 14, 18, 28,  
20 and Amoco Empire Empire South Deep No. 2 in Section 12, of  
21 18, 28.

22 This cross section just simply shows the  
23 relationship of the Canyon reservoir, which is colored in  
24 blue, with perforations in red, in the HEYCO well and its  
25 near absence in the Amoco well to the north; the presence of

SALLY W. BOYD, C.S.R.

Rt. 1 Box 191-B  
Santa Fe, New Mexico 87501  
Phone (505) 455-7409

1 the Lower Morrow Sands in the HEYCO well and their absence  
2 to the north in the Amoco well.

3 The Lower Morrow Sands, the productive  
4 sands, are colored in yellow there.

5 Q Mr. Smith, in summarizing your testimony  
6 relating to these exhibits, would it be correct to say that  
7 the location chosen is a primary location for the Canyon  
8 formation and that this application was required due to the  
9 fact it will be deepened to the Morrow?

10 A Yes, it is. The reason for the two  
11 Canyon maps is that this is primarily a Pennsylvanian Canyon  
12 prospect. We would like to have drilled the well in the  
13 orthodox location of 1980 from the east, 660 from the south,  
14 but there is presently a shallow San Andres well there, so  
15 we felt that we needed to move to the west -- excuse me, to  
16 the east, to obtain the best Canyon reservoir. We did not  
17 want to move to the north. You can look at these two maps,  
18 you can see that we're losing the reservoir, the gross pay,  
19 as well as -- excuse me, the net pay, as well as the gross  
20 reservoir itself to the north and to the west. That's why  
21 we requested to move the location to the east 300 feet.

22 Q Mr. Smith, could you tell me the status  
23 of the land status of the two offset locations to the south  
24 and to the east of your proposed location?

25 A The land status is subject to the same

SALLY W. BOYD, C.S.R.

Rt. 1 Box 193-B  
Santa Fe, New Mexico 87501  
Phone (505) 455-7409

SALLY W. BOYD, C.S.R.

Rt. 1 Box 195-B  
Santa Fe, New Mexico 87501  
Phone (505) 435-7409

Page 8

1 operating agreement which Harvey E. Yates is the operator.

2 Q Mr. Smith, is it your opinion that appro-  
3 val of this application will allow the applicant to produce  
4 its just and equitable share of gas, prevent drilling of  
5 excess wells, reduce risk, protect correlative rights, and  
6 otherwise promote conservation and prevent waste?

7 A Yes, it is.

8 MR. STRAND: I have nothing further, Mr.  
9 Examiner.

10

11

CROSS EXAMINATION

12

BY MR. STAMETS:

13

Q I presume the reason for the location is  
14 that this is primarily a Canyon test.

15

A That's correct.

16

Q And you don't want to waste drilling to  
17 that point in order to have to drill another well to the  
18 Morrow?

19

A That's correct.

20

Q Does Harvey E. Yates have the gas rights  
21 in the other Wolfcamp and Pennsylvanian formations in this  
22 area?

23

A Yes, we do. Yes.

24

25

MR. STRAND: Mr. Smith, were Exhibits  
One through Four prepared by you or under your supervision?

1 A Yes, they were.

2 MR. STRAND: Mr. Examiner, I move the  
3 admission of Exhibits One through Four.

4 MR. STAMETS: These exhibits will be  
5 admitted.

6 Are there any other questions of the  
7 witness? He may be excused.

8 Anything further in this case?

9 The case will be taken under advisement.

10  
11 (Hearing concluded.)  
12  
13  
14  
15  
16  
17  
18  
19  
20  
21  
22  
23  
24  
25

SALLY W. BOYD, C.S.R.

Rt. 1 Box 193-B  
Santa Fe, New Mexico 87501  
Phone (505) 455-7409

REPORTER'S CERTIFICATE

I, SALLY W. BOYD, C.S.R., DO HEREBY CERTIFY that  
the foregoing Transcript of Hearing before the Oil Conserva-  
tion Division was reported by me; that the said transcript  
is a full, true, and correct record of the hearing, prepared  
by me to the best of my ability.

SALLY W. BOYD, C.S.R.

Rt. 1 Box 193-B  
Santa Fe, New Mexico 87501  
Phone (505) 455-7400

I do hereby certify that the foregoing is  
a complete record of the proceedings in  
the Examiner hearing of Case No. 19  
heard by me on 19

Oil Conservation Division, Examiner

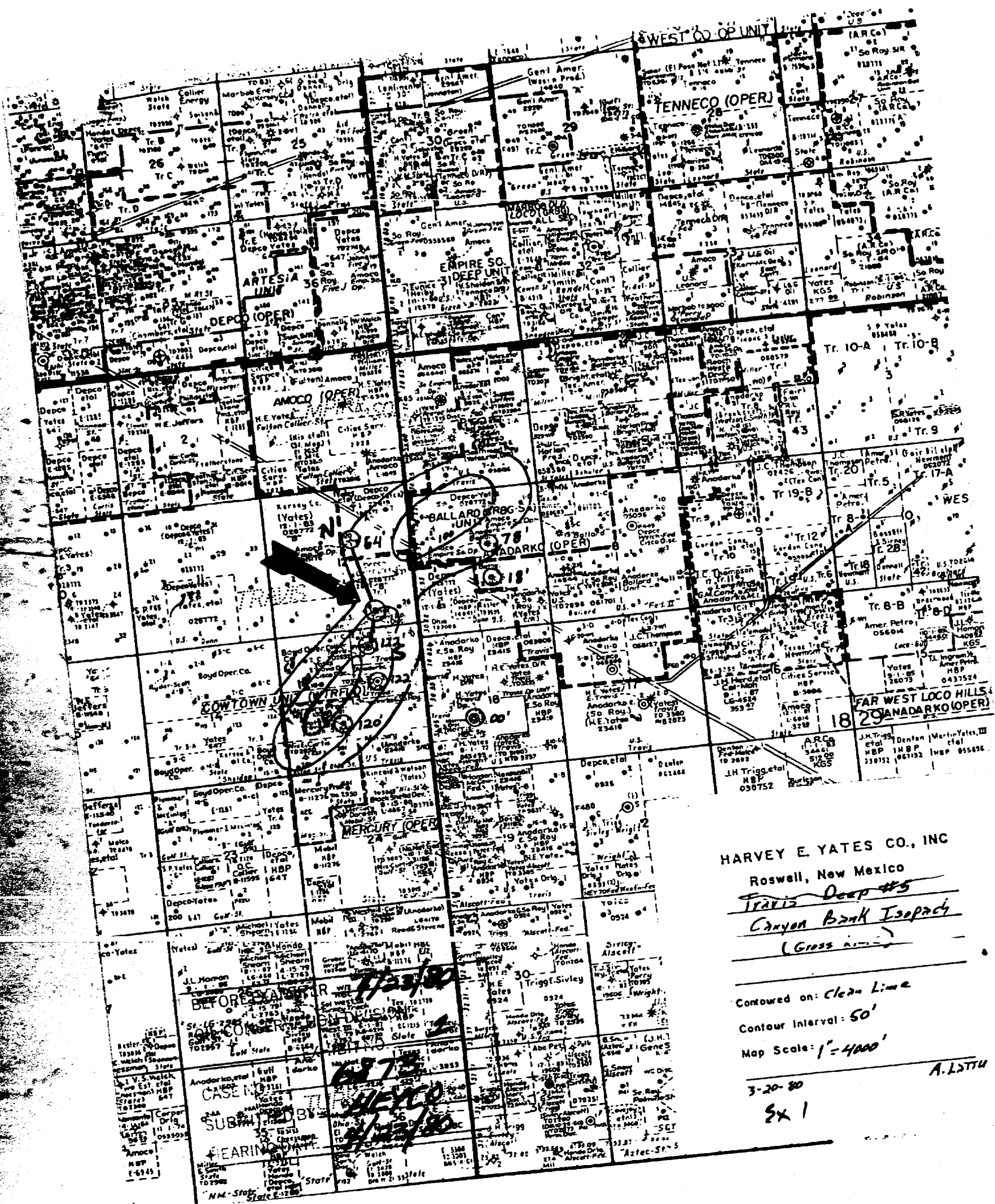

HARVEY E. YATES CO., INC  
Roswell, New Mexico  
Travis Deep #5  
Canyon Bank Isopach  
(Gross Area)

Contoured on: Clean Line  
Contour Interval: 50'  
Map Scale: 1" = 4000'

3-20-80

SX 1

A. LSTIU

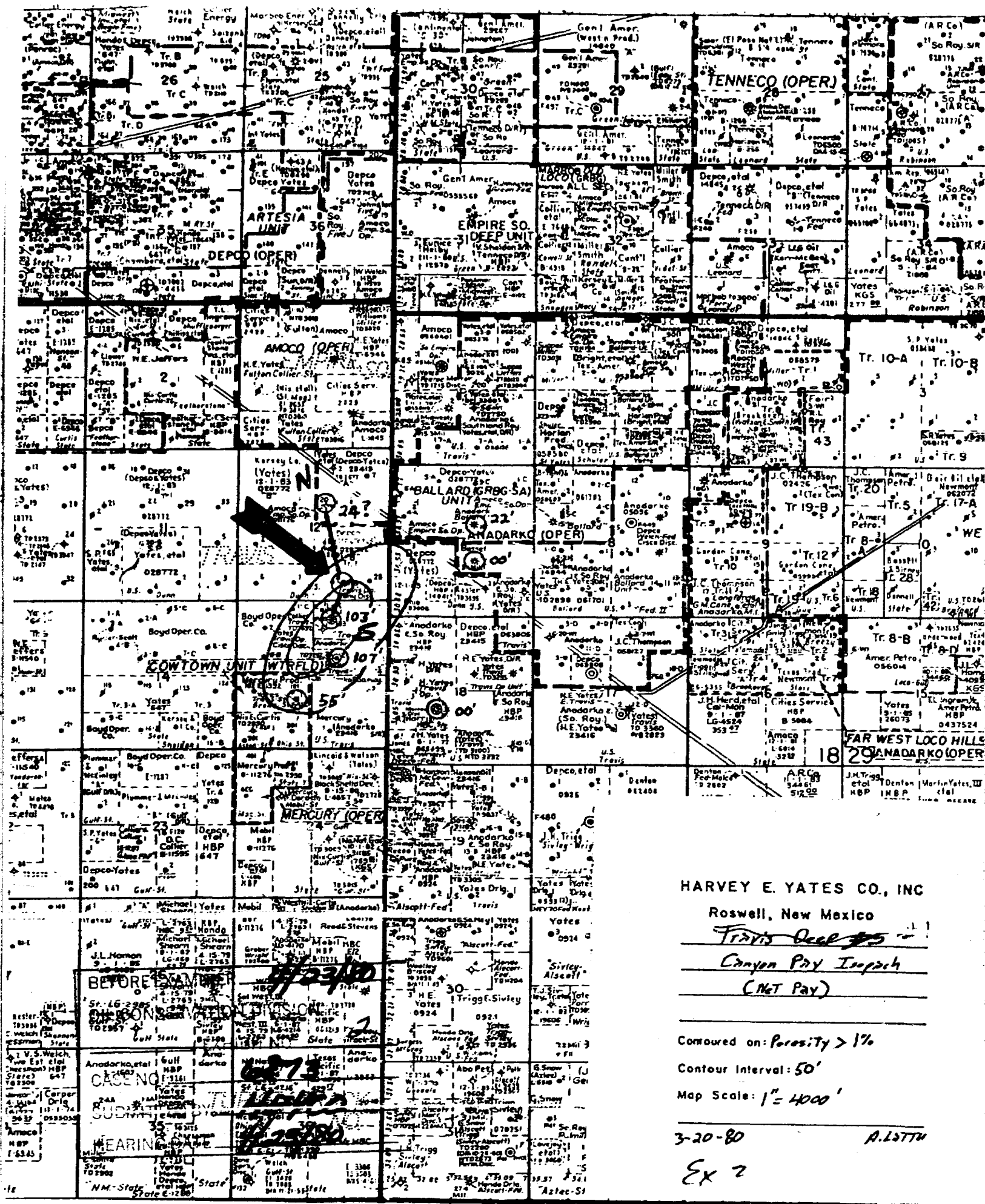

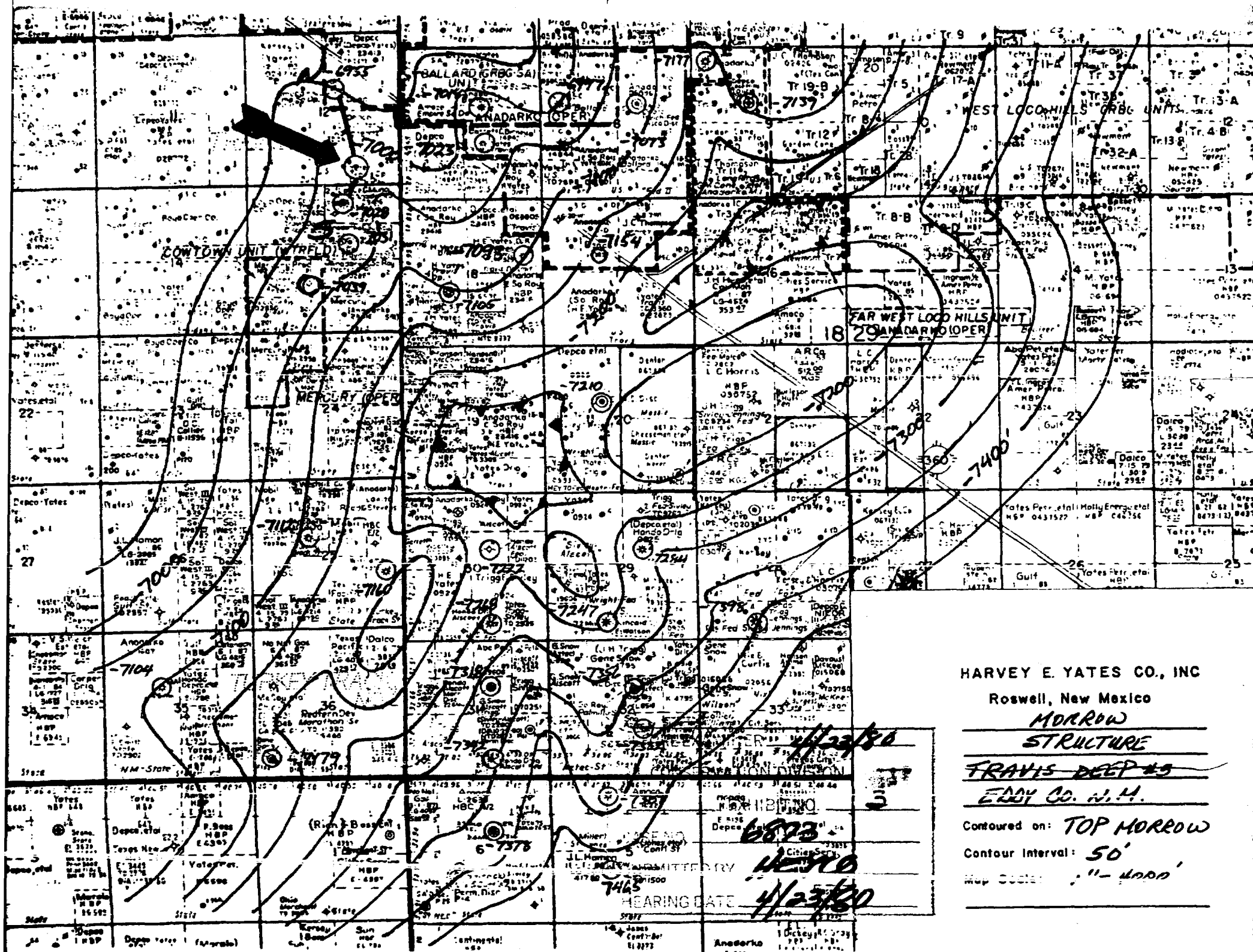

HARVEY E. YATES CO., INC

Roswell, New Mexico

MORROW

STRUCTURE

FRANIS DEEP #3

EDDY CO. N.M.

Contoured on: TOP MORROW

Contour Interval: 50'

Map Scale: 1" = 4000'



HARVEY E. YATES CO., INC  
Roswell, New Mexico  
Travis Deep #1  
Canyon Bank Isopach  
(Gross line)

Contoured on: *clean Line*

Contour Interval: 50'

Map Scale:  $1'' = 4000'$

3-20-80

A. L. L. T. U.

 $\sum x$

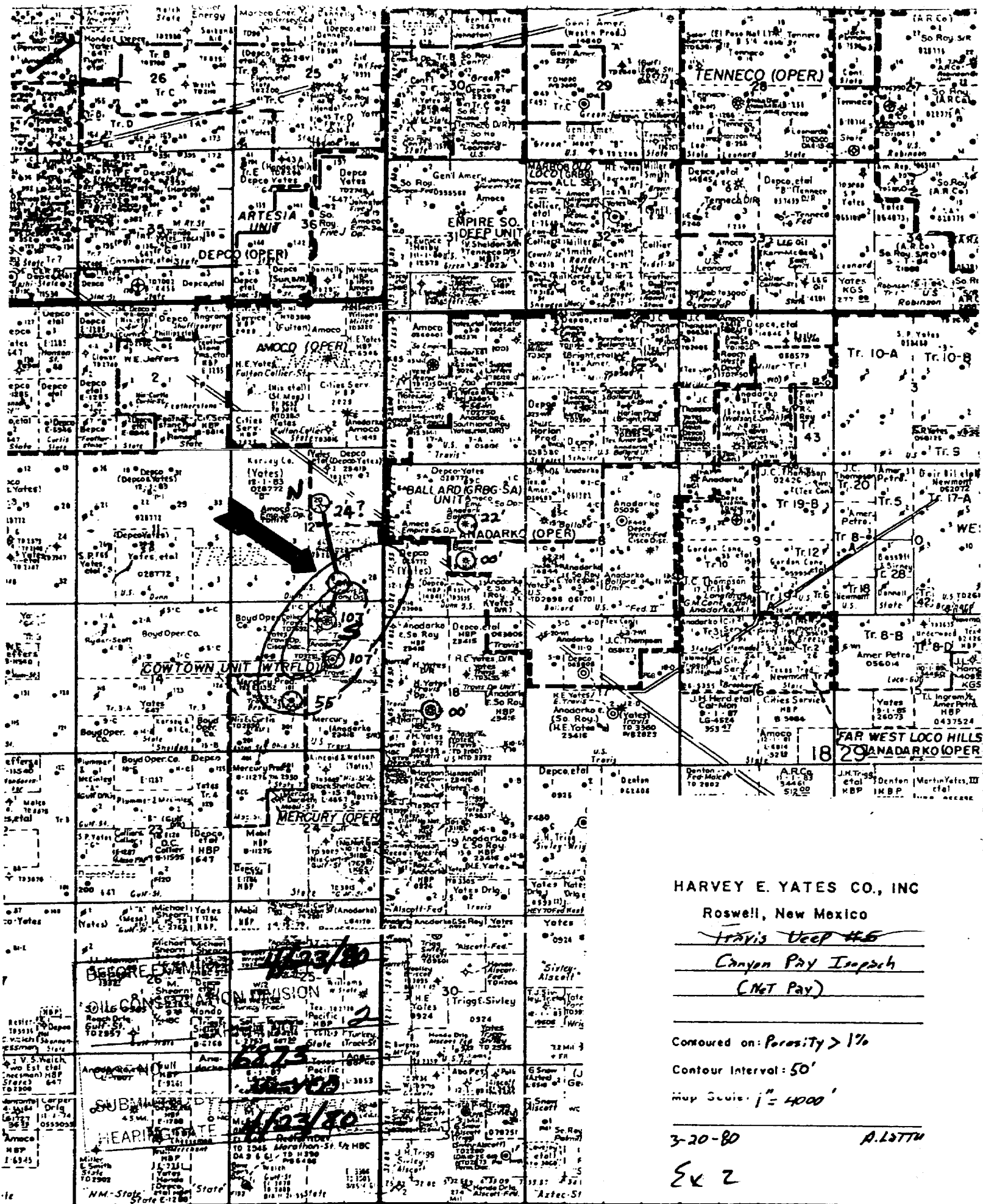

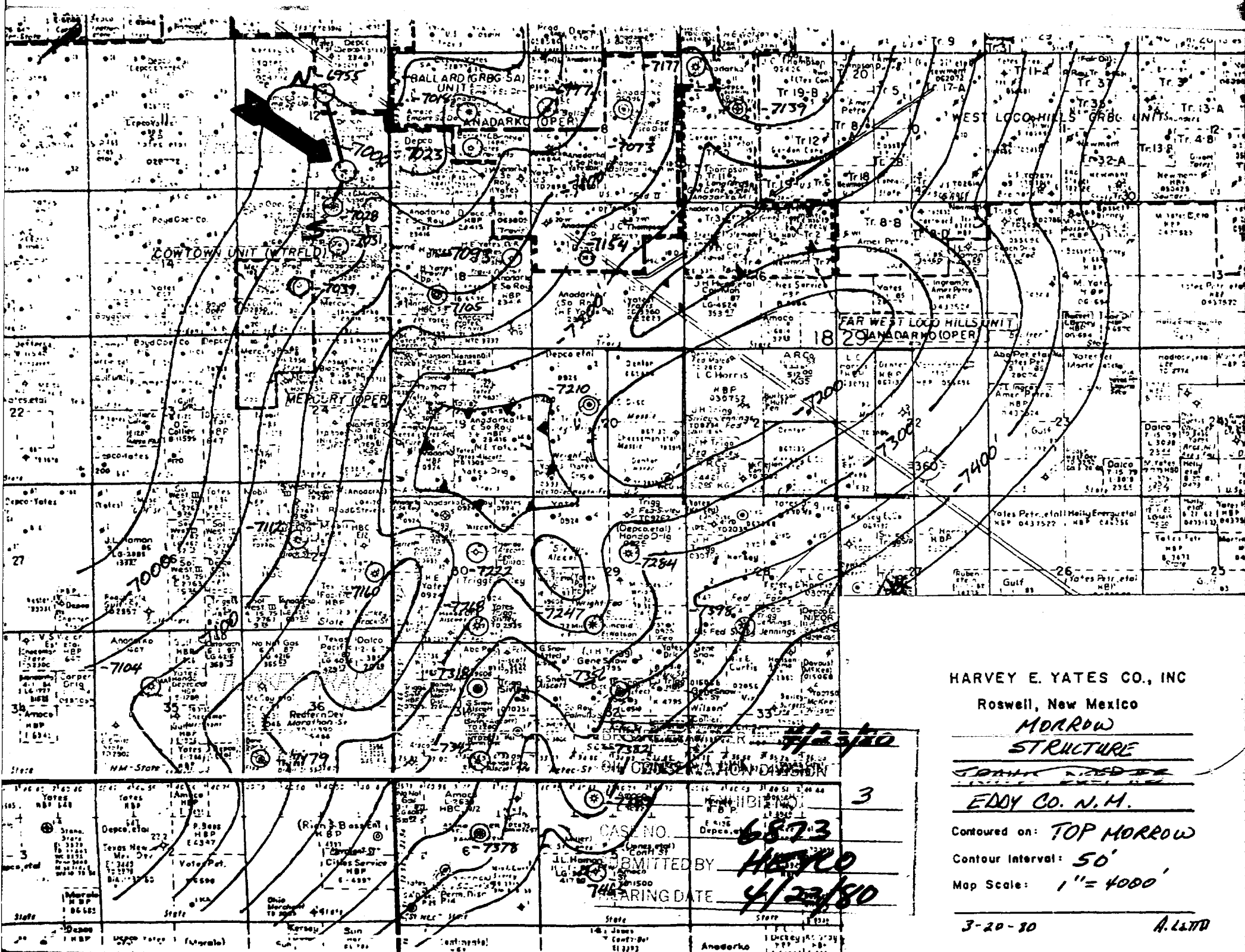

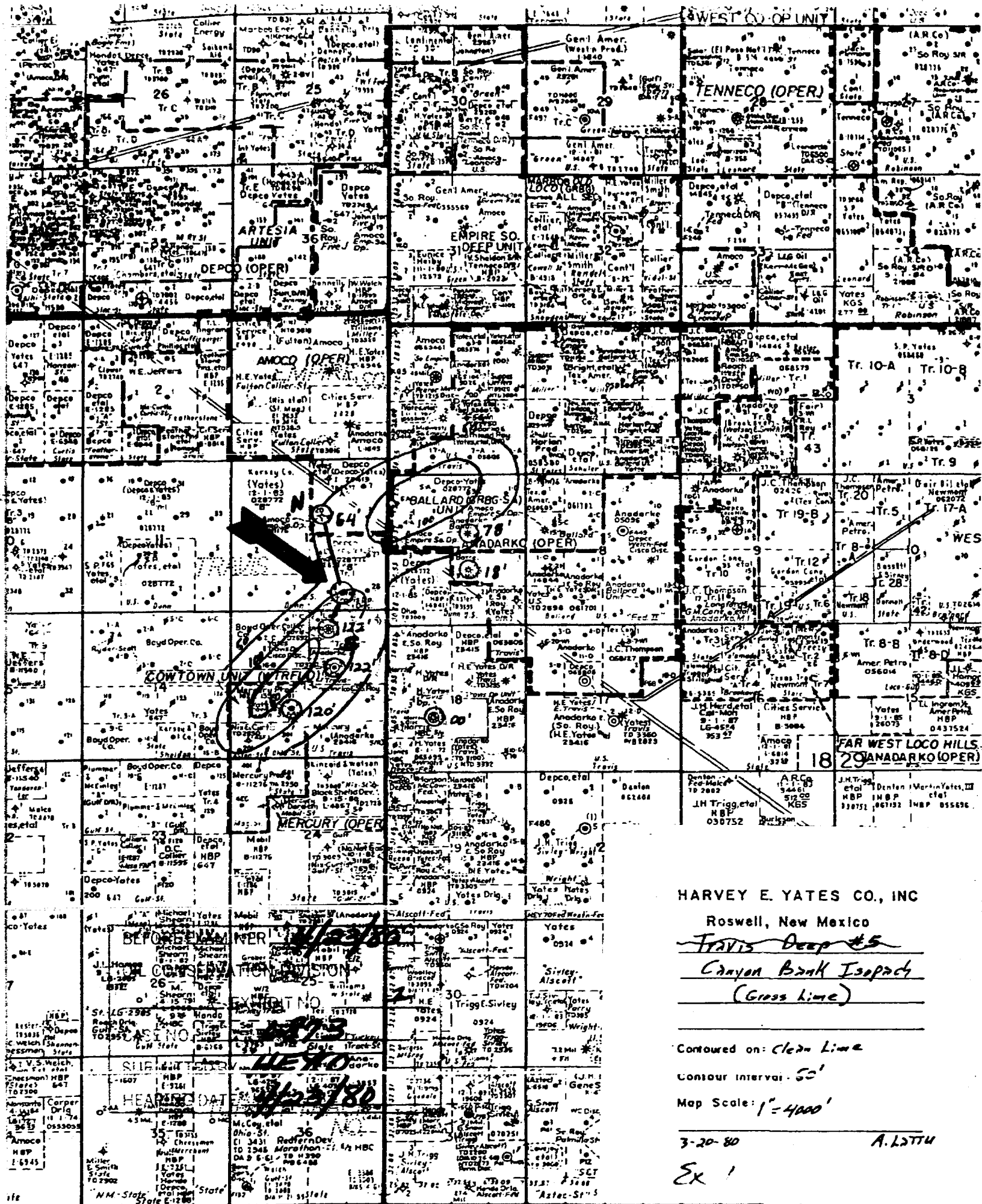

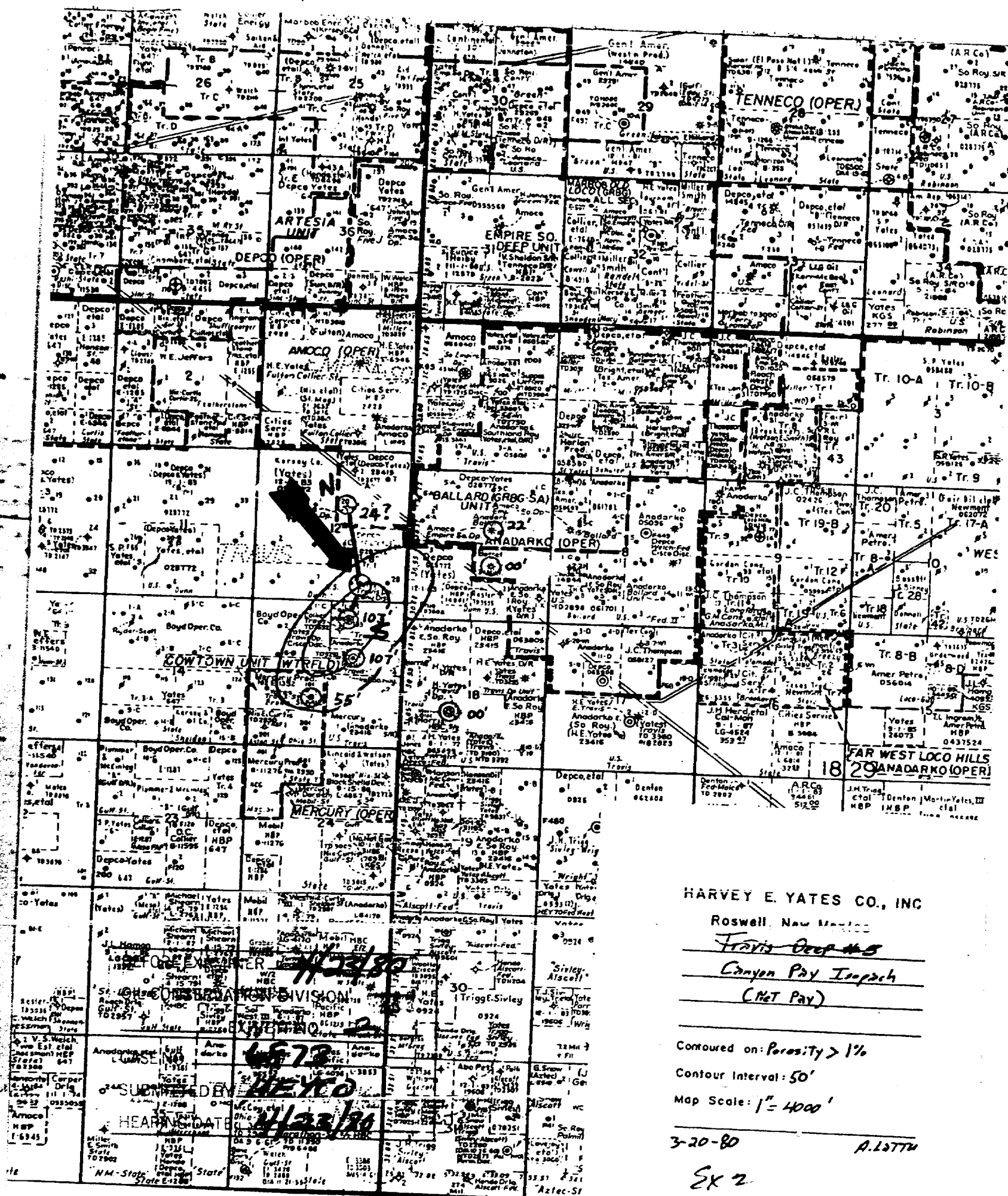

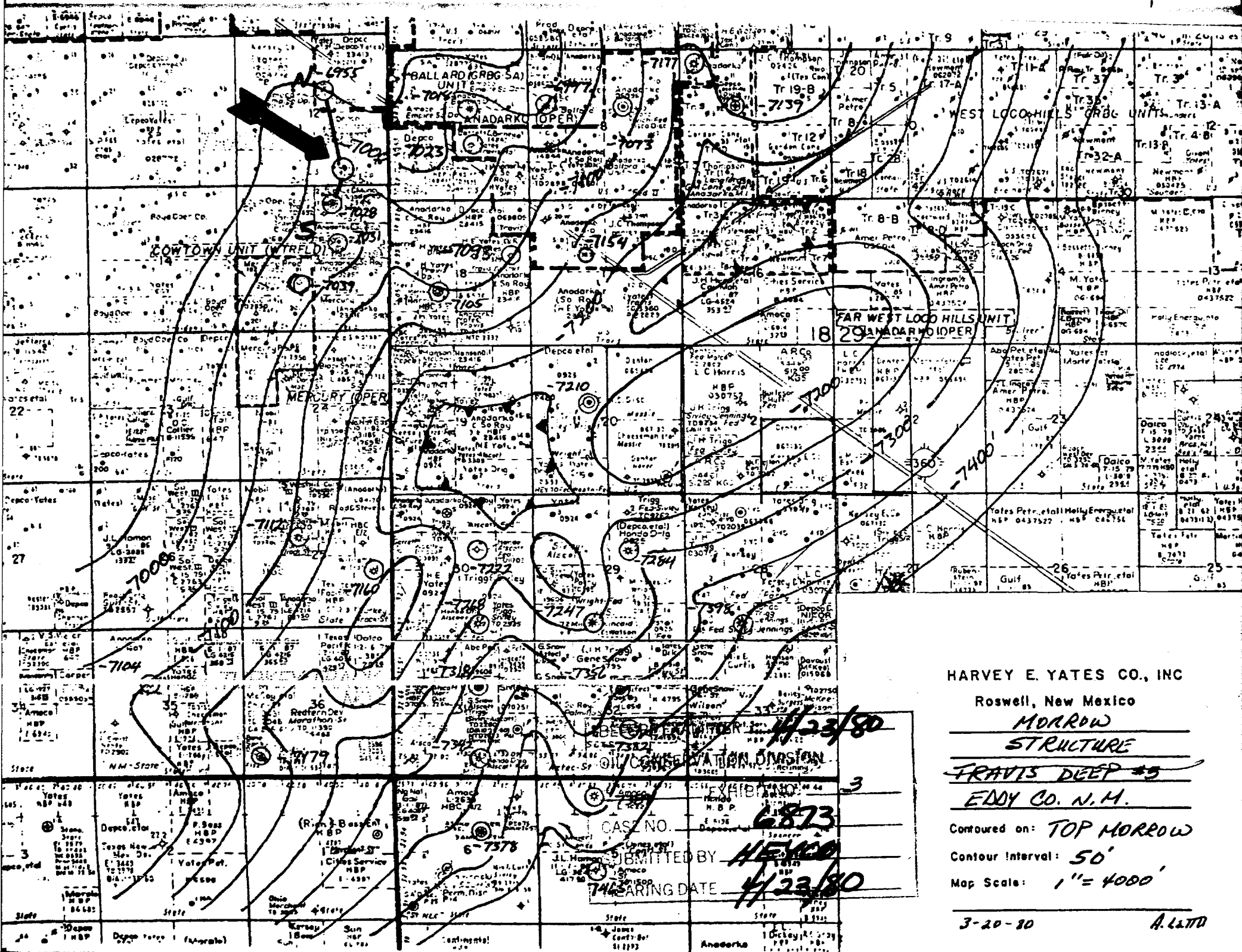

Dockets Nos. 13-80 and 14-80 are tentatively set for May 7 and 21, 1980. Applications for hearing must be filed at least 22 days in advance of hearing date.

DOCKET: EXAMINER HEARING - WEDNESDAY - APRIL 23, 1980

9 A.M. - OIL CONSERVATION DIVISION CONFERENCE ROOM,  
STATE LAND OFFICE BUILDING, SANTA FE, NEW MEXICO

The following cases will be heard before Richard L. Stamets, Examiner, or Daniel S. Nutter, Alternate Examiner:

CASE 6803: (Continued from February 13, 1980, Examiner Hearing)

In the matter of the hearing called by the Oil Conservation Division on its own motion to permit EPROC Associates, Hartford Accident and Indemnity Company, and all other interested parties to appear and show cause why its Monsanto State H Well No. 1 located in Unit E of Section 2, Township 30 North, Range 16 West, San Juan County, should not be plugged and abandoned in accordance with a Division-approved plugging program.

CASE 6866: In the matter of the hearing called by the Oil Conservation Division on its own motion to permit Hare and McCoy and all other interested parties to appear and show cause why the H. L. Hare Well No. 2 located in Unit B of Section 23, Township 29 North, Range 11 West, San Juan County, should not be plugged and abandoned in accordance with a Division-approved plugging program.

CASE 6867: In the matter of the hearing called by the Oil Conservation Division on its own motion to permit all interested parties to appear and show cause why the following abandoned wells drilled by unknown party or parties and located in Township 29 North, Range 11 West, San Juan County, should not be plugged and abandoned in accordance with a Division-approved plugging program: a well in the SW/4 of Section 24, a well in the SE/4 of Section 22, and a well in the SE/4 of Section 28.

CASE 6850: (Continued from April 9, 1980, Examiner Hearing)

In the matter of the hearing called by the Oil Conservation Division on its own motion to permit Jack F. Grimm, N. B. Hunt, George R. Brown, Am-Arctic, Ltd., The Travelers Indemnity Company, and all other interested parties to appear and show cause why the Mobil 32 Well No. 1 located in Unit D of Section 32, Township 25 South, Range 1 East, Dona Ana County, should not be plugged and abandoned in accordance with a Division-approved plugging program.

CASE 6870: Application of Bass Enterprises Production Company for a dual completion, Lea County, New Mexico. Applicant, in the above-styled cause, seeks approval for the dual completion (conventional) of its Bass State 36 Well No. 1 located in Unit E of Section 36, Township 15 South, Range 34 East, to produce oil from the Townsend-Wolfcamp Pool and gas from an undesignated Morrow pool thru the tubing and casing-tubing annulus, respectively, by means of a cross-over assembly.

CASE 6871: Application of Bass Enterprises Production Company to amend Order No. R-5693, Eddy County, New Mexico. Applicant, in the above-styled cause, seeks to amend Order No. R-5693 to remove the restriction as to the time limit in which salt water may be disposed into Big Eddy Unit Well No. 56 located in Unit G of Section 35, Township 21 South, Range 28 East.

CASE 6872: Application of Amoco Production Company for a dual completion, Lea County, New Mexico. Applicant, in the above-styled cause, seeks approval for the dual completion (conventional) of its State "HQ" Well No. 1 located in Unit P of Section 26, Township 18 South, Range 34 East, Airstrip Field, to produce Bone Springs and Wolfcamp oil thru parallel strings of tubing.

CASE 6873: Application of Harvey E. Yates Company for an unorthodox gas well location, Eddy County, New Mexico. Applicant, in the above-styled cause, seeks approval for the unorthodox location of its Travis Deep Well No. 5, a Morrow test to be drilled 660 feet from the South line and 1650 feet from the East line of Section 12, Township 18 South, Range 28 East, the S/2 of said Section 12 to be dedicated to the well.

CASE 6874: Application of HNC Oil Company for compulsory pooling, Lea County, New Mexico. Applicant, in the above-styled cause, seeks an order pooling all mineral interests in the Pennsylvanian formation underlying the E/2 of Section 6, Township 22 South, Range 35 East, to be dedicated to a well to be drilled at a standard location thereon. Also to be considered will be the cost of drilling and completing said well and the allocation of the cost thereof as well as actual operating costs and charges for supervision. Also to be considered will be the designation of applicant as operator of the well and a charge for risk involved in drilling said well.

CASE 6453: (Continued from April 9, 1968, Examiner Hearing)

Application of Caribou Four Corners, Inc. for compulsory pooling, Las Alamos County, New Mexico. Applicant, in the above-styled cause, seeks an order pooling all mineral interests in the Las Alamos Gallup Pool underlying the NW 1/4 of Section 18, Township 24 North, Range 14 East, to be dedicated to a well to be drilled at a standard location thereon. Also to be considered will be the cost of drilling and completing said well and the allocation of the cost thereof as well as actual operating costs and charges for supervision. Also to be considered will be the designation of applicant as operator of the well and a charge for risk involved in drilling said well.

CASE 6475: Application of Maurice L. Brown Co. for compulsory pooling, Las Alamos County, New Mexico.

Applicant, in the above-styled cause, seeks an order pooling all mineral interests in the Las Alamos Andros formation underlying the SE 1/4 of Section 4, Township 9 South, Range 36 East, to be dedicated to a well to be drilled at a standard location thereon. Also to be considered will be the cost of drilling and completing said well and the allocation of the cost thereof as well as actual operating costs and charges for supervision. Also to be considered will be the designation of applicant as operator of the well and a charge for risk involved in drilling said well.

CASE 6476: Application of Maurice L. Brown Co. for compulsory pooling, Las Alamos County, New Mexico.

Applicant, in the above-styled cause, seeks an order pooling all mineral interests in the Las Alamos Pennsylvania Pool underlying the SW 1/4 of Section 5, Township 9 South, Range 36 East, to be dedicated to a well to be drilled at a standard location thereon. Also to be considered will be the cost of drilling and completing said well and the allocation of the cost thereof as well as actual operating costs and charges for supervision. Also to be considered will be the designation of applicant as operator of the well and a charge for risk involved in drilling said well.

CASE 6467: (Suspended and Reopened)

In the matter of Case 6467 being reopened pursuant to the provisions of Order No. 8-5958 which order created the Crown Ridge-Horse Spring Pool in Las Alamos County with temporary special rules therefor providing for 160-acre spacing. All interested parties may appear and show cause why the Crown Ridge-Horse Spring Pool should not be developed on 40-acre spacing units.

CASE 6477: Application of Florida Exploration Company for compulsory pooling and unitization well location, Las Alamos County, New Mexico. Applicant, in the above-styled cause, seeks an order pooling all mineral interests in the Holbrook and Elmore formation underlying the NW 1/4 of Section 11, Township 25 North, Range 35 East, to be dedicated to a well to be drilled at an unorthodox location 1254 feet from the North and West lines of said Section 11. Also to be considered will be the cost of drilling and completing said well and the allocation of the cost thereof as well as actual operating costs and charges for supervision. Also to be considered will be the designation of applicant as operator of the well and a charge for risk involved in drilling said well.

CASE 6478: Application of Stevens Oil Company for a non-standard gas production unit, Chaves County, New Mexico. Applicant, in the above-styled cause, seeks approval of a 160-acre non-standard gas production unit comprising the NW 1/4 and SW 1/4 of Section 25, Township 8 South, Range 28 East, Unit Lease-Pet Andros Associated Pool, to be dedicated to its D'Brien "F" Well No. 4 located in Unit 1 of said Section 25.

CASE 6479: Application of John L. Moore for a tubingless completion, Las Alamos County, New Mexico.

Applicant, in the above-styled cause, seeks authority to produce his America Federal Well No. 1 located in Unit 1 of Section 17, Township 21 South, Range 36 East, North Lando-Morris Las Pool, thru a 1 1/2-inch drill pipe cemented in the hole.

CASE 6480: (Continued from April 9, 1968, Examiner Hearing)

Application of The Energy, Inc. for well creation, special pool rules, and an ROPE determination, Las Alamos County, New Mexico. Applicant, in the above-styled cause, seeks the creation of a new Las Alamos oil pool for its State "T" Well No. 1 located in Unit 1 of Section 17, Township 21 South, Range 36 East, and special rules therefor, including a provision for a limiting gas-oil ratio of 10,000 to 1. Applicant further seeks a new permanent reservoir determination for said State "T" Well No. 1.

CASE 6481: (Continued from April 9, 1968, Examiner Hearing)

Application of Lorus Little for compulsory pooling, Las Alamos County, New Mexico. Applicant, in the above-styled cause, seeks an order pooling all mineral interests in the Las Alamos formation underlying the NW 1/4 of Section 7, Township 21 North, Range 36 East, to be dedicated to a well to be drilled at a standard location thereon. Also to be considered will be the cost of drilling and completing said well and the allocation of the cost thereof as well as actual operating costs and charges for supervision. Also to be considered will be the designation of applicant as operator of the well and a charge for risk involved in drilling said well.

**CASE 6487:** (Continued from February 13, 1980, Examiner Hearing)

Application of El Paso Natural Gas Company for approval of infill drilling, Lea County, New Mexico. Applicant, in the above-styled cause, seeks a waiver of existing well-spacing requirements and a finding that the drilling of its Shell E State Com Well No. 2 located in Unit N of Section 6, Township 21 South, Range 36 East, Eumont Gas Pool, Lea County, New Mexico, is necessary to effectively and efficiently drain that portion of the proration unit which cannot be so drained by the existing well.

**CASE 6868:** In the matter of the hearing called by the Oil Conservation Division on its own motion for an order contracting and extending certain pools in San Juan, Rio Arriba, Sandoval, and McKinley Counties, New Mexico:

- (a) CONTRACT the Bisti-Farmington Pool in San Juan County, New Mexico, by deleting:

TOWNSHIP 26 NORTH, RANGE 12 WEST, NMPM  
Section 20: W/2

- (b) CONTRACT the Blanco-Pictured Cliffs Pool in San Juan and Rio Arriba Counties, New Mexico, by deleting:

TOWNSHIP 30 NORTH, RANGE 10 WEST, NMPM  
Section 35: NW/4

- (c) EXTEND the Albino-Pictured Cliffs Pool in San Juan County, New Mexico, to include therein:

TOWNSHIP 32 NORTH, RANGE 8 WEST, NMPM  
Section 24: W/2  
Section 25: W/2  
Section 26: SE/4  
Section 36: W/2

- (d) EXTEND the Aztec-Fruitland Pool in San Juan County, New Mexico, to include therein:

TOWNSHIP 29 NORTH, RANGE 10 WEST, NMPM  
Section 17: S/2

- (e) EXTEND the Aztec-Pictured Cliffs Pool in San Juan County, New Mexico, to include therein:

TOWNSHIP 29 NORTH, RANGE 9 WEST, NMPM  
Section 34: NW/4

TOWNSHIP 30 NORTH, RANGE 10 WEST, NMPM  
Section 6: SE/4

TOWNSHIP 31 NORTH, RANGE 11 WEST, NMPM  
Section 7: SW/4  
Section 17: S/2

TOWNSHIP 31 NORTH, RANGE 12 WEST, NMPM  
Section 23: NE/4

- (f) EXTEND the Ballard-Pictured Cliffs Pool in Rio Arriba, Sandoval, and San Juan Counties, New Mexico, to include therein:

TOWNSHIP 26 NORTH, RANGE 8 WEST, NMPM  
Section 15: NW/4

- (g) EXTEND the Bisti-Farmington Pool in San Juan County, New Mexico, to include therein:

TOWNSHIP 26 NORTH, RANGE 12 WEST, NMPM  
Section 29: S/2  
Section 30: SE/4 and W/2

- (h) EXTEND the Bisti-Lower Gallup Oil Pool in San Juan County, New Mexico, to include therein:

TOWNSHIP 25 NORTH, RANGE 12 WEST, NMPM  
Section 22: NW/4

(i) EXTEND the Blanco-Fruitland Pool in San Juan County, New Mexico, to include therein:

TOWNSHIP 29 NORTH, RANGE 9 WEST, NMPM  
Section 1: SW/4  
Section 2: SE/4

TOWNSHIP 30 NORTH, RANGE 9 WEST, NMPM  
Section 10: SW/4  
Section 16: NW/4

(j) EXTEND the Blanco Mesaverde Pool in Rio Arriba and San Juan Counties, New Mexico, to include therein:

TOWNSHIP 25 NORTH, RANGE 3 WEST, NMPM  
Section 3: N/2  
Section 5: N/2  
Section 6: All  
Section 7: All  
Section 8: W/2

TOWNSHIP 26 NORTH, RANGE 2 WEST, NMPM  
Section 4: All

TOWNSHIP 27 NORTH, RANGE 2 WEST, NMPM  
Section 17: E/2

(k) EXTEND the Blanco-Pictured Cliffs Pool in San Juan County, New Mexico, to include therein:

TOWNSHIP 29 NORTH, RANGE 8 WEST, NMPM  
Section 10: NE/4 and S/2

TOWNSHIP 29 NORTH, RANGE 9 WEST, NMPM  
Section 20: NE/4

TOWNSHIP 30 NORTH, RANGE 8 WEST, NMPM  
Section 19: All  
Section 29: NW/4  
Section 30: N/2

TOWNSHIP 30 NORTH, RANGE 9 WEST, NMPM  
Section 10: SW/4  
Section 24: E/2

TOWNSHIP 30 NORTH, RANGE 10 WEST, NMPM  
Section 8: NW/4

TOWNSHIP 31 NORTH, RANGE 9 WEST, NMPM  
Section 7: NE/4  
Section 19: NW/4

TOWNSHIP 31 NORTH, RANGE 10 WEST, NMPM  
Section 24: E/2 and SW/4

TOWNSHIP 31 NORTH, RANGE 11 WEST, NMPM  
Section 15: SW/4  
Section 18: NE/4  
Section 21: NE/4  
Section 22: NE/4

TOWNSHIP 31 NORTH, RANGE 12 WEST, NMPM  
Section 1: N/2

TOWNSHIP 32 NORTH, RANGE 10 WEST, NMPM  
Section 33: S/2

TOWNSHIP 32 NORTH, RANGE 12 WEST, NMPM

Section 10: E/2  
Section 11: All  
Section 13: SW/4  
Section 14: All  
Section 24: NW/4  
Section 25: N/2  
Section 26: NE/4  
Section 35: E/2 and SW/4

- (1) EXTEND the South Blanco-Pictured Cliffs Pool in Rio Arriba, San Juan, and Sandoval Counties, New Mexico, to include therein:

TOWNSHIP 23 NORTH, RANGE 1 WEST, NMPM

Section 19: E/2  
Section 30: NE/4

TOWNSHIP 23 NORTH, RANGE 2 WEST, NMPM

Section 26: NE/4

TOWNSHIP 24 NORTH, RANGE 3 WEST, NMPM

Section 36: NW/4

TOWNSHIP 27 NORTH, RANGE 7 WEST, NMPM

Section 12: SE/4

TOWNSHIP 28 NORTH, RANGE 6 WEST, NMPM

Section 34: NE/4

- (m) EXTEND the East Blanco-Pictured Cliffs Pool in Rio Arriba County, New Mexico, to include therein:

TOWNSHIP 30 NORTH, RANGE 4 WEST, NMPM

Section 4: W/2

TOWNSHIP 31 NORTH, RANGE 4 WEST, NMPM

Section 33: SW/4

- (n) EXTEND the Bloomfield-Farmington Oil Pool in San Juan County, New Mexico, to include therein:

TOWNSHIP 29 NORTH, RANGE 11 WEST, NMPM

Section 25: SE/4

- (o) EXTEND the Campo-Gallup Pool in Rio Arriba County, New Mexico, to include therein:

TOWNSHIP 29 NORTH, RANGE 4 WEST, NMPM

Section 12: SE/4  
Section 13: NE/4

- (p) EXTEND the Cha Cha-Gallup Oil Pool in San Juan County, New Mexico, to include therein:

TOWNSHIP 29 NORTH, RANGE 14 WEST, NMPM

Section 18: N/2 SW/4 and NW/4 SE/4

TOWNSHIP 29 NORTH, RANGE 15 WEST, NMPM

Section 19: NE/4 and N/2 SE/4

- (q) EXTEND the Chacon-Dakota Associated Pool in Rio Arriba and Sandoval Counties, New Mexico, to include therein:

TOWNSHIP 23 NORTH, RANGE 3 WEST, NMPM

Section 25: NW/4  
Section 26: NE/4  
Section 34: SW/4  
Section 35: NE/4  
Section 36: NW/4

TOWNSHIP 24 NORTH, RANGE 3 WEST, NMPM

Section 20: E/2  
Section 34: NW/4

- (r) EXTEND the Chozas Mesa-Pictured Cliffs Pool in Rio Arriba County, New Mexico, to include therein:

TOWNSHIP 28 NORTH, RANGE 3 WEST, NMPM

Section 19: S/2

Section 30: N/2

TOWNSHIP 28 NORTH, RANGE 4 WEST, NMPM

Section 9: E/2

Section 10: All

Section 16: E/2

Section 21: NE/4

- (s) EXTEND the Escrito-Gallup Oil Pool in Rio Arriba County, New Mexico, to include therein:

TOWNSHIP 24 NORTH, RANGE 7 WEST, NMPM

Section 21: SW/4

- (t) EXTEND the Fulcher Kutz-Pictured Cliffs Pool in San Juan County, New Mexico, to include therein:

TOWNSHIP 29 NORTH, RANGE 11 WEST, NMPM

Section 25: SE/4

Section 36: NE/4 and S/2

- (u) EXTEND the Gobernador-Pictured Cliffs Pool in Rio Arriba County, New Mexico, to include therein:

TOWNSHIP 29 NORTH, RANGE 5 WEST, NMPM

Section 4: N/2 and SE/4

Section 5: N/2

Section 6: N/2

Section 15: S/2

Section 23: NW/4 and SE/4

Section 25: NW/4

TOWNSHIP 29 NORTH, RANGE 6 WEST, NMPM

Section 1: NE/4

TOWNSHIP 30 NORTH, RANGE 5 WEST, NMPM

Section 31: SW/4

- (v) EXTEND the Harper Hill Fruitland-Pictured Cliffs Pool in San Juan County, New Mexico, to include therein:

TOWNSHIP 30 NORTH, RANGE 14 WEST, NMPM

Section 27: SE/4

Section 34: NE/4

Section 35: SW/4

- (w) EXTEND the Harris Mesa-Chacra Pool in San Juan County, New Mexico, to include therein:

TOWNSHIP 27 NORTH, RANGE 9 WEST, NMPM

Section 11: S/2

Section 12: SW/4

Section 13: N/2

Section 14: NE/4

- (x) EXTEND the West Kutz-Pictured Cliffs Pool in San Juan County, New Mexico, to include therein:

TOWNSHIP 29 NORTH, RANGE 13 WEST, NMPM

Section 24: S/2

- (y) EXTEND the Largo-Chacra Pool in Rio Arriba and San Juan Counties, New Mexico, to include therein:

TOWNSHIP 27 NORTH, RANGE 7 WEST, NMPM

Section 28: SE/4

- (z) EXTEND the South Lindrith Gallup-Dakota Oil Pool in Rio Arriba County, New Mexico, to include therein:

TOWNSHIP 24 NORTH, RANGE 4 WEST, NMPM

Section 21: SW/4

Section 27: N/2

(aa) EXTEND the West Lindrith Gallup-Dakota Oil Pool in Rio Arriba County, New Mexico, to include therein:

TOWNSHIP 24 NORTH, RANGE 3 WEST, NMPM  
Section 17: NW/4

TOWNSHIP 24 NORTH, RANGE 4 WEST, NMPM  
Section 3: SW/4  
Section 5: S/2  
Section 6: S/2  
Section 7: N/2 and SW/4  
Section 8: N/2  
Section 11: SW/4  
Section 14: NE/4  
Section 24: SW/4

TOWNSHIP 25 NORTH, RANGE 4 WEST, NMPM  
Section 23: NW/4  
Section 30: SW/4  
Section 31: SE/4

(bb) EXTEND the South Los Pinos Fruitland-Pictured Cliffs Pool in San Juan County, New Mexico, to include therein:

TOWNSHIP 31 NORTH, RANGE 7 WEST, NMPM  
Section 1: W/2  
Section 10: SE/4  
Section 11: N/2

TOWNSHIP 32 NORTH, RANGE 7 WEST, NMPM  
Section 26: SE/4  
Section 34: SE/4

(cc) EXTEND the Otero-Chacra Pool in Rio Arriba County, New Mexico, to include therein:

TOWNSHIP 26 NORTH, RANGE 7 WEST, NMPM  
Section 23: N/2  
Section 25: N/2 and SE/4

(dd) EXTEND the Otero-Gallup Oil Pool in Rio Arriba County, New Mexico, to include therein:

TOWNSHIP 24 NORTH, RANGE 5 WEST, NMPM  
Section 2: N/2 NW/4

TOWNSHIP 25 NORTH, RANGE 5 WEST, NMPM  
Section 22: NE/4  
Section 23: NW/4  
Section 34: W/2 SW/4 and SE/4  
Section 35: SW/4 SW/4

(ee) EXTEND the Rusty-Chacra Pool in Sandoval County, New Mexico, to include therein:

TOWNSHIP 22 NORTH, RANGE 6 WEST, NMPM  
Section 18: SW/4  
Section 19: All  
Section 20: SW/4  
Section 29: N/2  
Section 30: NE/4

TOWNSHIP 22 NORTH, RANGE 7 WEST, NMPM  
Section 10: S/2  
Section 11: SW/4  
Section 14: W/2  
Section 15: SE/4  
Section 20: NE/4

(ff) EXTEND the Star-Mesaverde Oil Pool in McKinley County, New Mexico, to include therein:

TOWNSHIP 19 NORTH, RANGE 6 WEST, NMPM  
Section 16: N/2 NE/4

(gg) EXTEND the Ute Dome-Dakota Pool in San Juan County, New Mexico, to include therein:

TOWNSHIP 32 NORTH, RANGE 14 WEST, NMPM  
Section 25: W/2

(hh) EXTEND the WAW Fruitland-Pictured Cliffs Pool in San Juan County, New Mexico, to include therein:

TOWNSHIP 26 NORTH, RANGE 12 WEST, NMPM  
Section 19: S/2 and NW/4  
Section 30: NW/4  
Section 31: NE/4  
Section 36: NW/4

TOWNSHIP 26 NORTH, RANGE 13 WEST, NMPM  
Section 2: S/2  
Section 3: S/2  
Section 9: NE/4  
Section 10: N/2  
Section 11: All  
Section 12: W/2  
Section 13: NW/4  
Section 14: N/2  
Section 24: E/2

TOWNSHIP 27 NORTH, RANGE 13 WEST, NMPM  
Section 7: W/2 and SE/4  
Section 17: W/2 and SE/4  
Section 20: E/2  
Section 21: W/2  
Section 28: All

CASE 6869: In the matter of the hearing called by the Oil Conservation Division on its own motion for an order creating, contracting and extending the vertical and horizontal limits of certain pools in Chaves, Eddy, Lea, and Roosevelt Counties, New Mexico:

(a) CREATE a new pool in Lea County, New Mexico, classified as an oil pool for Wolfcamp production and designated as the East Anderson Ranch-Wolfcamp Pool. The discovery well is Holly Energy, Inc. Pogo State Well No. 1 located in Unit H of Section 19, Township 16 South, Range 33 East, NMPM. Said pool would comprise:

TOWNSHIP 16 SOUTH, RANGE 33 EAST, NMPM  
Section 19: NE/4

(b) CREATE a new pool in Chaves County, New Mexico, classified as an oil pool for San Andres production and designated as the Bull's Eye-San Andres Pool. The discovery well is Ralph Nix Union Happy Well No. 1 located in Unit O of Section 1, Township 8 South, Range 28 East, NMPM. Said pool would comprise:

TOWNSHIP 8 SOUTH, RANGE 28 EAST, NMPM  
Section 1: SE/4 and S/2 NE/4  
Section 12: NE/4

TOWNSHIP 8 SOUTH, RANGE 29 EAST, NMPM  
Section 6: W/2 SW/4  
Section 7: W/2 NW/4

(c) CREATE a new pool in Lea County, New Mexico, classified as an oil pool for San Andres production and designated as the Cary-San Andres Pool. The discovery well is Zia Energy, Inc. State C Well No. 1 located in Unit F of Section 17, Township 22 South, Range 37 East, NMPM. Said pool would comprise:

TOWNSHIP 22 SOUTH, RANGE 37 EAST, NMPM  
Section 17: NW/4

(d) CREATE a new pool in Eddy County, New Mexico, classified as a gas pool for Grayburg production and designated as the Diamond Mound-Grayburg Gas Pool. The discovery well is Mesa Petroleum Company Sink Federal Well No. 1 located in Unit I of Section 9, Township 16 South, Range 27 East, NMPM. Said pool would comprise:

TOWNSHIP 16 SOUTH, RANGE 27 EAST, NMPM  
Section 9: SE/4

(e) CREATE a new pool in Eddy County, New Mexico, classified as a gas pool for Morrow production and designated as the Diamond Mound-Morrow Gas Pool. The discovery well is Mesa Petroleum Company Derrick Federal Com Well No. 1 located in Unit K of Section 5, Township 16 South, Range 28 East, NMPM. Said pool would comprise:

TOWNSHIP 16 SOUTH, RANGE 28 EAST, NMPM  
Section 5: Lots 3, 4, 5, 6, 11, 12,  
13, and 14

(f) CREATE a new pool in Eddy County, New Mexico, classified as a gas pool for Abo production and designated as the Gopher-Abo Gas Pool. The discovery well is Mesa Petroleum Company Catclaw State Well No. 1 located in Unit C of Section 31, Township 17 South, Range 24 East, NMPM. Said pool would comprise:

TOWNSHIP 17 SOUTH, RANGE 24 EAST, NMPM  
Section 31: NE/4

(g) CREATE a new pool in Eddy County, New Mexico, classified as an oil pool for Upper Pennsylvanian production and designated as the Grayburg-Upper Pennsylvanian Pool. The discovery well is Depco, Inc. Conoco State Well No. 1 located in Unit K of Section 15, Township 17 South, Range 29 East, NMPM. Said pool would comprise:

TOWNSHIP 17 SOUTH, RANGE 29 EAST, NMPM  
Section 15: SW/4

(h) CREATE a new pool in Lea County, New Mexico, classified as an oil pool for Drinkard production and designated as the Hardy-Drinkard Pool. The discovery well is Amoco Production Company State C Tr. 11 Well No. 11 located in Unit X of Section 2, Township 21 South, Range 36 East, NMPM. Said pool would comprise:

TOWNSHIP 21 SOUTH, RANGE 36 EAST, NMPM  
Section 2: SE/4  
Section 11: NE/4

(i) CREATE a new pool in Eddy County, New Mexico, classified as a gas pool for Atoka production and designated as the Logan Draw-Atoka Gas Pool. The discovery well is Mesa Petroleum Company Maralo Federal Com Well No. 1 located in Unit L of Section 22, Township 17 South, Range 27 East, NMPM. Said pool would comprise:

TOWNSHIP 17 SOUTH, RANGE 27 EAST, NMPM  
Section 22: W/2

(j) CREATE a new pool in Chavez County, New Mexico, classified as an oil pool for Queen production and designated as the Rabbit Flats-Queen Pool. The discovery well is Rapid Company, Inc. Copelan State Well No. 1 located in Unit C of Section 31, Township 10 South, Range 27 East, NMPM. Said pool would comprise:

TOWNSHIP 10 SOUTH, RANGE 27 EAST, NMPM  
Section 31: NE/4 NW/4 and N/2 NE/4

(k) CREATE a new pool in Eddy County, New Mexico, classified as a gas pool for Wolfcamp production and designated as the Ross Draw-Wolfcamp Gas Pool. The discovery well is Florida Gas Exploration Company Ross Draw Unit Well No. 7 located in Unit J of Section 26, Township 26 South, Range 30 East, NMPM. Said pool would comprise:

TOWNSHIP 26 SOUTH, RANGE 30 EAST, NMPM  
Section 26: S/2  
Section 27: All

(l) CREATE a new pool in Eddy County, New Mexico, classified as a gas pool for Morrow production and designated as the Sand Point-Morrow Gas Pool. The discovery well is Ferry R. Base Big Eddy Unit Well No. 72 located in Unit R of Section 3, Township 21 South, Range 28 East, NMPM. Said pool would comprise:

TOWNSHIP 21 SOUTH, RANGE 28 EAST, NMPM  
Section 3: S/2

(m) CREATE a new pool in Chaves County, New Mexico, classified as a gas pool for Mississippian production and designated as the Sand Ranch-Mississippian Gas Pool. The discovery well is MCF Oil Corporation Biker Federal Well No. 1 located in Unit G of Section 14, Township 10 South, Range 29 East, NMPM. Said pool would comprise:

TOWNSHIP 10 SOUTH, RANGE 29 EAST, NMPM  
Section 14: N/2

(n) CREATE a new pool in Chaves County, New Mexico, classified as an oil pool for San Andres production and designated as the North Tom Tom-San Andres Pool. The discovery well is NRM Petroleum Corporation Mooney Well No. 1 located in Unit A of Section 17, Township 7 South, Range 31 East, NMPM. Said pool would comprise:

TOWNSHIP 7 SOUTH, RANGE 31 EAST, NMPM  
Section 17: NE/4

(o) CREATE a new pool in Lea County, New Mexico, classified as an oil pool for Bone Springs production and designated as the Tonto-Bone Springs Pool. The discovery well is Amoco Production Company Nellis A Federal Well No. 1 located in Unit E of Section 8, Township 19 South, Range 33 East, NMPM. Said pool would comprise:

TOWNSHIP 19 SOUTH, RANGE 33 EAST, NMPM  
Section 8: NW/4

(p) CREATE a new pool in Lea County, New Mexico, classified as a gas pool for Mississippian production and designated as the Townsend-Mississippian Gas Pool. The discovery well is Allen K. Trobaugh Eidsen Com Well No. 1 located in Unit C of Section 28, Township 16 South, Range 35 East, NMPM. Said pool would comprise:

TOWNSHIP 16 SOUTH, RANGE 35 EAST, NMPM  
Section 28: NE/4

(q) CREATE a new pool in Lea County, New Mexico, classified as an oil pool for Fusselman production and designated as the Wantz-Fusselman Pool. The discovery well is N. B. Hunt Mittie Weatherly Well No. 8 located in Unit G of Section 21, Township 21 South, Range 37 East, NMPM. Said pool would comprise:

TOWNSHIP 21 SOUTH, RANGE 37 EAST, NMPM  
Section 21: NE/4

(r) EXTEND the Airstrip-Lover Bone Springs Pool in Lea County, New Mexico, to include therein:

TOWNSHIP 18 SOUTH, RANGE 34 EAST, NMPM  
Section 25: NW/4

(s) EXTEND the West Arkansas Junction-San Andres Pool in Lea County, New Mexico, to include therein:

TOWNSHIP 18 SOUTH, RANGE 36 EAST, NMPM  
Section 28: NW/4

(t) EXTEND the Avalon-Atoka Gas Pool in Eddy County, New Mexico, to include therein:

TOWNSHIP 21 SOUTH, RANGE 26 EAST, NMPM  
Section 5: S/2

(u) EXTEND the Bar U-Pennsylvanian Pool in Chaves County, New Mexico, to include therein:

TOWNSHIP 8 SOUTH, RANGE 33 EAST, NMPM  
Section 31: N/2

- (v) EXTEND the Blinebry Oil and Gas Pool in Lea County, New Mexico, to include therein:

TOWNSHIP 20 SOUTH, RANGE 38 EAST, NMPM  
Section 20: NE/4

- (w) EXTEND the Boyd-Morrow Gas Pool in Eddy County, New Mexico, to include therein:

TOWNSHIP 19 SOUTH, RANGE 25 EAST, NMPM  
Section 11: All

- (x) EXTEND the East Caprock-Pennsylvanian Pool in Lea County, New Mexico, to include therein:

TOWNSHIP 12 SOUTH, RANGE 32 EAST, NMPM  
Section 14: SW/4  
Section 23: W/2

- (y) CONTRACT the horizontal limits of the Cato-San Andres Pool in Chaves County, New Mexico, by the deletion of the following described area:

TOWNSHIP 8 SOUTH, RANGE 31 EAST, NMPM  
Section 5: NW/4

- and EXTEND the horizontal limits of said pool to include therein:

TOWNSHIP 8 SOUTH, RANGE 30 EAST, NMPM  
Section 4: SE/4

- (z) EXTEND the Chaveroo-San Andres Pool in Roosevelt County, New Mexico, to include therein:

TOWNSHIP 7 SOUTH, RANGE 32 EAST, NMPM  
Section 34: NW/4

- (aa) EXTEND the Comanche Stateline Tansill-Yates Pool in Lea County, New Mexico, to include therein:

TOWNSHIP 26 SOUTH, RANGE 36 EAST, NMPM  
Section 21: NW/4

- (bb) EXTEND the South Culebra Bluff-Bone Springs Pool in Eddy County, New Mexico, to include therein:

TOWNSHIP 23 SOUTH, RANGE 28 EAST, NMPM  
Section 22: NE/4  
Section 23: NW/4

- (cc) EXTEND the Custer-Devonian Gas Pool in Lea County, New Mexico, to include therein:

TOWNSHIP 24 SOUTH, RANGE 36 EAST, NMPM  
Section 25: W/2

- (dd) EXTEND the Double L-Queen Associated Pool in Chaves County, New Mexico, to include therein:

TOWNSHIP 15 SOUTH, RANGE 29 EAST, NMPM  
Section 1: W/2, SW/4 NE/4 and W/2 SE/4

- (ee) EXTEND the Eagle Creek Permo-Pennsylvanian Gas Pool in Eddy County, New Mexico, to include therein:

TOWNSHIP 18 SOUTH, RANGE 25 EAST, NMPM  
Section 3: All

- (ff) EXTEND the South Eunice-San Andres Pool in Lea County, New Mexico, to include therein:

TOWNSHIP 22 SOUTH, RANGE 37 EAST, NMPM  
Section 10: SE/4

- (gg) EXTEND the East Gam-Morrow Gas Pool in Lea County, New Mexico, to include therein:

TOWNSHIP 19 SOUTH, RANGE 33 EAST, NMPM  
Section 26: S/2

- (hh) EXTEND the East Grama Ridge-Morrow Gas Pool in Lea County, New Mexico, to include therein:

TOWNSHIP 22 SOUTH, RANGE 34 EAST, NMPM  
Section 1: W/2

- (ii) EXTEND the Gram Ridge-Wolfcamp Gas Pool in Lea County, New Mexico, to include therein:

TOWNSHIP 21 SOUTH, RANGE 35 EAST, NMPM  
Section 36: N/2 and SE/4

- (jj) EXTEND the Hobbs-Drinkard Pool in Lea County, New Mexico, to include therein:

TOWNSHIP 18 SOUTH, RANGE 38 EAST, NMPM  
Section 36: W/2

TOWNSHIP 19 SOUTH, RANGE 38 EAST, NMPM  
Section 3: NW/4

- (kk) EXTEND the Jalmat Yates-Seven Rivers Pool in Lea County, New Mexico, to include therein:

TOWNSHIP 23 SOUTH, RANGE 36 EAST, NMPM  
Section 28: S/2 NW/4

- (ll) EXTEND the Justice-Paddock Pool in Lea County, New Mexico, to include therein:

TOWNSHIP 25 SOUTH, RANGE 37 EAST, NMPM  
Section 25: S/2

TOWNSHIP 25 SOUTH, RANGE 38 EAST, NMPM  
Section 30: SW/4

- (mm) EXTEND the Langley-Devonian Gas Pool in Lea County, New Mexico, to include therein:

TOWNSHIP 22 SOUTH, RANGE 36 EAST, NMPM  
Section 17: S/2  
Section 28: N/2

- (nn) EXTEND the Langley-Ellenburger Gas Pool in Lea County, New Mexico, to include therein:

TOWNSHIP 22 SOUTH, RANGE 36 EAST, NMPM  
Section 17: S/2

- (oo) EXTEND the Leamex-Wolfcamp Pool in Lea County, New Mexico, to include therein:

TOWNSHIP 17 SOUTH, RANGE 33 EAST, NMPM  
Section 21: N/2 N/2

- (pp) EXTEND the Logan Draw-Morrow Gas Pool in Eddy County, New Mexico, to include therein:

TOWNSHIP 17 SOUTH, RANGE 27 EAST, NMPM  
Section 20: All  
Section 21: S/2  
Section 28: E/2  
Section 33: E/2

- (qq) EXTEND the Northeast Lovington-Pennsylvanian Pool in Lea County, New Mexico, to include therein:

TOWNSHIP 16 SOUTH, RANGE 37 EAST, NMPM  
Section 18: NE/4

- (rr) EXTEND the Parkway-Strawn Pool in Eddy County, New Mexico, to include therein:

TOWNSHIP 19 SOUTH, RANGE 29 EAST, NMPM  
Section 25: SW/4

- (ss) EXTEND the West Parkway-Morrow Gas Pool in Eddy County, New Mexico, to include therein:

TOWNSHIP 19 SOUTH, RANGE 29 EAST, NMPM  
Section 21: S/2  
Section 22: All

(tt) EXTEND the South Peterson-Fusselman Pool in Roosevelt County, New Mexico, to include therein:

TOWNSHIP 5 SOUTH, RANGE 32 EAST, NMPM  
Section 25: SE/4

(uu) EXTEND the North Quail Ridge-Morrow Gas Pool in Lea County, New Mexico, to include therein:

TOWNSHIP 19 SOUTH, RANGE 33 EAST, NMPM  
Section 12: E/2

TOWNSHIP 19 SOUTH, RANGE 34 EAST, NMPM  
Section 7: W/2

(vv) EXTEND the South Salt Lake-Morrow Gas Pool in Lea County, New Mexico, to include therein:

TOWNSHIP 20 SOUTH, RANGE 32 EAST, NMPM  
Section 25: SW/4  
Section 36: NW/4

(ww) EXTEND the Scoggin Draw-Morrow Gas Pool in Eddy County, New Mexico, to include therein:

TOWNSHIP 18 SOUTH, RANGE 27 EAST, NMPM  
Section 3: E/2  
Section 10: E/2

(xx) EXTEND the Shugart Yates-Seven Rivers Queen-Grayburg Pool in Eddy County, New Mexico, to include therein:

TOWNSHIP 18 SOUTH, RANGE 30 EAST, NMPM  
Section 35: N/2 NE/4

(yy) EXTEND the vertical limits of the Sioux-Yates Pool in Lea County, New Mexico, to include the Tansill formation and redesignate said pool as the Sioux Tansill-Yates Pool, and extend the horizontal limits of said pool to include therein:

TOWNSHIP 26 SOUTH, RANGE 36 EAST, NMPM  
Section 16: N/2 and SE/4

(zz) EXTEND the Tom-Tom San Andres Pool in Chaves County, New Mexico, to include therein:

TOWNSHIP 7 SOUTH, RANGE 31 EAST, NMPM  
Section 25: NW/4  
Section 26: SE/4  
Section 28: SW/4

TOWNSHIP 8 SOUTH, RANGE 31 EAST, NMPM  
Section 5: NW/4 and N/2 SW/4

(aaa) EXTEND the West Tonto-Pennsylvanian Gas Pool in Lea County, New Mexico, to include therein:

TOWNSHIP 19 SOUTH, RANGE 33 EAST, NMPM  
Section 18: NE/4

(bbb) EXTEND the Turkey Track-Morrow Gas Pool in Eddy County, New Mexico, to include therein:

TOWNSHIP 19 SOUTH, RANGE 29 EAST, NMPM  
Section 11: All  
Section 14: E/2

(ccc) EXTEND the North Turkey Track-Morrow Gas Pool in Eddy County, New Mexico, to include therein:

TOWNSHIP 18 SOUTH, RANGE 29 EAST, NMPM  
Section 27: S/2

(ddd) EXTEND the Warren-Tubb Gas Pool in Lea County, New Mexico, to include therein:

TOWNSHIP 20 SOUTH, RANGE 38 EAST, NMPM  
Section 20: NE/4

(ccc) EXTEND the White Ranch-Mississippian Gas Pool in Chaves County, New Mexico, to include therein:

TOWNSHIP 11 SOUTH, RANGE 29 EAST, NMPM  
Section 36: E/2

(fff) EXTEND the Wilson-Strawn Pool in Lea County, New Mexico, to include therein:

TOWNSHIP 21 SOUTH, RANGE 34 EAST, NMPM  
Section 12: SE/4  
Section 13: NE/4

**HEYCO**

PETROLEUM PRODUCERS

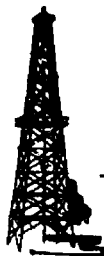

**HARVEY E. YATES COMPANY**

P. O. BOX 1933

SUITE 300, SECURITY NATIONAL BANK BUILDING

505/623-6601

ROSWELL, NEW MEXICO 88201

March 25, 1980

State of New Mexico  
Oil Conservation Division  
P. O. Box 2088  
Santa Fe, New Mexico 87501

Attention: Mr. Richard Stamets

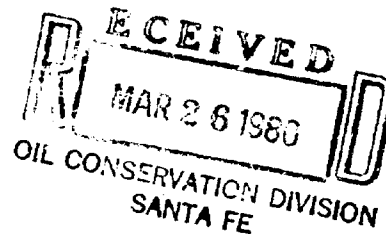

Re: Application for  
Unorthodox Location  
S/2 Section 12,  
T-18S R-28E, N.M.P.M.  
Eddy County, New Mexico

*Case 6873*

Dear Mr. Stamets:

Enclosed for filing is original and two copies of the above referenced application. Please set this matter for Examiner hearing on the April 23, 1980 Docket. Thank you.

Sincerely,

Robert H. Strand  
Attorney

RHS/lh  
OCD #18

Enclosure

BEFORE THE OIL CONSERVATION DIVISION  
ENERGY AND MINERALS DEPARTMENT  
OF THE STATE OF NEW MEXICO

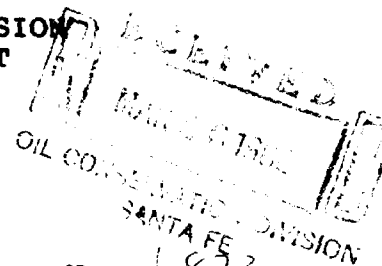

IN THE MATTER OF THE APPLICATION OF  
HARVEY E. YATES COMPANY  
FOR AN UNORTHODOX GAS WELL LOCATION,  
Eddy COUNTY, NEW MEXICO

Case No. 6873

APPLICATION

COMES NOW HARVEY E. YATES COMPANY by its attorney  
and respectfully states:

1. Applicant is the operator of the Morrow forma-  
tion underlying:

Township 18 South, Range 28 East, N.M.P.M.

Section 12: S/2

2. Applicant proposes to drill its TRAVIS DEEP #5  
Well at a location 660 feet from the South line and 1,650  
feet from the East line of said Section 12 to a depth suf-  
ficient to adequately test the Morrow formation which is  
reasonably expected to be productive of gas.

3. Applicant seeks an exception to the well location  
requirements of Rule 104-C.2(a) of the Oil Conservation Divi-  
sion to drill said well to the Morrow formation at the above  
described unorthodox location.

4. A standard 320 acre gas proration unit com-  
prising the aboved described lands should be dedicated to  
such well.

5. The approval of this application will afford  
applicant the opportunity to produce its just and equitable  
share of gas, will prevent economic loss caused by drilling

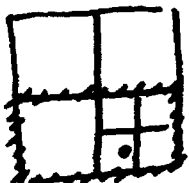

of unnecessary wells, avoid the augmentation of risk arising from the drilling of an excessive number of wells, and will otherwise prevent waste and protect correlative rights.

WHEREFORE, applicant prays:

A. That this application be set for hearing before an examiner and that notice of said hearing be given as required by law.

B. That upon hearing, the Division enter its order granting applicant permission to drill said well at a location 660 feet from the South line and 1,650 feet from the East line of said Section 12 and to dedicate the S/2 of Section 12 to said well.

C. For such further relief as the Division deems just and proper.

DATED this 25th day of March, 1980.

HARVEY E. YATES COMPANY

By: 

Robert H. Strand  
Attorney for Applicant  
P. O. Box 1933  
Roswell, New Mexico 88201

BEFORE THE OIL CONSERVATION DIVISION  
ENERGY AND MINERALS DEPARTMENT  
OF THE STATE OF NEW MEXICO

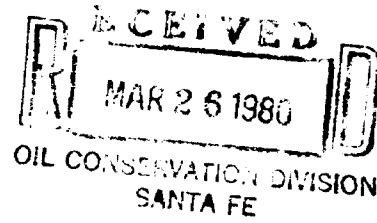

IN THE MATTER OF THE APPLICATION OF  
HARVEY E. YATES COMPANY  
FOR AN UNORTHODOX GAS WELL LOCATION,  
Eddy COUNTY, NEW MEXICO

:  
:  
: Case No. 6873  
:

APPLICATION

COMES NOW HARVEY E. YATES COMPANY by its attorney  
and respectfully states:

1. Applicant is the operator of the Morrow forma-  
tion underlying:

Township 18 South, Range 28 East, N.M.P.M.

Section 12: S/2

2. Applicant proposes to drill its TRAVIS DEEP #5  
Well at a location 660 feet from the South line and 1,650  
feet from the East line of said Section 12 to a depth suf-  
ficient to adequately test the Morrow formation which is  
reasonably expected to be productive of gas.

3. Applicant seeks an exception to the well location  
requirements of Rule 104-C.2(a) of the Oil Conservation Divi-  
sion to drill said well to the Morrow formation at the above  
described unorthodox location.

4. A standard 320 acre gas proration unit com-  
prising the aboved described lands should be dedicated to  
such well.

5. The approval of this application will afford  
applicant the opportunity to produce its just and equitable  
share of gas, will prevent economic loss caused by drilling

of unnecessary wells, avoid the augmentation of risk arising from the drilling of an excessive number of wells, and will otherwise prevent waste and protect correlative rights.

WHEREFORE, applicant prays:

A. That this application be set for hearing before an examiner and that notice of said hearing be given as required by law.

B. That upon hearing, the Division enter its order granting applicant permission to drill said well at a location 660 feet from the South line and 1,650 feet from the East line of said Section 12 and to dedicate the S/2 of Section 12 to said well.

C. For such further relief as the Division deems just and proper.

DATED this 25th day of March, 1980.

HARVEY E. YATES COMPANY

By: 

Robert H. Strand  
Attorney for Applicant  
P. O. Box 1933  
Roswell, New Mexico 88201

BEFORE THE OIL CONSERVATION DIVISION  
ENERGY AND MINERALS DEPARTMENT  
OF THE STATE OF NEW MEXICO

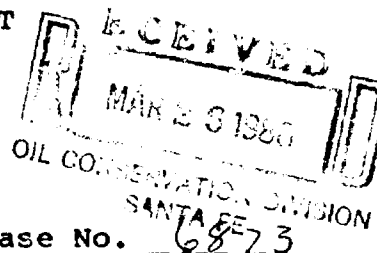

IN THE MATTER OF THE APPLICATION OF  
HARVEY E. YATES COMPANY  
FOR AN UNORTHODOX GAS WELL LOCATION,  
Eddy COUNTY, NEW MEXICO

:  
:  
:  
:

Case No.

APPLICATION

COMES NOW HARVEY E. YATES COMPANY by its attorney  
and respectfully states:

1. Applicant is the operator of the Morrow forma-  
tion underlying:

Township 18 South, Range 28 East, N.M.P.M.

Section 12: S/2

2. Applicant proposes to drill its TRAVIS DEEP #5  
Well at a location 660 feet from the South line and 1,650  
feet from the East line of said Section 12 to a depth suf-  
ficient to adequately test the Morrow formation which is  
reasonably expected to be productive of gas.

3. Applicant seeks an exception to the well location  
requirements of Rule 104-C.2(a) of the Oil Conservation Divi-  
sion to drill said well to the Morrow formation at the above  
described unorthodox location.

4. A standard 320 acre gas proration unit com-  
prising the aboved described lands should be dedicated to  
such well.

5. The approval of this application will afford  
applicant the opportunity to produce its just and equitable  
share of gas, will prevent economic loss caused by drilling

of unnecessary wells, avoid the augmentation of risk arising from the drilling of an excessive number of wells, and will otherwise prevent waste and protect correlative rights.

WHEREFORE, applicant prays:

A. That this application be set for hearing before an examiner and that notice of said hearing be given as required by law.

B. That upon hearing, the Division enter its order granting applicant permission to drill said well at a location 660 feet from the South line and 1,650 feet from the East line of said Section 12 and to dedicate the S/2 of Section 12 to said well.

C. For such further relief as the Division deems just and proper.

DATED this 25th day of March, 1980.

HARVEY E. YATES COMPANY

By: 

Robert H. Strand  
Attorney for Applicant  
P. O. Box 1933  
Roswell, New Mexico 88201

**DRAFT**

dr/

STATE OF NEW MEXICO  
ENERGY AND MINERALS DEPARTMENT  
OIL CONSERVATION DIVISION

IN THE MATTER OF THE HEARING  
CALLED BY THE OIL CONSERVATION  
DIVISION FOR THE PURPOSE OF  
CONSIDERING:

CASE NO. 6873

ORDER NO. R- 6341

APPLICATION OF HARVEY E. YATES COMPANY

FOR AN UNORTHODOX GAS WELL LOCATION,  
EDDY COUNTY, NEW MEXICO.

### ORDER OF THE DIVISION

**BY THE DIVISION:**

This cause came on for hearing at 9 a.m. on April 23,  
1980, at Santa Fe, New Mexico, before Examiner Richard L. Stamets

NOW, on this \_\_\_\_\_ day of \_\_\_\_\_, 1980, the Division Director, having considered the testimony, the record, and the recommendations of the Examiner, and being fully advised in the premises,

**FINDS:**

(1) That due public notice having been given as required by law, the Division has jurisdiction of this cause and the subject matter thereof.

(2) That the applicant, Harvey E. Yates Company,  
for its North Travis 12 Deep Well No 1; ~~and proposed~~ to be drilled  
seeks approval of an unorthodox gas well location/ 660

feet from the South line and 1650 feet from the  
East line of Section 12, Township 18 South

Range 28 East: NMPM, ~~to test the~~ Wolfcamp and  
~~formation~~ connections,  
~~formation~~ Travis Field BASE, DATA

County, New Mexico. *about 1000 ft. above sea level*

(3) That the S/2 of said Section 12 is to be dedicated to the well.

dedicated to the well.

That said North Travis 12 Deep Well No. 1 is to be drilled as a development well at a standard location in the Travis-Upper Pennsylvanian Pool.

(4) ~~That a well at said unorthodox location will better enable applicant to produce the gas underlying the proration unit.~~

(5) That no offset operator objected to the proposed unorthodox location.

(5) That approval of the application will permit the applicant to produce any gas zones encountered in the Wolfcamp or other Pennsylvanian zones without the drilling of ~~another~~ a second ~~well~~ (unnecessary) well.

-2-

Case No. \_\_\_\_\_  
Order No. R- \_\_\_\_\_

(7) (6) That approval of the subject application will afford the applicant the opportunity to produce its just and equitable share of the gas in the subject pool, will prevent the economic loss caused by the drilling of unnecessary wells, avoid the augmentation of risk arising from the drilling of an excessive number of wells, and will otherwise prevent waste and protect correlative rights.

IT IS THEREFORE ORDERED:

(1) That an unorthodox gas well location for the ~~Moscow~~ Wolfcamp and the Harvey E. Yates Company ~~North Texas 12 Deep Well No. 1~~ to be drilled formations is hereby approved for ~~location as indicated~~ at a point 660 feet from the South line and 1650 feet from the East line of Section 12, Township 18 South, Range 28 East NMPN, Travis Field, ~~Eddy~~, Eddy County, New Mexico.

*as a gas well in the Wolfcamp or lower Pennsylvanian formation,*  
(2) That the S/2 of said Section 12 shall be dedicated to the above-described well.

(3) That jurisdiction of this cause is retained for the entry of such further orders as the Division may deem necessary.

DONE at Santa Fe, New Mexico, on the day and year hereinabove designated.