

District I
1625 N. French Dr., Hobbs, NM 88240
District II
811 S. First St., Artesia, NM 88210
District III
1000 Rio Brazos Road, Aztec, NM 87410
District IV
1220 S. St. Francis Dr., Santa Fe, NM 87505

State of New Mexico
Energy Minerals and Natural Resources
Department
Oil Conservation Division
1220 South St. Francis Dr.
Santa Fe, NM 87505

Form C-147
Revised April 3, 2017

Recycling Facility and/or Recycling Containment

Type of Facility: ☒ Recycling Facility ☒ Recycling Containment*
Type of action: ☐ Permit ☐ Registration
☐ Modification ☐ Extension
☒ Closure ☐ Other (explain) _____

* At the time C-147 is submitted to the division for a Recycling Containment, a copy shall be provided to the surface owner.

Be advised that approval of this request does not relieve the operator of liability should operations result in pollution of surface water, ground water or the environment. Nor does approval relieve the operator of its responsibility to comply with any other applicable governmental authority's rules, regulations or ordinances.

1.

Operator: Enduring Resources, LLC (For multiple operators attach page with information) OGRID #: 372286
Address: 200 Energy Court, Farmington, New Mexico 87401
Facility or well name (include API# if associated with a well): Rodeo 511H Facility
OCD Permit Number: 3RF-49 (Facility ID FVV2123237271) (For new facilities the permit number will be assigned by the district office)
U/L or Qtr/Qtr N Section 25 Township 23N Range 9W County: San Juan
Surface Owner: ☒ Federal ☐ State ☐ Private ☐ Tribal Trust or Indian Allotment

2.

☒ **Recycling Facility:**

Location of recycling facility (if applicable): Latitude 36.191179 Longitude -107.744800 NAD83

Proposed Use: ☒ Drilling* ☒ Completion* ☒ Production* ☒ Plugging *

*The re-use of produced water may NOT be used until fresh water zones are cased and cemented

☐ Other, requires permit for other uses. Describe use, process, testing, volume of produced water and ensure there will be no adverse impact on groundwater or surface water.

☒ Fluid Storage

☒ Above ground tanks ☒ Recycling containment ☐ Activity permitted under 19.15.17 NMAC explain type _____

☐ Activity permitted under 19.15.36 NMAC explain type: _____ ☐ Other explain _____

☒ For multiple or additional recycling containments, attach design and location information of each containment

☒ **Closure Report (required within 60 days of closure completion):** ☒ Recycling Facility Closure Completion Date: 7/25/2022

3.

☒ **Recycling Containment:**

☐ Annual Extension after initial 5 years (attach summary of monthly leak detection inspections for previous year)

Center of Recycling Containment (if applicable): Latitude 36.191179 Longitude -107.744800 NAD83

☒ For multiple or additional recycling containments, attach design and location information of each containment

☒ Lined ☐ Liner type: Thickness 45 mil ☒ LLDPE ☐ HDPE ☐ PVC ☒ Other Secondary Liner 30 mil

☒ String-Reinforced

Liner Seams: ☒ Welded ☐ Factory ☐ Other _____ Volume: 50,000 & 60,000 bbl Dimensions: Radius 80' x Height 10'

☒ Recycling Containment Closure Completion Date: 7/25/2022

4.

Bonding:

- ☒ Covered under bonding pursuant to 19.15.8 NMAC per 19.15.34.15(A)(2) NMAC (These containments are limited to only the wells owned or operated by the owners of the containment.)
- ☐ Bonding in accordance with 19.15.34.15(A)(1). Amount of bond \$ _____ (work on these facilities cannot commence until bonding amounts are approved)
- ☐ Attach closure cost estimate and documentation on how the closure cost was calculated.

5.

Fencing:

- ☒ Four foot height, four strands of barbed wire evenly spaced between one and four feet
- ☐ Alternate. Please specify _____

6.

Signs:

- ☒ 12"x 24", 2" lettering, providing Operator's name, site location, and emergency telephone numbers
- ☐ Signed in compliance with 19.15.16.8 NMAC

7.

Variances:

Justifications and/or demonstrations that the proposed variance will afford reasonable protection against contamination of fresh water, human health, and the environment.

Check the below box only if a variance is requested:

- ☐ Variance(s): Requests must be submitted to the appropriate division district for consideration of approval. If a Variance is requested, include the variance information on a separate page and attach it to the C-147 as part of the application.

If a Variance is requested, it must be approved prior to implementation.

8.

Siting Criteria for Recycling Containment

Instructions: The applicant must provide attachments that demonstrate compliance for each siting criteria below as part of the application. Potential examples of the siting attachment source material are provided below under each criteria.

General siting**Ground water is less than 50 feet below the bottom of the Recycling Containment.**

NM Office of the State Engineer - iWATERS database search; USGS; Data obtained from nearby wells

☐ Yes ☒ No
☐ NA

Within incorporated municipal boundaries or within a defined municipal fresh water well field covered under a municipal ordinance adopted pursuant to NMSA 1978, Section 3-27-3, as amended.

☐ Yes ☒ No
☐ NA

- Written confirmation or verification from the municipality; written approval obtained from the municipality

Within the area overlying a subsurface mine.

☐ Yes ☒ No

- Written confirmation or verification or map from the NM EMNRD-Mining and Minerals Division

Within an unstable area.

☐ Yes ☒ No

- Engineering measures incorporated into the design; NM Bureau of Geology & Mineral Resources; USGS; NM Geological Society; topographic map

Within a 100-year floodplain. FEMA map

☐ Yes ☒ No

Within 300 feet of a continuously flowing watercourse, or 200 feet of any other significant watercourse, or lakebed, sinkhole, or playa lake (measured from the ordinary high-water mark).

☐ Yes ☒ No

- Topographic map; visual inspection (certification) of the proposed site

Within 1000 feet from a permanent residence, school, hospital, institution, or church in existence at the time of initial application.

☐ Yes ☒ No

- Visual inspection (certification) of the proposed site; aerial photo; satellite image

Within 500 horizontal feet of a spring or a fresh water well used for domestic or stock watering purposes, in existence at the time of initial application.

☐ Yes ☒ No

- NM Office of the State Engineer - iWATERS database search; visual inspection (certification) of the proposed site

Within 500 feet of a wetland.

☐ Yes ☒ No

- US Fish and Wildlife Wetland Identification map; topographic map; visual inspection (certification) of the proposed site

9.

Recycling Facility and/or Containment Checklist:

Instructions: Each of the following items must be attached to the application. Indicate, by a check mark in the box, that the documents are attached.

- ☐ Design Plan - based upon the appropriate requirements.
- ☐ Operating and Maintenance Plan - based upon the appropriate requirements.
- ☒ Closure Plan - based upon the appropriate requirements.
- ☐ Site Specific Groundwater Data -
- ☐ Siting Criteria Compliance Demonstrations -
- ☒ Certify that notice of the C-147 (only) has been sent to the surface owner(s)

10.

Operator Application Certification:

I hereby certify that the information and attachments submitted with this application are true, accurate and complete to the best of my knowledge and belief.

Name (Print): Khem Suthiwan Title: Regulatory Manager

Signature: Khem Suthiwan Date: 9/9/2022

e-mail address: ksuthiwan@eduringresources.com Telephone: 303-350-5721

11.

OCD Representative Signature: Victoria Venegas Approval Date: 10/05/2022

Title: Environmental Specialist OCD Permit Number: 3RF-49

- ☐ OCD Conditions _____
- ☐ Additional OCD Conditions on Attachment _____

Closure Documentation

Rodeo 511H Water Recycle Facility



Enduring Resources, LLC
200 Energy Court
Farmington, New Mexico 87401

Introduction

This closure plan is designed to meet the requirements of NMAC 19.15.34.14, which outlines the requirements for closure of a produced water recycling containment.

Closure Plan

1. **Upon cessation of operations (Defined as the use of less than 20% of the pond's total fluid capacity), Enduring will remove all fluids within 60 days of the official date of cessation.**
The final date of use was July 25, 2022. All fluids were removed from the containment on July 25, 2022 and all containments were removed.
2. **Enduring will close the produced water containment within six (6) months from the official date of cessation. If Enduring will require more than 6 months to complete closure activities, an extension request will be filed prior to the six (6) month time limit for closure.**
The containment was disassembled, and closure sampling was conducted on August 22, 2022.
3. **Within 60 days of final closure completion, Enduring will submit a closure report on form C-147, including required attachments, to document all closure activities including sampling results. The closure report will certify that all information in the report and attachments is correct and that Enduring has complied with all applicable closure requirements and conditions specified in divisions rules of directives.**
This closure report is submitted within 60 days of the documented closure date of 7/25/2022.
4. **Closure activities will consist of the following:**
 - a. **Removal of all containment contents**
All containments were removed on 7/25/2022.
 - b. **Removal of liners and associated leak detection equipment for disposal at a division approved facility.**
All liner and leak detection materials were removed and transported to another facility for use.
 - c. **Removal of all equipment associated with the continued operation of the recycling containment.**
All equipment associated with the continued operation of the recycling containment has been removed from the site.
 - d. **Enduring will test the soils beneath the containment for contamination with a five-point composite sample which includes wet or stained soils, if any, and that sample shall be analyzed for the constituents listed in Table I.**
One (1) 5-point composite was collected beneath the location of the above grade storage tanks that made up the recycling facility on 8/22/2022; see attached *Field Notes*. The sample was analyzed for the constituents listed in Table I. No wet or stained areas were observed during the sampling event.
 - e. **If the closure sample(s) collected return results equal to or less than the values listed in Table I, closure will be completed and backfill will begin with non-waste containing, uncontaminated, earthen material**
The 5-point composite sample collected returned results below the limits listed in Table I for sites with groundwater from 51'-100' below ground surface; see attached *Results Table*. No backfill is required, as no excavation was needed.
 - f. **If the closure sample(s) collected indicate concentrations are higher than the values listed in Table I, Enduring will report the elevated sample values to the NMOC, and additional delineation may be required at this time.**

The 5-point composite sample collected returned results below the limits listed in Table I for sites with groundwater from 51'-100' below ground surface; see attached *Results Table*.

5. **Enduring will reclaim the containment location to a safe and stable condition that blends the surrounding undisturbed area. Top soils and subsoils will be replaced to their original relative positions and recontoured to achieve erosion control, long term stability and preservation of surface water flow patterns. The disturbed area will be re-seeded in the first favorable growing season. The impacted surface area will be restored to the condition that existed prior to the condition that existed prior to construction.**

The pad area will be reclaimed to meet the standards of the surface owner, the Bureau of Land Management. Enduring will submit notice to the NMOCD when recontouring and re-seeding activities have been completed.

6. **Reclamation of all disturbed areas no longer in use shall be considered complete when all ground disturbing activities have been completed, and a uniform vegetative cover has been established that reflects a life-form ratio of fifty percent of pre-disturbance levels and total percent plant cover of at least seventy percent of pre-disturbance levels excluding noxious weeds.**

The pad area will be reclaimed to meet the standards of the surface owner, the Bureau of Land Management. Enduring will submit notice to the NMOCD when the required vegetative cover requirements have been met.

7. **Soil cover and revegetation as required in 19.15.34.14 NMAC will be met in addition to the reclamation requirements of the BLM as surface owner, which provides for more stringent requirements.**

The pad area will be reclaimed to meet the standards of the surface owner, the Bureau of Land Management.

Table I Closure Criteria for Recycling Containments			
Depth below bottom of containment to groundwater less than 10,000 mg/l TDS	Constituent	Method*	Limit**
51 feet - 100 feet	Chloride	EPA 300.0	10,000 mg/kg
	TPH (GRO+DRO+MRO)	EPA SW-846 Method 8015M	2,500 mg/kg
	GRO+DRO	EPA SW-846 Method 8015M	1,000 mg/kg
	BTEX	EPA SW-846 Method 8021B or 8260B	50 mg/kg
	Benzene	EPA SW-846 Method 8021B or 8260B	10 mg/kg
> 100 feet	Chloride	EPA 300.0	20,000 mg/kg
	TPH (GRO+DRO+MRO)	EPA SW-846 Method 8015M	2,500 mg/kg
	GRO+DRO	EPA SW-846 Method 8015M	1,000 mg/kg
	BTEX	EPA SW-846 Method 8021B or 8260B	50 mg/kg
	Benzene	EPA SW-846 Method 8021B or 8260B	10 mg/kg

* Or other test methods approved by the division.

** Numerical limits or natural background level, whichever is greater.

[19.15.34.14 NMAC - N, 3/31/2015; A, 10/13/2020]

Results Table - Rodeo 511H

Sample Description	Date	Chlorides (mg/kg)	GRO (mg/kg)	DRO (mg/kg)	TPH (DRO+GRO) (mg/kg)	MRO (mg/kg)	TPH (DRO+GRO+MRO) (mg/kg)	Benzene (mg/kg)	Toluene (mg/kg)	Ethylbenzene (mg/kg)	Total Xylenes (mg/kg)	BTEX (mg/kg)
TABLE I STANDARDS	NA	10,000	NA	NA	1,000	NA	2,500	10	NA	NA	NA	50
Composite Sample	8/22/2022	< 20.6	< 0.100	< 4.00	< 4.10	< 4.00	< 8.10	< 0.00100	<0.00500	< 0.00250	<0.00650	< 0.0150

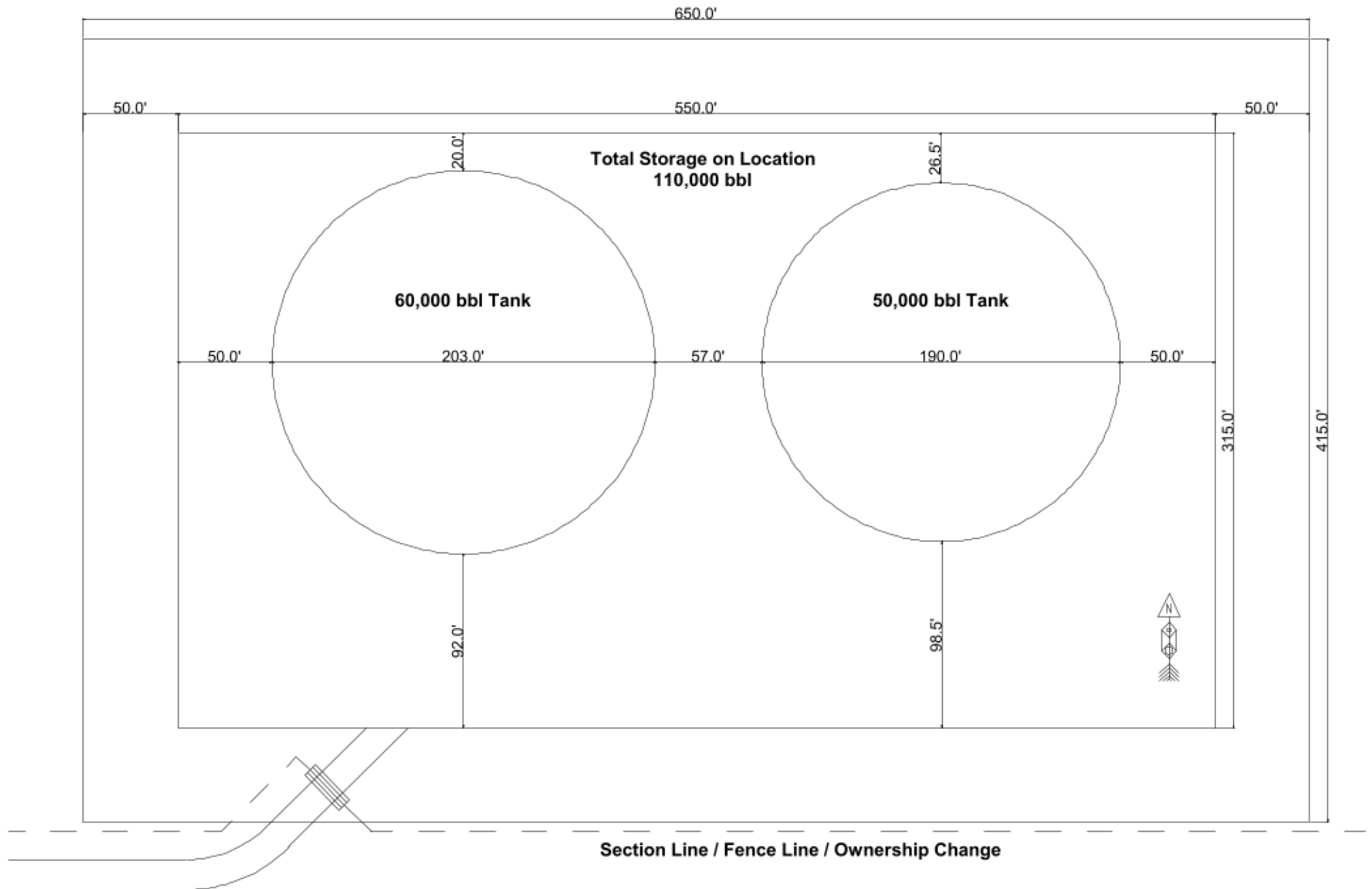



ANALYTICAL REPORT

September 01, 2022

CDH Consulting - Thorton, CO

Sample Delivery Group: L1528745
Samples Received: 08/24/2022
Project Number: ENDURING
Description: Rodeo 511 Closure Sampling
Site: RODEO 511
Report To: Kayla White
9446 Clermont Street
Thorton, CO 80229

1 Cp

2 Tc

3 Ss

4 Cn

5 Sr

6 Qc

7 Gl

8 Al

9 Sc

Entire Report Reviewed By:

Chris Ward
Project Manager

Results relate only to the items tested or calibrated and are reported as rounded values. This test report shall not be reproduced, except in full, without written approval of the laboratory. Where applicable, sampling conducted by Pace Analytical National is performed per guidance provided in laboratory standard operating procedures ENV-SOP-MTJL-0067 and ENV-SOP-MTJL-0068. Where sampling conducted by the customer, results relate to the accuracy of the information provided, and as the samples are received.

Pace Analytical National

12065 Lebanon Rd Mount Juliet, TN 37122 615-758-5858 800-767-5859 www.pacenational.com

Cp: Cover Page	1	¹ Cp
Tc: Table of Contents	2	
Ss: Sample Summary	3	² Tc
Cn: Case Narrative	4	
Sr: Sample Results	5	³ Ss
RODEO 511 L1528745-01	5	⁴ Cn
Qc: Quality Control Summary	6	
Wet Chemistry by Method 9056A	6	⁵ Sr
Volatile Organic Compounds (GC) by Method 8015D/GRO	7	
Volatile Organic Compounds (GC/MS) by Method 8260B	8	⁶ Qc
Semi-Volatile Organic Compounds (GC) by Method 8015	10	⁷ Gl
Gl: Glossary of Terms	11	
Al: Accreditations & Locations	12	⁸ Al
Sc: Sample Chain of Custody	13	⁹ Sc

RODEO 511 L1528745-01 Solid

Collected by
Travis ShortCollected date/time
08/22/22 11:00Received date/time
08/24/22 08:45

Method	Batch	Dilution	Preparation date/time	Analysis date/time	Analyst	Location
Wet Chemistry by Method 9056A	WG1917071	1.03	08/26/22 19:30	08/27/22 00:06	LBR	Mt. Juliet, TN
Volatile Organic Compounds (GC) by Method 8015D/GRO	WG1917402	1	08/25/22 18:24	08/28/22 23:41	DWR	Mt. Juliet, TN
Volatile Organic Compounds (GC/MS) by Method 8260B	WG1916822	1	08/25/22 18:24	08/26/22 01:36	ACG	Mt. Juliet, TN
Volatile Organic Compounds (GC/MS) by Method 8260B	WG1918165	1	08/25/22 18:24	08/30/22 04:46	ACG	Mt. Juliet, TN
Semi-Volatile Organic Compounds (GC) by Method 8015	WG1917188	1	08/26/22 19:20	08/27/22 14:32	JAS	Mt. Juliet, TN

1 Cp

2 Tc

3 Ss

4 Cn

5 Sr

6 Qc

7 Gl

8 Al

9 Sc

All sample aliquots were received at the correct temperature, in the proper containers, with the appropriate preservatives, and within method specified holding times, unless qualified or notated within the report. Where applicable, all MDL (LOD) and RDL (LOQ) values reported for environmental samples have been corrected for the dilution factor used in the analysis. All Method and Batch Quality Control are within established criteria except where addressed in this case narrative, a non-conformance form or properly qualified within the sample results. By my digital signature below, I affirm to the best of my knowledge, all problems/anomalies observed by the laboratory as having the potential to affect the quality of the data have been identified by the laboratory, and no information or data have been knowingly withheld that would affect the quality of the data.



Chris Ward
Project Manager

¹ Cp² Tc³ Ss⁴ Cn⁵ Sr⁶ Qc⁷ Gl⁸ Al⁹ Sc

Collected date/time: 08/22/22 11:00

L1528745

Wet Chemistry by Method 9056A

Analyte	Result mg/kg	Qualifier	RDL mg/kg	Dilution	Analysis date / time	Batch
Chloride	ND		20.6	1.03	08/27/2022 00:06	WG1917071

Volatile Organic Compounds (GC) by Method 8015D/GRO

Analyte	Result mg/kg	Qualifier	RDL mg/kg	Dilution	Analysis date / time	Batch
TPH (GC/FID) Low Fraction	ND		0.100	1	08/28/2022 23:41	WG1917402
(S) <i>o</i> , <i>a</i> , <i>a</i> -Trifluorotoluene(FID)	113		77.0-120		08/28/2022 23:41	WG1917402

Volatile Organic Compounds (GC/MS) by Method 8260B

Analyte	Result mg/kg	Qualifier	RDL mg/kg	Dilution	Analysis date / time	Batch
Benzene	ND		0.00100	1	08/26/2022 01:36	WG1916822
Toluene	ND		0.00500	1	08/26/2022 01:36	WG1916822
Ethylbenzene	ND		0.00250	1	08/30/2022 04:46	WG1918165
Total Xylenes	ND		0.00650	1	08/30/2022 04:46	WG1918165
(S) Toluene-d8	107		75.0-131		08/26/2022 01:36	WG1916822
(S) Toluene-d8	103		75.0-131		08/30/2022 04:46	WG1918165
(S) 4-Bromofluorobenzene	98.3		67.0-138		08/26/2022 01:36	WG1916822
(S) 4-Bromofluorobenzene	108		67.0-138		08/30/2022 04:46	WG1918165
(S) 1,2-Dichloroethane-d4	90.6		70.0-130		08/26/2022 01:36	WG1916822
(S) 1,2-Dichloroethane-d4	111		70.0-130		08/30/2022 04:46	WG1918165

Semi-Volatile Organic Compounds (GC) by Method 8015

Analyte	Result mg/kg	Qualifier	RDL mg/kg	Dilution	Analysis date / time	Batch
C10-C28 Diesel Range	ND		4.00	1	08/27/2022 14:32	WG1917188
C28-C40 Oil Range	ND		4.00	1	08/27/2022 14:32	WG1917188
(S) <i>o</i> -Terphenyl	55.3		18.0-148		08/27/2022 14:32	WG1917188

Wet Chemistry by Method 9056A

L1528745-01

Method Blank (MB)

(MB) R3831169-1 08/26/22 20:24

Analyte	MB Result mg/kg	MB Qualifier	MB MDL mg/kg	MB RDL mg/kg
Chloride	U		9.20	20.0

L1528727-22 Original Sample (OS) • Duplicate (DUP)

(OS) L1528727-22 08/26/22 22:37 • (DUP) R3831169-3 08/26/22 22:52

Analyte	Original Result mg/kg	DUP Result mg/kg	Dilution	DUP RPD %	DUP Qualifier	DUP RPD Limits %
Chloride	606	635	1	4.75		15

L1528843-01 Original Sample (OS) • Duplicate (DUP)

(OS) L1528843-01 08/27/22 01:50 • (DUP) R3831169-4 08/27/22 02:05

Analyte	Original Result mg/kg	DUP Result mg/kg	Dilution	DUP RPD %	DUP Qualifier	DUP RPD Limits %
Chloride	23.3	27.2	1	15.5	P1	15

Laboratory Control Sample (LCS)

(LCS) R3831169-2 08/26/22 20:39

Analyte	Spike Amount mg/kg	LCS Result mg/kg	LCS Rec. %	Rec. Limits %	LCS Qualifier
Chloride	200	211	106	80.0-120	

L1528843-01 Original Sample (OS) • Matrix Spike (MS) • Matrix Spike Duplicate (MSD)

(OS) L1528843-01 08/27/22 01:50 • (MS) R3831169-5 08/27/22 02:20 • (MSD) R3831169-6 08/27/22 03:05

Analyte	Spike Amount mg/kg	Original Result mg/kg	MS Result mg/kg	MSD Result mg/kg	MS Rec. %	MSD Rec. %	Dilution	Rec. Limits %	MS Qualifier	MSD Qualifier	RPD %	RPD Limits %
Chloride	500	23.3	548	552	105	106	1	80.0-120			0.689	15

1 Cp

2 Tc

3 Ss

4 Cn

5 Sr

6 Qc

7 Gl

8 Al

9 Sc

Volatile Organic Compounds (GC) by Method 8015D/GRO

L1528745-01

Method Blank (MB)

(MB) R3832443-3 08/28/22 16:06

Analyte	MB Result mg/kg	MB Qualifier	MB MDL mg/kg	MB RDL mg/kg
TPH (GC/FID) Low Fraction	U		0.0217	0.100
(S) a,a,a-Trifluorotoluene(FID)	112			77.0-120

Laboratory Control Sample (LCS)

(LCS) R3832443-2 08/28/22 15:23

Analyte	Spike Amount mg/kg	LCS Result mg/kg	LCS Rec. %	Rec. Limits %	LCS Qualifier
TPH (GC/FID) Low Fraction	5.50	5.52	100	72.0-127	
(S) a,a,a-Trifluorotoluene(FID)			101	77.0-120	

L1528811-09 Original Sample (OS) • Matrix Spike (MS) • Matrix Spike Duplicate (MSD)

(OS) L1528811-09 08/28/22 16:52 • (MS) R3832443-6 08/29/22 00:46 • (MSD) R3832443-7 08/29/22 01:08

Analyte	Spike Amount mg/kg	Original Result mg/kg	MS Result mg/kg	MSD Result mg/kg	MS Rec. %	MSD Rec. %	Dilution	Rec. Limits %	MS Qualifier	MSD Qualifier	RPD %	RPD Limits %
TPH (GC/FID) Low Fraction	5.50	ND	5.09	5.20	92.5	94.5	1	10.0-151			2.14	28
(S) a,a,a-Trifluorotoluene(FID)					107	101		77.0-120				

1 Cp

2 Tc

3 Ss

4 Cn

5 Sr

6 Qc

7 Gl

8 Al

9 Sc

Volatile Organic Compounds (GC/MS) by Method 8260B

L1528745-01

Method Blank (MB)

(MB) R3831500-2 08/25/22 21:54

Analyte	MB Result mg/kg	MB Qualifier	MB MDL mg/kg	MB RDL mg/kg
Benzene	U		0.000467	0.00100
Toluene	U		0.00130	0.00500
(S) Toluene-d8	107			75.0-131
(S) 4-Bromofluorobenzene	98.1			67.0-138
(S) 1,2-Dichloroethane-d4	95.7			70.0-130

Laboratory Control Sample (LCS)

(LCS) R3831500-1 08/25/22 21:08

Analyte	Spike Amount mg/kg	LCS Result mg/kg	LCS Rec. %	Rec. Limits %	LCS Qualifier
Benzene	0.125	0.126	101	70.0-123	
Toluene	0.125	0.133	106	75.0-121	
(S) Toluene-d8			107	75.0-131	
(S) 4-Bromofluorobenzene			93.4	67.0-138	
(S) 1,2-Dichloroethane-d4			102	70.0-130	

1 Cp

2 Tc

3 Ss

4 Cn

5 Sr

6 Qc

7 Gl

8 Al

9 Sc

Volatile Organic Compounds (GC/MS) by Method 8260B

L1528745-01

Method Blank (MB)

(MB) R3831777-3 08/29/22 22:13

Analyte	MB Result mg/kg	MB Qualifier	MB MDL mg/kg	MB RDL mg/kg
Ethylbenzene	U		0.000737	0.00250
Xylenes, Total	U		0.000880	0.00650
(S) Toluene-d8	105			75.0-131
(S) 4-Bromofluorobenzene	103			67.0-138
(S) 1,2-Dichloroethane-d4	97.2			70.0-130

Laboratory Control Sample (LCS) • Laboratory Control Sample Duplicate (LCSD)

(LCS) R3831777-1 08/29/22 20:59 • (LCSD) R3831777-2 08/29/22 21:17

Analyte	Spike Amount mg/kg	LCS Result mg/kg	LCSD Result mg/kg	LCS Rec. %	LCSD Rec. %	Rec. Limits %	LCS Qualifier	LCSD Qualifier	RPD %	RPD Limits %
Ethylbenzene	0.125	0.139	0.119	111	95.2	74.0-126			15.5	20
Xylenes, Total	0.375	0.417	0.368	111	98.1	72.0-127			12.5	20
(S) Toluene-d8				104	105	75.0-131				
(S) 4-Bromofluorobenzene				103	103	67.0-138				
(S) 1,2-Dichloroethane-d4				106	106	70.0-130				

1 Cp

2 Tc

3 Ss

4 Cn

5 Sr

6 Qc

7 Gl

8 Al

9 Sc

Semi-Volatile Organic Compounds (GC) by Method 8015

L1528745-01

Method Blank (MB)

(MB) R3831120-1 08/27/22 06:21

Analyte	MB Result mg/kg	MB Qualifier	MB MDL mg/kg	MB RDL mg/kg
C10-C28 Diesel Range	U		1.61	4.00
C28-C40 Oil Range	U		0.274	4.00
(S) o-Terphenyl	68.6			18.0-148

Laboratory Control Sample (LCS)

(LCS) R3831120-2 08/27/22 06:40

Analyte	Spike Amount mg/kg	LCS Result mg/kg	LCS Rec. %	Rec. Limits %	LCS Qualifier
C10-C28 Diesel Range	50.0	40.3	80.6	50.0-150	
(S) o-Terphenyl			85.4	18.0-148	

L1528561-01 Original Sample (OS) • Matrix Spike (MS) • Matrix Spike Duplicate (MSD)

(OS) L1528561-01 08/27/22 17:36 • (MS) R3831120-3 08/27/22 17:49 • (MSD) R3831120-4 08/27/22 18:02

Analyte	Spike Amount mg/kg	Original Result mg/kg	MS Result mg/kg	MSD Result mg/kg	MS Rec. %	MSD Rec. %	Dilution	Rec. Limits %	MS Qualifier	MSD Qualifier	RPD %	RPD Limits %
C10-C28 Diesel Range	50.0	ND	28.2	30.0	50.6	54.2	1	50.0-150			6.19	20
(S) o-Terphenyl					59.0	59.6		18.0-148				

1 Cp

2 Tc

3 Ss

4 Cn

5 Sr

6 Qc

7 Gl

8 Al

9 Sc

Guide to Reading and Understanding Your Laboratory Report

The information below is designed to better explain the various terms used in your report of analytical results from the Laboratory. This is not intended as a comprehensive explanation, and if you have additional questions please contact your project representative.

Results Disclaimer - Information that may be provided by the customer, and contained within this report, include Permit Limits, Project Name, Sample ID, Sample Matrix, Sample Preservation, Field Blanks, Field Spikes, Field Duplicates, On-Site Data, Sampling Collection Dates/Times, and Sampling Location. Results relate to the accuracy of this information provided, and as the samples are received.

Abbreviations and Definitions

MDL	Method Detection Limit.
ND	Not detected at the Reporting Limit (or MDL where applicable).
RDL	Reported Detection Limit.
Rec.	Recovery.
RPD	Relative Percent Difference.
SDG	Sample Delivery Group.
(S)	Surrogate (Surrogate Standard) - Analytes added to every blank, sample, Laboratory Control Sample/Duplicate and Matrix Spike/Duplicate; used to evaluate analytical efficiency by measuring recovery. Surrogates are not expected to be detected in all environmental media.
U	Not detected at the Reporting Limit (or MDL where applicable).
Analyte	The name of the particular compound or analysis performed. Some Analyses and Methods will have multiple analytes reported.
Dilution	If the sample matrix contains an interfering material, the sample preparation volume or weight values differ from the standard, or if concentrations of analytes in the sample are higher than the highest limit of concentration that the laboratory can accurately report, the sample may be diluted for analysis. If a value different than 1 is used in this field, the result reported has already been corrected for this factor.
Limits	These are the target % recovery ranges or % difference value that the laboratory has historically determined as normal for the method and analyte being reported. Successful QC Sample analysis will target all analytes recovered or duplicated within these ranges.
Original Sample	The non-spiked sample in the prep batch used to determine the Relative Percent Difference (RPD) from a quality control sample. The Original Sample may not be included within the reported SDG.
Qualifier	This column provides a letter and/or number designation that corresponds to additional information concerning the result reported. If a Qualifier is present, a definition per Qualifier is provided within the Glossary and Definitions page and potentially a discussion of possible implications of the Qualifier in the Case Narrative if applicable.
Result	The actual analytical final result (corrected for any sample specific characteristics) reported for your sample. If there was no measurable result returned for a specific analyte, the result in this column may state "ND" (Not Detected) or "BDL" (Below Detectable Levels). The information in the results column should always be accompanied by either an MDL (Method Detection Limit) or RDL (Reporting Detection Limit) that defines the lowest value that the laboratory could detect or report for this analyte.
Uncertainty (Radiochemistry)	Confidence level of 2 sigma.
Case Narrative (Cn)	A brief discussion about the included sample results, including a discussion of any non-conformances to protocol observed either at sample receipt by the laboratory from the field or during the analytical process. If present, there will be a section in the Case Narrative to discuss the meaning of any data qualifiers used in the report.
Quality Control Summary (Qc)	This section of the report includes the results of the laboratory quality control analyses required by procedure or analytical methods to assist in evaluating the validity of the results reported for your samples. These analyses are not being performed on your samples typically, but on laboratory generated material.
Sample Chain of Custody (Sc)	This is the document created in the field when your samples were initially collected. This is used to verify the time and date of collection, the person collecting the samples, and the analyses that the laboratory is requested to perform. This chain of custody also documents all persons (excluding commercial shippers) that have had control or possession of the samples from the time of collection until delivery to the laboratory for analysis.
Sample Results (Sr)	This section of your report will provide the results of all testing performed on your samples. These results are provided by sample ID and are separated by the analyses performed on each sample. The header line of each analysis section for each sample will provide the name and method number for the analysis reported.
Sample Summary (Ss)	This section of the Analytical Report defines the specific analyses performed for each sample ID, including the dates and times of preparation and/or analysis.

Qualifier Description

P1	RPD value not applicable for sample concentrations less than 5 times the reporting limit.
----	---

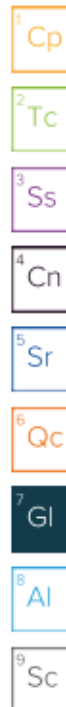

Pace Analytical National 12065 Lebanon Rd Mount Juliet, TN 37122

Alabama	40660	Nebraska	NE-OS-15-05
Alaska	17-026	Nevada	TN000032021-1
Arizona	AZ0612	New Hampshire	2975
Arkansas	88-0469	New Jersey-NELAP	TN002
California	2932	New Mexico ¹	TN00003
Colorado	TN00003	New York	11742
Connecticut	PH-0197	North Carolina	Env375
Florida	E87487	North Carolina ¹	DW21704
Georgia	NELAP	North Carolina ³	41
Georgia ¹	923	North Dakota	R-140
Idaho	TN00003	Ohio-VAP	CL0069
Illinois	200008	Oklahoma	9915
Indiana	C-TN-01	Oregon	TN200002
Iowa	364	Pennsylvania	68-02979
Kansas	E-10277	Rhode Island	LA000356
Kentucky ^{1 6}	KY90010	South Carolina	84004002
Kentucky ²	16	South Dakota	n/a
Louisiana	AI30792	Tennessee ^{1 4}	2006
Louisiana	LA018	Texas	T104704245-20-18
Maine	TN00003	Texas ⁵	LAB0152
Maryland	324	Utah	TN000032021-11
Massachusetts	M-TN003	Vermont	VT2006
Michigan	9958	Virginia	110033
Minnesota	047-999-395	Washington	C847
Mississippi	TN00003	West Virginia	233
Missouri	340	Wisconsin	998093910
Montana	CERT0086	Wyoming	AZLA
AZLA - ISO 17025	1461.01	AIHA-LAP, LLC EMLAP	100789
AZLA - ISO 17025 ⁵	1461.02	DOD	1461.01
Canada	1461.01	USDA	P330-15-00234
EPA-Crypto	TN00003		

¹ Drinking Water ² Underground Storage Tanks ³ Aquatic Toxicity ⁴ Chemical/Microbiological ⁵ Mold ⁶ Wastewater n/a Accreditation not applicable

* Not all certifications held by the laboratory are applicable to the results reported in the attached report.

* Accreditation is only applicable to the test methods specified on each scope of accreditation held by Pace Analytical.

1 Cp

2 Tc

3 Ss

4 Cn

5 Sr

6 Qc

7 Gl

8 Al

9 Sc

Released to Imaging: 10/6/2022 10:52:58 AM

Venegas, Victoria, EMNRD

From: Venegas, Victoria, EMNRD
Sent: Thursday, October 6, 2022 10:46 AM
To: Kayla White; Khem Suthiwan
Subject: 3RF-49 - RODEO UNIT 511H - FACILITY ID [fVV2123237271].

3RF-49 - RODEO UNIT 511H - FACILITY ID [fVV2123237271]

Good morning,

NMOCD has reviewed the closure report submitted for [372286] ENDURING RESOURCES, LLC, on 09/08/2022, for 3RF-49 - RODEO UNIT 511H - FACILITY ID [fVV2123237271] in N-25-23N-09W, San Juan County, New Mexico. The closure report has been approved.

Please note that according to NMAC 19.15.34.14.E. Once the operator has closed the recycling containment, the operator shall reclaim the containment's location to a safe and stable condition that blends with the surrounding undisturbed area. Topsoils and subsoils shall be replaced to their original relative positions and contoured so as to achieve erosion control, long-term stability and preservation of surface water flow patterns. The disturbed area shall then be reseeded in the first favorable growing season following closure of a recycling containment. The operator shall substantially restore the impacted surface area to the condition that existed prior to the construction of the recycling containment. Also, per NMAC 19.15.34.14.G: The re-vegetation and reclamation obligations imposed by federal, state trust land or tribal agencies on lands managed by those agencies shall supersede these provisions and govern the obligations of any operator subject to those provisions, provided that the other requirements provide equal or better protection of fresh water, human health, and the environment. In accordance with 19.15.34.14.H, the operator shall notify the division when reclamation and re-vegetation are complete.

Please let me know if you have any additional questions.

Victoria Venegas • Environmental Specialist

Environmental Bureau

EMNRD - Oil Conservation Division

(575) 909-0269 | Victoria.Venegas@emnrd.nm.gov

<http://www.emnrd.state.nm.us/OCD/>



District I

1625 N. French Dr., Hobbs, NM 88240
Phone:(575) 393-6161 Fax:(575) 393-0720

District II

811 S. First St., Artesia, NM 88210
Phone:(575) 748-1283 Fax:(575) 748-9720

District III

1000 Rio Brazos Rd., Aztec, NM 87410
Phone:(505) 334-6178 Fax:(505) 334-6170

District IV

1220 S. St Francis Dr., Santa Fe, NM 87505
Phone:(505) 476-3470 Fax:(505) 476-3462

State of New Mexico
Energy, Minerals and Natural Resources
Oil Conservation Division
1220 S. St Francis Dr.
Santa Fe, NM 87505

CONDITIONS

Action 141498

CONDITIONS

Operator: ENDURING RESOURCES, LLC 6300 S Syracuse Way, Suite 525 Centennial, CO 80111	OGRID: 372286
	Action Number: 141498
	Action Type: [C-147] Water Recycle Long (C-147L)

CONDITIONS

Created By	Condition	Condition Date
vvenegas	NMOCD has reviewed the closure report submitted for [372286] ENDURING RESOURCES, LLC, on 09/08/2022, for 3RF-49 - RODEO UNIT 511H - FACILITY ID [fVV2123237271] in N-25-23N-09W, San Juan County, New Mexico. The closure report has been approved. Please note that according to NMAC 19.15.34.14.E. Once the operator has closed the recycling containment, the operator shall reclaim the containment's location to a safe and stable condition that blends with the surrounding undisturbed area. Topsoils and subsoils shall be replaced to their original relative positions and contoured so as to achieve erosion control, long-term stability and preservation of surface water flow patterns. The disturbed area shall then be reseeded in the first favorable growing season following closure of a recycling containment. The operator shall substantially restore the impacted surface area to the condition that existed prior to the construction of the recycling containment.	10/6/2022