



303 Veterans Airpark Lane Midland, TX 79705

Closure Report

October 9, 2020

Re: Monument ABO Battery
Case # NRM2005941614

On 9/14/2020 the release area was excavated to depths of 1', 1 ½', and 2'. On 09/15/2020 Apache Corporation began collecting final 5-point bottom and wall composites samples in accordance with the approved OCD remediation plan. All samples were submitted to a commercial laboratory for analysis of chloride, TPH, and BTEX. Laboratory results indicate that all samples were below table 1 standards for releases less than or equal to 50 feet to groundwater. Approximately 260 yards of excavated material was taken to an approved OCD disposal facility. The excavation was backfilled with clean imported caliche.

Apache Corporation has completed remediation activities in accordance with NMOCD closure criteria and respectfully request closure of NRM2005941614.

Enclosed: C-141, Maps, Sample Data, Laboratory Results, and Photos

Submitted by;

Bruce Baker

Environmental Technician
larry.baker@apachecorp.com
Cell# 432-631-6982

Incident ID	NRM2005941614
District RP	
Facility ID	
Application ID	

Closure

The responsible party must attach information demonstrating they have complied with all applicable closure requirements and any conditions or directives of the OCD. This demonstration should be in the form of a comprehensive report (electronic submittals in .pdf format are preferred) including a scaled site map, sampling diagrams, relevant field notes, photographs of any excavation prior to backfilling, laboratory data including chain of custody documents of final sampling, and a narrative of the remedial activities. Refer to 19.15.29.12 NMAC.

Closure Report Attachment Checklist: *Each of the following items must be included in the closure report.*

- ☒ A scaled site and sampling diagram as described in 19.15.29.11 NMAC
- ☒ Photographs of the remediated site prior to backfill or photos of the liner integrity if applicable (Note: appropriate OCD District office must be notified 2 days prior to liner inspection)
- ☒ Laboratory analyses of final sampling (Note: appropriate ODC District office must be notified 2 days prior to final sampling)
- ☒ Description of remediation activities

I hereby certify that the information given above is true and complete to the best of my knowledge and understand that pursuant to OCD rules and regulations all operators are required to report and/or file certain release notifications and perform corrective actions for releases which may endanger public health or the environment. The acceptance of a C-141 report by the OCD does not relieve the operator of liability should their operations have failed to adequately investigate and remediate contamination that pose a threat to groundwater, surface water, human health or the environment. In addition, OCD acceptance of a C-141 report does not relieve the operator of responsibility for compliance with any other federal, state, or local laws and/or regulations. The responsible party acknowledges they must substantially restore, reclaim, and re-vegetate the impacted surface area to the conditions that existed prior to the release or their final land use in accordance with 19.15.29.13 NMAC including notification to the OCD when reclamation and re-vegetation are complete.

Printed Name: Larry Baker

Title: Environmental Tech SR.

Signature: Larry Baker

Date: 10/9/2020

email: larry.baker@apachecorp.com

Telephone: 432-631-6982

OCD Only

Received by: Cristina Eads

Date: 10/9/2020

Closure approval by the OCD does not relieve the responsible party of liability should their operations have failed to adequately investigate and remediate contamination that poses a threat to groundwater, surface water, human health, or the environment nor does not relieve the responsible party of compliance with any other federal, state, or local laws and/or regulations.

Closure Approved by: Cristina Eads

Date: 12/18/2020

Printed Name: Cristina Eads

Title: Environmental Specialist



100 ft

© 2020 Google

Google earth

Monument Abo



W1
W2
W3
W4
W5 (1.5')
W6 (2')
W7 (2')

Monument Abo

100 ft

© 2020 Google

Google earth

Sample Date	Sample ID	Depth	Chloride	Benzene	Toulene	Ethybenzene	Total Xylenes	Total BTEX	GRO	DRO	EXT DRO	GPS Coordinates
<u>Wall Samples</u>												
9/15/2020	W1	1'	224	<0.050	<0.050	<0.050	<0.150	<0.300	<10.0	<10.0	<10.0	32.611936 -103.332752
9/15/2020	W2	1'	208	<0.050	<0.050	<0.050	<0.150	<0.300	<10.0	<10.0	10.2	32.611864 -103.332673
9/15/2020	W3	1'	400	<0.050	<0.050	<0.050	<0.150	<0.300	<10.0	<10.0	<10.0	32.611790 -103.332734
9/15/2020	W4	1'	240	<0.050	<0.050	<0.050	<0.150	<0.300	<10.0	<10.0	<10.0	32.611869 -103.332872
9/16/2020	W5	1.5'	320	<0.050	<0.050	<0.050	<0.150	<0.300	<10.0	<10.0	<10.0	32.611869 -103.332739
9/16/2020	W6	2'	352	<0.050	<0.050	<0.050	<0.150	<0.300	<10.0	<10.0	<10.0	32.611830 -103.332741
9/16/2020	W7	2'	272	<0.050	<0.050	<0.050	<0.150	<0.300	<10.0	<10.0	<10.0	32.611817 -103.332804
<u>Bottom Samples</u>												
9/15/2020	B1	1.5'	32	<0.050	<0.050	<0.050	<0.150	<0.300	<10.0	<10.0	<10.0	32.611909 -103.332694
9/15/2020	B2	1.5'	112	<0.050	<0.050	<0.050	<0.150	<0.300	<10.0	<10.0	<10.0	32.611853 -103.332691
9/15/2020	B3	2'	208	<0.050	<0.050	<0.050	<0.150	<0.300	<10.0	<10.0	<10.0	32.611805 -103.332683
9/15/2020	B4	2'	192	<0.050	<0.050	<0.050	<0.150	<0.300	<10.0	<10.0	<10.0	32.611805 -103.332715
9/15/2020	B5	1.5'	208	<0.050	<0.050	<0.050	<0.150	<0.300	<10.0	<10.0	<10.0	32.611853 -103.332720
9/15/2020	B6	1'	96	<0.050	<0.050	<0.050	<0.150	<0.300	<10.0	<10.0	<10.0	32.611907 -103.332723
9/15/2020	B7	1'	48	<0.050	<0.050	<0.050	<0.150	<0.300	<10.0	<10.0	<10.0	32.611920 -103.332778
9/15/2020	B8	1'	256	<0.050	<0.050	<0.050	<0.150	<0.300	<10.0	<10.0	<10.0	32.611884 -103.332755
9/15/2020	B9	2'	288	<0.050	<0.050	<0.050	<0.150	<0.300	<10.0	<10.0	<10.0	32.611827 -103.332750
9/15/2020	B10	2'	128	<0.050	<0.050	<0.050	<0.150	<0.300	<10.0	<10.0	<10.0	32.611828 -103.332786

9/15/2020	B11	1'	16	<0.050	<0.050	<0.050	<0.150	<0.300	<10.0	<10.0	<10.0	32.611879 -103.332788
9/15/2020	B12	1'	<16.0	<0.050	<0.050	<0.050	<0.150	<0.300	<10.0	<10.0	<10.0	32.611888 -103.332822
9/15/2020	B13	1'	16	<0.050	<0.050	<0.050	<0.150	<0.300	<10.0	<10.0	<10.0	32.611837 -103.332822
9/16/2020	B14	1'	128	<0.050	<0.050	<0.050	<0.150	<0.300	<10.0	<10.0	<10.0	32.611863 -103.332851



PHONE (575) 393-2326 ° 101 E. MARLAND ° HOBBS, NM 88240

September 21, 2020

BRUCE BAKER

APACHE CORP - HOBBS

2350 W. MARLAND BLVD.

HOBBS, NM 88240

RE: MONUMENT CTB

Enclosed are the results of analyses for samples received by the laboratory on 09/15/20 16:30.

Cardinal Laboratories is accredited through Texas NELAP under certificate number T104704398-20-13. Accreditation applies to drinking water, non-potable water and solid and chemical materials. All accredited analytes are denoted by an asterisk (*). For a complete list of accredited analytes and matrices visit the TCEQ website at www.tceq.texas.gov/field/qa/lab_accred_certif.html.

Cardinal Laboratories is accredited through the State of Colorado Department of Public Health and Environment for:

Method EPA 552.2	Haloacetic Acids (HAA-5)
Method EPA 524.2	Total Trihalomethanes (TTHM)
Method EPA 524.4	Regulated VOCs (V1, V2, V3)

Accreditation applies to public drinking water matrices.

This report meets NELAP requirements and is made up of a cover page, analytical results, and a copy of the original chain-of-custody. If you have any questions concerning this report, please feel free to contact me.

Sincerely,

A handwritten signature in black ink that reads "Celey D. Keene".

Celey D. Keene

Lab Director/Quality Manager



PHONE (575) 393-2326 • 101 E. MARLAND • HOBBS, NM 88240

Analytical Results For:

APACHE CORP - HOBBS
 BRUCE BAKER
 2350 W. MARLAND BLVD.
 HOBBS NM, 88240
 Fax To: (575) 393-2432

Received:	09/15/2020	Sampling Date:	09/15/2020
Reported:	09/21/2020	Sampling Type:	Soil
Project Name:	MONUMENT CTB	Sampling Condition:	Cool & Intact
Project Number:	NONE GIVEN	Sample Received By:	Tamara Oldaker
Project Location:	NONE GIVEN		

Sample ID: B 1 (H002448-01)

BTEX 8021B		mg/kg		Analyzed By: MS						
Analyte	Result	Reporting Limit	Analyzed	Method Blank	BS	% Recovery	True Value QC	RPD	Qualifier	
Benzene*	<0.050	0.050	09/16/2020	ND	1.99	99.5	2.00	4.86		
Toluene*	<0.050	0.050	09/16/2020	ND	2.00	100	2.00	5.27		
Ethylbenzene*	<0.050	0.050	09/16/2020	ND	1.97	98.7	2.00	5.60		
Total Xylenes*	<0.150	0.150	09/16/2020	ND	5.68	94.6	6.00	5.62		
Total BTEX	<0.300	0.300	09/16/2020	ND						

Surrogate: 4-Bromofluorobenzene (PID) 98.3 % 73.3-129

Chloride, SM4500Cl-B		mg/kg		Analyzed By: GM						
Analyte	Result	Reporting Limit	Analyzed	Method Blank	BS	% Recovery	True Value QC	RPD	Qualifier	
Chloride	32.0	16.0	09/16/2020	ND	432	108	400	3.77		

TPH 8015M		mg/kg		Analyzed By: MS					
Analyte	Result	Reporting Limit	Analyzed	Method Blank	BS	% Recovery	True Value QC	RPD	Qualifier
GRO C6-C10*	<10.0	10.0	09/16/2020	ND	180	90.2	200	1.55	
DRO >C10-C28*	<10.0	10.0	09/16/2020	ND	177	88.7	200	1.18	
EXT DRO >C28-C36	<10.0	10.0	09/16/2020	ND					

Surrogate: 1-Chlorooctane 105 % 44.3-144

Surrogate: 1-Chlorooctadecane 118 % 42.2-156

Cardinal Laboratories

*=Accredited Analyte

PLEASE NOTE: Liability and Damages. Cardinal's liability and client's exclusive remedy for any claim arising, whether based in contract or tort, shall be limited to the amount paid by client for analyses. All claims, including those for negligence and any other cause whatsoever shall be deemed waived unless made in writing and received by Cardinal within thirty (30) days after completion of the applicable service. In no event shall Cardinal be liable for incidental or consequential damages, including, without limitation, business interruptions, loss of use, or loss of profits incurred by client, its subsidiaries, affiliates or successors arising out of or related to the performance of the services hereunder by Cardinal, regardless of whether such claim is based upon any of the above stated reasons or otherwise. Results relate only to the samples identified above. This report shall not be reproduced except in full with written approval of Cardinal Laboratories.

Celey D. Keene, Lab Director/Quality Manager



PHONE (575) 393-2326 • 101 E. MARLAND • HOBBS, NM 88240

Analytical Results For:

APACHE CORP - HOBBS
 BRUCE BAKER
 2350 W. MARLAND BLVD.
 HOBBS NM, 88240
 Fax To: (575) 393-2432

Received:	09/15/2020	Sampling Date:	09/15/2020
Reported:	09/21/2020	Sampling Type:	Soil
Project Name:	MONUMENT CTB	Sampling Condition:	Cool & Intact
Project Number:	NONE GIVEN	Sample Received By:	Tamara Oldaker
Project Location:	NONE GIVEN		

Sample ID: B 2 (H002448-02)

BTX 8021B		mg/kg		Analyzed By: MS					
Analyte	Result	Reporting Limit	Analyzed	Method Blank	BS	% Recovery	True Value QC	RPD	Qualifier
Benzene*	<0.050	0.050	09/16/2020	ND	1.99	99.5	2.00	4.86	
Toluene*	<0.050	0.050	09/16/2020	ND	2.00	100	2.00	5.27	
Ethylbenzene*	<0.050	0.050	09/16/2020	ND	1.97	98.7	2.00	5.60	
Total Xylenes*	<0.150	0.150	09/16/2020	ND	5.68	94.6	6.00	5.62	
Total BTX	<0.300	0.300	09/16/2020	ND					

Surrogate: 4-Bromofluorobenzene (PID) 98.7 % 73.3-129

Chloride, SM4500CI-B		mg/kg		Analyzed By: GM					
Analyte	Result	Reporting Limit	Analyzed	Method Blank	BS	% Recovery	True Value QC	RPD	Qualifier
Chloride	112	16.0	09/16/2020	ND	432	108	400	3.77	

TPH 8015M		mg/kg		Analyzed By: MS					
Analyte	Result	Reporting Limit	Analyzed	Method Blank	BS	% Recovery	True Value QC	RPD	Qualifier
GRO C6-C10*	<10.0	10.0	09/16/2020	ND	180	90.2	200	1.55	
DRO >C10-C28*	<10.0	10.0	09/16/2020	ND	177	88.7	200	1.18	
EXT DRO >C28-C36	<10.0	10.0	09/16/2020	ND					

Surrogate: 1-Chlorooctane 104 % 44.3-144

Surrogate: 1-Chlorooctadecane 116 % 42.2-156

Cardinal Laboratories

*=Accredited Analyte

PLEASE NOTE: Liability and Damages. Cardinal's liability and client's exclusive remedy for any claim arising, whether based in contract or tort, shall be limited to the amount paid by client for analyses. All claims, including those for negligence and any other cause whatsoever shall be deemed waived unless made in writing and received by Cardinal within thirty (30) days after completion of the applicable service. In no event shall Cardinal be liable for incidental or consequential damages, including, without limitation, business interruptions, loss of use, or loss of profits incurred by client, its subsidiaries, affiliates or successors arising out of or related to the performance of the services hereunder by Cardinal, regardless of whether such claim is based upon any of the above stated reasons or otherwise. Results relate only to the samples identified above. This report shall not be reproduced except in full with written approval of Cardinal Laboratories.

Celey D. Keene, Lab Director/Quality Manager



PHONE (575) 393-2326 ° 101 E. MARLAND ° HOBBS, NM 88240

Analytical Results For:

APACHE CORP - HOBBS
 BRUCE BAKER
 2350 W. MARLAND BLVD.
 HOBBS NM, 88240
 Fax To: (575) 393-2432

Received:	09/15/2020	Sampling Date:	09/15/2020
Reported:	09/21/2020	Sampling Type:	Soil
Project Name:	MONUMENT CTB	Sampling Condition:	Cool & Intact
Project Number:	NONE GIVEN	Sample Received By:	Tamara Oldaker
Project Location:	NONE GIVEN		

Sample ID: B 3 (H002448-03)

BTX 8021B		mg/kg		Analyzed By: MS					
Analyte	Result	Reporting Limit	Analyzed	Method Blank	BS	% Recovery	True Value QC	RPD	Qualifier
Benzene*	<0.050	0.050	09/16/2020	ND	1.99	99.5	2.00	4.86	
Toluene*	<0.050	0.050	09/16/2020	ND	2.00	100	2.00	5.27	
Ethylbenzene*	<0.050	0.050	09/16/2020	ND	1.97	98.7	2.00	5.60	
Total Xylenes*	<0.150	0.150	09/16/2020	ND	5.68	94.6	6.00	5.62	
Total BTX	<0.300	0.300	09/16/2020	ND					

Surrogate: 4-Bromofluorobenzene (PID) 97.9 % 73.3-129

Chloride, SM4500CI-B		mg/kg		Analyzed By: GM					
Analyte	Result	Reporting Limit	Analyzed	Method Blank	BS	% Recovery	True Value QC	RPD	Qualifier
Chloride	208	16.0	09/16/2020	ND	400	100	400	0.00	

TPH 8015M		mg/kg		Analyzed By: MS					
Analyte	Result	Reporting Limit	Analyzed	Method Blank	BS	% Recovery	True Value QC	RPD	Qualifier
GRO C6-C10*	<10.0	10.0	09/16/2020	ND	180	90.2	200	1.55	
DRO >C10-C28*	<10.0	10.0	09/16/2020	ND	177	88.7	200	1.18	
EXT DRO >C28-C36	<10.0	10.0	09/16/2020	ND					

Surrogate: 1-Chlorooctane 102 % 44.3-144

Surrogate: 1-Chlorooctadecane 116 % 42.2-156

Cardinal Laboratories

*=Accredited Analyte

PLEASE NOTE: Liability and Damages. Cardinal's liability and client's exclusive remedy for any claim arising, whether based in contract or tort, shall be limited to the amount paid by client for analyses. All claims, including those for negligence and any other cause whatsoever shall be deemed waived unless made in writing and received by Cardinal within thirty (30) days after completion of the applicable service. In no event shall Cardinal be liable for incidental or consequential damages, including, without limitation, business interruptions, loss of use, or loss of profits incurred by client, its subsidiaries, affiliates or successors arising out of or related to the performance of the services hereunder by Cardinal, regardless of whether such claim is based upon any of the above stated reasons or otherwise. Results relate only to the samples identified above. This report shall not be reproduced except in full with written approval of Cardinal Laboratories.

Celey D. Keene, Lab Director/Quality Manager



PHONE (575) 393-2326 • 101 E. MARLAND • HOBBS, NM 88240

Analytical Results For:

APACHE CORP - HOBBS
 BRUCE BAKER
 2350 W. MARLAND BLVD.
 HOBBS NM, 88240
 Fax To: (575) 393-2432

Received:	09/15/2020	Sampling Date:	09/15/2020
Reported:	09/21/2020	Sampling Type:	Soil
Project Name:	MONUMENT CTB	Sampling Condition:	Cool & Intact
Project Number:	NONE GIVEN	Sample Received By:	Tamara Oldaker
Project Location:	NONE GIVEN		

Sample ID: B 4 (H002448-04)

BTEX 8021B		mg/kg		Analyzed By: MS					
Analyte	Result	Reporting Limit	Analyzed	Method Blank	BS	% Recovery	True Value QC	RPD	Qualifier
Benzene*	<0.050	0.050	09/16/2020	ND	1.99	99.5	2.00	4.86	
Toluene*	<0.050	0.050	09/16/2020	ND	2.00	100	2.00	5.27	
Ethylbenzene*	<0.050	0.050	09/16/2020	ND	1.97	98.7	2.00	5.60	
Total Xylenes*	<0.150	0.150	09/16/2020	ND	5.68	94.6	6.00	5.62	
Total BTEX	<0.300	0.300	09/16/2020	ND					

Surrogate: 4-Bromofluorobenzene (PID) 98.8 % 73.3-129

Chloride, SM4500Cl-B		mg/kg		Analyzed By: GM					
Analyte	Result	Reporting Limit	Analyzed	Method Blank	BS	% Recovery	True Value QC	RPD	Qualifier
Chloride	192	16.0	09/16/2020	ND	400	100	400	0.00	

TPH 8015M		mg/kg		Analyzed By: MS					
Analyte	Result	Reporting Limit	Analyzed	Method Blank	BS	% Recovery	True Value QC	RPD	Qualifier
GRO C6-C10*	<10.0	10.0	09/16/2020	ND	180	90.2	200	1.55	
DRO >C10-C28*	<10.0	10.0	09/16/2020	ND	177	88.7	200	1.18	
EXT DRO >C28-C36	<10.0	10.0	09/16/2020	ND					

Surrogate: 1-Chlorooctane 108 % 44.3-144

Surrogate: 1-Chlorooctadecane 122 % 42.2-156

Cardinal Laboratories

*=Accredited Analyte

PLEASE NOTE: Liability and Damages. Cardinal's liability and client's exclusive remedy for any claim arising, whether based in contract or tort, shall be limited to the amount paid by client for analyses. All claims, including those for negligence and any other cause whatsoever shall be deemed waived unless made in writing and received by Cardinal within thirty (30) days after completion of the applicable service. In no event shall Cardinal be liable for incidental or consequential damages, including, without limitation, business interruptions, loss of use, or loss of profits incurred by client, its subsidiaries, affiliates or successors arising out of or related to the performance of the services hereunder by Cardinal, regardless of whether such claim is based upon any of the above stated reasons or otherwise. Results relate only to the samples identified above. This report shall not be reproduced except in full with written approval of Cardinal Laboratories.

Celey D. Keene, Lab Director/Quality Manager



PHONE (575) 393-2326 ° 101 E. MARLAND ° HOBBS, NM 88240

Analytical Results For:

APACHE CORP - HOBBS
 BRUCE BAKER
 2350 W. MARLAND BLVD.
 HOBBS NM, 88240
 Fax To: (575) 393-2432

Received:	09/15/2020	Sampling Date:	09/15/2020
Reported:	09/21/2020	Sampling Type:	Soil
Project Name:	MONUMENT CTB	Sampling Condition:	Cool & Intact
Project Number:	NONE GIVEN	Sample Received By:	Tamara Oldaker
Project Location:	NONE GIVEN		

Sample ID: B 5 (H002448-05)

BTEX 8021B		mg/kg		Analyzed By: MS					
Analyte	Result	Reporting Limit	Analyzed	Method Blank	BS	% Recovery	True Value QC	RPD	Qualifier
Benzene*	<0.050	0.050	09/16/2020	ND	1.99	99.5	2.00	4.86	
Toluene*	<0.050	0.050	09/16/2020	ND	2.00	100	2.00	5.27	
Ethylbenzene*	<0.050	0.050	09/16/2020	ND	1.97	98.7	2.00	5.60	
Total Xylenes*	<0.150	0.150	09/16/2020	ND	5.68	94.6	6.00	5.62	
Total BTEX	<0.300	0.300	09/16/2020	ND					

Surrogate: 4-Bromofluorobenzene (PID) 98.7 % 73.3-129

Chloride, SM4500CI-B		mg/kg		Analyzed By: GM						
Analyte	Result	Reporting Limit	Analyzed	Method Blank	BS	% Recovery	True Value QC	RPD	Qualifier	
Chloride	208	16.0	09/16/2020	ND	400	100	400	0.00		

TPH 8015M		mg/kg		Analyzed By: MS					
Analyte	Result	Reporting Limit	Analyzed	Method Blank	BS	% Recovery	True Value QC	RPD	Qualifier
GRO C6-C10*	<10.0	10.0	09/16/2020	ND	180	90.2	200	1.55	
DRO >C10-C28*	<10.0	10.0	09/16/2020	ND	177	88.7	200	1.18	
EXT DRO >C28-C36	<10.0	10.0	09/16/2020	ND					

Surrogate: 1-Chlorooctane 106 % 44.3-144

Surrogate: 1-Chlorooctadecane 121 % 42.2-156

Cardinal Laboratories

*=Accredited Analyte

PLEASE NOTE: Liability and Damages. Cardinal's liability and client's exclusive remedy for any claim arising, whether based in contract or tort, shall be limited to the amount paid by client for analyses. All claims, including those for negligence and any other cause whatsoever shall be deemed waived unless made in writing and received by Cardinal within thirty (30) days after completion of the applicable service. In no event shall Cardinal be liable for incidental or consequential damages, including, without limitation, business interruptions, loss of use, or loss of profits incurred by client, its subsidiaries, affiliates or successors arising out of or related to the performance of the services hereunder by Cardinal, regardless of whether such claim is based upon any of the above stated reasons or otherwise. Results relate only to the samples identified above. This report shall not be reproduced except in full with written approval of Cardinal Laboratories.

Celey D. Keene, Lab Director/Quality Manager



PHONE (575) 393-2326 • 101 E. MARLAND • HOBBS, NM 88240

Analytical Results For:

APACHE CORP - HOBBS
 BRUCE BAKER
 2350 W. MARLAND BLVD.
 HOBBS NM, 88240
 Fax To: (575) 393-2432

Received:	09/15/2020	Sampling Date:	09/15/2020
Reported:	09/21/2020	Sampling Type:	Soil
Project Name:	MONUMENT CTB	Sampling Condition:	Cool & Intact
Project Number:	NONE GIVEN	Sample Received By:	Tamara Oldaker
Project Location:	NONE GIVEN		

Sample ID: B 6 (H002448-06)

BTEX 8021B		mg/kg		Analyzed By: MS					
Analyte	Result	Reporting Limit	Analyzed	Method Blank	BS	% Recovery	True Value QC	RPD	Qualifier
Benzene*	<0.050	0.050	09/16/2020	ND	1.99	99.5	2.00	4.86	
Toluene*	<0.050	0.050	09/16/2020	ND	2.00	100	2.00	5.27	
Ethylbenzene*	<0.050	0.050	09/16/2020	ND	1.97	98.7	2.00	5.60	
Total Xylenes*	<0.150	0.150	09/16/2020	ND	5.68	94.6	6.00	5.62	
Total BTEX	<0.300	0.300	09/16/2020	ND					

Surrogate: 4-Bromofluorobenzene (PID) 98.9 % 73.3-129

Chloride, SM4500CI-B		mg/kg		Analyzed By: GM					
Analyte	Result	Reporting Limit	Analyzed	Method Blank	BS	% Recovery	True Value QC	RPD	Qualifier
Chloride	96.0	16.0	09/16/2020	ND	400	100	400	0.00	

TPH 8015M		mg/kg		Analyzed By: MS					
Analyte	Result	Reporting Limit	Analyzed	Method Blank	BS	% Recovery	True Value QC	RPD	Qualifier
GRO C6-C10*	<10.0	10.0	09/16/2020	ND	180	90.2	200	1.55	
DRO >C10-C28*	<10.0	10.0	09/16/2020	ND	177	88.7	200	1.18	
EXT DRO >C28-C36	<10.0	10.0	09/16/2020	ND					

Surrogate: 1-Chlorooctane 96.6 % 44.3-144

Surrogate: 1-Chlorooctadecane 110 % 42.2-156

Cardinal Laboratories

*=Accredited Analyte

PLEASE NOTE: Liability and Damages. Cardinal's liability and client's exclusive remedy for any claim arising, whether based in contract or tort, shall be limited to the amount paid by client for analyses. All claims, including those for negligence and any other cause whatsoever shall be deemed waived unless made in writing and received by Cardinal within thirty (30) days after completion of the applicable service. In no event shall Cardinal be liable for incidental or consequential damages, including, without limitation, business interruptions, loss of use, or loss of profits incurred by client, its subsidiaries, affiliates or successors arising out of or related to the performance of the services hereunder by Cardinal, regardless of whether such claim is based upon any of the above stated reasons or otherwise. Results relate only to the samples identified above. This report shall not be reproduced except in full with written approval of Cardinal Laboratories.

Celey D. Keene, Lab Director/Quality Manager



PHONE (575) 393-2326 ° 101 E. MARLAND ° HOBBS, NM 88240

Analytical Results For:

APACHE CORP - HOBBS
 BRUCE BAKER
 2350 W. MARLAND BLVD.
 HOBBS NM, 88240
 Fax To: (575) 393-2432

Received:	09/15/2020	Sampling Date:	09/15/2020
Reported:	09/21/2020	Sampling Type:	Soil
Project Name:	MONUMENT CTB	Sampling Condition:	Cool & Intact
Project Number:	NONE GIVEN	Sample Received By:	Tamara Oldaker
Project Location:	NONE GIVEN		

Sample ID: B 7 (H002448-07)

BTX 8021B		mg/kg		Analyzed By: MS					
Analyte	Result	Reporting Limit	Analyzed	Method Blank	BS	% Recovery	True Value QC	RPD	Qualifier
Benzene*	<0.050	0.050	09/16/2020	ND	1.99	99.5	2.00	4.86	
Toluene*	<0.050	0.050	09/16/2020	ND	2.00	100	2.00	5.27	
Ethylbenzene*	<0.050	0.050	09/16/2020	ND	1.97	98.7	2.00	5.60	
Total Xylenes*	<0.150	0.150	09/16/2020	ND	5.68	94.6	6.00	5.62	
Total BTX	<0.300	0.300	09/16/2020	ND					

Surrogate: 4-Bromofluorobenzene (PID) 99.3 % 73.3-129

Chloride, SM4500CI-B		mg/kg		Analyzed By: GM						
Analyte	Result	Reporting Limit	Analyzed	Method Blank	BS	% Recovery	True Value QC	RPD	Qualifier	
Chloride	48.0	16.0	09/16/2020	ND	400	100	400	0.00		

TPH 8015M		mg/kg		Analyzed By: MS					
Analyte	Result	Reporting Limit	Analyzed	Method Blank	BS	% Recovery	True Value QC	RPD	Qualifier
GRO C6-C10*	<10.0	10.0	09/16/2020	ND	180	90.2	200	1.55	
DRO >C10-C28*	<10.0	10.0	09/16/2020	ND	177	88.7	200	1.18	
EXT DRO >C28-C36	<10.0	10.0	09/16/2020	ND					

Surrogate: 1-Chlorooctane 104 % 44.3-144

Surrogate: 1-Chlorooctadecane 116 % 42.2-156

Cardinal Laboratories

*=Accredited Analyte

PLEASE NOTE: Liability and Damages. Cardinal's liability and client's exclusive remedy for any claim arising, whether based in contract or tort, shall be limited to the amount paid by client for analyses. All claims, including those for negligence and any other cause whatsoever shall be deemed waived unless made in writing and received by Cardinal within thirty (30) days after completion of the applicable service. In no event shall Cardinal be liable for incidental or consequential damages, including, without limitation, business interruptions, loss of use, or loss of profits incurred by client, its subsidiaries, affiliates or successors arising out of or related to the performance of the services hereunder by Cardinal, regardless of whether such claim is based upon any of the above stated reasons or otherwise. Results relate only to the samples identified above. This report shall not be reproduced except in full with written approval of Cardinal Laboratories.

Celey D. Keene, Lab Director/Quality Manager



PHONE (575) 393-2326 • 101 E. MARLAND • HOBBS, NM 88240

Analytical Results For:

APACHE CORP - HOBBS
 BRUCE BAKER
 2350 W. MARLAND BLVD.
 HOBBS NM, 88240
 Fax To: (575) 393-2432

Received:	09/15/2020	Sampling Date:	09/15/2020
Reported:	09/21/2020	Sampling Type:	Soil
Project Name:	MONUMENT CTB	Sampling Condition:	Cool & Intact
Project Number:	NONE GIVEN	Sample Received By:	Tamara Oldaker
Project Location:	NONE GIVEN		

Sample ID: B 8 (H002448-08)

BTX 8021B		mg/kg		Analyzed By: MS					
Analyte	Result	Reporting Limit	Analyzed	Method Blank	BS	% Recovery	True Value QC	RPD	Qualifier
Benzene*	<0.050	0.050	09/16/2020	ND	1.99	99.5	2.00	4.86	
Toluene*	<0.050	0.050	09/16/2020	ND	2.00	100	2.00	5.27	
Ethylbenzene*	<0.050	0.050	09/16/2020	ND	1.97	98.7	2.00	5.60	
Total Xylenes*	<0.150	0.150	09/16/2020	ND	5.68	94.6	6.00	5.62	
Total BTX	<0.300	0.300	09/16/2020	ND					

Surrogate: 4-Bromofluorobenzene (PID) 99.2 % 73.3-129

Chloride, SM4500Cl-B		mg/kg		Analyzed By: GM					
Analyte	Result	Reporting Limit	Analyzed	Method Blank	BS	% Recovery	True Value QC	RPD	Qualifier
Chloride	256	16.0	09/16/2020	ND	400	100	400	0.00	

TPH 8015M		mg/kg		Analyzed By: MS					
Analyte	Result	Reporting Limit	Analyzed	Method Blank	BS	% Recovery	True Value QC	RPD	Qualifier
GRO C6-C10*	<10.0	10.0	09/16/2020	ND	180	90.2	200	1.55	
DRO >C10-C28*	<10.0	10.0	09/16/2020	ND	177	88.7	200	1.18	
EXT DRO >C28-C36	<10.0	10.0	09/16/2020	ND					

Surrogate: 1-Chlorooctane 105 % 44.3-144

Surrogate: 1-Chlorooctadecane 118 % 42.2-156

Cardinal Laboratories

*=Accredited Analyte

PLEASE NOTE: Liability and Damages. Cardinal's liability and client's exclusive remedy for any claim arising, whether based in contract or tort, shall be limited to the amount paid by client for analyses. All claims, including those for negligence and any other cause whatsoever shall be deemed waived unless made in writing and received by Cardinal within thirty (30) days after completion of the applicable service. In no event shall Cardinal be liable for incidental or consequential damages, including, without limitation, business interruptions, loss of use, or loss of profits incurred by client, its subsidiaries, affiliates or successors arising out of or related to the performance of the services hereunder by Cardinal, regardless of whether such claim is based upon any of the above stated reasons or otherwise. Results relate only to the samples identified above. This report shall not be reproduced except in full with written approval of Cardinal Laboratories.

Celey D. Keene, Lab Director/Quality Manager



PHONE (575) 393-2326 ° 101 E. MARLAND ° HOBBS, NM 88240

Analytical Results For:

APACHE CORP - HOBBS
 BRUCE BAKER
 2350 W. MARLAND BLVD.
 HOBBS NM, 88240
 Fax To: (575) 393-2432

Received:	09/15/2020	Sampling Date:	09/15/2020
Reported:	09/21/2020	Sampling Type:	Soil
Project Name:	MONUMENT CTB	Sampling Condition:	Cool & Intact
Project Number:	NONE GIVEN	Sample Received By:	Tamara Oldaker
Project Location:	NONE GIVEN		

Sample ID: B 9 (H002448-09)

BTEX 8021B		mg/kg		Analyzed By: MS						
Analyte	Result	Reporting Limit	Analyzed	Method Blank	BS	% Recovery	True Value QC	RPD	Qualifier	
Benzene*	<0.050	0.050	09/16/2020	ND	1.99	99.5	2.00	4.86		
Toluene*	<0.050	0.050	09/16/2020	ND	2.00	100	2.00	5.27		
Ethylbenzene*	<0.050	0.050	09/16/2020	ND	1.97	98.7	2.00	5.60		
Total Xylenes*	<0.150	0.150	09/16/2020	ND	5.68	94.6	6.00	5.62		
Total BTEX	<0.300	0.300	09/16/2020	ND						

Surrogate: 4-Bromofluorobenzene (PID) 99.3 % 73.3-129

Chloride, SM4500Cl-B		mg/kg		Analyzed By: GM					
Analyte	Result	Reporting Limit	Analyzed	Method Blank	BS	% Recovery	True Value QC	RPD	Qualifier
Chloride	288	16.0	09/16/2020	ND	400	100	400	0.00	

TPH 8015M		mg/kg		Analyzed By: MS					
Analyte	Result	Reporting Limit	Analyzed	Method Blank	BS	% Recovery	True Value QC	RPD	Qualifier
GRO C6-C10*	<10.0	10.0	09/16/2020	ND	180	90.2	200	1.55	
DRO >C10-C28*	<10.0	10.0	09/16/2020	ND	177	88.7	200	1.18	
EXT DRO >C28-C36	<10.0	10.0	09/16/2020	ND					

Surrogate: 1-Chlorooctane 106 % 44.3-144

Surrogate: 1-Chlorooctadecane 120 % 42.2-156

Cardinal Laboratories

*=Accredited Analyte

PLEASE NOTE: Liability and Damages. Cardinal's liability and client's exclusive remedy for any claim arising, whether based in contract or tort, shall be limited to the amount paid by client for analyses. All claims, including those for negligence and any other cause whatsoever shall be deemed waived unless made in writing and received by Cardinal within thirty (30) days after completion of the applicable service. In no event shall Cardinal be liable for incidental or consequential damages, including, without limitation, business interruptions, loss of use, or loss of profits incurred by client, its subsidiaries, affiliates or successors arising out of or related to the performance of the services hereunder by Cardinal, regardless of whether such claim is based upon any of the above stated reasons or otherwise. Results relate only to the samples identified above. This report shall not be reproduced except in full with written approval of Cardinal Laboratories.

Celey D. Keene, Lab Director/Quality Manager



PHONE (575) 393-2326 • 101 E. MARLAND • HOBBS, NM 88240

Analytical Results For:

APACHE CORP - HOBBS
 BRUCE BAKER
 2350 W. MARLAND BLVD.
 HOBBS NM, 88240
 Fax To: (575) 393-2432

Received:	09/15/2020	Sampling Date:	09/15/2020
Reported:	09/21/2020	Sampling Type:	Soil
Project Name:	MONUMENT CTB	Sampling Condition:	Cool & Intact
Project Number:	NONE GIVEN	Sample Received By:	Tamara Oldaker
Project Location:	NONE GIVEN		

Sample ID: B 10 (H002448-10)

BTX 8021B		mg/kg		Analyzed By: MS					
Analyte	Result	Reporting Limit	Analyzed	Method Blank	BS	% Recovery	True Value QC	RPD	Qualifier
Benzene*	<0.050	0.050	09/16/2020	ND	1.99	99.5	2.00	4.86	
Toluene*	<0.050	0.050	09/16/2020	ND	2.00	100	2.00	5.27	
Ethylbenzene*	<0.050	0.050	09/16/2020	ND	1.97	98.7	2.00	5.60	
Total Xylenes*	<0.150	0.150	09/16/2020	ND	5.68	94.6	6.00	5.62	
Total BTX	<0.300	0.300	09/16/2020	ND					

Surrogate: 4-Bromofluorobenzene (PID) 99.3 % 73.3-129

Chloride, SM4500CI-B		mg/kg		Analyzed By: GM					
Analyte	Result	Reporting Limit	Analyzed	Method Blank	BS	% Recovery	True Value QC	RPD	Qualifier
Chloride	128	16.0	09/16/2020	ND	400	100	400	0.00	

TPH 8015M		mg/kg		Analyzed By: MS					
Analyte	Result	Reporting Limit	Analyzed	Method Blank	BS	% Recovery	True Value QC	RPD	Qualifier
GRO C6-C10*	<10.0	10.0	09/16/2020	ND	180	90.2	200	1.55	
DRO >C10-C28*	<10.0	10.0	09/16/2020	ND	177	88.7	200	1.18	
EXT DRO >C28-C36	<10.0	10.0	09/16/2020	ND					

Surrogate: 1-Chlorooctane 104 % 44.3-144

Surrogate: 1-Chlorooctadecane 119 % 42.2-156

Cardinal Laboratories

*=Accredited Analyte

PLEASE NOTE: Liability and Damages. Cardinal's liability and client's exclusive remedy for any claim arising, whether based in contract or tort, shall be limited to the amount paid by client for analyses. All claims, including those for negligence and any other cause whatsoever shall be deemed waived unless made in writing and received by Cardinal within thirty (30) days after completion of the applicable service. In no event shall Cardinal be liable for incidental or consequential damages, including, without limitation, business interruptions, loss of use, or loss of profits incurred by client, its subsidiaries, affiliates or successors arising out of or related to the performance of the services hereunder by Cardinal, regardless of whether such claim is based upon any of the above stated reasons or otherwise. Results relate only to the samples identified above. This report shall not be reproduced except in full with written approval of Cardinal Laboratories.

Celey D. Keene, Lab Director/Quality Manager



PHONE (575) 393-2326 • 101 E. MARLAND • HOBBS, NM 88240

Analytical Results For:

APACHE CORP - HOBBS
 BRUCE BAKER
 2350 W. MARLAND BLVD.
 HOBBS NM, 88240
 Fax To: (575) 393-2432

Received:	09/15/2020	Sampling Date:	09/15/2020
Reported:	09/21/2020	Sampling Type:	Soil
Project Name:	MONUMENT CTB	Sampling Condition:	Cool & Intact
Project Number:	NONE GIVEN	Sample Received By:	Tamara Oldaker
Project Location:	NONE GIVEN		

Sample ID: B 11 (H002448-11)

BTX 8021B		mg/kg		Analyzed By: MS					
Analyte	Result	Reporting Limit	Analyzed	Method Blank	BS	% Recovery	True Value QC	RPD	Qualifier
Benzene*	<0.050	0.050	09/16/2020	ND	1.99	99.5	2.00	4.86	
Toluene*	<0.050	0.050	09/16/2020	ND	2.00	100	2.00	5.27	
Ethylbenzene*	<0.050	0.050	09/16/2020	ND	1.97	98.7	2.00	5.60	
Total Xylenes*	<0.150	0.150	09/16/2020	ND	5.68	94.6	6.00	5.62	
Total BTX	<0.300	0.300	09/16/2020	ND					

Surrogate: 4-Bromofluorobenzene (PID) 100 % 73.3-129

Chloride, SM4500Cl-B		mg/kg		Analyzed By: GM					
Analyte	Result	Reporting Limit	Analyzed	Method Blank	BS	% Recovery	True Value QC	RPD	Qualifier
Chloride	16.0	16.0	09/16/2020	ND	400	100	400	0.00	

TPH 8015M		mg/kg		Analyzed By: MS					
Analyte	Result	Reporting Limit	Analyzed	Method Blank	BS	% Recovery	True Value QC	RPD	Qualifier
GRO C6-C10*	<10.0	10.0	09/16/2020	ND	180	90.2	200	1.55	
DRO >C10-C28*	<10.0	10.0	09/16/2020	ND	177	88.7	200	1.18	
EXT DRO >C28-C36	<10.0	10.0	09/16/2020	ND					

Surrogate: 1-Chlorooctane 108 % 44.3-144

Surrogate: 1-Chlorooctadecane 124 % 42.2-156

Cardinal Laboratories

*=Accredited Analyte

PLEASE NOTE: Liability and Damages. Cardinal's liability and client's exclusive remedy for any claim arising, whether based in contract or tort, shall be limited to the amount paid by client for analyses. All claims, including those for negligence and any other cause whatsoever shall be deemed waived unless made in writing and received by Cardinal within thirty (30) days after completion of the applicable service. In no event shall Cardinal be liable for incidental or consequential damages, including, without limitation, business interruptions, loss of use, or loss of profits incurred by client, its subsidiaries, affiliates or successors arising out of or related to the performance of the services hereunder by Cardinal, regardless of whether such claim is based upon any of the above stated reasons or otherwise. Results relate only to the samples identified above. This report shall not be reproduced except in full with written approval of Cardinal Laboratories.

Celey D. Keene, Lab Director/Quality Manager



PHONE (575) 393-2326 • 101 E. MARLAND • HOBBS, NM 88240

Analytical Results For:

APACHE CORP - HOBBS
 BRUCE BAKER
 2350 W. MARLAND BLVD.
 HOBBS NM, 88240
 Fax To: (575) 393-2432

Received:	09/15/2020	Sampling Date:	09/15/2020
Reported:	09/21/2020	Sampling Type:	Soil
Project Name:	MONUMENT CTB	Sampling Condition:	Cool & Intact
Project Number:	NONE GIVEN	Sample Received By:	Tamara Oldaker
Project Location:	NONE GIVEN		

Sample ID: B 12 (H002448-12)

BTX 8021B		mg/kg		Analyzed By: MS					
Analyte	Result	Reporting Limit	Analyzed	Method Blank	BS	% Recovery	True Value QC	RPD	Qualifier
Benzene*	<0.050	0.050	09/16/2020	ND	1.99	99.5	2.00	4.86	
Toluene*	<0.050	0.050	09/16/2020	ND	2.00	100	2.00	5.27	
Ethylbenzene*	<0.050	0.050	09/16/2020	ND	1.97	98.7	2.00	5.60	
Total Xylenes*	<0.150	0.150	09/16/2020	ND	5.68	94.6	6.00	5.62	
Total BTX	<0.300	0.300	09/16/2020	ND					

Surrogate: 4-Bromofluorobenzene (PID) 99.2 % 73.3-129

Chloride, SM4500Cl-B		mg/kg		Analyzed By: GM						
Analyte	Result	Reporting Limit	Analyzed	Method Blank	BS	% Recovery	True Value QC	RPD	Qualifier	
Chloride	<16.0	16.0	09/16/2020	ND	400	100	400	0.00		

TPH 8015M		mg/kg		Analyzed By: MS					
Analyte	Result	Reporting Limit	Analyzed	Method Blank	BS	% Recovery	True Value QC	RPD	Qualifier
GRO C6-C10*	<10.0	10.0	09/16/2020	ND	180	90.2	200	1.55	
DRO >C10-C28*	<10.0	10.0	09/16/2020	ND	177	88.7	200	1.18	
EXT DRO >C28-C36	<10.0	10.0	09/16/2020	ND					

Surrogate: 1-Chlorooctane 104 % 44.3-144

Surrogate: 1-Chlorooctadecane 121 % 42.2-156

Cardinal Laboratories

*=Accredited Analyte

PLEASE NOTE: Liability and Damages. Cardinal's liability and client's exclusive remedy for any claim arising, whether based in contract or tort, shall be limited to the amount paid by client for analyses. All claims, including those for negligence and any other cause whatsoever shall be deemed waived unless made in writing and received by Cardinal within thirty (30) days after completion of the applicable service. In no event shall Cardinal be liable for incidental or consequential damages, including, without limitation, business interruptions, loss of use, or loss of profits incurred by client, its subsidiaries, affiliates or successors arising out of or related to the performance of the services hereunder by Cardinal, regardless of whether such claim is based upon any of the above stated reasons or otherwise. Results relate only to the samples identified above. This report shall not be reproduced except in full with written approval of Cardinal Laboratories.

Celey D. Keene, Lab Director/Quality Manager



PHONE (575) 393-2326 • 101 E. MARLAND • HOBBS, NM 88240

Analytical Results For:

APACHE CORP - HOBBS
 BRUCE BAKER
 2350 W. MARLAND BLVD.
 HOBBS NM, 88240
 Fax To: (575) 393-2432

Received:	09/15/2020	Sampling Date:	09/15/2020
Reported:	09/21/2020	Sampling Type:	Soil
Project Name:	MONUMENT CTB	Sampling Condition:	Cool & Intact
Project Number:	NONE GIVEN	Sample Received By:	Tamara Oldaker
Project Location:	NONE GIVEN		

Sample ID: B 13 (H002448-13)

BTX 8021B		mg/kg		Analyzed By: MS					
Analyte	Result	Reporting Limit	Analyzed	Method Blank	BS	% Recovery	True Value QC	RPD	Qualifier
Benzene*	<0.050	0.050	09/16/2020	ND	1.99	99.5	2.00	4.86	
Toluene*	<0.050	0.050	09/16/2020	ND	2.00	100	2.00	5.27	
Ethylbenzene*	<0.050	0.050	09/16/2020	ND	1.97	98.7	2.00	5.60	
Total Xylenes*	<0.150	0.150	09/16/2020	ND	5.68	94.6	6.00	5.62	
Total BTX	<0.300	0.300	09/16/2020	ND					

Surrogate: 4-Bromofluorobenzene (PID) 97.2 % 73.3-129

Chloride, SM4500CI-B		mg/kg		Analyzed By: GM					
Analyte	Result	Reporting Limit	Analyzed	Method Blank	BS	% Recovery	True Value QC	RPD	Qualifier
Chloride	16.0	16.0	09/16/2020	ND	400	100	400	0.00	

TPH 8015M		mg/kg		Analyzed By: MS					
Analyte	Result	Reporting Limit	Analyzed	Method Blank	BS	% Recovery	True Value QC	RPD	Qualifier
GRO C6-C10*	<10.0	10.0	09/16/2020	ND	180	90.2	200	1.55	
DRO >C10-C28*	<10.0	10.0	09/16/2020	ND	177	88.7	200	1.18	
EXT DRO >C28-C36	<10.0	10.0	09/16/2020	ND					

Surrogate: 1-Chlorooctane 113 % 44.3-144

Surrogate: 1-Chlorooctadecane 129 % 42.2-156

Cardinal Laboratories

*=Accredited Analyte

PLEASE NOTE: Liability and Damages. Cardinal's liability and client's exclusive remedy for any claim arising, whether based in contract or tort, shall be limited to the amount paid by client for analyses. All claims, including those for negligence and any other cause whatsoever shall be deemed waived unless made in writing and received by Cardinal within thirty (30) days after completion of the applicable service. In no event shall Cardinal be liable for incidental or consequential damages, including, without limitation, business interruptions, loss of use, or loss of profits incurred by client, its subsidiaries, affiliates or successors arising out of or related to the performance of the services hereunder by Cardinal, regardless of whether such claim is based upon any of the above stated reasons or otherwise. Results relate only to the samples identified above. This report shall not be reproduced except in full with written approval of Cardinal Laboratories.

Celey D. Keene, Lab Director/Quality Manager



PHONE (575) 393-2326 • 101 E. MARLAND • HOBBS, NM 88240

Notes and Definitions

ND	Analyte NOT DETECTED at or above the reporting limit
RPD	Relative Percent Difference
**	Samples not received at proper temperature of 6°C or below.
***	Insufficient time to reach temperature.
-	Chloride by SM4500Cl-B does not require samples be received at or below 6°C Samples reported on an as received basis (wet) unless otherwise noted on report

Cardinal Laboratories

*=Accredited Analyte

PLEASE NOTE: Liability and Damages. Cardinal's liability and client's exclusive remedy for any claim arising, whether based in contract or tort, shall be limited to the amount paid by client for analyses. All claims, including those for negligence and any other cause whatsoever shall be deemed waived unless made in writing and received by Cardinal within thirty (30) days after completion of the applicable service. In no event shall Cardinal be liable for incidental or consequential damages, including, without limitation, business interruptions, loss of use, or loss of profits incurred by client, its subsidiaries, affiliates or successors arising out of or related to the performance of the services hereunder by Cardinal, regardless of whether such claim is based upon any of the above stated reasons or otherwise. Results relate only to the samples identified above. This report shall not be reproduced except in full with written approval of Cardinal Laboratories.

A handwritten signature in black ink, appearing to read "Celey D. Keene".

Celey D. Keene, Lab Director/Quality Manager



101 East Marland, Hobbs, NM 88240
(575) 393-2326 FAX (575) 393-2476

CHAIN-OF-CUSTODY AND ANALYSIS REQUEST

[illegible]

CHAIN-OF-CUSTODY AND ANALYSIS REQUEST

[illegible]

† Cardinal cannot accept verbal changes. Please email changes to celeve.keene@cardinallabsnm.com

PHONE (575) 393-2326 ° 101 E. MARLAND ° HOBBS, NM 88240

September 24, 2020

BRUCE BAKER

APACHE CORP - HOBBS

2350 W. MARLAND BLVD.

HOBBS, NM 88240

RE: MONUMENT CTB

Enclosed are the results of analyses for samples received by the laboratory on 09/16/20 14:02.

Cardinal Laboratories is accredited through Texas NELAP under certificate number T104704398-20-13. Accreditation applies to drinking water, non-potable water and solid and chemical materials. All accredited analytes are denoted by an asterisk (*). For a complete list of accredited analytes and matrices visit the TCEQ website at

www.tceq.texas.gov/field/ga/lab_accred_certif.html.

Cardinal Laboratories is accredited through the State of Colorado Department of Public Health and Environment for:

Method EPA 552.2	Total Haloacetic Acids (HAA-5)
Method EPA 524.2	Total Trihalomethanes (TTHM)
Method EPA 524.4	Regulated VOCs (V1, V2, V3)

Cardinal Laboratories is accredited through the State of New Mexico Environment Department for:

Method SM 9223-B	Total Coliform and E. coli (Colilert MMO-MUG)
Method EPA 524.2	Regulated VOCs and Total Trihalomethanes (TTHM)
Method EPA 552.2	Total Haloacetic Acids (HAA-5)

Accreditation applies to public drinking water matrices for State of Colorado and New Mexico.

This report meets NELAP requirements and is made up of a cover page, analytical results, and a copy of the original chain-of-custody. If you have any questions concerning this report, please feel free to contact me.

Sincerely,

Celey D. Keene

Lab Director/Quality Manager



PHONE (575) 393-2326 • 101 E. MARLAND • HOBBS, NM 88240

Analytical Results For:

APACHE CORP - HOBBS
2350 W. MARLAND BLVD.
HOBBS NM, 88240

Project: MONUMENT CTB
Project Number: NONE GIVEN
Project Manager: BRUCE BAKER
Fax To: (575) 393-2432

Reported:
24-Sep-20 11:45

Sample ID	Laboratory ID	Matrix	Date Sampled	Date Received
W 1	H002465-01	Soil	16-Sep-20 11:08	16-Sep-20 14:02
W 2	H002465-02	Soil	16-Sep-20 11:10	16-Sep-20 14:02
W 3	H002465-03	Soil	16-Sep-20 11:12	16-Sep-20 14:02
W 4	H002465-04	Soil	16-Sep-20 11:14	16-Sep-20 14:02
W 5	H002465-05	Soil	16-Sep-20 12:03	16-Sep-20 14:02
W 6	H002465-06	Soil	16-Sep-20 12:05	16-Sep-20 14:02
W 7	H002465-07	Soil	16-Sep-20 12:07	16-Sep-20 14:02
B 14	H002465-08	Soil	16-Sep-20 11:38	16-Sep-20 14:02

09/24/20 - Client requested a rerun of the chloride on sample -07. Replaced previous result with the new one because there was an analyst error on the first run. This is the revised report and will replace the one sent on 09/22/20.

Cardinal Laboratories

*=Accredited Analyte

PLEASE NOTE: Liability and Damages. Cardinal's liability and client's exclusive remedy for any claim arising, whether based in contract or tort, shall be limited to the amount paid by client for analyses. All claims, including those for negligence or any other cause whatsoever shall be deemed waived unless made in writing and received by Cardinal within thirty (30) days after completion of the applicable service. In no event shall Cardinal be liable for incidental or consequential damage including, without limitation, business interruptions, loss of use, or loss of profits incurred by client, its subsidiaries, affiliates or successors arising out of or related to the performance of the services hereunder by Cardinal, regardless of whether such claim is based upon any of the above stated reasons or otherwise. Results relate only to the samples identified above. This report shall not be reproduced except in full with written approval of Cardinal Laboratories.

Celey D. Keene, Lab Director/Quality Manager



PHONE (575) 393-2326 • 101 E. MARLAND • HOBBS, NM 88240

Analytical Results For:

APACHE CORP - HOBBS
2350 W. MARLAND BLVD.
HOBBS NM, 88240

Project: MONUMENT CTB
Project Number: NONE GIVEN
Project Manager: BRUCE BAKER
Fax To: (575) 393-2432

Reported:
24-Sep-20 11:45

W 1**H002465-01 (Soil)**

Analyte	Result	MDL	Reporting Limit	Units	Dilution	Batch	Analyst	Analyzed	Method	Notes
---------	--------	-----	-----------------	-------	----------	-------	---------	----------	--------	-------

Cardinal Laboratories**Inorganic Compounds**

Chloride	224		16.0	mg/kg	4	0091702	GM	17-Sep-20	4500-Cl-B	
-----------------	------------	--	------	-------	---	---------	----	-----------	-----------	--

Volatile Organic Compounds by EPA Method 8021

Benzene*	<0.050	0.050	mg/kg	50	0091617	MS	17-Sep-20	8021B	
Toluene*	<0.050	0.050	mg/kg	50	0091617	MS	17-Sep-20	8021B	
Ethylbenzene*	<0.050	0.050	mg/kg	50	0091617	MS	17-Sep-20	8021B	
Total Xylenes*	<0.150	0.150	mg/kg	50	0091617	MS	17-Sep-20	8021B	
Total BTEX	<0.300	0.300	mg/kg	50	0091617	MS	17-Sep-20	8021B	

Surrogate: 4-Bromofluorobenzene (PID)	99.8 %	73.3-129	0091617	MS	17-Sep-20	8021B	
---------------------------------------	--------	----------	---------	----	-----------	-------	--

Petroleum Hydrocarbons by GC FID

GRO C6-C10*	<10.0	10.0	mg/kg	1	0091616	MS	22-Sep-20	8015B	
DRO >C10-C28*	<10.0	10.0	mg/kg	1	0091616	MS	22-Sep-20	8015B	
EXT DRO >C28-C36	<10.0	10.0	mg/kg	1	0091616	MS	22-Sep-20	8015B	

Surrogate: 1-Chlorooctane	113 %	44.3-144	0091616	MS	22-Sep-20	8015B	
---------------------------	-------	----------	---------	----	-----------	-------	--

Surrogate: 1-Chlorooctadecane	124 %	42.2-156	0091616	MS	22-Sep-20	8015B	
-------------------------------	-------	----------	---------	----	-----------	-------	--

Cardinal Laboratories

*=Accredited Analyte

PLEASE NOTE: Liability and Damages. Cardinal's liability and client's exclusive remedy for any claim arising, whether based in contract or tort, shall be limited to the amount paid by client for analyses. All claims, including those for negligence or any other cause whatsoever shall be deemed waived unless made in writing and received by Cardinal within thirty (30) days after completion of the applicable service. In no event shall Cardinal be liable for incidental or consequential damage including, without limitation, business interruptions, loss of use, or loss of profits incurred by client, its subsidiaries, affiliates or successors arising out of or related to the performance of the services hereunder by Cardinal, regardless of whether such claim is based upon any of the above stated reasons or otherwise. Results relate only to the samples identified above. This report shall not be reproduced except in full with written approval of Cardinal Laboratories.

Celey D. Keene, Lab Director/Quality Manager



PHONE (575) 393-2326 • 101 E. MARLAND • HOBBS, NM 88240

Analytical Results For:

APACHE CORP - HOBBS
2350 W. MARLAND BLVD.
HOBBS NM, 88240

Project: MONUMENT CTB
Project Number: NONE GIVEN
Project Manager: BRUCE BAKER
Fax To: (575) 393-2432

Reported:
24-Sep-20 11:45

W 2**H002465-02 (Soil)**

Analyte	Result	MDL	Reporting Limit	Units	Dilution	Batch	Analyst	Analyzed	Method	Notes
---------	--------	-----	-----------------	-------	----------	-------	---------	----------	--------	-------

Cardinal Laboratories**Inorganic Compounds**

Chloride	208		16.0	mg/kg	4	0091702	GM	17-Sep-20	4500-Cl-B	
-----------------	------------	--	------	-------	---	---------	----	-----------	-----------	--

Volatile Organic Compounds by EPA Method 8021

Benzene*	<0.050		0.050	mg/kg	50	0091617	MS	17-Sep-20	8021B	
Toluene*	<0.050		0.050	mg/kg	50	0091617	MS	17-Sep-20	8021B	
Ethylbenzene*	<0.050		0.050	mg/kg	50	0091617	MS	17-Sep-20	8021B	
Total Xylenes*	<0.150		0.150	mg/kg	50	0091617	MS	17-Sep-20	8021B	
Total BTEX	<0.300		0.300	mg/kg	50	0091617	MS	17-Sep-20	8021B	

Surrogate: 4-Bromofluorobenzene (PID)			100 %	73.3-129		0091617	MS	17-Sep-20	8021B	
---------------------------------------	--	--	-------	----------	--	---------	----	-----------	-------	--

Petroleum Hydrocarbons by GC FID

GRO C6-C10*	<10.0		10.0	mg/kg	1	0091616	MS	17-Sep-20	8015B	
DRO >C10-C28*	<10.0		10.0	mg/kg	1	0091616	MS	17-Sep-20	8015B	
EXT DRO >C28-C36	10.2		10.0	mg/kg	1	0091616	MS	17-Sep-20	8015B	

Surrogate: 1-Chlorooctane			103 %	44.3-144		0091616	MS	17-Sep-20	8015B	
---------------------------	--	--	-------	----------	--	---------	----	-----------	-------	--

Surrogate: 1-Chlorooctadecane			117 %	42.2-156		0091616	MS	17-Sep-20	8015B	
-------------------------------	--	--	-------	----------	--	---------	----	-----------	-------	--

Cardinal Laboratories

*=Accredited Analyte

PLEASE NOTE: Liability and Damages. Cardinal's liability and client's exclusive remedy for any claim arising, whether based in contract or tort, shall be limited to the amount paid by client for analyses. All claims, including those for negligence or any other cause whatsoever shall be deemed waived unless made in writing and received by Cardinal within thirty (30) days after completion of the applicable service. In no event shall Cardinal be liable for incidental or consequential damage including, without limitation, business interruptions, loss of use, or loss of profits incurred by client, its subsidiaries, affiliates or successors arising out of or related to the performance of the services hereunder by Cardinal, regardless of whether such claim is based upon any of the above stated reasons or otherwise. Results relate only to the samples identified above. This report shall not be reproduced except in full with written approval of Cardinal Laboratories.

Celey D. Keene, Lab Director/Quality Manager



PHONE (575) 393-2326 • 101 E. MARLAND • HOBBS, NM 88240

Analytical Results For:

APACHE CORP - HOBBS
2350 W. MARLAND BLVD.
HOBBS NM, 88240

Project: MONUMENT CTB
Project Number: NONE GIVEN
Project Manager: BRUCE BAKER
Fax To: (575) 393-2432

Reported:
24-Sep-20 11:45

W 3**H002465-03 (Soil)**

Analyte	Result	MDL	Reporting Limit	Units	Dilution	Batch	Analyst	Analyzed	Method	Notes
---------	--------	-----	-----------------	-------	----------	-------	---------	----------	--------	-------

Cardinal Laboratories**Inorganic Compounds**

Chloride	400		16.0	mg/kg	4	0091702	GM	17-Sep-20	4500-Cl-B	
----------	-----	--	------	-------	---	---------	----	-----------	-----------	--

Volatile Organic Compounds by EPA Method 8021

Benzene*	<0.050		0.050	mg/kg	50	0091617	MS	17-Sep-20	8021B	
Toluene*	<0.050		0.050	mg/kg	50	0091617	MS	17-Sep-20	8021B	
Ethylbenzene*	<0.050		0.050	mg/kg	50	0091617	MS	17-Sep-20	8021B	
Total Xylenes*	<0.150		0.150	mg/kg	50	0091617	MS	17-Sep-20	8021B	
Total BTEX	<0.300		0.300	mg/kg	50	0091617	MS	17-Sep-20	8021B	

Surrogate: 4-Bromofluorobenzene (PID)			100 %	73.3-129		0091617	MS	17-Sep-20	8021B	
---------------------------------------	--	--	-------	----------	--	---------	----	-----------	-------	--

Petroleum Hydrocarbons by GC FID

GRO C6-C10*	<10.0		10.0	mg/kg	1	0091701	MS	17-Sep-20	8015B	QR-03
DRO >C10-C28*	<10.0		10.0	mg/kg	1	0091701	MS	17-Sep-20	8015B	QR-03
EXT DRO >C28-C36	<10.0		10.0	mg/kg	1	0091701	MS	17-Sep-20	8015B	

Surrogate: 1-Chlorooctane			98.9 %	44.3-144		0091701	MS	17-Sep-20	8015B	
---------------------------	--	--	--------	----------	--	---------	----	-----------	-------	--

Surrogate: 1-Chlorooctadecane			107 %	42.2-156		0091701	MS	17-Sep-20	8015B	
-------------------------------	--	--	-------	----------	--	---------	----	-----------	-------	--

Cardinal Laboratories

*=Accredited Analyte

PLEASE NOTE: Liability and Damages. Cardinal's liability and client's exclusive remedy for any claim arising, whether based in contract or tort, shall be limited to the amount paid by client for analyses. All claims, including those for negligence or any other cause whatsoever shall be deemed waived unless made in writing and received by Cardinal within thirty (30) days after completion of the applicable service. In no event shall Cardinal be liable for incidental or consequential damage including, without limitation, business interruptions, loss of use, or loss of profits incurred by client, its subsidiaries, affiliates or successors arising out of or related to the performance of the services hereunder by Cardinal, regardless of whether such claim is based upon any of the above stated reasons or otherwise. Results relate only to the samples identified above. This report shall not be reproduced except in full with written approval of Cardinal Laboratories.

Celey D. Keene, Lab Director/Quality Manager



PHONE (575) 393-2326 • 101 E. MARLAND • HOBBS, NM 88240

Analytical Results For:

APACHE CORP - HOBBS
2350 W. MARLAND BLVD.
HOBBS NM, 88240

Project: MONUMENT CTB
Project Number: NONE GIVEN
Project Manager: BRUCE BAKER
Fax To: (575) 393-2432

Reported:
24-Sep-20 11:45

W 4**H002465-04 (Soil)**

Analyte	Result	MDL	Reporting Limit	Units	Dilution	Batch	Analyst	Analyzed	Method	Notes
---------	--------	-----	-----------------	-------	----------	-------	---------	----------	--------	-------

Cardinal Laboratories**Inorganic Compounds**

Chloride	240		16.0	mg/kg	4	0091702	GM	17-Sep-20	4500-Cl-B	
----------	-----	--	------	-------	---	---------	----	-----------	-----------	--

Volatile Organic Compounds by EPA Method 8021

Benzene*	<0.050		0.050	mg/kg	50	0091617	MS	17-Sep-20	8021B	
Toluene*	<0.050		0.050	mg/kg	50	0091617	MS	17-Sep-20	8021B	
Ethylbenzene*	<0.050		0.050	mg/kg	50	0091617	MS	17-Sep-20	8021B	
Total Xylenes*	<0.150		0.150	mg/kg	50	0091617	MS	17-Sep-20	8021B	
Total BTEX	<0.300		0.300	mg/kg	50	0091617	MS	17-Sep-20	8021B	

Surrogate: 4-Bromofluorobenzene (PID)			99.6 %		73.3-129	0091617	MS	17-Sep-20	8021B	
---------------------------------------	--	--	--------	--	----------	---------	----	-----------	-------	--

Petroleum Hydrocarbons by GC FID

GRO C6-C10*	<10.0		10.0	mg/kg	1	0091701	MS	17-Sep-20	8015B	
DRO >C10-C28*	<10.0		10.0	mg/kg	1	0091701	MS	17-Sep-20	8015B	
EXT DRO >C28-C36	<10.0		10.0	mg/kg	1	0091701	MS	17-Sep-20	8015B	

Surrogate: 1-Chlorooctane			112 %		44.3-144	0091701	MS	17-Sep-20	8015B	
---------------------------	--	--	-------	--	----------	---------	----	-----------	-------	--

Surrogate: 1-Chlorooctadecane			121 %		42.2-156	0091701	MS	17-Sep-20	8015B	
-------------------------------	--	--	-------	--	----------	---------	----	-----------	-------	--

Cardinal Laboratories

*=Accredited Analyte

PLEASE NOTE: Liability and Damages. Cardinal's liability and client's exclusive remedy for any claim arising, whether based in contract or tort, shall be limited to the amount paid by client for analyses. All claims, including those for negligence or any other cause whatsoever shall be deemed waived unless made in writing and received by Cardinal within thirty (30) days after completion of the applicable service. In no event shall Cardinal be liable for incidental or consequential damage including, without limitation, business interruptions, loss of use, or loss of profits incurred by client, its subsidiaries, affiliates or successors arising out of or related to the performance of the services hereunder by Cardinal, regardless of whether such claim is based upon any of the above stated reasons or otherwise. Results relate only to the samples identified above. This report shall not be reproduced except in full with written approval of Cardinal Laboratories.

Celey D. Keene, Lab Director/Quality Manager



PHONE (575) 393-2326 • 101 E. MARLAND • HOBBS, NM 88240

Analytical Results For:

APACHE CORP - HOBBS
2350 W. MARLAND BLVD.
HOBBS NM, 88240

Project: MONUMENT CTB
Project Number: NONE GIVEN
Project Manager: BRUCE BAKER
Fax To: (575) 393-2432

Reported:
24-Sep-20 11:45

W 5**H002465-05 (Soil)**

Analyte	Result	MDL	Reporting Limit	Units	Dilution	Batch	Analyst	Analyzed	Method	Notes
---------	--------	-----	-----------------	-------	----------	-------	---------	----------	--------	-------

Cardinal Laboratories**Inorganic Compounds**

Chloride	320		16.0	mg/kg	4	0091702	GM	17-Sep-20	4500-Cl-B	
----------	-----	--	------	-------	---	---------	----	-----------	-----------	--

Volatile Organic Compounds by EPA Method 8021

Benzene*	<0.050		0.050	mg/kg	50	0091617	MS	17-Sep-20	8021B	
Toluene*	<0.050		0.050	mg/kg	50	0091617	MS	17-Sep-20	8021B	
Ethylbenzene*	<0.050		0.050	mg/kg	50	0091617	MS	17-Sep-20	8021B	
Total Xylenes*	<0.150		0.150	mg/kg	50	0091617	MS	17-Sep-20	8021B	
Total BTEX	<0.300		0.300	mg/kg	50	0091617	MS	17-Sep-20	8021B	

Surrogate: 4-Bromofluorobenzene (PID)			99.6 %		73.3-129	0091617	MS	17-Sep-20	8021B	
---------------------------------------	--	--	--------	--	----------	---------	----	-----------	-------	--

Petroleum Hydrocarbons by GC FID

GRO C6-C10*	<10.0		10.0	mg/kg	1	0091701	MS	17-Sep-20	8015B	
DRO >C10-C28*	<10.0		10.0	mg/kg	1	0091701	MS	17-Sep-20	8015B	
EXT DRO >C28-C36	<10.0		10.0	mg/kg	1	0091701	MS	17-Sep-20	8015B	

Surrogate: 1-Chlorooctane			105 %		44.3-144	0091701	MS	17-Sep-20	8015B	
---------------------------	--	--	-------	--	----------	---------	----	-----------	-------	--

Surrogate: 1-Chlorooctadecane			114 %		42.2-156	0091701	MS	17-Sep-20	8015B	
-------------------------------	--	--	-------	--	----------	---------	----	-----------	-------	--

Cardinal Laboratories

*=Accredited Analyte

PLEASE NOTE: Liability and Damages. Cardinal's liability and client's exclusive remedy for any claim arising, whether based in contract or tort, shall be limited to the amount paid by client for analyses. All claims, including those for negligence or any other cause whatsoever shall be deemed waived unless made in writing and received by Cardinal within thirty (30) days after completion of the applicable service. In no event shall Cardinal be liable for incidental or consequential damage including, without limitation, business interruptions, loss of use, or loss of profits incurred by client, its subsidiaries, affiliates or successors arising out of or related to the performance of the services hereunder by Cardinal, regardless of whether such claim is based upon any of the above stated reasons or otherwise. Results relate only to the samples identified above. This report shall not be reproduced except in full with written approval of Cardinal Laboratories.

Celey D. Keene, Lab Director/Quality Manager



PHONE (575) 393-2326 • 101 E. MARLAND • HOBBS, NM 88240

Analytical Results For:

APACHE CORP - HOBBS
2350 W. MARLAND BLVD.
HOBBS NM, 88240

Project: MONUMENT CTB
Project Number: NONE GIVEN
Project Manager: BRUCE BAKER
Fax To: (575) 393-2432

Reported:
24-Sep-20 11:45

W 6**H002465-06 (Soil)**

Analyte	Result	MDL	Reporting Limit	Units	Dilution	Batch	Analyst	Analyzed	Method	Notes
---------	--------	-----	-----------------	-------	----------	-------	---------	----------	--------	-------

Cardinal Laboratories**Inorganic Compounds**

Chloride	352		16.0	mg/kg	4	0091702	GM	17-Sep-20	4500-Cl-B	
----------	-----	--	------	-------	---	---------	----	-----------	-----------	--

Volatile Organic Compounds by EPA Method 8021

Benzene*	<0.050		0.050	mg/kg	50	0091704	MS	17-Sep-20	8021B	
Toluene*	<0.050		0.050	mg/kg	50	0091704	MS	17-Sep-20	8021B	
Ethylbenzene*	<0.050		0.050	mg/kg	50	0091704	MS	17-Sep-20	8021B	
Total Xylenes*	<0.150		0.150	mg/kg	50	0091704	MS	17-Sep-20	8021B	
Total BTEX	<0.300		0.300	mg/kg	50	0091704	MS	17-Sep-20	8021B	

Surrogate: 4-Bromofluorobenzene (PID)			101 %	73.3-129		0091704	MS	17-Sep-20	8021B	
---------------------------------------	--	--	-------	----------	--	---------	----	-----------	-------	--

Petroleum Hydrocarbons by GC FID

GRO C6-C10*	<10.0		10.0	mg/kg	1	0091701	MS	17-Sep-20	8015B	
DRO >C10-C28*	<10.0		10.0	mg/kg	1	0091701	MS	17-Sep-20	8015B	
EXT DRO >C28-C36	<10.0		10.0	mg/kg	1	0091701	MS	17-Sep-20	8015B	

Surrogate: 1-Chlorooctane			95.2 %	44.3-144		0091701	MS	17-Sep-20	8015B	
---------------------------	--	--	--------	----------	--	---------	----	-----------	-------	--

Surrogate: 1-Chlorooctadecane			100 %	42.2-156		0091701	MS	17-Sep-20	8015B	
-------------------------------	--	--	-------	----------	--	---------	----	-----------	-------	--

Cardinal Laboratories

*=Accredited Analyte

PLEASE NOTE: Liability and Damages. Cardinal's liability and client's exclusive remedy for any claim arising, whether based in contract or tort, shall be limited to the amount paid by client for analyses. All claims, including those for negligence or any other cause whatsoever shall be deemed waived unless made in writing and received by Cardinal within thirty (30) days after completion of the applicable service. In no event shall Cardinal be liable for incidental or consequential damage including, without limitation, business interruptions, loss of use, or loss of profits incurred by client, its subsidiaries, affiliates or successors arising out of or related to the performance of the services hereunder by Cardinal, regardless of whether such claim is based upon any of the above stated reasons or otherwise. Results relate only to the samples identified above. This report shall not be reproduced except in full with written approval of Cardinal Laboratories.

Celey D. Keene, Lab Director/Quality Manager



PHONE (575) 393-2326 • 101 E. MARLAND • HOBBS, NM 88240

Analytical Results For:

APACHE CORP - HOBBS
2350 W. MARLAND BLVD.
HOBBS NM, 88240

Project: MONUMENT CTB
Project Number: NONE GIVEN
Project Manager: BRUCE BAKER
Fax To: (575) 393-2432

Reported:
24-Sep-20 11:45

W 7**H002465-07 (Soil)**

Analyte	Result	MDL	Reporting Limit	Units	Dilution	Batch	Analyst	Analyzed	Method	Notes
---------	--------	-----	-----------------	-------	----------	-------	---------	----------	--------	-------

Cardinal Laboratories**Inorganic Compounds**

Chloride	272		16.0	mg/kg	4	0091702	GM	17-Sep-20	4500-Cl-B	
----------	-----	--	------	-------	---	---------	----	-----------	-----------	--

Volatile Organic Compounds by EPA Method 8021

Benzene*	<0.050		0.050	mg/kg	50	0091704	MS	17-Sep-20	8021B	
Toluene*	<0.050		0.050	mg/kg	50	0091704	MS	17-Sep-20	8021B	
Ethylbenzene*	<0.050		0.050	mg/kg	50	0091704	MS	17-Sep-20	8021B	
Total Xylenes*	<0.150		0.150	mg/kg	50	0091704	MS	17-Sep-20	8021B	
Total BTEX	<0.300		0.300	mg/kg	50	0091704	MS	17-Sep-20	8021B	

Surrogate: 4-Bromofluorobenzene (PID)			101 %	73.3-129		0091704	MS	17-Sep-20	8021B	
---------------------------------------	--	--	-------	----------	--	---------	----	-----------	-------	--

Petroleum Hydrocarbons by GC FID

GRO C6-C10*	<10.0		10.0	mg/kg	1	0091701	MS	17-Sep-20	8015B	
DRO >C10-C28*	<10.0		10.0	mg/kg	1	0091701	MS	17-Sep-20	8015B	
EXT DRO >C28-C36	<10.0		10.0	mg/kg	1	0091701	MS	17-Sep-20	8015B	

Surrogate: 1-Chlorooctane			99.0 %	44.3-144		0091701	MS	17-Sep-20	8015B	
---------------------------	--	--	--------	----------	--	---------	----	-----------	-------	--

Surrogate: 1-Chlorooctadecane			104 %	42.2-156		0091701	MS	17-Sep-20	8015B	
-------------------------------	--	--	-------	----------	--	---------	----	-----------	-------	--

Cardinal Laboratories

*=Accredited Analyte

PLEASE NOTE: Liability and Damages. Cardinal's liability and client's exclusive remedy for any claim arising, whether based in contract or tort, shall be limited to the amount paid by client for analyses. All claims, including those for negligence or any other cause whatsoever shall be deemed waived unless made in writing and received by Cardinal within thirty (30) days after completion of the applicable service. In no event shall Cardinal be liable for incidental or consequential damage including, without limitation, business interruptions, loss of use, or loss of profits incurred by client, its subsidiaries, affiliates or successors arising out of or related to the performance of the services hereunder by Cardinal, regardless of whether such claim is based upon any of the above stated reasons or otherwise. Results relate only to the samples identified above. This report shall not be reproduced except in full with written approval of Cardinal Laboratories.

Celey D. Keene, Lab Director/Quality Manager



PHONE (575) 393-2326 • 101 E. MARLAND • HOBBS, NM 88240

Analytical Results For:

APACHE CORP - HOBBS
2350 W. MARLAND BLVD.
HOBBS NM, 88240

Project: MONUMENT CTB
Project Number: NONE GIVEN
Project Manager: BRUCE BAKER
Fax To: (575) 393-2432

Reported:
24-Sep-20 11:45

B 14**H002465-08 (Soil)**

Analyte	Result	MDL	Reporting Limit	Units	Dilution	Batch	Analyst	Analyzed	Method	Notes
---------	--------	-----	-----------------	-------	----------	-------	---------	----------	--------	-------

Cardinal Laboratories**Inorganic Compounds**

Chloride	128		16.0	mg/kg	4	0091702	GM	17-Sep-20	4500-Cl-B	
----------	-----	--	------	-------	---	---------	----	-----------	-----------	--

Volatile Organic Compounds by EPA Method 8021

Benzene*	<0.050		0.050	mg/kg	50	0091704	MS	17-Sep-20	8021B	
Toluene*	<0.050		0.050	mg/kg	50	0091704	MS	17-Sep-20	8021B	
Ethylbenzene*	<0.050		0.050	mg/kg	50	0091704	MS	17-Sep-20	8021B	
Total Xylenes*	<0.150		0.150	mg/kg	50	0091704	MS	17-Sep-20	8021B	
Total BTEX	<0.300		0.300	mg/kg	50	0091704	MS	17-Sep-20	8021B	

Surrogate: 4-Bromofluorobenzene (PID)			101 %	73.3-129		0091704	MS	17-Sep-20	8021B	
---------------------------------------	--	--	-------	----------	--	---------	----	-----------	-------	--

Petroleum Hydrocarbons by GC FID

GRO C6-C10*	<10.0		10.0	mg/kg	1	0091701	MS	17-Sep-20	8015B	
DRO >C10-C28*	<10.0		10.0	mg/kg	1	0091701	MS	17-Sep-20	8015B	
EXT DRO >C28-C36	<10.0		10.0	mg/kg	1	0091701	MS	17-Sep-20	8015B	

Surrogate: 1-Chlorooctane			108 %	44.3-144		0091701	MS	17-Sep-20	8015B	
---------------------------	--	--	-------	----------	--	---------	----	-----------	-------	--

Surrogate: 1-Chlorooctadecane			115 %	42.2-156		0091701	MS	17-Sep-20	8015B	
-------------------------------	--	--	-------	----------	--	---------	----	-----------	-------	--

Cardinal Laboratories

*=Accredited Analyte

PLEASE NOTE: Liability and Damages. Cardinal's liability and client's exclusive remedy for any claim arising, whether based in contract or tort, shall be limited to the amount paid by client for analyses. All claims, including those for negligence or any other cause whatsoever shall be deemed waived unless made in writing and received by Cardinal within thirty (30) days after completion of the applicable service. In no event shall Cardinal be liable for incidental or consequential damage including, without limitation, business interruptions, loss of use, or loss of profits incurred by client, its subsidiaries, affiliates or successors arising out of or related to the performance of the services hereunder by Cardinal, regardless of whether such claim is based upon any of the above stated reasons or otherwise. Results relate only to the samples identified above. This report shall not be reproduced except in full with written approval of Cardinal Laboratories.

Celey D. Keene, Lab Director/Quality Manager



PHONE (575) 393-2326 • 101 E. MARLAND • HOBBS, NM 88240

Analytical Results For:

APACHE CORP - HOBBS
2350 W. MARLAND BLVD.
HOBBS NM, 88240

Project: MONUMENT CTB
Project Number: NONE GIVEN
Project Manager: BRUCE BAKER
Fax To: (575) 393-2432

Reported:
24-Sep-20 11:45

Inorganic Compounds - Quality Control**Cardinal Laboratories**

Analyte	Result	Reporting Limit	Units	Spike Level	Source Result	%REC	%REC Limits	RPD	RPD Limit	Notes
Batch 0091702 - 1:4 DI Water										
Blank (0091702-BLK1)										
					Prepared & Analyzed: 17-Sep-20					
Chloride	ND	16.0	mg/kg							
LCS (0091702-BS1)										
					Prepared & Analyzed: 17-Sep-20					
Chloride	400	16.0	mg/kg	400		100	80-120			
LCS Dup (0091702-BSD1)										
					Prepared & Analyzed: 17-Sep-20					
Chloride	416	16.0	mg/kg	400		104	80-120	3.92	20	

Cardinal Laboratories

*=Accredited Analyte

PLEASE NOTE: Liability and Damages. Cardinal's liability and client's exclusive remedy for any claim arising, whether based in contract or tort, shall be limited to the amount paid by client for analyses. All claims, including those for negligence or any other cause whatsoever shall be deemed waived unless made in writing and received by Cardinal within thirty (30) days after completion of the applicable service. In no event shall Cardinal be liable for incidental or consequential damage including, without limitation, business interruptions, loss of use, or loss of profits incurred by client, its subsidiaries, affiliates or successors arising out of or related to the performance of the services hereunder by Cardinal, regardless of whether such claim is based upon any of the above stated reasons or otherwise. Results relate only to the samples identified above. This report shall not be reproduced except in full with written approval of Cardinal Laboratories.

Celey D. Keene, Lab Director/Quality Manager



PHONE (575) 393-2326 • 101 E. MARLAND • HOBBS, NM 88240

Analytical Results For:

APACHE CORP - HOBBS
2350 W. MARLAND BLVD.
HOBBS NM, 88240

Project: MONUMENT CTB
Project Number: NONE GIVEN
Project Manager: BRUCE BAKER
Fax To: (575) 393-2432

Reported:
24-Sep-20 11:45

Volatile Organic Compounds by EPA Method 8021 - Quality Control**Cardinal Laboratories**

Analyte	Result	Reporting Limit	Units	Spike Level	Source Result	%REC	%REC Limits	RPD	RPD Limit	Notes
---------	--------	-----------------	-------	-------------	---------------	------	-------------	-----	-----------	-------

Batch 0091617 - Volatiles**Blank (0091617-BLK1)**

Prepared & Analyzed: 16-Sep-20

Benzene	ND	0.050	mg/kg							
Toluene	ND	0.050	mg/kg							
Ethylbenzene	ND	0.050	mg/kg							
Total Xylenes	ND	0.150	mg/kg							
Total BTEX	ND	0.300	mg/kg							
Surrogate: 4-Bromofluorobenzene (PID)	0.0504		mg/kg	0.0500		101	73.3-129			

LCS (0091617-BS1)

Prepared & Analyzed: 16-Sep-20

Benzene	2.15	0.050	mg/kg	2.00		107	72.2-131			
Toluene	2.18	0.050	mg/kg	2.00		109	71.7-126			
Ethylbenzene	2.16	0.050	mg/kg	2.00		108	68.9-126			
Total Xylenes	6.21	0.150	mg/kg	6.00		104	71.4-125			
Surrogate: 4-Bromofluorobenzene (PID)	0.0516		mg/kg	0.0500		103	73.3-129			

LCS Dup (0091617-BSD1)

Prepared & Analyzed: 16-Sep-20

Benzene	2.18	0.050	mg/kg	2.00		109	72.2-131	1.34	14.6	
Toluene	2.21	0.050	mg/kg	2.00		110	71.7-126	1.51	17.4	
Ethylbenzene	2.18	0.050	mg/kg	2.00		109	68.9-126	1.27	18.9	
Total Xylenes	6.29	0.150	mg/kg	6.00		105	71.4-125	1.20	18.5	
Surrogate: 4-Bromofluorobenzene (PID)	0.0516		mg/kg	0.0500		103	73.3-129			

Batch 0091704 - Volatiles**Blank (0091704-BLK1)**

Prepared & Analyzed: 17-Sep-20

Benzene	ND	0.050	mg/kg							
Toluene	ND	0.050	mg/kg							
Ethylbenzene	ND	0.050	mg/kg							
Total Xylenes	ND	0.150	mg/kg							
Total BTEX	ND	0.300	mg/kg							
Surrogate: 4-Bromofluorobenzene (PID)	ND		mg/kg	0.0500		99.7	73.3-129			

Cardinal Laboratories

*=Accredited Analyte

PLEASE NOTE: Liability and Damages. Cardinal's liability and client's exclusive remedy for any claim arising, whether based in contract or tort, shall be limited to the amount paid by client for analyses. All claims, including those for negligence or any other cause whatsoever shall be deemed waived unless made in writing and received by Cardinal within thirty (30) days after completion of the applicable service. In no event shall Cardinal be liable for incidental or consequential damage including, without limitation, business interruptions, loss of use, or loss of profits incurred by client, its subsidiaries, affiliates or successors arising out of or related to the performance of the services hereunder by Cardinal, regardless of whether such claim is based upon any of the above stated reasons or otherwise. Results relate only to the samples identified above. This report shall not be reproduced except in full with written approval of Cardinal Laboratories.

Celey D. Keene, Lab Director/Quality Manager



PHONE (575) 393-2326 • 101 E. MARLAND • HOBBS, NM 88240

Analytical Results For:

APACHE CORP - HOBBS
2350 W. MARLAND BLVD.
HOBBS NM, 88240

Project: MONUMENT CTB
Project Number: NONE GIVEN
Project Manager: BRUCE BAKER
Fax To: (575) 393-2432

Reported:
24-Sep-20 11:45

Volatile Organic Compounds by EPA Method 8021 - Quality Control**Cardinal Laboratories**

Analyte	Result	Reporting Limit	Units	Spike Level	Source Result	%REC	%REC Limits	RPD	RPD Limit	Notes
---------	--------	--------------------	-------	----------------	------------------	------	----------------	-----	--------------	-------

Batch 0091704 - Volatiles**LCS (0091704-BS1)**

Prepared & Analyzed: 17-Sep-20

Benzene	2.14	0.050	mg/kg	2.00		107	72.2-131			
Toluene	2.15	0.050	mg/kg	2.00		108	71.7-126			
Ethylbenzene	2.12	0.050	mg/kg	2.00		106	68.9-126			
Total Xylenes	6.09	0.150	mg/kg	6.00		102	71.4-125			
Surrogate: 4-Bromofluorobenzene (PID)	0.0505		mg/kg	0.0500		101	73.3-129			

LCS Dup (0091704-BS1)

Prepared & Analyzed: 17-Sep-20

Benzene	2.22	0.050	mg/kg	2.00		111	72.2-131	3.88	14.6	
Toluene	2.24	0.050	mg/kg	2.00		112	71.7-126	4.13	17.4	
Ethylbenzene	2.21	0.050	mg/kg	2.00		111	68.9-126	4.31	18.9	
Total Xylenes	6.37	0.150	mg/kg	6.00		106	71.4-125	4.47	18.5	
Surrogate: 4-Bromofluorobenzene (PID)	0.0511		mg/kg	0.0500		102	73.3-129			

Cardinal Laboratories

*=Accredited Analyte

PLEASE NOTE: Liability and Damages. Cardinal's liability and client's exclusive remedy for any claim arising, whether based in contract or tort, shall be limited to the amount paid by client for analyses. All claims, including those for negligence or any other cause whatsoever shall be deemed waived unless made in writing and received by Cardinal within thirty (30) days after completion of the applicable service. In no event shall Cardinal be liable for incidental or consequential damage including, without limitation, business interruptions, loss of use, or loss of profits incurred by client, its subsidiaries, affiliates or successors arising out of or related to the performance of the services hereunder by Cardinal, regardless of whether such claim is based upon any of the above stated reasons or otherwise. Results relate only to the samples identified above. This report shall not be reproduced except in full with written approval of Cardinal Laboratories.

Celey D. Keene, Lab Director/Quality Manager



PHONE (575) 393-2326 • 101 E. MARLAND • HOBBS, NM 88240

Analytical Results For:

APACHE CORP - HOBBS
2350 W. MARLAND BLVD.
HOBBS NM, 88240

Project: MONUMENT CTB
Project Number: NONE GIVEN
Project Manager: BRUCE BAKER
Fax To: (575) 393-2432

Reported:
24-Sep-20 11:45

Petroleum Hydrocarbons by GC FID - Quality Control**Cardinal Laboratories**

Analyte	Result	Reporting Limit	Units	Spike Level	Source Result	%REC	%REC Limits	RPD	RPD Limit	Notes
---------	--------	-----------------	-------	-------------	---------------	------	-------------	-----	-----------	-------

Batch 0091616 - General Prep - Organics**Blank (0091616-BLK1)**

Prepared & Analyzed: 16-Sep-20

GRO C6-C10	ND	10.0	mg/kg							
DRO >C10-C28	ND	10.0	mg/kg							
EXT DRO >C28-C36	ND	10.0	mg/kg							
Surrogate: 1-Chlorooctane	51.8		mg/kg	50.0		104	44.3-144			
Surrogate: 1-Chlorooctadecane	59.5		mg/kg	50.0		119	42.2-156			

LCS (0091616-BS1)

Prepared & Analyzed: 16-Sep-20

GRO C6-C10	184	10.0	mg/kg	200		92.0	78.8-127			
DRO >C10-C28	191	10.0	mg/kg	200		95.7	80-132			
Total TPH C6-C28	375	10.0	mg/kg	400		93.8	81.3-128			
Surrogate: 1-Chlorooctane	52.9		mg/kg	50.0		106	44.3-144			
Surrogate: 1-Chlorooctadecane	61.0		mg/kg	50.0		122	42.2-156			

LCS Dup (0091616-BS1)

Prepared & Analyzed: 16-Sep-20

GRO C6-C10	180	10.0	mg/kg	200		89.9	78.8-127	2.27	15.1	
DRO >C10-C28	187	10.0	mg/kg	200		93.6	80-132	2.20	17.1	
Total TPH C6-C28	367	10.0	mg/kg	400		91.8	81.3-128	2.23	15	
Surrogate: 1-Chlorooctane	51.8		mg/kg	50.0		104	44.3-144			
Surrogate: 1-Chlorooctadecane	59.6		mg/kg	50.0		119	42.2-156			

Batch 0091701 - General Prep - Organics**Blank (0091701-BLK1)**

Prepared & Analyzed: 17-Sep-20

GRO C6-C10	ND	10.0	mg/kg							
DRO >C10-C28	ND	10.0	mg/kg							
EXT DRO >C28-C36	ND	10.0	mg/kg							
Surrogate: 1-Chlorooctane	51.0		mg/kg	50.0		102	44.3-144			
Surrogate: 1-Chlorooctadecane	57.7		mg/kg	50.0		115	42.2-156			

Cardinal Laboratories

*=Accredited Analyte

PLEASE NOTE: Liability and Damages. Cardinal's liability and client's exclusive remedy for any claim arising, whether based in contract or tort, shall be limited to the amount paid by client for analyses. All claims, including those for negligence or any other cause whatsoever shall be deemed waived unless made in writing and received by Cardinal within thirty (30) days after completion of the applicable service. In no event shall Cardinal be liable for incidental or consequential damage including, without limitation, business interruptions, loss of use, or loss of profits incurred by client, its subsidiaries, affiliates or successors arising out of or related to the performance of the services hereunder by Cardinal, regardless of whether such claim is based upon any of the above stated reasons or otherwise. Results relate only to the samples identified above. This report shall not be reproduced except in full with written approval of Cardinal Laboratories.

Celey D. Keene, Lab Director/Quality Manager



PHONE (575) 393-2326 • 101 E. MARLAND • HOBBS, NM 88240

Analytical Results For:

APACHE CORP - HOBBS
2350 W. MARLAND BLVD.
HOBBS NM, 88240

Project: MONUMENT CTB
Project Number: NONE GIVEN
Project Manager: BRUCE BAKER
Fax To: (575) 393-2432

Reported:
24-Sep-20 11:45

Petroleum Hydrocarbons by GC FID - Quality Control**Cardinal Laboratories**

Analyte	Result	Reporting Limit	Units	Spike Level	Source Result	%REC	%REC Limits	RPD	RPD Limit	Notes
---------	--------	--------------------	-------	----------------	------------------	------	----------------	-----	--------------	-------

Batch 0091701 - General Prep - Organics**LCS (0091701-BS1)**

Prepared & Analyzed: 17-Sep-20

GRO C6-C10	179	10.0	mg/kg	200		89.6	78.8-127			
DRO >C10-C28	177	10.0	mg/kg	200		88.4	80-132			
Total TPH C6-C28	356	10.0	mg/kg	400		89.0	81.3-128			
Surrogate: 1-Chlorooctane	51.7		mg/kg	50.0		103	44.3-144			
Surrogate: 1-Chlorooctadecane	61.3		mg/kg	50.0		123	42.2-156			

LCS Dup (0091701-BS1)

Prepared & Analyzed: 17-Sep-20

GRO C6-C10	175	10.0	mg/kg	200		87.6	78.8-127	2.25	15.1	
DRO >C10-C28	174	10.0	mg/kg	200		86.9	80-132	1.72	17.1	
Total TPH C6-C28	349	10.0	mg/kg	400		87.2	81.3-128	1.99	15	
Surrogate: 1-Chlorooctane	51.0		mg/kg	50.0		102	44.3-144			
Surrogate: 1-Chlorooctadecane	58.2		mg/kg	50.0		116	42.2-156			

Cardinal Laboratories

*=Accredited Analyte

PLEASE NOTE: Liability and Damages. Cardinal's liability and client's exclusive remedy for any claim arising, whether based in contract or tort, shall be limited to the amount paid by client for analyses. All claims, including those for negligence or any other cause whatsoever shall be deemed waived unless made in writing and received by Cardinal within thirty (30) days after completion of the applicable service. In no event shall Cardinal be liable for incidental or consequential damage including, without limitation, business interruptions, loss of use, or loss of profits incurred by client, its subsidiaries, affiliates or successors arising out of or related to the performance of the services hereunder by Cardinal, regardless of whether such claim is based upon any of the above stated reasons or otherwise. Results relate only to the samples identified above. This report shall not be reproduced except in full with written approval of Cardinal Laboratories.

Celey D. Keene, Lab Director/Quality Manager



PHONE (575) 393-2326 • 101 E. MARLAND • HOBBS, NM 88240

Notes and Definitions

QR-03	The RPD value for the sample duplicate or MS/MSD was outside of QC acceptance limits due to matrix interference. QC batch accepted based on LCS and/or LCSD recovery and/or RPD values.
ND	Analyte NOT DETECTED at or above the reporting limit
RPD	Relative Percent Difference
**	Samples not received at proper temperature of 6°C or below.
***	Insufficient time to reach temperature.
-	Chloride by SM4500Cl-B does not require samples be received at or below 6°C Samples reported on an as received basis (wet) unless otherwise noted on report

Cardinal Laboratories

*=Accredited Analyte

PLEASE NOTE: Liability and Damages. Cardinal's liability and client's exclusive remedy for any claim arising, whether based in contract or tort, shall be limited to the amount paid by client for analyses. All claims, including those for negligence or any other cause whatsoever shall be deemed waived unless made in writing and received by Cardinal within thirty (30) days after completion of the applicable service. In no event shall Cardinal be liable for incidental or consequential damage including, without limitation, business interruptions, loss of use, or loss of profits incurred by client, its subsidiaries, affiliates or successors arising out of or related to the performance of the services hereunder by Cardinal, regardless of whether such claim is based upon any of the above stated reasons or otherwise. Results relate only to the samples identified above. This report shall not be reproduced except in full with written approval of Cardinal Laboratories.

A handwritten signature in cursive script, reading "Celey D. Keene".

Celey D. Keene, Lab Director/Quality Manager



BILL TO

ANALYSIS REQUEST

[illegible]

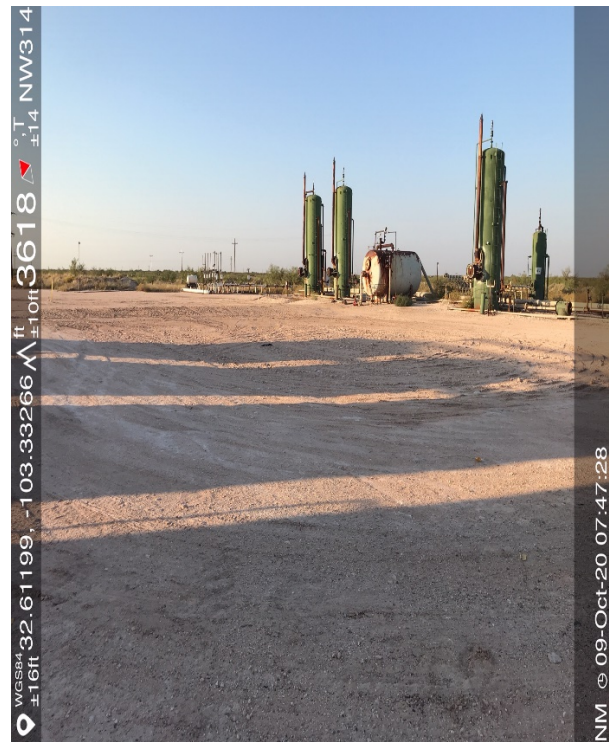

District I
1625 N. French Dr., Hobbs, NM 88240
Phone:(575) 393-6161 Fax:(575) 393-0720
District II
811 S. First St., Artesia, NM 88210
Phone:(575) 748-1283 Fax:(575) 748-9720
District III
1000 Rio Brazos Rd., Aztec, NM 87410
Phone:(505) 334-6178 Fax:(505) 334-6170
District IV
1220 S. St Francis Dr., Santa Fe, NM 87505
Phone:(505) 476-3470 Fax:(505) 476-3462

State of New Mexico
Energy, Minerals and Natural Resources
Oil Conservation Division
1220 S. St Francis Dr.
Santa Fe, NM 87505

CONDITIONS

Action 10585

CONDITIONS OF APPROVAL

Operator:		OGRID:	Action Number:	Action Type:
#1000	APACHE CORPORATION Midland, TX79705	303 Veterans Airpark Ln 873	10585	C-141
OCD Reviewer	Condition			
ceads	None			