



PHONE (575) 397-6388 • FAX (575) 397- 0397 • 1324 W. MARLAND • P.O. BOX 805 • HOBBS, NM 88241-0805  
E-MAIL: cbrunson@bbcinternational.com

## DELINEATION/REMEDATION WORKPLAN

### OXY – OXBOW CC 17-8 FED COM #32H (Leak Date: 11/5/19)

**Incident ID: NAPP2117549767**

This delineation workplan and remediation proposal addresses the releases associated with Incident ID #NAPP2117549767.

The following information includes:

1. Appropriate completed and signed C-141 pages.
2. Scaled digital site map with spill area demarcated and leak point identified along with sample point locations and areas of remediation at appropriate depths.
3. GPS information for sample points and sample methodology.
4. Depth to groundwater information (i.e., pdf of OSE search results, USGS search results).
5. Watercourse/features map within 1000 feet.
6. BLM Cave Karst map.
7. FEMA National Flood map.
8. Laboratory analysis results summary table and original laboratory analysis reports.
9. Potentially other pertinent information as necessary for site specific purposes.

***Based on the information included in this package and the NMOCD rules, the following remediation is proposed:***

***OXY will excavate the spill area as depicted on the following site diagram. The leak area near SP1 and SP5 (YELLOW shade on diagram) will be excavated to a depth of 2 feet. The leak area near SP2 (GREEN shade on diagram) will be excavated to a depth of 5 feet. The leak area near SP3 and SP4 (PURPLE shade on diagram) will be excavated to a depth of 3 feet.***

***OXY will collect bottom and sidewall confirmation samples every 200 square feet. The estimated amount of soil to be excavated is 1,651 cubic yards. The remediation will be completed within 90 days of approval.***

The entire site will then be backfilled with clean soil and revegetated (if warranted) to the standards of the appropriate agency or private surface owner.  
All excavated materials will be disposed of at an NMOCD-approved disposal facility.

Form C-141

State of New Mexico  
Oil Conservation Division

Page 3

Incident ID	nAPP2117549767
District RP	
Facility ID	
Application ID	

## Site Assessment/Characterization

*This information must be provided to the appropriate district office no later than 90 days after the release discovery date.*

What is the shallowest depth to groundwater beneath the area affected by the release?	51 (ft bgs)
Did this release impact groundwater or surface water?	<input type="checkbox"/> Yes <input checked="" type="checkbox"/> No
Are the lateral extents of the release within 300 feet of a continuously flowing watercourse or any other significant watercourse?	<input type="checkbox"/> Yes <input checked="" type="checkbox"/> No
Are the lateral extents of the release within 200 feet of any lakebed, sinkhole, or playa lake (measured from the ordinary high-water mark)?	<input type="checkbox"/> Yes <input checked="" type="checkbox"/> No
Are the lateral extents of the release within 300 feet of an occupied permanent residence, school, hospital, institution, or church?	<input type="checkbox"/> Yes <input checked="" type="checkbox"/> No
Are the lateral extents of the release within 500 horizontal feet of a spring or a private domestic fresh water well used by less than five households for domestic or stock watering purposes?	<input type="checkbox"/> Yes <input checked="" type="checkbox"/> No
Are the lateral extents of the release within 1000 feet of any other fresh water well or spring?	<input type="checkbox"/> Yes <input checked="" type="checkbox"/> No
Are the lateral extents of the release within incorporated municipal boundaries or within a defined municipal fresh water well field?	<input type="checkbox"/> Yes <input checked="" type="checkbox"/> No
Are the lateral extents of the release within 300 feet of a wetland?	<input type="checkbox"/> Yes <input checked="" type="checkbox"/> No
Are the lateral extents of the release overlying a subsurface mine?	<input type="checkbox"/> Yes <input checked="" type="checkbox"/> No
Are the lateral extents of the release overlying an unstable area such as karst geology?	<input type="checkbox"/> Yes <input checked="" type="checkbox"/> No
Are the lateral extents of the release within a 100-year floodplain?	<input type="checkbox"/> Yes <input checked="" type="checkbox"/> No
Did the release impact areas <b>not</b> on an exploration, development, production, or storage site?	<input type="checkbox"/> Yes <input checked="" type="checkbox"/> No

Attach a comprehensive report (electronic submittals in .pdf format are preferred) demonstrating the lateral and vertical extents of soil contamination associated with the release have been determined. Refer to 19.15.29.11 NMAC for specifics.

### **Characterization Report Checklist:** *Each of the following items must be included in the report.*

- ☒ Scaled site map showing impacted area, surface features, subsurface features, delineation points, and monitoring wells.
- ☐ Field data
- ☒ Data table of soil contaminant concentration data
- ☒ Depth to water determination
- ☒ Determination of water sources and significant watercourses within ½-mile of the lateral extents of the release
- ☐ Boring or excavation logs
- ☐ Photographs including date and GIS information
- ☒ Topographic/Aerial maps
- ☒ Laboratory data including chain of custody

If the site characterization report does not include completed efforts at remediation of the release, the report must include a proposed remediation plan. That plan must include the estimated volume of material to be remediated, the proposed remediation technique, proposed sampling plan and methods, anticipated timelines for beginning and completing the remediation. The closure criteria for a release are contained in Table 1 of 19.15.29.12 NMAC, however, use of the table is modified by site- and release-specific parameters.

Form C-141

State of New Mexico  
Oil Conservation Division

Page 4

Incident ID	nAPP2117549767
District RP	
Facility ID	
Application ID	

I hereby certify that the information given above is true and complete to the best of my knowledge and understand that pursuant to OCD rules and regulations all operators are required to report and/or file certain release notifications and perform corrective actions for releases which may endanger public health or the environment. The acceptance of a C-141 report by the OCD does not relieve the operator of liability should their operations have failed to adequately investigate and remediate contamination that pose a threat to groundwater, surface water, human health or the environment. In addition, OCD acceptance of a C-141 report does not relieve the operator of responsibility for compliance with any other federal, state, or local laws and/or regulations.

Printed Name: Wade DittrichTitle: Environmental CoordinatorSignature: Date: 6-24-21email: wade\_dittrich@oxy.comTelephone: (575) 390-2828**OCD Only**

Received by: \_\_\_\_\_

Date: \_\_\_\_\_

Form C-141

State of New Mexico  
Oil Conservation Division

Page 5

Incident ID	nAPP2117549767
District RP	
Facility ID	
Application ID	

## Remediation Plan

**Remediation Plan Checklist:** *Each of the following items must be included in the plan.*

- ☒ Detailed description of proposed remediation technique
- ☒ Scaled sitemap with GPS coordinates showing delineation points
- ☒ Estimated volume of material to be remediated
- ☒ Closure criteria is to Table 1 specifications subject to 19.15.29.12(C)(4) NMAC
- ☒ Proposed schedule for remediation (note if remediation plan timeline is more than 90 days OCD approval is required)

**Deferral Requests Only:** *Each of the following items must be confirmed as part of any request for deferral of remediation.*

- ☐ Contamination must be in areas immediately under or around production equipment where remediation could cause a major facility deconstruction.
- ☐ Extents of contamination must be fully delineated.
- ☐ Contamination does not cause an imminent risk to human health, the environment, or groundwater.

I hereby certify that the information given above is true and complete to the best of my knowledge and understand that pursuant to OCD rules and regulations all operators are required to report and/or file certain release notifications and perform corrective actions for releases which may endanger public health or the environment. The acceptance of a C-141 report by the OCD does not relieve the operator of liability should their operations have failed to adequately investigate and remediate contamination that pose a threat to groundwater, surface water, human health or the environment. In addition, OCD acceptance of a C-141 report does not relieve the operator of responsibility for compliance with any other federal, state, or local laws and/or regulations.

Printed Name: Wade Dittrich Title: Environmental Coordinator  
Signature:  Date: 6-24-21  
email: wade\_dittrich@oxy.com Telephone: (575) 390-2828

**OCD Only**

Received by: \_\_\_\_\_ Date: \_\_\_\_\_

☐ Approved ☐ Approved with Attached Conditions of Approval ☐ Denied ☐ Deferral Approved





Signature: \_\_\_\_\_ Date: \_\_\_\_\_



# Oxy, Oxbow CC 17-8 Fed Com #32H

Leak Date: 11/5/19  
County: Eddy, NM  
Incident ID: nAPP2117549767  
API: 30-015-45084

**Legend**

-  2' Excavation
-  3' Excavation
-  5' Excavation
-  Leak area
-  Sample Points



Google Earth

© 2021 Google

SAMPLE POINT NOTES OXBOW CC 17-8 FED COM #32H(11-5-19)

SP NORTH	N 32.211688°	W 104.010950°
SP SOUTH	N 32.211203°	W 104.010835°
SP EAST	N 32.211473°	W 104.010751°
SP WEST	N 32.211440°	W 104.011352°
SP1	N 32.211599°	W 104.010877°
SP2	N 32.211581°	W 104.011077°
SP3	N 32.211436°	W 104.011102°
SP4	N 32.211328°	W 104.010839°
SP5	N 32.211451°	W 104.010858°





USGS Home  
Contact USGS  
Search USGS

National Water Information System: Web Interface

USGS Water Resources

Data Category:

Groundwater

Geographic Area:

New Mexico

GO

Click to hideNews Bulletins

- Introducing The Next Generation of USGS Water Data for the Nation
- Full News

Groundwater levels for New Mexico

Click to hide state-specific text

Search Results -- 1 sites found

Agency code = usgs  
site\_no list =

- 321355104012001

Minimum number of levels = 1  
[Save file of selected sites](#) to local disk for future upload

USGS 321355104012001 24S.29E.07.14444

Eddy County, New Mexico  
Latitude 32°13'55", Longitude 104°01'20" NAD27  
Land-surface elevation 2,983 feet above NAVD88  
The depth of the well is 160 feet below land surface.  
This well is completed in the Castile Formation (312CSTL) local aquifer.

Output formats

Table of data

Tab-separated data

Graph of data

Reselect period

Date	Time	? Water-level date-time accuracy	Water level, feet below land surface	Water level, feet above specific vertical datum	Referenced vertical datum	? Water-level accuracy	? Status	? Method of measurement	? Measuring agency	? Source of measurem
1983-02-01		D	47.14			2			U	
1987-10-16		D	51.84			2			U	
1988-02-11		D	52.19			2			U	
1992-10-20		D	51.78			2			S	

Explanation

Section	Code	Description
Water-level date-time accuracy	D	Date is accurate to the Day
Water-level accuracy	2	Water level accuracy to nearest hundredth of a foot
Status		The reported water-level measurement represents a static level
Method of measurement	S	Steel-tape measurement.
Method of measurement	U	Unknown method.
Measuring agency		Not determined
Source of measurement	U	Source is unknown.
Water-level approval status	A	Approved for publication -- Processing and review completed.

[Questions about sites/data?](#)  
[Feedback on this web site](#)  
[Automated retrievals](#)  
[Help](#)  
[Data Tips](#)  
[Explanation of terms](#)  
[Subscribe for system changes](#)  
[News](#)

[Accessibility](#)   [Plug-Ins](#)   [FOIA](#)   [Privacy](#)   [Policies and Notices](#)

[U.S. Department of the Interior](#) | [U.S. Geological Survey](#)



**Title: Groundwater for New Mexico: Water Levels**

**URL: <https://nwis.waterdata.usgs.gov/nm/nwis/gwlevels?>**

Page Contact Information: [New Mexico Water Data Maintainer](#)

Page Last Modified: 2019-11-18 17:51:23 EST

0.22 0.2 nadww02







# Oxy, Oxbow CC 17-8 Fed Com 32H

Leak date: 11/5/19  
Eddy County, NM

## BLM CAVE KARST MAP

- Legend**
-  Leak area
  -  Medium potential

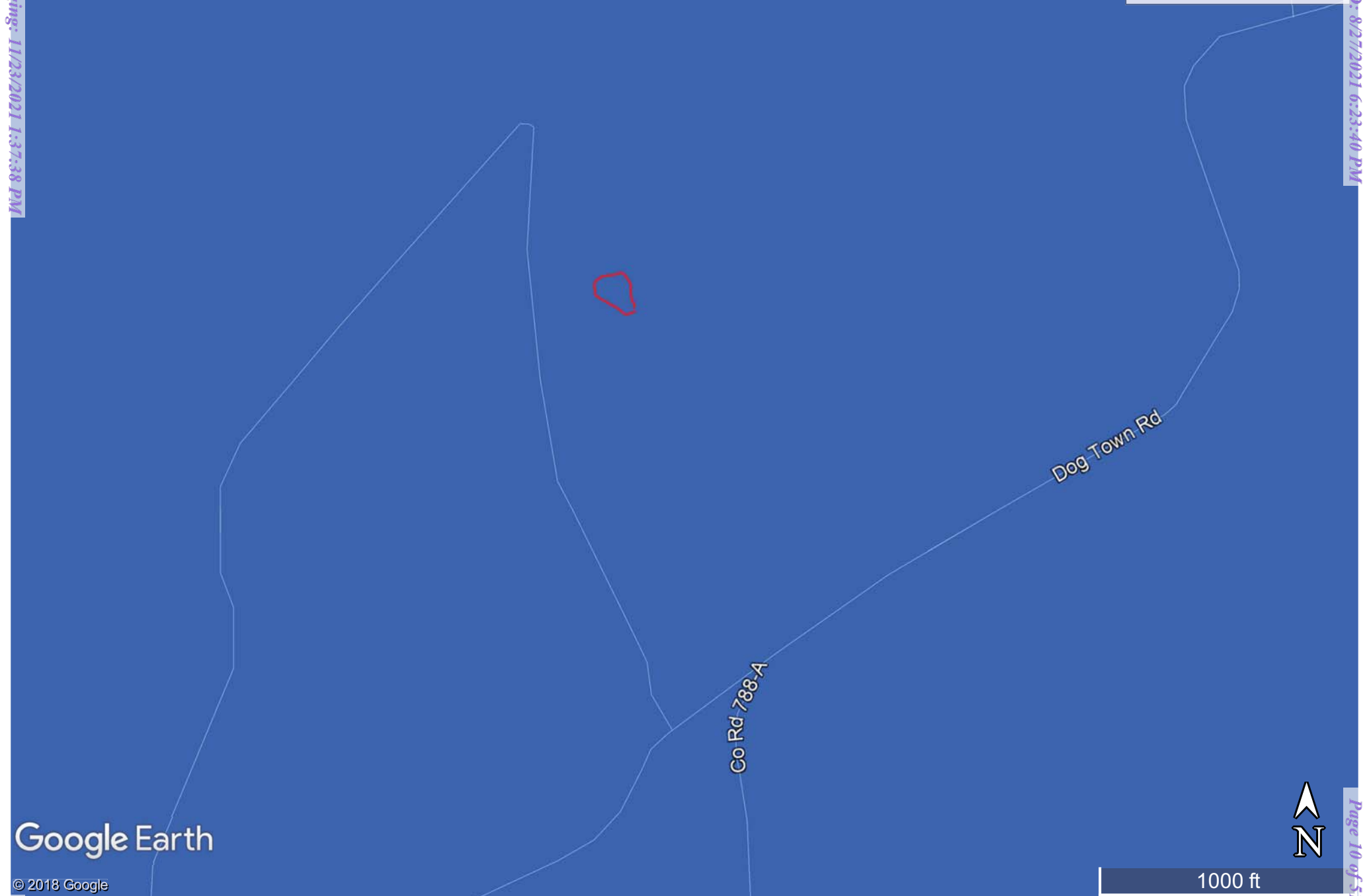

# National Flood Hazard Layer FIRMette



### Legend

SEE FIS REPORT FOR DETAILED LEGEND AND INDEX MAP FOR FIRM PANEL LAYOUT

SPECIAL FLOOD HAZARD AREAS		Without Base Flood Elevation (BFE) Zone A, V, A99
		With BFE or Depth Zone AE, AO, AH, VE, AR
		Regulatory Floodway
OTHER AREAS OF FLOOD HAZARD		0.2% Annual Chance Flood Hazard, Areas of 1% annual chance flood with average depth less than one foot or with drainage areas of less than one square mile Zone X
		Future Conditions 1% Annual Chance Flood Hazard Zone X
		Area with Reduced Flood Risk due to Levee. See Notes. Zone X
		Area with Flood Risk due to Levee Zone X
OTHER AREAS		Area of Minimal Flood Hazard Zone X
		Effective LOMRs
GENERAL STRUCTURES		Channel, Culvert, or Storm Sewer
		Levee, Dike, or Floodwall
OTHER FEATURES		Cross Sections with 1% Annual Chance Water Surface Elevation
		Coastal Transect
		Base Flood Elevation Line (BFE)
		Limit of Study
		Jurisdiction Boundary
		Coastal Transect Baseline
		Profile Baseline
MAP PANELS		Digital Data Available
		No Digital Data Available
		Unmapped

The pin displayed on the map is an approximate point selected by the user and does not represent an authoritative property location.

This map complies with FEMA's standards for the use of digital flood maps if it is not void as described below. The basemap shown complies with FEMA's basemap accuracy standards

The flood hazard information is derived directly from the authoritative NFHL web services provided by FEMA. This map was exported on **11/18/2019 at 5:56:37 PM** and does not reflect changes or amendments subsequent to this date and time. The NFHL and effective information may change or become superseded by new data over time.

This map image is void if the one or more of the following map elements do not appear: basemap imagery, flood zone labels, legend, scale bar, map creation date, community identifiers, FIRM panel number, and FIRM effective date. Map images for unmapped and unmodernized areas cannot be used for regulatory purposes.

Retrieved by: 11/23/2021 1:37:38 PM

Retrieved by: 11/23/2021 6:23:40 PM

Page 11 of 51

Laboratory Analytical Results Summary  
Oxy, Oxbow Cedar Canyon 17 8 Fed Com (11-5-19)

		Sample ID	North @ Surface	East @ Surface	West @ Surface	South @ Surface
Analyte	Method	Date	10/26/20	10/26/20	10/26/20	10/26/20
			mg/kg	mg/kg	mg/kg	mg/kg
Benzene	BTEX 8021B		<0.050	<0.050	<0.050	<0.050
Toluene	BTEX 8021B		<0.050	<0.050	<0.050	<0.050
Ethylbenzene	BTEX 8021B		<0.050	<0.050	<0.050	<0.050
Total Xylenes	BTEX 8021B		<0.150	<0.150	<0.150	<0.150
Total BTEX	BTEX 8021B		<0.050	<0.050	<0.050	<0.050
Chloride	SM4500Cl-B		48.0	96.0	96.0	48.0
GRO	TPH 8015M		<10.0	<10.0	<10.0	<10.0
DRO	TPH 8015M		<10.0	<10.0	<10.0	<10.0
EXT DRO	TPH 8015M		<10.0	<10.0	<10.0	<10.0

		Sample ID	SP1 @ Surface	SP1 @ 1'	SP1 @ 2'	SP1 @ 3'	SP1 @ 4'
Analyte	Method	Date	10/26/20	10/26/20	6/9/21	6/9/21	6/9/21
			mg/kg	mg/kg	mg/kg	mg/kg	mg/kg
Benzene	BTEX 8021B		<0.050	<0.050	<0.050	<0.050	<0.050
Toluene	BTEX 8021B		<0.050	<0.050	<0.050	<0.050	<0.050
Ethylbenzene	BTEX 8021B		<0.050	<0.050	<0.050	<0.050	<0.050
Total Xylenes	BTEX 8021B		<0.150	<0.150	<0.150	<0.150	<0.150
Total BTEX	BTEX 8021B		<0.050	<0.050	<0.050	<0.050	<0.050
Chloride	SM4500Cl-B		18400	2480	80	32	80
GRO	TPH 8015M		<10.0	<10.0	<10.1	<10.1	<10.1
DRO	TPH 8015M		17200	718	<10.0	<10.0	<10.0
EXT DRO	TPH 8015M		6460	28.9	<10.0	<10.0	<10.0

		Sample ID	SP2 @ Surface	SP2 @ 1'	SP2 @ 2'	SP2 @ 3'	SP2 @ 4'	SP2 @ 5'	SP2 @ 6'
Analyte	Method	Date	10/26/20	10/26/20	10/26/20	6/9/21	6/9/21	6/9/21	6/9/21
			mg/kg	mg/kg	mg/kg	mg/kg	mg/kg	mg/kg	mg/kg
Benzene	BTEX 8021B		<0.050	<0.050	<0.050	<0.050	<0.050	<0.050	<0.050
Toluene	BTEX 8021B		<0.050	<0.050	<0.050	<0.050	<0.050	<0.050	<0.050
Ethylbenzene	BTEX 8021B		<0.050	<0.050	<0.050	<0.050	<0.050	<0.050	<0.050
Total Xylenes	BTEX 8021B		<0.150	<0.150	<0.150	<0.150	<0.150	<0.150	<0.150
Total BTEX	BTEX 8021B		<0.050	<0.050	<0.050	<0.050	<0.050	<0.050	<0.050
Chloride	SM4500Cl-B		30800	3920	2720	1160	672	224	48
GRO	TPH 8015M		<10.0	<10.0	<10.0	<10.0	<10.0	<10.0	<10.0
DRO	TPH 8015M		6110	98.4	168	<10.0	<10.0	<10.0	<10.0
EXT DRO	TPH 8015M		2840	10.9	23.2	<10.0	<10.0	<10.0	<10.0

		Sample ID	SP3 @ Surface	SP3 @ 1'	SP3 @ 2'	SP3 @ 3'	SP3 @ 4'	SP3 @ 5'
Analyte	Method	Date	10/28/20	10/28/20	10/28/20	6/9/21	6/9/21	6/9/21
			mg/kg	mg/kg	mg/kg	mg/kg	mg/kg	mg/kg
Benzene	BTEX 8021B		<0.050	<0.050	n/a	n/a	n/a	n/a
Toluene	BTEX 8021B		<0.050	<0.050	n/a	n/a	n/a	n/a
Ethylbenzene	BTEX 8021B		<0.050	<0.050	n/a	n/a	n/a	n/a
Total Xylenes	BTEX 8021B		<0.150	<0.150	n/a	n/a	n/a	n/a
Total BTEX	BTEX 8021B		<0.050	<0.050	n/a	n/a	n/a	n/a
Chloride	SM4500Cl-B		1840	1120	688	96	80	128
GRO	TPH 8015M		<10.0	<10.0	n/a	n/a	n/a	n/a
DRO	TPH 8015M		230	16.9	n/a	n/a	n/a	n/a
EXT DRO	TPH 8015M		<10.0	<10.0	n/a	n/a	n/a	n/a



Laboratory Analytical Results Summary  
Oxy, Oxbow Cedar Canyon 17 8 Fed Com (11-5-19)

		Sample ID	SP4 @ Surface	SP4 @ 1'	SP4 @ 2'	SP4 @ 3'	SP4 @ 4'
Analyte	Method	Date	10/28/20	10/28/20	10/28/20	6/11/21	6/11/21
			mg/kg	mg/kg	mg/kg	mg/kg	mg/kg
Benzene	BTEX 8021B		<0.050	<0.050	<0.050	<0.050	<0.050
Toluene	BTEX 8021B		<0.050	<0.050	<0.050	<0.050	<0.050
Ethylbenzene	BTEX 8021B		<0.050	<0.050	<0.050	<0.050	<0.050
Total Xylenes	BTEX 8021B		0.374	0.752	0.562	<0.150	<0.150
Total BTEX	BTEX 8021B		0.374	0.852	0.562	<0.300	<0.300
Chloride	SM4500Cl-B		7200	3560	1840	672	48
GRO	TPH 8015M		<100	72.3	95.1	<10.0	<10.0
DRO	TPH 8015M		14600	7760	6230	<10.0	<10.0
EXT DRO	TPH 8015M		<100	82.6	67.1	<10.0	<10.0

		Sample ID	SP5 @ Surface	SP5 @ 1'	SP5 @ 2'
Analyte	Method	Date	10/28/20	10/28/20	10/28/20
			mg/kg	mg/kg	mg/kg
Benzene	BTEX 8021B		<0.050	<0.050	n/a
Toluene	BTEX 8021B		<0.050	<0.050	n/a
Ethylbenzene	BTEX 8021B		<0.050	<0.050	n/a
Total Xylenes	BTEX 8021B		<0.150	<0.150	n/a
Total BTEX	BTEX 8021B		<0.050	<0.050	n/a
Chloride	SM4500Cl-B		9520	784	528
GRO	TPH 8015M		<10.0	<10.0	n/a
DRO	TPH 8015M		186	<10.0	n/a
EXT DRO	TPH 8015M		34.3	<10.0	n/a



PHONE (575) 393-2326 ° 101 E. MARLAND ° HOBBS, NM 88240

---

November 10, 2020

Cliff Brunson

BBC International, Inc.

P.O. Box 805

Hobbs, NM 88241

RE: OXBOW CEDAR CANYON 17 8 FED COM #32H

Enclosed are the results of analyses for samples received by the laboratory on 11/05/20 16:40.

Cardinal Laboratories is accredited through Texas NELAP under certificate number T104704398-20-13. Accreditation applies to drinking water, non-potable water and solid and chemical materials. All accredited analytes are denoted by an asterisk (\*). For a complete list of accredited analytes and matrices visit the TCEQ website at [www.tceq.texas.gov/field/qa/lab\\_accred\\_certif.html](http://www.tceq.texas.gov/field/qa/lab_accred_certif.html).

Cardinal Laboratories is accredited through the State of Colorado Department of Public Health and Environment for:

Method EPA 552.2	Haloacetic Acids (HAA-5)
Method EPA 524.2	Total Trihalomethanes (TTHM)
Method EPA 524.4	Regulated VOCs (V1, V2, V3)

Accreditation applies to public drinking water matrices.

This report meets NELAP requirements and is made up of a cover page, analytical results, and a copy of the original chain-of-custody. If you have any questions concerning this report, please feel free to contact me.

Sincerely,

A handwritten signature in black ink that reads "Celey D. Keene". The signature is written in a cursive, flowing style.

Celey D. Keene

Lab Director/Quality Manager



PHONE (575) 393-2326 • 101 E. MARLAND • HOBBS, NM 88240

**Analytical Results For:**

BBC International, Inc.  
 Cliff Brunson  
 P.O. Box 805  
 Hobbs NM, 88241  
 Fax To: (575) 397-0397

Received:	11/05/2020	Sampling Date:	10/26/2020
Reported:	11/10/2020	Sampling Type:	Soil
Project Name:	OXBOW CEDAR CANYON 17 8 FED COM	Sampling Condition:	Cool & Intact
Project Number:	( 11-5-19 )	Sample Received By:	Tamara Oldaker
Project Location:	OXY		

**Sample ID: SP N SURFACE (H002948-01)**

BTEX 8021B		mg/kg		Analyzed By: MS						
Analyte	Result	Reporting Limit	Analyzed	Method Blank	BS	% Recovery	True Value QC	RPD	Qualifier	
Benzene*	<0.050	0.050	11/06/2020	ND	1.93	96.7	2.00	7.59		
Toluene*	<0.050	0.050	11/06/2020	ND	1.90	94.8	2.00	8.30		
Ethylbenzene*	<0.050	0.050	11/06/2020	ND	1.87	93.5	2.00	8.37		
Total Xylenes*	<0.150	0.150	11/06/2020	ND	5.41	90.2	6.00	7.94		
Total BTEX	<0.300	0.300	11/06/2020	ND						

Surrogate: 4-Bromofluorobenzene (PID) 96.9 % 73.3-129

Chloride, SM4500Cl-B		mg/kg		Analyzed By: GM						
Analyte	Result	Reporting Limit	Analyzed	Method Blank	BS	% Recovery	True Value QC	RPD	Qualifier	
Chloride	48.0	16.0	11/09/2020	ND	416	104	400	0.00		

TPH 8015M		mg/kg		Analyzed By: MS					
Analyte	Result	Reporting Limit	Analyzed	Method Blank	BS	% Recovery	True Value QC	RPD	Qualifier
GRO C6-C10*	<10.0	10.0	11/06/2020	ND	197	98.4	200	3.66	
DRO >C10-C28*	<10.0	10.0	11/06/2020	ND	189	94.7	200	0.00633	
EXT DRO >C28-C36	<10.0	10.0	11/06/2020	ND					

Surrogate: 1-Chlorooctane 100 % 44.3-144

Surrogate: 1-Chlorooctadecane 110 % 42.2-156

Cardinal Laboratories

\*=Accredited Analyte

PLEASE NOTE: Liability and Damages. Cardinal's liability and client's exclusive remedy for any claim arising, whether based in contract or tort, shall be limited to the amount paid by client for analyses. All claims, including those for negligence and any other cause whatsoever shall be deemed waived unless made in writing and received by Cardinal within thirty (30) days after completion of the applicable service. In no event shall Cardinal be liable for incidental or consequential damages, including, without limitation, business interruptions, loss of use, or loss of profits incurred by client, its subsidiaries, affiliates or successors arising out of or related to the performance of the services hereunder by Cardinal, regardless of whether such claim is based upon any of the above stated reasons or otherwise. Results relate only to the samples identified above. This report shall not be reproduced except in full with written approval of Cardinal Laboratories.

Celey D. Keene, Lab Director/Quality Manager



PHONE (575) 393-2326 ° 101 E. MARLAND ° HOBBS, NM 88240

**Analytical Results For:**

BBC International, Inc.  
 Cliff Brunson  
 P.O. Box 805  
 Hobbs NM, 88241  
 Fax To: (575) 397-0397

Received:	11/05/2020	Sampling Date:	10/26/2020
Reported:	11/10/2020	Sampling Type:	Soil
Project Name:	OXBOW CEDAR CANYON 17 8 FED COM	Sampling Condition:	Cool & Intact
Project Number:	( 11-5-19 )	Sample Received By:	Tamara Oldaker
Project Location:	OXY		

**Sample ID: SP E SURFACE (H002948-02)**

BTX 8021B		mg/kg		Analyzed By: MS					
Analyte	Result	Reporting Limit	Analyzed	Method Blank	BS	% Recovery	True Value QC	RPD	Qualifier
Benzene*	<0.050	0.050	11/06/2020	ND	1.93	96.7	2.00	7.59	
Toluene*	<0.050	0.050	11/06/2020	ND	1.90	94.8	2.00	8.30	
Ethylbenzene*	<0.050	0.050	11/06/2020	ND	1.87	93.5	2.00	8.37	
Total Xylenes*	<0.150	0.150	11/06/2020	ND	5.41	90.2	6.00	7.94	
Total BTX	<0.300	0.300	11/06/2020	ND					

Surrogate: 4-Bromofluorobenzene (PID) 97.9 % 73.3-129

Chloride, SM4500CI-B		mg/kg		Analyzed By: GM					
Analyte	Result	Reporting Limit	Analyzed	Method Blank	BS	% Recovery	True Value QC	RPD	Qualifier
Chloride	96.0	16.0	11/09/2020	ND	416	104	400	0.00	

TPH 8015M		mg/kg		Analyzed By: MS					
Analyte	Result	Reporting Limit	Analyzed	Method Blank	BS	% Recovery	True Value QC	RPD	Qualifier
GRO C6-C10*	<10.0	10.0	11/06/2020	ND	197	98.4	200	3.66	
DRO >C10-C28*	<10.0	10.0	11/06/2020	ND	189	94.7	200	0.00633	
EXT DRO >C28-C36	<10.0	10.0	11/06/2020	ND					

Surrogate: 1-Chlorooctane 99.7 % 44.3-144

Surrogate: 1-Chlorooctadecane 110 % 42.2-156

Cardinal Laboratories

\*=Accredited Analyte

PLEASE NOTE: Liability and Damages. Cardinal's liability and client's exclusive remedy for any claim arising, whether based in contract or tort, shall be limited to the amount paid by client for analyses. All claims, including those for negligence and any other cause whatsoever shall be deemed waived unless made in writing and received by Cardinal within thirty (30) days after completion of the applicable service. In no event shall Cardinal be liable for incidental or consequential damages, including, without limitation, business interruptions, loss of use, or loss of profits incurred by client, its subsidiaries, affiliates or successors arising out of or related to the performance of the services hereunder by Cardinal, regardless of whether such claim is based upon any of the above stated reasons or otherwise. Results relate only to the samples identified above. This report shall not be reproduced except in full with written approval of Cardinal Laboratories.

Celey D. Keene, Lab Director/Quality Manager





PHONE (575) 393-2326 ° 101 E. MARLAND ° HOBBS, NM 88240

**Analytical Results For:**

BBC International, Inc.  
 Cliff Brunson  
 P.O. Box 805  
 Hobbs NM, 88241  
 Fax To: (575) 397-0397

Received:	11/05/2020	Sampling Date:	10/26/2020
Reported:	11/10/2020	Sampling Type:	Soil
Project Name:	OXBOW CEDAR CANYON 17 8 FED COM	Sampling Condition:	Cool & Intact
Project Number:	( 11-5-19 )	Sample Received By:	Tamara Oldaker
Project Location:	OXY		

**Sample ID: SP W SURFACE (H002948-03)**

BTX 8021B		mg/kg		Analyzed By: MS						
Analyte	Result	Reporting Limit	Analyzed	Method Blank	BS	% Recovery	True Value QC	RPD	Qualifier	
Benzene*	<0.050	0.050	11/06/2020	ND	1.93	96.7	2.00	7.59		
Toluene*	<0.050	0.050	11/06/2020	ND	1.90	94.8	2.00	8.30		
Ethylbenzene*	<0.050	0.050	11/06/2020	ND	1.87	93.5	2.00	8.37		
Total Xylenes*	<0.150	0.150	11/06/2020	ND	5.41	90.2	6.00	7.94		
Total BTX	<0.300	0.300	11/06/2020	ND						

Surrogate: 4-Bromofluorobenzene (PID) 96.5 % 73.3-129

Chloride, SM4500CI-B		mg/kg		Analyzed By: GM						
Analyte	Result	Reporting Limit	Analyzed	Method Blank	BS	% Recovery	True Value QC	RPD	Qualifier	
Chloride	96.0	16.0	11/09/2020	ND	416	104	400	0.00		

TPH 8015M		mg/kg		Analyzed By: MS					
Analyte	Result	Reporting Limit	Analyzed	Method Blank	BS	% Recovery	True Value QC	RPD	Qualifier
GRO C6-C10*	<10.0	10.0	11/06/2020	ND	197	98.4	200	3.66	
DRO >C10-C28*	<10.0	10.0	11/06/2020	ND	189	94.7	200	0.00633	
EXT DRO >C28-C36	<10.0	10.0	11/06/2020	ND					

Surrogate: 1-Chlorooctane 99.8 % 44.3-144

Surrogate: 1-Chlorooctadecane 110 % 42.2-156

Cardinal Laboratories

\*=Accredited Analyte

PLEASE NOTE: Liability and Damages. Cardinal's liability and client's exclusive remedy for any claim arising, whether based in contract or tort, shall be limited to the amount paid by client for analyses. All claims, including those for negligence and any other cause whatsoever shall be deemed waived unless made in writing and received by Cardinal within thirty (30) days after completion of the applicable service. In no event shall Cardinal be liable for incidental or consequential damages, including, without limitation, business interruptions, loss of use, or loss of profits incurred by client, its subsidiaries, affiliates or successors arising out of or related to the performance of the services hereunder by Cardinal, regardless of whether such claim is based upon any of the above stated reasons or otherwise. Results relate only to the samples identified above. This report shall not be reproduced except in full with written approval of Cardinal Laboratories.

Celey D. Keene, Lab Director/Quality Manager



PHONE (575) 393-2326 ° 101 E. MARLAND ° HOBBS, NM 88240

**Analytical Results For:**

BBC International, Inc.  
 Cliff Brunson  
 P.O. Box 805  
 Hobbs NM, 88241  
 Fax To: (575) 397-0397

Received:	11/05/2020	Sampling Date:	10/26/2020
Reported:	11/10/2020	Sampling Type:	Soil
Project Name:	OXBOW CEDAR CANYON 17 8 FED COM	Sampling Condition:	Cool & Intact
Project Number:	( 11-5-19 )	Sample Received By:	Tamara Oldaker
Project Location:	OXY		

**Sample ID: SP S SURFACE (H002948-04)**

BTX 8021B		mg/kg		Analyzed By: MS						
Analyte	Result	Reporting Limit	Analyzed	Method Blank	BS	% Recovery	True Value QC	RPD	Qualifier	
Benzene*	<0.050	0.050	11/06/2020	ND	1.93	96.7	2.00	7.59		
Toluene*	<0.050	0.050	11/06/2020	ND	1.90	94.8	2.00	8.30		
Ethylbenzene*	<0.050	0.050	11/06/2020	ND	1.87	93.5	2.00	8.37		
Total Xylenes*	<0.150	0.150	11/06/2020	ND	5.41	90.2	6.00	7.94		
Total BTX	<0.300	0.300	11/06/2020	ND						

Surrogate: 4-Bromofluorobenzene (PID) 97.5 % 73.3-129

Chloride, SM4500CI-B		mg/kg		Analyzed By: GM					
Analyte	Result	Reporting Limit	Analyzed	Method Blank	BS	% Recovery	True Value QC	RPD	Qualifier
Chloride	48.0	16.0	11/09/2020	ND	416	104	400	0.00	

TPH 8015M		mg/kg		Analyzed By: MS					
Analyte	Result	Reporting Limit	Analyzed	Method Blank	BS	% Recovery	True Value QC	RPD	Qualifier
GRO C6-C10*	<10.0	10.0	11/06/2020	ND	197	98.4	200	3.66	
DRO >C10-C28*	<10.0	10.0	11/06/2020	ND	189	94.7	200	0.00633	
EXT DRO >C28-C36	<10.0	10.0	11/06/2020	ND					

Surrogate: 1-Chlorooctane 102 % 44.3-144

Surrogate: 1-Chlorooctadecane 112 % 42.2-156

Cardinal Laboratories

\*=Accredited Analyte

PLEASE NOTE: Liability and Damages. Cardinal's liability and client's exclusive remedy for any claim arising, whether based in contract or tort, shall be limited to the amount paid by client for analyses. All claims, including those for negligence and any other cause whatsoever shall be deemed waived unless made in writing and received by Cardinal within thirty (30) days after completion of the applicable service. In no event shall Cardinal be liable for incidental or consequential damages, including, without limitation, business interruptions, loss of use, or loss of profits incurred by client, its subsidiaries, affiliates or successors arising out of or related to the performance of the services hereunder by Cardinal, regardless of whether such claim is based upon any of the above stated reasons or otherwise. Results relate only to the samples identified above. This report shall not be reproduced except in full with written approval of Cardinal Laboratories.

Celey D. Keene, Lab Director/Quality Manager



PHONE (575) 393-2326 ° 101 E. MARLAND ° HOBBS, NM 88240

**Analytical Results For:**

BBC International, Inc.  
 Cliff Brunson  
 P.O. Box 805  
 Hobbs NM, 88241  
 Fax To: (575) 397-0397

Received:	11/05/2020	Sampling Date:	10/26/2020
Reported:	11/10/2020	Sampling Type:	Soil
Project Name:	OXBOW CEDAR CANYON 17 8 FED COM	Sampling Condition:	Cool & Intact
Project Number:	( 11-5-19 )	Sample Received By:	Tamara Oldaker
Project Location:	OXY		

**Sample ID: SP 1 @ SURFACE (H002948-05)**

BTEx 8021B		mg/kg		Analyzed By: MS						
Analyte	Result	Reporting Limit	Analyzed	Method Blank	BS	% Recovery	True Value QC	RPD	Qualifier	
Benzene*	<0.050	0.050	11/06/2020	ND	1.93	96.7	2.00	7.59		
Toluene*	<0.050	0.050	11/06/2020	ND	1.90	94.8	2.00	8.30		
Ethylbenzene*	<0.050	0.050	11/06/2020	ND	1.87	93.5	2.00	8.37		
Total Xylenes*	<0.150	0.150	11/06/2020	ND	5.41	90.2	6.00	7.94		
Total BTEx	<0.300	0.300	11/06/2020	ND						

Surrogate: 4-Bromofluorobenzene (PID) 99.6 % 73.3-129

Chloride, SM4500CI-B		mg/kg		Analyzed By: GM						
Analyte	Result	Reporting Limit	Analyzed	Method Blank	BS	% Recovery	True Value QC	RPD	Qualifier	
Chloride	18400	16.0	11/09/2020	ND	416	104	400	0.00		

TPH 8015M		mg/kg		Analyzed By: MS					S-06	
Analyte	Result	Reporting Limit	Analyzed	Method Blank	BS	% Recovery	True Value QC	RPD	Qualifier	
GRO C6-C10*	<100	100	11/09/2020	ND	197	98.4	200	3.66		
DRO >C10-C28*	17200	100	11/09/2020	ND	189	94.7	200	0.00633		
EXT DRO >C28-C36	6460	100	11/09/2020	ND						

Surrogate: 1-Chlorooctane 92.8 % 44.3-144

Surrogate: 1-Chlorooctadecane 769 % 42.2-156

Cardinal Laboratories

\*=Accredited Analyte

PLEASE NOTE: Liability and Damages. Cardinal's liability and client's exclusive remedy for any claim arising, whether based in contract or tort, shall be limited to the amount paid by client for analyses. All claims, including those for negligence and any other cause whatsoever shall be deemed waived unless made in writing and received by Cardinal within thirty (30) days after completion of the applicable service. In no event shall Cardinal be liable for incidental or consequential damages, including, without limitation, business interruptions, loss of use, or loss of profits incurred by client, its subsidiaries, affiliates or successors arising out of or related to the performance of the services hereunder by Cardinal, regardless of whether such claim is based upon any of the above stated reasons or otherwise. Results relate only to the samples identified above. This report shall not be reproduced except in full with written approval of Cardinal Laboratories.

Celey D. Keene, Lab Director/Quality Manager



PHONE (575) 393-2326 ° 101 E. MARLAND ° HOBBS, NM 88240

**Analytical Results For:**

BBC International, Inc.  
 Cliff Brunson  
 P.O. Box 805  
 Hobbs NM, 88241  
 Fax To: (575) 397-0397

Received:	11/05/2020	Sampling Date:	10/26/2020
Reported:	11/10/2020	Sampling Type:	Soil
Project Name:	OXBOW CEDAR CANYON 17 8 FED COM	Sampling Condition:	Cool & Intact
Project Number:	( 11-5-19 )	Sample Received By:	Tamara Oldaker
Project Location:	OXY		

**Sample ID: SP 1 @ 1' (H002948-06)**

BTX 8021B		mg/kg		Analyzed By: MS						
Analyte	Result	Reporting Limit	Analyzed	Method Blank	BS	% Recovery	True Value QC	RPD	Qualifier	
Benzene*	<0.050	0.050	11/06/2020	ND	1.93	96.7	2.00	7.59		
Toluene*	<0.050	0.050	11/06/2020	ND	1.90	94.8	2.00	8.30		
Ethylbenzene*	<0.050	0.050	11/06/2020	ND	1.87	93.5	2.00	8.37		
Total Xylenes*	<0.150	0.150	11/06/2020	ND	5.41	90.2	6.00	7.94		
Total BTX	<0.300	0.300	11/06/2020	ND						

Surrogate: 4-Bromofluorobenzene (PID) 99.2 % 73.3-129

Chloride, SM4500Cl-B		mg/kg		Analyzed By: GM					
Analyte	Result	Reporting Limit	Analyzed	Method Blank	BS	% Recovery	True Value QC	RPD	Qualifier
Chloride	2480	16.0	11/09/2020	ND	416	104	400	0.00	

TPH 8015M		mg/kg		Analyzed By: MS					
Analyte	Result	Reporting Limit	Analyzed	Method Blank	BS	% Recovery	True Value QC	RPD	Qualifier
GRO C6-C10*	<10.0	10.0	11/09/2020	ND	197	98.4	200	3.66	
DRO >C10-C28*	718	10.0	11/09/2020	ND	189	94.7	200	0.00633	
EXT DRO >C28-C36	28.9	10.0	11/09/2020	ND					

Surrogate: 1-Chlorooctane 88.0 % 44.3-144

Surrogate: 1-Chlorooctadecane 107 % 42.2-156

Cardinal Laboratories

\*=Accredited Analyte

PLEASE NOTE: Liability and Damages. Cardinal's liability and client's exclusive remedy for any claim arising, whether based in contract or tort, shall be limited to the amount paid by client for analyses. All claims, including those for negligence and any other cause whatsoever shall be deemed waived unless made in writing and received by Cardinal within thirty (30) days after completion of the applicable service. In no event shall Cardinal be liable for incidental or consequential damages, including, without limitation, business interruptions, loss of use, or loss of profits incurred by client, its subsidiaries, affiliates or successors arising out of or related to the performance of the services hereunder by Cardinal, regardless of whether such claim is based upon any of the above stated reasons or otherwise. Results relate only to the samples identified above. This report shall not be reproduced except in full with written approval of Cardinal Laboratories.

Celey D. Keene, Lab Director/Quality Manager





PHONE (575) 393-2326 ° 101 E. MARLAND ° HOBBS, NM 88240

**Analytical Results For:**

BBC International, Inc.  
 Cliff Brunson  
 P.O. Box 805  
 Hobbs NM, 88241  
 Fax To: (575) 397-0397

Received:	11/05/2020	Sampling Date:	10/26/2020
Reported:	11/10/2020	Sampling Type:	Soil
Project Name:	OXBOW CEDAR CANYON 17 8 FED COM	Sampling Condition:	Cool & Intact
Project Number:	( 11-5-19 )	Sample Received By:	Tamara Oldaker
Project Location:	OXY		

**Sample ID: SP 2 @ SURFACE (H002948-07)**

BTEx 8021B		mg/kg		Analyzed By: MS						
Analyte	Result	Reporting Limit	Analyzed	Method Blank	BS	% Recovery	True Value QC	RPD	Qualifier	
Benzene*	<0.050	0.050	11/06/2020	ND	1.93	96.7	2.00	7.59		
Toluene*	<0.050	0.050	11/06/2020	ND	1.90	94.8	2.00	8.30		
Ethylbenzene*	<0.050	0.050	11/06/2020	ND	1.87	93.5	2.00	8.37		
Total Xylenes*	<0.150	0.150	11/06/2020	ND	5.41	90.2	6.00	7.94		
Total BTEX	<0.300	0.300	11/06/2020	ND						

Surrogate: 4-Bromofluorobenzene (PID) 96.4 % 73.3-129

Chloride, SM4500Cl-B		mg/kg		Analyzed By: GM						
Analyte	Result	Reporting Limit	Analyzed	Method Blank	BS	% Recovery	True Value QC	RPD	Qualifier	
Chloride	30800	16.0	11/09/2020	ND	416	104	400	0.00		

TPH 8015M		mg/kg		Analyzed By: MS				S-04	
Analyte	Result	Reporting Limit	Analyzed	Method Blank	BS	% Recovery	True Value QC	RPD	Qualifier
GRO C6-C10*	<10.0	10.0	11/06/2020	ND	197	98.4	200	3.66	
DRO >C10-C28*	6110	10.0	11/06/2020	ND	189	94.7	200	0.00633	
EXT DRO >C28-C36	2840	10.0	11/06/2020	ND					

Surrogate: 1-Chlorooctane 66.3 % 44.3-144

Surrogate: 1-Chlorooctadecane 302 % 42.2-156

Cardinal Laboratories

\*=Accredited Analyte

PLEASE NOTE: Liability and Damages. Cardinal's liability and client's exclusive remedy for any claim arising, whether based in contract or tort, shall be limited to the amount paid by client for analyses. All claims, including those for negligence and any other cause whatsoever shall be deemed waived unless made in writing and received by Cardinal within thirty (30) days after completion of the applicable service. In no event shall Cardinal be liable for incidental or consequential damages, including, without limitation, business interruptions, loss of use, or loss of profits incurred by client, its subsidiaries, affiliates or successors arising out of or related to the performance of the services hereunder by Cardinal, regardless of whether such claim is based upon any of the above stated reasons or otherwise. Results relate only to the samples identified above. This report shall not be reproduced except in full with written approval of Cardinal Laboratories.

Celey D. Keene, Lab Director/Quality Manager



PHONE (575) 393-2326 ° 101 E. MARLAND ° HOBBS, NM 88240

**Analytical Results For:**

BBC International, Inc.  
 Cliff Brunson  
 P.O. Box 805  
 Hobbs NM, 88241  
 Fax To: (575) 397-0397

Received:	11/05/2020	Sampling Date:	10/26/2020
Reported:	11/10/2020	Sampling Type:	Soil
Project Name:	OXBOW CEDAR CANYON 17 8 FED COM	Sampling Condition:	Cool & Intact
Project Number:	( 11-5-19 )	Sample Received By:	Tamara Oldaker
Project Location:	OXY		

**Sample ID: SP 2 @ 1' (H002948-08)**

BTEx 8021B		mg/kg		Analyzed By: MS						
Analyte	Result	Reporting Limit	Analyzed	Method Blank	BS	% Recovery	True Value QC	RPD	Qualifier	
Benzene*	<0.050	0.050	11/06/2020	ND	1.93	96.7	2.00	7.59		
Toluene*	<0.050	0.050	11/06/2020	ND	1.90	94.8	2.00	8.30		
Ethylbenzene*	<0.050	0.050	11/06/2020	ND	1.87	93.5	2.00	8.37		
Total Xylenes*	<0.150	0.150	11/06/2020	ND	5.41	90.2	6.00	7.94		
Total BTEX	<0.300	0.300	11/06/2020	ND						

Surrogate: 4-Bromofluorobenzene (PID) 98.5 % 73.3-129

Chloride, SM4500Cl-B		mg/kg		Analyzed By: GM					
Analyte	Result	Reporting Limit	Analyzed	Method Blank	BS	% Recovery	True Value QC	RPD	Qualifier
Chloride	3920	16.0	11/09/2020	ND	416	104	400	0.00	

TPH 8015M		mg/kg		Analyzed By: MS					
Analyte	Result	Reporting Limit	Analyzed	Method Blank	BS	% Recovery	True Value QC	RPD	Qualifier
GRO C6-C10*	<10.0	10.0	11/07/2020	ND	197	98.4	200	3.66	
DRO >C10-C28*	98.4	10.0	11/07/2020	ND	189	94.7	200	0.00633	
EXT DRO >C28-C36	10.9	10.0	11/07/2020	ND					

Surrogate: 1-Chlorooctane 105 % 44.3-144

Surrogate: 1-Chlorooctadecane 121 % 42.2-156

Cardinal Laboratories

\*=Accredited Analyte

PLEASE NOTE: Liability and Damages. Cardinal's liability and client's exclusive remedy for any claim arising, whether based in contract or tort, shall be limited to the amount paid by client for analyses. All claims, including those for negligence and any other cause whatsoever shall be deemed waived unless made in writing and received by Cardinal within thirty (30) days after completion of the applicable service. In no event shall Cardinal be liable for incidental or consequential damages, including, without limitation, business interruptions, loss of use, or loss of profits incurred by client, its subsidiaries, affiliates or successors arising out of or related to the performance of the services hereunder by Cardinal, regardless of whether such claim is based upon any of the above stated reasons or otherwise. Results relate only to the samples identified above. This report shall not be reproduced except in full with written approval of Cardinal Laboratories.

Celey D. Keene, Lab Director/Quality Manager



PHONE (575) 393-2326 ° 101 E. MARLAND ° HOBBS, NM 88240

**Analytical Results For:**

BBC International, Inc.  
 Cliff Brunson  
 P.O. Box 805  
 Hobbs NM, 88241  
 Fax To: (575) 397-0397

Received:	11/05/2020	Sampling Date:	10/26/2020
Reported:	11/10/2020	Sampling Type:	Soil
Project Name:	OXBOW CEDAR CANYON 17 8 FED COM	Sampling Condition:	Cool & Intact
Project Number:	( 11-5-19 )	Sample Received By:	Tamara Oldaker
Project Location:	OXY		

**Sample ID: SP 2 @ 2' (H002948-09)**

BTEx 8021B		mg/kg		Analyzed By: MS						
Analyte	Result	Reporting Limit	Analyzed	Method Blank	BS	% Recovery	True Value QC	RPD	Qualifier	
Benzene*	<0.050	0.050	11/06/2020	ND	1.93	96.7	2.00	7.59		
Toluene*	<0.050	0.050	11/06/2020	ND	1.90	94.8	2.00	8.30		
Ethylbenzene*	<0.050	0.050	11/06/2020	ND	1.87	93.5	2.00	8.37		
Total Xylenes*	<0.150	0.150	11/06/2020	ND	5.41	90.2	6.00	7.94		
Total BTEX	<0.300	0.300	11/06/2020	ND						

Surrogate: 4-Bromofluorobenzene (PID) 99.6 % 73.3-129

Chloride, SM4500Cl-B		mg/kg		Analyzed By: GM					
Analyte	Result	Reporting Limit	Analyzed	Method Blank	BS	% Recovery	True Value QC	RPD	Qualifier
Chloride	2720	16.0	11/09/2020	ND	416	104	400	0.00	

TPH 8015M		mg/kg		Analyzed By: MS					
Analyte	Result	Reporting Limit	Analyzed	Method Blank	BS	% Recovery	True Value QC	RPD	Qualifier
GRO C6-C10*	<10.0	10.0	11/07/2020	ND	197	98.4	200	3.66	
DRO >C10-C28*	168	10.0	11/07/2020	ND	189	94.7	200	0.00633	
EXT DRO >C28-C36	23.2	10.0	11/07/2020	ND					

Surrogate: 1-Chlorooctane 105 % 44.3-144

Surrogate: 1-Chlorooctadecane 121 % 42.2-156

Cardinal Laboratories

\*=Accredited Analyte

PLEASE NOTE: Liability and Damages. Cardinal's liability and client's exclusive remedy for any claim arising, whether based in contract or tort, shall be limited to the amount paid by client for analyses. All claims, including those for negligence and any other cause whatsoever shall be deemed waived unless made in writing and received by Cardinal within thirty (30) days after completion of the applicable service. In no event shall Cardinal be liable for incidental or consequential damages, including, without limitation, business interruptions, loss of use, or loss of profits incurred by client, its subsidiaries, affiliates or successors arising out of or related to the performance of the services hereunder by Cardinal, regardless of whether such claim is based upon any of the above stated reasons or otherwise. Results relate only to the samples identified above. This report shall not be reproduced except in full with written approval of Cardinal Laboratories.

Celey D. Keene, Lab Director/Quality Manager



PHONE (575) 393-2326 ° 101 E. MARLAND ° HOBBS, NM 88240

**Analytical Results For:**

BBC International, Inc.  
 Cliff Brunson  
 P.O. Box 805  
 Hobbs NM, 88241  
 Fax To: (575) 397-0397

Received:	11/05/2020	Sampling Date:	10/28/2020
Reported:	11/10/2020	Sampling Type:	Soil
Project Name:	OXBOW CEDAR CANYON 17 8 FED COM	Sampling Condition:	Cool & Intact
Project Number:	( 11-5-19 )	Sample Received By:	Tamara Oldaker
Project Location:	OXY		

**Sample ID: SP 3 @ SURFACE (H002948-10)**

BTEx 8021B		mg/kg		Analyzed By: MS						
Analyte	Result	Reporting Limit	Analyzed	Method Blank	BS	% Recovery	True Value QC	RPD	Qualifier	
Benzene*	<0.050	0.050	11/06/2020	ND	1.93	96.7	2.00	7.59		
Toluene*	<0.050	0.050	11/06/2020	ND	1.90	94.8	2.00	8.30		
Ethylbenzene*	<0.050	0.050	11/06/2020	ND	1.87	93.5	2.00	8.37		
Total Xylenes*	<0.150	0.150	11/06/2020	ND	5.41	90.2	6.00	7.94		
Total BTEX	<0.300	0.300	11/06/2020	ND						

Surrogate: 4-Bromofluorobenzene (PID) 97.9 % 73.3-129

Chloride, SM4500Cl-B		mg/kg		Analyzed By: GM						
Analyte	Result	Reporting Limit	Analyzed	Method Blank	BS	% Recovery	True Value QC	RPD	Qualifier	
Chloride	1840	16.0	11/09/2020	ND	416	104	400	0.00		

TPH 8015M		mg/kg		Analyzed By: MS					
Analyte	Result	Reporting Limit	Analyzed	Method Blank	BS	% Recovery	True Value QC	RPD	Qualifier
GRO C6-C10*	<10.0	10.0	11/07/2020	ND	197	98.4	200	3.66	
DRO >C10-C28*	230	10.0	11/07/2020	ND	189	94.7	200	0.00633	
EXT DRO >C28-C36	<10.0	10.0	11/07/2020	ND					

Surrogate: 1-Chlorooctane 88.2 % 44.3-144

Surrogate: 1-Chlorooctadecane 107 % 42.2-156

Cardinal Laboratories

\*=Accredited Analyte

PLEASE NOTE: Liability and Damages. Cardinal's liability and client's exclusive remedy for any claim arising, whether based in contract or tort, shall be limited to the amount paid by client for analyses. All claims, including those for negligence and any other cause whatsoever shall be deemed waived unless made in writing and received by Cardinal within thirty (30) days after completion of the applicable service. In no event shall Cardinal be liable for incidental or consequential damages, including, without limitation, business interruptions, loss of use, or loss of profits incurred by client, its subsidiaries, affiliates or successors arising out of or related to the performance of the services hereunder by Cardinal, regardless of whether such claim is based upon any of the above stated reasons or otherwise. Results relate only to the samples identified above. This report shall not be reproduced except in full with written approval of Cardinal Laboratories.

Celey D. Keene, Lab Director/Quality Manager





PHONE (575) 393-2326 ° 101 E. MARLAND ° HOBBS, NM 88240

**Analytical Results For:**

BBC International, Inc.  
 Cliff Brunson  
 P.O. Box 805  
 Hobbs NM, 88241  
 Fax To: (575) 397-0397

Received:	11/05/2020	Sampling Date:	10/28/2020
Reported:	11/10/2020	Sampling Type:	Soil
Project Name:	OXBOW CEDAR CANYON 17 8 FED COM	Sampling Condition:	Cool & Intact
Project Number:	( 11-5-19 )	Sample Received By:	Tamara Oldaker
Project Location:	OXY		

**Sample ID: SP 3 @ 1' (H002948-11)**

BTX 8021B		mg/kg		Analyzed By: MS					
Analyte	Result	Reporting Limit	Analyzed	Method Blank	BS	% Recovery	True Value QC	RPD	Qualifier
Benzene*	<0.050	0.050	11/06/2020	ND	1.93	96.7	2.00	7.59	
Toluene*	<0.050	0.050	11/06/2020	ND	1.90	94.8	2.00	8.30	
Ethylbenzene*	<0.050	0.050	11/06/2020	ND	1.87	93.5	2.00	8.37	
Total Xylenes*	<0.150	0.150	11/06/2020	ND	5.41	90.2	6.00	7.94	
Total BTX	<0.300	0.300	11/06/2020	ND					

Surrogate: 4-Bromofluorobenzene (PID) 98.5 % 73.3-129

Chloride, SM4500CI-B		mg/kg		Analyzed By: GM					
Analyte	Result	Reporting Limit	Analyzed	Method Blank	BS	% Recovery	True Value QC	RPD	Qualifier
Chloride	1120	16.0	11/09/2020	ND	416	104	400	0.00	

TPH 8015M		mg/kg		Analyzed By: MS					
Analyte	Result	Reporting Limit	Analyzed	Method Blank	BS	% Recovery	True Value QC	RPD	Qualifier
GRO C6-C10*	<10.0	10.0	11/07/2020	ND	197	98.4	200	3.66	
DRO >C10-C28*	16.9	10.0	11/07/2020	ND	189	94.7	200	0.00633	
EXT DRO >C28-C36	<10.0	10.0	11/07/2020	ND					

Surrogate: 1-Chlorooctane 78.5 % 44.3-144

Surrogate: 1-Chlorooctadecane 90.7 % 42.2-156

Cardinal Laboratories

\*=Accredited Analyte

PLEASE NOTE: Liability and Damages. Cardinal's liability and client's exclusive remedy for any claim arising, whether based in contract or tort, shall be limited to the amount paid by client for analyses. All claims, including those for negligence and any other cause whatsoever shall be deemed waived unless made in writing and received by Cardinal within thirty (30) days after completion of the applicable service. In no event shall Cardinal be liable for incidental or consequential damages, including, without limitation, business interruptions, loss of use, or loss of profits incurred by client, its subsidiaries, affiliates or successors arising out of or related to the performance of the services hereunder by Cardinal, regardless of whether such claim is based upon any of the above stated reasons or otherwise. Results relate only to the samples identified above. This report shall not be reproduced except in full with written approval of Cardinal Laboratories.

Celey D. Keene, Lab Director/Quality Manager



PHONE (575) 393-2326 ° 101 E. MARLAND ° HOBBS, NM 88240

**Analytical Results For:**

BBC International, Inc.  
 Cliff Brunson  
 P.O. Box 805  
 Hobbs NM, 88241  
 Fax To: (575) 397-0397

Received:	11/05/2020	Sampling Date:	10/28/2020
Reported:	11/10/2020	Sampling Type:	Soil
Project Name:	OXBOW CEDAR CANYON 17 8 FED COM	Sampling Condition:	Cool & Intact
Project Number:	( 11-5-19 )	Sample Received By:	Tamara Oldaker
Project Location:	OXY		

**Sample ID: SP 3 @ 2' (H002948-12)**

Chloride, SM4500Cl-B		mg/kg		Analyzed By: GM						
Analyte	Result	Reporting Limit	Analyzed	Method Blank	BS	% Recovery	True Value QC	RPD	Qualifier	
Chloride	688	16.0	11/09/2020	ND	416	104	400	0.00		

Cardinal Laboratories

\*=Accredited Analyte

PLEASE NOTE: Liability and Damages. Cardinal's liability and client's exclusive remedy for any claim arising, whether based in contract or tort, shall be limited to the amount paid by client for analyses. All claims, including those for negligence and any other cause whatsoever shall be deemed waived unless made in writing and received by Cardinal within thirty (30) days after completion of the applicable service. In no event shall Cardinal be liable for incidental or consequential damages, including, without limitation, business interruptions, loss of use, or loss of profits incurred by client, its subsidiaries, affiliates or successors arising out of or related to the performance of the services hereunder by Cardinal, regardless of whether such claim is based upon any of the above stated reasons or otherwise. Results relate only to the samples identified above. This report shall not be reproduced except in full with written approval of Cardinal Laboratories.

Celey D. Keene, Lab Director/Quality Manager



PHONE (575) 393-2326 • 101 E. MARLAND • HOBBS, NM 88240

**Analytical Results For:**

BBC International, Inc.  
 Cliff Brunson  
 P.O. Box 805  
 Hobbs NM, 88241  
 Fax To: (575) 397-0397

Received:	11/05/2020	Sampling Date:	10/28/2020
Reported:	11/10/2020	Sampling Type:	Soil
Project Name:	OXBOW CEDAR CANYON 17 8 FED COM	Sampling Condition:	Cool & Intact
Project Number:	( 11-5-19 )	Sample Received By:	Tamara Oldaker
Project Location:	OXY		

**Sample ID: SP 4 @ SURFACE (H002948-13)**

BTX 8021B		mg/kg		Analyzed By: MS						
Analyte	Result	Reporting Limit	Analyzed	Method Blank	BS	% Recovery	True Value QC	RPD	Qualifier	
Benzene*	<0.050	0.050	11/06/2020	ND	1.93	96.7	2.00	7.59		
Toluene*	<0.050	0.050	11/06/2020	ND	1.90	94.8	2.00	8.30		
Ethylbenzene*	<0.050	0.050	11/06/2020	ND	1.87	93.5	2.00	8.37		
Total Xylenes*	0.374	0.150	11/06/2020	ND	5.41	90.2	6.00	7.94		
Total BTX	0.374	0.300	11/06/2020	ND						

Surrogate: 4-Bromofluorobenzene (PID) 110 % 73.3-129

Chloride, SM4500Cl-B		mg/kg		Analyzed By: GM						
Analyte	Result	Reporting Limit	Analyzed	Method Blank	BS	% Recovery	True Value QC	RPD	Qualifier	
Chloride	7200	16.0	11/09/2020	ND	416	104	400	0.00		

TPH 8015M		mg/kg		Analyzed By: MS				S-06	
Analyte	Result	Reporting Limit	Analyzed	Method Blank	BS	% Recovery	True Value QC	RPD	Qualifier
GRO C6-C10*	<100	100	11/09/2020	ND	197	98.4	200	3.66	
<b>DRO &gt;C10-C28*</b>	<b>14600</b>	100	11/09/2020	ND	189	94.7	200	0.00633	
EXT DRO >C28-C36	<100	100	11/09/2020	ND					

Surrogate: 1-Chlorooctane 115 % 44.3-144

Surrogate: 1-Chlorooctadecane 574 % 42.2-156

Cardinal Laboratories

\*=Accredited Analyte

PLEASE NOTE: Liability and Damages. Cardinal's liability and client's exclusive remedy for any claim arising, whether based in contract or tort, shall be limited to the amount paid by client for analyses. All claims, including those for negligence and any other cause whatsoever shall be deemed waived unless made in writing and received by Cardinal within thirty (30) days after completion of the applicable service. In no event shall Cardinal be liable for incidental or consequential damages, including, without limitation, business interruptions, loss of use, or loss of profits incurred by client, its subsidiaries, affiliates or successors arising out of or related to the performance of the services hereunder by Cardinal, regardless of whether such claim is based upon any of the above stated reasons or otherwise. Results relate only to the samples identified above. This report shall not be reproduced except in full with written approval of Cardinal Laboratories.

Celey D. Keene, Lab Director/Quality Manager



PHONE (575) 393-2326 ° 101 E. MARLAND ° HOBBS, NM 88240

**Analytical Results For:**

BBC International, Inc.  
 Cliff Brunson  
 P.O. Box 805  
 Hobbs NM, 88241  
 Fax To: (575) 397-0397

Received:	11/05/2020	Sampling Date:	10/28/2020
Reported:	11/10/2020	Sampling Type:	Soil
Project Name:	OXBOW CEDAR CANYON 17 8 FED COM	Sampling Condition:	Cool & Intact
Project Number:	( 11-5-19 )	Sample Received By:	Tamara Oldaker
Project Location:	OXY		

**Sample ID: SP 4 @ 1' (H002948-14)**

BTEx 8021B		mg/kg		Analyzed By: MS				S-04	
Analyte	Result	Reporting Limit	Analyzed	Method Blank	BS	% Recovery	True Value QC	RPD	Qualifier
Benzene*	<0.050	0.050	11/06/2020	ND	1.93	96.7	2.00	7.59	
Toluene*	<0.050	0.050	11/06/2020	ND	1.90	94.8	2.00	8.30	
Ethylbenzene*	<0.050	0.050	11/06/2020	ND	1.87	93.5	2.00	8.37	
<b>Total Xylenes*</b>	<b>0.752</b>	0.150	11/06/2020	ND	5.41	90.2	6.00	7.94	
<b>Total BTEX</b>	<b>0.852</b>	0.300	11/06/2020	ND					

Surrogate: 4-Bromofluorobenzene (PID) 131 % 73.3-129

Chloride, SM4500Cl-B		mg/kg		Analyzed By: GM				S-04	
Analyte	Result	Reporting Limit	Analyzed	Method Blank	BS	% Recovery	True Value QC	RPD	Qualifier
<b>Chloride</b>	<b>3560</b>	16.0	11/09/2020	ND	416	104	400	0.00	
TPH 8015M		mg/kg		Analyzed By: MS				S-04	
Analyte	Result	Reporting Limit	Analyzed	Method Blank	BS	% Recovery	True Value QC	RPD	Qualifier
<b>GRO C6-C10*</b>	<b>72.3</b>	10.0	11/07/2020	ND	203	101	200	3.39	
<b>DRO &gt;C10-C28*</b>	<b>7760</b>	10.0	11/07/2020	ND	206	103	200	5.64	QM-07, QR-03
<b>EXT DRO &gt;C28-C36</b>	<b>82.6</b>	10.0	11/07/2020	ND					

Surrogate: 1-Chlorooctane 174 % 44.3-144

Surrogate: 1-Chlorooctadecane 324 % 42.2-156

Cardinal Laboratories

\*=Accredited Analyte

PLEASE NOTE: Liability and Damages. Cardinal's liability and client's exclusive remedy for any claim arising, whether based in contract or tort, shall be limited to the amount paid by client for analyses. All claims, including those for negligence and any other cause whatsoever shall be deemed waived unless made in writing and received by Cardinal within thirty (30) days after completion of the applicable service. In no event shall Cardinal be liable for incidental or consequential damages, including, without limitation, business interruptions, loss of use, or loss of profits incurred by client, its subsidiaries, affiliates or successors arising out of or related to the performance of the services hereunder by Cardinal, regardless of whether such claim is based upon any of the above stated reasons or otherwise. Results relate only to the samples identified above. This report shall not be reproduced except in full with written approval of Cardinal Laboratories.

Celey D. Keene, Lab Director/Quality Manager



PHONE (575) 393-2326 ° 101 E. MARLAND ° HOBBS, NM 88240

**Analytical Results For:**

BBC International, Inc.  
 Cliff Brunson  
 P.O. Box 805  
 Hobbs NM, 88241  
 Fax To: (575) 397-0397

Received:	11/05/2020	Sampling Date:	10/28/2020
Reported:	11/10/2020	Sampling Type:	Soil
Project Name:	OXBOW CEDAR CANYON 17 8 FED COM	Sampling Condition:	Cool & Intact
Project Number:	( 11-5-19 )	Sample Received By:	Tamara Oldaker
Project Location:	OXY		

**Sample ID: SP 4 @ 2' (H002948-15)**

BTX 8021B		mg/kg		Analyzed By: MS				S-04	
Analyte	Result	Reporting Limit	Analyzed	Method Blank	BS	% Recovery	True Value QC	RPD	Qualifier
Benzene*	<0.050	0.050	11/07/2020	ND	2.11	105	2.00	3.82	
Toluene*	<0.050	0.050	11/07/2020	ND	2.05	102	2.00	3.88	
Ethylbenzene*	<0.050	0.050	11/07/2020	ND	2.04	102	2.00	5.04	
<b>Total Xylenes*</b>	<b>0.560</b>	0.150	11/07/2020	ND	5.89	98.1	6.00	5.22	
<b>Total BTX</b>	<b>0.560</b>	0.300	11/07/2020	ND					

Surrogate: 4-Bromofluorobenzene (PID) 146 % 73.3-129

Chloride, SM4500Cl-B		mg/kg		Analyzed By: GM					
Analyte	Result	Reporting Limit	Analyzed	Method Blank	BS	% Recovery	True Value QC	RPD	Qualifier
<b>Chloride</b>	<b>1840</b>	16.0	11/09/2020	ND	416	104	400	0.00	

TPH 8015M		mg/kg		Analyzed By: MS				S-04	
Analyte	Result	Reporting Limit	Analyzed	Method Blank	BS	% Recovery	True Value QC	RPD	Qualifier
<b>GRO C6-C10*</b>	<b>95.1</b>	10.0	11/07/2020	ND	203	101	200	3.39	
<b>DRO &gt;C10-C28*</b>	<b>6230</b>	10.0	11/07/2020	ND	206	103	200	5.64	
<b>EXT DRO &gt;C28-C36</b>	<b>67.1</b>	10.0	11/07/2020	ND					

Surrogate: 1-Chlorooctane 175 % 44.3-144

Surrogate: 1-Chlorooctadecane 264 % 42.2-156

Cardinal Laboratories

\*=Accredited Analyte

PLEASE NOTE: Liability and Damages. Cardinal's liability and client's exclusive remedy for any claim arising, whether based in contract or tort, shall be limited to the amount paid by client for analyses. All claims, including those for negligence and any other cause whatsoever shall be deemed waived unless made in writing and received by Cardinal within thirty (30) days after completion of the applicable service. In no event shall Cardinal be liable for incidental or consequential damages, including, without limitation, business interruptions, loss of use, or loss of profits incurred by client, its subsidiaries, affiliates or successors arising out of or related to the performance of the services hereunder by Cardinal, regardless of whether such claim is based upon any of the above stated reasons or otherwise. Results relate only to the samples identified above. This report shall not be reproduced except in full with written approval of Cardinal Laboratories.

Celey D. Keene, Lab Director/Quality Manager





PHONE (575) 393-2326 • 101 E. MARLAND • HOBBS, NM 88240

**Analytical Results For:**

BBC International, Inc.  
 Cliff Brunson  
 P.O. Box 805  
 Hobbs NM, 88241  
 Fax To: (575) 397-0397

Received:	11/05/2020	Sampling Date:	10/28/2020
Reported:	11/10/2020	Sampling Type:	Soil
Project Name:	OXBOW CEDAR CANYON 17 8 FED COM	Sampling Condition:	Cool & Intact
Project Number:	( 11-5-19 )	Sample Received By:	Tamara Oldaker
Project Location:	OXY		

**Sample ID: SP 5 @ SURFACE (H002948-16)**

BTEx 8021B		mg/kg		Analyzed By: MS						
Analyte	Result	Reporting Limit	Analyzed	Method Blank	BS	% Recovery	True Value QC	RPD	Qualifier	
Benzene*	<0.050	0.050	11/07/2020	ND	2.11	105	2.00	3.82		
Toluene*	<0.050	0.050	11/07/2020	ND	2.05	102	2.00	3.88		
Ethylbenzene*	<0.050	0.050	11/07/2020	ND	2.04	102	2.00	5.04		
Total Xylenes*	<0.150	0.150	11/07/2020	ND	5.89	98.1	6.00	5.22		
Total BTEx	<0.300	0.300	11/07/2020	ND						

Surrogate: 4-Bromofluorobenzene (PID) 98.6 % 73.3-129

Chloride, SM4500Cl-B		mg/kg		Analyzed By: GM					
Analyte	Result	Reporting Limit	Analyzed	Method Blank	BS	% Recovery	True Value QC	RPD	Qualifier
Chloride	9520	16.0	11/09/2020	ND	416	104	400	0.00	

TPH 8015M		mg/kg		Analyzed By: MS					
Analyte	Result	Reporting Limit	Analyzed	Method Blank	BS	% Recovery	True Value QC	RPD	Qualifier
GRO C6-C10*	<10.0	10.0	11/07/2020	ND	203	101	200	3.39	
DRO >C10-C28*	186	10.0	11/07/2020	ND	206	103	200	5.64	
EXT DRO >C28-C36	34.3	10.0	11/07/2020	ND					

Surrogate: 1-Chlorooctane 105 % 44.3-144

Surrogate: 1-Chlorooctadecane 124 % 42.2-156

Cardinal Laboratories

\*=Accredited Analyte

PLEASE NOTE: Liability and Damages. Cardinal's liability and client's exclusive remedy for any claim arising, whether based in contract or tort, shall be limited to the amount paid by client for analyses. All claims, including those for negligence and any other cause whatsoever shall be deemed waived unless made in writing and received by Cardinal within thirty (30) days after completion of the applicable service. In no event shall Cardinal be liable for incidental or consequential damages, including, without limitation, business interruptions, loss of use, or loss of profits incurred by client, its subsidiaries, affiliates or successors arising out of or related to the performance of the services hereunder by Cardinal, regardless of whether such claim is based upon any of the above stated reasons or otherwise. Results relate only to the samples identified above. This report shall not be reproduced except in full with written approval of Cardinal Laboratories.

Celey D. Keene, Lab Director/Quality Manager



PHONE (575) 393-2326 ° 101 E. MARLAND ° HOBBS, NM 88240

**Analytical Results For:**

BBC International, Inc.  
 Cliff Brunson  
 P.O. Box 805  
 Hobbs NM, 88241  
 Fax To: (575) 397-0397

Received:	11/05/2020	Sampling Date:	10/28/2020
Reported:	11/10/2020	Sampling Type:	Soil
Project Name:	OXBOW CEDAR CANYON 17 8 FED COM	Sampling Condition:	Cool & Intact
Project Number:	( 11-5-19 )	Sample Received By:	Tamara Oldaker
Project Location:	OXY		

**Sample ID: SP 5 @ 1' (H002948-17)**

BTEX 8021B		mg/kg		Analyzed By: MS						
Analyte	Result	Reporting Limit	Analyzed	Method Blank	BS	% Recovery	True Value QC	RPD	Qualifier	
Benzene*	<0.050	0.050	11/07/2020	ND	2.11	105	2.00	3.82		
Toluene*	<0.050	0.050	11/07/2020	ND	2.05	102	2.00	3.88		
Ethylbenzene*	<0.050	0.050	11/07/2020	ND	2.04	102	2.00	5.04		
Total Xylenes*	<0.150	0.150	11/07/2020	ND	5.89	98.1	6.00	5.22		
Total BTEX	<0.300	0.300	11/07/2020	ND						

Surrogate: 4-Bromofluorobenzene (PID) 97.8 % 73.3-129

Chloride, SM4500Cl-B		mg/kg		Analyzed By: GM						
Analyte	Result	Reporting Limit	Analyzed	Method Blank	BS	% Recovery	True Value QC	RPD	Qualifier	
Chloride	784	16.0	11/09/2020	ND	416	104	400	0.00		

TPH 8015M		mg/kg		Analyzed By: MS					
Analyte	Result	Reporting Limit	Analyzed	Method Blank	BS	% Recovery	True Value QC	RPD	Qualifier
GRO C6-C10*	<10.0	10.0	11/07/2020	ND	203	101	200	3.39	
DRO >C10-C28*	<10.0	10.0	11/07/2020	ND	206	103	200	5.64	
EXT DRO >C28-C36	<10.0	10.0	11/07/2020	ND					

Surrogate: 1-Chlorooctane 104 % 44.3-144

Surrogate: 1-Chlorooctadecane 116 % 42.2-156

Cardinal Laboratories

\*=Accredited Analyte

PLEASE NOTE: Liability and Damages. Cardinal's liability and client's exclusive remedy for any claim arising, whether based in contract or tort, shall be limited to the amount paid by client for analyses. All claims, including those for negligence and any other cause whatsoever shall be deemed waived unless made in writing and received by Cardinal within thirty (30) days after completion of the applicable service. In no event shall Cardinal be liable for incidental or consequential damages, including, without limitation, business interruptions, loss of use, or loss of profits incurred by client, its subsidiaries, affiliates or successors arising out of or related to the performance of the services hereunder by Cardinal, regardless of whether such claim is based upon any of the above stated reasons or otherwise. Results relate only to the samples identified above. This report shall not be reproduced except in full with written approval of Cardinal Laboratories.

Celey D. Keene, Lab Director/Quality Manager



PHONE (575) 393-2326 ° 101 E. MARLAND ° HOBBS, NM 88240

**Analytical Results For:**

BBC International, Inc.  
 Cliff Brunson  
 P.O. Box 805  
 Hobbs NM, 88241  
 Fax To: (575) 397-0397

Received:	11/05/2020	Sampling Date:	10/28/2020
Reported:	11/10/2020	Sampling Type:	Soil
Project Name:	OXBOW CEDAR CANYON 17 8 FED COM	Sampling Condition:	Cool & Intact
Project Number:	( 11-5-19 )	Sample Received By:	Tamara Oldaker
Project Location:	OXY		

**Sample ID: SP 5 @ 2' (H002948-18)**

Chloride, SM4500Cl-B		mg/kg		Analyzed By: GM						
Analyte	Result	Reporting Limit	Analyzed	Method Blank	BS	% Recovery	True Value QC	RPD	Qualifier	
Chloride	528	16.0	11/09/2020	ND	416	104	400	0.00		

Cardinal Laboratories

\*=Accredited Analyte

PLEASE NOTE: Liability and Damages. Cardinal's liability and client's exclusive remedy for any claim arising, whether based in contract or tort, shall be limited to the amount paid by client for analyses. All claims, including those for negligence and any other cause whatsoever shall be deemed waived unless made in writing and received by Cardinal within thirty (30) days after completion of the applicable service. In no event shall Cardinal be liable for incidental or consequential damages, including, without limitation, business interruptions, loss of use, or loss of profits incurred by client, its subsidiaries, affiliates or successors arising out of or related to the performance of the services hereunder by Cardinal, regardless of whether such claim is based upon any of the above stated reasons or otherwise. Results relate only to the samples identified above. This report shall not be reproduced except in full with written approval of Cardinal Laboratories.

Celey D. Keene, Lab Director/Quality Manager



PHONE (575) 393-2326 • 101 E. MARLAND • HOBBS, NM 88240

### Notes and Definitions

S-06	The recovery of this surrogate is outside control limits due to sample dilution required from high analyte concentration and/or matrix interference's.
S-04	The surrogate recovery for this sample is outside of established control limits due to a sample matrix effect.
QR-03	The RPD value for the sample duplicate or MS/MSD was outside of QC acceptance limits due to matrix interference. QC batch accepted based on LCS and/or LCSD recovery and/or RPD values.
QM-07	The spike recovery was outside acceptance limits for the MS and/or MSD. The batch was accepted based on acceptable LCS recovery.
ND	Analyte NOT DETECTED at or above the reporting limit
RPD	Relative Percent Difference
**	Samples not received at proper temperature of 6°C or below.
***	Insufficient time to reach temperature.
-	Chloride by SM4500Cl-B does not require samples be received at or below 6°C Samples reported on an as received basis (wet) unless otherwise noted on report

Cardinal Laboratories

\*=Accredited Analyte

PLEASE NOTE: Liability and Damages. Cardinal's liability and client's exclusive remedy for any claim arising, whether based in contract or tort, shall be limited to the amount paid by client for analyses. All claims, including those for negligence and any other cause whatsoever shall be deemed waived unless made in writing and received by Cardinal within thirty (30) days after completion of the applicable service. In no event shall Cardinal be liable for incidental or consequential damages, including, without limitation, business interruptions, loss of use, or loss of profits incurred by client, its subsidiaries, affiliates or successors arising out of or related to the performance of the services hereunder by Cardinal, regardless of whether such claim is based upon any of the above stated reasons or otherwise. Results relate only to the samples identified above. This report shall not be reproduced except in full with written approval of Cardinal Laboratories.

Celey D. Keene, Lab Director/Quality Manager



## ARDINAL LABORATORIES

101 East Marland, Hobbs, NM 88240  
(505) 393-2326 FAX (505) 393-2476

## CHAIN-OF-CUSTODY AND ANALYSIS REQUEST

Page 1 of 2

Company Name: BBC International, Inc.  
Project Manager: Cliff Brunson  
Address: P.O. Box 805  
City: Hobbs  
Phone #: 575-397-6388  
Fax #: 575-397-0397  
Project #:  
Project Name: Oxbow Cedar Canyon 17 8 Fed Com #32H - 11-5-19  
Project Location:  
Sampler Name: Simon Rendon

BILL TO  
P.O. #:  
Company: Oxy  
Attn:  
Address:  
City:  
State:  
Zip:  
Phone #:  
Fax #:

ANALYSIS REQUEST

Lab I.D.	Sample I.D.	(G)RAB OR (C)OMP.	# CONTAINERS	MATRIX	PRESERV	SAMPLING	DATE	TIME	Chloride	TPH Ext	BTEX
1002948	SP N SURFACE		1	GROUNDWATER			10-26-20	9:40 AM	✓	✓	✓
	SP E SURFACE			WASTEWATER			10-26-20	10:05	✓	✓	✓
	SP W SURFACE			SOIL			10-26-20	10:22	✓	✓	✓
	SP S SURFACE			OIL			10-26-20	10:40	✓	✓	✓
	SP1 @ SURFACE			SLUDGE			10-26-20	11:04	✓	✓	✓
	SP1 @ 1'			OTHER :			10-26-20	11:28	✓	✓	✓
	SP2 @ SURFACE			ACID/BASE:			10-26-20	11:47	✓	✓	✓
	SP2 @ 1'			ICE / COOL			10-26-20	12:20	✓	✓	✓
	SP2 @ 2'			OTHER :			10-26-20	12:47	✓	✓	✓
	SP3 @ SURFACE						10-28-20	10:20	✓	✓	✓

PLEASE NOTE: Liability and Damages. Cardinal's liability and client's exclusive remedy for any claim arising whether based in contract or tort, shall be limited to the amount paid by the client for the analyses. All claims, including those for negligence and any other cause whatsoever shall be deemed waived unless made in writing and received by Cardinal within 30 days after completion of the applicable service. In no event shall Cardinal be liable for incidental or consequential damages, including without limitation, business interruption, loss of use, or loss of profits incurred by client, its subsidiaries, affiliates or successors arising out of or related to the performance of services hereunder by Cardinal, regardless of whether such claim is based upon any of the above stated reasons or otherwise.

Relinquished By:

Date: 11-5-20

Received By:

Relinquished By:

Date: 11-5-20

Received By:

Delivered By: (Circle One)

Sampler - UPS - Bus - Other:

-1.7° #113

Sample Condition  
Cool ☐ Yes ☐ No  
Intact ☐ Yes ☐ No

CHECKED BY:

(Initials)

Phone Result: ☐ Yes ☐ No  
Fax Result: ☐ Yes ☐ No  
Add'l Phone #:   
Add'l Fax #:   
REMARKS:

† Cardinal cannot accept verbal changes. Please fax written changes to 505-393-2476





## ARDINAL LABORATORIES

101 East Marland, Hobbs, NM 88240  
(505) 393-2326 FAX (505) 393-2476

## CHAIN-OF-CUSTODY AND ANALYSIS REQUEST

Pg. 2 of 2

<b>Company Name:</b> BBC International, Inc. <b>Project Manager:</b> Cliff Brunson <b>Address:</b> P.O. Box 805 <b>City:</b> Hobbs <b>Phone #:</b> 575-397-6388 <b>State:</b> NM <b>Zip:</b> 88241 <b>Fax #:</b> 575-397-0397 <b>Project #:</b> <b>Project Name:</b> Oxbow Cedar Canyon 17 8 Fed Com #32H - 11-5-19 <b>Project Location:</b> <b>Sampler Name:</b> Simon Rendon		<b>P.O. #:</b> <b>Company:</b> QY <b>Attn:</b> <b>Address:</b> <b>City:</b> <b>State:</b> <b>Zip:</b> <b>Phone #:</b> <b>Fax #:</b>	
<b>Lab I.D.</b> H002946		<b>Sample I.D.</b>	
SP3 @ 1' SP3 @ 2' SP4 @ SURFACE SP4 @ 1' SP4 @ 2' SP5 @ SURFACE SP5 @ 1' SP5 @ 2'		(G)RAB OR (C)OMP. # CONTAINERS GROUNDWATER WASTEWATER SOIL OIL SLUDGE OTHER: ACID/BASE: ICE / COOL OTHER:	
DATE TIME		DATE TIME	
Chloride TPH Ext BTEX		ANALYSIS REQUEST	
Relinquished By: [Signature] Date: 11-28-20 Time: 1:00 PM Received By: [Signature] Date: 11-25-20 Time: 1:40 PM Delivered By: (Circle One) UPS - Bus - Other: 1.7c #113 Sample Condition: Cool Intact Checked By: [Signature] (Initials)		Phone Result: <input type="checkbox"/> Yes <input type="checkbox"/> No Fax Result: <input type="checkbox"/> Yes <input type="checkbox"/> No Add'l Phone #: Add'l Fax #: REMARKS:	

† Cardinal cannot accept verbal changes. Please fax written changes to 505-393-2476



PHONE (575) 393-2326 ° 101 E. MARLAND ° HOBBS, NM 88240

---

June 16, 2021

Cliff Brunson

BBC International, Inc.

P.O. Box 805

Hobbs, NM 88241

RE: OXBOW CEDAR CANYON 17 8 FED COM #32H

Enclosed are the results of analyses for samples received by the laboratory on 06/14/21 11:45.

Cardinal Laboratories is accredited through Texas NELAP under certificate number T104704398-20-13. Accreditation applies to drinking water, non-potable water and solid and chemical materials. All accredited analytes are denoted by an asterisk (\*). For a complete list of accredited analytes and matrices visit the TCEQ website at [www.tceq.texas.gov/field/qa/lab\\_accred\\_certif.html](http://www.tceq.texas.gov/field/qa/lab_accred_certif.html).

Cardinal Laboratories is accredited through the State of Colorado Department of Public Health and Environment for:

Method EPA 552.2	Haloacetic Acids (HAA-5)
Method EPA 524.2	Total Trihalomethanes (TTHM)
Method EPA 524.4	Regulated VOCs (V1, V2, V3)

Accreditation applies to public drinking water matrices.

This report meets NELAP requirements and is made up of a cover page, analytical results, and a copy of the original chain-of-custody. If you have any questions concerning this report, please feel free to contact me.

Sincerely,

A handwritten signature in black ink that reads "Celey D. Keene". The signature is written in a cursive style with a large, stylized 'C' and 'K'.

Celey D. Keene

Lab Director/Quality Manager



PHONE (575) 393-2326 ° 101 E. MARLAND ° HOBBS, NM 88240

**Analytical Results For:**

BBC International, Inc.  
 Cliff Brunson  
 P.O. Box 805  
 Hobbs NM, 88241  
 Fax To: (575) 397-0397

Received:	06/14/2021	Sampling Date:	06/09/2021
Reported:	06/16/2021	Sampling Type:	Soil
Project Name:	OXBOW CEDAR CANYON 17 8 FED COM	Sampling Condition:	Cool & Intact
Project Number:	( 11-5-19 )	Sample Received By:	Tamara Oldaker
Project Location:	OXY		

**Sample ID: SP 1 @ 2' (H211511-01)**

BTX 8021B			mg/kg		Analyzed By: MS				
Analyte	Result	Reporting Limit	Analyzed	Method Blank	BS	% Recovery	True Value QC	RPD	Qualifier
Benzene*	<0.050	0.050	06/14/2021	ND	1.98	98.9	2.00	9.11	
Toluene*	<0.050	0.050	06/14/2021	ND	1.85	92.4	2.00	9.71	
Ethylbenzene*	<0.050	0.050	06/14/2021	ND	1.81	90.6	2.00	9.17	
Total Xylenes*	<0.150	0.150	06/14/2021	ND	5.51	91.9	6.00	9.02	
Total BTX	<0.300	0.300	06/14/2021	ND					

Surrogate: 4-Bromofluorobenzene (PID) 111 % 69.9-140

Chloride, SM4500Cl-B			mg/kg		Analyzed By: AC				
Analyte	Result	Reporting Limit	Analyzed	Method Blank	BS	% Recovery	True Value QC	RPD	Qualifier
Chloride	80.0	16.0	06/15/2021	ND	400	100	400	0.00	

TPH 8015M			mg/kg		Analyzed By: MS				
Analyte	Result	Reporting Limit	Analyzed	Method Blank	BS	% Recovery	True Value QC	RPD	Qualifier
GRO C6-C10*	<10.0	10.0	06/15/2021	ND	195	97.7	200	3.53	
DRO >C10-C28*	<10.0	10.0	06/15/2021	ND	208	104	200	1.62	
EXT DRO >C28-C36	<10.0	10.0	06/15/2021	ND					

Surrogate: 1-Chlorooctane 100 % 44.3-133

Surrogate: 1-Chlorooctadecane 98.9 % 38.9-142

Cardinal Laboratories

\*=Accredited Analyte

PLEASE NOTE: Liability and Damages. Cardinal's liability and client's exclusive remedy for any claim arising, whether based in contract or tort, shall be limited to the amount paid by client for analyses. All claims, including those for negligence and any other cause whatsoever shall be deemed waived unless made in writing and received by Cardinal within thirty (30) days after completion of the applicable service. In no event shall Cardinal be liable for incidental or consequential damages, including, without limitation, business interruptions, loss of use, or loss of profits incurred by client, its subsidiaries, affiliates or successors arising out of or related to the performance of the services hereunder by Cardinal, regardless of whether such claim is based upon any of the above stated reasons or otherwise. Results relate only to the samples identified above. This report shall not be reproduced except in full with written approval of Cardinal Laboratories.

Celey D. Keene, Lab Director/Quality Manager



PHONE (575) 393-2326 ° 101 E. MARLAND ° HOBBS, NM 88240

**Analytical Results For:**

BBC International, Inc.  
 Cliff Brunson  
 P.O. Box 805  
 Hobbs NM, 88241  
 Fax To: (575) 397-0397

Received:	06/14/2021	Sampling Date:	06/09/2021
Reported:	06/16/2021	Sampling Type:	Soil
Project Name:	OXBOW CEDAR CANYON 17 8 FED COM	Sampling Condition:	Cool & Intact
Project Number:	( 11-5-19 )	Sample Received By:	Tamara Oldaker
Project Location:	OXY		

**Sample ID: SP 1 @ 3' (H211511-02)**

BTEX 8021B			mg/kg		Analyzed By: MS					
Analyte	Result	Reporting Limit	Analyzed	Method Blank	BS	% Recovery	True Value QC	RPD	Qualifier	
Benzene*	<0.050	0.050	06/14/2021	ND	1.98	98.9	2.00	9.11		
Toluene*	<0.050	0.050	06/14/2021	ND	1.85	92.4	2.00	9.71		
Ethylbenzene*	<0.050	0.050	06/14/2021	ND	1.81	90.6	2.00	9.17		
Total Xylenes*	<0.150	0.150	06/14/2021	ND	5.51	91.9	6.00	9.02		
Total BTEX	<0.300	0.300	06/14/2021	ND						

Surrogate: 4-Bromofluorobenzene (PID) 112 % 69.9-140

Chloride, SM4500Cl-B		mg/kg		Analyzed By: AC					
Analyte	Result	Reporting Limit	Analyzed	Method Blank	BS	% Recovery	True Value QC	RPD	Qualifier
Chloride	32.0	16.0	06/15/2021	ND	400	100	400	0.00	

TPH 8015M		mg/kg		Analyzed By: MS					
Analyte	Result	Reporting Limit	Analyzed	Method Blank	BS	% Recovery	True Value QC	RPD	Qualifier
GRO C6-C10*	<10.0	10.0	06/15/2021	ND	195	97.7	200	3.53	
DRO >C10-C28*	<10.0	10.0	06/15/2021	ND	208	104	200	1.62	
EXT DRO >C28-C36	<10.0	10.0	06/15/2021	ND					

Surrogate: 1-Chlorooctane 93.5 % 44.3-133

Surrogate: 1-Chlorooctadecane 92.8 % 38.9-142

Cardinal Laboratories

\*=Accredited Analyte

PLEASE NOTE: Liability and Damages. Cardinal's liability and client's exclusive remedy for any claim arising, whether based in contract or tort, shall be limited to the amount paid by client for analyses. All claims, including those for negligence and any other cause whatsoever shall be deemed waived unless made in writing and received by Cardinal within thirty (30) days after completion of the applicable service. In no event shall Cardinal be liable for incidental or consequential damages, including, without limitation, business interruptions, loss of use, or loss of profits incurred by client, its subsidiaries, affiliates or successors arising out of or related to the performance of the services hereunder by Cardinal, regardless of whether such claim is based upon any of the above stated reasons or otherwise. Results relate only to the samples identified above. This report shall not be reproduced except in full with written approval of Cardinal Laboratories.

Celey D. Keene, Lab Director/Quality Manager



PHONE (575) 393-2326 ° 101 E. MARLAND ° HOBBS, NM 88240

**Analytical Results For:**

BBC International, Inc.  
 Cliff Brunson  
 P.O. Box 805  
 Hobbs NM, 88241  
 Fax To: (575) 397-0397

Received:	06/14/2021	Sampling Date:	06/09/2021
Reported:	06/16/2021	Sampling Type:	Soil
Project Name:	OXBOW CEDAR CANYON 17 8 FED COM	Sampling Condition:	Cool & Intact
Project Number:	( 11-5-19 )	Sample Received By:	Tamara Oldaker
Project Location:	OXY		

**Sample ID: SP 1 @ 4' (H211511-03)**

BTEx 8021B		mg/kg		Analyzed By: MS					
Analyte	Result	Reporting Limit	Analyzed	Method Blank	BS	% Recovery	True Value QC	RPD	Qualifier
Benzene*	<0.050	0.050	06/15/2021	ND	1.98	98.9	2.00	9.11	
Toluene*	<0.050	0.050	06/15/2021	ND	1.85	92.4	2.00	9.71	
Ethylbenzene*	<0.050	0.050	06/15/2021	ND	1.81	90.6	2.00	9.17	
Total Xylenes*	<0.150	0.150	06/15/2021	ND	5.51	91.9	6.00	9.02	
Total BTEX	<0.300	0.300	06/15/2021	ND					

Surrogate: 4-Bromofluorobenzene (PID) 109 % 69.9-140

Chloride, SM4500Cl-B		mg/kg		Analyzed By: AC						
Analyte	Result	Reporting Limit	Analyzed	Method Blank	BS	% Recovery	True Value QC	RPD	Qualifier	
Chloride	80.0	16.0	06/15/2021	ND	400	100	400	0.00		

TPH 8015M		mg/kg		Analyzed By: MS					
Analyte	Result	Reporting Limit	Analyzed	Method Blank	BS	% Recovery	True Value QC	RPD	Qualifier
GRO C6-C10*	<10.0	10.0	06/15/2021	ND	195	97.7	200	3.53	
DRO >C10-C28*	<10.0	10.0	06/15/2021	ND	208	104	200	1.62	
EXT DRO >C28-C36	<10.0	10.0	06/15/2021	ND					

Surrogate: 1-Chlorooctane 98.4 % 44.3-133

Surrogate: 1-Chlorooctadecane 102 % 38.9-142

Cardinal Laboratories

\*=Accredited Analyte

PLEASE NOTE: Liability and Damages. Cardinal's liability and client's exclusive remedy for any claim arising, whether based in contract or tort, shall be limited to the amount paid by client for analyses. All claims, including those for negligence and any other cause whatsoever shall be deemed waived unless made in writing and received by Cardinal within thirty (30) days after completion of the applicable service. In no event shall Cardinal be liable for incidental or consequential damages, including, without limitation, business interruptions, loss of use, or loss of profits incurred by client, its subsidiaries, affiliates or successors arising out of or related to the performance of the services hereunder by Cardinal, regardless of whether such claim is based upon any of the above stated reasons or otherwise. Results relate only to the samples identified above. This report shall not be reproduced except in full with written approval of Cardinal Laboratories.

Celey D. Keene, Lab Director/Quality Manager





PHONE (575) 393-2326 ° 101 E. MARLAND ° HOBBS, NM 88240

**Analytical Results For:**

BBC International, Inc.  
 Cliff Brunson  
 P.O. Box 805  
 Hobbs NM, 88241  
 Fax To: (575) 397-0397

Received:	06/14/2021	Sampling Date:	06/09/2021
Reported:	06/16/2021	Sampling Type:	Soil
Project Name:	OXBOW CEDAR CANYON 17 8 FED COM	Sampling Condition:	Cool & Intact
Project Number:	( 11-5-19 )	Sample Received By:	Tamara Oldaker
Project Location:	OXY		

**Sample ID: SP 2 @ 3' (H211511-04)**

BTX 8021B		mg/kg		Analyzed By: MS						
Analyte	Result	Reporting Limit	Analyzed	Method Blank	BS	% Recovery	True Value QC	RPD	Qualifier	
Benzene*	<0.050	0.050	06/15/2021	ND	1.98	98.9	2.00	9.11		
Toluene*	<0.050	0.050	06/15/2021	ND	1.85	92.4	2.00	9.71		
Ethylbenzene*	<0.050	0.050	06/15/2021	ND	1.81	90.6	2.00	9.17		
Total Xylenes*	<0.150	0.150	06/15/2021	ND	5.51	91.9	6.00	9.02		
Total BTX	<0.300	0.300	06/15/2021	ND						

Surrogate: 4-Bromofluorobenzene (PID) 111 % 69.9-140

Chloride, SM4500CI-B		mg/kg		Analyzed By: AC						
Analyte	Result	Reporting Limit	Analyzed	Method Blank	BS	% Recovery	True Value QC	RPD	Qualifier	
Chloride	1160	16.0	06/15/2021	ND	400	100	400	0.00		

TPH 8015M		mg/kg		Analyzed By: MS					
Analyte	Result	Reporting Limit	Analyzed	Method Blank	BS	% Recovery	True Value QC	RPD	Qualifier
GRO C6-C10*	<10.0	10.0	06/15/2021	ND	195	97.7	200	3.53	
DRO >C10-C28*	<10.0	10.0	06/15/2021	ND	208	104	200	1.62	
EXT DRO >C28-C36	<10.0	10.0	06/15/2021	ND					

Surrogate: 1-Chlorooctane 90.8 % 44.3-133

Surrogate: 1-Chlorooctadecane 94.8 % 38.9-142

Cardinal Laboratories

\*=Accredited Analyte

PLEASE NOTE: Liability and Damages. Cardinal's liability and client's exclusive remedy for any claim arising, whether based in contract or tort, shall be limited to the amount paid by client for analyses. All claims, including those for negligence and any other cause whatsoever shall be deemed waived unless made in writing and received by Cardinal within thirty (30) days after completion of the applicable service. In no event shall Cardinal be liable for incidental or consequential damages, including, without limitation, business interruptions, loss of use, or loss of profits incurred by client, its subsidiaries, affiliates or successors arising out of or related to the performance of the services hereunder by Cardinal, regardless of whether such claim is based upon any of the above stated reasons or otherwise. Results relate only to the samples identified above. This report shall not be reproduced except in full with written approval of Cardinal Laboratories.

Celey D. Keene, Lab Director/Quality Manager



PHONE (575) 393-2326 ° 101 E. MARLAND ° HOBBS, NM 88240

**Analytical Results For:**

BBC International, Inc.  
 Cliff Brunson  
 P.O. Box 805  
 Hobbs NM, 88241  
 Fax To: (575) 397-0397

Received:	06/14/2021	Sampling Date:	06/09/2021
Reported:	06/16/2021	Sampling Type:	Soil
Project Name:	OXBOW CEDAR CANYON 17 8 FED COM	Sampling Condition:	Cool & Intact
Project Number:	( 11-5-19 )	Sample Received By:	Tamara Oldaker
Project Location:	OXY		

**Sample ID: SP 2 @ 4' (H211511-05)**

BTX 8021B		mg/kg		Analyzed By: MS						
Analyte	Result	Reporting Limit	Analyzed	Method Blank	BS	% Recovery	True Value QC	RPD	Qualifier	
Benzene*	<0.050	0.050	06/15/2021	ND	1.98	98.9	2.00	9.11		
Toluene*	<0.050	0.050	06/15/2021	ND	1.85	92.4	2.00	9.71		
Ethylbenzene*	<0.050	0.050	06/15/2021	ND	1.81	90.6	2.00	9.17		
Total Xylenes*	<0.150	0.150	06/15/2021	ND	5.51	91.9	6.00	9.02		
Total BTX	<0.300	0.300	06/15/2021	ND						

Surrogate: 4-Bromofluorobenzene (PID) 111 % 69.9-140

Chloride, SM4500CI-B		mg/kg		Analyzed By: AC					
Analyte	Result	Reporting Limit	Analyzed	Method Blank	BS	% Recovery	True Value QC	RPD	Qualifier
Chloride	672	16.0	06/15/2021	ND	400	100	400	0.00	

TPH 8015M		mg/kg		Analyzed By: MS					
Analyte	Result	Reporting Limit	Analyzed	Method Blank	BS	% Recovery	True Value QC	RPD	Qualifier
GRO C6-C10*	<10.0	10.0	06/15/2021	ND	195	97.7	200	3.53	
DRO >C10-C28*	<10.0	10.0	06/15/2021	ND	208	104	200	1.62	
EXT DRO >C28-C36	<10.0	10.0	06/15/2021	ND					

Surrogate: 1-Chlorooctane 94.4 % 44.3-133

Surrogate: 1-Chlorooctadecane 99.8 % 38.9-142

Cardinal Laboratories

\*=Accredited Analyte

PLEASE NOTE: Liability and Damages. Cardinal's liability and client's exclusive remedy for any claim arising, whether based in contract or tort, shall be limited to the amount paid by client for analyses. All claims, including those for negligence and any other cause whatsoever shall be deemed waived unless made in writing and received by Cardinal within thirty (30) days after completion of the applicable service. In no event shall Cardinal be liable for incidental or consequential damages, including, without limitation, business interruptions, loss of use, or loss of profits incurred by client, its subsidiaries, affiliates or successors arising out of or related to the performance of the services hereunder by Cardinal, regardless of whether such claim is based upon any of the above stated reasons or otherwise. Results relate only to the samples identified above. This report shall not be reproduced except in full with written approval of Cardinal Laboratories.

Celey D. Keene, Lab Director/Quality Manager



PHONE (575) 393-2326 ° 101 E. MARLAND ° HOBBS, NM 88240

**Analytical Results For:**

BBC International, Inc.  
 Cliff Brunson  
 P.O. Box 805  
 Hobbs NM, 88241  
 Fax To: (575) 397-0397

Received:	06/14/2021	Sampling Date:	06/09/2021
Reported:	06/16/2021	Sampling Type:	Soil
Project Name:	OXBOW CEDAR CANYON 17 8 FED COM	Sampling Condition:	Cool & Intact
Project Number:	( 11-5-19 )	Sample Received By:	Tamara Oldaker
Project Location:	OXY		

**Sample ID: SP 2 @ 5' (H211511-06)**

BTEx 8021B		mg/kg		Analyzed By: MS						
Analyte	Result	Reporting Limit	Analyzed	Method Blank	BS	% Recovery	True Value QC	RPD	Qualifier	
Benzene*	<0.050	0.050	06/15/2021	ND	2.07	103	2.00	1.39		
Toluene*	<0.050	0.050	06/15/2021	ND	1.94	97.2	2.00	1.61		
Ethylbenzene*	<0.050	0.050	06/15/2021	ND	1.90	94.8	2.00	1.58		
Total Xylenes*	<0.150	0.150	06/15/2021	ND	5.76	96.0	6.00	1.60		
Total BTEx	<0.300	0.300	06/15/2021	ND						

Surrogate: 4-Bromofluorobenzene (PID) 112 % 69.9-140

Chloride, SM4500CI-B		mg/kg		Analyzed By: AC						
Analyte	Result	Reporting Limit	Analyzed	Method Blank	BS	% Recovery	True Value QC	RPD	Qualifier	
Chloride	224	16.0	06/15/2021	ND	416	104	400	0.00		

TPH 8015M		mg/kg		Analyzed By: MS					
Analyte	Result	Reporting Limit	Analyzed	Method Blank	BS	% Recovery	True Value QC	RPD	Qualifier
GRO C6-C10*	<10.0	10.0	06/15/2021	ND	195	97.7	200	3.53	
DRO >C10-C28*	<10.0	10.0	06/15/2021	ND	208	104	200	1.62	
EXT DRO >C28-C36	<10.0	10.0	06/15/2021	ND					

Surrogate: 1-Chlorooctane 92.3 % 44.3-133

Surrogate: 1-Chlorooctadecane 96.1 % 38.9-142

Cardinal Laboratories

\*=Accredited Analyte

PLEASE NOTE: Liability and Damages. Cardinal's liability and client's exclusive remedy for any claim arising, whether based in contract or tort, shall be limited to the amount paid by client for analyses. All claims, including those for negligence and any other cause whatsoever shall be deemed waived unless made in writing and received by Cardinal within thirty (30) days after completion of the applicable service. In no event shall Cardinal be liable for incidental or consequential damages, including, without limitation, business interruptions, loss of use, or loss of profits incurred by client, its subsidiaries, affiliates or successors arising out of or related to the performance of the services hereunder by Cardinal, regardless of whether such claim is based upon any of the above stated reasons or otherwise. Results relate only to the samples identified above. This report shall not be reproduced except in full with written approval of Cardinal Laboratories.

Celey D. Keene, Lab Director/Quality Manager



PHONE (575) 393-2326 ° 101 E. MARLAND ° HOBBS, NM 88240

**Analytical Results For:**

BBC International, Inc.  
 Cliff Brunson  
 P.O. Box 805  
 Hobbs NM, 88241  
 Fax To: (575) 397-0397

Received:	06/14/2021	Sampling Date:	06/09/2021
Reported:	06/16/2021	Sampling Type:	Soil
Project Name:	OXBOW CEDAR CANYON 17 8 FED COM	Sampling Condition:	Cool & Intact
Project Number:	( 11-5-19 )	Sample Received By:	Tamara Oldaker
Project Location:	OXY		

**Sample ID: SP 2 @ 6' (H211511-07)**

BTX 8021B		mg/kg		Analyzed By: MS						
Analyte	Result	Reporting Limit	Analyzed	Method Blank	BS	% Recovery	True Value QC	RPD	Qualifier	
Benzene*	<0.050	0.050	06/15/2021	ND	2.07	103	2.00	1.39		
Toluene*	<0.050	0.050	06/15/2021	ND	1.94	97.2	2.00	1.61		
Ethylbenzene*	<0.050	0.050	06/15/2021	ND	1.90	94.8	2.00	1.58		
Total Xylenes*	<0.150	0.150	06/15/2021	ND	5.76	96.0	6.00	1.60		
Total BTX	<0.300	0.300	06/15/2021	ND						

Surrogate: 4-Bromofluorobenzene (PID) 110 % 69.9-140

Chloride, SM4500CI-B		mg/kg		Analyzed By: AC						
Analyte	Result	Reporting Limit	Analyzed	Method Blank	BS	% Recovery	True Value QC	RPD	Qualifier	
Chloride	48.0	16.0	06/15/2021	ND	416	104	400	0.00		

TPH 8015M		mg/kg		Analyzed By: MS					
Analyte	Result	Reporting Limit	Analyzed	Method Blank	BS	% Recovery	True Value QC	RPD	Qualifier
GRO C6-C10*	<10.0	10.0	06/15/2021	ND	195	97.7	200	3.53	
DRO >C10-C28*	<10.0	10.0	06/15/2021	ND	208	104	200	1.62	
EXT DRO >C28-C36	<10.0	10.0	06/15/2021	ND					

Surrogate: 1-Chlorooctane 98.7 % 44.3-133

Surrogate: 1-Chlorooctadecane 103 % 38.9-142

Cardinal Laboratories

\*=Accredited Analyte

PLEASE NOTE: Liability and Damages. Cardinal's liability and client's exclusive remedy for any claim arising, whether based in contract or tort, shall be limited to the amount paid by client for analyses. All claims, including those for negligence and any other cause whatsoever shall be deemed waived unless made in writing and received by Cardinal within thirty (30) days after completion of the applicable service. In no event shall Cardinal be liable for incidental or consequential damages, including, without limitation, business interruptions, loss of use, or loss of profits incurred by client, its subsidiaries, affiliates or successors arising out of or related to the performance of the services hereunder by Cardinal, regardless of whether such claim is based upon any of the above stated reasons or otherwise. Results relate only to the samples identified above. This report shall not be reproduced except in full with written approval of Cardinal Laboratories.

Celey D. Keene, Lab Director/Quality Manager



PHONE (575) 393-2326 ° 101 E. MARLAND ° HOBBS, NM 88240

**Analytical Results For:**

BBC International, Inc.  
 Cliff Brunson  
 P.O. Box 805  
 Hobbs NM, 88241  
 Fax To: (575) 397-0397

Received:	06/14/2021	Sampling Date:	06/09/2021
Reported:	06/16/2021	Sampling Type:	Soil
Project Name:	OXBOW CEDAR CANYON 17 8 FED COM	Sampling Condition:	Cool & Intact
Project Number:	( 11-5-19 )	Sample Received By:	Tamara Oldaker
Project Location:	OXY		

**Sample ID: SP 3 @ 3' (H211511-08)**

Chloride, SM4500Cl-B		mg/kg		Analyzed By: AC						
Analyte	Result	Reporting Limit	Analyzed	Method Blank	BS	% Recovery	True Value QC	RPD	Qualifier	
Chloride	96.0	16.0	06/15/2021	ND	416	104	400	0.00		

**Sample ID: SP 3 @ 4' (H211511-09)**

Chloride, SM4500Cl-B		mg/kg		Analyzed By: AC					
Analyte	Result	Reporting Limit	Analyzed	Method Blank	BS	% Recovery	True Value QC	RPD	Qualifier
Chloride	80.0	16.0	06/15/2021	ND	416	104	400	0.00	

**Sample ID: SP 3 @ 5' (H211511-10)**

Chloride, SM4500Cl-B		mg/kg		Analyzed By: AC					
Analyte	Result	Reporting Limit	Analyzed	Method Blank	BS	% Recovery	True Value QC	RPD	Qualifier
Chloride	128	16.0	06/15/2021	ND	416	104	400	0.00	

Cardinal Laboratories

\*=Accredited Analyte

PLEASE NOTE: Liability and Damages. Cardinal's liability and client's exclusive remedy for any claim arising, whether based in contract or tort, shall be limited to the amount paid by client for analyses. All claims, including those for negligence and any other cause whatsoever shall be deemed waived unless made in writing and received by Cardinal within thirty (30) days after completion of the applicable service. In no event shall Cardinal be liable for incidental or consequential damages, including, without limitation, business interruptions, loss of use, or loss of profits incurred by client, its subsidiaries, affiliates or successors arising out of or related to the performance of the services hereunder by Cardinal, regardless of whether such claim is based upon any of the above stated reasons or otherwise. Results relate only to the samples identified above. This report shall not be reproduced except in full with written approval of Cardinal Laboratories.

Celey D. Keene, Lab Director/Quality Manager



PHONE (575) 393-2326 ° 101 E. MARLAND ° HOBBS, NM 88240

**Analytical Results For:**

BBC International, Inc.  
 Cliff Brunson  
 P.O. Box 805  
 Hobbs NM, 88241  
 Fax To: (575) 397-0397

Received:	06/14/2021	Sampling Date:	06/11/2021
Reported:	06/16/2021	Sampling Type:	Soil
Project Name:	OXBOW CEDAR CANYON 17 8 FED COM	Sampling Condition:	Cool & Intact
Project Number:	( 11-5-19 )	Sample Received By:	Tamara Oldaker
Project Location:	OXY		

**Sample ID: SP 4 @ 3' (H211511-11)**

BTEx 8021B		mg/kg		Analyzed By: MS						
Analyte	Result	Reporting Limit	Analyzed	Method Blank	BS	% Recovery	True Value QC	RPD	Qualifier	
Benzene*	<0.050	0.050	06/15/2021	ND	2.07	103	2.00	1.39		
Toluene*	<0.050	0.050	06/15/2021	ND	1.94	97.2	2.00	1.61		
Ethylbenzene*	<0.050	0.050	06/15/2021	ND	1.90	94.8	2.00	1.58		
Total Xylenes*	<0.150	0.150	06/15/2021	ND	5.76	96.0	6.00	1.60		
Total BTEx	<0.300	0.300	06/15/2021	ND						

Surrogate: 4-Bromofluorobenzene (PID) 110 % 69.9-140

Chloride, SM4500CI-B		mg/kg		Analyzed By: AC					
Analyte	Result	Reporting Limit	Analyzed	Method Blank	BS	% Recovery	True Value QC	RPD	Qualifier
Chloride	672	16.0	06/15/2021	ND	416	104	400	0.00	

TPH 8015M		mg/kg		Analyzed By: MS					
Analyte	Result	Reporting Limit	Analyzed	Method Blank	BS	% Recovery	True Value QC	RPD	Qualifier
GRO C6-C10*	<10.0	10.0	06/15/2021	ND	195	97.7	200	3.53	
DRO >C10-C28*	<10.0	10.0	06/15/2021	ND	208	104	200	1.62	
EXT DRO >C28-C36	<10.0	10.0	06/15/2021	ND					

Surrogate: 1-Chlorooctane 96.6 % 44.3-133

Surrogate: 1-Chlorooctadecane 101 % 38.9-142

Cardinal Laboratories

\*=Accredited Analyte

PLEASE NOTE: Liability and Damages. Cardinal's liability and client's exclusive remedy for any claim arising, whether based in contract or tort, shall be limited to the amount paid by client for analyses. All claims, including those for negligence and any other cause whatsoever shall be deemed waived unless made in writing and received by Cardinal within thirty (30) days after completion of the applicable service. In no event shall Cardinal be liable for incidental or consequential damages, including, without limitation, business interruptions, loss of use, or loss of profits incurred by client, its subsidiaries, affiliates or successors arising out of or related to the performance of the services hereunder by Cardinal, regardless of whether such claim is based upon any of the above stated reasons or otherwise. Results relate only to the samples identified above. This report shall not be reproduced except in full with written approval of Cardinal Laboratories.

Celey D. Keene, Lab Director/Quality Manager





PHONE (575) 393-2326 • 101 E. MARLAND • HOBBS, NM 88240

**Analytical Results For:**

BBC International, Inc.  
 Cliff Brunson  
 P.O. Box 805  
 Hobbs NM, 88241  
 Fax To: (575) 397-0397

Received:	06/14/2021	Sampling Date:	06/11/2021
Reported:	06/16/2021	Sampling Type:	Soil
Project Name:	OXBOW CEDAR CANYON 17 8 FED COM	Sampling Condition:	Cool & Intact
Project Number:	( 11-5-19 )	Sample Received By:	Tamara Oldaker
Project Location:	OXY		

**Sample ID: SP 4 @ 4' (H211511-12)**

BTX 8021B		mg/kg		Analyzed By: MS						
Analyte	Result	Reporting Limit	Analyzed	Method Blank	BS	% Recovery	True Value QC	RPD	Qualifier	
Benzene*	<0.050	0.050	06/15/2021	ND	2.07	103	2.00	1.39		
Toluene*	<0.050	0.050	06/15/2021	ND	1.94	97.2	2.00	1.61		
Ethylbenzene*	<0.050	0.050	06/15/2021	ND	1.90	94.8	2.00	1.58		
Total Xylenes*	<0.150	0.150	06/15/2021	ND	5.76	96.0	6.00	1.60		
Total BTX	<0.300	0.300	06/15/2021	ND						

Surrogate: 4-Bromofluorobenzene (PID) 112 % 69.9-140

Chloride, SM4500CI-B		mg/kg		Analyzed By: AC						
Analyte	Result	Reporting Limit	Analyzed	Method Blank	BS	% Recovery	True Value QC	RPD	Qualifier	
Chloride	48.0	16.0	06/15/2021	ND	416	104	400	0.00		

TPH 8015M		mg/kg		Analyzed By: MS					
Analyte	Result	Reporting Limit	Analyzed	Method Blank	BS	% Recovery	True Value QC	RPD	Qualifier
GRO C6-C10*	<10.0	10.0	06/15/2021	ND	195	97.7	200	3.53	
DRO >C10-C28*	<10.0	10.0	06/15/2021	ND	208	104	200	1.62	
EXT DRO >C28-C36	<10.0	10.0	06/15/2021	ND					

Surrogate: 1-Chlorooctane 90.5 % 44.3-133

Surrogate: 1-Chlorooctadecane 95.2 % 38.9-142

Cardinal Laboratories

\*=Accredited Analyte

PLEASE NOTE: Liability and Damages. Cardinal's liability and client's exclusive remedy for any claim arising, whether based in contract or tort, shall be limited to the amount paid by client for analyses. All claims, including those for negligence and any other cause whatsoever shall be deemed waived unless made in writing and received by Cardinal within thirty (30) days after completion of the applicable service. In no event shall Cardinal be liable for incidental or consequential damages, including, without limitation, business interruptions, loss of use, or loss of profits incurred by client, its subsidiaries, affiliates or successors arising out of or related to the performance of the services hereunder by Cardinal, regardless of whether such claim is based upon any of the above stated reasons or otherwise. Results relate only to the samples identified above. This report shall not be reproduced except in full with written approval of Cardinal Laboratories.

Celey D. Keene, Lab Director/Quality Manager

PHONE (575) 393-2326 • 101 E. MARLAND • HOBBS, NM 88240

---

### Notes and Definitions

QR-03	The RPD value for the sample duplicate or MS/MSD was outside of QC acceptance limits due to matrix interference. QC batch accepted based on LCS and/or LCSD recovery and/or RPD values.
QM-07	The spike recovery was outside acceptance limits for the MS and/or MSD. The batch was accepted based on acceptable LCS recovery.
ND	Analyte NOT DETECTED at or above the reporting limit
RPD	Relative Percent Difference
**	Samples not received at proper temperature of 6°C or below.
***	Insufficient time to reach temperature.
-	Chloride by SM4500Cl-B does not require samples be received at or below 6°C Samples reported on an as received basis (wet) unless otherwise noted on report

---

Cardinal Laboratories

\*=Accredited Analyte

PLEASE NOTE: Liability and Damages. Cardinal's liability and client's exclusive remedy for any claim arising, whether based in contract or tort, shall be limited to the amount paid by client for analyses. All claims, including those for negligence and any other cause whatsoever shall be deemed waived unless made in writing and received by Cardinal within thirty (30) days after completion of the applicable service. In no event shall Cardinal be liable for incidental or consequential damages, including, without limitation, business interruptions, loss of use, or loss of profits incurred by client, its subsidiaries, affiliates or successors arising out of or related to the performance of the services hereunder by Cardinal, regardless of whether such claim is based upon any of the above stated reasons or otherwise. Results relate only to the samples identified above. This report shall not be reproduced except in full with written approval of Cardinal Laboratories.

A handwritten signature in black ink, appearing to read "Celey D. Keene", is written over a horizontal line.

Celey D. Keene, Lab Director/Quality Manager



## ARDINAL LABORATORIES

101 East Marland, Hobbs, NM 88240  
(505) 393-2326 FAX (505) 393-2476

## CHAIN-OF-CUSTODY AND ANALYSIS REQUEST

Company Name: BBC International, Inc.		P.O. #:		BILL TO										ANALYSIS REQUEST										
Project Manager: Cliff Brunson		Company: OXY																						
Address: P.O. Box 805		Attn: WADE																						
City: Hobbs		Address:																						
State: NM Zip: 88241		City:																						
Phone #: 575-397-6388		Fax #: 575-397-0397																						
Project #:		Project Owner: Oxy																						
Project Name: Oxybow CC 17-8 Fed Com 32H (11-5-19)		State: Zip:																						
Project Location:		Phone #:																						
Sampler Name: SIMON RENDON		Fax #:																						
FOR LAB USE ONLY																								
Lab I.D.	Sample I.D.	(G)RAB OR (C)OMP	# CONTAINERS	MATRIX		PRESERV		SAMPLING																
				GROUNDWATER	WASTEWATER	SOIL	OIL	SLUDGE	OTHER:	ACID/BASE:	ICE / COOL	OTHER:	DATE	TIME	CL	BTEX	TPH EXT							
H211511	SP 1 @ 2'	G	1										6-9-21	10:10	✓	✓	✓							
1	SP 1 @ 3'												6-9-21	10:24	✓	✓	✓							
2	SP 1 @ 4'												6-9-21	10:43	✓	✓	✓							
3	SP 2 @ 3'												6-9-21	11:12	✓	✓	✓							
4	SP 2 @ 4'												6-9-21	11:25	✓	✓	✓							
5	SP 2 @ 5'												6-9-21	11:47	✓	✓	✓							
6	SP 2 @ 6'												6-9-21	12:10	✓	✓	✓							
7	SP 3 @ 3'												6-9-21	1:20	✓	✓	✓							
8	SP 3 @ 4'												6-9-21	1:38	✓	✓	✓							
9	SP 3 @ 5'												6-9-21	2:04	✓	✓	✓							

PLEASE NOTE: Cardholder and Company Name and address are required for any claim arising under this contract or bill. Cardholder shall be required to provide the above information to the applicable analysis. All claims, including those for negligence and any other cause whatsoever, shall be deemed waived unless made in writing and received by Cardinal within 30 days after completion of the applicable service. In the event that Cardinal is liable for incidental or consequential damages, including without limitation, business interruption, loss of use, or loss of profits incurred by client, as a result of service or non-service, Cardinal shall be held liable for the performance of services rendered by Cardinal. This document is the property of Cardinal and shall remain the property of Cardinal.

Relinquished By: *Simon Rendon* Date: 6-14-21 Received By: *David Rendon* Time: 8:00 AM

Relinquished By: *David Rendon* Date: 6-14-21 Received By: *David Rendon* Time: 11:45 AM

Delivered By: (Circle One) *Delivered* Sample Condition: *Intact* CHECKED BY: *David Rendon* (Initials) *DR*

Sampler - UPS - Bus - Other: *- 1.1c #1/3* Yes ☒ No ☐ Intact ☒ Cool ☐ Yes ☐ No ☐

REMARKS: Phone Result: ☐ Yes ☐ No ☐ Add'l Phone #: Fax Result: ☐ Yes ☐ No ☐ Add'l Fax #:

† Cardinal cannot accept verbal changes. Please fax written changes to 505-393-2476



# ORDINAL LABORATORIES

101 East Marland, Hobbs, NM 88240

(505) 393-2326 FAX (505) 393-2476

### CHAIN-OF-CUSTODY AND ANALYSIS REQUEST

[illegible]



Form C-141

State of New Mexico  
Oil Conservation Division

Page 5

Incident ID	nAPP2117549767
District RP	
Facility ID	
Application ID	

## Remediation Plan

**Remediation Plan Checklist:** *Each of the following items must be included in the plan.*

- ☒ Detailed description of proposed remediation technique
- ☒ Scaled sitemap with GPS coordinates showing delineation points
- ☒ Estimated volume of material to be remediated
- ☒ Closure criteria is to Table 1 specifications subject to 19.15.29.12(C)(4) NMAC
- ☒ Proposed schedule for remediation (note if remediation plan timeline is more than 90 days OCD approval is required)

**Deferral Requests Only:** *Each of the following items must be confirmed as part of any request for deferral of remediation.*

- ☐ Contamination must be in areas immediately under or around production equipment where remediation could cause a major facility deconstruction.
- ☐ Extents of contamination must be fully delineated.
- ☐ Contamination does not cause an imminent risk to human health, the environment, or groundwater.

I hereby certify that the information given above is true and complete to the best of my knowledge and understand that pursuant to OCD rules and regulations all operators are required to report and/or file certain release notifications and perform corrective actions for releases which may endanger public health or the environment. The acceptance of a C-141 report by the OCD does not relieve the operator of liability should their operations have failed to adequately investigate and remediate contamination that pose a threat to groundwater, surface water, human health or the environment. In addition, OCD acceptance of a C-141 report does not relieve the operator of responsibility for compliance with any other federal, state, or local laws and/or regulations.

Printed Name: Wade Dittrich Title: Environmental Coordinator  
Signature:  Date: 6-24-21  
email: wade\_dittrich@oxy.com Telephone: (575) 390-2828

**OCD Only**

Received by: Robert Hamlet Date: 11/23/2021

☐ Approved ☒ Approved with Attached Conditions of Approval ☐ Denied ☐ Deferral Approved

Signature:  Date: 11/23/2021

**District I**

1625 N. French Dr., Hobbs, NM 88240  
 Phone:(575) 393-6161 Fax:(575) 393-0720

**District II**

811 S. First St., Artesia, NM 88210  
 Phone:(575) 748-1283 Fax:(575) 748-9720

**District III**

1000 Rio Brazos Rd., Aztec, NM 87410  
 Phone:(505) 334-6178 Fax:(505) 334-6170

**District IV**

1220 S. St Francis Dr., Santa Fe, NM 87505  
 Phone:(505) 476-3470 Fax:(505) 476-3462

**State of New Mexico**  
**Energy, Minerals and Natural Resources**  
**Oil Conservation Division**  
**1220 S. St Francis Dr.**  
**Santa Fe, NM 87505**

CONDITIONS

Action 44985

**CONDITIONS**

Operator: OXY USA INC P.O. Box 4294 Houston, TX 772104294	OGRID: 16696
	Action Number: 44985
	Action Type: [C-141] Release Corrective Action (C-141)

**CONDITIONS**

Created By	Condition	Condition Date
rhamlet	The Workplan/Remediation Plan is approved with the following conditions: Please make sure the floor confirmation samples are delineated/excavated to meet closure criteria standards for proven depth to water determination. Sidewall samples should be delineated to 600 mg/kg for chlorides and 100 mg/kg for TPH to define the edge of the release. Collect confirmation samples, representing no more than 200 ft2.	11/23/2021