

Incident ID	NAPP2127147753
District RP	
Facility ID	
Application ID	

## Closure

The responsible party must attach information demonstrating they have complied with all applicable closure requirements and any conditions or directives of the OCD. This demonstration should be in the form of a comprehensive report (electronic submittals in .pdf format are preferred) including a scaled site map, sampling diagrams, relevant field notes, photographs of any excavation prior to backfilling, laboratory data including chain of custody documents of final sampling, and a narrative of the remedial activities. Refer to 19.15.29.12 NMAC.

**Closure Report Attachment Checklist:** *Each of the following items must be included in the closure report.*

- ☒ A scaled site and sampling diagram as described in 19.15.29.11 NMAC
- ☒ Photographs of the remediated site prior to backfill or photos of the liner integrity if applicable (Note: appropriate OCD District office must be notified 2 days prior to liner inspection)
- ☒ Laboratory analyses of final sampling (Note: appropriate ODC District office must be notified 2 days prior to final sampling)
- ☒ Description of remediation activities

I hereby certify that the information given above is true and complete to the best of my knowledge and understand that pursuant to OCD rules and regulations all operators are required to report and/or file certain release notifications and perform corrective actions for releases which may endanger public health or the environment. The acceptance of a C-141 report by the OCD does not relieve the operator of liability should their operations have failed to adequately investigate and remediate contamination that pose a threat to groundwater, surface water, human health or the environment. In addition, OCD acceptance of a C-141 report does not relieve the operator of responsibility for compliance with any other federal, state, or local laws and/or regulations. The responsible party acknowledges they must substantially restore, reclaim, and re-vegetate the impacted surface area to the conditions that existed prior to the release or their final land use in accordance with 19.15.29.13 NMAC including notification to the OCD when reclamation and re-vegetation are complete.

Printed Name: Larry Baker

Title: Environmental Tech SR.

Signature: Larry Baker

Date: 4/18/2022

email: larry.baker@apachecorp.com

Telephone: 432-215-2284

**OCD Only**

Received by: Robert Hamlet

Date: 5/16/2022

Closure approval by the OCD does not relieve the responsible party of liability should their operations have failed to adequately investigate and remediate contamination that poses a threat to groundwater, surface water, human health, or the environment nor does not relieve the responsible party of compliance with any other federal, state, or local laws and/or regulations.

Closure Approved by: Robert Hamlet

Date: 5/16/2022

Printed Name: Robert Hamlet

Title: Environmental Specialist - Advanced



## **CLOSURE REQUEST AND REMEDIATION SUMMARY REPORT**

**Apache Corporation  
NEDU CTB  
Lea County, New Mexico  
Unit Letter "P", Section 10, Township 21 South, Range 37 East  
Latitude 32.487188° North, Longitude 103.143346° West  
NMOCD Incident: nAPP2127147753**

Prepared For:

**Apache Corporation  
303 Veterans Airpark Lane  
Midland, TX 79705**

Prepared By:

**Etech Environmental & Safety Solutions, Inc.  
P.O. Box 62228  
Midland, Texas 79711**

**April 14, 2022**

A handwritten signature in blue ink, appearing to read "Wesley A. Desilets", written over a horizontal line.

Wesley A. Desilets  
Project Manager

A handwritten signature in blue ink, appearing to read "Sean Carter", written over a horizontal line.

Sean Carter  
Senior Project Manager

## TABLE OF CONTENTS

INTRODUCTION.....	1
NMOCD SITE CLASSIFICATION.....	1
SUMMARY OF SOIL REMEDIATION ACTIVITIES .....	1
SOIL DISPOSAL AND BACKFILL ACTIVITIES.....	2
SITE CLOSURE REQUEST.....	2
LIMITATIONS.....	2
DISTRIBUTION.....	3

## FIGURES

Figure 1 – Site Location Map

Figure 2 – Delineation Soil Sample Location Map

Figure 3 – Confirmation Soil Sample Location Map (Bottom Holes)

Figure 4 – Confirmation Soil Sample Location Map (Side Walls)

## TABLES

Table 1 – Concentrations of Benzene, BTEX, TPH, and Chlorides in Soil (Delineation)

Table 2 – Concentrations of Benzene, BTEX, TPH, and Chlorides in Soil (Confirmation)

Table 3 – Delineation Soil Sample GPS Points

Table 4 – Confirmation Soil Sample GPS Points

## APPENDICES

Appendix A – Photographic Documentation

Appendix B – Analytical Reports

Appendix C – Release Notification and Corrective Action (Form C-141)

## INTRODUCTION

Etech Environmental & Safety Solutions, Inc. (Etech), on behalf of Apache Corporation (Apache), has prepared this Closure Request and Remediation Summary Report for the Release Site known as NEDU CTB. The legal description of the Release Site is Unit Letter "P", Section 10, Township 21 South, Range 37 East, in Lea County, New Mexico. The subject property is owned by The New Mexico State Land Office (NMSLO). The Release Site GPS coordinates are 32.487188° North and 103.143346° West. Please reference Figure 1 for the Site Location Map, Figure 2 for the Delineation Soil Sample Location Map, Figure 3 for the Confirmation Soil Sample Location Map (Bottom Holes), and Figure 4 for the Confirmation Soil Sample Location Map (Side Walls).

On September 25, 2021, a produced water release occurred at the NEDU CTB. The release was the result of an eight (8) inch steel line failure caused by internal corrosion. The release was reported as approximately one hundred sixty-three (163) barrels of produced water released with approximately one hundred twenty (120) barrels of produced water recovered, resulting in a net loss of approximately forty-three (43) barrels. On September 28, 2021, Apache filed a *Release Notification and Corrective Action Form* (Form C-141) with the New Mexico Oil Conservation Division (NMOCD) and NMSLO documenting the release. The Form C-141 is provided as Appendix C. Photographic documentation for the site are provided as Appendix A.

## NMOCD SITE CLASSIFICATION

Based on previous soil boring activities conducted by Apache on February 28, 2019, groundwater should be encountered at approximately twenty-eight and a half (28.5) feet below ground surface (bgs). Based on the NMOCD site classification system, zero (0) points will be assigned to the subject area ranking as a result of this criterion. No water wells were observed within one thousand (1,000) feet of the Release Site. Based on the NMOCD site classification system, zero (0) points will be assigned to the subject area ranking as a result of this criterion. No surface water was observed within one thousand (1,000) feet of the release. Based on the NMOCD site classification system, zero (0) points will be assigned to the NEDU CTB Release Site as a result of this criterion. Based on this score, the soil remediation levels for a site with a ranking score of zero (0) points are as follows:

- Benzene – 10 mg/Kg (ppm)
- BTEX – 50 mg/Kg (ppm)
- TPH – 100 mg/Kg (ppm)
- Chloride – 600 mg/Kg (ppm)

## SUMMARY OF SOIL REMEDIATION ACTIVITIES

On December 3, 2021, delineation activities were conducted utilizing a backhoe to collect eight (8) vertical delineation soil samples (SP 1 @ Surface, SP 1 @ 1', SP 2 @ Surface, SP 2 @ 1', SP 3 @ Surface, SP 3 @ 1', SP 4 @ Surface, SP 4 @ 1') from within the release area. In addition, three (3) five-point composite soil samples (H1, H2, and H3) were collected from outside the release area to establish horizontal delineation. The soil samples were submitted to Cardinal Laboratories in Hobbs, New Mexico for determination of concentrations of benzene, toluene, ethylbenzene, and xylene (BTEX) using EPA Method SW 846-8021B, and Total Petroleum

Hydrocarbons (TPH) using EPA Method SW 846-8015M, and Chlorides using Method SM 4500CI-B. The analytical results for the delineation activities are provided as Table 1 – Concentrations of Benzene, BTEX, TPH, and Chloride in Soil (Delineation). Please reference Figure 2 for delineation soil sampling locations.

On March 30, 2022, Etech commenced excavation activities at the Release Site utilizing a hydro-vac, backhoe and manual methods. Excavation activities were conducted in a manner that protected the integrity of the production equipment. Etech hand spotted around all surface equipment and/or hydro-excavated all impacted material within two (2) feet of any production equipment. Based on the delineation data, the impacted area was excavated to depths ranging from six (6) inches to one and a half (1.5) feet bgs. Excavated soil was stockpiled on a layer of poly sheeting adjacent to the excavation pending disposal.

On April 7, 2022, Etech, on behalf of Apache, collected thirteen (13) five-point composite confirmation soil samples from the base of the excavated area and two (2) five-point composite confirmation soil samples from the side walls of the excavation approximately every two hundred (200) square feet. Soil samples were submitted to Cardinal Laboratories in Hobbs, New Mexico and analyzed for BTEX, TPH, and chloride analysis. A review of laboratory analytical results indicated all collected soil samples were below applicable NMOCD regulatory limits. Please reference Figure 3 and Figure 4 for confirmation soil sampling locations.

Table 2 summarizes the Concentrations of Benzene, BTEX, TPH, and Chlorides in Soil (Confirmation). Analytical reports are provided as Appendix B.

## **SOIL DISPOSAL AND BACKFILL ACTIVITIES**

On April 12, 2022, Etech transported approximately one hundred twenty (120) cubic yards of impacted soil to the Sundance disposal facility in Lea County, NM. The excavated area was backfilled with non-impacted caliche from a local source and the site was contoured to fit the surrounding area.

## **SITE CLOSURE REQUEST**

Based on the analytical results, Etech, on the behalf of Apache, requests NMOCD and NMSLO grant Site Closure Status to the NEDU CTB Release Site NMOCD Incident: nAPP2127147753.

## **LIMITATIONS**

Etech has prepared this Closure Request and Remediation Summary Report to the best of its ability. No other warranty, expressed or implied, is made or intended. Etech has examined and relied upon documents referenced in the report and has relied on oral statements made by certain individuals. Etech has not conducted an independent examination of the facts contained in referenced materials and statements. We have presumed the genuineness of the documents and that the information provided in documents or statements is true and accurate. Etech has prepared this report, in a professional manner, using the degree of skill and care exercised by similar environmental consultants. Etech also notes that the facts and conditions referenced in this report may change over time and the conclusions and recommendations set forth herein are applicable only to the facts and conditions as described at the time of this report.

This report has been prepared for the benefit of Apache Corporation. The information contained in this report, including all exhibits and attachments, may not be used by any other party without the express consent of Etech and/or Apache Corporation.

## **DISTRIBUTION**

- Copy 1: New Mexico Energy, Minerals and Natural Resources Department  
Oil Conservation Division, District 1  
1624 N. French Drive  
Hobbs, New Mexico 88210
- Copy 2: Ryan Mann  
New Mexico State Land Office  
Remediation Specialist  
2827 N. Dal Paso Suite 117  
Hobbs, NM 88240
- Copy 3: Larry Baker  
Apache Corporation  
303 Veterans Airpark Lane  
Midland, TX 79705
- Copy 4: Etech Environmental & Safety Solutions, Inc.  
P.O. Box 62228  
Midland, TX 79711

# FIGURES

**Figure 1 – Site Location Map**

**Figure 2 – Delineation Soil Sample Location Map**

**Figure 3 – Confirmation Soil Sample Location Map (Bottom Holes)**

**Figure 4 – Confirmation Soil Sample Location Map (Side Walls)**

**Closure Request and Remediation Summary Report  
NEDU CTB**





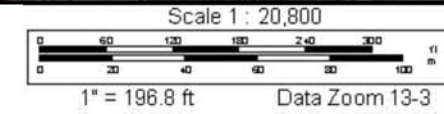
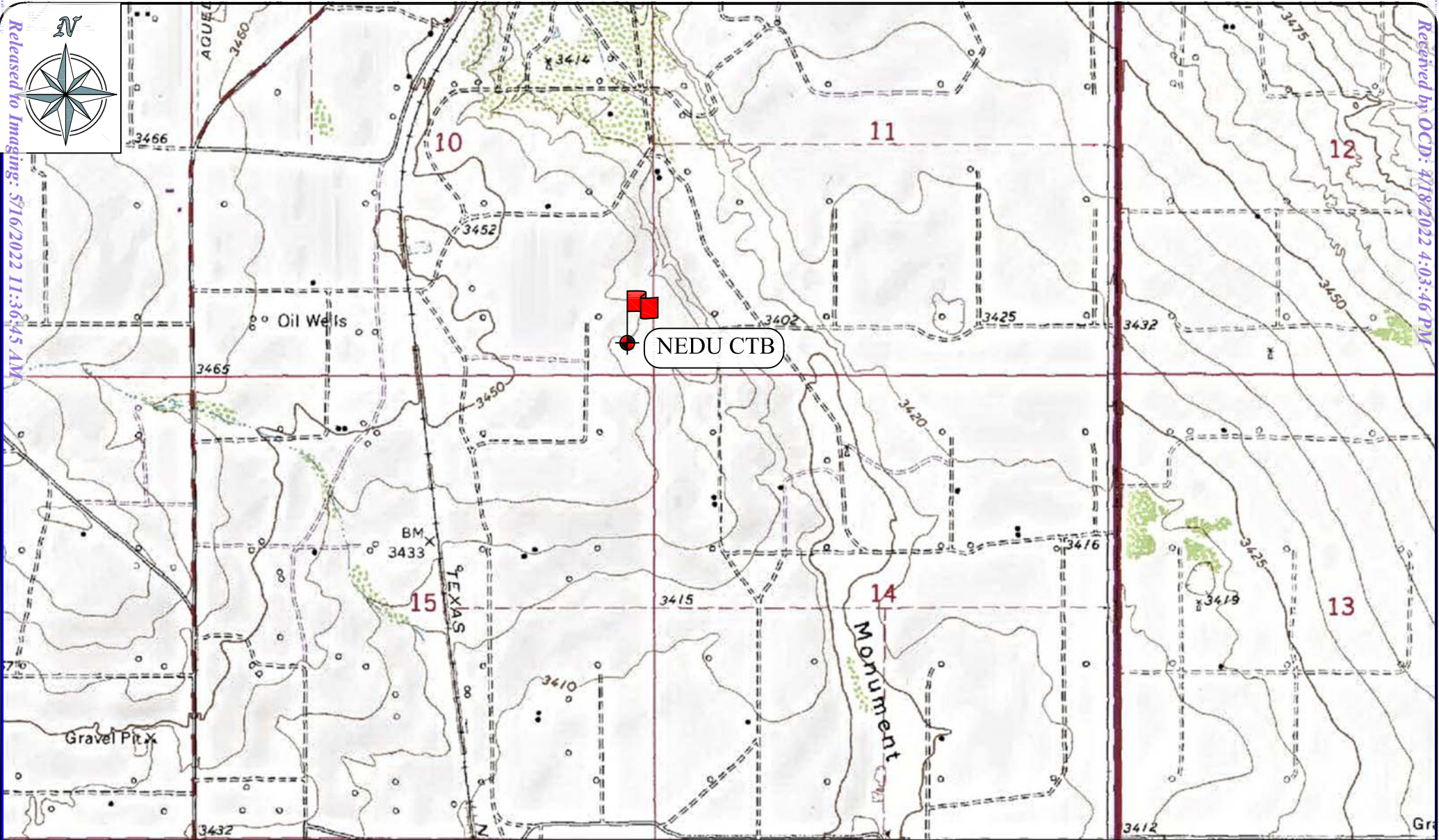

Site - NEDU CTB  
Site Location Map  
Apache Corporation  
Lea County, NM  
N 32.487188°, W 103.143346°  
April 2022

Legend  
 = Site Location



Figure 2 Delineation	Project Name:	NEDU CTB	Project No.:	15817	Page 9 of 63
	Date Sampled:	December 3, 2021	GPS:	32.487188, -103.143346	





Figure 3  
Confirmation  
(Bottom Holes)

Project Name:	NEDU CTB	Project No.:	15817	Page 10 of 63
Date Sampled:	April 7, 2022	GPS:	32.487188, -103.143346	

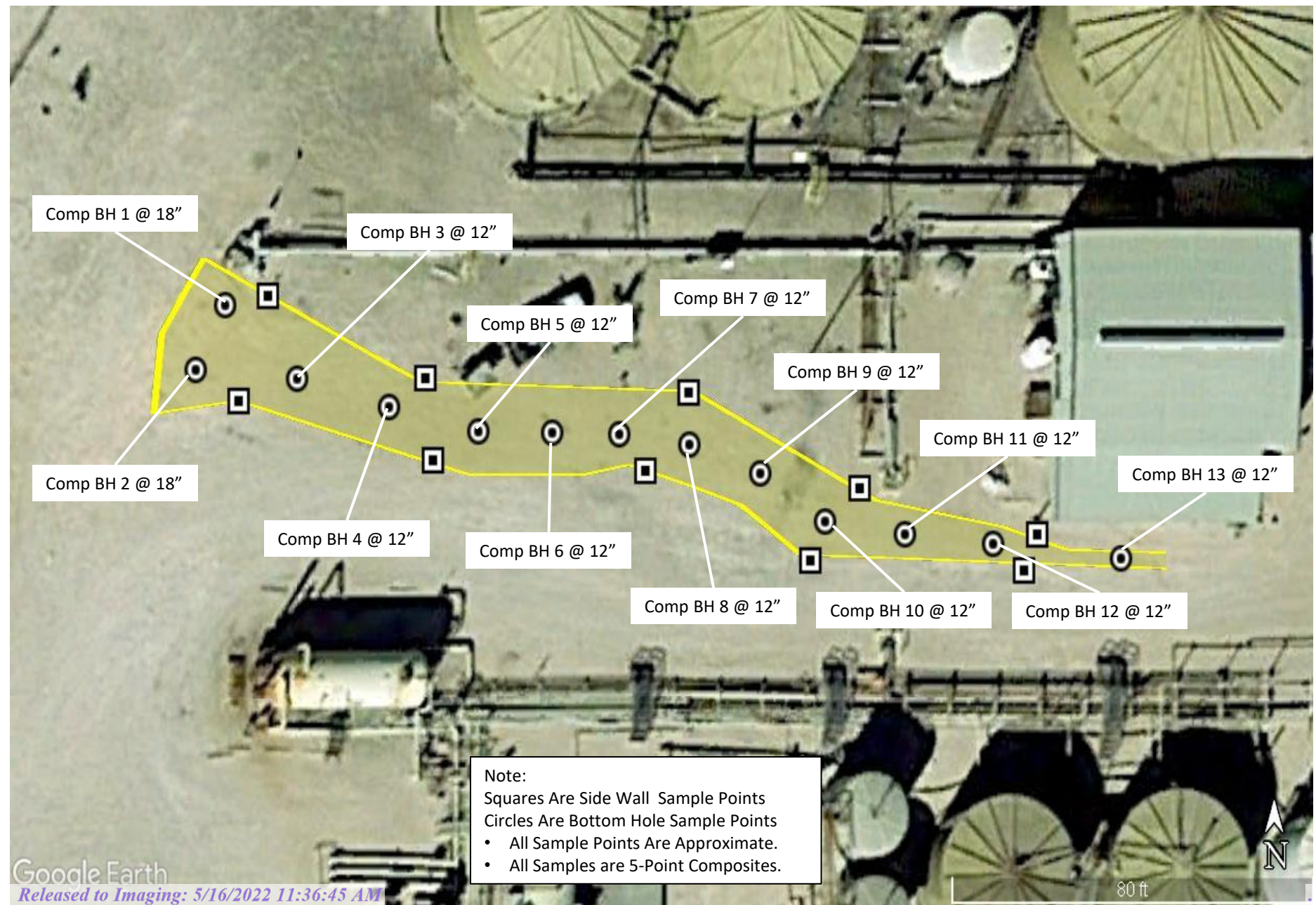
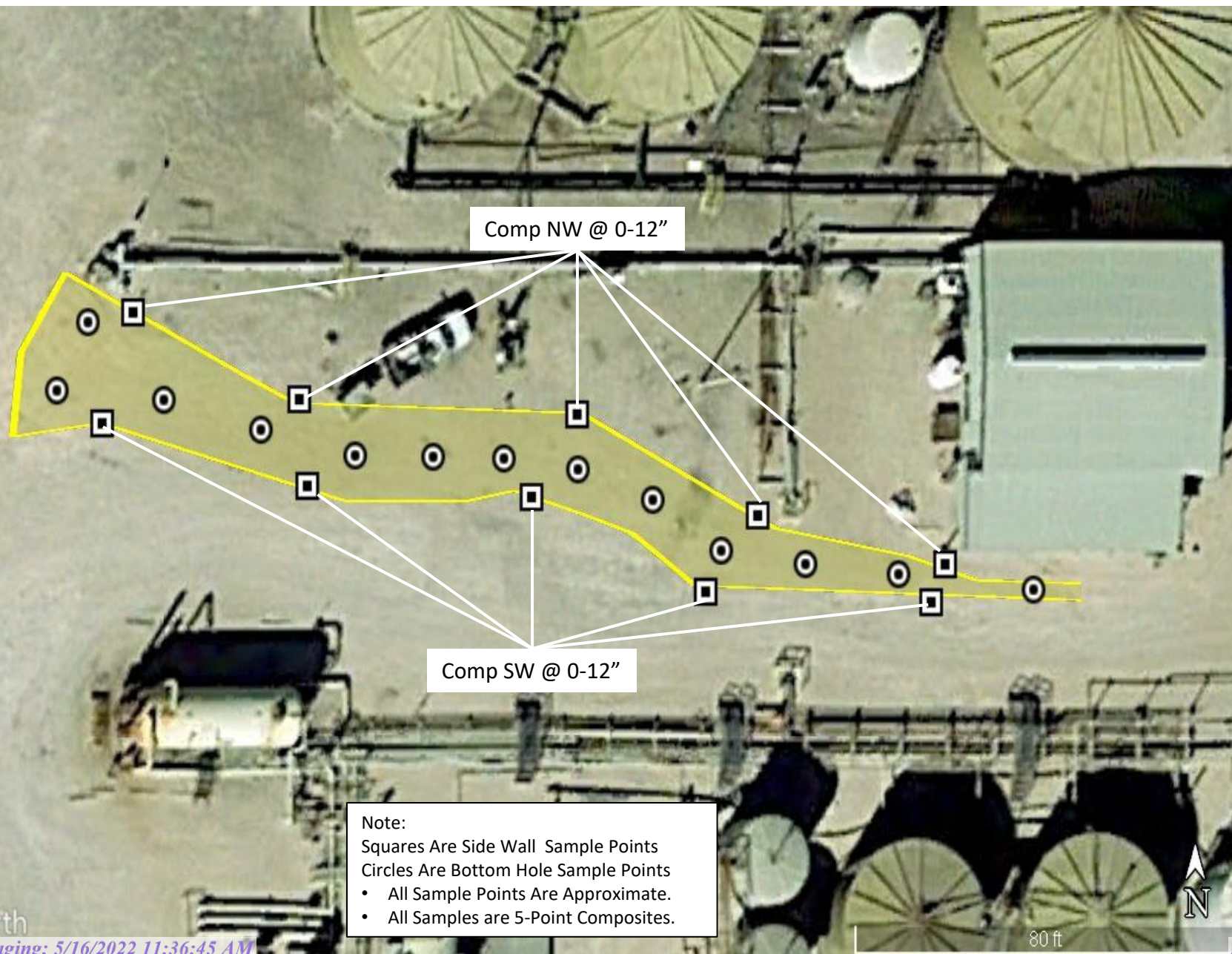



Figure 4  
Confirmation  
(Side Walls)

Project Name:	NEDU CTB	Project No.:	15817	Page 11 of 63
Date Sampled:	April 7, 2022	GPS:	32.487188, -103.143346	



# TABLES

**Table 1 – Concentrations of Benzene, BTEX, TPH, and Chlorides in Soil (Delineation)**

**Table 2 – Concentrations of Benzene, BTEX, TPH, and Chlorides in Soil (Confirmation)**

**Table 3 – Delineation Soil Sample GPS Points**

**Table 4 – Confirmation Soil Sample GPS Points**

**Closure Request and Remediation Summary Report  
NEDU CTB**



**TABLE 1****CONCENTRATIONS OF BENZENE, BTEX, TPH AND CHLORIDE IN SOIL  
DELINEATION SAMPLE RESULTS****APACHE CORPORATION****NEDU CTB RELEASE SITE****NMOCD INCIDENT: nAPP2127147753****LEA COUNTY, NEW MEXICO***All concentrations are reported in mg/Kg*

SAMPLE LOCATION	SAMPLE DATE	METHOD: SW 846-8021B				METHOD: SW 8015M					METHOD: SM 4500Cl-B
		BENZENE	TOLUENE	ETHYL-BENZENE	TOTAL XYLENES	TOTAL BTEX	TPH GRO C <sub>6</sub> -C <sub>10</sub>	TPH DRO C <sub>10</sub> -C <sub>28</sub>	TPH ORO C <sub>28</sub> -C <sub>36</sub>	TOTAL TPH C <sub>6</sub> -C <sub>35</sub>	CHLORIDE
Limits		10 mg/Kg				50 mg/Kg				100 mg/Kg	600 mg/Kg
Vertical Delineation Sample Results											
SP 1 @ SURFACE	12/3/2021	<0.050	<0.050	<0.050	<0.150	<0.300	<10.0	<10.0	<10.0	<10.0	5,520
SP 1 @ 1'	12/3/2021	<0.050	<0.050	<0.050	<0.150	<0.300	<10.0	<10.0	<10.0	<10.0	464
SP 2 @ SURFACE	12/3/2021	<0.050	0.058	0.117	1.140	1.315	<10.0	463	118	581	752
SP 2 @ 1'	12/3/2021	<0.050	<0.050	<0.050	<0.150	<0.300	<10.0	<10.0	<10.0	<10.0	384
SP 3 @ SURFACE	12/3/2021	<0.050	<0.050	<0.050	<0.150	<0.300	<10.0	63.8	16.6	80.4	496
SP 3 @ 1'	12/3/2021	<0.050	<0.050	<0.050	<0.150	<0.300	<10.0	<10.0	<10.0	<10.0	256
SP 4 @ SURFACE	12/3/2021	<0.050	<0.050	<0.050	<0.150	<0.300	<10.0	<10.0	<10.0	<10.0	1,740
SP 4 @ 1'	12/3/2021	<0.050	<0.050	<0.050	<0.150	<0.300	<10.0	<10.0	<10.0	<10.0	272
Horizontal Delineation Sample Results											
H1	12/3/2021	<0.050	<0.050	<0.050	<0.150	<0.300	<10.0	<10.0	<10.0	<10.0	256
H2	12/3/2021	<0.050	<0.050	<0.050	<0.150	<0.300	<10.0	<10.0	<10.0	<10.0	560
H3	12/3/2021	<0.050	<0.050	<0.050	<0.150	<0.300	<10.0	<10.0	<10.0	<10.0	336

**Bold and Yellow Highlighted indicates Analyte Above NMOCD Regulatory Limit**



TABLE 2

**CONCENTRATIONS OF BENZENE, BTEX, TPH AND CHLORIDE IN SOIL  
CONFIRMATION SAMPLE RESULTS**

**APACHE CORPORATION**

**NEDU CTB RELEASE SITE**

**NMOCD INCIDENT: nAPP2127147753**

**LEA COUNTY, NEW MEXICO**

*All concentrations are reported in mg/Kg*

SAMPLE LOCATION	SAMPLE DATE	METHODS: SW 846-8021B				METHOD: SW 8015M					METHOD: SM 4500Cl-B
		BENZENE	TOLUENE	ETHYL-BENZENE	TOTAL XYLENES	TOTAL BTEX	TPH GRO C <sub>6</sub> -C <sub>10</sub>	TPH DRO C <sub>10</sub> -C <sub>28</sub>	TPH ORO C <sub>28</sub> -C <sub>36</sub>	TOTAL TPH C <sub>6</sub> -C <sub>36</sub>	CHLORIDE
Limits		10 mg/Kg				50 mg/Kg				100 mg/Kg	600 mg/Kg
Bottom Hole Sample Results											
COMP BH 1 @ 18"	4/7/2022	<0.050	<0.050	<0.050	<0.150	<0.300	<10.0	<10.0	<10.0	<10.0	64.0
COMP BH 2 @ 18"	4/7/2022	<0.050	<0.050	<0.050	<0.150	<0.300	<10.0	<10.0	<10.0	<10.0	144
COMP BH 3 @ 12"	4/7/2022	<0.050	<0.050	<0.050	<0.150	<0.300	<10.0	<10.0	<10.0	<10.0	272
COMP BH 4 @ 12"	4/7/2022	<0.050	<0.050	<0.050	<0.150	<0.300	<10.0	<10.0	<10.0	<10.0	304
COMP BH 5 @ 12"	4/7/2022	<0.050	<0.050	<0.050	<0.150	<0.300	<10.0	<10.0	<10.0	<10.0	320
COMP BH 6 @ 12"	4/7/2022	<0.050	<0.050	<0.050	<0.150	<0.300	<10.0	<10.0	<10.0	<10.0	192
COMP BH 7 @ 12"	4/7/2022	<0.050	<0.050	<0.050	<0.150	<0.300	<10.0	17.2	<10.0	17.2	384
COMP BH 8 @ 12"	4/7/2022	<0.050	<0.050	<0.050	<0.150	<0.300	<10.0	25.1	<10.0	25.1	512
COMP BH 9 @ 12"	4/7/2022	<0.050	<0.050	<0.050	<0.150	<0.300	<10.0	<10.0	<10.0	<10.0	304
COMP BH 10 @ 12"	4/7/2022	<0.050	<0.050	<0.050	<0.150	<0.300	<10.0	27.3	<10.0	27.3	544
COMP BH 11 @ 12"	4/7/2022	<0.050	<0.050	<0.050	<0.150	<0.300	<10.0	<10.0	<10.0	<10.0	544
COMP BH 12 @ 12"	4/7/2022	<0.050	<0.050	<0.050	<0.150	<0.300	<10.0	<10.0	<10.0	<10.0	128
COMP BH 13 @ 6"	4/7/2022	<0.050	<0.050	<0.050	<0.150	<0.300	<10.0	<10.0	<10.0	<10.0	416
Side Wall Sample Results											
COMP NW @ 0-12"	4/7/2022	<0.050	<0.050	<0.050	<0.150	<0.300	<10.0	<10.0	<10.0	<10.0	160
COMP SW @ 0-12"	4/7/2022	<0.050	<0.050	<0.050	<0.150	<0.300	<10.0	<10.0	<10.0	<10.0	400

**Bold and Yellow Highlighted indicates Analyte Above NMOCD Regulatory Limit**

**TABLE 3****Delineation Soil Sample GPS Points****APACHE CORPORATION****NEDU CTB RELEASE SITE****NMOCD INCIDENT: nAPP2127147753****LEA COUNTY, NEW MEXICO**

Sample Name	Latitude	Longitude
<b>Vertical Delineation Sample Points</b>		
<b>SP 1 @ SURFACE/1'</b>	32.487451°	-103.143789°
<b>SP 2 @ SURFACE/1'</b>	32.487375°	-103.143613°
<b>SP 3 @ SURFACE/1'</b>	32.487374°	-103.143421°
<b>SP 4 @ SURFACE/1'</b>	32.487321°	-103.143206°
<b>Horizontal Delineation Sample Points</b>		
<b>H1</b>	32.487316°	-103.143616°
<b>H2</b>	32.487323°	-103.143129°
<b>H3</b>	32.487442°	-103.143699°

**TABLE 4****Confirmation Soil Sample GPS Points****APACHE CORPORATION****NEDU CTB RELEASE SITE****NMOCD INCIDENT: nAPP2127147753****LEA COUNTY, NEW MEXICO**

Sample Name	Latitude	Longitude
<b>Bottom Hole Sample Points</b>		
<b>Comp BH 1 @ 18"</b>	32.487460°	-103.143820°
<b>Comp BH 2 @ 18"</b>	32.487427°	-103.143842°
<b>Comp BH 3 @ 12"</b>	32.487422°	-103.143768°
<b>Comp BH 4 @ 12"</b>	32.487408°	-103.143702°
<b>Comp BH 5 @ 12"</b>	32.487395°	-103.143638°
<b>Comp BH 6 @ 12"</b>	32.487393°	-103.143584°
<b>Comp BH 7 @ 12"</b>	32.487394°	-103.143536°
<b>Comp BH 8 @ 12"</b>	32.487389°	-103.143485°
<b>Comp BH 9 @ 12"</b>	32.487374°	-103.143433°
<b>Comp BH 10 @ 12"</b>	32.487349°	-103.143386°
<b>Comp BH 11 @ 12"</b>	32.487343°	-103.143329°
<b>Comp BH 12 @ 12"</b>	32.487338°	-103.143266°
<b>Comp BH 13 @ 6"</b>	32.487331°	-103.143176°
<b>Side Wall Sample Points</b>		
<b>COMP NW @ 0-12"</b>	32.487465°	-103.143789°
	32.487423°	-103.143676°
	32.487415°	-103.143485°
	32.487366°	-103.143361°
	32.487343°	-103.143235°
<b>COMP SW @ 0-12"</b>	32.487411°	-103.143811°
	32.487381°	-103.143670°
	32.487375°	-103.143517°
	32.487329°	-103.143397°
	32.487324°	-103.143244°

# APPENDIX A

## Photographic Documentation

**Closure Request and Remediation Summary Report  
NEDU CTB**



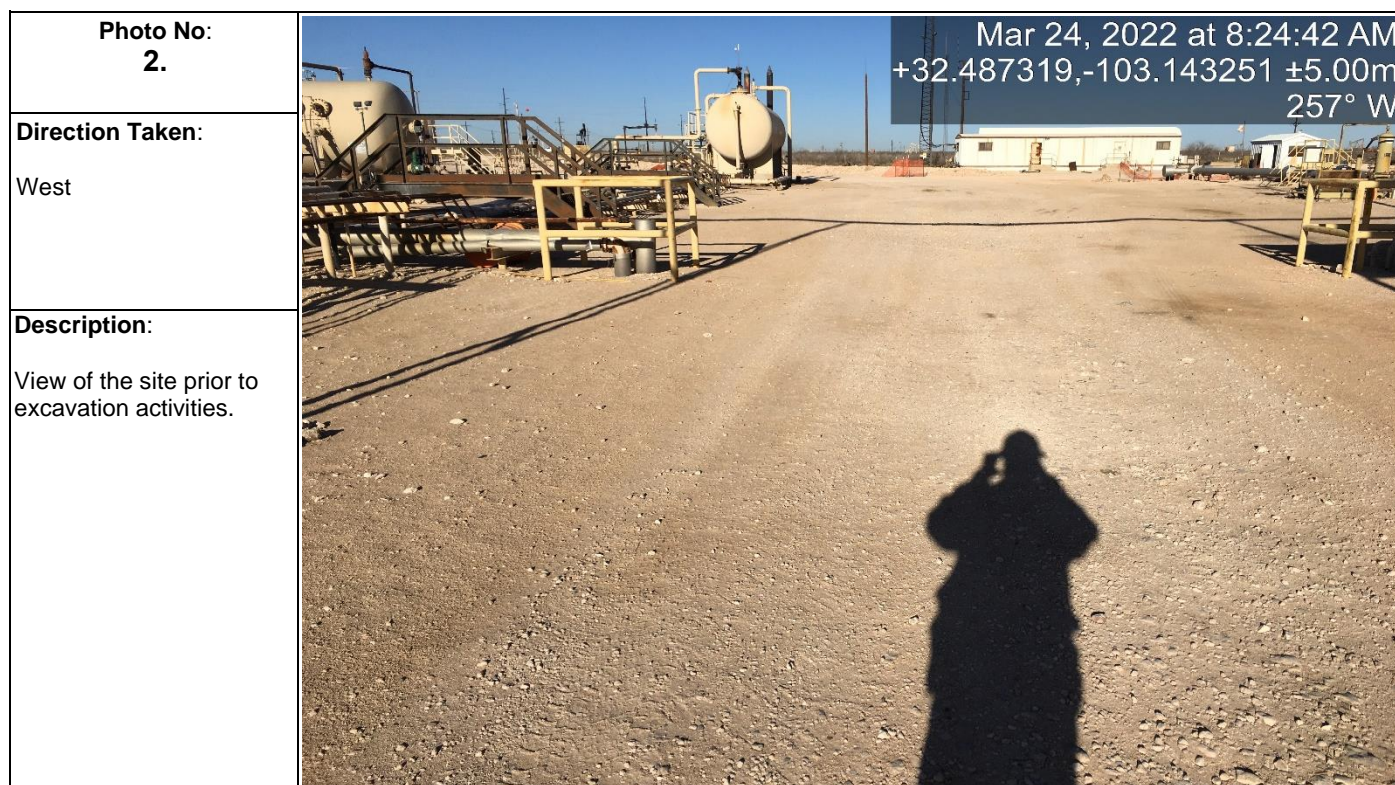

**Site Name:** NEDU CTB  
**NMOCD Incident ID:** nAPP2127147753

**Photographic Documentation**

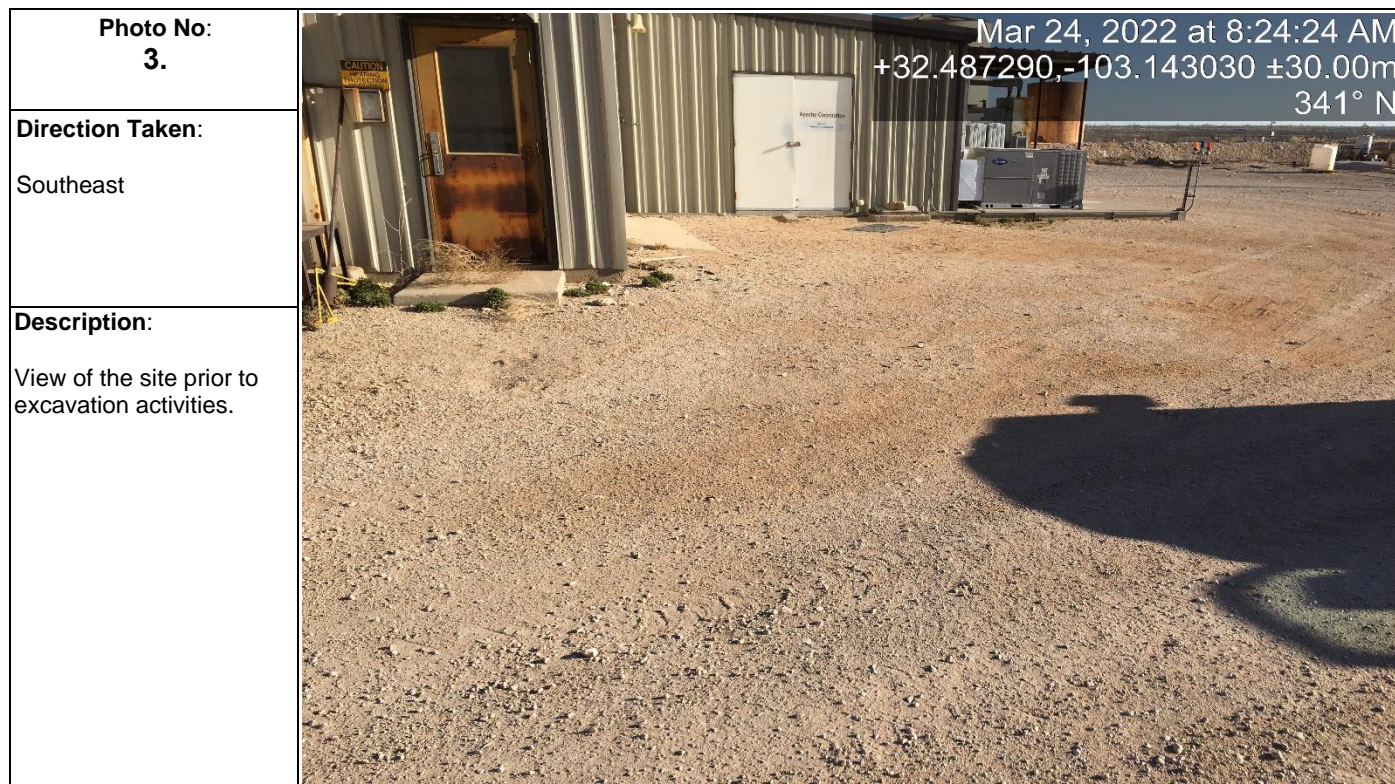

**Site Name:** NEDU CTB  
**NMOCD Incident ID:** nAPP2127147753

**Photographic Documentation**



**Site Name:** NEDU CTB  
**NMOCD Incident ID:** nAPP2127147753

**Photographic Documentation**



**Site Name:** NEDU CTB  
**NMOCD Incident ID:** nAPP2127147753

**Photographic Documentation**

**Site Name:** NEDU CTB  
**NMOCD Incident ID:** nAPP2127147753

**Photographic Documentation**

<b>Photo No:</b> <b>9.</b>	
<b>Direction Taken:</b>  West	
<b>Description:</b>  View of the backfilled area.	

# APPENDIX B

## Laboratory Analytical Reports

**Closure Request and Remediation Summary Report  
NEDU CTB**







PHONE (575) 393-2326 ° 101 E. MARLAND ° HOBBS, NM 88240

---

December 08, 2021

BRUCE BAKER

APACHE CORP - HOBBS

2350 W. MARLAND BLVD.

HOBBS, NM 88240

RE: NEDU CTB

Enclosed are the results of analyses for samples received by the laboratory on 12/03/21 16:15.

Cardinal Laboratories is accredited through Texas NELAP under certificate number T104704398-21-14. Accreditation applies to drinking water, non-potable water and solid and chemical materials. All accredited analytes are denoted by an asterisk (\*). For a complete list of accredited analytes and matrices visit the TCEQ website at [www.tceq.texas.gov/field/qa/lab\\_accred\\_certif.html](http://www.tceq.texas.gov/field/qa/lab_accred_certif.html).

Cardinal Laboratories is accredited through the State of Colorado Department of Public Health and Environment for:

Method EPA 552.2	Haloacetic Acids (HAA-5)
Method EPA 524.2	Total Trihalomethanes (TTHM)
Method EPA 524.4	Regulated VOCs (V1, V2, V3)

Accreditation applies to public drinking water matrices.

This report meets NELAP requirements and is made up of a cover page, analytical results, and a copy of the original chain-of-custody. If you have any questions concerning this report, please feel free to contact me.

Sincerely,

A handwritten signature in black ink that reads "Celey D. Keene".

Celey D. Keene

Lab Director/Quality Manager



PHONE (575) 393-2326 ° 101 E. MARLAND ° HOBBS, NM 88240

**Analytical Results For:**

APACHE CORP - HOBBS  
 BRUCE BAKER  
 2350 W. MARLAND BLVD.  
 HOBBS NM, 88240  
 Fax To: (575) 393-2432

Received: 12/03/2021  
 Reported: 12/08/2021  
 Project Name: NEDU CTB  
 Project Number: NONE GIVEN  
 Project Location: NONE GIVEN

Sampling Date: 12/03/2021  
 Sampling Type: Soil  
 Sampling Condition: Cool & Intact  
 Sample Received By: Jodi Henson

**Sample ID: SP 1 @ SURFACE (H213496-01)**

BTEX 8021B		mg/kg		Analyzed By: JH					
Analyte	Result	Reporting Limit	Analyzed	Method Blank	BS	% Recovery	True Value QC	RPD	Qualifier
Benzene*	<0.050	0.050	12/08/2021	ND	2.00	100	2.00	10.3	
Toluene*	<0.050	0.050	12/08/2021	ND	1.98	99.0	2.00	8.00	
Ethylbenzene*	<0.050	0.050	12/08/2021	ND	1.96	98.1	2.00	8.64	
Total Xylenes*	<0.150	0.150	12/08/2021	ND	5.96	99.4	6.00	9.16	
Total BTEX	<0.300	0.300	12/08/2021	ND					

Surrogate: 4-Bromofluorobenzene (PID) 98.2 % 69.9-140

Chloride, SM4500Cl-B		mg/kg		Analyzed By: GM						
Analyte	Result	Reporting Limit	Analyzed	Method Blank	BS	% Recovery	True Value QC	RPD	Qualifier	
Chloride	5520	16.0	12/08/2021	ND	400	100	400	0.00		

TPH 8015M		mg/kg		Analyzed By: MS					
Analyte	Result	Reporting Limit	Analyzed	Method Blank	BS	% Recovery	True Value QC	RPD	Qualifier
GRO C6-C10*	<10.0	10.0	12/07/2021	ND	192	95.9	200	7.90	
DRO >C10-C28*	<10.0	10.0	12/07/2021	ND	206	103	200	1.62	
EXT DRO >C28-C36	<10.0	10.0	12/07/2021	ND					

Surrogate: 1-Chlorooctane 60.4 % 44.3-133

Surrogate: 1-Chlorooctadecane 64.2 % 38.9-142

Cardinal Laboratories

\*=Accredited Analyte

PLEASE NOTE: Liability and Damages. Cardinal's liability and client's exclusive remedy for any claim arising, whether based in contract or tort, shall be limited to the amount paid by client for analyses. All claims, including those for negligence and any other cause whatsoever shall be deemed waived unless made in writing and received by Cardinal within thirty (30) days after completion of the applicable service. In no event shall Cardinal be liable for incidental or consequential damages, including, without limitation, business interruptions, loss of use, or loss of profits incurred by client, its subsidiaries, affiliates or successors arising out of or related to the performance of the services hereunder by Cardinal, regardless of whether such claim is based upon any of the above stated reasons or otherwise. Results relate only to the samples identified above. This report shall not be reproduced except in full with written approval of Cardinal Laboratories.

Celey D. Keene, Lab Director/Quality Manager



PHONE (575) 393-2326 ° 101 E. MARLAND ° HOBBS, NM 88240

**Analytical Results For:**

APACHE CORP - HOBBS  
 BRUCE BAKER  
 2350 W. MARLAND BLVD.  
 HOBBS NM, 88240  
 Fax To: (575) 393-2432

Received: 12/03/2021  
 Reported: 12/08/2021  
 Project Name: NEDU CTB  
 Project Number: NONE GIVEN  
 Project Location: NONE GIVEN

Sampling Date: 12/03/2021  
 Sampling Type: Soil  
 Sampling Condition: Cool & Intact  
 Sample Received By: Jodi Henson

**Sample ID: SP 1 @ 1' (H213496-02)**

BTX 8021B		mg/kg		Analyzed By: JH					
Analyte	Result	Reporting Limit	Analyzed	Method Blank	BS	% Recovery	True Value QC	RPD	Qualifier
Benzene*	<0.050	0.050	12/08/2021	ND	2.00	100	2.00	10.3	
Toluene*	<0.050	0.050	12/08/2021	ND	1.98	99.0	2.00	8.00	
Ethylbenzene*	<0.050	0.050	12/08/2021	ND	1.96	98.1	2.00	8.64	
Total Xylenes*	<0.150	0.150	12/08/2021	ND	5.96	99.4	6.00	9.16	
Total BTX	<0.300	0.300	12/08/2021	ND					

Surrogate: 4-Bromofluorobenzene (PID) 97.8 % 69.9-140

Chloride, SM4500CI-B		mg/kg		Analyzed By: GM						
Analyte	Result	Reporting Limit	Analyzed	Method Blank	BS	% Recovery	True Value QC	RPD	Qualifier	
Chloride	464	16.0	12/08/2021	ND	400	100	400	0.00		

TPH 8015M		mg/kg		Analyzed By: MS					
Analyte	Result	Reporting Limit	Analyzed	Method Blank	BS	% Recovery	True Value QC	RPD	Qualifier
GRO C6-C10*	<10.0	10.0	12/07/2021	ND	192	95.9	200	7.90	
DRO >C10-C28*	<10.0	10.0	12/07/2021	ND	206	103	200	1.62	
EXT DRO >C28-C36	<10.0	10.0	12/07/2021	ND					

Surrogate: 1-Chlorooctane 61.6 % 44.3-133

Surrogate: 1-Chlorooctadecane 65.5 % 38.9-142

Cardinal Laboratories

\*=Accredited Analyte

PLEASE NOTE: Liability and Damages. Cardinal's liability and client's exclusive remedy for any claim arising, whether based in contract or tort, shall be limited to the amount paid by client for analyses. All claims, including those for negligence and any other cause whatsoever shall be deemed waived unless made in writing and received by Cardinal within thirty (30) days after completion of the applicable service. In no event shall Cardinal be liable for incidental or consequential damages, including, without limitation, business interruptions, loss of use, or loss of profits incurred by client, its subsidiaries, affiliates or successors arising out of or related to the performance of the services hereunder by Cardinal, regardless of whether such claim is based upon any of the above stated reasons or otherwise. Results relate only to the samples identified above. This report shall not be reproduced except in full with written approval of Cardinal Laboratories.

Celey D. Keene, Lab Director/Quality Manager



PHONE (575) 393-2326 • 101 E. MARLAND • HOBBS, NM 88240

**Analytical Results For:**

APACHE CORP - HOBBS  
 BRUCE BAKER  
 2350 W. MARLAND BLVD.  
 HOBBS NM, 88240  
 Fax To: (575) 393-2432

Received: 12/03/2021  
 Reported: 12/08/2021  
 Project Name: NEDU CTB  
 Project Number: NONE GIVEN  
 Project Location: NONE GIVEN

Sampling Date: 12/03/2021  
 Sampling Type: Soil  
 Sampling Condition: Cool & Intact  
 Sample Received By: Jodi Henson

**Sample ID: SP 2 @ SURFACE (H213496-03)**

BTX 8021B		mg/kg		Analyzed By: MS/					
Analyte	Result	Reporting Limit	Analyzed	Method Blank	BS	% Recovery	True Value QC	RPD	Qualifier
Benzene*	<0.050	0.050	12/08/2021	ND	2.00	100	2.00	10.3	
Toluene*	0.058	0.050	12/08/2021	ND	1.98	99.0	2.00	8.00	
Ethylbenzene*	0.117	0.050	12/08/2021	ND	1.96	98.1	2.00	8.64	
Total Xylenes*	1.14	0.150	12/08/2021	ND	5.96	99.4	6.00	9.16	
Total BTX	1.31	0.300	12/08/2021	ND					

Surrogate: 4-Bromofluorobenzene (PID) 95.7 % 69.9-140

Chloride, SM4500CI-B		mg/kg		Analyzed By: GM						
Analyte	Result	Reporting Limit	Analyzed	Method Blank	BS	% Recovery	True Value QC	RPD	Qualifier	
Chloride	752	16.0	12/08/2021	ND	400	100	400	0.00		

TPH 8015M		mg/kg		Analyzed By: MS					
Analyte	Result	Reporting Limit	Analyzed	Method Blank	BS	% Recovery	True Value QC	RPD	Qualifier
GRO C6-C10*	<10.0	10.0	12/07/2021	ND	192	95.9	200	7.90	
DRO >C10-C28*	463	10.0	12/07/2021	ND	206	103	200	1.62	
EXT DRO >C28-C36	118	10.0	12/07/2021	ND					

Surrogate: 1-Chlorooctane 65.3 % 44.3-133

Surrogate: 1-Chlorooctadecane 102 % 38.9-142

Cardinal Laboratories

\*=Accredited Analyte

PLEASE NOTE: Liability and Damages. Cardinal's liability and client's exclusive remedy for any claim arising, whether based in contract or tort, shall be limited to the amount paid by client for analyses. All claims, including those for negligence and any other cause whatsoever shall be deemed waived unless made in writing and received by Cardinal within thirty (30) days after completion of the applicable service. In no event shall Cardinal be liable for incidental or consequential damages, including, without limitation, business interruptions, loss of use, or loss of profits incurred by client, its subsidiaries, affiliates or successors arising out of or related to the performance of the services hereunder by Cardinal, regardless of whether such claim is based upon any of the above stated reasons or otherwise. Results relate only to the samples identified above. This report shall not be reproduced except in full with written approval of Cardinal Laboratories.

Celey D. Keene, Lab Director/Quality Manager



PHONE (575) 393-2326 ° 101 E. MARLAND ° HOBBS, NM 88240

**Analytical Results For:**

APACHE CORP - HOBBS  
 BRUCE BAKER  
 2350 W. MARLAND BLVD.  
 HOBBS NM, 88240  
 Fax To: (575) 393-2432

Received: 12/03/2021  
 Reported: 12/08/2021  
 Project Name: NEDU CTB  
 Project Number: NONE GIVEN  
 Project Location: NONE GIVEN

Sampling Date: 12/03/2021  
 Sampling Type: Soil  
 Sampling Condition: Cool & Intact  
 Sample Received By: Jodi Henson

**Sample ID: SP 2 @ 1' (H213496-04)**

BTX 8021B		mg/kg		Analyzed By: MS/					
Analyte	Result	Reporting Limit	Analyzed	Method Blank	BS	% Recovery	True Value QC	RPD	Qualifier
Benzene*	<0.050	0.050	12/07/2021	ND	1.83	91.4	2.00	7.22	
Toluene*	<0.050	0.050	12/07/2021	ND	1.75	87.7	2.00	6.55	
Ethylbenzene*	<0.050	0.050	12/07/2021	ND	1.72	86.0	2.00	6.52	
Total Xylenes*	<0.150	0.150	12/07/2021	ND	5.29	88.2	6.00	6.23	
Total BTX	<0.300	0.300	12/07/2021	ND					

Surrogate: 4-Bromofluorobenzene (PID) 94.0 % 69.9-140

Chloride, SM4500CI-B		mg/kg		Analyzed By: GM					
Analyte	Result	Reporting Limit	Analyzed	Method Blank	BS	% Recovery	True Value QC	RPD	Qualifier
Chloride	384	16.0	12/08/2021	ND	400	100	400	0.00	

TPH 8015M		mg/kg		Analyzed By: MS					
Analyte	Result	Reporting Limit	Analyzed	Method Blank	BS	% Recovery	True Value QC	RPD	Qualifier
GRO C6-C10*	<10.0	10.0	12/07/2021	ND	192	95.9	200	7.90	
DRO >C10-C28*	<10.0	10.0	12/07/2021	ND	206	103	200	1.62	
EXT DRO >C28-C36	<10.0	10.0	12/07/2021	ND					

Surrogate: 1-Chlorooctane 67.5 % 44.3-133

Surrogate: 1-Chlorooctadecane 72.2 % 38.9-142

Cardinal Laboratories

\*=Accredited Analyte

PLEASE NOTE: Liability and Damages. Cardinal's liability and client's exclusive remedy for any claim arising, whether based in contract or tort, shall be limited to the amount paid by client for analyses. All claims, including those for negligence and any other cause whatsoever shall be deemed waived unless made in writing and received by Cardinal within thirty (30) days after completion of the applicable service. In no event shall Cardinal be liable for incidental or consequential damages, including, without limitation, business interruptions, loss of use, or loss of profits incurred by client, its subsidiaries, affiliates or successors arising out of or related to the performance of the services hereunder by Cardinal, regardless of whether such claim is based upon any of the above stated reasons or otherwise. Results relate only to the samples identified above. This report shall not be reproduced except in full with written approval of Cardinal Laboratories.

Celey D. Keene, Lab Director/Quality Manager





PHONE (575) 393-2326 ° 101 E. MARLAND ° HOBBS, NM 88240

**Analytical Results For:**

APACHE CORP - HOBBS  
 BRUCE BAKER  
 2350 W. MARLAND BLVD.  
 HOBBS NM, 88240  
 Fax To: (575) 393-2432

Received: 12/03/2021  
 Reported: 12/08/2021  
 Project Name: NEDU CTB  
 Project Number: NONE GIVEN  
 Project Location: NONE GIVEN

Sampling Date: 12/03/2021  
 Sampling Type: Soil  
 Sampling Condition: Cool & Intact  
 Sample Received By: Jodi Henson

**Sample ID: SP 3 @ SURFACE (H213496-05)**

BTX 8021B		mg/kg		Analyzed By: MS/						
Analyte	Result	Reporting Limit	Analyzed	Method Blank	BS	% Recovery	True Value QC	RPD	Qualifier	
Benzene*	<0.050	0.050	12/07/2021	ND	1.83	91.4	2.00	7.22		
Toluene*	<0.050	0.050	12/07/2021	ND	1.75	87.7	2.00	6.55		
Ethylbenzene*	<0.050	0.050	12/07/2021	ND	1.72	86.0	2.00	6.52		
Total Xylenes*	<0.150	0.150	12/07/2021	ND	5.29	88.2	6.00	6.23		
Total BTX	<0.300	0.300	12/07/2021	ND						

Surrogate: 4-Bromofluorobenzene (PID) 94.5 % 69.9-140

Chloride, SM4500CI-B		mg/kg		Analyzed By: GM						
Analyte	Result	Reporting Limit	Analyzed	Method Blank	BS	% Recovery	True Value QC	RPD	Qualifier	
Chloride	496	16.0	12/08/2021	ND	400	100	400	0.00		

TPH 8015M		mg/kg		Analyzed By: MS					
Analyte	Result	Reporting Limit	Analyzed	Method Blank	BS	% Recovery	True Value QC	RPD	Qualifier
GRO C6-C10*	<10.0	10.0	12/07/2021	ND	192	95.9	200	7.90	
DRO >C10-C28*	63.8	10.0	12/07/2021	ND	206	103	200	1.62	
EXT DRO >C28-C36	16.6	10.0	12/07/2021	ND					

Surrogate: 1-Chlorooctane 66.4 % 44.3-133

Surrogate: 1-Chlorooctadecane 72.1 % 38.9-142

Cardinal Laboratories

\*=Accredited Analyte

PLEASE NOTE: Liability and Damages. Cardinal's liability and client's exclusive remedy for any claim arising, whether based in contract or tort, shall be limited to the amount paid by client for analyses. All claims, including those for negligence and any other cause whatsoever shall be deemed waived unless made in writing and received by Cardinal within thirty (30) days after completion of the applicable service. In no event shall Cardinal be liable for incidental or consequential damages, including, without limitation, business interruptions, loss of use, or loss of profits incurred by client, its subsidiaries, affiliates or successors arising out of or related to the performance of the services hereunder by Cardinal, regardless of whether such claim is based upon any of the above stated reasons or otherwise. Results relate only to the samples identified above. This report shall not be reproduced except in full with written approval of Cardinal Laboratories.

Celey D. Keene, Lab Director/Quality Manager



PHONE (575) 393-2326 ° 101 E. MARLAND ° HOBBS, NM 88240

**Analytical Results For:**

APACHE CORP - HOBBS  
 BRUCE BAKER  
 2350 W. MARLAND BLVD.  
 HOBBS NM, 88240  
 Fax To: (575) 393-2432

Received: 12/03/2021  
 Reported: 12/08/2021  
 Project Name: NEDU CTB  
 Project Number: NONE GIVEN  
 Project Location: NONE GIVEN

Sampling Date: 12/03/2021  
 Sampling Type: Soil  
 Sampling Condition: Cool & Intact  
 Sample Received By: Jodi Henson

**Sample ID: SP 3 @ 1' (H213496-06)**

BTX 8021B		mg/kg		Analyzed By: MS/						
Analyte	Result	Reporting Limit	Analyzed	Method Blank	BS	% Recovery	True Value QC	RPD	Qualifier	
Benzene*	<0.050	0.050	12/07/2021	ND	1.83	91.4	2.00	7.22		
Toluene*	<0.050	0.050	12/07/2021	ND	1.75	87.7	2.00	6.55		
Ethylbenzene*	<0.050	0.050	12/07/2021	ND	1.72	86.0	2.00	6.52		
Total Xylenes*	<0.150	0.150	12/07/2021	ND	5.29	88.2	6.00	6.23		
Total BTX	<0.300	0.300	12/07/2021	ND						

Surrogate: 4-Bromofluorobenzene (PID) 94.3 % 69.9-140

Chloride, SM4500CI-B		mg/kg		Analyzed By: GM						
Analyte	Result	Reporting Limit	Analyzed	Method Blank	BS	% Recovery	True Value QC	RPD	Qualifier	
Chloride	256	16.0	12/08/2021	ND	400	100	400	0.00		

TPH 8015M		mg/kg		Analyzed By: MS					
Analyte	Result	Reporting Limit	Analyzed	Method Blank	BS	% Recovery	True Value QC	RPD	Qualifier
GRO C6-C10*	<10.0	10.0	12/07/2021	ND	192	95.9	200	7.90	
DRO >C10-C28*	<10.0	10.0	12/07/2021	ND	206	103	200	1.62	
EXT DRO >C28-C36	<10.0	10.0	12/07/2021	ND					

Surrogate: 1-Chlorooctane 77.9 % 44.3-133

Surrogate: 1-Chlorooctadecane 84.0 % 38.9-142

Cardinal Laboratories

\*=Accredited Analyte

PLEASE NOTE: Liability and Damages. Cardinal's liability and client's exclusive remedy for any claim arising, whether based in contract or tort, shall be limited to the amount paid by client for analyses. All claims, including those for negligence and any other cause whatsoever shall be deemed waived unless made in writing and received by Cardinal within thirty (30) days after completion of the applicable service. In no event shall Cardinal be liable for incidental or consequential damages, including, without limitation, business interruptions, loss of use, or loss of profits incurred by client, its subsidiaries, affiliates or successors arising out of or related to the performance of the services hereunder by Cardinal, regardless of whether such claim is based upon any of the above stated reasons or otherwise. Results relate only to the samples identified above. This report shall not be reproduced except in full with written approval of Cardinal Laboratories.

Celey D. Keene, Lab Director/Quality Manager



PHONE (575) 393-2326 ° 101 E. MARLAND ° HOBBS, NM 88240

**Analytical Results For:**

APACHE CORP - HOBBS  
 BRUCE BAKER  
 2350 W. MARLAND BLVD.  
 HOBBS NM, 88240  
 Fax To: (575) 393-2432

Received: 12/03/2021  
 Reported: 12/08/2021  
 Project Name: NEDU CTB  
 Project Number: NONE GIVEN  
 Project Location: NONE GIVEN

Sampling Date: 12/03/2021  
 Sampling Type: Soil  
 Sampling Condition: Cool & Intact  
 Sample Received By: Jodi Henson

**Sample ID: SP 4 @ SURFACE (H213496-07)**

BTX 8021B		mg/kg		Analyzed By: MS/						
Analyte	Result	Reporting Limit	Analyzed	Method Blank	BS	% Recovery	True Value QC	RPD	Qualifier	
Benzene*	<0.050	0.050	12/08/2021	ND	1.83	91.4	2.00	7.22		
Toluene*	<0.050	0.050	12/08/2021	ND	1.75	87.7	2.00	6.55		
Ethylbenzene*	<0.050	0.050	12/08/2021	ND	1.72	86.0	2.00	6.52		
Total Xylenes*	<0.150	0.150	12/08/2021	ND	5.29	88.2	6.00	6.23		
Total BTX	<0.300	0.300	12/08/2021	ND						

Surrogate: 4-Bromofluorobenzene (PID) 94.7 % 69.9-140

Chloride, SM4500CI-B		mg/kg		Analyzed By: GM						
Analyte	Result	Reporting Limit	Analyzed	Method Blank	BS	% Recovery	True Value QC	RPD	Qualifier	
Chloride	1740	16.0	12/08/2021	ND	400	100	400	0.00		

TPH 8015M		mg/kg		Analyzed By: MS					
Analyte	Result	Reporting Limit	Analyzed	Method Blank	BS	% Recovery	True Value QC	RPD	Qualifier
GRO C6-C10*	<10.0	10.0	12/07/2021	ND	192	95.9	200	7.90	
DRO >C10-C28*	<10.0	10.0	12/07/2021	ND	206	103	200	1.62	
EXT DRO >C28-C36	<10.0	10.0	12/07/2021	ND					

Surrogate: 1-Chlorooctane 66.7 % 44.3-133

Surrogate: 1-Chlorooctadecane 69.3 % 38.9-142

Cardinal Laboratories

\*=Accredited Analyte

PLEASE NOTE: Liability and Damages. Cardinal's liability and client's exclusive remedy for any claim arising, whether based in contract or tort, shall be limited to the amount paid by client for analyses. All claims, including those for negligence and any other cause whatsoever shall be deemed waived unless made in writing and received by Cardinal within thirty (30) days after completion of the applicable service. In no event shall Cardinal be liable for incidental or consequential damages, including, without limitation, business interruptions, loss of use, or loss of profits incurred by client, its subsidiaries, affiliates or successors arising out of or related to the performance of the services hereunder by Cardinal, regardless of whether such claim is based upon any of the above stated reasons or otherwise. Results relate only to the samples identified above. This report shall not be reproduced except in full with written approval of Cardinal Laboratories.

Celey D. Keene, Lab Director/Quality Manager



PHONE (575) 393-2326 ° 101 E. MARLAND ° HOBBS, NM 88240

**Analytical Results For:**

APACHE CORP - HOBBS  
 BRUCE BAKER  
 2350 W. MARLAND BLVD.  
 HOBBS NM, 88240  
 Fax To: (575) 393-2432

Received: 12/03/2021  
 Reported: 12/08/2021  
 Project Name: NEDU CTB  
 Project Number: NONE GIVEN  
 Project Location: NONE GIVEN

Sampling Date: 12/03/2021  
 Sampling Type: Soil  
 Sampling Condition: Cool & Intact  
 Sample Received By: Jodi Henson

**Sample ID: SP 4 @ 1' (H213496-08)**

BTX 8021B		mg/kg		Analyzed By: MS/					
Analyte	Result	Reporting Limit	Analyzed	Method Blank	BS	% Recovery	True Value QC	RPD	Qualifier
Benzene*	<0.050	0.050	12/08/2021	ND	1.83	91.4	2.00	7.22	
Toluene*	<0.050	0.050	12/08/2021	ND	1.75	87.7	2.00	6.55	
Ethylbenzene*	<0.050	0.050	12/08/2021	ND	1.72	86.0	2.00	6.52	
Total Xylenes*	<0.150	0.150	12/08/2021	ND	5.29	88.2	6.00	6.23	
Total BTX	<0.300	0.300	12/08/2021	ND					

Surrogate: 4-Bromofluorobenzene (PID) 93.8 % 69.9-140

Chloride, SM4500CI-B		mg/kg		Analyzed By: GM					
Analyte	Result	Reporting Limit	Analyzed	Method Blank	BS	% Recovery	True Value QC	RPD	Qualifier
Chloride	272	16.0	12/08/2021	ND	416	104	400	0.00	

TPH 8015M		mg/kg		Analyzed By: MS					
Analyte	Result	Reporting Limit	Analyzed	Method Blank	BS	% Recovery	True Value QC	RPD	Qualifier
GRO C6-C10*	<10.0	10.0	12/07/2021	ND	192	95.9	200	7.90	
DRO >C10-C28*	<10.0	10.0	12/07/2021	ND	206	103	200	1.62	
EXT DRO >C28-C36	<10.0	10.0	12/07/2021	ND					

Surrogate: 1-Chlorooctane 76.9 % 44.3-133

Surrogate: 1-Chlorooctadecane 80.8 % 38.9-142

Cardinal Laboratories

\*=Accredited Analyte

PLEASE NOTE: Liability and Damages. Cardinal's liability and client's exclusive remedy for any claim arising, whether based in contract or tort, shall be limited to the amount paid by client for analyses. All claims, including those for negligence and any other cause whatsoever shall be deemed waived unless made in writing and received by Cardinal within thirty (30) days after completion of the applicable service. In no event shall Cardinal be liable for incidental or consequential damages, including, without limitation, business interruptions, loss of use, or loss of profits incurred by client, its subsidiaries, affiliates or successors arising out of or related to the performance of the services hereunder by Cardinal, regardless of whether such claim is based upon any of the above stated reasons or otherwise. Results relate only to the samples identified above. This report shall not be reproduced except in full with written approval of Cardinal Laboratories.

Celey D. Keene, Lab Director/Quality Manager





PHONE (575) 393-2326 ° 101 E. MARLAND ° HOBBS, NM 88240

**Analytical Results For:**

APACHE CORP - HOBBS  
 BRUCE BAKER  
 2350 W. MARLAND BLVD.  
 HOBBS NM, 88240  
 Fax To: (575) 393-2432

Received: 12/03/2021  
 Reported: 12/08/2021  
 Project Name: NEDU CTB  
 Project Number: NONE GIVEN  
 Project Location: NONE GIVEN

Sampling Date: 12/03/2021  
 Sampling Type: Soil  
 Sampling Condition: Cool & Intact  
 Sample Received By: Jodi Henson

**Sample ID: H 1 (H213496-09)**

BTEx 8021B		mg/kg		Analyzed By: MS/						
Analyte	Result	Reporting Limit	Analyzed	Method Blank	BS	% Recovery	True Value QC	RPD	Qualifier	
Benzene*	<0.050	0.050	12/08/2021	ND	1.83	91.4	2.00	7.22		
Toluene*	<0.050	0.050	12/08/2021	ND	1.75	87.7	2.00	6.55		
Ethylbenzene*	<0.050	0.050	12/08/2021	ND	1.72	86.0	2.00	6.52		
Total Xylenes*	<0.150	0.150	12/08/2021	ND	5.29	88.2	6.00	6.23		
Total BTEx	<0.300	0.300	12/08/2021	ND						

Surrogate: 4-Bromofluorobenzene (PID) 94.6 % 69.9-140

Chloride, SM4500CI-B		mg/kg		Analyzed By: GM					
Analyte	Result	Reporting Limit	Analyzed	Method Blank	BS	% Recovery	True Value QC	RPD	Qualifier
Chloride	256	16.0	12/08/2021	ND	416	104	400	0.00	

TPH 8015M		mg/kg		Analyzed By: MS					
Analyte	Result	Reporting Limit	Analyzed	Method Blank	BS	% Recovery	True Value QC	RPD	Qualifier
GRO C6-C10*	<10.0	10.0	12/07/2021	ND	192	95.9	200	7.90	
DRO >C10-C28*	<10.0	10.0	12/07/2021	ND	206	103	200	1.62	
EXT DRO >C28-C36	<10.0	10.0	12/07/2021	ND					

Surrogate: 1-Chlorooctane 80.5 % 44.3-133

Surrogate: 1-Chlorooctadecane 83.8 % 38.9-142

Cardinal Laboratories

\*=Accredited Analyte

PLEASE NOTE: Liability and Damages. Cardinal's liability and client's exclusive remedy for any claim arising, whether based in contract or tort, shall be limited to the amount paid by client for analyses. All claims, including those for negligence and any other cause whatsoever shall be deemed waived unless made in writing and received by Cardinal within thirty (30) days after completion of the applicable service. In no event shall Cardinal be liable for incidental or consequential damages, including, without limitation, business interruptions, loss of use, or loss of profits incurred by client, its subsidiaries, affiliates or successors arising out of or related to the performance of the services hereunder by Cardinal, regardless of whether such claim is based upon any of the above stated reasons or otherwise. Results relate only to the samples identified above. This report shall not be reproduced except in full with written approval of Cardinal Laboratories.

Celey D. Keene, Lab Director/Quality Manager



PHONE (575) 393-2326 ° 101 E. MARLAND ° HOBBS, NM 88240

**Analytical Results For:**

APACHE CORP - HOBBS  
 BRUCE BAKER  
 2350 W. MARLAND BLVD.  
 HOBBS NM, 88240  
 Fax To: (575) 393-2432

Received: 12/03/2021  
 Reported: 12/08/2021  
 Project Name: NEDU CTB  
 Project Number: NONE GIVEN  
 Project Location: NONE GIVEN

Sampling Date: 12/03/2021  
 Sampling Type: Soil  
 Sampling Condition: Cool & Intact  
 Sample Received By: Jodi Henson

**Sample ID: H 2 (H213496-10)**

BTEx 8021B		mg/kg		Analyzed By: MS/						
Analyte	Result	Reporting Limit	Analyzed	Method Blank	BS	% Recovery	True Value QC	RPD	Qualifier	
Benzene*	<0.050	0.050	12/08/2021	ND	1.83	91.4	2.00	7.22		
Toluene*	<0.050	0.050	12/08/2021	ND	1.75	87.7	2.00	6.55		
Ethylbenzene*	<0.050	0.050	12/08/2021	ND	1.72	86.0	2.00	6.52		
Total Xylenes*	<0.150	0.150	12/08/2021	ND	5.29	88.2	6.00	6.23		
Total BTEx	<0.300	0.300	12/08/2021	ND						

Surrogate: 4-Bromofluorobenzene (PID) 94.4 % 69.9-140

Chloride, SM4500CI-B		mg/kg		Analyzed By: GM						
Analyte	Result	Reporting Limit	Analyzed	Method Blank	BS	% Recovery	True Value QC	RPD	Qualifier	
Chloride	560	16.0	12/08/2021	ND	416	104	400	0.00		

TPH 8015M		mg/kg		Analyzed By: MS					
Analyte	Result	Reporting Limit	Analyzed	Method Blank	BS	% Recovery	True Value QC	RPD	Qualifier
GRO C6-C10*	<10.0	10.0	12/07/2021	ND	192	95.9	200	7.90	
DRO >C10-C28*	<10.0	10.0	12/07/2021	ND	206	103	200	1.62	
EXT DRO >C28-C36	<10.0	10.0	12/07/2021	ND					

Surrogate: 1-Chlorooctane 67.3 % 44.3-133

Surrogate: 1-Chlorooctadecane 70.0 % 38.9-142

Cardinal Laboratories

\*=Accredited Analyte

PLEASE NOTE: Liability and Damages. Cardinal's liability and client's exclusive remedy for any claim arising, whether based in contract or tort, shall be limited to the amount paid by client for analyses. All claims, including those for negligence and any other cause whatsoever shall be deemed waived unless made in writing and received by Cardinal within thirty (30) days after completion of the applicable service. In no event shall Cardinal be liable for incidental or consequential damages, including, without limitation, business interruptions, loss of use, or loss of profits incurred by client, its subsidiaries, affiliates or successors arising out of or related to the performance of the services hereunder by Cardinal, regardless of whether such claim is based upon any of the above stated reasons or otherwise. Results relate only to the samples identified above. This report shall not be reproduced except in full with written approval of Cardinal Laboratories.

Celey D. Keene, Lab Director/Quality Manager



PHONE (575) 393-2326 ° 101 E. MARLAND ° HOBBS, NM 88240

**Analytical Results For:**

APACHE CORP - HOBBS  
 BRUCE BAKER  
 2350 W. MARLAND BLVD.  
 HOBBS NM, 88240  
 Fax To: (575) 393-2432

Received: 12/03/2021  
 Reported: 12/08/2021  
 Project Name: NEDU CTB  
 Project Number: NONE GIVEN  
 Project Location: NONE GIVEN

Sampling Date: 12/03/2021  
 Sampling Type: Soil  
 Sampling Condition: Cool & Intact  
 Sample Received By: Jodi Henson

**Sample ID: H 3 (H213496-11)**

BTEx 8021B		mg/kg		Analyzed By: MS/						
Analyte	Result	Reporting Limit	Analyzed	Method Blank	BS	% Recovery	True Value QC	RPD	Qualifier	
Benzene*	<0.050	0.050	12/08/2021	ND	1.83	91.4	2.00	7.22		
Toluene*	<0.050	0.050	12/08/2021	ND	1.75	87.7	2.00	6.55		
Ethylbenzene*	<0.050	0.050	12/08/2021	ND	1.72	86.0	2.00	6.52		
Total Xylenes*	<0.150	0.150	12/08/2021	ND	5.29	88.2	6.00	6.23		
Total BTEx	<0.300	0.300	12/08/2021	ND						

Surrogate: 4-Bromofluorobenzene (PID) 94.5 % 69.9-140

Chloride, SM4500CI-B		mg/kg		Analyzed By: GM						
Analyte	Result	Reporting Limit	Analyzed	Method Blank	BS	% Recovery	True Value QC	RPD	Qualifier	
Chloride	336	16.0	12/08/2021	ND	416	104	400	0.00		

TPH 8015M		mg/kg		Analyzed By: MS					
Analyte	Result	Reporting Limit	Analyzed	Method Blank	BS	% Recovery	True Value QC	RPD	Qualifier
GRO C6-C10*	<10.0	10.0	12/07/2021	ND	188	94.0	200	14.9	
DRO >C10-C28*	<10.0	10.0	12/07/2021	ND	201	100	200	6.84	
EXT DRO >C28-C36	<10.0	10.0	12/07/2021	ND					

Surrogate: 1-Chlorooctane 64.7 % 44.3-133

Surrogate: 1-Chlorooctadecane 61.6 % 38.9-142

Cardinal Laboratories

\*=Accredited Analyte

PLEASE NOTE: Liability and Damages. Cardinal's liability and client's exclusive remedy for any claim arising, whether based in contract or tort, shall be limited to the amount paid by client for analyses. All claims, including those for negligence and any other cause whatsoever shall be deemed waived unless made in writing and received by Cardinal within thirty (30) days after completion of the applicable service. In no event shall Cardinal be liable for incidental or consequential damages, including, without limitation, business interruptions, loss of use, or loss of profits incurred by client, its subsidiaries, affiliates or successors arising out of or related to the performance of the services hereunder by Cardinal, regardless of whether such claim is based upon any of the above stated reasons or otherwise. Results relate only to the samples identified above. This report shall not be reproduced except in full with written approval of Cardinal Laboratories.

Celey D. Keene, Lab Director/Quality Manager





---

PHONE (575) 393-2326 ° 101 E. MARLAND ° HOBBS, NM 88240

---

### Notes and Definitions

QR-04	The RPD for the BS/BSD was outside of historical limits.
BS-3	Blank spike recovery outside of lab established statistical limits, but still within method limits. Data is not adversely affected.
ND	Analyte NOT DETECTED at or above the reporting limit
RPD	Relative Percent Difference
**	Samples not received at proper temperature of 6°C or below.
***	Insufficient time to reach temperature.
-	Chloride by SM4500Cl-B does not require samples be received at or below 6°C Samples reported on an as received basis (wet) unless otherwise noted on report

---

Cardinal Laboratories

\*=Accredited Analyte

PLEASE NOTE: Liability and Damages. Cardinal's liability and client's exclusive remedy for any claim arising, whether based in contract or tort, shall be limited to the amount paid by client for analyses. All claims, including those for negligence and any other cause whatsoever shall be deemed waived unless made in writing and received by Cardinal within thirty (30) days after completion of the applicable service. In no event shall Cardinal be liable for incidental or consequential damages, including, without limitation, business interruptions, loss of use, or loss of profits incurred by client, its subsidiaries, affiliates or successors arising out of or related to the performance of the services hereunder by Cardinal, regardless of whether such claim is based upon any of the above stated reasons or otherwise. Results relate only to the samples identified above. This report shall not be reproduced except in full with written approval of Cardinal Laboratories.

A handwritten signature in black ink, appearing to read "Celey D. Keene".

---

Celey D. Keene, Lab Director/Quality Manager

## CHAIN-OF-CUSTODY AND ANALYSIS REQUEST

Company Name: <u>Apple</u>		P.O. #:		BILL TO		ANALYSIS REQUEST	
Project Manager: <u>Bruce B.</u>		Company:					
Address:		Attn:					
City: <u>Hobbs</u>		Address:					
State: <u>NM</u>		City:					
Zip: <u>88240</u>		State:					
Phone #:		Phone #:					
Fax #:		Fax #:					
Project #:		Project Owner:					
Project Name:		Project Location:					
Sample Name: <u>see attached</u>		Sample Name:					
FOR LAB USE ONLY		FOR LAB USE ONLY					
Lab I.D.		Sample I.D.					
H12134910		SP1 @ Surface					
1		SP1 @ 1'					
2		SP2 @ Surface					
3		SP2 @ 1'					
4		SP3 @ Surface					
5		SP3 @ 1'					
6		SP4 @ Surface					
7		SP4 @ 1'					
8		SP4 @ 1'					
9		SP4 @ 1'					
10		SP4 @ 1'					
11		SP4 @ 1'					
12		SP4 @ 1'					
13		SP4 @ 1'					
14		SP4 @ 1'					
15		SP4 @ 1'					
16		SP4 @ 1'					
17		SP4 @ 1'					
18		SP4 @ 1'					
19		SP4 @ 1'					
20		SP4 @ 1'					
21		SP4 @ 1'					
22		SP4 @ 1'					
23		SP4 @ 1'					
24		SP4 @ 1'					
25		SP4 @ 1'					
26		SP4 @ 1'					
27		SP4 @ 1'					
28		SP4 @ 1'					
29		SP4 @ 1'					
30		SP4 @ 1'					
31		SP4 @ 1'					
32		SP4 @ 1'					
33		SP4 @ 1'					
34		SP4 @ 1'					
35		SP4 @ 1'					
36		SP4 @ 1'					
37		SP4 @ 1'					
38		SP4 @ 1'					
39		SP4 @ 1'					
40		SP4 @ 1'					
41		SP4 @ 1'					
42		SP4 @ 1'					
43		SP4 @ 1'					
44		SP4 @ 1'					
45		SP4 @ 1'					
46		SP4 @ 1'					
47		SP4 @ 1'					
48		SP4 @ 1'					
49		SP4 @ 1'					
50		SP4 @ 1'					
51		SP4 @ 1'					
52		SP4 @ 1'					
53		SP4 @ 1'					
54		SP4 @ 1'					
55		SP4 @ 1'					
56		SP4 @ 1'					
57		SP4 @ 1'					
58		SP4 @ 1'					
59		SP4 @ 1'					
60		SP4 @ 1'					
61		SP4 @ 1'					
62		SP4 @ 1'					
63		SP4 @ 1'					
64		SP4 @ 1'					
65		SP4 @ 1'					
66		SP4 @ 1'					
67		SP4 @ 1'					
68		SP4 @ 1'					
69		SP4 @ 1'					
70		SP4 @ 1'					
71		SP4 @ 1'					
72		SP4 @ 1'					
73		SP4 @ 1'					
74		SP4 @ 1'					
75		SP4 @ 1'					
76		SP4 @ 1'					
77		SP4 @ 1'					
78		SP4 @ 1'					
79		SP4 @ 1'					
80		SP4 @ 1'					
81		SP4 @ 1'					
82		SP4 @ 1'					
83		SP4 @ 1'					
84		SP4 @ 1'					
85		SP4 @ 1'					
86		SP4 @ 1'					
87		SP4 @ 1'					
88		SP4 @ 1'					
89		SP4 @ 1'					
90		SP4 @ 1'					
91		SP4 @ 1'					
92		SP4 @ 1'					
93		SP4 @ 1'					
94		SP4 @ 1'					
95		SP4 @ 1'					
96		SP4 @ 1'					
97		SP4 @ 1'					
98		SP4 @ 1'					
99		SP4 @ 1'					
100		SP4 @ 1'					
101		SP4 @ 1'					
102		SP4 @ 1'					
103		SP4 @ 1'					
104		SP4 @ 1'					
105		SP4 @ 1'					



Page 15 of 15





PHONE (575) 393-2326 ° 101 E. MARLAND ° HOBBS, NM 88240

---

April 11, 2022

SEAN CARTER

ETECH Environmental & Safety Solutions, Inc.

P. O. BOX 8469

MIDLAND, TX 79708

RE: NEDU CTB

Enclosed are the results of analyses for samples received by the laboratory on 04/07/22 16:41.

Cardinal Laboratories is accredited through Texas NELAP under certificate number T104704398-21-14. Accreditation applies to drinking water, non-potable water and solid and chemical materials. All accredited analytes are denoted by an asterisk (\*). For a complete list of accredited analytes and matrices visit the TCEQ website at [www.tceq.texas.gov/field/qa/lab\\_accred\\_certif.html](http://www.tceq.texas.gov/field/qa/lab_accred_certif.html).

Cardinal Laboratories is accredited through the State of Colorado Department of Public Health and Environment for:

Method EPA 552.2	Haloacetic Acids (HAA-5)
Method EPA 524.2	Total Trihalomethanes (TTHM)
Method EPA 524.4	Regulated VOCs (V1, V2, V3)

Accreditation applies to public drinking water matrices.

This report meets NELAP requirements and is made up of a cover page, analytical results, and a copy of the original chain-of-custody. If you have any questions concerning this report, please feel free to contact me.

Sincerely,

A handwritten signature in black ink that reads "Celey D. Keene". The signature is written in a cursive, flowing style.

Celey D. Keene

Lab Director/Quality Manager



PHONE (575) 393-2326 • 101 E. MARLAND • HOBBS, NM 88240

**Analytical Results For:**

ETECH Environmental & Safety Solutions, Inc.  
 SEAN CARTER  
 P. O. BOX 8469  
 MIDLAND TX, 79708  
 Fax To: (432) 563-2213

Received:	04/07/2022	Sampling Date:	04/07/2022
Reported:	04/11/2022	Sampling Type:	Soil
Project Name:	NEDU CTB	Sampling Condition:	Cool & Intact
Project Number:	15817	Sample Received By:	Shalyn Rodriguez
Project Location:	APACHE CORP - LEA CO NM		

**Sample ID: COMP BH 1 @ 18" (H221428-01)**

BTEX 8021B		mg/kg		Analyzed By: MS/					
Analyte	Result	Reporting Limit	Analyzed	Method Blank	BS	% Recovery	True Value QC	RPD	Qualifier
Benzene*	<0.050	0.050	04/08/2022	ND	2.10	105	2.00	0.637	
Toluene*	<0.050	0.050	04/08/2022	ND	2.10	105	2.00	0.486	
Ethylbenzene*	<0.050	0.050	04/08/2022	ND	2.00	99.8	2.00	0.896	
Total Xylenes*	<0.150	0.150	04/08/2022	ND	6.16	103	6.00	1.48	
Total BTEX	<0.300	0.300	04/08/2022	ND					

Surrogate: 4-Bromofluorobenzene (PID) 103 % 69.9-140

Chloride, SM4500Cl-B		mg/kg		Analyzed By: AC						
Analyte	Result	Reporting Limit	Analyzed	Method Blank	BS	% Recovery	True Value QC	RPD	Qualifier	
Chloride	64.0	16.0	04/08/2022	ND	432	108	400	0.00		

TPH 8015M		mg/kg		Analyzed By: MS					
Analyte	Result	Reporting Limit	Analyzed	Method Blank	BS	% Recovery	True Value QC	RPD	Qualifier
GRO C6-C10*	<10.0	10.0	04/08/2022	ND	191	95.6	200	1.32	
DRO >C10-C28*	<10.0	10.0	04/08/2022	ND	200	100	200	2.30	
EXT DRO >C28-C36	<10.0	10.0	04/08/2022	ND					

Surrogate: 1-Chlorooctane 102 % 66.9-136

Surrogate: 1-Chlorooctadecane 107 % 59.5-142

Cardinal Laboratories

\*=Accredited Analyte

PLEASE NOTE: Liability and Damages. Cardinal's liability and client's exclusive remedy for any claim arising, whether based in contract or tort, shall be limited to the amount paid by client for analyses. All claims, including those for negligence and any other cause whatsoever shall be deemed waived unless made in writing and received by Cardinal within thirty (30) days after completion of the applicable service. In no event shall Cardinal be liable for incidental or consequential damages, including, without limitation, business interruptions, loss of use, or loss of profits incurred by client, its subsidiaries, affiliates or successors arising out of or related to the performance of the services hereunder by Cardinal, regardless of whether such claim is based upon any of the above stated reasons or otherwise. Results relate only to the samples identified above. This report shall not be reproduced except in full with written approval of Cardinal Laboratories.

Celey D. Keene, Lab Director/Quality Manager



PHONE (575) 393-2326 • 101 E. MARLAND • HOBBS, NM 88240

**Analytical Results For:**

ETECH Environmental & Safety Solutions, Inc.  
 SEAN CARTER  
 P. O. BOX 8469  
 MIDLAND TX, 79708  
 Fax To: (432) 563-2213

Received:	04/07/2022	Sampling Date:	04/07/2022
Reported:	04/11/2022	Sampling Type:	Soil
Project Name:	NEDU CTB	Sampling Condition:	Cool & Intact
Project Number:	15817	Sample Received By:	Shalyn Rodriguez
Project Location:	APACHE CORP - LEA CO NM		

**Sample ID: COMP BH 2 @ 18" (H221428-02)**

BTX 8021B		mg/kg		Analyzed By: MS/					
Analyte	Result	Reporting Limit	Analyzed	Method Blank	BS	% Recovery	True Value QC	RPD	Qualifier
Benzene*	<0.050	0.050	04/08/2022	ND	2.10	105	2.00	0.637	
Toluene*	<0.050	0.050	04/08/2022	ND	2.10	105	2.00	0.486	
Ethylbenzene*	<0.050	0.050	04/08/2022	ND	2.00	99.8	2.00	0.896	
Total Xylenes*	<0.150	0.150	04/08/2022	ND	6.16	103	6.00	1.48	
Total BTX	<0.300	0.300	04/08/2022	ND					

Surrogate: 4-Bromofluorobenzene (PID) 102 % 69.9-140

Chloride, SM4500CI-B		mg/kg		Analyzed By: AC						
Analyte	Result	Reporting Limit	Analyzed	Method Blank	BS	% Recovery	True Value QC	RPD	Qualifier	
Chloride	144	16.0	04/08/2022	ND	432	108	400	0.00		

TPH 8015M		mg/kg		Analyzed By: MS					
Analyte	Result	Reporting Limit	Analyzed	Method Blank	BS	% Recovery	True Value QC	RPD	Qualifier
GRO C6-C10*	<10.0	10.0	04/08/2022	ND	191	95.6	200	1.32	
DRO >C10-C28*	<10.0	10.0	04/08/2022	ND	200	100	200	2.30	
EXT DRO >C28-C36	<10.0	10.0	04/08/2022	ND					

Surrogate: 1-Chlorooctane 106 % 66.9-136

Surrogate: 1-Chlorooctadecane 111 % 59.5-142

Cardinal Laboratories

\*=Accredited Analyte

PLEASE NOTE: Liability and Damages. Cardinal's liability and client's exclusive remedy for any claim arising, whether based in contract or tort, shall be limited to the amount paid by client for analyses. All claims, including those for negligence and any other cause whatsoever shall be deemed waived unless made in writing and received by Cardinal within thirty (30) days after completion of the applicable service. In no event shall Cardinal be liable for incidental or consequential damages, including, without limitation, business interruptions, loss of use, or loss of profits incurred by client, its subsidiaries, affiliates or successors arising out of or related to the performance of the services hereunder by Cardinal, regardless of whether such claim is based upon any of the above stated reasons or otherwise. Results relate only to the samples identified above. This report shall not be reproduced except in full with written approval of Cardinal Laboratories.

Celey D. Keene, Lab Director/Quality Manager





PHONE (575) 393-2326 • 101 E. MARLAND • HOBBS, NM 88240

**Analytical Results For:**

ETECH Environmental & Safety Solutions, Inc.  
 SEAN CARTER  
 P. O. BOX 8469  
 MIDLAND TX, 79708  
 Fax To: (432) 563-2213

Received:	04/07/2022	Sampling Date:	04/07/2022
Reported:	04/11/2022	Sampling Type:	Soil
Project Name:	NEDU CTB	Sampling Condition:	Cool & Intact
Project Number:	15817	Sample Received By:	Shalyn Rodriguez
Project Location:	APACHE CORP - LEA CO NM		

**Sample ID: COMP BH 3 @ 12" (H221428-03)**

BTEx 8021B		mg/kg		Analyzed By: MS/						
Analyte	Result	Reporting Limit	Analyzed	Method Blank	BS	% Recovery	True Value QC	RPD	Qualifier	
Benzene*	<0.050	0.050	04/08/2022	ND	2.10	105	2.00	0.637		
Toluene*	<0.050	0.050	04/08/2022	ND	2.10	105	2.00	0.486		
Ethylbenzene*	<0.050	0.050	04/08/2022	ND	2.00	99.8	2.00	0.896		
Total Xylenes*	<0.150	0.150	04/08/2022	ND	6.16	103	6.00	1.48		
Total BTEx	<0.300	0.300	04/08/2022	ND						

Surrogate: 4-Bromofluorobenzene (PID) 102 % 69.9-140

Chloride, SM4500CI-B		mg/kg		Analyzed By: AC						
Analyte	Result	Reporting Limit	Analyzed	Method Blank	BS	% Recovery	True Value QC	RPD	Qualifier	
Chloride	272	16.0	04/08/2022	ND	432	108	400	0.00		

TPH 8015M		mg/kg		Analyzed By: MS					
Analyte	Result	Reporting Limit	Analyzed	Method Blank	BS	% Recovery	True Value QC	RPD	Qualifier
GRO C6-C10*	<10.0	10.0	04/08/2022	ND	191	95.6	200	1.32	
DRO >C10-C28*	<10.0	10.0	04/08/2022	ND	200	100	200	2.30	
EXT DRO >C28-C36	<10.0	10.0	04/08/2022	ND					

Surrogate: 1-Chlorooctane 109 % 66.9-136

Surrogate: 1-Chlorooctadecane 114 % 59.5-142

Cardinal Laboratories

\*=Accredited Analyte

PLEASE NOTE: Liability and Damages. Cardinal's liability and client's exclusive remedy for any claim arising, whether based in contract or tort, shall be limited to the amount paid by client for analyses. All claims, including those for negligence and any other cause whatsoever shall be deemed waived unless made in writing and received by Cardinal within thirty (30) days after completion of the applicable service. In no event shall Cardinal be liable for incidental or consequential damages, including, without limitation, business interruptions, loss of use, or loss of profits incurred by client, its subsidiaries, affiliates or successors arising out of or related to the performance of the services hereunder by Cardinal, regardless of whether such claim is based upon any of the above stated reasons or otherwise. Results relate only to the samples identified above. This report shall not be reproduced except in full with written approval of Cardinal Laboratories.

Celey D. Keene, Lab Director/Quality Manager



PHONE (575) 393-2326 • 101 E. MARLAND • HOBBS, NM 88240

**Analytical Results For:**

ETECH Environmental & Safety Solutions, Inc.  
 SEAN CARTER  
 P. O. BOX 8469  
 MIDLAND TX, 79708  
 Fax To: (432) 563-2213

Received:	04/07/2022	Sampling Date:	04/07/2022
Reported:	04/11/2022	Sampling Type:	Soil
Project Name:	NEDU CTB	Sampling Condition:	Cool & Intact
Project Number:	15817	Sample Received By:	Shalyn Rodriguez
Project Location:	APACHE CORP - LEA CO NM		

**Sample ID: COMP BH 4 @ 12" (H221428-04)**

BTX 8021B		mg/kg		Analyzed By: MS/					
Analyte	Result	Reporting Limit	Analyzed	Method Blank	BS	% Recovery	True Value QC	RPD	Qualifier
Benzene*	<0.050	0.050	04/08/2022	ND	2.10	105	2.00	0.637	
Toluene*	<0.050	0.050	04/08/2022	ND	2.10	105	2.00	0.486	
Ethylbenzene*	<0.050	0.050	04/08/2022	ND	2.00	99.8	2.00	0.896	
Total Xylenes*	<0.150	0.150	04/08/2022	ND	6.16	103	6.00	1.48	
Total BTX	<0.300	0.300	04/08/2022	ND					

Surrogate: 4-Bromofluorobenzene (PID) 102 % 69.9-140

Chloride, SM4500CI-B		mg/kg		Analyzed By: AC					
Analyte	Result	Reporting Limit	Analyzed	Method Blank	BS	% Recovery	True Value QC	RPD	Qualifier
Chloride	304	16.0	04/08/2022	ND	432	108	400	0.00	

TPH 8015M		mg/kg		Analyzed By: MS					
Analyte	Result	Reporting Limit	Analyzed	Method Blank	BS	% Recovery	True Value QC	RPD	Qualifier
GRO C6-C10*	<10.0	10.0	04/08/2022	ND	191	95.6	200	1.32	
DRO >C10-C28*	<10.0	10.0	04/08/2022	ND	200	100	200	2.30	
EXT DRO >C28-C36	<10.0	10.0	04/08/2022	ND					

Surrogate: 1-Chlorooctane 86.6 % 66.9-136

Surrogate: 1-Chlorooctadecane 90.3 % 59.5-142

Cardinal Laboratories

\*=Accredited Analyte

PLEASE NOTE: Liability and Damages. Cardinal's liability and client's exclusive remedy for any claim arising, whether based in contract or tort, shall be limited to the amount paid by client for analyses. All claims, including those for negligence and any other cause whatsoever shall be deemed waived unless made in writing and received by Cardinal within thirty (30) days after completion of the applicable service. In no event shall Cardinal be liable for incidental or consequential damages, including, without limitation, business interruptions, loss of use, or loss of profits incurred by client, its subsidiaries, affiliates or successors arising out of or related to the performance of the services hereunder by Cardinal, regardless of whether such claim is based upon any of the above stated reasons or otherwise. Results relate only to the samples identified above. This report shall not be reproduced except in full with written approval of Cardinal Laboratories.

Celey D. Keene, Lab Director/Quality Manager



PHONE (575) 393-2326 • 101 E. MARLAND • HOBBS, NM 88240

**Analytical Results For:**

ETECH Environmental & Safety Solutions, Inc.  
 SEAN CARTER  
 P. O. BOX 8469  
 MIDLAND TX, 79708  
 Fax To: (432) 563-2213

Received:	04/07/2022	Sampling Date:	04/07/2022
Reported:	04/11/2022	Sampling Type:	Soil
Project Name:	NEDU CTB	Sampling Condition:	Cool & Intact
Project Number:	15817	Sample Received By:	Shalyn Rodriguez
Project Location:	APACHE CORP - LEA CO NM		

**Sample ID: COMP BH 5 @ 12" (H221428-05)**

BTEx 8021B		mg/kg		Analyzed By: MS/						
Analyte	Result	Reporting Limit	Analyzed	Method Blank	BS	% Recovery	True Value QC	RPD	Qualifier	
Benzene*	<0.050	0.050	04/08/2022	ND	2.10	105	2.00	0.637		
Toluene*	<0.050	0.050	04/08/2022	ND	2.10	105	2.00	0.486		
Ethylbenzene*	<0.050	0.050	04/08/2022	ND	2.00	99.8	2.00	0.896		
Total Xylenes*	<0.150	0.150	04/08/2022	ND	6.16	103	6.00	1.48		
Total BTEx	<0.300	0.300	04/08/2022	ND						

Surrogate: 4-Bromofluorobenzene (PID) 103 % 69.9-140

Chloride, SM4500CI-B		mg/kg		Analyzed By: AC						
Analyte	Result	Reporting Limit	Analyzed	Method Blank	BS	% Recovery	True Value QC	RPD	Qualifier	
Chloride	320	16.0	04/08/2022	ND	432	108	400	0.00		

TPH 8015M		mg/kg		Analyzed By: MS					
Analyte	Result	Reporting Limit	Analyzed	Method Blank	BS	% Recovery	True Value QC	RPD	Qualifier
GRO C6-C10*	<10.0	10.0	04/09/2022	ND	191	95.6	200	1.32	
DRO >C10-C28*	<10.0	10.0	04/09/2022	ND	200	100	200	2.30	
EXT DRO >C28-C36	<10.0	10.0	04/09/2022	ND					

Surrogate: 1-Chlorooctane 97.9 % 66.9-136

Surrogate: 1-Chlorooctadecane 102 % 59.5-142

Cardinal Laboratories

\*=Accredited Analyte

PLEASE NOTE: Liability and Damages. Cardinal's liability and client's exclusive remedy for any claim arising, whether based in contract or tort, shall be limited to the amount paid by client for analyses. All claims, including those for negligence and any other cause whatsoever shall be deemed waived unless made in writing and received by Cardinal within thirty (30) days after completion of the applicable service. In no event shall Cardinal be liable for incidental or consequential damages, including, without limitation, business interruptions, loss of use, or loss of profits incurred by client, its subsidiaries, affiliates or successors arising out of or related to the performance of the services hereunder by Cardinal, regardless of whether such claim is based upon any of the above stated reasons or otherwise. Results relate only to the samples identified above. This report shall not be reproduced except in full with written approval of Cardinal Laboratories.

Celey D. Keene, Lab Director/Quality Manager



PHONE (575) 393-2326 • 101 E. MARLAND • HOBBS, NM 88240

**Analytical Results For:**

ETECH Environmental & Safety Solutions, Inc.  
 SEAN CARTER  
 P. O. BOX 8469  
 MIDLAND TX, 79708  
 Fax To: (432) 563-2213

Received:	04/07/2022	Sampling Date:	04/07/2022
Reported:	04/11/2022	Sampling Type:	Soil
Project Name:	NEDU CTB	Sampling Condition:	Cool & Intact
Project Number:	15817	Sample Received By:	Shalyn Rodriguez
Project Location:	APACHE CORP - LEA CO NM		

**Sample ID: COMP BH 6 @ 12" (H221428-06)**

BTEx 8021B		mg/kg		Analyzed By: MS/						
Analyte	Result	Reporting Limit	Analyzed	Method Blank	BS	% Recovery	True Value QC	RPD	Qualifier	
Benzene*	<0.050	0.050	04/08/2022	ND	2.10	105	2.00	0.637		
Toluene*	<0.050	0.050	04/08/2022	ND	2.10	105	2.00	0.486		
Ethylbenzene*	<0.050	0.050	04/08/2022	ND	2.00	99.8	2.00	0.896		
Total Xylenes*	<0.150	0.150	04/08/2022	ND	6.16	103	6.00	1.48		
Total BTEx	<0.300	0.300	04/08/2022	ND						

Surrogate: 4-Bromofluorobenzene (PID) 103 % 69.9-140

Chloride, SM4500CI-B		mg/kg		Analyzed By: AC						
Analyte	Result	Reporting Limit	Analyzed	Method Blank	BS	% Recovery	True Value QC	RPD	Qualifier	
Chloride	192	16.0	04/08/2022	ND	432	108	400	0.00		

TPH 8015M		mg/kg		Analyzed By: MS					
Analyte	Result	Reporting Limit	Analyzed	Method Blank	BS	% Recovery	True Value QC	RPD	Qualifier
GRO C6-C10*	<10.0	10.0	04/09/2022	ND	191	95.6	200	1.32	
DRO >C10-C28*	<10.0	10.0	04/09/2022	ND	200	100	200	2.30	
EXT DRO >C28-C36	<10.0	10.0	04/09/2022	ND					

Surrogate: 1-Chlorooctane 97.8 % 66.9-136

Surrogate: 1-Chlorooctadecane 102 % 59.5-142

Cardinal Laboratories

\*=Accredited Analyte

PLEASE NOTE: Liability and Damages. Cardinal's liability and client's exclusive remedy for any claim arising, whether based in contract or tort, shall be limited to the amount paid by client for analyses. All claims, including those for negligence and any other cause whatsoever shall be deemed waived unless made in writing and received by Cardinal within thirty (30) days after completion of the applicable service. In no event shall Cardinal be liable for incidental or consequential damages, including, without limitation, business interruptions, loss of use, or loss of profits incurred by client, its subsidiaries, affiliates or successors arising out of or related to the performance of the services hereunder by Cardinal, regardless of whether such claim is based upon any of the above stated reasons or otherwise. Results relate only to the samples identified above. This report shall not be reproduced except in full with written approval of Cardinal Laboratories.

Celey D. Keene, Lab Director/Quality Manager





PHONE (575) 393-2326 • 101 E. MARLAND • HOBBS, NM 88240

**Analytical Results For:**

ETECH Environmental & Safety Solutions, Inc.  
 SEAN CARTER  
 P. O. BOX 8469  
 MIDLAND TX, 79708  
 Fax To: (432) 563-2213

Received:	04/07/2022	Sampling Date:	04/07/2022
Reported:	04/11/2022	Sampling Type:	Soil
Project Name:	NEDU CTB	Sampling Condition:	Cool & Intact
Project Number:	15817	Sample Received By:	Shalyn Rodriguez
Project Location:	APACHE CORP - LEA CO NM		

**Sample ID: COMP BH 7 @ 12" (H221428-07)**

BTX 8021B		mg/kg		Analyzed By: MS/					
Analyte	Result	Reporting Limit	Analyzed	Method Blank	BS	% Recovery	True Value QC	RPD	Qualifier
Benzene*	<0.050	0.050	04/08/2022	ND	2.10	105	2.00	0.637	
Toluene*	<0.050	0.050	04/08/2022	ND	2.10	105	2.00	0.486	
Ethylbenzene*	<0.050	0.050	04/08/2022	ND	2.00	99.8	2.00	0.896	
Total Xylenes*	<0.150	0.150	04/08/2022	ND	6.16	103	6.00	1.48	
Total BTX	<0.300	0.300	04/08/2022	ND					

Surrogate: 4-Bromofluorobenzene (PID) 102 % 69.9-140

Chloride, SM4500CI-B		mg/kg		Analyzed By: AC						
Analyte	Result	Reporting Limit	Analyzed	Method Blank	BS	% Recovery	True Value QC	RPD	Qualifier	
Chloride	384	16.0	04/08/2022	ND	432	108	400	0.00		

TPH 8015M		mg/kg		Analyzed By: MS					
Analyte	Result	Reporting Limit	Analyzed	Method Blank	BS	% Recovery	True Value QC	RPD	Qualifier
GRO C6-C10*	<10.0	10.0	04/09/2022	ND	191	95.6	200	1.32	
DRO >C10-C28*	17.2	10.0	04/09/2022	ND	200	100	200	2.30	
EXT DRO >C28-C36	<10.0	10.0	04/09/2022	ND					

Surrogate: 1-Chlorooctane 89.6 % 66.9-136

Surrogate: 1-Chlorooctadecane 95.3 % 59.5-142

Cardinal Laboratories

\*=Accredited Analyte

PLEASE NOTE: Liability and Damages. Cardinal's liability and client's exclusive remedy for any claim arising, whether based in contract or tort, shall be limited to the amount paid by client for analyses. All claims, including those for negligence and any other cause whatsoever shall be deemed waived unless made in writing and received by Cardinal within thirty (30) days after completion of the applicable service. In no event shall Cardinal be liable for incidental or consequential damages, including, without limitation, business interruptions, loss of use, or loss of profits incurred by client, its subsidiaries, affiliates or successors arising out of or related to the performance of the services hereunder by Cardinal, regardless of whether such claim is based upon any of the above stated reasons or otherwise. Results relate only to the samples identified above. This report shall not be reproduced except in full with written approval of Cardinal Laboratories.

Celey D. Keene, Lab Director/Quality Manager



PHONE (575) 393-2326 • 101 E. MARLAND • HOBBS, NM 88240

**Analytical Results For:**

ETECH Environmental & Safety Solutions, Inc.  
 SEAN CARTER  
 P. O. BOX 8469  
 MIDLAND TX, 79708  
 Fax To: (432) 563-2213

Received:	04/07/2022	Sampling Date:	04/07/2022
Reported:	04/11/2022	Sampling Type:	Soil
Project Name:	NEDU CTB	Sampling Condition:	Cool & Intact
Project Number:	15817	Sample Received By:	Shalyn Rodriguez
Project Location:	APACHE CORP - LEA CO NM		

**Sample ID: COMP BH 8 @ 12" (H221428-08)**

BTEx 8021B		mg/kg		Analyzed By: MS/						
Analyte	Result	Reporting Limit	Analyzed	Method Blank	BS	% Recovery	True Value QC	RPD	Qualifier	
Benzene*	<0.050	0.050	04/08/2022	ND	2.10	105	2.00	0.637		
Toluene*	<0.050	0.050	04/08/2022	ND	2.10	105	2.00	0.486		
Ethylbenzene*	<0.050	0.050	04/08/2022	ND	2.00	99.8	2.00	0.896		
Total Xylenes*	<0.150	0.150	04/08/2022	ND	6.16	103	6.00	1.48		
Total BTEx	<0.300	0.300	04/08/2022	ND						

Surrogate: 4-Bromofluorobenzene (PID) 103 % 69.9-140

Chloride, SM4500Cl-B		mg/kg		Analyzed By: AC					
Analyte	Result	Reporting Limit	Analyzed	Method Blank	BS	% Recovery	True Value QC	RPD	Qualifier
Chloride	512	16.0	04/08/2022	ND	432	108	400	0.00	

TPH 8015M		mg/kg		Analyzed By: MS					
Analyte	Result	Reporting Limit	Analyzed	Method Blank	BS	% Recovery	True Value QC	RPD	Qualifier
GRO C6-C10*	<10.0	10.0	04/09/2022	ND	191	95.6	200	1.32	
DRO >C10-C28*	25.1	10.0	04/09/2022	ND	200	100	200	2.30	
EXT DRO >C28-C36	<10.0	10.0	04/09/2022	ND					

Surrogate: 1-Chlorooctane 70.8 % 66.9-136

Surrogate: 1-Chlorooctadecane 76.1 % 59.5-142

Cardinal Laboratories

\*=Accredited Analyte

PLEASE NOTE: Liability and Damages. Cardinal's liability and client's exclusive remedy for any claim arising, whether based in contract or tort, shall be limited to the amount paid by client for analyses. All claims, including those for negligence and any other cause whatsoever shall be deemed waived unless made in writing and received by Cardinal within thirty (30) days after completion of the applicable service. In no event shall Cardinal be liable for incidental or consequential damages, including, without limitation, business interruptions, loss of use, or loss of profits incurred by client, its subsidiaries, affiliates or successors arising out of or related to the performance of the services hereunder by Cardinal, regardless of whether such claim is based upon any of the above stated reasons or otherwise. Results relate only to the samples identified above. This report shall not be reproduced except in full with written approval of Cardinal Laboratories.

Celey D. Keene, Lab Director/Quality Manager



PHONE (575) 393-2326 • 101 E. MARLAND • HOBBS, NM 88240

**Analytical Results For:**

ETECH Environmental & Safety Solutions, Inc.  
 SEAN CARTER  
 P. O. BOX 8469  
 MIDLAND TX, 79708  
 Fax To: (432) 563-2213

Received:	04/07/2022	Sampling Date:	04/07/2022
Reported:	04/11/2022	Sampling Type:	Soil
Project Name:	NEDU CTB	Sampling Condition:	Cool & Intact
Project Number:	15817	Sample Received By:	Shalyn Rodriguez
Project Location:	APACHE CORP - LEA CO NM		

**Sample ID: COMP BH 9 @ 12" (H221428-09)**

BTX 8021B		mg/kg		Analyzed By: MS/					
Analyte	Result	Reporting Limit	Analyzed	Method Blank	BS	% Recovery	True Value QC	RPD	Qualifier
Benzene*	<0.050	0.050	04/08/2022	ND	2.10	105	2.00	0.637	
Toluene*	<0.050	0.050	04/08/2022	ND	2.10	105	2.00	0.486	
Ethylbenzene*	<0.050	0.050	04/08/2022	ND	2.00	99.8	2.00	0.896	
Total Xylenes*	<0.150	0.150	04/08/2022	ND	6.16	103	6.00	1.48	
Total BTX	<0.300	0.300	04/08/2022	ND					

Surrogate: 4-Bromofluorobenzene (PID) 104 % 69.9-140

Chloride, SM4500CI-B		mg/kg		Analyzed By: AC						
Analyte	Result	Reporting Limit	Analyzed	Method Blank	BS	% Recovery	True Value QC	RPD	Qualifier	
Chloride	304	16.0	04/08/2022	ND	432	108	400	0.00		

TPH 8015M		mg/kg		Analyzed By: MS					
Analyte	Result	Reporting Limit	Analyzed	Method Blank	BS	% Recovery	True Value QC	RPD	Qualifier
GRO C6-C10*	<10.0	10.0	04/09/2022	ND	191	95.6	200	1.32	
DRO >C10-C28*	<10.0	10.0	04/09/2022	ND	200	100	200	2.30	
EXT DRO >C28-C36	<10.0	10.0	04/09/2022	ND					

Surrogate: 1-Chlorooctane 93.2 % 66.9-136

Surrogate: 1-Chlorooctadecane 97.4 % 59.5-142

Cardinal Laboratories

\*=Accredited Analyte

PLEASE NOTE: Liability and Damages. Cardinal's liability and client's exclusive remedy for any claim arising, whether based in contract or tort, shall be limited to the amount paid by client for analyses. All claims, including those for negligence and any other cause whatsoever shall be deemed waived unless made in writing and received by Cardinal within thirty (30) days after completion of the applicable service. In no event shall Cardinal be liable for incidental or consequential damages, including, without limitation, business interruptions, loss of use, or loss of profits incurred by client, its subsidiaries, affiliates or successors arising out of or related to the performance of the services hereunder by Cardinal, regardless of whether such claim is based upon any of the above stated reasons or otherwise. Results relate only to the samples identified above. This report shall not be reproduced except in full with written approval of Cardinal Laboratories.

Celey D. Keene, Lab Director/Quality Manager



PHONE (575) 393-2326 • 101 E. MARLAND • HOBBS, NM 88240

**Analytical Results For:**

ETECH Environmental & Safety Solutions, Inc.  
 SEAN CARTER  
 P. O. BOX 8469  
 MIDLAND TX, 79708  
 Fax To: (432) 563-2213

Received:	04/07/2022	Sampling Date:	04/07/2022
Reported:	04/11/2022	Sampling Type:	Soil
Project Name:	NEDU CTB	Sampling Condition:	Cool & Intact
Project Number:	15817	Sample Received By:	Shalyn Rodriguez
Project Location:	APACHE CORP - LEA CO NM		

**Sample ID: COMP BH 10 @ 12" (H221428-10)**

BTX 8021B		mg/kg		Analyzed By: MS/					
Analyte	Result	Reporting Limit	Analyzed	Method Blank	BS	% Recovery	True Value QC	RPD	Qualifier
Benzene*	<0.050	0.050	04/08/2022	ND	2.10	105	2.00	0.637	
Toluene*	<0.050	0.050	04/08/2022	ND	2.10	105	2.00	0.486	
Ethylbenzene*	<0.050	0.050	04/08/2022	ND	2.00	99.8	2.00	0.896	
Total Xylenes*	<0.150	0.150	04/08/2022	ND	6.16	103	6.00	1.48	
Total BTX	<0.300	0.300	04/08/2022	ND					

Surrogate: 4-Bromofluorobenzene (PID) 103 % 69.9-140

Chloride, SM4500CI-B		mg/kg		Analyzed By: AC					
Analyte	Result	Reporting Limit	Analyzed	Method Blank	BS	% Recovery	True Value QC	RPD	Qualifier
Chloride	544	16.0	04/08/2022	ND	432	108	400	0.00	

TPH 8015M		mg/kg		Analyzed By: MS					
Analyte	Result	Reporting Limit	Analyzed	Method Blank	BS	% Recovery	True Value QC	RPD	Qualifier
GRO C6-C10*	<10.0	10.0	04/09/2022	ND	191	95.6	200	1.32	
DRO >C10-C28*	27.3	10.0	04/09/2022	ND	200	100	200	2.30	
EXT DRO >C28-C36	<10.0	10.0	04/09/2022	ND					

Surrogate: 1-Chlorooctane 86.9 % 66.9-136

Surrogate: 1-Chlorooctadecane 95.8 % 59.5-142

Cardinal Laboratories

\*=Accredited Analyte

PLEASE NOTE: Liability and Damages. Cardinal's liability and client's exclusive remedy for any claim arising, whether based in contract or tort, shall be limited to the amount paid by client for analyses. All claims, including those for negligence and any other cause whatsoever shall be deemed waived unless made in writing and received by Cardinal within thirty (30) days after completion of the applicable service. In no event shall Cardinal be liable for incidental or consequential damages, including, without limitation, business interruptions, loss of use, or loss of profits incurred by client, its subsidiaries, affiliates or successors arising out of or related to the performance of the services hereunder by Cardinal, regardless of whether such claim is based upon any of the above stated reasons or otherwise. Results relate only to the samples identified above. This report shall not be reproduced except in full with written approval of Cardinal Laboratories.

Celey D. Keene, Lab Director/Quality Manager





PHONE (575) 393-2326 • 101 E. MARLAND • HOBBS, NM 88240

**Analytical Results For:**

ETECH Environmental & Safety Solutions, Inc.  
 SEAN CARTER  
 P. O. BOX 8469  
 MIDLAND TX, 79708  
 Fax To: (432) 563-2213

Received:	04/07/2022	Sampling Date:	04/07/2022
Reported:	04/11/2022	Sampling Type:	Soil
Project Name:	NEDU CTB	Sampling Condition:	Cool & Intact
Project Number:	15817	Sample Received By:	Shalyn Rodriguez
Project Location:	APACHE CORP - LEA CO NM		

**Sample ID: COMP BH 11 @ 12" (H221428-11)**

BTX 8021B		mg/kg		Analyzed By: MS/					
Analyte	Result	Reporting Limit	Analyzed	Method Blank	BS	% Recovery	True Value QC	RPD	Qualifier
Benzene*	<0.050	0.050	04/08/2022	ND	2.10	105	2.00	0.637	
Toluene*	<0.050	0.050	04/08/2022	ND	2.10	105	2.00	0.486	
Ethylbenzene*	<0.050	0.050	04/08/2022	ND	2.00	99.8	2.00	0.896	
Total Xylenes*	<0.150	0.150	04/08/2022	ND	6.16	103	6.00	1.48	
Total BTX	<0.300	0.300	04/08/2022	ND					

Surrogate: 4-Bromofluorobenzene (PID) 103 % 69.9-140

Chloride, SM4500CI-B		mg/kg		Analyzed By: AC					
Analyte	Result	Reporting Limit	Analyzed	Method Blank	BS	% Recovery	True Value QC	RPD	Qualifier
Chloride	544	16.0	04/08/2022	ND	416	104	400	3.77	

TPH 8015M		mg/kg		Analyzed By: MS					
Analyte	Result	Reporting Limit	Analyzed	Method Blank	BS	% Recovery	True Value QC	RPD	Qualifier
GRO C6-C10*	<10.0	10.0	04/09/2022	ND	191	95.6	200	1.32	
DRO >C10-C28*	<10.0	10.0	04/09/2022	ND	200	100	200	2.30	
EXT DRO >C28-C36	<10.0	10.0	04/09/2022	ND					

Surrogate: 1-Chlorooctane 93.5 % 66.9-136

Surrogate: 1-Chlorooctadecane 97.2 % 59.5-142

Cardinal Laboratories

\*=Accredited Analyte

PLEASE NOTE: Liability and Damages. Cardinal's liability and client's exclusive remedy for any claim arising, whether based in contract or tort, shall be limited to the amount paid by client for analyses. All claims, including those for negligence and any other cause whatsoever shall be deemed waived unless made in writing and received by Cardinal within thirty (30) days after completion of the applicable service. In no event shall Cardinal be liable for incidental or consequential damages, including, without limitation, business interruptions, loss of use, or loss of profits incurred by client, its subsidiaries, affiliates or successors arising out of or related to the performance of the services hereunder by Cardinal, regardless of whether such claim is based upon any of the above stated reasons or otherwise. Results relate only to the samples identified above. This report shall not be reproduced except in full with written approval of Cardinal Laboratories.

Celey D. Keene, Lab Director/Quality Manager



PHONE (575) 393-2326 • 101 E. MARLAND • HOBBS, NM 88240

**Analytical Results For:**

ETECH Environmental & Safety Solutions, Inc.  
 SEAN CARTER  
 P. O. BOX 8469  
 MIDLAND TX, 79708  
 Fax To: (432) 563-2213

Received:	04/07/2022	Sampling Date:	04/07/2022
Reported:	04/11/2022	Sampling Type:	Soil
Project Name:	NEDU CTB	Sampling Condition:	Cool & Intact
Project Number:	15817	Sample Received By:	Shalyn Rodriguez
Project Location:	APACHE CORP - LEA CO NM		

**Sample ID: COMP BH 12 @ 12" (H221428-12)**

BTX 8021B		mg/kg		Analyzed By: MS/					
Analyte	Result	Reporting Limit	Analyzed	Method Blank	BS	% Recovery	True Value QC	RPD	Qualifier
Benzene*	<0.050	0.050	04/08/2022	ND	2.10	105	2.00	0.637	
Toluene*	<0.050	0.050	04/08/2022	ND	2.10	105	2.00	0.486	
Ethylbenzene*	<0.050	0.050	04/08/2022	ND	2.00	99.8	2.00	0.896	
Total Xylenes*	<0.150	0.150	04/08/2022	ND	6.16	103	6.00	1.48	
Total BTX	<0.300	0.300	04/08/2022	ND					

Surrogate: 4-Bromofluorobenzene (PID) 103 % 69.9-140

Chloride, SM4500CI-B		mg/kg		Analyzed By: AC					
Analyte	Result	Reporting Limit	Analyzed	Method Blank	BS	% Recovery	True Value QC	RPD	Qualifier
Chloride	128	16.0	04/08/2022	ND	416	104	400	3.77	

TPH 8015M		mg/kg		Analyzed By: MS					
Analyte	Result	Reporting Limit	Analyzed	Method Blank	BS	% Recovery	True Value QC	RPD	Qualifier
GRO C6-C10*	<10.0	10.0	04/09/2022	ND	191	95.6	200	1.32	
DRO >C10-C28*	<10.0	10.0	04/09/2022	ND	200	100	200	2.30	
EXT DRO >C28-C36	<10.0	10.0	04/09/2022	ND					

Surrogate: 1-Chlorooctane 104 % 66.9-136

Surrogate: 1-Chlorooctadecane 111 % 59.5-142

Cardinal Laboratories

\*=Accredited Analyte

PLEASE NOTE: Liability and Damages. Cardinal's liability and client's exclusive remedy for any claim arising, whether based in contract or tort, shall be limited to the amount paid by client for analyses. All claims, including those for negligence and any other cause whatsoever shall be deemed waived unless made in writing and received by Cardinal within thirty (30) days after completion of the applicable service. In no event shall Cardinal be liable for incidental or consequential damages, including, without limitation, business interruptions, loss of use, or loss of profits incurred by client, its subsidiaries, affiliates or successors arising out of or related to the performance of the services hereunder by Cardinal, regardless of whether such claim is based upon any of the above stated reasons or otherwise. Results relate only to the samples identified above. This report shall not be reproduced except in full with written approval of Cardinal Laboratories.

Celey D. Keene, Lab Director/Quality Manager



PHONE (575) 393-2326 • 101 E. MARLAND • HOBBS, NM 88240

**Analytical Results For:**

ETECH Environmental & Safety Solutions, Inc.  
 SEAN CARTER  
 P. O. BOX 8469  
 MIDLAND TX, 79708  
 Fax To: (432) 563-2213

Received:	04/07/2022	Sampling Date:	04/07/2022
Reported:	04/11/2022	Sampling Type:	Soil
Project Name:	NEDU CTB	Sampling Condition:	Cool & Intact
Project Number:	15817	Sample Received By:	Shalyn Rodriguez
Project Location:	APACHE CORP - LEA CO NM		

**Sample ID: COMP BH 13 @ 6" (H221428-13)**

BTX 8021B		mg/kg		Analyzed By: MS/					
Analyte	Result	Reporting Limit	Analyzed	Method Blank	BS	% Recovery	True Value QC	RPD	Qualifier
Benzene*	<0.050	0.050	04/08/2022	ND	2.10	105	2.00	0.637	
Toluene*	<0.050	0.050	04/08/2022	ND	2.10	105	2.00	0.486	
Ethylbenzene*	<0.050	0.050	04/08/2022	ND	2.00	99.8	2.00	0.896	
Total Xylenes*	<0.150	0.150	04/08/2022	ND	6.16	103	6.00	1.48	
Total BTX	<0.300	0.300	04/08/2022	ND					

Surrogate: 4-Bromofluorobenzene (PID) 102 % 69.9-140

Chloride, SM4500CI-B		mg/kg		Analyzed By: AC						
Analyte	Result	Reporting Limit	Analyzed	Method Blank	BS	% Recovery	True Value QC	RPD	Qualifier	
Chloride	416	16.0	04/08/2022	ND	416	104	400	3.77		

TPH 8015M		mg/kg		Analyzed By: MS					
Analyte	Result	Reporting Limit	Analyzed	Method Blank	BS	% Recovery	True Value QC	RPD	Qualifier
GRO C6-C10*	<10.0	10.0	04/09/2022	ND	191	95.6	200	1.32	
DRO >C10-C28*	<10.0	10.0	04/09/2022	ND	200	100	200	2.30	
EXT DRO >C28-C36	<10.0	10.0	04/09/2022	ND					

Surrogate: 1-Chlorooctane 70.4 % 66.9-136

Surrogate: 1-Chlorooctadecane 72.5 % 59.5-142

Cardinal Laboratories

\*=Accredited Analyte

PLEASE NOTE: Liability and Damages. Cardinal's liability and client's exclusive remedy for any claim arising, whether based in contract or tort, shall be limited to the amount paid by client for analyses. All claims, including those for negligence and any other cause whatsoever shall be deemed waived unless made in writing and received by Cardinal within thirty (30) days after completion of the applicable service. In no event shall Cardinal be liable for incidental or consequential damages, including, without limitation, business interruptions, loss of use, or loss of profits incurred by client, its subsidiaries, affiliates or successors arising out of or related to the performance of the services hereunder by Cardinal, regardless of whether such claim is based upon any of the above stated reasons or otherwise. Results relate only to the samples identified above. This report shall not be reproduced except in full with written approval of Cardinal Laboratories.

Celey D. Keene, Lab Director/Quality Manager

PHONE (575) 393-2326 ° 101 E. MARLAND ° HOBBS, NM 88240

---

### Notes and Definitions

ND	Analyte NOT DETECTED at or above the reporting limit
RPD	Relative Percent Difference
**	Samples not received at proper temperature of 6°C or below.
***	Insufficient time to reach temperature.
-	Chloride by SM4500Cl-B does not require samples be received at or below 6°C Samples reported on an as received basis (wet) unless otherwise noted on report

---

Cardinal Laboratories

\*=Accredited Analyte

PLEASE NOTE: Liability and Damages. Cardinal's liability and client's exclusive remedy for any claim arising, whether based in contract or tort, shall be limited to the amount paid by client for analyses. All claims, including those for negligence and any other cause whatsoever shall be deemed waived unless made in writing and received by Cardinal within thirty (30) days after completion of the applicable service. In no event shall Cardinal be liable for incidental or consequential damages, including, without limitation, business interruptions, loss of use, or loss of profits incurred by client, its subsidiaries, affiliates or successors arising out of or related to the performance of the services hereunder by Cardinal, regardless of whether such claim is based upon any of the above stated reasons or otherwise. Results relate only to the samples identified above. This report shall not be reproduced except in full with written approval of Cardinal Laboratories.

A handwritten signature in black ink, appearing to read "Celey D. Keene".

---

Celey D. Keene, Lab Director/Quality Manager





101 East Marland, Hobbs, NM 88240  
(575) 393-2326 FAX (575) 393-2476

CHAIN-OF-CUSTODY AND ANALYSIS REQUEST

Company Name: <i>Etch Environmental &amp; Safety Solutions, Inc.</i>		P.O. #:		BILL TO		ANALYSIS REQUEST	
Project Manager: <i>Sean Carter</i>		Company: <i>APACHE</i>					
Address: <i>13000 W. CR 100</i>		Attn:					
City: <i>Odessa</i>		State: <i>TX</i>		Zip: <i>79765</i>			
Phone #: <i>432 563 2200</i>		Fax #:					
Project #: <i>15817</i>		Project Owner: <i>APACHE</i>		City:			
Project Name: <i>Nadu CTB</i>		State:		Zip:			
Project Location: <i>Lee County, NM</i>		Phone #:					
Sampler Name: <i>Wesley Deslets</i>		Fax #:					

Lab I.D.	Sample I.D.	(G)RAB OR (C)OMP.	# CONTAINERS	MATRIX						PRESERV.			DATE	TIME	BTEX	TPH	Chloride	E 300.0
				GROUNDWATER	WASTEWATER	SOIL	OIL	SLUDGE	OTHER :	ACID/BASE:	ICE / COOL	OTHER :						
1301428	Comp BH1 @ 18"	C 1	1	X									4/7/22	1200	X	X	X	
2	Comp BH2 @ 18"	C 1	1	X									1205	X	X	X		
3	Comp BH3 @ 12"	C 1	1	X									1210	X	X	X		
4	Comp BH4 @ 12"	C 1	1	X									1215	X	X	X		
5	Comp BH5 @ 12"	C 1	1	X									1220	X	X	X		
6	Comp BH6 @ 12"	C 1	1	X									1225	X	X	X		
7	Comp BH7 @ 12"	C 1	1	X									1230	X	X	X		
8	Comp BH8 @ 12"	C 1	1	X									1235	X	X	X		
9	Comp BH9 @ 12"	C 1	1	X									1240	X	X	X		
10	Comp BH10 @ 12"	C 1	1	X									1245	X	X	X		

Relinquished By: <i>Sean Carter</i>	Date: <i>4/7/22</i>	Received By: <i>Wesley Deslets</i>	Date: <i>4/7/22</i>
Relinquished By: <i>Wesley Deslets</i>	Date: <i>4/7/22</i>	Received By: <i>Wesley Deslets</i>	Date: <i>4/7/22</i>

Delivered By: (Circle One)	Observed Temp. °C	Corrected Temp. °C	Sample Condition	CHECKED BY: (Initials)	Turnaround Time:	Standard	Bacteria (only)
Sampler - UPS - Bus - Other:	<i>0.12</i>	<i>0.02</i>	<input checked="" type="checkbox"/> Intact <input type="checkbox"/> Cool	<i>SE</i>	<i>48 Hrs</i>	<input checked="" type="checkbox"/> Rush	<input type="checkbox"/> Bacteria (only)

REMARKS: *B-11 to Apache Corporation*

Verbal Result: ☐ Yes ☐ No Add'l Phone #:

All Results are emailed. Please provide Email address: *Sean@etchenv.com / Wesley@etchenv.com*





**101 East Marland, Hobbs, NM 88240  
(575) 393-2326 FAX (575) 393-2476**

## CHAIN-OF-CUSTODY AND ANALYSIS REQUEST

[illegible]



PHONE (575) 393-2326 ° 101 E. MARLAND ° HOBBS, NM 88240

---

April 11, 2022

SEAN CARTER

ETECH Environmental & Safety Solutions, Inc.

P. O. BOX 8469

MIDLAND, TX 79708

RE: NEDU CTB

Enclosed are the results of analyses for samples received by the laboratory on 04/07/22 16:40.

Cardinal Laboratories is accredited through Texas NELAP under certificate number T104704398-21-14. Accreditation applies to drinking water, non-potable water and solid and chemical materials. All accredited analytes are denoted by an asterisk (\*). For a complete list of accredited analytes and matrices visit the TCEQ website at [www.tceq.texas.gov/field/qa/lab\\_accred\\_certif.html](http://www.tceq.texas.gov/field/qa/lab_accred_certif.html).

Cardinal Laboratories is accredited through the State of Colorado Department of Public Health and Environment for:

Method EPA 552.2	Haloacetic Acids (HAA-5)
Method EPA 524.2	Total Trihalomethanes (TTHM)
Method EPA 524.4	Regulated VOCs (V1, V2, V3)

Accreditation applies to public drinking water matrices.

This report meets NELAP requirements and is made up of a cover page, analytical results, and a copy of the original chain-of-custody. If you have any questions concerning this report, please feel free to contact me.

Sincerely,

A handwritten signature in black ink that reads "Celey D. Keene". The signature is written in a cursive style with a large, stylized 'C' and 'K'.

Celey D. Keene

Lab Director/Quality Manager



PHONE (575) 393-2326 • 101 E. MARLAND • HOBBS, NM 88240

**Analytical Results For:**

ETECH Environmental & Safety Solutions, Inc.  
 SEAN CARTER  
 P. O. BOX 8469  
 MIDLAND TX, 79708  
 Fax To: (432) 563-2213

Received:	04/07/2022	Sampling Date:	04/07/2022
Reported:	04/11/2022	Sampling Type:	Soil
Project Name:	NEDU CTB	Sampling Condition:	Cool & Intact
Project Number:	15817	Sample Received By:	Shalyn Rodriguez
Project Location:	APACHE CORP - LEA CO NM		

**Sample ID: COMP NW @ 0-12" (H221429-01)**

BTEX 8021B		mg/kg		Analyzed By: MS/					
Analyte	Result	Reporting Limit	Analyzed	Method Blank	BS	% Recovery	True Value QC	RPD	Qualifier
Benzene*	<0.050	0.050	04/08/2022	ND	2.10	105	2.00	0.637	
Toluene*	<0.050	0.050	04/08/2022	ND	2.10	105	2.00	0.486	
Ethylbenzene*	<0.050	0.050	04/08/2022	ND	2.00	99.8	2.00	0.896	
Total Xylenes*	<0.150	0.150	04/08/2022	ND	6.16	103	6.00	1.48	
Total BTEX	<0.300	0.300	04/08/2022	ND					

Surrogate: 4-Bromofluorobenzene (PID) 103 % 69.9-140

Chloride, SM4500Cl-B		mg/kg		Analyzed By: AC						
Analyte	Result	Reporting Limit	Analyzed	Method Blank	BS	% Recovery	True Value QC	RPD	Qualifier	
Chloride	160	16.0	04/08/2022	ND	416	104	400	3.77		

TPH 8015M		mg/kg		Analyzed By: MS					
Analyte	Result	Reporting Limit	Analyzed	Method Blank	BS	% Recovery	True Value QC	RPD	Qualifier
GRO C6-C10*	<10.0	10.0	04/09/2022	ND	191	95.6	200	1.32	
DRO >C10-C28*	<10.0	10.0	04/09/2022	ND	200	100	200	2.30	
EXT DRO >C28-C36	<10.0	10.0	04/09/2022	ND					

Surrogate: 1-Chlorooctane 103 % 66.9-136

Surrogate: 1-Chlorooctadecane 110 % 59.5-142

Cardinal Laboratories

\*=Accredited Analyte

PLEASE NOTE: Liability and Damages. Cardinal's liability and client's exclusive remedy for any claim arising, whether based in contract or tort, shall be limited to the amount paid by client for analyses. All claims, including those for negligence and any other cause whatsoever shall be deemed waived unless made in writing and received by Cardinal within thirty (30) days after completion of the applicable service. In no event shall Cardinal be liable for incidental or consequential damages, including, without limitation, business interruptions, loss of use, or loss of profits incurred by client, its subsidiaries, affiliates or successors arising out of or related to the performance of the services hereunder by Cardinal, regardless of whether such claim is based upon any of the above stated reasons or otherwise. Results relate only to the samples identified above. This report shall not be reproduced except in full with written approval of Cardinal Laboratories.

Celey D. Keene, Lab Director/Quality Manager





PHONE (575) 393-2326 • 101 E. MARLAND • HOBBS, NM 88240

**Analytical Results For:**

ETECH Environmental & Safety Solutions, Inc.  
 SEAN CARTER  
 P. O. BOX 8469  
 MIDLAND TX, 79708  
 Fax To: (432) 563-2213

Received:	04/07/2022	Sampling Date:	04/07/2022
Reported:	04/11/2022	Sampling Type:	Soil
Project Name:	NEDU CTB	Sampling Condition:	Cool & Intact
Project Number:	15817	Sample Received By:	Shalyn Rodriguez
Project Location:	APACHE CORP - LEA CO NM		

**Sample ID: COMP SW @ 0-12" (H221429-02)**

BTX 8021B		mg/kg		Analyzed By: MS/						
Analyte	Result	Reporting Limit	Analyzed	Method Blank	BS	% Recovery	True Value QC	RPD	Qualifier	
Benzene*	<0.050	0.050	04/08/2022	ND	2.10	105	2.00	0.637		
Toluene*	<0.050	0.050	04/08/2022	ND	2.10	105	2.00	0.486		
Ethylbenzene*	<0.050	0.050	04/08/2022	ND	2.00	99.8	2.00	0.896		
Total Xylenes*	<0.150	0.150	04/08/2022	ND	6.16	103	6.00	1.48		
Total BTX	<0.300	0.300	04/08/2022	ND						

Surrogate: 4-Bromofluorobenzene (PID) 102 % 69.9-140

Chloride, SM4500CI-B		mg/kg		Analyzed By: AC						
Analyte	Result	Reporting Limit	Analyzed	Method Blank	BS	% Recovery	True Value QC	RPD	Qualifier	
Chloride	400	16.0	04/08/2022	ND	416	104	400	3.77		

TPH 8015M		mg/kg		Analyzed By: MS					
Analyte	Result	Reporting Limit	Analyzed	Method Blank	BS	% Recovery	True Value QC	RPD	Qualifier
GRO C6-C10*	<10.0	10.0	04/09/2022	ND	191	95.6	200	1.32	
DRO >C10-C28*	<10.0	10.0	04/09/2022	ND	200	100	200	2.30	
EXT DRO >C28-C36	<10.0	10.0	04/09/2022	ND					

Surrogate: 1-Chlorooctane 98.4 % 66.9-136

Surrogate: 1-Chlorooctadecane 103 % 59.5-142

Cardinal Laboratories

\*=Accredited Analyte

PLEASE NOTE: Liability and Damages. Cardinal's liability and client's exclusive remedy for any claim arising, whether based in contract or tort, shall be limited to the amount paid by client for analyses. All claims, including those for negligence and any other cause whatsoever shall be deemed waived unless made in writing and received by Cardinal within thirty (30) days after completion of the applicable service. In no event shall Cardinal be liable for incidental or consequential damages, including, without limitation, business interruptions, loss of use, or loss of profits incurred by client, its subsidiaries, affiliates or successors arising out of or related to the performance of the services hereunder by Cardinal, regardless of whether such claim is based upon any of the above stated reasons or otherwise. Results relate only to the samples identified above. This report shall not be reproduced except in full with written approval of Cardinal Laboratories.

Celey D. Keene, Lab Director/Quality Manager



---

PHONE (575) 393-2326 ° 101 E. MARLAND ° HOBBS, NM 88240

---

### Notes and Definitions

ND	Analyte NOT DETECTED at or above the reporting limit
RPD	Relative Percent Difference
**	Samples not received at proper temperature of 6°C or below.
***	Insufficient time to reach temperature.
-	Chloride by SM4500Cl-B does not require samples be received at or below 6°C Samples reported on an as received basis (wet) unless otherwise noted on report

---

Cardinal Laboratories

\*=Accredited Analyte

PLEASE NOTE: Liability and Damages. Cardinal's liability and client's exclusive remedy for any claim arising, whether based in contract or tort, shall be limited to the amount paid by client for analyses. All claims, including those for negligence and any other cause whatsoever shall be deemed waived unless made in writing and received by Cardinal within thirty (30) days after completion of the applicable service. In no event shall Cardinal be liable for incidental or consequential damages, including, without limitation, business interruptions, loss of use, or loss of profits incurred by client, its subsidiaries, affiliates or successors arising out of or related to the performance of the services hereunder by Cardinal, regardless of whether such claim is based upon any of the above stated reasons or otherwise. Results relate only to the samples identified above. This report shall not be reproduced except in full with written approval of Cardinal Laboratories.

A handwritten signature in black ink, appearing to read "Celey D. Keene".

---

Celey D. Keene, Lab Director/Quality Manager

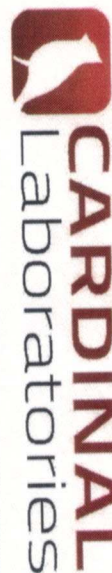

101 East Marland, Hobbs, NM 88240  
(575) 393-2326 FAX (575) 393-2476

## CHAIN-OF-CUSTODY AND ANALYSIS REQUEST

[illegible]

# APPENDIX C

## Release Notification and Corrective Action Form (Form C-141)

**Closure Request and Remediation Summary Report  
NEDU CTB**





Incident ID	
District RP	
Facility ID	
Application ID	

## Closure

The responsible party must attach information demonstrating they have complied with all applicable closure requirements and any conditions or directives of the OCD. This demonstration should be in the form of a comprehensive report (electronic submittals in .pdf format are preferred) including a scaled site map, sampling diagrams, relevant field notes, photographs of any excavation prior to backfilling, laboratory data including chain of custody documents of final sampling, and a narrative of the remedial activities. Refer to 19.15.29.12 NMAC.

**Closure Report Attachment Checklist:** *Each of the following items must be included in the closure report.*

- ☒ A scaled site and sampling diagram as described in 19.15.29.11 NMAC
- ☒ Photographs of the remediated site prior to backfill or photos of the liner integrity if applicable (Note: appropriate OCD District office must be notified 2 days prior to liner inspection)
- ☒ Laboratory analyses of final sampling (Note: appropriate ODC District office must be notified 2 days prior to final sampling)
- ☒ Description of remediation activities

I hereby certify that the information given above is true and complete to the best of my knowledge and understand that pursuant to OCD rules and regulations all operators are required to report and/or file certain release notifications and perform corrective actions for releases which may endanger public health or the environment. The acceptance of a C-141 report by the OCD does not relieve the operator of liability should their operations have failed to adequately investigate and remediate contamination that pose a threat to groundwater, surface water, human health or the environment. In addition, OCD acceptance of a C-141 report does not relieve the operator of responsibility for compliance with any other federal, state, or local laws and/or regulations. The responsible party acknowledges they must substantially restore, reclaim, and re-vegetate the impacted surface area to the conditions that existed prior to the release or their final land use in accordance with 19.15.29.13 NMAC including notification to the OCD when reclamation and re-vegetation are complete.

Printed Name: Larry Baker

Title: Environmental Tech SR.

Signature: Larry Baker

Date: 4/18/2022

email: larry.baker@apachecorp.com

Telephone: 432-215-2284

**OCD Only**

Received by: \_\_\_\_\_

Date: \_\_\_\_\_

Closure approval by the OCD does not relieve the responsible party of liability should their operations have failed to adequately investigate and remediate contamination that poses a threat to groundwater, surface water, human health, or the environment nor does not relieve the responsible party of compliance with any other federal, state, or local laws and/or regulations.

Closure Approved by: \_\_\_\_\_ Date: \_\_\_\_\_

Printed Name: \_\_\_\_\_

Title: \_\_\_\_\_

**District I**

1625 N. French Dr., Hobbs, NM 88240  
Phone:(575) 393-6161 Fax:(575) 393-0720

**District II**

811 S. First St., Artesia, NM 88210  
Phone:(575) 748-1283 Fax:(575) 748-9720

**District III**

1000 Rio Brazos Rd., Aztec, NM 87410  
Phone:(505) 334-6178 Fax:(505) 334-6170

**District IV**

1220 S. St Francis Dr., Santa Fe, NM 87505  
Phone:(505) 476-3470 Fax:(505) 476-3462

**State of New Mexico**  
**Energy, Minerals and Natural Resources**  
**Oil Conservation Division**  
**1220 S. St Francis Dr.**  
**Santa Fe, NM 87505**

CONDITIONS

Action 99548

**CONDITIONS**

Operator: APACHE CORPORATION 303 Veterans Airpark Ln Midland, TX 79705	OGRID: 873
	Action Number: 99548
	Action Type: [C-141] Release Corrective Action (C-141)

**CONDITIONS**

Created By	Condition	Condition Date
rhamlet	We have received your closure report and final C-141 for Incident #NAPP2127147753 NEDU CTB, thank you. This closure is approved.	5/16/2022