



PO Box 2948 | Hobbs, NM 88241 | Phone 575.393.2967

August 9, 2017

Attn: Mike Bratcher

New Mexico Energy, Minerals, & Natural Resources
Oil Conservation Division, Environmental Bureau – District 2
811 S. First St.
Artesia, NM 88210

**RE: Termination Request Report
XTO Energy Inc. – James Ranch Unit 135 H
UL/G sec. 21 T22S R30E
API No. 30-015-42376
2RP-4250**

Mr. Bratcher:

XTO Energy Inc. (XTO) has retained Basin Environmental Service Technologies (Basin) to address potential environmental concerns at the above-referenced site.

Background and Previous Work

The site is located approximately fourteen (14) miles northeast of Loving, New Mexico at Unit Letter G of Section 21 in Township 22 South of Range 30 East. The longitude is 32.380927 and the latitude is -103.881337. This site is located in an area where groundwater can be anticipated to found at a depth greater than two-hundred (200) feet below ground surface (bgs).

On May 5th, 2017, XTO discovered a release of approximately sixteen and seven tenths (16.7) barrels (bbls) of produced water from a corroded flow line. Approximately ten (10) bbls were recovered. The release impacted an estimated seven-thousand two-hundred eighty-eight (7,288) square feet (ft²) of well pad. The Bureau of Land Management (BLM) and New Mexico Oil Conservation Division (NMOCD) were notified of the release on June 13th, 2017, and an initial Release Notification and Corrective Action form (C-141) was submitted to NMOCD June 13th, 2017, for approval (Appendix A).

Basin personnel were on site beginning June 22nd, 2017, to begin remediation activities. The impacted area was excavated down to approximately one and a half (1.5) foot bgs except in Floor 4 which was excavated down to two and a half (2.5) feet bgs. Seven (7) discreet floor soil samples from different areas were retrieved and submitted to a certified NMOCD approved commercial laboratory for confirmatory analysis of chloride concentrations.

Numerous discrete wall soil samples were taken at a depth of approximately one foot bgs and submitted to an approved NMOCD laboratory for concentration analysis of chlorides. Laboratory analysis confirms that the boundaries of the release were encompassed within the excavated area. Laboratory analysis shows the impacted areas of the release met the criteria necessary for closure of the release. (See Figure 2 for sampling locations)

The excavated area was backfilled with clean, non-impacted soils and contoured to the surrounding area.

Soil samples collected from the XTO, James Ranch Unit 135 H release site were analyzed by an NMOCD approved laboratory, and concentrations of chloride were below the recommended remediation action level (RRAL) established for the site (Appendix B). Soil exhibiting chloride concentrations above the RRAL were removed and disposed of at a BLM/NMOCD approved facility. XTO via Basin requests site closure to the James Ranch Unit 135 H release site.

Photo documentation of the release and remediation activities can be found in Appendix C.

Basin appreciates the opportunity to work with you on this project. Please contact me if you have any questions or wish to discuss the site.

Sincerely,



Robbie Runnels
Project Manager
Basin Environmental Service Technologies
(575) 393-2967

Attachments:

Figure 1 – Site Location Map
Figure 2 - Initial sampling Data
Appendix A – Initial C-141
Appendix B – Laboratory Analysis
Appendix C – Photo Documentation

FIGURES

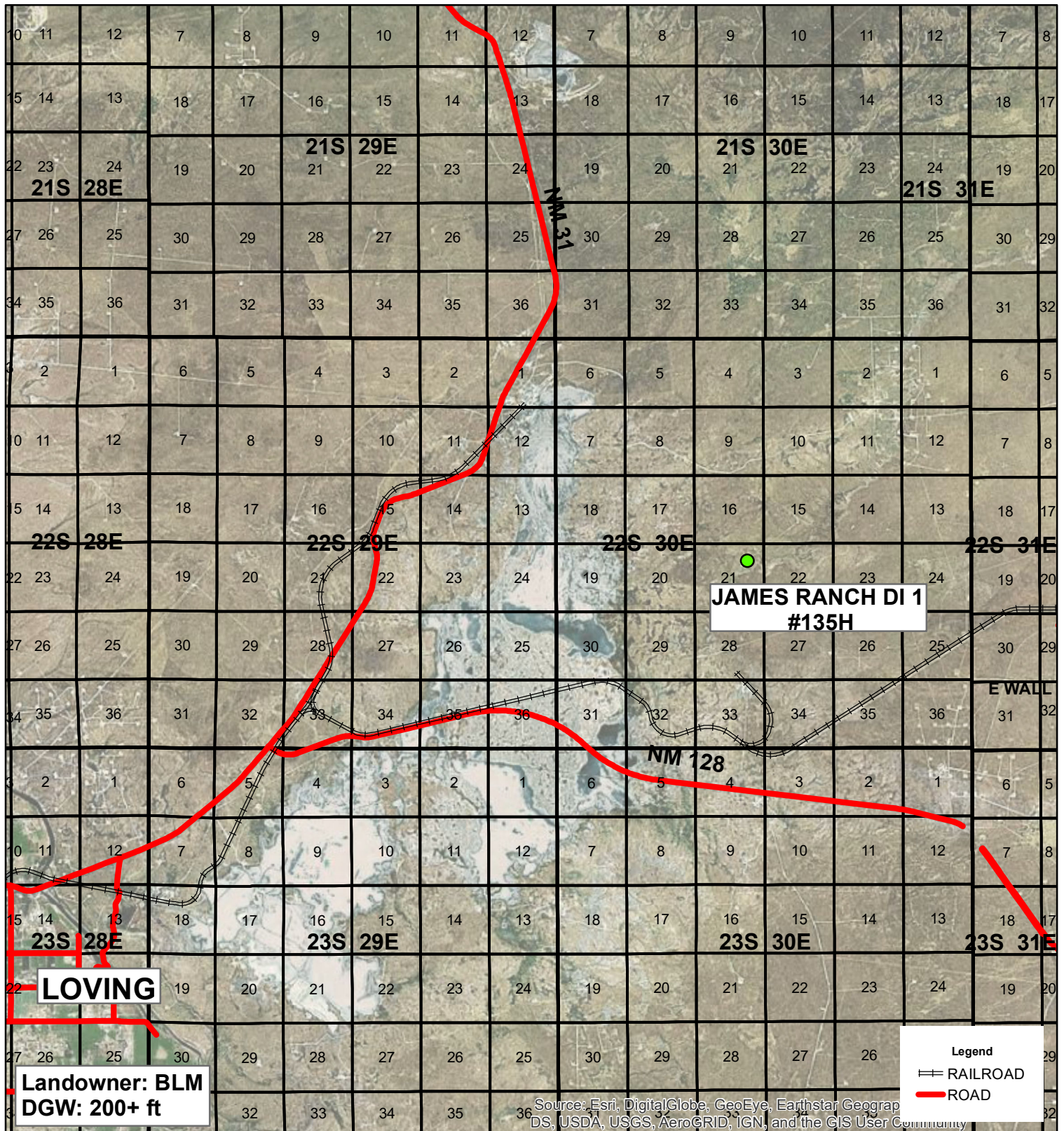

XTO
JAMES RANCH DI 1
#135H
 2RP-4250
 UL G & H SECTION 21
 T-22-S R-30-E
 EDDY COUNTY, NM

GPS (SOURCE): 32.381095 -103.881231

Figure 1

0 1 2
 Miles

Drawing date: 8/9/17
 Drafted by: T. Grieco



Initial Sampling

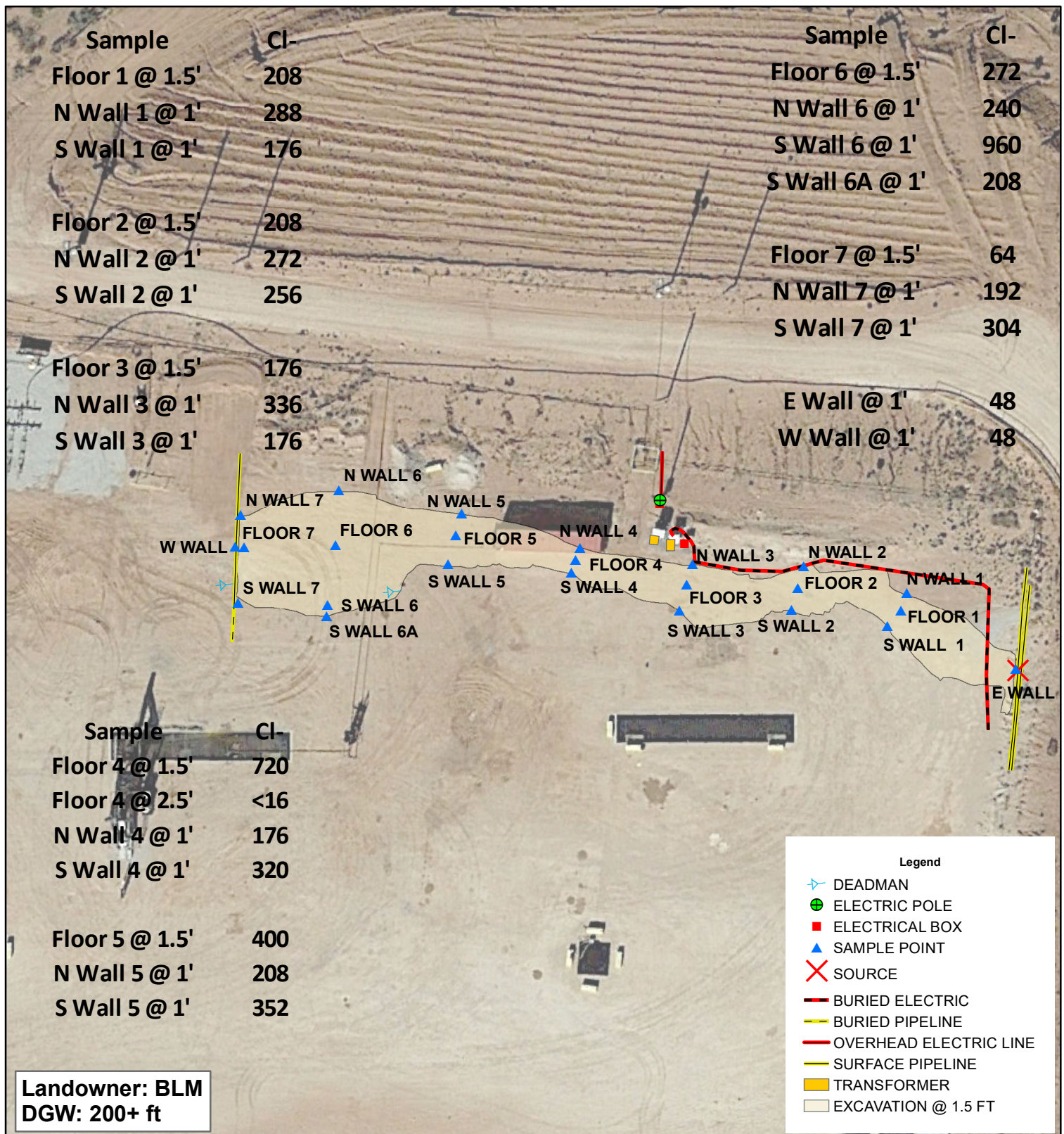

XTO
JAMES RANCH DI 1
#135H

UL G & H SECTION 21
T-22-S R-30-E
EDDY COUNTY, NM

Underground facilities are spatially projected and need to be field verified.

GPS (SOURCE): 32.381095 -103.881231

0 25 50
Feet

GPS date: 6/27/17 TG
Drawing date: 6/27/17
Drafted by: T. Grieco



APPENDICES

APPENDIX –A

C-141

NM OIL CONSERVATION

ARTESIA DISTRICT

District I
1625 N. French Dr., Hobbs, NM 88240
District II
811 S. First St., Artesia, NM 88210
District III
1000 Rio Brazos Road, Aztec, NM 87410
District IV
1220 S. St. Francis Dr., Santa Fe, NM 87505

State of New Mexico
Energy Minerals and Natural Resources

JUN 07 2017

Form C-141
Revised August 8, 2011

Oil Conservation Division
1220 South St. Francis Dr.
Santa Fe, NM 87505

RECEIVED Submit Copy to appropriate District Office in accordance with 19.15.29 NMAC.

Release Notification and Corrective Action

NAB171645716BDDCD L.P.

OPERATOR

☒ Initial Report ☐ Final Report

Name of Company: XTO Energy 2160737	Contact: Jacob Foust
Address: 522 W. Mermod, Suite 704 Carlsbad, N.M. 88220	Telephone No. 432-266-2663
Facility Name: James Ranch Unit 135 H	Facility Type: Exploration and Production

Surface Owner: Federal	Mineral Owner: Federal	API No. 30-01542376
------------------------	------------------------	---------------------

LOCATION OF RELEASE

Unit Letter A	Section 21	Township 22S	Range 30E	Feet from the 1460	North/South Line North	Feet from the 1135	East/West Line East	County Eddy
------------------	---------------	-----------------	--------------	-----------------------	---------------------------	-----------------------	------------------------	----------------

G

Latitude 32.380927 Longitude-103.881337

NATURE OF RELEASE

Type of Release Produced water	Volume of Release 16.7 bbl	Volume Recovered 10 bbl
Source of Release Flowline on eastern side of pad	Date and Hour of Occurrence 5/25/2017, time unknown	Date and Hour of Discovery 5/25/17 10:00 A.M.
Was Immediate Notice Given? <input type="checkbox"/> Yes <input type="checkbox"/> No <input checked="" type="checkbox"/> Not Required	If YES, To Whom? N/A	
By Whom? N/A	Date and Hour N/A	
Was a Watercourse Reached? <input type="checkbox"/> Yes <input checked="" type="checkbox"/> No	If YES, Volume Impacting the Watercourse. N/A	
If a Watercourse was Impacted, Describe Fully.* N/A		
Describe Cause of Problem and Remedial Action Taken.* A section of flowline pipe corroded, releasing produced water. The section of pipe was replaced.		
Describe Area Affected and Cleanup Action Taken.* The spill began on the eastern edge of the drill island and flowed west approximately 300 feet. An environmental crew has scraped the saturated soils and is in the process of sampling.		
I hereby certify that the information given above is true and complete to the best of my knowledge and understand that pursuant to NMOCD rules and regulations all operators are required to report and/or file certain release notifications and perform corrective actions for releases which may endanger public health or the environment. The acceptance of a C-141 report by the NMOCD marked as "Final Report" does not relieve the operator of liability should their operations have failed to adequately investigate and remediate contamination that pose a threat to ground water, surface water, human health or the environment. In addition, NMOCD acceptance of a C-141 report does not relieve the operator of responsibility for compliance with any other federal, state, or local laws and/or regulations.		
Signature: 	OIL CONSERVATION DIVISION	
Printed Name: Jacob Foust	Approved by Environmental Specialist: 	
Title: Environmental Supervisor	Approval Date: 6/13/17	Expiration Date: N/A
E-mail Address: Bryan.Foust@xtoenergy.com	Conditions of Approval: See attached	Attached <input checked="" type="checkbox"/>
Date: Phone: 432-266-2663		

* Attach Additional Sheets If Necessary

2RP-4250

District I
1625 N. French Dr., Hobbs, NM 88240
District II
811 S. First St., Artesia, NM 88210
District III
1000 Rio Brazos Road, Aztec, NM 87410
District IV
1220 S. St. Francis Dr., Santa Fe, NM 87505

State of New Mexico
Energy Minerals and Natural Resources
Oil Conservation Division
1220 South St. Francis Dr.
Santa Fe, NM 87505

Form C-141
Revised August 8, 2011

Submit 1 Copy to appropriate District Office in
accordance with 19.15.29 NMAC.

Release Notification and Corrective Action

OPERATOR

☐ Initial Report ☒ Final Report

Name of Company: XTO Energy	Contact: Amy Ruth
Address: 522 W. Mermod, Suite 704 Carlsbad, N.M. 88220	Telephone No. 575-887-7329
Facility Name: James Ranch Unit #135H	Facility Type: Exploration and Production
Surface Owner: Federal	Mineral Owner: Federal
API No. 30-015-42376	

LOCATION OF RELEASE

Unit Letter G	Section 21	Township 22S	Range 30E	Feet from the 1460	North/South Line North	Feet from the 1135	East/West Line East	County Eddy
------------------	---------------	-----------------	--------------	-----------------------	---------------------------	-----------------------	------------------------	----------------

Latitude 32.380927° Longitude -103.881337°

NATURE OF RELEASE

Type of Release Produced Water	Volume of Release 16.7 BPW	Volume Recovered 10 BPW
Source of Release Flowline on eastern side of pad	Date and Hour of Occurrence 5/25/2017 time unknown	Date and Hour of Discovery 5/25/2017 10:00 A.M.
Was Immediate Notice Given? <input type="checkbox"/> Yes <input type="checkbox"/> No <input checked="" type="checkbox"/> Not Required	If YES, To Whom? N/A	
By Whom? N/A	Date and Hour N/A	
Was a Watercourse Reached? <input type="checkbox"/> Yes <input checked="" type="checkbox"/> No	If YES, Volume Impacting the Watercourse. N/A	
If a Watercourse was Impacted, Describe Fully.* N/A		
Describe Cause of Problem and Remedial Action Taken.* A section of flowline pipe corroded, releasing produced water. The section of pipe was replaced.		
Describe Area Affected and Cleanup Action Taken.* The spill began on the eastern edge of the drill island and flowed west approximately 300 feet. An environmental crew excavated all impacted soils with constituents of concern in concentrations above required action levels. Low level confirmation floor and sidewall samples from the excavation were returned from a commercial laboratory. The excavated soils were removed to a NMOCD approved disposal facility and the excavation was backfilled in lifts with clean caliche and compacted with a vibratory roller.		
I hereby certify that the information given above is true and complete to the best of my knowledge and understand that pursuant to NMOCD rules and regulations all operators are required to report and/or file certain release notifications and perform corrective actions for releases which may endanger public health or the environment. The acceptance of a C-141 report by the NMOCD marked as "Final Report" does not relieve the operator of liability should their operations have failed to adequately investigate and remediate contamination that pose a threat to ground water, surface water, human health or the environment. In addition, NMOCD acceptance of a C-141 report does not relieve the operator of responsibility for compliance with any other federal, state, or local laws and/or regulations.		
Signature: 	OIL CONSERVATION DIVISION	
Printed Name: Amy C. Ruth	Approved by Environmental Specialist: 	
Title: Environmental Coordinator	Approval Date: 3/16/2023	Expiration Date: N/A
E-mail Address: Amy_Ruth@xtoenergy.com	Conditions of Approval:	Attached <input type="checkbox"/>
Date: 10/13/2017	Phone: 432-661-0571	N/A

* Attach Additional Sheets If Necessary

APPENDIX – B

Analytical Reports



PHONE (575) 393-2326 ° 101 E. MARLAND ° HOBBS, NM 88240

June 26, 2017

ROBBIE RUNNELS

Basin Environmental Service

P.O. Box 301

Lovington, NM 88260

RE: JRU DI 1 -#135H

Enclosed are the results of analyses for samples received by the laboratory on 06/23/17 12:40.

Cardinal Laboratories is accredited through Texas NELAP under certificate number T104704398-16-8. Accreditation applies to drinking water, non-potable water and solid and chemical materials. All accredited analytes are denoted by an asterisk (*). For a complete list of accredited analytes and matrices visit the TCEQ website at www.tceq.texas.gov/field/qa/lab_accred_certif.html.

Cardinal Laboratories is accredited through the State of Colorado Department of Public Health and Environment for:

Method EPA 552.2	Haloacetic Acids (HAA-5)
Method EPA 524.2	Total Trihalomethanes (TTHM)
Method EPA 524.4	Regulated VOCs (V1, V2, V3)

Accreditation applies to public drinking water matrices.

This report meets NELAP requirements and is made up of a cover page, analytical results, and a copy of the original chain-of-custody. If you have any questions concerning this report, please feel free to contact me.

Sincerely,

A handwritten signature in black ink that reads "Celey D. Keene". The signature is fluid and cursive, with the first name "Celey" and last name "Keene" clearly distinguishable.

Celey D. Keene

Lab Director/Quality Manager



PHONE (575) 393-2326 ° 101 E. MARLAND ° HOBBS, NM 88240

Analytical Results For:

Basin Environmental Service
 ROBBIE RUNNELS
 P.O. Box 301
 Lovington NM, 88260
 Fax To: (575) 396-1429

Received: 06/23/2017
 Reported: 06/26/2017
 Project Name: JRU DI 1 -#135H
 Project Number: NONE GIVEN
 Project Location: EDDY

Sampling Date: 06/22/2017
 Sampling Type: Soil
 Sampling Condition: ** (See Notes)
 Sample Received By: Celey D. Keene

Sample ID: FLOOR 1 @ 1.5' (H701651-01)

Chloride, SM4500CI-B		mg/kg		Analyzed By: CK					
Analyte	Result	Reporting Limit	Analyzed	Method Blank	BS	% Recovery	True Value QC	RPD	Qualifier
Chloride	208	16.0	06/24/2017	ND	416	104	400	3.77	

Sample ID: FLOOR 2 @ 1.5' (H701651-02)

Chloride, SM4500CI-B		mg/kg		Analyzed By: CK					
Analyte	Result	Reporting Limit	Analyzed	Method Blank	BS	% Recovery	True Value QC	RPD	Qualifier
Chloride	208	16.0	06/24/2017	ND	416	104	400	3.77	

Sample ID: FLOOR 3 @ 1.5' (H701651-03)

Chloride, SM4500CI-B		mg/kg		Analyzed By: CK					
Analyte	Result	Reporting Limit	Analyzed	Method Blank	BS	% Recovery	True Value QC	RPD	Qualifier
Chloride	176	16.0	06/23/2017	ND	432	108	400	0.00	

Sample ID: FLOOR 4 @ 1.5' (H701651-04)

Chloride, SM4500CI-B		mg/kg		Analyzed By: CK					
Analyte	Result	Reporting Limit	Analyzed	Method Blank	BS	% Recovery	True Value QC	RPD	Qualifier
Chloride	720	16.0	06/24/2017	ND	416	104	400	3.77	

Cardinal Laboratories

*=Accredited Analyte

PLEASE NOTE: Liability and Damages. Cardinal's liability and client's exclusive remedy for any claim arising, whether based in contract or tort, shall be limited to the amount paid by client for analyses. All claims, including those for negligence and any other cause whatsoever shall be deemed waived unless made in writing and received by Cardinal within thirty (30) days after completion of the applicable service. In no event shall Cardinal be liable for incidental or consequential damages, including, without limitation, business interruptions, loss of use, or loss of profits incurred by client, its subsidiaries, affiliates or successors arising out of or related to the performance of the services hereunder by Cardinal, regardless of whether such claim is based upon any of the above stated reasons or otherwise. Results relate only to the samples identified above. This report shall not be reproduced except in full with written approval of Cardinal Laboratories.

Celey D. Keene, Lab Director/Quality Manager



PHONE (575) 393-2326 • 101 E. MARLAND • HOBBS, NM 88240

Analytical Results For:

Basin Environmental Service
 ROBBIE RUNNELS
 P.O. Box 301
 Lovington NM, 88260
 Fax To: (575) 396-1429

Received: 06/23/2017
 Reported: 06/26/2017
 Project Name: JRU DI 1 -#135H
 Project Number: NONE GIVEN
 Project Location: EDDY

Sampling Date: 06/22/2017
 Sampling Type: Soil
 Sampling Condition: ** (See Notes)
 Sample Received By: Celey D. Keene

Sample ID: FLOOR 5 @ 1.5' (H701651-05)

Chloride, SM4500Cl-B		mg/kg		Analyzed By: CK						
Analyte	Result	Reporting Limit	Analyzed	Method Blank	BS	% Recovery	True Value QC	RPD	Qualifier	
Chloride	400	16.0	06/23/2017	ND	432	108	400	0.00		

Sample ID: FLOOR 6 @ 1.5' (H701651-06)

Chloride, SM4500Cl-B		mg/kg		Analyzed By: CK						
Analyte	Result	Reporting Limit	Analyzed	Method Blank	BS	% Recovery	True Value QC	RPD	Qualifier	
Chloride	272	16.0	06/23/2017	ND	432	108	400	0.00		

Sample ID: NW 1 @ 1' (H701651-07)

Chloride, SM4500Cl-B		mg/kg		Analyzed By: CK						
Analyte	Result	Reporting Limit	Analyzed	Method Blank	BS	% Recovery	True Value QC	RPD	Qualifier	
Chloride	288	16.0	06/23/2017	ND	432	108	400	0.00		

Sample ID: NW 2 @ 1' (H701651-08)

Chloride, SM4500Cl-B		mg/kg		Analyzed By: CK					
Analyte	Result	Reporting Limit	Analyzed	Method Blank	BS	% Recovery	True Value QC	RPD	Qualifier
Chloride	272	16.0	06/23/2017	ND	432	108	400	0.00	

Sample ID: NW 3 @ 1' (H701651-09)

Chloride, SM4500Cl-B		mg/kg		Analyzed By: CK					
Analyte	Result	Reporting Limit	Analyzed	Method Blank	BS	% Recovery	True Value QC	RPD	Qualifier
Chloride	336	16.0	06/23/2017	ND	432	108	400	0.00	

Cardinal Laboratories

*=Accredited Analyte

PLEASE NOTE: Liability and Damages. Cardinal's liability and client's exclusive remedy for any claim arising, whether based in contract or tort, shall be limited to the amount paid by client for analyses. All claims, including those for negligence and any other cause whatsoever shall be deemed waived unless made in writing and received by Cardinal within thirty (30) days after completion of the applicable service. In no event shall Cardinal be liable for incidental or consequential damages, including, without limitation, business interruptions, loss of use, or loss of profits incurred by client, its subsidiaries, affiliates or successors arising out of or related to the performance of the services hereunder by Cardinal, regardless of whether such claim is based upon any of the above stated reasons or otherwise. Results relate only to the samples identified above. This report shall not be reproduced except in full with written approval of Cardinal Laboratories.

Celey D. Keene, Lab Director/Quality Manager



PHONE (575) 393-2326 ° 101 E. MARLAND ° HOBBS, NM 88240

Analytical Results For:

Basin Environmental Service
 ROBBIE RUNNELS
 P.O. Box 301
 Lovington NM, 88260
 Fax To: (575) 396-1429

Received:	06/23/2017	Sampling Date:	06/22/2017
Reported:	06/26/2017	Sampling Type:	Soil
Project Name:	JRU DI 1 -#135H	Sampling Condition:	** (See Notes)
Project Number:	NONE GIVEN	Sample Received By:	Celey D. Keene
Project Location:	EDDY		

Sample ID: NW 4 @ 1' (H701651-10)

Chloride, SM4500Cl-B		mg/kg		Analyzed By: CK						
Analyte	Result	Reporting Limit	Analyzed	Method Blank	BS	% Recovery	True Value QC	RPD	Qualifier	
Chloride	176	16.0	06/23/2017	ND	432	108	400	0.00		

Sample ID: NW 5 @ 1' (H701651-11)

Chloride, SM4500Cl-B		mg/kg		Analyzed By: CK						
Analyte	Result	Reporting Limit	Analyzed	Method Blank	BS	% Recovery	True Value QC	RPD	Qualifier	
Chloride	208	16.0	06/23/2017	ND	432	108	400	0.00		

Sample ID: NW 6 @ 1' (H701651-12)

Chloride, SM4500Cl-B		mg/kg		Analyzed By: CK					
Analyte	Result	Reporting Limit	Analyzed	Method Blank	BS	% Recovery	True Value QC	RPD	Qualifier
Chloride	240	16.0	06/23/2017	ND	432	108	400	0.00	

Sample ID: SW 1 @ 1' (H701651-13)

Chloride, SM4500Cl-B		mg/kg		Analyzed By: CK					
Analyte	Result	Reporting Limit	Analyzed	Method Blank	BS	% Recovery	True Value QC	RPD	Qualifier
Chloride	176	16.0	06/23/2017	ND	432	108	400	0.00	

Sample ID: SW 2 @ 1' (H701651-14)

Chloride, SM4500Cl-B		mg/kg		Analyzed By: CK						
Analyte	Result	Reporting Limit	Analyzed	Method Blank	BS	% Recovery	True Value QC	RPD	Qualifier	
Chloride	256	16.0	06/23/2017	ND	432	108	400	0.00		

Cardinal Laboratories

*=Accredited Analyte

PLEASE NOTE: Liability and Damages. Cardinal's liability and client's exclusive remedy for any claim arising, whether based in contract or tort, shall be limited to the amount paid by client for analyses. All claims, including those for negligence and any other cause whatsoever shall be deemed waived unless made in writing and received by Cardinal within thirty (30) days after completion of the applicable service. In no event shall Cardinal be liable for incidental or consequential damages, including, without limitation, business interruptions, loss of use, or loss of profits incurred by client, its subsidiaries, affiliates or successors arising out of or related to the performance of the services hereunder by Cardinal, regardless of whether such claim is based upon any of the above stated reasons or otherwise. Results relate only to the samples identified above. This report shall not be reproduced except in full with written approval of Cardinal Laboratories.

Celey D. Keene, Lab Director/Quality Manager



PHONE (575) 393-2326 ° 101 E. MARLAND ° HOBBS, NM 88240

Analytical Results For:

Basin Environmental Service
 ROBBIE RUNNELS
 P.O. Box 301
 Lovington NM, 88260
 Fax To: (575) 396-1429

Received:	06/23/2017	Sampling Date:	06/22/2017
Reported:	06/26/2017	Sampling Type:	Soil
Project Name:	JRU DI 1 -#135H	Sampling Condition:	** (See Notes)
Project Number:	NONE GIVEN	Sample Received By:	Celey D. Keene
Project Location:	EDDY		

Sample ID: SW 3 @ 1' (H701651-15)

Chloride, SM4500Cl-B		mg/kg		Analyzed By: CK					
Analyte	Result	Reporting Limit	Analyzed	Method Blank	BS	% Recovery	True Value QC	RPD	Qualifier
Chloride	176	16.0	06/23/2017	ND	432	108	400	0.00	

Sample ID: SW 4 @ 1' (H701651-16)

Chloride, SM4500Cl-B		mg/kg		Analyzed By: CK					
Analyte	Result	Reporting Limit	Analyzed	Method Blank	BS	% Recovery	True Value QC	RPD	Qualifier
Chloride	320	16.0	06/23/2017	ND	432	108	400	0.00	

Sample ID: SW 5 @ 1' (H701651-17)

Chloride, SM4500Cl-B		mg/kg		Analyzed By: CK					
Analyte	Result	Reporting Limit	Analyzed	Method Blank	BS	% Recovery	True Value QC	RPD	Qualifier
Chloride	352	16.0	06/23/2017	ND	432	108	400	0.00	

Sample ID: SW 6 @ 1' (H701651-18)

Chloride, SM4500Cl-B		mg/kg		Analyzed By: CK					
Analyte	Result	Reporting Limit	Analyzed	Method Blank	BS	% Recovery	True Value QC	RPD	Qualifier
Chloride	960	16.0	06/23/2017	ND	432	108	400	0.00	

Cardinal Laboratories

*=Accredited Analyte

PLEASE NOTE: Liability and Damages. Cardinal's liability and client's exclusive remedy for any claim arising, whether based in contract or tort, shall be limited to the amount paid by client for analyses. All claims, including those for negligence and any other cause whatsoever shall be deemed waived unless made in writing and received by Cardinal within thirty (30) days after completion of the applicable service. In no event shall Cardinal be liable for incidental or consequential damages, including, without limitation, business interruptions, loss of use, or loss of profits incurred by client, its subsidiaries, affiliates or successors arising out of or related to the performance of the services hereunder by Cardinal, regardless of whether such claim is based upon any of the above stated reasons or otherwise. Results relate only to the samples identified above. This report shall not be reproduced except in full with written approval of Cardinal Laboratories.

Celey D. Keene, Lab Director/Quality Manager



PHONE (575) 393-2326 • 101 E. MARLAND • HOBBS, NM 88240

Notes and Definitions

QM-07	The spike recovery was outside acceptance limits for the MS and/or MSD. The batch was accepted based on acceptable LCS recovery.
ND	Analyte NOT DETECTED at or above the reporting limit
RPD	Relative Percent Difference
**	Samples not received at proper temperature of 6°C or below.
***	Insufficient time to reach temperature.
-	Chloride by SM4500Cl-B does not require samples be received at or below 6°C Samples reported on an as received basis (wet) unless otherwise noted on report

Cardinal Laboratories

*=Accredited Analyte

PLEASE NOTE: Liability and Damages. Cardinal's liability and client's exclusive remedy for any claim arising, whether based in contract or tort, shall be limited to the amount paid by client for analyses. All claims, including those for negligence and any other cause whatsoever shall be deemed waived unless made in writing and received by Cardinal within thirty (30) days after completion of the applicable service. In no event shall Cardinal be liable for incidental or consequential damages, including, without limitation, business interruptions, loss of use, or loss of profits incurred by client, its subsidiaries, affiliates or successors arising out of or related to the performance of the services hereunder by Cardinal, regardless of whether such claim is based upon any of the above stated reasons or otherwise. Results relate only to the samples identified above. This report shall not be reproduced except in full with written approval of Cardinal Laboratories.

A handwritten signature in black ink, appearing to read "Celey D. Keene".

Celey D. Keene, Lab Director/Quality Manager



ORDINAL LABORATORIES

101 East Marland, Hobbs, NM 88240
(575) 393-2326 FAX (575) 393-2476

CHAIN-OF-CUSTODY AND ANALYSIS REQUEST

[illegible]



ARDINAL LABORATORIES
101 East Marland, Hobbs, NM 88240
(575) 393-2326 FAX (575) 393-2476

CHAIN-OF-CUSTODY AND ANALYSIS REQUEST

Company Name: Basin Environmental Service Technologies, LLC Project Manager: Robbie Runnels Address: P.O. Box 301 City: Lovington State: NM Zip: 88260 Phone #: (575) 396-2378 Fax #: (575) 396-1429 Project #: Project Name: JRU D 1 - #135H Project Location: Eddy Sampler Name: Jody Walters		P.O. #: Company: XTO Energy Attn: Amy Ruth Address: City: State: NM Zip: 88260 Phone #: Fax #:	
FOR LAB USE ONLY		BILL TO	
Lab I.D. Sample I.D.	(G)RAB OR (C)OMP. # CONTAINERS GROUNDWATER WASTEWATER SOIL OIL SLUDGE OTHER : ACID/BASE: ICE / COOL OTHER :	MATRIX PRESERV. SAMPLING	ANALYSIS REQUEST
11 NW 5 @ 1' 12 NW 6 @ 1' 13 SW 1 @ 1' 14 SW 2 @ 1' 15 SW 3 @ 1' 16 SW 4 @ 1' 17 SW 5 @ 1' 18 SW 6 @ 1'	g 1 g 1 g 1 g 1 g 1 g 1 g 1 g 1	X X X X X X X X	DATE TIME 6/22/17 11:05 6/22/17 11:10 6/22/17 11:30 6/22/17 11:35 6/22/17 11:40 6/22/17 11:45 6/22/17 11:50 6/22/17 11:55
Chloride TPH (8015M) BTEX (8021B)		X X X X X X X X	
PLEASE NOTE: Liability and Damages. Cardinal's liability and client's exclusive remedy for any claim arising whether based in contract or tort, shall be limited to the amount paid by the client for the analyses. All claims including those for negligence and any other cause whatsoever shall be deemed waived unless made in writing and received by Cardinal within 30 days after completion of the applicable service. In no event shall Cardinal be liable for incidental or consequential damages, including without limitation, business interruptions, loss of use, or loss of profits incurred by client, its subsidiaries, affiliates or successors arising out of or related to the performance of services hereunder by Cardinal regardless of whether such claim is based upon any of the above stated reasons or otherwise.			
Relinquished By: Date: 6-23-17 Time: 12:40 Relinquished By:	Received By: Date: 6-23-17 Time: 12:40 Received By:	REMARKS: Phone Result: <input type="checkbox"/> Yes <input type="checkbox"/> No Add'l Phone #: Fax Result: <input type="checkbox"/> Yes <input type="checkbox"/> No Add'l Fax #: Please email results to pm@basineny.com, amy_ruth@xtoenergy.com	
Delivered By: (Circle One) Sampler - UPS - Bus - Other:	Sample Condition Cool <input checked="" type="checkbox"/> Intact <input checked="" type="checkbox"/> Yes <input checked="" type="checkbox"/> No <input type="checkbox"/> Yes <input checked="" type="checkbox"/> No <input type="checkbox"/>	CHECKED BY: Initials/Signature	

FORM-006
Revision 1.0

† Cardinal cannot accept verbal changes. Please fax written changes to 575-393-2476



PHONE (575) 393-2326 ° 101 E. MARLAND ° HOBBS, NM 88240

June 29, 2017

ROBBIE RUNNELS

Basin Environmental Service

P.O. Box 301

Lovington, NM 88260

RE: JRU DI 1 -#135H

Enclosed are the results of analyses for samples received by the laboratory on 06/28/17 9:50.

Cardinal Laboratories is accredited through Texas NELAP under certificate number T104704398-16-8. Accreditation applies to drinking water, non-potable water and solid and chemical materials. All accredited analytes are denoted by an asterisk (*). For a complete list of accredited analytes and matrices visit the TCEQ website at www.tceq.texas.gov/field/qa/lab_accred_certif.html.

Cardinal Laboratories is accredited through the State of Colorado Department of Public Health and Environment for:

Method EPA 552.2	Haloacetic Acids (HAA-5)
Method EPA 524.2	Total Trihalomethanes (TTHM)
Method EPA 524.4	Regulated VOCs (V1, V2, V3)

Accreditation applies to public drinking water matrices.

This report meets NELAP requirements and is made up of a cover page, analytical results, and a copy of the original chain-of-custody. If you have any questions concerning this report, please feel free to contact me.

Sincerely,

A handwritten signature in black ink that reads "Celey D. Keene". The signature is written in a cursive style with a large, stylized 'C' and 'K'.

Celey D. Keene

Lab Director/Quality Manager



PHONE (575) 393-2326 • 101 E. MARLAND • HOBBS, NM 88240

Analytical Results For:

Basin Environmental Service
 ROBBIE RUNNELS
 P.O. Box 301
 Lovington NM, 88260
 Fax To: (575) 396-1429

Received: 06/28/2017
 Reported: 06/29/2017
 Project Name: JRU DI 1 -#135H
 Project Number: NONE GIVEN
 Project Location: EDDY

Sampling Date: 06/27/2017
 Sampling Type: Soil
 Sampling Condition: Cool & Intact
 Sample Received By: Jodi Henson

Sample ID: FLOOR 7 @ 1.5' (H701689-01)

Chloride, SM4500CI-B		mg/kg		Analyzed By: AC					
Analyte	Result	Reporting Limit	Analyzed	Method Blank	BS	% Recovery	True Value QC	RPD	Qualifier
Chloride	64.0	16.0	06/28/2017	ND	448	112	400	0.00	

Sample ID: SW 7 @ 1' (H701689-02)

Chloride, SM4500CI-B		mg/kg		Analyzed By: AC					
Analyte	Result	Reporting Limit	Analyzed	Method Blank	BS	% Recovery	True Value QC	RPD	Qualifier
Chloride	304	16.0	06/28/2017	ND	448	112	400	0.00	

Sample ID: NW 7 @ 1' (H701689-03)

Chloride, SM4500CI-B		mg/kg		Analyzed By: AC					
Analyte	Result	Reporting Limit	Analyzed	Method Blank	BS	% Recovery	True Value QC	RPD	Qualifier
Chloride	192	16.0	06/28/2017	ND	448	112	400	0.00	

Sample ID: EW @ 1' (H701689-04)

Chloride, SM4500CI-B		mg/kg		Analyzed By: AC					
Analyte	Result	Reporting Limit	Analyzed	Method Blank	BS	% Recovery	True Value QC	RPD	Qualifier
Chloride	48.0	16.0	06/28/2017	ND	448	112	400	0.00	

Cardinal Laboratories

*=Accredited Analyte

PLEASE NOTE: Liability and Damages. Cardinal's liability and client's exclusive remedy for any claim arising, whether based in contract or tort, shall be limited to the amount paid by client for analyses. All claims, including those for negligence and any other cause whatsoever shall be deemed waived unless made in writing and received by Cardinal within thirty (30) days after completion of the applicable service. In no event shall Cardinal be liable for incidental or consequential damages, including, without limitation, business interruptions, loss of use, or loss of profits incurred by client, its subsidiaries, affiliates or successors arising out of or related to the performance of the services hereunder by Cardinal, regardless of whether such claim is based upon any of the above stated reasons or otherwise. Results relate only to the samples identified above. This report shall not be reproduced except in full with written approval of Cardinal Laboratories.

Celey D. Keene, Lab Director/Quality Manager



PHONE (575) 393-2326 ° 101 E. MARLAND ° HOBBS, NM 88240

Analytical Results For:

Basin Environmental Service
 ROBBIE RUNNELS
 P.O. Box 301
 Lovington NM, 88260
 Fax To: (575) 396-1429

Received: 06/28/2017
 Reported: 06/29/2017
 Project Name: JRU DI 1 -#135H
 Project Number: NONE GIVEN
 Project Location: EDDY

Sampling Date: 06/27/2017
 Sampling Type: Soil
 Sampling Condition: Cool & Intact
 Sample Received By: Jodi Henson

Sample ID: WW @ 1' (H701689-05)

Chloride, SM4500Cl-B		mg/kg		Analyzed By: AC						
Analyte	Result	Reporting Limit	Analyzed	Method Blank	BS	% Recovery	True Value QC	RPD	Qualifier	
Chloride	48.0	16.0	06/28/2017	ND	448	112	400	0.00		

Sample ID: FLOOR 4 @ 2.5' (H701689-06)

Chloride, SM4500Cl-B		mg/kg		Analyzed By: AC						
Analyte	Result	Reporting Limit	Analyzed	Method Blank	BS	% Recovery	True Value QC	RPD	Qualifier	
Chloride	<16.0	16.0	06/28/2017	ND	448	112	400	0.00		

Sample ID: SW 6A @ 1' (H701689-07)

Chloride, SM4500Cl-B		mg/kg		Analyzed By: AC						
Analyte	Result	Reporting Limit	Analyzed	Method Blank	BS	% Recovery	True Value QC	RPD	Qualifier	
Chloride	208	16.0	06/28/2017	ND	448	112	400	0.00		

Cardinal Laboratories

*=Accredited Analyte

PLEASE NOTE: Liability and Damages. Cardinal's liability and client's exclusive remedy for any claim arising, whether based in contract or tort, shall be limited to the amount paid by client for analyses. All claims, including those for negligence and any other cause whatsoever shall be deemed waived unless made in writing and received by Cardinal within thirty (30) days after completion of the applicable service. In no event shall Cardinal be liable for incidental or consequential damages, including, without limitation, business interruptions, loss of use, or loss of profits incurred by client, its subsidiaries, affiliates or successors arising out of or related to the performance of the services hereunder by Cardinal, regardless of whether such claim is based upon any of the above stated reasons or otherwise. Results relate only to the samples identified above. This report shall not be reproduced except in full with written approval of Cardinal Laboratories.

Celey D. Keene, Lab Director/Quality Manager

PHONE (575) 393-2326 ° 101 E. MARLAND ° HOBBS, NM 88240

Notes and Definitions

ND	Analyte NOT DETECTED at or above the reporting limit
RPD	Relative Percent Difference
**	Samples not received at proper temperature of 6°C or below.
***	Insufficient time to reach temperature.
-	Chloride by SM4500Cl-B does not require samples be received at or below 6°C Samples reported on an as received basis (wet) unless otherwise noted on report

Cardinal Laboratories

*=Accredited Analyte

PLEASE NOTE: Liability and Damages. Cardinal's liability and client's exclusive remedy for any claim arising, whether based in contract or tort, shall be limited to the amount paid by client for analyses. All claims, including those for negligence and any other cause whatsoever shall be deemed waived unless made in writing and received by Cardinal within thirty (30) days after completion of the applicable service. In no event shall Cardinal be liable for incidental or consequential damages, including, without limitation, business interruptions, loss of use, or loss of profits incurred by client, its subsidiaries, affiliates or successors arising out of or related to the performance of the services hereunder by Cardinal, regardless of whether such claim is based upon any of the above stated reasons or otherwise. Results relate only to the samples identified above. This report shall not be reproduced except in full with written approval of Cardinal Laboratories.

A handwritten signature in black ink, appearing to read "C. D. Keene", is written over a horizontal line.

Celey D. Keene, Lab Director/Quality Manager



ARDINAL LABORATORIES
101 East Marland, Hobbs, NM 88240
(575) 393-2326 FAX (575) 393-2476

CHAIN-OF-CUSTODY AND ANALYSIS REQUEST

Company Name: Basin Environmental Service Technologies, LLC
Project Manager: Robbie Runnels
Address: P.O. Box 301
City: Lovington
Phone #: (575)396-2378
Project #:
Project Name: JRU DI 1 - #135H
Project Location: Eddy, N.M.
Sampler Name: Jody Walters

P.O. #:
Company: XTO Energy
Attn: Amy Ruth
Address: 522 W. Mermod
City: Carlsbad
State: NM **Zip:** 88220
Phone #: (423)556-8730
Fax #:

BILL TO

ANALYSIS REQUEST

Project Manager: Robbie Runnels										P.O. #:	
Address: P.O. Box 301										Company: XTO Energy	
City: Lovington										Attn: Amy Ruth	
Phone #: (575)396-2378										Address: 522 W. Mermod	
Fax #: (575)396-1429										City: Carlsbad	
Project #: Project Owner: XTO Energy										State: NM Zip: 88220	
Project Name: JRU DI 1 - #135H										Phone #: (423)556-8730	
Project Location: Eddy, N.M.										Fax #:	
Sampler Name: Jody Walters											
FOR LAB USE ONLY										MATRIX	
										PRESERV	
										SAMPLING	
Lab I.D.										Sample I.D.	
										(G)RAB OR (C)OMP.	
										# CONTAINERS	
										GROUNDWATER	
										WASTEWATER	
										SOIL	
										OIL	
										SLUDGE	
										OTHER :	
										ACID/BASE:	
										ICE / COOL	
										OTHER :	
										DATE	
										TIME	
1										X	
2										X	
3										X	
4										X	
5										X	
6										X	
7										X	
8										X	
9										X	
10										X	
11										X	
12										X	
13										X	
14										X	
15										X	
16										X	
17										X	
18										X	
19										X	
20										X	
21										X	
22										X	
23										X	
24										X	
25										X	
26										X	
27										X	
28										X	
29										X	
30										X	
31										X	
32										X	
33										X	
34										X	
35										X	
36										X	
37										X	
38										X	
39										X	
40										X	
41										X	
42										X	
43										X	
44										X	
45										X	
46										X	
47										X	
48										X	
49										X	
50										X	
51										X	
52										X	
53										X	
54										X	
55										X	
56										X	
57										X	
58										X	
59										X	
60										X	
61										X	
62										X	
63										X	
64										X	
65										X	
66										X	
67										X	
68										X	
69										X	
70										X	
71										X	
72										X	
73										X	
74										X	
75										X	
76										X	
77										X	
78										X	
79										X	
80										X	
81										X	
82										X	
83										X	
84										X	
85										X	
86										X	
87										X	
88										X	
89										X	
90										X	
91										X	
92										X	
93										X	
94										X	
95										X	
96										X	
97										X	
98										X	
99										X	
100										X	

PLEASE NOTE: Liability and Damages. Cardinal's liability and client's exclusive remedy for any claim arising under this contract or tort, shall be limited to the amount paid by the client for the analysis. All claims including those for negligence and any other cause whatsoever shall be deemed waived unless made in writing and received by Cardinal within 30 days after completion of the applicable service. In no event shall Cardinal be liable for incidental or consequential damages, including without limitation, business interruptions, loss of use, or loss of profits incurred by client, its subsidiaries, affiliates or successors arising out of or related to the performance of services hereunder by Cardinal, regardless of whether such claim is based upon any of the above stated reasons or otherwise.

Relinquished By: *[Signature]* **Date:** 6-28-17 **Received By:** *[Signature]* **Date:** 6-28-17

Relinquished By: *[Signature]* **Date:** 6-28-17 **Received By:** *[Signature]* **Date:** 6-28-17

Delivered By: (Circle One) **Time:** 5:40 **Received By:** *[Signature]* **Date:** 6-28-17

Sampler - UPS - Bus - Other: #75 **Sample Condition:** ☒ Cool ☐ Intact ☐ Yes ☐ No

Phone Result: ☐ Yes ☐ No **Add'l Phone #:**
Fax Result: ☐ Yes ☐ No **Add'l Fax #:**

REMARKS: #7 sample ID changed by Robbie.

Please email results to pm@basinenv.com & amy_ruth@xtoenergy.com

APPENDIX – C

Photo Documentation

JRU DI 1 #135 2RP-4250

Unit G, Section 21, T22S, R30E



Source of release

5/25/2017



Release, facing east

5/25/2017



Release, facing west

5/25/2017



Release, facing west

5/25/2017

JRU DI 1 #135 2RP-4250

Unit G, Section 21, T22S, R30E



Excavation, facing northwest

6/27/2017



Excavation, facing west

6/27/2017



Excavation, facing west

6/27/2017



Excavation, facing west

6/27/2017

District I
1625 N. French Dr., Hobbs, NM 88240
Phone:(575) 393-6161 Fax:(575) 393-0720
District II
811 S. First St., Artesia, NM 88210
Phone:(575) 748-1283 Fax:(575) 748-9720
District III
1000 Rio Brazos Rd., Aztec, NM 87410
Phone:(505) 334-6178 Fax:(505) 334-6170
District IV
1220 S. St Francis Dr., Santa Fe, NM 87505
Phone:(505) 476-3470 Fax:(505) 476-3462

State of New Mexico
Energy, Minerals and Natural Resources
Oil Conservation Division
1220 S. St Francis Dr.
Santa Fe, NM 87505

CONDITIONS

Action 197904

CONDITIONS

Operator: XTO PERMIAN OPERATING LLC. 6401 HOLIDAY HILL ROAD MIDLAND, TX 79707	OGRID: 373075
	Action Number: 197904
	Action Type: [IM-SD] Incident File Support Doc (ENV) (IM-BNF)

CONDITIONS

Created By	Condition	Condition Date
bhall	Closure approved. Although it is noted that no TPH/BTEX samples were collected but this release is being closed out under the old rules since the report and final c-141 are dated in 2017.	3/16/2023