

FESCO, Ltd.
1100 Fesco Ave. - Alice, Texas 78332

For: Ameredev Operating, LLC
 2901 Via Fortuna
 Austin, Texas 78746

Sample: Red Bud CTB

Sales Meter Run
 Spot Gas Sample @ 58 psig & 105°F

Date Sampled: 06/03/2023

Job Number: 232371.021

CHROMATOGRAPH EXTENDED ANALYSIS - GPA 2286

| Un-Normalized | | | |
|---------------------|--------------|--------------|--------------|
| COMPONENT | Mol% | MOL% | GPM |
| Hydrogen Sulfide* | ----- | 0.750 | |
| Oxygen | 0.002 | 0.002 | |
| Nitrogen | 1.073 | 1.082 | |
| Carbon Dioxide | 1.284 | 1.294 | |
| Methane | 71.998 | 72.593 | |
| Ethane | 10.867 | 10.956 | 3.002 |
| Propane | 6.678 | 6.732 | 1.900 |
| Isobutane | 1.184 | 1.194 | 0.400 |
| n-Butane | 2.613 | 2.634 | 0.851 |
| 2-2 Dimethylpropane | 0.013 | 0.013 | 0.005 |
| Isopentane | 0.820 | 0.827 | 0.310 |
| n-Pentane | 0.700 | 0.706 | 0.262 |
| Hexanes | 0.540 | 0.575 | 0.243 |
| Heptanes Plus | <u>0.669</u> | <u>0.642</u> | <u>0.261</u> |
| Totals | 98.441 | 100.000 | 7.234 |

Computed Real Characteristics Of Heptanes Plus:

Specific Gravity ----- 3.314 (Air=1)
 Molecular Weight ----- 95.55
 Gross Heating Value ----- 5126 BTU/CF

Computed Real Characteristics Of Total Sample:

Specific Gravity ----- 0.815 (Air=1)
 Compressibility (Z) ----- 0.9954
 Molecular Weight ----- 23.49
 Gross Heating Value
 Dry Basis ----- 1384 BTU/CF
 Saturated Basis ----- 1361 BTU/CF

*Hydrogen Sulfide tested on location by: Stain Tube Method (GPA 2377)
 Results: 471.7 Gr/100 CF, 7500 PPMV or 0.750 Mol %

Base Conditions: 15.025 PSI & 60 Deg F

Sampled By: (16) D. Field
 Analyst: JS
 Processor: HB
 Cylinder ID: T-6113

Certified: FESCO, Ltd. - Alice, Texas

Conan Pierce 361-661-7015

CHROMATOGRAPH EXTENDED ANALYSIS - GPA 2286

TOTAL REPORT

| COMPONENT | MOL % | GPM | WT % |
|------------------------|--------------|--------------|--------------|
| Hydrogen Sulfide* | 0.750 | | 1.088 |
| Oxygen | 0.002 | | 0.003 |
| Nitrogen | 1.082 | | 1.291 |
| Carbon Dioxide | 1.294 | | 2.425 |
| Methane | 72.593 | | 49.584 |
| Ethane | 10.956 | 3.002 | 14.027 |
| Propane | 6.732 | 1.900 | 12.639 |
| Isobutane | 1.194 | 0.400 | 2.955 |
| n-Butane | 2.634 | 0.851 | 6.518 |
| 2,2 Dimethylpropane | 0.013 | 0.005 | 0.040 |
| Isopentane | 0.827 | 0.310 | 2.540 |
| n-Pentane | 0.706 | 0.262 | 2.169 |
| 2,2 Dimethylbutane | 0.011 | 0.005 | 0.040 |
| Cyclopentane | 0.000 | 0.000 | 0.000 |
| 2,3 Dimethylbutane | 0.060 | 0.025 | 0.220 |
| 2 Methylpentane | 0.179 | 0.076 | 0.657 |
| 3 Methylpentane | 0.116 | 0.048 | 0.426 |
| n-Hexane | 0.209 | 0.088 | 0.767 |
| Methylcyclopentane | 0.083 | 0.030 | 0.297 |
| Benzene | 0.058 | 0.017 | 0.193 |
| Cyclohexane | 0.098 | 0.034 | 0.351 |
| 2-Methylhexane | 0.027 | 0.013 | 0.115 |
| 3-Methylhexane | 0.030 | 0.014 | 0.128 |
| 2,2,4 Trimethylpentane | 0.013 | 0.007 | 0.063 |
| Other C7's | 0.049 | 0.022 | 0.207 |
| n-Heptane | 0.049 | 0.023 | 0.209 |
| Methylcyclohexane | 0.074 | 0.030 | 0.309 |
| Toluene | 0.052 | 0.018 | 0.204 |
| Other C8's | 0.050 | 0.024 | 0.235 |
| n-Octane | 0.014 | 0.007 | 0.068 |
| Ethylbenzene | 0.004 | 0.002 | 0.018 |
| M & P Xylenes | 0.011 | 0.004 | 0.050 |
| O-Xylene | 0.003 | 0.001 | 0.014 |
| Other C9's | 0.017 | 0.009 | 0.091 |
| n-Nonane | 0.003 | 0.002 | 0.016 |
| Other C10's | 0.005 | 0.003 | 0.030 |
| n-Decane | 0.001 | 0.001 | 0.006 |
| Undecanes (11) | <u>0.001</u> | <u>0.001</u> | <u>0.007</u> |
| Totals | 100.000 | 7.234 | 100.000 |

Computed Real Characteristics of Total Sample

Specific Gravity ----- 0.815 (Air=1)
 Compressibility (Z) ----- 0.9954
 Molecular Weight ----- 23.49

Gross Heating Value

Dry Basis ----- 1384 BTU/CF
 Saturated Basis ----- 1361 BTU/CF

Sample Date: 06/03/2023

Sample Time: 15:15

Analysis Date: 06/08/2023

Analysis Time: 16:58

Sample Pressure: 58 psig

Sample Temp: 105 °F

Sampling Flow Rate: 3204 MCF/D

Ambient Air Temp: 85 °F

Heating Method Utilized: Yes

Sampling Method: Fill & Empty

Device: (GC) S14

Make & Model: Shimadzu GC 2014

Last Verification Date: 06/08/2023

| POW | OCD Incident # | Facility # | Date (C-129 Was Filed) | Date (Flaring Discovered) | Date Flaring Occurred | Location | Flare Source Equipment | Gas Volume (MCF) | Flared or Vented | Start Time of the flare event | End Time of the flare event | Flare Duration (hr) | C129 Filing Reason | FL |
|---------------------|----------------|----------------|---------------------------|------------------------------|--------------------------|-------------|------------------------------|---------------------|------------------------|-------------------------------------|-----------------------------------|---------------------------|---------------------------|---------------------------------|
| QIRDJ-231207-C-129A | nAPP2332823810 | fAPP2203927141 | 12/7/2023 | 11/11/2023 | 11/10/2023 | Pinestraw | VRU Discharge | 178.14 | Flared | 12:00 AM | 11:48 PM | 20.17 | Flared more than 8 HRs | Continued O2 flaring from |
| AK0SO-231207-C-129A | nAPP2332824279 | fAPP2203928043 | 12/7/2023 | 11/11/2023 | 11/10/2023 | Red Bud | VRU Discharge | 476.82 | Flared | 8:43 AM | 11:39 PM | 13.95 | Flared more than 8 HRs | O2 was detected at 8:43 AM |
| NA | NA | NA | NA | 11/12/2023 | 11/11/2023 | Nan 1.5N | HP Flare | 135.23 | Flared | 9:57 AM | 10:40 PM | 0.13 | Insufficient Availability | Flaring occurred to due to |
| RVYGU-231126-C-1290 | nAPP2333068403 | fAPP2203927141 | 11/26/2023 | 11/12/2023 | 11/11/2023 | Pinestraw | VRU Discharge | 184.95 | Flared | 12:48 AM | 3:00 PM | 11.15 | Flared more than 8 HRs | Continued O2 flaring from |
| PH2IE-231207-C-129A | nAPP2331641317 | fAPP2203928043 | 12/7/2023 | 11/12/2023 | 11/11/2023 | Red Bud | VRU Discharge | 889.96 | Flared | 12:00 AM | 11:23 PM | 22.83 | Flared more than 8 HRs | Continued O2 flaring from |
| MO7JG-231207-C-129A | nAPP2333156535 | fAPP2203846035 | 12/7/2023 | 11/13/2023 | 11/12/2023 | Amen Corner | VRU Discharge | 130.75 | Flared | 12:00 AM | 8:16 PM | 14.12 | Flared more than 8 HRs | O2 was detected and sent t |
| KX29C-231207-C-129A | nAPP2331749209 | fAPP2203928043 | 12/7/2023 | 11/13/2023 | 11/12/2023 | Red Bud | VRU Discharge | 1122.19 | Flared | 12:00 AM | 11:57 PM | 22.72 | Flared more than 8 HRs | Continued O2 flaring from |
| NA | NA | NA | NA | 11/14/2023 | 11/13/2023 | Amen Corner | VRU Discharge | 80.69 | Flared | 6:58 AM | 11:01 PM | 4.03 | Oxygen | Note: Flare amount is an es |
| NA | NA | NA | NA | 11/14/2023 | 11/13/2023 | Red Bud | VRU Discharge | 289.78 | Flared | 12:00 AM | 8:46 PM | 6.68 | Oxygen | We were getting high O2 fr |
| M75VU-231128-C-1290 | nAPP2333354438 | fAPP2203846035 | 12/10/2023 | 11/15/2023 | 11/14/2023 | Amen Corner | VRU Discharge | 509.70 | Flared | 1:33 AM | 11:42 PM | 25.49 | Flared more than 8 HRs | Note: Flare amount is an es |
| NQ34D-231201-C-1290 | nAPP2333555019 | fAPP2203846035 | 12/10/2023 | 11/16/2023 | 11/15/2023 | Amen Corner | VRU Discharge | 65.67 | Flared | 12:00 AM | 11:03 AM | 3.28 | Flared more than 8 HRs | Note: Flare amount is an es |
| NA | NA | NA | NA | 12/6/2023 | 11/15/2023 | Nandina | VRU Discharge | 52.13 | Flared | | | 2.83 | Oxygen | There was an Acid Job taki |
| NA | NA | NA | NA | 11/17/2023 | 11/16/2023 | Nan 1.5N | HP Flare | 163.33 | Flared | 3:54 PM | 7:42 PM | 0.45 | Insufficient Availability | Pinion was shut in so line p |
| NA | NA | NA | NA | 11/17/2023 | 11/16/2023 | Pinestraw | HP Flare | 75.96 | Flared | 12:19 PM | 5:13 PM | 3.55 | Insufficient Availability | Pinion was shut in so line p |
| NA | NA | NA | NA | 11/17/2023 | 11/16/2023 | Red Bud | HP Flare | 56.73 | Flared | 4:27 PM | 9:21 PM | 1.32 | Insufficient Availability | Pinion was shut in so line p |
| SBWCN-231201-C-1290 | nAPP2333555774 | fAPP2203927141 | 12/1/2023 | 11/17/2023 | 11/16/2023 | Pinestraw | VRU Discharge | 118.78 | Flared | 12:02 AM | 8:15 AM | 8.38 | Flared more than 8 HRs | We don't have comms with |
| NA | NA | NA | NA | 11/17/2023 | 11/16/2023 | Red Bud | VRU Discharge | 112.92 | Flared | 12:00 AM | 4:16 PM | 4.95 | Oxygen | VAC truck pushed into the |
| NA | NA | NA | NA | 11/18/2023 | 11/17/2023 | Nandina | LP - Vent flare/Blower Flare | 107.48 | Flared | 4:36 AM | 8:46 AM | 5.63 | Repair/Maintenance | Oxygen analyzer was servic |
| 3K570-231206-C-129A | nAPP2331427967 | fAPP2203846035 | 12/6/2023 | 12/6/2023 | 11/17/2023 | Amen Corner | VRU Discharge | 110.58 | Flared | 12:24 AM | 8:32 PM | 8.37 | Flared more than 8 HRs | O2 issues at Hila, all faciliti |
| 99PR-231202-C-1290 | nAPP2333679787 | fAPP2203927141 | 12/2/2023 | 11/18/2023 | 11/17/2023 | Pinestraw | VRU Discharge | 410.86 | Flared | 2:38 AM | 11:48 PM | 19.37 | Flared more than 8 HRs | Getting large O2 spikes so |
| 5F7EF-231202-C-129A | nAPP2332456176 | fAPP2203928043 | 12/2/2023 | 11/18/2023 | 11/17/2023 | Red Bud | VRU Discharge | 523.35 | Flared | 6:13 AM | 10:48 PM | 11.85 | Flared more than 8 HRs | Hila got hit with oxygen, VI |
| NA | NA | NA | NA | 11/19/2023 | 11/18/2023 | Nandina | LP - Vent flare/Blower Flare | 57.58 | Flared | 1:35 PM | 11:52 PM | 4.18 | Oxygen | O2 tested heater 2 and bro |
| FYJQN-231207-C-1290 | nAPP2334175976 | fAPP2203856979 | 12/7/2023 | 12/6/2023 | 11/18/2023 | Nandina | VRU Discharge | 197.92 | Flared | 1:06 PM | 11:16 PM | 10.95 | Flared more than 8 HRs | Hila got hit with oxygen, VI |
| NA | NA | NA | NA | 11/19/2023 | 11/18/2023 | Pinestraw | VRU Discharge | 99.55 | Flared | 12:00 AM | 3:02 AM | 2.82 | Oxygen | Getting large O2 spikes so |
| NA | NA | NA | NA | 11/20/2023 | 11/19/2023 | Nandina | LP - Vent flare/Blower Flare | 52.08 | Flared | 12:05 AM | 10:56 AM | 3.78 | Malfunction | Blower Faulted on High Dis |
| NA | NA | NA | NA | 11/20/2023 | 11/19/2023 | Amen Corner | VRU Discharge | 148.01 | Flared | 12:00 AM | 7:24 AM | 7.40 | Oxygen | O2 issues at Hila, all faciliti |
| NA | NA | NA | NA | 11/20/2023 | 11/19/2023 | Nandina | VRU Discharge | 63.58 | Flared | 12:03 AM | 5:06 AM | 3.55 | Oxygen | Hila got hit with oxygen, VI |
| 56H4R-231207-C-1290 | nAPP2334176584 | fAPP2203846035 | 12/7/2023 | 12/6/2023 | 11/20/2023 | Amen Corner | VRU Discharge | 182.35 | Flared | 12:00 AM | 11:33 PM | 9.12 | Flared more than 8 HRs | O2 issues at Hila, all faciliti |
| NA | NA | NA | NA | 11/21/2023 | 11/20/2023 | Nandina | VRU Discharge | 50.97 | Flared | 5:48 AM | 11:00 AM | 5.37 | Oxygen | Hila got hit with oxygen, VI |
| NA | NA | NA | NA | 11/21/2023 | 11/20/2023 | Pinestraw | VRU Discharge | 70.07 | Flared | 5:51 AM | 9:15 AM | 3.45 | Oxygen | Hila got hit with oxygen, VI |
| QKTCO-231207-C-1290 | nAPP2334177191 | fAPP2203928043 | 12/7/2023 | 12/6/2023 | 11/20/2023 | Red Bud | VRU Discharge | 467.02 | Flared | 5:52 AM | 5:21 PM | 11.50 | Flared more than 8 HRs | Hila got hit with oxygen, VI |
| NA | NA | NA | NA | 11/22/2023 | 11/21/2023 | Pinestraw | VRU Discharge | 95.61 | Flared | 11:44 AM | 3:55 PM | 4.33 | Oxygen | Oxygen detected VRUs sen |
| NA | NA | NA | NA | 11/23/2023 | 11/22/2023 | Nan 1.5N | HP Flare | 329.35 | Flared | 4:57 PM | 11:51 PM | 0.62 | Insufficient Availability | Pinion was shut in so line p |
| NA | NA | NA | NA | 11/23/2023 | 11/22/2023 | Red Bud | HP Flare | 123.23 | Flared | 1:21 PM | 11:59 PM | 2.52 | Insufficient Availability | Pinion was shut in so line p |

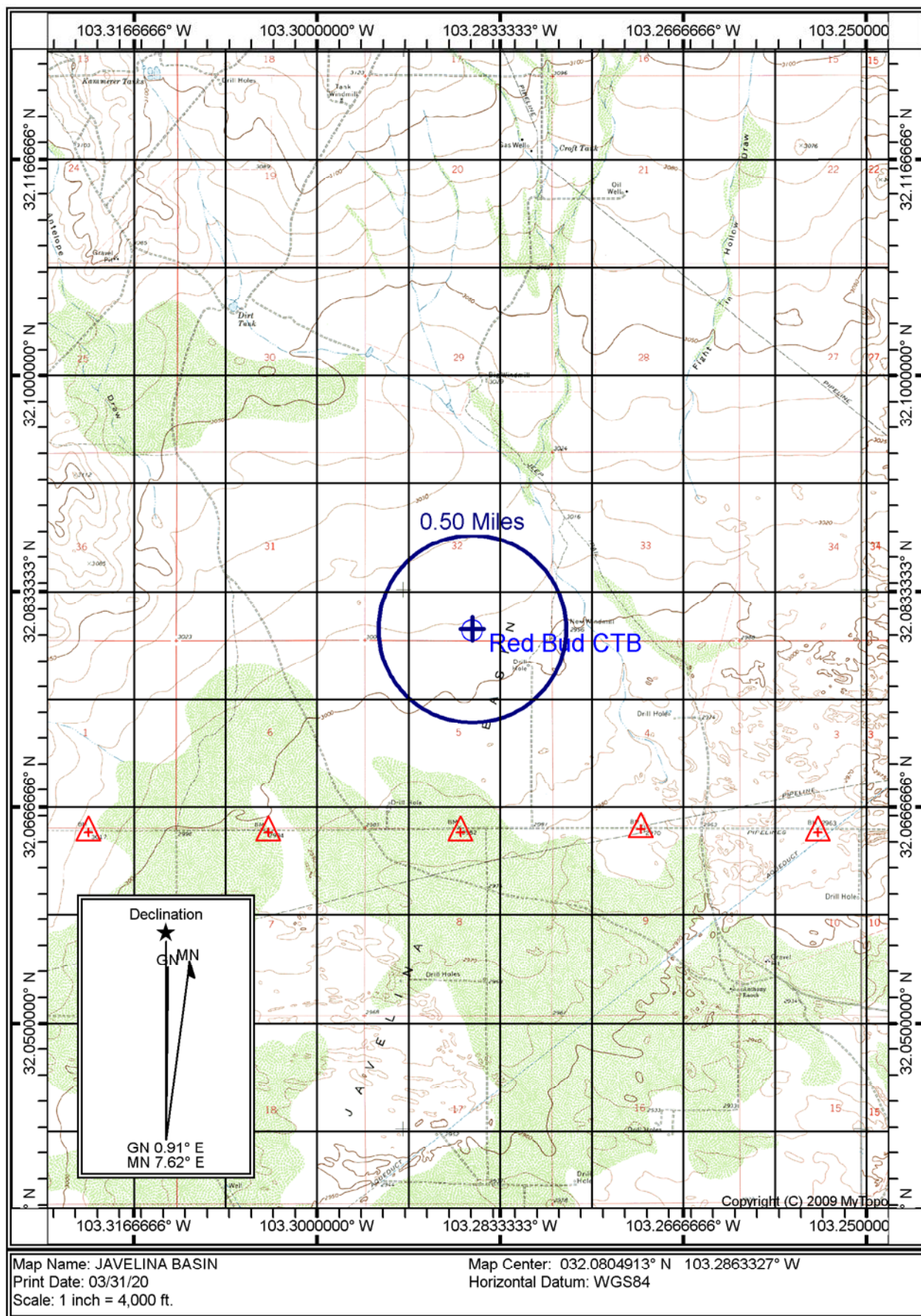

District I
1625 N. French Dr., Hobbs, NM 88240
Phone:(575) 393-6161 Fax:(575) 393-0720
District II
811 S. First St., Artesia, NM 88210
Phone:(575) 748-1283 Fax:(575) 748-9720
District III
1000 Rio Brazos Rd., Aztec, NM 87410
Phone:(505) 334-6178 Fax:(505) 334-6170
District IV
1220 S. St Francis Dr., Santa Fe, NM 87505
Phone:(505) 476-3470 Fax:(505) 476-3462

State of New Mexico
Energy, Minerals and Natural Resources
Oil Conservation Division
1220 S. St Francis Dr.
Santa Fe, NM 87505

DEFINITIONS

Action 293454

DEFINITIONS

| | |
|--|--|
| Operator: AMEREDEV OPERATING, LLC 2901 Via Fortuna Austin, TX 78746 | OGRID: 372224 |
| | Action Number: 293454 |
| | Action Type: [C-129] Venting and/or Flaring (C-129) |

DEFINITIONS

For the sake of brevity and completeness, please allow for the following in all groups of questions and for the rest of this application:

- this application's operator, hereinafter "this operator";
- venting and/or flaring, hereinafter "vent or flare";
- any notification or report(s) of the C-129 form family, hereinafter "any C-129 forms";
- the statements in (and/or attached to) this, hereinafter "the statements in this";
- and the past tense will be used in lieu of mixed past/present tense questions and statements.

District I

1625 N. French Dr., Hobbs, NM 88240
Phone:(575) 393-6161 Fax:(575) 393-0720

District II

811 S. First St., Artesia, NM 88210
Phone:(575) 748-1283 Fax:(575) 748-9720

District III

1000 Rio Brazos Rd., Aztec, NM 87410
Phone:(505) 334-6178 Fax:(505) 334-6170

District IV

1220 S. St Francis Dr., Santa Fe, NM 87505
Phone:(505) 476-3470 Fax:(505) 476-3462

State of New Mexico
Energy, Minerals and Natural Resources
Oil Conservation Division
1220 S. St Francis Dr.
Santa Fe, NM 87505

QUESTIONS

Action 293454

QUESTIONS

| | |
|--|--|
| Operator: AMEREDEV OPERATING, LLC 2901 Via Fortuna Austin, TX 78746 | OGRID: 372224 |
| | Action Number: 293454 |
| | Action Type: [C-129] Venting and/or Flaring (C-129) |

QUESTIONS

| | |
|---|--------------------------|
| Prerequisites <i>Any messages presented in this section, will prevent submission of this application. Please resolve these issues before continuing with the rest of the questions.</i> | |
| Incident Well | Unavailable. |
| Incident Facility | [fAPP2203928043] Red Bud |

| | |
|--|---|
| Determination of Reporting Requirements <i>Answer all questions that apply. The Reason(s) statements are calculated based on your answers and may provide additional guidance.</i> | |
| Was this vent or flare caused by an emergency or malfunction | No |
| Did this vent or flare last eight hours or more cumulatively within any 24-hour period from a single event | Yes |
| Is this considered a submission for a vent or flare event | Yes, minor venting and/or flaring of natural gas. |
| <i>An operator shall file a form C-141 instead of a form C-129 for a release that, includes liquid during venting and/or flaring that is or may be a major or minor release under 19.15.29.7 NMAC.</i> | |
| Was there at least 50 MCF of natural gas vented and/or flared during this event | Yes |
| Did this vent or flare result in the release of ANY liquids (not fully and/or completely flared) that reached (or has a chance of reaching) the ground, a surface, a watercourse, or otherwise, with reasonable probability, endanger public health, the environment or fresh water | No |
| Was the vent or flare within an incorporated municipal boundary or within 300 feet from an occupied permanent residence, school, hospital, institution or church in existence | No |

| | |
|---|---------------|
| Equipment Involved | |
| Primary Equipment Involved | Not answered. |
| Additional details for Equipment Involved. Please specify | Not answered. |

| | |
|--|---------------|
| Representative Compositional Analysis of Vented or Flared Natural Gas <i>Please provide the mole percent for the percentage questions in this group.</i> | |
| Methane (CH4) percentage | 73 |
| Nitrogen (N2) percentage, if greater than one percent | 1 |
| Hydrogen Sulfide (H2S) PPM, rounded up | 1 |
| Carbon Dioxide (CO2) percentage, if greater than one percent | 1 |
| Oxygen (O2) percentage, if greater than one percent | 0 |
| <i>If you are venting and/or flaring because of Pipeline Specification, please provide the required specifications for each gas.</i> | |
| Methane (CH4) percentage quality requirement | Not answered. |
| Nitrogen (N2) percentage quality requirement | Not answered. |
| Hydrogen Sulfide (H2S) PPM quality requirement | Not answered. |
| Carbon Dioxide (CO2) percentage quality requirement | Not answered. |
| Oxygen (O2) percentage quality requirement | Not answered. |

District I
1625 N. French Dr., Hobbs, NM 88240
Phone:(575) 393-6161 Fax:(575) 393-0720

District II
811 S. First St., Artesia, NM 88210
Phone:(575) 748-1283 Fax:(575) 748-9720

District III
1000 Rio Brazos Rd., Aztec, NM 87410
Phone:(505) 334-6178 Fax:(505) 334-6170

District IV
1220 S. St Francis Dr., Santa Fe, NM 87505
Phone:(505) 476-3470 Fax:(505) 476-3462

State of New Mexico
Energy, Minerals and Natural Resources
Oil Conservation Division
1220 S. St Francis Dr.
Santa Fe, NM 87505

QUESTIONS, Page 2

Action 293454

QUESTIONS (continued)

| | |
|--|--|
| Operator: AMEREDEV OPERATING, LLC 2901 Via Fortuna Austin, TX 78746 | OGRID: 372224 |
| | Action Number: 293454 |
| | Action Type: [C-129] Venting and/or Flaring (C-129) |

QUESTIONS

| Date(s) and Time(s) | |
|--|------------|
| Date vent or flare was discovered or commenced | 11/28/2023 |
| Time vent or flare was discovered or commenced | 12:01 AM |
| Time vent or flare was terminated | 11:15 PM |
| Cumulative hours during this event | 24 |

| Measured or Estimated Volume of Vented or Flared Natural Gas | |
|---|--|
| Natural Gas Vented (Mcf) Details | Not answered. |
| Natural Gas Flared (Mcf) Details | Cause: Midstream Emergency Maintenance Gas Compressor Station Natural Gas Flared Released: 85 Mcf Recovered: 0 Mcf Lost: 85 Mcf. |
| Other Released Details | Not answered. |
| Additional details for Measured or Estimated Volume(s). Please specify | Not answered. |
| Is this a gas only submission (i.e. only significant Mcf values reported) | Yes, according to supplied volumes this appears to be a "gas only" report. |

| Venting or Flaring Resulting from Downstream Activity | |
|---|---------------|
| Was this vent or flare a result of downstream activity | No |
| Was notification of downstream activity received by this operator | Not answered. |
| Downstream OGRID that should have notified this operator | Not answered. |
| Date notified of downstream activity requiring this vent or flare | Not answered. |
| Time notified of downstream activity requiring this vent or flare | Not answered. |

| Steps and Actions to Prevent Waste | |
|--|--|
| For this event, this operator could not have reasonably anticipated the current event and it was beyond this operator's control. | True |
| Please explain reason for why this event was beyond this operator's control | Pinion is out of service so gas was sent to flare. |
| Steps taken to limit the duration and magnitude of vent or flare | We choked back the wells to limit production. |
| Corrective actions taken to eliminate the cause and reoccurrence of vent or flare | Our midstream buyer was on fire. |

District I
1625 N. French Dr., Hobbs, NM 88240
Phone:(575) 393-6161 Fax:(575) 393-0720

District II
811 S. First St., Artesia, NM 88210
Phone:(575) 748-1283 Fax:(575) 748-9720

District III
1000 Rio Brazos Rd., Aztec, NM 87410
Phone:(505) 334-6178 Fax:(505) 334-6170

District IV
1220 S. St Francis Dr., Santa Fe, NM 87505
Phone:(505) 476-3470 Fax:(505) 476-3462

State of New Mexico
Energy, Minerals and Natural Resources
Oil Conservation Division
1220 S. St Francis Dr.
Santa Fe, NM 87505

ACKNOWLEDGMENTS

Action 293454

ACKNOWLEDGMENTS

| | |
|--|--|
| Operator: AMEREDEV OPERATING, LLC 2901 Via Fortuna Austin, TX 78746 | OGRID: 372224 |
| | Action Number: 293454 |
| | Action Type: [C-129] Venting and/or Flaring (C-129) |

ACKNOWLEDGMENTS

| | |
|-------------------------------------|---|
| <input checked="" type="checkbox"/> | I acknowledge that I am authorized to submit a <i>Venting and/or Flaring</i> (C-129) report on behalf of this operator and understand that this report can be a complete C-129 submission per 19.15.27.8 and 19.15.28.8 NMAC. |
| <input checked="" type="checkbox"/> | I acknowledge that upon submitting this application, I will be creating a new incident file (assigned to this operator) to track any C-129 forms, pursuant to 19.15.27.7 and 19.15.28.8 NMAC and understand that this submission meets the notification requirements of Paragraph (1) of Subsection G and F respectively. |
| <input checked="" type="checkbox"/> | I hereby certify the statements in this report are true and correct to the best of my knowledge and acknowledge that any false statement may be subject to civil and criminal penalties under the Oil and Gas Act. |
| <input checked="" type="checkbox"/> | I acknowledge that the acceptance of any C-129 forms by the OCD does not relieve this operator of liability should their operations have failed to adequately investigate, report, and remediate contamination that poses a threat to groundwater, surface water, human health, or the environment. |
| <input checked="" type="checkbox"/> | I acknowledge that OCD acceptance of any C-129 forms does not relieve this operator of responsibility for compliance with any other applicable federal, state, or local laws and/or regulations. |

District I
1625 N. French Dr., Hobbs, NM 88240
Phone:(575) 393-6161 Fax:(575) 393-0720
District II
811 S. First St., Artesia, NM 88210
Phone:(575) 748-1283 Fax:(575) 748-9720
District III
1000 Rio Brazos Rd., Aztec, NM 87410
Phone:(505) 334-6178 Fax:(505) 334-6170
District IV
1220 S. St Francis Dr., Santa Fe, NM 87505
Phone:(505) 476-3470 Fax:(505) 476-3462

State of New Mexico
Energy, Minerals and Natural Resources
Oil Conservation Division
1220 S. St Francis Dr.
Santa Fe, NM 87505

CONDITIONS

Action 293454

CONDITIONS

| | |
|--|--|
| Operator: AMEREDEV OPERATING, LLC 2901 Via Fortuna Austin, TX 78746 | OGRID: 372224 |
| | Action Number: 293454 |
| | Action Type: [C-129] Venting and/or Flaring (C-129) |

CONDITIONS

| Created By | Condition | Condition Date |
|------------|--|----------------|
| cescayu | If the information provided in this report requires an amendment, submit a [C-129] Amend Venting and/or Flaring Incident (C-129A), utilizing your incident number from this event. | 12/12/2023 |