

Office
 District I – (575) 393-6161
 1625 N. French Dr., Hobbs, NM 88240
 District II – (575) 748-1283
 811 S. First St., Artesia, NM 88210
 District III – (505) 334-6178
 1000 Rio Brazos Rd., Aztec, NM 87410
 District IV – (505) 476-3460
 1220 S. St. Francis Dr., Santa Fe, NM
 87505

State of New Mexico
 Energy, Minerals and Natural Resources

Form C-103
 Revised July 18, 2013

OIL CONSERVATION DIVISION
 1220 South St. Francis Dr.
 Santa Fe, NM 87505

WELL API NO. 30-025-36891
5. Indicate Type of Lease STATE <input checked="" type="checkbox"/> FEE <input type="checkbox"/>
6. State Oil & Gas Lease No.
7. Lease Name or Unit Agreement Name South Vacuum 27
8. Well Number #003
9. OGRID Number
10. Pool name or Wildcat Vacuum, Mississippian, South

SUNDRY NOTICES AND REPORTS ON WELLS (DO NOT USE THIS FORM FOR PROPOSALS TO DRILL OR TO DEEPEN OR PLUG BACK TO A DIFFERENT RESERVOIR. USE "APPLICATION FOR PERMIT" (FORM C-101) FOR SUCH PROPOSALS.)	
1. Type of Well: Oil Well <input checked="" type="checkbox"/> Gas Well <input type="checkbox"/> Other <input type="checkbox"/>	
2. Name of Operator Catena Resources Operating, LLC	
3. Address of Operator 18402 US Hwy 281 N, Suite 258 San Antonio, TX 78259	
4. Well Location Unit Letter <u>I</u> : <u>2300</u> feet from the <u>South</u> line and <u>1100</u> feet from the <u>East</u> line Section <u>27</u> Township <u>18S</u> Range <u>35E</u> NMPM Lea County	
11. Elevation (Show whether DR, RKB, RT, GR, etc.) 4000' GR	

12. Check Appropriate Box to Indicate Nature of Notice, Report or Other Data

NOTICE OF INTENTION TO:

PERFORM REMEDIAL WORK ☐ PLUG AND ABANDON ☐
TEMPORARILY ABANDON ☒ CHANGE PLANS ☐
 PULL OR ALTER CASING ☐ MULTIPLE COMPL ☐
 DOWNHOLE COMMINGLE ☐
 CLOSED-LOOP SYSTEM ☐
 OTHER: ☐

SUBSEQUENT REPORT OF:

REMEDIAL WORK ☐ ALTERING CASING ☐
 COMMENCE DRILLING OPNS. ☐ P AND A ☐
 CASING/CEMENT JOB ☐
 OTHER: ☐

13. Describe proposed or completed operations. (Clearly state all pertinent details, and give pertinent dates, including estimated date of starting any proposed work). SEE RULE 19.15.7.14 NMAC. For Multiple Completions: Attach wellbore diagram of proposed completion or recompletion.

On behalf of Catena Resources this C-103 is being submitted to request to TA the subject well with the below procedure.

1. RIH and Set CIBP @ 10,764' + or - (top Perf at 10,814')
2. Cap CIBP at 10,764' w/ 35' Cement by wireline
3. Load hole with Packer fluid and pressure test to 500# for 30 minutes

**Condition of Approval: notify
 OCD Hobbs office 24 hours
 prior of running MIT Test & Chart**

Spud Date: 10/20/2004

Rig Release Date:

I hereby certify that the information above is true and complete to the best of my knowledge and belief.

SIGNATURE Rachel Milne TITLE Regulatory Analyst III DATE 4/29/2021

Type or print name Rachel Milne E-mail address: ramilne@progressivepcs.net PHONE: (303) 309-1656
For State Use Only

APPROVED BY: Kerry Fortner TITLE Compliance Officer A DATE 5/18/21
 Conditions of Approval (if any):

Lease: South Vacuum 27 Well: #3 API # 30-025-36891
 Field: South Vacuum County: Lea State New Mexico
 Section 27 Township 18-S Range 35-E
 Elev. GL 3886' Elev. DF 4006' Elev. KB _____
 Spudded 10/17/2004 Completed _____ 2300' FSL, 1100' FEL

Surface Casing 13 3/8" OD 54.5#/Ft. Grade _____
 Set @ 420' Hole Size 17 1/2"
 TOC Sur. Sacks 166

Intermediate Casing 9 5/8" OD 40&36#/Ft. Grade _____
 Set @ 3846' Hole Size 12-1/4"
 TOC Sur. Sacks 1,675

Production Casing *5-1/2" 17 & 23#/Ft. Grade N-80
 Set @ 11,010' Hole Size 8-3/4"
 TOC est. 6800' Sacks 1,325

Liner Record OD #/Ft. Grade _____
 Top @ _____ Bottom @ _____
 Screen _____ Hole Size _____
 TOC _____ Sacks _____

Tubing Detail Grade/Trd. _____
 Pkr. Set @ _____ EOT _____
 Nipples _____
 Anchors _____ Rods _____

Perforation Record

Current Perfs.

Treatment record

*5-1/2" Casing: 17# from 3,276' to 7016', rest is 23# above and below.

Perforations: Mississippian/Chester Limestone 10,814'-24'

Comments:

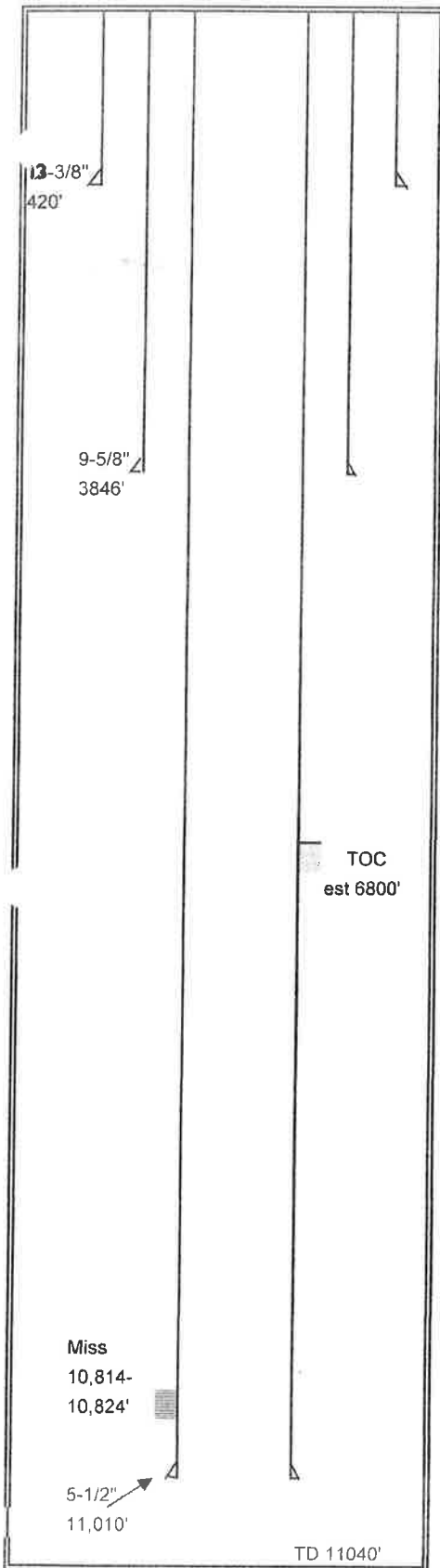

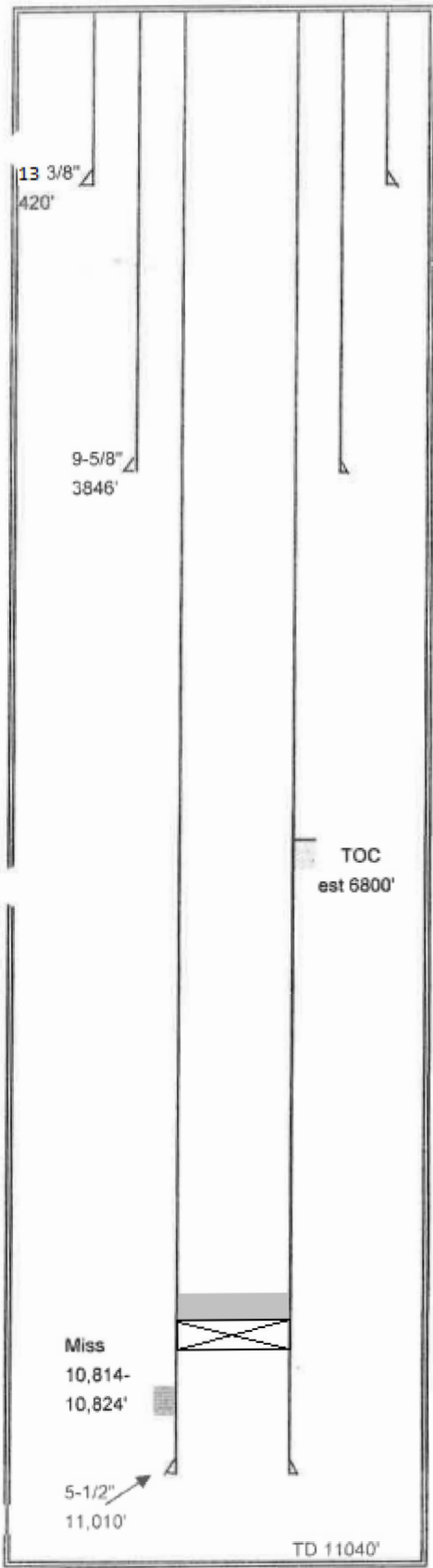

Lease: South Vacuum 27 Well: #3 API # 30-025
Field: South Vacuum County: Lea State New M
Section 27 Township 18-S Range 35-
Elev. GL 3886' Elev. DF 4006' Elev. KB
Spudded 10/17/2004 Completed 2300' FSL, 1100' FEL

Surface Casing	13 3/8" OD	54.5#/Ft.	Grade	
	Set @	420'	Hole Size	17 1
	TOC	Sur.	Sacks	16
Intermediate Casing	9 5/8" OD	40&36#/Ft.	Grade	
	Set @	3846'	Hole Size	12-1
	TOC	Sur	Sacks	1,67
Production Casing	*5-1/2" 17 & 23#/Ft.	Grade	N-8	
	Set @	11,010'	Hole Size	8-3/
	TOC	est. 6800'	Sacks	1,32
Liner Record	OD	#/Ft.	Grade	
	Top @		Bottom @	
	Screen		Hole Size	
	TOC		Sacks	
Tubing Detail			Grade/Trd.	
	Pkr. Set @		EOT	
	Nipples			
	Anchors		Rods	
Perforation Record				
Current Perfs.				
Treatment record				

*5-1/2" Casing: 17# from 3,276' to 7016', rest is 23# above and below.
Perforations: Mississippian/Chester Limestone 10,814'-10,824'
Proposed CIBP at 10,864' +/- with 35' Cement on Top
10,764 50' above top perforation

Comments:

Lease: South Vacuum 27 Well: #3 API # 30-025-36891
 Field: South Vacuum County: Lea State New Mexico
 Section 27 Township 18-S Range 35-E
 Elev. GL 3886' Elev. DF 4006' Elev. KB _____
 Spudded 10/17/2004 Completed _____ 2300' FSL, 1100' FEL

Surface Casing 13 3/8" OD 54.5#/Ft. Grade _____
 Set @ 420' Hole Size 17 1/2"
 TOC Sur. Sacks 166

Intermediate Casing 9 5/8" OD 40&36#/Ft. Grade _____
 Set @ 3846' Hole Size 12-1/4"
 TOC Sur. Sacks 1,675

Production Casing *5-1/2" 17 & 23#/Ft. Grade N-80
 Set @ 11,010' Hole Size 8-3/4"
 TOC est. 6800' Sacks 1,325

Liner Record OD #/Ft. Grade _____
 Top @ _____ Bottom @ _____
 Screen _____ Hole Size _____
 TOC _____ Sacks _____

Tubing Detail Grade/Trd. _____
 Pkr. Set @ _____ EOT _____
 Nipples _____

Anchors _____ Rods _____

Perforation Record

Current Perfs.

Treatment record

*5-1/2" Casing: 17# from 3,276' to 7016', rest is 23# above and below.

Perforations: Mississippian/Chester Limestone 10,814'-24'

Comments:

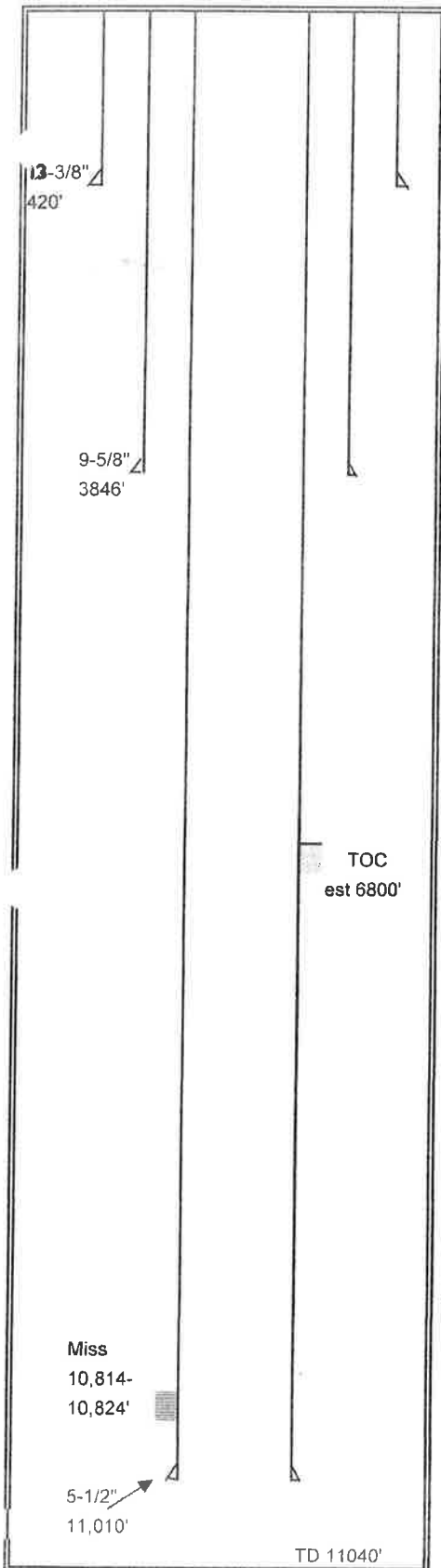

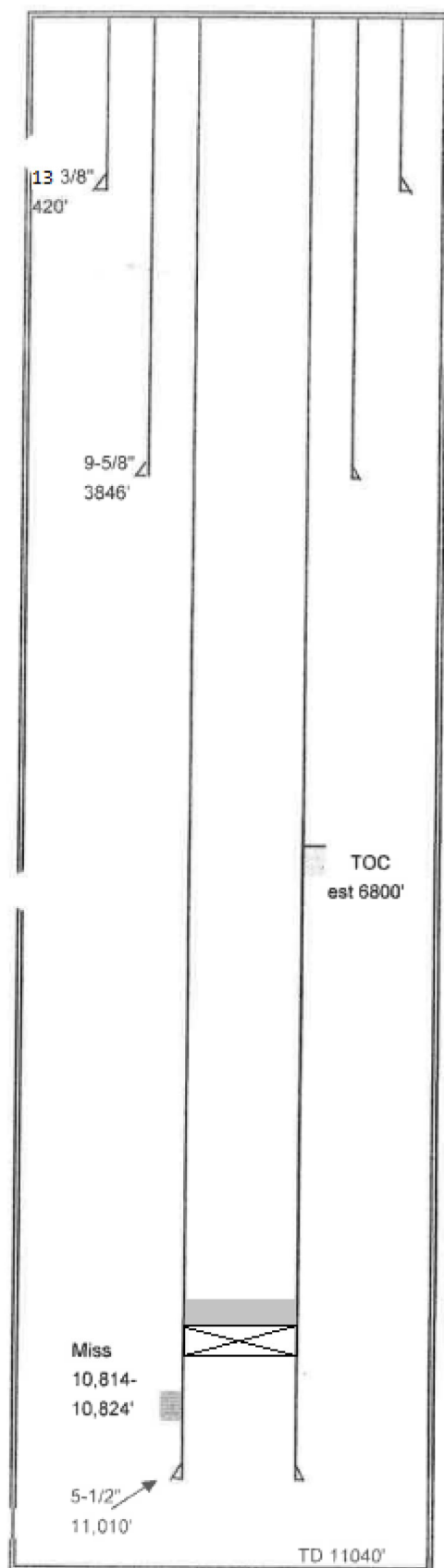

Lease: South Vacuum 27 Well: #3 API # 30-025

Field: South Vacuum County: Lea State: New Mexico

Section 27 Township 18-S Range 35-

Elev. GL 3886' Elev. DF 4006' Elev. KB

Spudded	10/17/2004	Completed	2300' FSL, 1100' FEL
---------	------------	-----------	----------------------

Surface Casing	13 3/8" OD	54.5#/Ft.	Grade	
	Set @	420'	Hole Size	17 1/2"
	TOC	Sur.	Sacks	16

Intermediate Casing	9 5/8" OD	40&36#/Ft.	Grade	
	Set @	3846'	Hole Size	12-1
	TOC	Sur	Sacks	1,67

Production Casing	*5-1/2" 17 & 23#/Ft.	Grade	N-8
	Set @ 11,010'	Hole Size	8-3/4"
	TOC est. 6800'	Sacks	1,320

Liner Record	OD	#/Ft.	Grade
Top @			Bottom @
Screen			Hole Size
TOC			Sacks

Tubing Detail	Pkr. Set @	Grade/Trd.
	Nipples	EOT
	Anchors	Rods

Perforation Record

Current Perfs.

Treatment record

*5-1/2" Casing: 17# from 3,276' to 7016', rest is 23# above and below.

Perforations: Mississippian/Chester Limestone 10,814'-10,824'

Proposed CIBP at 10,864' +/- with 35' Cement on Top

Comments:

District I
1625 N. French Dr., Hobbs, NM 88240
Phone:(575) 393-6161 Fax:(575) 393-0720
District II
811 S. First St., Artesia, NM 88210
Phone:(575) 748-1283 Fax:(575) 748-9720
District III
1000 Rio Brazos Rd., Aztec, NM 87410
Phone:(505) 334-6178 Fax:(505) 334-6170
District IV
1220 S. St Francis Dr., Santa Fe, NM 87505
Phone:(505) 476-3470 Fax:(505) 476-3462

State of New Mexico
Energy, Minerals and Natural Resources
Oil Conservation Division
1220 S. St Francis Dr.
Santa Fe, NM 87505

CONDITIONS

Action 26336

CONDITIONS OF APPROVAL

Operator:		OGRID:	Action Number:	Action Type:
CATENA RESOURCES OPERATING, LL	919 Milam	328449	26336	C-103I
Suite 2475	Houston, TX77002			

OCD Reviewer	Condition
kfortner	RUN TA STATUS MIT/BHT TEST