

Form 3160-3
(June 2015)FORM APPROVED
OMB No. 1004-0137
Expires: January 31, 2018

UNITED STATES
DEPARTMENT OF THE INTERIOR
BUREAU OF LAND MANAGEMENT
APPLICATION FOR PERMIT TO DRILL OR REENTER

1a. Type of work: <input type="checkbox"/> DRILL <input type="checkbox"/> REENTER 1b. Type of Well: <input type="checkbox"/> Oil Well <input type="checkbox"/> Gas Well <input type="checkbox"/> Other 1c. Type of Completion: <input type="checkbox"/> Hydraulic Fracturing <input type="checkbox"/> Single Zone <input type="checkbox"/> Multiple Zone		5. Lease Serial No. 6. If Indian, Allottee or Tribe Name 7. If Unit or CA Agreement, Name and No. 8. Lease Name and Well No. <div style="text-align: center; font-weight: bold; font-size: 1.2em;">[332895]</div>
2. Name of Operator <div style="text-align: center; font-weight: bold; font-size: 1.2em;">[260297]</div>		9. API Well No. <div style="text-align: center; font-weight: bold; font-size: 1.2em;">30-025-50197</div>
3a. Address	3b. Phone No. (include area code)	10. Field and Pool, or Exploratory
4. Location of Well (Report location clearly and in accordance with any State requirements. *) At surface At proposed prod. zone		11. Sec., T. R. M. or Blk. and Survey or Area
14. Distance in miles and direction from nearest town or post office*		12. County or Parish
13. State		
15. Distance from proposed* location to nearest property or lease line, ft. (Also to nearest drig. unit line, if any)	16. No of acres in lease	17. Spacing Unit dedicated to this well
18. Distance from proposed location* to nearest well, drilling, completed, applied for, on this lease, ft.	19. Proposed Depth	20. BLM/BIA Bond No. in file
21. Elevations (Show whether DF, KDB, RT, GL, etc.)	22. Approximate date work will start*	23. Estimated duration
24. Attachments		

The following, completed in accordance with the requirements of Onshore Oil and Gas Order No. 1, and the Hydraulic Fracturing rule per 43 CFR 3162.3-3 (as applicable)

- | | |
|---|---|
| 1. Well plat certified by a registered surveyor.
2. A Drilling Plan.
3. A Surface Use Plan (if the location is on National Forest System Lands, the SUPO must be filed with the appropriate Forest Service Office). | 4. Bond to cover the operations unless covered by an existing bond on file (see Item 20 above).
5. Operator certification.
6. Such other site specific information and/or plans as may be requested by the BLM. |
|---|---|

25. Signature	Name (Printed/Typed)	Date
Title		
Approved by (Signature)	Name (Printed/Typed)	Date
Title		
Office		

Application approval does not warrant or certify that the applicant holds legal or equitable title to those rights in the subject lease which would entitle the applicant to conduct operations thereon.
 Conditions of approval, if any, are attached.

Title 18 U.S.C. Section 1001 and Title 43 U.S.C. Section 1212, make it a crime for any person knowingly and willfully to make to any department or agency of the United States any false, fictitious or fraudulent statements or representations as to any matter within its jurisdiction.

NGMP Rec 05/16/2022

SL

(Continued on page 2)



Approval Date: 03/29/2022

KZ
06/01/2022

*(Instructions on page 2)

DISTRICT 1

1625 N. French Dr., Hobbs, NM 88240
Phone: (575) 393-6161 Fax: (575) 393-0720

DISTRICT II

811 S. First St., Artesia, NM 88210
Phone (575) 748-1283 Fax: (575) 748-9720

DISTRICT III

1000 Rio Brazos Road, Aztec, NM 87410
Phone: (505) 334-6178 Fax: (505) 334-6170

DISTRICT IV

DISTRICT IV
1220 S. St. Francis Dr., Santa Fe, NM 87505
Phone: (505) 476-3460 Fax: (505) 476-3462

State of New Mexico
Energy, Minerals & Natural Resources Department

OIL CONSERVATION DIVISION

1220 South St. Francis Dr.
Santa Fe, New Mexico 87505

Form C-102

Revised August 1, 2011

Submit one copy to appropriate
District Office

□ AMENDED REPORT

WELL LOCATION AND ACREAGE DEDICATION PLAT

API Number 30-025-50197		Pool Code 97903	Pool Name WC-025 G-08 S253235G;LWR BONE SPRING
Property Code 332895	Property Name MESA B 8115 7 FEDERAL COM		Well Number 26H
OGRID No. 260297	Operator Name BTA OIL PRODUCERS, LLC		Elevation 3237'

Surface Location

UL or lot No.	Section	Township	Range	Lot Idn	Feet from the	North/South line	Feet from the	East/West line	County
P	7	26-S	33-E		220	SOUTH	520	EAST	LEA

Bottom Hole Location If Different From Surface

UL or lot No.	Section	Township	Range	Lot Idn	Feet from the	North/South line	Feet from the	East/West line	County
A	7	26-S	33-E		50	NORTH	380	EAST	LEA

Dedicated Acres	Joint or Infill	Consolidation Code	Order No.
160			

NO ALLOWABLE WILL BE ASSIGNED TO THIS COMPLETION UNTIL ALL INTERESTS HAVE BEEN CONSOLIDATED OR A NON-STANDARD UNIT HAS BEEN APPROVED BY THE DIVISION

State of New Mexico
Energy, Minerals and Natural Resources Department

Submit Electronically
Via E-permitting

Oil Conservation Division
1220 South St. Francis Dr.
Santa Fe, NM 87505

NATURAL GAS MANAGEMENT PLAN

This Natural Gas Management Plan must be submitted with each Application for Permit to Drill (APD) for a new or recompleted well.

Section 1 – Plan Description

Effective May 25, 2021

I. Operator: BTA Oil Producers, LLC **OGRID:** 260297 **Date:** 4 / 20 / 2022

II. Type: ☒ Original ☐ Amendment due to ☐ 19.15.27.9.D(6)(a) NMAC ☐ 19.15.27.9.D(6)(b) NMAC ☐ Other.

If Other, please describe: _____

III. Well(s): Provide the following information for each new or recompleted well or set of wells proposed to be drilled or proposed to be recompleted from a single well pad or connected to a central delivery point.

Well Name	API	ULSTR	Footages	Anticipated Oil BBL/D	Anticipated Gas MCF/D	Anticipated Produced Water BBL/D
MESA B 8115 7 FEDERAL	30-025-50197	P-7-26S-33E	220 FSL, 520 FEL	+/- 800	+/- 2000	+/- 1200
COM 26H						

IV. Central Delivery Point Name: MESA B CTB [See 19.15.27.9(D)(1) NMAC]

V. Anticipated Schedule: Provide the following information for each new or recompleted well or set of wells proposed to be drilled or proposed to be recompleted from a single well pad or connected to a central delivery point.

Well Name	API	Spud Date	TD Reached Date	Completion Commencement Date	Initial Flow Back Date	First Production Date
MESA B 8115 7 FEDERAL	30-025-50197	9/20/2022	10/10/2022	10/24/2022	11/14/2022	12/14/2022
COM 26H						

VI. Separation Equipment: ☒ Attach a complete description of how Operator will size separation equipment to optimize gas capture.

VII. Operational Practices: ☒ Attach a complete description of the actions Operator will take to comply with the requirements of Subsection A through F of 19.15.27.8 NMAC.

VIII. Best Management Practices: ☒ Attach a complete description of Operator's best management practices to minimize venting during active and planned maintenance.

Section 2 – Enhanced Plan**EFFECTIVE APRIL 1, 2022**

Beginning April 1, 2022, an operator that is not in compliance with its statewide natural gas capture requirement for the applicable reporting area must complete this section.

☒ Operator certifies that it is not required to complete this section because Operator is in compliance with its statewide natural gas capture requirement for the applicable reporting area.

IX. Anticipated Natural Gas Production:

Well	API	Anticipated Average Natural Gas Rate MCF/D	Anticipated Volume of Natural Gas for the First Year MCF

X. Natural Gas Gathering System (NGGS):

Operator	System	ULSTR of Tie-in	Anticipated Gathering Start Date	Available Maximum Daily Capacity of System Segment Tie-in

XI. Map. ☐ Attach an accurate and legible map depicting the location of the well(s), the anticipated pipeline route(s) connecting the production operations to the existing or planned interconnect of the natural gas gathering system(s), and the maximum daily capacity of the segment or portion of the natural gas gathering system(s) to which the well(s) will be connected.

XII. Line Capacity. The natural gas gathering system ☐ will ☐ will not have capacity to gather 100% of the anticipated natural gas production volume from the well prior to the date of first production.

XIII. Line Pressure. Operator ☐ does ☐ does not anticipate that its existing well(s) connected to the same segment, or portion, of the natural gas gathering system(s) described above will continue to meet anticipated increases in line pressure caused by the new well(s).

☐ Attach Operator's plan to manage production in response to the increased line pressure.

XIV. Confidentiality: ☐ Operator asserts confidentiality pursuant to Section 71-2-8 NMSA 1978 for the information provided in Section 2 as provided in Paragraph (2) of Subsection D of 19.15.27.9 NMAC, and attaches a full description of the specific information for which confidentiality is asserted and the basis for such assertion.

Section 3 - Certifications

Effective May 25, 2021

Operator certifies that, after reasonable inquiry and based on the available information at the time of submittal:

☒ Operator will be able to connect the well(s) to a natural gas gathering system in the general area with sufficient capacity to transport one hundred percent of the anticipated volume of natural gas produced from the well(s) commencing on the date of first production, taking into account the current and anticipated volumes of produced natural gas from other wells connected to the pipeline gathering system; or

☐ Operator will not be able to connect to a natural gas gathering system in the general area with sufficient capacity to transport one hundred percent of the anticipated volume of natural gas produced from the well(s) commencing on the date of first production, taking into account the current and anticipated volumes of produced natural gas from other wells connected to the pipeline gathering system.

If Operator checks this box, Operator will select one of the following:

Well Shut-In. ☐ Operator will shut-in and not produce the well until it submits the certification required by Paragraph (4) of Subsection D of 19.15.27.9 NMAC; or

Venting and Flaring Plan. ☐ Operator has attached a venting and flaring plan that evaluates and selects one or more of the potential alternative beneficial uses for the natural gas until a natural gas gathering system is available, including:

- (a) power generation on lease;
- (b) power generation for grid;
- (c) compression on lease;
- (d) liquids removal on lease;
- (e) reinjection for underground storage;
- (f) reinjection for temporary storage;
- (g) reinjection for enhanced oil recovery;
- (h) fuel cell production; and
- (i) other alternative beneficial uses approved by the division.

Section 4 - Notices

1. If, at any time after Operator submits this Natural Gas Management Plan and before the well is spud:

(a) Operator becomes aware that the natural gas gathering system it planned to connect the well(s) to has become unavailable or will not have capacity to transport one hundred percent of the production from the well(s), no later than 20 days after becoming aware of such information, Operator shall submit for OCD's approval a new or revised venting and flaring plan containing the information specified in Paragraph (5) of Subsection D of 19.15.27.9 NMAC; or

(b) Operator becomes aware that it has, cumulatively for the year, become out of compliance with its baseline natural gas capture rate or natural gas capture requirement, no later than 20 days after becoming aware of such information, Operator shall submit for OCD's approval a new or revised Natural Gas Management Plan for each well it plans to spud during the next 90 days containing the information specified in Paragraph (2) of Subsection D of 19.15.27.9 NMAC, and shall file an update for each Natural Gas Management Plan until Operator is back in compliance with its baseline natural gas capture rate or natural gas capture requirement.

2. OCD may deny or conditionally approve an APD if Operator does not make a certification, fails to submit an adequate venting and flaring plan which includes alternative beneficial uses for the anticipated volume of natural gas produced, or if OCD determines that Operator will not have adequate natural gas takeaway capacity at the time a well will be spud.

I certify that, after reasonable inquiry, the statements in and attached to this Natural Gas Management Plan are true and correct to the best of my knowledge and acknowledge that a false statement may be subject to civil and criminal penalties under the Oil and Gas Act.

Signature: 
Printed Name: Sammy Hajar
Title: Regulatory Analyst
E-mail Address: SHAJAR@BTAOIL.COM
Date: 4/20/2022
Phone: 432-682-3753
OIL CONSERVATION DIVISION (Only applicable when submitted as a standalone form)
Approved By:
Title:
Approval Date:
Conditions of Approval:

VI. Separation Equipment: Attach a complete description of how Operator will size separation equipment to optimize gas capture.

- Separation equipment will be sized to provide adequate separation for anticipated rates.
- Separation equipment will allow for adequate retention time to allow gas and liquids to separate.
- Separation equipment will separate all three phases (Oil, Water, and Gas).
- Collection systems are appropriately sized to handle facility production rates on all (3) phases.
- Ancillary equipment and metering is selected to be serviced without flow interruptions or the need to release gas from the well.

VII. Operational Practices: Attach a complete description of the actions Operator will take to comply with the requirements of Subsection A through F 19.15.27.8 NMAC.

Drilling Operations

- All flare stacks will be properly sized. The flare stacks will be located at a minimum 100' from the nearest surface hole location on the pad.
- All natural gas produced during drilling operations will be flared, unless there is an equipment malfunction and/or to avoid risk of an immediate and substantial adverse impact on safety and the environment, at which point the gas will be vented.

Completions/Recompletions Operations

- New wells will not be flowed back until they are connected to a properly sized gathering system.
- The facility will be built/sized for maximum anticipated flowrates and pressures to minimize waste.
- For flowback operations, multiple stages of separation will be used as well as VRU and blowers to make sure waste is minimized off the storage tanks and facility.
- During initial flowback, the well stream will be routed to separation equipment.
- At an existing facility, when necessary, post separation natural gas will be flared until it meets pipeline specifications, at which point it will be turned into a collection system.
- At a new facility, post separation natural gas will be vented until storage tanks can safely function, at which point it will be flared until it meets pipeline spec.

Production Operations

- Weekly AVOs will be performed on all facilities that produce more than 60 MCFD.
- Leaking thief hatches and pressure safety valves found during AVOs will be cleaned and properly re-sealed.
- All flares will be equipped with auto-ignition systems and continuous pilot operations.
- After a well is stabilized from liquid unloading, the well will be turned back into the collection system.
- All gas lift systems will be optimized to limit the amount of waste.
- All tanks will have automatic gauging equipment installed.

Performance Standards

- Production equipment will be designed to handle maximum anticipated rates and pressure.
- All flared gas will be combusted in a flare stack that is properly sized and designed to ensure proper combustion.
- All gas will have multiple points of separation to ensure no liquids enter flares, combustors, or gas sales line.
- Weekly AVOs will be performed on all wells and facilities that produce more than 60 MCFD.
- All OOOOa facilities will be filmed with an Optical Gas Imaging Thermographer camera once per month to check for fugitive emissions.

Measurement & Estimation

- All volume that is flared and vented that is not measured will be estimated.
- All measurement equipment for flared volumes will conform to API 14.10.
- All meters will be calibrated at regular intervals according to meter manufacturer recommendations.
- When metering is not practical due to low pressure/low rate, the vented or flared volume will be estimated.

VIII. Best Management Practices: Attach a complete description of Operator's best management practices to minimize venting during active and planned maintenance.

- During downhole well maintenance, BTA will use best management practices to vent as minimally as possible.
- Prior to the commencement of any maintenance, the tank or vessel will be isolated from the rest of the facilities.
- All valves upstream of the equipment will be closed and isolated.
- After equipment has been isolated, the equipment will be blown down to as low a pressure as possible into the collection system.
- If the equipment being maintained cannot be relieved into the collection system, it shall be released to a tank where the vapor can either be captured or combusted if possible.
- After downhole well maintenance, natural gas will be flared until it reaches pipeline specification.



U.S. Department of the Interior
BUREAU OF LAND MANAGEMENT

Drilling Plan Data Report

03/29/2022

APD ID: 10400073320

Submission Date: 04/20/2021

Highlighted data
reflects the most
recent changes

Operator Name: BTA OIL PRODUCERS LLC

Well Name: MESA B 8115 7 FEDERAL COM

Well Number: 26H

[Show Final Text](#)

Well Type: OIL WELL

Well Work Type: Drill

Section 1 - Geologic Formations

Formation ID	Formation Name	Elevation	True Vertical Depth	Measured Depth	Lithologies	Mineral Resources	Producing Formation
3781295	QUATERNARY	3237	0	0	ALLUVIUM	NONE	N
3781296	RUSTLER	2475	762	762	ANHYDRITE	NONE	N
3781297	TOP SALT	2005	1232	1232	SALT	NONE	N
3781298	BASE OF SALT	-1285	4522	4522	SALT	NONE	N
3781299	DELAWARE	-1525	4762	4762	LIMESTONE	NATURAL GAS, OIL	N
3781308	BELL CANYON	-1685	4922	4922	SANDSTONE	NATURAL GAS, OIL	N
3781301	CHERRY CANYON	-2975	6212	6212	SANDSTONE	NATURAL GAS, OIL	N
3781302	BRUSHY CANYON	-4140	7377	7377	SANDSTONE	NATURAL GAS, OIL	N
3781303	BONE SPRING LIME	-5760	8997	8997	LIMESTONE	NATURAL GAS, OIL	N
3781317	FIRST BONE SPRING SAND	-6695	9932	9932	SANDSTONE	NATURAL GAS, OIL	N
3781320	BONE SPRING 2ND	-7255	10492	10492	SANDSTONE	NATURAL GAS, OIL	Y

Section 2 - Blowout Prevention

Pressure Rating (PSI): 5M

Rating Depth: 12000

Equipment: The blowout preventer equipment (BOP) shown in Exhibit A will consist of a (5M system) double ram type (5,000 psi WP) preventer and a bag-type (Hydril) preventer (5000 psi WP). Both units will be hydraulically operated and the ram type preventer will be equipped with blind rams on top and 5" drill pipe rams on bottom. The BOPs will be installed on the 13-3/8" surface casing and utilized continuously until total depth is reached. A 2" kill line and 3" choke line will be incorporated in the drilling spool below the ram-type BOP. A remote kill line will be used for the 5M system as per onshore order #2. Other accessory BOP equipment will include a Kelly cock, floor safety valve, choke lines, and choke manifold having a 5,000 psi WP rating. The 5M annular will be tested as per BLM drilling Operations Order No. 2, and will be test to 100% of working pressure.

Requesting Variance? NO

Variance request:

Operator Name: BTA OIL PRODUCERS LLC**Well Name:** MESA B 8115 7 FEDERAL COM**Well Number:** 26H

Testing Procedure: Pipe rams will be operated and checked each 24-hour period and each time the drill pipe is out of the hole. These functional tests will be documented on the daily drillers log. All BOPs and associated equipment will be tested as per BLM drilling Operations Order No. 2.

Choke Diagram Attachment:

5M_choke_mannifold_20200917143047.pdf

Choke_Hose___Test_Chart_and_Specs_20190723082742.pdf

BOP Diagram Attachment:

5M_BOP_diagram_20200917143053.pdf

Section 3 - Casing

Casing ID	String Type	Hole Size	Csg Size	Condition	Standard	Tapered String	Top Set MD	Bottom Set MD	Top Set TVD	Bottom Set TVD	Top Set MSL	Bottom Set MSL	Calculated casing length MD	Grade	Weight	Joint Type	Collapse SF	Burst SF	Joint SF Type	Joint SF	Body SF Type	Body SF
1	SURFACE	17.5	13.375	NEW	API	N	0	890	0	890	3237	2347	890	J-55	54.5	ST&C	3.5	8.4	DRY	12.6	DRY	20.9
2	INTERMEDIATE	12.25	9.625	NEW	API	N	0	4754	0	4742	3419	-1505	4754	J-55	40	LT&C	1.4	1.4	DRY	2.7	DRY	3.3
3	PRODUCTION	8.75	5.5	NEW	API	N	0	15559	0	10542	3419	-7305	15559	P-110	17	BUTT	1.3	1.8	DRY	3.4	DRY	3.3

Casing Attachments

Casing ID: 1 **String Type:** SURFACE

Inspection Document:

Spec Document:

Tapered String Spec:

Casing Design Assumptions and Worksheet(s):

Mesa_B_26H_casing_assumption_20210420135722.JPG

Operator Name: BTA OIL PRODUCERS LLC

Well Name: MESA B 8115 7 FEDERAL COM

Well Number: 26H

Casing Attachments

Casing ID: 2 String Type: INTERMEDIATE

Inspection Document:

Spec Document:

Tapered String Spec:

Casing Design Assumptions and Worksheet(s):

Mesa_B_26H_casing_assumption_20210420135636.JPG

Casing ID: 3 String Type: PRODUCTION

Inspection Document:

Spec Document:

Tapered String Spec:

Casing Design Assumptions and Worksheet(s):

Mesa_B_26H_casing_assumption_20210420135545.JPG

Section 4 - Cement

String Type	Lead/Tail	Stage Tool Depth	Top MD	Bottom MD	Quantity(sx)	Yield	Density	Cu Ft	Excess%	Cement type	Additives
SURFACE	Lead		0	555	450	1.73	13.5	778.5	100	Class C	2% CaCl2
SURFACE	Tail		555	890	340	1.35	14.8	459	100	Class C	2% CaCl2
INTERMEDIATE	Lead		0	4195	1240	2.46	12.8	3050.4	100	Class C	0.5% CaCl2
INTERMEDIATE	Tail		4195	4754	200	1.34	14.8	268	25	Class C	1% CaCl2
PRODUCTION	Lead		3754	9910	605	3.9	10.5	2359.5	60	25% Poz 75% Class C	0.4% Fluid Loss

Operator Name: BTA OIL PRODUCERS LLC

Well Name: MESA B 8115 7 FEDERAL COM

Well Number: 26H

String Type	Lead/Tail	Stage Tool Depth	Top MD	Bottom MD	Quantity(sx)	Yield	Density	Cu Ft	Excess%	Cement type	Additives
PRODUCTION	Tail		9910	1555 9	1430	1.25	14.4	1787. 5	25	Class H	0.2% LT Retarder

Section 5 - Circulating Medium

Mud System Type: Closed

Will an air or gas system be Used? NO

Description of the equipment for the circulating system in accordance with Onshore Order #2:

Diagram of the equipment for the circulating system in accordance with Onshore Order #2:

Describe what will be on location to control well or mitigate other conditions: Sufficient mud materials to maintain mud properties and meet minimum lost circulation and weight increase requirements will be kept on location at all times.

Describe the mud monitoring system utilized: PVT/Pason/Visual Monitoring

Circulating Medium Table

Top Depth	Bottom Depth	Mud Type	Min Weight (lbs/gal)	Max Weight (lbs/gal)	Density (lbs/cu ft)	Gel Strength (lbs/100 sqft)	PH	Viscosity (CP)	Salinity (ppm)	Filtration (cc)	Additional Characteristics
0	890	OTHER : FW SPUD	8.3	8.4							
890	4742	OTHER : Saturated Brine	10	10.2							
4742	10542	OTHER : CUT BRINE	8.7	9.4							

Operator Name: BTA OIL PRODUCERS LLC**Well Name:** MESA B 8115 7 FEDERAL COM**Well Number:** 26H

Section 6 - Test, Logging, Coring

List of production tests including testing procedures, equipment and safety measures:

Drill Stem Tests will be based on geological sample shows.

List of open and cased hole logs run in the well:

MUD LOG/GEOLOGICAL LITHOLOGY LOG,GAMMA RAY LOG,CEMENT BOND LOG,

Coring operation description for the well:

None planned

Section 7 - Pressure

Anticipated Bottom Hole Pressure: 5153**Anticipated Surface Pressure:** 2833**Anticipated Bottom Hole Temperature(F):** 165**Anticipated abnormal pressures, temperatures, or potential geologic hazards?** NO**Describe:****Contingency Plans geohazards description:****Contingency Plans geohazards attachment:****Hydrogen Sulfide drilling operations plan required?** YES**Hydrogen sulfide drilling operations plan:**

BTA_Oil_Producers_LLC___EMERGENCY_CALL_LIST_20190723161502.pdf

H2S_Equipment_Schematic_20190723161502.pdf

H2S_Plan_20190723161502.pdf

Section 8 - Other Information

Proposed horizontal/directional/multi-lateral plan submission:

MESA_B_8115_7_Fed_Com_26H_Gas_Capture_Plan_20210420142334.pdf

Mesa_B_26H_directional_plan_20210420142346.pdf

Mesa_B_26H_Wall_plot_20210420142346.pdf

Other proposed operations facets description:

A variance is requested for a Multi Bowl Wellhead. See the attached schematic. *All strings will be kept 1/3 full while running.

Other proposed operations facets attachment:**Other Variance attachment:**

BOP_Break_Testing_Variance_20200917143242.pdf

Multi_Bowl_Diagram_13_38_x_9_58_x_5_12_20200917143315.pdf

13-5/8" 5,000 PSI BOP

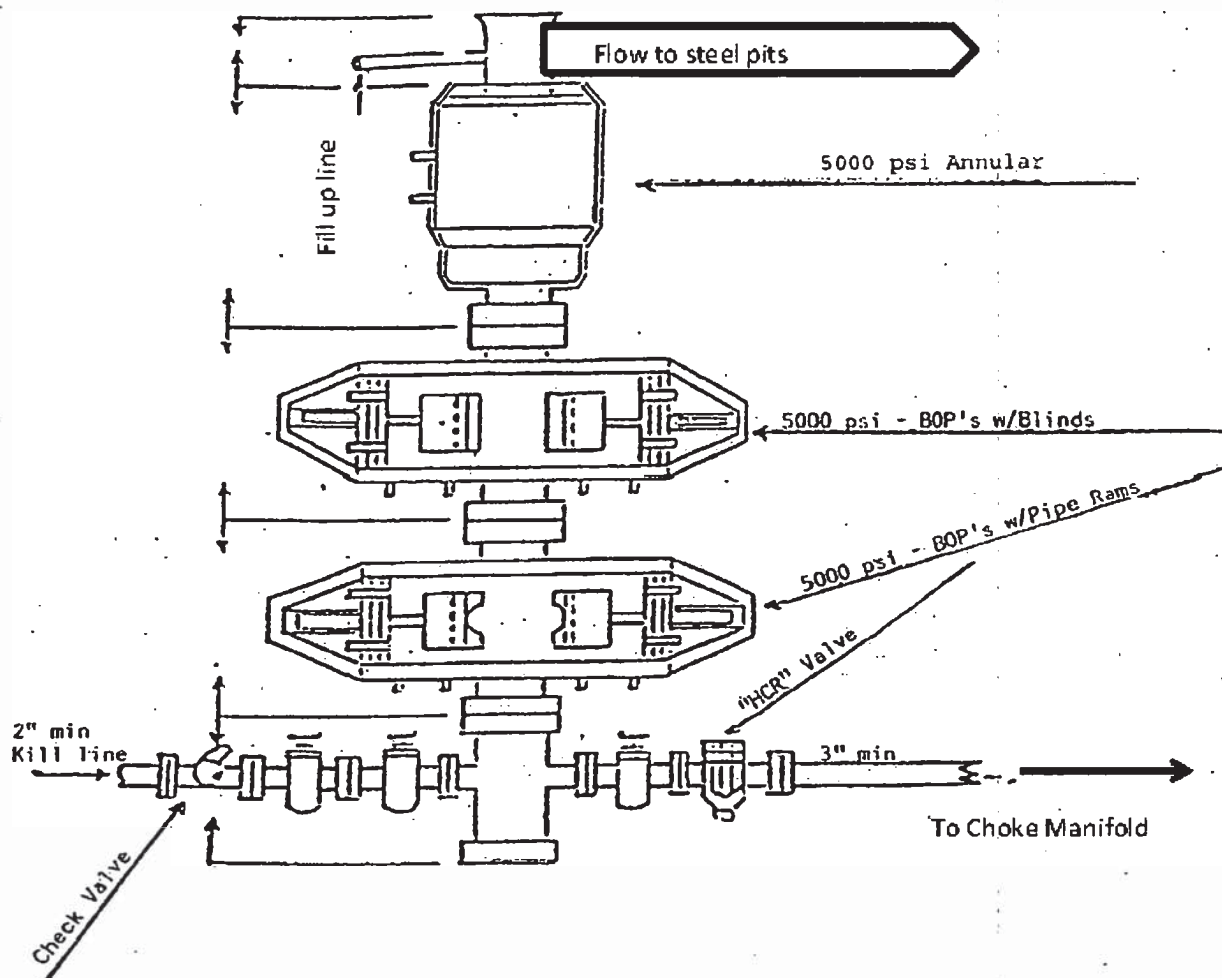

BTA Oil Producers, LLC

Lea County, NM (NAD 83)

Mesa B

Mesa B #26H

Wellbore #1

Plan: Design #1

Standard Planning Report - Geographic

13 April, 2021

Microsoft
Planning Report - Geographic

Database:	EDM16	Local Co-ordinate Reference:	Well Mesa B #26H
Company:	BTA Oil Producers, LLC	TVD Reference:	WELL @ 3237.0usft (Original Well Elev)
Project:	Lea County, NM (NAD 83)	MD Reference:	WELL @ 3237.0usft (Original Well Elev)
Site:	Mesa B	North Reference:	Grid
Well:	Mesa B #26H	Survey Calculation Method:	Minimum Curvature
Wellbore:	Wellbore #1		
Design:	Design #1		

Project	Lea County, NM (NAD 83), Lea County, NM		
Map System:	US State Plane 1983	System Datum:	Ground Level
Geo Datum:	North American Datum 1983		
Map Zone:	New Mexico Eastern Zone		Using geodetic scale factor

Site	Mesa B				
Site Position:		Northing:	383,154.37 usft	Latitude:	32° 3' 4.704 N
From:	Map	Easting:	765,479.20 usft	Longitude:	103° 36' 35.543 W
Position Uncertainty:	0.0 usft	Slot Radius:	13-3/16 "		

Well	Mesa B #26H					
Well Position	+N/-S	0.0 usft	Northing:	383,197.10 usft	Latitude:	32° 3' 5.017 N
	+E/-W	0.0 usft	Easting:	767,138.80 usft	Longitude:	103° 36' 16.257 W
Position Uncertainty		0.0 usft	Wellhead Elevation:	usft	Ground Level:	3,237.0 usft
Grid Convergence:		0.39 °				

Wellbore	Wellbore #1				
Magnetics	Model Name	Sample Date	Declination (°)	Dip Angle (°)	Field Strength (nT)
	IGRF200510	12/31/2009	7.75	60.07	48,686.93568077

Design	Design #1			
Audit Notes:				
Version:	Phase:	PROTOTYPE	Tie On Depth:	0.0
Vertical Section:	Depth From (TVD) (usft)	+N/-S (usft)	+E/-W (usft)	Direction (°)
	0.0	0.0	0.0	1.17

Plan Survey Tool Program	Date	4/13/2021		
Depth From (usft)	Depth To (usft)	Survey (Wellbore)	Tool Name	Remarks
1	0.0	15,558.7 Design #1 (Wellbore #1)		

Microsoft
Planning Report - Geographic

Database:	EDM16	Local Co-ordinate Reference:	Well Mesa B #26H
Company:	BTA Oil Producers, LLC	TVD Reference:	WELL @ 3237.0usft (Original Well Elev)
Project:	Lea County, NM (NAD 83)	MD Reference:	WELL @ 3237.0usft (Original Well Elev)
Site:	Mesa B	North Reference:	Grid
Well:	Mesa B #26H	Survey Calculation Method:	Minimum Curvature
Wellbore:	Wellbore #1		
Design:	Design #1		

Plan Sections										
Measured Depth (usft)	Inclination (°)	Azimuth (°)	Vertical Depth (usft)	+N/-S (usft)	+E/-W (usft)	Dogleg Rate (°/100usft)	Build Rate (°/100usft)	Turn Rate (°/100usft)	TFO (°)	Target
0.0	0.00	0.00	0.0	0.0	0.0	0.00	0.00	0.00	0.00	
1,500.0	0.00	0.00	1,500.0	0.0	0.0	0.00	0.00	0.00	0.00	
1,800.0	6.00	145.01	1,799.5	-12.9	9.0	2.00	2.00	0.00	145.01	
3,835.3	6.00	145.01	3,823.6	-187.1	131.0	0.00	0.00	0.00	0.00	
4,135.3	0.00	0.00	4,123.0	-200.0	140.0	2.00	-2.00	0.00	180.00	
10,026.7	0.00	0.00	10,014.5	-200.0	140.0	0.00	0.00	0.00	0.00	
10,076.8	0.00	0.00	10,064.5	-200.0	140.0	0.00	0.00	0.00	0.00	
10,826.8	90.00	359.59	10,542.0	277.5	136.6	12.00	12.00	0.00	359.59	
15,558.7	90.00	359.59	10,542.0	5,009.3	102.5	0.00	0.00	0.00	0.00	Mesa B #26H BHL

Microsoft
Planning Report - Geographic

Database:	EDM16	Local Co-ordinate Reference:	Well Mesa B #26H
Company:	BTA Oil Producers, LLC	TVD Reference:	WELL @ 3237.0usft (Original Well Elev)
Project:	Lea County, NM (NAD 83)	MD Reference:	WELL @ 3237.0usft (Original Well Elev)
Site:	Mesa B	North Reference:	Grid
Well:	Mesa B #26H	Survey Calculation Method:	Minimum Curvature
Wellbore:	Wellbore #1		
Design:	Design #1		

Planned Survey									
Measured Depth (usft)	Inclination (°)	Azimuth (°)	Vertical Depth (usft)	+N/-S (usft)	+E/-W (usft)	Map Northing (usft)	Map Easting (usft)	Latitude	Longitude
0.0	0.00	0.00	0.0	0.0	0.0	383,197.10	767,138.80	32° 3' 5.017 N	103° 36' 16.257 W
100.0	0.00	0.00	100.0	0.0	0.0	383,197.10	767,138.80	32° 3' 5.017 N	103° 36' 16.257 W
200.0	0.00	0.00	200.0	0.0	0.0	383,197.10	767,138.80	32° 3' 5.017 N	103° 36' 16.257 W
300.0	0.00	0.00	300.0	0.0	0.0	383,197.10	767,138.80	32° 3' 5.017 N	103° 36' 16.257 W
400.0	0.00	0.00	400.0	0.0	0.0	383,197.10	767,138.80	32° 3' 5.017 N	103° 36' 16.257 W
500.0	0.00	0.00	500.0	0.0	0.0	383,197.10	767,138.80	32° 3' 5.017 N	103° 36' 16.257 W
600.0	0.00	0.00	600.0	0.0	0.0	383,197.10	767,138.80	32° 3' 5.017 N	103° 36' 16.257 W
700.0	0.00	0.00	700.0	0.0	0.0	383,197.10	767,138.80	32° 3' 5.017 N	103° 36' 16.257 W
800.0	0.00	0.00	800.0	0.0	0.0	383,197.10	767,138.80	32° 3' 5.017 N	103° 36' 16.257 W
900.0	0.00	0.00	900.0	0.0	0.0	383,197.10	767,138.80	32° 3' 5.017 N	103° 36' 16.257 W
1,000.0	0.00	0.00	1,000.0	0.0	0.0	383,197.10	767,138.80	32° 3' 5.017 N	103° 36' 16.257 W
1,100.0	0.00	0.00	1,100.0	0.0	0.0	383,197.10	767,138.80	32° 3' 5.017 N	103° 36' 16.257 W
1,200.0	0.00	0.00	1,200.0	0.0	0.0	383,197.10	767,138.80	32° 3' 5.017 N	103° 36' 16.257 W
1,300.0	0.00	0.00	1,300.0	0.0	0.0	383,197.10	767,138.80	32° 3' 5.017 N	103° 36' 16.257 W
1,400.0	0.00	0.00	1,400.0	0.0	0.0	383,197.10	767,138.80	32° 3' 5.017 N	103° 36' 16.257 W
1,500.0	0.00	0.00	1,500.0	0.0	0.0	383,197.10	767,138.80	32° 3' 5.017 N	103° 36' 16.257 W
1,600.0	2.00	145.01	1,600.0	-1.4	1.0	383,195.67	767,139.80	32° 3' 5.003 N	103° 36' 16.245 W
1,700.0	4.00	145.01	1,699.8	-5.7	4.0	383,191.38	767,142.80	32° 3' 4.960 N	103° 36' 16.211 W
1,800.0	6.00	145.01	1,799.5	-12.9	9.0	383,184.24	767,147.80	32° 3' 4.889 N	103° 36' 16.153 W
1,900.0	6.00	145.01	1,898.9	-21.4	15.0	383,175.68	767,153.79	32° 3' 4.804 N	103° 36' 16.084 W
2,000.0	6.00	145.01	1,998.4	-30.0	21.0	383,167.12	767,159.78	32° 3' 4.719 N	103° 36' 16.015 W
2,100.0	6.00	145.01	2,097.8	-38.5	27.0	383,158.55	767,165.78	32° 3' 4.634 N	103° 36' 15.946 W
2,200.0	6.00	145.01	2,197.3	-47.1	33.0	383,149.99	767,171.77	32° 3' 4.549 N	103° 36' 15.878 W
2,300.0	6.00	145.01	2,296.7	-55.7	39.0	383,141.43	767,177.77	32° 3' 4.463 N	103° 36' 15.809 W
2,400.0	6.00	145.01	2,396.2	-64.2	45.0	383,132.86	767,183.76	32° 3' 4.378 N	103° 36' 15.740 W
2,500.0	6.00	145.01	2,495.6	-72.8	51.0	383,124.30	767,189.76	32° 3' 4.293 N	103° 36' 15.671 W
2,600.0	6.00	145.01	2,595.1	-81.4	57.0	383,115.74	767,195.75	32° 3' 4.208 N	103° 36' 15.602 W
2,700.0	6.00	145.01	2,694.5	-89.9	62.9	383,107.18	767,201.74	32° 3' 4.123 N	103° 36' 15.533 W
2,800.0	6.00	145.01	2,794.0	-98.5	68.9	383,098.61	767,207.74	32° 3' 4.038 N	103° 36' 15.464 W
2,900.0	6.00	145.01	2,893.4	-107.1	74.9	383,090.05	767,213.73	32° 3' 3.953 N	103° 36' 15.395 W
3,000.0	6.00	145.01	2,992.9	-115.6	80.9	383,081.49	767,219.73	32° 3' 3.867 N	103° 36' 15.326 W
3,100.0	6.00	145.01	3,092.3	-124.2	86.9	383,072.92	767,225.72	32° 3' 3.782 N	103° 36' 15.257 W
3,200.0	6.00	145.01	3,191.8	-132.7	92.9	383,064.36	767,231.71	32° 3' 3.697 N	103° 36' 15.188 W
3,300.0	6.00	145.01	3,291.2	-141.3	98.9	383,055.80	767,237.71	32° 3' 3.612 N	103° 36' 15.119 W
3,400.0	6.00	145.01	3,390.7	-149.9	104.9	383,047.23	767,243.70	32° 3' 3.527 N	103° 36' 15.050 W
3,500.0	6.00	145.01	3,490.1	-158.4	110.9	383,038.67	767,249.70	32° 3' 3.442 N	103° 36' 14.981 W
3,600.0	6.00	145.01	3,589.6	-167.0	116.9	383,030.11	767,255.69	32° 3' 3.357 N	103° 36' 14.912 W
3,700.0	6.00	145.01	3,689.0	-175.6	122.9	383,021.54	767,261.68	32° 3' 3.271 N	103° 36' 14.843 W
3,800.0	6.00	145.01	3,788.5	-184.1	128.9	383,012.98	767,267.68	32° 3' 3.186 N	103° 36' 14.774 W
3,835.3	6.00	145.01	3,823.6	-187.1	131.0	383,009.96	767,269.79	32° 3' 3.156 N	103° 36' 14.750 W
3,900.0	4.71	145.01	3,888.0	-192.1	134.5	383,005.01	767,273.26	32° 3' 3.107 N	103° 36' 14.710 W
4,000.0	2.71	145.01	3,987.8	-197.4	138.2	382,999.72	767,276.96	32° 3' 3.055 N	103° 36' 14.667 W
4,100.0	0.71	145.01	4,087.8	-199.8	139.9	382,997.28	767,278.67	32° 3' 3.030 N	103° 36' 14.648 W
4,135.3	0.00	0.00	4,123.0	-200.0	140.0	382,997.11	767,278.79	32° 3' 3.029 N	103° 36' 14.646 W
4,200.0	0.00	0.00	4,187.8	-200.0	140.0	382,997.11	767,278.79	32° 3' 3.029 N	103° 36' 14.646 W
4,300.0	0.00	0.00	4,287.8	-200.0	140.0	382,997.11	767,278.79	32° 3' 3.029 N	103° 36' 14.646 W
4,400.0	0.00	0.00	4,387.8	-200.0	140.0	382,997.11	767,278.79	32° 3' 3.029 N	103° 36' 14.646 W
4,500.0	0.00	0.00	4,487.8	-200.0	140.0	382,997.11	767,278.79	32° 3' 3.029 N	103° 36' 14.646 W
4,600.0	0.00	0.00	4,587.8	-200.0	140.0	382,997.11	767,278.79	32° 3' 3.029 N	103° 36' 14.646 W
4,700.0	0.00	0.00	4,687.8	-200.0	140.0	382,997.11	767,278.79	32° 3' 3.029 N	103° 36' 14.646 W
4,800.0	0.00	0.00	4,787.8	-200.0	140.0	382,997.11	767,278.79	32° 3' 3.029 N	103° 36' 14.646 W
4,900.0	0.00	0.00	4,887.8	-200.0	140.0	382,997.11	767,278.79	32° 3' 3.029 N	103° 36' 14.646 W
5,000.0	0.00	0.00	4,987.8	-200.0	140.0	382,997.11	767,278.79	32° 3' 3.029 N	103° 36' 14.646 W
5,100.0	0.00	0.00	5,087.8	-200.0	140.0	382,997.11	767,278.79	32° 3' 3.029 N	103° 36' 14.646 W
5,200.0	0.00	0.00	5,187.8	-200.0	140.0	382,997.11	767,278.79	32° 3' 3.029 N	103° 36' 14.646 W

Microsoft
Planning Report - Geographic

Database:	EDM16	Local Co-ordinate Reference:	Well Mesa B #26H
Company:	BTA Oil Producers, LLC	TVD Reference:	WELL @ 3237.0usft (Original Well Elev)
Project:	Lea County, NM (NAD 83)	MD Reference:	WELL @ 3237.0usft (Original Well Elev)
Site:	Mesa B	North Reference:	Grid
Well:	Mesa B #26H	Survey Calculation Method:	Minimum Curvature
Wellbore:	Wellbore #1		
Design:	Design #1		

Planned Survey										
Measured Depth (usft)	Inclination (°)	Azimuth (°)	Vertical Depth (usft)	+N/-S (usft)	+E/-W (usft)	Map Northing (usft)	Map Easting (usft)	Latitude	Longitude	
5,300.0	0.00	0.00	5,287.8	-200.0	140.0	382,997.11	767,278.79	32° 3' 3.029 N	103° 36' 14.646 W	
5,400.0	0.00	0.00	5,387.8	-200.0	140.0	382,997.11	767,278.79	32° 3' 3.029 N	103° 36' 14.646 W	
5,500.0	0.00	0.00	5,487.8	-200.0	140.0	382,997.11	767,278.79	32° 3' 3.029 N	103° 36' 14.646 W	
5,600.0	0.00	0.00	5,587.8	-200.0	140.0	382,997.11	767,278.79	32° 3' 3.029 N	103° 36' 14.646 W	
5,700.0	0.00	0.00	5,687.8	-200.0	140.0	382,997.11	767,278.79	32° 3' 3.029 N	103° 36' 14.646 W	
5,800.0	0.00	0.00	5,787.8	-200.0	140.0	382,997.11	767,278.79	32° 3' 3.029 N	103° 36' 14.646 W	
5,900.0	0.00	0.00	5,887.8	-200.0	140.0	382,997.11	767,278.79	32° 3' 3.029 N	103° 36' 14.646 W	
6,000.0	0.00	0.00	5,987.8	-200.0	140.0	382,997.11	767,278.79	32° 3' 3.029 N	103° 36' 14.646 W	
6,100.0	0.00	0.00	6,087.8	-200.0	140.0	382,997.11	767,278.79	32° 3' 3.029 N	103° 36' 14.646 W	
6,200.0	0.00	0.00	6,187.8	-200.0	140.0	382,997.11	767,278.79	32° 3' 3.029 N	103° 36' 14.646 W	
6,300.0	0.00	0.00	6,287.8	-200.0	140.0	382,997.11	767,278.79	32° 3' 3.029 N	103° 36' 14.646 W	
6,400.0	0.00	0.00	6,387.8	-200.0	140.0	382,997.11	767,278.79	32° 3' 3.029 N	103° 36' 14.646 W	
6,500.0	0.00	0.00	6,487.8	-200.0	140.0	382,997.11	767,278.79	32° 3' 3.029 N	103° 36' 14.646 W	
6,600.0	0.00	0.00	6,587.8	-200.0	140.0	382,997.11	767,278.79	32° 3' 3.029 N	103° 36' 14.646 W	
6,700.0	0.00	0.00	6,687.8	-200.0	140.0	382,997.11	767,278.79	32° 3' 3.029 N	103° 36' 14.646 W	
6,800.0	0.00	0.00	6,787.8	-200.0	140.0	382,997.11	767,278.79	32° 3' 3.029 N	103° 36' 14.646 W	
6,900.0	0.00	0.00	6,887.8	-200.0	140.0	382,997.11	767,278.79	32° 3' 3.029 N	103° 36' 14.646 W	
7,000.0	0.00	0.00	6,987.8	-200.0	140.0	382,997.11	767,278.79	32° 3' 3.029 N	103° 36' 14.646 W	
7,100.0	0.00	0.00	7,087.8	-200.0	140.0	382,997.11	767,278.79	32° 3' 3.029 N	103° 36' 14.646 W	
7,200.0	0.00	0.00	7,187.8	-200.0	140.0	382,997.11	767,278.79	32° 3' 3.029 N	103° 36' 14.646 W	
7,300.0	0.00	0.00	7,287.8	-200.0	140.0	382,997.11	767,278.79	32° 3' 3.029 N	103° 36' 14.646 W	
7,400.0	0.00	0.00	7,387.8	-200.0	140.0	382,997.11	767,278.79	32° 3' 3.029 N	103° 36' 14.646 W	
7,500.0	0.00	0.00	7,487.8	-200.0	140.0	382,997.11	767,278.79	32° 3' 3.029 N	103° 36' 14.646 W	
7,600.0	0.00	0.00	7,587.8	-200.0	140.0	382,997.11	767,278.79	32° 3' 3.029 N	103° 36' 14.646 W	
7,700.0	0.00	0.00	7,687.8	-200.0	140.0	382,997.11	767,278.79	32° 3' 3.029 N	103° 36' 14.646 W	
7,800.0	0.00	0.00	7,787.8	-200.0	140.0	382,997.11	767,278.79	32° 3' 3.029 N	103° 36' 14.646 W	
7,900.0	0.00	0.00	7,887.8	-200.0	140.0	382,997.11	767,278.79	32° 3' 3.029 N	103° 36' 14.646 W	
8,000.0	0.00	0.00	7,987.8	-200.0	140.0	382,997.11	767,278.79	32° 3' 3.029 N	103° 36' 14.646 W	
8,100.0	0.00	0.00	8,087.8	-200.0	140.0	382,997.11	767,278.79	32° 3' 3.029 N	103° 36' 14.646 W	
8,200.0	0.00	0.00	8,187.8	-200.0	140.0	382,997.11	767,278.79	32° 3' 3.029 N	103° 36' 14.646 W	
8,300.0	0.00	0.00	8,287.8	-200.0	140.0	382,997.11	767,278.79	32° 3' 3.029 N	103° 36' 14.646 W	
8,400.0	0.00	0.00	8,387.8	-200.0	140.0	382,997.11	767,278.79	32° 3' 3.029 N	103° 36' 14.646 W	
8,500.0	0.00	0.00	8,487.8	-200.0	140.0	382,997.11	767,278.79	32° 3' 3.029 N	103° 36' 14.646 W	
8,600.0	0.00	0.00	8,587.8	-200.0	140.0	382,997.11	767,278.79	32° 3' 3.029 N	103° 36' 14.646 W	
8,700.0	0.00	0.00	8,687.8	-200.0	140.0	382,997.11	767,278.79	32° 3' 3.029 N	103° 36' 14.646 W	
8,800.0	0.00	0.00	8,787.8	-200.0	140.0	382,997.11	767,278.79	32° 3' 3.029 N	103° 36' 14.646 W	
8,900.0	0.00	0.00	8,887.8	-200.0	140.0	382,997.11	767,278.79	32° 3' 3.029 N	103° 36' 14.646 W	
9,000.0	0.00	0.00	8,987.8	-200.0	140.0	382,997.11	767,278.79	32° 3' 3.029 N	103° 36' 14.646 W	
9,100.0	0.00	0.00	9,087.8	-200.0	140.0	382,997.11	767,278.79	32° 3' 3.029 N	103° 36' 14.646 W	
9,200.0	0.00	0.00	9,187.8	-200.0	140.0	382,997.11	767,278.79	32° 3' 3.029 N	103° 36' 14.646 W	
9,300.0	0.00	0.00	9,287.8	-200.0	140.0	382,997.11	767,278.79	32° 3' 3.029 N	103° 36' 14.646 W	
9,400.0	0.00	0.00	9,387.8	-200.0	140.0	382,997.11	767,278.79	32° 3' 3.029 N	103° 36' 14.646 W	
9,500.0	0.00	0.00	9,487.8	-200.0	140.0	382,997.11	767,278.79	32° 3' 3.029 N	103° 36' 14.646 W	
9,600.0	0.00	0.00	9,587.8	-200.0	140.0	382,997.11	767,278.79	32° 3' 3.029 N	103° 36' 14.646 W	
9,700.0	0.00	0.00	9,687.8	-200.0	140.0	382,997.11	767,278.79	32° 3' 3.029 N	103° 36' 14.646 W	
9,800.0	0.00	0.00	9,787.8	-200.0	140.0	382,997.11	767,278.79	32° 3' 3.029 N	103° 36' 14.646 W	
9,900.0	0.00	0.00	9,887.8	-200.0	140.0	382,997.11	767,278.79	32° 3' 3.029 N	103° 36' 14.646 W	
10,000.0	0.00	0.00	9,987.8	-200.0	140.0	382,997.11	767,278.79	32° 3' 3.029 N	103° 36' 14.646 W	
10,026.7	0.00	0.00	10,014.5	-200.0	140.0	382,997.11	767,278.79	32° 3' 3.029 N	103° 36' 14.646 W	
10,076.8	0.00	0.00	10,064.5	-200.0	140.0	382,997.11	767,278.79	32° 3' 3.029 N	103° 36' 14.646 W	
10,100.0	2.79	359.59	10,087.7	-199.4	140.0	382,997.67	767,278.79	32° 3' 3.034 N	103° 36' 14.646 W	
10,200.0	14.79	359.59	10,186.4	-184.2	139.9	383,012.92	767,278.68	32° 3' 3.185 N	103° 36' 14.646 W	
10,300.0	26.79	359.59	10,279.7	-148.8	139.6	383,048.34	767,278.42	32° 3' 3.535 N	103° 36' 14.646 W	
10,400.0	38.79	359.59	10,363.6	-94.7	139.2	383,102.39	767,278.03	32° 3' 4.070 N	103° 36' 14.647 W	
10,500.0	50.79	359.59	10,434.5	-24.4	138.7	383,172.70	767,277.53	32° 3' 4.766 N	103° 36' 14.647 W	

Microsoft
Planning Report - Geographic

Database:	EDM16	Local Co-ordinate Reference:	Well Mesa B #26H
Company:	BTA Oil Producers, LLC	TVD Reference:	WELL @ 3237.0usft (Original Well Elev)
Project:	Lea County, NM (NAD 83)	MD Reference:	WELL @ 3237.0usft (Original Well Elev)
Site:	Mesa B	North Reference:	Grid
Well:	Mesa B #26H	Survey Calculation Method:	Minimum Curvature
Wellbore:	Wellbore #1		
Design:	Design #1		

Planned Survey										
Measured Depth (usft)	Inclination (°)	Azimuth (°)	Vertical Depth (usft)	+N/-S (usft)	+E/-W (usft)	Map Northing (usft)	Map Easting (usft)	Latitude	Longitude	
10,600.0	62.79	359.59	10,489.1	59.1	138.1	383,256.21	767,276.93	32° 3' 5.593 N	103° 36' 14.647 W	
10,700.0	74.79	359.59	10,525.3	152.2	137.5	383,349.25	767,276.26	32° 3' 6.513 N	103° 36' 14.648 W	
10,800.0	86.79	359.59	10,541.2	250.7	136.8	383,447.78	767,275.55	32° 3' 7.488 N	103° 36' 14.648 W	
10,826.8	90.00	359.59	10,542.0	277.5	136.6	383,474.54	767,275.36	32° 3' 7.753 N	103° 36' 14.649 W	
10,900.0	90.00	359.59	10,542.0	350.7	136.0	383,547.76	767,274.83	32° 3' 8.478 N	103° 36' 14.649 W	
11,000.0	90.00	359.59	10,542.0	450.7	135.3	383,647.75	767,274.11	32° 3' 9.467 N	103° 36' 14.649 W	
11,100.0	90.00	359.59	10,542.0	550.7	134.6	383,747.75	767,273.39	32° 3' 10.457 N	103° 36' 14.650 W	
11,200.0	90.00	359.59	10,542.0	650.7	133.9	383,847.74	767,272.67	32° 3' 11.446 N	103° 36' 14.650 W	
11,300.0	90.00	359.59	10,542.0	750.7	133.2	383,947.73	767,271.95	32° 3' 12.436 N	103° 36' 14.651 W	
11,400.0	90.00	359.59	10,542.0	850.7	132.4	384,047.73	767,271.23	32° 3' 13.425 N	103° 36' 14.651 W	
11,500.0	90.00	359.59	10,542.0	950.7	131.7	384,147.72	767,270.51	32° 3' 14.415 N	103° 36' 14.652 W	
11,600.0	90.00	359.59	10,542.0	1,050.7	131.0	384,247.72	767,269.79	32° 3' 15.405 N	103° 36' 14.653 W	
11,700.0	90.00	359.59	10,542.0	1,150.6	130.3	384,347.71	767,269.07	32° 3' 16.394 N	103° 36' 14.653 W	
11,800.0	90.00	359.59	10,542.0	1,250.6	129.6	384,447.70	767,268.35	32° 3' 17.384 N	103° 36' 14.654 W	
11,900.0	90.00	359.59	10,542.0	1,350.6	128.8	384,547.70	767,267.63	32° 3' 18.373 N	103° 36' 14.654 W	
12,000.0	90.00	359.59	10,542.0	1,450.6	128.1	384,647.69	767,266.91	32° 3' 19.363 N	103° 36' 14.655 W	
12,100.0	90.00	359.59	10,542.0	1,550.6	127.4	384,747.69	767,266.19	32° 3' 20.352 N	103° 36' 14.655 W	
12,200.0	90.00	359.59	10,542.0	1,650.6	126.7	384,847.68	767,265.47	32° 3' 21.342 N	103° 36' 14.656 W	
12,300.0	90.00	359.59	10,542.0	1,750.6	126.0	384,947.68	767,264.75	32° 3' 22.331 N	103° 36' 14.656 W	
12,400.0	90.00	359.59	10,542.0	1,850.6	125.2	385,047.67	767,264.03	32° 3' 23.321 N	103° 36' 14.657 W	
12,500.0	90.00	359.59	10,542.0	1,950.6	124.5	385,147.66	767,263.31	32° 3' 24.310 N	103° 36' 14.657 W	
12,600.0	90.00	359.59	10,542.0	2,050.6	123.8	385,247.66	767,262.59	32° 3' 25.300 N	103° 36' 14.658 W	
12,700.0	90.00	359.59	10,542.0	2,150.6	123.1	385,347.65	767,261.87	32° 3' 26.290 N	103° 36' 14.658 W	
12,800.0	90.00	359.59	10,542.0	2,250.6	122.4	385,447.65	767,261.15	32° 3' 27.279 N	103° 36' 14.659 W	
12,900.0	90.00	359.59	10,542.0	2,350.6	121.6	385,547.64	767,260.43	32° 3' 28.269 N	103° 36' 14.659 W	
13,000.0	90.00	359.59	10,542.0	2,450.6	120.9	385,647.63	767,259.71	32° 3' 29.258 N	103° 36' 14.660 W	
13,100.0	90.00	359.59	10,542.0	2,550.6	120.2	385,747.63	767,258.99	32° 3' 30.248 N	103° 36' 14.660 W	
13,200.0	90.00	359.59	10,542.0	2,650.6	119.5	385,847.62	767,258.27	32° 3' 31.237 N	103° 36' 14.661 W	
13,300.0	90.00	359.59	10,542.0	2,750.6	118.8	385,947.62	767,257.55	32° 3' 32.227 N	103° 36' 14.661 W	
13,400.0	90.00	359.59	10,542.0	2,850.6	118.0	386,047.61	767,256.83	32° 3' 33.216 N	103° 36' 14.662 W	
13,500.0	90.00	359.59	10,542.0	2,950.6	117.3	386,147.61	767,256.12	32° 3' 34.206 N	103° 36' 14.662 W	
13,600.0	90.00	359.59	10,542.0	3,050.6	116.6	386,247.60	767,255.40	32° 3' 35.195 N	103° 36' 14.663 W	
13,700.0	90.00	359.59	10,542.0	3,150.6	115.9	386,347.59	767,254.68	32° 3' 36.185 N	103° 36' 14.663 W	
13,800.0	90.00	359.59	10,542.0	3,250.6	115.2	386,447.59	767,253.96	32° 3' 37.174 N	103° 36' 14.664 W	
13,900.0	90.00	359.59	10,542.0	3,350.6	114.4	386,547.58	767,253.24	32° 3' 38.164 N	103° 36' 14.664 W	
14,000.0	90.00	359.59	10,542.0	3,450.6	113.7	386,647.58	767,252.52	32° 3' 39.154 N	103° 36' 14.665 W	
14,100.0	90.00	359.59	10,542.0	3,550.6	113.0	386,747.57	767,251.80	32° 3' 40.143 N	103° 36' 14.665 W	
14,200.0	90.00	359.59	10,542.0	3,650.6	112.3	386,847.56	767,251.08	32° 3' 41.133 N	103° 36' 14.666 W	
14,300.0	90.00	359.59	10,542.0	3,750.6	111.6	386,947.56	767,250.36	32° 3' 42.122 N	103° 36' 14.666 W	
14,400.0	90.00	359.59	10,542.0	3,850.6	110.8	387,047.55	767,249.64	32° 3' 43.112 N	103° 36' 14.667 W	
14,500.0	90.00	359.59	10,542.0	3,950.6	110.1	387,147.55	767,248.92	32° 3' 44.101 N	103° 36' 14.667 W	
14,600.0	90.00	359.59	10,542.0	4,050.6	109.4	387,247.54	767,248.20	32° 3' 45.091 N	103° 36' 14.668 W	
14,700.0	90.00	359.59	10,542.0	4,150.6	108.7	387,347.54	767,247.48	32° 3' 46.080 N	103° 36' 14.668 W	
14,800.0	90.00	359.59	10,542.0	4,250.6	108.0	387,447.53	767,246.76	32° 3' 47.070 N	103° 36' 14.669 W	
14,900.0	90.00	359.59	10,542.0	4,350.6	107.2	387,547.52	767,246.04	32° 3' 48.059 N	103° 36' 14.669 W	
15,000.0	90.00	359.59	10,542.0	4,450.6	106.5	387,647.52	767,245.32	32° 3' 49.049 N	103° 36' 14.670 W	
15,100.0	90.00	359.59	10,542.0	4,550.6	105.8	387,747.51	767,244.60	32° 3' 50.039 N	103° 36' 14.670 W	
15,200.0	90.00	359.59	10,542.0	4,650.6	105.1	387,847.51	767,243.88	32° 3' 51.028 N	103° 36' 14.671 W	
15,300.0	90.00	359.59	10,542.0	4,750.6	104.4	387,947.50	767,243.16	32° 3' 52.018 N	103° 36' 14.671 W	
15,400.0	90.00	359.59	10,542.0	4,850.6	103.6	388,047.49	767,242.44	32° 3' 53.007 N	103° 36' 14.672 W	
15,500.0	90.00	359.59	10,542.0	4,950.6	102.9	388,147.49	767,241.72	32° 3' 53.997 N	103° 36' 14.673 W	
15,558.7	90.00	359.59	10,542.0	5,009.3	102.5	388,206.20	767,241.30	32° 3' 54.578 N	103° 36' 14.673 W	

Microsoft
Planning Report - Geographic

Database:	EDM16	Local Co-ordinate Reference:	Well Mesa B #26H
Company:	BTA Oil Producers, LLC	TVD Reference:	WELL @ 3237.0usft (Original Well Elev)
Project:	Lea County, NM (NAD 83)	MD Reference:	WELL @ 3237.0usft (Original Well Elev)
Site:	Mesa B	North Reference:	Grid
Well:	Mesa B #26H	Survey Calculation Method:	Minimum Curvature
Wellbore:	Wellbore #1		
Design:	Design #1		

Design Targets									
Target Name									
- hit/miss target	Dip Angle	Dip Dir.	TVD	+N/-S	+E/-W	Northing	Easting	Latitude	Longitude
- Shape	(°)	(°)	(usft)	(usft)	(usft)	(usft)	(usft)		
Mesa B #26H BHL	0.00	0.00	10,542.0	5,009.3	102.5	388,206.20	767,241.30	32° 3' 54.578 N	103° 36' 14.673 W
- plan hits target center									
- Point									

BTA Oil Producers, LLC

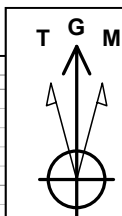

Azimuths to Grid North
True North: -0.39°
Magnetic North: 7.36°

Magnetic Field
Strength: 48686.9nT
Dip Angle: 60.07°
Date: 12/31/2009
Model: IGRF200510

SITE DETAILS: Mesa B

Site Centre Northing: 383154.37
Easting: 765479.20

Positional Uncertainty: 0.0
Convergence: 0.38
Local North: Grid

SECTION DETAILS

Sec	MD	Inc	Azi	TVD	+N/-S	+E/-W	Dleg
1	0.0	0.00	0.00	0.0	0.0	0.0	0.00
2	1500.0	0.00	0.00	1500.0	0.0	0.0	0.00
3	1800.0	6.00	145.01	1799.5	-12.9	9.0	2.00
4	3835.3	6.00	145.01	3823.6	-187.1	131.0	0.00
5	4135.3	0.00	0.00	4123.0	-200.0	140.0	2.00
6	10026.7	0.00	0.00	10014.5	-200.0	140.0	0.00
7	10076.8	0.00	0.00	10064.5	-200.0	140.0	0.00
8	10826.8	90.00	359.59	10542.0	277.5	136.6	12.00
9	1558.7	90.00	359.59	10542.0	5009.3	102.5	0.00

PROJECT DETAILS: Lea County, NM (NAD 83)

Geodetic System: US State Plane 1983
Datum: North American Datum 1983
Ellipsoid: GRS 1980
Zone: New Mexico Eastern Zone

System Datum: Ground Level

WELL DETAILS: Mesa B #26H

+N/-S	+E/-W	Northing	Ground Level Easting	3237.0 Latitude	Longitude
0.0	0.0	383197.10	767138.80	32° 3' 5.017 N	103° 36' 16.257 W

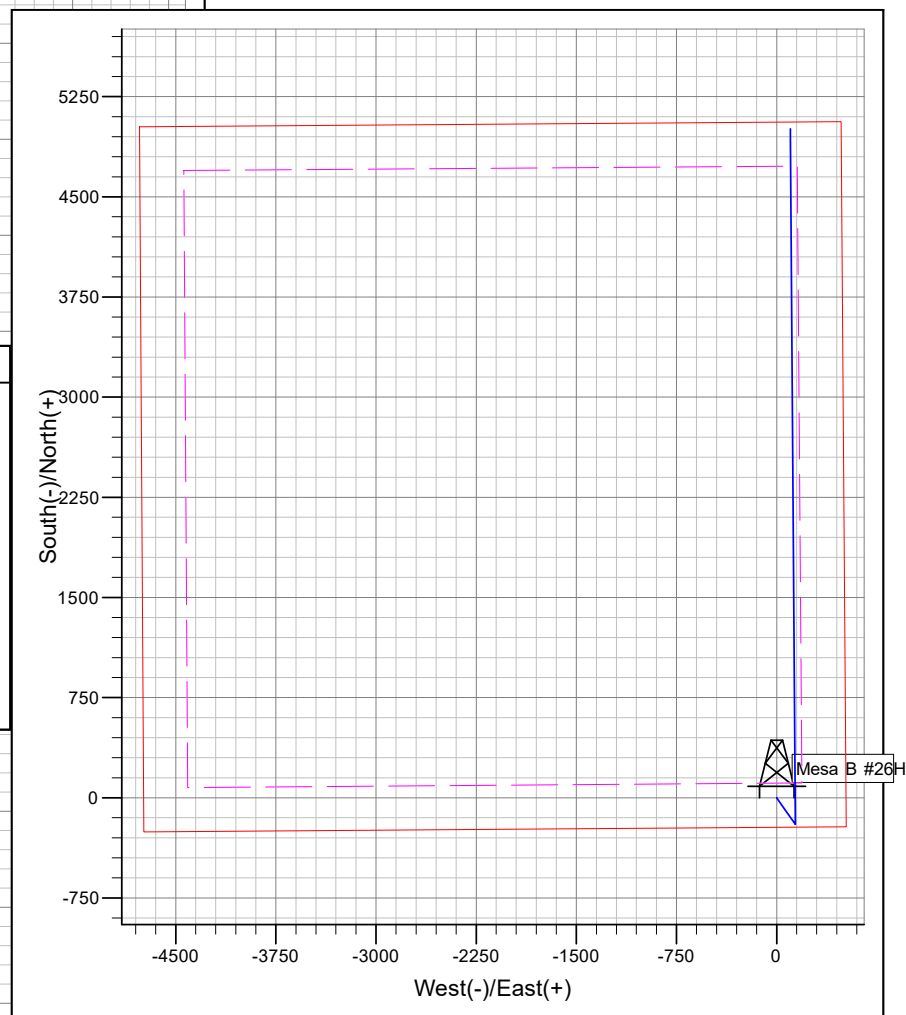
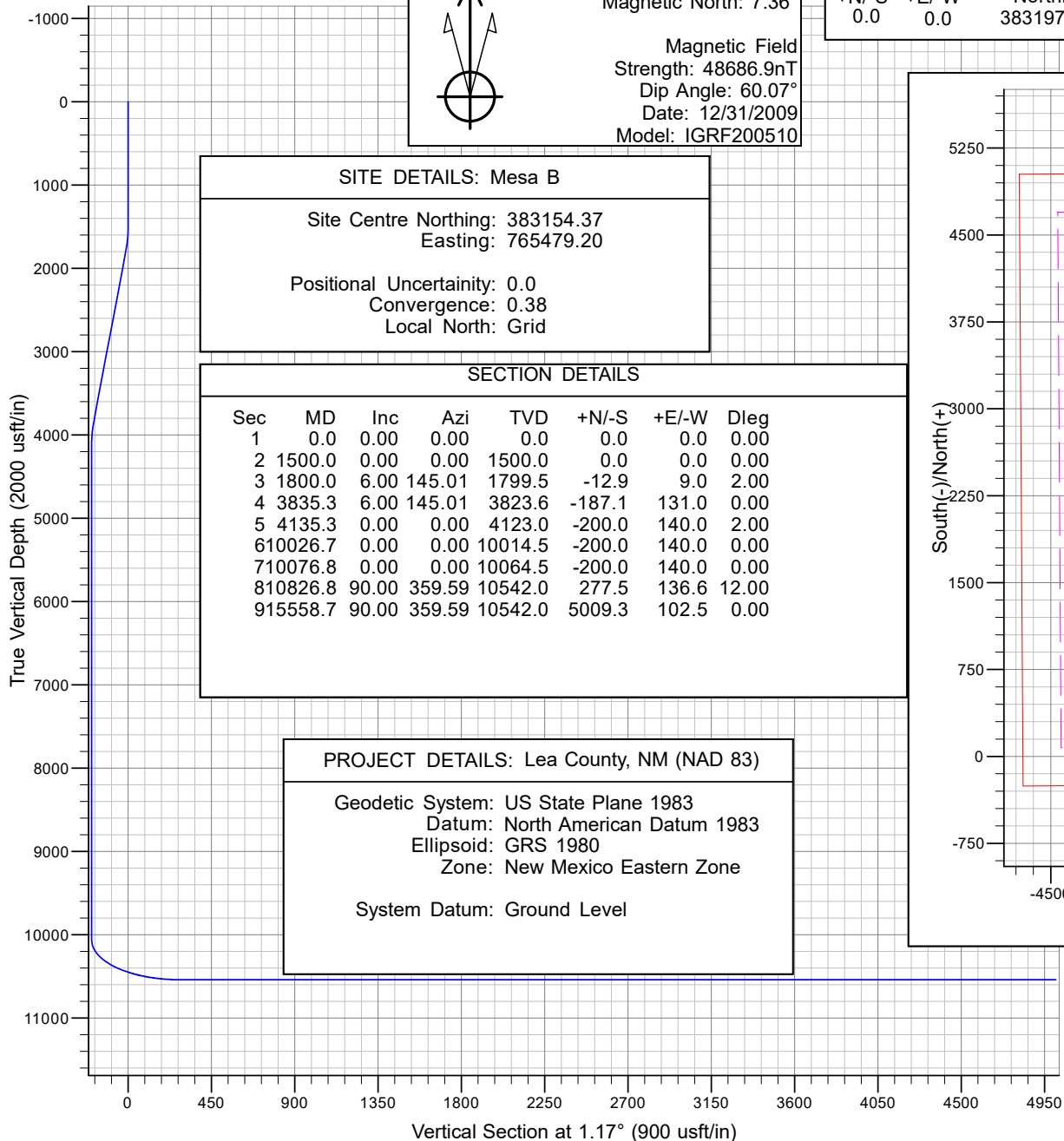

PECOS DISTRICT DRILLING CONDITIONS OF APPROVAL

OPERATOR'S NAME:	BTA Oil Producers
LEASE NO.:	NMNM160973
WELL NAME & NO.:	MESA B 8115 7 Fed Com 26H
SURFACE HOLE FOOTAGE:	220'S & 520'E
BOTTOM HOLE FOOTAGE:	50'N & 380'E
LOCATION:	Section 7, T.26 S., R.33 E., NMP
COUNTY:	Lea County, New Mexico

COA

H2S	<input type="radio"/> Yes	<input checked="" type="radio"/> No	
Potash	<input checked="" type="radio"/> None	<input type="radio"/> Secretary	<input type="radio"/> R-111-P
Cave/Karst Potential	<input type="radio"/> Low	<input checked="" type="radio"/> Medium	<input type="radio"/> High
Cave/Karst Potential	<input type="radio"/> Critical		
Variance	<input type="radio"/> None	<input checked="" type="radio"/> Flex Hose	<input type="radio"/> Other
Wellhead	<input type="radio"/> Conventional	<input checked="" type="radio"/> Multibowl	<input type="radio"/> Both
Other	<input type="checkbox"/> 4 String Area	<input type="checkbox"/> Capitan Reef	<input type="checkbox"/> WIPP
Other	<input checked="" type="checkbox"/> Fluid Filled	<input type="checkbox"/> Cement Squeeze	<input type="checkbox"/> Pilot Hole
Special Requirements	<input type="checkbox"/> Water Disposal	<input checked="" type="checkbox"/> COM	<input type="checkbox"/> Unit

A. HYDROGEN SULFIDE

Hydrogen Sulfide (H2S) monitors shall be installed prior to drilling out the surface shoe. If H2S is detected in concentrations greater than 100 ppm, the Hydrogen Sulfide area shall meet Onshore Order 6 requirements, which includes equipment and personnel/public protection items. If Hydrogen Sulfide is encountered, provide measured values and formations to the BLM.

B. CASING

Casing Design:

1. The **13-3/8** inch surface casing shall be set at approximately **890** feet (a minimum of **25 feet (Lea County)** into the Rustler Anhydrite and above the salt) and cemented to the surface.
 - a. If cement does not circulate to the surface, the appropriate BLM office shall be notified and a temperature survey utilizing an electronic type temperature survey with surface log readout will be used or a cement bond log shall be run to verify the top of the cement. Temperature survey will be run a minimum of six hours after pumping cement and ideally between 8-10 hours after

- completing the cement job.
- b. Wait on cement (WOC) time for a primary cement job will be a minimum of **8 hours** or 500 pounds compressive strength, whichever is greater. (This is to include the lead cement)
- c. Wait on cement (WOC) time for a remedial job will be a minimum of 4 hours after bringing cement to surface or 500 pounds compressive strength, whichever is greater.
- d. If cement falls back, remedial cementing will be done prior to drilling out that string.

Intermediate casing must be kept fluid filled to meet BLM minimum collapse requirement.

2. The **9-5/8** inch intermediate casing shall be set at approximately **4,742** feet. The minimum required fill of cement behind the **9-5/8** inch intermediate casing is:
 - Cement to surface. If cement does not circulate see B.1.a, c-d above. **Wait on cement (WOC) time for a primary cement job is to include the lead cement slurry due to cave/karst or potash.**
- ❖ In Medium Cave/Karst Areas if cement does not circulate to surface on the first two casing strings, the cement on the 3rd casing string must come to surface.
3. The minimum required fill of cement behind the **5-1/2** inch production casing is:
 - Cement should tie-back at least **200 feet** into previous casing string. Operator shall provide method of verification.

C. PRESSURE CONTROL

1. Variance approved to use flex line from BOP to choke manifold. Manufacturer's specification to be readily available. No external damage to flex line. Flex line to be installed as straight as possible (no hard bends).^{*}
2. Operator has proposed a multi-bowl wellhead assembly. This assembly will only be tested when installed on the surface casing. Minimum working pressure of the blowout preventer (BOP) and related equipment (BOPE) required for drilling below the surface casing shoe shall be **5000 (5M) psi**.
 - a. Wellhead shall be installed by manufacturer's representatives, submit documentation with subsequent sundry.
 - b. If the welding is performed by a third party, the manufacturer's representative shall monitor the temperature to verify that it does not exceed the maximum temperature of the seal.

- c. Manufacturer representative shall install the test plug for the initial BOP test.
- d. If the cement does not circulate and one inch operations would have been possible with a standard wellhead, the well head shall be cut off, cementing operations performed and another wellhead installed.
- e. Whenever any seal subject to test pressure is broken, all the tests in OOGO2.III.A.2.i must be followed.

D. SPECIAL REQUIREMENT (S)

Communitization Agreement

- The operator will submit a Communitization Agreement to the Carlsbad Field Office, 620 E Greene St. Carlsbad, New Mexico 88220, at least 90 days before the anticipated date of first production from a well subject to a spacing order issued by the New Mexico Oil Conservation Division. The Communitization Agreement will include the signatures of all working interest owners in all Federal and Indian leases subject to the Communitization Agreement (i.e., operating rights owners and lessees of record), or certification that the operator has obtained the written signatures of all such owners and will make those signatures available to the BLM immediately upon request.
- If the operator does not comply with this condition of approval, the BLM may take enforcement actions that include, but are not limited to, those specified in 43 CFR 3163.1.
- In addition, the well sign shall include the surface and bottom hole lease numbers. When the Communitization Agreement number is known, it shall also be on the sign.

BOP Break Testing Variance (Note: For 5M BOP or less)

- BOPE Break Testing is ONLY permitted for 5M BOPE or less.
- BOPE Break Testing is NOT permitted to drilling the production hole section.
- While in transfer between wells, the BOPE shall be secured by the hydraulic carrier or cradle.
- Any well control event while drilling require notification to the BLM Petroleum Engineer prior to the commencement of any BOPE Break Testing operations.
- A full BOPE test is required prior to drilling the first deep intermediate hole section. If any subsequent hole interval is deeper than the first, a full BOPE test will be required.
- The BLM is to be contacted (575-361-2822 Eddy County) (575-393-3612 Lea County) 4 hours prior to BOPE tests.
- As a minimum, a full BOPE test shall be performed at 21-day intervals.
- In the event any repairs or replacement of the BOPE is required, the BOPE shall test as per Onshore Oil and Gas Order No. 2.

GENERAL REQUIREMENTS

The BLM is to be notified in advance for a representative to witness:

- a. Spudding well (minimum of 24 hours)
- b. Setting and/or Cementing of all casing strings (minimum of 4 hours)
- c. BOPE tests (minimum of 4 hours)

☒ Chaves and Roosevelt Counties
Call the Roswell Field Office, 2909 West Second St., Roswell NM 88201.
During office hours call (575) 627-0272.
After office hours call (575)

☒ Eddy County
Call the Carlsbad Field Office, 620 East Greene St., Carlsbad, NM 88220,
(575) 361-2822

☒ Lea County
Call the Hobbs Field Station, 414 West Taylor, Hobbs NM 88240, (575)
393-3612

1. Unless the production casing has been run and cemented or the well has been properly plugged, the drilling rig shall not be removed from over the hole without prior approval.
 - a. In the event the operator has proposed to drill multiple wells utilizing a skid/walking rig. Operator shall secure the wellbore on the current well, after installing and testing the wellhead, by installing a blind flange of like pressure rating to the wellhead and a pressure gauge that can be monitored while drilling is performed on the other well(s).
 - b. When the operator proposes to set surface casing with Spudder Rig
 - Notify the BLM when moving in and removing the Spudder Rig.
 - Notify the BLM when moving in the 2nd Rig. Rig to be moved in within 90 days of notification that Spudder Rig has left the location.
 - BOP/BOPE test to be conducted per Onshore Oil and Gas Order No. 2 as soon as 2nd Rig is rigged up on well.
2. Floor controls are required for 3M or Greater systems. These controls will be on the rig floor, unobstructed, readily accessible to the driller and will be operational at all times during drilling and/or completion activities. Rig floor is defined as the area immediately around the rotary table; the area immediately above the substructure on which the draw works are located, this does not include the dog house or stairway area.

3. The record of the drilling rate along with the GR/N well log run from TD to surface (horizontal well – vertical portion of hole) shall be submitted to the BLM office as well as all other logs run on the borehole 30 days from completion. If available, a digital copy of the logs is to be submitted in addition to the paper copies. The Rustler top and top and bottom of Salt are to be recorded on the Completion Report.

A. CASING

1. Changes to the approved APD casing program need prior approval if the items substituted are of lesser grade or different casing size or are Non-API. The Operator can exchange the components of the proposal with that of superior strength (i.e. changing from J-55 to N-80, or from 36# to 40#). Changes to the approved cement program need prior approval if the altered cement plan has less volume or strength or if the changes are substantial (i.e. Multistage tool, ECP, etc.). The initial wellhead installed on the well will remain on the well with spools used as needed.
2. Wait on cement (WOC) for Potash Areas: After cementing but before commencing any tests, the casing string shall stand cemented under pressure until both of the following conditions have been met: 1) cement reaches a minimum compressive strength of 500 psi for all cement blends, 2) until cement has been in place at least 24 hours. WOC time will be recorded in the driller's log.
3. Wait on cement (WOC) for Water Basin: After cementing but before commencing any tests, the casing string shall stand cemented under pressure until both of the following conditions have been met: 1) cement reaches a minimum compressive strength of 500 psi at the shoe, 2) until cement has been in place at least 8 hours. WOC time will be recorded in the driller's log. See individual casing strings for details regarding lead cement slurry requirements.
4. Provide compressive strengths including hours to reach required 500 pounds compressive strength prior to cementing each casing string. Have well specific cement details onsite prior to pumping the cement for each casing string.
5. No pea gravel permitted for remedial or fall back remedial without prior authorization from the BLM engineer.
6. On that portion of any well approved for a 5M BOPE system or greater, a pressure integrity test of each casing shoe shall be performed. Formation at the shoe shall be tested to a minimum of the mud weight equivalent anticipated to control the formation pressure to the next casing depth or at total depth of the well. This test shall be performed before drilling more than 20 feet of new hole.
7. If hardband drill pipe is rotated inside casing, returns will be monitored for metal. If metal is found in samples, drill pipe will be pulled and rubber protectors which have a larger diameter than the tool joints of the drill pipe will be installed prior to continuing drilling operations.

8. Whenever a casing string is cemented in the R-111-P potash area, the NMOCD requirements shall be followed.

B. PRESSURE CONTROL

1. All blowout preventer (BOP) and related equipment (BOPE) shall comply with well control requirements as described in Onshore Oil and Gas Order No. 2 and API RP 53 Sec. 17.
2. If a variance is approved for a flexible hose to be installed from the BOP to the choke manifold, the following requirements apply: Check condition of flexible line from BOP to choke manifold, replace if exterior is damaged or if line fails test. Line to be as straight as possible with no hard bends and is to be anchored according to Manufacturer's requirements. The flexible hose can be exchanged with a hose of equal size and equal or greater pressure rating. Anchor requirements, specification sheet and hydrostatic pressure test certification matching the hose in service, to be onsite for review. These documents shall be posted in the company man's trailer and on the rig floor.
3. 5M or higher system requires an HCR valve, remote kill line and annular to match. The remote kill line is to be installed prior to testing the system and tested to stack pressure.
4. If the operator has proposed a multi-bowl wellhead assembly in the APD. The following requirements must be met:
 - a. Wellhead shall be installed by manufacturer's representatives, submit documentation with subsequent sundry.
 - b. If the welding is performed by a third party, the manufacturer's representative shall monitor the temperature to verify that it does not exceed the maximum temperature of the seal.
 - c. Manufacturer representative shall install the test plug for the initial BOP test.
 - d. Whenever any seal subject to test pressure is broken, all the tests in OOGO2.III.A.2.i must be followed.
 - e. If the cement does not circulate and one inch operations would have been possible with a standard wellhead, the well head shall be cut off, cementing operations performed and another wellhead installed.
5. The appropriate BLM office shall be notified a minimum of 4 hours in advance for a representative to witness the tests.
 - a. In a water basin, for all casing strings utilizing slips, these are to be set as soon as the crew and rig are ready and any fallback cement remediation has been done. The casing cut-off and BOP installation can be initiated four hours after installing the slips, which will be approximately six hours after bumping the

plug. For those casing strings not using slips, the minimum wait time before cut-off is eight hours after bumping the plug. BOP/BOPE testing can begin after cut-off or once cement reaches 500 psi compressive strength (including lead when specified), whichever is greater. However, if the float does not hold, cut-off cannot be initiated until cement reaches 500 psi compressive strength (including lead when specified).

- b. In potash areas, for all casing strings utilizing slips, these are to be set as soon as the crew and rig are ready and any fallback cement remediation has been done. For all casing strings, casing cut-off and BOP installation can be initiated at twelve hours after bumping the plug. However, **no tests** shall commence until the cement has had a minimum of 24 hours setup time.
- c. The tests shall be done by an independent service company utilizing a test plug not a cup or J-packer. The operator also has the option of utilizing an independent tester to test without a plug (i.e. against the casing) pursuant to Onshore Order 2 with the pressure not to exceed 70% of the burst rating for the casing. Any test against the casing must meet the WOC time for water basin (8 hours) or potash (24 hours) or 500 pounds compressive strength, whichever is greater, prior to initiating the test (see casing segment as lead cement may be critical item).
- d. The test shall be run on a 5000 psi chart for a 2-3M BOP/BOP, on a 10000 psi chart for a 5M BOP/BOPE and on a 15000 psi chart for a 10M BOP/BOPE. If a linear chart is used, it shall be a one hour chart. A circular chart shall have a maximum 2 hour clock. If a twelve hour or twenty-four hour chart is used, tester shall make a notation that it is run with a two hour clock.
- e. The results of the test shall be reported to the appropriate BLM office.
- f. All tests are required to be recorded on a calibrated test chart. A copy of the BOP/BOPE test chart and a copy of independent service company test will be submitted to the appropriate BLM office.
- g. The BOP/BOPE test shall include a low pressure test from 250 to 300 psi. The test will be held for a minimum of 10 minutes if test is done with a test plug and 30 minutes without a test plug. This test shall be performed prior to the test at full stack pressure.
- h. BOP/BOPE must be tested by an independent service company within 500 feet of the top of the Wolfcamp formation if the time between the setting of the intermediate casing and reaching this depth exceeds 20 days. This test does not exclude the test prior to drilling out the casing shoe as per Onshore Order No. 2.

C. DRILLING MUD

Mud system monitoring equipment, with derrick floor indicators and visual and audio alarms, shall be operating before drilling into the Wolfcamp formation, and shall be used until production casing is run and cemented.

D. WASTE MATERIAL AND FLUIDS

All waste (i.e. drilling fluids, trash, salts, chemicals, sewage, gray water, etc.) created as a result of drilling operations and completion operations shall be safely contained and disposed of properly at a waste disposal facility. No waste material or fluid shall be disposed of on the well location or surrounding area.

Porto-johns and trash containers will be on-location during fracturing operations or any other crew-intensive operations.

OTA08192021



Multi-Bowl System

13-3/8" X 9-5/8" X 5-1/2"

Tubing Head-TCM-PP

13-5/8"- M X 7-1/16"- M
w/(2) 1-13/16"- M Gate Valves

7-1/16- M

Casing Spool- MBS

13-5/8"-5M X 13-5/8"- M
w/(2) 1-13/16"- M SSO

13-5/8"- M

7" Dbl P Seal

13-5/8" X 7" C-22
Casing Hanger

Casing Head- MBS

13-5/8"-5M X 13-3/8" SOW
w/36" Base Plate

13-5/8"-5M

13-5/8" X 9-5/8" MBS
Packoff Assembly

13-5/8" X 9-5/8" Mandrel
Casing Hanger

13-3/8" SOW



SYENERGY
WELLHEAD & FRAC

District I

1625 N. French Dr., Hobbs, NM 88240
 Phone:(575) 393-6161 Fax:(575) 393-0720

District II

811 S. First St., Artesia, NM 88210
 Phone:(575) 748-1283 Fax:(575) 748-9720

District III

1000 Rio Brazos Rd., Aztec, NM 87410
 Phone:(505) 334-6178 Fax:(505) 334-6170

District IV

1220 S. St Francis Dr., Santa Fe, NM 87505
 Phone:(505) 476-3470 Fax:(505) 476-3462

State of New Mexico
Energy, Minerals and Natural Resources
Oil Conservation Division
1220 S. St Francis Dr.
Santa Fe, NM 87505

CONDITIONS

Action 107173

CONDITIONS

Operator: BTA OIL PRODUCERS, LLC 104 S Pecos Midland, TX 79701	OGRID:
	260297
	Action Number:
	107173
Action Type:	
[C-101] BLM - Federal/Indian Land Lease (Form 3160-3)	

CONDITIONS

Created By	Condition	Condition Date
pkautz	Will require a File As Drilled C-102 and a Directional Survey with the C-104	6/1/2022
pkautz	Once the well is spud, to prevent ground water contamination through whole or partial conduits from the surface, the operator shall drill without interruption through the fresh water zone or zones and shall immediately set in cement the water protection string	6/1/2022
pkautz	Oil base muds are not to be used until fresh water zones are cased and cemented providing isolation from the oil or diesel. This includes synthetic oils. Oil based mud, drilling fluids and solids must be contained in a steel closed loop system	6/1/2022
pkautz	Cement is required to circulate on both surface and intermediate1 strings of casing	6/1/2022