

Form 3160-5  
(June 2015)UNITED STATES  
DEPARTMENT OF THE INTERIOR  
BUREAU OF LAND MANAGEMENTFORM APPROVED  
OMB No. 1004-0137  
Expires: January 31, 2018**SUNDRY NOTICES AND REPORTS ON WELLS**  
**Do not use this form for proposals to drill or to re-enter an abandoned well. Use Form 3160-3 (APD) for such proposals.**

5. Lease Serial No. NM-28489

6. If Indian, Allottee or Tribe Name

**SUBMIT IN TRIPLICATE - Other instructions on page 2**

7. If Unit of CA/Agreement, Name and/or No.

1. Type of Well

☐ Oil Well ☒ Gas Well ☐ Other

8. Well Name and No. Trout Well Federal #001

2. Name of Operator Jack J. Grynberg

9. API Well No. 30-005-61578

3a. Address 3773 Cherry Creek N. Dr., Denver, CO 80202

3b. Phone No. (include area code)

10. Field and Pool or Exploratory Area  
Pecos Slope, Abo4. Location of Well (Footage, Sec., T., R., M., or Survey Description)  
Sec 29 T5S R24E11. Country or Parish, State  
Chaves, New Mexico

12. CHECK THE APPROPRIATE BOX(ES) TO INDICATE NATURE OF NOTICE, REPORT OR OTHER DATA

TYPE OF SUBMISSION	TYPE OF ACTION			
<input type="checkbox"/> Notice of Intent	<input type="checkbox"/> Acidize	<input type="checkbox"/> Deepen	<input type="checkbox"/> Production (Start/Resume)	<input type="checkbox"/> Water Shut-Off
<input type="checkbox"/> Subsequent Report	<input type="checkbox"/> Alter Casing	<input type="checkbox"/> Hydraulic Fracturing	<input type="checkbox"/> Reclamation	<input type="checkbox"/> Well Integrity
<input type="checkbox"/> Final Abandonment Notice	<input type="checkbox"/> Casing Repair	<input type="checkbox"/> New Construction	<input type="checkbox"/> Recomplete	<input type="checkbox"/> Other
	<input type="checkbox"/> Change Plans	<input checked="" type="checkbox"/> Plug and Abandon	<input type="checkbox"/> Temporarily Abandon	
	<input type="checkbox"/> Convert to Injection	<input type="checkbox"/> Plug Back	<input type="checkbox"/> Water Disposal	

13. Describe Proposed or Completed Operation: Clearly state all pertinent details, including estimated starting date of any proposed work and approximate duration thereof. If the proposal is to deepen directionally or recompleat horizontally, give subsurface locations and measured and true vertical depths of all pertinent markers and zones. Attach the Bond under which the work will be performed or provide the Bond No. on file with BLM/BIA. Required subsequent reports must be filed within 30 days following completion of the involved operations. If the operation results in a multiple completion or recompleat in a new interval, a Form 3160-4 must be filed once testing has been completed. Final Abandonment Notices must be filed only after all requirements, including reclamation, have been completed and the operator has determined that the site is ready for final inspection.)

Request for permission to P&A well.  
See attached procedure for details.

See Conditions of Approval

14. I hereby certify that the foregoing is true and correct. Name (Printed/Typed)

Adam Pfeifer

Consultant Production Engineer

Title

Signature

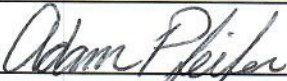

Date

8-13-2022

08/13/2022

Accepted for record - NMOCD gc 8/22/2022

**THE SPACE FOR FEDERAL OR STATE OFFICE USE**

Approved by

Title Petroleum Engineer

Date 08/15/2022

Conditions of approval, if any, are attached. Approval of this notice does not warrant or certify that the applicant holds legal or equitable title to those rights in the subject lease which would entitle the applicant to conduct operations thereon.

Office RFO

Title 18 U.S.C Section 1001 and Title 43 U.S.C Section 1212, make it a crime for any person knowingly and willfully to make to any department or agency of the United States any false, fictitious or fraudulent statements or representations as to any matter within its jurisdiction.

(Instructions on page 2)

**WELL NAME:** Trout Well Federal #001**API #:** 30-005-61578**AFE:****DATE:** 7/21/2022**ENGINEER:** Adam Pfeifer**PROCEDURE:** Plug and Abandon**CURRENT OPERATION:**

This well is a currently active gas well. Due to economics this well has been selected to be plugged and abandoned.

**WELL SUMMARY:**

Formation Tops:

- Oil or Gas Sands or Zones:
  - Abo: 3,664'
- Important Water Sands:
  - San Andres: 580'
  - Glorieta: 1,450'

Perforation Depths:

- 3,664' – 3,670' (1 shot/ft)
- 3,713' – 3,719' (1 shot/ft)
- 3,910' – 3,921' (1 shot/ft)

Current Tubular Data:

Tubular Data	Size (in)	Weight (lb/ft)	ID (in)	Depth Set (ft)	Hole Size (in)	Cement # Sacks
Surface	10.785	32.750	10.050	865	14.785	400
Intermediate	0.000	0.000	0.000	0	0.000	0
Production	4.500	10.500	4.052	4152	7.875	1460
Tubing	2.375	4.700	1.995	3810	NA	

**REQUIRED NMOCD SUBMISSIONS:**

Form C-103 – Notice of Intent to P&amp;A

Form C-105 – Well Completion or Recompletion Report and Log (P&amp;A Details)

**GADECO CONTACTS:**Adam Pfeifer – Project Manager, Cell: 785-216-0160, [adam.pfeifer28@gmail.com](mailto:adam.pfeifer28@gmail.com)**EMERGENCY CONTACTS:**Hospital: Lovelace Regional Hospital, 117E 19<sup>th</sup> St, Roswell, NM 88201, (575) 627-7000

Fire: Roswell Fire Department Station #3, 2800 Wilshire Blvd, Roswell, NM 88201, (575) 624-6813

Sheriff: Chaves County Sheriff's Office, 1 St Mary's Pl, Roswell, NM 88203, (575) 624-6500

**VENDOR CONTACTS: TBD****HS&E:**

This workover does not introduce any new equipment, materials, or process hazards.

**PROCEDURE:**

- 1) MIRU cement equipment. **Note that all cement calculations for required sacks of cement already account for the required 100% excess in open hole cement plugs and 50' excess in cased hole cement plugs.**
- 2) Plug #1 – Isolate the producing perforations at 3,664'.
  - a. MU CIBP.
  - b. TIH and set CIBP at 3,639' (25' above perforations at 3,664').
  - c. Mix 10 sacks of Class C cement (100' of cement) and spot on top of CIBP.
  - d. TOH 4 stands of tubing. WOC.
  - e. TIH and tag TOC. Record depth.
  - f. Circulate hole clean. Pressure test CIBP to 500 psi for 15 minutes.
  - g. TOH w/ work string standing back 2,500' in the derrick and laying down the rest.
- 3) MIRU wireline. RIH with WL and perform CBL from 3,350' to surface.
- 4) With WL still rigged up, perforate the 4-1/2" casing with 4 shots at the following plugging depths:
  - a. Plug #2: Perforate at 2,500' (this will shift after the CBL is ran).
  - b. Plug #3: Perforate at 1,500'.
  - c. Plug #4: Perforate at 915'.
  - d. Plug #5: Perforate at 60'.
- 5) Plug #2 – Isolate 100' above 4-1/2" casing TOC.
  - a. Assuming 4-1/2" casing TOC is at 2,600' (Caliper log shows hole much larger than 7-7/8").
  - b. MU CICR. TIH and set at 2,400'.
  - c. Mix 47 sacks of Class C cement. Displace 45 sacks of cement through CICR down to perforations and up the 4-1/2" casing annulus. This will cover the required 100' inside and 100' outside of the 4-1/2" casing.
  - d. Sting out of CICR and spot the remaining 2 sacks of cement on top of CICR.
  - e. TOH and LD tubing to 1,400' and then stand back the remaining work string in the derrick.
- 6) Plug #3 – Isolate the Glorieta formation w/ 100' plug across the formation top at 1,450'.
  - a. MU CICR to work string and TIH.
  - b. Set CICR at 1,400'.
  - c. Mix 47 sacks of Class C cement. Displace 45 sacks of cement through CICR down to perforations and up the 4-1/2" casing annulus. This will cover the required 100' inside and 100' outside of the 4-1/2" casing.
  - d. Sting out of CICR and spot the remaining 2 sacks of cement on top of CICR.
  - e. TOH and LD tubing to 1,000' and then stand back the remaining work string in the derrick.
- 7) Plug #4 – Surface casing shoe isolation.
  - a. MU CICR to work string and TIH.
  - b. Set CICR at 815'.
  - c. Mix 64 sacks of Class C Cement. Displace 62 sacks of cement through the CICR down through the perforations and up the 10-3/4" x 4-1/2" annulus. This will cover the required 100' inside and outside of the 4-1/2" casing.
  - d. Sting out of CICR and spot the remaining 2 sacks of cement on top of CICR.
  - e. TOH and LD work string.
- 8) Plug #5 – Plug to surface.
  - a. MU CIBP to work string and TIH.

- b. Set CIBP at 65’.
  - c. TOH and LD work string.
  - d. Mix and pump +/- 24 sacks Class C cement down the 10-1/2” x 4-1/2” annulus through the perforations and circulate cement to surface filling both the annulus and production casing with cement.
  - e. Shut well in and WOC. RDMO pulling unit and cement equipment.
- 9) Cut off the wellhead at least 4’ below surface. Verify cement in annulus and production casing. Take pictures for documentation.
- a. For below marker, the top of the casing must be fitted with a screw cap or steel plate welded in place with a weep hole.
  - b. The marker must have a marker that is inscribed with well’s legal locations, well name, number, and API number and take pictures for documentation.
- 10) Once well is plugged and abandoned, remove all surface processing and storage equipment.
- 11) Conduct pad reclamation per NMOCD. See separate procedure.

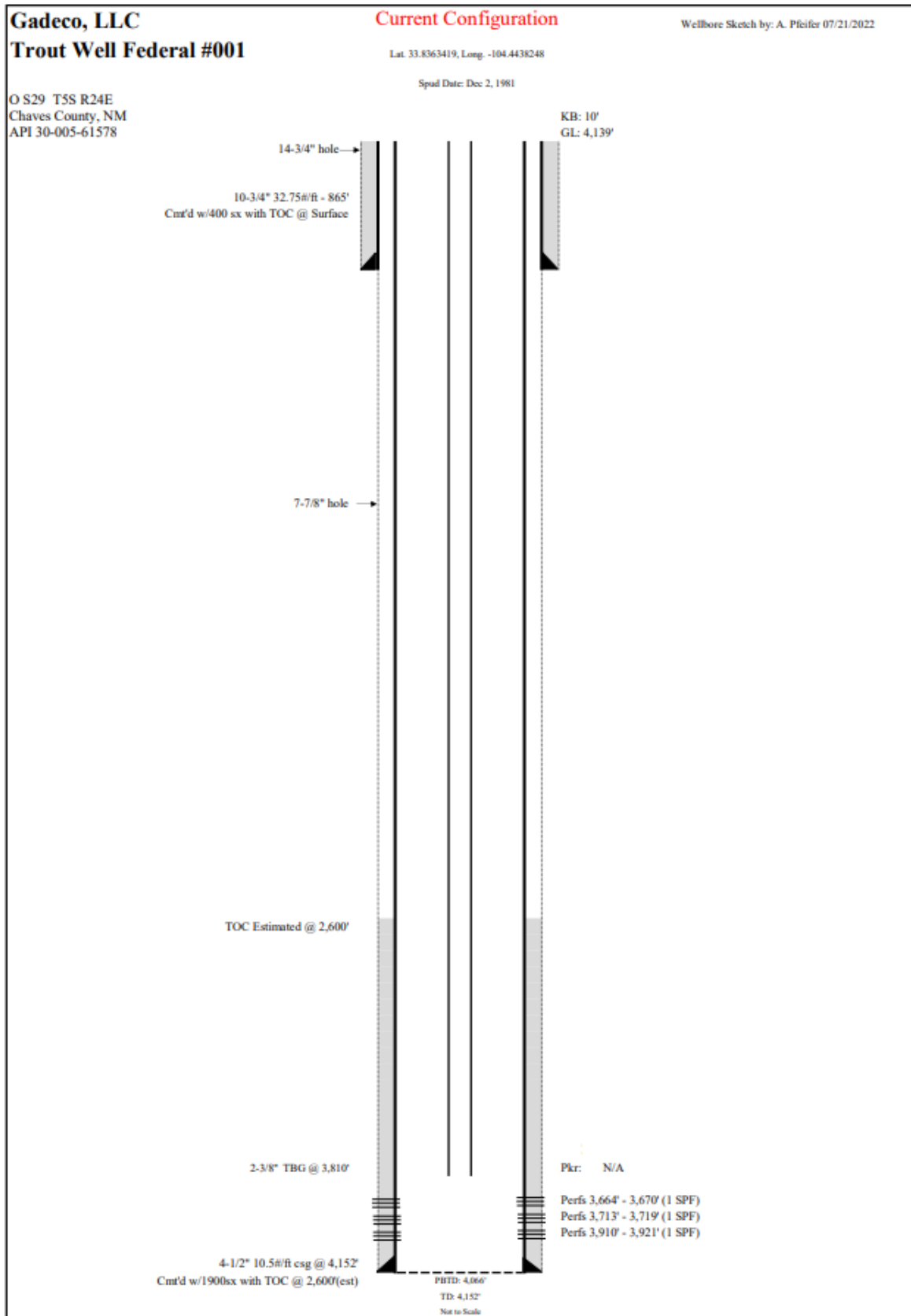
**CURRENT DOWNHOLE CONFIGURATION:**

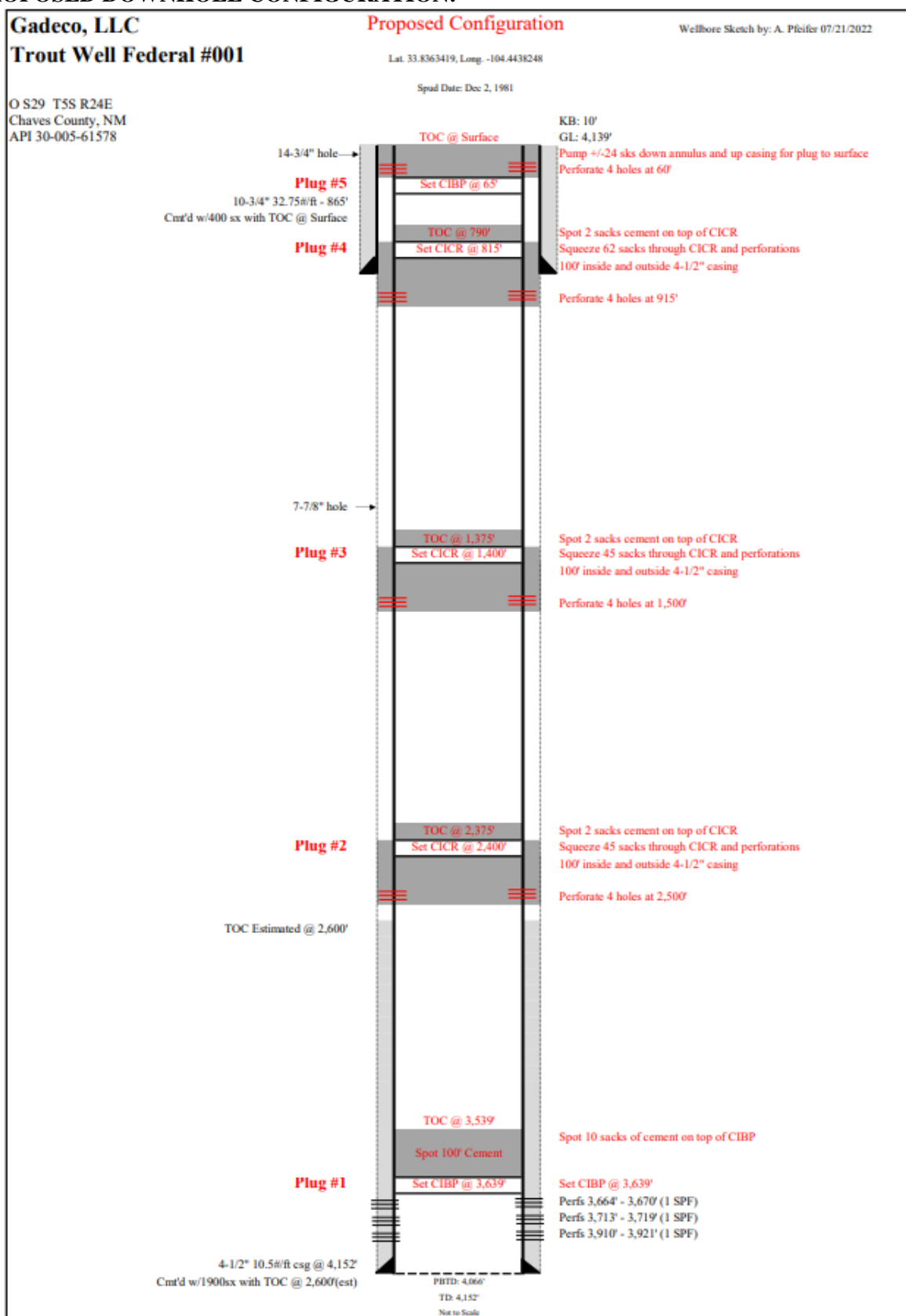
**PROPOSED DOWNHOLE CONFIGURATION:**

Gadeco, LLC

Current Configuration

Wellbore Sketch by: A. Pfeifer 07/21/2022

Trout Well Federal #001

Lat. 33.8363419, Long. -104.4438248

Spud Date: Dec 2, 1981

O S29 T5S R24E  
Chaves County, NM  
API 30-005-61578

KB: 10'  
GL: 4,139'

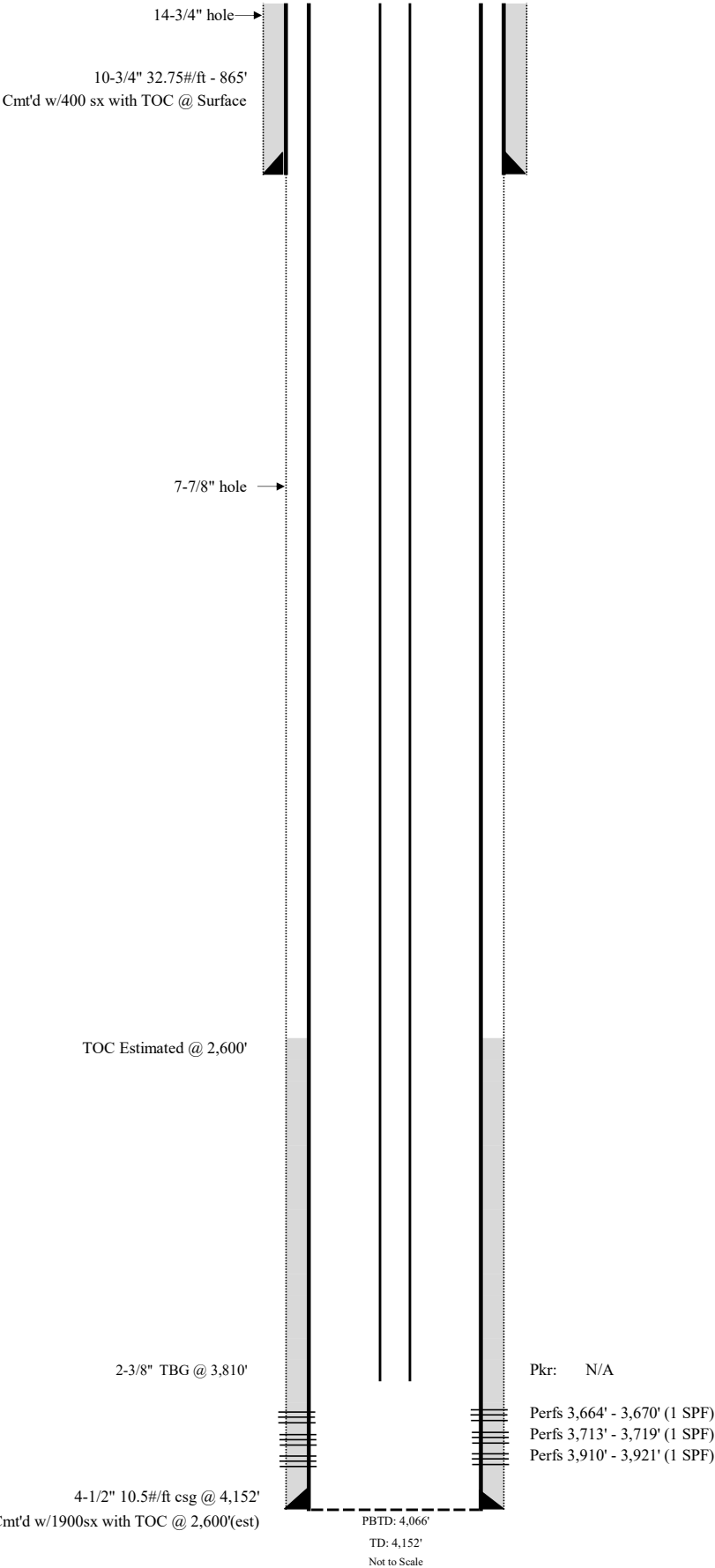

## Wellbore Sketch by: A. Pfeifer 07/21/2022

Lat. 33.8363419, Long. -104.4438248

Spud Date: Dec 2, 1981

KB: 10'  
GL: 4,139'



**Trout Well Federal 1  
30-005-61578  
Grynberg Petroleum Company  
August 15, 2022  
Conditions of Approval**

- 1. Operator shall place CIBP at 3,614' (50'-100' above top most perf) and places 25 sx of Class C cement on top. WOC and TAG.**
- 2. Operator shall perf at 2,500' and squeeze class C Cement to 2,375' as proposed. WOC and TAG.**
- 3. Operator shall perf at 1,500' and squeeze class C Cement to 1,385' to seal the Glorietta Formation. WOC and TAG.**
- 4. Operator shall perf at 915' and squeeze class C Cement to 815' to seal the 10-3/4" casing shoe. WOC and TAG.**
- 5. Operator shall perf at 60' and squeeze class C Cement to surface as proposed.**
- 6. Surface reclamation will need to be completed once the well bore has been plugged. Please contact [rflores@blm.gov](mailto:rflores@blm.gov) for additional information.**
- 7. See Attached for general plugging stipulations.**

**JAM 08152022**

**District I**  
1625 N. French Dr., Hobbs, NM 88240  
Phone:(575) 393-6161 Fax:(575) 393-0720  
**District II**  
811 S. First St., Artesia, NM 88210  
Phone:(575) 748-1283 Fax:(575) 748-9720  
**District III**  
1000 Rio Brazos Rd., Aztec, NM 87410  
Phone:(505) 334-6178 Fax:(505) 334-6170  
**District IV**  
1220 S. St Francis Dr., Santa Fe, NM 87505  
Phone:(505) 476-3470 Fax:(505) 476-3462

State of New Mexico  
Energy, Minerals and Natural Resources  
Oil Conservation Division  
1220 S. St Francis Dr.  
Santa Fe, NM 87505

CONDITIONS  
  
Action 134252

CONDITIONS

Operator:  JACK J. GRYNBERG C/O 3773 Cherry Creek N. Drive Denver, CO 80202	OGRID:  11492
	Action Number:  134252
	Action Type:  [C-103] NOI Plug & Abandon (C-103F)

CONDITIONS

Created By	Condition	Condition Date
gcordero	None	8/22/2022