

Well Name: POKER LAKE UNIT 30-19 BS	Well Location: T25S / R31E / SEC 30 / NENW /	County or Parish/State:
Well Number: 121H	Type of Well: CONVENTIONAL GAS WELL	Allottee or Tribe Name:
Lease Number: NMLC061634B	Unit or CA Name:	Unit or CA Number: NMNM71016X
US Well Number: 3001553540	Well Status: Approved Application for Permit to Drill	Operator: XTO PERMIAN OPERATING LLC

Notice of Intent

Sundry ID: 2756690

Type of Submission: Notice of Intent Type of Action: APD Change

Date Sundry Submitted: 10/17/2023 Time Sundry Submitted: 03:16

Date proposed operation will begin: 11/09/2023

Procedure Description: ** Surface hole Change, First and Last Take Point Changes, Bottomhole Location Change, Drilling Plan Change, Casing/Cement Change XTO Permian Operating, LCC. requests permission to make the following changes to the original APD: No Additional Surface Disturbance SHL: fr/824'FNL & 1516'FWL to 781'FNL & 1663'FWL, NMLC061634B FTP: fr/2310'FNL & 330'FWL to 2115'FNL & 330'FWL, NMLC061634B LTP: fr/100'FNL & 330'FWL to 2489'FSL & 330'FWL, NMLC063079A BHL: fr/50'FNL & 330'FWL to 2588'FSL & 330'FWL, Section 18-T25S-R31E NMLC063079A Additionally, XTO Permian Operating, LLC. respectfully requests permission to upsize the casing design. The surface, intermediate and production hole, casing, and cement based on the attached drilling program. Due to the design change in these strings, the wellhead configuration has also changed based on the attached drilling program. Casing/Cement design per the attached drilling program. Attachments: C102 Drilling Program MBS Directional Plan

NOI Attachments

Procedure Description

PLU_30_19_BS_121H_Sundry_Attachments_20231017151645.pdf

Well Name: POKER LAKE UNIT 30-19 BS	Well Location: T25S / R31E / SEC 30 / NENW /	County or Parish/State:
Well Number: 121H	Type of Well: CONVENTIONAL GAS WELL	Allottee or Tribe Name:
Lease Number: NMLC061634B	Unit or CA Name:	Unit or CA Number: NMNM71016X
US Well Number: 3001553540	Well Status: Approved Application for Permit to Drill	Operator: XTO PERMIAN OPERATING LLC

Conditions of Approval

Additional

PLU_30_19_BS_122H___102H_and_121H_COA_20231122101300.pdf

Operator

I certify that the foregoing is true and correct. Title 18 U.S.C. Section 1001 and Title 43 U.S.C. Section 1212, make it a crime for any person knowingly and willfully to make to any department or agency of the United States any false, fictitious or fraudulent statements or representations as to any matter within its jurisdiction. Electronic submission of Sundry Notices through this system satisfies regulations requiring a

Operator Electronic Signature: CASSIE EVANS	Signed on: OCT 19, 2023 07:29 AM
Name: XTO PERMIAN OPERATING LLC	
Title: Regulatory Analyst	
Street Address: 6401 Holiday Hill Road, Bldg 5	
City: Midland	State: TX
Phone: (432) 218-3671	
Email address: CASSIE.EVANS@EXXONMOBIL.COM	

Field

Representative Name:		
Street Address:		
City:	State:	Zip:
Phone:		
Email address:		

BLM Point of Contact

BLM POC Name: CHRISTOPHER WALLS	BLM POC Title: Petroleum Engineer
BLM POC Phone: 5752342234	BLM POC Email Address: cwalls@blm.gov
Disposition: Approved	Disposition Date: 11/22/2023
Signature: Chris Walls	

Form 3160-5
(June 2019)UNITED STATES
DEPARTMENT OF THE INTERIOR
BUREAU OF LAND MANAGEMENTFORM APPROVED
OMB No. 1004-0137
Expires: October 31, 2021**SUNDRY NOTICES AND REPORTS ON WELLS**
Do not use this form for proposals to drill or to re-enter an abandoned well. Use Form 3160-3 (APD) for such proposals.5. Lease Serial No. **NMLC061634B**

6. If Indian, Allottee or Tribe Name

SUBMIT IN TRIPLICATE - Other instructions on page 2

1. Type of Well

☐ Oil Well ☒ Gas Well ☐ Other2. Name of Operator **XTO PERMIAN OPERATING LLC**3a. Address **6401 HOLIDAY HILL ROAD BLDG 5, MIDLAND,** 3b. Phone No. (include area code)
(432) 683-22774. Location of Well (Footage, Sec., T., R., M., or Survey Description)
SEC 30/T25S/R31E/NMP7. If Unit of CA/Agreement, Name and/or No.
NMNM71016X8. Well Name and No. **POKER LAKE UNIT 30-19 BS/121H**9. API Well No. **3001553540**10. Field and Pool or Exploratory Area
PURPLE SAGE/BONE SPRING11. Country or Parish, State
EDDY/NM**12. CHECK THE APPROPRIATE BOX(ES) TO INDICATE NATURE OF NOTICE, REPORT OR OTHER DATA**

TYPE OF SUBMISSION	TYPE OF ACTION				
<input checked="" type="checkbox"/> Notice of Intent	<input type="checkbox"/> Acidize	<input type="checkbox"/> Deepen	<input type="checkbox"/> Production (Start/Resume)	<input type="checkbox"/> Water Shut-Off	
<input type="checkbox"/> Subsequent Report	<input type="checkbox"/> Alter Casing	<input type="checkbox"/> Hydraulic Fracturing	<input type="checkbox"/> Reclamation	<input type="checkbox"/> Well Integrity	
<input type="checkbox"/> Final Abandonment Notice	<input type="checkbox"/> Casing Repair	<input type="checkbox"/> New Construction	<input type="checkbox"/> Recomplete	<input type="checkbox"/> Other	
	<input checked="" type="checkbox"/> Change Plans	<input type="checkbox"/> Plug and Abandon	<input type="checkbox"/> Temporarily Abandon		
	<input type="checkbox"/> Convert to Injection	<input type="checkbox"/> Plug Back	<input type="checkbox"/> Water Disposal		

13. Describe Proposed or Completed Operation: Clearly state all pertinent details, including estimated starting date of any proposed work and approximate duration thereof. If the proposal is to deepen directionally or recompleat horizontally, give subsurface locations and measured and true vertical depths of all pertinent markers and zones. Attach the Bond under which the work will be performed or provide the Bond No. on file with BLM/BIA. Required subsequent reports must be filed within 30 days following completion of the involved operations. If the operation results in a multiple completion or recompleat in a new interval, a Form 3160-4 must be filed once testing has been completed. Final Abandonment Notices must be filed only after all requirements, including reclamation, have been completed and the operator has detennined that the site is ready for final inspection.)

**** Surface hole Change, First and Last Take Point Changes, Bottomhole Location Change, Drilling Plan Change, Casing/Cement Change**

XTO Permian Operating, LCC. requests permission to make the following changes to the original APD:

No Additional Surface Disturbance

SHL: fr/824FNL & 1516FWL to 781FNL & 1663FWL, NMLC061634B

FTP: fr/2310FNL & 330FWL to 2115FNL & 330FWL, NMLC061634B

LTP: fr/100FNL & 330FWL to 2489FSL & 330FWL, NMLC063079A

Continued on page 3 additional information

14. I hereby certify that the foregoing is true and correct. Name (Printed/Typed) CASSIE EVANS / Ph: (432) 218-3671	Title Regulatory Analyst
Signature (Electronic Submission)	Date 10/19/2023

THE SPACE FOR FEDERAL OR STATE OFFICE USE

Approved by CHRISTOPHER WALLS / Ph: (575) 234-2234 / Approved	Title Petroleum Engineer	Date 11/22/2023
Conditions of approval, if any, are attached. Approval of this notice does not warrant or certify that the applicant holds legal or equitable title to those rights in the subject lease which would entitle the applicant to conduct operations thereon.	Office CARLSBAD	

Title 18 U.S.C Section 1001 and Title 43 U.S.C Section 1212, make it a crime for any person knowingly and willfully to make to any department or agency of the United States any false, fictitious or fraudulent statements or representations as to any matter within its jurisdiction.

(Instructions on page 2)

GENERAL INSTRUCTIONS

This form is designed for submitting proposals to perform certain well operations and reports of such operations when completed as indicated on Federal and Indian lands pursuant to applicable Federal law and regulations. Any necessary special instructions concerning the use of this form and the number of copies to be submitted, particularly with regard to local area or regional procedures and practices, are either shown below, will be issued by or may be obtained from the local Federal office.

SPECIFIC INSTRUCTIONS

Item 4 - Locations on Federal or Indian land should be described in accordance with Federal requirements. Consult the local Federal office for specific instructions.

Item 13: Proposals to abandon a well and subsequent reports of abandonment should include such special information as is required by the local Federal office. In addition, such proposals and reports should include reasons for the abandonment; data on any former or present productive zones or other zones with present significant fluid contents not sealed off by cement or otherwise; depths (top and bottom) and method of placement of cement plugs; mud or other material placed below, between and above plugs; amount, size, method of parting of any casing, liner or tubing pulled and the depth to the top of any tubing left in the hole; method of closing top of well and date well site conditioned for final inspection looking for approval of the abandonment. If the proposal will involve **hydraulic fracturing operations**, you must comply with 43 CFR 3162.3-3, including providing information about the protection of usable water. Operators should provide the best available information about all formations containing water and their depths. This information could include data and interpretation of resistivity logs run on nearby wells. Information may also be obtained from state or tribal regulatory agencies and from local BLM offices.

NOTICES

The privacy Act of 1974 and the regulation in 43 CFR 2.48(d) provide that you be furnished the following information in connection with information required by this application.

AUTHORITY: 30 U.S.C. 181 et seq., 351 et seq., 25 U.S.C. 396; 43 CFR 3160.

PRINCIPAL PURPOSE: The information is used to: (1) Evaluate, when appropriate, approve applications, and report completion of subsequent well operations, on a Federal or Indian lease; and (2) document for administrative use, information for the management, disposal and use of National Resource lands and resources, such as: (a) evaluating the equipment and procedures to be used during a proposed subsequent well operation and reviewing the completed well operations for compliance with the approved plan; (b) requesting and granting approval to perform those actions covered by 43 CFR 3162.3-2, 3162.3-3, and 3162.3-4; (c) reporting the beginning or resumption of production, as required by 43 CFR 3162.4-1(c) and (d) analyzing future applications to drill or modify operations in light of data obtained and methods used.

ROUTINE USES: Information from the record and/or the record will be transferred to appropriate Federal, State, local or foreign agencies, when relevant to civil, criminal or regulatory investigations or prosecutions in connection with congressional inquiries or to consumer reporting agencies to facilitate collection of debts owed the Government.

EFFECT OF NOT PROVIDING THE INFORMATION: Filing of this notice and report and disclosure of the information is mandatory for those subsequent well operations specified in 43 CFR 3162.3-2, 3162.3-3, 3162.3-4.

The Paperwork Reduction Act of 1995 requires us to inform you that:

The BLM collects this information to evaluate proposed and/or completed subsequent well operations on Federal or Indian oil and gas leases.

Response to this request is mandatory.

The BLM would like you to know that you do not have to respond to this or any other Federal agency-sponsored information collection unless it displays a currently valid OMB control number.

BURDEN HOURS STATEMENT: Public reporting burden for this form is estimated to average 8 hours per response, including the time for reviewing instructions, gathering and maintaining data, and completing and reviewing the form. Direct comments regarding the burden estimate or any other aspect of this form to U.S. Department of the Interior, Bureau of Land Management (1004-0137), Bureau Information Collection Clearance Officer (WO-630), 1849 C St., N.W., Mail Stop 401 LS, Washington, D.C. 20240

Additional Information

Additional Remarks

BHL: fr/50FNL & 330FWL to 2588FSL & 330FWL, Section 18-T25S-R31E NMLC063079A

Additionally, XTO Permian Operating, LLC. respectfully requests permission to upsize the casing design. The surface, intermediate and production hole, casing, and cement based on the attached drilling program. Due to the design change in these strings, the wellhead configuration has also changed based on the attached drilling program.

Casing/Cement design per the attached drilling program.

Attachments:

C102

Drilling Program

MBS

Directional Plan

Location of Well

0. SHL: NENW / 824 FNL / 1516 FWL / TWSP: 25S / RANGE: 31E / SECTION: 30 / LAT: 32.106263 / LONG: -103.821133 (TVD: 0 feet, MD: 0 feet)

PPP: LOT 2 / 2310 FNL / 330 FWL / TWSP: 25S / RANGE: 31E / SECTION: 30 / LAT: 32.102172 / LONG: -103.824955 (TVD: 11064 feet, MD: 11365 feet)

BHL: LOT 1 / 50 FNL / 330 FWL / TWSP: 25S / RANGE: 31E / SECTION: 19 / LAT: 32.122998 / LONG: -103.82489 (TVD: 11763 feet, MD: 19973 feet)

PECOS DISTRICT DRILLING CONDITIONS OF APPROVAL

OPERATOR'S NAME:	XTO
LEASE NO.:	NMLC061634B
LOCATION:	Section 30, T.25 S, R.31 E., NMPM
COUNTY:	Eddy County, New Mexico
WELL NAME & NO.:	Poker Lake Unit 30-19 BS 122H
SURFACE HOLE FOOTAGE:	808'/N & 1677'/W
BOTTOM HOLE FOOTAGE:	2592'/S & 660'/W

WELL NAME & NO.:	Poker Lake Unit 30-19 BS 102H
SURFACE HOLE FOOTAGE:	835'/N & 1691'/W
BOTTOM HOLE FOOTAGE:	1915'/S & 990'/W

WELL NAME & NO.:	Poker Lake Unit 30-19 BS 121H
SURFACE HOLE FOOTAGE:	781'/N & 1663'/W
BOTTOM HOLE FOOTAGE:	2588'/S & 330'/W

Changes approved through engineering via **Sundry 2756627, 2756690, 2756628**, on **11-21-2023**. Any previous COAs not addressed within the updated COAs still apply.

COA

H₂S	<input type="radio"/> Yes	<input checked="" type="radio"/> No		
Potash / WIPP	<input checked="" type="radio"/> None	<input type="radio"/> Secretary	<input type="radio"/> R-111-P	<input type="checkbox"/> WIPP
Cave / Karst	<input type="radio"/> Low	<input checked="" type="radio"/> Medium	<input type="radio"/> High	<input type="radio"/> Critical
Wellhead	<input type="radio"/> Conventional	<input checked="" type="radio"/> Multibowl	<input type="radio"/> Both	<input type="radio"/> Diverter
Cementing	<input checked="" type="checkbox"/> Primary Squeeze	<input type="checkbox"/> Cont. Squeeze	<input checked="" type="checkbox"/> EchoMeter	<input type="checkbox"/> DV Tool
Special Req	<input checked="" type="checkbox"/> Break Testing	<input type="checkbox"/> Water Disposal	<input checked="" type="checkbox"/> COM	<input type="checkbox"/> Unit
Variance	<input checked="" type="checkbox"/> Flex Hose	<input type="checkbox"/> Casing Clearance	<input type="checkbox"/> Pilot Hole	<input type="checkbox"/> Capitan Reef
Variance	<input type="checkbox"/> Four-String	<input checked="" type="checkbox"/> Offline Cementing	<input type="checkbox"/> Fluid-Filled	<input type="checkbox"/> Open Annulus
<input type="checkbox"/> Batch APD / Sundry				

A. HYDROGEN SULFIDE

Hydrogen Sulfide (H₂S) monitors shall be installed prior to drilling out the surface shoe. If H₂S is detected in concentrations greater than 100 ppm, the Hydrogen Sulfide area must meet all requirements from **43 CFR 3176**, which includes equipment and personnel/public protection items. If Hydrogen Sulfide is encountered, provide measured values and formations to the BLM.

B. CASING

- The **9-5/8** inch surface casing shall be set at approximately **1221** feet (a minimum of **70 feet (Eddy County)** into the Rustler Anhydrite, above the salt, and below usable fresh water) and cemented to the surface.

- a. If cement does not circulate to the surface, the appropriate BLM office shall be notified and a temperature survey utilizing an electronic type temperature survey with surface log readout will be used or a cement bond log shall be run to verify the top of the cement. Temperature survey will be run a minimum of six hours after pumping cement and ideally between 8-10 hours after completing the cement job.
 - b. Wait on cement (WOC) time for a primary cement job will be a minimum of **8 hours** or 500 pounds compressive strength, whichever is greater. (This is to include the lead cement)
 - c. Wait on cement (WOC) time for a remedial job will be a minimum of 4 hours after bringing cement to surface or 500 pounds compressive strength, whichever is greater.
 - d. If cement falls back, remedial cementing will be done prior to drilling out that string.
2. The minimum required fill of cement behind the **7-5/8** inch intermediate casing is: Operator has proposed to cement in two stages by conventionally cementing the first stage and performing a bradenhead squeeze on the second stage, contingent upon no returns to surface.
 - a. First stage: Operator will cement with intent to reach the top of the **Brushy Canyon at (PLU 30-19 BS 122H-6722'), (PLU 30-19 BS 121H- 6719'), (PLU 30-19 BS 102H-6725')**.
 - b. Second stage:
 - Operator will perform bradenhead squeeze and top-out. Cement to surface. If cement does not reach surface, the appropriate BLM office shall be notified. **Wait on cement (WOC) time for a primary cement job is to include the lead cement slurry due to cave/karst.**
 - ❖ In Medium Cave/Karst Areas if cement does not circulate to surface on the first two casing strings, the cement on the 3rd casing string must come to surface.

Operator has proposed to pump down 9-5/8" X 7-5/8" annulus after primary cementing stage. Operator must run Echo-meter to verify Cement Slurry/Fluid top in the annulus OR operator shall run a CBL from TD of the 7-5/8" casing to surface after the second stage BH to verify TOC.

Submit results to the BLM. No displacement fluid/wash out shall be utilized at the top of the cement slurry between second stage BH and top out.

If cement does not reach surface, the next casing string must come to surface.

Operator must use a limited flush fluid volume of 5 bbl following backside cementing procedures.

3. The minimum required fill of cement behind the **5-1/2** inch production casing is:
 - Cement should tie-back at least **200 feet** into previous casing string. Operator shall provide method of verification.

C. PRESSURE CONTROL

1. Variance approved to use flex line from BOP to choke manifold. Manufacturer's specification to be readily available. No external damage to flex line. Flex line to be installed as straight as possible (no hard bends).
2. Operator has proposed a multi-bowl wellhead assembly. This assembly will only be tested when installed on the surface casing. Minimum working pressure of the blowout preventer (BOP) and related equipment (BOPE) required for drilling below the casing shoe shall be **10,000 (10M) psi. Variance is approved to use a 5000 (5M) Annular which shall be tested to 5000 (5M) psi.**
 - a. Wellhead shall be installed by manufacturer's representatives, submit documentation with subsequent sundry.
 - b. If the welding is performed by a third party, the manufacturer's representative shall monitor the temperature to verify that it does not exceed the maximum temperature of the seal.
 - c. Manufacturer representative shall install the test plug for the initial BOP test.
 - d. If the cement does not circulate and one inch operations would have been possible with a standard wellhead, the well head shall be cut off, cementing operations performed and another wellhead installed.
 - e. Whenever any seal subject to test pressure is broken, all the tests in 43 CFR 3172 must be followed.

D. SPECIAL REQUIREMENT (S)

Communitization Agreement

- The operator will submit a Communitization Agreement to the Santa Fe Office, 301 Dinosaur Trail Santa Fe, New Mexico 87508, at least 90 days before the anticipated date of first production from a well subject to a spacing order issued by the New Mexico Oil Conservation Division. The Communitization Agreement will include the signatures of all working interest owners in all Federal and Indian leases subject to the Communitization Agreement (i.e., operating rights owners and lessees of record), or certification that the operator has obtained the written signatures of all such owners and will make those signatures available to the BLM immediately upon request.
- The operator will submit an as-drilled survey well plat of the well completion, but are not limited to, those specified in 43 CFR 3171 and 3172.
- If the operator does not comply with this condition of approval, the BLM may take enforcement actions that include, but are not limited to, those specified in 43 CFR 3163.1.

- In addition, the well sign shall include the surface and bottom hole lease numbers. When the Communitization Agreement number is known, it shall also be on the sign.

Offline Cementing

Contact the BLM prior to the commencement of any offline cementing procedure.

(Note: For a minimum 5M BOPE or less (Utilizing a 10M BOPE system))

BOPE Break Testing Variance

- BOPE Break Testing is ONLY permitted for 5M BOPE or less. **(Annular preventer must be tested to a minimum of 70% of BOPE working pressure and shall be higher than the MASP)**
- BOPE Break Testing is NOT permitted to drilling the production hole section.
- Variance only pertains to the intermediate hole-sections and no deeper than the Bone Springs formation.
- While in transfer between wells, the BOPE shall be secured by the hydraulic carrier or cradle.
- Any well control event while drilling require notification to the BLM Petroleum Engineer **(575-706-2779)** prior to the commencement of any BOPE Break Testing operations.
- A full BOPE test is required prior to drilling the first deep intermediate hole section. If any subsequent hole interval is deeper than the first, a full BOPE test will be required. (200' TVD tolerance between intermediate shoes is allowable).
- The BLM is to be contacted **(575-361-2822 Eddy County)** 4 hours prior to BOPE tests.
- As a minimum, a full BOPE test shall be performed at 21-day intervals.
- In the event any repairs or replacement of the BOPE is required, the BOPE shall test as per must meet all requirements from **43 CFR 3172**.

GENERAL REQUIREMENTS

The BLM is to be notified in advance for a representative to witness:

- a. Spudding well (minimum of 24 hours)
- b. Setting and/or Cementing of all casing strings (minimum of 4 hours)
- c. BOPE tests (minimum of 4 hours)

☒ Eddy County

Email or call the Carlsbad Field Office, 620 East Greene St., Carlsbad, NM

88220, BLM_NM_CFO_DrillingNotifications@BLM.GOV
(575) 361-2822

☒ Lea County

Call the Hobbs Field Station, 414 West Taylor, Hobbs NM 88240,
(575) 689-5981

1. Unless the production casing has been run and cemented or the well has been properly plugged, the drilling rig shall not be removed from over the hole without prior approval.
 - a. In the event the operator has proposed to drill multiple wells utilizing a skid/walking rig. Operator shall secure the wellbore on the current well, after installing and testing the wellhead, by installing a blind flange of like pressure rating to the wellhead and a pressure gauge that can be monitored while drilling is performed on the other well(s).
 - b. When the operator proposes to set surface casing with Spudder Rig
 - Notify the BLM when moving in and removing the Spudder Rig.
 - Notify the BLM when moving in the 2nd Rig. Rig to be moved in within 90 days of notification that Spudder Rig has left the location.
 - BOP/BOPE test to be conducted per **43 CFR part 3170 Subpart 3172** as soon as 2nd Rig is rigged up on well.
2. Floor controls are required for 3M or Greater systems. These controls will be on the rig floor, unobstructed, readily accessible to the driller and will be operational at all times during drilling and/or completion activities. Rig floor is defined as the area immediately around the rotary table; the area immediately above the substructure on which the draw works are located, this does not include the dog house or stairway area.
3. The record of the drilling rate along with the GR/N well log run from TD to surface (horizontal well – vertical portion of hole) shall be submitted to the BLM office as well as all other logs run on the borehole 30 days from completion. If available, a digital copy of the logs is to be submitted in addition to the paper copies. The Rustler top and top and bottom of Salt are to be recorded on the Completion Report.

A. CASING

1. Changes to the approved APD casing program need prior approval if the items substituted are of lesser grade or different casing size or are Non-API. The Operator can exchange the components of the proposal with that of superior strength (i.e. changing from J-55 to N-80, or from 36# to 40#). Changes to the approved cement program need prior approval if the altered cement plan has less volume or strength or if the changes are substantial (i.e. Multistage tool, ECP, etc.). The initial wellhead installed on the well will remain on the well with spools used as needed.

2. Wait on cement (WOC) for Potash Areas: After cementing but before commencing any tests, the casing string shall stand cemented under pressure until both of the following conditions have been met: 1) cement reaches a minimum compressive strength of 500 psi for all cement blends, 2) until cement has been in place at least 24 hours. WOC time will be recorded in the driller's log. The casing integrity test can be done (prior to the cement setting up) immediately after bumping the plug.
3. Wait on cement (WOC) for Water Basin: After cementing but before commencing any tests, the casing string shall stand cemented under pressure until both of the following conditions have been met: 1) cement reaches a minimum compressive strength of 500 psi at the shoe, 2) until cement has been in place at least 8 hours. WOC time will be recorded in the driller's log. See individual casing strings for details regarding lead cement slurry requirements. The casing integrity test can be done (prior to the cement setting up) immediately after bumping the plug.
4. Provide compressive strengths including hours to reach required 500 pounds compressive strength prior to cementing each casing string. Have well specific cement details onsite prior to pumping the cement for each casing string.
5. No pea gravel permitted for remedial or fall back remedial without prior authorization from the BLM engineer.
6. On that portion of any well approved for a 5M BOPE system or greater, a pressure integrity test of each casing shoe shall be performed. Formation at the shoe shall be tested to a minimum of the mud weight equivalent anticipated to control the formation pressure to the next casing depth or at total depth of the well. This test shall be performed before drilling more than 20 feet of new hole.
7. If hardband drill pipe is rotated inside casing, returns will be monitored for metal. If metal is found in samples, drill pipe will be pulled and rubber protectors which have a larger diameter than the tool joints of the drill pipe will be installed prior to continuing drilling operations.
8. Whenever a casing string is cemented in the R-111-P potash area, the NMOCD requirements shall be followed.

B. PRESSURE CONTROL

1. All blowout preventer (BOP) and related equipment (BOPE) shall comply with well control requirements as described in **43 CFR part 3170 Subpart 3172** and **API STD 53 Sec. 5.3**.
2. If a variance is approved for a flexible hose to be installed from the BOP to the choke manifold, the following requirements apply: The flex line must meet the requirements of API 16C. Check condition of flexible line from BOP to choke

manifold, replace if exterior is damaged or if line fails test. Line to be as straight as possible with no hard bends and is to be anchored according to Manufacturer's requirements. The flexible hose can be exchanged with a hose of equal size and equal or greater pressure rating. Anchor requirements, specification sheet and hydrostatic pressure test certification matching the hose in service, to be onsite for review. These documents shall be posted in the company man's trailer and on the rig floor.

3. 5M or higher system requires an HCR valve, remote kill line and annular to match. The remote kill line is to be installed prior to testing the system and tested to stack pressure.
4. If the operator has proposed a multi-bowl wellhead assembly in the APD. The following requirements must be met:
 - a. Wellhead shall be installed by manufacturer's representatives, submit documentation with subsequent sundry.
 - b. If the welding is performed by a third party, the manufacturer's representative shall monitor the temperature to verify that it does not exceed the maximum temperature of the seal.
 - c. Manufacturer representative shall install the test plug for the initial BOP test.
 - d. Whenever any seal subject to test pressure is broken, all the tests in **43 CFR part 3170 Subpart 3172** must be followed.
 - e. If the cement does not circulate and one inch operations would have been possible with a standard wellhead, the well head shall be cut off, cementing operations performed and another wellhead installed.
5. The appropriate BLM office shall be notified a minimum of 4 hours in advance for a representative to witness the tests.
 - a. In a water basin, for all casing strings utilizing slips, these are to be set as soon as the crew and rig are ready and any fallback cement remediation has been done. The casing cut-off and BOP installation can be initiated four hours after installing the slips, which will be approximately six hours after bumping the plug. For those casing strings not using slips, the minimum wait time before cut-off is eight hours after bumping the plug. BOP/BOPE testing can begin after cut-off or once cement reaches 500 psi compressive strength (including lead cement), whichever is greater. However, if the float does not hold, cut-off cannot be initiated until cement reaches 500 psi compressive strength (including lead when specified).
 - b. In potash areas, for all casing strings utilizing slips, these are to be set as soon as the crew and rig are ready and any fallback cement remediation has been done. For all casing strings, casing cut-off and BOP installation can be initiated at twelve hours after bumping the cement plug. The BOPE test can be

initiated after bumping the cement plug with the casing valve open. (only applies to single stage cement jobs, prior to the cement setting up.)

- c. The tests shall be done by an independent service company utilizing a test plug not a cup or J-packer and can be initiated immediately with the casing valve open. The operator also has the option of utilizing an independent tester to test without a plug (i.e. against the casing) pursuant to **43 CFR part 3170 Subpart 3172** with the pressure not to exceed 70% of the burst rating for the casing. Any test against the casing must meet the WOC time for water basin (8 hours) or potash (24 hours) or 500 pounds compressive strength, whichever is greater, prior to initiating the test (see casing segment as lead cement may be critical item).
- d. The test shall be run on a 5000 psi chart for a 2-3M BOP/BOP, on a 10000 psi chart for a 5M BOP/BOPE and on a 15000 psi chart for a 10M BOP/BOPE. If a linear chart is used, it shall be a one hour chart. A circular chart shall have a maximum 2 hour clock. If a twelve hour or twenty-four hour chart is used, tester shall make a notation that it is run with a two hour clock.
- e. The results of the test shall be reported to the appropriate BLM office.
- f. All tests are required to be recorded on a calibrated test chart. A copy of the BOP/BOPE test chart and a copy of independent service company test will be submitted to the appropriate BLM office.
- g. The BOP/BOPE test shall include a low pressure test from 250 to 300 psi. The test will be held for a minimum of 10 minutes if test is done with a test plug and 30 minutes without a test plug. This test shall be performed prior to the test at full stack pressure.
- h. BOP/BOPE must be tested by an independent service company within 500 feet of the top of the Wolfcamp formation if the time between the setting of the intermediate casing and reaching this depth exceeds 20 days. This test does not exclude the test prior to drilling out the casing shoe as per **43 CFR part 3170 Subpart 3172**.

C. DRILLING MUD

Mud system monitoring equipment, with derrick floor indicators and visual and audio alarms, shall be operating before drilling into the Wolfcamp formation, and shall be used until production casing is run and cemented.

D. WASTE MATERIAL AND FLUIDS

All waste (i.e. drilling fluids, trash, salts, chemicals, sewage, gray water, etc.) created as a result of drilling operations and completion operations shall be safely contained and

disposed of properly at a waste disposal facility. No waste material or fluid shall be disposed of on the well location or surrounding area.

Porto-johns and trash containers will be on-location during fracturing operations or any other crew-intensive operations.

ZS 11/22/2023

Form C-102
Revised August 1, 2011
Submit one copy to appropriate
District Office
☐ AMENDED REPORT

¹ API Number 30-015-	² Pool Code 98220	³ Pool Name Purple Sage; Wolfcamp
⁴ Property Code	⁵ Property Name POKER LAKE UNIT 30-19 BS	
⁷ OGRID No. 373075	⁸ Operator Name XTO PERMIAN OPERATING, LLC.	
		⁶ Well Number 121H
		⁹ Elevation 3,388'

UL or lot no.	Section	Township	Range	Lot Idn	Feet from the	North/South line	Feet from the	East/West line	County
C	30	25 S	31 E		781	NORTH	1,663	WEST	EDDY

UL or lot no.	Section	Township	Range	Lot Idn	Feet from the	North/South line	Feet from the	East/West line	County
3	18	25 S	31 E		2,588	SOUTH	330	WEST	EDDY

No allowable will be assigned to this completion until all interests have been consolidated or a non-standard unit has been approved by the division.

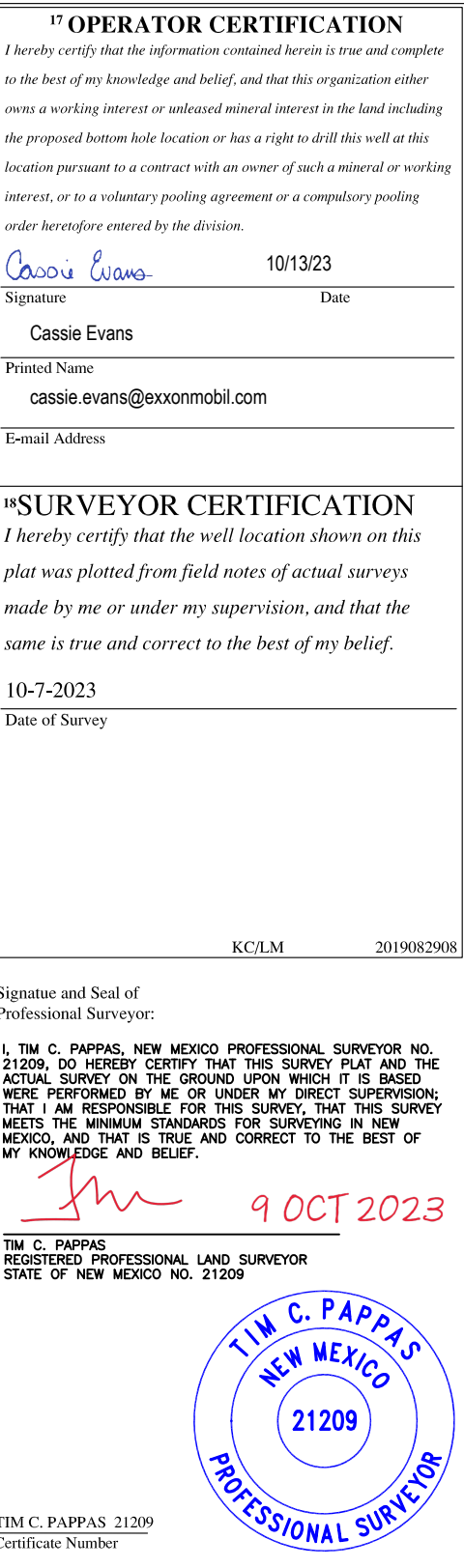

ALL INFORMATION CONTAINED HEREIN IS THE PROPERTY OF CACTUS WELLHEAD, LLC. REPRODUCTION, DISCLOSURE, OR USE THEREOF IS PERMISSIBLE ONLY AS PROVIDED BY CONTRACT OR AS EXPRESSLY AUTHORIZED BY CACTUS WELLHEAD, LLC.



ALL DIMENSIONS APPROXIMATE			
CACTUS WELLHEAD LLC		XTO ENERGY INC DELAWARE BASIN	
20" x 9-5/8" x 7-5/8" x 5-1/2" MBU-T-CFL-R-DBLO Wellhead With 11" 10M x 7-1/16" 15M CTH-DBLHPS Tubing Head And 9-5/8", 7-5/8" & 5-1/2" Pin Bottom Mandrel Casing Hangers		DRAWN	VJK
		APPRV	31MAR22
		DRAWING NO. HBE0000479	

DRILLING PLAN: BLM COMPLIANCE
(Supplement to BLM 3160-3)

XTO Energy Inc.
PLU 30-19 BS 121H
Projected TD: 22870.35' MD / 11815' TVD
SHL: 781' FNL & 1663' FWL , Section 30, T25S, R31E
BHL: 2588' FSL & 330' FWL , Section 18, T25S, R31E
Eddy County, NM

1. Geologic Name of Surface Formation

A. Quaternary

2. Estimated Tops of Geological Markers & Depths of Anticipated Fresh Water, Oil or Gas

Formation	Well Depth (TVD)	Water/Oil/Gas
Rustler	1112'	Water
Top of Salt	1428'	Water
Base of Salt	3950'	Water
Delaware	4146'	Water
Brushy Canyon	6719'	Water/Oil/Gas
Bone Spring	8063'	Water
1st Bone Spring	8993'	Water/Oil/Gas
2nd Bone Spring	9674'	Water/Oil/Gas
3rd Bone Spring	10962'	Water/Oil/Gas
Wolfcamp	11387'	Water/Oil/Gas
Wolfcamp X	11411'	Water/Oil/Gas
Wolfcamp Y	11505'	Water/Oil/Gas
Wolfcamp A	11538'	Water/Oil/Gas
Target/Land Curve	11815'	Water/Oil/Gas

*** Hydrocarbons @ Brushy Canyon

*** Groundwater depth 40' (per NM State Engineers Office).

No other formations are expected to yield oil, gas or fresh water in measurable volumes. The surface fresh water sands will be protected by setting 9.625 inch casing @ 1212' (216' above the salt) and circulating cement back to surface. The intermediate will isolate from the top of salt down to the next casing seat by setting 7.625 inch casing at 11527.17' and cemented to surface. A 6.75 inch curve and 6.75 inch lateral hole will be drilled to 22870.35 MD/TD and 5.5 inch production casing will be set at TD and cemented back up in the intermediate shoe (estimated TOC 11227.17 feet).

3. Casing Design

Hole Size	Depth	OD Csg	Weight	Grade	Collar	New/Used	SF Burst	SF Collapse	SF Tension
12.25	0' – 1212'	9.625	40	J-55	BTC	New	1.10	5.19	13.00
8.75	0' – 4000'	7.625	29.7	RY P-110	Flush Joint	New	1.86	2.52	1.63
8.75	4000' – 11527.17'	7.625	29.7	HC L-80	Flush Joint	New	1.35	1.59	1.82
6.75	0' – 11427.17'	5.5	23	RY P-110	Semi-Premium	New	1.45	1.96	1.78
6.75	11427.17' - 22870.35'	5.5	23	RY P-110	Semi-Flush	New	1.45	1.89	1.88

· XTO requests the option to utilize a spudder rig (Atlas Copco RD20 or Equivalent) to set and cement surface casing per this Sundry

· XTO requests to not utilize centralizers in the curve and lateral

· 7.625 Collapse analyzed using 50% evacuation based on regional experience.

· 5.5 Tension calculated using vertical hanging weight plus the lateral weight multiplied by a friction factor of 0.35

· Test on Casing will be limited to 70% burst of the casing or 1500 psi, whichever is less

· XTO requests the option to use 5" BTC Float equipment for the the production casing

Wellhead:

Permanent Wellhead – Multibowl System

A. Starting Head: 11" 10M top flange x 9-5/8" bottom

B. Tubing Head: 11" 10M bottom flange x 7-1/16" 15M top flange

- Wellhead will be installed by manufacturer's representatives.
- Manufacturer will monitor welding process to ensure appropriate temperature of seal.
- Operator will test the 7-5/8" casing per BLM Onshore Order 2
- Wellhead Manufacturer representative will not be present for BOP test plug installation

4. Cement Program

Surface Casing: 9.625, 40 New BTC, J-55 casing to be set at +/- 1212'

Lead: 300 sxs EconoCem-HLTRRC (mixed at 10.5 ppg, 1.87 ft³/sx, 10.13 gal/sx water)

Tail: 130 sxs Class C + 2% CaCl (mixed at 14.8 ppg, 1.35 ft³/sx, 6.39 gal/sx water)

Top of Cement: Surface

Compressives: 12-hr = 900 psi 24 hr = 1500 psi

2nd Intermediate Casing: 7.625, 29.7 New casing to be set at +/- 11527.17'

1st Stage

Optional Lead: 360 sxs Class C (mixed at 10.5 ppg, 2.77 ft³/sx, 15.59 gal/sx water)

TOC: Surface

Tail: 440 sxs Class C (mixed at 14.8 ppg, 1.35 ft³/sx, 6.39 gal/sx water)

TOC: Brushy Canyon @ 6719

Compressives: 12-hr = 900 psi 24 hr = 1150 psi

2nd Stage

Lead: 0 sxs Class C (mixed at 12.9 ppg, 2.16 ft³/sx, 9.61 gal/sx water)

Tail: 760 sxs Class C (mixed at 14.8 ppg, 1.33 ft³/sx, 6.39 gal/sx water)

Top of Cement: 0

Compressives: 12-hr = 900 psi 24 hr = 1150 psi

XTO requests to pump a two stage cement job on the 7-5/8" intermediate casing string with the first stage being pumped conventionally with the calculated top of cement at the Brush Canyon (6719') and the second stage performed as a bradenhead squeeze with planned cement from the Brushy Canyon to surface. If cement is not visually confirmed to circulate to surface, the final cement top after the second stage job will be verified by Echo-meter. If necessary, a top out consisting of 1,500 sack of Class C cement + 3% Salt + 1% PreMag-M + 6% Bentonite Gel (2.30 yld, 12.91 ppg) will be executed as a contingency. If cement is still unable to circulate to surface, another Echo-meter run will be performed for cement top verification.

XTO will report to the BLM the volume of fluid (limited to 5 bbls) used to flush intermediate casing valves following backside cementing procedures.

XTO requests to pump an Optional Lead if well conditions dictate in an attempt to bring cement inside the first intermediate casing. If cement reaches the desired height, the BLM will be notified and the second stage bradenhead squeeze and subsequent TOC verification will be negated.

XTO requests the option to conduct the bradenhead squeeze and TOC verification offline as per standard approval from BLM when unplanned remediation is needed and batch drilling is approved. In the event the bradenhead is conducted, we will ensure the first stage cement job is cemented properly and the well is static with floats holding and no pressure on the csg annulus as with all other casing strings where batch drilling operations occur before moving off the rig. The TA cap will also be installed per Cactus procedure and pressure inside the casing will be monitored via the valve on the TA cap as per standard batch drilling ops.

Production Casing: 5.5, 23 New Semi-Flush, RY P-110 casing to be set at +/- 22870.35'

Lead: 20 sxs NeoCem (mixed at 11.5 ppg, 2.69 ft³/sx, 15.00 gal/sx water) Top of Cement: 11227.17 feet

Tail: 800 sxs VersaCem (mixed at 13.2 ppg, 1.51 ft³/sx, 8.38 gal/sx water) Top of Cement: 11727.17 feet

Compressives: 12-hr = 800 psi 24 hr = 1500 psi

XTO requests the option to offline cement and remediate (if needed) surface and intermediate casing strings where batch drilling is approved and if unplanned remediation is needed. XTO will ensure well is static with no pressure on the csg annulus, as with all other casing strings where batch drilling operations occur before moving off the rig. The TA cap will also be installed when applicable per Cactus procedure and pressure inside the casing will be monitored via the valve on the TA cap as per standard batch drilling ops. Offline cement operations will then be conducted after the rig is moved off the current well to the next well in the batch sequence.

5. Pressure Control Equipment

Once the permanent WH is installed on the 9.625 casing, the blow out preventer equipment (BOP) will consist of a 13-5/8" minimum 10M Hydril and a 13-5/8" minimum 10M Double Ram BOP. MASP should not exceed 5080 psi. In any instance where 10M BOP is required by BLM, XTO requests a variance to utilize 5M annular with 10M ram preventers (a common BOP configuration, which allows use of 10M rams in unlikely event that pressures exceed 5M).

All BOP testing will be done by an independent service company. Annular pressure tests will be limited to 50% of the working pressure. When nipping up on the 9.625, 10M bradenhead and flange, the BOP test will be limited to 10000 psi. When nipping up on the 7.625, the BOP will be tested to a minimum of 10000 psi. All BOP tests will include a low pressure test as per BLM regulations. The 10M BOP diagrams are attached. Blind rams will be functioned tested each trip, pipe rams will be functioned tested each day.

A variance is requested to allow use of a flex hose as the choke line from the BOP to the Choke Manifold. If this hose is used, a copy of the manufacturer's certification and pressure test chart will be kept on the rig. Attached is an example of a certification and pressure test chart. The manufacturer does not require anchors.

XTO requests a variance to be able to batch drill this well if necessary. In doing so, XTO will set casing and ensure that the well is cemented properly (unless approval is given for offline cementing) and the well is static. With floats holding, no pressure on the csg annulus, and the installation of a 10K TA cap as per Cactus recommendations, XTO will contact the BLM to skid the rig to drill the remaining wells on the pad. Once surface and both intermediate strings are all completed, XTO will begin drilling the production

hole on each of the wells.

A variance is requested to **ONLY** test broken pressure seals on the BOP equipment when moving from wellhead to wellhead which is in compliance with API Standard 53. API standard 53 states, that for pad drilling operation, moving from one wellhead to another within 21 days, pressure testing is required for pressure-containing and pressure-controlling connections when the integrity of a pressure seal is broken. Based on discussions with the BLM on February 27th 2020, we will request permission to **ONLY** retest broken pressure seals if the following conditions are met: 1. After a full BOP test is conducted on the first well on the pad 2. When skidding to drill an intermediate section that does not penetrate into the Wolfcamp.

6. Proposed Mud Circulation System

INTERVAL	Hole Size	Mud Type	MW (ppg)	Viscosity (sec/qt)	Fluid Loss (cc)
0' - 1212'	12.25	FW/Native	8.4-8.9	35-40	NC
1212' - 11527.17'	8.75	FW / Cut Brine / Direct Emulsion	10.2-10.7	30-32	NC
11527.17' - 22870.35'	6.75	OBM	12.5-13	50-60	NC - 20

The necessary mud products for weight addition and fluid loss control will be on location at all times.

Spud with fresh water/native mud. Drill out from under 9-5/8" surface casing with brine solution. A 9.7 ppg - 10.2 ppg cut brine mud will be used while drilling through the salt formation. Use fibrous materials as needed to control seepage and lost circulation. Pump viscous sweeps as needed for hole cleaning. Pump speed will be recorded on a daily drilling report after mudding up. A Pason or Totco will be used to detect changes in loss or gain of mud volume. A mud test will be performed every 24 hours to determine: density, viscosity, strength, filtration and pH as necessary. Use available solids controls equipment to help keep mud weight down after mud up. Rig up solids control equipment to operate as a closed loop system.

7. Auxiliary Well Control and Monitoring Equipment

- A. A Kelly cock will be in the drill string at all times.
- B. A full opening drill pipe stabbing valve having appropriate connections will be on the rig floor at all times.
- C. H2S monitors will be on location when drilling below the 9.625 casing.

8. Logging, Coring and Testing Program

Mud Logger: Mud Logging Unit (2 man) below intermediate casing.

Open hole logging will not be done on this well.

9. Abnormal Pressures and Temperatures / Potential Hazards

None Anticipated. BHT of 180 to 200 F is anticipated. No H2S is expected but monitors will be in place to detect any H2S occurrences. Should these circumstances be encountered the operator and drilling contractor are prepared to take all necessary steps to ensure safety of all personnel and environment. Lost circulation could occur but is not expected to be a serious problem in this area and hole seepage will be compensated for by additions of small amounts of LCM in the drilling fluid. The maximum anticipated bottom hole pressure for this well is 7680 psi.

10. Anticipated Starting Date and Duration of Operations

Anticipated spud date will be after BLM approval. Move in operations and drilling is expected to take 40 days.

Well Plan Report - POKER LAKE UNIT 30-19 BS 121H

Measured Depth: 22870.00 ft

TVD RKB: 11815.00 ft

Location

Cartographic Reference System: New Mexico East - NAD 27

Northing: 402757.50 ft

Easting: 658892.30 ft

RKB: 3421.00 ft

Ground Level: 3421.00 ft

North Reference: Grid

Convergence Angle: 0.27 Deg

Plan Sections POKER LAKE UNIT 30-19 BS 121H

Measured				TVD			Build	Turn	Dogleg
Depth	Inclination	Azimuth	RKB	Y Offset	X Offset	Rate	Rate	Rate	Target
(ft)	(Deg)	(Deg)	(ft)	(ft)	(ft)	(Deg/100ft)	(Deg/100ft)	(Deg/100ft)	
0.00	0.00	0.00	0.00	0.00	0.00	0.00	0.00	0.00	
1100.00	0.00	0.00	1100.00	0.00	0.00	0.00	0.00	0.00	
2707.89	32.16	213.18	2624.79	-367.82	-240.55	2.00	0.00	2.00	
5720.48	32.16	213.18	5175.21	-1709.78	-1118.19	0.00	0.00	0.00	
7328.37	0.00	0.00	6700.00	-2077.60	-1358.74	-2.00	0.00	2.00	
11727.17	0.00	0.00	11098.80	-2077.60	-1358.74	0.00	0.00	0.00	
12852.17	90.00	359.93	11815.00	-1361.40	-1359.60	8.00	0.00	8.00	FTP 5
22771.87	90.00	359.93	11815.00	8558.30	-1371.50	0.00	0.00	0.00	LTP 5
22870.34	90.00	359.93	11815.00	8656.77	-1371.62	0.00	0.00	0.00	BHL 5

Planned Survey POKER LAKE UNIT 30-19 BS 121H

Measured

TVD

Depth (ft)	Inclination (Deg)	Azimuth (Deg)	RKB (ft)	Y Offset (ft)	X Offset (ft)
0.000	0.000	0.000	0.000	0.000	0.000
100.000	0.000	0.000	100.000	0.000	0.000
200.000	0.000	0.000	200.000	0.000	0.000
300.000	0.000	0.000	300.000	0.000	0.000
400.000	0.000	0.000	400.000	0.000	0.000
500.000	0.000	0.000	500.000	0.000	0.000
600.000	0.000	0.000	600.000	0.000	0.000
700.000	0.000	0.000	700.000	0.000	0.000
800.000	0.000	0.000	800.000	0.000	0.000
900.000	0.000	0.000	900.000	0.000	0.000
1000.000	0.000	0.000	1000.000	0.000	0.000
1100.000	0.000	0.000	1100.000	0.000	0.000
1200.000	1.999	213.100	1199.980	-1.460	-0.960
1300.000	4.000	213.100	1299.838	-5.840	-3.820
1400.000	6.000	213.100	1399.452	-13.130	-8.590
1500.000	7.999	213.100	1498.702	-23.330	-15.260
1600.000	10.000	213.100	1597.465	-36.420	-23.820
1700.000	11.990	213.100	1695.623	-52.390	-34.260
1800.000	14.000	213.100	1793.055	-71.220	-46.580
1900.000	15.990	213.100	1889.643	-92.880	-60.740
2000.000	18.000	213.100	1985.268	-117.350	-76.740
2100.000	19.990	213.100	2079.816	-144.590	-94.560
2200.000	22.000	213.100	2173.169	-174.580	-114.180
2300.000	24.000	213.100	2265.215	-207.280	-135.560
2400.000	26.000	213.100	2355.841	-242.650	-158.690
2500.000	28.000	213.100	2444.937	-280.640	-183.540
2600.000	30.000	213.100	2532.394	-321.210	-210.070
2707.800	32.150	213.100	2624.788	-367.820	-240.550
2800.000	32.150	213.100	2702.771	-408.850	-267.390
2900.000	32.150	213.100	2787.430	-453.400	-296.520
3000.000	32.150	213.100	2872.089	-497.940	-325.650

3100.000	32.150	213.100	2956.747	-542.490	-354.780
3200.000	32.150	213.100	3041.406	-587.030	-383.920
3300.000	32.150	213.100	3126.064	-631.580	-413.050
3400.000	32.150	213.100	3210.723	-676.120	-442.180
3500.000	32.150	213.100	3295.382	-720.670	-471.310
3600.000	32.150	213.100	3380.040	-765.210	-500.450
3700.000	32.150	213.100	3464.699	-809.760	-529.580
3800.000	32.150	213.100	3549.358	-854.300	-558.710
3900.000	32.150	213.100	3634.016	-898.850	-587.840
4000.000	32.150	213.100	3718.675	-943.390	-616.970
4100.000	32.150	213.100	3803.333	-987.940	-646.110
4200.000	32.150	213.100	3887.992	-1032.480	-675.240
4300.000	32.150	213.100	3972.651	-1077.020	-704.370
4400.000	32.150	213.100	4057.309	-1121.570	-733.500
4500.000	32.150	213.100	4141.968	-1166.110	-762.630
4600.000	32.150	213.100	4226.627	-1210.660	-791.770
4700.000	32.150	213.100	4311.285	-1255.200	-820.900
4800.000	32.150	213.100	4395.944	-1299.750	-850.030
4900.000	32.150	213.100	4480.602	-1344.290	-879.160
5000.000	32.150	213.100	4565.261	-1388.840	-908.300
5100.000	32.150	213.100	4649.920	-1433.380	-937.430
5200.000	32.150	213.100	4734.578	-1477.930	-966.560
5300.000	32.150	213.100	4819.237	-1522.470	-995.690
5400.000	32.150	213.100	4903.896	-1567.020	-1024.820
5500.000	32.150	213.100	4988.554	-1611.560	-1053.960
5600.000	32.150	213.100	5073.213	-1656.110	-1083.090
5700.000	32.150	213.100	5157.871	-1700.650	-1112.220
5720.400	32.150	213.100	5175.212	-1709.780	-1118.190
5800.000	30.560	213.100	5243.109	-1744.410	-1140.840
5900.000	28.560	213.100	5330.082	-1785.710	-1167.840
6000.000	26.560	213.100	5418.724	-1824.430	-1193.170
6100.000	24.560	213.100	5508.927	-1860.550	-1216.790
6200.000	22.560	213.100	5600.582	-1894.010	-1238.680

6300.000	20.560	213.100	5693.576	-1924.770	-1258.800
6400.000	18.560	213.100	5787.796	-1952.800	-1277.130
6500.000	16.560	213.100	5883.127	-1978.060	-1293.650
6600.000	14.560	213.100	5979.454	-2000.520	-1308.330
6700.000	12.560	213.100	6076.658	-2020.150	-1321.170
6800.000	10.560	213.100	6174.622	-2036.930	-1332.150
6900.000	8.567	213.100	6273.227	-2050.840	-1341.240
7000.000	6.567	213.100	6372.351	-2061.860	-1348.450
7100.000	4.567	213.100	6471.874	-2069.980	-1353.760
7200.000	2.567	213.100	6571.675	-2075.190	-1357.170
7300.000	0.567	213.100	6671.632	-2077.480	-1358.660
7328.300	0.000	0.000	6700.000	-2077.600	-1358.740
7400.000	0.000	0.000	6771.632	-2077.600	-1358.740
7500.000	0.000	0.000	6871.632	-2077.600	-1358.740
7600.000	0.000	0.000	6971.632	-2077.600	-1358.740
7700.000	0.000	0.000	7071.632	-2077.600	-1358.740
7800.000	0.000	0.000	7171.632	-2077.600	-1358.740
7900.000	0.000	0.000	7271.632	-2077.600	-1358.740
8000.000	0.000	0.000	7371.632	-2077.600	-1358.740
8100.000	0.000	0.000	7471.632	-2077.600	-1358.740
8200.000	0.000	0.000	7571.632	-2077.600	-1358.740
8300.000	0.000	0.000	7671.632	-2077.600	-1358.740
8400.000	0.000	0.000	7771.632	-2077.600	-1358.740
8500.000	0.000	0.000	7871.632	-2077.600	-1358.740
8600.000	0.000	0.000	7971.632	-2077.600	-1358.740
8700.000	0.000	0.000	8071.632	-2077.600	-1358.740
8800.000	0.000	0.000	8171.632	-2077.600	-1358.740
8900.000	0.000	0.000	8271.632	-2077.600	-1358.740
9000.000	0.000	0.000	8371.632	-2077.600	-1358.740
9100.000	0.000	0.000	8471.632	-2077.600	-1358.740
9200.000	0.000	0.000	8571.632	-2077.600	-1358.740
9300.000	0.000	0.000	8671.632	-2077.600	-1358.740
9400.000	0.000	0.000	8771.632	-2077.600	-1358.740

9500.000	0.000	0.000	8871.632	-2077.600	-1358.740
9600.000	0.000	0.000	8971.632	-2077.600	-1358.740
9700.000	0.000	0.000	9071.632	-2077.600	-1358.740
9800.000	0.000	0.000	9171.632	-2077.600	-1358.740
9900.000	0.000	0.000	9271.632	-2077.600	-1358.740
10000.000	0.000	0.000	9371.632	-2077.600	-1358.740
10100.000	0.000	0.000	9471.632	-2077.600	-1358.740
10200.000	0.000	0.000	9571.632	-2077.600	-1358.740
10300.000	0.000	0.000	9671.632	-2077.600	-1358.740
10400.000	0.000	0.000	9771.632	-2077.600	-1358.740
10500.000	0.000	0.000	9871.632	-2077.600	-1358.740
10600.000	0.000	0.000	9971.632	-2077.600	-1358.740
10700.000	0.000	0.000	10071.632	-2077.600	-1358.740
10800.000	0.000	0.000	10171.632	-2077.600	-1358.740
10900.000	0.000	0.000	10271.632	-2077.600	-1358.740
11000.000	0.000	0.000	10371.632	-2077.600	-1358.740
11100.000	0.000	0.000	10471.632	-2077.600	-1358.740
11200.000	0.000	0.000	10571.632	-2077.600	-1358.740
11300.000	0.000	0.000	10671.632	-2077.600	-1358.740
11400.000	0.000	0.000	10771.632	-2077.600	-1358.740
11500.000	0.000	0.000	10871.632	-2077.600	-1358.740
11600.000	0.000	0.000	10971.632	-2077.600	-1358.740
11700.000	0.000	0.000	11071.632	-2077.600	-1358.740
11727.000	0.000	0.000	11098.803	-2077.600	-1358.740
11800.000	5.826	359.900	11171.507	-2073.900	-1358.750
11900.000	13.820	359.900	11269.959	-2056.840	-1358.770
12000.000	21.820	359.900	11365.081	-2026.260	-1358.800
12100.000	29.820	359.900	11455.020	-1982.730	-1358.850
12200.000	37.820	359.900	11538.025	-1927.100	-1358.920
12300.000	45.820	359.900	11612.482	-1860.470	-1359.000
12400.000	53.820	359.900	11676.940	-1784.120	-1359.090
12500.000	61.820	359.900	11730.145	-1699.550	-1359.190
12600.000	69.810	359.900	11771.062	-1608.390	-1359.300

12700.000	77.810	359.900	11798.895	-1512.430	-1359.420
12800.000	85.810	359.900	11813.101	-1413.520	-1359.540
12852.000	90.000	359.900	11815.000	-1361.400	-1359.600
12900.000	90.000	359.900	11815.000	-1313.570	-1359.660
13000.000	90.000	359.900	11815.000	-1213.570	-1359.780
13100.000	90.000	359.900	11815.000	-1113.570	-1359.900
13200.000	90.000	359.900	11815.000	-1013.570	-1360.020
13300.000	90.000	359.900	11815.000	-913.570	-1360.140
13400.000	90.000	359.900	11815.000	-813.570	-1360.260
13500.000	90.000	359.900	11815.000	-713.570	-1360.380
13600.000	90.000	359.900	11815.000	-613.570	-1360.500
13700.000	90.000	359.900	11815.000	-513.570	-1360.620
13800.000	90.000	359.900	11815.000	-413.570	-1360.740
13900.000	90.000	359.900	11815.000	-313.570	-1360.860
14000.000	90.000	359.900	11815.000	-213.570	-1360.980
14100.000	90.000	359.900	11815.000	-113.570	-1361.100
14200.000	90.000	359.900	11815.000	-13.570	-1361.220
14300.000	90.000	359.900	11815.000	86.430	-1361.340
14400.000	90.000	359.900	11815.000	186.430	-1361.460
14500.000	90.000	359.900	11815.000	286.430	-1361.580
14600.000	90.000	359.900	11815.000	386.430	-1361.700
14700.000	90.000	359.900	11815.000	486.430	-1361.820
14800.000	90.000	359.900	11815.000	586.430	-1361.940
14900.000	90.000	359.900	11815.000	686.430	-1362.060
15000.000	90.000	359.900	11815.000	786.430	-1362.180
15100.000	90.000	359.900	11815.000	886.430	-1362.300
15200.000	90.000	359.900	11815.000	986.430	-1362.420
15300.000	90.000	359.900	11815.000	1086.430	-1362.540
15400.000	90.000	359.900	11815.000	1186.430	-1362.660
15500.000	90.000	359.900	11815.000	1286.430	-1362.780
15600.000	90.000	359.900	11815.000	1386.430	-1362.900
15700.000	90.000	359.900	11815.000	1486.430	-1363.020
15800.000	90.000	359.900	11815.000	1586.430	-1363.140

15900.000	90.000	359.900	11815.000	1686.430	-1363.260
16000.000	90.000	359.900	11815.000	1786.430	-1363.380
16100.000	90.000	359.900	11815.000	1886.430	-1363.500
16200.000	90.000	359.900	11815.000	1986.430	-1363.620
16300.000	90.000	359.900	11815.000	2086.430	-1363.740
16400.000	90.000	359.900	11815.000	2186.430	-1363.860
16500.000	90.000	359.900	11815.000	2286.430	-1363.980
16600.000	90.000	359.900	11815.000	2386.430	-1364.100
16700.000	90.000	359.900	11815.000	2486.430	-1364.220
16800.000	90.000	359.900	11815.000	2586.430	-1364.340
16900.000	90.000	359.900	11815.000	2686.430	-1364.460
17000.000	90.000	359.900	11815.000	2786.430	-1364.580
17100.000	90.000	359.900	11815.000	2886.430	-1364.700
17200.000	90.000	359.900	11815.000	2986.430	-1364.820
17300.000	90.000	359.900	11815.000	3086.430	-1364.940
17400.000	90.000	359.900	11815.000	3186.430	-1365.060
17500.000	90.000	359.900	11815.000	3286.430	-1365.180
17600.000	90.000	359.900	11815.000	3386.430	-1365.300
17700.000	90.000	359.900	11815.000	3486.430	-1365.420
17800.000	90.000	359.900	11815.000	3586.430	-1365.540
17900.000	90.000	359.900	11815.000	3686.430	-1365.660
18000.000	90.000	359.900	11815.000	3786.430	-1365.780
18100.000	90.000	359.900	11815.000	3886.430	-1365.900
18200.000	90.000	359.900	11815.000	3986.430	-1366.020
18300.000	90.000	359.900	11815.000	4086.430	-1366.140
18400.000	90.000	359.900	11815.000	4186.430	-1366.260
18500.000	90.000	359.900	11815.000	4286.430	-1366.380
18600.000	90.000	359.900	11815.000	4386.430	-1366.500
18700.000	90.000	359.900	11815.000	4486.430	-1366.620
18800.000	90.000	359.900	11815.000	4586.420	-1366.740
18900.000	90.000	359.900	11815.000	4686.420	-1366.860
19000.000	90.000	359.900	11815.000	4786.420	-1366.980
19100.000	90.000	359.900	11815.000	4886.420	-1367.100

19200.000	90.000	359.900	11815.000	4986.420	-1367.220
19300.000	90.000	359.900	11815.000	5086.420	-1367.340
19400.000	90.000	359.900	11815.000	5186.420	-1367.450
19500.000	90.000	359.900	11815.000	5286.420	-1367.570
19600.000	90.000	359.900	11815.000	5386.420	-1367.690
19700.000	90.000	359.900	11815.000	5486.420	-1367.810
19800.000	90.000	359.900	11815.000	5586.420	-1367.930
19900.000	90.000	359.900	11815.000	5686.420	-1368.050
20000.000	90.000	359.900	11815.000	5786.420	-1368.170
20100.000	90.000	359.900	11815.000	5886.420	-1368.290
20200.000	90.000	359.900	11815.000	5986.420	-1368.410
20300.000	90.000	359.900	11815.000	6086.420	-1368.530
20400.000	90.000	359.900	11815.000	6186.420	-1368.650
20500.000	90.000	359.900	11815.000	6286.420	-1368.770
20600.000	90.000	359.900	11815.000	6386.420	-1368.890
20700.000	90.000	359.900	11815.000	6486.420	-1369.010
20800.000	90.000	359.900	11815.000	6586.420	-1369.130
20900.000	90.000	359.900	11815.000	6686.420	-1369.250
21000.000	90.000	359.900	11815.000	6786.420	-1369.370
21100.000	90.000	359.900	11815.000	6886.420	-1369.490
21200.000	90.000	359.900	11815.000	6986.420	-1369.610
21300.000	90.000	359.900	11815.000	7086.420	-1369.730
21400.000	90.000	359.900	11815.000	7186.420	-1369.850
21500.000	90.000	359.900	11815.000	7286.420	-1369.970
21600.000	90.000	359.900	11815.000	7386.420	-1370.090
21700.000	90.000	359.900	11815.000	7486.420	-1370.210
21800.000	90.000	359.900	11815.000	7586.420	-1370.330
21900.000	90.000	359.900	11815.000	7686.420	-1370.450
22000.000	90.000	359.900	11815.000	7786.420	-1370.570
22100.000	90.000	359.900	11815.000	7886.420	-1370.690
22200.000	90.000	359.900	11815.000	7986.420	-1370.810
22300.000	90.000	359.900	11815.000	8086.420	-1370.930
22400.000	90.000	359.900	11815.000	8186.420	-1371.050

22500.000	90.000	359.900	11815.000	8286.420	-1371.170
22600.000	90.000	359.900	11815.000	8386.420	-1371.290
22700.000	90.000	359.900	11815.000	8486.420	-1371.410
22771.000	90.000	359.900	11815.000	8558.300	-1371.500
22800.000	90.000	359.900	11815.000	8586.420	-1371.530
22870.000	90.000	359.900	11815.000	8656.770	-1371.620

Plan Targets

POKER LAKE UNIT 30-19 BS 121H

Target Name	Measured Depth (ft)	Grid Northing (ft)	Grid Easting (ft)	TVD MSL (ft)	Target Shape
FTP 5	12891.95	401414.80	657568.00	8394.00	RECTANGLE
LTP 5	22836.56	411334.50	657556.10	8394.00	RECTANGLE
BHL 5	22910.39	411433.50	657556.20	8394.00	RECTANGLE

District I
1625 N. French Dr., Hobbs, NM 88240
Phone:(575) 393-6161 Fax:(575) 393-0720
District II
811 S. First St., Artesia, NM 88210
Phone:(575) 748-1283 Fax:(575) 748-9720
District III
1000 Rio Brazos Rd., Aztec, NM 87410
Phone:(505) 334-6178 Fax:(505) 334-6170
District IV
1220 S. St Francis Dr., Santa Fe, NM 87505
Phone:(505) 476-3470 Fax:(505) 476-3462

State of New Mexico
Energy, Minerals and Natural Resources
Oil Conservation Division
1220 S. St Francis Dr.
Santa Fe, NM 87505

CONDITIONS

Action 288009

CONDITIONS

Operator: XTO PERMIAN OPERATING LLC. 6401 HOLIDAY HILL ROAD MIDLAND, TX 79707	OGRID: 373075
	Action Number: 288009
	Action Type: [C-103] NOI Change of Plans (C-103A)

CONDITIONS

Created By	Condition	Condition Date
ward.rikala	All original COA's still apply.	11/27/2023