

Submit 1 Copy To Appropriate District Office

District I – (575) 393-6161
1625 N. French Dr., Hobbs, NM 88240
District II – (575) 748-1283
811 S. First St., Artesia, NM 88210
District III – (505) 334-6178
1000 Rio Brazos Rd., Aztec, NM 87410
District IV – (505) 476-3460
1220 S. St. Francis Dr., Santa Fe, NM 87505

State of New Mexico
Energy, Minerals and Natural ResourcesForm C-103
Revised July 18, 2013OIL CONSERVATION DIVISION
1220 South St. Francis Dr.
Santa Fe, NM 87505

WELL API NO. 30-025-51918	
5. Indicate Type of Lease STATE <input checked="" type="checkbox"/> FEE <input type="checkbox"/>	
6. State Oil & Gas Lease No.	
7. Lease Name or Unit Agreement Name CAPITAN 22301 32-5 STATE COM	
8. Well Number 6H	
9. OGRID Number 260297	
10. Pool name or Wildcat WC-025 G-09 S173615C; UPPER PENN	
SUNDRY NOTICES AND REPORTS ON WELLS (DO NOT USE THIS FORM FOR PROPOSALS TO DRILL OR TO DEEPEN OR PLUG BACK TO A DIFFERENT RESERVOIR. USE "APPLICATION FOR PERMIT" (FORM C-101) FOR SUCH PROPOSALS.)	
1. Type of Well: Oil Well <input type="checkbox"/> Gas Well <input type="checkbox"/> Other	
2. Name of Operator BTA OIL PRODUCERS, LLC	
3. Address of Operator 104 S. PECOS; MIDLAND, TX 79701	
4. Well Location Unit Letter C : 250 feet from the NORTH line and 1330 feet from the WEST line Section 32 Township 16S Range 36E NMPM County LEA	
11. Elevation (Show whether DR, RKB, RT, GR, etc.) 3925	

12. Check Appropriate Box to Indicate Nature of Notice, Report or Other Data

NOTICE OF INTENTION TO:		SUBSEQUENT REPORT OF:	
PERFORM REMEDIAL WORK <input type="checkbox"/>	PLUG AND ABANDON <input type="checkbox"/>	REMEDIAL WORK <input type="checkbox"/>	ALTERING CASING <input type="checkbox"/>
TEMPORARILY ABANDON <input type="checkbox"/>	CHANGE PLANS <input type="checkbox"/>	COMMENCE DRILLING OPNS. <input type="checkbox"/>	P AND A <input type="checkbox"/>
PULL OR ALTER CASING <input type="checkbox"/>	MULTIPLE COMPL <input type="checkbox"/>	CASING/CEMENT JOB <input type="checkbox"/>	
DOWNHOLE COMMINGLE <input type="checkbox"/>			
CLOSED-LOOP SYSTEM <input type="checkbox"/>			
OTHER: Incorrect Unit Letter <input checked="" type="checkbox"/>		OTHER: <input type="checkbox"/>	

13. Describe proposed or completed operations. (Clearly state all pertinent details, and give pertinent dates, including estimated date of starting any proposed work). SEE RULE 19.15.7.14 NMAC. For Multiple Completions: Attach wellbore diagram of proposed completion or recompletion.

BTA Oil Producers LLC respectfully requests the following changes to the original APD as approved. Original Unit Letter was incorrectly listed on the initial APD submission. Please change unit letter from D, to C.

Original Unit Letter: D

New Unit Letter: C

Spud Date:

10/17/2023

Rig Release Date:

12/7/2023

I hereby certify that the information above is true and complete to the best of my knowledge and belief.

SIGNATURE Sammy Hajar TITLE REGULATORY ANALYST DATE 5/8/2024Type or print name Sammy Hajar E-mail address: SHAJAR@BTAOIL.COM PHONE: 432-682-3753**For State Use Only**

APPROVED BY: _____ TITLE _____ DATE _____

Conditions of Approval (if any): _____

State of New Mexico
Energy, Minerals & Natural Resources Department
OIL CONSERVATION DIVISION
1220 South St. Francis Dr.
Santa Fe, NM 87505

¹ API Number 30-025-51918		² Pool Code 98333	³ Pool Name WC025 G09 S173615C ; UPPER PENN	
⁴ Property Code 334679	⁵ Property Name CAPITAN 22301 32-5 STATE COM			⁶ Well Number 6H
⁷ OGRID No. 260297	⁸ Operator Name BTA OIL PRODUCERS, LLC			⁹ Elevation 3925'

UL or lot no.	Section	Township	Range	Lot (dn)	Feet from the	North/South line	Feet from the	East/West line	County
C	32	16S	36E		250	North	1330	West	LEA

UL or lot no. N	Section 5	Township 17S	Range 36E	Lot Idn	Feet from the 50	North/South line South	Feet from the 1980	East/West line West	County LEA
¹² Dedicated Acres 319.42		¹³ Joint or Infill		¹⁴ Consolidation Code		¹⁵ Order No.			

SURFACE HOLE LOCATION
 250' FNL 1330' FWL, SECTION 32
 NAD 83, SPCS NM EAST
 X:833613.63' / Y:687037.66'
 LAT:32.88506100N / LON:103.38122958W
 NAD 27, SPCS NM EAST
 X:792435.49' / Y:686973.05'
 LAT:32.88494108N / LON:103.38073257W

KICK OFF POINT/FIRST TAKE POINT
 100' FNL 1980' FWL, SECTION 32
 NAD 83, SPCS NM EAST
 X:834262.09' / Y:687195.90'
 LAT:32.88547979N / LON:103.37911279W
 NAD 27, SPCS NM EAST
 X:793083.96' / Y:687131.31'
 LAT:32.88535992N / LON:103.37861580W

LAST TAKE POINT
 100' FSL 1980' FWL, SECTION 5
 NAD 83, SPCS NM EAST
 X:834385.19' / Y:676814.43'
 LAT:32.85694593N / LON:103.37901755W
 NAD 27, SPCS NM EAST
 X:793206.75' / Y:676750.08'
 LAT:32.85682586N / LON:103.37852170W

BOTTOM HOLE LOCATION
 50' FSL 1980' FWL, SECTION 5
 NAD 83, SPCS NM EAST
 X:834385.77' / Y:676764.43'
 LAT:32.85680851N / LON:103.37901711W
 NAD 27, SPCS NM EAST
 X:793207.33' / Y:676700.08'
 LAT:32.85668843N / LON:103.37852128W

WELL SECTIONS:
 SECTION 29
 SECTION 32
 SECTION 33
 SECTION 32
 SECTION 05
 SECTION 05
 SECTION 08
 SECTION 09
 SECTION 05
 SECTION 04
 SECTION 09
 SECTION 08
 SECTION 07
 SECTION 08
 SECTION 09
 SECTION 04
 SECTION 09

WELL DIAMETERS:
 16"
 12"
 10"
 8"
 6"
 4"
 3"
 2"
 1"

WELL PATH:
 500'40'46"E
 10382.21'

WELL POINTS:
 SHL
 KOP/
 FIRST
 TAKE
 LAST
 TAKE
 BHL

WELL SECTIONS:
 1980'
 1330'
 250'
 100'
 500'40'46"E
 10382.21'
 1980'
 1980'
 50'
 100'

WELL SECTIONS:
 SECTION 29
 SECTION 32
 SECTION 33
 SECTION 32
 SECTION 05
 SECTION 05
 SECTION 08
 SECTION 09
 SECTION 05
 SECTION 04
 SECTION 09
 SECTION 08
 SECTION 07
 SECTION 08
 SECTION 09
 SECTION 04
 SECTION 09

WELL SECTIONS:
 SECTION 29
 SECTION 32
 SECTION 33
 SECTION 32
 SECTION 05
 SECTION 05
 SECTION 08
 SECTION 09
 SECTION 05
 SECTION 04
 SECTION 09
 SECTION 08
 SECTION 07
 SECTION 08
 SECTION 09
 SECTION 04
 SECTION 09

WELL SECTIONS:
 SECTION 29
 SECTION 32
 SECTION 33
 SECTION 32
 SECTION 05
 SECTION 05
 SECTION 08
 SECTION 09
 SECTION 05
 SECTION 04
 SECTION 09
 SECTION 08
 SECTION 07
 SECTION 08
 SECTION 09
 SECTION 04
 SECTION 09

WELL SECTIONS:
 SECTION 29
 SECTION 32
 SECTION 33
 SECTION 32
 SECTION 05
 SECTION 05
 SECTION 08
 SECTION 09
 SECTION 05
 SECTION 04
 SECTION 09
 SECTION 08
 SECTION 07
 SECTION 08
 SECTION 09
 SECTION 04
 SECTION 09

WELL SECTIONS:
 SECTION 29
 SECTION 32
 SECTION 33
 SECTION 32
 SECTION 05
 SECTION 05
 SECTION 08
 SECTION 09
 SECTION 05
 SECTION 04
 SECTION 09
 SECTION 08
 SECTION 07
 SECTION 08
 SECTION 09
 SECTION 04
 SECTION 09

WELL SECTIONS:
 SECTION 29
 SECTION 32
 SECTION 33
 SECTION 32
 SECTION 05
 SECTION 05
 SECTION 08
 SECTION 09
 SECTION 05
 SECTION 04
 SECTION 09
 SECTION 08
 SECTION 07
 SECTION 08
 SECTION 09
 SECTION 04
 SECTION 09

WELL SECTIONS:
 SECTION 29
 SECTION 32
 SECTION 33
 SECTION 32
 SECTION 05
 SECTION 05
 SECTION 08
 SECTION 09
 SECTION 05
 SECTION 04
 SECTION 09
 SECTION 08
 SECTION 07
 SECTION 08
 SECTION 09
 SECTION 04
 SECTION 09

WELL SECTIONS:
 SECTION 29
 SECTION 32
 SECTION 33
 SECTION 32
 SECTION 05
 SECTION 05
 SECTION 08
 SECTION 09
 SECTION 05
 SECTION 04
 SECTION 09
 SECTION 08
 SECTION 07
 SECTION 08
 SECTION 09
 SECTION 04
 SECTION 09

WELL SECTIONS:
 SECTION 29
 SECTION 32
 SECTION 33
 SECTION 32
 SECTION 05
 SECTION 05
 SECTION 08
 SECTION 09
 SECTION 05
 SECTION 04
 SECTION 09
 SECTION 08
 SECTION 07
 SECTION 08
 SECTION 09
 SECTION 04
 SECTION 09

WELL SECTIONS:
 SECTION 29
 SECTION 32
 SECTION 33
 SECTION 32
 SECTION 05
 SECTION 05
 SECTION 08
 SECTION 09
 SECTION 05
 SECTION 04
 SECTION 09
 SECTION 08
 SECTION 07
 SECTION 08
 SECTION 09
 SECTION 04
 SECTION 09

WELL SECTIONS:
 SECTION 29
 SECTION 32
 SECTION 33
 SECTION 32
 SECTION 05
 SECTION 05
 SECTION 08
 SECTION 09
 SECTION 05
 SECTION 04
 SECTION 09
 SECTION 08
 SECTION 07
 SECTION 08
 SECTION 09
 SECTION 04
 SECTION 09

WELL SECTIONS:
 SECTION 29
 SECTION 32
 SECTION 33
 SECTION 32
 SECTION 05
 SECTION 05
 SECTION 08
 SECTION 09
 SECTION 05
 SECTION 04
 SECTION 09
 SECTION 08
 SECTION 07
 SECTION 08
 SECTION 09
 SECTION 04
 SECTION 09

WELL SECTIONS:
 SECTION 29
 SECTION 32
 SECTION 33
 SECTION 32
 SECTION 05
 SECTION 05
 SECTION 08
 SECTION 09
 SECTION 05
 SECTION 04
 SECTION 09
 SECTION 08
 SECTION 07
 SECTION 08
 SECTION 09
 SECTION 04
 SECTION 09

WELL SECTIONS:
 SECTION 29
 SECTION 32
 SECTION 33
 SECTION 32
 SECTION 05
 SECTION 05
 SECTION 08
 SECTION 09
 SECTION 05
 SECTION 04
 SECTION 09
 SECTION 08
 SECTION 07
 SECTION 08
 SECTION 09
 SECTION 04
 SECTION 09

WELL SECTIONS:
 SECTION 29
 SECTION 32
 SECTION 33
 SECTION 32
 SECTION 05
 SECTION 05
 SECTION 08
 SECTION 09
 SECTION 05
 SECTION 04
 SECTION 09
 SECTION 08
 SECTION 07
 SECTION 08
 SECTION 09
 SECTION 04
 SECTION 09

WELL SECTIONS:
 SECTION 29
 SECTION 32
 SECTION 33
 SECTION 32
 SECTION 05
 SECTION 05
 SECTION 08
 SECTION 09
 SECTION 05
 SECTION 04
 SECTION 09
 SECTION 08
 SECTION 07
 SECTION 08
 SECTION 09
 SECTION 04
 SECTION 09

WELL SECTIONS:
 SECTION 29
 SECTION 32
 SECTION 33
 SECTION 32
 SECTION 05
 SECTION 05
 SECTION 08
 SECTION 09
 SECTION 05
 SECTION 04
 SECTION 09
 SECTION 08
 SECTION 07
 SECTION 08
 SECTION 09
 SECTION 04
 SECTION 09

WELL SECTIONS:
 SECTION 29
 SECTION 32
 SECTION 33
 SECTION 32
 SECTION 05
 SECTION 05
 SECTION 08

I hereby certify that the information contained herein is true and complete to the best of my knowledge and belief, and that this organization either owns a working interest or unleased mineral interest in the land including the proposed bottom hole location or has a right to drill this well at this location pursuant to a contract with an owner of such a mineral or working interest, or to a voluntary pooling agreement or a compulsory pooling order heretofore entered by the division.

Signature: [Signature] Date: 5/8/2024

Sammy Hajar
Printed Name
SHAJAR@BTAOIL.COM
E-mail Address

¹⁸ **SURVEYOR CERTIFICATION**

I hereby certify that the well location shown on this plat was plotted from field notes of actual surveys made by me or under my supervision, and that the same is true and correct to the best of my belief.

Date of Survey: **APRIL 25, 2023**
Signature and Seal of Professional Surveyor

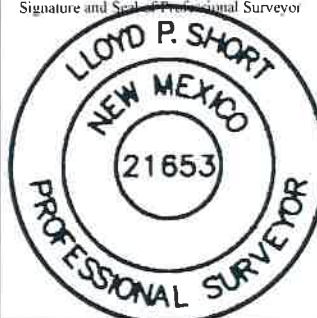

District I
1625 N. French Dr., Hobbs, NM 88240
Phone:(575) 393-6161 Fax:(575) 393-0720
District II
811 S. First St., Artesia, NM 88210
Phone:(575) 748-1283 Fax:(575) 748-9720
District III
1000 Rio Brazos Rd., Aztec, NM 87410
Phone:(505) 334-6178 Fax:(505) 334-6170
District IV
1220 S. St Francis Dr., Santa Fe, NM 87505
Phone:(505) 476-3470 Fax:(505) 476-3462

State of New Mexico
Energy, Minerals and Natural Resources
Oil Conservation Division
1220 S. St Francis Dr.
Santa Fe, NM 87505

CONDITIONS

Action 342279

CONDITIONS

Operator: BTA OIL PRODUCERS, LLC 104 S Pecos Midland, TX 79701	OGRID: 260297
	Action Number: 342279
	Action Type: [C-103] NOI Change of Plans (C-103A)

CONDITIONS

Created By	Condition	Condition Date
pkautz	None	5/9/2024