

Form 3160-3
(June 2015)FORM APPROVED
OMB No. 1004-0137
Expires: January 31, 2018UNITED STATES
DEPARTMENT OF THE INTERIOR
BUREAU OF LAND MANAGEMENT
APPLICATION FOR PERMIT TO DRILL OR REENTER

1a. Type of work: <input type="checkbox"/> DRILL <input type="checkbox"/> REENTER		5. Lease Serial No.
1b. Type of Well: <input type="checkbox"/> Oil Well <input type="checkbox"/> Gas Well <input type="checkbox"/> Other		6. If Indian, Allottee or Tribe Name
1c. Type of Completion: <input type="checkbox"/> Hydraulic Fracturing <input type="checkbox"/> Single Zone <input type="checkbox"/> Multiple Zone		7. If Unit or CA Agreement, Name and No.
2. Name of Operator		8. Lease Name and Well No.
3a. Address		9. API Well No. 30-015-55680
3b. Phone No. (include area code)		10. Field and Pool, or Exploratory
4. Location of Well (Report location clearly and in accordance with any State requirements. *) At surface At proposed prod. zone		11. Sec., T. R. M. or Blk. and Survey or Area
14. Distance in miles and direction from nearest town or post office*		12. County or Parish
		13. State
15. Distance from proposed* location to nearest property or lease line, ft. (Also to nearest drig. unit line, if any)	16. No of acres in lease	17. Spacing Unit dedicated to this well
18. Distance from proposed location* to nearest well, drilling, completed, applied for, on this lease, ft.	19. Proposed Depth	20. BLM/BIA Bond No. in file
21. Elevations (Show whether DF, KDB, RT, GL, etc.)	22. Approximate date work will start*	23. Estimated duration
24. Attachments		

The following, completed in accordance with the requirements of Onshore Oil and Gas Order No. 1, and the Hydraulic Fracturing rule per 43 CFR 3162.3-3 (as applicable)

- | | |
|--|---|
| 1. Well plat certified by a registered surveyor. | 4. Bond to cover the operations unless covered by an existing bond on file (see Item 20 above). |
| 2. A Drilling Plan. | 5. Operator certification. |
| 3. A Surface Use Plan (if the location is on National Forest System Lands, the SUPO must be filed with the appropriate Forest Service Office). | 6. Such other site specific information and/or plans as may be requested by the BLM. |

25. Signature	Name (Printed/Typed)	Date
Title		
Approved by (Signature)	Name (Printed/Typed)	Date
Title		
Office		

Application approval does not warrant or certify that the applicant holds legal or equitable title to those rights in the subject lease which would entitle the applicant to conduct operations thereon.
Conditions of approval, if any, are attached.

Title 18 U.S.C. Section 1001 and Title 43 U.S.C. Section 1212, make it a crime for any person knowingly and willfully to make to any department or agency of the United States any false, fictitious or fraudulent statements or representations as to any matter within its jurisdiction.

(Continued on page 2)

*(Instructions on page 2)



Approval Date: 10/04/2024

District I
1625 N. French Dr., Hobbs, NM 88240
Phone: (575) 393-6161 Fax: (575) 393-0720
District II
811 S. First St., Artesia, NM 88210
Phone: (575) 748-1283 Fax: (575) 748-9720
District III
1000 Rio Brazos Road, Aztec, NM 87410
Phone: (505) 334-6178 Fax: (505) 334-6170
District IV
1220 S. St. Francis Dr., Santa Fe, NM 87505
Phone: (505) 476-3460 Fax: (505) 476-3462

State of New Mexico
Energy, Minerals & Natural Resources Department
OIL CONSERVATION DIVISION
1220 South St. Francis Dr.
Santa Fe, NM 87505

Form C-102
Revised August 1, 2011
Submit one copy to appropriate
District Office

☐ AMENDED REPORT

WELL LOCATION AND ACREAGE DEDICATION PLAT

¹ API Number 30-015-55680		² Pool Code 51120	³ Pool Name RED LAKE; GLORIETA-YESO
⁴ Property Code 336464	⁵ Property Name RED SKIES 10 FEDERAL COM		⁶ Well Number 11H
⁷ OGRID NO. 328947	⁸ Operator Name SPUR ENERGY PARTNERS LLC.		⁹ Elevation 3556'

¹⁰ Surface Location

UL or lot no.	Section	Township	Range	Lot Idn	Feet from the	North/South line	Feet From the	East/West line	County
D	11	18S	27E		1100	NORTH	871	WEST	EDDY

¹¹ Bottom Hole Location If Different From Surface

UL or lot no.	Section	Township	Range	Lot Idn	Feet from the	North/South line	Feet from the	East/West line	County
E	10	18S	27E		1430	NORTH	50	WEST	EDDY

¹² Dedicated Acres 320	¹³ Joint or Infill	¹⁴ Consolidation Code	¹⁵ Order No. DEFINING WELL
---	-------------------------------	----------------------------------	---

No allowable will be assigned to this completion until all interest have been consolidated or a non-standard unit has been approved by the division.

<p>¹⁶ GEODETIC DATA NAD 83 GRID - NM EAST SURFACE LOCATION (SL) N: 642485.8 - E: 565453.6 LAT: 32.7662037° N LONG: 104.2548771° W</p> <p>KICK OFF POINT (KOP) 1391' FNL & 871' FWL - SEC.11 N: 642195.2 - E: 565450.5 N: 32.7654048° N LONG: 104.2548879° W</p> <p>FIRST TAKE POINT (FTP) 1430' FNL & 100' FWL - SEC.10 N: 642149.7 - E: 564478.8 LAT: 32.7652816° N LONG: 104.2580491° W</p> <p>LAST TAKE POINT (LTP) 1430' FNL & 100' FWL - SEC.10 N: 642273.2 - E: 559401.3 N: 32.7656302° N LONG: 104.2745671° W</p> <p>BOTTOM HOLE (BH) N: 642274.5 - E: 559351.3 LAT: 32.7656336° N LONG: 104.2747297° W</p> <p>CORNER DATA NAD 83 GRID - NM EAST</p> <table border="0"> <tr> <td>A: FOUND BRASS CAP "1941" N: 638442.5 - E: 559275.0</td> <td>H: FOUND BRASS CAP "1941" N: 640937.2 - E: 569825.3</td> </tr> <tr> <td>B: FOUND BRASS CAP "1941" N: 641074.3 - E: 559292.9</td> <td>I: FOUND BRASS CAP "1941" N: 638302.5 - E: 569800.0</td> </tr> <tr> <td>C: FOUND BRASS CAP "1941" N: 643705.3 - E: 559311.4</td> <td>J: FOUND BRASS CAP "1941" N: 638335.5 - E: 567187.6</td> </tr> <tr> <td>D: FOUND BRASS CAP "1941" N: 643640.2 - E: 561953.9</td> <td>K: FOUND BRASS CAP "1941" N: 638374.3 - E: 564542.8</td> </tr> <tr> <td>E: FOUND BRASS CAP "1941" N: 643576.8 - E: 564594.9</td> <td>L: FOUND BRASS CAP "1941" N: 638407.8 - E: 561899.5</td> </tr> <tr> <td>F: FOUND BRASS CAP "1941" N: 643603.5 - E: 567239.7</td> <td>M: FOUND BRASS CAP "1941" N: 641004.4 - E: 564565.8</td> </tr> <tr> <td>G: FOUND BRASS CAP "1941" N: 643569.0 - E: 569851.5</td> <td></td> </tr> </table>	A: FOUND BRASS CAP "1941" N: 638442.5 - E: 559275.0	H: FOUND BRASS CAP "1941" N: 640937.2 - E: 569825.3	B: FOUND BRASS CAP "1941" N: 641074.3 - E: 559292.9	I: FOUND BRASS CAP "1941" N: 638302.5 - E: 569800.0	C: FOUND BRASS CAP "1941" N: 643705.3 - E: 559311.4	J: FOUND BRASS CAP "1941" N: 638335.5 - E: 567187.6	D: FOUND BRASS CAP "1941" N: 643640.2 - E: 561953.9	K: FOUND BRASS CAP "1941" N: 638374.3 - E: 564542.8	E: FOUND BRASS CAP "1941" N: 643576.8 - E: 564594.9	L: FOUND BRASS CAP "1941" N: 638407.8 - E: 561899.5	F: FOUND BRASS CAP "1941" N: 643603.5 - E: 567239.7	M: FOUND BRASS CAP "1941" N: 641004.4 - E: 564565.8	G: FOUND BRASS CAP "1941" N: 643569.0 - E: 569851.5		<p>¹⁷ OPERATOR CERTIFICATION I hereby certify that the information contained herein is true and complete to the best of my knowledge and belief, and that this organization either owns a working interest or unleased mineral interest in the land including the proposed bottom hole location or has a right to drill this well at this location pursuant to a contract with an owner of such a mineral or working interest, or to a voluntary pooling agreement or a compulsory pooling order heretofore entered by the division.</p> <p><i>Sarah Chapman</i> 03/15/2024 Signature Date SARAH CHAPMAN Printed Name SCHAPMAN@SPURENERGY.COM E-mail Address</p> <p>¹⁸ SURVEYOR CERTIFICATION I hereby certify that the well location shown on this plat was plotted from field notes of actual surveys made by me or under my supervision, and that the same is true and correct to the best of my belief.</p> <p>10/10/2023 Date of Survey Signature and Seal of Professional Surveyor</p> <p>14400 03/07/2024 Certificate Number REV: ADD KOP/NAME CHANGE 03/05/2024 REV: DRILL PATH 02/28/2024</p> <p>DALE E. BELL NEW MEXICO PROFESSIONAL SURVEYOR 14400</p>
A: FOUND BRASS CAP "1941" N: 638442.5 - E: 559275.0	H: FOUND BRASS CAP "1941" N: 640937.2 - E: 569825.3														
B: FOUND BRASS CAP "1941" N: 641074.3 - E: 559292.9	I: FOUND BRASS CAP "1941" N: 638302.5 - E: 569800.0														
C: FOUND BRASS CAP "1941" N: 643705.3 - E: 559311.4	J: FOUND BRASS CAP "1941" N: 638335.5 - E: 567187.6														
D: FOUND BRASS CAP "1941" N: 643640.2 - E: 561953.9	K: FOUND BRASS CAP "1941" N: 638374.3 - E: 564542.8														
E: FOUND BRASS CAP "1941" N: 643576.8 - E: 564594.9	L: FOUND BRASS CAP "1941" N: 638407.8 - E: 561899.5														
F: FOUND BRASS CAP "1941" N: 643603.5 - E: 567239.7	M: FOUND BRASS CAP "1941" N: 641004.4 - E: 564565.8														
G: FOUND BRASS CAP "1941" N: 643569.0 - E: 569851.5															

Job No.: LS23100911D

State of New Mexico
Energy, Minerals and Natural Resources Department

Submit Electronically
Via E-permitting

Oil Conservation Division
1220 South St. Francis Dr.
Santa Fe, NM 87505

NATURAL GAS MANAGEMENT PLAN

This Natural Gas Management Plan must be submitted with each Application for Permit to Drill (APD) for a new or recompleted well.

Section 1 – Plan Description Effective May 25, 2021

I. Operator: SPUR ENERGY PARTNERS LLC **OGRID:** 328947 **Date:** 03/12/2024

II. Type: ☒ Original ☐ Amendment due to ☐ 19.15.27.9.D(6)(a) NMAC ☐ 19.15.27.9.D(6)(b) NMAC ☐ Other.

If Other, please describe: _____

III. Well(s): Provide the following information for each new or recompleted well or set of wells proposed to be drilled or proposed to be recompleted from a single well pad or connected to a central delivery point.

Well Name	API	ULSTR	Footages	Anticipated Oil BBL/D	Anticipated Gas MCF/D	Anticipated Produced Water BBL/D
RED SKIES 10 FEDERAL COM 10H	30-015-	D-11-18S-27E	1060' FNL 871' FWL	386 BBL/D	430 MCF/D	2316 BBL/D
RED SKIES 10 FEDERAL COM 11H	30-015-	D-11-18S-27E	1100' FNL 871' FWL	386 BBL/D	430 MCF/D	2316 BBL/D
RED SKIES 10 FEDERAL COM 12H	30-015-	D-11-18S-27E	1140' FNL 871' FWL	386 BBL/D	430 MCF/D	2316 BBL/D
RED SKIES 10 FEDERAL COM 50H	30-015-	D-11-18S-27E	1080' FNL 871' FWL	313 BBL/D	361 MCF/D	1877 BBL/D

IV. Central Delivery Point Name: RED SKIES 10 FEDERAL COM TANK BATTERY [See 19.15.27.9(D)(1) NMAC]

V. Anticipated Schedule: Provide the following information for each new or recompleted well or set of wells proposed to be drilled or proposed to be recompleted from a single well pad or connected to a central delivery point.

Well Name	API	Spud Date	TD Reached Date	Completion Commencement Date	Initial Flow Back Date	First Production Date
RED SKIES 10 FEDERAL COM 10H	30-015-	04/26/2025	05/02/2025	05/29/2025	06/13/2025	06/25/2025
RED SKIES 10 FEDERAL COM 11H	30-015-	05/02/2025	05/08/2025	05/29/2025	06/13/2025	06/25/2025
RED SKIES 10 FEDERAL COM 12H	30-015-	05/08/2025	05/14/2025	05/29/2025	06/13/2025	06/25/2025
RED SKIES 10 FEDERAL COM 50H	30-015-	05/14/2025	05/20/2025	05/29/2025	06/13/2025	06/25/2025

VI. Separation Equipment: ☒ Attach a complete description of how Operator will size separation equipment to optimize gas capture.

VII. Operational Practices: ☒ Attach a complete description of the actions Operator will take to comply with the requirements of Subsection A through F of 19.15.27.8 NMAC.

VIII. Best Management Practices: ☒ Attach a complete description of Operator's best management practices to minimize venting during active and planned maintenance.

Section 2 – Enhanced Plan

EFFECTIVE APRIL 1, 2022

Beginning April 1, 2022, an operator that is not in compliance with its statewide natural gas capture requirement for the applicable reporting area must complete this section.

☒ Operator certifies that it is not required to complete this section because Operator is in compliance with its statewide natural gas capture requirement for the applicable reporting area.

IX. Anticipated Natural Gas Production:

Well	API	Anticipated Average Natural Gas Rate MCF/D	Anticipated Volume of Natural Gas for the First Year MCF

X. Natural Gas Gathering System (NGGS):

Operator	System	ULSTR of Tie-in	Anticipated Gathering Start Date	Available Maximum Daily Capacity of System Segment Tie-in

XI. Map. ☐ Attach an accurate and legible map depicting the location of the well(s), the anticipated pipeline route(s) connecting the production operations to the existing or planned interconnect of the natural gas gathering system(s), and the maximum daily capacity of the segment or portion of the natural gas gathering system(s) to which the well(s) will be connected.

XII. Line Capacity. The natural gas gathering system ☐ will ☐ will not have capacity to gather 100% of the anticipated natural gas production volume from the well prior to the date of first production.

XIII. Line Pressure. Operator ☐ does ☐ does not anticipate that its existing well(s) connected to the same segment, or portion, of the natural gas gathering system(s) described above will continue to meet anticipated increases in line pressure caused by the new well(s).

☐ Attach Operator's plan to manage production in response to the increased line pressure.

XIV. Confidentiality: ☐ Operator asserts confidentiality pursuant to Section 71-2-8 NMSA 1978 for the information provided in Section 2 as provided in Paragraph (2) of Subsection D of 19.15.27.9 NMAC, and attaches a full description of the specific information for which confidentiality is asserted and the basis for such assertion.

Section 3 - Certifications

Effective May 25, 2021

Operator certifies that, after reasonable inquiry and based on the available information at the time of submittal:

☒ Operator will be able to connect the well(s) to a natural gas gathering system in the general area with sufficient capacity to transport one hundred percent of the anticipated volume of natural gas produced from the well(s) commencing on the date of first production, taking into account the current and anticipated volumes of produced natural gas from other wells connected to the pipeline gathering system; or

☐ Operator will not be able to connect to a natural gas gathering system in the general area with sufficient capacity to transport one hundred percent of the anticipated volume of natural gas produced from the well(s) commencing on the date of first production, taking into account the current and anticipated volumes of produced natural gas from other wells connected to the pipeline gathering system.

If Operator checks this box, Operator will select one of the following:

Well Shut-In. ☐ Operator will shut-in and not produce the well until it submits the certification required by Paragraph (4) of Subsection D of 19.15.27.9 NMAC; or

Venting and Flaring Plan. ☐ Operator has attached a venting and flaring plan that evaluates and selects one or more of the potential alternative beneficial uses for the natural gas until a natural gas gathering system is available, including:

- (a) power generation on lease;
- (b) power generation for grid;
- (c) compression on lease;
- (d) liquids removal on lease;
- (e) reinjection for underground storage;
- (f) reinjection for temporary storage;
- (g) reinjection for enhanced oil recovery;
- (h) fuel cell production; and
- (i) other alternative beneficial uses approved by the division.

Section 4 - Notices

1. If, at any time after Operator submits this Natural Gas Management Plan and before the well is spud:

(a) Operator becomes aware that the natural gas gathering system it planned to connect the well(s) to has become unavailable or will not have capacity to transport one hundred percent of the production from the well(s), no later than 20 days after becoming aware of such information, Operator shall submit for OCD's approval a new or revised venting and flaring plan containing the information specified in Paragraph (5) of Subsection D of 19.15.27.9 NMAC; or

(b) Operator becomes aware that it has, cumulatively for the year, become out of compliance with its baseline natural gas capture rate or natural gas capture requirement, no later than 20 days after becoming aware of such information, Operator shall submit for OCD's approval a new or revised Natural Gas Management Plan for each well it plans to spud during the next 90 days containing the information specified in Paragraph (2) of Subsection D of 19.15.27.9 NMAC, and shall file an update for each Natural Gas Management Plan until Operator is back in compliance with its baseline natural gas capture rate or natural gas capture requirement.

2. OCD may deny or conditionally approve an APD if Operator does not make a certification, fails to submit an adequate venting and flaring plan which includes alternative beneficial uses for the anticipated volume of natural gas produced, or if OCD determines that Operator will not have adequate natural gas takeaway capacity at the time a well will be spud.

I certify that, after reasonable inquiry, the statements in and attached to this Natural Gas Management Plan are true and correct to the best of my knowledge and acknowledge that a false statement may be subject to civil and criminal penalties under the Oil and Gas Act.

Signature:	<i>Sarah Chapman</i>
Printed Name:	SARAH CHAPMAN
Title:	REGULATORY DIRECTOR
E-mail Address:	SCHAPMAN@SPUREENERGY.COM
Date:	03/12/2024
Phone:	832-930-8613
OIL CONSERVATION DIVISION (Only applicable when submitted as a standalone form)	
Approved By:	
Title:	
Approval Date:	
Conditions of Approval:	

Spur Energy Partners LLC – Red Skies 10 Federal 11H**1. Geologic Formations**

TVD of Target	3,525'
MD at TD	9,486'

Formation	Depth	Lithology	Expected Fluids
Quaternary	0'	Dolomite, other: Caliche	Useable Water
Rustler		Not Present	
Top Salt		Not Present	
Base Salt		Not Present	
Yates	175'	Dolomite, Limestone, Shale, Siltstone	None
Seven Rivers	425'	Dolomite, Limestone	Natural Gas, Oil
Queen	995'	Anhydrite, Dolomite, Sandstone	Natural Gas, Oil
Grayburg	1455'	Anhydrite	Natural Gas, Oil
San Andres	1800'	Dolomite	Natural Gas, Oil
Glorieta	3315'	Dolomite, Siltstone	Natural Gas, Oil
Paddock	3460'	Dolomite, Limestone	Natural Gas, Oil
Blinberry	4065'	Dolomite, Limestone	Natural Gas, Oil
Abo	5395'	Dolomite, Limestone	Natural Gas, Oil

*H₂S, water flows, loss of circulation, abnormal pressures, etc.

2. Casing Program

All casing strings will be tested in accordance with Onshore Oil and Gas Order #2 III.B.1.h

Casing Formation Set Interval	Hole Size (in)	Casing Interval		Csg. Size (in)	Weight (lbs)	Grade	Conn.	SF	SF Burst	Body SF Tension	Joint SF Tension
		From (ft)	To (ft)					Collapse			
Seven Rivers	17.5	0	475	13.375	54.5	J-55	BTC	1.125	1.2	1.4	1.4
San Andres	12.25	0	2075	9.625	36	J-55	BTC	1.125	1.2	1.4	1.4
N/A	8.75	0	4100	7	32	L-80	BK-HT	1.125	1.2	1.4	1.4
Yeso	8.75	4100	9486	5.5	20	L-80	BK-HT	1.125	1.2	1.4	1.4
SF Values will meet or Exceed											

Spur Energy Partners LLC – Red Skies 10 Federal 11H

	Y or N
Is casing new? If used, attach certification as required in Onshore Order #1	Y
Does casing meet API specifications? If no, attach casing specification sheet.	Y
Is premium or uncommon casing planned? If yes attach casing specification sheet.	N
Does the above casing design meet or exceed BLM's minimum standards? If not provide justification (loading assumptions, casing design criteria).	Y
Will the intermediate pipe be kept at a minimum 1/3 fluid filled to avoid approaching the collapse pressure rating of the casing?	Y
Is well located within Capitan Reef?	N
If yes, does production casing cement tie back a minimum of 50' above the Reef?	
Is well within the designated 4 string boundary.	
Is well located in SOPA but not in R-111-P?	N
If yes, are the first 2 strings cemented to surface and 3 rd string cement tied back 500' into previous casing?	
Is well located in R-111-P and SOPA?	N
If yes, are the first three strings cemented to surface?	
Is 2 nd string set 100' to 600' below the base of salt?	
Is well located in high Cave/Karst?	Y
If yes, are there two strings cemented to surface?	Y
Is well located in critical Cave/Karst?	Y
If yes, are there three strings cemented to surface?	Y

3. Cementing Program

Casing String	Top (ft)	Bottom (ft)	% Excess
Surface Tail	0	475	165%
Intermediate (Lead)	0	475	100%
Intermediate (Tail)	475	2075	100%
Production (Lead)	0	3100	100%
Production (Tail)	3100	9486	25%

Casing String	# Sks	Wt. (lb/gal)	Yld (ft3/sack)	H2O (gal/sk)	500# Comp. Strength (hours)	Slurry Description
Surface Tail	454	13.2	1.87	9.92	6:59	Clas C Premium Plus Cement
Intermediate (Lead)	72	12	2.4	13.48	8:12	Clas C Premium Plus Cement
Intermediate (Tail)	546	13.2	1.87	9.92	6:59	Clas C Premium Plus Cement
Production (Lead)	643	11.4	2.42	15.29	N/A	Clas C Premium Plus Cement
Production (Tail)	1217	13.2	1.56	9.81	N/A	Clas C Premium Plus Cement

Spur Energy Partners LLC – Red Skies 10 Federal 11H

4. Pressure Control Equipment

Spur Energy Partners LLC variance for flex hose

Spur requests a variance to use a flex line from the BOP to the choke manifold. Documentation will be attached in the APD and be readily available. No external damage to flex line. Flex line to be installed as straight as possible (no bends).

BOP installed and tested before drilling which hole?	Size?	Min. Required WP	Type	✓	Tested to:
12.25" Hole	13-5/8"	5M	Annular	✓	70% of working pressure
		5M	Blind Ram	✓	250 psi / 3000 psi
			Pipe Ram	✓	
			Double Ram		
			Other*		
8.75" Hole	13-5/8"	5M	Annular	✓	70% of working pressure
		5M	Blind Ram	✓	250 psi / 3000 psi
			Pipe Ram	✓	
			Double Ram		
			Other*		

Spur Energy Partners LLC will be utilizing a 5M BOP

Condition	Specify what type and where?
BH Pressure at deepest TVD	1759 psi
Abnormal Temperature	No
BH Temperature at deepest TVD	111°F

*Specify if additional ram is utilized.

BOP/BOPE will be tested by an independent service company to 250 psi low and the high pressure indicated above per Onshore Order 2 requirements. The System may be upgraded to a higher pressure but still tested to the working pressure listed in the table above. If the system is upgraded all the components installed will be functional and tested.

Pipe rams will be operationally checked each 24-hour period. Blind rams will be operationally checked on each trip out of the hole. These checks will be noted on the daily tour sheets. Other accessories to the BOP equipment will include a Kelly cock and floor safety valve (inside BOP) and choke lines and choke manifold. See attached schematics.

	Formation integrity test will be performed per Onshore Order #2. On Exploratory wells or on that portion of any well approved for a 5M BOPE system or greater, a pressure integrity test of each casing shoe shall be performed. Will be tested in accordance with Onshore Oil and Gas Order #2 III.B.1.i.
--	---

Spur Energy Partners LLC – Red Skies 10 Federal 11H

Y	Are anchors required by manufacturer?
	A conventional wellhead system will be employed. The wellhead and connection to the BOPE will meet all API 6A requirements. The BOP will be tested per Onshore Order #2 after installation on the surface casing which will cover testing requirements for a maximum of 30 days. See attached schematics.

5. BOP Break Testing Request

Spur Energy Partners LLC requests permission to adjust the BOP break testing requirements as follows:

BOP break test under the following conditions:

- After a full BOP test is conducted
- When skidding to drill the production section, where the surface casing point is shallower than the 3 Bone Spring or 10,000 TVD.
- When skidding to drill a production section that does not penetrate the 3rd Bone Spring or deeper.

If the kill line is broken prior to skid, four tests will be performed.

- 1) The void between the wellhead and the spool (this consists of two tests)
- 2) The spool between the kill lines and the choke manifold (this consists of two tests)

If the kill line is not broken prior to skid, two tests will be performed.

- 1) The void between the wellhead and the pipe rams

6. Mud Program

Sufficient mud materials to maintain mud properties and meet minimum lost circulation and weight increase requirements will be kept on location at all times. The following is a general list of products: Barite, Bentonite, Gypsum, Lime, Soda Ash, Caustic Soda, Nut Plug, Cedar Fiber, Cotton Seed Hulls, Drilling Paper, Salt Water Clay, CACL2. Spur will use a closed mud system.

Depth		Type	Weight (ppg)	Viscosity	Water Loss
From (ft)	To (ft)				
0	475	Water-Based Mud	8.6-8.9	32-36	N/C
475	2075	Brine	10.0-10.5	32-36	N/C
2075	9486	Brine	10.0-10.5	32-36	N/C

What will be used to monitor the loss or gain of fluid?	PVT/PASON/Visual Monitoring
---	-----------------------------

7. Logging and Testing Procedures

Logging, Coring and Testing.

Spur Energy Partners LLC – Red Skies 10 Federal 11H

Yes	Will run GR from TD to surface (horizontal well – vertical portion of hole). Stated logs run will be in the Completion Report and submitted to the BLM.	
No	Logs are planned based on well control or offset log information.	
No	Drill stem test? If yes, explain	
No	Coring? If yes, explain	
Additional logs planned		Interval
No	Resistivity	
No	Density	
No	CBL	
Yes	Mud log	ICP - TD
No	PEX	

8. Drilling Conditions

Pump high viscosity sweeps as needed for hole cleaning. The mud system will be monitored visually/manually as well as with an electronic PVT. The necessary mud products for additional weight and fluid loss control will be on location at all times. Appropriately weighted mud will be used to isolate potential gas, oil, and water zones until such time as casing can be cemented into place for zonal isolation.

Hydrogen Sulfide (H ₂ S) monitors will be installed prior to drilling out the surface shoe. If H ₂ S is detected in concentrations greater than 100 ppm, the operator will comply with the provisions of Onshore Oil and Gas Order #6. If Hydrogen Sulfide is encountered, measured values and formations will be provided to the BLM.	
N	H ₂ S is present
Y	H ₂ S Plan attached

Total estimated cuttings volume: 869.5 bbls.

Spur Energy Partners LLC – Red Skies 10 Federal 11H**9. Other facets of operation**

	Yes/No
Will more than one drilling rig be used for drilling operations? If yes, describe. Spur Energy Partners LLC. requests the option to contract a Surface Rig to drill, set surface casing, and cement for this well. If the timing between rigs is such that Spur Energy Partners LLC. would not be able to preset surface, the Primary Rig will MIRU and drill the well in its entirety per the APD. Please see the attached document for information on the spudder rig.	Yes

Attachments

- ☒ Directional Plan
☒ H2S Contingency Plan
☒ Akita 57 Attachments
☒ BOP Schematics
☒ Transcend Spudder Rig Attachments

10. Company Personnel

Name	Title	Office Phone	Mobile Phone
Christopher Hollis	Drilling Manager	832-930-8629	713-380-7754
Johnny Nabors	Senior Vice President Operations	832-930-8502	281-904-8811



SPUR ENERGY PARTNERS, LLC

EDDY COUNTY, NM (NAD 83 - NME)

RED SKIES 10 FEDERAL

11H

Wellbore #1

Plan: PERMIT

Standard Planning Report

29 February, 2024



Planning Report

Database:	EDM 5000.1.13 Single User Db	Local Co-ordinate Reference:	Well 11H
Company:	SPUR ENERGY PARTNERS, LLC	TVD Reference:	RKB = 20' @ 3576.00usft (AKITA 57)
Project:	EDDY COUNTY, NM (NAD 83 - NME)	MD Reference:	RKB = 20' @ 3576.00usft (AKITA 57)
Site:	RED SKIES 10 FEDERAL	North Reference:	Grid
Well:	11H	Survey Calculation Method:	Minimum Curvature
Wellbore:	Wellbore #1		
Design:	PERMIT		

Project	EDDY COUNTY, NM (NAD 83 - NME)		
Map System:	US State Plane 1983	System Datum:	Mean Sea Level
Geo Datum:	North American Datum 1983		
Map Zone:	New Mexico Eastern Zone		

Site		RED SKIES 10 FEDERAL			
Site Position:		Northing:	642,445.90 usft	Latitude:	32.7660940
From:	Map	Easting:	565,453.30 usft	Longitude:	-104.2548781
Position Uncertainty:	0.00 usft	Slot Radius:	13-3/16 "	Grid Convergence:	0.042 °

Well	11H					
Well Position	+N/-S	39.90 usft	Northing:	642,485.80 usft	Latitude:	32.7662036
	+E/-W	0.30 usft	Easting:	565,453.60 usft	Longitude:	-104.2548770
Position Uncertainty		0.00 usft	Wellhead Elevation:	0.00 usft	Ground Level:	3,556.00 usft

Wellbore	Wellbore #1				
Magnetics	Model Name	Sample Date	Declination (°)	Dip Angle (°)	Field Strength (nT)
	IGRF2020	02/13/24	6.593	60.204	47,465

Design	PERMIT			
Audit Notes:				
Version:	Phase:	PLAN	Tie On Depth:	0.00
Vertical Section:	Depth From (TVD) (usft)	+N/-S (usft)	+E/-W (usft)	Direction (°)
	0.00	0.00	0.00	271.39

Plan Sections										
Measured Depth (usft)	Inclination (°)	Azimuth (°)	Vertical Depth (usft)	+N/-S (usft)	+E/-W (usft)	Dogleg Rate (°/100usft)	Build Rate (°/100usft)	Turn Rate (°/100usft)	TFO (°)	Target
0.00	0.00	0.00	0.00	0.00	0.00	0.00	0.00	0.00	0.000	
300.00	0.00	0.00	300.00	0.00	0.00	0.00	0.00	0.00	0.000	
657.56	7.15	180.61	656.63	-22.28	-0.24	2.00	2.00	0.00	180.613	
2,813.17	7.15	180.61	2,795.48	-290.61	-3.11	0.00	0.00	0.00	0.000	
3,819.07	60.00	271.39	3,624.06	-348.03	-484.59	6.00	5.25	9.02	94.881	
4,019.07	60.00	271.39	3,724.06	-343.82	-657.74	0.00	0.00	0.00	0.000	
4,349.76	93.07	271.39	3,800.00	-336.10	-974.80	10.00	10.00	0.00	0.000	RED SKIES 11H F1
9,436.06	93.07	271.39	3,527.68	-212.52	-6,052.30	0.00	0.00	0.00	0.000	RED SKIES 11H LT
9,486.15	93.07	271.39	3,525.00	-211.30	-6,102.30	0.00	0.00	0.00	0.000	RED SKIES 11H B1



Planning Report

Database:	EDM 5000.1.13 Single User Db	Local Co-ordinate Reference:	Well 11H
Company:	SPUR ENERGY PARTNERS, LLC	TVD Reference:	RKB = 20' @ 3576.00usft (AKITA 57)
Project:	EDDY COUNTY, NM (NAD 83 - NME)	MD Reference:	RKB = 20' @ 3576.00usft (AKITA 57)
Site:	RED SKIES 10 FEDERAL	North Reference:	Grid
Well:	11H	Survey Calculation Method:	Minimum Curvature
Wellbore:	Wellbore #1		
Design:	PERMIT		

Planned Survey									
Measured Depth (usft)	Inclination (°)	Azimuth (°)	Vertical Depth (usft)	+N/-S (usft)	+E/-W (usft)	Vertical Section (usft)	Dogleg Rate (°/100usft)	Build Rate (°/100usft)	Turn Rate (°/100usft)
0.00	0.00	0.00	0.00	0.00	0.00	0.00	0.00	0.00	0.00
RED SKIES 11H SHL: 1100' FNL, 871' FWL									
100.00	0.00	0.00	100.00	0.00	0.00	0.00	0.00	0.00	0.00
200.00	0.00	0.00	200.00	0.00	0.00	0.00	0.00	0.00	0.00
300.00	0.00	0.00	300.00	0.00	0.00	0.00	0.00	0.00	0.00
400.00	2.00	180.61	399.98	-1.75	-0.02	-0.02	2.00	2.00	0.00
500.00	4.00	180.61	499.84	-6.98	-0.07	-0.09	2.00	2.00	0.00
600.00	6.00	180.61	599.45	-15.69	-0.17	-0.21	2.00	2.00	0.00
657.56	7.15	180.61	656.63	-22.28	-0.24	-0.30	2.00	2.00	0.00
700.00	7.15	180.61	698.74	-27.57	-0.30	-0.37	0.00	0.00	0.00
800.00	7.15	180.61	797.96	-40.01	-0.43	-0.54	0.00	0.00	0.00
900.00	7.15	180.61	897.19	-52.46	-0.56	-0.71	0.00	0.00	0.00
1,000.00	7.15	180.61	996.41	-64.91	-0.69	-0.88	0.00	0.00	0.00
1,100.00	7.15	180.61	1,095.63	-77.36	-0.83	-1.05	0.00	0.00	0.00
1,200.00	7.15	180.61	1,194.85	-89.81	-0.96	-1.22	0.00	0.00	0.00
1,300.00	7.15	180.61	1,294.08	-102.25	-1.09	-1.39	0.00	0.00	0.00
1,400.00	7.15	180.61	1,393.30	-114.70	-1.23	-1.55	0.00	0.00	0.00
1,500.00	7.15	180.61	1,492.52	-127.15	-1.36	-1.72	0.00	0.00	0.00
1,600.00	7.15	180.61	1,591.74	-139.60	-1.49	-1.89	0.00	0.00	0.00
1,700.00	7.15	180.61	1,690.96	-152.05	-1.63	-2.06	0.00	0.00	0.00
1,800.00	7.15	180.61	1,790.19	-164.49	-1.76	-2.23	0.00	0.00	0.00
1,900.00	7.15	180.61	1,889.41	-176.94	-1.89	-2.40	0.00	0.00	0.00
2,000.00	7.15	180.61	1,988.63	-189.39	-2.03	-2.57	0.00	0.00	0.00
2,100.00	7.15	180.61	2,087.85	-201.84	-2.16	-2.74	0.00	0.00	0.00
2,200.00	7.15	180.61	2,187.07	-214.29	-2.29	-2.90	0.00	0.00	0.00
2,300.00	7.15	180.61	2,286.30	-226.73	-2.43	-3.07	0.00	0.00	0.00
2,400.00	7.15	180.61	2,385.52	-239.18	-2.56	-3.24	0.00	0.00	0.00
2,500.00	7.15	180.61	2,484.74	-251.63	-2.69	-3.41	0.00	0.00	0.00
2,600.00	7.15	180.61	2,583.96	-264.08	-2.83	-3.58	0.00	0.00	0.00
2,700.00	7.15	180.61	2,683.18	-276.53	-2.96	-3.75	0.00	0.00	0.00
2,800.00	7.15	180.61	2,782.41	-288.97	-3.09	-3.92	0.00	0.00	0.00
2,813.17	7.15	180.61	2,795.48	-290.61	-3.11	-3.94	0.00	0.00	0.00
RED SKIES 11H KOP: 2813.17' MD									
2,850.00	7.30	198.21	2,832.02	-295.13	-3.87	-3.29	6.00	0.41	47.78
2,900.00	8.47	218.49	2,881.55	-301.03	-7.15	-0.15	6.00	2.34	40.57
2,950.00	10.40	232.61	2,930.88	-306.66	-13.03	5.59	6.00	3.86	28.25
3,000.00	12.75	241.99	2,979.86	-311.99	-21.49	13.92	6.00	4.69	18.76
3,050.00	15.32	248.39	3,028.37	-317.01	-32.51	24.81	6.00	5.15	12.79
3,100.00	18.02	252.94	3,076.27	-321.72	-46.05	38.23	6.00	5.41	9.11
3,150.00	20.81	256.33	3,123.42	-326.09	-62.07	54.14	6.00	5.56	6.77
3,200.00	23.64	258.94	3,169.70	-330.11	-80.54	72.51	6.00	5.67	5.22
3,250.00	26.51	261.02	3,214.99	-333.78	-101.40	93.28	6.00	5.74	4.16
3,300.00	29.40	262.72	3,259.15	-337.07	-124.60	116.39	6.00	5.79	3.40
3,350.00	32.31	264.13	3,302.07	-340.00	-150.08	141.78	6.00	5.82	2.84
3,400.00	35.23	265.34	3,343.63	-342.54	-177.75	169.39	6.00	5.85	2.41
3,450.00	38.17	266.38	3,383.71	-344.68	-207.55	199.13	6.00	5.87	2.09
3,500.00	41.11	267.30	3,422.21	-346.43	-239.40	230.92	6.00	5.89	1.83
3,550.00	44.06	268.11	3,459.02	-347.78	-273.20	264.68	6.00	5.90	1.63
3,600.00	47.01	268.84	3,494.04	-348.72	-308.87	300.32	6.00	5.91	1.46
3,650.00	49.97	269.51	3,527.17	-349.26	-346.31	337.73	6.00	5.92	1.33
3,700.00	52.94	270.12	3,558.32	-349.38	-385.41	376.82	6.00	5.92	1.22
3,750.00	55.90	270.68	3,587.41	-349.10	-426.06	417.47	6.00	5.93	1.13
3,800.00	58.87	271.20	3,614.36	-348.40	-468.17	459.58	6.00	5.93	1.05
3,819.07	60.00	271.39	3,624.06	-348.03	-484.59	476.00	6.00	5.94	1.00



Planning Report

Database:	EDM 5000.1.13 Single User Db	Local Co-ordinate Reference:	Well 11H
Company:	SPUR ENERGY PARTNERS, LLC	TVD Reference:	RKB = 20' @ 3576.00usft (AKITA 57)
Project:	EDDY COUNTY, NM (NAD 83 - NME)	MD Reference:	RKB = 20' @ 3576.00usft (AKITA 57)
Site:	RED SKIES 10 FEDERAL	North Reference:	Grid
Well:	11H	Survey Calculation Method:	Minimum Curvature
Wellbore:	Wellbore #1		
Design:	PERMIT		

Planned Survey									
Measured Depth (usft)	Inclination (°)	Azimuth (°)	Vertical Depth (usft)	+N/-S (usft)	+E/-W (usft)	Vertical Section (usft)	Dogleg Rate (°/100usft)	Build Rate (°/100usft)	Turn Rate (°/100usft)
3,900.00	60.00	271.39	3,664.52	-346.33	-554.65	546.09	0.00	0.00	0.00
4,000.00	60.00	271.39	3,714.52	-344.22	-641.23	632.69	0.00	0.00	0.00
4,019.07	60.00	271.39	3,724.06	-343.82	-657.74	649.21	0.00	0.00	0.00
4,050.00	63.09	271.39	3,738.79	-343.16	-684.92	676.40	10.00	10.00	0.00
4,100.00	68.09	271.39	3,759.45	-342.05	-730.42	721.91	10.00	10.00	0.00
4,150.00	73.09	271.39	3,776.06	-340.90	-777.55	769.06	10.00	10.00	0.00
4,200.00	78.09	271.39	3,788.49	-339.72	-825.95	817.47	10.00	10.00	0.00
4,250.00	83.09	271.39	3,796.66	-338.52	-875.25	866.78	10.00	10.00	0.00
4,300.00	88.09	271.39	3,800.50	-337.31	-925.07	916.62	10.00	10.00	0.00
4,349.76	93.07	271.39	3,800.00	-336.10	-974.80	966.36	10.00	10.00	0.00
RED SKIES 11H FTP: 1430' FNL, 100' FEL									
4,400.00	93.07	271.39	3,797.31	-334.88	-1,024.95	1,016.53	0.00	0.00	0.00
4,500.00	93.07	271.39	3,791.96	-332.45	-1,124.78	1,116.38	0.00	0.00	0.00
4,600.00	93.07	271.39	3,786.60	-330.02	-1,224.61	1,216.24	0.00	0.00	0.00
4,700.00	93.07	271.39	3,781.25	-327.59	-1,324.43	1,316.10	0.00	0.00	0.00
4,800.00	93.07	271.39	3,775.89	-325.16	-1,424.26	1,415.95	0.00	0.00	0.00
4,900.00	93.07	271.39	3,770.54	-322.73	-1,524.09	1,515.81	0.00	0.00	0.00
5,000.00	93.07	271.39	3,765.19	-320.30	-1,623.91	1,615.67	0.00	0.00	0.00
5,100.00	93.07	271.39	3,759.83	-317.87	-1,723.74	1,715.52	0.00	0.00	0.00
5,200.00	93.07	271.39	3,754.48	-315.44	-1,823.57	1,815.38	0.00	0.00	0.00
5,300.00	93.07	271.39	3,749.12	-313.01	-1,923.39	1,915.24	0.00	0.00	0.00
5,400.00	93.07	271.39	3,743.77	-310.58	-2,023.22	2,015.09	0.00	0.00	0.00
5,500.00	93.07	271.39	3,738.42	-308.15	-2,123.05	2,114.95	0.00	0.00	0.00
5,600.00	93.07	271.39	3,733.06	-305.72	-2,222.88	2,214.81	0.00	0.00	0.00
5,700.00	93.07	271.39	3,727.71	-303.29	-2,322.70	2,314.66	0.00	0.00	0.00
5,800.00	93.07	271.39	3,722.35	-300.86	-2,422.53	2,414.52	0.00	0.00	0.00
5,900.00	93.07	271.39	3,717.00	-298.43	-2,522.36	2,514.38	0.00	0.00	0.00
6,000.00	93.07	271.39	3,711.65	-296.00	-2,622.18	2,614.23	0.00	0.00	0.00
6,100.00	93.07	271.39	3,706.29	-293.57	-2,722.01	2,714.09	0.00	0.00	0.00
6,200.00	93.07	271.39	3,700.94	-291.14	-2,821.84	2,813.95	0.00	0.00	0.00
6,300.00	93.07	271.39	3,695.59	-288.71	-2,921.66	2,913.80	0.00	0.00	0.00
6,400.00	93.07	271.39	3,690.23	-286.28	-3,021.49	3,013.66	0.00	0.00	0.00
6,500.00	93.07	271.39	3,684.88	-283.86	-3,121.32	3,113.51	0.00	0.00	0.00
6,600.00	93.07	271.39	3,679.52	-281.43	-3,221.15	3,213.37	0.00	0.00	0.00
6,700.00	93.07	271.39	3,674.17	-279.00	-3,320.97	3,313.23	0.00	0.00	0.00
6,800.00	93.07	271.39	3,668.82	-276.57	-3,420.80	3,413.08	0.00	0.00	0.00
6,900.00	93.07	271.39	3,663.46	-274.14	-3,520.63	3,512.94	0.00	0.00	0.00
7,000.00	93.07	271.39	3,658.11	-271.71	-3,620.45	3,612.80	0.00	0.00	0.00
7,100.00	93.07	271.39	3,652.75	-269.28	-3,720.28	3,712.65	0.00	0.00	0.00
7,200.00	93.07	271.39	3,647.40	-266.85	-3,820.11	3,812.51	0.00	0.00	0.00
7,300.00	93.07	271.39	3,642.05	-264.42	-3,919.93	3,912.37	0.00	0.00	0.00
7,400.00	93.07	271.39	3,636.69	-261.99	-4,019.76	4,012.22	0.00	0.00	0.00
7,500.00	93.07	271.39	3,631.34	-259.56	-4,119.59	4,112.08	0.00	0.00	0.00
7,600.00	93.07	271.39	3,625.98	-257.13	-4,219.42	4,211.94	0.00	0.00	0.00
7,700.00	93.07	271.39	3,620.63	-254.70	-4,319.24	4,311.79	0.00	0.00	0.00
7,800.00	93.07	271.39	3,615.28	-252.27	-4,419.07	4,411.65	0.00	0.00	0.00
7,900.00	93.07	271.39	3,609.92	-249.84	-4,518.90	4,511.51	0.00	0.00	0.00
8,000.00	93.07	271.39	3,604.57	-247.41	-4,618.72	4,611.36	0.00	0.00	0.00
8,100.00	93.07	271.39	3,599.21	-244.98	-4,718.55	4,711.22	0.00	0.00	0.00
8,200.00	93.07	271.39	3,593.86	-242.55	-4,818.38	4,811.08	0.00	0.00	0.00
8,300.00	93.07	271.39	3,588.51	-240.12	-4,918.21	4,910.93	0.00	0.00	0.00
8,400.00	93.07	271.39	3,583.15	-237.69	-5,018.03	5,010.79	0.00	0.00	0.00
8,500.00	93.07	271.39	3,577.80	-235.26	-5,117.86	5,110.65	0.00	0.00	0.00
8,600.00	93.07	271.39	3,572.44	-232.83	-5,217.69	5,210.50	0.00	0.00	0.00



Planning Report

Database:	EDM 5000.1.13 Single User Db	Local Co-ordinate Reference:	Well 11H
Company:	SPUR ENERGY PARTNERS, LLC	TVD Reference:	RKB = 20' @ 3576.00usft (AKITA 57)
Project:	EDDY COUNTY, NM (NAD 83 - NME)	MD Reference:	RKB = 20' @ 3576.00usft (AKITA 57)
Site:	RED SKIES 10 FEDERAL	North Reference:	Grid
Well:	11H	Survey Calculation Method:	Minimum Curvature
Wellbore:	Wellbore #1		
Design:	PERMIT		

Planned Survey									
Measured Depth (usft)	Inclination (°)	Azimuth (°)	Vertical Depth (usft)	+N/-S (usft)	+E/-W (usft)	Vertical Section (usft)	Dogleg Rate (°/100usft)	Build Rate (°/100usft)	Turn Rate (°/100usft)
8,700.00	93.07	271.39	3,567.09	-230.40	-5,317.51	5,310.36	0.00	0.00	0.00
8,800.00	93.07	271.39	3,561.74	-227.97	-5,417.34	5,410.22	0.00	0.00	0.00
8,900.00	93.07	271.39	3,556.38	-225.54	-5,517.17	5,510.07	0.00	0.00	0.00
9,000.00	93.07	271.39	3,551.03	-223.11	-5,616.99	5,609.93	0.00	0.00	0.00
9,100.00	93.07	271.39	3,545.67	-220.68	-5,716.82	5,709.79	0.00	0.00	0.00
9,200.00	93.07	271.39	3,540.32	-218.25	-5,816.65	5,809.64	0.00	0.00	0.00
9,300.00	93.07	271.39	3,534.97	-215.82	-5,916.48	5,909.50	0.00	0.00	0.00
9,400.00	93.07	271.39	3,529.61	-213.39	-6,016.30	6,009.36	0.00	0.00	0.00
9,436.06	93.07	271.39	3,527.68	-212.52	-6,052.30	6,045.36	0.00	0.00	0.00
RED SKIES 11H LTP: 1430' FNL, 100' FWL									
9,486.15	93.07	271.39	3,525.00	-211.30	-6,102.30	6,095.38	0.00	0.00	0.00
RED SKIES 11H BHL: 1430' FNL, 50' FWL									

Design Targets									
Target Name	Dip Angle (°)	Dip Dir. (°)	TVD (usft)	+N/-S (usft)	+E/-W (usft)	Northing (usft)	Easting (usft)	Latitude	Longitude
RED SKIES 11H SHL - hit/miss target - Shape - Point	0.00	0.00	0.00	0.00	0.00	642,485.80	565,453.60	32.7662036	-104.2548770
RED SKIES 11H KOP - plan hits target center - Point	0.00	0.00	2,795.48	-290.61	-3.11	642,195.19	565,450.49	32.7654048	-104.2548878
RED SKIES 11H BHL - plan hits target center - Point	0.00	0.01	3,525.00	-211.30	-6,102.30	642,274.50	559,351.30	32.7656337	-104.2747298
RED SKIES 11H LTP: - plan misses target center by 0.08usft at 9436.06usft MD (3527.68 TVD, -212.52 N, -6052.30 E) - Point	0.00	0.00	3,527.68	-212.60	-6,052.30	642,273.20	559,401.30	32.7656300	-104.2745672
RED SKIES 11H FTP - plan hits target center - Point	0.00	0.00	3,800.00	-336.10	-974.80	642,149.70	564,478.80	32.7652817	-104.2580491



Project: EDDY COUNTY, NM (NAD 83 - NME)
Site: RED SKIES 10 FEDERAL
Well: 11H
Wellbore: Wellbore #1
Design: PERMIT

PROJECT DETAILS: EDDY COUNTY, NM (NAD 83 - NME)

Geodetic System: US State Plane 1983
Datum: North American Datum 1983
Ellipsoid: GRS 1980
Zone: New Mexico Eastern Zone
System Datum: Mean Sea Level

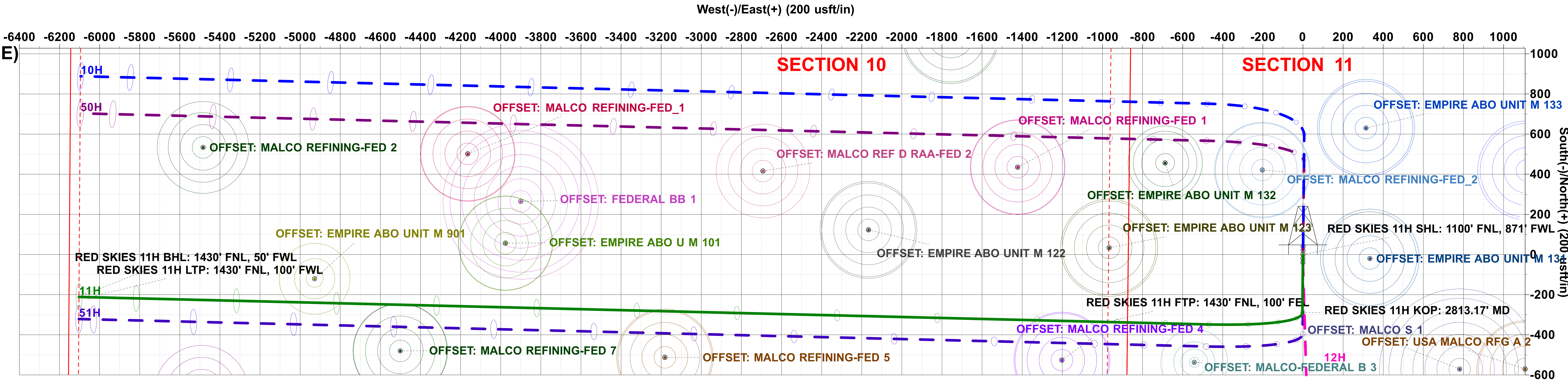

WELL DETAILS: 11H

Rig Name:		AKITA 57 RKB = 20' @ 3576.00usft (AKITA 57)			
		Ground Level:		3556.00	
+N/-S	+E/-W	Northing	Easting	Latitude	Longitude
0.00	0.00	642485.80	565453.60	32.7662036	-104.2548770

SECTION DETAILS

Sec	MD	Inc	Azi	TVD	+N/-S	+E/-W	Dleg	VSect
1	0.00	0.00	0.00	0.00	0.00	0.00	0.00	0.00
2	300.00	0.00	0.00	300.00	0.00	0.00	0.00	0.00
3	657.56	7.15	180.61	656.63	-22.28	-0.24	2.00	-0.30
4	2813.17	7.15	180.61	2795.48	-290.61	-3.11	0.00	-3.94
5	3819.07	60.00	271.39	3624.06	-348.03	-484.59	6.00	476.00
6	4019.07	60.00	271.39	3724.06	-343.82	-657.74	0.00	649.21
7	4349.76	93.07	271.39	3800.00	-336.10	-974.80	10.00	966.36
8	9436.06	93.07	271.39	3527.68	-212.52	-6052.30	0.00	6045.36
9	9486.15	93.07	271.39	3525.00	-211.30	-6102.30	0.00	6095.38

DESIGN TARGET DETAILS

Name	TVD	+N/-S	+E/-W	Northing	Easting	Latitude	Longitude
RED SKIES 11H BHL: 1430' FNL, 50' FWL	3525.00	-211.30	-6102.30	642274.50	559351.30	32.7656337	-104.2747299
RED SKIES 11H FTP: 1430' FNL, 100' FEL	3800.00	-336.10	-974.80	642149.70	564478.80	32.7652817	-104.2580491
RED SKIES 11H KOP: 2813.17' MD	2795.48	-290.61	-3.11	642195.19	565450.49	32.7654048	-104.2548879
RED SKIES 11H LTP: 1430' FNL, 100' FWL	3527.68	-212.60	-6052.30	642273.20	559401.30	32.7656300	-104.2745672
RED SKIES 11H SHL: 1100' FNL, 871' FWL	0.00	0.00	0.00	642485.80	565453.60	32.7662036	-104.2548770

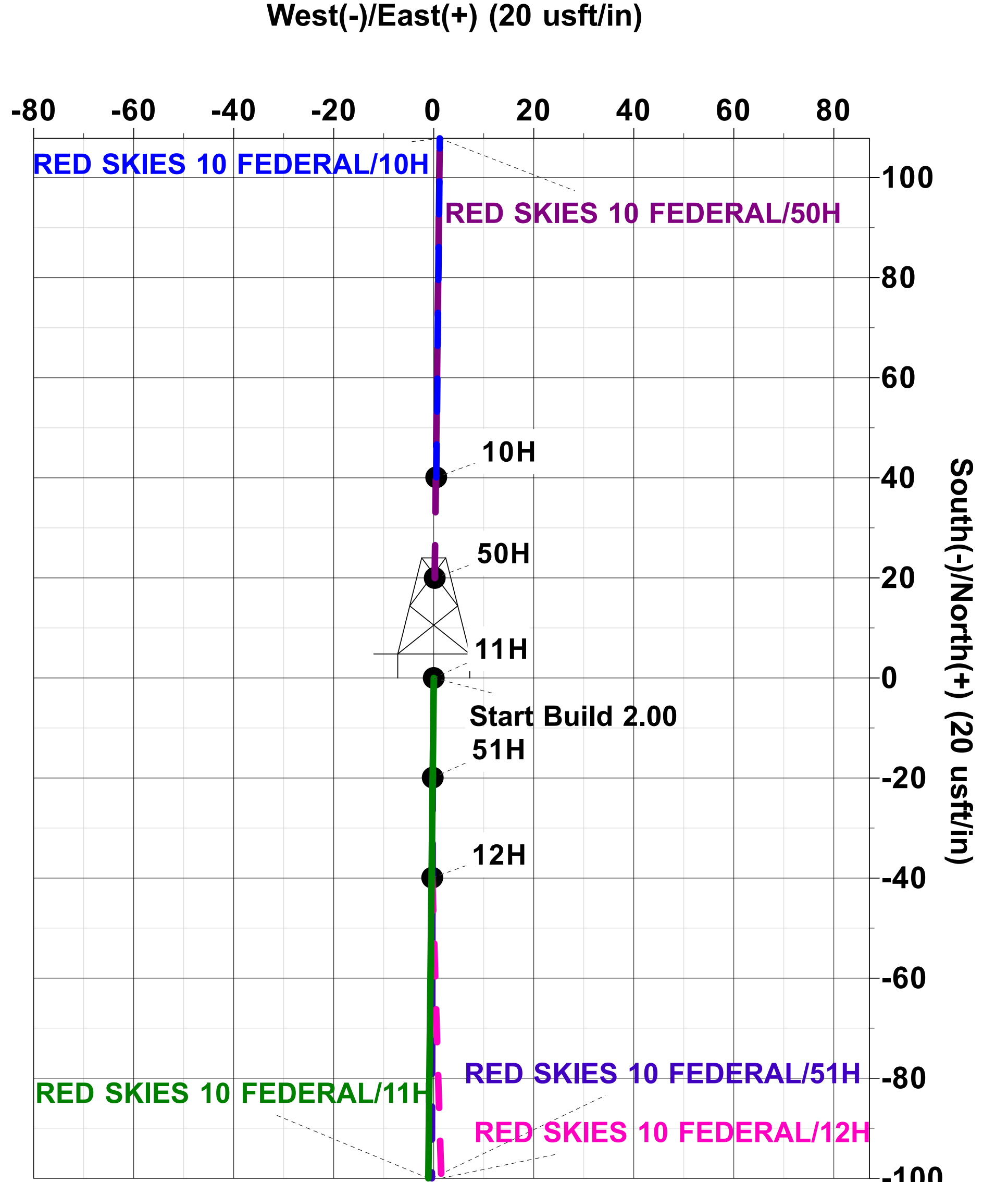
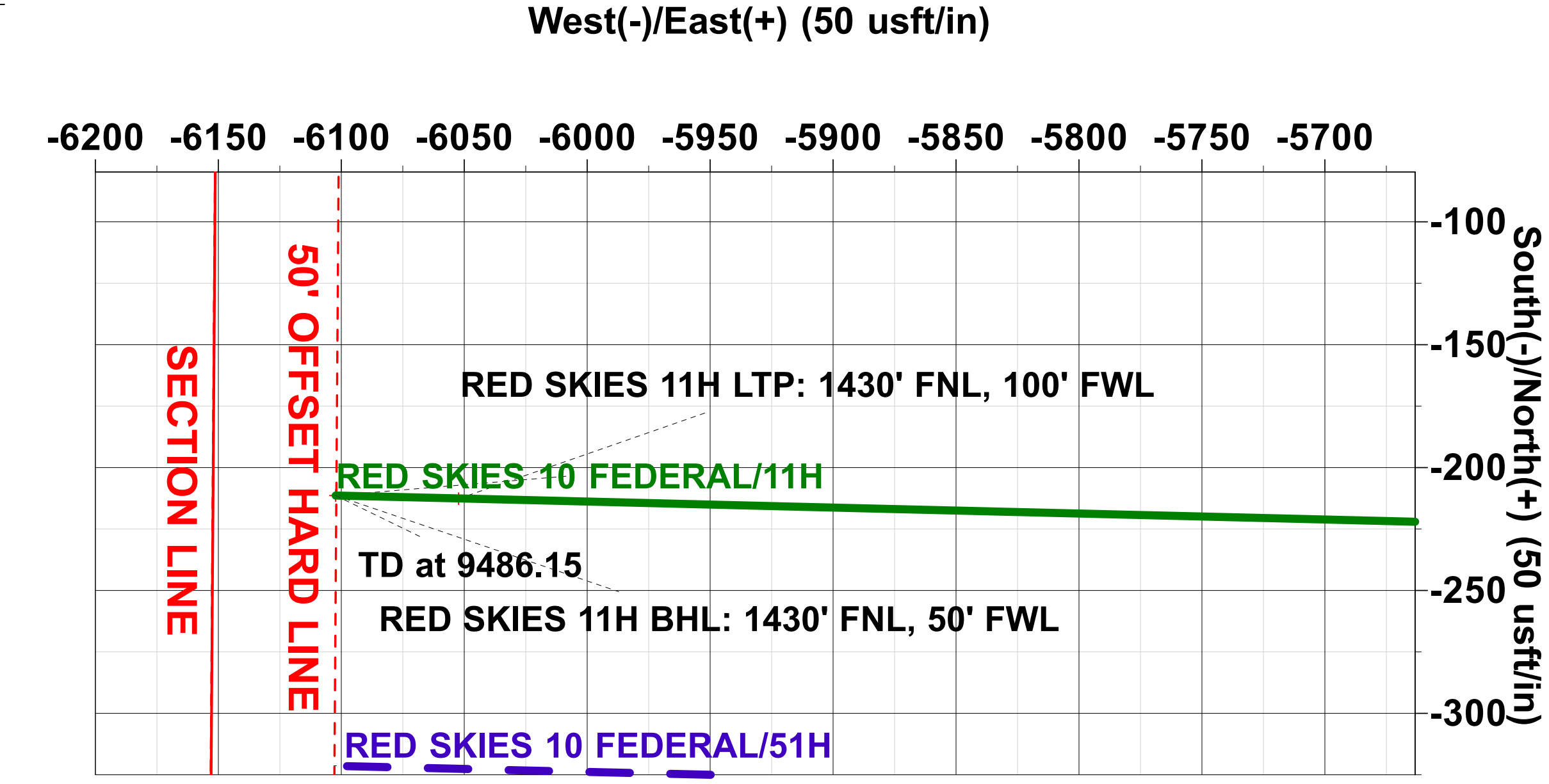
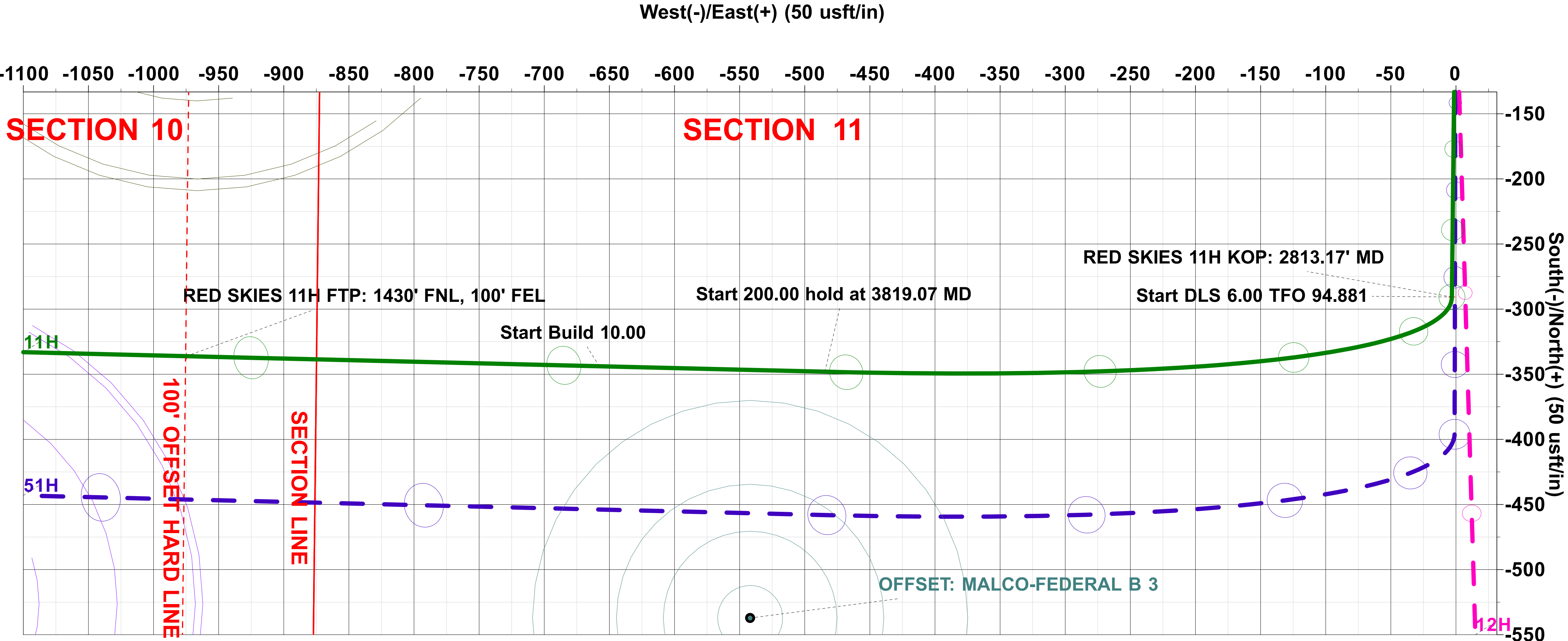
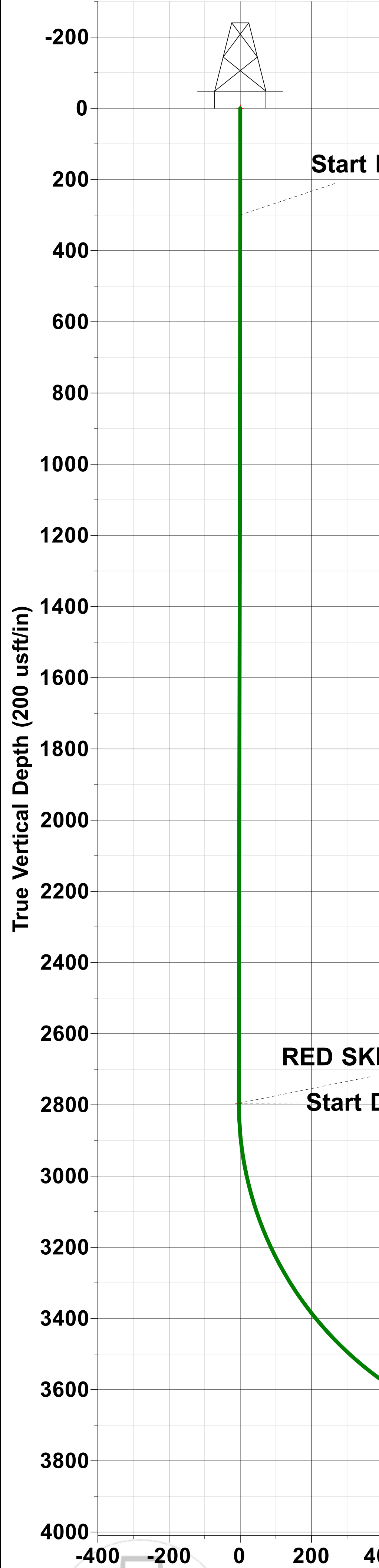

Note: this document is provided for information purposes only. Prototype Well Planning LLC, it's employees, and agents make no guarantee or warranty, expressed or implied, as to the accuracy of this electronic file. The data included here and may be subject to error, while corruption, change, alteration, or update without any notice to the user. Prototype Well Planning LLC, it's employees, and it's agents assume no responsibility, expressed or implied, for any damages incurred either directly or indirectly by the use of this document. The users agree to the above specified terms of this document and agrees to verify the data enclosed to ascertain its accuracy for their intended use. If these conditions are unacceptable, user shall discard this document.

Pecos District

Application for Permit to Drill

Conditions of Approval

Geology Concerns

Potash	<input checked="" type="checkbox"/> None	<input type="checkbox"/> Secretary	<input type="checkbox"/> R-111-P
Cave/Karst	<input type="checkbox"/> Medium	<input checked="" type="checkbox"/> High	<input type="checkbox"/> Critical
H2S	<input type="checkbox"/> None	<input type="checkbox"/> Below 100 PPM	<input checked="" type="checkbox"/> Above 100 PPM
Other	<input type="checkbox"/> 4 String Area	<input type="checkbox"/> Capitan Reef	<input type="checkbox"/> SWD Well

Note: The geology of the area where the well is being drilled determines the COAs that apply, not the above table.

Additional Engineering Requirements

Surface casing must be set at: 200 feet

Intermediate casing must be set at: 1,865 feet

General Requirements

1. Changes to the approved APD casing program need prior approval.
2. The Bureau of Land Management (BLM) will be notified in advance for a representative to witness:
 - a. Well spudding (minimum of 24 hours notice)
 - b. Setting and/or cementing of all casing strings (minimum of 4 hours notice)
 - c. BOPE tests (minimum of 4 hours notice)

Eddy County

620 East Greene Street, Carlsbad, NM 88220

(575) 361-2822

BLM_NM_CFO_DrillingNotifications@BLM.GOV

Lea County

414 West Taylor, Hobbs, NM 88240

(575) 689-5981

3. The initial wellhead installed on the well will remain on the well with spools used as needed.
4. Unless the production casing has been run and cemented or the well has been properly plugged, the drilling rig shall not be removed from over the hole without prior approval.

- a. In the event the operator has proposed to drill multiple wells utilizing a skid/walking rig:
 - i. Operator shall secure the wellbore on the current well, after installing and testing the wellhead, by installing a blind flange of like pressure rating to the wellhead and a pressure gauge that can be monitored while drilling is performed on the other well(s).
 - b. When the operator proposes to set surface casing with a Spudder Rig:
 - i. Notify the BLM when moving in and removing the Spudder Rig.
 - ii. Notify the BLM when moving in the 2nd Rig. Rig to be moved in within 90 days of notification that Spudder Rig has left the location.
 - iii. BOP/BOPE test to be conducted per 43 CFR 3172.6 as soon as 2nd Rig is rigged up on well.
5. Floor controls are required for 3M or greater systems. These controls will be on the rig floor, unobstructed, readily accessible to the driller, and will always be operational during drilling and/or completion activities. Rig floor is defined as the area immediately around the rotary table or the area immediately above the substructure on which the draw works are located (this does not include the doghouse or stairway area).
6. The record of the drilling rate along with the GR/N well log run from TD to surface (horizontal well – vertical portion of hole) shall be submitted to the BLM office as well as all other logs run on the borehole 30 days from completion. If available, a digital copy of the logs is to be submitted in addition to the paper copies. The Rustler top and top and bottom of Salt are to be recorded on the Completion Report.

Pressure Control

1. All blowout preventer (BOP) and related equipment (BOPE) shall comply with well control requirements as described in 43 CFR 3172.6 and API STD 53 Sec. 5.3.
2. 5M or higher systems require an HCR valve, remote kill line, and annular to match. The remote kill line is to be installed prior to testing the system and tested to stack pressure.
3. The appropriate BLM office shall be notified a minimum of 4 hours in advance for a representative to witness the tests.
 - a. The test shall be run on a 5000 psi chart for a 2-3M BOP/BOP, on a 10000 psi chart for a 5M BOP/BOPE, and on a 15000 psi chart for a 10M BOP/BOPE. If a linear chart is used, it shall be a one hour chart. A circular chart shall have a maximum 2 hour clock. If a twelve hour or twenty-four hour chart is used, tester shall make a notation that it is run with a two hour clock.
 - b. The results of the test shall be reported to the appropriate BLM office.
 - c. All tests are required to be recorded on a calibrated test chart. A copy of the BOP/BOPE test chart and a copy of independent service company test will be submitted to the appropriate BLM office.

- d. The BOP/BOPE test shall include a low pressure test from 250 to 300 psi. The test will be held for a minimum of 10 minutes if test is done with a test plug and 30 minutes without a test plug. This test shall be performed prior to the test at full stack pressure.
 - e. BOP/BOPE must be tested by an independent service company within 500 feet of the top of the Wolfcamp formation if the time between the setting of the intermediate casing and reaching this depth exceeds 20 days. This test does not exclude the test prior to drilling out the casing shoe as per 43 CFR 3172.6(b)(9).
 - f. In a water basin, for all casing strings utilizing slips, these are to be set as soon as the crew and rig are ready and any fallback cement remediation has been done. The casing cut-off and BOP installation can be initiated four hours after installing the slips, which will be approximately six hours after bumping the plug. For those casing strings not using slips, the minimum wait time before cut-off is eight hours after bumping the plug. BOP/BOPE testing can begin after cut-off or once cement reaches 500 psi compressive strength (including lead when specified), whichever is greater. However, if the float does not hold, cut-off cannot be initiated until cement reaches 500 psi compressive strength (including lead when specified).
 - g. In potash areas, for all casing strings utilizing slips, these are to be set as soon as the crew and rig are ready and any fallback cement remediation has been done. For all casing strings, casing cut-off and BOP installation can be initiated at twelve hours after bumping the plug. However, no tests shall commence until the cement has had a minimum of 24 hours setup time.
 - h. The tests shall be done by an independent service company utilizing a test plug, not a cup or J-packer and can be initiated immediately with the casing valve open. The operator also has the option of utilizing an independent tester to test without a plug (i.e. against the casing) pursuant to 43 CFR 3172 with the pressure not to exceed 70% of the burst rating for the casing. Any test against the casing must meet the WOC time for water basin (8 hours) or potash (24 hours) or 500 pounds compressive strength, whichever is greater, prior to initiating the test (see casing segment as lead cement may be critical item).
4. If the operator has proposed using a 5,000 (5M) Annular on a 10M BOP:
- a. Minimum working pressure of the blowout preventer (BOP) and related equipment (BOPE) required for drilling below the surface casing shoe shall be 10,000 (10M) psi.
5. If the operator has proposed a multi-bowl wellhead assembly in the APD. The following requirements must be met:
- a. Wellhead shall be installed by manufacturer's representatives (submit documentation with subsequent sundry).

- b. If the welding is performed by a third party, the manufacturer's representative shall monitor the temperature to verify that it does not exceed the maximum temperature of the seal.
 - c. Manufacturer representative shall install the test plug for the initial BOP test.
 - d. Whenever any seal subject to test pressure is broken, all the tests in 43 CFR 3172 must be followed.
 - e. If the cement does not circulate and one inch operations would have been possible with a standard wellhead, the well head shall be cut off, cementing operations performed, and another wellhead installed.
6. If a variance is approved for break testing the BOPE, the following requirements apply:
- a. BOPE break testing is only approved for a BOP rated at 5M or less.
 - b. Approval is only for the intermediate hole sections, so long as those sections do not go deeper than the Bone Springs formation.
 - c. The Annular Preventer must be tested to a minimum of 70% of BOPE working pressure and shall be higher than the MASP.
 - d. A full BOP test shall be performed every 21 days (at a minimum).
 - e. A full BOP test is required prior to drilling the first intermediate hole section (if applicable). If any subsequent intermediate hole interval is deeper than the first, a full BOP test shall be required (a maximum 200 foot difference in true vertical depth (TVD) is allowed).
 - f. BOPE break testing is not permitted for drilling the production hole section.
 - g. While in transfer, the BOP shall be secured by the hydraulic carrier or cradle.
 - h. If any repairs or replacements of the BOPE is required, the BOPE shall be tested as required by 43 CFR 3172.
 - i. Pressure tests shall be performed on any BOPE components that have been disconnected. A low pressure (250-300 psi) and a high pressure (BOP max pressure rating) test are required.
 - j. If a testing plug is used, pressure shall be maintained for at least 10 minutes. If there is any bleed off in pressure, the test shall be considered to have failed.
 - k. If no testing plug is used, pressure shall be maintained for at least 30 minutes. If there is a decline in pressure of more than 10 percent, the test shall be considered to have failed.
 - l. The appropriate Bureau of Land Management (BLM) office shall be notified a minimum of 4 hours before testing occurs.
 - m. Any well control event while drilling require notification to the BLM Petroleum Engineer (575-706-2779) prior to the commencement of any BOPE Break Testing operations.
 - n. If break testing is not used, then a full BOPE test shall be conducted.
7. If a variance is approved for a flexible hose to be installed from the BOP to the choke manifold, the following requirements apply:
- a. The flex line must meet the requirements of API 16C.

- b. Check condition of flexible line from BOP to choke manifold (replace if exterior is damaged or if line fails test).
- c. Line is to be as straight as possible with no hard bends and is to be anchored according to Manufacturer's requirements.
- d. The flexible hose can be exchanged with a hose of equal size and equal or greater pressure rating.
- e. Anchor requirements, specification sheet and hydrostatic pressure test certification matching the hose in service, shall be onsite for review. These documents shall be posted in the company man's trailer and on the rig floor.

Casing and Cement

1. Changes to the approved cement program need prior approval if the altered cement plan has less volume or strength or if the changes are substantial (i.e. Multistage tool, ECP, etc.).
2. On any well approved for a 5M BOPE system or greater, a pressure integrity test of each casing shoe shall be performed. The formation at the shoe shall be tested to a minimum of the mud weight equivalent anticipated to control the formation pressure to the next casing depth or at total depth of the well. This test shall be performed before drilling more than 20 feet of new hole.
3. Provide compressive strengths (including hours to reach required 500 pounds compressive strength) prior to cementing each casing string. Have well specific cement details onsite prior to pumping the cement for each casing string.
4. The surface casing shall be set at a minimum of 25 feet into the Rustler Anhydrite and 80 feet above the salt and cemented to the surface.
 - a. If cement does not circulate to the surface, the appropriate BLM office shall be notified and a temperature survey utilizing an electronic type temperature survey with surface log readout will be used or a cement bond log shall be run to verify the top of the cement. Temperature survey will be run a minimum of six hours after pumping cement and ideally between 8-10 hours after completing the cement job.
 - b. Wait on cement (WOC) time for a primary cement job will be a minimum of 8 hours (or 24 hours in the Potash Area) or 500 pounds compressive strength, whichever is greater. (This is to include the lead cement)
 - c. Wait on cement (WOC) time for a remedial job will be a minimum of 4 hours after bringing cement to surface or 500 pounds compressive strength, whichever is greater.
 - d. If cement falls back, remedial cementing will be done prior to drilling out that string.

5. Intermediate casing must be kept fluid filled to meet BLM minimum collapse requirement.
6. Intermediate casing must be cemented to surface. For medium/high cave/karst, potash, and Capitan Reef, wait on cement (WOC) time for a primary cement job is to include the lead cement slurry.
7. The production cement should tie-back at least 200 feet (500 feet in Secretary Potash, surface in R-111-P potash) into previous casing string. Operator shall provide method of verification.
8. Production liner cement should tie-back at least 100 feet into previous casing string. Operator shall provide verification of cement top.
9. In WIPP Areas, cement must come to surface on the first three casing strings.
10. If cement does not circulate to surface on the first two casing strings, the cement on the 3rd casing string must come to surface. The casing integrity test can be done (prior to the cement setting up) immediately after bumping the plug.
11. No pea gravel permitted for remedial cement or fall back remedial cement without prior authorization from a BLM petroleum engineer.
12. If hardband drill pipe is rotated inside casing, returns will be monitored for metal. If metal is found in samples, drill pipe will be pulled and rubber protectors which have a larger diameter than the tool joints of the drill pipe will be installed prior to continuing drilling operations.
13. DV tools:
 - a. First stage to DV tool (The DV tool may be cancelled if cement circulates to surface on the first stage):
 - i. Cement to circulate. If cement does not circulate off the DV tool, contact the appropriate BLM office before proceeding with second stage cement job.
 - b. Second stage above DV tool:
 - i. For intermediate casing, cement to surface.
 - ii. For production casing, cement should tie-back at least 200 feet (500 feet in Secretary Potash, surface in R-111-P potash) into previous casing string. Operator shall provide method of verification.
 - iii. If cement does not circulate, contact the appropriate BLM office.

14. Potash Areas:

- a. Wait on cement (WOC) time for a primary cement job is to include the lead cement slurry.
- b. After cementing but before commencing any tests, the casing string shall stand cemented under pressure until both of the following conditions have been met:
 - i. Cement reaches a minimum compressive strength of 500 psi for all cement blends
 - ii. Until cement has been in place at least 24 hours.
- c. WOC time will be recorded in the driller's log.
- d. Whenever a casing string is cemented in the R-111-P potash area, the NMOCD requirements shall be followed.
- e. In R111 Potash Areas, if cement does not circulate to surface on the first two salt protection casing strings, the cement on the 3rd casing salt string must come to surface.
- f. In Secretary Potash Areas, if cement does not circulate to surface on the first two casing strings, the cement on the 3rd casing string must come to surface.

15. Wait on cement (WOC) for Water Basin:

- a. After cementing but before commencing any tests, the casing string shall stand cemented under pressure until both of the following conditions have been met:
 - i. Cement reaches a minimum compressive strength of 500 psi at the shoe
 - ii. Until cement has been in place at least 8 hours.
- b. WOC time will be recorded in the driller's log.

16. Medium/High/Critical Cave/Karst Areas:

- a. Wait on cement (WOC) time for a primary cement job is to include the lead cement slurry.
- b. In Critical Cave/Karst Areas cement must come to surface on the first three casing strings.
- c. In Medium and High Cave/Karst Areas, if cement does not circulate to surface on the first two casing strings, the cement on the 3rd casing string must come to surface.
- d. In Critical Cave/Karst Areas, if cement does not circulate to surface on the first three casing strings, the cement on the 4th casing string must come to surface.

Drilling Mud

1. Mud system monitoring equipment, with derrick floor indicators and visual and audio alarms, shall be operating before drilling into the Wolfcamp formation and shall be used until production casing is run and cemented.

Waste Material and Fluids

1. All waste (i.e. drilling fluids, trash, salts, chemicals, sewage, gray water, etc.) created as a result of drilling operations and completion operations shall be safely contained and

disposed of properly at a waste disposal facility. No waste material or fluid shall be disposed of on the well location or surrounding area.

2. Porto-johns and trash containers will be on-location during fracturing operations or any other crew-intensive operations.

Special Requirements

1. Communitization Agreement
 - a. The operator will submit a Communitization Agreement to the Santa Fe Office (301 Dinosaur Trail, Santa Fe, NM 87508), at least 90 days before the anticipated date of first production from a well subject to a spacing order issued by the New Mexico Oil Conservation Division.
 - b. The Communitization Agreement will include the signatures of all working interest owners in all Federal and Indian leases subject to the Communitization Agreement (i.e., operating rights owners and lessees of record), or certification that the operator has obtained the written signatures of all such owners and will make those signatures available to the BLM immediately upon request.
 - i. The operator will submit an as-drilled survey well plat of the well completion, but are not limited to, those specified in 43 CFR 3171 and 3172.
 - ii. If the operator does not comply with this condition of approval, the BLM may take enforcement actions that include, but are not limited to, those specified in 43 CFR 3163.1.
 - c. In addition, the well sign shall include the surface and bottom hole lease numbers.
 - i. When the Communitization Agreement number is known, it shall also be on the sign.
2. Unit Wells
 - a. The well sign for a unit well shall include the unit number in addition to the surface and bottom hole lease numbers. This also applies to participating area numbers.
 - i. If a participating area has not been established, the operator can use the general unit designation, but will replace the unit number with the participating area number when the sign is replaced.
 - b. Commercial Well Determination
 - i. A commercial well determination shall be submitted after production has been established for at least six months (this is not necessary for secondary recovery unit wells).
3. Hydrogen Sulfide (H₂S)
 - a. If H₂S is encountered, provide measured values and formations to the BLM.
 - b. An H₂S area must meet 43 CFR 3176 requirements, which includes equipment and personnel/public protection items.

- c. An H2S Drilling Plan shall be activated 500 feet prior to drilling into any formation designated as having H2S.
 - d. Hydrogen Sulfide monitors shall be installed prior to drilling out the surface shoe. If H2S is detected in concentrations greater than 100 ppm, the Hydrogen Sulfide area shall meet 43 CFR 3176 requirements, which includes equipment and personnel/public protection items.
4. Capitan Reef
- a. If lost circulation (50% or greater) occurs below the Base of the Salt, the operator shall do the following (Use this for 3 string wells in the Capitan Reef, if it is a 4 string well ensure fresh water based mud is used across the Capitan interval):
 - i. Switch to fresh water mud to protect the Capitan Reef and use fresh water mud until setting the intermediate casing. The appropriate BLM office is to be notified for a PET to witness the switch to fresh water.
 - ii. Daily drilling reports from the Base of the Salt to the setting of the intermediate casing are to be submitted to the BLM CFO engineering staff via e-mail by 0800 hours each morning. Any lost circulation encountered is to be recorded on these drilling reports.
 - iii. The daily drilling report should show mud volume per shift/tour.
 - iv. Failure to submit these reports will result in an Incidence of Non-Compliance being issued for failure to comply with the Conditions of Approval.
 - v. If not already planned, the operator shall run a caliper survey for the intermediate well bore and submit to the appropriate BLM office.
5. Salt Water Disposal Wells
- a. The operator shall supply the BLM with a copy of a mudlog over the permitted disposal interval and estimated in situ water salinity based on open-hole logs.
 - b. If hydrocarbons are encountered while drilling, the operator shall notify the BLM.
 - c. The operator shall provide to the BLM a summary of formation depth picks based on mudlog and geophysical logs along with a copy of the mudlog and open-hole logs from total depth to top of Devonian.
 - d. An NOI sundry with the completion procedure for this well shall be submitted and approved prior to commencing completion work. The procedure will be reviewed to verify that the completion proposal will allow the operator to:
 - i. Properly evaluate the injection zone utilizing open-hole logs, swab testing and/or any other method to confirm that hydrocarbons cannot be produced in paying quantities. This evaluation shall be reviewed by the BLM prior to injection commencing.
 - ii. Restrict the injection fluid to the approved formation.
 - iii. If a step rate test will be run, an NOI sundry shall be submitted to the BLM for approval.

- e. If off-lease water will be disposed in this well, the operator shall provide proof of right-of-way approval.
6. WIPP Requirements
- a. If the proposed surface well or bottom hole is located within 330 feet of the WIPP Land Withdrawal Area boundary:
 - i. Daily drilling reports, logs, and deviation survey information are required to be submitted to the Bureau of Land Management Engineering Department and the U.S. Department of Energy (per requirements of the Joint Powers Agreement) until a total vertical depth of 7,000 feet is reached. These reports will have at a minimum the rate of penetration and a clearly marked section showing the deviation for each 500-foot interval. Operator may be required to do more frequent deviation surveys based on the daily information submitted and may be required to take other corrective measures.
 - ii. Information will also be provided to the New Mexico Oil Conservation Division after drilling activities have been completed.
 - iii. Upon completion of the well, the operator shall submit a complete directional survey.
 - iv. Any future entry into the well for purposes of completing additional drilling will require supplemental information.
 - b. Required information shall be emailed to OilGasReports@wipp.ws.
 - i. Attached files must not be greater than 20 MB.
 - ii. Call WIPP Tech Support at 575-234-7422, during the hours of 7:00am to 4:30pm, if there are any issues sending to this address.



Permian Drilling Hydrogen Sulfide Drilling Operations Plan Red Skies 10 Federal Development

Open drill site. No homes or buildings are near the proposed location.

1. Escape

Personnel shall escape upwind of wellbore in the event of an emergency gas release. Escape can take place through the lease road on the Southeast side of the location. Personnel need to move to a safe distance and block the entrance to location. If the primary route is not an option due to the wind direction, then a secondary egress route should be taken.

Secondary Briefing Area

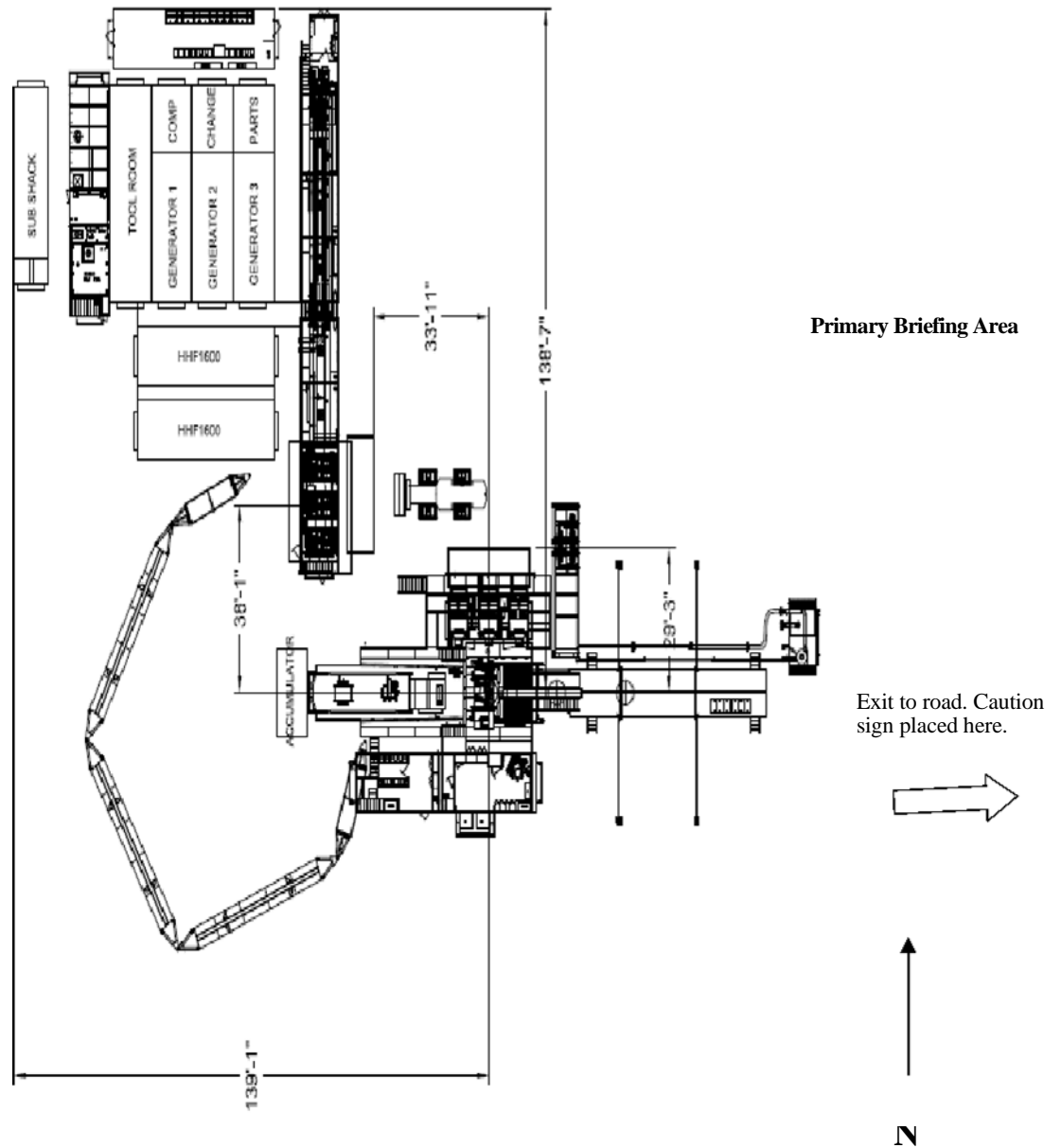

Exit to road. Caution sign placed here.

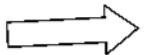

N

Secondary Egress



WIND: Prevailing winds are from the Southwest





RIG # 57_{1,150 HP Double Mast Drilling Rig}

SUBSTRUCTURE

One Piece Step Down

Floor Height: 18' 9" (on 4' pony sub moving system)

Clear Height (beneath rotary beams): 15' 5"

Rotary Capacity: 400,000 lbf

Max Pipe Setback: 400,000 lbf

Note: All floor heights above are based on the substructure sitting on 6" mats & 4' pony sub moving system

MAST

106' telescoping, Drill Line: 1-1/8"

Static Hook Load: 440,000 lbf

Racking Capacity: 18,000' of 4" DP, 12,500' of 5" DP

DRAWWORKS

TSM 850 425,000lbs w/ 10 Lines

Input Power: 1,150 hp AC traction motor

Main Brake: 1,150 hp AC traction motor (Dynamic)

Aux Parking Brake: Eaton brake & drum / band brake system

TOP DRIVE

Tesco EXI 600 AC 350 Ton: Max speed 220 rpm,

Continuous Drill Torque: 30,000 ft-lbs

Max Torque (Make / Break): 45,000 ft-lbs

600 hp AC induction motor & drive system with PLC

250 Ton 5 x 36" Becket Block Assembly

IRON ROUGHNECK

NOV ST-90C Conn Range: 4 1/4" to 8 1/2"

Spin Speed: 75 rpm nominal on 5" drill pipe

Spin Torque: 1,750 ft-lbs

Maximum Make-up torque: 60,000 ft-lbs

Maximum Break-out torque: 80,000 ft-lbs

ROTARY TABLE

National 27 1/2" 500 Ton with hydraulic drive to position tools only

27 1/2" Diameter opening

POWER SYSTEM

VFD, MCC, Eaton Drives, Current Power Systems Controls, three Caterpillar C32 gen

sets, 1220 BHP.

MUD PUMP #1

HHF1600 Triplex Rated Power: 1600 hp

Stroke: 12"

Input Power: 1500 hp AC traction motor

Pressure Rating: 5000 psi

MUD PUMP #2

HHF1600 Triplex Rated Power: 1600 hp

Stroke: 12"

Input Power: 1500 hp AC traction motor

Pressure Rating: 5000 psi

MUD TANKS

Two Tank system w/ 1200 bbls total capacity

Shakers: Three MI Swaco Mongoose 4 panel dual motion

Mud Gas Separator: MI Swaco 4' OD x 12' tall

Pill Tank: 54 bbls

MUD SYSTEM

5000 psi Max Pressure

5" Main plumbing and standpipe

SCALPING TANK

Main Tank: 186 bbls capacity

Trip Tank: 24 bbls capacity

Shakers: Three NOV Venom shakers dual motion

BOP (NACE)

11" x 5000 psi WP Spherical Annular

11" x 5000 psi WP Double Ram

11" x 5000 psi WP Single Ram (Optional)

MANIFOLD

3-1/8" 5,000 psi c/w two 3 1/8" manual chokes

ACCUMULATOR

CTI: 160 gal 6 station 3000 psi, c/w N2 Backup & electric triplex pump

CATWALK

Ja-co Power Catwalk, tubular max length 47' 6", max OD 13 5/8", max weight 10,000lbs

TUBULARS

Drill Pipe: Supplied as needed, per availability

Drill Collars & heavywate: Supplied as needed, per availability

MISC.

Water Tank: 409 bbls; Fuel Tank 189 bbls; Screw Compressor

Boiler: 125 hp with Full Winterization

MOVING SYSTEM:

Walking beam hydraulic pony sub moving system for linear motion & side shift.

350' of Utility Suitcase style [50' lengths] connection for hydraulic and electrical supply.

TOOL/ STORAGE/ CAMP

Parts Storage Room and Tool House Room

Rig Manage Trailer: 14' x 44' skid mounted

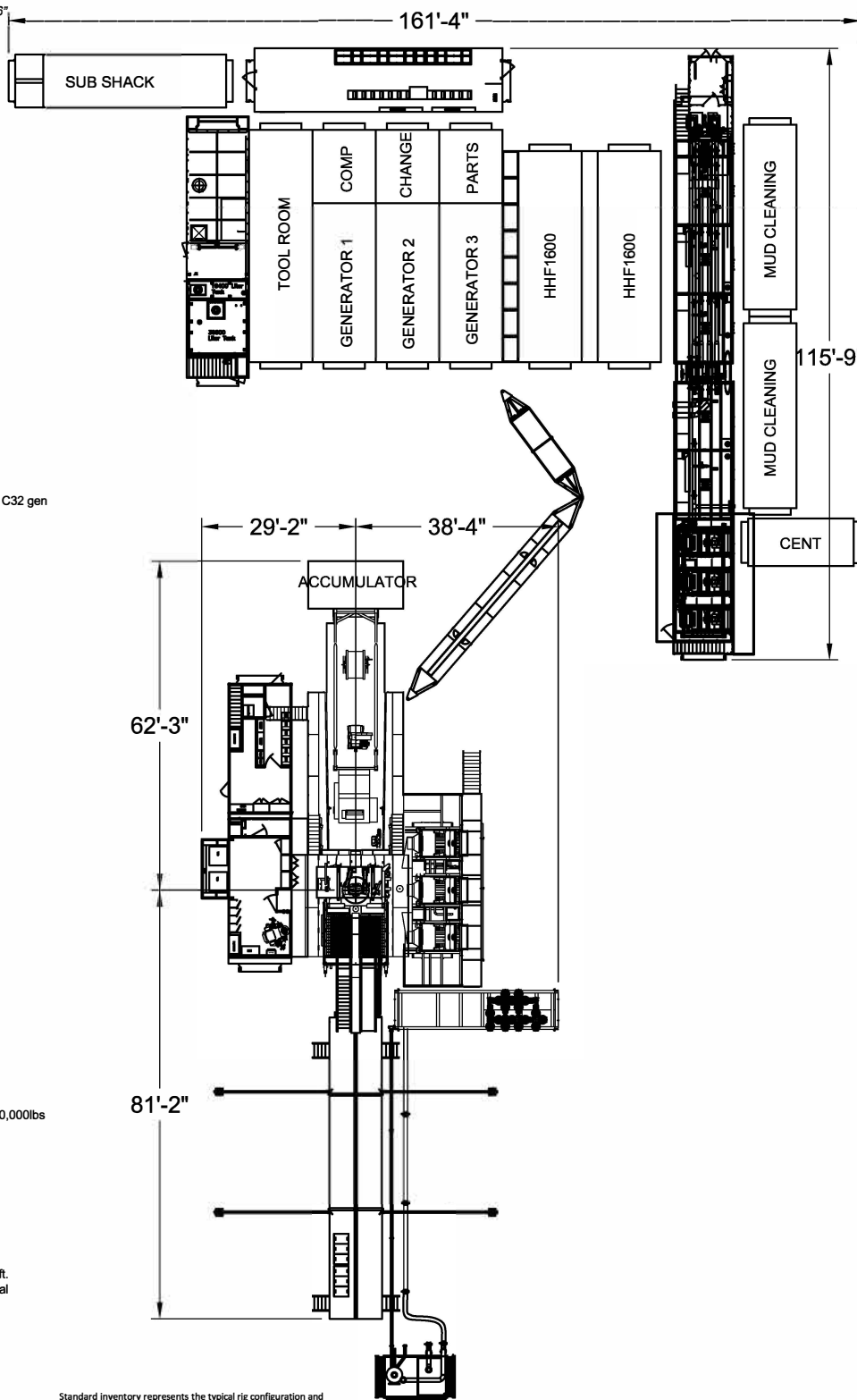

Standard inventory represents the typical rig configuration and inventory available, but specifications are subject to slight modifications from time to time due to customer requirements.

All ratings quoted herein are manufacturer specifications. AKITA's normal operating parameters are 90% of manufacturer mast ratings and 80% of mud pump manufacturer pressure rating. Operation of rig equipment beyond these parameters requires approval from AKITA field office management.

© AKITA DRILLING August, 2020

TRANSCEND RIG 4	Contractor Specification
Make	Schram
Model	TXD 130
Year of Manufacture	2006
Truck Mounted	YES
Rated Drilling Depth	130,000# hook load
Rated Depth with Tubing	
Derrick Height	69' 9"
Derrick Type	Telescoping Hydraulic
Derrick Capacity	130,000#
Elevators	N/A
Drawworks	760 HP Detroit
Wire Diameter	Hydraulic
Workfloor Max Height	8'
Tongs	Hydraulic Iron Roughneck
Slips	Manual Slips
Included Tubing Handling Tools	<ul style="list-style-type: none"> • 13 3/8" handling tools
Included Rod Handling Tools	85jts of 4.5" drill pipe
BOP Class Compatibility	
Weight Indicator	Hydraulic
Rig Safety Equipment	Eye wash station, fire extengushers, wind sock
Pad Size Requirements/Limitations	60' x 60'
Guy Line Spacing	N/A
Other Supplied Rig Equipment	<p>Standard Rig Hand Tools:</p> <ul style="list-style-type: none"> • (2) 36" pipe wrenches • (2) 24" pipe wrenches • (2) 18" pipe wrenches • (1) 24" crescent wrench • (2) 12" crescent wrenches • (1) 4 lb shop hammer • (1) 12 lb sledge hammer • (1) 4 foot pry bar • Vehicles for Contractor personnel • Air Impact Wrench with Sockets • Mud Scales (as needed) <p>1- F800 pump 1- Pill pit 80bbl 1- 400 bbl mud mix 1- Shaker 150mesh 1- 500 bbl fresh water frac tank</p>

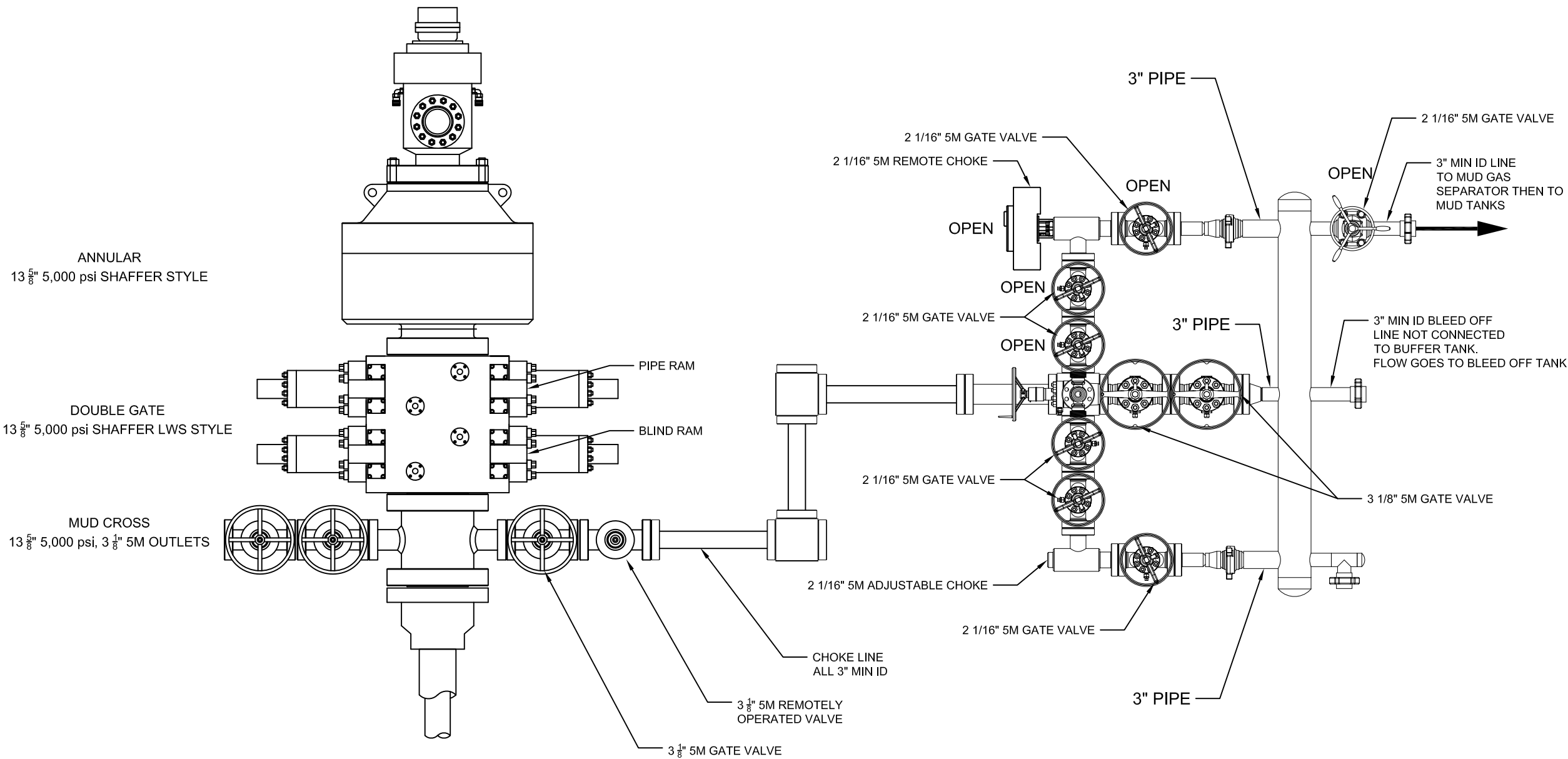

Notes
-
-
-

No.	Revision	Date



AKITA
DRILLING LTD.
2302 8th Street, Nisku Alberta
T9E 7Z2 Tel: (780) 955-6700

The information contained in this drawing is the sole property of AKITA Drilling Ltd. Any reproduction in whole or part without the express written consent of AKITA Drilling Ltd. is prohibited.

Date	5-6-2021	Scale	NTS
Des / Chk'd By	BG	File Name	R57 13 5M dou..
Project	R57		

RIG 57 BOP SCHEMATIC



POWERING PROGRESS™

MTR DATA BOOK

CL2013

CUSTOMER: GATES CANADA INC**DATE:** 12/19/2017**Purchase Order:** D235455 (PO 45750)**Sales Order #:** 509128**Product Description:** 5K 3 1/2 in. 17 FT. Fire Rated Choke & Kill Gates Hose Assembly c/w 3 1/8
5K Flange with Safety Clamps & Slings Attached**Hose S/N:** H-121917-14**PART NUMBER:** FR5K3.517.0CK31/85KFLG S/C**CONTENTS INCLUDED****GMCO FITTINGS**

17-309-1

INSERT STEM

15-095-1A

FERRULE

3 1/8 in. 5K FIXED FLANGE X 3 1/8 in. 5K FLOAT FLANGE

V4131

FIXED FLANGE

V5054

FLOAT FLANGE

WELDING SPECIFICATIONS

Certification and Procedure for welding

NDE RESULTS

1622371-03/1622371-01 Ultrasonic Test Results and Imaging

Safety Clamps

34145/34144

TEST CHART

Chart Recording of Hydrostatic Test

TEST CERTIFICATE

Document Product Details & Positive Results of Hydrostatic Testing

CERTIFICATE OF CONFORMANCE

A Declaration of the conformity with the type approval

IMAGES

Images of the product prior to shipping.

PACKING LIST

Details of Shipping Contents, Dimensions and Weights

**BLACK GOLD®**

GATES ENGINEERING & SERVICES NORTH AMERICA
7603 Prairie Oak Dr. Suite 190
Houston, TX. 77086

PHONE: +1 (281) 602-4100
FAX: +1 (281) 602-4147
EMAIL: gesna.quality@gates.com
WEB: www.gates.com/ollandgas

PRESSURE TEST CERTIFICATE

Customer:	GATES CANADA INC	Test Date:	12/19/2017
Customer Ref.:	D235455 (PO 45750)	Hose Serial No.:	H-121917-14
Invoice No.:	509128	Created By:	Cristian Rivera

Product Description: 5K 3 1/2 in. 17 FT. Fire Rated Choke & Kill c/w 3 1/8 5K Flange with Safety Clamps & Slings Attached

End Fitting 1:	3 1/8 in. 5K FIXED FLG	End Fitting 2:	3 1/8 in. 5K FLOAT FLG
Oracle Star No.:	68903550-9725917	Assembly Code:	15M5019042016H-121917-14
CUSTOMER P/N:	FR5K3.517.0CK31/85KFLG S/C	Test Pressure:	7,500 psi.
		Working Pressure:	5,000 psi.

Gates Engineering & Services North America certifies that:

The following hose assembly has successfully passed all pressure testing requirements set forth in Gates specifications: GTS-04-052 (for 5K assemblies) or GTS-04-053 (10K assemblies) or GTS-04-048 (15K assemblies), which include reference to Specification API 16C (2nd Edition); sections 7.5.4, 7.5.9, and 10.8.7. A test graph will accompany this test certificate to illustrate conformity to test requirements. This hose assembly was pressure tested using equipment and instrumentation that has been calibrated in accordance with the requirements set-forth in the GESNA management system.

Quality:	QUALITY
Date :	8/5/2021
Signature :	

F-PRD-005B

Production:	PRODUCTION
Date :	8/5/2021
Signature :	

Revision 6_05032021

**BLACK GOLD®**

GATES ENGINEERING & SERVICES NORTH AMERICA
7603 Prairie Oak Dr.
Houston, TX. 77086

PHONE: +1 (281) 602-4100
FAX: +1 (281) 602-4147
EMAIL: gesna.quality@gates.com
WEB: www.gates.com/ollandgas

CERTIFICATE OF CONFORMANCE

This is to certify that all parts and materials included in this shipment have manufactured and/or processed in accordance with various Gates and API assembly and test specifications. Records of required tests are on-file and subject to examination. Test reports and subsequent test graphs have been made available with this shipment. Additional supporting documentation related to materials, welding, weld inspections, and heat-treatment activities are available upon request.

CUSTOMER: GATES CANADA INC
CUSTOMER P.O.#: D235455 (PO 45750)
PART DESCRIPTION: FR5K3.517.0CK31/85KFLG S/C

PART DESCRIPTION: 5K 3 1/2 in. 17 FT. Fire Rated Choke & Kill c/w 3 1/8 5K Flange with Safety Clamps & Slings Attached

SALES ORDER #: 509128
QUANTITY: 1
SERIAL #: H-121917-14

SIGNATURE:

A handwritten signature in black ink, appearing to read "O. Rivera", written over a horizontal line.

TITLE:

QUALITY ASSURANCE

DATE:

8/5/2021

Gates E&S

North America

7603 Prairie Oak dr.

Houston, TX

Hydrostatic Test

Customer= **GATES CANADA**

Date of test= **12/19/17**

Serial # = **H-121917-13,-14**

Description = **3.5 5K 3 1/8 FLG 5K**

Technician= **CHRIS OLIVO**

12/19/2017 16:53:26

17:55:52

P
S
I
G

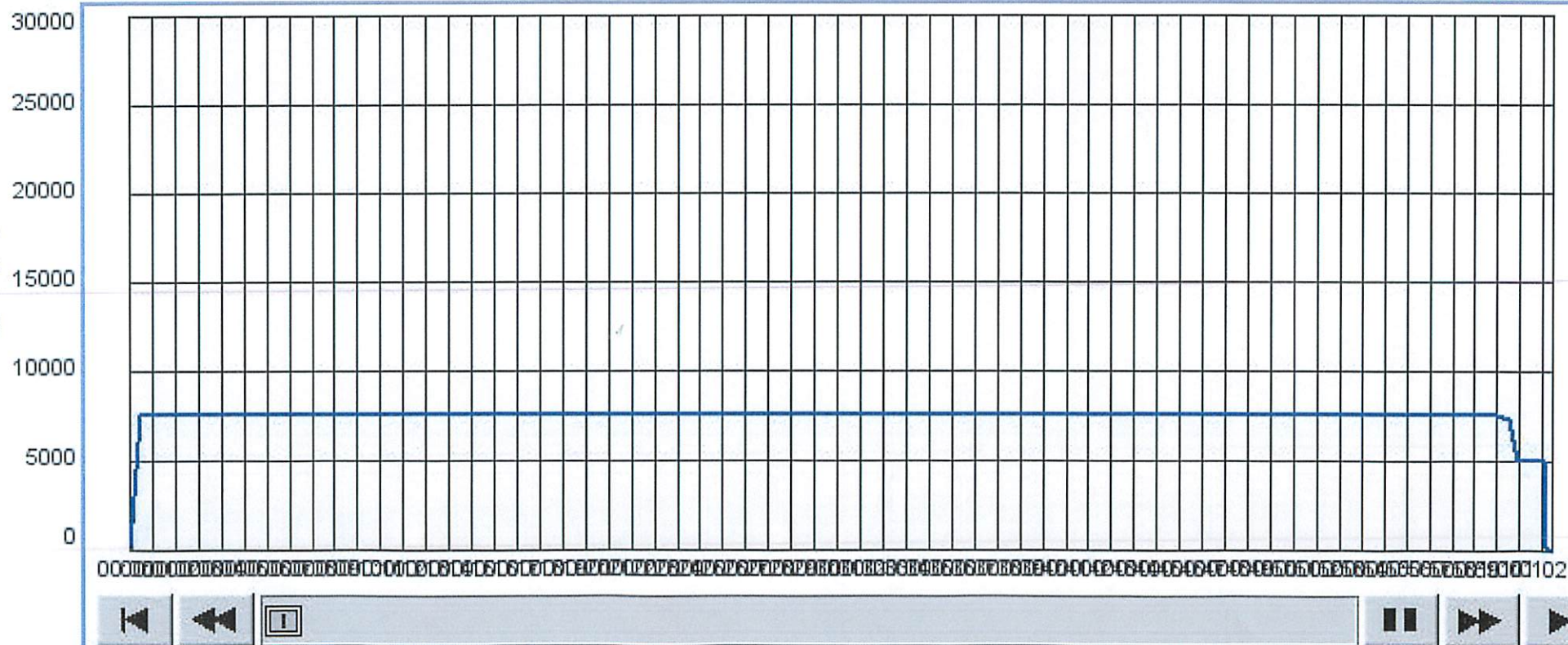



1385 Hwy. 35 Bypass S. O: (361) 790-7910
 P.O. Box 2350 F: (361) 790-7927
 Rockport, TX 78381

tedwards@edwardsfabrication.com
 www.edwardsfabrication.com

CERTIFICATE OF TEST

Client:
 Gates E & S North America
 134 44th Street
 Corpus Christi, TX 78405

Purchase Order: 1592198/0

Certificate Number			Date of Examination	
34145			04/27/17	
ID#	Part Number	Description	SWL*	Proofload
34145	E3.5S	3.5" E Safety Clamp	6016 lbs.	12031 lbs.

The Safety Clamp unit identified on this certificate has been load tested completely assembled; including the clamp body, (2) 3/4" shackles, 5/8" x 48" wire rope sling and anchor tab. Thus, all components are tested at the "Proof" load. Do not disassemble. Do not interchange any part or parts of this tested unit with parts of other Safety Clamp units. DO NOT WELD, CUT, ADD-TO, TAKE AWAY ANY COMPONENTS OR MAKE ANY MODIFICATION TO THIS CLAMP UNIT. Doing so voids this test certificate.

Cutting/Removing either one or both stainless steel Tamper-proof hardware cables renders this Test Certificate VOID.

* Safe Work Load

THIS PRODUCT IS MANUFACTURED IN THE U.S.A.

We hereby verify that the above information is correct
 as contained in the records of Edwards Fabrication L.L.C.



Edwards Fabrication L.L.C. is certified as
 having a Quality Management System.

Thomas F. Edwards
 President
 Edwards Fabrication L.L.C.



1385 Hwy. 35 Bypass S. O: (361) 790-7910
 P.O. Box 2350 F: (361) 790-7927
 Rockport, TX 78381

tedwards@edwardsfabrication.com
 www.edwardsfabrication.com

CERTIFICATE OF TEST

Client:
 Gates E & S North America
 134 44th Street
 Corpus Christi, TX 78405

Purchase Order: 1592198/0

Certificate Number				Date of Examination	
34144				04/27/17	
ID#	Part Number	Description	SWL*	Proofload	
34144	E3.5S	3.5" E Safety Clamp	6014 lbs.	12027 lbs.	

The Safety Clamp unit identified on this certificate has been load tested completely assembled; including the clamp body, (2) 3/4" shackles, 5/8" x 48" wire rope sling and anchor tab. Thus, all components are tested at the "Proof" load. Do not disassemble. Do not interchange any part or parts of this tested unit with parts of other Safety Clamp units. DO NOT WELD, CUT, ADD-TO, TAKE AWAY ANY COMPONENTS OR MAKE ANY MODIFICATION TO THIS CLAMP UNIT. Doing so voids this test certificate.

Cutting/Removing either one or both stainless steel Tamper-proof hardware cables renders this Test Certificate VOID.

* Safe Work Load

THIS PRODUCT IS MANUFACTURED IN THE U.S.A.

We hereby verify that the above information is correct
 as contained in the records of Edwards Fabrication L.L.C.

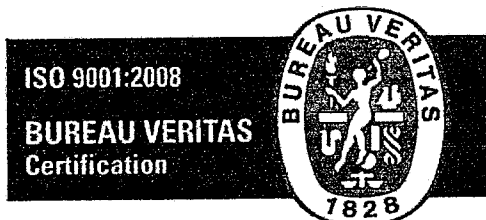

Edwards Fabrication L.L.C. is certified as
 having a Quality Management System.

Thomas F. Edwards
 President
 Edwards Fabrication L.L.C.

District I
1625 N. French Dr., Hobbs, NM 88240
Phone:(575) 393-6161 Fax:(575) 393-0720
District II
811 S. First St., Artesia, NM 88210
Phone:(575) 748-1283 Fax:(575) 748-9720
District III
1000 Rio Brazos Rd., Aztec, NM 87410
Phone:(505) 334-6178 Fax:(505) 334-6170
District IV
1220 S. St Francis Dr., Santa Fe, NM 87505
Phone:(505) 476-3470 Fax:(505) 476-3462

State of New Mexico
Energy, Minerals and Natural Resources
Oil Conservation Division
1220 S. St Francis Dr.
Santa Fe, NM 87505

CONDITIONS

Action 391192

CONDITIONS

Operator: Spur Energy Partners LLC 9655 Katy Freeway Houston, TX 77024	OGRID:
	328947
	Action Number:
	391192
Action Type:	
[C-101] BLM - Federal/Indian Land Lease (Form 3160-3)	

CONDITIONS

Created By	Condition	Condition Date
ward.rikala	Notify the OCD 24 hours prior to casing & cement.	11/6/2024
ward.rikala	File As Drilled C-102 and a directional Survey with C-104 completion packet.	11/6/2024
ward.rikala	Once the well is spud, to prevent ground water contamination through whole or partial conduits from the surface, the operator shall drill without interruption through the fresh water zone or zones and shall immediately set in cement the water protection string.	11/6/2024
ward.rikala	Cement is required to circulate on both surface and intermediate1 strings of casing.	11/6/2024
ward.rikala	If cement does not circulate on any string, a Cement Bond Log (CBL) is required for that string of casing.	11/6/2024
ward.rikala	Oil base muds are not to be used until fresh water zones are cased and cemented providing isolation from the oil or diesel. This includes synthetic oils. Oil based mud, drilling fluids and solids must be contained in a steel closed loop system.	11/6/2024
ward.rikala	Submit C-102 on new C-102 form.	11/6/2024