

Office  
 District I – (575) 393-6161  
 1625 N. French Dr., Hobbs, NM 88240  
 District II – (575) 748-1283  
 811 S. First St., Artesia, NM 88210  
 District III – (505) 334-6178  
 1000 Rio Brazos Rd., Aztec, NM 87410  
 District IV – (505) 476-3460  
 1220 S. St. Francis Dr., Santa Fe, NM  
 87505

State of New Mexico  
 Energy, Minerals and Natural Resources

Form C-103  
 Revised July 18, 2013

OIL CONSERVATION DIVISION  
 1220 South St. Francis Dr.  
 Santa Fe, NM 87505

<b>SUNDRY NOTICES AND REPORTS ON WELLS</b> (DO NOT USE THIS FORM FOR PROPOSALS TO DRILL OR TO DEEPEN OR PLUG BACK TO A DIFFERENT RESERVOIR. USE "APPLICATION FOR PERMIT" (FORM C-101) FOR SUCH PROPOSALS.)		WELL API NO. 30-015-54553
1. Type of Well: Oil Well <input type="checkbox"/> Gas Well <input checked="" type="checkbox"/> Other		5. Indicate Type of Lease STATE <input type="checkbox"/> FEE <input checked="" type="checkbox"/>
2. Name of Operator Mewbourne Oil Company		6. State Oil & Gas Lease No.
3. Address of Operator PO Box 5270, Hobbs, NM 88241		7. Lease Name or Unit Agreement Name Speedwagon 27 Fee
4. Well Location Unit Letter <u>A</u> : <u>505</u> feet from the <u>North</u> line and <u>230</u> feet from the <u>East</u> line Section <u>34</u> Township <u>23S</u> Range <u>28E</u> NMPM Eddy County		8. Well Number 856H
11. Elevation (Show whether DR, RKB, RT, GR, etc.) 3036' GR		9. OGRID Number 14744
		10. Pool name or Wildcat Purple Sage; Wolfcamp Gas (98220)

12. Check Appropriate Box to Indicate Nature of Notice, Report or Other Data

NOTICE OF INTENTION TO:		SUBSEQUENT REPORT OF:	
PERFORM REMEDIAL WORK <input type="checkbox"/>	PLUG AND ABANDON <input type="checkbox"/>	REMEDIAL WORK <input type="checkbox"/>	ALTERING CASING <input type="checkbox"/>
TEMPORARILY ABANDON <input type="checkbox"/>	CHANGE PLANS <input checked="" type="checkbox"/>	COMMENCE DRILLING OPNS. <input type="checkbox"/>	P AND A <input type="checkbox"/>
PULL OR ALTER CASING <input type="checkbox"/>	MULTIPLE COMPL <input type="checkbox"/>	CASING/CEMENT JOB <input type="checkbox"/>	
DOWNHOLE COMMINGLE <input type="checkbox"/>			
CLOSED-LOOP SYSTEM <input type="checkbox"/>			
OTHER: <input type="checkbox"/>		OTHER: <input type="checkbox"/>	

13. Describe proposed or completed operations. (Clearly state all pertinent details, and give pertinent dates, including estimated date of starting any proposed work). SEE RULE 19.15.7.14 NMAC. For Multiple Completions: Attach wellbore diagram of proposed completion or recompletion.

Mewbourne Oil Co. requests approval to change the well name to Speedwagon 27 Fee #999H

Spud Date: Est. 12/2025

Rig Release Date:

I hereby certify that the information above is true and complete to the best of my knowledge and belief.

SIGNATURE Andrew W Taylor TITLE Engineer DATE 4/3/2025

Type or print name Andrew Taylor E-mail address: ataylor@mewbourne.com PHONE: (575) 393-5905

**For State Use Only**

APPROVED BY: \_\_\_\_\_ TITLE \_\_\_\_\_ DATE \_\_\_\_\_

Conditions of Approval (if any):

Santa Fe Main Office Phone: (505) 476-3441 Fax: (55) 476-3462 General Information Phone: (505) 629-6116  Online Phone Directory Visit: <a href="https://www.emnrd.nm.gov/ocd/contact-us/">https://www.emnrd.nm.gov/ocd/contact-us/</a>	State of New Mexico Energy, Minerals & Natural Resources Department <b>OIL CONSERVATION DIVISION</b>	<div style="text-align: right;"> <b>C-102</b>            Revised July 9, 2024            Submit Electronically            via OCD Permitting         </div> <div>           Submittal Type:           <div style="border: 1px solid black; padding: 2px; margin-top: 5px;"> <input type="checkbox"/> Initial Submittal  <input checked="" type="checkbox"/> Amended Report  <input type="checkbox"/> As Drilled           </div> </div>
--	---	---

## WELL LOCATION INFORMATION

API Number <b>30-015-54553</b>	Pool Code <b>98220</b>	Pool Name <b>PURPLE SAGE; WOLFCAMP GAS</b>
Property Code <b>335078</b>	Property Name <b>SPEEDWAGON 27 FEE</b>	Well Number <b>999H</b>
OGRID No. <b>14744</b>	Operator Name <b>MEWBOURNE OIL COMPANY</b>	Ground Level Elevation <b>3036'</b>
Surface Owner: <input type="checkbox"/> State <input checked="" type="checkbox"/> Fee <input type="checkbox"/> Tribal <input type="checkbox"/> Federal		Mineral Owner: <input type="checkbox"/> State <input checked="" type="checkbox"/> Fee <input type="checkbox"/> Tribal <input type="checkbox"/> Federal

## Surface Location

UL	Section	Township	Range	Lot	Ft. from N/S	Ft. from E/W	Latitude	Longitude	County
<b>A</b>	<b>34</b>	<b>23S</b>	<b>28E</b>		<b>505 FNL</b>	<b>230 FEL</b>	<b>32.2674819°N</b>	<b>104.0673078°W</b>	<b>EDDY</b>

## Bottom Hole Location

UL	Section	Township	Range	Lot	Ft. from N/S	Ft. from E/W	Latitude	Longitude	County
<b>B</b>	<b>27</b>	<b>23S</b>	<b>28E</b>		<b>330 FNL</b>	<b>1980 FEL</b>	<b>32.2827026°N</b>	<b>104.0730702°W</b>	<b>EDDY</b>

Dedicated Acres <b>320</b>	Infill or Defining Well <b>INFILL</b>	Defining Well API <b>SPEEDWAGON 27 FEE #856H</b>	Overlapping Spacing Unit (Y/N) <b>N</b>	Consolidation Code <b>P</b>
Order Numbers. <b>N/A</b>			Well setbacks are under Common Ownership: <input checked="" type="checkbox"/> Yes <input type="checkbox"/> No	

## Kick Off Point (KOP)

UL	Section	Township	Range	Lot	Ft. from N/S	Ft. from E/W	Latitude	Longitude	County
<b>B</b>	<b>34</b>	<b>23S</b>	<b>28E</b>		<b>243 FNL</b>	<b>1980 FEL</b>	<b>32.2681925°N</b>	<b>104.0729374°W</b>	<b>EDDY</b>

## First Take Point (FTP)

UL	Section	Township	Range	Lot	Ft. from N/S	Ft. from E/W	Latitude	Longitude	County
<b>O</b>	<b>27</b>	<b>23S</b>	<b>28E</b>		<b>330 FSL</b>	<b>1980 FEL</b>	<b>32.2697675°N</b>	<b>104.0729521°W</b>	<b>EDDY</b>

## Last Take Point (LTP)

UL	Section	Township	Range	Lot	Ft. from N/S	Ft. from E/W	Latitude	Longitude	County
<b>B</b>	<b>27</b>	<b>23S</b>	<b>28E</b>		<b>330 FNL</b>	<b>1980 FEL</b>	<b>32.2827026°N</b>	<b>104.0730702°W</b>	<b>EDDY</b>

Unitized Area or Area of Uniform Interest <b>N/A</b>	Spacing Unit Type <input checked="" type="checkbox"/> Horizontal <input type="checkbox"/> Vertical	Ground Floor Elevation: <b>3036'</b>
---	--	---

## OPERATOR CERTIFICATIONS

I hereby certify that the information contained herein is true and complete to the best of my knowledge and belief, and, if the well is a vertical or directional well, that this organization either owns a working interest or unleased mineral interest in the land including the proposed bottom hole location or has a right to drill this well at this location pursuant to a contract with an owner of a working interest or unleased mineral interest, or to a voluntary pooling agreement or a compulsory pooling order heretofore entered by the division.

If this well is a horizontal well, I further certify that this organization has received the consent of at least one lessee or owner of a working interest or unleased mineral interest in each tract (in the target pool or formation) in which any part of the well's completed interval will be located or obtained a compulsory pooling order from the division.

Andrew W Taylor      4/3/2025  
Signature      Date

**Andrew Taylor**

Printed Name

**ataylor@mewbourne.com**

Email Address

## SURVEYOR CERTIFICATIONS

I hereby certify that the well location shown on this plat was plotted from field notes of actual surveys made by me or under my supervision and that the same is true and correct to the best of my belief.

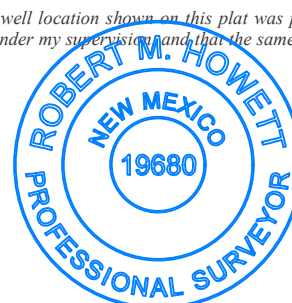

Signature and Seal of Professional Surveyor

Robert M. Howett

Certificate Number

Date of Survey

**19680**

**12/20/2023**

Note: No allowable will be assigned to this completion until all interests have been consolidated or a non-standard unit has been approved by the division.

This grid represents a standard section. You may superimpose a non-standard section, or larger area, over this grid. Operators must outline the dedicated acreage in a red box, clearly show the well surface location and bottom hole location, if it is directionally drilled, with the dimensions from the section lines in the cardinal directions. If this is a horizontal wellbore show on this plat the location of the First Take Point and Last Take Point, and the point within the Completed interval (other than the First Take Point or Last Take Point) that is closest to any outer boundary of the tract.

Surveyors shall use the latest United States government survey or dependent resurvey. Well locations will be in reference to the New Mexico Principal Meridian. If the land is not surveyed, contact the OCD Engineering Bureau. Independent subdivision surveys will not be acceptable.

No allowable will be assigned to this completion until all interest have been consolidated or a non-standard unit has been approved by the division.

	<p><b>GEODETIC DATA</b> NAD 83 GRID - NM EAST</p> <p><b>SURFACE LOCATION</b> N: 461144.9 - E: 623562.1 505' FNL &amp; 230' FEL LAT: 32.2674819° N LONG: 104.0673078° W</p> <p><b>FIRST TAKE POINT</b> 330' FSL &amp; 1980' FEL N: 461972.1 - E: 621815.5 32.2697675° N, 104.0729521° W</p> <p><b>KICK-OFF POINT</b> 243' FNL &amp; 1980' FEL N: 461399.1 - E: 621821.4 32.2681925° N, 104.0729374° W</p> <p><b>BOTTOM HOLE/LAST TAKE POINT</b> N: 466677.6 - E: 621767.6 330' FNL &amp; 1980' FEL LAT: 32.2827026° N LONG: 104.0730702° W</p> <p><b>CORNER DATA</b> NAD 83 GRID - NM EAST</p> <p>A: FOUND BRASS CAP "1942" N: 456318.1 - E: 618448.9</p> <p>B: FOUND 1/2" REBAR N: 458970.7 - E: 618484.3</p> <p>C: FOUND 1/2" REBAR N: 461626.4 - E: 618520.2</p> <p>D: FOUND COTTON SPINDLE N: 466918.0 - E: 618471.2</p> <p>E: FOUND 1/2" REBAR N: 466986.1 - E: 621106.4</p> <p>F: FOUND COTTON SPINDLE N: 467071.8 - E: 623742.7</p> <p>G: FOUND 1/2" REBAR N: 461650.7 - E: 623798.9</p> <p>H: FOUND 1/2" REBAR N: 458974.0 - E: 623762.4</p> <p>I: FOUND BRASS CAP "1942" N: 456331.9 - E: 623787.8</p> <p>J: FOUND BRASS CAP "1942" N: 456326.5 - E: 621092.9</p> <p>K: FOUND 1/2" SMOOTH ROD N: 461639.2 - E: 621159.6</p>	<p><b>17 OPERATOR CERTIFICATION</b> I hereby certify that the information contained herein is true and complete to the best of my knowledge and belief, and that this organization either owns a working interest or unleased mineral interest in the land including the proposed bottom hole location or has a right to drill this well at this location pursuant to a contract with an owner of such a mineral or working interest, or to a voluntary pooling agreement or a compulsory pooling order heretofore entered by the division.</p> <p>Signature _____ Date _____</p> <p>Printed Name _____</p> <p>E-mail Address _____</p> <p><b>18 SURVEYOR CERTIFICATION</b> I hereby certify that the well location shown on this plat was plotted from field notes of actual surveys made by me or under my supervision, and that the same is true and correct to the best of my belief.</p> <p><b>12/20/2023</b> Date of Survey</p> <p>Signature and Seal of Professional Surveyor: _____</p> <p><b>19680</b> Certificate Number</p> <p><b>19680</b> Job No: LS23121163</p>
--	---	---

Sante Fe Main Office  
Phone: (505) 476-3441

General Information  
Phone: (505) 629-6116

Online Phone Directory  
<https://www.emnrd.nm.gov/ocd/contact-us>

State of New Mexico  
Energy, Minerals and Natural Resources  
Oil Conservation Division  
1220 S. St Francis Dr.  
Santa Fe, NM 87505

CONDITIONS

Action 448633

CONDITIONS

Operator: MEWBOURNE OIL CO P.O. Box 5270 Hobbs, NM 88241	OGRID: 14744
	Action Number: 448633
	Action Type: [C-103] NOI Change of Plans (C-103A)

CONDITIONS

Created By	Condition	Condition Date
ward.rikala	Any previous COA's not addressed within the updated COA's still apply.	4/8/2025