

Submit a Copy To Appropriate District

Office

District I – (575) 393-6161
 1625 N. French Dr., Hobbs, NM 88240
 District II – (575) 748-1283
 811 S. First St., Artesia, NM 88210
 District III – (505) 334-6178
 1000 Rio Brazos Rd., Aztec, NM 87410
 District IV – (505) 476-3460
 1220 S. St. Francis Dr., Santa Fe, NM
 87505

State of New Mexico
 Energy, Minerals and Natural Resources

Form C-103
 Revised July 18, 2013

OIL CONSERVATION DIVISION
 1220 South St. Francis Dr.
 Santa Fe, NM 87505

WELL API NO. 30-005-61551
5. Indicate Type of Lease STATE <input checked="" type="checkbox"/> FEE <input type="checkbox"/>
6. State Oil & Gas Lease No. L-2464
7. Lease Name or Unit Agreement Name Tolmac State
8. Well Number #2
9. OGRID Number 330522
10. Pool name or Wildcat Pecos Slope; Abo (Gas)

SUNDRY NOTICES AND REPORTS ON WELLS
 (DO NOT USE THIS FORM FOR PROPOSALS TO DRILL OR TO DEEPEN OR PLUG BACK TO A
 DIFFERENT RESERVOIR. USE "APPLICATION FOR PERMIT" (FORM C-101) FOR SUCH
 PROPOSALS.)

1. Type of Well: Oil Well ☐ Gas Well ☒ Other

2. Name of Operator

State of New Mexico formerly Acacia Operating Company, LLC

3. Address of Operator

505 N Big Spring St, Suite 303, Midland, TX 79701

4. Well Location

Unit Letter **N** : **990** feet from the **S** line and **1980** feet from the **W** line
 Section **36** Township **09S** Range **25E** NMPM County **Chaves**

11. Elevation (Show whether DR, RKB, RT, GR, etc.)
3657' GR

12. Check Appropriate Box to Indicate Nature of Notice, Report or Other Data

NOTICE OF INTENTION TO:

PERFORM REMEDIAL WORK ☐ PLUG AND ABANDON ☐
 TEMPORARILY ABANDON ☐ CHANGE PLANS ☐
 PULL OR ALTER CASING ☐ MULTIPLE COMPL ☐
 DOWNHOLE COMMINGLE ☐
 CLOSED-LOOP SYSTEM ☐
 OTHER: ☐

SUBSEQUENT REPORT OF:

REMEDIAL WORK ☐ ALTERING CASING ☐
 COMMENCE DRILLING OPNS. ☐ P AND A ☒
 CASING/CEMENT JOB ☐
 OTHER: ☐

13. Describe proposed or completed operations. (Clearly state all pertinent details, and give pertinent dates, including estimated date of starting any proposed work). SEE RULE 19.15.7.14 NMAC. For Multiple Completions: Attach wellbore diagram of proposed completion or recompletion.

JMR Services, LLC plugged this well from 05/27/2025-06/03/2025. Please see the attached P&A Subsequent Report.

Spud Date:

Rig Release Date:

I hereby certify that the information above is true and complete to the best of my knowledge and belief.

SIGNATURE Abigail Anderson TITLE P&A Engineer DATE 06/04/2025

Type or print name Abigail Anderson E-mail address: aanderson@jmrsvcs.com PHONE: 432-889-4673

For State Use Only

APPROVED BY: _____ TITLE _____ DATE _____

Conditions of Approval (if any):

**Plug and Abandonment Procedure
Orphan Well Program
State of New Mexico formerly Acacia Operating Company, LLC
Tolmac State #2
API #30-005-61551
Unit N, 990' FSL and 1980' FWL Sec. 36, T9S, R25E
Chaves County, NM**

Note: All cement is Class C mixed at 14.8 ppg, yield 1.32 cu ft / sx. Cement volumes are based on inside capacities + 50' excess and outside capacities + 100% excess.

05/27/25 MIRU plugging equipment. Dug out cellar.

05/28/25 Bled well to pit. Circ'd hole w/ 90 bbls brine H2O & killed well. ND wellhead, NU BOP. POH w/ 63 stands of tbgs. Set 4 ½" CIBP @ 3,934'. Circulated hole w/ 70 bbls fresh H2O. Pressure tested csg, held 600 psi.

05/29/25 Checked pressures, 0 psi. RIH & tagged @ 3,940'. Ran CBL from 3,940' to surface. TOC @ 3,100'. Spotted 55 sxs class C cmt @ 3,940-3,144'. Perf'd @ 1,846'. Pressured up on perms to 1800 psi. Spotted 25 sxs class C cmt @ 1,900-1,533'. WOC.

05/30/25 Tagged TOC @ 1,575'. Perf'd @ 1,148'. Sqz'd 50 sxs class C cmt @ 1,148-1,048'. WOC & tagged @ 1,007'. Perf'd @ 685'. ND BOP. Sqz'd 290 sxs class C cmt @ 685' & circulated to surface. RDMO.

06/03/25 Moved in backhoe & welder. Cut off wellhead & verified cmt at surface. Installed an above ground DHM. (**33.4846667, -104.3569167**). Dug up anchors, backfilled cellar, cleaned location, & moved off.

State of New Mexico formerly Acacia Operating				PLUGGED
Author:	Abby @ JMR			
Well Name	Tolmac State			Well No. #2
Field/Pool	Pecos Slope; Abo			API #: 30-005-61551
County	Chaves			Location: 990' FSL & 1980' FWL
State	NM			Sec 36, T9S, R25E
Spud Date	6/12/1982			GL: 3657

Description	O.D.	Grade	Weight	Depth	Hole	Cmt Sx	TOC
Surface Csg	8 5/8	K55	32#	1,098	12 1/4	600	0
Prod Csg	4 1/2	J55	10.5#	4,474	7 7/8	350	3,100' CBL

Formation	Top
San Andres	635
Glorieta	1796
Tubb	3210
Abo	3965

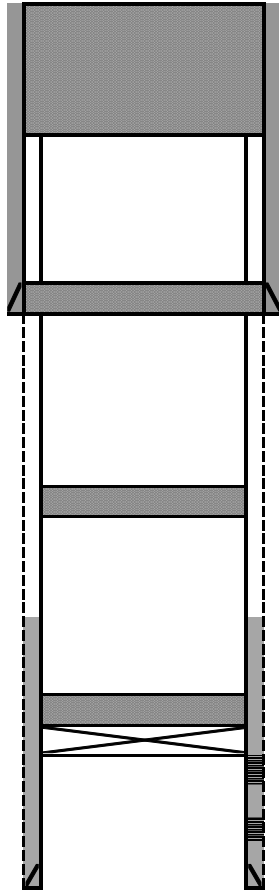

Plug #4: Perf'd @ 685'. Sqz'd 290 sxs class C cmt @ 685' & circulated to surface.

8 5/8 32# CSG @ 1,098
Hole Size: 12 1/4

Plug #3: Perf'd @ 1,148'. Sqz'd 50 sxs class C cmt @ 1,148-1,048'. WOC & tagged @ 1,007'.

Plug #2: Perf'd @ 1,846'. Pressured up on perfs. Spotted 25 sxs class C cmt @ 1,900-1,533'. WOC & tagged @ 1,575'.

Plug #1: Set 4 1/2" CIBP at 3,934'. Tagged @ 3,940'. Spotted 55 sxs class C cmt @ 3,940-3,144'.

Perfs @ 3,984-3,990'

Perfs @ 4,202-4,348'
2 3/8" tbgs @ 4110'

4 1/2 10.5# CSG @ 4,474
Hole Size: 7 7/8

PBTD @ 4,413'
TD @ 4,510'

















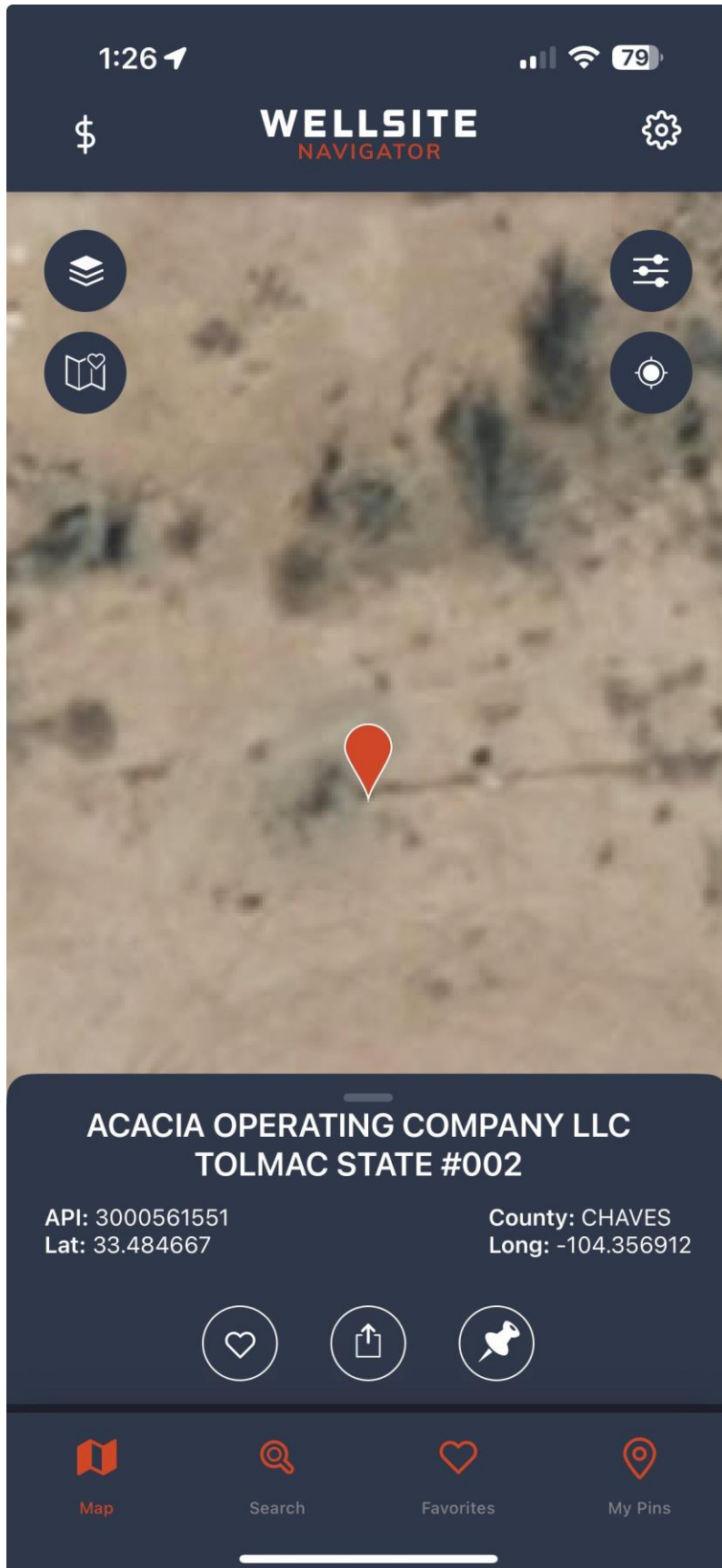

1000084165.heic

Sante Fe Main Office
Phone: (505) 476-3441

General Information
Phone: (505) 629-6116

Online Phone Directory
<https://www.emnrd.nm.gov/ocd/contact-us>

State of New Mexico
Energy, Minerals and Natural Resources
Oil Conservation Division
1220 S. St Francis Dr.
Santa Fe, NM 87505

CONDITIONS

Action 471640

CONDITIONS

Operator: JMR SERVICES, LLC 4706 Green Tree Blvd. Midland, TX 79707	OGRID: 372464
	Action Number: 471640
	Action Type: [C-103] Sub. Plugging (C-103P)

CONDITIONS

Created By	Condition	Condition Date
loren.diede	None	6/6/2025