



eog resources

RECEIVED OCD

2012 MAR -6 P 12: 50

EOG Resources, Inc.

P.O. Box 2267
Midland, TX 79702.
(432) 686-3600

March 2, 2012

Bureau of Land Management
Carlsbad Field Office
620 E. Greene St.
Carlsbad, New Mexico 88220-6292

State of New Mexico
Oil Conservation Division
1220 South St. Francis Drive
Santa Fe, New Mexico 87504

Re: Pitchblende Federal Exploratory Unit
Serial No. NMNM 111795X
2012 Plan of Development
Lea County, New Mexico
EOG Contract K0014621

Gentlemen:

EOG Resources, Inc. (EOG), as Unit Operator of the Pitchblende Federal Exploratory Unit (PFEU), hereby submits for your approval, our 2012 Plan of Development.

Items included are as follows: Planned 2012 operations; previous year operations; current status of all wells within the unit; production graphs for each productive reservoir. Also attached is a current map, showing respectively the units: structural and geologic interpretations; participating area boundaries; wells, flow-lines, and roads.

It is understood that approval of this plan does not approve the work covered by the plan. Individual approval is still required for such items as APDs/ROWs/etc.

Any modifications or additions to this Plan of Development will be filed as supplements to the plan.

Sincerely,

Douglas W. Hurlbut
Land Advisor

2012 Planned Operations:

Drilling -

At this time, EOG does not plan any new drill wells in the PFEU.

Completions -

At this time, EOG does not plan any new drill wells in the PFEU.

Plug Back -

At this time, EOG does not plan any plug backs in the PFEU.

Conversion -

At this time, EOG does not plan any conversions in the PFEU.

Abandonment -

EOG does not plan to plug and abandon any wells in 2012.

Other surface disturbing operations -

None

Previous Year Operations (2011):**Drilling –**

EOG did not drill any new wells in the PFEU in 2011.

Completions –

None

Plug Back –

EOG did not plug back any wells in the PFEU in 2011.

Conversion –

EOG did not complete any conversions in the PFEU in 2011.

Abandonment –

None

Other surface disturbing operations –

None

Status of all Wells within the Unit:

WELL NAME & NUMBER	API NUMBER	COMP DATE	ZONE	STATUS	
Pitchblende Fed Unit #2	3002527753	6/19/2005	Bone Spring	Pumping	

Production Graphs:

See Attachments

Map of structural and geologic interpretations, participating area boundaries, wells, flow-lines, and roads:

See Attachment

The PFEU was contracted effective June 19, 2010 from 7,799.76 acres down to 80.00 acres which is the initial Bone Springs Participating Area.

The working interest owners have been provided a copy of this 2012 Plan of Development. EOG Resources, Inc. and the working interest owners believe that all current Pitchblende Federal Exploratory Unit obligations have been satisfied.

In accordance with Section 10 of the Pitchblende Federal Exploratory Unit Agreement, please signify your approval of the 2012 Plan of Development by executing in the signature block below. Please return one approved copy to EOG Resources, Inc. at the letterhead address.

Should you have any questions or comments in this regard, please contact me at 432-686-3610.

Bureau of Land Management

Date

New Mexico Oil Conservation Division

Date

The foregoing approvals are for the 2012 Plan of Development for the Pitchblende Federal Exploratory Unit, Lea County, New Mexico.

cc: Devon Energy Corporation
20 North Broadway
Oklahoma City, OK 73102-8260
Attn: Ken Gray

Energen Resources Corporation
3300 North "A" St. Building 4, Suite 100
Midland, Texas 79705
Attn: Ken Gray

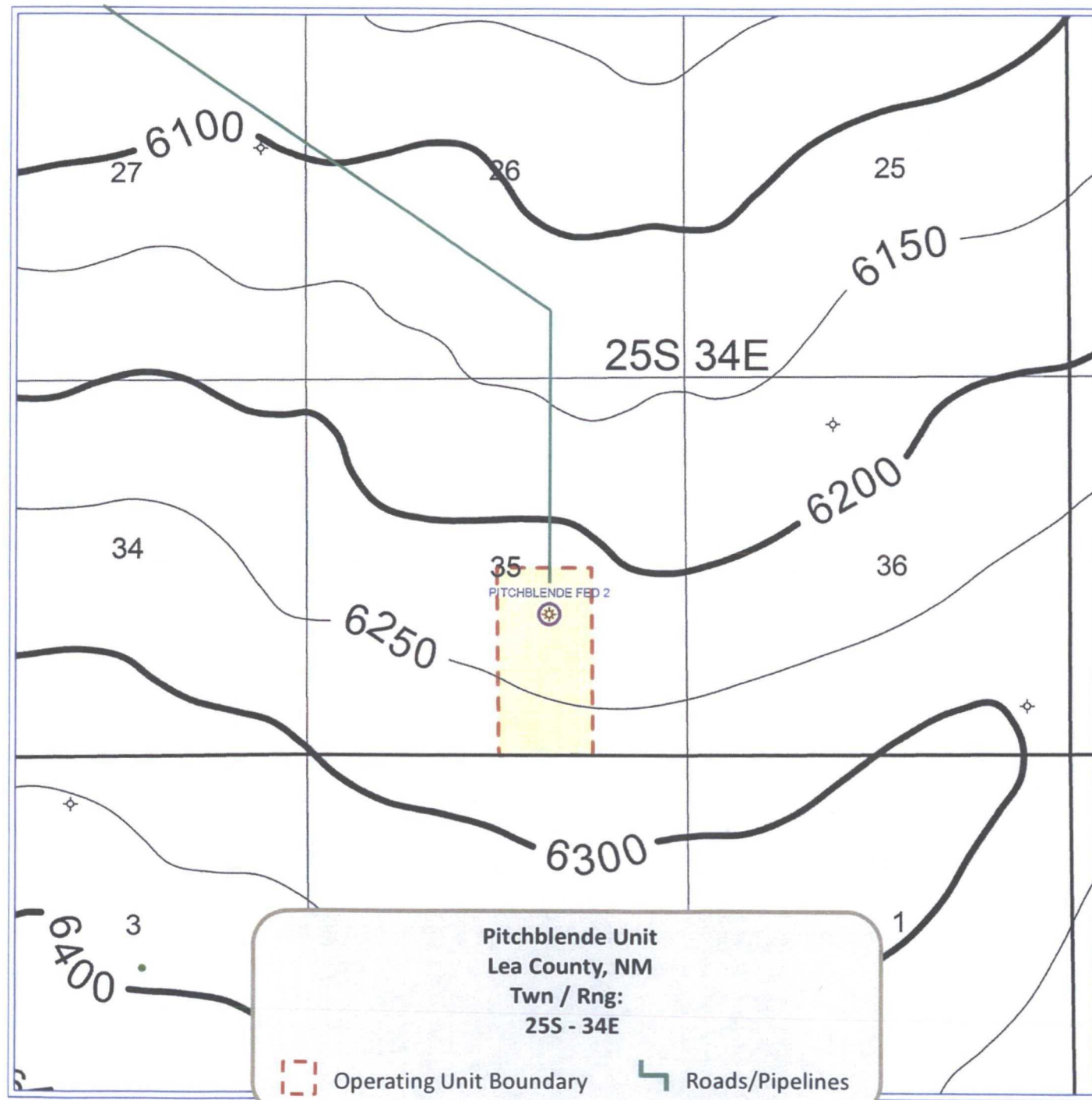

LEASE: PITCHBLEND FED UNIT

WELL: 2 (LS)
 FIELD: HARDIN TANK
 OPERATOR: EOG RESOURCES, INC
 COUNTY, STATE: LEA, NM
 RESERVE CATEGORY:

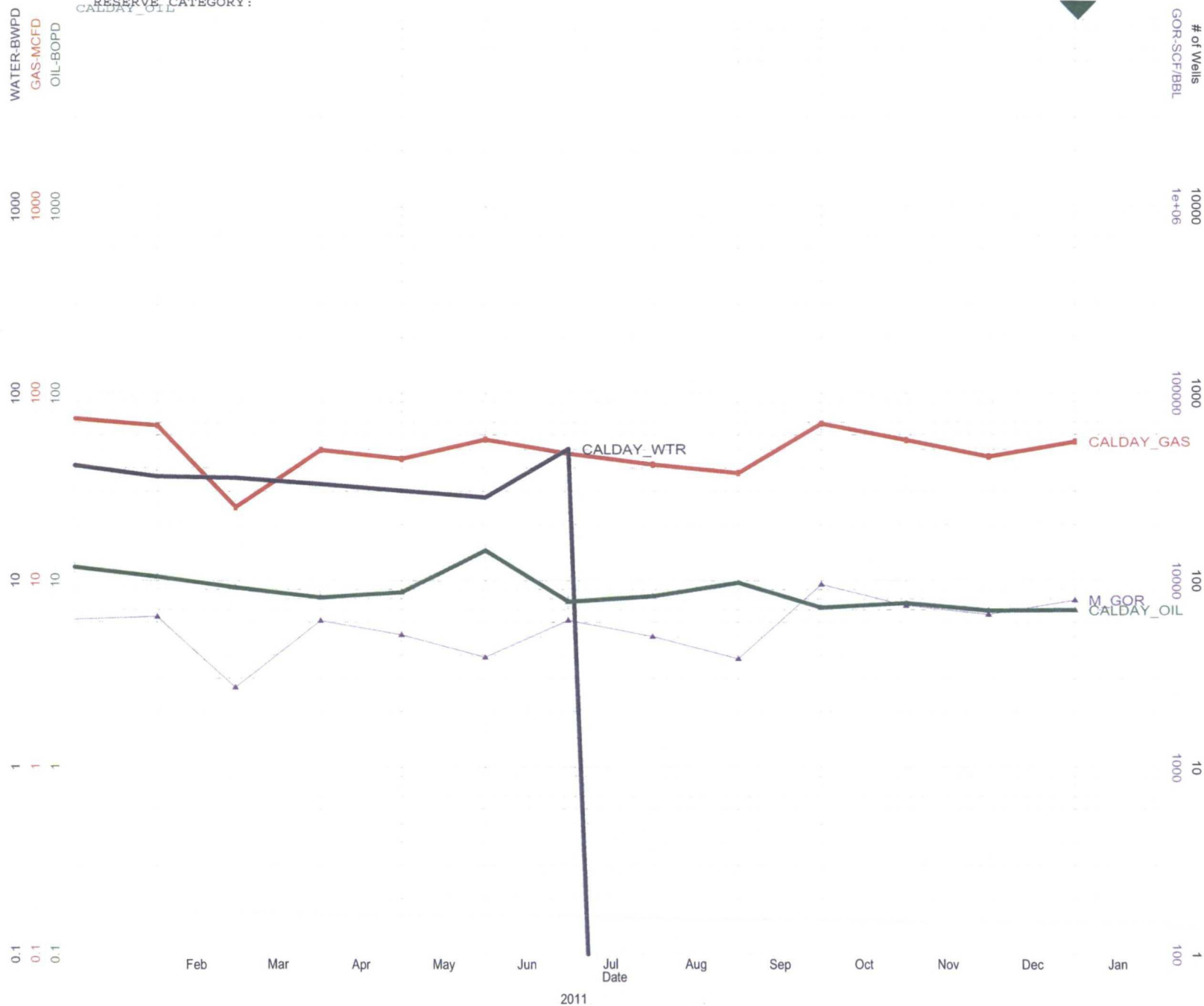

OIL-BOPD
 Ref= 1/2012
 Cum= 24818

GAS-MCFD
 Ref= 1/2012
 Cum= 50327

WATER-BWPD
 Ref= 1/2012
 Cum= 42402

GOR-SCF/BBL
 Ref= 1/2012
 Cum= 0

of Wells
 Ref= 1/2012
 Cum= 0



RECEIVED OCD

2011 MAR 31 A 11: 42

EOG Resources, Inc.
P.O. Box 2267
Midland, TX 79702
(432) 686-3600

March 16, 2011

Bureau of Land Management
Carlsbad Field Office
620 E. Greene St.
Carlsbad, New Mexico 88220-6292

State of New Mexico
Oil Conservation Division
1220 South St. Francis Drive
Santa Fe, New Mexico 87504

Re: Pitchblende Federal Exploratory Unit
Serial No. NMNM 111795X
2011 Plan of Development
Lea County, New Mexico
EOG Contract K0014621

Gentlemen:

EOG Resources, Inc. (EOG), as Unit Operator of the Pitchblende Federal Exploratory Unit (PFEU), hereby submits for your approval, our 2011 Plan of Development.

Items included are as follows: Planned 2011 operations; previous year operations; current status of all wells within the unit; production graphs for each productive reservoir. Also attached is a current map, showing respectively the units: structural and geologic interpretations; participating area boundaries; wells, flow-lines, and roads.

It is understood that approval of this plan does not approve the work covered by the plan. Individual approval is still required for such items as APDs/ROWs/etc.

Any modifications or additions to this Plan of Development will be filed as supplements to the plan.

Sincerely,

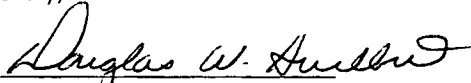
Douglas W. Hurlbut
Land Specialist

2011 Planned Operations:

Drilling -

At this time, EOG does not plan any new drill wells in the PFEU.

Completions -

At this time, EOG does not plan any new drill wells in the PFEU.

Plug Back -

At this time, EOG does not plan any plug backs in the PFEU.

Conversion -

At this time, EOG does not plan any conversions in the PFEU.

Abandonment -

EOG does not plan to plug and abandon any wells in 2011.

Other surface disturbing operations -

None

Previous Year Operations (2010):

Drilling –

EOG did not drill any new wells in the PFEU in 2010.

Completions –

EOG did numerous recompletions in various Bone Spring Sands in the #2 well in the PFEU in 2010.

Plug Back –

EOG did not plug back any wells in the PFEU in 2010.

Conversion –

EOG did not complete any conversions in the PFEU in 2010.

Abandonment –

None

Other surface disturbing operations –

None

Status of all Wells within the Unit:

WELL NAME & NUMBER	API NUMBER	COMP DATE	ZONE	STATUS
Pitchblende Fed Unit #2	3002527753	6/19/2005	Bone Spring	Pumping

Production Graphs:

See Attachments

Map of structural and geologic interpretations, participating area boundaries, wells, flow-lines, and roads:

See Attachment

The PFEU was contracted effective June 19, 2010 from 7,799.76 acres down to 80.00 acres which is the initial Bone Springs Participating Area.

The working interest owners have been provided a copy of this 2011 Plan of Development. EOG Resources, Inc. and the working interest owners believe that all current Pitchblende Federal Exploratory Unit obligations have been satisfied.

In accordance with Section 10 of the Pitchblende Federal Exploratory Unit Agreement, please signify your approval of the 2011 Plan of Development by executing in the signature block below. Please return one approved copy to EOG Resources, Inc. at the letterhead address.

Should you have any questions or comments in this regard, please contact me at 432-686-3610.

Bureau of Land Management

Date

New Mexico Oil Conservation Division

Date

The foregoing approvals are for the 2011 Plan of Development for the Pitchblende Federal Exploratory Unit, Lea County, New Mexico.

cc: Devon Energy Corporation
20 North Broadway
Oklahoma City, OK 73102-8260
Attn: Ken Gray

Energen Resources Corporation
3300 North "A" St. Building 4, Suite 100
Midland, Texas 79705
Attn: Ken Gray

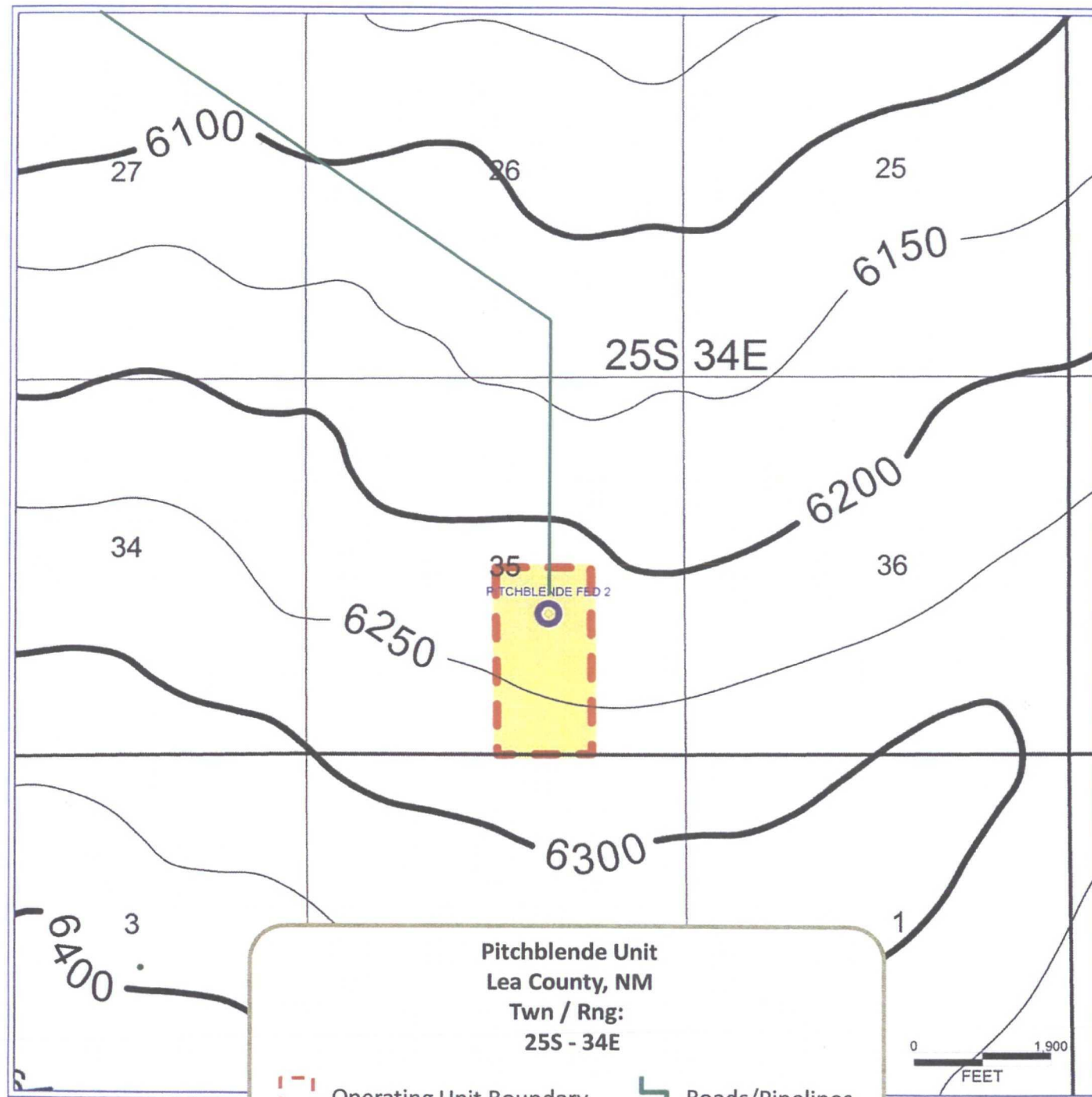

LEASE: PITCHBLEND FED UNIT

WELL: 120
 FIELD: HARDIN TANK
 OPERATOR: BOG RESOURCES
 COUNTY: LEA NM
 RESERVE CATEGORY

Production Graph

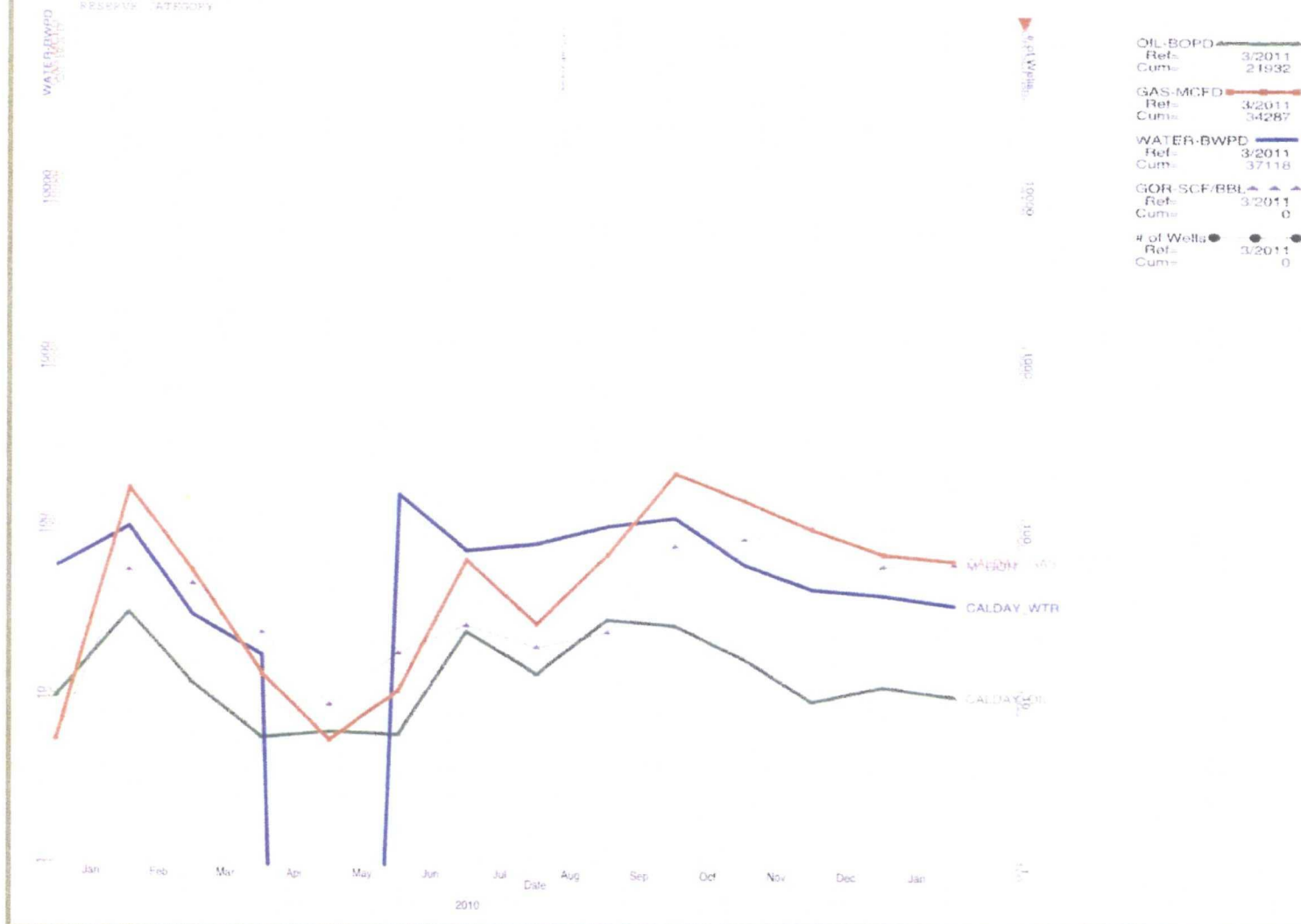

Pitchblende Unit
 Lea County, NM
 Twn / Rng:
 25S - 34E

Oil (BOPD) Gas (MCFD) Water (BWPD)



Ray Powell, M.S., D.V.M.
COMMISSIONER

State of New Mexico
Commissioner of Public Lands

310 OLD SANTA FE TRAIL
P.O. BOX 1148
SANTA FE, NEW MEXICO 87504-1148

COMMISSIONER'S OFFICE

Phone (505) 827-5760

Fax (505) 827-5766

www.nmstatelands.org

May 23, 2011

Ranger 40 Petroleum, LLC
1004 Collier Center Way #206
Naples, Florida 34110

Attn: Ms. Taber Tagliasacchi

Re: Resignation/Designation of Successor Unit Operator
Langlie Jal Unit
Lea County, New Mexico

Dear Ms. Tagliasacchi:

We are in receipt of your resignation/designation of successor unit operator, wherein Phoenix Hydrocarbons Operating Corporation, has resigned as unit operator of the Langlie Jal Unit and designated Ranger 40 Petroleum, LLC as the success or unit operator.

The Commissioner of Public Lands has this date approved the resignation of Phoenix Hydrocarbons Operating Corporation, and the designation of Ranger 40 Petroleum, LLC as the successor unit operator of this unit.

This change in operators is effective June 1, 2008. In accordance with this approval, Ranger 40 Petroleum, LLC is now responsible for all operations and the reporting of all production from the unit.

If you have any questions or if we may be of further help, please contact Pete Martinez at (505) 827-5791.

RAY POWELL, M.S., D.V.M.
COMMISSIONER OF PUBLIC LANDS

BY: 
LARRY J. ROYBAL, Director
Oil/Gas and Minerals Division
RP/LR/jm
xc: Reader File
OCD-Santa Fe, Attn: Mr. Ed Martin
TRD-Attn: Ms. Valdean Severson

RECEIVED OOD
2011 MAY 26 P 12:56