

TF-01-04

[NM-5]
Form C-132

State of New Mexico
Energy and Minerals Department
Oil Conservation Division
2040 Pacheco Street
Santa Fe, New Mexico 87505

APPLICATION FOR CATEGORY DETERMINATION

FOR DIVISION

USE ONLY:

APPROPRIATE FILING FEE ENCLOSED? YES ☒ NO ☐
DATE COMPLETE APPLICATION FILED Apr. 130, 2001
DATE DETERMINATION MADE May 4, 2001
WAS APPLICATION CONTESTED? YES ☐ NO ☒
NAME(S) OF INTERVENOR(S), IF ANY: _____

FILING FEE(S) -

Effective October 1, 1986
a non-refundable filing fee
of \$25.00 per category for
each application is mandatory
(Rule 2, Order No. R-5878-B-3)

1. Name of Operator: Burlington Resources Oil & Gas

6. County: San Juan

2. Address of Operator:
5051 Westheimer, Suite 1400
Houston, TX 77210-4236

7. Indicate Type of Lease:
State ☐ Fee ☒

8. State Oil & Gas Lease No.:

3. Location of Well: Unit Letter D

located 880 feet from the North line

and 930 feet from the West line of

sec. 3 Twp. 30N Rng. 11W

9. Unit Agreement Name:

4. Well No: 1A

10. Farm or Lease Name:
Lester

5. API No: 30-045-24550 ²⁴¹⁵⁵

11. Field and Pool or Wildcat:
Blanco Mesa Verde

Check the appropriate box for category sought and information submitted. Enter
Required information on lines 1 and 2, below.

1. Category sought NGPA Section No. 107 A1 ☐ occluded natural gas from coal seam
A3 ☒ natural gas from a designated tight formation

2. Filing Fee(s) amount enclosed: \$25.00

3. All application must contain:

- a. C-105 Well Completion or Recompletion Report
- b. Affidavits of Mailing or Delivery

I HEREBY CERTIFY THAT THE INFORMATION CONTAINED HEREIN IS TRUE AND COMPLETE TO
THE BEST OF MY KNOWLEDGE AND BELIEF.

David K. Miller

NAME OF APPLICANT (Type or Print)

SIGNATURE OF APPLICANT

TITLE: Manager, Royalty Compliance/Litigation

DATE: December 4, 2000

FOR DIVISION USE ONLY

APPROVED: ☒

DISAPPROVED: ☐

The information contained herein includes all of the information required to be filed by the applicant under
Subpart B of Part 274 of the FERC regulations

EXAMINER:

BURLINGTON RESOURCES

December 4, 2000

Mr. Michael Stogner
State of New Mexico
Energy and Minerals Department
Oil Conservation Division
2040 Pacheco Street
Santa Fe, NM 87505



Re: Application for Well Determination
NGPA Section 107
Lester #1A
San Juan Co., NM

Dear Mr. Stogner:

Burlington Resources Oil & Gas Company is enclosing, for review and approval by the New Mexico Oil Conservation Division, the original and two copies of an Application for Determination for the referenced well.

A copy of this letter, the FERC Form 121 and the OCD Form C-132 has been mailed to each working interest owner entitled to receive Notice of this Application.

Please indicate receipt of this filing by date stamping the attached extra copy of this letter and returning the copy for our records.

Sincerely,

David K. Miller
Manager, Royalty Compliance/Litigation

enclosures

xc: NGPA File

APPLICATION FOR DETERMINATION

A. THE NGPA WELL CATEGORY DETERMINATION IS BEING SOUGHT FOR A WELL PRODUCING:

- A1 _____ occluded natural gas from a coal seam.
A2 _____ natural gas from Devonian shale.
A3 X natural gas from a designated tight formation.

B. FOR ALL APPLICATIONS FOR DETERMINATION PROVIDE THE FOLLOWING:

1. Well Name and No.: Lester #1A
2. Completed in (Name of Reservoir): Mesa Verde
3. Field: Blanco
4. County: San Juan
5. State: New Mexico
6. API Well No.: 30-045-²⁴¹⁵⁵~~24550~~
7. Measured Depth of the Completion Interval (in feet)
TOP: 4,316' BASE: 4,654'

B. APPLICANT'S MAILING ADDRESS AND THE IDENTITY OF THE PERSON WHO IS RESPONSIBLE FOR APPLICATION:

1. Applicant's Name: Burlington Resources Oil & Gas Co.
2. Street: 5051 Westheimer, Suite 1400
3. City: Houston
4. State: Texas
5. Zip Code: 77056-5604
6. Name of Person Responsible: David K. Miller (713) 624-9086
7. Title of Such Person: Manager, Royalty Compliance/Litigation
8. Signature David K. Miller
Date: December 4, 2000

APPLICATION FOR WELL CATEGORY DETERMINATION
PURSUANT TO SECTION 270 OF
THE FEDERAL ENERGY REGULATORY COMMISSION'S
REGULATIONS IMPLEMENTING
THE NATURAL GAS POLICY ACT OF 1978 (NGPA)

AFFIDAVIT
TIGHT FORMATION GAS

STATE OF TEXAS

COUNTY OF HARRIS

BEFORE ME, the undersigned authority, duly commissioned and qualified within and for the State and County aforesaid, personally came and appeared David K. Miller, who being by me first duly sworn, deposed and said:

That he is the Manager, Royalty Compliance/Litigation for Burlington Resources Oil & Gas Company, the applicant for the well hereinafter described, and in that capacity, he is requesting the appropriate Authorized Officer to make a determination that this well is producing from a tight formation pursuant to the rules and regulations of the State of New Mexico and the Federal Energy Regulatory Commission (FERC), as such rules relate to the NGPA.

That production from the **Lester #1A** well, API No. **30-045-24155** is natural gas produced from a FERC designated tight formation, assigned State No. NM-48, through:

- X a well the surface drilling of which began after December 31, 1979, but before January 1, 1993; or
- a recompletion commenced after January 1, 1993, in a well the surface drilling of which began after December 31, 1979, but before January 1, 1993; or
- a recompletion commenced after December 31, 1979, but before January 1, 1993, where such gas could not have been produced from any completion location in existence in the well bore before January 1, 1980.

Said applicant has no knowledge of any information not described in the application that is inconsistent with his conclusion.

David K. Miller,
Manager, Royalty Compliance/Litigation

Subscribed in my presence and duly sworn to before me, this 5th day of December 2000.

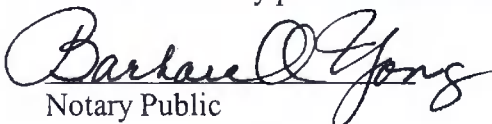
Notary Public

NMOCD Affidavit

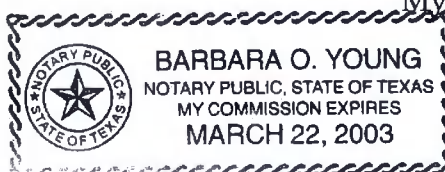

My Commission Expires: 3-22-03

NO. OF COPIES RECEIVED	5
DISTRIBUTION	
SANTA FE	1
FILE	
U.S.G.S.	2
LAND OFFICE	
OPERATOR	1

Form C-105
Revised 1-1-65

NEW MEXICO OIL CONSERVATION COMMISSION WELL COMPLETION OR RECOMPLETION REPORT AND LOG

5a. Indicate Type of Lease
State ☐ Fee ☒
5. State Oil & Gas Lease No.

1a. TYPE OF WELL
OIL WELL ☐ GAS WELL ☒ DRY ☐ OTHER _____
b. TYPE OF COMPLETION
NLW WELL ☒ WORK OVER ☐ DEEPEN ☐ PLUG BACK ☐ DIFF. RESVR. ☐ OTHER _____

7. Unit Agreement Name
8. Farm or Lease Name
LESTER

2. Name of Operator
SUPRON ENERGY CORPORATION

9. Well No.
1-A

3. Address of Operator
P.O. Box 808, Farmington, New Mexico 87401

10. Field and Pool, or Wildcat
Blanco Mesaverde

4. Location of Well
UNIT LETTER **D** LOCATED **880** FEET FROM THE **North** LINE AND **930** FEET FROM

12. County
San Juan

THE **West** LINE OF SEC. **3** TWP. **30N** RGE. **11W** NMPM

15. Date Spudded 1-29-80	16. Date T.D. Reached 2-10-80	17. Date Compl. (Ready to Prod.) 5-2-80	18. Elevations (DF, RKB, RT, GR, etc.) 5651 Ft. R.K.B.	19. Elev. Casinghead 5639
------------------------------------	---	---	--	-------------------------------------

20. Total Depth 4690	21. Plug Back T.D. 4654	22. If Multiple Compl., How Many	23. Intervals Drilled By 0 - 4690	Rotary Tools 0 - 4690	Cable Tools - - -
--------------------------------	-----------------------------------	----------------------------------	---	---------------------------------	-----------------------------

24. Producing Interval(s), of this completion - Top, Bottom, Name
4316 - 4582 Mesaverde

25. Was Directional Survey Made
No

26. Type Electric and Other Logs Run
Induction Electric and Compensated Density

27. Was Well Cored
No

28. CASING RECORD (Report all strings set in well)

CASING SIZE	WEIGHT LB./FT.	DEPTH SET	HOLE SIZE	CEMENTING RECORD	AMOUNT PULLED
8-5/8"	24.00	295	12-1/4"	275 Sacks	
5-1/2"	15.50	4690	7-7/8"	550 Sacks (2 Stages)	

29. LINER RECORD

SIZE	TOP	BOTTOM	SACKS CEMENT	SCREEN	SIZE	DEPTH SET	PACKER SET
					2-1/16" 3.25	4526'	

30. TUBING RECORD

31. Perforation Record (Interval, size and number)
**1 - 0.42" hole at each of the following depths:
4316, 4319, 4324, 4327, 4456, 4458, 4461, 4464,
4467, 4491, 4493, 4496, 4501, 4503, 4505, 4516,
4518, 4522, 4536, 4539, 4542, 4558, 4560, 4574,
4582. (Total of 25 Holes)**

32. ACID, SHOT, FRACTURE, CEMENT SQUEEZE, ETC.
DEPTH INTERVAL
4316 - 4582
AMOUNT AND KIND MATERIAL USED
**2000 Gal. 15 HCL, 75,000 lb.
20-40 sand, & 81,000 gal.
of 1% KCL water**

33. PRODUCTION

Date First Production _____ Production Method (Flowing, gas lift, pumping - Size and type pump)
Flowing

Well Status (Prod. or Shut-in)
Shut-In

Date of Test 5-2-80	Hours Tested 3	Choke Size 3/4"	Prod'n. For Test Period Oil - Bbl. _____ Gas - MCF 245	Water - Bbl. _____ Gas - Oil Ratio _____
Flow Tubing Press. 150	Casing Pressure 787	Calculated 24-Hour Rate Oil - Bbl. _____ Gas - MCF 1952	Water - Bbl. _____ Gas - Oil Ratio _____	API (Corr.) _____

34. Disposition of Gas (Sold, used for fuel, vented, etc.)
Vented

Test Witnessed By
Bennie Brown

35. List of Attachments

36. I hereby certify that the information shown on both sides of this form is true and complete to the best of my knowledge and belief.

SIGNED Kenneth E. Roddy TITLE Production Superintendent DATE May 6, 1980
Kenneth E. Roddy

NEW MEXICO OIL CONSERVATION COMMISSION
 LOCATION AND ACREAGE DEDICATION PLAT

Form C-10
 Superintend
 Effective

All distances must be from the outer boundaries of the Section.

Operator SUPRON ENERGY CORPORATION			Lease LESTER		Well No. 1-A
Unit Letter D	Section 3	Township 30 NORTH	Range 11 WEST	County SAN JUAN	
Actual Footage Location of Well:					
880 feet from the NORTH line and		930 feet from the WEST line			
Ground Level Elev. 5639	Producing Formation MESAVERDE	Pool BLANCO		Dedicated Acreage: N 1/2 320.40	

1. Outline the acreage dedicated to the subject well by colored pencil or hachure marks on the plat below.
2. If more than one lease is dedicated to the well, outline each and identify the ownership thereof (both as to working interest and royalty).
3. If more than one lease of different ownership is dedicated to the well, have the interests of all owners been consolidated by communitization, unitization, force-pooling, etc?

☐ Yes ☐ No If answer is "yes," type of consolidation _____

If answer is "no," list the owners and tract descriptions which have actually been consolidated. (Use reverse side of this form if necessary.) _____

No allowable will be assigned to the well until all interests have been consolidated (by communitization, unitization, forced-pooling, or otherwise) or until a non-standard unit, eliminating such interests, has been approved by the Commission.

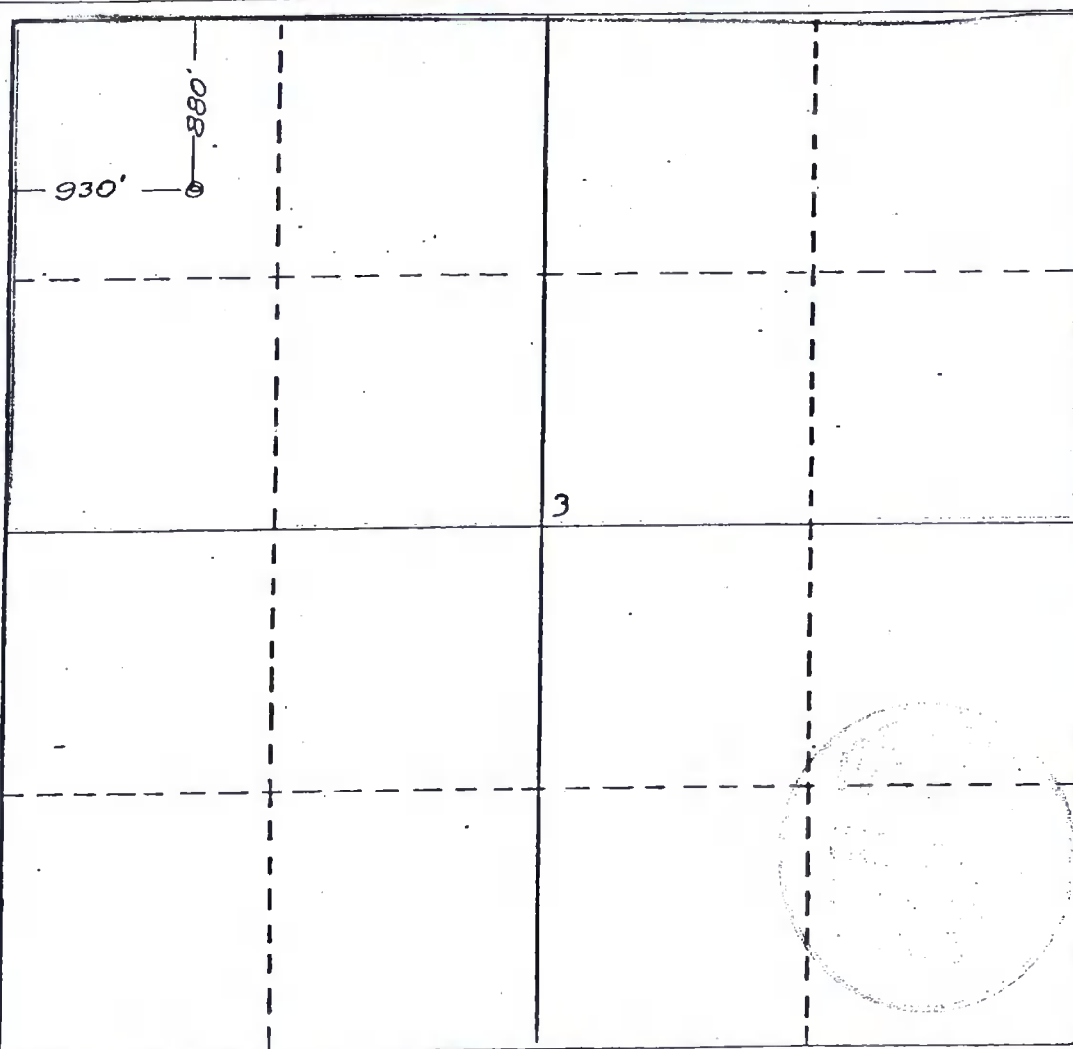

CERTIFICATION

I hereby certify that the information contained herein is true and complete to the best of my knowledge and belief.

Rudy D. Motto
 Name

Rudy D. Motto
 Position

Area Superintendent

Company

Supron Energy Corporation

Date

April 26, 1979

I hereby certify that the information shown on this plat is true and correct to the best of my knowledge and belief.

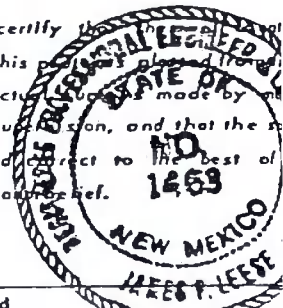

Date Surveyed
 24 April 1979

Registered Professional Engineer
 and/or Land Surveyor

James P. Leese
 James P. Leese

Certificate No.
 1463

District I
PO Box 1980, Hobbs, NM 88241-1980

District II
P.O. Drawer DD, Artesia, NM 88211-0719

District III
1000 Rio Brazos Rd., Aztec, NM 87410

District IV
PO Box 2088, Santa Fe, NM 87504-2088

State of New Mexico
Energy, Minerals, & Natural Resources Department

OIL CONSERVATION DIVISION
PO Box 2088

Santa Fe, NM 87504-2088

Form C-104
Revised February 21, 1994
Instructions on back
Submit to Appropriate District Office
5 Copies

☐ AMENDED REPORT

I. REQUEST FOR ALLOWABLE AND AUTHORIZATION TO TRANSPORT

¹ Operator Name and Address Burlington Resources Oil & Gas PO Box 4289 Farmington, NM 87499		² OGRID Number 14538
		³ Reason for Filing Code CO - 7/11/96
⁴ API Number 30-045-24155	⁵ Pool Name BLANCO MESAVERDE (PRORATED) GAS	⁶ Pool Code 72319
⁷ Property Code 007259	⁸ Property Name LESTER	⁹ Well Number #1A

II. ¹⁰ Surface Location

UI or lot no.	Section	Township	Range	Lot.Idn	Feet from the	North/South Line	Feet from the	East/West Line	County
D	3	030N	011W		880	N	930	W	SAN JUAN

¹¹ Bottom Hole Location

UI or lot no.	Section	Township	Range	Lot.Idn	Feet from the	North/South Line	Feet from the	East/West Line	County		
¹² Lse Code		¹³ Producing Method Code		¹⁴ Gas Connection Date		¹⁵ C-129 Permit Number		¹⁶ C-129 Effective Date		¹⁷ C-129 Expiration Date	

III. Oil and Gas Transporters

¹⁸ Transporter OGRID	¹⁹ Transporter Name and Address	²⁰ POD	²¹ O/G	²² POD ULSTR Location and Description
25244	WILLIAMS FIELD SERVICES CO P.O. BOX 58900 SALT LAKE CITY, UT 84158-0900		G	D-03-T030N-R011W
9018	Giant Industries 5764 US Hwy 64 Farmington, NM 87401	1811110	O	D-03-T030N-R011W

IV. Produced Water

²³ POD	²⁴ POD ULSTR Location and Description
-------------------	--

CMD :
OG6IWCM

ONGARD
INQUIRE WELL COMPLETIONS

05/04/01 16:24:26
OGOMES -TQBF

API Well No : 30 45 24155 Eff Date : 09-01-1980 WC Status : A
Pool Idn : 72319 BLANCO-MESAVERDE (PRORATED GAS)
OGRID Idn : 14538 BURLINGTON RESOURCES OIL & GAS CO
Prop Idn : 7259 LESTER

Well No : 001A
GL Elevation: 5639

	U/L	Sec	Township	Range	North/South	East/West	Prop/Act (P/A)
B.H. Locn	: 4	3	30N	11W	FTG 880 F N FTG	930 F W	P

Lot Identifier:

Dedicated Acre: 320.40

Lease Type : P

Type of consolidation (Comm, Unit, Forced Pooling - C/U/F/O) :

M0025: Enter PF keys to scroll

PF01 HELP	PF02	PF03 EXIT	PF04 GoTo	PF05	PF06
PF07	PF08	PF09	PF10 NEXT-WC	PF11 HISTORY	PF12 NXTREC

CMD : ONGARD 05/04/01 16:25:14
 OG6ACRE C102-DEDICATE ACREAGE OGOMES -TQBE
 Page No : 1

API Well No : 30 45 24155 Eff Date : 04-30-1991
 Pool Idn : 72319 BLANCO-MESAVERDE (PRORATED GAS)
 Prop Idn : 7259 LESTER Well No : 001A
 Spacing Unit : 34880 OCD Order : Simultaneous Dedication:
 Sect/Twp/Rng : Acreage : 320.40 Revised C102? (Y/N) :
 Dedicated Land:

S	Base	U/L	Sec	Twp	Rng	Acreage	L/W	Ownership	Lot	Idn
		E	3	30N	11W	40.00	N	FE		
		F	3	30N	11W	40.00	N	FE		
		G	3	30N	11W	40.00	N	FD		
		H	3	30N	11W	40.00	N	FD		
	A	1	3	30N	11W	40.02	N	FE		
	B	2	3	30N	11W	40.08	N	FD		
	C	3	3	30N	11W	40.12	N	FD		
	D	4	3	30N	11W	40.18	N	FD		

E0005: Enter data to modify or PF keys to scroll

PF01 HELP PF02 PF03 EXIT PF04 GoTo PF05 PF06 CONFIRM
 PF07 BKWD PF08 FWD PF09 PF10 LAND PF11 NXTSEC PF12 RECONF

ENERGY, MINERALS AND NATURAL RESOURCES DEPT.

No 53302

OFFICIAL RECEIPT

5/1/01

X

RECEIVED FROM

Burlington Resources

\$ 250.00

DOLLARS

FOR

NGPA Filing Fees (10 applications)

CODE

CODE

BY

Kathy Valdes

DR. CR.	ACCOUNT NUMBER	CENTER NUMBER	RECEIPT NUMBER	AMOUNT	RECEIVED FROM	DEPOSIT NUMBER	WORK ORDER NO.
REN	9696	0711		250.00	RC		
					RC		
					RC		

GRAND TOTAL \$

CHECK REQUEST SUPPORT

AIN NO.	WELL NAME & NO.	PROPERTY NO.	LOCATION	COUNTY	ST.	AMOUNT	COMMENT
268501	Hartman Com #5	071041600	Sec. 23, T-30N, R-11W	San Juan	NM	\$ 25.00	
673301	Brookhaven Com B #3R	012582201	Sec. 16, T-31N, R-11W	San Juan	NM	\$ 25.00	
7169501	Standard Oil Com #1A	0023080	Sec. 36, T-29N, R-9W	San Juan	NM	\$ 25.00	
5015901	Wilmuth #1	0126382	Sec. 26, T-31N, R-11W	San Juan	NM	\$ 25.00	
1138501	Hanley W M #1E	071083500	Sec. 18, T-29N, T10W	San Juan	NM	\$ 25.00	
4300301	Lester #1-A	071113300	Sec. 3, T-30N, R-11W	San Juan	NM	\$ 25.00	
5414401	Schultz Com G #13A	072014800	Sec. 16, T-27N, R-8W	San Juan	NM	\$ 25.00	
5449401	Fifield #4	072017300	Sec. 32, T-30N, R-11W	San Juan	NM	\$ 25.00	
267601	Atlantic D Com E #6R	071040600	Sec. 16, T-30N, R-10W	San Juan	NM	\$ 25.00	
5448701	Fuller #3	012589000	Sec. 33, T-30N, R-11W	San Juan	NM	\$ 25.00	
TOTAL						\$ 250.00	

BURLINGTON RESOURCES801 Cherry Street Suite 200
Ft. Worth TX 76102-6842CITIBANK (Delaware)
A Subsidiary of Citicorp
One Penn's Way
New Castle DE 19720
62-20/311

0000619756

Vendor No. 67739200

Date 03/22/2001 Pay Amount \$250.00

Void If Not Presented for Payment Within 60 Days

To The
Order OfNEW MEXICO STATE
OIL CONSERVATION DIVISION
1220 S SAINT FRANCIS DR
SANTA FE NM 87505-

⑈0000619756⑈ ⑆031100209⑆ 38822376⑈

BURLINGTON RESOURCES
801 Cherry Street Suite 200
Ft. Worth TX 76102-6842
(817) 347-2950

Vendor No. 67739200

Check Date 03/22/2001

Check No. 0000619756

Vendor Name NEW MEXICO STATE

Voucher ID	Invoice Number	Invoice Date	Payment Comments	Paid Amount
00600605	RFC	03/07/2001		\$250.00
TOTAL				\$250.00

on non-Federal residential buildings are also relevant to a building energy standard for Federal residences because the comments address issues of feasibility and cost-effectiveness. These and any future comments on the non-Federal residential standards will be given serious consideration for potential applicability to the Federal residential standard development required by the Energy Policy Act of 1992.

Issued in Washington, DC August 5, 1993.

Robert L. San Martin,

Acting Assistant Secretary, Energy Efficiency and Renewable Energy.

[FR Doc. 93-19409 Filed 8-11-93; 8:45 am]

BILLING CODE 6840-01-P

Federal Energy Regulatory Commission

[Docket No. JD93-13529T New Mexico-48]

United States Department of the Interior, Bureau of Land Management; NGPA Notice of Determination by Jurisdictional Agency Designating Tight Formation.

August 6, 1993.

Take notice that on July 30, 1993, the United States Department of the Interior's Bureau of Land Management (BLM) submitted the above-referenced notice of determination pursuant to § 271.703(c)(3) of the Commission's regulations, that the Mesaverde Group underlying certain lands in the Blanco Mesaverde Area of the Blanco Mesaverde Pool in San Juan and Rio Arriba Counties, New Mexico, qualifies as a tight formation under section 107(b) of the Natural Gas Policy Act of 1978. The area of application covers approximately 480,076 acres, more or less, and consists of 78.68% Federal, 0.33% Navajo Allotted, 12.08% State and 8.91% Fee Lands. The recommended area is described on the attached appendix.

The notice of determination also contains BLM's and the New Mexico Department of Energy, Minerals and Natural Resources' findings that the referenced portion of the Mesaverde Group meets the requirements of the Commission's regulations set forth in 18 CFR part 271.

The application for determination is available for inspection, except for material which is confidential under 18 CFR 275.206, at the Federal Energy Regulatory Commission, 825 North Capitol Street, NE., Washington, DC 20426. Persons objecting to the determination may file a protest, in accordance with 18 CFR 275.203 and

275.204, within 20 days after the date this notice is issued by the Commission. Limwood A. Watson, Jr., Acting Secretary.

Appendix

TOWNSHIP 27 NORTH, RANGE 7 WEST

Sections 1-12: All

Section 15: W/2

Sections 16-21: All

Section 22: W/2

Section 27: NW/4

Section 28: N/2

Sections 29-30: All

TOWNSHIP 27 NORTH, RANGE 8 WEST

Sections 1-36: All

TOWNSHIP 28 NORTH, RANGE 7 WEST

TOWNSHIP 28 NORTH, RANGE 8 WEST

TOWNSHIP 28 NORTH, RANGE 9 WEST

TOWNSHIP 28 NORTH, RANGE 10 WEST

Sections 7-36: All (Irregular Township)

TOWNSHIP 29 NORTH, RANGE 7 WEST

TOWNSHIP 29 NORTH, RANGE 8 WEST

TOWNSHIP 29 NORTH, RANGE 9 WEST

TOWNSHIP 29 NORTH, RANGE 10 WEST

TOWNSHIP 29 NORTH, RANGE 11 WEST

TOWNSHIP 30 NORTH, RANGE 7 WEST

TOWNSHIP 30 NORTH, RANGE 8 WEST

TOWNSHIP 30 NORTH, RANGE 9 WEST

TOWNSHIP 30 NORTH, RANGE 10 WEST

TOWNSHIP 30 NORTH, RANGE 11 WEST

Sections 1-36: All

TOWNSHIP 31 NORTH, RANGE 6 WEST

Sections 6-7: All

Sections 18-19: All

Section 30: All

TOWNSHIP 31 NORTH, RANGE 7 WEST

TOWNSHIP 31 NORTH, RANGE 8 WEST

TOWNSHIP 31 NORTH, RANGE 9 WEST

TOWNSHIP 31 NORTH, RANGE 10 WEST

TOWNSHIP 31 NORTH, RANGE 11 WEST

Sections 1-36: All

TOWNSHIP 32 NORTH, RANGE 10 WEST

TOWNSHIP 32 NORTH, RANGE 11 WEST

Sections 7-36: All (Irregular Township)

[FR Doc. 93-19327 Filed 8-11-93; 8:45 am]

BILLING CODE 6717-01-M

Energy, DOE.

Oil Energy of gives notice granting (NGC) port and to Canada ural gas ntry. The o import a l Bcf of gas. o 130 Bcf of ginning on of either ober 31.

r inspection. f Fuels -056. pendence DC 20585. room is.

NM-48
Final on 13 Sep 93.
OK

480,076 acres.
MU Group

NM-1813-92

///