

NO. OF COPIES RECEIVED	
DISTRIBUTION	
SANTA FE	
FILE	✓
U.S.G.S.	
LAND OFFICE	
OPERATOR	

NEW MEXICO OIL CONSERVATION COMMISSION

Form C-101
Revised 1-1-65

Apt #
30-037-20029

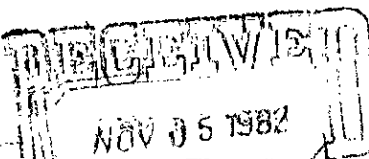

5A. Indicate Type of Lease STATE <input type="checkbox"/> FEE <input checked="" type="checkbox"/>
5. State Oil & Gas Lease No.
7. Unit Agreement Name
8. Farm or Lease Name T-4 Cattle Co.
9. Well No. 15
10. Field and Pool, or Wildcat Undesignated
12. County Quay
19. Proposed Depth 5600'
19A. Formation Granite
20. Rotary or C.T. Rotary
21. Elevations (Show whether DF, RT, etc.) 4311
21A. Kind & Status Plug. Bond Statewide on file
21B. Drilling Contractor Unknown
22. Approx. Date Work will start Dec 1, 1982

APPLICATION FOR PERMIT TO DRILL, DEEPEN OR PLUG BACK			
1a. Type of Work DRILL <input checked="" type="checkbox"/> DEEPEN <input type="checkbox"/> PLUG BACK <input type="checkbox"/>			
b. Type of Well OIL WELL <input type="checkbox"/> GAS WELL <input checked="" type="checkbox"/> OTHER <input type="checkbox"/> SINGLE ZONE <input checked="" type="checkbox"/> MULTIPLE ZONE <input type="checkbox"/>			
2. Name of Operator RKH LTD.			
3. Address of Operator P. O. Box 1552 Midland, Texas 79702			
4. Location of Well UNIT LETTER M LOCATED 1320 660 FEET FROM THE South LINE AND 1320 FEET FROM THE West LINE OF SEC. 5 TWP. 10-N RGE. 27-E NMPM			
5. PROPOSED CASING AND CEMENT PROGRAM			
SIZE OF HOLE	SIZE OF CASING	WEIGHT PER FOOT	SETTING DEPTH
12 1/2	8 5/8	24	350
7 7/8	4 1/2	10.5	5600
SACKS OF CEMENT		EST. TOP	
300		Surface	
200		4500	

MIRURT. Drill a 12 1/2" hole to 350'. Set & cement 8 5/8" O.D. 24#/ft K-55 new casing @ 350' and cement with 300 sacks. Cement quantity should circulate to surface. If not, bring cement to surface with 1" pipe. WOC 18 hrs. NU and test BOP. Test casing to 1000 psi. Drill out w/7 7/8" bit with water. Mud up at 3800' to 10#/gal and 38 sec viscosity. Run DST if samples yield shows. At T.D. run Log Suite. If production is indicated, run 4 1/2" 10.5#/ft K-55 new casing to T.D. and cement with 200 sacks cement.

COLLECT AND SACK SAMPLES FOR
NEW MEXICO BUREAU OF MINES, SOCORRO
AT AT LEAST TEN FOOT INTERVALS

APPROVAL VALID FOR 90 DAYS
PERMIT EXPIRES 2/7/83
UNLESS DRILLING UNDERWAY

ABOVE SPACE DESCRIBE PROPOSED PROGRAM: IF PROPOSAL IS TO DEEPEN OR PLUG BACK, GIVE DATA ON PRESENT PRODUCTIVE ZONE AND PROPOSED NEW PRODUCTION ZONE. GIVE BLOWOUT PREVENTER PROGRAM, IF ANY.

I hereby certify that the information above is true and complete to the best of my knowledge and belief.

Signed [Signature] Title Agent Date November 2, 1982

(This space for State Use)

PROVED BY Carl Ulloa TITLE DISTRICT SUPERVISOR DATE 11/8/82

CONDITIONS OF APPROVAL, IF ANY:

OIL CONSERVATION COMMISSION TO BE NOTIFIED
WITHIN 24 HOURS OF BEGINNING OPERATIONS

OIL CONSERVATION DIVISION

STATE OF NEW MEXICO
ENERGY AND MINERALS DEPARTMENTP. O. BOX 2088
SANTA FE, NEW MEXICO 87501Form C-102
Revised 10-1-78

All distances must be from the outer boundaries of the Section.

Operator YATES PETROLEUM CORPORATION			Lease T-4 Cattle Co.		Well No. 1-5
Unit Letter N	Section 5	Township 10 North	Range 27 East	County Quay	
Actual Footage Location of Well: 660 feet from the South line and 1980 feet from the West line					
Ground Level Elev. 4311' GL	Producing Formation Penn		Pool Wildcat	Dedicated Acreage: 40 Acres	

1. Outline the acreage dedicated to the subject well by colored pencil or hatchure marks on the plat below.
2. If more than one lease is dedicated to the well, outline each and identify the ownership thereof (both as to working interest and royalty).
3. If more than one lease of different ownership is dedicated to the well, have the interests of all owners been consolidated by communitization, unitization, force-pooling, etc?

☐ Yes ☐ No If answer is "yes," type of consolidation _____

If answer is "no," list the owners and tract descriptions which have actually been consolidated. (Use reverse side of this form if necessary.) _____

No allowable will be assigned to the well until all interests have been consolidated (by communitization, unitization, forced-pooling, or otherwise) or until a non-standard unit, eliminating such interests, has been approved by the Division.

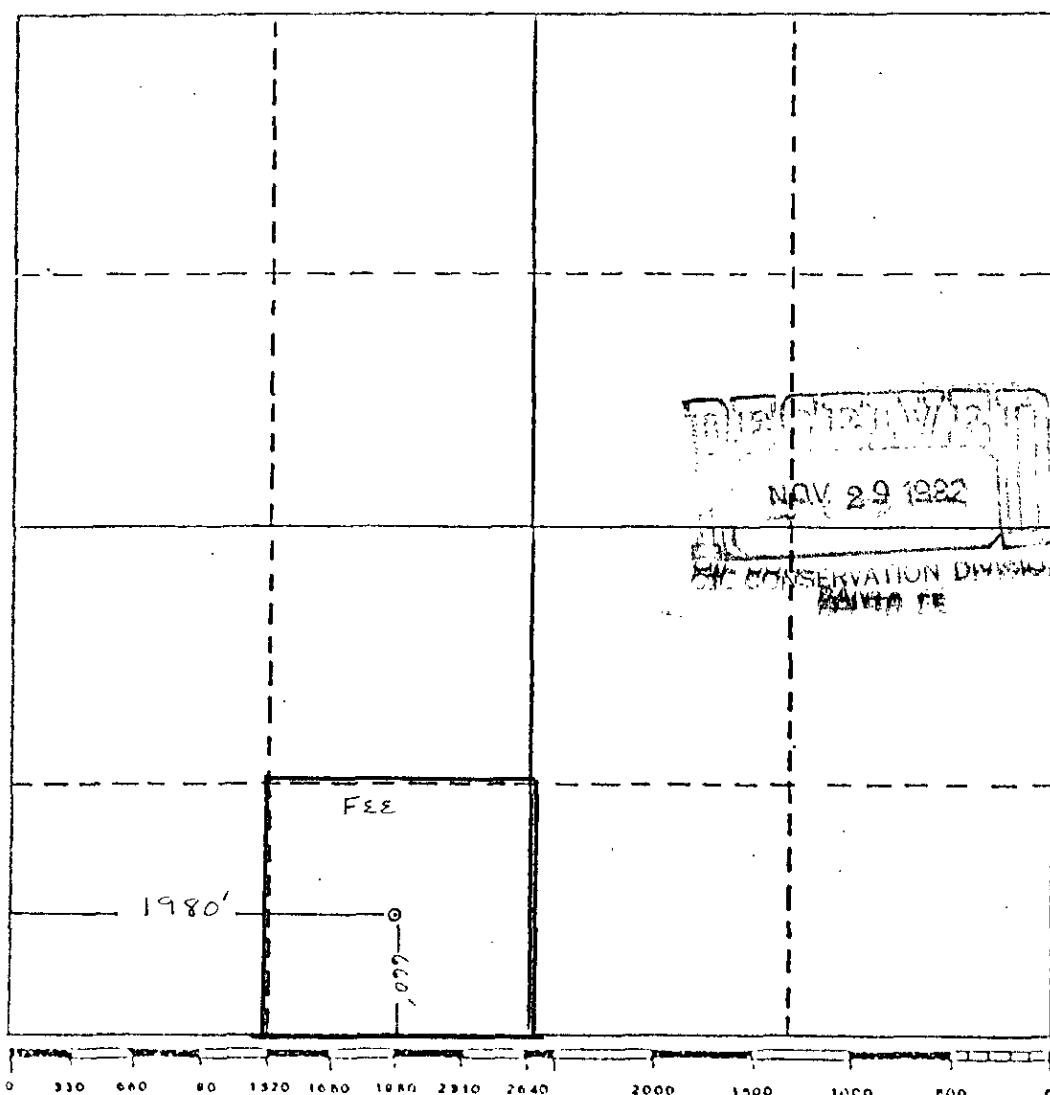

CERTIFICATION

I hereby certify that the information contained herein is true and complete to the best of my knowledge and belief.

Name
Gliserio Rodriguez
Position
Regulatory Manager
Company
Yates Petroleum Corp.
Date
11/22/82

I hereby certify that the well location shown on this plat was plotted from field notes of actual surveys made by me or under my supervision, and that the same is true and correct to the best of my knowledge and belief.

Date Surveyed
REFER TO ORIGINAL PLAT
Registered Professional Engineer
and/or Land Surveyor

Certificate No.