



Before the Oil Conservation Division
Examiner Hearing August 5, 2021

Compulsory Pooling

Case No. 22082: Santa Fe Fed Com 603H

**STATE OF NEW MEXICO
ENERGY, MINERALS AND NATURAL RESOURCES DEPARTMENT
OIL CONSERVATION DIVISION**

**APPLICATION OF FRANKLIN MOUNTAIN
ENERGY, LLC FOR COMPUSLORY POOLING,
LEA COUNTY, NEW MEXICO.**

CASE NO. 22082

TABLE OF CONTENTS

Tab A: Compulsory Pooling Checklist

Tab B: Affidavit of Shelly Albrecht, Land Professional

- Exhibit 1: Development Overview
- Exhibit 2: Application
- Exhibit 3: C-102
- Exhibit 4: Lease Tract Map and Interests
- Exhibit 5: Summary of Contacts
- Exhibit 6: Sample Proposal Letter
- Exhibit 7: AFE
- Exhibit 8: Notice Affidavit

Tab C: Affidavit of Ben Kessel, Geologist

- Exhibit 9: Locator Map
- Exhibit 10: Wellbore Schematic
- Exhibit 11-A: Structure Map
- Exhibit 11-B: Cross-Section Reference Map
- Exhibit 11-C: Stratigraphic Cross-Section
- Exhibit 11-D: Gross Interval Isochore
- Exhibit 12: Regional Stress Orientation Justification

COMPULSORY POOLING APPLICATION CHECKLIST

ALL INFORMATION IN THE APPLICATION MUST BE SUPPORTED BY SIGNED AFFIDAVITS

Case: 22082	APPLICANT'S RESPONSE
Date: August 3, 2021	
Applicant	Franklin Mountain Energy, LLC
Designated Operator & OGRID (affiliation if applicable)	Franklin Mountain Energy, LLC (373910)
Applicant's Counsel:	Modrall Sperling (Deana Bennett, Jamie Allen)
Case Title:	Application of Franklin Mountain Energy, LLC for Compulsory Pooling, Lea County, New Mexico
Entries of Appearance/Intervenors:	None
Well Family	Land of Enchantment
Formation/Pool	
Formation Name(s) or Vertical Extent:	Bone Spring
Primary Product (Oil or Gas):	Oil
Pooling this vertical extent:	Bone Spring
Pool Name and Pool Code:	WC-025 G-08 S2535340; BONE SPRING, Pool Code 97088
Well Location Setback Rules:	Statewide rules
Spacing Unit Size:	320 acres
Spacing Unit	
Type (Horizontal/Vertical)	Horizontal
Size (Acres)	320 acres
Building Blocks:	40 acres
Orientation:	North-South
Description: TRS/County	W/2E/2 of Sections 13 and 24, Township 25 South, Range 35 East, NMPM, Lea County, New Mexico
Standard Horizontal Well Spacing Unit (Y/N), If No, describe	Y
Other Situations	
Depth Severance: Y/N. If yes, description	N
Proximity Tracts: If yes, description	N
Proximity Defining Well: if yes, description	N
Applicant's Ownership in Each Tract	Exhibit 4.
Well(s)	
Name & API (if assigned), surface and bottom hole location, footages, completion target, orientation, completion status (standard or non-standard)	Tab B, Exhibits 3, 6

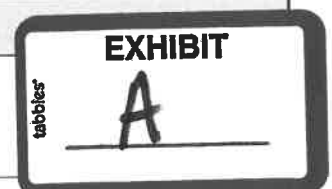

Well #1	Santa Fe Fed Com 603H SHL: 250 feet from the South line and 812 feet from the East line, Section 24, Township 25 South, Range 35 East, NMPM. BHL: 150 feet from the North line and 1689 feet from the East line, Section 13, Township 25 South, Range 35 East, NMPM. Completion Target: Bone Spring at approximately 11,695' TVD. Well Orientation: North/South Completion location: Expected to be standard. See also Exhibit 3 for C-102
Horizontal Well First and Last Take Points	Santa Fe Fed Com 603H Proposed first take point: 640' FSL, 1689' FEL, Proposed last take point: 150' FNL, 1,689' FEL
Completion Target (Formation, TVD and MD)	See Proposal Letter Exhibit 6.
AFE Capex and Operating Costs	
Drilling Supervision/Month \$	\$7000: See also Proposal Letter Exhibit 6
Production Supervision/Month \$	\$700: See also Proposal Letter Exhibit 6
Justification for Supervision Costs	See AFE Exhibit 7
Requested Risk Charge	200%: See also Proposal Letter Exhibit 6
Notice of Hearing	
Proposed Notice of Hearing	Exhibit 8
Proof of Mailed Notice of Hearing (20 days before hearing)	Exhibit 8
Proof of Published Notice of Hearing (10 days before hearing)	Exhibit 8
Ownership Determination	
Land Ownership Schematic of the Spacing Unit	Exhibit 4
Tract List (including lease numbers and owners)	Exhibit 4
Pooled Parties (including ownership type)	Exhibit 4
Unlocatable Parties to be Pooled	Exhibit 4
Ownership Depth Severance (including percentage above & below)	N/A
Joinder	
Sample Copy of Proposal Letter	Exhibit 6
List of Interest Owners (ie Exhibit A of JOA)	Exhibit 4

Chronology of Contact with Non-Joined Working Interests	See Exhibit 5 for Summary of Contacts
Overhead Rates In Proposal Letter	Proposal Letter Exhibit 6
Cost Estimate to Drill and Complete	Proposal Letter Exhibit 6; AFE Exhibit 7.
Cost Estimate to Equip Well	Proposal Letter Exhibit 6; AFE Exhibit 7.
Cost Estimate for Production Facilities	Proposal Letter Exhibit 6; AFE Exhibit 7.
Geology	
Summary (including special considerations)	Tab C
Spacing Unit Schematic	Exhibit 10, Exhibit 11-A
Gunbarrel/Lateral Trajectory Schematic	Exhibit 10, Exhibit 11-A
Well Orientation (with rationale)	Exhibit C, Exhibit 12
Target Formation	Exhibit 10, Exhibit 11-A through 11-D
HSU Cross Section	Exhibit 11-B and 11-C.
Depth Severance Discussion	N/A
Forms, Figures and Tables	
C-102	Exhibit 3
Tracts	Exhibit 4
Summary of Interests, Unit Recapitulation (Tracts)	Exhibit 4
General Location Map (including basin)	Exhibit 9
Well Bore Location Map	Exhibit 9
Structure Contour Map - Subsea Depth	Exhibit 11-A
Cross Section Location Map (including wells)	Exhibit 11-B
Cross Section (including Landing Zone)	Exhibit 11-C
Additional Information	
CERTIFICATION: I hereby certify that the information provided in this checklist is complete and accurate.	
Printed Name (Attorney or Party Representative):	Deana M. Bennett
Signed Name (Attorney or Party Representative):	
Date:	August 3, 2021

7. No opposition is expected because the interest owners being pooled have been contacted regarding the proposed wells, but have failed or refused to voluntarily commit their interests in the wells.

8. The spacing unit and well that Franklin proposes in this case is part of a comprehensive development plan covering the E/2 of Sections 13 and 24, Township 25 South, Range 35 East, NMPM, Lea County, New Mexico. Franklin's development plan includes a total of three units, including both Wolfcamp and Bone Spring units. The Development Overview is attached as **Exhibit 1**.

9. In this case, Franklin seeks an order from the Division pooling all uncommitted working interests and overriding royalty interests a within Bone Spring horizontal spacing unit underlying the W/2E/2 of Sections 13 and 24, Township 25 South, Range 35 East, NMPM, Lea County, New Mexico.

10. This spacing unit will be dedicated to the **Santa Fe Fed Com 603H** well to be horizontally drilled. The Application is attached hereto as **Exhibit 2**.

11. The producing area for the Santa Fe Fed Com 603H well will be orthodox.

12. Attached as **Exhibit 3** is the proposed C-102 for the well.

13. The C-102 identifies the proposed surface hole location, the first take point, and the bottom hole location. The C-102 also identifies the pool and pool code.

14. The well will develop the WC-025 G-09 S253534O, Bone Spring, Pool Code 97088.

15. This pool is an oil pool with 40-acre building blocks.

16. This pool is governed by the state-wide horizontal well rules. The producing interval for the well will be orthodox and will comply with the Division's set back requirements.

17. There are no depth severances within the proposed spacing unit.

18. **Exhibit 4** includes a lease tract map outlining the unit being pooled. Exhibit 4 also includes the parties being pooled, the nature, and the percent of their interests.

19. I have conducted a diligent search of the public records in the county where the well will be located, and conducted phone directory and computer searches to locate contact information for parties entitled to notification, and mailed the working interest owners well proposals, including an Authorization for Expenditure.

20. In my opinion, Franklin has made a good faith effort to obtain voluntary joinder in the proposed well.

21. **Exhibit 5** is a summary of my contacts with the various working interest owners.

22. **Exhibit 6** is a sample of the well proposal letter that was sent. The proposal letter identifies the proposed surface hole and bottom hole locations and approximate TVD/MD for the well.

23. **Exhibit 7** contains the Authorization for Expenditure for the proposed well. The estimated cost of the well set forth therein is fair and reasonable, and is comparable to the costs of other wells of similar depths and length drilled in this area of New Mexico.

24. Franklin requests overhead and administrative rates of \$7000.00/month for drilling a well and \$700.00/month for a producing well. These rates are fair, and comparable to the rates charged by other operators for wells of this type in this area of Southeastern, New Mexico. Franklin requests that these rates be adjusted periodically as provided in the COPAS Accounting Procedure.

25. Franklin requests the maximum cost plus 200% risk charge be assessed against non-consenting working interest owners.

26. Franklin requests that it be designated operator of the well.

27. The parties Franklin is seeking to pool were notified of this hearing.

28. Franklin seeks to pool overriding royalty interest owners, and they were provided notice of this hearing.

29. **Exhibit 8** is an affidavit of notice prepared by counsel for Franklin that shows the parties who were notified of this hearing, the status of whether they received notice, and an affidavit of publication from the Hobbs News-Sun newspaper, showing that notice of this hearing was published on July 21, 2021.

30. The attachments to this declaration were prepared by me, or compiled from company business records, or were prepared at my direction.

31. In my opinion, the granting of this application is in the interests of conservation and the prevention of waste.

32. I declare that the information provided herein is correct and complete to the best of my knowledge and belief.

I declare that the information provided herein is correct and complete to the best of my knowledge and belief.



Shelly Albrecht

Dated: August 2, 2021

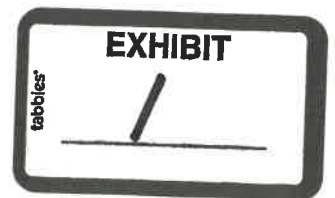
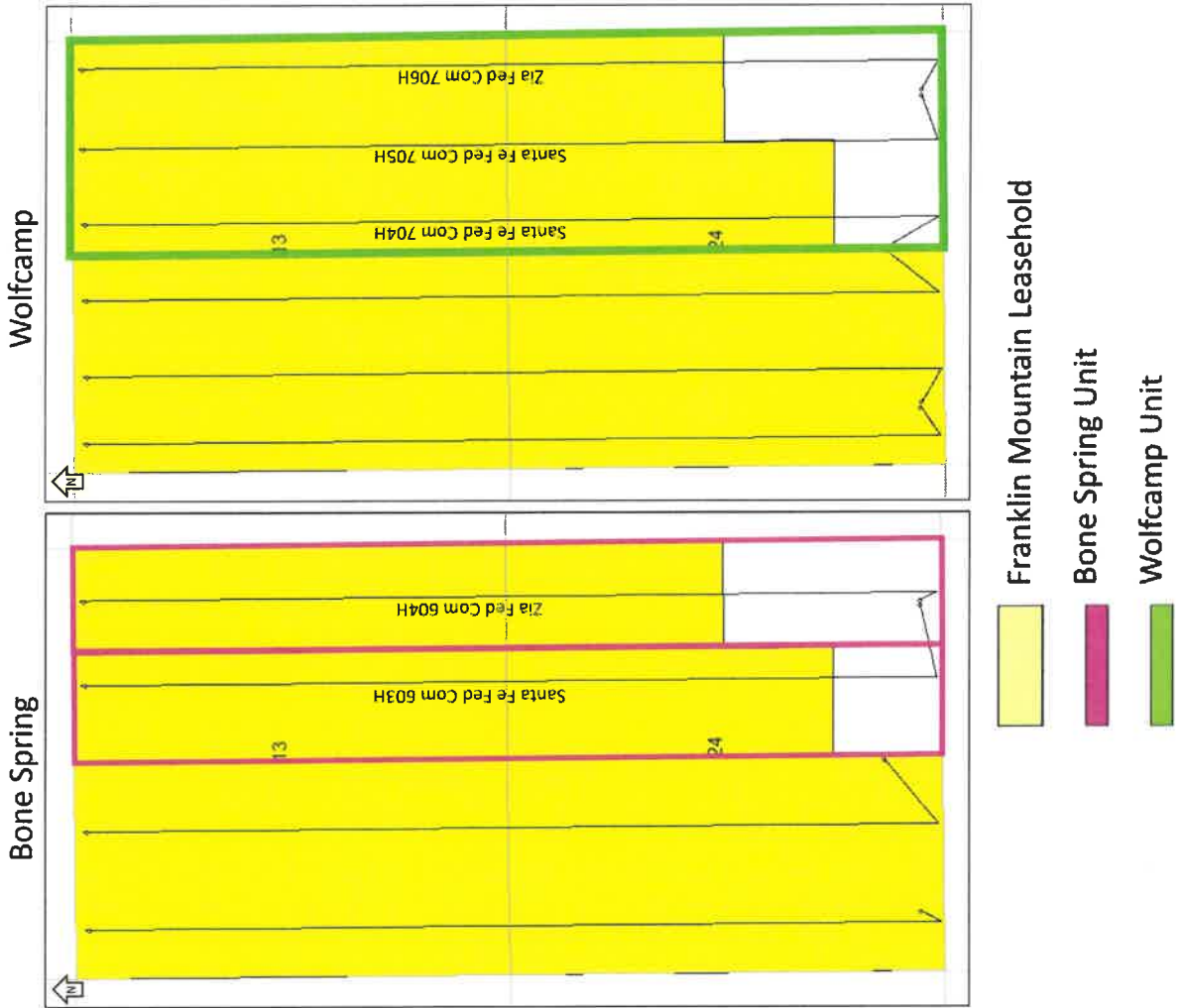

Development Overview

Case Nos. 22078, 22081 and 22082



**STATE OF NEW MEXICO
ENERGY, MINERALS AND NATURAL RESOURCES DEPARTMENT
OIL CONSERVATION DIVISION**

**APPLICATION OF FRANKLIN MOUNTAIN ENERGY, LLC
FOR COMPULSORY POOLING, LEA COUNTY, NEW MEXICO**

CASE NO. 22082

APPLICATION

Franklin Mountain Energy, LLC (“FME”), OGRID Number 373910, through its undersigned attorneys, hereby files this application with the Oil Conservation Division (“Division”) pursuant to the provisions of NMSA 1978, § 70-2-17, for an order pooling all uncommitted mineral interests within a Bone Spring horizontal spacing unit underlying the W/2E/2 of Sections 13 and 24, Township 25 South, Range 35 East, NMPM, Lea County, New Mexico. In support of this application, FME states:

1. FME has an interest in the subject lands and has a right to drill and operate a well thereon.
2. FME seeks to dedicate the W/2E/2 of Sections 13 and 24, Township 25 South, Range 35 East, NMPM, Lea County, New Mexico to form a 320-acre, more or less, spacing unit.
3. FME plans to drill the **Santa Fe Fed Com 603H** well to a depth sufficient to test the Bone Spring formation.
4. The well will be horizontally drilled and will be drilled at orthodox locations under the Division’s rules.
5. FME sought, but has been unable to obtain, a voluntary agreement from all interest owners in the Bone Spring formation underlying the proposed spacing unit to participate in the drilling of the well or to otherwise commit their interests to the well.



6. The pooling of all interests in the Bone Spring formation underlying the proposed unit will prevent the drilling of unnecessary wells, prevent waste and protect correlative rights.

WHEREFORE, FME requests this application be set for hearing before an Examiner of the Oil Conservation Division on August 5, 2021, and after notice and hearing as required by law, the Division enter its order:

A. Pooling all uncommitted interests in the Bone Spring formation underlying a horizontal spacing unit within the W/2E/2 of Sections 13 and 24, Township 25 South, Range 35 East, NMPM, Lea County, New Mexico;

B. Designating FME as operator of this unit and the well to be drilled thereon;

C. Authorizing FME to recover its costs of drilling, completing, and equipping the well;

D. Approving actual operating charges and costs charged for supervision while drilling and after completion, together with a provision adjusting the rates pursuant to the COPAS accounting procedure;

E. Imposing a 200% charge for the risk involved in drilling, completing, and equipping the well in the event a working interest owner elects not to participate in the well.

MODRALL, SPERLING, ROEHL, HARRIS
& SISK, P.A.

By: Deana M. Bennett
Deana M. Bennett
Jamie L. Allen
Post Office Box 2168
500 Fourth Street NW, Suite 1000
Albuquerque, New Mexico 87103-2168
Telephone: 505.848.1800
Attorneys for Applicant

CASE NO. ____: Application of Franklin Mountain Energy, LLC for compulsory pooling, Lea County, New Mexico. Applicant seeks an order from the Division pooling all uncommitted interests within a Bone Spring horizontal spacing unit underlying the W/2E/2 of Sections 13 and 24, Township 25 South, Range 35 East, NMPM, Lea County, New Mexico. This spacing unit will be dedicated to the **Santa Fe Fed Com 603H** well to be horizontally drilled. The producing area for the **Santa Fe Fed Com 603H** well will be orthodox. Also to be considered will be the cost of drilling, completing, and equipping said well, the allocation of these costs as well as the actual operating costs and charges for supervision while drilling and after completion, designation of Franklin Mountain Energy, LLC as operator of the well, and a 200% charge for risk involved in drilling said well. Said area is located approximately 10 miles Northwest of Jal, New Mexico.

District I
1625 N. French Dr., Hobbs, NM 88240
Phone: (575) 393-6161 Fax: (575) 393-0720
District II
811 S. First St., Artesia, NM 88210
Phone: (575) 748-1283 Fax: (575) 748-9720
District III
1000 Rio Brazos Road, Aztec, NM 87410
Phone: (505) 334-6178 Fax: (505) 334-6170
District IV
1220 S. St. Francis Dr., Santa Fe, NM 87505
Phone: (505) 476-3460 Fax: (505) 476-3462

State of New Mexico
Energy, Minerals & Natural Resources Department
OIL CONSERVATION DIVISION
1220 South St. Francis Dr.
Santa Fe, NM 87505

Form C-102
Revised August 1, 2011
Submit one copy to appropriate
District Office

AMENDED REPORT

WELL LOCATION AND ACREAGE DEDICATION PLAT

1 API Number 30-025-48577		2 Pool Code 97088		3 Pool Name WC-025 G-08 S253534O; BONE SPRING	
4 Property Code 330328		5 Property Name SANTA FE FED COM		6 Well Number 603H	
7 OGRID No. 373910		8 Operator Name FRANKLIN MOUNTAIN ENERGY LLC		9 Elevation 3079.8	

10 Surface Location

UL or lot no. P	Section 24	Township 25S	Range 35E	Lot Idn	Feet from the 250	North/South line SOUTH	Feet from the 812	East/West line EAST	County LEA
--------------------	---------------	-----------------	--------------	---------	----------------------	---------------------------	----------------------	------------------------	---------------

11 Bottom Hole Location If Different From Surface

UL or lot no. B	Section 13	Township 25S	Range 35E	Lot Idn	Feet from the 150	North/South line NORTH	Feet from the 1689	East/West line EAST	County LEA
--------------------	---------------	-----------------	--------------	---------	----------------------	---------------------------	-----------------------	------------------------	---------------

12 Dedicated Acres 320	13 Joint or Infill	14 Consolidation Code	15 Order No.
---------------------------	--------------------	-----------------------	--------------

No allowable will be assigned to this completion until all interests have been consolidated or a non-standard unit has been approved by the division.

16

- = SURFACE HOLE LOCATION
- ◇ = KICK OFF POINT & FTP
- = BOTTOM HOLE LOCATION & LTP
- ▲ = SECTION CORNER LOCATED
- △ = SECTION CORNER RE-ESTABLISHED. (Not Set on Ground.)

LINE TABLE		
LINE	DIRECTION	LENGTH
L1	S89°47'20"W	2636.56'
L2	S77°21'51"W	867.69'
L3	N00°16'47"W	583.06'
L4	N00°16'48"W	680.30'

NOTE:
• Distances referenced on plat to section lines are perpendicular.
• Basis of Bearings is a Transverse Mercator Projection with a Central Meridian of W103°53'00" (NAD 83)

17 OPERATOR CERTIFICATION
I hereby certify that the information contained herein is true and complete to the best of my knowledge and belief, and that this organization either owns a working interest or unleased mineral interest in the land including the proposed bottom hole location or has a right to drill this well at this location pursuant to a contract with an owner of such a mineral or working interest, or to a voluntary pooling agreement or a compulsory pooling order heretofore entered by the division.

Signature _____ Date _____
Printed Name _____
E-mail Address _____

18 SURVEYOR CERTIFICATION
I hereby certify that the well location shown on this plat was plotted from field notes of actual surveys made by me or under my supervision, and that the same is true and correct to the best of my belief.

February 11, 2020
Date of Survey
Signature and Seal of Professional Surveyor:

Certificate Number: _____

NAD 83 (SURFACE HOLE LOCATION)	
LATITUDE = 32°06'33.48" (32.109301°)	LONGITUDE = 103°18'55.28" (103.315356°)
NAD 27 (SURFACE HOLE LOCATION)	
LATITUDE = 32°06'33.02" (32.109174°)	LONGITUDE = 103°18'53.62" (103.314894°)
STATE PLANE NAD 83 (N.M. EAST)	N: 404988.33' E: 855633.75'
STATE PLANE NAD 27 (N.M. EAST)	N: 404930.07' E: 815343.45'
NAD 83 (KICK OFF POINT)	
LATITUDE = 32°06'31.58" (32.108774°)	LONGITUDE = 103°19'05.47" (103.318187°)
NAD 27 (KICK OFF POINT)	
LATITUDE = 32°06'31.13" (32.108647°)	LONGITUDE = 103°19'03.81" (103.317725°)
STATE PLANE NAD 83 (N.M. EAST)	N: 404788.33' E: 855633.75'
STATE PLANE NAD 27 (N.M. EAST)	N: 404730.09' E: 814483.46'
NAD 83 (PPP #1 LE)	
LATITUDE = 32°06'37.35" (32.110376°)	LONGITUDE = 103°19'05.47" (103.318187°)
NAD 27 (PPP #1 LE)	
LATITUDE = 32°06'36.90" (32.110249°)	LONGITUDE = 103°19'03.81" (103.317725°)
STATE PLANE NAD 83 (N.M. EAST)	N: 405371.28' E: 855650.47'
STATE PLANE NAD 27 (N.M. EAST)	N: 405313.02' E: 814483.21'
NAD 83 (PPP #2)	
LATITUDE = 32°06'44.08" (32.112246°)	LONGITUDE = 103°19'05.47" (103.318187°)
NAD 27 (PPP #2)	
LATITUDE = 32°06'43.63" (32.112119°)	LONGITUDE = 103°19'03.81" (103.317724°)
STATE PLANE NAD 83 (N.M. EAST)	N: 406051.43' E: 855644.33'
STATE PLANE NAD 27 (N.M. EAST)	N: 405993.17' E: 814457.07'
NAD 83 (PPP #3)	
LATITUDE = 32°06'37.15" (32.111874°)	LONGITUDE = 103°19'05.46" (103.318184°)
NAD 27 (PPP #3)	
LATITUDE = 32°06'36.69" (32.111747°)	LONGITUDE = 103°19'03.80" (103.317722°)
STATE PLANE NAD 83 (N.M. EAST)	N: 407371.50' E: 855632.34'
STATE PLANE NAD 27 (N.M. EAST)	N: 407313.19' E: 814445.15'
NAD 83 (BOTTOM HOLE LOCATION)	
LATITUDE = 32°08'14.12" (32.137255°)	LONGITUDE = 103°19'05.43" (103.318176°)
NAD 27 (BOTTOM HOLE LOCATION)	
LATITUDE = 32°08'13.66" (32.137128°)	LONGITUDE = 103°19'03.76" (103.317712°)
STATE PLANE NAD 83 (N.M. EAST)	N: 415149.87' E: 855561.81'
STATE PLANE NAD 27 (N.M. EAST)	N: 415091.34' E: 814374.93'

SCALE
DRAWN BY: B.G. 02-11-20
REV: 1 D.J.S. 07-06-20
(ADD KOP, PPP POINTS & LEASE INFO.)

EXHIBIT
3

Lease Tract Map

Case No. 22082

W/2E/2 of Sections 13 & 24-T25S-R35E, 320 Gross Acres
Santa Fe Fed Com 603H

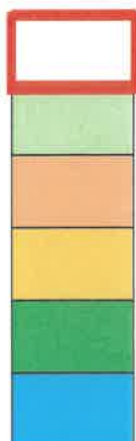
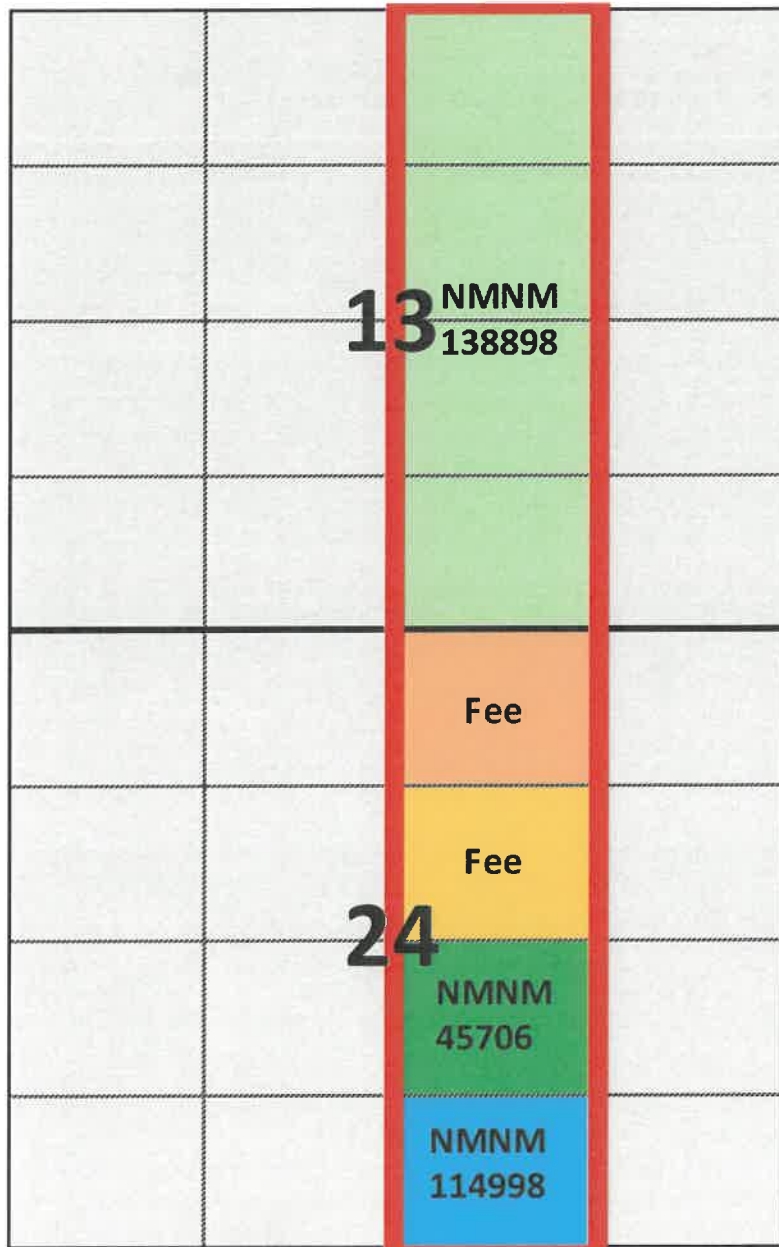

Proposed Bone Spring Unit

Tract 1 (160 acres)

Tract 2 (40 acres)

Tract 3 (40 acres)

Tract 4 (40 acres)

Tract 5 (40 acres)

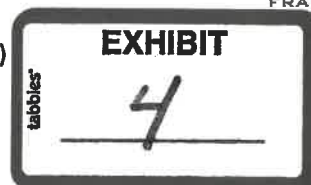

Summary of Interests

Case No. 22082

W/2E/2 of Sections 13 & 24-T25S-R35E, 320 Gross Acres

Santa Fe Fed Com 603H

Committed Working Interests	
Franklin Mountain Energy, LLC	72.278809%
Franklin Mountain Energy 2, LLC	14.791667%
Uncommitted Working Interest	
Chevron USA, Inc.	12.500000%
Uncommitted Unleased Interest	
Various	0.429525%
TOTAL:	100.000000%



Unit Recapitulation

Case No. 22082

W/2E/2 of Sections 13 & 24-T25S-R35E, 320 Gross Acres
Santa Fe Fed Com 603H

Working Interest Owner	Tract 1 (160 ac)	Tract 2 (40 ac)	Tract 3 (40 ac)	Tract 4 (40 ac)	Tract 5 (40 ac)
Franklin Mountain Energy, LLC	100.000000%	26.666666%	51.563802%	100.000000%	0.000000%
Franklin Mountain Energy 2, LLC	0.000000%	73.333334%	45.000000%	0.000000%	0.000000%
Chevron USA, Inc.	0.000000%	0.000000%	0.000000%	0.000000%	100.000000%
Various	0.000000%	0.000000%	3.436198%	0.000000%	0.000000%
TOTAL:	100.000000%	100.000000%	100.000000%	100.000000%	100.000000%



Tract	Lease
1	NMNM 138898
2	Fee
3	Fee
4	NMNM 45706
5	NMNM 114998



Case No. 22082 Parties to Be Pooled (Santa Fe Fed Com 603H)	
Name	Type
Chevron USA, Inc.	WI
Texas Tech University	UNL/WI
NMTX Mineral Fund, LLC	UNL/WI
Ohio State University	UNL/WI
West Texas A&M University	UNL/WI
United States of America	RI
Prevail Energy, LLC	ORRI
Monticello Minerals, LLC	ORRI
Rheiner Holdings, LLC	ORRI
Cayuga Royalties, LLC	ORRI
OGX Royalty Fund, LP	ORRI
Bryan Bell Family, LLC	ORRI
Cathleen Ann Adams, Trustee of the Cathleen Ann Adams Revocable Trust dated 9/25/2020	ORRI
Susan Arrott aka Susan Carol Arrott, Trustee of the Arrott Family Revocable Trust dated 4/8/2019	ORRI
Wells Fargo Bank, N.A., Trustee of the Robert N. Enfield Revocable Trust dated March 16, 1999	ORRI
Nuevo Seis, Limited Partnership	ORRI
Jetstream Royalty Partners, LP	ORRI
Morris E. Schertz	ORRI
DMA, Inc.	ORRI
Charmar, LLC	ORRI
Howard A. Rubin, Inc.	ORRI
Lisa M. Enfield, Trustee of the Lisa M. Enfield Trust u/a/d January 23, 2015	ORRI
MLE, LLC	ORRI
Richard C. Deason	ORRI
Thomas D. Deason	ORRI
Ronald H. Mayer	ORRI
SAP, LLC	ORRI
Rubie Crosby Bell Family, LLC	ORRI

Summary of Attempted Contacts

- Franklin Mountain Energy conducted extensive title work to determine the working interest owners and other interest owners.
- Franklin searched public records, phone directory, and various different types of internet searches.
- Franklin sent well proposal letters to the working interest owners on or around May 3, 2021.
- Franklin proposed general terms of a Joint Operating Agreements (JOA) within the well proposal letters sent to working interest owners and offered to send said form to owners upon request.
- Franklin filed an application to force pool parties who had not entered in to an agreement.
- Franklin's counsel sent notices of the force pooling application to the addresses of record for the uncommitted interest owners.
- Franklin also published notice in a newspaper of general circulation in the county where the wells will be located.

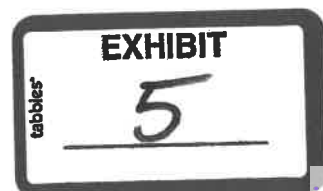



Sent via Certified Mail: 9414 7116 9900 0282 2523 83

May 3, 2021

Ohio State University
 Farmers National Company, Agent
 Oil & Gas Department
 P.O. Box 3480
 Omaha, NE 68103-0480

RE: Santa Fe Fed Com 603H Well Proposal
 Township 25 South, Range 35 East:
 Sections 13 and 24: W/2E/2, 320 acres m/l
 Lea County, New Mexico

Dear Owner:

Franklin Mountain Energy, LLC ("FME"), as Operator, hereby proposes the drilling and completion of the following horizontal well located in the W/2E/2 of Sections 13 and 24:

Well Name	Target Formation	Total Vertical Depth	Measured Depth	SHL	BHL	AFE
Santa Fe Fed Com 603H	Bone Spring	11,695'	21,874'	Sec. 24-T25S-R35E: 250' FSL, 812' FEL	Sec. 13-T25S-R35E: 150' FNL, 1,689' FEL	\$9,864,019.66

FME reserves the right to modify the locations and drilling plans described above in order to comply with any requirements from a governing regulatory agency or to address any topography, environmental and/or cultural concerns.

FME is proposing to drill and complete the aforementioned well under the terms of a modified, wellbore specific 1989 AAPL form Operating Agreement with the following general provisions:

- 100/300 Non-Consenting Penalty
- \$7,000/\$700 Drilling and Producing Rate
- Franklin Mountain Energy, LLC designated as Operator

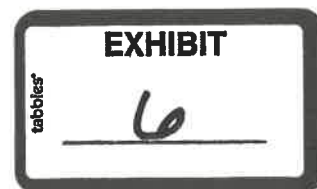

Should you be interested in participating under an Operating Agreement, with your unleased minerals, FME will send you our proposed form.

44 Cook Street | Suite 1000 | Denver, CO 80206



Please indicate your election in the space provided on the following page, sign and return this letter, along with a signed copy of the enclosed AFE. If you do not wish to participate, FME proposes to lease your minerals at the following terms:



The forgoing offer is non-binding in nature until a definitive agreement and/or conveyance documents are negotiated and agreed to by each party. FME is under no obligation to negotiate, lease or purchase your interest.

Please return your signed paperwork to Shelly Albrecht at salbrecht@fmelle.com or to the address provided below at your earliest convenience.

FME looks forward to working with you or your company on this proposed development and encourages you to call with any questions pertaining to these plans. However, please be advised that, in the near term, FME will file an application for compulsory pooling to pool any uncommitted owners.

Should you have any questions, please contact the undersigned at (720) 414-7855 or by email at the address mentioned above.

Respectfully,

Franklin Mountain Energy, LLC

A handwritten signature in blue ink that reads "Shelly Albrecht".

Shelly Albrecht
Director of Land

Enclosures



Santa Fe Fed Com 603H:

_____ I/We hereby elect to participate in the **Santa Fe Fed Com 603H** well.

_____ I/We hereby elect **NOT** to participate in the **Santa Fe Fed Com 603H** well.

_____ **I/We hereby elect to lease our interest.**

Owner: _____

By: _____

Printed Name: _____

Title: _____

Date: _____

STATE OF NEW MEXICO
ENERGY, MINERALS AND NATURAL RESOURCES DEPARTMENT
OIL CONSERVATION DIVISION

APPLICATION OF FRANKLIN MOUNTAIN
ENERGY, LLC FOR COMPULSORY POOLING,
LEA COUNTY, NEW MEXICO

CASE NO. 22078, 22081,
22082

AFFIDAVIT

STATE OF NEW MEXICO)
) ss.
COUNTY OF BERNALILLO)

Deana M. Bennett, attorney in fact and authorized representative of Franklin Mountain Energy, LLC, the Applicant herein, being first duly sworn, upon oath, states that the above-referenced Applications were provided under a notice letter, attached, and that proof of receipt is attached hereto. I also state that notice of the August 5, 2021 hearing was published in the Hobbs News-Sun on July 21, 2021, as reflected in the attached Affidavit of Publication.

Deana M. Bennett

SUBSCRIBED AND SWORN to before me this 3rd day of August, 2021 by Deana M. Bennett.

Notary Public

My commission expires: 02-27-25



Transaction Report Details - CertifiedPro.net
Firm Mail Book ID= 211991
Generated: 8/3/2021 9:28:57 AM

USPS Article Number	Reference Number	Name 1	City	State	Zip	Mailing Status	Service Options	Actual Delivery Date
9314869904300084472117	10154, SF 704H	OGX Royalty Fund, LP	Midland	TX	79701	Delivered	Return Receipt - Electronic, Certified Mail	2021-07-19 2:01 PM
9314869904300084472100	10154, SF 704H	Cayuga Royalties, LLC	Houston	TX	77254	To be Returned	Return Receipt - Electronic, Certified Mail	2021-07-21 3:02 PM
9314869904300084472094	10154, SF 704H	Reiner Holdings, LLC	Houston	TX	77098	Delivered	Return Receipt - Electronic, Certified Mail	
9314869904300084472089	10154, SF 704H	Monticello Minerals, LLC	Dallas	TX	75206	Undelivered	Return Receipt - Electronic, Certified Mail	
9314869904300084472070	10154, SF 704H	Prevail Energy, LLC	Denver	CO	80220	Delivered	Return Receipt - Electronic, Certified Mail	2021-07-19 2:58 PM
9314869904300084472063	10154, SF 704H	Prevail Energy, LLC	Denver	CO	80220	Delivered	Return Receipt - Electronic, Certified Mail	2021-07-19 2:58 PM
9314869904300084472056	10154, SF 704H	Debbie Fagel	Carrollton	TX	75010	Delivered	Return Receipt - Electronic, Certified Mail	2021-07-19 12:53 PM
9314869904300084472049	10154, SF 704H	Sharon Jeffreys	Edmond	OK	73012	Delivered	Return Receipt - Electronic, Certified Mail	2021-07-21 12:00 AM
9314869904300084472032	10154, SF 704H	The Southwestern Baptist Theological Seminary	Dallas	TX	75201	Undelivered	Return Receipt - Electronic, Certified Mail	2021-07-19 2:20 PM
9314869904300084472025	10154, SF 704H	University of the Southwest	Hobbs	NM	88240	Delivered	Return Receipt - Electronic, Certified Mail	2021-07-19 1:37 PM
9314869904300084472018	10154, SF 704H	Patrick Markam Boyd	Denver	CO	80247	Delivered	Return Receipt - Electronic, Certified Mail	2021-07-19 12:49 PM
9314869904300084472001	10154, SF 704H	Nicole Marie Sanchez	Colorado Springs	CO	80917	Delivered	Return Receipt - Electronic, Certified Mail	
9314869904300084471998	10154, SF 704H	Nancy I. Farmer	Tulsa	OK	74135	Undelivered	Return Receipt - Electronic, Certified Mail	
9314869904300084471981	10154, SF 704H	Mineral Interest Trust	Midland	TX	79705	Undelivered	Return Receipt - Electronic, Certified Mail	
9314869904300084471974	10154, SF 704H	Megan Kathleen Boyd	Colorado Springs	CO	80909	Delivered	Return Receipt - Electronic, Certified Mail	
9314869904300084471967	10154, SF 704H	Marilyn Burke Salter	Edmonds	WA	98026	Delivered	Return Receipt - Electronic, Certified Mail	
9314869904300084471950	10154, SF 704H	Lisa M. Daves Revocable Trust, by Lisa M. Daves	Magnolia	TX	77355	Delivered	Return Receipt - Electronic, Certified Mail	
9314869904300084471943	10154, SF 704H	Linda Ruth Garcia	Albuquerque	NM	87181	Delivered	Return Receipt - Electronic, Certified Mail	
9314869904300084471936	10154, SF 704H	Laura Jean Annman	Thornton	CO	80241	Undelivered	Return Receipt - Electronic, Certified Mail	
9314869904300084471929	10154, SF 704H	J.L. Burke, III	Dallas	TX	75243	Undelivered	Return Receipt - Electronic, Certified Mail	
9314869904300084471912	10154, SF 704H	DeAlva E. Blocker, Trustee of Blocker Family Trust	Tuscaloosa	AL	35405	Delivered	Return Receipt - Electronic, Certified Mail	
9314869904300084471905	10154, SF 704H	Charles David West, III	Centennial	CO	80122	Undelivered	Return Receipt - Electronic, Certified Mail	
9314869904300084471899	10154, SF 704H	Jerry Lasater, JR	Farmington	NM	87401	Delivered	Return Receipt - Electronic, Certified Mail	
9314869904300084471882	10154, SF 704H	Gregory Simone Salvo	Santa Fe	NM	87508	Delivered	Return Receipt - Electronic, Certified Mail	
9314869904300084471875	10154, SF 704H	Catherine DeAnn Salvo Wren	Oklahoma City	OK	73170	Delivered	Return Receipt - Electronic, Certified Mail	
9314869904300084471868	10154, SF 704H	Beverly B. Blair	Lake Havasue City	AZ	86403	Delivered	Return Receipt - Electronic, Certified Mail	
9314869904300084471851	10154, SF 704H	Augusta Elizabeth Bruley Elmwood	New Orleans	LA	70117	Undelivered	Return Receipt - Electronic, Certified Mail	
9314869904300084471844	10154, SF 704H	Joseph M. Victory	Shawnee	OK	74801	Delivered	Return Receipt - Electronic, Certified Mail	
9314869904300084471837	10154, SF 704H	John V. McCarthy, II	Bernice	OK	74331	Undelivered - To be Returned	Return Receipt - Electronic, Certified Mail	
9314869904300084471820	10154, SF 704H	TD Minerals, LLC	Dallas	TX	75225	Delivered	Return Receipt - Electronic, Certified Mail	
9314869904300084471813	10154, SF 704H	Katy Pipeline & Production Corp.	Dallas	TX	75235	Delivered	Return Receipt - Electronic, Certified Mail	
9314869904300084471806	10154, SF 704H	Sugarberry Oil & Gas Corporation	Dallas	TX	75235	Delivered	Return Receipt - Electronic, Certified Mail	
9314869904300084471790	10154, SF 704H	United States of America	Santa Fe	NM	87508	Delivered	Return Receipt - Electronic, Certified Mail	
9314869904300084471783	10154, SF 704H	Plantation Operating, LLC	The Woodlands	TX	77380	To be Returned	Return Receipt - Electronic, Certified Mail	
9314869904300084471776	10154, SF 704H	Texas State Bank, Trustee of Lucille Chism	San Angelo	TX	76902	Delivered	Return Receipt - Electronic, Certified Mail	
9314869904300084471769	10154, SF 704H	P.A.W.N. Enterprises, a Limited Partnership	Ada	OK	74821	Delivered	Return Receipt - Electronic, Certified Mail	
9314869904300084471752	10154, SF 704H	Daniel Fleet Freeman, Trustee of Margaret H.	Ada	OK	74821	Delivered	Return Receipt - Electronic, Certified Mail	
9314869904300084471745	10154, SF 704H	Frank T. Fleet, Inc.	College Station	TX	77840	Delivered	Return Receipt - Electronic, Certified Mail	
9314869904300084471738	10154, SF 704H	West Texas A&M University	Omaha	NE	68103	Delivered	Return Receipt - Electronic, Certified Mail	
9314869904300084471731	10154, SF 704H	Ohio State University/ Farmers National Company	Tyler	TX	75703	Undelivered - To be Returned	Return Receipt - Electronic, Certified Mail	
9314869904300084471707	10154, SF 704H	NMTX Mineral Fund, LLC	Cape Coral	FL	33993	Delivered	Return Receipt - Electronic, Certified Mail	
9314869904300084471691	10154, SF 704H	Stanley E. Luker and Glenda C. Luker Family Trust,	Lubbock	TX	79409	Delivered	Return Receipt - Electronic, Certified Mail	
9314869904300084471684	10154, SF 704H	Texas Tech University	Dallas	TX	75225	Delivered	Return Receipt - Electronic, Certified Mail	
9314869904300084471677	10154, SF 704H	Chief Capital (O&G) II, LLC	Fort Worth	TX	76147	Delivered	Return Receipt - Electronic, Certified Mail	
9314869904300084471660	10154, SF 704H	Chevron USA, Inc.	Houston	TX	77002	Delivered	Return Receipt - Electronic, Certified Mail	
		Attn: Scott Sabrula, Land						

Transaction Report Details - CertifiedPro.net
Firm Mail Book ID- 211993
Generated: 8/3/2021 8:55:23 AM

USPS Article Number	Reference Number	Name 1	Name 2	City	State	Zip	Delivery Status	Service, Options	Mail Delivery Date
9314869904300084474098	10154, SF 603H	Ruble Crosby Bell Family, LLC		New Orleans	LA	70130	Undelivered - To Be Returned	Return Receipt - Electronic, Certified Mail	2021-07-19 1:23 PM
9314869904300084474081	10154, SF 603H	SAP, LLC		Roswell	NM	88203	Delivered	Return Receipt - Electronic, Certified Mail	2021-07-23 12:47 PM
9314869904300084474074	10154, SF 603H	Ronald H. Mayer		Roswell	NM	88202	Delivered	Return Receipt - Electronic, Certified Mail	
9314869904300084474067	10154, SF 603H	Thomas D. Deason		Lubbock	TX	79424	Undelivered - To Be Returned	Return Receipt - Electronic, Certified Mail	
9314869904300084474050	10154, SF 603H	Richard C. Deason		West Hollywood	CA	90046	Delivered	Return Receipt - Electronic, Certified Mail	2021-07-19 12:00 AM
9314869904300084474043	10154, SF 603H	MLE, LLC		Santa Fe	NM	87504	Delivered	Return Receipt - Electronic, Certified Mail	2021-07-21 12:18 PM
9314869904300084474036	10154, SF 603H	Lisa M. Enfield, Trustee of Lisa M. Enfield Trust		Santa Fe	NM	87505	Delivered	Return Receipt - Electronic, Certified Mail	2021-07-17 2:41 PM
9314869904300084474029	10154, SF 603H	Howard A. Rubin, Inc.	u/a/d January 23, 2015	El Rito	NM	87530	Undelivered - To Be Returned	Return Receipt - Electronic, Certified Mail	
9314869904300084474012	10154, SF 603H	Charmar, LLC		Albuquerque	NM	87109	Delivered	Return Receipt - Electronic, Certified Mail	2021-07-36 4:33 PM
9314869904300084474005	10154, SF 603H	DMA, Inc.		Roswell	NM	88202	To Be Returned	Return Receipt - Electronic, Certified Mail	
9314869904300084474000	10154, SF 603H	Morris E. Schertz		Roswell	NM	88202	Delivered	Return Receipt - Electronic, Certified Mail	2021-07-21 12:26 PM
9314869904300084473992	10154, SF 603H	Jetstream Royalty Partners, LP		Roswell	TX	76147	Delivered	Return Receipt - Electronic, Certified Mail	2021-07-19 9:50 AM
9314869904300084473985	10154, SF 603H	Nuevo Seis, Limited Partnership		Fort Worth	TX	76147	Delivered	Return Receipt - Electronic, Certified Mail	2021-07-19 1:00 PM
9314869904300084473978	10154, SF 603H	Wells Fargo Bank, N.A., Trustee of Robert E. Susan Arrott, Trustee of Arrott Family Rev.	Revocable Trust dated March 16, 1999 Trust dated 4/8/2019	Roswell	NM	88202	Delivered	Return Receipt - Electronic, Certified Mail	
9314869904300084473954	10154, SF 603H	Cathleen Ann Adams, Trustee of Cathleen Ann Adams Revocable Trust of 9/25/2020		Roswell	NM	88202	Undelivered - To Be Returned	Return Receipt - Electronic, Certified Mail	
9314869904300084473947	10154, SF 603H	Bryan Bell Family, LLC		Albuquerque	NM	87103	Delivered	Return Receipt - Electronic, Certified Mail	2021-07-26 11:02 AM
9314869904300084473930	10154, SF 603H	OGX Royalty Fund, LP		North Little Rock	AR	72295	Delivered	Return Receipt - Electronic, Certified Mail	
9314869904300084473923	10154, SF 603H	Cayuga Royalties, LLC		Rio Rancho	NM	87174	Delivered	Return Receipt - Electronic, Certified Mail	2021-07-23 1:08 PM
9314869904300084473916	10154, SF 603H	Rheiner Holdings, LLC		Midland	TX	79701	Delivered	Return Receipt - Electronic, Certified Mail	
9314869904300084473909	10154, SF 603H	Monticello Minerals, LLC		Houston	TX	77254	To Be Returned	Return Receipt - Electronic, Certified Mail	2021-07-21 3:02 PM
9314869904300084473893	10154, SF 603H	Prevail Energy, LLC		Houston	TX	77098	Delivered	Return Receipt - Electronic, Certified Mail	
9314869904300084473886	10154, SF 603H	Debbie Fogel		Dallas	TX	75206	Undelivered	Return Receipt - Electronic, Certified Mail	2021-07-19 2:58 PM
9314869904300084473879	10154, SF 603H	Sharon Jeffreys		Denver	CO	80220	Delivered	Return Receipt - Electronic, Certified Mail	2021-07-19 12:53 PM
9314869904300084473862	10154, SF 603H	The Southwestern Baptist Theological Seminary		Carrollton	TX	75010	Delivered	Return Receipt - Electronic, Certified Mail	2021-07-21 12:00 AM
9314869904300084473855	10154, SF 603H	University of the Southwest		Edmond	OK	73012	Delivered	Return Receipt - Electronic, Certified Mail	2021-07-19 2:20 PM
9314869904300084473848	10154, SF 603H	Patrick Markam Boyd		Dallas	TX	75201	Undelivered	Return Receipt - Electronic, Certified Mail	2021-07-19 1:37 PM
9314869904300084473831	10154, SF 603H	Nicole Marie Sanchez		Hobbs	NM	88240	Delivered	Return Receipt - Electronic, Certified Mail	2021-07-22 11:22 AM
9314869904300084473824	10154, SF 603H	Nancy I. Farmer		Denver	CO	80247	Delivered	Return Receipt - Electronic, Certified Mail	
9314869904300084473817	10154, SF 603H	Megan Kathleen Boyd		Colorado Springs	CO	80917	Delivered	Return Receipt - Electronic, Certified Mail	2021-07-19 10:59 AM
9314869904300084473810	10154, SF 603H	Marilyn Burke Salter		Tulsa	OK	74135	Undelivered	Return Receipt - Electronic, Certified Mail	2021-07-20 2:21 PM
9314869904300084473794	10154, SF 603H	Lisa M. Davies Revocable Trust, by Lisa M. Davies		Edmonds	WA	98026	Delivered	Return Receipt - Electronic, Certified Mail	2021-07-19 1:15 PM
9314869904300084473787	10154, SF 603H	Linda Ruth Garcia		Magnolia	NM	87181	Delivered	Return Receipt - Electronic, Certified Mail	2021-07-16 10:24 AM
9314869904300084473770	10154, SF 603H	J.L. Burke, III		Dallas	TX	75243	Undelivered	Return Receipt - Electronic, Certified Mail	
9314869904300084473763	10154, SF 603H	DeAlva E. Blocker, Trustee of Blocker Family Trust		Turkeyfoot	AL	35405	Delivered	Return Receipt - Electronic, Certified Mail	2021-07-19 3:14 PM
9314869904300084473756	10154, SF 603H	Jerry Lasater, JR		Farmington	NM	87401	Delivered	Return Receipt - Electronic, Certified Mail	2021-07-20 3:36 PM
9314869904300084473749	10154, SF 603H	Gregory Simone Salvo		NM	NM	87508	Delivered	Return Receipt - Electronic, Certified Mail	2021-07-19 12:02 PM
9314869904300084473732	10154, SF 603H	Catherine DeAnn Salvo Wren		Santa Fe	OK	73170	Delivered	Return Receipt - Electronic, Certified Mail	2021-07-20 9:17 AM
9314869904300084473725	10154, SF 603H	Beverly B. Blair		Lake Havasu City	AZ	86403	Delivered	Return Receipt - Electronic, Certified Mail	2021-07-17 5:53 PM
9314869904300084473718	10154, SF 603H	Augusta Elizabeth Bruley Elmwood		New Orleans	LA	70117	Undelivered	Return Receipt - Electronic, Certified Mail	
9314869904300084473701	10154, SF 603H	Joyce Ann Fonville Preston		Pineville	LA	71360	Delivered	Return Receipt - Electronic, Certified Mail	2021-07-23 11:26 AM
9314869904300084473695	10154, SF 603H	Ellen Fonville Latsch		Luling	LA	70070	Delivered	Return Receipt - Electronic, Certified Mail	
9314869904300084473688	10154, SF 603H	Debra Fonville Lamb		Ball	LA	71405	Delivered	Return Receipt - Electronic, Certified Mail	2021-07-20 4:39 PM
9314869904300084473671	10154, SF 603H	Benjamin Louis Fonville, III		Midland	TX	79701	Undelivered	Return Receipt - Electronic, Certified Mail	
9314869904300084473664	10154, SF 603H	Russell H. Wickman		Santa Fe	NM	87508	Delivered	Return Receipt - Electronic, Certified Mail	2021-07-19 2:32 PM
9314869904300084473657	10154, SF 603H	West States of America		College Station	TX	77840	Delivered	Return Receipt - Electronic, Certified Mail	2021-07-19 11:18 AM
9314869904300084473640	10154, SF 603H	West Texas A&M University	Attr: SERO	Omaha	NE	68103	Delivered	Return Receipt - Electronic, Certified Mail	2021-07-19 7:13 AM
9314869904300084473633	10154, SF 603H	Ohio State University/ Farmers National Company	Oil & Gas Dept.	Tyler	TX	75703	To Be Returned	Return Receipt - Electronic, Certified Mail	
9314869904300084473626	10154, SF 603H	NMTX Mineral Fund, LLC		Cape Coral	FL	33993	Delivered	Return Receipt - Electronic, Certified Mail	2021-07-19 2:21 PM
9314869904300084473619	10154, SF 603H	Stanley E. Luker & Glenda C. Luker Family Trust	Patricia Ann Arenburg, Trustee	Lubbock	TX	79409	Undelivered	Return Receipt - Electronic, Certified Mail	
9314869904300084473602	10154, SF 603H	Texas Tech University		Lubbock	TX	79409	Undelivered	Return Receipt - Electronic, Certified Mail	2021-07-19 2:21 PM
9314869904300084473596	10154, SF 603H	Chevron USA, Inc.	Attr: Scott Sabarsala, Land	Houston	TX	77002	Delivered	Return Receipt - Electronic, Certified Mail	2021-07-20 2:33 PM

10154.0001

PS Form 3877

Firm Mailing Book ID: 211993

Type of Mailing: CERTIFIED MAIL
07/15/2021

Karlene Schuman
Modrall Spering Roehl Harris & Sisk P.A.
500 Fourth Street, Suite 1000
Albuquerque NM 87102

Line	USPS Article Number	Name, Street, City, State, Zip	Postage	Service Fee	RR Fee	Rest.Del.Fee	Reference Contents
1	9314 8699 0430 0084 4735 89	Chevron USA, Inc. Attn: Scott Sabrula, Land 1400 Smith St. Houston TX 77002	\$1.20	\$3.60	\$1.75	\$0.00	10154. SF 603H Notice
2	9314 8699 0430 0084 4735 96	Texas Tech University P.O. Box 41081 79409 Lubbock TX 70409	\$1.20	\$3.60	\$1.75	\$0.00	10154. SF 603H Notice
3	9314 8699 0430 0084 4736 02	Stanley E. Luker & Glenda C. Luker Family Trust Patricia Ann Arenburg, Trustee 3614 NW 2nd St. Cape Coral FL 33993	\$1.20	\$3.60	\$1.75	\$0.00	10154. SF 603H Notice
4	9314 8699 0430 0084 4736 19	NMTX Mineral Fund, LLC 7922 South Broadway Ave Tyler TX 75703	\$1.20	\$3.60	\$1.75	\$0.00	10154. SF 603H Notice
5	9314 8699 0430 0084 4736 26	Ohio State University/ Farmers National Company Oil & Gas Dept. P.O. Box 3480 Omaha NE 68103	\$1.20	\$3.60	\$1.75	\$0.00	10154. SF 603H Notice
6	9314 8699 0430 0084 4736 33	West Texas A&M University Attn: SERO 301 Tarrow, 6th Floor College Station TX 77840	\$1.20	\$3.60	\$1.75	\$0.00	10154. SF 603H Notice
7	9314 8699 0430 0084 4736 40	United States of America 301 Dinosaur Trail Santa Fe NM 87508	\$1.20	\$3.60	\$1.75	\$0.00	10154. SF 603H Notice
8	9314 8699 0430 0084 4736 57	Russell H. Wickman 2505 Princeton Ave. Midland TX 79701	\$1.20	\$3.60	\$1.75	\$0.00	10154. SF 603H Notice
9	9314 8699 0430 0084 4736 64	Benjamin Louis Fonville, III 5010 Samanta Dr. Ball LA 71405	\$1.20	\$3.60	\$1.75	\$0.00	10154. SF 603H Notice
10	9314 8699 0430 0084 4736 71	Debra Fonville Lamb 20 Chestnut Place Luling LA 70070	\$1.20	\$3.60	\$1.75	\$0.00	10154. SF 603H Notice
11	9314 8699 0430 0084 4736 88	Ellen Fonville Latsch 17753 Hickory Trail Lakeville MN 55044	\$1.20	\$3.60	\$1.75	\$0.00	10154. SF 603H Notice
12	9314 8699 0430 0084 4736 95	Joyce Ann Fonville Preston 8249 Fairway Dr. Pineville LA 71360	\$1.20	\$3.60	\$1.75	\$0.00	10154. SF 603H Notice
13	9314 8699 0430 0084 4737 01	Augusta Elizabeth Bruley Elmwood 1514 St. Roch Ave. New Orleans LA 70117	\$1.20	\$3.60	\$1.75	\$0.00	10154. SF 603H Notice
14	9314 8699 0430 0084 4737 18	Beverly B. Blair 2635 Bamboo Dr. Lake Havasue City AZ 86403	\$1.20	\$3.60	\$1.75	\$0.00	10154. SF 603H Notice



PS Form 3877

Firm Mailing Book ID: 211993

Type of Mailing: CERTIFIED MAIL
07/15/2021

Karlene Schuman
Toddral Sperling Roehl Harris & Sisk P.A.
100 Fourth Street, Suite 1000
Albuquerque NM 87102

Line	USPS Article Number	Name, Street, City, State, Zip	Postage	Service Fee	RR Fee	Rest.Del.Fee	Reference Contents
15	9314 8699 0430 0084 4737 25	Catherine DeAnn Salvo Wren 11629 Cedar Valley Dr. Oklahoma City OK 73170	\$1.20	\$3.60	\$1.75	\$0.00	10154. SF 603H Notice
16	9314 8699 0430 0084 4737 32	Gregory Simone Salvo 18 Estambre Road Santa Fe NM 87508	\$1.20	\$3.60	\$1.75	\$0.00	10154. SF 603H Notice
17	9314 8699 0430 0084 4737 49	Jerry Lasater, JR 5217 County Road, Lot 59 Farmington NM 87401	\$1.20	\$3.60	\$1.75	\$0.00	10154. SF 603H Notice
18	9314 8699 0430 0084 4737 56	DeAlva E. Blocker, Trustee of Blocker Family Trust 10430 Sunnyland Dr. Tuscaloosa AL 35405	\$1.20	\$3.60	\$1.75	\$0.00	10154. SF 603H Notice
19	9314 8699 0430 0084 4737 63	J.L. Burke, III 8928 Meadowknoll Dr. Dallas TX 75243	\$1.20	\$3.60	\$1.75	\$0.00	10154. SF 603H Notice
20	9314 8699 0430 0084 4737 70	Linda Ruth Garcia P.O. Box 50207 Albuquerque NM 87181	\$1.20	\$3.60	\$1.75	\$0.00	10154. SF 603H Notice
21	9314 8699 0430 0084 4737 87	Lisa M. Daves Revocable Trust, by Lisa M. Daves 20910 Timber Ridge Dr. Magnolia TX 77355	\$1.20	\$3.60	\$1.75	\$0.00	10154. SF 603H Notice
22	9314 8699 0430 0084 4737 94	Marilyn Burke Salter 20031 82nd Ave. West Edmonds WA 98026	\$1.20	\$3.60	\$1.75	\$0.00	10154. SF 603H Notice
23	9314 8699 0430 0084 4738 00	Megan Kathleen Boyd 2724 East Dale St. Colorado Springs CO 80909	\$1.20	\$3.60	\$1.75	\$0.00	10154. SF 603H Notice
24	9314 8699 0430 0084 4738 17	Nancy I. Farmer 5135 E. 35th St. Tulsa OK 74135	\$1.20	\$3.60	\$1.75	\$0.00	10154. SF 603H Notice
25	9314 8699 0430 0084 4738 24	Nicole Marie Sanchez 4622 N. Carefree Cir. Colorado Springs CO 80917	\$1.20	\$3.60	\$1.75	\$0.00	10154. SF 603H Notice
26	9314 8699 0430 0084 4738 31	Patrick Markam Boyd 650 S. Clinton St., #5A Denver CO 80247	\$1.20	\$3.60	\$1.75	\$0.00	10154. SF 603H Notice
27	9314 8699 0430 0084 4738 48	University of the Southwest 6610 N. Lovington Highway Hobbs NM 88240	\$1.20	\$3.60	\$1.75	\$0.00	10154. SF 603H Notice
28	9314 8699 0430 0084 4738 55	The Southwestern Baptist Theological Seminary 1717 Main St., Suite 1400 Dallas TX 75201	\$1.20	\$3.60	\$1.75	\$0.00	10154. SF 603H Notice
29	9314 8699 0430 0084 4738 62	Sharon Jeffreys 2716 Brenton Dr. Edmond OK 73012	\$1.20	\$3.60	\$1.75	\$0.00	10154. SF 603H Notice



Karlene Schuman
Woodruff Sperling Roehl Harris & Sisk P.A.
100 Fourth Street, Suite 1000
Albuquerque NM 87102

PS Form 3877

Type of Mailing: CERTIFIED MAIL
07/15/2021

Firm Mailing Book ID: 211993

Line	USPS Article Number	Name, Street, City, State, Zip	Postage	Service Fee	RR Fee	Rest.Del.Fee	Reference Contents
30	9314 8699 0430 0084 4738 79	Debbie Fogel 1821 Boyd Ct. Carrollton TX 75010	\$1.20	\$3.60	\$1.75	\$0.00	10154. SF 603H Notice
31	9314 8699 0430 0084 4738 86	Prevail Energy, LLC 521 Dexter St. Denver CO 80220	\$1.20	\$3.60	\$1.75	\$0.00	10154. SF 603H Notice
32	9314 8699 0430 0084 4738 93	Monticello Minerals, LLC 5528 Vockery Road Dallas TX 75206	\$1.20	\$3.60	\$1.75	\$0.00	10154. SF 603H Notice
33	9314 8699 0430 0084 4739 09	Rheiner Holdings, LLC P.O. Box 980552 Houston TX 77098	\$1.20	\$3.60	\$1.75	\$0.00	10154. SF 603H Notice
34	9314 8699 0430 0084 4739 16	Cayuga Royalties, LLC P.O. Box 540711 Houston TX 77254	\$1.20	\$3.60	\$1.75	\$0.00	10154. SF 603H Notice
35	9314 8699 0430 0084 4739 23	OGX Royalty Fund, LP 400 N. Marienfeld St. Ste 200 Midland TX 79701	\$1.20	\$3.60	\$1.75	\$0.00	10154. SF 603H Notice
36	9314 8699 0430 0084 4739 30	Bryan Bell Family, LLC 1331 Third Street New Orleans LA 70130	\$1.20	\$3.60	\$1.75	\$0.00	10154. SF 603H Notice
37	9314 8699 0430 0084 4739 47	Cathleen Ann Adams, Trustee of Cathleen Ann Adams Revocable Trust of 9/25/2020 P.O. Box 45807 Rio Rancho NM 87174	\$1.20	\$3.60	\$1.75	\$0.00	10154. SF 603H Notice
38	9314 8699 0430 0084 4739 54	Susan Arrott, Trustee of Arrott Family Rev. Trust dated 4/8/2019 P.O. Box 95074 North Little Rock AR 72295	\$1.20	\$3.60	\$1.75	\$0.00	10154. SF 603H Notice
39	9314 8699 0430 0084 4739 61	Wells Fargo Bank, N.A., Trustee of Robert E. Revocable Trust dated March 16, 1999 P.O. Box 1968 Albuquerque NM 87103	\$1.20	\$3.60	\$1.75	\$0.00	10154. SF 603H Notice
40	9314 8699 0430 0084 4739 78	Nuevo Seis, Limited Partnership P.O. Box 2588 Roswell NM 88202	\$1.20	\$3.60	\$1.75	\$0.00	10154. SF 603H Notice
41	9314 8699 0430 0084 4739 85	Jetstream Royalty Partners, LP P.O. Box 471396 Fort Worth TX 76147	\$1.20	\$3.60	\$1.75	\$0.00	10154. SF 603H Notice
42	9314 8699 0430 0084 4739 92	Morris E. Schertz P.O. Box 2588 Roswell NM 88202	\$1.20	\$3.60	\$1.75	\$0.00	10154. SF 603H Notice
43	9314 8699 0430 0084 4740 05	DMA, Inc. P.O. Box 1496 Roswell NM 88202	\$1.20	\$3.60	\$1.75	\$0.00	10154. SF 603H Notice

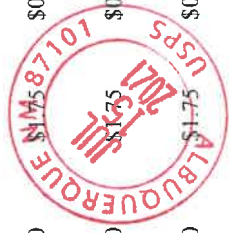

Karlene Schuman
 Modrall Spering Roehl Harris & Sisk P.A.
 500 Fourth Street, Suite 1000
 Albuquerque NM 87102

PS Form 3877

Type of Mailing: CERTIFIED MAIL
 07/15/2021

Firm Mailing Book ID: 211993

Line	USPS Article Number	Name, Street, City, State, Zip	Postage	Service Fee	RR Fee	Rest.Del.Fee	Reference Contents
44	9314 8699 0430 0084 4740 12	Charmar, LLC 4815 Vista Del Oso Court NE Albuquerque NM 87109	\$1.20	\$3.60	\$1.75	\$0.00	10154. SF 603H Notice
45	9314 8699 0430 0084 4740 29	Howard A. Rubin, Inc. P.O. Box 58 El Rito NM 87530	\$1.20	\$3.60	\$1.75	\$0.00	10154. SF 603H Notice
46	9314 8699 0430 0084 4740 36	Lisa M. Enfield, Trustee of Lisa M. Enfield Trust u/a/d January 23, 2015 465 Camino Manzano Santa Fe NM 87505	\$1.20	\$3.60	\$1.75	\$0.00	10154. SF 603H Notice
47	9314 8699 0430 0084 4740 43	MLE, LLC P.O. Box 1683 Santa Fe NM 87504	\$1.20	\$3.60	\$1.75	\$0.00	10154. SF 603H Notice
48	9314 8699 0430 0084 4740 50	Richard C. Deason 1301 N. Havenhurst #217 West Hollywood CA 90046	\$1.20	\$3.60	\$1.75	\$0.00	10154. SF 603H Notice
49	9314 8699 0430 0084 4740 67	Thomas D. Deason 6402 CR 7420 Lubbock TX 79424	\$1.20	\$3.60	\$1.75	\$0.00	10154. SF 603H Notice
50	9314 8699 0430 0084 4740 74	Ronald H. Mayer P.O. Box 2391 Roswell NM 88202	\$1.20	\$3.60	\$1.75	\$0.00	10154. SF 603H Notice
51	9314 8699 0430 0084 4740 81	SAP, LLC 4901 Whitney Lane Roswell NM 88203	\$1.20	\$3.60	\$1.75	\$0.00	10154. SF 603H Notice
52	9314 8699 0430 0084 4740 98	Rubie Crosby Bell Family, LLC 1331 Third Street New Orleans LA 70130	\$1.20	\$3.60	\$1.75	\$0.00	10154. SF 603H Notice
Totals:			\$62.40	\$187.20	\$91.00	\$0.00	Grand Total: \$340.60

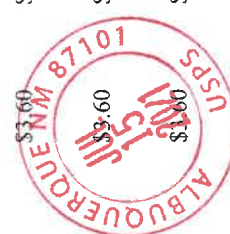

List Number of Pieces Received at Post Office: _____
 List Number of Pieces Sent: _____
 Total Number of Pieces Received at Post Office: _____
 Postmaster: _____
 Name of receiving employee: _____
 Dated: _____



MODRALL SPERLING
LAWYERS

July 15, 2021

Deana M. Bennett
505.848.1834
Deana.Bennett@modrall.com

VIA CERTIFIED MAIL
RETURN RECEIPT REQUESTED

**Re: APPLICATION OF FRANKLIN MOUNTAIN ENERGY, LLC
FOR COMPULSORY POOLING, LEA COUNTY, NEW MEXICO.**

CASE NO. 22082

TO: AFFECTED PARTIES

This letter is to advise you that Franklin Mountain Energy, LLC ("FME") has filed the above-listed application.

In Case No. 22082, FME seeks an order from the Division pooling all uncommitted interests within a Bone Spring horizontal spacing unit underlying the W/2E/2 of Sections 13 and 24, Township 25 South, Range 35 East, NMPM, Lea County, New Mexico. This spacing unit will be dedicated to the **Santa Fe Fed Com 603H** well to be horizontally drilled. The producing area for the **Santa Fe Fed Com 603H** well will be orthodox. Also to be considered will be the cost of drilling, completing, and equipping said well, the allocation of these costs as well as the actual operating costs and charges for supervision while drilling and after completion, designation of Franklin Mountain Energy, LLC as operator of the well, and a 200% charge for risk involved in drilling said well.

During the COVID-19 Public Health Emergency, state buildings are closed to the public and hearings will be conducted remotely. The hearing will be conducted on August 5, 2021 beginning at 8:15 a.m. To participate in the electronic hearing, see the instructions posted on the docket for the hearing date: <http://www.emnrd.state.nm.us/OCD/hearings.html>.

As a party who may be affected by this application, we are notifying you of your right to appear at the hearing and participate in the case, including the right to present evidence either in support of or in opposition to the application. Failure to appear at the hearing may preclude you from any involvement in the case at a later date.

You are further notified that if you desire to appear in this case, then you are requested to file a Pre-Hearing Statement with the Division at least four

Modrall Spierling
Roehl Harris & Sisk P.A.

500 Fourth Street NW
Suite 1000
Albuquerque,
New Mexico 87102

PO Box 2168
Albuquerque,
New Mexico 87103-2168

Tel: 505.848.1800
www.modrall.com

Page 2

business days in advance of a scheduled hearing before the Division or the Commission, but in no event later than 5:00 p.m. mountain time, on the Thursday preceding the scheduled hearing date, with a copy delivered to the undersigned.

Sincerely,

A handwritten signature in black ink that reads "Deana M. Bennett". The signature is written in a cursive style.

Deana M. Bennett
Attorney for Applicant

**STATE OF NEW MEXICO
ENERGY, MINERALS AND NATURAL RESOURCES DEPARTMENT
OIL CONSERVATION DIVISION**

**APPLICATION OF FRANKLIN MOUNTAIN ENERGY, LLC
FOR COMPULSORY POOLING, LEA COUNTY, NEW MEXICO**

CASE NO. 22082

APPLICATION

Franklin Mountain Energy, LLC (“FME”), OGRID Number 373910, through its undersigned attorneys, hereby files this application with the Oil Conservation Division (“Division”) pursuant to the provisions of NMSA 1978, § 70-2-17, for an order pooling all uncommitted mineral interests within a Bone Spring horizontal spacing unit underlying the W/2E/2 of Sections 13 and 24, Township 25 South, Range 35 East, NMPM, Lea County, New Mexico. In support of this application, FME states:

1. FME has an interest in the subject lands and has a right to drill and operate a well thereon.
2. FME seeks to dedicate the W/2E/2 of Sections 13 and 24, Township 25 South, Range 35 East, NMPM, Lea County, New Mexico to form a 320-acre, more or less, spacing unit.
3. FME plans to drill the **Santa Fe Fed Com 603H** well to a depth sufficient to test the Bone Spring formation.
4. The well will be horizontally drilled and will be drilled at orthodox locations under the Division’s rules.
5. FME sought, but has been unable to obtain, a voluntary agreement from all interest owners in the Bone Spring formation underlying the proposed spacing unit to participate in the drilling of the well or to otherwise commit their interests to the well.

6. The pooling of all interests in the Bone Spring formation underlying the proposed unit will prevent the drilling of unnecessary wells, prevent waste and protect correlative rights.

WHEREFORE, FME requests this application be set for hearing before an Examiner of the Oil Conservation Division on August 5, 2021, and after notice and hearing as required by law, the Division enter its order:

A. Pooling all uncommitted interests in the Bone Spring formation underlying a horizontal spacing unit within the W/2E/2 of Sections 13 and 24, Township 25 South, Range 35 East, NMPM, Lea County, New Mexico;

B. Designating FME as operator of this unit and the well to be drilled thereon;

C. Authorizing FME to recover its costs of drilling, completing, and equipping the well;

D. Approving actual operating charges and costs charged for supervision while drilling and after completion, together with a provision adjusting the rates pursuant to the COPAS accounting procedure;

E. Imposing a 200% charge for the risk involved in drilling, completing, and equipping the well in the event a working interest owner elects not to participate in the well.

MODRALL, SPERLING, ROEHL, HARRIS
& SISK, P.A.

By: Deana M. Bennett

Deana M. Bennett
Jamie L. Allen
Post Office Box 2168
500 Fourth Street NW, Suite 1000
Albuquerque, New Mexico 87103-2168
Telephone: 505.848.1800
Attorneys for Applicant

CASE NO. ____: Application of Franklin Mountain Energy, LLC for compulsory pooling, Lea County, New Mexico. Applicant seeks an order from the Division pooling all uncommitted interests within a Bone Spring horizontal spacing unit underlying the W/2E/2 of Sections 13 and 24, Township 25 South, Range 35 East, NMPM, Lea County, New Mexico. This spacing unit will be dedicated to the **Santa Fe Fed Com 603H** well to be horizontally drilled. The producing area for the **Santa Fe Fed Com 603H** well will be orthodox. Also to be considered will be the cost of drilling, completing, and equipping said well, the allocation of these costs as well as the actual operating costs and charges for supervision while drilling and after completion, designation of Franklin Mountain Energy, LLC as operator of the well, and a 200% charge for risk involved in drilling said well. Said area is located approximately 10 miles Northwest of Jal, New Mexico.

Affidavit of Publication

STATE OF NEW MEXICO
COUNTY OF LEA

I, Daniel Russell, Publisher of the Hobbs News-Sun, a newspaper published at Hobbs, New Mexico, solemnly swear that the clipping attached hereto was published in the regular and entire issue of said newspaper, and not a supplement thereof for a period of 1 issue(s).

Beginning with the issue dated
July 21, 2021
and ending with the issue dated
July 21, 2021.



Publisher

Sworn and subscribed to before me this
21st day of July 2021.



Business Manager

My commission expires
January 29, 2023

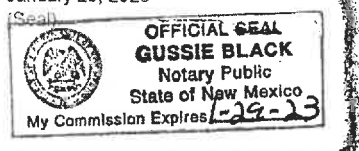

This newspaper is duly qualified to publish legal notices or advertisements within the meaning of Section 3, Chapter 167, Laws of 1937 and payment of fees for said

LEGAL NOTICE July 21, 2021

CASE NO. 22078: Notice to all affected parties, as well as the heirs and devisees of Chevron USA, Inc.; Jetstream Oil & Gas Partners LP; Chief Capital (O&G) II, LLC; Texas Tech University; Stanley E. Luker and Glenda C. Luker Family Trust; Patricia Ann Arenburg, Trustee; NMTX Mineral Fund, LLC; Ohio State University; West Texas A&M University; Rusaell H. Wickman; Frank T. Fleet, Inc.; Daniel Fleet Freeman, Trustee of the Margaret Helen Keimar Trust A; P.A.W.N. Enterprises, a Limited Partnership; Texas State Bank, Successor Trustee of the Lucille Chism Bates Testamentary Trust u/w/o Lucille Chism Bates; Plantation Operating, LLC; United States of America; Benjamin Louis Fonville, III; Debra Fonville Lamb; Ellen Fonville Latsch; Joyce Ann Fonville Preston; Sugarberry Oil & Gas Corporation; Katy Pipeline & Production Corp.; TD Minerals, LLC; John V. McCarthy, II; Joseph M. Victory; Augusta Elizabeth Bruley Elmwood; Beverly B. Blair; Catherine DeAnn Salvo Wren; Gregory Simone Salvo; Jerry Lasater, Jr.; Charles David West III; DeAlva E. Blocker, Trustee of the Blocker Family Trust, dated December 15, 1994; J.L. Burke, III; Laura of the Blocker Family Trust, dated December 15, 1994; Lisa M. Daves Revocable Trust, by Lisa Jean Amman; Linda Ruth Garcia; Lisa M. Daves Revocable Trust; Mineral M. Daves, Trustee; Marilyn Burke Salter; Megan Kathleen Boyd; Mineral Interest Trust; Nancy I Farmer; Nicole Marie Sanchez; Patrick Markam Boyd; University of the Southwest; The Southwestern Baptist Theological Seminary; Sharon Jeffreys; Debbie Fogel; Prevall Energy, LLC; Monticello Minerals, LLC; Rhainer Holdings, LLC; Cayuga Royalties, LLC; OGX Royalty Fund, LP; Bryan Bell Family, LLC; Cathleen Ann Adams, Trustee of the Cathleen Ann Adams Revocable Trust dated 9/25/2020; Susan Arrott aka Susan Carol Arrott, Trustee of the Arrott Family Revocable Trust dated 4/8/2019; Wells Fargo Bank N.A., Trustee of the Robert N. Enfield Revocable Trust dated March 16, 1999; Nuevo Sels, Limited Partnership; Jetstream Royalty Partners, LP; Morris E. Schertz; DMA, Inc.; Charmor, LLC; Howard A. Rubln, Inc.; Lisa M. Enfield, Trustee of the Lisa M. Enfield Trust u/a/d January 23, 2015; MLE, LLC; Richard C. Deason; Thomas D. Deason; Ronald H. Mayer; SAP, LLC; Rubie Crosby Bell Family, LLC of Franklin Mountain Energy, LLC's application for compulsory pooling, Lea County, New Mexico. The State of New Mexico, through its Oil Conservation Division, hereby gives notice that the Division will conduct a public hearing at 8:15 a.m. on August 5, 2021, to consider this application. Applicant seeks an order from the Division pooling all uncommitted interests within a Wolfcamp horizontal spacing unit underlying the E/2 of Sections 13 and 24, Township 25 South, Range 35 East, NMPM, Lea County, New Mexico. This spacing unit will be dedicated to the Santa Fe Fed Com 704H, Santa Fe Fed Com 705H, and Zia Fed Com 706H wells to be horizontally drilled. The completed interval for the Santa Fe Fed Com 705H well will be within 380' from the adjoining tracts to allow inclusion of proximity tracts within the proposed standard horizontal spacing unit. The producing area for the Santa Fe Fed Com 704H, Santa Fe Fed Com 705H, and Zia Fed Com 706H wells will be orthodox. Also, to be considered will be the cost of drilling, completing, and equipping said wells, the allocation of these costs as well as the actual operating costs and charges for supervision while drilling and after completion, designation of Franklin Mountain Energy, LLC as operator of the wells, and a 200% charge for risk involved in drilling said wells. Said area is located approximately 10 miles Northwest of Jal, New Mexico.

CASE NO. 22081: Notice to all affected parties, as well as the heirs and devisees of Chevron USA, Inc.; Jetstream Oil & Gas Partners LP; Chief Capital (O&G) II, LLC; Texas Tech University; Stanley E. Luker and Glenda C. Luker Family Trust; Patricia Ann Arenburg, Trustee; NMTX Mineral Fund, LLC; Ohio State University; West Texas A&M University; Frank T. Fleet, Inc.; Daniel Fleet Freeman, Trustee of the Margaret Helen Keimar Trust A; P.A.W.N. Enterprises, a Limited Partnership; Texas State Bank, Successor Trustee of the Lucille Chism Bates Testamentary Trust u/w/o Lucille Chism Bates; Plantation Operating, LLC; United States of America; Sugarberry Oil & Gas Corporation; Katy Pipeline & Production Corp.; TD Minerals, LLC; John V. McCarthy, II; Joseph M. Victory; Augusta Elizabeth Bruley Elmwood; Beverly B. Blair; Catherine DeAnn Salvo Wren; Gregory Simone Salvo; Jerry Lasater, Jr.; Charles David West III; DeAlva E. Blocker, Trustee of the Blocker Family Trust, dated December 15, 1994; J.L. Burke, III; Laura of the Blocker Family Trust, dated December 15, 1994; Lisa M. Daves Revocable Trust, by Lisa Jean Amman; Linda Ruth Garcia; Lisa M. Daves Revocable Trust; Mineral Interest Trust; Nancy I Farmer; Nicole Marie Sanchez; Patrick Markam Boyd; University of the Southwest; The Southwestern Baptist Theological Seminary; Sharon Jeffreys; Debbie Fogel; Prevall Energy, LLC; Monticello Minerals, LLC; Rhainer Holdings, LLC; Cayuga Royalties, LLC; OGX Royalty Fund, LP of Franklin Mountain Energy, LLC's application for compulsory pooling, Lea County, New Mexico. The State of New Mexico, through its Oil Conservation Division, hereby gives notice that the Division will conduct a public hearing at 8:15 a.m. on August 5, 2021, to consider this application. Applicant seeks an order from the Division pooling all uncommitted interests within a Bone Spring horizontal spacing unit underlying the E/2E/2 of Sections 13 and 24, Township 25 South, Range 35 East, NMPM, Lea County, New Mexico. This spacing unit will be dedicated to the Zia Fed Com 604H well to be horizontally drilled. The producing area for the Zia Fed Com 604H well will be orthodox. Also to be considered will be the cost of drilling, completing, and equipping said well, the allocation of these costs as well as the actual operating costs and charges for supervision while drilling and after completion, designation of Franklin Mountain Energy, LLC as operator of the well, and a 200% charge for risk involved in drilling said well. Said area is located approximately 10 miles Northwest of Jal, New Mexico.

CASE NO. 22082: Notice to all affected parties, as well as the heirs and devisees of Chevron USA, Inc.; Texas Tech University; Stanley E. Luker and Glenda C. Luker Family Trust; Patricia Ann Arenburg, Trustee; NMTX Mineral Fund, LLC; Ohio State University; West Texas A&M University; Russell H. Wickman; United States of America; Benjamin Louis Fonville, III; Debra Fonville Lamb; Ellen Fonville Latsch; Joyce Ann Fonville Preston; Augusta Elizabeth Bruley Elmwood; Beverly B. Blair; Catherine DeAnn Salvo Wren; Gregory Simone Salvo; Jerry Lasater Jr; DeAlva E. Blocker, Trustee of the Blocker Family Trust, dated December 15, 1994; J.L. Burke, III; Linda Ruth Garcia; Lisa M. Daves Revocable Trust, by Lisa M. Daves, Trustee; Marilyn Burke Salter; Megan Kathleen Boyd; Nancy I. Farmer; Nicole Marie Sanchez; Patrick Markam Boyd; University of the Southwest; The Southwestern Baptist Theological Seminary; Sharon Jeffreys; Debbie Fogel; Prevall Energy, LLC; Monticello Minerals, LLC; Rhainer Holdings, LLC; Cayuga Royalties, LLC; OGX Royalty Fund, LP; Bryan Bell Family, LLC; Cathleen Ann Adams, Trustee of the Cathleen Ann Adams Revocable Trust dated 9/25/2020; Susan Arrott aka Susan Carol Arrott, Trustee of the Arrott Family Revocable Trust dated 4/8/2019; Wells Fargo Bank N.A., Trustee of the Robert N. Enfield Revocable Trust dated March 16, 1999; Nuevo Sels, Limited Partnership; Jetstream Royalty Partners, LP; Morris E. Schertz; DMA, Inc.; Charmor, LLC; Howard A. Rubln, Inc.; Lisa M. Enfield, Trustee of the Lisa M. Enfield Trust u/a/d January 23, 2015; MLE, LLC; Richard C. Deason; Thomas D. Deason; Ronald H. Mayer; SAP, LLC; Rubie Crosby Bell Family, LLC of Franklin Mountain Energy, LLC's application for compulsory pooling, Lea County, New Mexico. The State of New Mexico, through its Oil Conservation Division, hereby gives notice that the Division will conduct a public hearing at 8:15 a.m. on August 5, 2021, to consider this application. Applicant seeks an order from the Division pooling all uncommitted interests within a Bone Spring horizontal spacing unit underlying the W/2E/2 of Sections 13 and 24, Township 25 South, Range 35 East, NMPM, Lea County, New Mexico. This spacing unit will be dedicated to the Santa Fe Fed Com 603H well to be horizontally drilled. The producing area for the Santa Fe Fed Com 603H well will be orthodox. Also to be considered will be the cost of drilling, completing, and equipping said well, the allocation of these costs as well as the actual operating costs and charges for supervision while drilling and after completion, designation of Franklin Mountain Energy, LLC as operator of the well, and a 200% charge for risk involved in drilling said well. Said area is located approximately 10 miles Northwest of Jal, New Mexico.
#36662

7. **Exhibit 11-A** is structure map of the top of the Third Bone Spring Sand. The proposed spacing unit is identified by a pink box. The Santa Fe Fed Com 603H well is the black dashed line identified by the box labeled "1". The contour interval used this exhibit is 25 feet. This exhibit shows that the structure dips gently to the southwest.

8. **Exhibit 11-B** is a cross section reference map that identifies three wells in the vicinity of the proposed well, shown by a line of cross-section running from A to A'.

9. **Exhibit 11-C** is a stratigraphic cross section hung on the Wolfcamp top. The well logs on the cross-section give a representative sample of the Third Bone Spring Sand formation in the area. The target zone is identified by a bracket and the words "Producing Interval". I have also identified where the Santa Fe Fed Com 603H well falls within the wells I used for the cross-section.

10. In my opinion, the gross interval thickness thickens slightly from north to the south.

11. **Exhibit 11-D** is a Gross Sand Isochore of the Third Bone Spring Sand. The gross interval thickness thickens slightly from north to the south across the unit and thickens slightly from northeast to southwest regionally.

12. I conclude from the maps that:

- a. The horizontal spacing unit is justified from a geologic standpoint.
- b. There are no structural impediments or faulting that will interfere with horizontal development.
- c. Each quarter quarter section in the proposed unit will contribute more or less equally to production.

13. **Exhibit 12** provides an overview of the stress orientation in the area based on the 2018 Snee-Zoback paper.

- a. The preferred well orientation in this area is either north/south or south/north, nearly orthogonal to S_{Hmax} , optimal for induced fracture propagation. This is because the S_{Hmax} is at approximately 265 degrees ENE in this area of Lea County.
14. Exhibits 9-12 were prepared by me or under my supervision or compiled from company business records.
15. In my opinion, the granting of Franklin's application is in the interests of conservation and the prevention of waste.

[Signature page follows]

I declare that the information provided herein is correct and complete to the best of my knowledge and belief.



Ben Kessel

Dated: August 2, 2021

Santa Fe Fed Com 603H

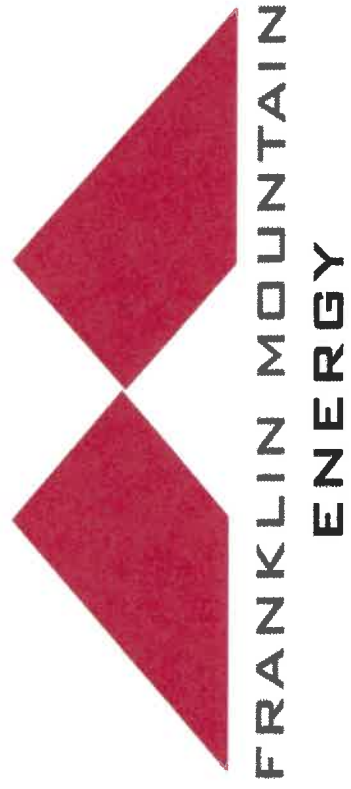

Land of Enchantment (LOE) Development



Locator Map

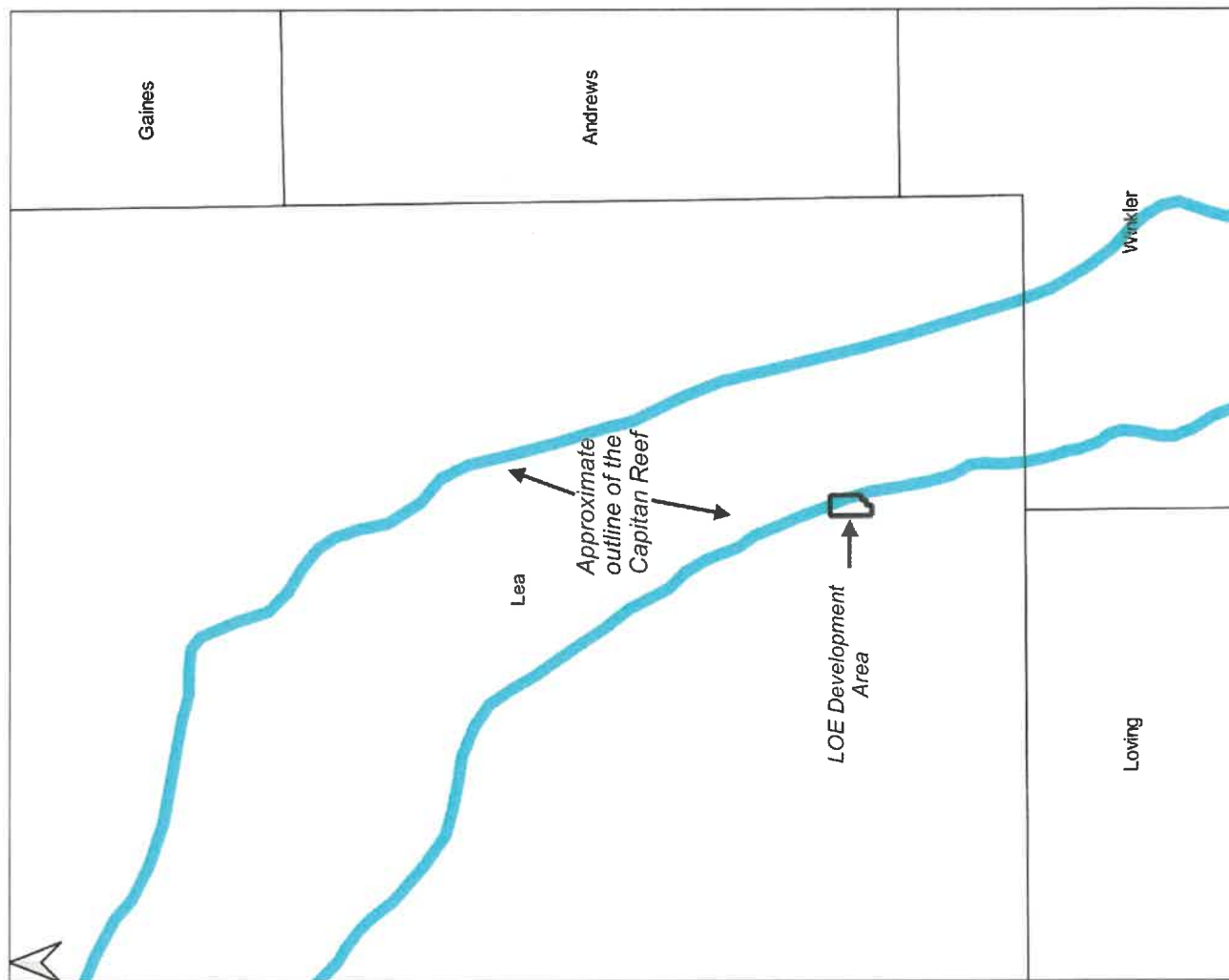

- Black box shows the location of LOE development area
- Planned wells are located adjacent to the western edge of the Capitán Reef



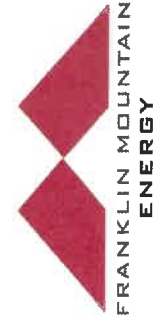

Wellbore Schematic

25S 35E Section 24-Looking North

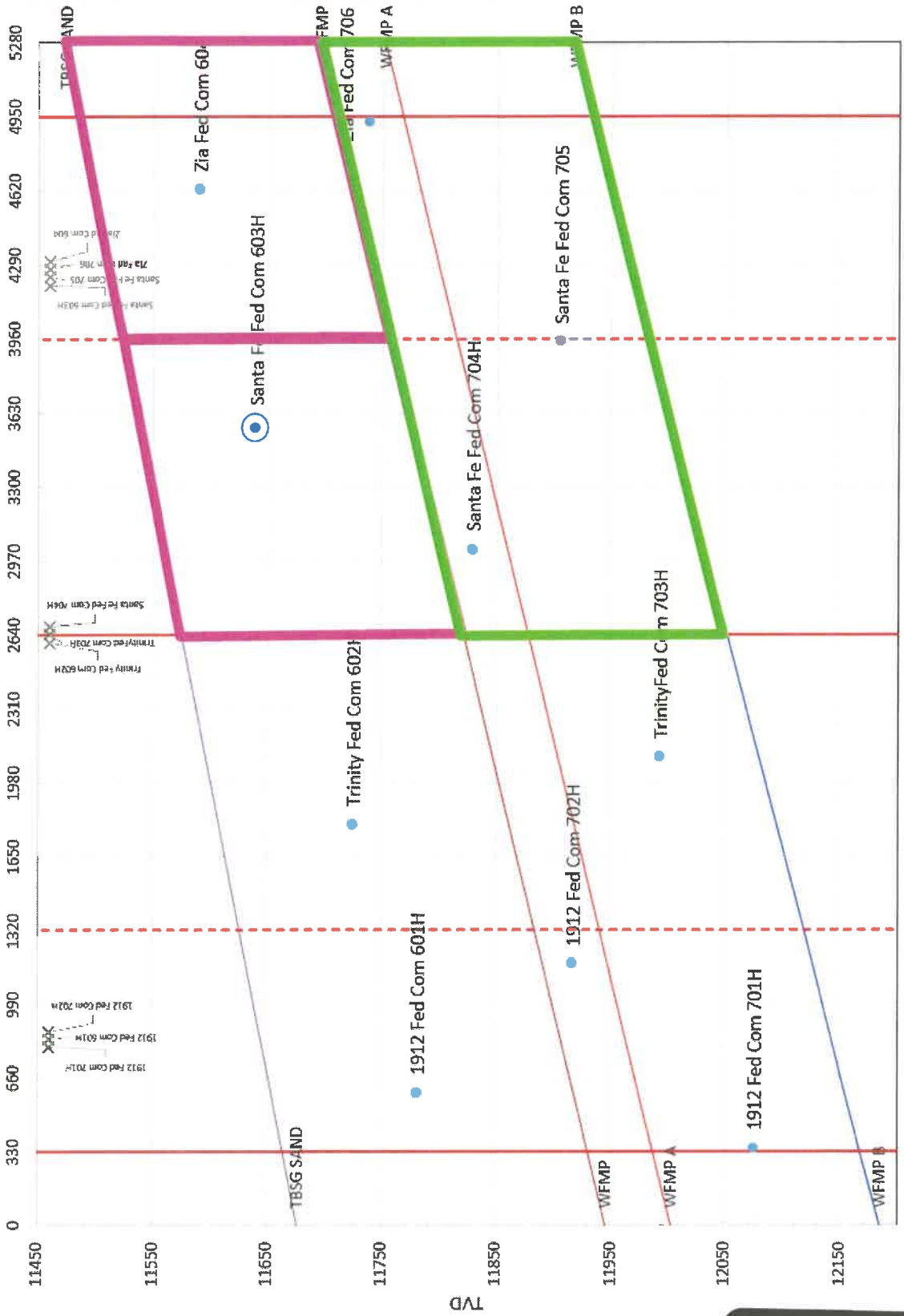

- Proposed Lateral
- Bone Spring Spacing Unit
- Wolfcamp Spacing Unit

tabbles[®] EXHIBIT 10

Top TBSG Sand Structure Map (SSTVD)

Santa Fe Fed Com 603H



Franklin Mountain Acreage

Bone Spring Spacing Unit

Proposed Horizontal Location

1 Santa Fe Fed Com 603H

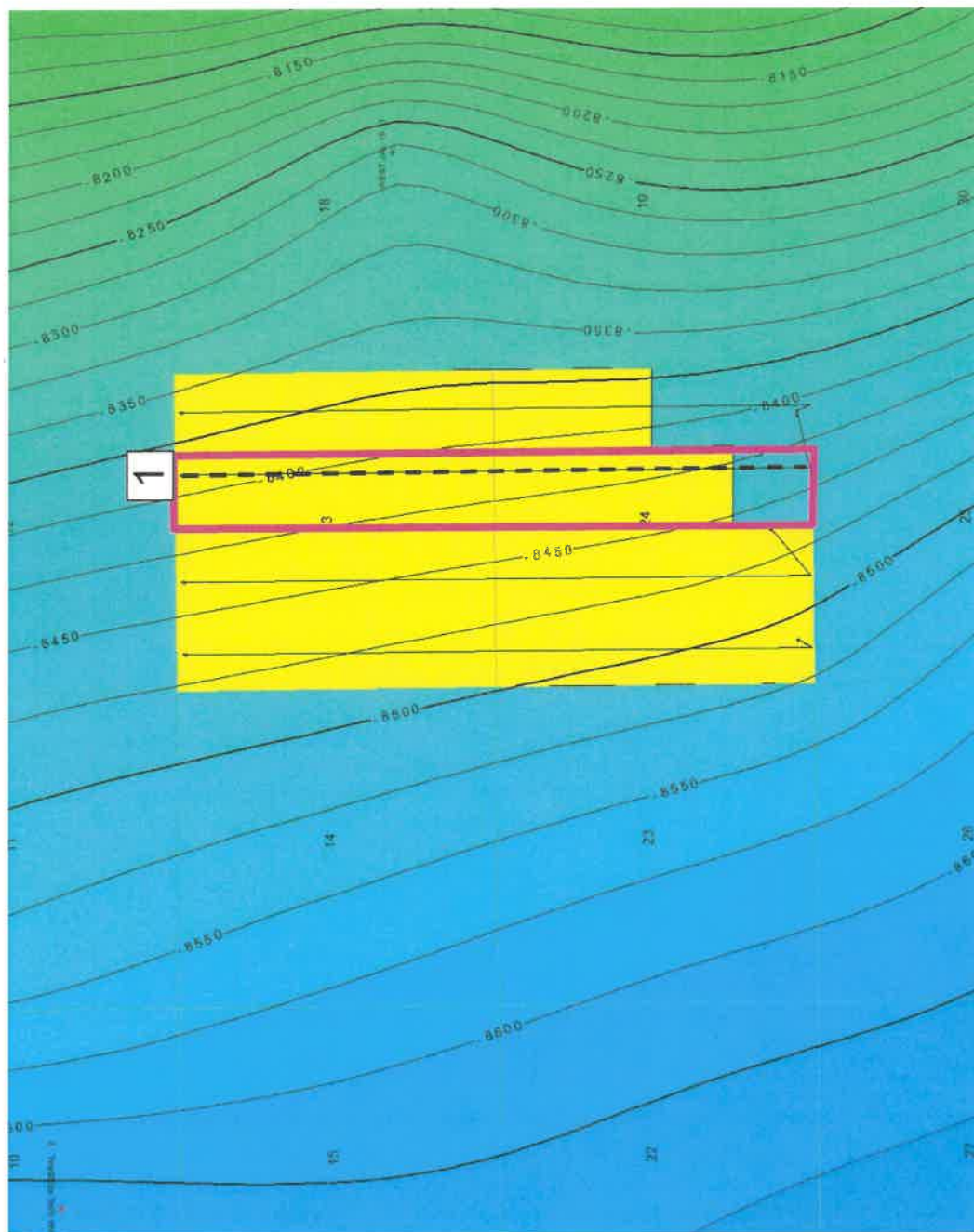

1 mile

Control wells shown

C.I. = 25'

tabbies' EXHIBIT 11-A

Third Bone Spring Sand Cross Section

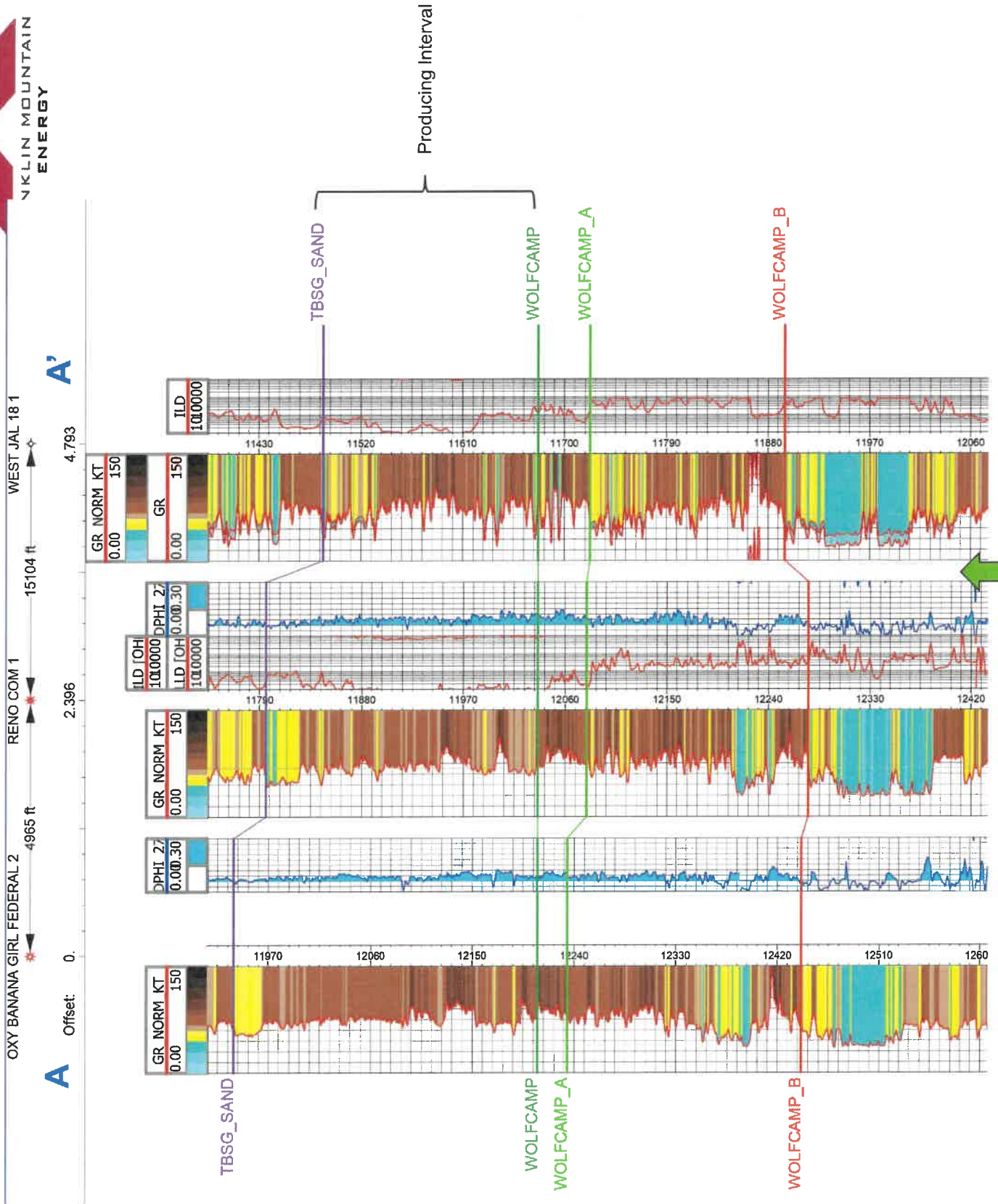

Santa Fe Fed Com 603H

tabbies

EXHIBIT

11-C

TBSG Sand Isochore

Santa Fe Fed Com 603H



Franklin Mountain Acreage

Bone Spring Spacing Unit

Proposed Horizontal Location

1 Santa Fe Fed Com 603H

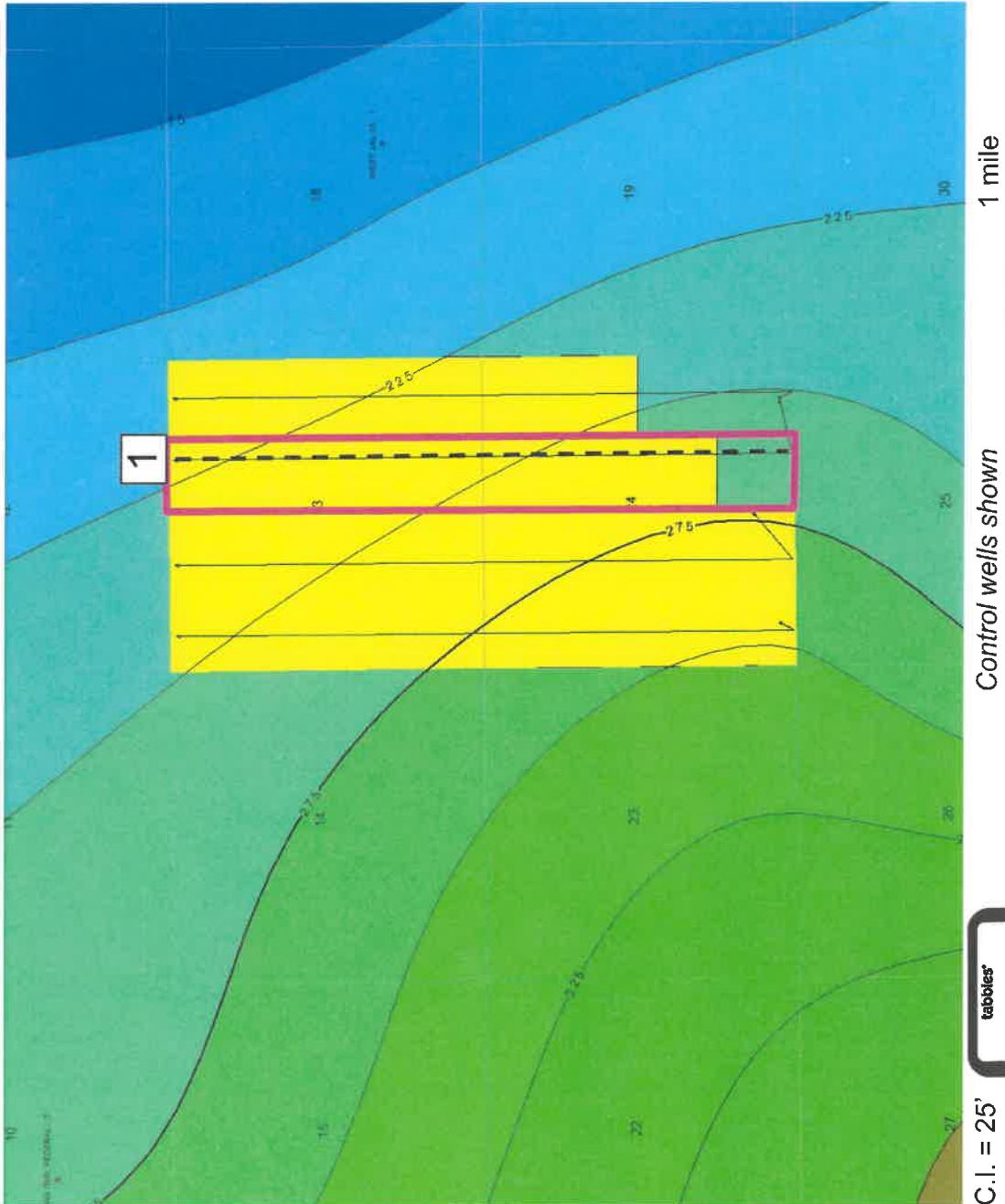

C.I. = 25'

Control wells shown

1 mile

EXHIBIT
11-D

Regional Stress

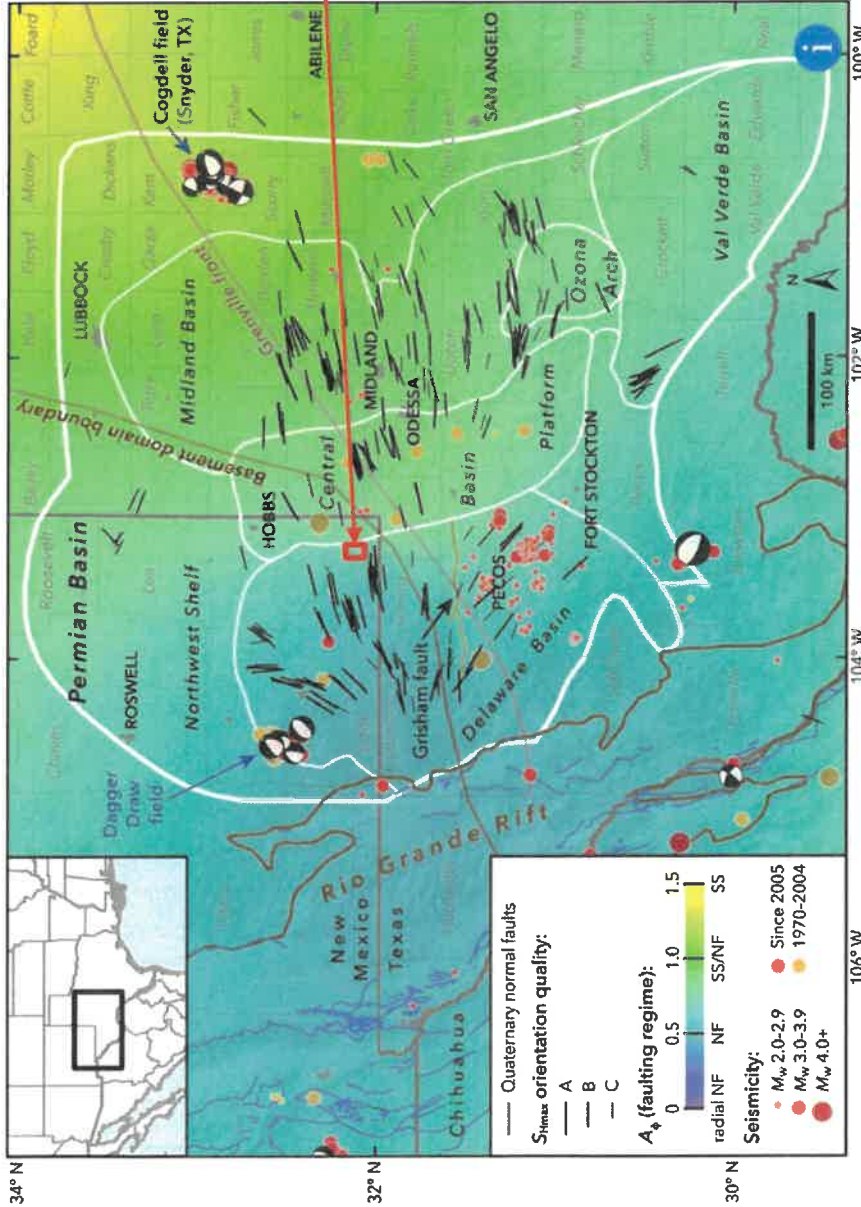

- Red box shows the approximate location of the LOE development
- Reported local S_{Hmax} (Snee and Zoback, 2018) direction is ENE, around 265°
- The Santa Fe Fed Com 603H well is planned to drill N-S, nearly orthogonal to S_{Hmax} , optimal for induced fracture propagation

Snee, J.L. and Zoback, M.D., 2018, State of stress in the Permian Basin, Texas and New Mexico: Implications for induced seismicity: The Leading Edge, 37, no. 2
http://www.tleonline.org/theleadingedge/february_2018/MobilePagedArticle.action?articleId=1331603#articleId1331603

