

CASE NOS. 21991 and 21992

APPLICATIONS OF
MATADOR PRODUCTION COMPANY FOR COMPULSORY POOLING,
EDDY COUNTY, NEW MEXICO

EXHIBITS (PART II)

- A. Applications and Proposed Notices
- B. Pooling Checklists
- C. Landman's Affidavit
- D. Geologist's Affidavit
- E. Affidavit of Notice
- F. Affidavit of Publication

Exhibit C-3

**Matador
Exhibit C-3**

Summary of Interests

MRC Permian Company Working Interest		62.991906%
Voluntary Joinder		2.498907%
Compulsory Pool Interest Total:		35.149645%
Interest Owner:	Description:	Interest:
EOG Resources Inc	Uncommitted Working Interest Owner	8.508013%
Yates-US Inc	Uncommitted Working Interest Owner	2.512595%
Yates Energy Corporation	Uncommitted Working Interest Owner	1.781057%
OXY USA WTP Limited Partnership	Uncommitted Working Interest Owner	0.972289%
Rejar LLC	Uncommitted Working Interest Owner	1.888863%
Harry B Hinkle	Uncommitted Working Interest Owner	1.888865%

Cedar 3231 Federal Com #123H



**Matador
Exhibit C-3**

Summary of Interests

Interest Owner:	Description:	Interest:
Nadel and Gussman Capitan LLC	Uncommitted Working Interest Owner	1.508668%
Finley Production Co LP	Uncommitted Working Interest Owner	12.747041%
Coikelan Corporation	Uncommitted Working Interest Owner	2.522442%
Grasslands Energy LP	Uncommitted Working Interest Owner	0.179354%
Burlington Resources Oil & Gas Company	Record Title Owner	Record Title Owner

Cedar 3231 Federal Com #123H



**Matador
Exhibit C-3**

Summary of Interests

MRC Permian Company Working Interest		47.415170%
Voluntary Joinder		3.866999%
Compulsory Pool Interest Total:		49.946557%
Interest Owner:	Description:	Interest:
EOG Resources Inc	Uncommitted Working Interest Owner	16.322733%
Yates-US Inc	Uncommitted Working Interest Owner	4.820446%
Yates Energy Corporation	Uncommitted Working Interest Owner	3.416980%
OXY USA WTP Limited Partnership	Uncommitted Working Interest Owner	1.865349%
Rejar LLC	Uncommitted Working Interest Owner	2.466777%
Harry B Hinkle	Uncommitted Working Interest Owner	2.466779%



Cedar 3231 Federal Com #124H

**Matador
Exhibit C-3**

Summary of Interests

Interest Owner:	Description:	Interest:
Nadel and Gussman Capitan LLC	Uncommitted Working Interest Owner	1.914857%
Finley Production Co LP	Uncommitted Working Interest Owner	12.742976%
Colkelan Corporation	Uncommitted Working Interest Owner	2.521638%
Grasslands Energy LP	Uncommitted Working Interest Owner	0.179297%
Burlington Resources Oil & Gas Company	Record Title Owner	Record Title Owner



Cedar 3231 Federal Com #124H

Exhibit C-4

ORRI to be pooled for Cedar 3231 Fed Com 123H & 124H

Pearson-Sibert Oil Co. of Texas
A. F. Gilmore Company
Janet Barr Fitting, Trustee of the Robert D. Fitting Trust
E. B. Hall
Fort Worth Royalty Company
Gregg Alan Groves, Trustee of the Groves Family Trust
Rodney O. Thompson
Sally Jo Roberts (a/k/a Sally Meador-Roberts)
Yates Energy Royalty Interests LLC

Exhibit C-5

MRC Permian Company

One Lincoln Centre • 5400 LBJ Freeway • Suite 1500 • Dallas, Texas 75240

Voice 972-629-2158 • Fax 214.866.4946

cade.labolt@matadorresources.com

Cade LaBolt
Landman

March 19, 2021

VIA CERTIFIED RETURN RECEIPT MAIL

EOG Resources, Inc.
P.O. Box 2267
Midland, TX 79702

Re: Cedar 3231 Fed Com #123H, #124H (the "Wells")
Participation Proposal
Section 31, Township 17 South, Range 31 East
Section 32, Township 17 South, Range 31 East
Eddy County, New Mexico

Dear Sir/Madam:

MRC Permian Company ("MRC") proposes the drilling of the following Matador Production Company's Cedar 3231 Fed Com #123H, Cedar 3231 Fed Com #124H wells, located in Sections 32 & 31, Township 17 South, Range 31 East, Eddy County, New Mexico.

In connection with the above, please note the following:

The estimated cost of drilling, testing, completing, and equipping of each Well is itemized on the two (2) enclosed Authority for Expenditures ("AFE") dated December 15, 2020.

- **Cedar 3231 Fed Com #123H:** to be drilled from a legal location with a proposed surface hole location in the NE/4SE/4 of Section 32-17S-31E and a proposed bottom hole location in the NW/4SW/4 of Section 31-17S-31E. The Well will have a targeted interval within the Bone Spring formation and will be drilled horizontally in the Bone Spring (~7,600' TVD) to a Measured Depth of approximately 17,850'.
- **Cedar 3231 Fed Com #124H:** to be drilled from a legal location with a proposed surface hole location in the SE/4SE/4 of Section 32-17S-31E and a proposed bottom hole location in the SW/4SW/4 of Section 31-17S-31E. The Well will have a targeted interval within the Bone Spring formation and will be drilled horizontally in the Bone Spring (~7,600' TVD) to a Measured Depth of approximately 17,850'.

MRC reserves the right to modify the locations and drilling plans described above in order to address topography, cultural or environmental concerns, among other reasons. MRC will advise you of any such modifications.

MRC requests that you indicate your election to participate in the drilling and completion of the Wells in the space provided below, sign and return one (1) copy of this letter to the undersigned.

MRC is proposing to drill the Wells under the terms of the modified 1989 AAPL form of Operating Agreement dated March 19, 2021, by and between Matador Production Company, as Operator and MRC Permian Company et al as Non-Operators covering All of Sections 32 & 31, Township 17 South, Range 31 East, Eddy County, New Mexico, and has the following general provisions:

- 100/300/300 Non-consenting penalty
- \$8,000/\$800 Drilling and Producing rate
- Matador Production Company named as Operator

If your election is to participate in the drilling and completion of the Well, please sign and return a copy of the enclosed AFE within thirty (30) days of receipt of this notice. Please be aware that the enclosed AFE is only an estimate of costs to be incurred and by electing to participate in the Well, each working interest owner shall be responsible for its proportionate share of all costs incurred.

Thank you for your consideration of this proposal. Please contact me if you have any questions.

Sincerely,

MRC PERMIAN COMPANY



Cade LaBolt

EOG Resources, Inc. hereby elects to:

- _____ Participate for its proportionate share of the costs detailed in the enclosed AFE associated with Matador Production Company's Cedar 3231 Fed Com #123H well.
- _____ Not to participate in the Cedar 3231 Fed Com #123H

- _____ Participate for its proportionate share of the costs detailed in the enclosed AFE associated with Matador Production Company's Cedar 3231 Fed Com #124H well.
- _____ Not to participate in the Cedar 3231 Fed Com #124H

EOG Resources, Inc.

By: _____

Title: _____

Date: _____

Contact Number: _____

MATADOR PRODUCTION COMPANY

ONE LINCOLN CENTRE • 5400 LBJ FREEWAY • SUITE 1500 • DALLAS, TEXAS 75240

Phone (972) 371-5200 • Fax (972) 371-5201

ESTIMATE OF COSTS AND AUTHORIZATION FOR EXPENDITURE

DATE:	December 15, 2020	AFE NO.:	
WELL NAME:	Cedar 3231 Fed Com 123H	FIELD:	
LOCATION:	32 and 31, 17S-31E	MD/TVD:	17,850/7,600'
COUNTY/STATE:	Eddy County, New Mexico	LATERAL LENGTH:	9,700'
MRC WI:			
GEOLOGIC TARGET:	2nd Bone Spring		
REMARKS:	Drill, complete and equip a horizontal 2nd Bone Spring well		

INTANGIBLE COSTS	DRILLING COSTS	COMPLETION COSTS	PRODUCTION COSTS	FACILITY COSTS	TOTAL COSTS
Land / Legal / Regulatory	\$ 36,500			\$ 10,000	\$ 46,500
Location, Surveys & Damages	94,000	13,000	15,000	25,000	147,000
Drilling	575,350				575,350
Cementing & Float Equip	224,000				224,000
Logging / Formation Evaluation		5,000	3,000		8,000
Flowback - Labor			23,400		23,400
Flowback - Surface Rentals			20,304		20,304
Flowback - Rental Living Quarters					
Mud Logging	12,000				12,000
Mud Circulation System	34,325				34,325
Mud & Chemicals	150,000	49,000	6,000		205,000
Mud / Wastewater Disposal	125,500			1,000	126,500
Freight / Transportation	7,500	19,500			27,000
Rig Supervision / Engineering	66,625	112,000	4,350	14,400	197,375
Drill Bits	86,500				86,500
Drill Bit Purchase					
Fuel & Power	46,125	8,000			54,125
Water	25,000	756,250	3,000	1,000	785,250
Drig & Completion Overhead	10,250	10,000			20,250
Plugging & Abandonment					
Directional Drilling, Surveys	171,725				171,725
Completion Unit, Swab, CTU		130,000	13,500		143,500
Perforating, Wireline, Slickline		180,000			180,000
High Pressure Pump Truck		64,000	6,000		70,000
Stimulation		1,872,750			1,872,750
Stimulation Flowback & Disp		15,500	195,000		210,500
Insurance	32,130				32,130
Labor	89,500	62,500	15,000	5,000	172,000
Rental - Surface Equipment	49,303	315,880	10,000	5,000	380,183
Rental - Downhole Equipment	78,800	80,000	5,000		163,800
Rental - Living Quarters	20,388	48,050		5,000	73,438
Contingency	96,776	166,869	16,028	6,640	306,313
Operations Center	22,038				22,038
TOTAL INTANGIBLES >	2,054,334	3,928,309	336,582	73,040	6,392,264

TANGIBLE COSTS	DRILLING COSTS	COMPLETION COSTS	PRODUCTION COSTS	FACILITY COSTS	TOTAL COSTS
Surface Casing	\$ 23,692				\$ 23,692
Intermediate Casing	69,975				69,975
Drilling Liner					
Production Casing	378,560				378,560
Production Liner					
Tubing			43,200		43,200
Wellhead	46,000		23,500		69,500
Packers, Liner Hangers		67,350			67,350
Tanks				29,900	29,900
Production Vessels				119,638	119,638
Flow Lines				120,000	120,000
Rod string					
Artificial Lift Equipment			275,000		275,000
Compressor				42,500	42,500
Installation Costs				96,000	96,000
Surface Pumps			2,500	26,250	28,750
Non-controllable Surface				2,000	2,000
Non-controllable Downhole					
Downhole Pumps					
Measurement & Meter Installation			10,000	49,000	59,000
Gas Conditioning / Dehydration					
Interconnecting Facility Piping				62,500	62,500
Gathering / Bulk Lines					
Valves, Dumps, Controllers					
Tank / Facility Containment				11,250	11,250
Flare Stack				20,000	20,000
Electrical / Grounding			36,000	16,000	46,000
Communications / SCADA			4,000	2,500	6,500
Instrumentation / Safety				55,750	55,750
TOTAL TANGIBLES >	518,227	67,350	388,200	653,288	1,627,064
TOTAL COSTS >	2,572,560	3,995,659	724,782	726,328	8,019,328

PREPARED BY MATADOR PRODUCTION COMPANY:

Drilling Engineer:	Blake Hernas	Team Lead - WTX/NM
Completions Engineer:	Garrett Hunt	WTE
Production Engineer:	George Malloy	

MATADOR RESOURCES COMPANY APPROVAL:

Executive VP, COO/CFO	DEL	VP - Res Engineering	BMR	VP - Drilling	BG
Executive VP, Legal	CA	Exec Dir - Exploration	NLF		
President	MVH				

NON OPERATING PARTNER APPROVAL:

Company Name:	Working Interest (%):	Tax ID:
Signed by:	Date:	
Title:	Approval Yes	No (mark one)

The costs on this AFE are estimates only and may not be confirmed or binding on any specific date or the later date of the project. Tubing installation approval under the AFE may be delayed up to a year after the well has been completed. In executing this AFE, the Participant agrees to pay its proportionate share of actual costs incurred including legal, survey, regulatory, bridge and well costs under the terms of the applicable (cost) operating agreement, regulatory order or other agreement covering the well. Participants will be contractually and jointly liable for their proportionate share of actual costs incurred under the terms of the applicable (cost) operating agreement, regulatory order or other agreement covering the well. Participants will be contractually and jointly liable for their proportionate share of actual costs incurred under the terms of the applicable (cost) operating agreement, regulatory order or other agreement covering the well.

MATADOR PRODUCTION COMPANY

ONE LINCOLN CENTRE • 5400 LBJ FREEWAY • SUITE 1500 • DALLAS, TEXAS 75240
 Phone (972) 371-5200 • Fax (972) 371-5201

ESTIMATE OF COSTS AND AUTHORIZATION FOR EXPENDITURE

DATE:	December 15, 2020	AFE NO.:	
WELL NAME:	Cedar 3231 Fed Com 124H	FIELD:	
LOCATION:	32 and 31, 17S-31E	MD/TVD:	17,850'/7,600'
COUNTY/STATE:	Eddy County, New Mexico	LATERAL LENGTH:	9,700'
MRC W/:			
GEOLOGIC TARGET:	2nd Bone Spring		
REMARKS:	Drill, complete and equip a horizontal 2nd Bone Spring well		

INTANGIBLE COSTS	DRILLING COSTS	COMPLETION COSTS	PRODUCTION COSTS	FACILITY COSTS	TOTAL COSTS
Land / Legal / Regulatory	\$ 36,500	\$ -	\$ -	\$ 10,000	\$ 46,500
Location, Surveys & Damages	94,000	13,000	18,000	25,000	147,000
Drilling	575,350	-	-	-	575,350
Cementing & Float Equip	224,000	-	-	-	224,000
Logging / Formation Evaluation	-	5,000	3,000	-	8,000
Flowback - Labor	-	-	23,400	-	23,400
Flowback - Surface Rentals	-	-	20,304	-	20,304
Flowback - Rental Living Quarters	-	-	-	-	-
Mud Logging	12,000	-	-	-	12,000
Mud Circulation System	34,325	-	-	-	34,325
Mud & Chemicals	150,000	49,000	6,000	-	205,000
Mud / Wastewater Disposal	125,500	-	-	1,000	126,500
Freight / Transportation	7,500	19,500	-	-	27,000
Rig Supervision / Engineering	66,625	112,000	4,350	14,400	197,375
Drill Bits	86,500	-	-	-	86,500
Drill Bit Purchase	-	-	-	-	-
Fuel & Power	48,125	8,000	-	-	54,125
Water	25,000	758,250	3,000	1,000	785,250
Drig & Completion Overhead	10,250	10,000	-	-	20,250
Plugging & Abandonment	-	-	-	-	-
Directional Drilling, Surveys	171,725	-	-	-	171,725
Completion Unit, Swab, CTU	-	130,000	13,500	-	143,500
Perforating, Wireline, Slickline	-	180,000	-	-	180,000
High Pressure Pump Truck	-	64,000	6,000	-	70,000
Stimulation	-	1,872,750	-	-	1,872,750
Stimulation Flowback & Disp	-	15,500	195,000	-	210,500
Insurance	32,130	-	-	-	32,130
Labor	89,500	62,500	15,000	5,000	172,000
Rental - Surface Equipment	49,303	315,890	10,000	5,000	380,193
Rental - Downhole Equipment	78,809	80,000	5,000	-	164,800
Rental - Living Quarters	20,388	48,050	-	5,000	73,438
Contingency	96,776	186,869	16,026	6,640	306,313
Operations Center	22,038	-	-	-	22,038
TOTAL INTANGIBLES >	2,054,334	3,928,309	336,582	73,040	6,392,264

TANGIBLE COSTS	DRILLING COSTS	COMPLETION COSTS	PRODUCTION COSTS	FACILITY COSTS	TOTAL COSTS
Surface Casing	\$ 23,692	\$ -	\$ -	\$ -	\$ 23,692
Intermediate Casing	69,975	-	-	-	69,975
Drilling Liner	-	-	-	-	-
Production Casing	378,560	-	-	-	378,560
Production Liner	-	-	-	-	-
Tubing	-	-	43,200	-	43,200
Wellhead	46,000	-	23,500	-	69,500
Packers, Liner Hangers	-	67,350	-	-	67,350
Tanks	-	-	-	29,900	29,900
Production Vessels	-	-	-	119,638	119,638
Flow Lines	-	-	-	120,000	120,000
Rod string	-	-	-	-	-
Artificial Lift Equipment	-	-	275,000	-	275,000
Compressor	-	-	-	42,500	42,500
Installation Costs	-	-	-	98,000	98,000
Surface Pumps	-	-	2,500	28,750	28,750
Non-controllable Surface	-	-	-	2,000	2,000
Non-controllable Downhole	-	-	-	-	-
Downhole Pumps	-	-	-	-	-
Measurement & Meter Installation	-	-	10,000	49,000	59,000
Gas Conditioning / Dehydration	-	-	-	-	-
Interconnecting Facility Piping	-	-	-	62,500	62,500
Gathering / Bulk Lines	-	-	-	-	-
Valves, Dumps, Controllers	-	-	-	-	-
Tank / Facility Containment	-	-	-	11,250	11,250
Flare Stack	-	-	-	20,000	20,000
Electrical / Grounding	-	-	30,000	16,000	46,000
Communications / SCADA	-	-	4,000	2,500	6,500
Instrumentation / Safety	-	-	-	55,750	55,750
TOTAL TANGIBLES >	518,227	67,350	388,200	653,288	1,627,064
TOTAL COSTS >	2,572,560	3,995,659	724,782	726,328	8,019,328

PREPARED BY MATADOR PRODUCTION COMPANY:

Drilling Engineer:	Blake Herms	Team Lead - WTXNM	
Completions Engineer:	Garrett Hunt		WTE
Production Engineer:	George Malloy		

MATADOR RESOURCES COMPANY APPROVAL:

Executive VP, COO/CFO	DEL	VP - Res Engineering	BMR	VP - Drilling	BO
Executive VP, Legal	CA	Exec Dir - Exploration	NLF		
President	MVH				

NON OPERATING PARTNER APPROVAL:

Company Name:	Working Interest (%):	Tax ID:
Signed by:	Date:	
Title:	Approval: Yes	No (mark one)

The costs on this AFE are estimates only and may not be identical to the actual costs of the project. Funding is subject to approval of the AFE by the designated partner after the well has been completed. In executing this AFE, the Participant agrees to bear its proportionate share of actual costs incurred including legal, contract, regulatory, brokerage and well costs under the terms of the applicable (and depending agreement, regulatory and/or other agreement) covering the well. Parties who shall be covered by and liable (pro-rata) to the Operator's well costs and general liability insurance unless participant provides Operator a certificate endorsing its own insurance in an amount acceptable to the Operator by the date of sale.

Exhibit C-6

Exhibit C-6

Cedar 3231 Fed Com 123H & 124H Communication with Parties

EOG Resources Inc. (Working Interest Owner)

- Well Proposals, JOA and AFEs sent on March 19, 2021 via certified mail for the Cedar 3231 Fed Com 123H & 124H
- Signed green card on March 23, 2021
- Emails exchanged regarding technical well specifications and anticipated spud date
- No election returned

Yates-US Inc. (Working Interest Owner)

- Well Proposals, JOA and AFEs sent on March 19, 2021 via certified mail for the Cedar 3231 Fed Com 123H & 124H
- Signed green card on March 23, 2021
- No election returned
- Email sent regarding well election

Yates Energy Corporation (Working Interest Owner)

- Well Proposals, JOA and AFEs sent on March 19, 2021 via certified mail for the Cedar 3231 Fed Com 123H & 124H
- Signed green card on March 23, 2021
- No election returned
- Phone calls exchanged

OXY USA WTP Limited Partnership (Working Interest Owner)

- Well Proposals, JOA and AFEs sent on March 19, 2021 via certified mail for the Cedar 3231 Fed Com 123H & 124H
- Signed green card on May 3, 2021
- Emails exchanged regarding anticipated spud dates
- No election returned

Rejar LLC (Working Interest Owner)

- Well Proposals, JOA and AFEs sent on March 19, 2021 via certified mail for the Cedar 3231 Fed Com 123H & 124H
- Signed green card on March 22, 2021
- Phone calls exchanged regarding interest
- No election returned

Harry B Hinkle (Working Interest Owner)

- Well Proposals, JOA and AFEs sent on March 19, 2021 via certified mail for the Cedar 3231 Fed Com 123H & 124H
- Signed green card; date of receipt not given
- Emails exchanged regarding ownership interest amounts
- No election returned

Nadel and Gussman Capitan LLC (Working Interest Owner)

- Well Proposals, JOA and AFEs sent on March 19, 2021 via certified mail for the Cedar 3231 Fed Com 123H & 124H
- Signed green card on March 27, 2021
- Emails exchanged regarding election to participate and JOA participation
- Election to participate received on April 20, 2021

Finley Production Co LP (Working Interest Owner)

- Well Proposals, JOA and AFEs sent on March 19, 2021 via certified mail for the Cedar 3231 Fed Com 123H & 124H
- Signed green card on March 22, 2021
- Emails exchanged regarding ownership interest amounts and force pooling status
- No election returned

Colkelan Corporation (Working Interest Owner)

- Well Proposals, JOA and AFEs sent on March 19, 2021 via certified mail for the Cedar 3231 Fed Com 123H & 124H
- Delivery attempted. Returned undelivered. New address not found.

Grasslands Energy LP (Working Interest Owner)

- Well Proposals, JOA and AFEs sent on March 19, 2021 via certified mail for the Cedar 3231 Fed Com 123H & 124H
- Signed green card on March 22, 2021
- Emails exchanged regarding election to participate and JOA
- Election to participate received on April 5, 2021

STATE OF NEW MEXICO
ENERGY, MINERALS, AND NATURAL RESOURCES DEPARTMENT
OIL CONSERVATION DIVISION

APPLICATIONS OF MATADOR
PRODUCTION COMPANY FOR
COMPULSORY POOLING,
EDDY COUNTY, NEW MEXICO.

CASE NOS. 21991 and 21992

AFFIDAVIT OF ANDREW PARKER

Andrew Parker, of lawful age and being first duly sworn, declares as follows:

1. My name is Andrew Parker. I work for MRC Energy Company, an affiliate of Matador Production Company ("Matador"), as a Vice President of Geology.
2. I have previously testified before the New Mexico Oil Conservation Division as an expert witness in petroleum geology. My credentials as a petroleum geologist have been accepted by the Division and made a matter of record.
3. I am familiar with the applications filed by Matador in these cases, and I have conducted a geologic study of the lands in the subject area.
4. **Matador Exhibit D-1** is a locator map outlining the horizontal spacing units with a black box shaded in yellow, with the larger area identified in a red box.
5. In these cases, Matador intends to develop the Bone Spring formation.
6. **Matador Exhibit D-2** is a subsea structure map that I prepared on the top of the Second Bone Spring Sand. The contour interval is 50 feet. The structure map shows the Bone Spring formation gently dipping to the south. The structure appears consistent across the proposed wellbore paths. I do not observe any faulting, pinchouts, or other geologic impediments to horizontal drilling.
7. Also included on Matador Exhibit D-2 is a line of cross section from A to A'.

EXHIBIT

D

8. **Matador Exhibit D-3** is a structural cross-section that I prepared displaying open-hole logs run over the Bone Spring formation from the two representative wells denoted from A to A'. For each well in the cross-section, the following logs are included: gamma ray, resistivity, and porosity. The proposed target intervals of each of the respective proposed wells is labeled and marked with a yellow shaded area. The logs in the cross-section demonstrate that the targeted intervals, within the Bone Spring formation, are consistent in thickness across the entirety of the proposed spacing unit.

9. Based on my geologic study of the area, I have not identified any geologic impediments to drilling horizontal wells within the Bone Spring formation in the area of the spacing units proposed in these cases.

10. In my opinion, each quarter-quarter section will be productive and contribute more-or-less equally to production from each respective horizontal spacing unit.

11. In my opinion, horizontal drilling will be the most efficient method to develop this acreage, to prevent the drilling of unnecessary wells, and to result in the greatest ultimate recovery.

12. Approving Matador's applications will be in the best interest of conservation, the prevention of waste, and protection of correlative rights.

13. **Matador Exhibits D-1 through D-3** were either prepared by me or compiled under my direction and supervision.

FURTHER AFFIANT SAYETH NOT.

Andrew Parker
ANDREW PARKER

STATE OF TEXAS)
)
COUNTY OF DALLAS)

SUBSCRIBED and SWORN to before me this 29th day of June 2021 by Andrew Parker.

Sara Marie Hartsfield
NOTARY PUBLIC

My Commission Expires:

8 -21-2023



Exhibit D-1

Locator Map

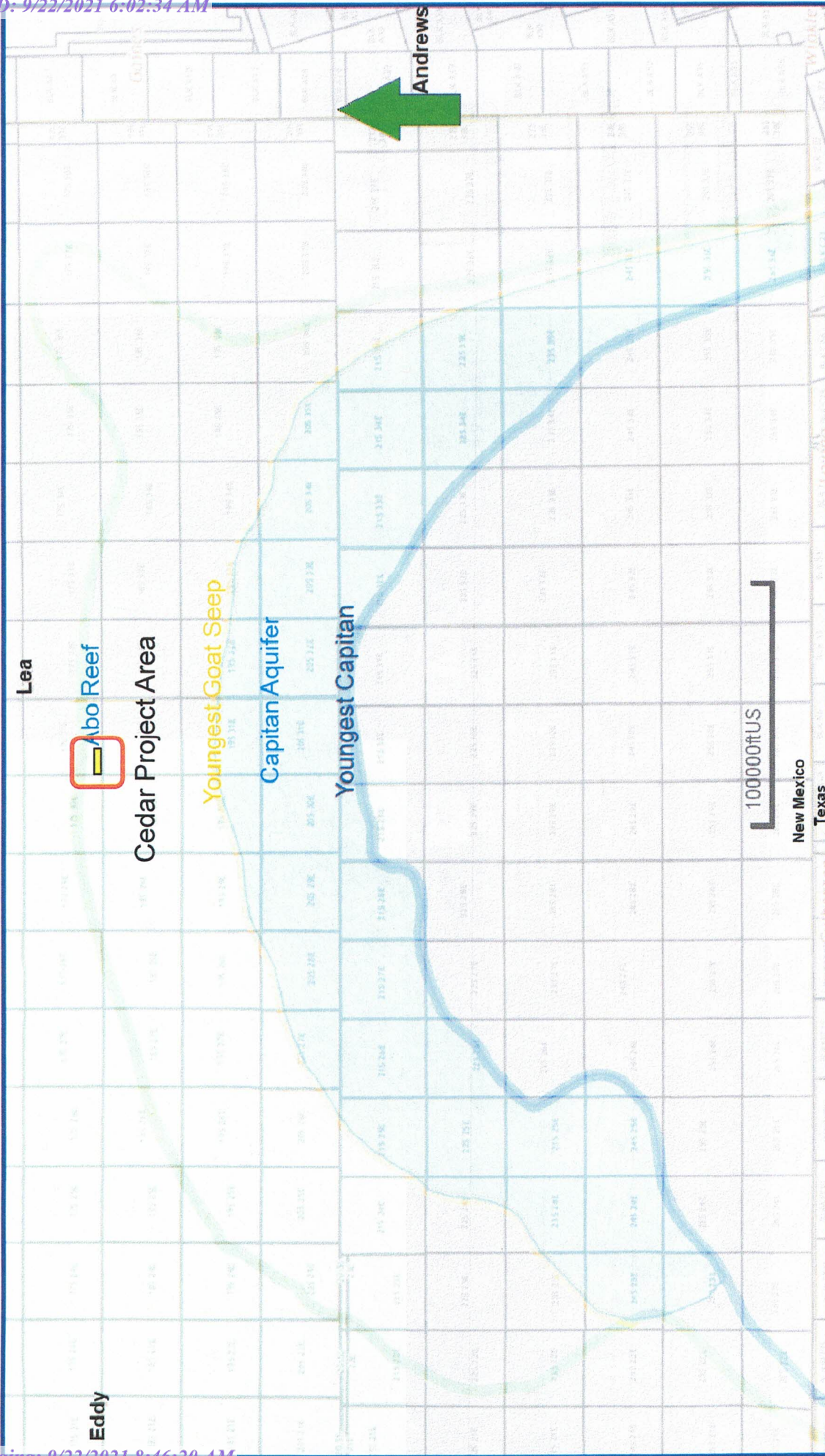

Shugart; Bone Spring, North (Pool Code 56405) Structure Map (Second Bone Spring Sand Subsea) A – A' Reference Line

Exhibit D-2

Map Legend

- Cedar Wells** (represented by a blue line)
- Bone Spring Wells** (represented by an orange line)
- Project Areas** (represented by a yellow rectangle)

C. I. = 50'

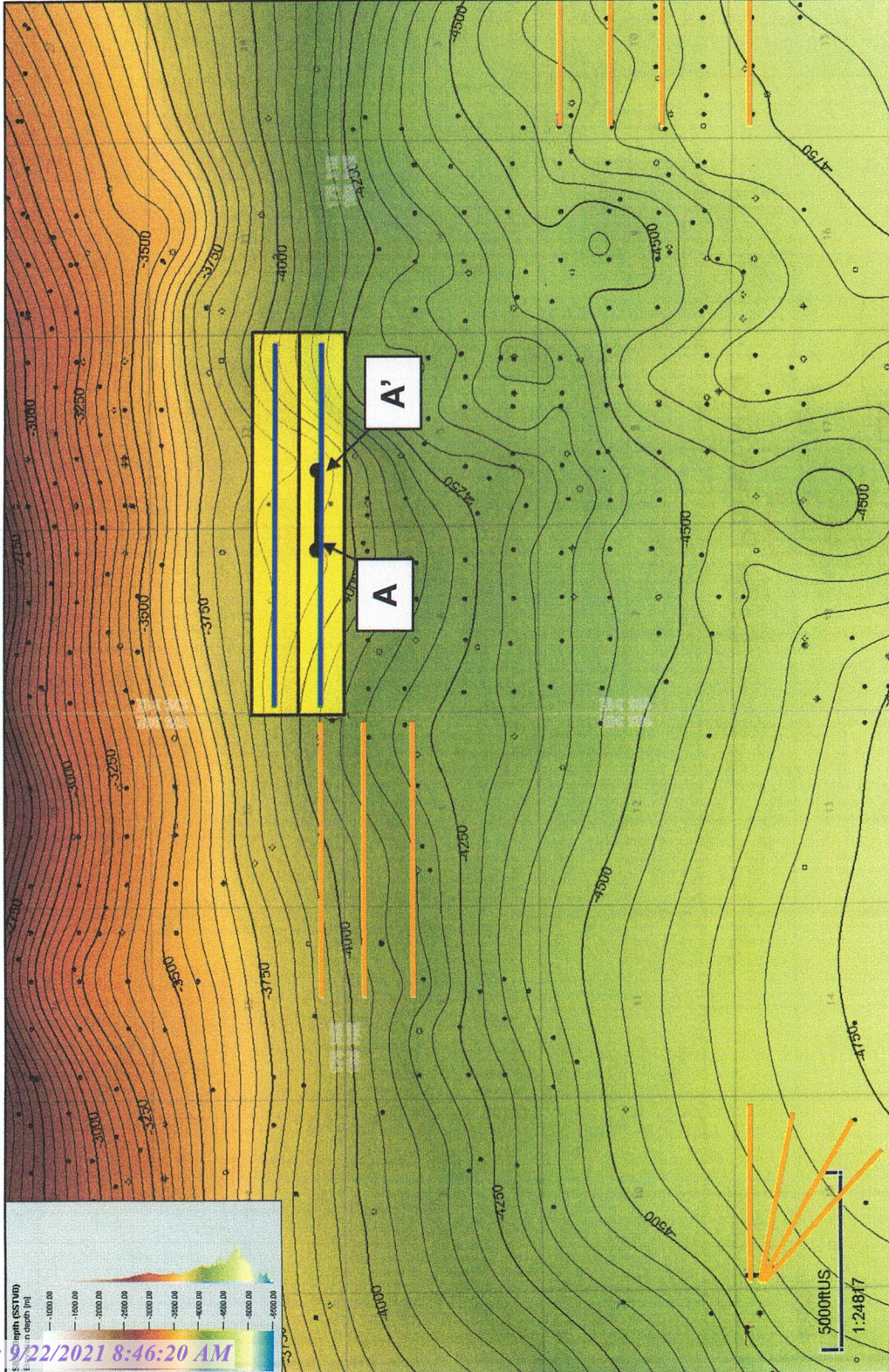

Shugart; Bone Spring, North (Pool Code 56405) Structural Cross-Section A - A'

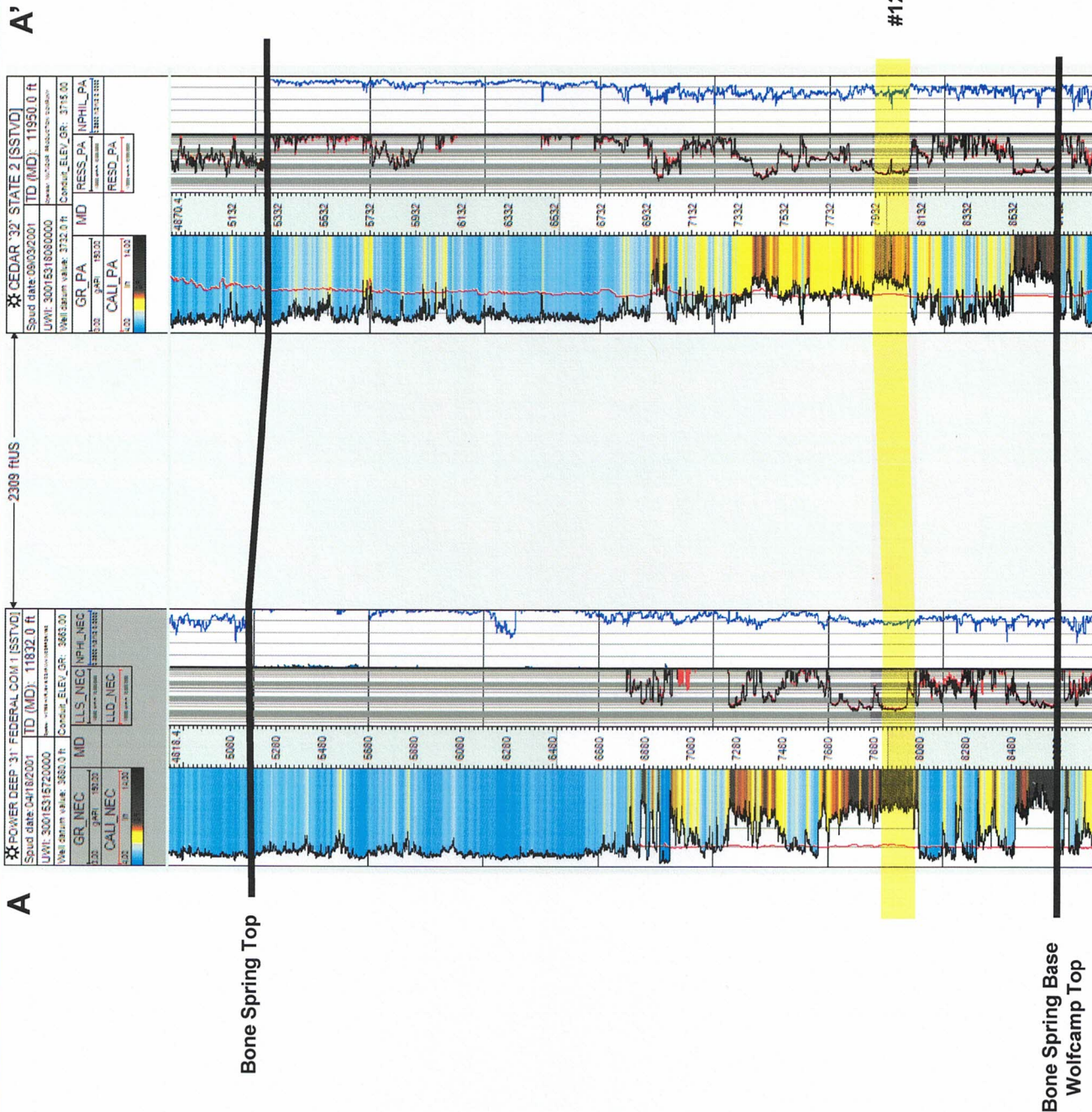

STATE OF NEW MEXICO
ENERGY, MINERALS AND NATURAL RESOURCES DEPARTMENT
OIL CONSERVATION DIVISION

APPLICATIONS OF MATADOR PRODUCTION
COMPANY FOR COMPULSORY POOLING, LEA
COUNTY, NEW MEXICO.

Case Nos. 21991 - 21992

SELF-AFFIRMED STATEMENT OF NOTICE

COUNTY OF SANTA FE)
) ss.
STATE OF NEW MEXICO)

James Bruce deposes and states:

1. I am over the age of 18, and have personal knowledge of the matters stated herein.
2. I am an attorney for Matador Production Company.
3. Matador Production Company has conducted a good faith, diligent effort to find the names and correct addresses of the interest owners entitled to receive notice of the applications filed herein.
4. Notice of the applications was provided to the interest owners, at their last known addresses, by certified mail. Copies of the notice letter and certified return receipts are attached hereto as Attachment A.
5. Matador Production has complied with the notice provisions of Division Rules.
6. I understand that this Self-Affirmed Statement will be used as written testimony in this case. I affirm that my testimony in paragraphs 1 through 5 above is true and correct and is made under penalty of perjury under the laws of the State of New Mexico. My testimony is made as of the date handwritten next to my signature below.

Date: 9/21/21

James Bruce
James Bruce

EXHIBIT **E**

JAMES BRUCE
ATTORNEY AT LAW

POST OFFICE BOX 1056
SANTA FE, NEW MEXICO 87504

369 MONTEZUMA, NO. 213
SANTA FE, NEW MEXICO 87501

(505) 982-2043 (Phone)
(505) 660-6612 (Cell)
(505) 982-2151 (Fax)

jamesbruc@aol.com

July 30, 2021

CERTIFIED MAIL – RETURN RECEIPT REQUESTED

To: Persons on Exhibit A

Ladies and gentlemen:

Enclosed are copies of the following applications for compulsory pooling, filed with the New Mexico Oil Conservation Division by Matador Production Company, seeking orders pooling all mineral interest owners in the Bone Spring formation underlying the following well units:

- (a) the N/2S/2 of Section 32 and N/2S/2 of Section 31, Township 17 South, Range 31 East, NMPM. The unit will be dedicated to the Cedar 3231 Fed. Com. Well No. 123H. (Case No. 21991); and
- (b) the S/2S/2 of Section 32 and S/2S/2 of Section 31, Township 17 South, Range 31 East, NMPM. The unit will be dedicated to the Cedar 3231 Fed. Com. Well No. 124H (Case No. 21992).

The lands are located in Eddy County, New Mexico.

This matter is scheduled for hearing at 8:15 a.m. on Thursday, August 19, 2021. During the COVID-19 Public Health Emergency, state buildings are closed to the public and the hearing will be conducted remotely. To determine the location of the hearing or to participate in an electronic hearing, go to emnrd.state.nm.us/OCD/hearings or see the instructions posted on the Division’s website, <http://emnrd.state.nm.us/OCD/announcements.html>. You are not required to attend this hearing, but as an owner of an interest who may be affected by the applications, you may appear and present testimony. Failure to appear at that time and become a party of record will preclude you from contesting these matters at a later date.

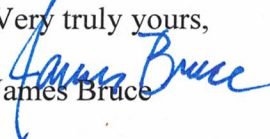
Very truly yours,

James Bruce

Attorney for Matador Production Company

ATTACHMENT **A**

Cedar 3231 Fed Com 123H and 124H (APO)

EOG Resources, Inc.
Midland Division-Land Department
P.O. Box 2267
Midland, TX 79702

Oxy USA WTP Limited Partnership
P.O. Box 27570
Houston, TX 77227-9930

Yates-US Inc.
P.O. Box 2323
Roswell, NM 88202

Yates Energy Corporation
P.O. Box 2323
Roswell, NM 88202

PetroYates, Inc.
P.O. Box 1608
Albuquerque, NM 87103-1608

Rejar LLC
c/o Jimmie R. Parker, Jr.
1903 Ward Street
Midland, TX 79705

Harry B. Hinkle
P.O. Box 60010
Midland, TX 79711

Nadel and Gussman Capitan LLC
15 East 5th Street, Suite 3200
Tulsa, OK 74103

Finley Production Co. LP
1308 Lake Street
Fort Worth, TX 76102

Sally Jo Roberts (a/k/a Sally Meador-Roberts)
1806 Hughes Street
Midland, TX 79705

EXHIBIT

A

Colkelan Corporation
906 S. St. Francis Dr., Suite C
Santa Fe, NM 87505

Grasslands Energy LP
5128 Apache Plume Rd., Suite 300
Fort Worth, TX 76109-1506

Burlington Resources Oil & Gas Company, LP
P.O. Box 51810
Midland, TX 79710

Yates Energy Royalty Interests LLC
P.O. Box 2323
Roswell, NM 88202

Pearson-Sibert Oil Co. of Texas
504 Vaughn Building
Midland, TX

A.F. Gilmore Company
160 S. Fairfax Avenue
Los Angeles, CA 90036

Janet Barr Fitting, Trustee of the Robert D. Fitting Trust
One Warwick Place
Midland, TX 79705

E.B. Hall
P.O. Box 6963
Albuquerque, NM 87197

Fort Worth Royalty Company
500 Throckmorton St., Suite 1104
Fort Worth, TX 76102-3709

Gregg Alan Groves, Trustee of the Groves Family Trust
3404 Woodhaven
Midland, TX 79707

Rodney O. Thompson
16714 NE 107th Street
Redmond, WA 98052

SENDER: COMPLETE THIS SECTION

Complete items 1, 2, and 3.

Print your name and address on the reverse so that we can return the card to you. Attach this card to the back of the mailpiece, or on the front if space permits.

Article Addressed to:

E.B. Hall
P.O. Box 6963
Albuquerque, NM 87197

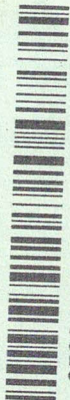

9590 9402 5941 0062 9209 65

2. Article Addressed to (Transfer from service label)

7020 2450 0002 1364 3886

PS Form 3811, July 2015 PSN 7530-02-000-9053

Domestic Return Receipt

MF-C

COMPLETE THIS SECTION ON DELIVERY

A. Signature

Agent
 Addressee

B. Received by (Printed Name)

Edward Hall

C. Date of Delivery
D. Is delivery address different from item 1? Yes No
If YES, enter delivery address below:

- 3. Service Type
 - Priority Mail Express®
 - Registered Mail™
 - Adult Signature Restricted Delivery
 - Certified Mail®
 - Certified Mail Restricted Delivery
 - Return Receipt for Merchandise
 - Collect on Delivery
 - Signature Confirmation™
 - Signature Confirmation Restricted Delivery

U.S. Postal Service™ CERTIFIED MAIL® RECEIPT
Domestic Mail Only

For delivery information, visit our website at www.usps.com®.

OFFICIAL USE

Certified Mail Fee

Extra Services & Fees (check box, add fee as appropriate)

- Return Receipt (hardcopy) \$
- Return Receipt (electronic) \$
- Certified Mail Restricted Delivery \$
- Adult Signature Required \$
- Adult Signature Restricted Delivery \$

Postage

Total Postage and Fees

Sent To PetroYates, Inc.
P.O. Box 1608
Albuquerque, NM 87103-1608

Street and Apt. No., or PO Box

City, State, ZIP+4®

See Reverse for Instructions

PS Form 3800, April 2015 PSN 7530-02-000-9047

SENDER: COMPLETE THIS SECTION

- 1. Article Addressed to:
 - Complete items 1, 2, and 3.
 - Print your name and address on the reverse so that we can return the card to you.
 - Attach this card to the back of the mailpiece, or on the front if space permits.

1. Article Addressed to:

PetroYates, Inc.
P.O. Box 1608
Albuquerque, NM 87103-1608

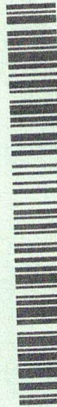

9590 9402 6769 1074 5698 26

2. Article 7020 2450 0002 1364 3856

PS Form 3811, July 2020 PSN 7530-02-000-9053

Domestic Return Receipt

MF-C

U.S. Postal Service™ CERTIFIED MAIL® RECEIPT
Domestic Mail Only

For delivery information, visit our website at www.usps.com®.

OFFICIAL USE

Certified Mail Fee

Extra Services & Fees (check box, add fee as appropriate)

- Return Receipt (hardcopy) \$
- Return Receipt (electronic) \$
- Certified Mail Restricted Delivery \$
- Adult Signature Required \$
- Adult Signature Restricted Delivery \$

Postage

Total Postage and Fees

Sent To

E.B. Hall
P.O. Box 6963
Albuquerque, NM 87197

Street and Apt. No., or PO

City, State, ZIP+4®

PS Form 3800, April 2015 PSN 7530-02-000-9047

COMPLETE THIS SECTION ON DELIVERY

A. Signature Agent Addressee

Julie APascal

B. Received by (Printed Name) C. Date of Delivery

Julie APascal 6 Aug 21

D. Is delivery address different from item 1? Yes No

If YES, enter delivery address below:

Priority Mail Express®

Registered Mail™

Adult Signature Restricted Delivery

Certified Mail®

Signature Confirmation™

Signature Confirmation Restricted Delivery

Collect on Delivery

restricted Delivery

87103

insured mail restricted Delivery

(over \$500)

Domestic Return Receipt

MF-C

426E 49E7 2000 0542 0202

SENDER: COMPLETE THIS SECTION

- Complete items 1, 2, and 3.
- Print your name and address on the reverse so that we can return the card to you.
- Attach this card to the back of the mailpiece, or on the front if space permits.

1. Article Addressed to:

Yates Energy Royalty Interests LLC
P.O. Box 2323
Roswell, NM 88202

9590 9402 5941 0062 92 10 47

2. Article Number (Transfer from *carmina label*)
7020 2450 0002 1364 3948 (over 3500)

PS Form 3811, July 2020 PSN 7530-02-000-9053

COMPLETE THIS SECTION ON DELIVERY

A. Signature Agent Addressee

B. Received by (Printed Name) C. Date of Delivery

D. Is delivery address different from item 1? Yes No
If YES, enter delivery address below:

3. Service Type
 Adult Signature
 Adult Signature Restricted Delivery
 Certified Mail®
 Certified Mail Restricted Delivery
 Collect on Delivery
 Collect on Delivery Restricted Delivery
 Priority Mail Express®
 Registered Mail™
 Registered Mail Restricted Delivery
 Return Receipt (hardcopy)
 Return Receipt (electronic)
 Certified Mail Restricted Delivery
 Adult Signature Required
 Adult Signature Restricted Delivery

Postmark Here

7020 2450 0002 1364 3948

PS Form 3811, July 2020 PSN 7530-02-000-9053

U.S. Postal Service™ CERTIFIED MAIL® RECEIPT
Domestic Mail Only

For delivery information, visit our website at www.usps.com®.

OFFICIAL USE

Certified Mail Fee \$

Extra Services & Fees (check box, add fee as appropriate)
 Return Receipt (hardcopy) \$
 Return Receipt (electronic) \$
 Certified Mail Restricted Delivery \$
 Adult Signature Required \$
 Adult Signature Restricted Delivery \$

Postmark Here

Total Postage and Fees \$

Sent To Grasslands Energy LP
5128 Apache Plume Rd., Suite 300
Fort Worth, TX 76109-1506

Street and Apt. No., or City, State, Zip+4®

PS Form 3800, April 2015 PSN 7530-02-000-9047 See Reverse for Instructions

U.S. Postal Service™ CERTIFIED MAIL® RECEIPT
Domestic Mail Only

For delivery information, visit our website at www.usps.com®.

OFFICIAL USE

Certified Mail Fee \$

Extra Services & Fees (check box, add fee as appropriate)
 Return Receipt (hardcopy) \$
 Return Receipt (electronic) \$
 Certified Mail Restricted Delivery \$
 Adult Signature Required \$
 Adult Signature Restricted Delivery \$

Postmark Here

Total Postage and Fees \$

Sent To Yates Energy Royalty Interests LLC
P.O. Box 2323
Roswell, NM 88202

Street and Apt. No., or PO Box No. City, State, Zip+4®

PS Form 3800, April 2015 PSN 7530-02-000-9047 See Reverse for Instructions

426E 49E7 2000 0542 0202

SENDER: COMPLETE THIS SECTION

- Complete items 1, 2, and 3.
- Print your name and address on the reverse so that we can return the card to you.
- Attach this card to the back of the mailpiece, or on the front if space permits.

1. Article Addressed to:

Grasslands Energy LP
5128 Apache Plume Rd., Suite 300
Fort Worth, TX 76109-1506

9590 9402 6769 1074 5675 18

2. Article Number (Transfer from *carmina label*)
7020 2450 0002 1364 3924

PS Form 3811, July 2020 PSN 7530-02-000-9053

COMPLETE THIS SECTION ON DELIVERY

A. Signature Agent Addressee

B. Received by (Printed Name) C. Date of Delivery

D. Is delivery address different from item 1? Yes No
If YES, enter delivery address below:

3. Service Type
 Adult Signature
 Adult Signature Restricted Delivery
 Certified Mail®
 Certified Mail Restricted Delivery
 Collect on Delivery
 Collect on Delivery Restricted Delivery
 Priority Mail Express®
 Registered Mail™
 Registered Mail Restricted Delivery
 Signature Confirmation™
 Signature Confirmation Restricted Delivery

Postmark Here

7020 2450 0002 1364 3924

PS Form 3811, July 2020 PSN 7530-02-000-9053

SENDER: COMPLETE THIS SECTION

- Complete items 1, 2, and 3.
- Print your name and address on the reverse so that we can return the card to you.
- Attach this card to the back of the mailpiece, or on the front if space permits.

1. Article Addressed to:

Yates-US Inc.
P.O. Box 2323
Roswell, NM 88202



9590 9402 6769 1074 5698 40

2. Article Number (Transfer from service label)

7020 2450 0002 1364 3832

PS Form 3811, July 2020 PSN 7530-02-000-9053

Domestic Return Receipt

COMPLETE THIS SECTION ON DELIVERY

- A. Signature Agent Addressee
- B. Received by (Printed Name) Shanika C. Date of Delivery 8-21
- D. Is delivery address different from item 1? Yes No
If YES, enter delivery address below:

3. Service Type
- Priority Mail Express®
 - Registered Mail™
 - Adult Signature Restricted Delivery
 - Certified Mail®
 - Certified Mail Restricted Delivery
 - Signature Confirmation™
 - Signature Confirmation Restricted Delivery
 - Collect on Delivery
 - Insured Mail

MY-C

U.S. Postal Service™ CERTIFIED MAIL® RECEIPT Domestic Mail Only

For delivery information, visit our website at www.usps.com®.

OFFICIAL USE

Certified Mail Fee

- Extra Services & Fees (check box, add fee as appropriate)
- Return Receipt (hardcopy) \$
 - Return Receipt (electronic) \$
 - Certified Mail Restricted Delivery \$
 - Adult Signature Required \$
 - Adult Signature Restricted Delivery \$
- Postage \$

Postmark Here

Total Postage and Fees

EOG Resources, Inc.
Midland Division-Land Department
P.O. Box 2267
Midland, TX 79702

Sent To

Street and Apt. No., or PO Box No.

City, State, ZIP+4®

PS Form 3800, April 2015 PSN 7530-02-000-9047

See Reverse for Instructions

U.S. Postal Service™ CERTIFIED MAIL® RECEIPT Domestic Mail Only

For delivery information, visit our website at www.usps.com®.

OFFICIAL USE

Certified Mail Fee

- Extra Services & Fees (check box, add fee as appropriate)
- Return Receipt (hardcopy) \$
 - Return Receipt (electronic) \$
 - Certified Mail Restricted Delivery \$
 - Adult Signature Required \$
 - Adult Signature Restricted Delivery \$
- Postage \$

Postmark Here

Total Postage and Fees

Yates-US Inc.
P.O. Box 2323
Roswell, NM 88202

Sent To

Street and Apt. No., or PO Box No.

City, State, ZIP+4®

PS Form 3800, April 2015 PSN 7530-02-000-9047

See Reverse for Instructions

SENDER: COMPLETE THIS SECTION

- Complete items 1, 2, and 3.
- Print your name and address on the reverse so that we can return the card to you.
- Attach this card to the back of the mailpiece, or on the front if space permits.

1. Article Addressed to:

EOG Resources, Inc.
Midland Division-Land Department
P.O. Box 2267
Midland, TX 79702



9590 9402 6769 1074 5698 64

2. Article Number (Transfer from service label)

7020 2450 0002 1364 3818

PS Form 3811, July 2020 PSN 7530-02-000-9053

Domestic Return Receipt

COMPLETE THIS SECTION ON DELIVERY

- A. Signature Agent Addressee
- B. Received by (Printed Name) Shanika C. Date of Delivery 8-21
- D. Is delivery address different from item 1? Yes No
If YES, enter delivery address below:

3. Service Type
- Priority Mail Express®
 - Registered Mail™
 - Adult Signature Restricted Delivery
 - Certified Mail®
 - Certified Mail Restricted Delivery
 - Signature Confirmation™
 - Signature Confirmation Restricted Delivery
 - Collect on Delivery
 - Collect on Delivery Restricted Delivery

restricted Delivery

MY-C

**U.S. Postal Service™
CERTIFIED MAIL® RECEIPT**
Domestic Mail Only

For delivery information, visit our website at www.usps.com®.

OFFICIAL USE

Certified Mail Fee \$ _____

Extra Services & Fees (check box, add fee as appropriate)

Return Receipt (hardcopy) \$ _____

Return Receipt (electronic) \$ _____

Certified Mail Restricted Delivery \$ _____

Adult Signature Required \$ _____

Adult Signature Restricted Delivery \$ _____

Postage \$ _____

Total Postage and Fees \$ _____

Yates Energy Corporation
P.O. Box 2323
Roswell, NM 88202

Sent To _____

Street and Apt. No., or PO Box No. _____

City, State, ZIP+4® _____

PS Form 3800, April 2015 PSN 7530-02-000-9047 See Reverse for Instructions

SENDER: COMPLETE THIS SECTION

1. Article Addressed to:

Complete items 1, 2, and 3.

Print your name and address on the reverse so that we can return the card to you.

Attach this card to the back of the mailpiece, or on the front if space permits.

1. Article Addressed to:

Nadel and Gussman Captain LLC
15 East 5th Street, Suite 3200
Tulsa, OK 74103

7020 2450 0002 1364 3887 (over \$500)

PS Form 3811, July 2020 PSN 7530-02-000-9053

COMPLETE THIS SECTION ON DELIVERY

A. Signature B.B.B. B-19 319 Agent Addressee

B. Received by (Printed Name) _____ C. Date of Delivery 8/11/21

D. Is delivery address different from item 1? Yes No
If YES, enter delivery address below:

3. Service Type

Adult Signature Registered Mail™ Priority Mail Express®

Adult Signature Restricted Delivery Registered Mail Restricted Delivery

Certified Mail® Signature Confirmation™

Collect on Delivery Restricted Delivery

Restricted Delivery _____

Domestic Return Receipt

SENDER: COMPLETE THIS SECTION

1. Article Addressed to:

Complete items 1, 2, and 3.

Print your name and address on the reverse so that we can return the card to you.

Attach this card to the back of the mailpiece, or on the front if space permits.

1. Article Addressed to:

Nadel and Gussman Captain LLC
15 East 5th Street, Suite 3200
Tulsa, OK 74103

7020 2450 0002 1364 3887 (over \$500)

PS Form 3811, July 2020 PSN 7530-02-000-9053

COMPLETE THIS SECTION ON DELIVERY

A. Signature B.B.B. B-19 319 Agent Addressee

B. Received by (Printed Name) _____ C. Date of Delivery 8/11/21

D. Is delivery address different from item 1? Yes No
If YES, enter delivery address below:

3. Service Type

Adult Signature Registered Mail™ Priority Mail Express®

Adult Signature Restricted Delivery Registered Mail Restricted Delivery

Certified Mail® Signature Confirmation™

Collect on Delivery Restricted Delivery

Restricted Delivery _____

Domestic Return Receipt

**U.S. Postal Service™
CERTIFIED MAIL® RECEIPT**
Domestic Mail Only

For delivery information, visit our website at www.usps.com®.

OFFICIAL USE

Certified Mail Fee \$ _____

Extra Services & Fees (check box, add fee as appropriate)

Return Receipt (hardcopy) \$ _____

Return Receipt (electronic) \$ _____

Certified Mail Restricted Delivery \$ _____

Adult Signature Required \$ _____

Adult Signature Restricted Delivery \$ _____

Postage \$ _____

Total Postage and Fees \$ _____

Nadel and Gussman Captain LLC
15 East 5th Street, Suite 3200
Tulsa, OK 74103

Street and Apt. No., or PO Box No. _____

City, State, ZIP+4® _____

PS Form 3800, April 2015 PSN 7530-02-000-9047 See Reverse for Instructions

SENDER: COMPLETE THIS SECTION

1. Article Addressed to:

Complete items 1, 2, and 3.

Print your name and address on the reverse so that we can return the card to you.

Attach this card to the back of the mailpiece, or on the front if space permits.

1. Article Addressed to:

Yates Energy Corporation
P.O. Box 2323
Roswell, NM 88202

7020 2450 0002 1364 3849 (over \$500)

PS Form 3811, July 2020 PSN 7530-02-000-9053

COMPLETE THIS SECTION ON DELIVERY

A. Signature B.B.B. B-19 319 Agent Addressee

B. Received by (Printed Name) _____ C. Date of Delivery 8/11/21

D. Is delivery address different from item 1? Yes No
If YES, enter delivery address below:

3. Service Type

Adult Signature Registered Mail™ Priority Mail Express®

Adult Signature Restricted Delivery Registered Mail Restricted Delivery

Certified Mail® Signature Confirmation™

Collect on Delivery Restricted Delivery

Restricted Delivery _____

Domestic Return Receipt

**U.S. Postal Service™
CERTIFIED MAIL® RECEIPT**
Domestic Mail Only

For delivery information, visit our website at www.usps.com®.

OFFICIAL USE

Certified Mail Fee \$ _____

Extra Services & Fees (check box, add fee as appropriate)

Return Receipt (hardcopy) \$ _____

Return Receipt (electronic) \$ _____

Certified Mail Restricted Delivery \$ _____

Adult Signature Required \$ _____

Adult Signature Restricted Delivery \$ _____

Postage \$ _____

Total Postage and Fees \$ _____

Yates Energy Corporation
P.O. Box 2323
Roswell, NM 88202

Sent To _____

Street and Apt. No., or PO Box No. _____

City, State, ZIP+4® _____

PS Form 3800, April 2015 PSN 7530-02-000-9047 See Reverse for Instructions

**U.S. Postal Service™
CERTIFIED MAIL® RECEIPT**
Domestic Mail Only

For delivery information, visit our website at www.usps.com®.

OFFICIAL USE

Certified Mail Fee \$ _____

Extra Services & Fees (check box, add fee as appropriate)

Return Receipt (hardcopy) \$ _____

Return Receipt (electronic) \$ _____

Certified Mail Restricted Delivery \$ _____

Adult Signature Required \$ _____

Adult Signature Restricted Delivery \$ _____

Postage \$ _____

Postmark Here _____

Total Postage and Fees \$ _____

Sent To _____

Oxy USA WTP Limited Partnership
P.O. Box 27570
Houston, TX 77227-9930

Street and Apt. No., or P.O. No. _____

City, State, ZIP+4® _____

PS Form 3800, April 2015 PSN 7530-02-000-9047 See Reverse for Instructions

529E 49ET 2000 0542 020L

SENDER: COMPLETE THIS SECTION

Complete items 1, 2, and 3.

Print your name and address on the reverse so that we can return the card to you.

Attach this card to the back of the mailpiece, or on the front if space permits.

1. Article Addressed to:

Rejar LLC
c/o Jimmie R. Parker, Jr.
1903 Ward Street
Midland, TX 79705

9590 9402 6769 1074 5697 72

7020 2450 0002 1364 3863 (over \$500)

PS Form 3811, July 2020 PSN 7530-02-000-9053

Domestic Return Receipt

COMPLETE THIS SECTION ON DELIVERY

A. Signature Agent

B. Received by (Printed Name) _____ C. Date of Delivery _____

Delivery address different from item 1? Yes No

If YES, enter delivery address below:

3. Service Type

Adult Signature Priority Mail Express®

Adult Signature Restricted Delivery Registered Mail™

Certified Mail® Certified Mail Restricted Delivery

Collect on Delivery Signature Confirmation™

Every Restricted Delivery Signature Confirmation Restricted Delivery

Restricted Delivery

MF-C

**U.S. Postal Service™
CERTIFIED MAIL® RECEIPT**
Domestic Mail Only

For delivery information, visit our website at www.usps.com®.

OFFICIAL USE

Certified Mail Fee \$ _____

Extra Services & Fees (check box, add fee as appropriate)

Return Receipt (hardcopy) \$ _____

Return Receipt (electronic) \$ _____

Certified Mail Restricted Delivery \$ _____

Adult Signature Required \$ _____

Adult Signature Restricted Delivery \$ _____

Postage \$ _____

Postmark Here _____

Total Postage and Fees \$ _____

Sent To _____

Oxy USA WTP Limited Partnership
P.O. Box 27570
Houston, TX 77227-9930

Street and Apt. No., or P.O. No. _____

City, State, ZIP+4® _____

PS Form 3800, April 2015 PSN 7530-02-000-9047 See Reverse for Instructions

SENDER: COMPLETE THIS SECTION

Complete items 1, 2, and 3.

Print your name and address on the reverse so that we can return the card to you.

Attach this card to the back of the mailpiece, or on the front if space permits.

1. Article Addressed to:

Oxy USA WTP Limited Partnership
P.O. Box 27570
Houston, TX 77227-9930

9590 9402 6769 1074 5698 57

7020 2450 0002 1364 3825 (over \$500)

PS Form 3811, July 2020 PSN 7530-02-000-9053

Domestic Return Receipt

COMPLETE THIS SECTION ON DELIVERY

A. Signature Agent

B. Received by (Printed Name) _____ C. Date of Delivery _____

Delivery address different from item 1? Yes No

If YES, enter delivery address below:

3. Service Type

Adult Signature Priority Mail Express®

Adult Signature Restricted Delivery Registered Mail™

Certified Mail® Certified Mail Restricted Delivery

Collect on Delivery Signature Confirmation™

Every Restricted Delivery Signature Confirmation Restricted Delivery

Restricted Delivery

MF-C

529E 49ET 2000 0542 020L

SENDER: COMPLETE THIS SECTION

- Complete items 1, 2, and 3.
- Print your name and address on the reverse so that we can return the card to you.
- Attach this card to the back of the mailpiece, or on the front if space permits.

1. Article Addressed to:

Rodney O. Thompson
16714 NE 107th Street
Redmond, WA 98052

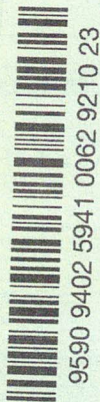

2. Article # 7020 2450 0002 1364 4013
(over \$500) MT-C

PS Form 3811, July 2015 PSN 7530-02-000-9053

Domestic Return Receipt

3. Service Type
- Adult Signature
 - Adult Signature Restricted Delivery
 - Certified Mail®
 - Certified Mail Restricted Delivery
 - Collect on Delivery
 - Priority Mail Express®
 - Registered Mail™
 - Registered Mail Restricted Delivery
 - Return Receipt for Merchandise
 - Signature Confirmation™
 - Signature Confirmation Restricted Delivery

COMPLETE THIS SECTION ON DELIVERY

- A. Signature C-19 Agent Addressee
- B. Received by (Printed Name) _____ C. Date of Delivery _____

D. Is delivery address different from item 1? Yes No
If YES, enter delivery address below:

U.S. Postal Service™
CERTIFIED MAIL® RECEIPT
Domestic Mail Only

For delivery information, visit our website at www.usps.com®.

OFFICIAL USE

Certified Mail Fee

Extra Services & Fees (check box, add fee as appropriate)

- Return Receipt (hardcopy) \$
- Return Receipt (electronic) \$
- Certified Mail Restricted Delivery \$
- Adult Signature Required \$
- Adult Signature Restricted Delivery \$

Postage \$

Total Postage and Fees \$

Sent To Gregg Alan Groves, Trustee of the Groves Family Trust
3404 Woodhaven
Midland, TX 79707

Street and Apt. No.,
City, State, Zip+4®

PS Form 3800, April 2015 PSN 7530-02-000-9047

See Reverse for Instructions

Postmark
Here

9004 4967 2000 0502 0202

U.S. Postal Service™
CERTIFIED MAIL® RECEIPT
Domestic Mail Only

For delivery information, visit our website at www.usps.com®.

OFFICIAL USE

Certified Mail Fee

Extra Services & Fees (check box, add fee as appropriate)

- Return Receipt (hardcopy) \$
- Return Receipt (electronic) \$
- Certified Mail Restricted Delivery \$
- Adult Signature Required \$
- Adult Signature Restricted Delivery \$

Postage \$

Total Postage and Fees \$

Rodney O. Thompson
16714 NE 107th Street
Redmond, WA 98052

Sent To _____

Street and Apt. No., or P.O. Box _____

City, State, Zip+4® _____

PS Form 3800, April 2015 PSN 7530-02-000-9047

See Reverse for Instructions

Gregg Alan Groves, Trustee of the Groves Family Trust
3404 Woodhaven
Midland, TX 79707



2. Article #

7020 2450 0002 1364 4006
(over \$500)

PS Form 3811, July 2015 PSN 7530-02-000-9053

Domestic Return Receipt

SENDER: COMPLETE THIS SECTION

- Complete items 1, 2, and 3.
- Print your name and address on the reverse so that we can return the card to you.
- Attach this card to the back of the mailpiece, or on the front if space permits.

1. Article Addressed to:

COMPLETE THIS SECTION ON DELIVERY

- A. Signature Agent Addressee
- B. Received by (Printed Name) _____ C. Date of Delivery _____

D. Is delivery address different from item 1? Yes No
If YES, enter delivery address below:

3. Service Type
- Priority Mail Express®
 - Registered Mail™
 - Adult Signature Restricted Delivery
 - Certified Mail®
 - Certified Mail Restricted Delivery
 - Collect on Delivery
 - Priority Mail Express®
 - Registered Mail™
 - Registered Mail Restricted Delivery
 - Return Receipt for Merchandise
 - Signature Confirmation™
 - Signature Confirmation Restricted Delivery

(over \$500)

Domestic Return Receipt

9004 4967 2000 0502 0202

**U.S. Postal Service™
CERTIFIED MAIL® RECEIPT
Domestic Mail Only**

For delivery information, visit our website at www.usps.com

OFFICIAL USE

Certified Mail Fee \$ _____

Extra Services & Fees (check box, add fee as appropriate)

Return Receipt (hardcopy) \$ _____

Return Receipt (electronic) \$ _____

Certified Mail Restricted Delivery \$ _____

Adult Signature Required \$ _____

Adult Signature Restricted Delivery \$ _____

Postage \$ _____

Total Postage and Fees \$ _____

Sent To Finley Production Co. LP
1308 Lake Street
Fort Worth, TX 76102

Street and Apt. No., or PO Box No. _____

City, State, ZIP+4® _____

PS Form 3800, April 2015 PSN 7530-02-000-9047 See Reverse for Instructions

569E 49E7 2000 0542 0202

COMPLETE THIS SECTION ON DELIVERY

A. Signature Agent* Addressee

X B. Received by (Printed Name) _____ C. Date of Delivery _____

D. Is delivery address different from item 1? Yes No
If YES, enter delivery address below: _____

3. Service Type

Priority Mail Express®

Registered Mail™

Adult Signature Restricted Delivery

Certified Mail®

Certified Mail Restricted Delivery

Signature Confirmation™

Collect on Delivery

Collect on Delivery Restricted Delivery

Priority Mail Express®
Registered Mail™
Adult Signature Restricted Delivery
Signature Confirmation™
Signature Confirmation Restricted Delivery

Domestic Return Receipt

COMPLETE THIS SECTION ON DELIVERY

1. Article Addressed to:

Finley Production Co. LP
1308 Lake Street
Fort Worth, TX 76102

2. Article Addressed to:

7020 2450 0002 1364 3894

PS Form 3811, July 2020 PSN 7530-02-000-9053

SENDER: COMPLETE THIS SECTION

1. Article Addressed to:

Complete items 1, 2, and 3.

Print your name and address on the reverse so that we can return the card to you.

Attach this card to the back of the mailpiece, or on the front if space permits.

A. Signature Agent Addressee

X B. Received by (Printed Name) _____ C. Date of Delivery _____

D. Is delivery address different from item 1? Yes No
If YES, enter delivery address below: _____

3. Service Type

Priority Mail Express®

Registered Mail™

Adult Signature Restricted Delivery

Certified Mail®

Certified Mail Restricted Delivery

Return Receipt for Merchandise

Signature Confirmation™

Signature Confirmation Restricted Delivery

Collect on Delivery Restricted Delivery Restricted Delivery

Insured Mail Restricted Delivery (over \$500)

PS Form 3811, July 2015 PSN 7530-02-000-9053

296E 49E7 2000 0542 0202

**U.S. Postal Service™
CERTIFIED MAIL® RECEIPT
Domestic Mail Only**

For delivery information, visit our website at www.usps.com

OFFICIAL USE

Certified Mail Fee \$ _____

Extra Services & Fees (check box, add fee as appropriate)

Return Receipt (hardcopy) \$ _____

Return Receipt (electronic) \$ _____

Certified Mail Restricted Delivery \$ _____

Adult Signature Required \$ _____

Adult Signature Restricted Delivery \$ _____

Postage \$ _____

Total Postage and Fees \$ _____

Sent To A.F. Gilmore Company
160 S. Fairfax Avenue
Los Angeles, CA 90036

Street and Apt. No., or _____

City, State, ZIP+4® _____

PS Form 3800, April 2015 PSN 7530-02-000-9047 See Reverse for Instructions



CS

Janet Barr Fitting, Trustee of the Robert D. Fitting Trust
One Warwick Place
Midland, TX 79705

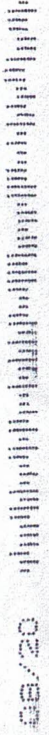

01009 6-8

Handwritten initials

Harry B. Hinkle
P.O. Box 60010
Midland, TX 79711

8-9
8-24
RETURNED

CERTIFIED MAIL

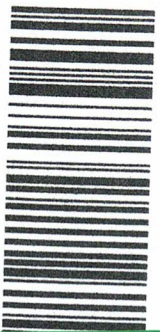

450 0002 1364 3979

Handwritten address and markings

CERTIFIED MAIL

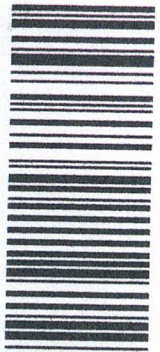

2450 0002 1364 3870

UT 87504>105

U.S. Postal Service™
CERTIFIED MAIL® RECEIPT
Domestic Mail Only

For delivery information, visit our website at www.usps.com®.

OFFICIAL USE

Certified Mail Fee	\$
Extra Services & Fees (check box, add fee as appropriate)	
<input type="checkbox"/> Return Receipt (hardcopy)	\$
<input type="checkbox"/> Return Receipt (electronic)	\$
<input type="checkbox"/> Certified Mail Restricted Delivery	\$
<input type="checkbox"/> Adult Signature Required	\$
<input type="checkbox"/> Adult Signature Restricted Delivery	\$
Postage	\$
Total Postage and Fees	\$

Postmark Here

Sent To Janet Barr Fitting, Trustee of the Robert D. Fitting Trust
One Warwick Place
Midland, TX 79705

Street and Apt. No., or P.O. Box

City, State, ZIP+4®

U.S. Postal Service™
CERTIFIED MAIL® RECEIPT
Domestic Mail Only

For delivery information, visit our website at www.usps.com®.

OFFICIAL USE

Certified Mail Fee	\$
Extra Services & Fees (check box, add fee as appropriate)	
<input type="checkbox"/> Return Receipt (hardcopy)	\$
<input type="checkbox"/> Return Receipt (electronic)	\$
<input type="checkbox"/> Certified Mail Restricted Delivery	\$
<input type="checkbox"/> Adult Signature Required	\$
<input type="checkbox"/> Adult Signature Restricted Delivery	\$
Postage	\$
Total Postage and Fees	\$
Sent To	Harry B. Hinkle P.O. Box 60010 Midland, TX 79711
Street and Apt. No., or P.O. Box	
City, State, ZIP+4®	

Postmark Here

S77081.61

\$0.71⁰
US POSTAGE
FIRST-CLASS
062S13292292
87501
000129722



Burlington Resources Oil & Gas Company, LP
P.O. Box 51810
Midland, TX 79710

CFJ

S77081.48

\$0.71⁰
US POSTAGE
FIRST-CLASS
062S13292292
87501
000129735



Pearson-Sibert Oil Co. of Texas
504 Vaughn Building
Midland, TX

Handwritten signature



0002 1364 3931

NOT DELIVERABLE
AS ADDRESSED,
UNABLE TO FORWARD

IA UTF
675047105

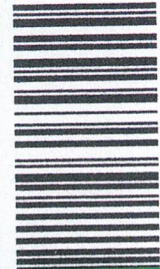

0002 1364 3955

UTF
57019989504>1056

U.S. Postal ServiceTM
CERTIFIED MAIL[®] RECEIPT
Domestic Mail Only

For delivery information, visit our website at www.usps.com[®]

OFFICIAL USE

Certified Mail Fee \$

Extra Services & Fees (check box, add fee as appropriate)

<input type="checkbox"/> Return Receipt (hardcopy)	\$
<input type="checkbox"/> Return Receipt (electronic)	\$
<input type="checkbox"/> Certified Mail Restricted Delivery	\$
<input type="checkbox"/> Adult Signature Required	\$
<input type="checkbox"/> Adult Signature Restricted Delivery	\$

Postage \$

Total Postage and Fees \$

Sent To Burlington Resources Oil & Gas Company, LP
P.O. Box 51810
Midland, TX 79710

Street and Apt. No., or PO Box No. _____

City, State, ZIP+4[®] _____

U.S. Postal ServiceTM
CERTIFIED MAIL[®] RECEIPT
Domestic Mail Only

For delivery information, visit our website at www.usps.com[®]

OFFICIAL USE

Certified Mail Fee \$

Extra Services & Fees (check box, add fee as appropriate)

<input type="checkbox"/> Return Receipt (hardcopy)	\$
<input type="checkbox"/> Return Receipt (electronic)	\$
<input type="checkbox"/> Certified Mail Restricted Delivery	\$
<input type="checkbox"/> Adult Signature Required	\$
<input type="checkbox"/> Adult Signature Restricted Delivery	\$

Postage \$

Total Postage and Fees \$

Sent To Pearson-Sibert Oil Co. of Texas
504 Vaughn Building
Midland, TX

Street and Apt. No., or PO _____

City, State, ZIP+4[®] _____



Colkelan Corporation
906 S. St. Francis Dr., Suite C
Santa Fe, NM 87505



Sally Jo Roberts (a/k/a Sally Meador-Roberts)
1806 Hughes Street
Midland, TX 79705

ERTIFIED MAIL®

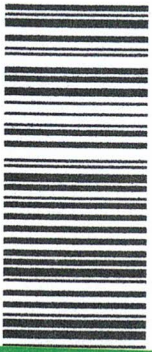

2450 0002 1364 3917

ANK
875044105

ERTIFIED MAIL®

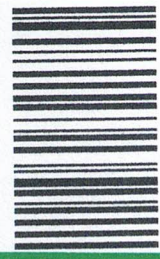

0002 1364 3900

Handwritten initials/signature.

U.S. Postal Service™
CERTIFIED MAIL® RECEIPT
Domestic Mail Only

For delivery information, visit our website at www.usps.com®.

OFFICIAL USE

Certified Mail Fee	\$
Extra Services & Fees (check box, add fee as appropriate)	
<input type="checkbox"/> Return Receipt (hardcopy)	\$
<input type="checkbox"/> Return Receipt (electronic)	\$
<input type="checkbox"/> Certified Mail Restricted Delivery	\$
<input type="checkbox"/> Adult Signature Required	\$
<input type="checkbox"/> Adult Signature Restricted Delivery	\$
Postage	\$
Total Postage and Fees	\$
Sent To	Colkelan Corporation 906 S. St. Francis Dr., Suite C Santa Fe, NM 87505
Street and Apt. No., or P.O. Box No.	
City, State, ZIP+4®	

PS Form 3800, April 2015 PSN 7530-02-000-9047 See Reverse for Instructions

U.S. Postal Service™
CERTIFIED MAIL® RECEIPT
Domestic Mail Only

For delivery information, visit our website at www.usps.com®.

OFFICIAL USE

Certified Mail Fee	\$
Extra Services & Fees (check box, add fee as appropriate)	
<input type="checkbox"/> Return Receipt (hardcopy)	\$
<input type="checkbox"/> Return Receipt (electronic)	\$
<input type="checkbox"/> Certified Mail Restricted Delivery	\$
<input type="checkbox"/> Adult Signature Required	\$
<input type="checkbox"/> Adult Signature Restricted Delivery	\$
Postage	\$
Total Postage and Fees	\$
Sent To	Sally Jo Roberts (a/k/a Sally Meador-Roberts) 1806 Hughes Street Midland, TX 79705
Street and Apt. No., or P.O. Box No.	
City, State, ZIP+4®	

PS Form 3800, April 2015 PSN 7530-02-000-9047 See Reverse for Instructions



Fort Worth Royalty Company
500 Throckmorton St., Suite 1104
Fort Worth, TX 76102-3709

750 FE 1 0008/14/21
RETURN TO SENDER
NOT DELIVERABLE AS ADDRESSED
UNABLE TO FORWARD
BC: 87504105656 *2182-01290414-29

STICKER AT TOP OF ENVELOPE TO THE RIGHT
RETURN ADDRESS: FOLD AT DOTTED LINE

CERTIFIED MAIL

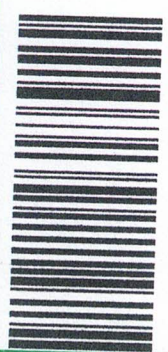

2450 0002 1364 3993

U.S. Postal Service™
CERTIFIED MAIL® RECEIPT
Domestic Mail Only

For delivery information, visit our website at www.usps.com®.

OFFICIAL USE

7020 2450 0002 1364 3993

Certified Mail Fee	\$	
Extra Services & Fees (check box, add fee as appropriate)		
<input type="checkbox"/> Return Receipt (hardcopy)	\$	
<input type="checkbox"/> Return Receipt (electronic)	\$	
<input type="checkbox"/> Certified Mail Restricted Delivery	\$	
<input type="checkbox"/> Adult Signature Required	\$	
<input type="checkbox"/> Adult Signature Restricted Delivery	\$	
Postage	\$	
Total Postage and Fees	\$	

Sent To
Street and Apt. No., or P
City, State, ZIP+4®

Fort Worth Royalty Company
500 Throckmorton St., Suite 1104
Fort Worth, TX 76102-3709

Postmark Here

87504>1056
UTF

Carlsbad Current Argus.

PART OF THE USA TODAY NETWORK

Affidavit of Publication

Ad # 0004858293

This is not an invoice

JAMES BRUCE ATTORNEY AT LAW
POBOX 1056

SANTA FE, NM 87504

I, a legal clerk of the **Carlsbad Current Argus**, a newspaper published daily at the City of Carlsbad, in said county of Eddy, state of New Mexico and of general paid circulation in said county; that the same is a duly qualified newspaper under the laws of the State wherein legal notices and advertisements may be published; that the printed notice attached hereto was published in the regular and entire edition of said newspaper and not in supplement thereof on the date as follows, to wit:

08/11/2021

Legal Clerk

Subscribed and sworn before me this August 11, 2021:

State of WI, County of Brown
NOTARY PUBLIC

1-7-25

My commission expires

KATHLEEN ALLEN
Notary Public
State of Wisconsin

NOTICE

To: EOG Resources Inc., Oxy USA WTP Limited Partnership, Yates-US Inc., Yates Energy Corporation, PetroYates, Inc., Rejar LLC, Harry B. Hinkle, Nadel and Gussman Capitan LLC, Finley Production Co. LP, Colkelan Corporation, Grasslands Energy LP, Burlington Resources Oil & Gas Company, Yates Energy Royalty Interests LLC, Pearson-Sibert Oil Co. of Texas, A.F. Gilmore Company, Janet Barr Fitting as Trustee of the Robert D Fitting Trust, E.B. Hall, Fort Worth Royalty Company, Gregg Alan Groves as Trustee of the Groves Family Trust, Rodney O. Thompson, and Sally Jo Roberts (a/k/a Sally Meador-Roberts), or your heirs, devisees, successors, or assigns: Matador Production Company has filed two applications with the New Mexico Oil Conservation Division seeking orders pooling all mineral interest owners in the Bone Spring formation underlying the following well units:

(a) the N/2S/2 of Section 32 and N/2S/2 of Section 31, Township 17 South, Range 31 East, NMPM. The unit will be dedicated to the Cedar 3231 Fed. Com. Well No. 123H. (Case No. 21991); and

(b) the S/2S/2 of Section 32 and S/2S/2 of Section 31, Township 17 South, Range 31 East, NMPM. The unit will be dedicated to the Cedar 3231 Fed. Com. Well No. 124H (Case No. 21992).

The lands are located in Eddy County, New Mexico. Also to be considered will be the cost of drilling, completing, and equipping the wells and the allocation of the cost thereof, as well as actual operating costs and charges for supervision, designation of applicant as operator of the wells and a 200% charge for the risk involved in drilling, completing, and equipping the wells.

The applications are scheduled to be heard at 8:15 a.m. on August 19, 2021. During the COVID-19 Public Health Emergency, state buildings are closed to the public and the hearing will be conducted remotely. To determine the location of the hearing or to participate in an electronic hearing, go to emnrd.state.nm.us/OCD/hearings or see the instructions posted on the Division's website, <http://emnrd.state.nm.us/OCD/announcements.html>. As an interest owner in the well units, you have the right to enter an appearance and participate in the cases. Failure to appear will preclude you from contesting these matters at a later date. A party appearing in a Division case is required by Division Rules to file a Pre-Hearing Statement no later than Thursday, August 12, 2021. This statement may be filed online with the Division at ocd.hearings@state.nm.us, and should include: The name of the party and his or her attorney; a concise statement of the case; the name(s) of the witness(es) the party will call to testify at the hearing; the approximate time the party will need to present his or her case; and identification of any procedural matters that need to be resolved prior to the hearing. The Pre-Hearing Statement must also be provided to the undersigned. As a working interest owner in the well units you have the right to enter an appearance and participate in the cases. Failure to appear will preclude you from contesting these matters at a later date. The attorney for applicant is James Bruce, P.O. Box 1056, Santa Fe, New Mexico 87504. The units are located approximately 5 miles east-southeast of Loco Hills, New Mexico. #4858293, Current Argus, August 11, 2021

Ad # 0004858293
PO #:
of Affidavits 1

This is not an invoice

EXHIBIT **F**